

MS.

0

0

7

6

2

LOT NO. 37.....

SURVEY NO. 762.....

### Field Notes

of the survey of the

Fountain

Mining Claim

Situate in Walnut Grove..... Mining district

County of Yavapai..... and in Sec. 5....., Tp. 12 N

Range 4 W 3 W....., of the Gila and Salt River Meridian.

ARIZONA.

Claimed by A. W. Callen.....

Survey executed by C. B. Foster..... D. S.

Under instructions dated January 30<sup>th</sup>..... 1886

Survey commenced February 25<sup>th</sup>..... 1886

Survey completed February 26<sup>th</sup>..... 1886.

# PRELIMINARY OATHS,

FOR SURVEYS OF MINING CLAIMS AND MILL-SITES.

WE, Joseph Seignard and Joseph Colmant

do solemnly swear that we will faithfully execute the duties of Chain Carriers; that we will level the chain upon uneven ground, and plumb the tally pins, whether by sticking or dropping the same; that we will report the true distance to all notable objects, and the true length of all lines that we assist in measuring, to the best of our skill and ability.

*Frank Dolbe*

J. Seignard  
Joseph Colmant

SWORN to and subscribed before me, this 25 day of February 1886

Frank Dolbe  
Nature Public

I, Joseph Seignard

do solemnly swear that I will well and truly perform the duties of Assessor according to instructions given me, to the best of my skill and ability.

*Frank Dolbe*

J. Seignard

SWORN to and subscribed before, me this 25 day of February 1886

Frank Dolbe  
Nature Public

Field Notes

of the Survey of the  
Fountain's Mining Claim  
 in Walnut Grove Mining District

(Yavapai County, Arizona)  
 Claimed by A. W. Galle  
 Surveyed by E. B. Foster U.S.  
 Deputy Mineral Surveyor under  
 instructions from the Surveyor  
 General of date January 30<sup>th</sup> 1886

Survey Commenced Feb 25 1886  
 " Completed " 26 1886.

Description of Survey.

Beginning at the Initial Mon.  
 mentioned in location notice  
 and marking the center of  
 claim where I set a slate  
 stone 16 x 14 x 6 ins. 1 ft in  
 ground and on W side build  
 mound of stones. Stone  
 marked F. 1 M.

U S Min Mon No 1 bears S 72°  
 15' E 512 ft

Thence S 68° W

to 14° 1' East

385 to French Gulch flows S  
 thence E

750 to loc mon for westerly  
 end center of claim where  
 I set a granite stone 18 x 14 x 12  
 ins 1 ft in ground and sur-  
 rounded same with  
 mound of stones. Stone  
 marked F No 1.

Feet

- Thence S 22° E  
Va 14° 1' East  
300 to loc mon where I set a  
slate stone 24x14x8 ins. 1 ft  
in ground and surrounded  
same with mound of stones.  
Stone marked F No 2  
Thence N 68° E  
Va 14° 1' East  
865 to Center French Gulch flom  
E  
1085 to road brs N and S E  
1500 to point where I set a slate  
stone 15x12x12 ins 1 ft in ground  
and surrounded same with  
mound of stones. Stone  
marked F No 3. no loc mon found  
Thence N 22° W  
Va 14° 1' East  
300 To point where I set a slate  
stone 24x14x4 ins. 1 ft in  
ground and surrounded  
same with mound of stones  
Stone marked F No 4  
original loc mon brs  
N 63° E 24 ft  
Thence N 22° W (same course)  
Va 14° 1' East  
300 to point where I set a  
granite stone 18x10x10 ins  
1 ft in ground and surrounded  
same with mound of stones  
Stone marked F No 5.  
original loc mon brs  
N 64° E 16 ft  
Thence S 68° W  
Va 14° 1' East  
390 To road brs N and S S E  
1083 " French gulch flom S  
1500 " point where I set a granite  
stone 22x10x8 ins 1 ft in ground  
and surrounded same with  
mound of stones. Stone marked

Sub

F' No 6

Original loc mon bms S  
70° W, 8 ft

Thence S 27° E

Va 14° 1' E

300 To mon and Stone F' No 1  
place of beginning on out  
boundaries of claim

Area of claim 20  $\frac{66}{100}$  acres

### Location

This claim is located  
along French gulch and  
in the foot hills of Walnut  
Cove Mountains and  
is on unurveyed lands

### Improvements

made upon this claim by  
Claimant or grantors consist  
of a shaft 10' x 10' 20 ft deep  
S 68° W 15 ft from Stone F' M  
a cut 12 ft long by 4 x 4 ft  
S 68° W 50 ft from Stone F' M  
a cut 6' x 6' 4 ft deep, S 68° W 10 ft  
from Stone F' M. a cross cut  
50 ft long average width and  
depth is 4 ft S 68° W 440 ft  
from Stone IM. a cut 4 x 4 x 4 ft deep  
N 68° E 720 ft from Stone F' M  
A road graded at intervals for a  
distance of 2 Miles said road  
having <sup>been</sup> built by Claimant for  
the development of this and  
the Arroyo Mining Claim  
I hereby certify that the  
value of said improvements  
exceeds the sum of five  
hundred dollars

There have been no other  
improvements made by  
other parties on this claim

Instruments used a  
Gurley Transit and 50  
ft steel chain  
for and courses determined  
by observation of  
Polaris

C. P. Foster  
Asst Deputy Mineral Surveyor

February 26 1886

AFFIDAVIT OF FIVE HUNDRED DOLLARS IMPROVEMENTS.

We, *Joseph Seignard* and *Joseph Calmont*  
 of lawful age, being first duly sworn according to law, depose and say that we are acquainted with the  
*Fountain*  
 mining claim, situated in *Walnut Grove*  
 Mining District, *Yavapai* County, Arizona  
 Territory, for which *A W Callen* and  
 ha *made* application for survey prior to application for patent under the provisions of the Act of  
 Congress approved May 10, 1872, and that the labor done and improvements made thereon by the appli-  
 cant and his grantor s exceed Five Hundred Dollars in value, and further that we are not per-  
 sonally interested in said mine.

J<sup>th</sup> Seignard  
 Joseph Calmont

TERRITORY OF ARIZONA,  
 County of *Yavapai* } SS.

*Grant Dolph*

SWORN to and subscribed before me, this *27* day  
 of *February* 188*6*

*Grant Dolph*  
 Notary Public



FINAL OATHS FOR SURVEYS OF MINING CLAIMS AND MILL SITES.

A LIST of names of individuals employed to assist in running, measuring, or marking the lines and corners described in the foregoing field-notes of the survey of the Mountain Mining Claim located in Walnut Grove Mining District Yavapai County, Arizona, showing the respective capacities in which they acted.

Joseph Sigmond Chainman
Joseph Colmant Chainman
Joseph Sigmond Axeman.
Flagman.

WE hereby certify that we assisted C.B. Foster U. S. Deputy Surveyor, in surveying the Mountain Mining Claim claimed by A.W. Callen located in Walnut Grove Mining District Yavapai County, Arizona, and that said survey has been in all respects, to the best of our knowledge and belief, well and faithfully executed, and the boundary monuments planted according to the instructions furnished by the Surveyor General.

J. Sigmond Chainman.
Joseph Colmant Chainman.
J. Sigmond Axeman.
Flagman.

Francis Delp

SWORN TO AND SUBSCRIBED before me this 27 day of February 1886 Francis Delp Notary Public

I, C.B. Foster U. S. Deputy Surveyor, do solemnly swear that, in pursuance of instructions from the U. S. Surveyor-General for Arizona, bearing date the 30 day of January 1886, I have well, faithfully and truly, in my own proper person, and in strict conformity with the instructions furnished by the Surveyor-General and the laws of the United States surveyed those portions the Mountain Mining Claim claimed by A.W. Callen located in Walnut Grove Mining District, Yavapai County, Arizona, as are represented in the foregoing field-notes as having been surveyed under my directions; and I do further solemnly swear that all the corners of said surveys have been established and perpetuated in strict accordance with the instructions furnished me, and that the foregoing are the true and original field-notes of such surveys,

C.B. Foster Deputy Surveyor.

SWORN TO AND SUBSCRIBED before me this 20 day of March 1886 W.C. Foster Notary Public

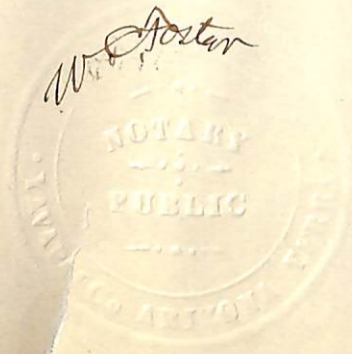

# Fountain

Notice of Location  
of the Fountain Mine or Mineral  
Claim under and in accordance  
with the provisions of an "Act of  
Congress" of the United States of  
America approved May 10<sup>th</sup> 1872  
and amendments thereto the under-  
signed claims for Mining purposes  
Six hundred feet in width and  
fifteen hundred feet in length  
along this vein or lode called the  
"Fountain" mine and situate on  
French Gulch and both sides thereof  
about one fourth of a mile upstream  
and at the upper spring and arastra  
on said French Gulch in Walnut  
Grove Mining District, Yavapai County  
Arizona Territory, said mine or  
Mineral Claim is described and  
bounded as follows to wit: Running  
along the ledge or vein from the  
Monument in which this notice (duplicate)  
is placed 750 feet southwesterly and  
750 feet northerly. The exterior bounda-  
ries commence at a stone monument

Territory of Arizona }  
County of Yavapai } 58

11

I William Wilkerson

County Recorder of the County of  
Yavapai Arizona, do hereby certify  
~~that~~ the above and foregoing  
to be a full true and correct  
transcript of the record of  
the "Notice of Location of the  
"Fountain" Mining Claim as the  
same appears of Record  
in this office.

In witness whereof  
I have hereunto set my  
hand and affixed my seal  
of office this 13<sup>th</sup> day  
of April AD 1886

William Wilkerson  
County Recorder

on the vein at the  $\text{S}$  westerly end  
of the claim, & running thence in  
a  $\text{S}$  easterly direction at a right  
angle with the vein 300 feet to  
a Stone Monument; Thence  $\text{N}$  easterly  
parallel with the vein 1500 feet  
to a Stone Monument; thence  $\text{N}$   
westerly at right angles with the  
vein 600 feet to a Stone Monument;  
thence  $\text{S}$  westerly parallel with  
the vein 1500 feet to a Stone mon-  
ument; thence  $\text{S}$  easterly at a right angle  
with the vein 300 feet to the  
place of beginning. Dated on the  
ground this 15<sup>th</sup> day of May 1884,

Witnesses }  
Cecilio Savana } A. W. Callen  
T B Everleigh } Locator & Claimant  
and 18 others }

Filed and recorded at request of A.  
W. Callen May 19 AD 1884 at  
9 o'clock am in Book 20 of  
Minutes pages 28 and 29 Records of Yavapai  
County Arizona H. H. Carter  
County Recorder

## U. S. Surveyor-General's Office.

Tucson, Arizona, *April 28<sup>th</sup>* 1886,

The foregoing Field Notes of the survey of the .....

*Fountain* .....

situate in the *Walnut Grove* mining district, *Yavapai* .....

County, Arizona, claimed by .....

*A. W. Callie* .....

survey executed by *C. B. Foster* Deputy .....

Surveyor, under instructions from this office, having been critically examined and the necessary corrections and alterations made, the said Field Notes and the survey they describe are hereby approved.

*John Wise* .....

Surveyor General.

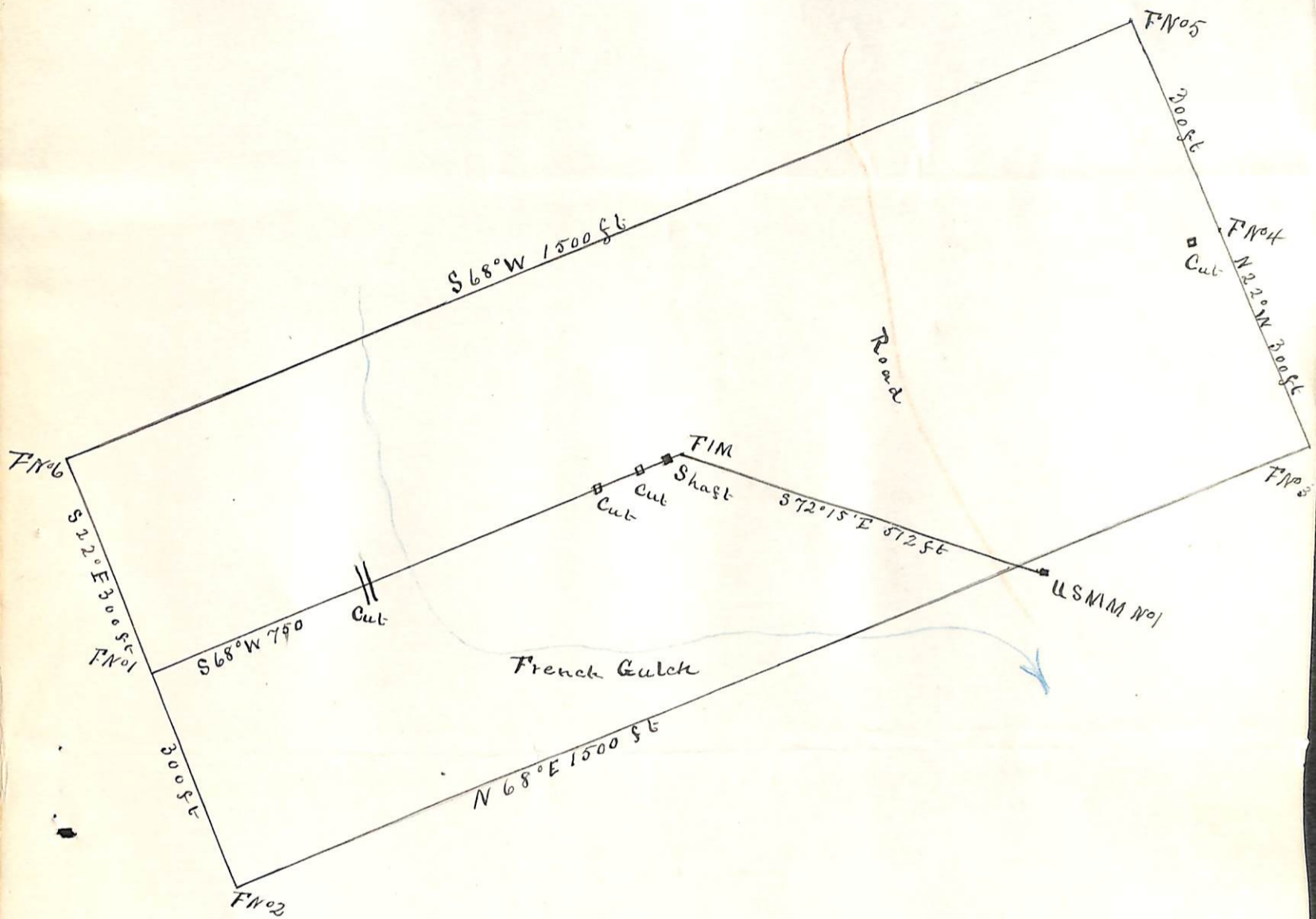

Plat  
of the  
Fountain Mining Claim  
Walnut Grove Mining District  
Yavapai County Arizona  
Claimed by A W Callen  
Surveyed by C B Foster USDS  
February 26 1886  
Contains 20.66 Acres  
Scale 200 ft to in  
Var 141° 1' E