

MS -

0

0

7

9

4

LOT NO. 187

SURVEY NO. 794

**FIELD NOTES**

of the survey of the

Chance

Mining Claim

Situate in Tombstone mining district,

County of Cochise and in Sec 16, Tp 20 S,

Range 22 E, of the Gila and Salt River Meridian.

ARIZONA.

Claimed by C W Leach

Survey executed by H G Howe D. S.

Under instructions dated November 1<sup>st</sup> 1886,

Survey commenced December 11<sup>th</sup> 1886

Survey completed December 13<sup>th</sup> 1886

# PRELIMINARY OATHS,

FOR SURVEYS OF MINING CLAIMS AND MILL-SITES.



I we,            and     

do solemnly swear that <sup>I</sup> we will faithfully execute the duties of Chain Carriers; that <sup>I</sup> we will level the chain upon uneven ground, and plumb the tally pins, whether by sticking or dropping the same; that <sup>I</sup> we will report the true distance to all notable objects, and the true lengths of all lines that <sup>I</sup> we assist in measuring, to the best of <sup>my</sup> ~~our~~ skill and ability.

SWORN to and subscribed before me, this      <sup>th</sup>/ day of      188    



I,       
do solemnly swear that I will well and truly perform the duties of       
     according to instructions given me,  
to the best of my skill and ability.

SWORN to and subscribed before me, this      day  
of      188

Field Notes

of the survey of the

ChanceMining ClaimTombstone Mining DistrictCochise County, ArizonaClaimed byChas. W. Leach

Surveyed by

H. G. Howe

U. S. Depy. Mil. SurveyorUnder instructions from the  
surveyor General, bearing date  
November 1st - 1886 -Survey Commenced. Dec 11-86  
Survey Completed " 13-86

Feet.

Description of Survey.

Commencing at the Initial monument. I a post in a monument of stone. as described in the supplemental notice of location.

Post marked I.M. CHANCE Situated at N.W. center end of claim. where I set post 5 ft long, 4 inches square, 1 foot in ground. and surround by monument of stone and earth, 4 feet at base and 3 feet high

Post marked I.M. Chance, M.C. No. 1. from which a shaft 4x6 feet. over one hundred feet deep bears S 72° 32' W. one hundred and twenty four feet distant Thence N. 64° - 28' W.

Var. 11° 43' East.

58.7  
300. 4 inch post marked S. Center Bonanza To post in monument of stones marked N.W. Corner Chance. South side 4 in. post. marked S.W. Bonanza. where I set post 5 ft long, 4 in. square. 1 ft. in ground on South side of of a 4 in. post marked S.W. Bonanza. and rebuild monument of stone around them 4 1/2 feet at base. 3 ft high

Post marked C. M. C. No. 2. Thence S. 32° 40' W.

Var. 11° 43' East.

1500. To 4 in. post. in monument of stone. Post marked S.W. Corner, where I set post 5 feet long, 4 in. square. 1 foot in ground, surrounded by monument of stone 4 1/2 ft at base. 3 ft high.

- Feet Post marked C. M. C. No 3  
Thence  $S 64^{\circ} 28' E$ .  
Var  $11^{\circ} 43' East$
300. To a 4 in. post in monument  
of stone S.W. Center of Claim,  
where I set a post 5 ft long.  
4 in. square, 1 ft. in ground,  
surrounded by monument of  
stone  $4\frac{1}{2}$  ft at base. 3 ft high.  
Post marked C. M. C. No. 4.
- From which croppings bear  $N 32^{\circ}$   
 $40' E$ , four hundred feet distant.  
Thence  $S 64^{\circ} 28' E$ ,  
Var  $11^{\circ} 43' East$ .
- 300 To a 4 in post in monument of  
stone the S. E. corner of claim.  
where I set post 5 ft long. 4 in  
square. 1 ft. in ground, surround-  
ed by monument of stone  $4\frac{1}{2}$  ft  
at base. 3 ft high.  
Post marked C. M. C. No 5  
From which U. S. M. M. No. 3. bears  
 $N 45^{\circ} 48' W$  7096 ft distant  
U. S. M. M. No. 6. bears  $S 70^{\circ} 40' E$ .
- Corner to sections 1 & 2 North  
boundary T. 20. S. R. 22. E. bears  $N 43^{\circ}$   
 $02' East$  18018 ft distant
- Thence  $N 32^{\circ} 40' E$ .  
Var  $11^{\circ} 43' East$ .
- 1500 To a 4 in. post in monument of  
stone the N. E. corner, where I  
set post 5 ft long. 4 in square. 1 ft  
in ground, and surround by  
monument of stone  $3\frac{1}{2}$  ft at base  
3 feet high.  
Post marked C. M. C. No. 6.  
Thence  $N 64^{\circ} 28' W$ .  
Var  $11^{\circ} 43' East$
- 144.7 Post in line the S. E. corner Bonanza  
300 To post No. 1, and place of beginning

## Area

Containing a total area of 20.66 Acres.

## Location

This mining claim is located in the Tombstone Mining District, Cochise County, Arizona Territory, and about two (2) miles South Westerly from town of Tombstone, and about 500 yds South Easterly from Merrimac Mining Claim.

This claim is bounded upon N. E. by the Bonanza Mining Claim. Not surveyed.

## Improvements.

The improvements made upon this claim by the present owner or his grantors, consist of a shaft 4x6 feet over one hundred feet deep, and over one hundred feet in length of drifts from the shaft.

And I hereby certify that the labor done by the present owner or his grantors, exceed in value the sum of five hundred dollars.

There have been no improvements made by other parties upon this claim.

Instruments used an improved Youngs Solar Transit, and steel tape

Variation and courses taken by use of solar apparatus.

A. C. Howe,

U. S. Dep. Mineral Surveyor

Dec 21<sup>st</sup> /86.

Tombstone, Arizona.

## AFFIDAVIT OF FIVE HUNDRED DOLLARS IMPROVEMENTS.

We, Casper Taylor and Gas H Hart,  
of lawful age, being first duly sworn according to law, depose and say that we are acquainted with the  
Chance.

\_\_\_\_\_ mining claim, situated in \_\_\_\_\_  
Tombstone - Mining District, Cochise County, Arizona  
Territory, for which Chas W. Leuch,  
has made application for survey prior to application for patent under the provisions of the Act of  
Congress approved May 10, 1872, and that the labor done and improvements made thereon by the appli-  
cant - and his grantor - exceed Five Hundred Dollars in value, and further that we are not per-  
sonally interested in said mine.

Casper Taylor  
Gas. H. Hart

TERRITORY OF ARIZONA,  
County of Cochise. } SS.

SWORN to and subscribed before me, this 21<sup>st</sup> day

of December 1886,

B. L. Peel  
Probate Judge.



FINAL OATHS FOR SURVEYS OF MINING CLAIMS AND MILL SITES.

A LIST of names of individuals employed to assist in running, measuring or marking the lines and corners described in the foregoing field-notes of the survey of The Chance Mining Claim located in Tombstone Mining District, Cochise County, Arizona, showing the respective capacities in which they acted.

Jas H Hart Chairman.  
Chainman.  
Axeman.  
Flagman.

I H. G. Howe hereby certify that I assisted H. G. Howe U. S. Deputy Surveyor, in surveying The Chance Mining Claim claimed by Chas W Leach located in Tombstone Mining District, Cochise County, and in Township No. 20. S. Range No. 22. E. of the Gila and Salt River base and meridian, Arizona, and that said survey has been in all respects, to the best of my knowledge and belief, well and faithfully executed, and the boundary monuments planted according to the instructions furnished by the Surveyor-General.

Jas. H. Hart Chairman.  
Chainman.  
Axeman.  
Flagman.

SWORN TO AND SUBSCRIBED before me this 21<sup>st</sup> day of December 1886

A O Wallace  
Notary Public

I, H. G. Howe U. S. Deputy Surveyor, do solemnly swear that, in pursuance of instructions from the U. S. Surveyor General for Arizona, bearing date the 1<sup>st</sup> day of November 1886, I have well, faithfully and truly, in my own proper person, and in strict conformity with the instructions furnished by the Surveyor-General and the laws of the United States, surveyed all those portions of the Chance Mining Claim claimed by Chas W. Leach located in Tombstone Mining District, Cochise County, Arizona, as are represented in the foregoing field-notes as having been surveyed under my instructions; and I do further solemnly swear that all the corners of said surveys have been established and perpetuated in strict accordance with the instructions furnished me, and that the foregoing are the true and original field-notes of such surveys.

H. G. Howe Deputy Surveyor.

SWORN TO AND SUBSCRIBED before me this 21<sup>st</sup> day of December 1886

A. O. Wallace  
Notary Public



a 4 in post in monument of stone. Thence  
 $S 32^{\circ} 40' W$  1500ft to the S.W. cor a 4 in post in  
 monument of stone. Thence  $S 64^{\circ} 28' E$  300ft  
 to the south center of claim a 4 in post in  
 monument of stone. Thence  $S 64^{\circ} 28' E$  300ft to a 4  
 in post in monument of stone the South East corner  
 of claim. Thence  $N 32^{\circ} 40' E$  1500ft to the North East  
 corner of claim a 4 in post in monument of  
 stone. Thence  $N 64^{\circ} 28' W$  300ft to the initial  
 monument and place of beginning. This claim  
 is bounded upon the North by the Bonanza  
 Mining claim. This notice is placed upon  
 the initial monument of the Chance mine  
 this 20<sup>th</sup> day of October 1886 By  
 Witness by C.A. Wallace L.H. Leach  
 Filed and recorded at request of L.H.  
 Leach Oct 20<sup>th</sup> 1886 at 3 P.M.

A.S. Jones.

County Recorder

Chance Mine

14

000

14

1300

PLAT  
of the  
Chance Mining Claim  
Tombstone Mining District

COCHISE COUNTY ARIZONA.

Containing 20.66 Acres.

Scale 200 ft = 1 inch.

var 11° 43' East.

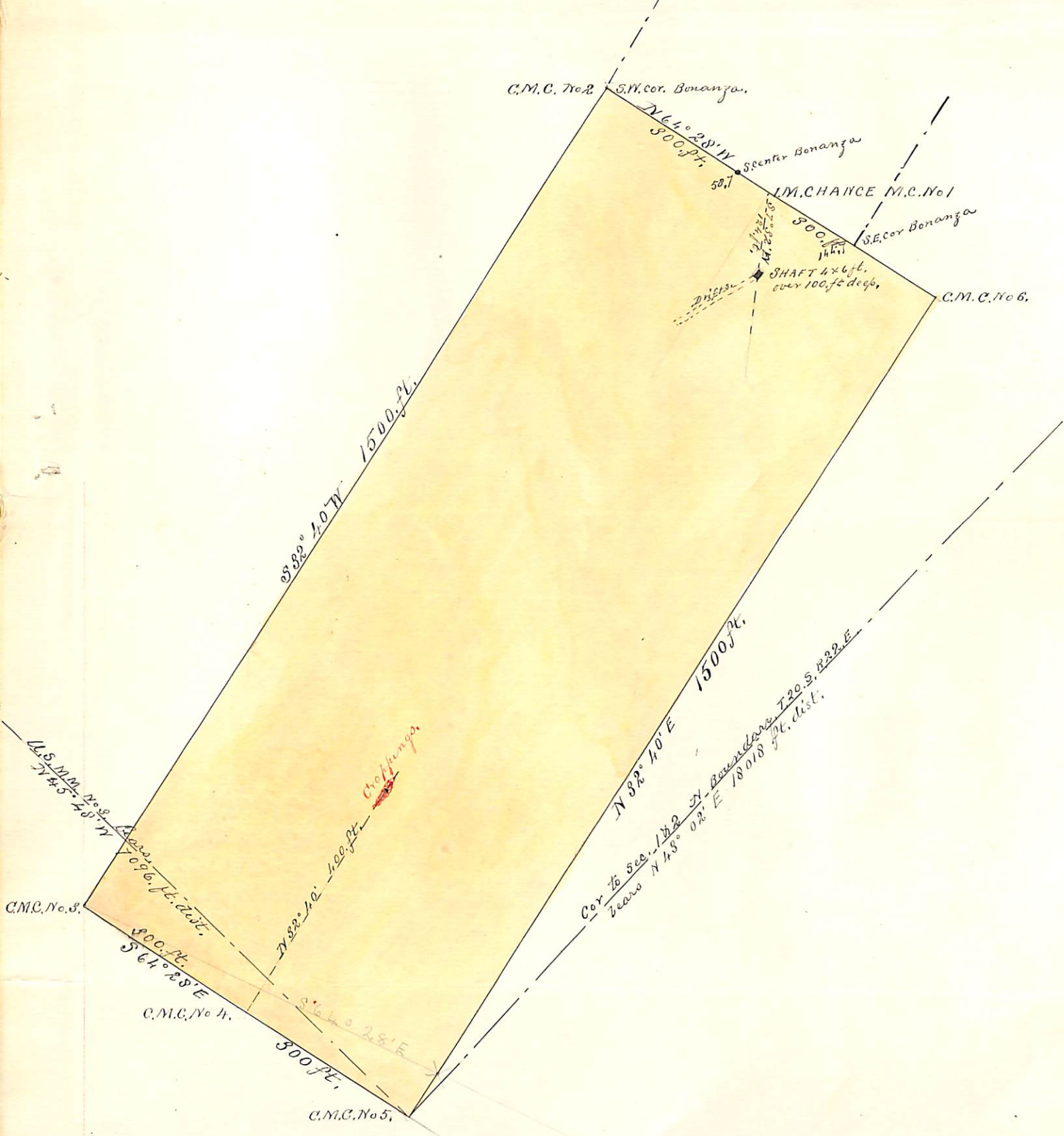

## U. S. Surveyor-General's Office.

Tucson, Arizona, December 31<sup>st</sup> 1886.

The foregoing Field Notes of the survey of the

Chance Mining Claim  
situate in the Lou Boston mining district, Cochise  
County, Arizona, claimed by

C. W. Leach,  
survey executed by H. G. Howe Deputy

Surveyor, under instructions from this office, having been critically  
examined and the necessary corrections and alterations made, the said  
Field Notes and the survey they describe are hereby approved.

John Hise  
Surveyor General.