

**M
S
-**

0

0

8

1

3

LOT NO. 50

SURVEY NO. 813

FIELD NOTES

of the survey of the

Sink To Rise

Mining Claim

Situate in Big Bug mining district,

County of Yavapai and in Sec. 11, Tp. 13 N

Range 1 E, of the Gila and Salt River Meridian.

ARIZONA.

Claimed by Frank W. Caber and W.C. Parsons

Survey executed by C.B. Foster D. S.

Under instructions dated May 17th 1887

Survey commenced May 25th 1887

Survey completed May 25th 1887

PRELIMINARY OATHS.

FOR SURVEYS OF MINING CLAIMS AND MILL-SITES.

WE, *J. B. Breitschmitt* and *George Rohpeter*
do solemnly swear that we will faithfully execute the duties of Chain Carriers; that we will level the chain upon uneven ground, and plumb the tally pins, whether by sticking or dropping the same; that we will report the true distance to all notable objects, and the true length of all lines that we assist in measuring, to the best of our skill and ability.

J. B. Breitschmitt
George Rohpeter

Henry J. Andrews

SWORN to and subscribed before me this *25th* day
of *May*, 188*7*.

Henry J. Andrews
Notary Public

I, *George Rohpeter*
do solemnly swear that I will well and truly perform the duties of
Arman according to instructions given me,
to the best of my skill and ability.

George Rohpeter

Henry J. Andrews

SWORN to and subscribed before me this *25th* day
of *May*, 188*7*.

Henry J. Andrews
Notary Public

Field Notes
of the Survey of the
Sink to Rise Mining Claim
in the Big Bug Mining District
Yavapai County.

Arizona

Claimed by Frank McCabe
and W. C. Parsons.

Surveyed by E. B. Foster U.S.
Deputy Mineral Surveyor under
instructions from the Surveyor
General of date May 17th 1887

Survey Commenced May 25. 1887
" Completed " 25. 1887

Sub

Description of Survey

Beginning at the Initial Mon.
Mentioned in Location Notice
located in central portion of
claim where I set a post 4
ft long, 4 ins squared $1\frac{1}{2}$ ft
in ground and surrounded
same with mound of stones
Post marked I M S R No 1.

U S Min Mon No 1 brs N 41°
16' E 9850 ft

A prominent peak of Lynx
Creek Mountains brs S 61° W

Thence S 65° W

458 To loc mon^{cy} for westerly end center of claim. 14° E
where I set a granite
stone 20x16x12 ins 1 ft in ground
and surrounded same with
mound of stones. Stone marked
S. R. No 2.

Feet. Thence S 25° E
Va 14° E

170 To Center of Galena Gulch
flows E. N. E.

300 To loc Mon where I set a
granite Stone 20x12x4 ins 1ft
in ground and surrounded
same with mound of stones
Stone marked S R No 3.

Thence N 65° E
Va 14° E

1154 To point where I set a granite
stone 18x12x10 ins 1 ft in ground
and surrounded same with mound
of stones. Stone marked S R No 4.
Original loc. Mon. bcs N 63° E
12 ft

Thence N 25° W
Va 14° E

160 To Road bcs N E and S W

188 " Center of Galena Gulch
flows E. N. E.

300 To loc. Mon. for easterly end
center of claim where I set
a granite stone 18x10x10 ins
1ft in ground and surrounded
same with mound of stones
Stone marked S R No 5.

Thence N 25° W (same course)
Va 14° E

300 To loc Mon where I set a
granite Stone 24x12x10 ins 1ft
in ground and surrounded
same with mound of stones.
Stone marked S R No 6

Thence S 65° W
Va 14° E

1154 To point where I set a granite
stone 22x14x12 ins 1ft in ground
and surrounded same with
mound of stones. Stone
marked S R No 7. No loc Mon
found at this cor.

Feet Thence $A 25^{\circ} E$
 Va $140^{\circ} E$

300 To Mon and Stone marked
 S. R. No 2. place of beginning
 on out boundaries of Claim.

Area

Total and Net area of Claim 15.89 Acres

Location

This Claim is located along
 Galena Gulch about
 4 miles East of the Summit
 of the Lynx range of Moun-
 tains and is on unsurveyed
 land

Improvements

Made upon this Claim by
 claimants or their grantors
 consist of work as follows
 a Shaft $6 \times 4'$ and 10 ft deep.
 N $64^{\circ} E$ 345 ft. a Shaft $8 \times 4'$
 and 8 ft deep N $65^{\circ} E$ 355 ft.
 a Shaft $4 \times 4 \times 4'$ deep brs N
 $63^{\circ} E$ 363 ft. a Cut 30 ft
 long by 6 ft deep by 4 ft
 wide brs N $65^{\circ} E$ 450 ft to
 Westerly end of same
 a Shaft $6 \times 4'$ and 45 ft deep
 brs N $65^{\circ} E$ 535 ft.

All bearings and distances taken from
 Post I. M. S. R. No 1.

and I hereby certify that the value
 of said improvements exceeds
 the sum of five hundred dollars
 There are no improvements
 made by other parties on
 this claim.

Instruments used a Gurley
 Solar Transit and Steel
 chain

Var and Course taken by
me of Glass apparatus

C. R. Foster

Albany Mineral Spring

Greenwich N. Y. May 26. 1887

AFFIDAVIT OF FIVE HUNDRED DOLLARS IMPROVEMENTS.

WE, J B Breitschmitt and George Rohpeter
of lawful age, being first duly sworn according to law, depose and say that we are acquainted with
the "Sink to Rise"
mining claim, situated in Big Bug Mining District, Yavapai County, Arizona
Territory, for which Frank McCabe and W. C. Parsons
have made application for survey prior to application for patent under the provisions of the act
of Congress approved May 10, 1872, and that the labor done and improvements made thereon by
the applicant and the grantors exceed Five Hundred Dollars in value, and further that
we are not personally interested in said mine.

J. B. Breitschmitt
George Rohpeter

TERRITORY OF ARIZONA. }
County of Yavapai } ss.

Henry J. Andrews

SWORN to and subscribed before me this 25th day
of May, 1887.

Henry J. Andrews
Notary Public

FINAL OATHS FOR SURVEYS OF MINING CLAIMS AND MILL SITES.

A list of names of individuals employed to assist in running, measuring or marking the lines and corners described in the foregoing field-notes of the survey of the

located in Sink to Rise Mining District, Yavapai County, Arizona, showing the respective capacities in which they acted.

George R. Roper, Chairman.
J. B. Breitschmitt, Chairman.
George Roper, Axeman.
....., Flagman.

We hereby certify that we assisted C. B. Foster U. S. Deputy Surveyor, in surveying the Sink to Rise Mining Claim claimed by Frank McCabe and W. C. Parsons located in Big Bug Mining District, Yavapai County, and in Township No. _____, Range No. _____ of the Gila and Salt River base and meridian, Arizona, and that said survey has been in all respects, to the best of my knowledge and belief, well and faithfully executed, and the boundary monuments planted according to the instructions furnished by the Surveyor General.

Berry J. Andrews

J. B. Breitschmitt, Chairman.
George Roper, Chairman.
George Roper, Axeman.
....., Flagman.

SWORN to and subscribed before me this 25th day of May, 1887.

Berry J. Andrews
Notary Public

I, C. B. Foster U. S. Deputy Surveyor, do solemnly swear that, in pursuance of instructions from the U. S. Surveyor General for Arizona, bearing date the 17th day of May, 1887, I have well, faithfully and truly, in my own proper person, and in strict conformity with the instructions furnished by the Surveyor General and the laws of the United States, surveyed all those portions the "Sink to Rise Mining Claim" claimed by Frank McCabe and W. C. Parsons located in Big Bug Mining District, Yavapai County, Arizona, as are represented in the foregoing field-notes as having been surveyed under my instructions; and I do further solemnly swear that all the corners of said surveys have been established and perpetuated in strict accordance with the instructions furnished me, and that the foregoing are the true and original field-notes of such surveys.

C. B. Foster Deputy Surveyor.

SWORN to and subscribed before me this 25th day of May, 1887.

Berry J. Andrews
Notary Public

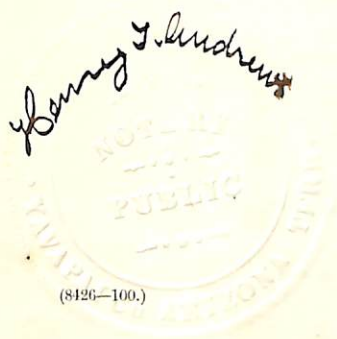

Sink to Rise

February 28th 1883

Mining Notice

The undersigned have this day located and claimed one Mining Claim, fifteen hundred linear feet on the lead ledge or Mineral deposit of gold bearing rock, together with three hundred feet on each side of the thread or middle of the vein and running from this notice and Monument of five hundred feet westerly to Monument of Stone setting on the North side of Galena Gulch and North of a dead tree standing in the Gulch; also claim from this said initial Monument one thousand feet easterly to a like Monument of Stone in due line of the lead; also corners of this claim is duly Monumented in plain view, and more particularly described and old Anrastra setting 300 feet below it in the gulch.

Located in Big Bug District, Yavapai County Az Territory, and shall be known as the Sink to Rise Mining Claim.

Located this 28th day of January 1883.

Located by Frank McCabe

R. H. Upton

Witness
Charles Dugd.

10

Filed and recorded at request of
Frank McCabe February 28th 1883
at 1.50 o'clock P.M. In Book 16
of Minis Page 604 Records
of Yavapai County Arizona.

H. H. Carter
County Recorder

Territory of Arizona }
County of Yavapai } S S

I E. J. F. Horne County
Recorder of the County of Yavapai
Territory of Arizona and Custodian of
the Records thereof, hereby certify
the above and foregoing to be a full,
true and correct copy of the original
location notice of the "Sink to Rise"
Mining Claims situated in Big Bug
District Yavapai County Arizona
Territory as the same appears of
record in my office.

In witness whereof I have
hereunto set my hand and affixed
my official seal this 12th day
of May A.D. 1887.

E. J. F. Horne
County Recorder.

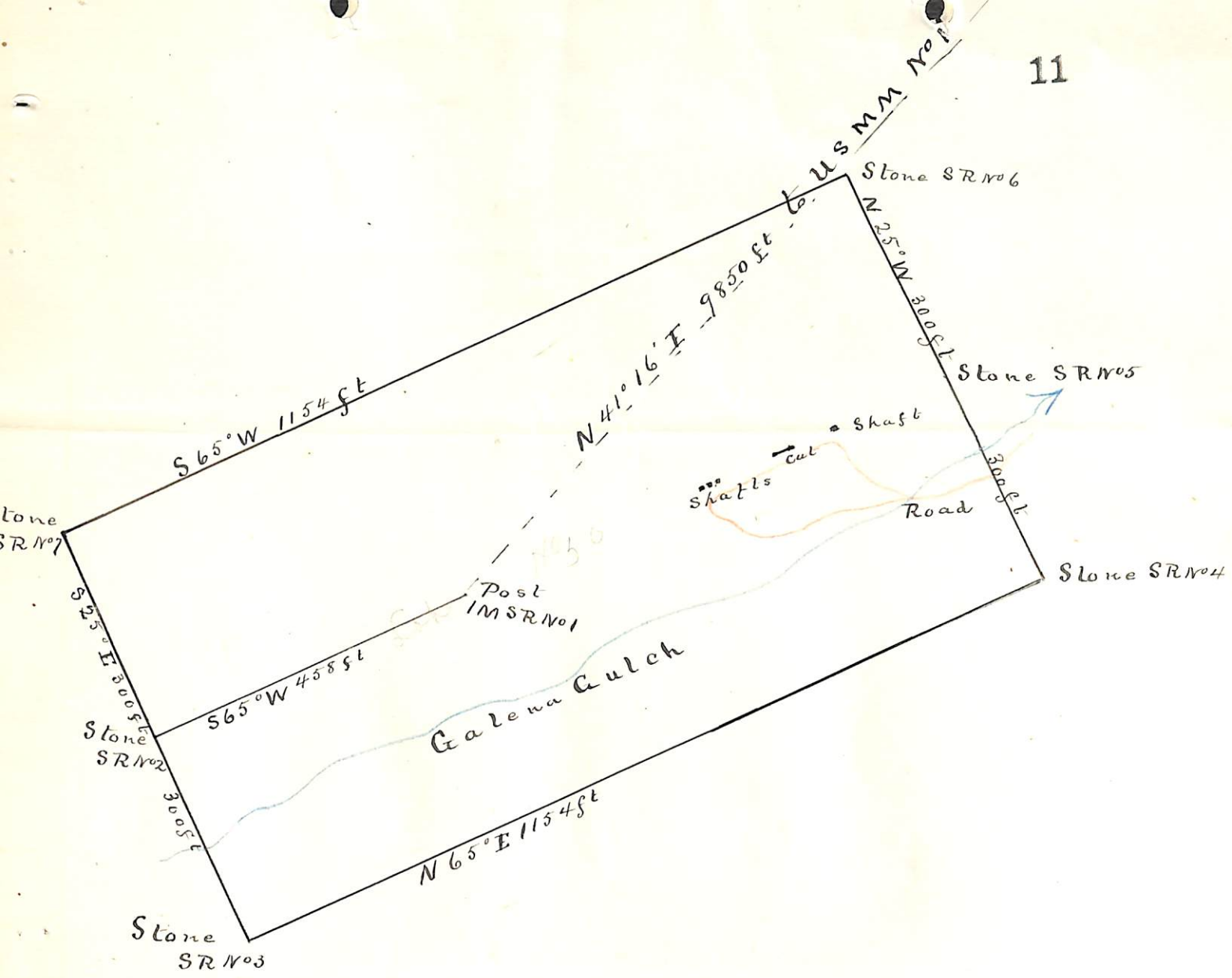

Plat

of the

Sink to Rise Mining Claim

Big Bug Mining District

Yavapai County, Arizona

Claimed by Frank McCabe & W.C. Parsons

Surveyed by C.B. Foster U.S.D.S.

May 25 1887

Contains 15.89 Acres

Scale 200 ft to 1 in

Var 14° E.

U. S. Surveyor-General's Office.

Tucson, Arizona, June 17th 1887.

The foregoing Field Notes of the survey of the
 "Sunk to Rise" Mining claim
 situate in the Big Bug mining district, Yavapai
 County, Arizona, claimed by Frank Mc Cabe
and W. C. Parsons
 survey executed by C. B. Foster Deputy
 Surveyor, under instructions from this office, having been critically
 examined and the necessary corrections and alterations made, the said
 Field Notes and the survey they describe are hereby approved.

John Hise
 Surveyor General.