

MS .

0

0

8

1

8

LOT NO. 74

SURVEY NO. 818

**FIELD NOTES**

of the survey of the

Red Robin

Mining Claim

Situate in Globe mining district,

County of Gila and in Sec     , Tp 1N

Range 17 T5E, of the Gila and Salt River Meridian.

ARIZONA.

Claimed by Levi Newcomb, H. P. Salmadge,

and L Downing, Trustees,

Survey executed by H. G. Howe D. S.

Under instructions dated June 11<sup>th</sup> 1887

Survey commenced July 29<sup>th</sup> 1887

Survey completed July 29<sup>th</sup> 1887

# PRELIMINARY OATHS,

FOR SURVEYS OF MINING CLAIMS AND MILL-SITES.

WE, W A Holmes and Chancery Gunn,

do solemnly swear that we will faithfully execute the duties of Chain Carriers; that we will level the chain upon uneven ground, and plumb the tally pins, whether by sticking or dropping the same; that we will report the true distance to all notable objects, and the true length of all lines that we assist in measuring, to the best of our skill and ability.

W. A. Holmes,  
Chancery Gunn

Sworn to and subscribed before me this 28<sup>th</sup> day

of July, 1887.  
W W Kingsbury  
Probate Judge

I, \_\_\_\_\_

do solemnly swear that I will well and truly perform the duties of \_\_\_\_\_  
\_\_\_\_\_ according to instructions given me,  
to the best of my skill and ability.

SWORN to and subscribed before me this \_\_\_\_\_ day

of \_\_\_\_\_, 188 .

Field Notes  
of Survey of the

Red Robin Mining Claim  
in the Globe Mining District  
Gila, County, Arizona.

Claimed by.

Levi Newcomb H.P. Tallmadge and  
L. Downing Trustees.

Surveyed by H.G. Howe, U.S.  
Deputy Mineral Surveyor under  
instructions from the Surveyor  
General of date June 11<sup>th</sup>/87

Survey commenced July 28<sup>th</sup>/87  
Survey completed July 29<sup>th</sup>/87

Description of Survey

Feet, Beginning at the Initial mon.  
mentioned in location, marking  
the N.E. end center of claim  
where I set Post 4½ ft. long 4 in  
sqr. 6 in in ground, and surround  
by mound of stone.

Post marked J.M. RED ROBIN. M.C.  
No. 1.

Thence  $S40^{\circ}58'E$

Var  $13^{\circ}20'E$

Along the N.E. end of claim which  
is also the S.W. end of the Julius,  
300. So old mon, the N.E. cor. where  
I set post 4½ ft long 4 in sqr. 6 in  
in ground and surround  
by mound of stone.

Post marked R.R. M.C. No. 2.

Thence  $S49^{\circ}02'W$

Var  $13^{\circ}20'E$

Feet Along S.E. side line and slope of hill.

1217. To old mon. the S.E. cor. where I set post 4 1/2 ft long 4 in sgr. 6 in in ground and surround by mound of stone.  
Post marked R.R.M.C. No 3.  
Thence N 40° 58' W

Var 13° 20' E

60. Small wash drains S.W.

300. To S.W. center end mon, where I set post 4 1/2 ft long 4 ins sgr, 6 ins in ground and surround by mound of stone.  
Post marked R.R.M.C. No 4.  
From which U.S. M.M. No 3 (also 6 in Post) bears S 62° 32' W 3160 ft.  
Thence N 40° 58' W

Var 13° 20' E

300. To S.W. cor an old mon, where I set Post 4 1/2 ft. long 4 in sgr. 6 in in ground and surrounds by mound of stone  
Post marked R.R.M.C. No 5.  
Thence N 52° 35' E

Var 13° 20' E

925. Intersect south end line Fame mining claim brs S 52° 30' E

1219. To old mon and N.W. cor. where I set post 4 1/2 ft long 4 in sgr, 6 in in ground and surround by mound of stone.  
Post marked R.R.M.C. No 6.  
Thence S 40° 58' E

Var 13° 20' E

56. Intersect east line Fame M.C. N 37° 17' E 273. ft from S.E. cor.

225 To Post No 1 and place of beginning the survey of the exterior lines.

Area.

Total area 15.71 acres

5

Feet. The conflict with the  
Fame mine is .64 Acres  
which is claimed by the  
owners of this claim,

#### Location.

This claim is located in the  
Globe Mining District Gila  
County, Arizona, about 5  
miles from Globe city, and on  
the southerly slope of Mineral  
or quartzite Hill, and is bo-  
unded upon the N.E. by the  
Julius mine and N.W. by the  
Fame with which it conflicts.

#### Improvements.

made upon this claim by clai-  
nants or grantors consist of  
Tunnel 4x7 ft. 150 ft. long.  $S49^{\circ}02'W$   
535 ft. from Post. No. 1.

Shaft 4x8 ft. 15 ft deep.  $S49^{\circ}02'W$   
513 ft. from Post. No. 1.

and I hereby certify that the  
value of said improvements  
exceeds the sum of five hundred  
dollars.

There have been no improvements  
made by other parties on this  
claim.

Instruments used, a young's  
improved Solar Transit and  
steel tape.

Bar, and courses taken by  
use of Solar Apparatus.

H. S. Howe U. S.

Deputy Mineral Surveyor.  
Tombstone Augt. 18<sup>th</sup>/87

AFFIDAVIT OF FIVE HUNDRED DOLLARS IMPROVEMENTS.

WE, W. A. Holmes and Chancy Gunn  
of lawful age, being first duly sworn according to law, depose and say that we are acquainted with  
the Red Robin \_\_\_\_\_  
\_\_\_\_\_ mining claim, situated in the Globe,  
\_\_\_\_\_ Mining District, Gila \_\_\_\_\_ County, Arizona  
Territory, for which J. L. Stiles Attorney for Levi Newcomb et al.  
have made application for survey prior to application for patent under the provisions of the act  
of Congress approved May 10, 1872, and that the labor done and improvements made thereon by  
the applicant S and this grantor S exceed Five Hundred Dollars in value, and further that  
we are not personally interested in said mine.

W. A. Holmes,  
Chancy Gunn

TERRITORY OF ARIZONA, }  
County of Gila } ss.

SWORN to and subscribed before me this 30th day  
of July, 1887.

W. W. Kingsbury Public Clerk

# FINAL OATHS FOR SURVEYS OF MINING CLAIMS AND MILL SITES.

A list of names of individuals employed to assist in running, measuring or marking the lines and corners described in the foregoing field-notes of the survey of

*The Red Robin Mining Claim,*  
located in *Globe,* Mining District, *Gila,*  
County, Arizona, showing the respective capacities in which they acted.

*W. A. Holmes,* Chainman.  
*Chancy Gunn,* Chainman.  
Axeman.  
Flagman.

We hereby certify that we assisted *H. G. Howe,*  
U. S. Deputy Surveyor, in surveying  
*The Red Robin Mining Claim,*  
claimed by *Levi Newcombe, H. P. Tallmudge and L. Downing, Trustees,*  
located in *Globe,* Mining District, *Gila* County,  
and in Township No. \_\_\_\_\_, Range No. \_\_\_\_\_ of the Gila and Salt River base and meridian,  
Arizona, and that said survey has been in all respects, to the best of my knowledge and belief, well and faithfully  
executed, and the boundary monuments planted according to the instructions furnished by the Surveyor General.

*W. A. Holmes,* Chainman.  
*Chancy Gunn* Chainman.  
Axeman.  
Flagman.

SWORN to and subscribed before me this *30th* day

of *July*, 1887.  
*W. V. Kugebunz*  
*Clk of the Probate Court*

I, *H. G. Howe,* U. S. Deputy Surveyor, do solemnly swear that, in pursuance  
of instructions from the U. S. Surveyor General for Arizona, bearing date the *Eleventh* day of  
*June*, 1887, I have well, faithfully and truly, in my own proper person, and in strict  
conformity with the instructions furnished by the Surveyor General and the laws of the United States, surveyed all  
those portions *of the Red Robin Mining Claim,*

claimed by *Levi Newcombe, H. P. Tallmudge and L. Downing Trustees*  
located in *Globe,* Mining District, *Gila,* County,  
Arizona, as are represented in the foregoing field-notes as having been surveyed under my instructions; and I do  
further solemnly swear that all the corners of said surveys have been established and perpetuated in strict accordance  
with the instructions furnished me, and that the foregoing are the true and original field-notes of such surveys.

*H. G. Howe,* Deputy Surveyor.

SWORN to and subscribed before me this *18th* day

of *August*, 1887.  
*W. H. Daily*  
Clerk



I, C. T. MARTIN, County Recorder, in and for said County, Territory aforesaid do hereby certify that the above and foregoing is a full, true and correct copy of a location

Notice of the "Red Robin" Mine  
as the same appears of record in my office, in Book 6 of Mine at Page 129

Given under my hand and official seal this 9<sup>th</sup> day of June 1887

Chas. Martin Recorder.

..... Deputy.

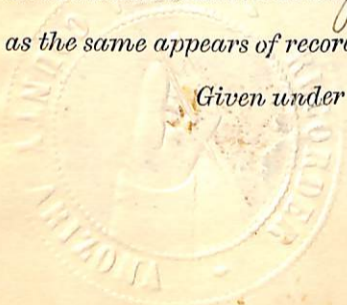

Notice of Location

Notice is hereby given that the undersigned in compliance with the requirements of the Mining Act of Congress, approved May 10<sup>th</sup> 1872, have this day located and claim fifteen hundred linear feet along the course of this lead, lode or vein of mineral bearing quartz, and three hundred feet in width on each side of the middle of said lead, lode or vein situate in Globe Mining District, County of ~~Pinal~~ Arizona and more particularly described as follows, to wit:

Commencing at this monument of stones, being the center of the North East end of claim upon which this notice is posted thence South East 300 feet to a monument of stones, thence South west 1500 feet to a monument of stones, thence Northwest 300 feet to a monument of stones, being the center of the South west end of claim, thence Northwest 300 feet to a monument of stones; thence North east 1500 feet to a monument of stones, thence South east 300 to place of beginning.

This Claim is situated about 7 miles from Globe City on Mineral Hill forms an extension of the Julius Mine and shall be known as the Red Robin Mine.

Located Feby 19<sup>th</sup> 1880

Witness

J. J. Vosburgh

Locators: C. Loyer

G. C. Fineman

Filed & Recorded - 4 o'clock P.M. Feby 19<sup>th</sup> 1880

G. A. Swasey District Recorder

Book C

years 6,

Given in

PLAT  
 OF THE  
 RED ROBIN MINING CLAIM, GLOBE  
 MINING DISTRICT.

ARIZONA,  
 Containing 15.71 acres,  
 Scale 200ft = 1 inch,  
 Var 13° 20' E

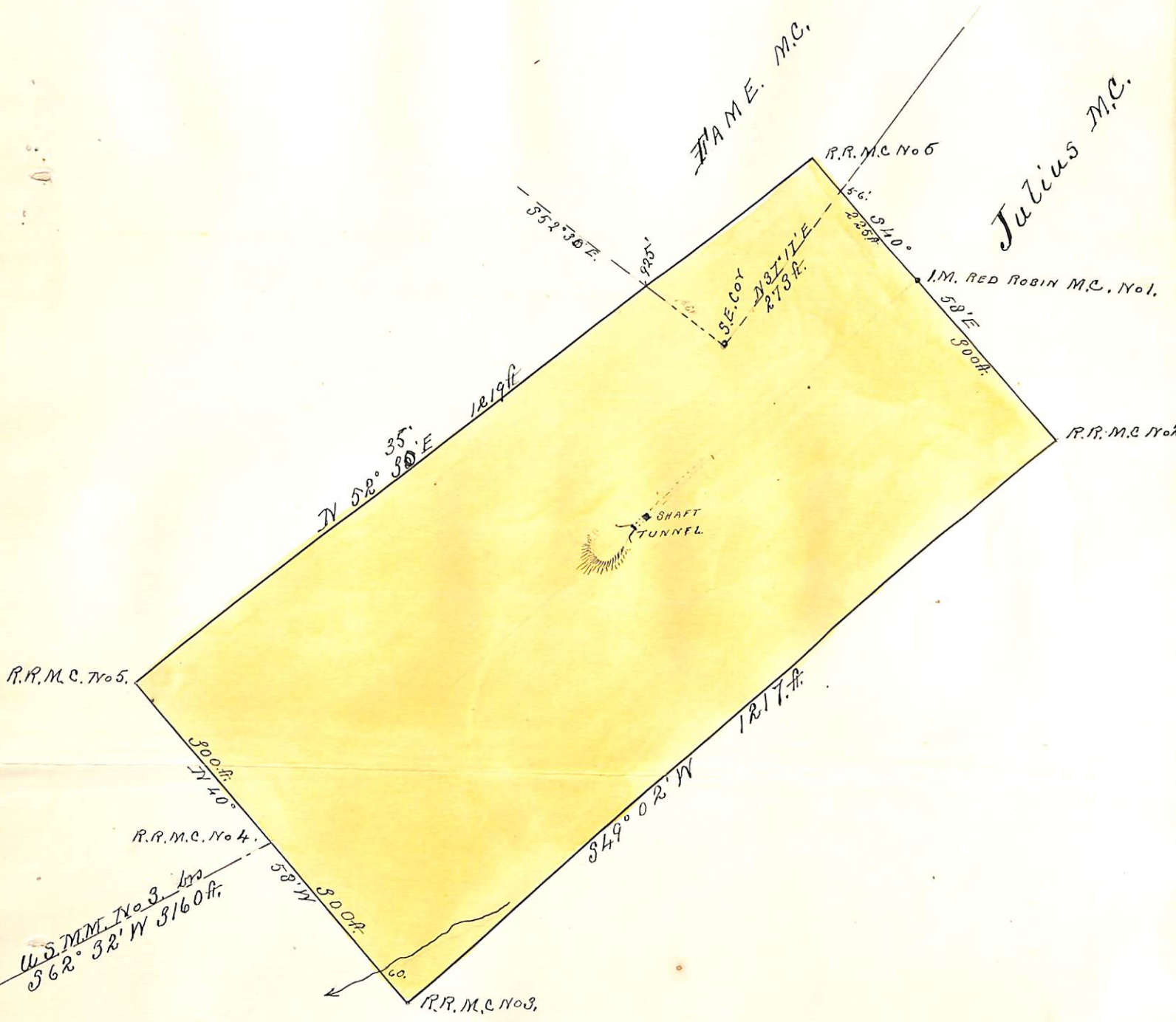

U. S. Surveyor-General's Office.

Tucson, Arizona, Sept 19<sup>th</sup> 1887.

The foregoing Field Notes of the survey of the  
Red Robin, Mining Claim  
situate in the Globe mining district, Gila  
County, Arizona, claimed by L. Newcomb, N.P.,  
Zalluadge and C. Downing, Trustees  
survey executed by H. B. Shaw Deputy  
Surveyor, under instructions from this office, having been critically  
examined and the necessary corrections and alterations made, the said  
Field Notes and the survey they describe are hereby approved.

John Hise  
Surveyor General.