

MS -

0

0

8

2

9

LOT NO. 48

SURVEY NO. 829

Field Notes

of the survey of the

Emma

Mining Claims.

Situate in Pindall Mining district

County of Pima and in Sec. 21 & 22, Tp. 20 & 21 S

Range 14 E, of the Gila and Salt River Meridian.

ARIZONA.

Claimed by B. M. Jacobs and Wisconsin & Arizona Mining Co.

Survey executed by George J. Roskrug D. S.

Under instructions dated February 28th 1888

Survey commenced March 3rd 1888

Survey completed March 3rd 1888

PRELIMINARY OATHS,

FOR SURVEYS OF MINING CLAIMS AND MILL-SITES.

WE, J. M. C. Elliott and

do solemnly swear that we will faithfully execute the duties of Chain Carriers; that we will level the chain upon uneven ground, and plumb the tally pins, whether by sticking or dropping the same; that we will report the true distance to all notable objects, and the true length of all lines that we assist in measuring, to the best of my skill and ability.

J. M. C. Elliott

Sworn to and subscribed before me this 1st day of March, 1888.

William J. Osborn
Notary Public

I, S. B. Mann

do solemnly swear that I will well and truly perform the duties of Claimman and Flagman according to instructions given me, to the best of my skill and ability.

S. B. Mann

Sworn to and subscribed before me this 1st day of March, 1888.

William J. Osborn
Notary Public

Field notes
of the Survey of the
"Emma" Mining Claim

in the
Tyndall Mining District
Pima County, Arizona

Claimed by, B. M. Jacobs and
 the Wisconsin and Arizona Min.
Company

Surveyed by George J. Rostkuge,
 U. S. Deputy Mineral Surveyor,
 under instructions, from the
 Surveyor General, of date Feby
 28th 1888.

Survey commenced Mar 3^d 1888.
 Survey completed Mar 3^d 1888.

Description of Survey

Beginning at the Initial mon.
 mentioned in location notice and
 marking the Westerly end center of
 claim, (This is also the Initial mon of
 the "Josephine" mine and is marked by
 a post in mound of stone, post marked
 J. I. M. n^o 1.) I now set a post 4 feet long
 4 in square 1 1/2 feet in ground along
 side of other post, and surround
 same with mound of stones.

Post marked E. I. M. n^o 1 -
 U. S. Min. Mon n^o 4, Tyndall
 Mining District bears N 41° 35' W
 1145 feet - dist
 An oak 14 in dia, and marked

Feet E. 1. M. N^o 1 - B.T. bears N 82° 50' E 109 feet dist.
 This tree is also marked J. 1 M. N^o 1. B.T.
 An oak 16 ins dia, and marked E. 1. M.
 N^o 1. B.T. bears S 34° 30' W 82 feet dist.
 This tree is also marked J. 1 M. N^o 1. B.T.
 Thence N 16° 14' E
 Var 12° 40' E.

- 9 Discovery and Combination Shaft.

75 Gulch course S.E. and line runs up and along East slope of the Josephine hill.

300 To loc mon, where is a post 3 ins dia, firmly set in ground and surrounded by a monument of stone, post marked on West side J. N^o 2. being the N.E. cor of the "Josephine" mine lot N^o 47 - I now mark the post on its East face E. N^o 2
 No bearings available -

Thence S 80° E
 Var 12° 40' E

descending East slope of "Josephine" hill -

10.90 To center of "Josephine" Cañon, course S. W. and ascend over hilly ground.

1365 To loc mon where I set a post 4x4 ins, 4 feet, long 1 1/2 ft in ground and surrounded same with a mound of stone, Post marked E. N^o 3.
 An oak 18 ins dia, marked E. N^o 3. B.T. bears S 86° W. 22 feet - dist
 An oak 6 ins dia, marked E. N^o 3. B.T. bears N 16° W. 10 feet. dist
 An oak 12 ins dia, marked E. N^o 3. B.T. bears N 60° E 44 feet. dist
 An oak 15 ins dia, marked E. N^o 3. B.T. bears S 45° E, 51. feet. dist.

Thence S 16° 14' W
 Var 12° 40' E.

descending over hilly ground -

270 Gulch, course S 80° E.

Feet

300 To loc: mon for Easterly end centre of claim where I set a post 4 x 4 ins 4 feet long 1 1/2 ft in ground and surrounded same with a mon: of stone - Post marked E. N^o 4. An oak 6 ins dia and marked E. N^o 4 B.T. bears N 36 1/2° W 17 ft - dist
 An oak 8 ins dia and marked E. N^o 4 B.T. bears N 38° E 19 ft - dist
 An oak 12 ins dia and marked E. N^o 4. B.T. bears N 63° E, 32 ft. dist
 An oak 14 ins dia and marked E. N^o 4. B.T. bears S 18° W, 55 ft. dist.
 Thence S 16° 14' W. (same course)
 Var 12° 40' E.
 over hilly ground.

108 Gulch course N 75° W.

300 To loc mon, where I set a post 4 x 4 ins 4 feet long 1 1/2 ft in ground and surrounded same with a mon: of stone, post marked E. N^o 5. An oak 6 ins dia and marked E N^o 5 B. T. bears S 86° E - 13 feet. dist
 A juniper 12 ins dia and marked E. N^o 5. B.T. bears S 22° E 13 feet - dist
 An oak 6 ins dia and marked E N^o 5 B.T. bears S 45° W. 42 feet. dist
 An oak 10 ins dia and marked E N^o 5. B.T. bears S 68° E 25 ft - dist.
 Thence N 80° W
 Var 12° 40' E.

Descending over hilly ground.

600 Center of the "Josephine" Cañon, 20 feet wide, course S. W. and line runs up East slope of the "Josephine" hill.

1160
 1365 ^{Gulch, course S.E.} To loc mon, where is a post 3 ins dia firmly set in ground and surrounded by a monument of stone, post marked on West side J. N^o 6, being the S. E. cor of the

Feet "Josephine" Mining Claim Lot No 47 - I now mark the post on its East side E. N. 6.

An oak 8 ins dia marked E. N. 6. B. J. bears N 41 1/2 E, 15 1/2 feet distant (This tree is also marked J. N. 6. B. J.)

An oak 10 ins dia, marked E. N. 6. B. J. bears N 38 3/4 E 71 feet. dist

An oak 10 ins dia, marked E. N. 6. B. J. bears N 39 E 74 feet - dist

An oak 8 ins dia, marked E. N. 6. B. J. bears N 29 E 81 ft dist.

Thence N 16 1/4 E

To 12 1/4 E

Line runs along East Slope of the Josephine hill -

300 From and post E. S. M. No 1, place of beginning:

Area

Total Area of Claim 18 ⁷⁰/₁₀₀ Acres

Location

This Claim is located on both sides of the "Josephine" Canon, and is an Extension of the "Josephine" mine. It is 3 1/2 miles north of the old Salero House, and the trail from the Hacienda del Santa Rita to Milnes Camp runs up the Canon passing through the claim in a N E and S. W. direction, but at present from rains and dense is very indistinct - It is on unsurveyed land - Pima Co Arizona.

Improvements

made upon this claim by claimants or grantors, consist of a discovery shaft sunk on the boundary line at the initial posts

of the Josephine and Emma mining claims and is 5 x 7 ft 65 ft deep, and is owned jointly by the owners of the two claims.

I now run a line along the ledge S 80° E and at

- 154 Open cut 10 x 8 x 6 ft.
- 200 Shaft 10 x 6 x 4 ft.
- 250 Open cut 30 x 10 x 5 ft. 6 ft South of line.
- 350 Shaft 20 x 6 x 4 ft.
- 445 Shaft 10 x 6 x 4 ft.
- 503 Shaft 8 x 6 x 4 ft 4 ft North of line.
- 570 Open cut 15 x 5 x 5 with Tunnel running N 60° W into hill 18 x 6 1/2 x 4 ft.

And I hereby certify that the value of said improvements exceeds the sum of Five hundred Dollars.

There have been no improvements made by other parties on this claim (except the two old shafts ment^d in the location notice)

Instruments used a Young and Sons Solar Transit, and Steel tape -

Var and courses taken by use of solar apparatus.

George Roskrue

U. S. Dep. Min. Sur.

Tucson A. T. 15 Mar 1885.

AFFIDAVIT OF FIVE HUNDRED DOLLARS IMPROVEMENTS.

We James M. C. Elliott and John Gardiner

of lawful age, being first duly sworn according to law, depose and say that we are acquainted with the Emma

mining claim, situated in Tyndall

Mining District, Pima County, Arizona

Territory, for which Jeffords & Franklin Agents and Attorneys for B. M. Jacobs and the Wisconsin and Arizona Min. Co have made application for survey prior to application for patent under the provisions of the act

of Congress approved May 10, 1872, and that the labor done and improvements made thereon by the applicant and their grantors exceed Five Hundred Dollars in value, and further that we are not personally interested in said mine.

James M. C. Elliott
John Gardiner

TERRITORY OF ARIZONA,
County of Pima ss.

SWORN to and subscribed before me this 13th day of March, 1888.

William J. Osborn
a notary public in and for Pima Co. Ariz.

FINAL OATHS FOR SURVEYS OF MINING CLAIMS AND MILL SITES.

A list of names of individuals employed to assist in running, measuring or marking the lines and corners described in the foregoing field-notes of the survey of the Emma Mining Claim located in Tyndall Mining District, Pima County, Arizona, showing the respective capacities in which they acted.

James M. C. Elliott, Chairman.
 _____, Chairman.
S. B. Mann } Axeman.
 } Flagman.

We hereby certify that we assisted George Roskrug U. S. Deputy Surveyor, in surveying The Emma Mining Claim claimed by B. M. Jacobs and the Wisconsin & Arizona Mining Co. located in Tyndall Mining District, Pima County, and in Township No. _____, Range No. _____ of the Gila and Salt River base and meridian, Arizona, and that said survey has been in all respects, to the best of my knowledge and belief, well and faithfully executed, and the boundary monuments planted according to the instructions furnished by the Surveyor General.

James M. C. Elliott, Chairman.
 _____, Chairman.
S. B. Mann } Axeman.
 } Flagman.

SWORN to and subscribed before me this 13th day of March, 1888.

William J. O'Brien
 Notary public

I, George Roskrug U. S. Deputy Surveyor, do solemnly swear that, in pursuance of instructions from the U. S. Surveyor General for Arizona, bearing date the 28th day of February, 1888, I have well, faithfully and truly, in my own proper person, and in strict conformity with the instructions furnished by the Surveyor General and the laws of the United States, surveyed all those portions of the Emma Mining Claim claimed by B. M. Jacobs & the Wisconsin & Arizona Mining Co. located in Tyndall Mining District, Pima County, Arizona, as are represented in the foregoing field-notes as having been surveyed under my instructions; and I do further solemnly swear that all the corners of said surveys have been established and perpetuated in strict accordance with the instructions furnished me, and that the foregoing are the true and original field-notes of such surveys.

George Roskrug Deputy Surveyor.

SWORN to and subscribed before me this 13th day of March, 1888.

William J. O'Brien
 Notary public

Amended
NOTICE OF LOCATION.
of the Emma Mine.

10

NOTICE IS HEREBY GIVEN That the undersigned, in compliance with the requirements of the Mining Act of Congress, ~~approved May 10th, 1872~~, have. this day located and claim *fifteen* hundred linear feet along the course of this lead, lode or vein of mineral-bearing quartz, *and three hundred* feet in width on each side of the middle of said lead, lode or vein, situate in the *Syn-*
dall Mining District, County of *Pima* Arizona, and more particularly described as follows, to-wit:

Commencing at this monument of stones, being the center of the *West* end of the claim, and upon which this notice is posted; thence *Northerly, 300* feet to a monument of stones; thence *Easterly 1500* feet to a monument of stones; thence *Southerly 300* feet to a monument of stones, being the center of the *East* end of claim; thence *Southerly 300* feet to a monument of stones; thence *Westerly 1500* feet to a monument of stones; thence *Northerly 300* feet to place of beginning.

THIS CLAIM is situated about *three* miles in a *South westerly* direction from the second highest peak of the Santa Rita Mountains and about *5* miles *north easterly* from the old *Galero* shaft. It is the same claim located April 22, 1877 by Warner Buck and D. M. Jacobs, and called the "Emma Mine", of which we are now the owners, and this notice and location is intended as an ~~amended~~ notice of location of said claim, and said claim "*Emma*" Mine. ~~and~~ shall be known as the

~~FILED~~ *February 15th* 1888.

T. M. Jacobs
The Wisconsin and Arizona
Mining Company.

[Printed and for sale by J. S. Mansfeld, Pioneer News Depot, Tucson, Arizona.]

Filed and recorded at request of S. M. Franklin 15th February A.D. 1888, at 2.45 P.M.
A. B. Sampson, County Recorder

TERRITORY OF ARIZONA, } ss.

County of Pima.

I, *A. B. SAMPSON*, County Recorder in and for the County of Pima, do hereby certify that the above and foregoing is a full true and correct copy of an Amended Location Notice of the "Emma" Mine, as filed for Record in my Office on the 15th day of February A.D. 1888

~~as appears of Record now in my Office in Book _____ Pages _____~~

IN WITNESS WHEREOF, I have hereunto set my hand and affixed my official seal, at my office in Tucson this 16th day of February A. D. 1888.

A. B. Sampson

County Recorder.



Notice of Location,

of the Emma Mine.

Notice is hereby given that the undersigned having complied with the requirements of Chapter six, title 32, of the Revised Statutes of the United States, and the local customs, laws and regulations, have located fifteen hundred linear feet on this the "Josephine lode", situate in Sep-dall Mining District, Santa Rita Mountains, Pima County, Arizona Territory, and described as follows, commencing at a stone monument placed on the lode at the eastern end of the Josephine Mine, by the side of an old shaft which is the most westerly of two old shafts that are about 100 feet apart, — on which monument is a copy of this notice, and running in an Easterly direction 1500 feet, claiming 300 feet on each side from the center of the lode, the whole length of the claim. This claim is situated about 3 miles in a southwestly direction from the second highest peak of the Santa Rita Mountains and about 5 miles

withcasted from the old Salero¹³
shaft, and we name it the "Emma
Mine." Dated this 22nd day of April
1877. Warner Buck
L. M. Jacobs.

Filed and recorded at the request
of J. G. Roddick May 29 1877, at 11
o'clock^{A.M.} in Book B, Record of Mines
Records of Pima County, Ariz., Pages 644 + 645.
S. W. Carpenter County Recorder
By J. A. Apperson deputy.

TERRITORY OF ARIZONA, }
County of Pima. } ss.

I, A. B. SAMPSON, County Recorder in and for the County of Pima, do hereby
certify that the above and foregoing is a full true and correct copy of Location Notice
of the "Emma" Mine.

as appears of Record now in my Office in Book "B" Records of Mines Pages 644 + 645.

IN WITNESS WHEREOF, I have hereunto set my hand and
affixed my official seal, at my office in Tucson this 16th
day of February A. D. 1888.

A. B. Sampson
County Recorder.



Plat of the Survey of the
"Emma" Mining Claim

Claimed by B.M. Jacobs & the Wisconsin and Arizona M⁸C²

Containing $18 \frac{70}{100}$ Acres

Located in the Tyndall Mining District

Pima County, Arizona.

Scale 200 feet to 1 inch.

Var $12^{\circ} 35' E$

Surveyed by George J. Roskruge U.S. Dep. Sur^r
 3rd March 1888.

$N 41^{\circ} 35' W$ 1145 feet to Tyndall M⁸ Dist.
 $N 57^{\circ} 12' W$ 747.12
 $N 2^{\circ} 4'$
 $J. N^{\circ} 2$

"Josephine"
 Lot $N^{\circ} 47$

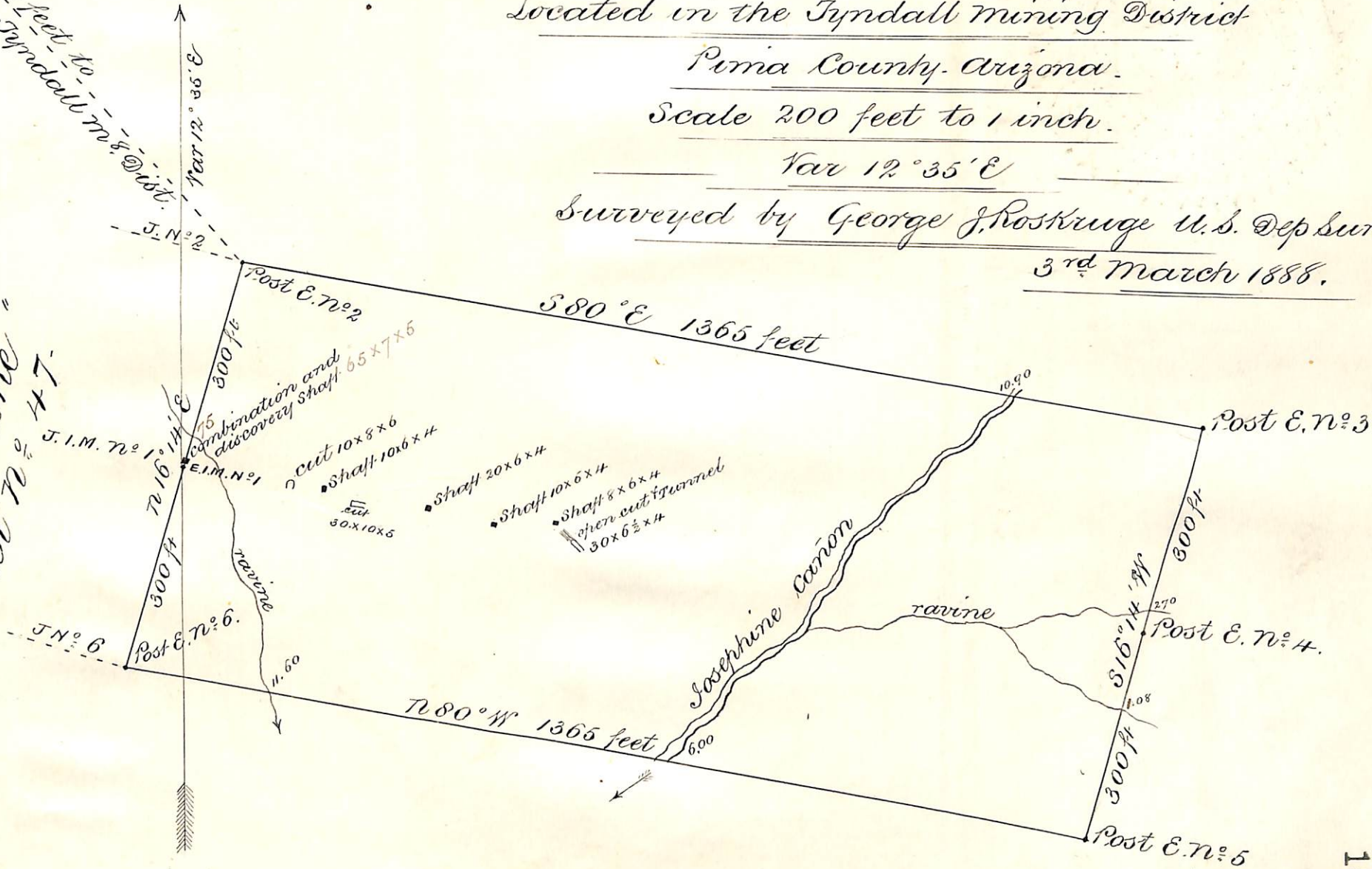

U. S. Surveyor-General's Office.

Tucson, Arizona, *March 26th* 1888.

The foregoing Field Notes of the survey of the
Emma Mining Claim
situate in the *Fyndall* mining district, *Pima*
County, Arizona, claimed by *B. M. Jacobs & Wisconsin*
and Arizona Mining Company
survey executed by *George J. Roskrug* Deputy
Surveyor, under instructions from this office, having been critically
examined and the necessary corrections and alterations made, the said
Field Notes and the survey they describe are hereby approved.

John Hise
Surveyor General.