

**M
S
-**

0

0

9

0

4

(4-683.)

Mineral Survey No. 904

Lot No. 44. A

Prescott

Land District.

FIELD NOTES

OF THE SURVEY OF THE MINING CLAIM OF

William B. Dodge
and D. Willis James

KNOWN AS THE

Autler

Cedar Valley Mining District,

Mohave County, Arizona

Section _____, Township 12 N, Range 16 W

Surveyed under instructions dated Oct 7th, 18 89
by W. B. Foster
U. S. Deputy Mineral Surveyor.

Claim located October 25th, 18 79

Survey commenced October 18th, 18 89

Survey completed October 18th, 18 89

PRELIMINARY OATHS OF ASSISTANTS IN SURVEY OF MINING CLAIM.

WE, A. J. Shrope and Ole Ingebretson,
do solemnly swear that we will well and faithfully execute the duties of chain carriers;
that we will level the chain upon even and uneven ground and plumb the tally-pins,
either by sticking or dropping the same; that we will report the true distance to all
notable objects, and the true length of all lines that we assist in measuring, to the best
of our skill and ability, and in accordance with instructions given us, in the survey of
the Mining Claim of William E. Dodge and D. Willis
James Antler, known as the
situate in Cedar Valley mining district,
Mohave County, Arizona,
in Section _____, Township No. _____, Range No. _____.

C. B. Foster

A. J. Shrope, Chainman.
Ole Ingebretson, Chainman.

Subscribed and sworn to by the above-named persons before
me this 16 day of October, 1889.

C. B. Foster
Notary Public

I, T. M. Mahon, do solemnly swear that I will well and
truly perform the duties of axeman, in the establishment of corners and other duties,
according to instructions given me and to the best of my skill and ability, in the survey
of the Mining Claim of William E. Dodge and
D. Willis James
known as the Antler,
more fully described in the preceding affidavit.

C. B. Foster

T. M. Mahon, Axeman.

Subscribed and sworn to by the said T. M. Mahon
before me this 16th day of
October, 1889.

C. B. Foster
Notary Public

I, _____, do solemnly swear that I will
well and truly perform the duties of flagman, in the establishment of corners and other
duties, according to instructions given me and to the best of my skill and ability, in the
survey of the Mining Claim of _____
_____ known as the _____,
more fully described in the preceding affidavit.

_____, Flagman.

Subscribed and sworn to by the said _____
before me this _____ day of _____,
18 _____.

Field Notes
of the Survey of the
Antler Mining Claim
in Cedar Valley Mining District
Mohave County, Arizona.

Claimed by
Wm. C. Dodge and D. Willis James.

Surveyed by C. B. Foster U.S. Deputy
Mineral Surveyor under instructions
from the Surveyor General of
date October 7th 1889.

Survey commenced Oct 18th 1889
Survey completed Oct 18. 1889

Description of Survey.

Beginning at the Initial mon mentioned
in Location Notice and marking the
southerly end Center of claim
where I set a sand stone 30x18x12 ins.
1 ft in ground and surrounded
same with mound of stones
Stone marked ^{MA} No. 1.

(Same stone marks northerly end
Center of Spuyten Duyvil Claim)
U.S. Min. Mon. No 2. bro N 56° 45' E
809.5 feet.

Initial loc. mon. of Antler Mill
Site claim taken in connection
with this claim bro N 74° E
7500 feet.

Thence N 71° W

To 15° East

300 To loc. mon. where I set a sand stone
20x10x8 ins. 1 ft. in ground and
surrounded same with mound.

Feet

of Stones. Stone marked A No 2
(Same Stone marks N.W. Corner
of Spuyten Duyvil Claim)

Thence N 19° E

Va 15° East

1500 To loc. mon. where I set a granite
stone $18 \times 16 \times 14$ ins 1 ft in ground
and surrounded same with mound
of stones. Stone marked A No 3

Thence S 71° E

Va 15° East

300 To loc. mon. at northerly end center
of claim where I mark A. No 4.
on E. face of granite boulder
projecting above surface 3 ft.
high by 4×2 ft square and
surrounded same with mound
of stones.

Thence S 71° E (Same course)

Va 15° East

300 To point where I set a granite stone
 $20 \times 18 \times 6$ ins 1 ft in ground and
surrounded same with mound
of stones. Stone marked A. No. 5.
Original loc. mon. by N 20° E 10. ft.

Thence S 19° W

Va 15° East

1500 To loc. mon. where I set a sand stone
 $24 \times 16 \times 5$ ins 1 ft in ground and
surrounded same with mound
of stones. Stone marked A. No. 6.
(Same Stone marks N.E. Corner of
Spuyten Duyvil Claim)

Thence N 71° W.

Va 15° East.

300 To Mon and Stone I. M. A No 1.
place of beginning.

Area

Net Area of Claim 20.66 Acres

Location
 This claim is located along a low ridge being a spur projecting S. W from the foot hills of the Huulpai Mountains and is on unsurveyed land.

- Improvements
 Made upon this claim by claimants or grantors consist of a shaft 8x6' 20ft deep N 22° E 100 ft from Mon. I. M. A. No 1. ✓
 A shaft 6x4' 50 ft deep N 19° E 820 ft. from Mon. I. M. A. No 1. ✓
 A Tunnel 6x4' 15ft deep ~~15ft~~ N 17° E 830 ft. from Mon. I. M. A. No 1. long ✓
 A shaft 6x4' 60ft deep N 20° E 860 ft. from Mon. I. M. A. No 1. ✓
 A shaft 6x4' 60 ft deep N 17° E 940 ft from Mon. I. M. A. No 1. ✓

And I hereby certify that the value of said improvements exceeds the sum of five hundred dollars.

There have been no improvements made by other ^{parties} on this claim

Instruments used a Gurley Transit and 50 ft. steel chain

Var and courses determined by observation of Polaris.

C. B. Foster
 U.S. Deputy Mineral Surveyor

October 18th 1889.

AFFIDAVIT OF FIVE HUNDRED DOLLARS IMPROVEMENTS.

We, *A. J. Shrope* and *T. M. Mahon*
of lawful age, being first duly sworn according to law, depose and say that we are acquainted with the
"Antler"

mining claim, situated in *Cedar Valley*
Mining District, *Mohave* County, Arizona
Territory, for which *William E. Dodge* and *D. Willis James*
have made application for survey prior to application for patent under the provisions of the Act of
Congress approved May 10, 1872, and that the labor done and improvements made thereon by the appli-
cants and their grantors exceed Five Hundred Dollars in value, and further that we are not per-
sonally interested in said mine.

A. J. Shrope
T. M. Mahon

TERRITORY OF ARIZONA,
County of *Mohave* } SS.

J. Foster

SWORN to and subscribed before me, this *19* day

of *October* 188*9*

C. B. Foster
Notary Public

FINAL OATHS FOR SURVEYS.

LIST OF NAMES.

A list of the names of the individuals employed by C. B. Foster
 United States Deputy Mineral Surveyor, to assist in running, measuring, and marking the lines
 corners and boundaries described in the foregoing field notes of the survey of the mining claim
 of William E. Dodge and D. Willis James
 known as the "Antler"
 and showing the respective capacities in which they acted.

A. J. Shrope , Chainman.
Ole Ingelbreton , Chainman.
T. M. Mahon , Axman.
 _____ , Flagman.

FINAL OATHS OF ASSISTANTS.

We, A. J. Shrope, Ole Ingelbreton
 and T. M. Mahon , do solemnly swear that we assisted
C. B. Foster , United States Deputy Mineral Surveyor, in marking the corners and
 surveying the boundaries of the mining claim of William E. Dodge
 and D. Willis James
 _____ , known as the "Antler"

_____ , represented
 in the foregoing field notes as having been surveyed by said deputy mineral surveyor and under
 his direction; and that said survey has been in all respects, to the best of our knowledge and
 belief, faithfully and correctly executed, and the corner and boundary monuments established
 according to law and the instructions furnished by the United States Surveyor-General for

Arizona

C. B. Foster

A. J. Shrope , Chainman.
Ole Ingelbreton , Chainman.
T. M. Mahon , Axman .
 _____ , Flagman.

Subscribed and sworn to by the above-named persons before me
 this 19 day of October, 1889.

C. B. Foster
 Notary Public

(4-686.)

FINAL OATH OF U. S. DEPUTY MINERAL SURVEYOR.

I, C. B. Foster, U. S. Deputy Mineral Surveyor, do solemnly swear that, in pursuance of instructions received from the United States Surveyor General for Arizona, dated Oct 7th, 1889, I have, in strict conformity to the laws of the United States, the official regulations and instructions thereunder, and the instructions of said Surveyor General, faithfully and correctly executed the survey of the Mining Claim of Wm. E. Dodge and D. Willis James, known as the "Antler", situate in Cedar Valley Mining District, Mohave County, Arizona, in Section _____, Township No. _____, Range No. _____ and designated as Survey No. 907 as represented in the foregoing field notes, which accurately show the boundaries of said mining claim as distinctly marked by monuments on the ground, and described in the attached copy of the location certificate, which was received by me from the Surveyor General with said instructions, and that all the corners of said survey have been established and perpetuated in strict accordance with the law, official regulations and instructions thereunder; and I do further solemnly swear that the foregoing are the true and original field notes of said survey and my report therein, and that the labor expended and improvements made upon said mining claim by claimant or their grantors are as therein fully stated, and that the character, extent, location and itemized value thereof are specified therein with particularity and full detail, and that no portion of said labor or improvements so credited to this claim has been included in the estimate of expenditures upon any other claim.

C. B. Foster
U. S. Deputy Mineral Surveyor.

Subscribed and sworn to by the said C. B. Foster,
U. S. Deputy Mineral Surveyor, before me
a Notary Public this 25th
day of October, 1889.

Aug. J. Nowinski
Notary Public

Antler

Cedar Valley Dist

Notice of Location

The undersigned locate and claim (1500) fifteen hundred on this lode or vein and (300) Three hundred feet on each side of the middle of the vein, more particularly described as follows. Commencing at this notice and monument which is situated on the Southwest End of the Claim, and running from thence (300) Three hundred feet in a South westerly direction to a stone monument thence (1500) Fifteen hundred feet in a North Easterly direction parallel with the vein to a stone monument. thence six hundred (600) feet in a North North westerly direction to a stone monument. Crossing the lode at right angles, on the North East End of the location. thence (1500) Fifteen hundred feet in a South westerly direction parallel with the vein to a stone monument and from thence (300) three hundred feet in a South South Easterly direction to the place of beginning. - This Claim is situated a mile west of Cane Spring and about 500 yards north west of Cane Spring wash on the West side of Nallapai Mountains, and shall be known as the "Antler" mine in Cedar Mining District Mohave County, Arizona

October 25th 1879

John K Mackenzie

Recorded at the request of John K Mackenzie
December 2nd AD 1879 at 11 A.M.

Caldwell Wright
County Recorder

Territory of Arizona } S.S.
County of Mohave } 3

10

J. E. J. Godman County
Recorder in and for Mohave County Arizona
Territory. Do hereby Certify that the above and
foregoing is a full, true and correct copy of the
Location Notice of the Antler Mining Claim
as the same appears of record in my office
in Book A Page 615 Mining Records of
Mohave County Arizona Territory.

In Witness whereof I have hereunto set my
hand and affixed my official seal this 4th
day of September A D 1889

E. J. Godman
County Recorder

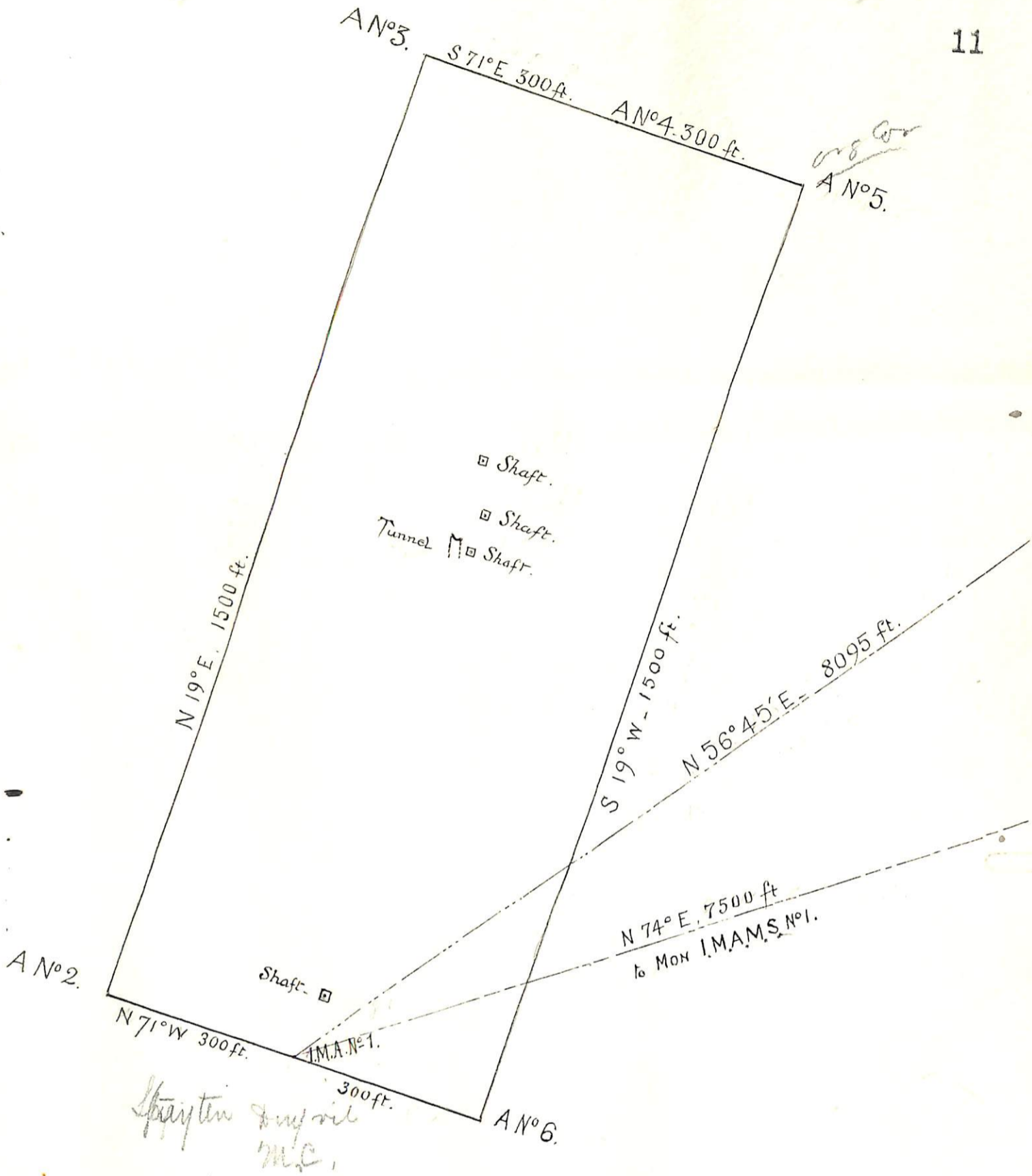

PLAT OF THE ANTLER MINING CLAIM,
 Cedar Valley Mining District
 Mohave County, Arizona.

Claimed by Wm. E. Dodge & D. Willis James.

SURVEYED BY

C. B. FOSTER, U.S.D.S.

OCT 18, 1889.

Contains 20⁶⁶/₁₀₀ Acres.

Scale 200 feet to 1 inch. Var. 15° E.

(4-687.)

Surveyor General's Certificate of Approval of Field Notes and Survey of Mining Claim.

Department of the Interior,

Office of U. S. Surveyor General,

Tucson, Arizona

November 4th 1889

I, U. S. Surveyor General for

Arizona

do hereby certify that the foregoing and hereto attached Field Notes and Return of the

Survey of the Mining Claim of

William E. Dodge

and D. Willis James

, known as the

Antler

situate in

cedar Valley

mining district,

Mohave

County,

Arizona

in Section

Township No.

Range No.

, designated as Survey No.

9024

executed by

W. B. Foster

U. S. Deputy Mineral

Surveyor,

October 18th 1889

, 1889,

under my instructions dated

October 7th 1889,

1889,

have been critically examined and the

necessary corrections and explanations made, and the said Field Notes and Return, and

the Survey they describe, are hereby approved. A true copy of the copy of the location

certificate filed by the applicant for survey is included in the field notes.

Rapala & Johnson
U. S. Surveyor General for Arizona