

MS

00909

(4-683.)

Mineral Survey No. 909

Lot No. 52

Prescott Land District.

FIELD NOTES

OF THE SURVEY OF THE MINING CLAIM OF

Hackberry Mining Co.

KNOWN AS THE

Hackberry Mining Claim

Big Bug Mining District,
Yavapai County, Arizona

Section _____, Township _____, Range _____

Surveyed under instructions dated Nov. 11th, 1889,
by C. B. Foster,
U. S. Deputy Mineral Surveyor.

Claim located June 29th 1881 and
August 9th, 1889.

Survey commenced December 11th, 1889.

Survey completed December 11th, 1889.

PRELIMINARY OATHS OF ASSISTANTS IN SURVEY OF MINING CLAIM.

WE, W. H. Switzer and T. J. Flannery,
do solemnly swear that we will well and faithfully execute the duties of chain carriers;
that we will level the chain upon even and uneven ground and plumb the tally-pins,
either by sticking or dropping the same; that we will report the true distance to all
notable objects, and the true length of all lines that we assist in measuring, to the best
of our skill and ability, and in accordance with instructions given us, in the survey of
the Mining Claim of Hackberry Mining Company, known as the
Hackberry Mining Claim
situate in Big Bug mining district,
Yavapai County, Arizona,
in Section _____, Township No. _____, Range No. _____.

W. H. Switzer, Chainman.

T. J. Flannery, Chainman.

C. B. Foster

Subscribed and sworn to by the above-named persons before
me this 11 day of December, 1889.

C. B. Foster
Notary Public

I, Michael Barron, do solemnly swear that I will well and
truly perform the duties of axeman, in the establishment of corners and other duties,
according to instructions given me and to the best of my skill and ability, in the survey
of the Mining Claim of Hackberry Mining Company
known as the Hackberry Mining Claim,
more fully described in the preceding affidavit.

Michael Barron, Axeman.

Subscribed and sworn to by the said Michael
Barron before me this 11 day of
December, 1889.

C. B. Foster

C. B. Foster
Notary Public

I, _____, do solemnly swear that I will
well and truly perform the duties of flagman, in the establishment of corners and other
duties, according to instructions given me and to the best of my skill and ability, in the
survey of the Mining Claim of _____
known as the _____,
more fully described in the preceding affidavit.

_____, Flagman.

Subscribed and sworn to by the said _____
before me this _____ day of
_____, 18 _____.

Fet

Field Notes

of the survey of the
Hackberry Mining Claim
in Big Bug Mining District
Yavapai County, Arizona.

Claimed by

Hackberry Mining Company.

Surveyed by C. B. Foster, U. S.
Deputy Mineral Surveyor, under
instructions from the Surveyor
General of date Nov 11, 1889.

Survey Commenced Dec. 11, 1889.
Survey Completed Dec. 11, 1889.

Description of Survey.

Beginning at Initial mon. men-
tioned in location notice and
marking the central portion of
claim where I set a slate stone
28 x 10 x 8 ins. one and one half feet
in ground and surrounded same
with mound of stones.

Stone marked I. M. H. No. 1.

U. S. Min. Mon. No. 3. bears N.
24° 55' E. 5535 feet.

Thence N. 35° 30' E.

Far. 13° 55' East.

- 190 To road bears N. and S.
720 To center Hackberry gulch, flows
N. N. E.,
840 To loc. mon. at N. center end of
claim where I mark H. No. 2. on
N. W. face of slate rock in place
projecting above surface 24 x

- Feet 12 x 8 ins. and on S. W. side build mound of rocks;
 Thence N. $54^{\circ} 30' N$.
 Var. $13^{\circ} 55'$ East.
- 27 To center Hackberry gulch, flows N. E.
- 300 To loc. mon. where I set a slate stone 20 x 14 x 8 ins. one foot in ground and surrounded same with mound of stones.
 Stone marked N. No. 3.
 Thence S. $35^{\circ} 30' N$.
 Var. $13^{\circ} 55'$ East.
- 200 To road to Prescott, bears N. N. E.
⁹⁰ S. (No loc. mon. found on W. boundary of claim)
- 1440 To where I set a slate stone 20 x 8 x 8 ins. one foot in ground and surrounded same with mound of stones.
 Stone marked N. No. 4.
 Original mon. bears N. $29^{\circ} N$.
 12 feet.
 Thence S. $54^{\circ} 30' E$.
 Var. $13^{\circ} 55'$ East.
- 280 To center Hackberry gulch, flows N. E.
- 300 To loc. mon. at S. center end of claim, where I mark N. No. 5. on N. face of slate rock in place projecting above surface 20 x 12 x 10 ins. on S. side build mound of stones.
 Thence $54^{\circ} 30' E$ (same course)
 Var. $13^{\circ} 55'$ East.
- 300 To loc. mon. where I set a slate stone 20 x 10 x 6 ins. one foot in ground and surrounded same with mound of stones.
 Stone marked N. No. 6.
 Thence N. $35^{\circ} 30' E$.
 Var. $13^{\circ} 55'$ East.
- 1440 To loc. mon. where I set a slate

Foot stone 26 x 8 x 8 ins. one foot in ground and surrounded same with mound of stones.

Stone marked H. No. 7.

Thence N. 54° 30' W.

Var. 13° 55' East.

300 To mon. and stone H. No. 2. place of beginning on out-boundaries of claim.

Area.

Total ^{and} net area of claim 19.83 acres.

Location

This claim is located along Hackberry gulch in Big Bug Mining District and is on unsurveyed lands.

Improvements

Made upon this claim by claimant or grantors consist of a shaft 8 x 6 - 101 feet deep. N. 36° E. 50 ft from mon. I. M. H. No. 1.

Hoisting Works erected westerly from this shaft. A shaft 6 x 4 - 37 ft deep, bears N. 34° E. 80 ft from mon. I. M. H. No. 1.

A cut 8 x 8 ft - 15 ft long. N. 34° E. 290 ft from mon. I. M. H. No. 1.

Thereby certify that the value of said improvements exceed the sum of five hundred dollars.

There have been no improvements made by other parties on this ground.

Instrument used, a Gurley Transit ^{and} 50 ft steel chain.

Variances determined by observation of Polaris.

December 11th 1889.

Ed. Foster
Deputy Mineral Surveyor.

AFFIDAVIT OF FIVE HUNDRED DOLLARS IMPROVEMENTS.

We, *Jno H. Boyd* and *J. W. Boggs*
of lawful age, being first duly sworn according to law, depose and say that we are acquainted with the
Hackberry mining claim, situated in *Big Bug*
Mining District, *Yavapai* County, Arizona
Territory, for which *Hackberry* and *Mining Company*
has made application for survey prior to application for patent under the provisions of the Act of
Congress approved May 10, 1872, and that the labor done and improvements made thereon by the appli-
cant and its grantor exceed Five Hundred Dollars in value, and further that we are not per-
sonally interested in said mine.

Jno H. Boyd
J. W. Boggs

TERRITORY OF ARIZONA,
County of *Yavapai* } SS.

SWORN to and subscribed before me, this *11th* day
of *December* 188*9*

C. P. Foster

C. P. Foster
Notary Public

FINAL OATHS FOR SURVEYS.

LIST OF NAMES.

A list of the names of the individuals employed by C. B. Foster
 United States Deputy Mineral Surveyor, to assist in running, measuring, and marking the lines
 corners and boundaries described in the foregoing field notes of the survey of the mining claim
 of Hackberry Mining Company
 known as the Hackberry Mining Claim
 and showing the respective capacities in which they acted.

W. H. Switzer, Chairman.
T. J. Flannery, Chairman.
Michael Barron, Axman.
 _____, Flagman.

FINAL OATHS OF ASSISTANTS.

We, W. H. Switzer T. J. Flannery
 and Michael Barron, do solemnly swear that we assisted
C. B. Foster, United States Deputy Mineral Surveyor, in marking the corners and
 surveying the boundaries of the mining claim of _____

Hackberry Mining Company
 _____, known as the
Hackberry Mining Claim, represented
 in the foregoing field notes as having been surveyed by said deputy mineral surveyor and under
 his direction; and that said survey has been in all respects, to the best of our knowledge and
 belief, faithfully and correctly executed, and the corner and boundary monuments established
 according to law and the instructions furnished by the United States Surveyor-General for
Arizona

C. B. Foster

W. H. Switzer, Chairman.
T. J. Flannery, Chairman.
Michael Barron, Axman.
 _____, Flagman.

Subscribed and sworn to by the above-named persons before me
 this 11th day of December, 1889.

C. B. Foster
Notary Public

(4-686.)

FINAL OATH OF U. S. DEPUTY MINERAL SURVEYOR.

I, C. P. Foster, U. S. Deputy Mineral Surveyor, do solemnly swear that, in pursuance of instructions received from the United States Surveyor General for Arizona, dated November 11, 1889, I have, in strict conformity to the laws of the United States, the official regulations and instructions thereunder, and the instructions of said Surveyor General, faithfully and correctly executed the survey of the Mining Claim of Hackberry Mining Company, known as the Hackberry Mining Claim, situate in Big Bug Mining District, Yavapai County, Arizona, in Section _____ Township No. _____ Range No. _____ and designated as Survey No. 909, as represented in the foregoing field notes, which accurately show the boundaries of said mining claim as distinctly marked by monuments on the ground, and described in the attached copy of the location certificate, which was received by me from the Surveyor General with said instructions, and that all the corners of said survey have been established and perpetuated in strict accordance with the law, official regulations and instructions thereunder; and I do further solemnly swear that the foregoing are the true and original field notes of said survey and my report therein, and that the labor expended and improvements made upon said mining claim by claimant or its grantors are as therein fully stated, and that the character, extent, location and itemized value thereof are specified therein with particularity and full detail, and that no portion of said labor or improvements so credited to this claim has been included in the estimate of expenditures upon any other claim.

C. P. Foster
U. S. Deputy Mineral Surveyor.

Subscribed and sworn to by the said C. P. Foster,
U. S. Deputy Mineral Surveyor, before me Henry J. Andrews
a Notary Public this 14th
day of December, 1889.

Henry J. Andrews

Henry J. Andrews
Notary Public
Deputy Collector

Location Notice.

Of the Hackberry Ledge or Claim. Containing Gold, Silver and Copper and Located as a Gold, Silver and Copper Mine.

The undersigned claim for mining purposes Fifteen hundred (1500) feet of this Quartz Ledge in length, along the ledge or vein and Three hundred (300) feet on each side of the middle of the vein at the surface, together with all the dips, spurs, and angles, and all valuable mineral deposits contained therein, and all Timber growing within the limits of said claim, and all water and water privileges thereon or appurtenant thereto, under and according to the provisions of an Act of Congress approved May 10. 1872. entitled An Act to promote the development of the Mining Resources of the United States." This claim commences at this Notice, which is posted in a conspicuous place on the vein in a monument of stones, runing Seven hundred and fifty feet each way in a North easterly and South westerly direction, situate about two miles ~~west~~ South west from the mouth of Grape Vine Creek on the west side of Big Bug Creek, and shall be known as the Hackberry Mine Ledge or Claim.

Dated on the ground this 29th day of June 1881

William Gavin.

T. W. Boggs.

Filed and Recorded at request of T. W. Boggs August 10th A. D.
1881. at 4- 0'clock P.M. in Book L. Mines at pages 618. Records
of Yavapai County Arizona.

William Wilkerson.

County Recorder.

By H.H. Cartter

Deputy.

Notice of Location.

Know all Men by these Presents; That the undersigned a corporation erected under the laws of Arizona Territory, have this day Located Fifteen Hundred (1500) linear feet of this vein or lode, bearing precious metals, with all dips, spurs, angles and variations, with surface ground Three Hundred (300) feet on each side of the center of vein, with all mineral deposits contained therein, and all Timber growing within the limits of said claim, and all Water and Water privileges thereon or appurtenant thereto, under and according to the provisions of the United States Mining Laws, under which it is Located. This claim commences at this monument and Notice placed upon the ledge, and runs Seven Hundred and Fifty Feet in a Northerly direction, and Seven Hundred and Fifty Feet in a Southerly direction along the ledge,. The Exterior Boundaries are as follows, Viz; Commencing at a monument of stone on west boundary line, distant Three Hundred (300) feet in a westerly direction from Discovery Monument; thence in a Northerly direction parallel with the ledge Seven Hundred and Fifty Feet to a monument of stone at N. W. corner of claim; thence in an Easterly direction

at right angles across the ledge Six Hundred (600) feet to monument
of stone at N. E. corner of claim; thence in a Southerly direction
parallel with the ledge Fifteen Hundred (1500) feet to monument of
stone at S. E. corner of claim; thence at right angles across the
ledge in a westerly direction Six Hundred (600) feet to monument of
stone at S. W. corner of claim; thence in a Northerly direction
parallel with the ledge Seven Hundred and Fifty Feet to monument on
west boundary and place of beginning. This ledge may be more genera-
lly described as situated, the initial monument being one mile
more or less Southwesterly from the mouth of Grape Vine Creek on
the west side of Big Bug Creek, at a shaft 70 feet deep, This loca-
tion is made to correct the description and identify the ground
covered by the Hackberry location, notice as recorded at page 618
of Book II of mining records in the office of the County Recorder
of the County of Yavapai Territory of Arizona in Big Bug Mining
District, Yavapai County, Arizona Territory. and shall be known as
the Hackberry Mining Claim. Dated on the Ground this 9th day of
August 1889,

Big Bug Reduction and Development Company.

By T. W. Boggs its President.

TERRITORY OF ARIZONA,)

13

County of Yavapai.)

ss.

I, CHARLES H. AKERS, County Recorder in and for said County and Territory, and Custodian of the Records thereof, do hereby certify that I have compared the above and foregoing with, and the same is a full, true and correct copy of *The original Location Notice of The "Hackberry" Mine in Big Bug Mining District Yavapai County, Arizona dated June 29" 1881 also the Notice of Re-location of the said "Hackberry" Mine, dated Aug 9" 1889 as they appear on the records of Yavapai County, Arizona.*

In Witness Whereof, I have hereunto set my hand and affixed my official seal this *Thirty first* Day of *October* A. D. 18 *89*
Charles H. Akers

County Recorder.

Filed and Recorded at Request of E. M. Sanford August 14th A. D.
1889, at 35 minutes past 3 P. M. in Book 27 of Mines of Mining
Records, Pages 636- 637.

C. H. Akers.

County Recorder.

(L. S.)

1
a
O
R

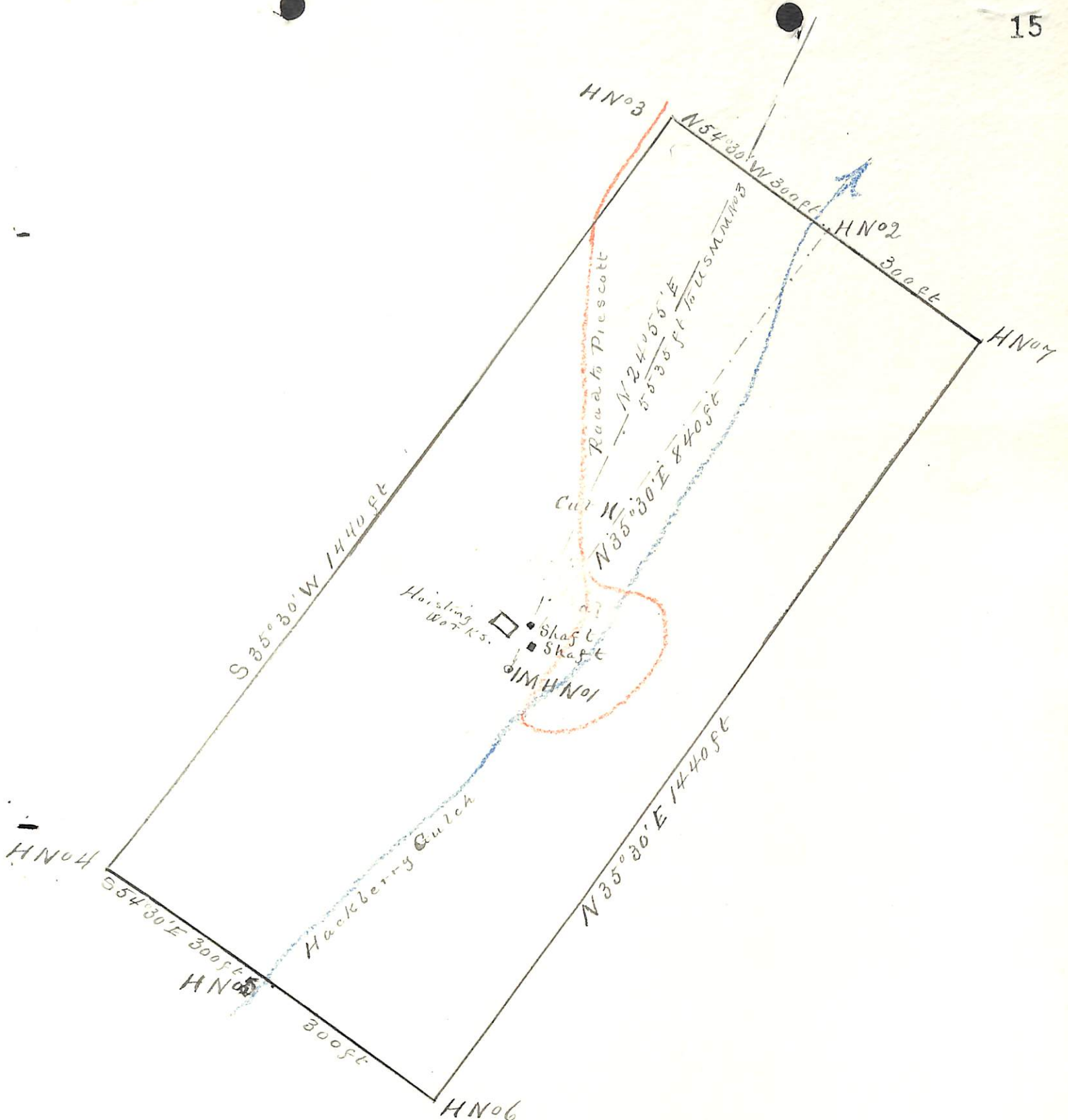

PLAT
of the
Hackberry Mining Claim
Big Bug Mining District
Yavapai County Arizona
claimed by Hackberry Mining Co.

Surveyed by C B Foster U.S.D.S.

Dec 11 1889

Contains 19.83 Acres

Scale 200 ft to 1 in.

Var 13° 55' E.

POOR QUALITY

The following pages are scanned at the best possible quality setting. The original pages are of poor quality and this is the best possible reproduction.

(4-687.)

Surveyor General's Certificate of Approval of Field Notes and Survey of Mining Claim.

Department of the Interior,

Office of U. S. Surveyor General,

Tucson, Arizona.

December 28th, 1889.

I, U. S. Surveyor General for Arizona,

do hereby certify that the foregoing and hereto attached Field Notes and Return of the Survey of the Mining Claim of

Hackberry Mining Company, known as the

Hackberry Mining Claim.

situate in Big Bug mining district,

Yavapai County, Arizona,

in Section _____, Township No. _____, Range No. _____

designated as Survey No. 909.

executed by C. B. Foster, U. S. Deputy Mineral

Surveyor, December 11th, 1889, under my instructions dated

November 11th, 1889, have been critically examined and the

necessary corrections and explanations made, and the said Field Notes and Return, and

the Survey they describe, are hereby approved. A true copy of the copy of the location

certificate filed by the applicant for survey is included in the field notes.

Payal Johnson

U. S. Surveyor General for Arizona.

o 6-162