

MS .

0

0

9

1

1

Ent. J. P.
1

(4-683.)

Mineral Survey No. 911

Lot No. 71

Gila Land District.

FIELD NOTES

OF THE SURVEY OF THE MINING CLAIM OF

C. D. Gage, W. F. Bradley and M. D. Scribner,
KNOWN AS THE

Silver Spray Mining Claim.
Warren Mining District,

Cochise County, Arizona,

Section _____, Township _____, Range _____

Surveyed under instructions dated Jan. 13th, 1890,
by H. G. Howe,
U. S. Deputy Mineral Surveyor

Claim located February 2nd, 1880.

Survey commenced January 22nd, 1890.

Survey completed January 23rd, 1890.

PRELIMINARY OATHS OF ASSISTANTS IN SURVEY OF MINING CLAIM.

WE, Chas Smith and _____,
do solemnly swear that we will well and faithfully execute the duties of chain carriers;
that we will level the chain upon even and uneven ground and plumb the tally-pins,
either by sticking or dropping the same; that we will report the true distance to all
notable objects, and the true length of all lines that we assist in measuring, to the best
of ^{my} skill and ability, and in accordance with instructions given ^{me} us, in the survey of
the Mining Claim of M. D. Scribner et al

_____, known as the
Silver Spring
situate in Worren mining district,
Cochise County, Arizona,
in Section _____, Township No. _____, Range No. _____.

Charlie Smith, Chainman.
_____, Chainman.

Subscribed and sworn to by the above-named persons before
me this 22nd day of January, 1890.

J. C. Smith
Notary Public

I, Lehar, do solemnly swear that I will well and
truly perform the duties of axeman, in the establishment of corners and other duties,
according to instructions given me and to the best of my skill and ability, in the survey
of the Mining Claim of _____

known as the _____,
more fully described in the preceding affidavit.
_____, Axeman.

Subscribed and sworn to by the said _____
before me this _____ day of _____,
18 _____.

I, _____, do solemnly swear that I will
well and truly perform the duties of flagman, in the establishment of corners and other
duties, according to instructions given me and to the best of my skill and ability, in the
survey of the Mining Claim of _____

known as the _____,
more fully described in the preceding affidavit.
_____, Flagman.

Subscribed and sworn to by the said _____
before me this _____ day of _____,
18 _____.

Field Notes.
of the Survey of the

Silver Spray Mining Claim
in the Warren Mining District,
Cochise County Arizona.

Claimed by.

C. D. Gage, W. F. Bradley and
M. D. Scribner.

Surveyed by A. G. Howe U.S.
Deputy Mineral Surveyor, under
instructions from the Surveyor
General, of date January 13th/90

Survey commenced Jan. 22nd, 1890
Survey completed Jan 23rd, 1890

Description of Survey.

Beginning at the Initial mon-
ument mentioned in location
notice and marking the South
east center of claim, a 2x4 in stake,
in mon. ^{which point coming upon solid rock} ~~where~~ I set post 5 ft. long
4 in sq. and surrounds with a
monument of stone and earth.

Post marked INT SILVER SPRAY M.C. Tr. 1.
U.S. M.M. Tr. 1. bears N 13° 40' W 2782 ft.

Thence N 47° 46' E

or 11° 35' E

223. Wash drains east.

295.4 To the N.E. cor. a 2x4 in stake, also a
2x4 in stake marked Keystone,
^{which point coming upon solid rock}
Where I set post in monument of
earth and stone, replacing Keystone
stake.

Post marked S.S. M.C. Tr. 2.

Feet, Thence $N 48^{\circ} 35' W$

var $11^{\circ} 35'$ East.

- 543. East edge Ravine bears N.E.
- 645. West N.E.
- 768. Road bears N.E.

778. To N.W. cor a 2x4 in stake in edge of wash at east end of shaft, ^{which point coming upon level post} where I set post 5 ft long 4 in sgr. and surround by monument of stone. Post marked S.S. M.C. No 3.

This is also the S.W. cor of the J. G. Batterson mining claim and a point upon the easterly side line of the Hayes mining claim. The S.E. cor Hayes M.C. bears $S 25^{\circ} 32' W$ 520.5 ft.

Thence $S 47^{\circ} 46' W$.

var $11^{\circ} 35'$ East.

285.5 To N.W. center where I drive an Iron pin 1 inch in diameter and one foot long. and build mon of stone, and set Post 5 ft. long 4 in sgr. 6 ins in ground and surround by monument of stone $S 48^{\circ} 0' E$ 112 ft. for Witness Corner.

Post marked M.C. S.S. M.C. No 4.

Thence $S 7^{\circ} 47' W$.

var $11^{\circ} 35'$ East.

281. Intersect southerly end line Hayes Mining claim. $S 81^{\circ} 30' W$ 24 ft. from a 2x4 in stake S.E. cor Hayes.

350. To a 2x4 in stake the S.W. cor where I set post 5 ft. long 4 in sgr. 6 ins in ground and surround by monument of stone, and earth.

Post marked S.S. M.C. No 5.

A 4 in post. the N.E. center. old. Home stake. now "North Star" bears $N 47^{\circ} 41' W$ 7 ft dist.

Thence $S 47^{\circ} 41' E$

var $11^{\circ} 35'$ East.

70. and $8\frac{1}{2}$ ft. to right. Shaft 4x6 ft.

Feet, 11 ft deep.

291. And 13. ft to right a 2x4 in stake
S.E. cor. Homestake.

475. and 3 ft. to right a mon of stone

550. To the S.E. cor. ^{which points coming upon solid rock} a 2x4 in stake where
I set post 5 ft. long 4 in. sq. and
surround by a monument of
earth and stone.

Post marked S.S. M.C. No 6.

Thence N47°46'E

var 11°35' East.

294. To Post No 1. and place of beginning

Area.

Total area of claim. 9.522 acres.

The conflict with the
Hays mining claim
of .681 acres. is claimed
in this application.

Net area 9.522 acres

Location.

This claim is located in Warren
Mining District Cochise County,
Arizona. Three fourths of a mile
south east of Bisbee, and is
bounded upon the north east by
the J. G. Patterson mining claim,
upon the north west by the Hays
mining claim, upon the south-
west by the Homestake and copper
monarch mining claim, upon
the south east by the Keystone
mining claim.

Improvements.

Made upon this claim by
claimants or grantors consist
of a shaft 4x6 ft 100 ft deep
N20°E 71 ft. from Post No 1. Silver
Spray.

A shaft 4x6 ft., 12 ft. deep. $N 20^{\circ} E$ 32 ft.
from I.M. No 1 Post.

A shaft. 4x6 ft., 20 ft. deep. $S 54^{\circ} 20' W$
42.5 ft. from post I.M. No 1.

Croppings showing mineral.

$N 48^{\circ} W$ 30 ft. from Post I.M. No 1.

And I hereby certify that the value
of said improvements exceeds in
value the sum of five hundred
dollars.

There have been no improvements
^{made} by other parties upon this claim

Instruments used a young's
improved Solar Transit and
Steel tape.

Bar and courses taken by use
of Solar apparatus.

H. G. Howe.
U.S. Deputy Mineral Surveyor.

Tombstone Ariz.
January 31st /90.

AFFIDAVIT OF FIVE HUNDRED DOLLARS IMPROVEMENTS.

We *Charles Smith*.....and.....*Henry Pien*.....
of lawful age, being first duly sworn according to law, depose and say
that we are acquainted with the SILVER SPRAY MINING CLAIM, situated in
WARREN MINING DISTRICT, COCHISE COUNTY, Arizona TERRITORY, for which
C.D.Gage, W.F.Bradley and M.D.Scribner have made application for sur-
-vey prior to application for patent under the provisions of the act
of Congress approved May 10, 1872, and that the labor done and improve-
-ments made thereon by the applicants and their grantors exceed Five
Hundred Dollars in value, and further that we are not personally in-
-terested in said mine.

.....*Charlie Smith*.....
.....*Henry Pien*.....

TERRITORY of ARIZONA.)
) SS.
COUNTY of COCHISE.)
)



Sworn to and subscribed before me this
23rd day of *January*.....1890

.....*A. C. Pinn*.....
Notary Public

FINAL OATHS FOR SURVEYS.

LIST OF NAMES.

A list of the names of the individuals employed by A. G. Howe,
 United States Deputy Mineral Surveyor, to assist in running, measuring, and marking the lines
 corners and boundaries described in the foregoing field notes of the survey of the mining claim
 of M. D. Scribner et al.,
 known as the Silver Spray;
 and showing the respective capacities in which they acted.

Chas Smith, , Chainman.
 , Chainman.
 , Axman.
 , Flagman.

FINAL OATHS OF ASSISTANTS.

I Charles Smith -
 and , do solemnly swear that ^I ~~we~~ assisted
A. G. Howe , United States Deputy Mineral Surveyor, in marking the corners and
 surveying the boundaries of the mining claim of M. D. Scribner
et. al. ,
 known as the

Silver Spray , represented
 in the foregoing field notes as having been surveyed by said deputy mineral surveyor and under
 his direction; and that said survey has been in all respects, to the best of ^{my} ~~our~~ knowledge and
 belief, faithfully and correctly executed, and the corner and boundary monuments established
 according to law and the instructions furnished by the United States Surveyor-General for
Arizona ,

Charlie Smith , Chainman.
 , Chainman.
 , Axman .
 , Flagman.

Subscribed and sworn to by the above-named persons before me
 this 23rd day of January , 1890

J. C. Dennis
Notary Public



(4-686.)

FINAL OATH OF U. S. DEPUTY MINERAL SURVEYOR.

I, H. G. Howe, U. S. Deputy Mineral Surveyor, do solemnly swear that, in pursuance of instructions received from the United States Surveyor General for Arizona, dated January 13th, 1890, I have, in strict conformity to the laws of the United States, the official regulations and instructions thereunder, and the instructions of said Surveyor General, faithfully and correctly executed the survey of the Mining Claim of C. D. Gage, W. F. Bradley and M. D. Scribner, known as the Silver Spray, situate in the Warren Mining District, Cochise County, Arizona, in Section _____, Township No. _____, Range No. _____, and designated as Survey No. 911, as represented in the foregoing field notes, which accurately show the boundaries of said mining claim as distinctly marked by monuments on the ground, and described in the attached copy of the location certificate, which was received by me from the Surveyor General with said instructions, and that all the corners of said survey have been established and perpetuated in strict accordance with the law, official regulations and instructions thereunder; and I do further solemnly swear that the foregoing are the true and original field notes of said survey and my report therein, and that the labor expended and improvements made upon said mining claim by claimant or their grantors are as therein fully stated, and that the character, extent, location and itemized value thereof are specified therein with particularity and full detail, and that no portion of said labor or improvements so credited to this claim has been included in the estimate of expenditures upon any other claim.

H. G. Howe
U. S. Deputy Mineral Surveyor.

Subscribed and sworn to by the said H. G. Howe,
U. S. Deputy Mineral Surveyor, before me J. W. Easton
Notary Public this 2nd
day of January, 1890.

J. W. Easton
Notary Public

"Silver Spray"

Notice of Location, Notice is hereby given that the undersigned in compliance with the requirements of the Mining Act of Congress of May 10, 1872 have this day located and claim 760 linear feet along the course of this lead lode or vein of mineral bearing quartz, and three hundred feet in width on each side of the middle of said lead, lode or vein, situate in Mule Mountains half mile west of Iron Springs, and one mile South of Warren & Ray's Smelting works, Pima County, Arizona and more particularly described as follows, to wit:

Commencing at this monument of stones being the center of the South East end of claim thence running 200 feet to a monument of stone being the North East corner of claim,

thence 760 feet to a monument of stones being the North west corner of claim,

thence 300 feet to a monument of stones, being the center of the North West end of claim, thence 300 feet to a

monument of stones being South-West corner of claim, thence 760 feet to a

Monument of stones being the South-east corner
of claim, thence 200 feet to place of beginning.
Dated on the ground this 2nd day of
February 1880. And shall be known as
the Silver Spray Mine.

Locators George Kline,
G.W. Anschutz.

Filed and recorded at request of
O.H. Light Feb'y 23rd A.D. 1880 at 10.15
A.M.

S.W. Carpenter
County Recorder.
By, M. McKenna,
Deputy.

TERRITORY OF ARIZONA)
County of Cochise) ss.

I, W. F. Bradley, County Recorder in and for the County of Cochise, do
hereby certify that the above and foregoing is a full, true and correct copy of
The Location Notice of the Silver Spray Mine, Warren Dist, A.T.
as appears of record now in my office in Book Q, Page 77. Transcribed Records
of Mines.

In witness whereof, I have hereunto set my hand and affixed
my official seal, at my office, in Tombstone, this
10th day of January, A. D. 1890
W. F. Bradley
County Recorder.

PLAT
 of the
 SILVER SPRAY MINING CLAIM
 WARREN MINING DISTRICT
 COCHISE COUNTY ARIZONA
 Containing 9.522 Acres.
 Scale 200 ft. = 1 inch.
 Var 11° 35' East.

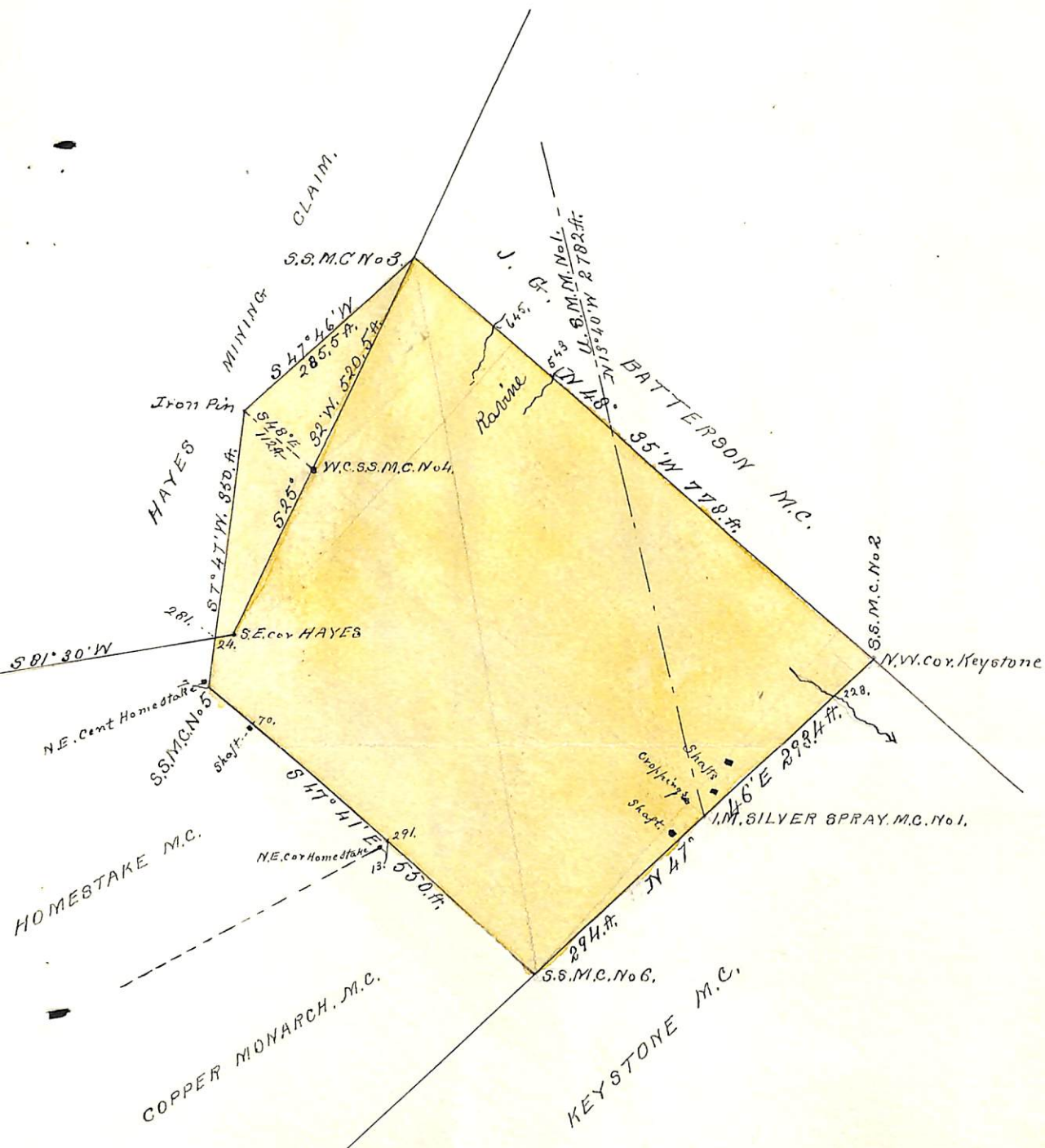

(4-687.)

Surveyor General's Certificate of Approval of Field Notes and Survey of Mining Claim.

Department of the Interior,

Office of U. S. Surveyor General,

Tucson, Arizona

February 11th, 1890.

I, U. S. Surveyor General for Arizona,

do hereby certify that the foregoing and hereto attached Field Notes and Return of the Survey of the Mining Claim of

C. H. Gage, W. F. Bradley and M. D. Scribner

, known as the

Silver Spray Mining Claim,

situate in Warren mining district,

Cochise County, Arizona,

in Section _____, Township No. _____, Range No. _____

designated as Survey No. 911.

executed by H. G. Howe, U. S. Deputy Mineral

Surveyor, January 23rd, 1890, under my instructions dated

January 13th, 1890, have been critically examined and the necessary corrections and explanations made, and the said Field Notes and Return, and

the Survey they describe, are hereby approved. A true copy of the copy of the location certificate filed by the applicant for survey is included in the field notes.

Raymond Johnson
U. S. Surveyor General for Arizona

o 6-162