

MS.

0

1

0

1

4

(4-683.)

Mineral Survey No. 1014

Lot No. 43.

Priscott Land District.

FIELD NOTES

OF THE SURVEY OF THE MINING CLAIM OF

Minnie Shurtz

KNOWN AS THE

Wilcox

Mallapai Mining District,

Maricopa County, Arizona

Section 3, Township 23 N., Range 18 W.

Surveyed under instructions dated October 29, 1891,

by O. F. HUNTER,

U. S. Deputy Mineral Surveyor.

Claim located January 19th, 1891.

Survey commenced October 14th, 1891.

Survey completed October 15th, 1891.

PRELIMINARY OATHS OF ASSISTANTS IN SURVEY OF MINING CLAIM.

WE, C. E. Sherman and J. Richard,
do solemnly swear that we will well and faithfully execute the duties of chain carriers;
that we will level the chain upon even and uneven ground and plumb the tally-pins,
either by sticking or dropping the same; that we will report the true distance to all
notable objects, and the true length of all lines that we assist in measuring, to the best
of our skill and ability, and in accordance with instructions given us, in the survey of
the Mining Claim of Minnie Sherman
....., known as the
"Wallace" mining claim
situate in Wallapai mining district,
Maricopa County, Arizona,
in Section 3, Township No. 23 N., Range No. 18 W.

C. E. Sherman, Chainman.
J. Richard, Chainman.

Subscribed and sworn to by the above-named persons before
me this 14 day of Octob., 18 91.

E. J. Gadsden County Recorder
By O. F. Knicker
Deputy

I,, do solemnly swear that I will well and
truly perform the duties of axeman, in the establishment of corners and other duties,
according to instructions given me and to the best of my skill and ability, in the survey
of the Mining Claim of

known as the,
more fully described in the preceding affidavit.

....., Axeman.

Subscribed and sworn to by the said,
..... before me this day of
....., 18 ..

I,, do solemnly swear that I will
well and truly perform the duties of flagman, in the establishment of corners and other
duties, according to instructions given me and to the best of my skill and ability, in the
survey of the Mining Claim of

known as the,
more fully described in the preceding affidavit.

....., Flagman.

Subscribed and sworn to by the said,
..... before me this day of
....., 18 ..

Feet.

— Field Notes —
 of the survey of the
"Willace" Mining Claim
 in the Wallapai Mining Dist.
 Mohave County.

Arizona.

{ Located viz Sec 3, T. 23, N. R. 18, W }
 Claimed by Minnie Sherman.

Surveyed by O. J. Kueneer.

U. S. Deputy Mineral Surveyor.

under instructions from the
 Surveyor General of date
 September 29th 1891.

Survey commenced Oct. 14, 1891
 " completed Oct. 15, 91.

— Description of Survey —

Beginning at the initial
 mon. mentioned in loc.
 notice, placed on center of
 vein, at the South end center
 of "Diestaff" mining claim,
 and North end center of
 "Willace" mining claim,
 where I set a post 4 ft.
 long, 4 ins. dia. 1 1/2 ft. in
 ground, and surrounded
 same, with mound of stones;
 Post marked W. I. M. on South
 side and D. on North side.

Thence S. 88° 20' W
 Cor. 14° 20' E

Feet.

300. To loc. mon. on N.W. cor. of "Willace" and S.W. cor. of "Distaff" mining claim, where is set a post 4 ft. long, 4 ins. dia. ^{marked D. 15} in a granitic reef - ~~not marked W.I.~~ ^{not marked W.I.} said reef, immediately back of post is marked W.I. B.R. Post below the letter: D.S.B.R. (for Distaff)
 NE. cor. of Distaff Lodging house bears: S. 3° 15' E. 220 ft.

Thence S. 10° 55' W.
 Var. 14° 20' E.

366. to center of Road, bears E and W.
 701. to center of big wash, bears E and W.
 1050 to mon. on S.W. cor. of claim, where I set a post 4 ft. long, 4 ins. dia. 1/2 ft in ground, and unrounded same with ground of stones.

Not marked W.II.
 Granite boulder 2 x 3 x 3 1/2 ft. marked: W.II. B.R. bears: S. 20° 30' W. 245 feet.
 Split in Canyon Back in Union Pass Range bears: S 29° 40' W.

Thence N. 88° 20' E.
 Var. 14° 20' E.

300. to wagon road, bears N. and S.
 600. to mon. on S.E. cor. of claim, where I set a post, 4 ft. long, 4 ins. dia. 1/2 ft. in ground, and unrounded same with ground stones

Not marked: W.III.
 Face of Granitic reef, 3 ft. from ground, marked: W.III. B.R. bears: S. 71° 20' W. 43 ft.

Feet

(Thence N. $10^{\circ}55'$ E.Var. $14^{\circ}20'$ E

630. To center of wash - bears NE and SW.
 950. " " " big wash - bears NE and S.W.
 967. " " " wagon road, bears NE and SW.
 1050. " sec. mon. on NE. cor. of "Wallace"
 and SE. cor. of "Distaff" mining
 claim, where is set a post,
 4 ft. long, 4 ins. dia.

Post marked W. IV. on South
 side and D. 4. on North side
 (for Distaff)

Post is set in a clump
 of large boulders, immediately
 north of the road, leading from
 Chloride to Baker's furnace.

Face of large boulder, against
 which the post rests is marked
 W. IV. B. R. just below the letters
 D. 4. B. R. for "Distaff" claim.

SW. cor. of Schuykill mine
 patented, bears: N. $28^{\circ}20'$ E. 887 ft.

Cor common to Secs 34-
 35 - 2 and 3. Tps 23 and 24 N.
 R. 18 W. bears N. $57^{\circ}10'$ E. 1902 ft.

(Thence S. $88^{\circ}20'$ W.Var. $14^{\circ}20'$ E.

300. To initial mon and post
 W. I. M.

Area.

Total Area of claim 14.27 acs.

Location.

This claim is located in Sec. 3.
 Tps. 23. N. R. 18 W. 9th and 10th
 River Base and Meridian.

Improvements

Made upon this claim by claimant consist of a small shaft $2\frac{1}{2}$ ft. wide by 6 ft. long and 6 ft. deep - S. $10^{\circ}55'$ W. 60 ft. from post W. I. M.

The value of said improvements is Twenty five dollars.

The loc. mon. on South boundary line of claim, I found placed 70 ft. farther South, than the 1050 ft. claimed in loc. notice; I shortened the claim 70 ft. to correspond with notice of location - otherwise the survey and location of "Willace" mining claim are identical.

The course of the vein, on "Willace" mining claim, although the southeasterly of "Diotaff" mining claim, changes from S. $1^{\circ}40'$ E. to S. $10^{\circ}55'$ W, at the initial mon. of "Willace" claim;

This mon. sets at the foot of the hill, across which the "Diotaff" runs, the whole of the "Willace" claim lying in the valley. The trend of the vein, from this mon. south, bearing plainly traceable, as given in field notes and plat, although no development work has been done on the vein.

Instruments used: a Keller

5
7
and Brightley Transit, with
Solar attachment, and steel
chain.

Obs. and courses taken
by solar apparatus and vernier
readings.

O. F. Knencel
U. S. Deputy Min. Surveyor

Kingman A. T. Oct 16-91.

FINAL OATHS FOR SURVEYS.

LIST OF NAMES.

A list of the names of the individuals employed by O. J. Knencel
 United States Deputy Mineral Surveyor, to assist in running, measuring, and marking the lines
 corners and boundaries described in the foregoing field notes of the survey of the mining claim
 of Winnie Sherman
 known as the "Willace" mining claim
 and showing the respective capacities in which they acted.

B. E. Sherman, Chairman.
G. Richard, Chairman.
 _____, Axman.
 _____, Flagman.

FINAL OATHS OF ASSISTANTS.

We, B. E. Sherman and G. Richard
 and _____, do solemnly swear that we assisted O. J.
Knencel, United States Deputy Mineral Surveyor, in marking the corners and
 surveying the boundaries of the mining claim of Winnie
Sherman,
 _____, known as the "Willace"
mining claim, represented
 in the foregoing field notes as having been surveyed by said deputy mineral surveyor and under
 his direction; and that said survey has been in all respects, to the best of our knowledge and
 belief, faithfully and correctly executed, and the corner and boundary monuments established
 according to law and the instructions furnished by the United States Surveyor-General for
Arizona.

B. E. Sherman, Chairman.
G. Richard, Chairman.
 _____, Axman.
 _____, Flagman.

County Recorder
 Subst

Subscribed and sworn to by the above-named persons before me
 this 15th day of October, 18 91

E. J. Godman
 County Recorder
 By O. J. Knencel
Deputy

FINAL OATH OF U. S. DEPUTY MINERAL SURVEYOR.

I, O. F. Kuenced, U. S. Deputy Mineral Surveyor, do solemnly swear that, in pursuance of instructions received from the United States Surveyor General for Arizona, dated Sept. 29, 1891, I have, in strict conformity to the laws of the United States, the official regulations and instructions thereunder, and the instructions of said Surveyor General, faithfully and correctly executed the survey of the Mining Claim of Minnie Sherman, known as the "Willace" mining claim, situate in Willapa Mining District, Mohave County, Arizona, in Section 3, Township No. 23 N., Range No. 18. E. and designated as Survey No. 1014 Pat. 7043, as represented in the foregoing field notes, which accurately show the boundaries of said mining claim as distinctly marked by monuments on the ground, and described in the attached copy of the location certificate, which was received by me from the Surveyor General with said instructions, and that all the corners of said survey have been established and perpetuated in strict accordance with the law, official regulations and instructions thereunder; and I do further solemnly swear that the foregoing are the true and original field notes of said survey and my report therein, and that the labor expended and improvements made upon said mining claim by claimant or her grantors are as therein fully stated, and that the character, extent, location and itemized value thereof are specified therein with particularity and full detail, and that no portion of said labor or improvements so credited to this claim has been included in the estimate of expenditures upon any other claim.

O. F. Kuenced
U. S. Deputy Mineral Surveyor.

Subscribed and sworn to by the said O. F. Kuenced,
U. S. Deputy Mineral Surveyor, before me E. J. Godman
County Recorder this 27th
day of October, 1891.

E. J. Godman
County Recorder

Notice of Location

To all whom it may concern: Notice is hereby given that the undersigned having complied with all the requirements of Chapter 41. of Title 32 of the Revised Statutes of the United States, and the local Mining laws rules and regulations, has this day located fifteen hundred (1500) linear feet of this vein or lode, bearing precious metals, with all dips, spurs, angles and variations, with surface ground three hundred (300) feet on each side of the center of vein, with all mineral deposits contained therein, and all timber growing within the limits of said claim, and all water and water privileges thereon or appurtenant thereto, under and according to the provisions of the United States Mining laws, under which it is located. This claim commences at this monument and notice placed upon the ledge and runs 1050 feet in a south direction along the ledge. The exterior boundaries are as follows, to wit: Commencing at a monument of stone on the west boundary line distant three hundred (300) feet in a west direction from Discovery monument: thence in a south direction parallel with the ledge 1050 feet to monument of stone at S. W. Corner of Claim: thence in a East direction at right angles across the ledge six hundred (600) feet to monument of stone at S. E. Corner of Claim: thence in a North direction parallel with the ledge 1050 feet to monument of stone at N. E. Corner of Claim: thence at right angles across the ledge in a west direction six hundred (600) feet to monument of stone at N. W. Corner of Claim and place of beginning. This ledge may be more generally described as situated and adjoining the Distaff mine on the south being the first south extension of the same. In Mollapai Mining District, Mohave County, Arizona Territory and shall be known as the Wallace Mining Claim. Dated on the ground. This first day of Jan 1891

Witnesses C. E. Sherman Locator

Recorded at the request of C. E. Sherman Jan 3^d
A D 1891 at 10 Minutes past 11 O'clock Am.

E J Godman
County Recorder,

Territory of Arizona } ss
County of Mohave } 3

I, E J Godman, County Recorder, in
and for said County do hereby Certify, that the above
and foregoing is a full true and correct Copy of the
location Notice of the Wallace Mining Claim, as the
same appears of record in this office in Book J
Page 395 Mining records of Mohave County Arizona
Territory.

In Witness whereof I have hereunto set my hand and
affixed my official Seal this 16th day of September A. D.
1891

E J Godman
County Recorder.

Plat of the
Willace Mining Claim.

Situate in Wallapai Mining District,
County of Mohave,
and in Sec. 3, T²³ N. R. 18 W.,
Gila and Salt River Meridian,
Arizona.

Claimed by Minnie Sherman.
Surveyed by O. F. Huencer, U. S. Deputy
Surveyor Oct. 14th and 15th, 1897.
Containing **14.32** 27 acres.
Scale: 200-ft. to an inch.

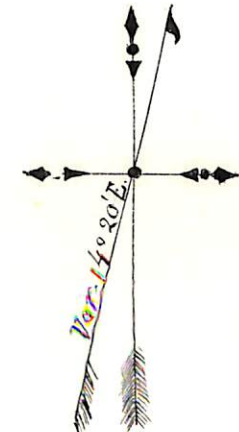
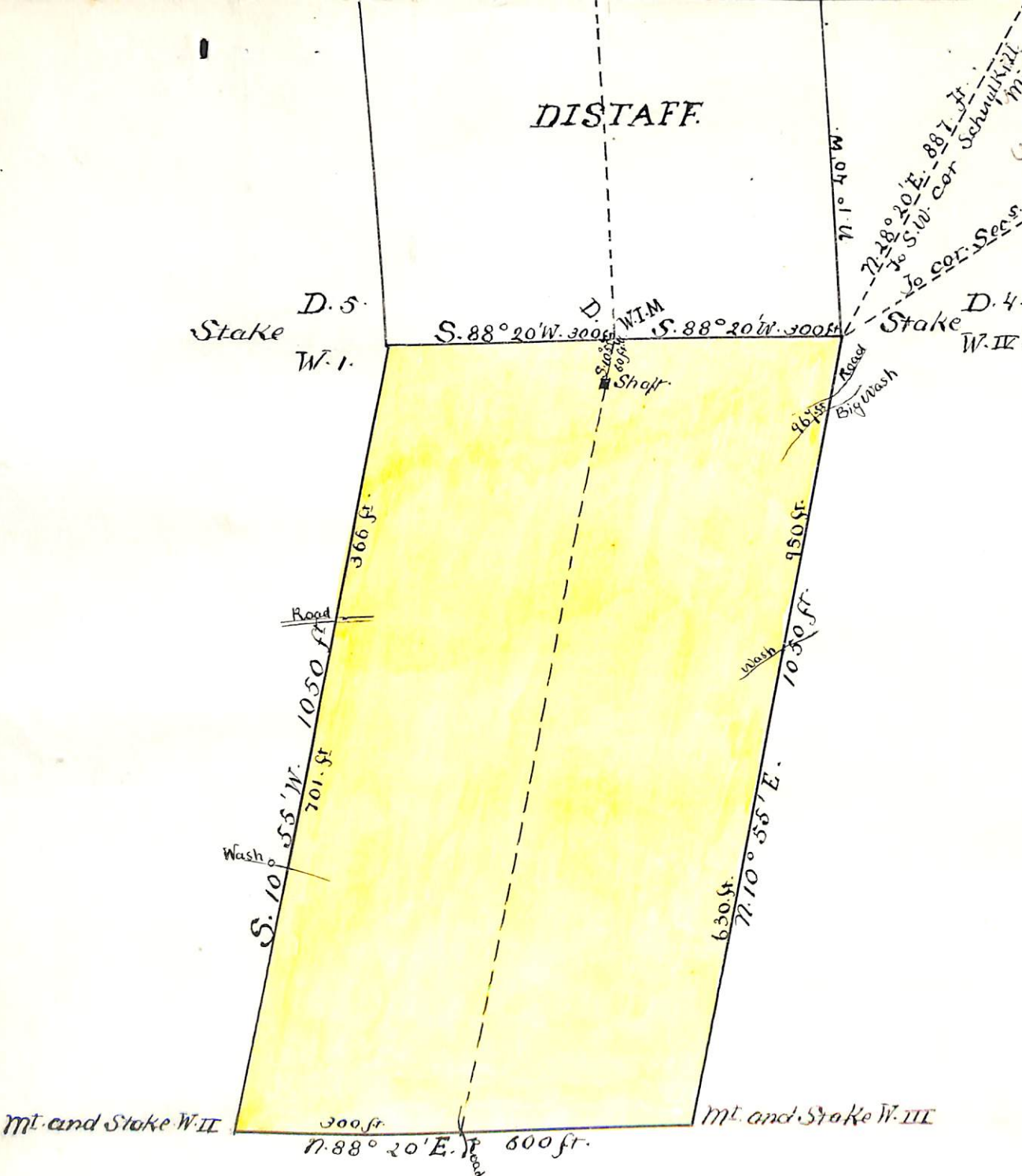

(4-687.)

Surveyor General's Certificate of Approval of Field Notes and Survey of Mining Claim.

Department of the Interior,

Office of U. S. Surveyor General,

Tucson Arizona

February 17th, 1892.

I, U. S. Surveyor General for *Arizona Territory*,
do hereby certify that the foregoing and hereto attached Field Notes and Return of the
Survey of the Mining Claim of *Minnie Sherman*

....., known as the

Willow

situate in *Holladay* mining district,

Mohave

County, *Arizona*

in Section *3*, Township No. *23 N*, Range No. *18 W*.

and, designated as Survey No. *1014* Lot. *7th 43*

executed by *O. F. Stewart*, U. S. Deputy Mineral

Surveyor, *October 14th and 15th*, 1891, under my instructions dated

September 29th, 1891, have been critically examined and the

necessary corrections and explanations made, and the said Field Notes and Return, and

the Survey they describe, are hereby approved. A true copy of the copy of the location

certificate filed by the applicant for survey is included in the field notes.

Royce Johnson

U. S. Surveyor General for *Arizona*

o 6-1c2

UNITED STATES DEPARTMENT OF THE INTERIOR
BUREAU OF LAND MANAGEMENT
ARIZONA STATE OFFICE

9605 (942)
M.S. 1014

NOTICE OF CANCELLATION OF MINERAL SURVEY

The Willace lode, Mineral Survey 1014, located in section 3, T. 23 N., R. 18 W., Gila and Salt River Meridian, Arizona, is hereby cancelled.

This claim has not been filed with the Arizona State Office, Bureau of Land Management, in accordance with Section 314 of 43 U.S.C. 1744.

This cancellation was necessitated by a need to survey section 3 as requested by the Kingman Resource Area office of the Phoenix District.

February 1, 1988

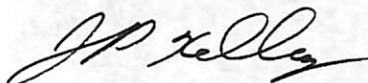

Chief Cadastral Surveyor of Arizona