

**MS**  
-

**0**

**1**

**0**

**3**

**8**

700  
m. 10

(4-683.)

Mineral Survey No. 1038.

Lot No. ~~~~~

Gila. Land District.

### FIELD NOTES

OF THE SURVEY OF THE MINING CLAIM OF

Aravaipa Mining Company  
John F. Blandy Atty.

KNOWN AS THE

Gordon, Maxwell, Glory, Arizona Thanksgiving  
and David Lodes Situate in Aravaipa Mining District,

Graham County, Arizona.

Section ~~~~~, Township 5 South, Range 20 East

Surveyed under instructions dated June 6<sup>th</sup>, 1892.

by H. G. Howe,  
U. S. Deputy Mineral Surveyor.

Claim located....., 18 ..

Survey commenced July 11<sup>th</sup>....., 1892.

Survey completed July 14<sup>th</sup>....., 1892.

Glory Claim located Jan 1<sup>st</sup> 1890.

Gordon Claim located Jan 1<sup>st</sup> 1889.

Maxwell Mine located Jan 1<sup>st</sup> 1889.

Arizona Mine located Jan 1<sup>st</sup> 1889.

Thanksgiving Mine located November 27<sup>th</sup> 1890.

David Mine. .. Sept 5<sup>th</sup> 1890.

Claimants address.

Aravaipa.  
Graham County,  
Arizona

# PRELIMINARY OATHS OF ASSISTANTS IN SURVEY OF MINING CLAIM.

WE, W. H. Moore and Harry J. Frith,  
do solemnly swear that we will well and faithfully execute the duties of chain carriers;  
that we will level the chain upon even and uneven ground and plumb the tally-pins,  
either by sticking or dropping the same; that we will report the true distance to all  
notable objects, and the true length of all lines that we assist in measuring, to the best  
of our skill and ability, and in accordance with instructions given us, in the survey of  
the Mining Claim of Aravaipa Mining Company  
by John F. Blandy Atty., known as the  
Gordon Maxwell, Glory Arizona Thanksgiving & David  
situate in Aravaipa mining district,  
Graham County,  
in Section \_\_\_\_\_, Township No. \_\_\_\_\_, Range No. \_\_\_\_\_

W. H. Moore, Chainman.  
H. J. Frith, Chainman.

Subscribed and sworn to by the above-named persons before  
me this 11<sup>th</sup> day of July, 1892

A. G. Howel  
Notary Public.

I, \_\_\_\_\_, do solemnly swear that I will well and  
truly perform the duties of axeman, in the establishment of corners and other duties,  
according to instructions given me and to the best of my skill and ability, in the survey  
of the Mining Claim of \_\_\_\_\_

known as the \_\_\_\_\_,  
more fully described in the preceding affidavit.

\_\_\_\_\_, Axeman.

Subscribed and sworn to by the said \_\_\_\_\_  
before me this \_\_\_\_\_ day of \_\_\_\_\_,  
\_\_\_\_\_, 18 \_\_\_\_\_.

I, Alvan W. Howel, do solemnly swear that I will  
well and truly perform the duties of flagman, in the establishment of corners and other  
duties, according to instructions given me and to the best of my skill and ability, in the  
survey of the Mining Claim of Aravaipa Mining Company  
John F. Blandy Atty.  
known as the Gordon Maxwell, Glory Arizona Thanksgiving and  
David more fully described in the preceding affidavit.

Alvan W. Howel, Flagman.

Subscribed and sworn to by the said Alvan  
W. Howel before me this 11<sup>th</sup> day of  
July, 1892.

A. G. Howel  
Notary Public.

Feet.

Survey No. 1038.  
Arizona Lode.

Beginning at Cor. No 1

A pine post 4 ins. sq. 5 ft. long in  
monument of stones, marked  $\frac{1}{1038}$ , whence

U. S. L. M. No. 1 bears  $N. 85^{\circ} 34' E. 5325$  ft.

Boy cañon bears  $S. 39^{\circ} 0' E. 3650$  ft.

Office Aravaipa Mining Co. bears  $S. 21^{\circ} 39' E. 3775$  ft. whin over shaft No. 1.

upon No. 1. mine bears  $S. 11^{\circ} 46' E. 3720$  ft.

Cor. No. 1. Sur. 529 1039 bears  $N. 53^{\circ} 2' E. 2773$  feet

Thence  $N. 51^{\circ} 0' E.$

Var.  $12^{\circ} 35' E.$

300

To center of claim bold croppings which  
point is also the North centre David  
claim, Aravaipa Mining Co. claimant;

600

To cor. No 2.

A 4x4 in. post 5 ft long in mound of stone,  
marked  $\frac{2}{1038}$ , upon N. W. face, (this point  
is 5 ft east of face of Tunnel extending  
into Arizona)

this post is also the S. W. cor. Thanksgiving  
and N. E. cor. David Lodes, Aravaipa  
Mining Co. claimant.

Thence  $N. 8^{\circ} 20' W.$

Var.  $12^{\circ} 35' East$

1430

To cor. No 3.

Old location cor. a 4x4 in. post 5 ft long  
in mound of stones marked  $\frac{3}{1038}$ , upon  
S. W. face, this post is also the N. W. cor  
Thanksgiving and S. E. cor. Glory Lodes  
Aravaipa Mining Co. claimant.

Thence  $S 81^{\circ} W.$

Var.  $12^{\circ} 35' East,$

130

To wash, drains South,

300

To bold croppings, being northerly center  
Arizona and southerly center Glory.

600.

To cor. No. 4

A pine post 4 ins sq. 5 ft. long, in  
mound of stone, marked  $\frac{4}{1038}$ .

Feet.

Thence S.  $8^{\circ} 20'$  E.Var.  $12^{\circ} 35'$  East.

840

To wash, drains S. S. W.

1430

To cor. No 1, the place of beginning,

## Gordon Lode.

Beginning at cor. No. 5, the S. W. cor. Gordon

A pine post 4 ins sgr. 5 ft. long, in mound of stone, marked  $\frac{5}{1038}$ , whence cor. No 1 of this survey bears S.  $22^{\circ} 40'$  E. 3009.7 ft.Thence N.  $21^{\circ} 08'$  W.Var.  $12^{\circ} 35'$  East.

1170

To wash, drains westerly

1497

To cor. No 6,

A pine post 4 ins sgr. 5 ft. long in mound of stone marked  $\frac{6}{1038}$ , near the top of Table Land,Thence N.  $81^{\circ} 0'$  EVar.  $12^{\circ} 35'$  East.

600

To cor. No 7.

A pine post 4 ins sgr. 5 ft. long in mound of stone on the southerly slope of ridge, marked upon south-west face  $\frac{7}{1038}$ .Thence S.  $21^{\circ} 8'$  E.Var.  $12^{\circ} 35'$  East.

240

To wash, drains westerly

1497

To cor. No 8.

A pine post 4 ins. sgr. 5 ft. long in mound of stone marked north-west face  $\frac{8}{1038}$ .  
This point is also the S. W. cor. of the Maxwell and N. W. cor. of the Gray Lodes Aravaipa Mining Co. claimants.Thence S  $81^{\circ} 0'$  W.Var.  $12^{\circ} 35'$  East

600

To cor. No 5, the place of beginning.

Feet

Maxwell Lode.

Beginning at cor. No. 9,  
the S. W. cor. Maxwell  
A pine post 4 ins. sq. 5 ft. long in mound  
of stone, marked north-east face  $\frac{9}{10}^{\circ}$ , the  
north west face is marked  $\frac{9}{10}^{\circ}$ .

Thence N.  $21^{\circ} 8' W.$   
Var.  $12^{\circ} 35' East.$

1257  
1497

To wash, drains westerly  
To cor. No. 10,  
A pine post 4 ins. sq. 5 ft. long in mound  
of stone marked south-east face  $\frac{10}{10}^{\circ}$  and  
southwest-face  $\frac{7}{10}^{\circ}$ , being identical with  
N. E. cor. Gordon.

Thence N.  $81^{\circ} 0' E.$   
Var  $12^{\circ} 35' East$

540  
600

To wash, drains westerly  
To cor. No. 11  
A pine post 4 ins. sq. 5 ft. long in mound  
of stone marked  $\frac{11}{10}^{\circ}$

Thence S.  $21^{\circ} 8' E.$   
Var  $12^{\circ} 35' East$

1497

To cor. No. 12.  
A pine post 4 ins. sq. 5 ft. long in mound  
of stone marked  $\frac{12}{10}^{\circ}$ . This point is also  
the N. E. cor. Glory.

Thence S.  $81^{\circ} 0' W.$   
Var.  $12^{\circ} 35' East.$

600

To cor. No. 9, the place of beginning.

Glory Lode.

Beginning at cor. No. 13.  
A pine post 4 ins. sq. 5 ft. long in mound  
of stone marked  $\frac{13}{10}^{\circ}$ , which point is  
identical with the S. W. cor. Maxwell  
and S. E. cor. Gordon Lodes,

Thence N.  $81^{\circ} 0' E.$   
Var  $12^{\circ} 35' East$

Feet

600

To cor. No. 14

A pine post 4 ins. sq. 5 ft. long in mound of stone marked  $\frac{14}{1038}$ , this point is identical with the S. E. cor. Maxwell lode.

Thence S.  $13^{\circ} 54'$  E.

Var.  $12^{\circ} 35'$  East

1500

To cor. No. 15;

A pine post 4 ins. sq. 5 ft. long in mound of stone, marked  $\frac{15}{1038}$ , which point is also the identical N. W. cor. Thanksgiving and N. E. cor. Arizona lodes, Aravaipa Mining Co. claimants.

Thence S.  $81^{\circ} 0'$  W.

Var.  $12^{\circ} 35'$  East.

130

To wash, drains south

300

To bold croppings being southerly center Gloy and northerly center Arizona,

600

To cor. No. 16.

A pine post 4 ins. sq. 5 ft. long in mound of stone marked  $\frac{16}{1038}$ , this point is also the N. W. cor. Arizona.

Thence N.  $13^{\circ} 54'$  W.

Var.  $12^{\circ} 35'$  East.

1260.

To wash, drains easterly.

1500

To cor. No. 13 the place of beginning.

### Thanksgiving Lode.

Beginning at cor. No. 17.

A pine post 4 ins. sq. 5 ft. long, in mound of stone, marked  $\frac{17}{1038}$ , this cor. is identical with the S. E. cor. Gloy and N. E. cor. Arizona. Aravaipa Mining Co. claimants.

Thence N.  $81^{\circ}$  E.

Var.  $12^{\circ} 35'$  East

555

Intersect line 7-8. Sur. No. 1039 at S.  $65^{\circ} 26'$  E. 130 ft. from cor. No. 7.

580

To cor. No. 18.

- Feet- A pine post 4 ins. sq., 5 ft. long in mound of stone, marked  $\frac{18}{1035}$   
Thence S.  $9^{\circ}-08' E.$   
Var.  $12^{\circ}-35'$  East.
- 7 Intersect-line 7-8 Sur. No 1039 at S.  $65^{\circ}-26' E.$   
15.6 ft. from cor. No. 7.
- 93.5 Intersect-line 14-15. Sur. No. 1039, N  $62^{\circ}-08' E.$   
169.2 ft. from cor. No 14.
- 675.8 Intersect-line 13-14. Sur. No 1039 S.  $26^{\circ}-01' E.$   
551.7 ft. from cor. No. 14.
- 1150 To wash, drains westerly
- 1429.8 To cor. No. 19.  
A pine post 4 ins. sq., 5 ft. long in mound of stone, marked  $\frac{19}{1038}$   
Thence S.  $81^{\circ}-0' W.$   
Var.  $12^{\circ}-35'$  East.
- 220 To wash, drains S. S. W.
- 600 To cor. No. 20.  
A pine post 4 ins. sq., 5 ft. long in mound of stone marked  $\frac{20}{1038}$ , this is also the S. E. cor. Arizona and N. E. cor. David Lode's Arandipa Mining Co. claimants,  
Thence N.  $8^{\circ}-20' W.$   
Var  $12^{\circ}-35'$  East.
- 1430 To cor. No. 17, the place of beginning.

### David Lode.

Beginning at cor. No. 21  
which point is identical with the S. W.  
cor. Thanksgiving and S. E. cor. Arizona.

A pine post 4 ins. sq., 5 ft. long in mound of stone, marked  $\frac{21}{1038}$

Thence S.  $81^{\circ}-0' W.$

Var  $12^{\circ}-35'$  East.

- 300 To bold croppings, center of claim
- 600 To cor No. 22.

A pine post 4 ins. sq., 5 ft. long in mound of stone, marked  $\frac{22}{1038}$ ,  
this point is identical with S. W. cor. Arizona.



Feet, Thence  $54^{\circ} 38' E$   
 Var  $12^{\circ} 35' East.$

1500. To cor. No. 23.  
 Alpine post 4 in sq. 5 ft. long, in mound of  
 stone marked  $23/1038.$   
 Thence  $N 81^{\circ} 0' E$   
 Var  $12^{\circ} 35' East.$

435. To wash drains S.S.W.

600. To cor. No. 24.  
 Alpine post 4 in sq. 5 ft. long, in mound  
 of stone marked  $24/1038.$   
 Thence  $N 4^{\circ} 38' W$   
 Var  $12^{\circ} 35' East.$

290. To wash drains S.S.E

1500 To cor. No. 21, the place of beginning.

Area.

Total Area Arizona Lode	19.695 Acres.
" " Gordon Lode	20.159 "
" " Maxwell Lode	20.159 "
" " Glory Lode	20.585 "
" " David Lode	20.601 "
" " Thanksgiving Lode.	19.368 "
Area in conflict with	
Survey No 1039.	
Mammoth Chief Lode.	.002 Acres.
Keedy Lode	1.069 "
Thanksgiving Lode exclusive of Mammoth Chief Lode	<u>19.366 Acres.</u>

Area of Lode Claims. 120.565 Acres

Location.

This group of claims is situated in  
 the S.W. cor. T. 5. S. R. 20, East, Gila and  
 Salt River Meridian (Township un-  
 surveyed) in the Aravaipa Mining  
 District, Graham, County, Arizona

## Expenditure of Five Hundred Dollars.

I certify that the value of the labor and improvements upon this claim, placed thereon by the claimant and its grantors, is not less than five hundred dollars, and that said improvements consist of,

The discovery Shaft, of the Arizona lode 6x5ft. 8ft deep in rock, which bears from cor. No. 1.

N 14° 52' E 764. ft.

Value,

\$ 80.

An incline Shaft 4x6ft. 70ft. deep in ledge timbered  $\frac{1}{3}$  the way down bears from cor. No. 1. N 48° 30' E 417 ft.

Value,

\$ 1050.

A Shaft. 4x6ft. 83.5ft deep in rock, timbered with square timber. bears from cor. No. 1. N 8° 22' E. 891. ft.

Value

\$ 1670.—

Tunnel No. 1. (To develop Arizona and Thanksgiving lodes.) 5x7ft. 578ft long in rock course N 85° 0' E The face of bears from cor. No. 1. N 1° 38' W. 540. ft.

Value of Tunnel

\$ 11560.

Tunnel No. 2. 5x7ft. 326.5ft. in rock. course N 38° 0' W. The face of bears from cor. No. 2. S 81° 0' W 5. ft.

Value

\$ 6530.—

## "Gordon Lode."

Discovery Tunnel 4x7ft. 446ft. long. in rock course, south. face of bears from cor. No. 7. S 26° 32' W 418. ft.

Value

\$ 6690.—

A Shaft. 4x6ft. 132ft. deep in rock bears from cor. No. 7. S 10° 52' W 736. ft.

Value,

1650.—

## "Maxwell Lode"

The discovery Shaft. 4x6ft. 50ft. deep in rock bears from cor. No. 9. N 14° 36' E 570. ft.

Value,

\$ 500.—

There are croppings upon center line of this claim.

## "Glory Lode"

The discovery Shaft 4x6ft. 10ft. deep, in rock bears from cor. Tr. 15.  $N 88^{\circ} 52' W$ . 302. ft.

value \$100.—

A Shaft. 4x6ft. 10ft. deep, in rock, bears from cor. Tr. 15.  $N 60^{\circ} W$  475. ft.

value. \$100.—

A Tunnel 4.5ft x 7ft. 200. ft. long in rock course  $S 59^{\circ} 58' W$ . face of bears from cor. No. 15.  $N 52^{\circ} 43' W$  187. ft.

value. \$3000.—

## "David Lode"

The discovery Shaft. 4x6ft. 10ft. deep in rock, bears from cor. Tr. 22.  $N 88^{\circ} 24' E$  302 ft.

value. \$100.—

A Shaft. 4x6ft. 10ft deep, in rock bears from cor. Tr. 22  $S 76^{\circ} 20' E$  320. ft.

value \$100.—

A Shaft 4x6ft. 10ft in decomposed ledge matter, bears from cor. Tr. 22.  $S 20^{\circ} 0' E$  1145. ft.

value \$85.—

The development work upon the Shanks giving lode consists of the east end of Tunnel Tr. 1, described in improvements upon Arizona Lode.

value. \$1400.—

## Instrument.

The survey was made with a young and Son's Mountain Transit No. 5585, with Smith's Solar attachment.

The courses were deflected from the true meridian as determined by solar observations.

The distances were measured with a 100ft. steel tape.

A. G. Howe

Tombstone U. S. Deputy Mineral Surveyor,  
Sept 17<sup>th</sup> 1892

# Affidavit of Five Hundred Dollars Improvements.

We, W. H. Moore and H. J. Firth

of lawful age, being first duly sworn according to law, depose and say: that we are acquainted with the  
Gordon Maxwell, Glory, Arizona, and David, <sup>and David,</sup> ~~Thanksgiving~~ mining claim, situated in  
Aravaipa Mining District, Graham County,

Arizona Territory, for which Aravaipa Mining Company

John F. Blandy, Atty

has made application for survey prior to application for patent under the provisions of the Act of Congress, approved May 10, 1872; and that the labor done and improvements made thereon by the applicant and their grantors exceed Five Hundred Dollars in value, and further that we are not personally interested in said mine.

W. H. Moore

H. J. Firth

TERRITORY OF ARIZONA,  
County of Graham } ss.

SWORN to and subscribed before me, this 18<sup>th</sup> day  
of July — 1892.

H. C. Howel  
Notary Public.

# FINAL OATHS FOR SURVEYS.

## LIST OF NAMES.

A list of the names of the individuals employed by H. G. Howe,  
 United States Deputy Mineral Surveyor, to assist in running, measuring, and marking the lines  
 corners and boundaries described in the foregoing field notes of the survey of the mining claim  
 of Aravaipa Mining Company, John F. Blandy Atty.  
 known as the Gordon, Mapwell, Glory, Arizona, Thanksgiving and David,  
 and showing the respective capacities in which they acted.

W. H. Moore, ..... , Chairman.  
Harry J. Frith, ..... , Chairman.  
 ..... , Axman.  
Alvan W. Howe, ..... , Flagman.

## FINAL OATHS OF ASSISTANTS.

We, W. H. Moore Harry J. Frith  
 and Alvan W. Howe, ..... , do solemnly swear that we assisted  
H. G. Howe, ..... , United States Deputy Mineral Surveyor, in marking the corners and  
 surveying the boundaries of the mining claim of .....  
Aravaipa Mining Company .....  
John F. Blandy Atty ..... , known as the Gordon  
Mapwell, Glory, Arizona, Thanksgiving and David represented  
 in the foregoing field notes as having been surveyed by said deputy mineral surveyor and under  
 his direction; and that said survey has been in all respects, to the best of our knowledge and  
 belief, faithfully and correctly executed, and the corner and boundary monuments established  
 according to law and the instructions furnished by the United States Surveyor-General for  
Arizona.

W. H. Moore, ..... , Chairman.  
Harry J. Frith, ..... , Chairman.  
 ..... , Axman .  
Alvan W. Howe, ..... , Flagman.

Subscribed and sworn to by the above-named persons before me  
 this 18<sup>th</sup> day of July, ..... , 1892.

H. G. Howe, .....  
 Notary Public.

(4-686.)

FINAL OATH OF U. S. DEPUTY MINERAL SURVEYOR.

I, H. G. Howe, U. S. Deputy Mineral Surveyor, do solemnly swear that, in pursuance of instructions received from the United States Surveyor General for Arizona, dated June 6<sup>th</sup>, 1892, I have, in strict conformity to the laws of the United States, the official regulations and instructions thereunder, and the instructions of said Surveyor General, faithfully and correctly executed the survey of the Mining Claim of Aravaipa Mining Company John F. Blandy Atty., known as the Gordon, Maxwell, Glory, Arizona, Thanksgiving and David, Lodes, situate in Aravaipa Mining Mining District, Graham County, Arizona, in Section \_\_\_\_\_, Township No. \_\_\_\_\_, Range No. \_\_\_\_\_, and designated as Survey No. 1038, as represented in the foregoing field notes, which accurately show the boundaries of said mining claim as distinctly marked by monuments on the ground, and described in the attached copy of the location certificate, which was received by me from the Surveyor General with said instructions, and that all the corners of said survey have been established and perpetuated in strict accordance with the law, official regulations and instructions thereunder; and I do further solemnly swear that the foregoing are the true and original field notes of said survey and my report therein, and that the labor expended and improvements made upon said mining claim by claimant or their grantors are as therein fully stated, and that the character, extent, location and itemized value thereof are specified therein with particularity and full detail, and that no portion of said labor or improvements so credited to this claim has been included in the estimate of expenditures upon any other claim.

H. G. Howe  
U. S. Deputy Mineral Surveyor.

Subscribed and sworn to by the said H. G. Howe  
U. S. Deputy Mineral Surveyor, before me James Reilly  
Notary Public this 17<sup>th</sup>  
day of August, 1892

James Reilly  
Notary Public



o 6-164

NOTICE OF LOCATION

Notice is hereby given that the undersigned in compliance with the requirements of the Mining Act of Congress approved May 10th, 1872, have this day located and claimed fifteen hundred linear feet along the course of this lead, lode or vein of mineral bearing quartz, and three hundred feet in width on each side of the middle of said lead, lode or vein. Situated in the Aravaipa Mining Dist. County of Graham Arizona, and more particularly described as follows to-wit:  
 Commencing at this mon. of stones being the center of the South-eastern end of the claim, and upon which this notice is posted, thence Northeasterly 300 feet to a mon. of stones, thence North-westerly 1500 feet to a mon. of stones, thence South-westerly 300 feet to a mon. of stones, being the center of the North-westerly end of claim, thence South-westerly, 300 feet to a mon. of stones, thence South-easterly 1500 feet to a mon. of stones, thence 300 feet to the place of beginning.

This claim is situated about six hundred yards Northwest of the Arizona Mine, about 3-4 of a mile South of Deer Creek and about eight miles North of Dunlap post office. It has latterly been known as the Silver Reef Mine and shall be known as the Gordon Mine.  
 Located Jan. 1st. 1889

John P. Han  
 Howard Dunlap  
 Burt Dunlap  
 Horace E. Dunlap

Recorded at request of Howard Dunlap Jan. 10th, 1889 at 9 o'clock A.M.  
 Eduardo Soto

Co. Recorder  
 By Ben. M. Crawford  
 Deputy

Territory of Arizona }  
 County of Graham } ss

I, H.J. Dowdle, County Recorder in and for the County of Graham Arizona do hereby certify that the above and foregoing is a true and correct copy of the Gordon Mine as appears on record in my office Recorded in Book(6) six Page eighteen (18) Record of Mines. Graham County Arizona.

In witness whereof I have hereunto set my hand and seal this the 7th, day of May A.D. 1892  
 H.J. Dowdle

County Recorder  
 Graham County Arizona Territory.

*80*  
*Records*  
*Recd*

NOTICE OF LOCATION

Notice is hereby given that the undersigned, in compliance with the requirements of the Mining Act of Congress approved May 10th, 1872 have this day located and claimed fifteen hundred linear ft. along the course of this lead, lode or vein of mineral bearing quartz and three hundred feet in width on each side of the middle of said lead, lode or vein, situate in the Aravaipa Mining District, County of Graham Arizona and more particularly described as follows to-wit: Commencing at this mon. of stones, being the center of the Southerly end of claim, and upon which this notice is posted, thence Northeast-erly 300 feet to a mon. of stones, thence North-westerly 1500 feet to a mon. of stones, thence South-westerly 300 feet to a mon. of stones, being the center of the Northwesterly end of claim, thence South-east-erly 300 feet to a mon. of stones, thence South-easterly 1500 feet to a mon. of stones, thence Northeasterly 300 feet to the place of begin-ning.

This claim is situated about six hundred yards North-west of the Arizona Mine, and runs parallel with the Gordon Mine, joining it on the North-east side,. It has lately been known as the Magnet Mine and shall be known as the Maxwell Mine.  
Located Jan. 1st. 1889.

John P. Han.  
Burt Dunlap  
Howard Dunlap  
Horace E. Dunlap

Recorded at request of Howard Dunlap Jan. 10th, 1889, at 9 o'clock A.M.

Eduardo Soto

Co. Recorder

By Ben.M.Crawford deputy.

Territory of Arizona }  
County of Graham } ss

I, H.J.Dowdle County Recorder in and for Graham County, Arizona do hereby certify that the above and foregoing is a full true and correct copy of the Maxwell Mine as appears of Record in my office in Book 6, Page 17 and 18 Records of Mines. In witness whereof I have hereunto set my hand and affixed my official seal at Solomonville Arizona, Territory on this 7th, day of May 1892

H.J.Dowdle  
Co. Recorder  
By Ben.W.Olney Deputy.

*Recorders Seal*



Notice is hereby given that the undersigned in compliance with the requirements of the Mining Act of Congress approved May 10th, 1872, have this day located and claim 1500 linear feet along the course of this lead, lode or vein of mineral bearing quartz and 300 feet in width on each side of the middle of said lead, lode or vein situate in the Aravaipa Mining District County of Graham Arizona, and more particularly described as follows to-wit:

Commencing at this monument of stones being the center of the Southern end of the claim and upon which this notice is posted, thence Easterly 300 feet to a monument of stones, thence Northerly 1500 feet to a monument of stones, thence Westerly 300 feet to a monument of stones, being the center of the Northerly end of claim, thence Westerly 300 feet to a monument of stones, thence Southerly 1500 feet to a monument of stones, thence Easterly 300 feet to the place of beginning.

This claim is situated about one mile North-west the Box Canon near the trail passing from Stowe Gulch to Deer Creek and is the first Northwesterly extension of the old Arizona Mine, and shall be known as the Glory Mine.

Located Jan. 1st, 1890 John P. Han. }  
Horace E. Dunlap } Locators

Witness  
Howard Dunlap }  
Thos. Horn. }

Recorder at 2 P.M. Jan. 6th, 1890 request of Howard Dunlap  
E. Soto

Co. Recorder  
By Fred M. Newell Deputy.

Territory of Arizona }  
County of Graham } ss

I, H.J. Dowdle, County Recorder in and for the County of Graham do hereby certify that the above and foregonig is a full true and correct copy of the Glory Mine as the same appears of Record in my office in Book 6, Page 274.

Witness my hand and seal, This the  
7th, day of May A.D. 1892.

H.J. Dowdle

County Recorder.

*Ricidas*  
*Seac*

LOCATION NOTICE

Notice is hereby given that the undersigned in compliance with the requirements of the Mining Act of Congress approved May 10th, 1872, has this day located and claim (1500 feet) Fifteen hundred linear feet along the course of this lead or lode or vein of mineral bearing quartz and (3) hundred feet in width on each side of the middle of said lead or lode or vein situate in the Aravaipa Mining District, County of Graham, Arizona and more particularly described as follows to-wit:

Commencing at this monument of stones being the South end of claim and upon which this notice is posted, thence East 300 feet to a monument of stones, thence North 1500 feet to a monument of stones, thence West 300 feet to a mon. of stones, being the center of North end of claim, thence West 300 feet to a mon. of stones, thence South 1500 feet to a mon. of stones, thence East 300 feet to place of beginning.

This claim is situated about one (1) mile North of Box Canon and and on the right of the old San Carlos trail and shall be known as the Arizona Mine.

Located Jan. 1st, 1889 W.C.Bridwell Locator.

Recorded at request of Burt Dunlap Jan. 4th, 1889 at 9 o'clock A.M.  
Eduardo Soto Recorder  
By Ben M.Crawford Deputy.

Territory of Arizona }  
County of Graham } ss

I, H.J. Dowdle, County Recorder in and for said County do hereby certify that the foregoing is a full true and correct copy of the Arizona Mine as the same appears on record of said County in Book (5) Five Record of Mines Page 472.  
In witness whereof I have hereunto set my hand and affixed my official seal at Solomonville Arizona Territory This 7th, day of May 1892.

H.J. Dowdle

County Recorder  
Graham County Arizona Territory



NOTICE OF LOCATION.

Notice is hereby given that the undersigned in compliance with the requirements of the Mining Act of Congress approved May 10th, 1872 has this day located and claim fifteen hundred linear feet along the course of this lead, lode or vein of mineral bearing quartz and three hundred feet in width on each side of the middle of said lead, lode or vein situate in the Aravaipa Mining District, County of Graham Arizona and more particularly described as follows to-wit :

Commencing at this monument of stones being the the center of the Southerly end of the claim and upon which this notice is posted thence Westerly three hundred feet to a monument of stones, thence North-erly fifteen hundred feet to a monument of stones, thence Easterly three hundred feet to a monument of stones, being t he center of the Northern end of claim, thence Easterly three hundred feet to a monu-ment of stones, thence Southerly fifteen hundred feet to a monuent of stones, thence Westerly three hundred feet to the plac eof beginnin- ing. This claim is situated upon the East side of the Arizona Mine and parallel to it, and shall be known as the Thanksgiving Mine. Located November 27th, 1890 John Heard Jr.

Witness  
N.P. McCallum

Recorded at request of C.M. Renard Dec. 11 1890 at 2 P.M.  
E. Soto

Recorder  
By Fred M. Newell Deputy

Territory of Arizona }  
County of Graham } SS

I, H.J. Dowdle, County Recorder in and for the County of Graham do hereby certify that the above and foregoing is a full true and correct copy of the Thanksgiving Mine as the same appears of Record in my office in Book 6, Page 417, Record of Mines. In witness whereof I ~~have~~ hereunto set my hand and affixed my official seal at Solomonville. This the 7th, day of May 1892.

H.J. Dowdle  
County Recorder

Records  
True

LOCATION NOTICE.

Notice is hereby given that the undersigned in compliance with the requirements of the Mining Act of Congress approved May 10th, 1872, has this day located and claim 1500 linear feet along the course of this leador lode or vein of mineral bearing quartz and 300 feet <sup>in width</sup> on each side of the middle of said lead or lode or vein situated in the Aravaipa Mining District County of Graham Arizona and more particularly described as follows to-wit:

Commencing at this monument of stones being the center of the North-west end of claim and upon which this notice is posted, thence North-east 300 feet to a monument of stones, thence South-east 1500 feet to a monument of stones, thence South-west 300 feet to a monument of stones, being the center of the South-east end of claim, thence South-west 300 feet to a monument of stones, thence North-west 1500 feet to a monument of stones, thence North-east 300 feet to place of beginning. This claim is situated about 1-2 mile from the Box Canon and is the South-east Extension of the Arizona Mine, and shall be known as the *David* Mine.

Located Sept. 5, 1890. Aravaipa Mining Co.

Witness  
A.L. Trippell }  
N.P. McCallum }

Recorded at request of C.M. Renard Nov. 3, 1890 at 3 P.M.

E. Soto  
Recorder  
By Fred M. Newell  
Deputy

Territory of Arizona }  
County of Graham } ss

I, H.J. Dowdle, County Recorder in and for the County of Graham do hereby certify that the above and foregoing is a full true and correct copy of the David Mine as the same appears of Record in my office in Book 6 Pages 405 & 406 Record of Mines.

In witness whereof I have hereunto set my hand and affixed my official seal at Solomonville This the 7th, day of May 1892

H.J. Dowdle  
County Recorder.



(4-687.)

# Surveyor General's Certificate of Approval of Field Notes and Survey of Mining Claim.

Department of the Interior,

Office of U. S. Surveyor General,

*Mesaon. Arizona*

*October 20<sup>th</sup>, 1892*

I, U. S. Surveyor General for

*District of Arizona*

do hereby certify that the foregoing and hereto attached Field Notes and Return of the

Survey of the Mining Claim of

*Arawaiipa Mining*

*Company, known as the "Gordon"*

*Maywell - "Glory" - "Arizona", known as the*

*"Thanksgiving" and "David" lodes*

situate in

*Arawaiipa*

mining district,

*Graham*

County,

*Arizona*

in Section \_\_\_\_\_, Township No. \_\_\_\_\_, Range No. \_\_\_\_\_

*and*, designated as Survey No. *1038*

executed by

*H. G. Howe*

U. S. Deputy Mineral

Surveyor,

*July 11<sup>th</sup> to 14<sup>th</sup>, 1892*

under my instructions dated

*June - 6<sup>th</sup>, 1892*

, 1892,

have been critically examined and the

necessary corrections and explanations made, and the said Field Notes and Return, and

the Survey they describe, are hereby approved. A true copy of the copy of the location

certificate filed by the applicant for survey is included in the field notes.

*Rapier & Jamison*

U. S. Surveyor General for

*Arizona*

o 6-162

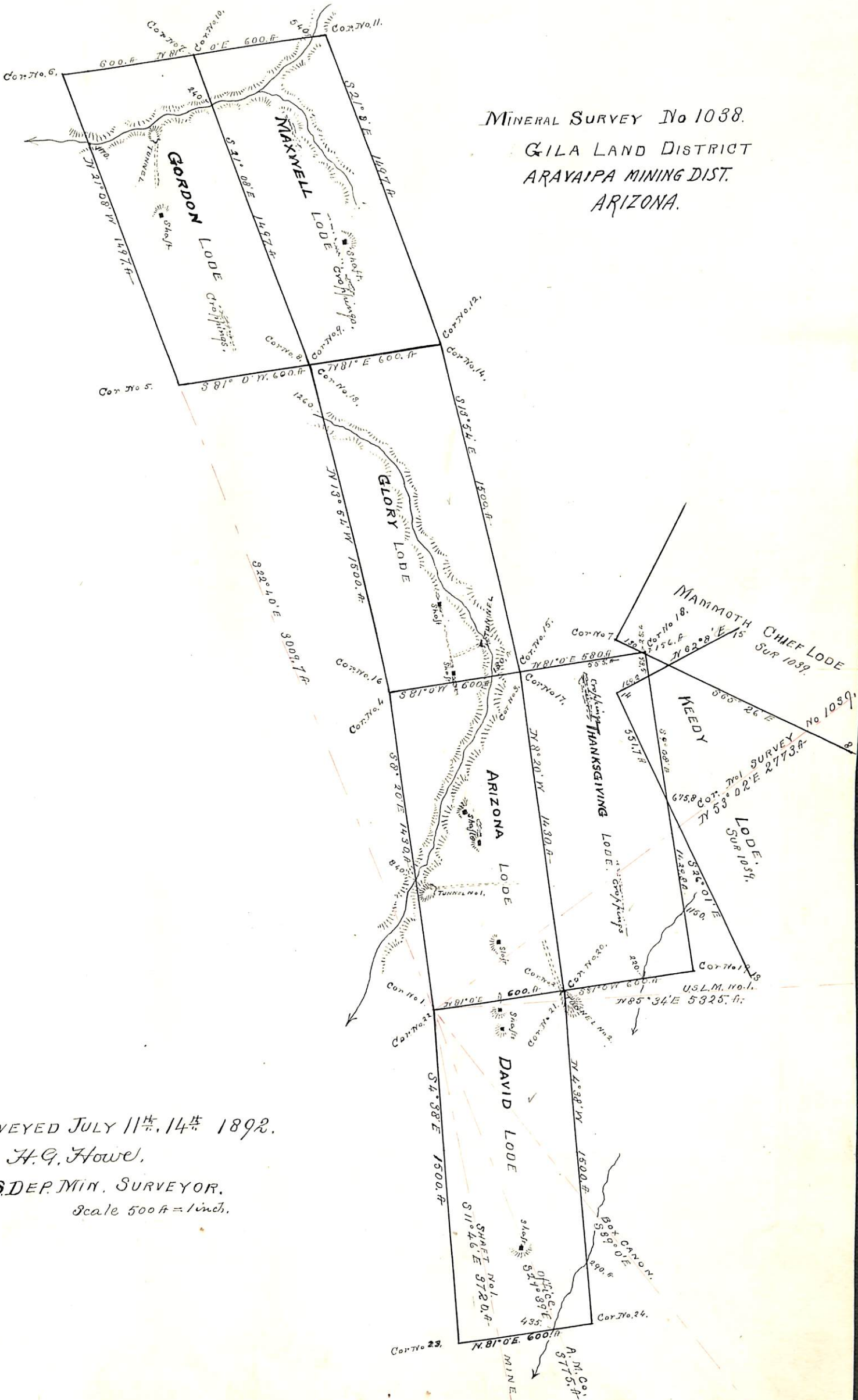

MINERAL SURVEY No 1038.  
 GILA LAND DISTRICT  
 ARAYAIPA MINING DIST.  
 ARIZONA.

SURVEYED JULY 11<sup>th</sup>, 14<sup>th</sup> 1892.  
 by H. G. Howe,  
 U.S. DEPT. MIN. SURVEYOR.  
 Scale 500 ft = 1 inch.