

**M  
S  
-**

**0**

**1**

**0**

**4**

**9**



(4-683.)

Mineral Survey No. 1049.

Lot No. \_\_\_\_\_

Gila, \_\_\_\_\_ Land District.

### FIELD NOTES

OF THE SURVEY OF THE MINING CLAIM OF

Copper Queen Con Mining Co.

Ben Williams Agent.

KNOWN AS THE

"Iron Monster"

Warren, \_\_\_\_\_ Mining District,

Cochise, \_\_\_\_\_ County, Arizona.

Section \_\_\_\_\_, Township \_\_\_\_\_, Range \_\_\_\_\_

Surveyed under instructions dated June 10<sup>th</sup>, 1892

by H. C. Howe,

U. S. Deputy Mineral Surveyor.

Claim located Oct 9<sup>th</sup>, 1892.

Survey commenced Sept 9<sup>th</sup>, 1892

Survey completed Oct 12<sup>th</sup>, 1892

o 6-160

Address of claimant.

Bisbee,

Cochise,

County,

Arizona.



# PRELIMINARY OATHS OF ASSISTANTS IN SURVEY OF MINING CLAIM.

WE, R. S. Hunt and T. J. Bailey,  
do solemnly swear that we will well and faithfully execute the duties of chain carriers;  
that we will level the chain upon even and uneven ground and plumb the tally-pins,  
either by sticking or dropping the same; that we will report the true distance to all  
notable objects, and the true length of all lines that we assist in measuring, to the best  
of our skill and ability, and in accordance with instructions given us, in the survey of  
the Mining Claim of Copper Queen Con Mining  
Co. Ben Williams Agent., known as the  
Iron Monster.  
situate in Warren, mining district,  
Cochise County, Arizona,  
in Section \_\_\_\_\_, Township No. \_\_\_\_\_, Range No. \_\_\_\_\_

R. S. Hunt, Chainman.  
T. J. Bailey, Chainman.

Subscribed and sworn to by the above-named persons before  
me this 9<sup>th</sup> day of Sept, 1892,

S. C. Perrin  
Notary Public

I, \_\_\_\_\_, do solemnly swear that I will well and  
truly perform the duties of axeman, in the establishment of corners and other duties,  
according to instructions given me and to the best of my skill and ability, in the survey  
of the Mining Claim of \_\_\_\_\_

known as the \_\_\_\_\_,  
more fully described in the preceding affidavit.

\_\_\_\_\_, Axeman.

Subscribed and sworn to by the said \_\_\_\_\_  
before me this \_\_\_\_\_ day of \_\_\_\_\_,  
\_\_\_\_\_, 18 \_\_\_\_\_.

I, \_\_\_\_\_, do solemnly swear that I will  
well and truly perform the duties of flagman, in the establishment of corners and other  
duties, according to instructions given me and to the best of my skill and ability, in the  
survey of the Mining Claim of \_\_\_\_\_

known as the \_\_\_\_\_,  
more fully described in the preceding affidavit.

\_\_\_\_\_, Flagman.

Subscribed and sworn to by the said \_\_\_\_\_  
before me this \_\_\_\_\_ day of \_\_\_\_\_,  
\_\_\_\_\_, 18 \_\_\_\_\_.



Survey No 1049.  
Iron Mounster.

Foot Beginning at cor No 1.  
Which is also a cor copper Jack lode  
A pine post 4 ft long 4 in sqr 6 in in  
ground in mound of stone marked  
westly face 1/1047 C.S. lode and eastly  
face 1/1049 I.M. lode  
From which U.S.L.M. No 1 bears S 17° 12' W.  
313 ft.

Thence S 24° 25' W.  
Var 11° 40' East

425. To cor No 2.  
Which point is also the S.E. cor copper  
Jack lode. Sur. No 1047  
A pine post 2 ft long 4 in sqr sunk in  
ground marked west face 9/1047 C.S.  
and east face 2/1049 I.M.

Thence S 75° 40' E  
Var 11° 40' East.

50. To cor No 3.  
Which point is also the N.E. cor  
General lode Survey No. 620.  
A pine post 2 ft long 4 in sqr sunk  
in ground marked 3/1049 I.M. lode

Thence N 24° 25' E  
Var 11° 40' East.

417.1 To cor No 4.  
Which point is also the N.W. cor  
Rucker lode Survey No. 614.  
A pine post 4 ft long 4 in sqr in  
mound of stones on west side of  
post marked R.M. No 2. Post marked  
4/1049 I.M. lode.

Thence N 66° 34' W  
Var 11° 40' East

49.2 To cor No 1 and place of beginning.



Area

Total area of claim .473 Acont

Location

This claim is located in the Warren Mining district Cochise County Arizona and is bounded upon the West by the Copper Jack South by the General and East by the Rucker lode survey No. 614.

Expenditure of Five Hundred Dollars.  
I certify that the value of the labor and improvements upon this claim placed thereon by the claimant and its grantors is not less than five hundred dollars, and that said improvements consist of

A Tunnel 7x10 ft 40 ft long face of bears from Cn No. 1. S 22° 40' W 320 ft.

Value of Tunnel \$ 800.00

A drift on 100 ft level 4x7 ft 90 ft long crosses side line at S 24° 45' W. 405 ft from Cn No. 1. (direction of drift N 49° 15' E)

Value of drift \$ 1350.00

Instrument

The survey was made with a Young & Sons Wrought Iron Transit No. 5555. With Smiths Solar Attachment

The courses were deflected from the true meridian as determined by solar observations

The distances were measured with a 100 ft steel tape.

A. G. Howe,

U. S. Deputy Mineral Surveyor,

Tombstone Dec. 23<sup>rd</sup> 92



# Affidavit of Five Hundred Dollars Improvements.

We, C. L. Beckwith and R. S. Hunt

of lawful age, being first duly sworn according to law, depose and say: that we are acquainted with the

Iron Monster mining claim, situated in

Warren Mining District, Cochise County,

Arizona Territory, for which Copper Queen Con. Mining Co.

by Ben Williams Agent.

has made application for survey prior to application for patent under the provisions of the Act of Congress, approved May 10, 1872; and that the labor done and improvements made thereon by the applicants and their grantors exceed Five Hundred Dollars in value, and further that we are not personally interested in said mine.

C. L. Beckwith

R. S. Hunt

TERRITORY OF ARIZONA,  
County of Cochise } ss.

SWORN to and subscribed before me, this 12<sup>th</sup> day

of October 1892

A. C. Penin

Notary Public





# FINAL OATHS FOR SURVEYS.

## LIST OF NAMES.

A list of the names of the individuals employed by A. G. Howel,  
 United States Deputy Mineral Surveyor, to assist in running, measuring, and marking the lines  
 corners and boundaries described in the foregoing field notes of the survey of the mining claim  
 of Copper Queen Con. Mining Co. Ben Williams Agent,  
 known as the Iron Monster,  
 and showing the respective capacities in which they acted.

R. S. Hunt, Chainman.  
F. J. Bailey, Chainman.  
 \_\_\_\_\_, Axman.  
 \_\_\_\_\_, Flagman.

## FINAL OATHS OF ASSISTANTS.

We, R. S. Hunt and F. J. Bailey  
 and \_\_\_\_\_, do solemnly swear that we assisted  
A. G. Howel, United States Deputy Mineral Surveyor, in marking the corners and  
 surveying the boundaries of the mining claim of Copper Queen Con.  
Mining Co. Ben Williams Agent,  
 known as the  
"Iron Monster", represented  
 in the foregoing field notes as having been surveyed by said deputy mineral surveyor and under  
 his direction; and that said survey has been in all respects, to the best of our knowledge and  
 belief, faithfully and correctly executed, and the corner and boundary monuments established  
 according to law and the instructions furnished by the United States Surveyor-General for  
Arizona.

R. S. Hunt, Chainman.  
F. J. Bailey, Chainman.  
 \_\_\_\_\_, Axman  
 \_\_\_\_\_, Flagman.

Subscribed and sworn to by the above-named persons before me  
 this 12<sup>th</sup> day of October, 1892

A. C. Ferris  
 Notary Public





(4-686.)

FINAL OATH OF U. S. DEPUTY MINERAL SURVEYOR.

I, H. G. Howe, U. S. Deputy Mineral Surveyor, do solemnly swear that, in pursuance of instructions received from the United States Surveyor General for Arizona, dated June 21st 1892, I have, in strict conformity to the laws of the United States, the official regulations and instructions thereunder, and the instructions of said Surveyor General, faithfully and correctly executed the survey of the Mining Claim of Copper Queen Con Mining Co. Ben Williams Agent., known as the Iron Monster, situate in Warren Mining District, Cochise County, Arizona, in Section \_\_\_\_\_, Township No. \_\_\_\_\_, Range No. \_\_\_\_\_, and designated as Survey No. 1049, as represented in the foregoing field notes, which accurately show the boundaries of said mining claim as distinctly marked by monuments on the ground, and described in the attached copy of the location certificate, which was received by me from the Surveyor General with said instructions, and that all the corners of said survey have been established and perpetuated in strict accordance with the law, official regulations and instructions thereunder; and I do further solemnly swear that the foregoing are the true and original field notes of said survey and my report therein, and that the labor expended and improvements made upon said mining claim by claimant or their grantors are as therein fully stated, and that the character, extent, location and itemized value thereof are specified therein with particularity and full detail, and that no portion of said labor or improvements so credited to this claim has been included in the estimate of expenditures upon any other claim.

H. G. Howe

U. S. Deputy Mineral Surveyor.

Subscribed and sworn to by the said H. G. Howe

U. S. Deputy Mineral Surveyor, before me S. C. Dennis

a Notary Public this 12<sup>th</sup>

day of October, 1892.

S. C. Dennis

Notary Public

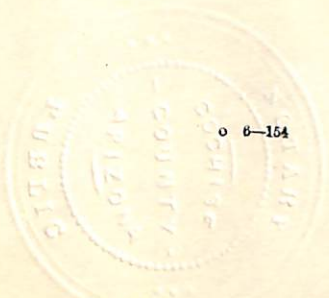

o 6-154



902

8

Location Notice.

Notice is hereby given that the undersigned in compliance with the requirements of the Mining Act of Congress approved May 10th, 1872, We have this day located and claim One hundred linear feet along the course of this lead, lode or vein of mineral bearing quartz and three hundred feet in width on each side of the middle of said lead, lode or vein situate in the Warren Mining District, County of Cochise, Arizona, and more particularly described as follows, to-wit,

Commencing at this monument of stones being the center of the westerly end of claim, and upon which this notice is posted, thence Northerly three hundred feet to a monument of stones, thence Easterly One hundred feet to a monument of stones, thence Southerly three hundred feet to a monument of stones, being the center of the Easterly end of claim, thence Southerly three hundred feet to a monument of stones, thence Northerly three hundred feet to the place of beginning .

This Claim is situated at the United States Mineral Monument No, 1, and is bounded on the West by the "Copper Queen, on the South by the Copper Czar, and on the East by the Rucker Mines, and occupies all the vacant ground between said mines, and the U.S.Min, Monument No,1, is situated upon it, and shall be known as the "Iron Monster" Mine .

Located Oct 9, 1882, Locators,  
West Howell,  
J.C.Tappeiner,

Filed and recorded at request of J.C.Tappeiner Nov, 23, 1882. at 9 A.M.

A.T.Jones,  
County Recorder.

TERRITORY OF ARIZONA. } S.S.  
County of Cochise.

I W.F.Bradley, County Recorder in and for the County of Cochise, do hereby certify that the above and foregoing is a full, true and correct copy of the Location Notice of the Iron Monster M.C. Warren Mining District, as appears of record now in my office in Book 5 Page 390 Record of Mines.

In witness whereof, I have hereunto set my hand and affixed my official seal, at my office, in Tombstone, this 9th, day of June A.D.1892.

W.F.Bradley,  
County Recorder.

Recorders  
Seal.



SURVEY. No. 1049.

GILA LAND DISTRICT

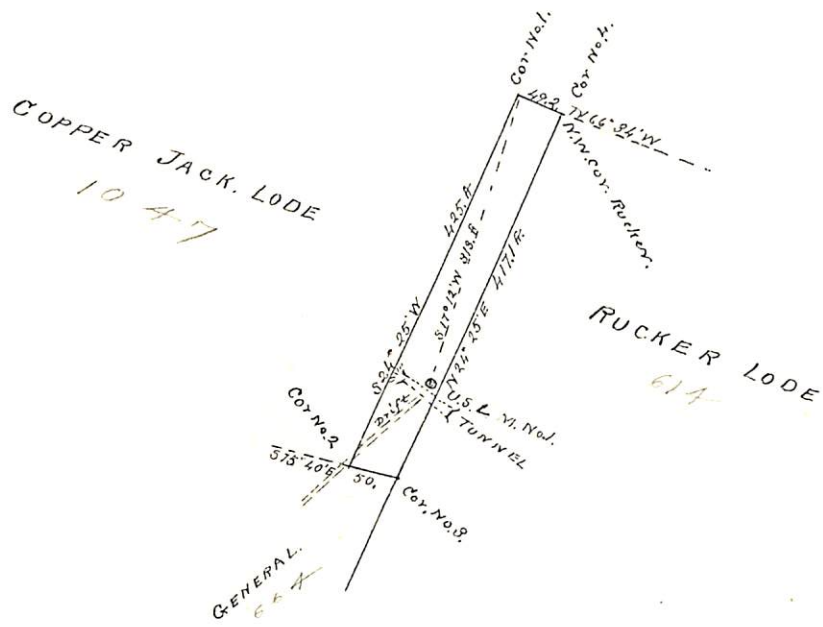

SURVEYED Sept 9th. Oct 12th / 92

by H. G. HOWE  
U.S. Dep. Min. Surveyor.



(4-687.)

# Surveyor General's Certificate of Approval of Field Notes and Survey of Mining Claim.

Department of the Interior,

Office of U. S. Surveyor General,

*Tucson, Arizona*  
*December 29, 1892*

I, U. S. Surveyor General for

*District of Arizona*

do hereby certify that the foregoing and hereto attached Field Notes and Return of the

Survey of the Mining Claim of

*Copper Queen*

*Consolidated Mining Company*

, known as the

*"Iron Monster"*

situate in

*Warren*

mining district,

*Coconino*

County,

*Arizona*

in Section

Township No.

Range No.

*and*

designated as Survey No.

*1049*

executed by

*H. G. Howe*

U. S. Deputy Mineral

Surveyor,

*Sept 9<sup>th</sup> to Oct 12<sup>th</sup>, 1892*

under my instructions dated

*June 10<sup>th</sup>, 1892*, have been critically examined and the necessary corrections and explanations made, and the said Field Notes and Return, and

the Survey they describe, are hereby approved. A true copy of the copy of the location

certificate filed by the applicant for survey is included in the field notes.

*Repaet Jamison*  
*Arizona*

U. S. Surveyor General for

o 6-102