

M
S
-

0

1

2

6

0

(4-683.)

Mineral Survey No. 1260 A & B

Lot No. _____

Prescott Land District.

FIELD NOTES

OF THE SURVEY OF THE MINING CLAIM OF

The Santa Maria Gold Company

KNOWN AS THE

Waters mine and millsite and Sunset mine

Cureka Mining District,

Yavapai County, Arizona

Section _____, Township 13 N, Range 9 W

Surveyed under instructions dated July 21, 1897,

by Ridgley C. Powers
U. S. Deputy Mineral Surveyor.

Claim located See below, 18 .

Survey commenced July 23d, 1897.

Survey completed July 30th, 1897.

o 6-160

Located

Waters mine, March 22/87. And June 19/97.
Waters millsite, April 12/90.
Sun Set mine, Oct. 21/89, And June 19/97.

Address of Claimants, Chauncey D. Clarke, Pres't.
Peoria Ariz.

PRELIMINARY OATHS OF ASSISTANTS IN SURVEY OF MINING CLAIM.

WE, James Bohem and John Ryan, do solemnly swear that we will well and faithfully execute the duties of chain carriers; that we will level the chain upon even and uneven ground and plumb the tally-pins, either by sticking or dropping the same; that we will report the true distance to all notable objects, and the true length of all lines that we assist in measuring, to the best of our skill and ability, and in accordance with instructions given us, in the survey of the Mining Claim of The Santa Maria Gold Co's, ~~mining~~ claims and mill site, known as the Waters Mine and Mill site and Sun Set Mine situate in Eureka mining district, Yavapai County, Arizona, in Section _____, Township No. _____, Range No. _____.

R. C. Powers

James Bohem, Chainman.
John Ryan, Chainman.

Subscribed and sworn to by the above-named persons before me this 23^d day of July, 1897

R. C. Powers

I, James Bohem, do solemnly swear that I will well and truly perform the duties of axeman, in the establishment of corners and other duties, according to instructions given me and to the best of my skill and ability, in the survey of the Mining Claim of the Santa Maria Gold Companies Mining Claims known as the Waters Mine & Mill site & Sun Set Mines more fully described in the preceding affidavit.

R. C. Powers

James Bohem, Axeman.

Subscribed and sworn to by the said James Bohem before me this 23^d day of July, 1897

R. C. Powers

I, John Ryan, do solemnly swear that I will well and truly perform the duties of flagman, in the establishment of corners and other duties, according to instructions given me and to the best of my skill and ability, in the survey of the Mining Claim of the Santa Maria Gold Companies Mining Claims known as the Waters Mine and Mill site & Sun Set Mine more fully described in the preceding affidavit.

R. C. Powers

John Ryan, Flagman.

Subscribed and sworn to by the said John Ryan before me this 23^d day of July, 1897

R. C. Powers

Notary Public
 My Commission expires Dec. 31st 1900

SURVEY NO. 1260 A.

WATERS LODE.

Beginning at Corner No. 1. Identical with Cor. No. 1 of the location (amended).

A rock in place, 4 x 5 x 7 feet above the general surface, chiseled with a cross (+) at corner point, and 1-1260 A., Whence,

The initial location monument and the discovery tunnel bear N. 3° 50' E., 590 feet.

U. S. L. M. No. 1260 A & B, bears N. 25° 35' E., 984 feet.

No other bearing objects available.

Thence S. 56° 30' E.
Var. 14° 54' E.

60. Left bank of Santa Maria Creek, course Northwesterly; Thence in bed of creek.

345. To Corner No. 2. Identical with corner of the location.

A granite boulder 20 x 12 x 8 inches, set 14 ins. in the ground, chiseled 2-1260 A.

As this point is in the Santa Maria Creek bed, I established a witness corner to this point, N. 64° 30' E., 144 feet distant, as follows:

A Massive rock in place, 10 x 12 x 10 feet above the general surface, chiseled W. C. 2-1260 A. This corner is situated on a bluff at the north bank of the Santa Maria Creek.

No other bearing objects available.

Thence North 3° 50' East, from true cor. point.
Var. 14° 54' E.

In the bed of Santa Maria Creek.

272. Leave steep right bank of Santa Maria Creek, course Northwesterly, and ascend steep ridge.

375. Cross tramway track, bears N.W. and S.E.

750. Center of east side line. Identical with monument of location.

Feet.

2.

A granite boulder 24 x 18 x 10 inches, set 14 inches in the ground, chiseled E. Cr. 1260 A., with mound of stone, 3 ft. high alongside.

1200. Top of ridge bears N.W. and S.Easterly.

1236. To Cor. No. 3.

A granite boulder 20 x 15 x 8 inches, set 14 inches in the ground, chiseled 3-1260 A., with mound of stone alongside.

No bearing objects available.

Thence N. $63^{\circ}10'$ E.
Var. $14^{\circ}54'$ E.

Descending gentle slope.

264. To cor. No. 4, and bottom of slope.

A brown granite boulder 5 x 6 x 6 feet, above ground, chiseled 4-1260 A.

Whence, brown granite boulder 4 x 6 x 7 feet bears N. $72^{\circ}15'$ W., 53 ft., chiseled B.R. 4-1260 A.

Thence N. $56^{\circ}30'$ W.
Var. $14^{\circ}54'$ E.

345. To Cor. No. 5. N. Center end of claim.

A granite stone in place, 16 x 12 x 8 inches above the ground, chiseled 5-1260 A.

Whence, a granite rock in place, 24 x 20 x 18 inches bears N. 82° W., 30 feet, chiseled B.R. 5-1260 A.

Thence N. $56^{\circ}30'$ W.
Var. $14^{\circ}54'$ E.

Ascending gently.

345. To Cor. No. 6. N.W. cor. of location.

A granite rock 18 x 12 x 9 ins., set 12 inches in the ground chiseled 6-1260 A.

Whence, a granite boulder in place, 6 x 5 x 5 feet high, bears S. $10^{\circ}30'$ E., 58 feet, chiseled B.R. 6-1260 A.

A shaft 6 x 8 x 40 feet deep, on the Santa Maria Mining claim (unsurveyed) bears N. $22^{\circ}40'$ W., 278 ft.

Thence S. $63^{\circ}10'$ W.
Var. $14^{\circ}54'$ E.

Feet.

3.

264. To cor. No. 7.

A massive granite boulder 10 x 12 x 14 feet,
above the ground, chiseled cross (+) at cor. point,
and 7-1260 A.

No bearings available.

Thence S. $3^{\circ}50'W$.

Var. $14^{\circ}54'E$.

486. Center of the west side line.

A granite boulder 24 x 12 x 8 inches, set 14
inches in the ground, chiseled W.Cr.^S, 1260 A. and
mound of stones alongside.

No bearings available.

934. North bank of Santa Maria Creek, course northwester-
ly.1190. South bank of Santa Maria Creek, course Northwest-
ly.

1236. To cor. No. 8.

A malpais rock in place, 15 x 15 x 11 inches
above ground, chiseled 8-1260 A., with mound of
stone alongside.

Whence, a granite boulder $4\frac{1}{2} \times 4 \times 4$ feet
above the ground bears N. $33^{\circ}W$., 47 feet distant,
chiseled B.R. 8-1260 A.

Thence S. $56^{\circ}30'E$.

Var. $14^{\circ}54'E$.

Along south bank of Santa Maria Creek.

345. To cor. No. 1, and place of beginning, survey of
exterior boundaries.

SUN SET LODE.

1260 A.

Beginning at cor. No. 1, being the south end center
of the claim, and identical with corner No. 1 of
the amended location, at the base of a steep hillside.

Feet.

4.

A granite boulder 20 x 10 x 8 inches, set 12 inches in the ground, chiseled (+) at corner point, and 1-1260 A., with mound of stone alongside.

Whence, the initial monument of location, and the discovery tunnel bears N. $3^{\circ}50'E.$, 15 feet dist.

Tramway track bears N. $70^{\circ}E.$, 58 feet.

A massive granite wall, 20 feet high, bears S. $35^{\circ}E.$, 78 feet, chiseled B.R. 1-1260 A.

U. S. L. M. No. 1260, bears N. $6^{\circ}55'W.$, 1277 feet.

Thence S. $56^{\circ}30'E.$,

Var. $14^{\circ}54'E.$

Ascending.

72. Cross tramway track, bears N.W. & S.E.

169. Cor. No. 1 of Waters millsite, of this survey.

345. To cor. No. 2.

A granite rock in place, 20 x 20 x 18 inches above the ground, chiseled 2-1260 A.,

Whence, massive granite wall 50 feet high, bears N. $85^{\circ}E.$, 27 feet dist., chiseled B.R. 2-1260 A.

Thence N. $3^{\circ}50'E.$

Var. $14^{\circ}54'E.$

Ascending a rocky hill.

750. Center of east side line.

A granite rock 24 x 20 x 10 inches, set 14 inches in the ground, chiseled E.Cr.S, 1260 A. , with mound of stone alongside.

No bearings available.

1236. To cor. No. 3.

A granite rock in place, 3 x 3 x 1 1/2 ft. above the ground, chiseled (+) at corner point, and 3-1260 A., with mound of stone alongside, on top of rock.

No bearing objects available.

Feet.

5.

Thence N. $63^{\circ} 10' E$.Var. $14^{\circ} 54' E$.

Descending gentle slope.

264. To cor. No. 4.

A granite stone in place, 18 x 15 x 12 inches above the ground, chiseled 4-1260 A.

Whence, a massive granite boulder 10 x 10 x 12 ft. high, bears N. $58^{\circ} E$., 100 ft. dist., chiseled B.R. 4-1260 A.

Thence N. $56^{\circ} 30' W$.Var. $14^{\circ} 54' E$.

Ascending.

345. To cor. No. 5, being North Center end of claim.

A granite rock 20 x 15 x 12 ins., set 12 ins. in the ground, chiseled 5-1260 A.

No bearings available.

Thence N. $56^{\circ} 30' W$.Var. $14^{\circ} 54' E$.

Ascending.

345. To cor. No. 6. Identical with cor. No. 4 of the Waters lode, of this survey.

A brown granite boulder 5 x 6 x 6 feet above the ground, chiseled 6-1260 A.

Whence, a brown granite boulder 4 x 6 x 7 ft. above the ground, bears N. $72^{\circ} 15' W$., 53 ft. distant, chiseled B.R. 6-1260 A.

Thence S. $63^{\circ} 10' W$.Var. $14^{\circ} 54' E$.

264. To cor. No. 7. Identical with cor. No. 3 of the Waters lode of this survey.

A granite boulder 20 x 15 x 8 ins., set 14 inches in the ground, chiseled 7-1260 A., with mound of stone alongside.

No bearings available.

Thence S. $3^{\circ} 50' W$.

Feet.

6.

Var. $14^{\circ}54'E$.

Descending rocky hill.

486. Center of west side line. Identical with the center of the east side line of the Waters lode of this survey.

A granite boulder 24 x 18 x 10 ins., set 14 inches in the ground, chiseled W.C. 8-1260 A., with mound of stone 3 ft. high, alongside.

No bearings available.

861. Cross tramway track, bears N.W. and S.E.
964. North bank of Santa Maria Creek, course Northwesterly. *Thence in bed of creek.*

1236. To cor. No. 8, in bed of Santa Maria Creek. Identical with cor. No. 2 of the Waters lode of this survey.

A granite boulder 20 x 12 x 8 inches, set 14 inches in the ground, chiseled 8-1260 A.

As this point is in the bed of the Santa Maria Creek, and liable to destruction, I establish a Witness Corner N. $64^{\circ}30'E$., 144 ft. distant.

A massive rock in place 10 x 12 x 10 ft. above the general surface, chiseled W.C. 8-1260A.

This corner is situated on a bluff at the north bank of the Santa Maria Creek.

No bearings available.

Thence S. $56^{\circ}30'E$.

Var. $14^{\circ}54'E$.

(From true corner point). *In bed of creek.*

226. Right bank of the Santa Maria Creek, course Northwesterly.

345. To cor. No. 1, the place of beginning, survey of exterior boundaries.

Feet.

7.

Waters Millsite.

Survey No. 1260 B.

Beginning at Cor. No. 1. Identical with the N.E. corner of the location.

A granite boulder 15 x 13 x 10 inches, set 10 inches in the ground, chiseled 1-1260 B.

Whence, a granite rock in place, 8 x 8 x 5 feet above the general surface bears N. 89°E. . 15.5 ft. distant, chiseled B.R. 1-1260 B.

Cor. No. 1, of the Waters lode, bears N. 56°30' W., 859 feet.

U. S. L. M. No. 1260 bears N. 12°00'W., 1387 feet distant.

Cor. No. 1 of the Sun Set lode of this survey bears N. 56°30'W., 169 feet.

The point where the tramway enters the 20-stamp mill, bears S. 10°8'W., 207 feet distant.

Thence S. 62°30'W.

Var. 14°54'E.

52. Cross tramway, bears northwesterly and southweſly. Down steep rocky slope.
210. Bottom of slope.
410. Enter Santa Maria Creek, course Northerly.
- 466.5 To cor. No. 2, Identical with S.W. cor. of location.

A granite rock 20 x 18 x 12 ins., set 13 ins. in the ground, chiseled 2-1260 B.

As this cor. is in creek bed, I establish a witness corner N. 72°E., 34 ft. distant, on granite bluff 10 ft. high, chiseled W.C. 2-1260 B.

No bearings available.

Thence S. 24°30'E. From true cor. point. *in bed of creek.*

Var. 14°54'E.

75. Leave Santa Maria Creek, course Northerly.

Feet.

8.

400. Re-enter creek (dry wash), course northwesterly.

466.5 To cor. No. 3.

A granite rock 16 x 12 x 12 ins. set 12 ins. in the ground, chiseled 3-1260 B.

As this corner is in creek bed ^{+ liable to destruction} I establish a witness corner on granite bluff 18 feet high, N. 43° 3' E., 265 ft. distant, chiseled W.C. 3-1260 B. ^{+ mound of stone alongside}

A granite bluff on S. bank of Santa Maria Creek bears S. 40° W., 250 ft. distant,

Thence N. 62° 30' E. from true cor. point.

Var. 14° 54' E.

110. Leave creek bed, and ascend rocky slope.

466.5 To cor. No. 4.

A granite rock in place, 5 x 5 x 4 ft. above the ground, chiseled 4-1260 B. and (+) at exact cor. point, with mound of stone alongside.

Whence N.E. cor. of boarding house brs. S. 66° 30' W., 132 ft. dist.

Ware room brs. N. 60° W., 200 ft. distant.

Thence N. 24° 30' W.

Var. 14° 54' E.

466.5 Up grade to place of beginning, corner No. 1, survey of exterior boundaries.

The survey of the Waters and Sun Set lodes, and the Waters millsite is identical with their respective locations, as monumented on the ground,

AREA.

Total and net area of Waters lode, - - -	20.64 acres.
Total and net area of Sun Set lode, - -	20.64 "
Total and net area of Waters millsite, -	5.00 "
Total and net area of claim, - - - - -	46.28 "

9.

LOCATION.

This claim is located in Eureka Mining District, Yavapai County, Arizona, on unsurveyed land, approximately in T. 13 N., R. 9 W., G. & S.R.B. & Meridian. The nearest town is Prescott, Yavapai County, Ariz. about 45 miles east. Adjoining claims are as follows:- Dannie on the North; Sunrise on the east; Waters South Extension on the south, and Rule on the West, (of the lode claims,) owned by the claimants herein, all unsurveyed.

 EXPENDITURE OF FIVE HUNDRED DOLLARS.

I certify that the value of the labor and improvements upon this claim, placed thereon by the claimant and its grantors, is not less than five hundred dollars, and that said improvements consist of-

On Waters lode.

No. 1. Discovery tunnel, the mouth of which bears from cor. No. 1, N. 3°50' E., 590 feet, 5 x 6 ft. running N. 40° E., 50 feet.

Value. \$300.00

No. 2. Tunnel, 5 x 6 ft., 517 feet long, running N. 56° E., bears from cor. No. 1, N. 24° 50' E., 400 feet.

Value, on Sun Set, -- \$1962.00
Value, on Waters, -- \$1140.00

No. 3. Tunnel, 5 x 6 ft., 100 ft. long, running N. 40° E., the mouth of which bears N. 16° 30' E., 450 feet from cor. No. 1. Value. \$600.00

No. 4. Tunnel 5 x 6 ft. 70 feet long, running N. 40° E., the mouth of which bears N. 8° 35' E., 500 feet from cor. No. 1.

Value. \$420.00

10.

No. 5. Tunnel, 5 x 6 ft. 40 ft. long, running N. 5° E., the mouth of which bears N. 2° E., 625 ft. from Cor. No. 1.

Value. \$240.00

On SUN SET lode.

No. 1. Discovery tunnel, 5 x 6 ft., 20 feet long running N. 20° E., the mouth of which bears N. 3° 50' E., 15 feet from Cor. No. 1.

Value. \$120.00

No. 2. Tunnel, 5 x 6 ft. 40 ft. long, running N. 20° E., the mouth of which bears N. 84° E., 130 feet from cor. No. 8.

Value. \$240.00

Note. See No. 2 tunnel on Waters for \$1962

The tunnels described above are so constructed as to systematically develop the claims of this survey, ~~and to develop the claims of this~~

Other improvements.

A 20-stamp mill, complete, the entrance to which bears from Cor. No. 1 of Waters millsite, S. 10° 8' W., 207 feet.

Value. \$10,000

A tramway track from tunnel No. 2, of the Waters lode to the mill, about 1100 feet long.

Value. \$1200.00

A boarding house, the N.E. ~~Cor~~ bears from cor. No. 4 of the Waters millsite, S. 66° 30' W., 132 feet.

Value. \$300.00

A store room, of which the S.E. corner bears from Cor. No. 4 of the Waters millsite, N. 60° W., 200 ft.

Value. \$150.00

11.

Instrument.

This survey was made with a Gurley Light Mountain transit, with solar attachment. The courses were deflected from the true meridian as determined by direct solar observations. The distances were measured with a 100 foot steel tape.

R. L. Powell

Prescott, A.T., U. S. Deputy Mineral Surveyor.

Sept 13th 1897.

U. S. Location Monument No. 1260.

Established July 30, 1897.

There being no corner of the public survey and no U. S. Location Monuments within the prescribed limits of two miles, from Mineral Survey No. 1260 A & B., Waters and Sun Set mining claim, and the Waters mill-site, I proceed to establish a U. S. L. M. as follows:

On the summit of a high hill rising abruptly from the North bank of Santa Maria Creek, - about 900 feet south of the monument, - I set a pine post, 8 ft. long, 6 ins. square, 3 ft. in the ground, and build around it a conical mound of stone, 3 ¹/₂ ft. high, and 6 ft. base. The letters U. S. L. M. No. 1260 are plainly chiseled in the post, and at the exact point for connection a tack is driven in the post to indicate the point. Whence,

A granite mass, 10 x 10 x 15 feet, above the ground, bears N. 46°15'W., 775 feet distant, chiseled with a cross + at connection point, and U. S. L. M. No. 1260 B.R.

A granite mass 6 x 6 x 10 feet above the ground, chiseled with a cross + at connection point and U. S. L. M. No. 1260 B.R. bears S. 20°E., 25 ft. dist.

The mouth of No. 2 tunnel on the Waters lode bears S. 26°10'W., 580 feet,

Cor. No. 1 of the Waters lode bears S. 24°50'W., 984 feet.

The point where the tramway enters the mill on the Waters mill-site bears S, 8°50'E., 1540 feet.

The junction of Black Canyon and Santa Maria creek bears S. 85°E., about 3/4 of a mile distant.

Negro Ben Peak bears N. 61°21'W., about 2 1/2 miles distant.

Court House Rock bears S. 62°30'E., 1 3/4 miles dist.

Page 2. (U.S.L.M.NO. 1260).

Table Mountain bears S. 1°E., 1/2 mile distant.

Tres Niños bears S. 39° 30' W., about 3/4 of a mile distant.

The U. S. L. M. No. 1260 is located in Eureka Mining District, Yavapai County, Arizona, approximately in T. 13 N., R. 9 W. (unsurveyed), and the nearest town is Prescott, Yavapai County, Arizona, about 45 miles east of it.

R. L. Powers

Prescott. A.T., U. S. Deputy Mineral Surveyor,

September, 13th, 1897.

Missing

Page

FINAL OATHS FOR SURVEYS.

LIST OF NAMES.

A list of the names of the individuals employed by R. C. Powers

United States Deputy Mineral Surveyor, to assist in running, measuring, and marking the lines corners and boundaries described in the foregoing field notes of the survey of the mining claim of The Santa Maria Gold Co. known as the Waters mine & Mill site and Sun Set mine and showing the respective capacities in which they acted.

- James Bohan, Chainman.
- John Ryan, Chainman.
- James Bohan, Axman.
- John Ryan, Flagman.

FINAL OATHS OF ASSISTANTS.

We, James Bohan and John Ryan and R. C. Powers, do solemnly swear that we assisted R. C. Powers, United States Deputy Mineral Surveyor, in marking the corners and surveying the boundaries of the mining claim of The Santa Maria Gold Company, known as the Waters Mine and Mill site and Sun Set mine, represented in the foregoing field notes as having been surveyed by said deputy mineral surveyor and under his direction; and that said survey has been in all respects, to the best of our knowledge and belief, faithfully and correctly executed, and the corner and boundary monuments established according to law and the instructions furnished by the United States Surveyor-General for same

- James Bohan, Chainman.
- John Ryan, Chainman.
- James Bohan, Axman.
- John Ryan, Flagman.

R. C. Powers

Subscribed and sworn to by the above-named persons before me this 30th day of July, 1897

R. C. Powers
Notary Public

My Commission Expires Dec. 31st 1900

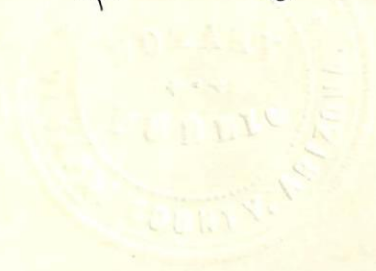

(4-686.)

FINAL OATH OF U. S. DEPUTY MINERAL SURVEYOR.

I, R. L. Powers, U. S. Deputy Mineral Surveyor, do solemnly swear that, in pursuance of instructions received from the United States Surveyor General for The District of Arizona, dated July 21st, 1897, I have, in strict conformity to the laws of the United States, the official regulations and instructions thereunder, and the instructions of said Surveyor General, faithfully and correctly executed the survey of the Mining Claim of The Santa Maria Gold Co., known as the Water mine and mill site and the Sun set mine situate in The Eureka Mining District, Yavapai County, in Section _____, Township No. 13 N, Range No. 9 W, Unsurveyed and designated as Survey No. 126 A + B, as represented in the foregoing field notes, which accurately show the boundaries of said mining claim as distinctly marked by monuments on the ground, and described in the attached copy of the location certificate, which was received by me from the Surveyor General with said instructions, and that all the corners of said survey have been established and perpetuated in strict accordance with the law, official regulations and instructions thereunder; and I do further solemnly swear that the foregoing are the true and original field notes of said survey and my report therein, and that the labor expended and improvements made upon said mining claim by claimant or their grantors are as therein fully stated, and that the character, extent, location and itemized value thereof are specified therein with particularity and full detail, and that no portion of said labor or improvements so credited to this claim has been included in the estimate of expenditures upon any other claim.

R. L. Powers
U. S. Deputy Mineral Surveyor.

Subscribed and sworn to by the said R. L. Powers
U. S. Deputy Mineral Surveyor, before me J. M. R. Moon a
Notary Public this 17th
day of August, 1897.

J. M. R. Moon
Notary Public

My commission expires Dec 21 1898

o 6-164

Affidavit of Five Hundred Dollars Improvements.

We James Bohan and John Ryan
of lawful age, being first duly sworn according to law, depose and say: that we are acquainted
with the Hobbs mine & mill site and Linn Sec 1 mining claim, & situated in
Big Buy Mining district, Yavapai County,
Arizona Territory, for which The Santa Maria Gold Co

has made application for survey prior to application for patent under the provisions of the
Act of Congress, approved May 10, 1872; and that the labor done and improvements made thereon
by the applicant and their grantor exceed Five Hundred Dollars in value, and further
that we are not personally interested in said mine.

James Bohan
John Ryan

TERRITORY OF ARIZONA,

County of Yavapai } ss.

SWORN to and subscribed before me, this

30th day of July 1897

R. C. Powers
Notary Public
my Commission expires Dec 31, 1900.



NON-MINERAL AFFIDAVIT.

TERRITORY OF ARIZONA,

County of Yavapai } ss.

James Bohem and John Ryan of said County and Territory, being first duly sworn, each for himself and not one for the other, deposes and says; that he is well acquainted with the land of the

Waters mill-site claim, situated in The Cureka Minny District, Gila and Salt River Meridian, in the County of Yavapai and Territory of Arizona, claimed by The Santa Maria Gold Co

applicant for United States patent therefor; that he is well acquainted with the character of said described land included within the boundary lines as officially surveyed by R. C. Poppers United States Deputy Mineral Surveyor, having frequently passed over the same; that his knowledge of such land is such as to enable him to testify understandingly with regard thereto; that there is not to his knowledge, within the limits thereof, any vein or lode of quartz or other rock in place bearing gold, silver, cinnabar, lead, tin or copper, or any deposit of coal; that there is not within the limits of said land, within his knowledge, any placer, cement, gravel or other valuable mineral deposit; that no portion of said land is claimed under the local customs or rules of miners or otherwise; that no portion of said land is worked for minerals during any part of the year by any person or persons; that said land is essentially non-mineral land, and that there is within the boundaries of said claim improvements, to-wit:

A 20 Stamp gold mill complete - A Boarding and bunk house and a ware-room

and that he has no interest whatever in said described mill-site claim.

James Bohem
John Ryan

Subscribed and Sworn to before me this 30th day

of July A. D. 1897, and I hereby certify that

the foregoing affidavit was read to the said James

Bohem and John Ryan

previous to their names being subscribed thereto, and that

deponents are reputable persons to whose affidavits full faith

and credit should be given.

R. C. Poppers

Notary Public.

My Commission Expires Dec 31st 1890

R. C. Poppers

WATERS.

NOTICE OF LOCATION.

KNOW ALL MEN BY THESE PRESENTS: That we the undersigned have this day located Fifteen Hundred (1500) linear feet of this vein or lode bearing precious metals, with all dips, spurs, angles and variations with surface ground Three Hundred (300) feet on each side of the center of vein, with all Mineral Deposits contained therein, and all Timber growing within the limits of said claim, and all Water and Water Privileges thereon or appurtenant thereto, under and according to the provisions of the Mining Laws of the United States under which it is located.

This claim commences at this monument and notice placed upon the ledge, and runs 1000) one thousand feet in a Northerly direction (500) Five Hundred feet Southerly direction along the ledge.

The Exterior boundaries are as follows, viz:-500 feet from this Notice center Southerly end Commencing at this monument and and running Three Hundred (300) feet in an Easterly direction to monument at S.E. corner of claim; thence in a Northerly direction parallel with the ledge Fifteen Hundred (1500) feet to monument at N.E. corner of claim; thence in a Westerly direction at right angles across the ledge Six Hundred (600) feet to monument at N.W. corner of claim; thence parallel with the lode in a Southerly direction Fifteen Hundred (1500) feet to a monument at S.W. corner of claim; thence at right angles across the ledge in an Easterly direction Three Hundred (300) feet to monument upon the ledge and place of beginning, thence (1500) feet Northerly where this notice is posted.

This ledge may be more generally described as situated 11 miles down the Santa Maria from the mine known as the Hays Mine about 2 miles below the Mexican Ranch on the Santa Maria Creek in Eureka Mining District, Yavapai County, Arizona Territory, and shall be known as the Waters Mining Claim. Dated on the ground, this 22nd., day of March, 1887.

H. A. Owen.

T. C. BOWE.

J. M. Owen.

Recorded at Request of T.C.Bowe, April 2nd A.D.1887, at 9.0'clock
A.M. in Book 23 of Mining Records, Pages 537-538, Records of Yavapai
County Arizona.

E.J.F. Horne,
County Recorder.

.....

TERRITORY OF ARIZONA,)
)
COUNTY OF YAVAPAI.)SS.

I, W.I.JOHNSON, County Recorder in and for
said County and Territory, and Custodian of the Records thereof, do
hereby certify that I have compared the above and foregoing with,
and the same is a full, true and correct copy of the Location Notice
of the Waters Mining claim as the same appears on the Records in
Book 23 of Mines, Pages 537-538, Records of Yavapai County, Arizona.
IN WITNESS WHEREOF, I have hereunto set my hand and affixed my offi-
cial seal this, the Fifth day of June A.D.1897.

.....
W.I. Johnson
.....
County Recorder.

POOR QUALITY

The following pages are scanned at the best possible quality setting. The original pages are of poor quality and this is the best possible reproduction.

KNOW ALL MEN BY THESE PRESENTS: That the undersigned, the Santa Maria Gold Company, in compliance with the mining Acts of Congress, approved May 10th., 1872, and all subsequent Acts, and with the laws of the Territory of Arizona, particularly an Act of the Legislative Assembly of the Territory of Arizona, approved March 20th., 1895, with regard to the location of mining claims and the amending thereof, has this 19th day of June, 1897, amended, located and claimed, and by these presents does amend, locate and claim by right of discovery and amended location, Fifteen Hundred (1500) linear feet, horizontal measurement, on the Waters lead, lode, ledge, vein or deposit, along the course thereof, and 300 feet in width of surface ground on either side of the center of said vein or deposit, together with all dips, angles, spurs and variations, and all leads, lodes, ledges, veins or deposits within the exterior limits of said claim. The Discovery Tunnel being situated upon said vein, lead, lode, ledge or deposit, within the boundaries of said claim, the boundaries being more particularly described as follows:

Beginning at Cor. No. 1, the same being the center end monument of the South end of said claim, whence the Discovery Tunnel bears N. 3° 50' E., 500 feet dist; thence S. 53°, 30' E., 356 feet to Cor. No. 2, S. E. Cor., a monument of stone three feet high. Thence N. 3°, 50' E., 750 feet to center of E. side line, a monument of stone three feet

high. Thence N. $3^{\circ} 50'$ E., 480 feet to Corner No. 3, a monument of stone three feet high. Thence N. 60° E.,

204 feet to Cor. No. 4, the N. E. Corner, a monument of stone
Thence N. $54^{\circ} 30'$ W. 356 feet to Cor. No. 5 - the Center end monument of the N. end, a monument of stone 3 feet high
 three feet high. Thence N. $56^{\circ} 30'$ W., 220 feet to Corner

No. 6, the N. W. Corner, a monument of stone three feet

high. Thence S. 60° W., 264 feet to Corner No. 7, a

monument of stone three feet high. Thence S. $3^{\circ} 50'$ W.,

480 feet to a monument of stone three feet high, at the

center of the West side line. Thence E. $3^{\circ} 50'$ W., 750

feet to Corner No. 8, the S. W. Corner, a monument of stone

three feet high. Thence S. $56^{\circ} 30'$ E., 356 feet to the

place of beginning. This being the same lode as was

originally located by T. C. Bove, H. A. Owen and J. W.

Owen, on the 22nd day of March, 1887, and recorded in Book

28, pages 527-528, Mining Records of Yavapai County,

Arizona, and described as situated in Eureka Mining District,

Yavapai County, Arizona, on Santa Maria Creek, eleven

miles down the Santa Maria from the Hayes' Mine, and about

two miles below the Mexican Ranch on the Santa Maria.

This further and additional amended certificate of loca-
 tion being made without waiver of any previously acquired

rights by said original locators, but for the purpose of

correcting any errors in the original location, and for the

further purpose of giving the undersigned all the benefits

secured under and by virtue of the said Act of the Legisla-

tive Assembly of the Territory of Arizona, approved the

20th day of March, 1895.

Date of original location March 22nd., 1887.

Date of this amended location notice, June 19th., 1897.

Santa Maria Gold Co.
 By Chauncy D. Clark,
 President.

NOTICE OF LOCATION.

KNOW ALL MEN BY THESE PRESENTS: That the undersigned, have this day located Fifteen Hundred (1500) linear feet of this vein or lode, bearing precious metals, with all dips, spurs, angles and variations, with surface ground Three hundred (300) feet on each side of the center of vein, with all mineral deposits contained therein, and all timber growing within the limits of said claim and all water and water privileges thereon or appurtenant thereto, under and according to the provisions of the Mining Laws of the United States, under which it is located.

This claim commences at this monument and notice placed upon the ledge and runs Fifteen Hundred (1500) feet in a Northerly direction along the ledge.

The exterior boundaries are as follows, viz:- Commencing at this monument and notice, and running Three Hundred (300) feet in an easterly direction to monument at S.E. corner of claim; thence in a Northerly direction parallel with the ledge Fifteen Hundred (1500) feet to monument at N.E. corner of claim; thence in a Westerly direction at right angles across the ledge Six Hundred (600) feet to monument at N.W. corner of claim; thence parallel with the lode in a Southerly direction Fifteen Hundred (1500) feet to a monument at S.W. corner of claim; thence at right angles across the ledge in an Easterly direction Three Hundred (300) feet to Monument upon the ledge and place of beginning.

This ledge may be more generally described as situated ^{on the} Santa Maria Creek and runs parallel with the Waters Mine the north half of this claim adjoins the Waters on the west side and is between the Sunrise and the Waters in Eureka Mining District, Yavapai County, Arizona Territory, and shall be known as the Sun Set Mining Claim.

Dated on the ground, this 21 day of October 1889.

Locator

T.C. Bowe.

Filed and recorded at the request of T.C. Bowe, Oct., 25th A.D. 1889, at 20 mins. past 9 o'clock A.M. in Book 28 of Mines, pages 178 and 179, Records of Yavapai County, Arizona.

By

(L.S.)

Charles H. Akers,

J.M. Aitken, Deputy.

County Recorder.

.....

TERRITORY OF ARIZONA,
COUNTY OF YAVAPAI. ISS.

I, W.I. Johnson, County Recorder in and

for said county and territory, and Custodian of the records thereof do hereby certify that I have compared the above and foregoing with, and the same is a full, true and correct copy of the Location notice of the Sun Set Mining Claim as the same appears on the records in Book 28 of Mines, pages 178 & 179 Records of Yavapai County, Arizona.

IN WITNESS WHEREOF, I have hereunto set my hand and affixed my official seal this, the 22nd day of July A.D. 1897.

W.I. Johnson
County Recorder.

NOTICE OF AMENDED LOCATION CERTIFICATE OF THE SUN SET
MINING CLAIM.

KNOW ALL MEN BY THESE PRESENTS: That the undersigned, the Santa Maria Gold Company, in compliance with the mining Acts of Congress, approved May 10th, 1872, and all subsequent Acts, and with the laws of the Territory of Arizona, particularly an Act of the Legislative Assembly of the Territory of Arizona, approved March 30th, 1895, with regard to the location of mining claims and the amending thereof, has this 19th day of June, 1907, amended located and claimed, and by these presents does amend, locate and claim by right of discovery and amended location, Fifteen Hundred (1500) linear feet, horizontal measurement, on the Sun Set lode, lode, ledge, vein or deposit, along the course thereof, and 200 feet in width of surface ground on either side of the center of said vein or deposit, together with all dips, angles, spurs and variations, and all leads, lodes, ledges, veins or deposits within the exterior limits of said claim. The Discovery Tunnel being situated upon said vein, lead, lode, ledge or deposit, within the boundaries of said claim, the boundaries being more particularly described as follows:

Beginning at Cor. No. 1, the same being the center and monument of the South end of said claim, whence the Discovery Tunnel, ^{brs} N. 3° 50' E. 15 ft. dist; thence S. 56° 30' E., 356 feet to Cor. No. 2, S.E. Cor., a monument of stone three feet high. Thence N, 3° 50' E., 750 feet to center of E. side line, a monument of stone 3 feet high. Thence N. 3° 50' ~~W~~ E., 486 feet to Corner No. 3, a monument

~~monument~~ of stone 3 feet high. Thence N. 60° E., 364 feet
 to Cor. No. 4, the N. E. Corner a monument of stone 3 feet
 high. Thence N. $56^{\circ} 30'$ W. 356 feet to Cor. No. 5, a
 monument of stone three feet high, the same being the center
 end monument of the North end. Thence [^] $56^{\circ} 30'$ W. 356
 feet to Cor. No. 6, the N. W. Corner, a monument of stone
 three feet high. Thence S. 60° W. 364 feet to Corner No. 7,
 a monument of stone three feet high. Thence S. $3^{\circ} 50'$
 W., 488 feet to a monument of stone three feet high, at the
 center of the West side line. Thence S. $3^{\circ} 50'$ W., 750 feet
 to Corner No. 8, the S. W. Cor., a monument of stone three
 feet high. Thence S. $56^{\circ} 30'$ E., 356 feet to the place of
 beginning. This being the same lode as was originally
 located ^{by} T. C. Bowen on the 21st day of October, 1889, and
 recorded in Book 28, page 178, Mining Records of Yavapai
 County, Arizona, and described as situated in Gureka Mining
 District, Yavapai County, Arizona, on Santa Maria Creek, ad-
 joining the Waters Mine.

This further and additional amended certificate of lo-
 cation being made without waiver of any previously acquired
 rights by said original locators, but for the purpose of
 correcting any errors in the original location, and for the
 further purpose of giving the undersigned all the benefits
 secured under and by virtue of the said Act of the Legisla-
 tive Assembly of the Territory of Arizona, approved the
 20th day of March, 1895.

Date of original location October 21st., 1889.

Date of this amended location notice June 19th, 1897.

Santa Maria Gold Co.
 By Chauncy D. Clark,
 President.

Notice of Amended
Location Certificate
of the Sun Set Mining
Claim

Situated in the Eureka
Mining District Yavapai
County Arizona

Dated June 19th, 1897.

Witness

RECORDED AT REQUEST OF

R. C. Powers

July 14th A. D., 1897.
At 4⁰⁶ o'clock P. M.

In Book 48, Mines

Pages 80 to 82

Records of Yavapai County, Arizona.

W. D. Johnson

County Recorder

By E. B. Arroyo Deputy.

Notice of Amended Location
Certificate of the Waters
Mining Claim.

Situated in the Eureka
Mining Dist. Yavapai Co
Arizona

Dated June 19th, 1897.

RECORDED AT REQUEST OF

R. C. Parsons

July 16th A. D., 1897

At 11¹⁶ o'clock P. M.

In Book 48th minus

Pages 82 to 84

Records of Yavapai County, Arizona.

M. D. Johnson

By C. B. Fry

WATERS.

LOCATION NOTICE.



Of the Waters Mill-Site Claim and Water Right.

KNOW ALL MEN BY THESE PRESENTS: That we the undersigned have this day located a Mill-Site for the purpose of erecting suitable works for reducing the ores of the Waters Mining Claim, together with six other mining claims known and called the Waters Group of Mining Claims, situated in Eureka Mining District, Yavapa county, Arizona territory. The Exterior boundaries of said Waters Mill-Site Claim are as follows, viz:-

Commencing at a monument of stone at N.E. corner of claim, and running thence in a Westeely diriction 466 1/2 feet to monument of stone at N.W. corner of clai m, thence in a Southerly direction 466 1/2 feet to a monument of stone at S.W. corner of claim , thence in a Easterly direction 466 1/2 feet to monument of stone at S.E. corner of claim thence in a Northerly direction 466 1/2 feet to monument of stone at N.E. corner of claim, and place of beginning.

This location may be more generally described as being situated on Santa Maria Creek about two miles below a ranch known as the Mexican ranch about 3/4 mile West of the "Howell Group" of Mines & about One thousand feet South of the Waters Mine in Yavapai County Arizona. That we have also located in connection with said Mill-site Claim Fifty (50) inches miners' measure of the water of this Santa Maria Creek, under and in accordance with the laws of the Territory of Arizona regulating the location and possession of water rights, said water to be taken from the Creek about one mile above & East & to be conveyed to the mill by pipe line , the water to be stored in the reservoir at the point where it ist taken from the Creek.

Dated on the ground this, 12th., day of April, 1890.

Witness:

.....

T.C. Bowe.

D.C. Thorne.

(4-687.)

Surveyor General's Certificate of Approval of Field Notes and Survey of Mining Claim.

Department of the Interior,

Office of U. S. Surveyor General,

Tucson, Arizona,

November 5th, 1897.

I, U. S. Surveyor General for *District of Arizona*,

do hereby certify that the foregoing and hereto attached Field Notes and Return of the Survey of the Mining Claim of *The Santa Maria Gold Company*,

known as the *Waters Mine and Millsite and Gun Jet Mine*

situate in *Eureka* mining district,

Yavapai County, *Arizona*,

in Section _____, Township No. _____, Range No. *unsurveyed*

designated as Survey No. *1260 A and B*

executed by *J. J. Fisher*, U. S. Deputy Mineral

Surveyor, *July 23-30*, 1897, under my instructions dated

July 21st, 1897, have been critically examined and the

necessary corrections and explanations made, and the said Field Notes and Return, and

the Survey they describe, are hereby approved. A true copy of the copy of the location

certificates filed by the applicant for survey is included in the field notes.

George Christ

U. S. Surveyor General for *Arizona*

Large

map

Drawing

Large

map

Drawing

Large

map

Drawing

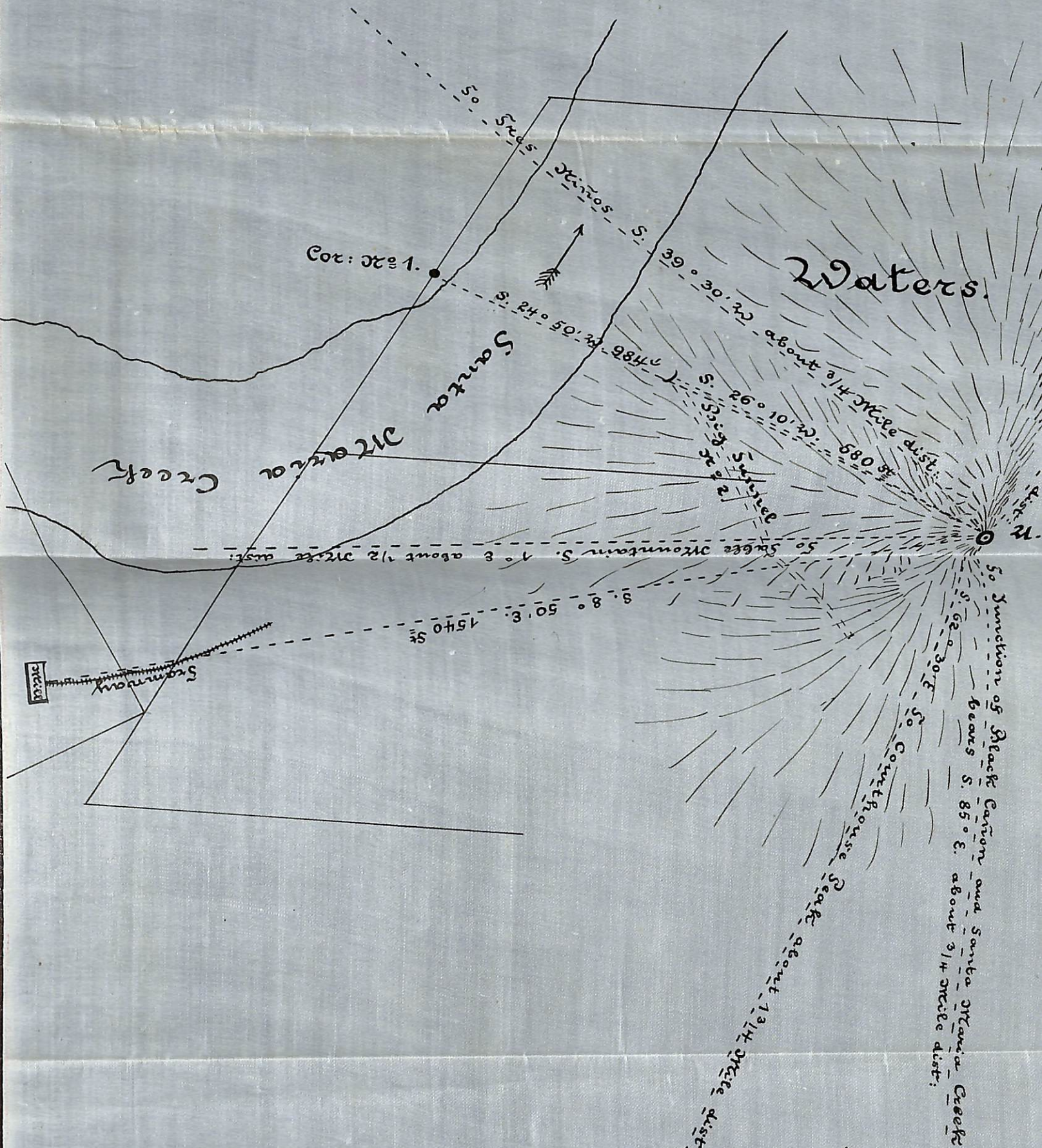

Waters.

Santa Myraia Creek

Cor: No 1.

Steamway

50 Junction of Black Canyon and Santa Myraia Creek
 bears S. 85° E. about 3/4 mile dist.

50 Count House Peak about 1 1/4 mile dist.

Myraia
 showing the location

of the
 21. S. & N. No 120
 Prescott Sand Si

R. E. So

21. S. Dep: No

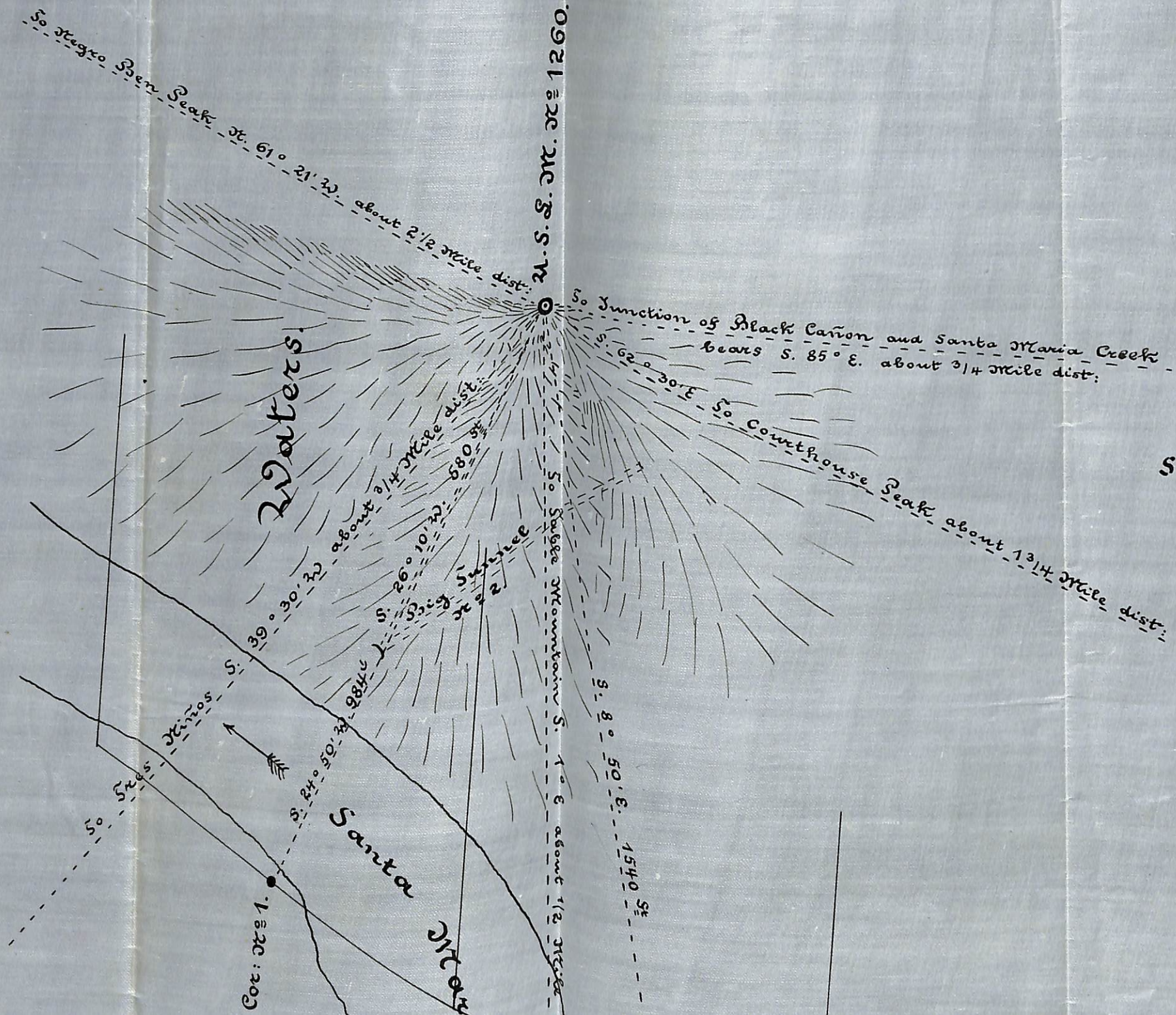

Map
 showing the location
 of the
 U.S.L.M. No. 1260
 Prescott Land Dist.

R. C. Power

U.S. Dep: Min.