

MS -

0  
1  
2  
8  
0



(4-683.)

Mineral Survey No. 1280

Lot No. \_\_\_\_\_

Gila Land District.

### FIELD NOTES

OF THE SURVEY OF THE MINING CLAIM OF

August Baron.

KNOWN AS THE

State of Texas Lode.

in Huachuca Mountains Mining District,

Cochise County, Arizona.

Section \_\_\_\_\_, Township 24S, Range 20E

Surveyed under instructions dated Dec 11<sup>th</sup> 1897 & Feb 14<sup>th</sup> 1898,

by Henry G Howe,  
U. S. Deputy Mineral Surveyor.

Claim located	<u>January 1<sup>st</sup></u>	1887.
Recorded	<u>January 22<sup>nd</sup></u>	1887.
Survey commenced	<u>Dec 14<sup>th</sup></u>	1897.
Survey completed	<u>Feb 17<sup>th</sup></u>	1898.

<sup>o 6-160</sup>  
Address.

August Baron.  
Tombstone,  
Cochise County  
Arizona.

*Form 2 to 01 sub 18/98*



# PRELIMINARY OATHS OF ASSISTANTS IN SURVEY OF MINING CLAIM.

WE, I John W. Reany and \_\_\_\_\_ do solemnly swear that we will well and faithfully execute the duties of chain carriers; that I will level the chain upon even and uneven ground and plumb the tally-pins, either by sticking or dropping the same; that I will report the true distance to all notable objects, and the true length of all lines that I assist in measuring, to the best of ~~our~~<sup>my</sup> skill and ability, and in accordance with instructions given ~~us~~<sup>me</sup>, in the survey of the Mining Claim of August Baron;

\_\_\_\_\_, known as the State of Texas,  
situate in Huachuca Mountains mining district,  
Cochise County, Arizona,  
in Section \_\_\_\_\_, Township No. \_\_\_\_\_, Range No. \_\_\_\_\_.

John W. Reany, Chainman.  
\_\_\_\_\_, Chainman.

Subscribed and sworn to by the above-named persons before me the 14<sup>th</sup> day of December, 1897.

A. G. Howe  
Notary Public  
Commission Expires July 13<sup>th</sup> 1901.

I, \_\_\_\_\_, do solemnly swear that I will well and truly perform the duties of axeman, in the establishment of corners and other duties, according to instructions given me and to the best of my skill and ability, in the survey of the Mining Claim of \_\_\_\_\_

known as the \_\_\_\_\_,  
more fully described in the preceding affidavit.

\_\_\_\_\_, Axeman.

Subscribed and sworn to by the said \_\_\_\_\_  
before me this \_\_\_\_\_ day of \_\_\_\_\_,  
18 \_\_\_\_\_.

I, \_\_\_\_\_, do solemnly swear that I will well and truly perform the duties of flagman, in the establishment of corners and other duties, according to instructions given me and to the best of my skill and ability, in the survey of the Mining Claim of \_\_\_\_\_

known as the \_\_\_\_\_,  
more fully described in the preceding affidavit.

\_\_\_\_\_, Flagman.

Subscribed and sworn to by the said \_\_\_\_\_  
before me this \_\_\_\_\_ day of \_\_\_\_\_,  
18 \_\_\_\_\_.



# Survey No 1280

Feet.

## State of Texas Lode.

Beginning at Cor. No. 1.

A Pine Post 5ft. long 4 ins sqr 12 ins in ground surrounded by mound of stone. Scribed 1-1280. S. of T. From which.

U.S. L.M. No. 1274. bears  $N 31^{\circ} 18' W$  6706. ft. No bearings available.

Thence  $N 8^{\circ} 10' E$

Var  $12^{\circ} 20' E$

300. Old location mon. of stone.

600. To Cor. No. 2.

A pine post 5ft. long 4 ins sqr. 12 ins in ground surrounded by mound of stone. Scribed 2-1280. S of T.

No bearings available.

Thence  $S 81^{\circ} 37' E$

Var  $12^{\circ} 20' E$

1500. To Cor. No. 3.

an oak post  $4\frac{1}{2}$  ft. long 4 ins sqr. 12 inches in ground surrounded by mound of stone Scribed 3-1280 S. of T.

No bearings available.

Thence  $S 8^{\circ} 10' W$

Var  $12^{\circ} 20' E$

300. Old location mon. of stone.

600. To Cor. No. 4.

A Pine Post. 5ft. long. 4 ins sqr. 16 ins in ground surrounded by a mound of stone Scribed 4-1280. S. of T.

No bearings available.

Thence  $N 81^{\circ} 37' W$ .

Var  $12^{\circ} 20' E$

1500. To Cor. No. 1. The place of beginning.

The Survey of the State of Texas Lode is identical with the location:

Area.

Total Area State of Texas Lode 20.66 Acres.



### Location.

This claim is located near the South Easterly end of the Huachuca Mountains, near the head of Montezuma Canon about five hundred yards north from the Spring in said canon. There are no adjoining mining claims. This claim The State of Texas lode or deposit being upon unsurveyed ground, and would be in T. 24. S. R. 21. E. of G<sup>nd</sup> and S. R. <sup>By Cochise Co, Arizona</sup> Mer. when the Surveys are extended. The nearest Township subdivided being T. 24. S. R. 25. E. The nearest Township that the lines have been run, being T. 20. S. R. 22. E of G<sup>nd</sup> and S. R. <sup>By</sup> Mer. The nearest organized Mining District being Hartford Mining District, located at the head of Ramsey's Canon just south of Huachuca Military Reservation and about ten miles distant in a north westerly direction.

Expenditure of five hundred dollars. I certify that the value of the labor and improvements upon this claim placed thereon by the claimant and ~~their~~<sup>his</sup> grantors, is not less than five hundred dollars, and that said improvements consist of, Shaft No. 1. sunk upon lode <sup>which</sup> extends 20 ft. S 82° 0' E and N 82° 0' W 15 ft. Shaft the mouth of bears N 76° 15' E 76 ft. from Cor. No. 1 and is 4 x 6 ft. 15 ft. deep.

value \$ 100.00

Shaft No. 2. sunk upon ledge <sup>which</sup> extends east 20 ft. and west 25 ft. bold outcrop mouth of Shaft. bears N 44° 0' E 380. ft. from Cor. No. 1. and is 4 x 6 ft. over 50 ft. deep

Value \$ 500.00



Incline Shaft No. 3. sunk upon Ore  
body. Extends easterly forty feet. mouth of  
incline shaft No. 3. bears  $N 59^{\circ} E$  253. ft from  
cor. No. 1. is 4 X 7 ft. course of incline  $N 9^{\circ} E$   
and 85 ft. deep. incline dips  $45^{\circ}$  and is  
sunk upon Ore

Value, \$900.00



Instrument,

This Survey was made with a Young & Sons  
Light mountain transit with solar attach-  
-ment. The courses were deflected from  
the true meridian as determined by  
direct solar observations.

The distances were measured with a  
100. ft Steel tape.

Bisbee February 19<sup>th</sup>/98

Bisbee March 14<sup>th</sup>/98

Henry G. Howe  
U.S. Deputy Mineral Surveyor



# FINAL OATHS FOR SURVEYS.

## LIST OF NAMES.

A list of the names of the individuals employed by Henry G. Howe  
 United States Deputy Mineral Surveyor, to assist in running, measuring, and marking the lines  
 corners and boundaries described in the foregoing field notes of the survey of the mining claim  
 of August Baron.  
 known as the State of Texas Lode Claim.  
 and showing the respective capacities in which they acted.

John W. Reamy, Chairman.  
 \_\_\_\_\_, Chairman.  
 \_\_\_\_\_, Axman.  
 \_\_\_\_\_, Flagman.

## FINAL OATHS OF ASSISTANTS.

We, I John W. Reamy  
 and \_\_\_\_\_, do solemnly swear that I assisted Henry  
G. Howe, United States Deputy Mineral Surveyor, in marking the corners and  
 surveying the boundaries of the mining claim of August Baron.

\_\_\_\_\_, known as the \_\_\_\_\_  
State of Texas Lode Claim, represented  
 in the foregoing field notes as having been surveyed by said deputy mineral surveyor and under  
 his direction; and that said survey has been in all respects, to the best of ~~our~~<sup>my</sup> knowledge and  
 belief, faithfully and correctly executed, and the corner and boundary monuments established  
 according to law and the instructions furnished by the United States Surveyor-General for  
Arizona.

John W. Reamy, Chairman.  
 \_\_\_\_\_, Chairman.  
 \_\_\_\_\_, Axman.  
 \_\_\_\_\_, Flagman.

Subscribed and sworn to by the above-named persons before me  
 this 17<sup>th</sup> day of February, 1898.

H. G. Howe  
 Notary Public  
 Commission Expires July 13<sup>th</sup> 1901.





(4-686.)

FINAL OATH OF U. S. DEPUTY MINERAL SURVEYOR.

I, Henry G Howe, U. S. Deputy Mineral Surveyor, do solemnly swear that, in pursuance of instructions received from the United States Surveyor General for Arizona, dated Dec 11<sup>th</sup> 97<sup>and</sup> Feb 14<sup>th</sup>, 1898, I have, in strict conformity to the laws of the United States, the official regulations and instructions thereunder, and the instructions of said Surveyor General, faithfully and correctly executed the survey of the Mining Claim of August Baron, known as the State of Texas Lode, situate in Huachuca Mountains Mining District, Cochise County, Arizona, in Section \_\_\_\_\_, Township No. \_\_\_\_\_, Range No. \_\_\_\_\_, and designated as Survey No. 1280, as represented in the foregoing field notes, which accurately show the boundaries of said mining claim as distinctly marked by monuments on the ground, and described in the attached copy of the location certificate, which was received by me from the Surveyor General with said instructions, and that all the corners of said survey have been established and perpetuated in strict accordance with the law, official regulations and instructions thereunder; and I do further solemnly swear that the foregoing are the true and original field notes of said survey and my report therein, and that the labor expended and improvements made upon said mining claim by claimant or his grantors are as therein fully stated, and that the character, extent, location and itemized value thereof are specified therein with particularity and full detail, and that no portion of said labor or improvements so credited to this claim has been included in the estimate of expenditures upon any other claim.

Henry G Howe  
U. S. Deputy Mineral Surveyor.

Subscribed and sworn to by the said Henry G Howe,  
U. S. Deputy Mineral Surveyor, before me S. C. Perwin  
a Notary Public this 19<sup>th</sup>  
day of February, 1898.

S. C. Perwin  
Notary Public

my Commission expires  
Oct 18<sup>th</sup> 1900

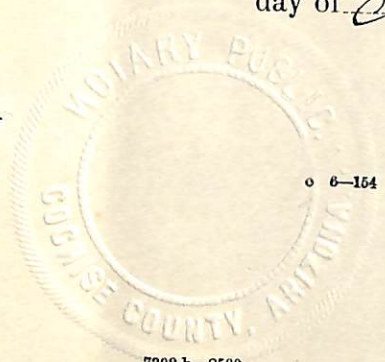



# Affidavit of Five Hundred Dollars Improvements.

We August Zellar and John W. Reamy

of lawful age, being first duly sworn according to law, depose and say: that we are acquainted with the State of Texas mining claim, situated in The Huachuca Mountains Mining district, Cochise County, Arizona Territory, for which August Barons

has made application for survey prior to application for patent under the provisions of the Act of Congress, approved May 10, 1872; and that the labor done and improvements made thereon by the applicant and his grantors exceed Five Hundred Dollars in value, and further that we are not personally interested in said mine.

August Zellar  
John W. Reamy

TERRITORY OF ARIZONA,  
County of Cochise } ss.



SWORN to and subscribed before me, this  
18<sup>th</sup> day of February 1898

H.C. Howe  
Notary Public.  
Commission Expires July 13<sup>th</sup> 1901.



## Location Notice.

Notice Is Hereby Given, that - the undersigned, in compliance with the requirements of the Mining Act of Congress, approved May 10<sup>th</sup> 1872, have this day located and claim 1500 hundred linear feet - along the course of this lead, lode or vein of mineral bearing quartz, and 300 feet in width on each side of the middle of said lead, lode or vein, situated in the Huachuca Mountains County of Cochise Arizona, and more particularly described as follows, to-wit:

Commencing at this monument of stones, being the center of the westerly end of claim, and upon which this notice is posted, thence Northerly 300 feet to a monument of stones; thence Easterly 1500 feet to a monument of stones; thence Southerly 300 feet to a monument of stones; being the center of the Easterly end of claim; thence Southerly 300 feet to a monument of stones; thence Westerly 1500 feet to a monument of stones; thence Northerly 300 feet to the place of beginning.

This Claim is situated in the Huachuca Mountains in what is known as Montezuma Canon about 500 yards north from the spring in said canon is bounded on the north by the General Harrison Mine and was formerly known as the "Chicago Mine" there was no work done on this claim for the year 1888 and shall be known as the State of Texas Mine. Located January 1<sup>st</sup> 1889

Witness

Adam Snyderhans

Richard C. Van Dorn



Filed and recorded at request of Richard S.  
Van Dorn January 2<sup>nd</sup> A.D. 1889 at 1 P.M.

W.F. Bradley

County Recorder.

Territory of Arizona }  
County of Cochise } ss.

I, M. J. Brown, County Recorder in and  
for the County of Cochise, Territory of  
Arizona, do hereby certify that the above  
and foregoing instrument is a full, true  
and correct copy of the Location Notice of  
the "State of Texas" mine, as appears of  
record in Book, 11, Record of Mines, page  
584, of the Records of Cochise County, now  
in my office.

Given under my hand and Official  
Seal, this 9<sup>th</sup> day of December A.D. 1897.

M. J. Brown  
County Recorder.



SURVEY No 1280.

OF THE

STATE OF TEXAS LODE

HUACHUCA MOUNTAINS

COCHISE COUNTY ARIZ.

Scale 400ft = 1 inch

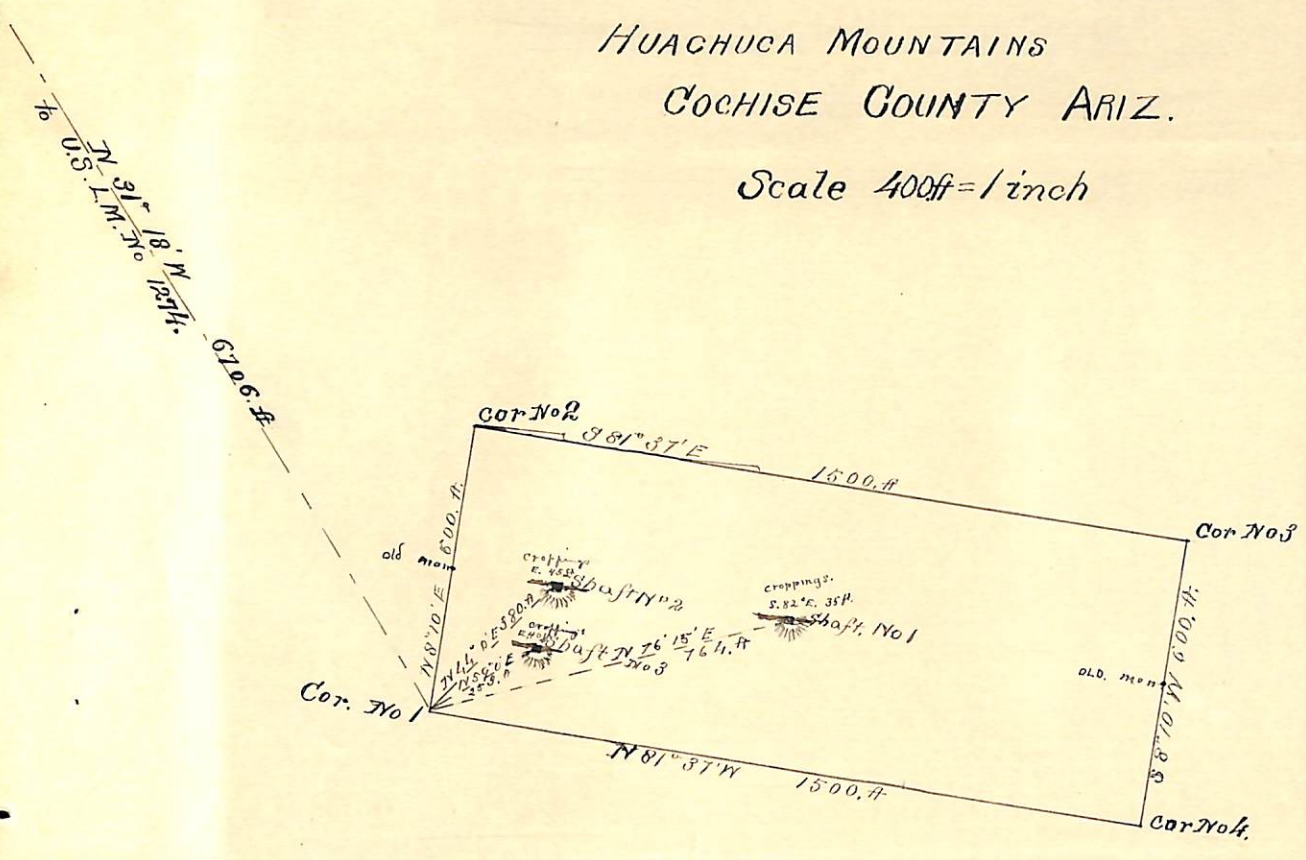



(4-687.)

# Surveyor General's Certificate of Approval of Field Notes and Survey of Mining Claim.

Department of the Interior,

Office of U. S. Surveyor General,

*Tucson, Arizona,*

*April 4<sup>th</sup>*, 1898.

I, U. S. Surveyor General for *District of Arizona*,  
do hereby certify that the foregoing and hereto attached Field Notes and Return of the  
Survey of the Mining Claim of *August Baron*,

\_\_\_\_\_ , known as the

*State of Texas lode*  
situate in *Huachuca mountains* ~~mining district~~,

*Cochise* County, *Arizona*,

in Section \_\_\_\_\_, Township No. \_\_\_\_\_, Range No. \_\_\_\_\_

\_\_\_\_\_, designated as Survey No. *1280*

executed by *Henry G. Howe*, U. S. Deputy Mineral

Surveyor, *Dec. 14/97 & Feby. 17*, 1898, under my instructions dated

*Dec. 11/97 & Feby. 14*, 1898, have been critically examined and the

necessary corrections and explanations made, and the said Field Notes and Return, and

the Survey they describe, are hereby approved. A true copy of the copy of the location

certificate filed by the applicant for survey is included in the field notes.

*George Christ*

U. S. Surveyor General for *Arizona*.