

**MS**  
-

**0**

**1**

**3**

**1**

**4**

(4-683.)

Mineral Survey No. 1314

Lot No. \_\_\_\_\_

Prescott

Land District.

FIELD NOTES

OF THE SURVEY OF THE MINING CLAIM OF

Mrs. S. Bullock and F. A. Tittle Jr.

KNOWN AS THE

Champion

Walker

Mining District,

Yavapai

County,

Arizona

Section 4

Township 12 N

Range 1 W

Surveyed under instructions dated Aug 25<sup>th</sup>, 1898,

by J. J. Fisher

U. S. Deputy Mineral Surveyor.

Claim located Jan 1<sup>st</sup>, 1885

Survey commenced Sep. 22<sup>nd</sup>, 1898.

Survey completed Sep. 22<sup>nd</sup>, 1898

o 6-160

Address.

F. A. Tittle Jr.

Prescott  
Arizona

# PRELIMINARY OATHS OF ASSISTANTS IN SURVEY OF MINING CLAIM.

WE, E. H. Draper and J. S. Swigert  
do solemnly swear that we will well and faithfully execute the duties of chain carriers; that we will level the chain upon even and uneven ground and plumb the tally-pins, either by sticking or dropping the same; that we will report the true distance to all notable objects, and the true length of all lines that we assist in measuring, to the best of our skill and ability, and in accordance with instructions given us, in the survey of the Mining Claim of Thos. A. Bullock and  
J. A. Tritle Jr, known as the  
Champion  
situate in Walker mining district,  
Leopold County, Arizona  
in Section 4, Township No. 12 N., Range No. 1 W.

E. H. Draper, Chainman.

J. S. Swigert, Chainman.

Subscribed and sworn to by the above-named persons before me this 22 day of September, 1898.

*My commission expires May 10<sup>th</sup> 1900*

J. J. Fisher  
Notary Public

*J. J. Fisher*

I, E. H. Draper, do solemnly swear that I will well and truly perform the duties of axeman, in the establishment of corners and other duties, according to instructions given me and to the best of my skill and ability, in the survey of the Mining Claim of Thos. A. Bullock and  
J. A. Tritle Jr.  
known as the Champion  
more fully described in the preceding affidavit.

E. H. Draper, Axeman.

Subscribed and sworn to by the said E. H. Draper before me this 22 day of

September, 1898.

*My commission expires May 10<sup>th</sup> 1900*

J. J. Fisher  
Notary Public

*J. J. Fisher*

I, J. S. Swigert, do solemnly swear that I will well and truly perform the duties of flagman, in the establishment of corners and other duties, according to instructions given me and to the best of my skill and ability, in the survey of the Mining Claim of Thos. A. Bullock and  
J. A. Tritle Jr.  
known as the Champion  
more fully described in the preceding affidavit.

J. S. Swigert, Flagman.

Subscribed and sworn to by the said J. S. Swigert before me this 22 day of

September, 1898.

*My commission expires May 10<sup>th</sup> 1900*

J. J. Fisher  
Notary Public

*J. J. Fisher*

3

# Survey No 1314

## Champion Lode

Feet

Beginning at Cor. No 1. Identical with S.W. corner of the location.

A granite stone 5x10x24 ins. set 1 foot in ground and surrounded by mm. of stones. Stone marked C. No 1-1314.

A + on a pine tree 24" diameter, blazed and scribed B.T.C. No 1-1314 brs. S 88° 25' E 64.5 feet.

A + on a pine tree 8" diameter, blazed and scribed B.T.C. No 1-1314. brs. S 81° 4' W 29.5 feet

Bald Mt. brs N 33° 10' W

Cor. No 1, Survey No 1174. Homestead Lode. brs. N 89° 42' W 1842 feet.

Cor. No 1. Survey No 1307. Golden Fleece No 2. Lode. brs. S 65° 52' W 856 feet

Cor. to sec's 4, 5, 32 & 33, Tps. 12 & 13 N. R. 1. W. 9 & S.R. Mex. brs. N 13° 29' W 1990 feet.

### Fence N 42° 54' E

Var. 14° E

1365 To cor. No 2. Identical with north west corner of the location.

A granite stone 6x8x30 ins. set 1 foot in ground and surrounded by mm. of stones. Stone marked C. No 2-1314.

A + on an oak tree 10" diameter, blazed and scribed B.T.C. No 2-1314. brs. S 33° 49' W 47.7 feet.

A + on a pine tree 8" diameter, blazed and marked B.T.C. No 2-1314. brs. N 69° 35' W 35.5 feet.

Bald Mt. brs N 47° 50' W.

Survey No 1314

Champions Lode

Feet

Thence S 39° 15' E  
Var. 14° E

250

To north center end, initial mon.  
identical with same.  
A granite stone 4x10x24 ins. set 1 foot in  
ground and surrounded by mon. of stones.  
Stone marked J.M.C. No 1314.  
A+ on an oak tree 12" diameter, blazed  
and scribed B.T. J.M.C. No 1314 br. N 29°  
10' W 24 feet.

550

Bald Mt. br. N 47° 45' W about 1/2 miles.  
Same course to cr. No 3. Identical with  
north East corner of the location.  
A granite stone 8x10x24 ins. set 1 foot  
in ground and surrounded by mon.  
of stones. Stone marked C, No 3-1314.  
A+ on an oak tree 8" diameter, blazed  
and marked B.T. C. No 3-1314 br. S 73°  
51' W 31 feet.  
A+ on a pine tree 14" diameter, blazed  
and scribed B.T. C. No 3-1314 br. S 50° E  
117 feet.  
Bald Mt. br. N 47° 8' W

Thence S 42° 54' W  
Var. 14° E

1365

To cr No 4. Identical with South East  
Cor. of the location  
A granite stone 6x8x30 ins. set 1 foot  
in ground and surrounded by a mon.  
of stones, stone marked C. No 4-1314  
A+ on a pine tree 12" diameter blazed  
and scribed B.T. C. No 4-1314 br.  
N 69° 35' E 38.5 feet.  
A+ on a pine tree, 15" diameter, blazed  
and scribed B.T. C. No 4-1314 br.  
S 15° 5' W 46 feet  
Bald Mt. br. N 33° 40' W

# Survey No 1314

Feet

## Champion Lode

Thence N 39° 15' W  
Var. 14° E

300 To south-center end, no location now.  
A granite stone 5x6x30 ins. set 1 foot  
in ground and surrounded by mm. of  
stones. stone marked S.C.E., E. No. 1314

550 Same course to Cor No. 1. the place of  
beginning survey of exterior boundaries.

Containing 17.07+ acres.

### Location

This claim is located in the N.W. 1/4 of  
Sec. 4 T. 12, N. R. 1 W, G + S. B. Mer., in Walker  
mining district, Yavapai Co, Arizona. There are no known adjoining claims.  
Mining District of Yavapai Co Arizona.

### Expenditure of Five Hundred Dollars

I certify that the value of the labor and  
improvements upon this claim, placed  
thereon by the claimants and their grantors,  
is not less than five hundred dollars,  
and that said improvements consist of:

Discovery shaft No. 1, which has from initial  
mon. S 36° 45' W 350 feet.  
Shaft 4x6 x 50 feet  
Value \$500,

Tunnel No. 2, the approach to which has from  
initial mon. S 36° 45' W 350 feet.  
Approach 4x40 feet, 12 foot face  
Tunnel 4x6 feet, 125 feet long, course S 56° 30' W  
Value \$1450.

Shaft No. 3,  
4x6 feet 50 feet deep, which has from initial mon.  
S 43° 5' W 510 feet.  
Value \$500

Survey No 1314

Champion Lode

Shaft No 4.

4x6x30 feet, which has, from S.C.E. mm., N 31° E  
470 feet.

Value \$300

Shaft No 5.

4x8 feet, 25 feet deep, which has, from S.C.E. mm.  
N 44° 15' E 550 feet.

Value \$250.

Shaft No 6.

4x6 feet, 30 feet deep, which has, from S.C.E. mm.  
N 42° E 400 feet

Value \$300

Shaft No 7.

4x6 feet, 50 feet deep, which has, from S.C.E. mm.  
N 43° E 340 feet.

Value \$500

Shaft No 8.

5x10 feet, 40 feet deep, which has, from S.C.E. mm.  
N 41° 45' E 300 feet.

Value \$500.

Instruments

This survey was made with a Gurley solar transit  
The courses were deflected from the true meridians  
as determined by solar and Polaris observations.  
The distances were measured with a 100 foot  
steel chain.

J. J. Fisher  
U.S. Dep. Min. Surveyor

Pouco A.T.  
Sep. 26<sup>th</sup> 1898

# FINAL OATHS FOR SURVEYS.

## LIST OF NAMES.

A list of the names of the individuals employed by J. J. Fisher  
 United States Deputy Mineral Surveyor, to assist in running, measuring, and marking the lines  
 corners and boundaries described in the foregoing field notes of the survey of the mining claim  
 of Mrs. S. Bullock and F. A. Tille Jr.  
 known as the Champion  
 and showing the respective capacities in which they acted.

- E. H. Draper ..... , Chainman.
- J. S. Swigert ..... , Chainman.
- E. H. Draper ..... , Axman.
- J. S. Swigert ..... , Flagman.

## FINAL OATHS OF ASSISTANTS.

We, E. H. Draper  
 and J. S. Swigert ..... do solemnly swear that we assisted J. J. Fisher  
 United States Deputy Mineral Surveyor, in marking the corners and  
 surveying the boundaries of the mining claim of Mrs. S. Bullock and F. A. Tille Jr.  
 known as the Champion ..... represented

in the foregoing field notes as having been surveyed by said deputy mineral surveyor and under  
 his direction; and that said survey has been in all respects, to the best of our knowledge and  
 belief, faithfully and correctly executed, and the corner and boundary monuments established  
 according to law and the instructions furnished by the United States Surveyor-General for

Arizona

- E. H. Draper ..... , Chainman.
- J. S. Swigert ..... , Chainman.
- E. H. Draper ..... , Axman .
- J. S. Swigert ..... , Flagman.

J. J. Fisher

Subscribed and sworn to by the above-named persons before me  
 this 22<sup>nd</sup> day of September, 1898

J. J. Fisher  
 Notary Public

My commission  
 expires May 10<sup>th</sup> 1900



(4-686.)

FINAL OATH OF U. S. DEPUTY MINERAL SURVEYOR.

I, J. J. Fisher, U. S. Deputy Mineral Surveyor, do solemnly swear that, in pursuance of instructions received from the United States Surveyor General for Arizona, dated Aug 20<sup>th</sup>, 1898, I have, in strict conformity to the laws of the United States, the official regulations and instructions thereunder, and the instructions of said Surveyor General, faithfully and correctly executed the survey of the Mining Claim of Mrs. S. Bullock and F. A. Tittle Jr., known as the Champions, situate in Walker Mining District, Yavapai County, Arizona, in Section 4, Township No. 12 N, Range No. 1 W, and designated as Survey No. 1314, as represented in the foregoing field notes, which accurately show the boundaries of said mining claim as distinctly marked by monuments on the ground, and described in the attached copy of the location certificate, which was received by me from the Surveyor General with said instructions, and that all the corners of said survey have been established and perpetuated in strict accordance with the law, official regulations and instructions thereunder; and I do further solemnly swear that the foregoing are the true and original field notes of said survey and my report therein, and that the labor expended and improvements made upon said mining claim by claimants or their grantors are as therein fully stated, and that the character, extent, location and itemized value thereof are specified therein with particularity and full detail, and that no portion of said labor or improvements so credited to this claim has been included in the estimate of expenditures upon any other claim.

J. J. Fisher  
U. S. Deputy Mineral Surveyor.

Subscribed and sworn to by the said J. J. Fisher  
U. S. Deputy Mineral Surveyor, before me a Notary Public  
this 28<sup>th</sup>  
day of September, 1898

My Commission expires July 20, 1901.

Jno J Hawkins  
Notary Public

# Affidavit of Five Hundred Dollars Improvements.

We E. H. Draper and J. S. Swigert

of lawful age, being first duly sworn according to law, depose and say: that we are acquainted with the Champion mining claim, situated in

Halker Mining district, Yavapai County, Arizona Territory, for which Thos. S. Bullock and

J. A. Tittle Jr.

have made application for survey prior to application for patent under the provisions of the Act of Congress, approved May 10, 1872; and that the labor done and improvements made thereon by the applicant and his grantor exceed Five Hundred Dollars in value, and further that we are not personally interested in said mine.

E. H. Draper

J. S. Swigert

TERRITORY OF ARIZONA,  
County of Yavapai } ss.

SWORN to and subscribed before me, this 22<sup>nd</sup> day of September 1898

J. J. Fisher  
Notary Public

J. J. Fisher

My commission  
Expires May 10<sup>th</sup> 1900

CHAMPION.NOTICE.

The undersigned has located this mineral bearing quartz containing Gold, Silver and other precious metals and commencing at this monument and notice and running 300 feet westerly to a monument & N.W. Corner, thence 1500 feet Southerly to a monument & S.W. Corner, thence 600 feet Easterly to a monument & S.E. Corner, thence 1500 feet Northerly to a monument at N.E. Corner, thence 300 feet Westerly to the initial monument and place of beginning.

Situate nigh 50 rods above Dakes saw mill & smelter and on the east bank of Lynx Creek, and shall be known as the Champion Lode in Walker Mining District, Yavapai County, Arizona.

This the 1st., day of January 1885.

Wm. M. Moore

Witness:  
W. L. Lewis.

Recorded at request of J. M. W. Moore Jany 6th., 1885 at 1:40 o'clock p.m. in in Book 20 of Mines pages 353-4, Records of Yavapai County, Arizona.

William Wilkerson,  
County Recorder.

By W. C. Foster, Deputy.

TERRITORY OF ARIZONA, |  
                                  | SS:  
COUNTY OF YAVAPAI.     |

I, W. I. JOHNSON, County Recorder in and for the County of Yavapai, Territory of Arizona, and Custodian of the records thereof, do hereby certify that I have compared the above and foregoing with, and the same is a full, true and correct copy of the Notice of Location of the Champion Mining Claim as the same appears of record in Book 20 of Mines, Pages 353-4, records of Yavapai County, Arizona.

IN WITNESS WHEREOF, I have hereunto set my hand and affixed my official seal, this 16th., day of August, A. D. 1898.

  
*W. I. Johnson*  
\_\_\_\_\_  
County Recorder

(4-687.)

# Surveyor General's Certificate of Approval of Field Notes and Survey of Mining Claim.

Department of the Interior,

Office of U. S. Surveyor General,

*Tucson, Arizona*

*October 26<sup>th</sup>*, 1898.

I, U. S. Surveyor General for *Arizona*,

do hereby certify that the foregoing and hereto attached Field Notes and Return of the Survey of the Mining Claim of *Thos S. Bullock and*

*F. A. Frittle Jr*

, known as the

*Champion*

situate in *Walker* mining district,

*Yavapai* County, *Arizona*,

in Section *4*, Township No. *12 N.*, Range No. *1 W.*

, designated as Survey No. *1314*

executed by *J. J. Fisher*, U. S. Deputy Mineral

Surveyor, *September 22<sup>nd</sup>*, 1898, under my instructions dated

*August 20<sup>th</sup>*, 1898, have been critically examined and the

necessary corrections and explanations made, and the said Field Notes and Return, and

the Survey they describe, are hereby approved. A true copy of the copy of the location

certificate filed by the applicant for survey is included in the field notes.

*George Christ*

U. S. Surveyor General for *Arizona*.

Survey N<sup>o</sup> 1314.  
 Prescott Land District.

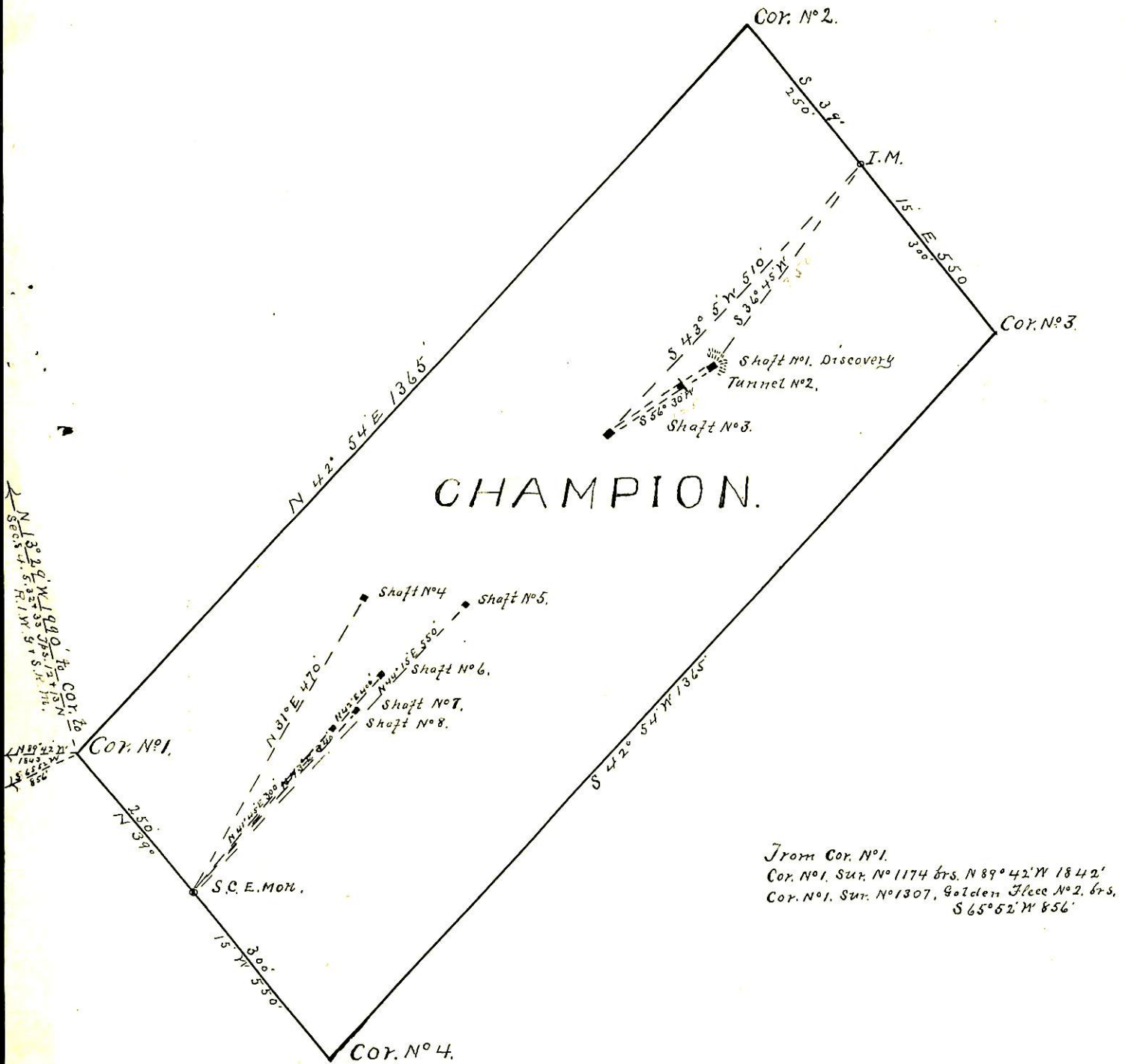

From Cor. N<sup>o</sup> 1.  
 Cor. N<sup>o</sup> 1, Sur. N<sup>o</sup> 1174 brs. N 89° 42' W 1842'  
 Cor. N<sup>o</sup> 1, Sur. N<sup>o</sup> 1307, Golden Fleece N<sup>o</sup> 2, brs.  
 S 65° 52' W 856'

Surveyed Sep. 22<sup>nd</sup> 1898  
 by J. J. Fisher  
 U.S. Dep. Min. Surveyor.