

MS

0

1

5

2

3

Rec'd Dec 26

Approved by [Signature] Dec 26 1900 1

T 21 S. R. 15 E.

(4-683.)

Mineral Survey No. 1523.

Lot No.

Greson Gila Land District.

FIELD NOTES

OF THE SURVEY OF THE MINING CLAIM OF

THE PATAGONIA MINING COMPANY.

KNOWN AS THE

JOHN BULL LODE.

WRIGHTSON Mining District,

SANTA CRUZ County, ARIZONA.

Section UNSURVEYED, Township 21 South, Range 5 East (Approved)

Surveyed under instructions dated DEC. 10th. 1900, 18^{xxx},

by THOS. L. DARBY U. S. Deputy Mineral Surveyor

Claim located JULY 17th. 1900, 18^{xxx}.

Survey commenced DEC. 11th. 1900, 18^{xxxx}.

Survey completed DEC. 15th. 1900, 18^{xxxx}.

6-101

Address,

The Patagonia Mining Co.,
Wm. E. Lloyd, agt.,
Patagonia P.O., Arizona.

FEET

SURVEY No. 1523;

JOHN BULL LODGE.

Beginning at Cor. No. 1

A granite stone 27 x 12 x 11 ins. set 14 ins. in the ground with mound of stone and chiseled 1-1523, whence

The N. E. Cor. of the location bears N. 51° 58' E. 498 ft.

U. S. M. M. No. 2-T. D. bears N. 73° 49' W. 9519.7 ft.

A black oak tree 10 ins. in diam. blazed and scribed B. T. 1-1523 and cross (x) bears N. 79° 12' W. 11.35 ft. to x.

A boulder 4 ft. in diam. standing 15 ins. above ground chiseled B. R. 1-1523, and cross (x) bears N. 53° 04' E. 11.80 ft. to x.

The top of a point of rock bears N. 15° W.

Thence S. 36° 01' W.

57 To Squaw gulch, course North and South.

736.4 To Cor. No. 2

A granite stone 27 x 14 x 7 ins. set 16 ins. in the ground with mound of stone and chiseled 2-1523, whence

The N. W. Cor. of the location bears N. 73° 10' W. 244.5 ft.

A high peak of the 3 R. Mts. bears S. 20° 47' E.

A black oak tree 10 ins. in diam. blazed and scribed B. T. 2-1523 and cross (x) bears S. 55° 03' W. 38.44 ft. to x.

A black oak tree 10 ins. in diam. blazed and scribed B. T. 2-1523 and cross (x) bears N. 9° 13' E. 26.98 ft. to x.

Thence S. 37° 15' E.

276 To Squaw gulch, course S. 75° W.

400 To Cor. No. 3

A granite stone 27 x 12 x 11 ins set 16 ins. in the ground with mound of stone and chiseled 3-1523, whence

The S. W. Cor. of the location bears S. 51° 05' W. 166.5 ft.

A black oak tree 11 ins. in diam. blazed and scribed B. T. 3-1523 and cross (x) bears N. 39° 03' W. 25.65 ft. to x.

A white oak tree 9 ins. in diam. blazed and scribed B. T. 3-1523 and cross (x) bears S. 62° 01' W. 14.76 ft. to x.

FEET

Thence N. 38° 01' E.

786.4 To Cor. No. 4

A granite stone 30 x 10 x 6 ins. set 16 ins. in the ground with mound of stone and chiseled 4-1523, whence

The S. E. Cor. of the location bears N. 75° 22' E. 547.5 ft.

The top of a high point of rock bears N. 65° 17' W.

A black oak tree 10 ins. in diam. blazed and scribed B. T. 4-1523 and cross (x) bears N. 45° 01' E. 19.6 ft. to x.

Thence N. 37° 15' W.

153 To gulch, course S. 60° W.

400 To Cor. No. 1

The place of beginning.

Variations at all corners 12° 30' E.

LODE LINES.

The lode line is N. 52° 45' E. 200 ft. and S. 52° 45' W. 560.5 ft. from the center of the discovery shaft.

AREA.

Total and net area of John Bull Lode 6.990 Acres.

LOCATION.

This claim is located upon unsurveyed Government land, *see Houghton Mining Dist, Santa Cruz Co., Arizona.*
EXPENDITURE OF FIVE HUNDRED DOLLARS.

I certify that the value of the labor and improvements upon this claim, placed thereon by the claimant and its grantors is not less than five hundred dollars and that said improvements consist of

Sp. 1.

The discovery shaft which bears from Cor. No. 4 S. 79° 19' W. 223.6 ft. 4 x 7 ft. 11 ft. deep in rock.

Value \$100.00

Sp. 2.

A shaft which bears from Cor. No. 4 S. 79° 20' W. 301 ft. 4 x 8 ft. 10 ft. deep in rock.

Value \$100.00

Sp. 3.

A shaft which bears from Cor. No. 4 S. 79° W. 315.5 ft. 3 x 3 ft 9 ft. deep in rock.

Value \$80.00

Sp. 4.

A shaft which bears from Cor. No. 4 S. 76° 20' W. 334 ft. ¹²/₈ x 12 ft. ¹²/₁₂ ft. deep

Value \$240.

Other Improvements

None.

INSTRUMENT.

This survey was made with a Buff and Berger No. 6 Transit, with vertical arc, side telescope and Solar at-

tachment. The courses were deflected from the true meridian as determined from observation of Polaris at its upper culmination, when in the same vertical plane with the Star Delta of the constellation Cassiopeia.

The distances were measured with 100 ft. and 500 ft. steel tapes.

NOTE: The disagreement between these field notes and the location certificate is caused partly by errors in the latter, but chiefly by direction of the owners who only care to pay for the part embraced in this survey.

Calculation of Areas.

Course	Dist.	Lat.	Dep.	D.M.D.	N. +	S. -
N 38° 01' E	786.4	+619.54	+484.33	+484.33	+300,061.5082	
S 37° 15' E	400	-318.40	+242.12	+210.78		-385512352
S 38° 01' W	786.4	-619.54	-484.33	+968.57		-6010678693
N 37° 15' W	400	+318.40	-242.12	+242.12	+77061.008	
					+377,122.8162	-986,580.2098
						377,122.8162
					43,560	609,457.3936
						2713.99

6.99 acres.

0492

31

31

422

FINAL OATHS FOR SURVEYS.

LIST OF NAMES.

A list of the names of the individuals employed by Thos L. Darby
 United States Deputy Mineral Surveyor, to assist in running, measuring, and marking the lines
 corners and boundaries described in the foregoing field notes of the survey of the mining claim
 of The Patagonia Mining Company
 known as the John Bull lode
 and showing the respective capacities in which they acted.

Henry Lamb , Chairman.
Ramon B Daniel , Chairman.
 , Axman.
 , Flagman.

FINAL OATHS OF ASSISTANTS.

We, Henry Lamb
 and Ramon Daniel, do solemnly swear that we assisted Thos L.
Darby, United States Deputy Mineral Surveyor, in marking the corners and
 surveying the boundaries of the mining claim of The Patagonia Mining
Company
 , known as the.....
John Bull lode , represented
 in the foregoing field notes as having been surveyed by said deputy mineral surveyor and under
 his direction; and that said survey has been in all respects, to the best of our knowledge and
 belief, faithfully and correctly executed, and the corner and boundary monuments established
 according to law and the instructions furnished by the United States Surveyor-General for
Arizona

Henry Lamb , Chairman.
Ramon B Daniel , Chairman.
 , Axman .
 , Flagman.

Subscribed and sworn to by the above-named persons before me
 this 15th day of December, 1900.

Richard Farrell
 Notary Public

My Com. expires April 28th 1902

FINAL OATH OF U. S. DEPUTY MINERAL SURVEYOR

I, Thos L. Darby, U. S. Deputy Mineral Surveyor, do solemnly swear that, in pursuance of instructions received from the United States Surveyor General for Arizona, dated Dec 10th 1900, I have, in strict conformity to the laws of the United States, the official regulations and instructions thereunder, and the instructions of said Surveyor General, faithfully and correctly executed the survey of the Mining Claim of The Patagonia Mining Company, known as the John Bull lode, situate in Wrightson Mining District, Santa Cruz County, Arizona, in Section —, Township No. —, Range No. Unsurveyed, and designated as Survey No. 1523, as represented in the foregoing field notes, which accurately show the boundaries of said mining claim as distinctly marked by monuments on the ground, and described in the attached copy of the location certificate, which was received by me from the Surveyor General with said instructions, and that all the corners of said survey have been established and perpetuated in strict accordance with the law, official regulations and instructions thereunder; and I do further solemnly swear that the foregoing are the true and original field notes of said survey and my report therein, and that the labor expended and improvements made upon said mining claim by claimant or its grantors are as therein fully stated, and that the character, extent, location and itemized value thereof are specified therein with particularity and full detail, and that no portion of said labor or improvements so credited to this claim has been included in the estimate of expenditures upon any other claim.

Thos L. Darby
U. S. Deputy Mineral Surveyor.

Subscribed and sworn to by the said Thos L. Darby

U. S. Deputy Mineral Surveyor, before me The Clerk of the District Court of the Republic of Colorado this 29th day of December 1900

Chas. W. Wainwright
CLERK

Affidavit of Five Hundred Dollars Improvements.

We, J. Johnson, and Geo. Lloyd
of lawful age, being first duly sworn according to law, depose and say: that we are
acquainted with the John Bull Lode mining claim, situate
in Wrightson Mining district, Santa Cruz County,
Arizona Territory, for which The Patagonia Mining Company

has made application for survey prior to application for patent under the provisions
of the Act of Congress, approved May 10, 1872; and that the labor done and improve-
ments made thereon by the applicant and its grantor exceed Five Hundred
Dollars in value, and further that we are not personally interested in said mine.

J. Johnson Jr
Geo Lloyd

TERRITORY OF ARIZONA,
County of Santa Cruz } ss:

Sworn to and subscribed before me, this 28th
day of December, 1890

Richard Farrell

Notary Public
My Comm expires Apr 28th 1902

Notice of Mining Location.

LODE CLAIM.

To All Whom It May Concern:

This mining claim, the name of which is the John Bull Mining Claim, situate on lands belonging to the United States of America, and in which there are valuable mineral deposits, was entered upon and located for the purpose of exploration and purchase by C. W. Hays, Annie B. Hays, and J. N. Castle

the undersigned, on the 17 day of July 1900.

The length of this claim is Fifteen Hundred feet, and we claim seven hundred and fifty feet in a westerly direction, and seven hundred and fifty feet in a Easterly direction from the center of the discovery shaft, at which this notice is posted, lengthwise of the claim, together with Three hundred feet in width of the surface grounds, on each side of the center of said claim. The general course of the lode deposit and premises is from the North east to the south west

The claim is situated and located in the Wrightson Mining District, in San Geronimo County, in the Territory of Arizona, about seven miles in a western direction from Patagonia

The surface boundaries of the claim are marked upon the ground as follows: Beginning at Location monument at discovery shaft thence 750 ft in a Easterly direction at a point in a _____ direction _____ feet from the discovery shaft (at which this notice is posted), being in the center of the _____ end line of said claim; thence 300 feet to a Monument, being the north west corner of said claim; thence 750 feet to a monument at the center of the north side line of said claim; thence 750 feet to a monument, being at the South East corner of said claim; thence 300 feet to a Monument at the center of the West end of said claim; thence 300 feet to a monument, being at the South East corner of said claim; thence 750 feet to a monument being at the center of the South side line of said claim; thence 750 feet to a monument at the North East corner of said claim; thence 300 feet to the place of beginning.

All done under the provisions of Chapter Six, of Title XXXII., of the Revised Statutes of the United States, and of an Act of the General Assembly of Arizona, entitled "An Act Concerning Mines," approved March 20th, 1895, and amended March 2, 1899.

Dated and posted on the ground this 17 day of July 1900.
C. W. Hays
Annie B. Hays
J. N. Castle

Filed and recorded at request of J. N. Castle Sept 8th, a.d. 1900 at 10:20 a.m. W. N. Cummings, County Recorder, by Louis Hedgim, Deputy

TERRITORY OF ARIZONA,

County of..... } ss

I....., County Recorder in and for the County and Territory aforesaid, do hereby certify that the within instrument was filed for record at..... o'clock,..... M., on this..... day of..... 190..., and duly recorded in Book No..... of..... Records of..... County, Arizona, at pages.....

WITNESS my hand and official seal the day and year first above written

..... County Recorder.

Notice of Location.

LODE CLAIM.

Dated..... 190.....

Filed and recorded at request of

A. D. 190.....

at..... M.

Book.....

Pages.....

County Recorder.

Deputy Recorder.

The H. H. McNeill Co., Printers, Phoenix, Arizona.

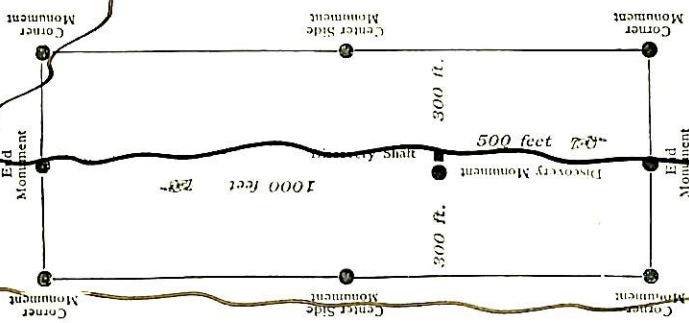

This diagram is to give locator a general idea of plan of location under the new law. The Discovery Shaft can be in the center of claim or any distance from either end desired. In the diagram it is placed 500 feet from one end and 1000 feet from the other. Commence description of claim at center end monument, giving its distance and direction from center of Discovery Shaft; then bound the claim in either direction. In description be careful to state locality of claim with reference to some natural object, or permanent monument, as will identify the claim.

TERRITORY OF ARIZONA,)

) ss-

County of Santa Cruz.)

I, W. N. Cummings, County Recorder in and for said County, do hereby certify that the within copy of the location notice of the John Bull Mining Claim, is a full, true and exact copy of the same as it appears of record in the Recorder's Office of said County in Book 1 Mining Locations at pages 620, 621 and 622.

Witness my hand and official seal, this 3rd day of December A. D. 1900.



W. N. Cummings
County Recorder

POOR QUALITY

The following pages are scanned at the best possible quality setting. The original pages are of poor quality and this is the best possible reproduction.

(4-687.)

Surveyor General's Certificate of Approval of Field Notes and Survey of Mining Claim.

Department of the Interior,

Office of U. S. Surveyor General,

Tucson Arizona

March 15-1901, 18

I, U. S. Surveyor General for *District of Arizona*,

do hereby certify that the foregoing and hereto attached Field Notes and Return of the Survey of the Mining Claim of *The Patagonia Mining Company*.

....., known as the

John Bull lode

situate in *Wrightson* mining district,

Santa Cruz County, *Arizona*,

in Section _____, Township No. *21 S.*, Range No. *15 E.* (*approx. unsurveyed*)

....., designated as Survey No. *1523*.

executed by *Thos. L. Darby*, U. S. Deputy Mineral

Surveyor, *Dec. 11-15-1900*, 18, under my instructions dated

Dec. 10-1900, 18, have been critically examined and the

necessary corrections and explanations made, and the said Field Notes and Return, and

the Survey they describe, are hereby approved. A true copy of the copy of the location

certificate filed by the applicant for survey is included in the field notes.

George Christ

U. S. Surveyor General for *Arizona*.

