

**MS** .

**0**

**1**

**5**

**8**

**1**



Recd Oct. 5-1901.

(4-683.)

Mineral Survey No. 1581.

Lot No. \_\_\_\_\_

Gila

Land District.

FIELD NOTES

OF THE SURVEY OF THE MINING CLAIM OF

G. E. Whiteford per  
W. E. Truman, Agent

KNOWN AS THE

Rainey, Indicator, Loner, Saturn, Satellite, Grace & Thomas, Contention and Truman

in Mineral Creek

Mining District,

Pinal

County,

Arizona approximately

~~Section~~

in

Township

9<sup>th</sup> Tanta

Range

10 East

Surveyed under instructions dated

July 8<sup>th</sup>, 1901.

by

Charles von Arden

U. S. Deputy Mineral Surveyor

Claim located \_\_\_\_\_

, 1

Survey commenced \_\_\_\_\_

July 11<sup>th</sup>

, 1

1901.

Survey completed \_\_\_\_\_

July 26<sup>th</sup>

, 1

1901.

6-100

Address:

W. E. Truman

Florence Pinal Co  
Arizona.



PRELIMINARY OATHS OF ASSISTANTS IN SURVEY OF MINING CLAIM.

We, J. W. Thomas and A. J. Anderson, do solemnly swear that we will well and faithfully execute the duties of chain carriers; that we will level the chain upon even and uneven ground and plumb the tally-pins, either by sticking or dropping the same; that we will report the true distance to all notable objects, and the true length of all lines that we assist in measuring, to the best of our skill and ability, and in accordance with instructions given us, in the survey of the Mining Claim of G. E. Whiteford

known as the Rainey, Vindicator, Lancer, Saturn, Satellite, Grace L. Thomas, Contention & Truman situate in Pinal Mineral Creek mining district, Pinal County, Arizona, approximately in Section 112, Township No. 3 South, Range No. 13 East Tia and Salt River Meridian

J. W. Thomas, Chainman. A. J. Anderson, Chainman.

My commission expires January 29th 1905.

Subscribed and sworn to by the above-named persons before me this 11th day of July, 1901.

Charles von Guleben Notary Public.

I, Pedro Bia, do solemnly swear that I will well and truly perform the duties of axeman, in the establishment of corners and other duties, according to instructions given me and to the best of my skill and ability, in the survey of the Mining Claim of G. E. Whiteford

known as the Rainey, Vindicator, Lancer, Saturn, Satellite, Grace L. Thomas, Contention & Truman more fully described in the preceding affidavit.

Pedro Bia, Axeman.

Subscribed and sworn to by the said Pedro Bia before me this 11th day of July, 1901.

My commission expires January 29th 1905.

Charles von Guleben Notary Public.

I, Alberto Lopez, do solemnly swear that I will well and truly perform the duties of flagman, in the establishment of corners and other duties, according to instructions given me and to the best of my skill and ability, in the survey of the Mining Claim of G. E. Whiteford

known as the Rainey, Vindicator, Lancer, Saturn, Satellite, Grace L. Thomas, Contention & Truman more fully described in the preceding affidavit.

Alberto Lopez, Flagman.

Subscribed and sworn to by the said Alberto Lopez before me this 11th day of July, 1901.

My commission expires January 29th 1905.

Charles von Guleben Notary Public.



# Mineral Survey No 1581.

## Peircey Lode.

Beginning at Corner No 1. - identical with the Southwest corner of the location and with the Northwest corner of the Derrite ~~land~~ claim. (unsurveyed.) U. S. Loc: Mon: No 1. bears South  $16^{\circ} 19'$  East 1030 feet dist: A pine post  $4\frac{1}{2}$  feet long, 4 ins: square, set 18 ins: in the ground with mound of stone scribed S. R. 1581. - No other bearings available. -

Bearing North  $11^{\circ} 10'$  West

Declination  $13^{\circ} 45'$  East. -

ascending steep ridge, sloping westerly. -

105. Top of ridge. -

200 West End Center identical with the location and with Cor: No 2 of the Mining <sup>Sept. 1580</sup> Sink and <sup>No. 1247</sup> Outbank ~~claims~~. - A pine post,  $4\frac{1}{2}$  feet long, 4 ins: square, set 18 inches in the ground with mound of stone, scribed W. E. C<sup>o</sup> R. 1581. - along Eastern Side Line of Mining Sink to

600. - Cor: No 2. identical with the location. - A pine post,  $4\frac{1}{2}$  feet long, 4 ins: square, set 18 inches in the ground with mound of stone scribed S. R. 1581. - No bearings available. -

Bearing North  $73^{\circ} 50'$  East

Declination  $13^{\circ} 45'$  East

Ascending ridge sloping westerly

150. Guide, course westerly, 25 feet wide,

700. - North Side Line Center, identical with the location. A pine post,  $4\frac{1}{2}$  feet long, 4 ins: square, set 18 inches in the ground with mound of stone, scribed N. S. I. C<sup>o</sup> R. 1581.

1250. Top of rocky ridge. -

1500. - Cor: No 3. identical with the location. - A pine post,  $4\frac{1}{2}$  feet long, 4 ins: square, set 18 ins: in the ground with mound of stone scribed S. R. 1581. - No bearings available. -

Bearing South  $11^{\circ} 10'$  East

Declination  $13^{\circ} 45'$  East

Ascending



# Mineral Survey No 1581.

175. Foot of descent and ascent  
 124. Top of rocky point and East End center of The claim identical with the location. - A pine post, 4 1/2 feet long, 4 ins: square, set 18 inches in the ground with mound of stone, scribed E. E. C. B. 1581. No bearings available. -  
 ascending over boulders and very rough ground  
 600. - to cor: N<sup>o</sup> 4 identical with the location. - A pine post, 4 1/2 feet long, 4 ins: square, set 18 inches in the ground with mound of stone scribed C. H. B. 1581. - No bearings available. -  
Bearing South 79° 50' West. -  
Variation 13° 45' East. -  
 descending long ridge, dipping westerly. -  
 750. - South side line center of The claim, identical with the location. - A pine post, 4 1/2 feet long, 4 ins: square, set 18 ins: in the ground with mound of stone, scribed S. S. L. C. B. 1581. - No bearings available. -  
 1500. to cor: N<sup>o</sup> 1. The place of beginning. -

## Vindicator Lode.

- Beginning at corner N<sup>o</sup> 1. identical with the Southwest corner of the location. - A pine post, 4 1/2 feet long, 4 ins: square, set 18 inches in the ground with mound of stone, scribed I. V. 1581. - corner N<sup>o</sup> 2 of The Quincy Lode bears N<sup>o</sup> 27° East 260 <sup>80</sup> feet dist: West End center of the Quincy and corner N<sup>o</sup> 2 of The Burbank and Herring Lode bears S. 70° 40' East 187.07 feet dist: N. E. cor: Mon: N<sup>o</sup> 1. bears S. 19° 49' East 2047.00 feet dist:  
Bearing North 18° 30' West  
Variation 13° 45' East.  
 along top of high ridge, gradually ascending  
 750. - West side line center, identical with the location. - A pine post, 4 1/2 feet long, 4 ins: square, set 18 inches in the ground with mound of stone scribed W. S. L. C. V. 1581. - No bearings available. -  
 904. <sup>48</sup> intersect Line 3 - 4 of the Herring Lode at S. 79° 50' W. 276. <sup>02</sup> feet from cor: N<sup>o</sup> 3. - Mineral Lode  
 1320. - Gulch, 15 feet wide, course Southwesterly, across ridge. -



# Mineral Survey No 1581.

1500. - Cor: No 2 identical with the Northwest corner of the location. - A pine post, 4 1/2 feet long, 4 in: square, set 18 inches in the ground with mound of stone, scribed Cor: 2. V. 1581. - No bearings available.

Bearing North 71° 30' East

Variation 14° 30' East

Ascending into Gulch. -

200. Gulch, 15 feet wide, course Southwesterly and around North End Center, identical with the location. - A pine post, 4 1/2 feet long, 4 inches square, set 18 inches in the ground with mound of stone, scribed N. E. C & V. 1581. - No bearings available. -

Cor: - Cor: No 3. - identical with the Northeast corner of the location. - A pine post, 4 1/2 feet long, 4 in: square, set 18 inches in the ground with mound of stone, scribed 3. V. 1581. - No bearings available. -

Bearing South 18° 30' East

Variation 13° 45' East

along West Slope of High Mountain ridge

750. - East Side Line Center of the claim, identical with the location, a pine post, 4 1/2 feet long, 4 in: square, set 18 in: in the ground with mound of stone, scribed E. S. I. C & V. 1581. - No bearings available. -

1370. <sup>42</sup> intersect Line 2. - 3. - of the Ragney Lode at N. 78° 50' E. - 417. <sup>50</sup> feet from Cor: No 2. -

1500. - Cor: No 4. - identical with the Southeast corner of the location. A pine post, 4 1/2 feet long, 4 in: square, set 18 inches in the ground with mound of stone, scribed 4. V. - 1581. - No bearings available. -

Bearing South 71° 30' West

Variation 13° 45' East.

Ascending

140. Gulch, 15 feet wide, course Westerly

150. - same Gulch, course Southwesterly

290 same Gulch, course Northwesterly

300. - South End Center of the claim, identical with the location. - A pine post, 4 1/2 feet long, 4 inches square, set 18 inches in the ground with mound of stone scribed S. E. C & V. 1581. - No bearings available. -

330 same Gulch, course Southwesterly

402. - same Gulch, course Northwesterly -



# Mineral Survey No 1581.

(4.)  
6

437. 50. intersect line 1. - 2. - of the Pragny Lode at South  $11^{\circ} 10'$  East 1817.  $5\frac{1}{2}$  feet from Cor: No 2. -
550. Gulch 25 feet wide, Course Southwesterly. -  
600. - to Cor: No 1. The place of beginning.

## Lower Lode.

Beginning at Cor: No 1. identical with the Southwest Corner of the location and with Cor: No 4 of the Indicator. - A pine post,  $4\frac{1}{2}$  feet long, 4 inches square, set 18 inches in the ground with mound of stone, scribed Cor: 1. So: 1581. - whence N. S. Cor: No: 1. - bears S.  $3^{\circ} 20'$  E. - 2120.  $\frac{1}{2}$  feet dist: No other bearings available. -

Thence North  $13^{\circ} 30'$  West  
Variation  $13^{\circ} 45'$  East

- along the eastern side line of the Indicator  
437. 50 intersect line 2. - 3. - of the Pragny Lode at N.  $78^{\circ} 50'$  East 417.  $5\frac{1}{2}$  feet from Cor: No 2. -
750. West side line center of the claim, identical with the location and with the East Side Line center of the Indicator. - A pine post,  $4\frac{1}{2}$  feet long, 4 ins: square, set 18 ins: in the ground with mound of stone, scribed N. S. I. C. No 50: 1581. - No bearings available. -
1000. - to Cor: No 2. - identical with the Northwest Cor: of the location and with Cor: No 3 of the Indicator. A pine post,  $4\frac{1}{2}$  feet long, 4 ins: square, set 18 inches in the ground with mound of stone, scribed Cor: 2 So: 1581. No bearings available. -

Thence ~~South  $11^{\circ} 10'$  East~~ N.  $71^{\circ} 30'$  E  
Variation  $13^{\circ} 45'$  East

- ascending along North slope of ridge  
800. North End center of the claim, identical with the location. A pine post,  $4\frac{1}{2}$  feet long, 4 ins: square, set 18 inches in the ground with mound of stone, scribed N. E. C. No 50: 1581. No bearings available.
400. - top of ascent and descent  
500. - to Cor: No 3. identical with the Northeast Corner of the location. A pine post,  $4\frac{1}{2}$  feet long 4 ins: square, set 18 inches



c 5.

# Mineral Survey No 1581.

7

in the ground with mound of stone, scribbled Cor. 3, so: 1581.  
No bearings available. —

Bearing South 18° 30' East  
Variation 13° 45' East

ascending over very rough rocky ground along West  
Slope of High Mountain ridge

1440. — East End Center Northeastery and Southeastery. —

1441. — East Side Line Center, identical with the location. — A  
pine post, 4 1/2 feet long, 4 ins square, set 18 inches in the  
ground with mound of stone, scribbled E. S. L. C<sup>o</sup> So: 1581. —  
No bearings available. —

1447. 63. intersect line 2. — 3. of the Quincy Lode at South 78°  
50' West. 477. 42 feet from Cor. No 3. —

1450. — to Cor. No 4, identical with the Southeast corner of the  
location. — A pine post, 4 1/2 feet long, 4 ins square, set 18  
inches in the ground with mound of stone, scribbled Cor. 4, So:  
1581. — No bearings available. —

Bearing South 71° 30' West  
Variation 13° 45' East

Ascending steep rocky ridge over boulders and very  
rough ground

1451. — South End Center of the claim, identical with the location.  
A pine post 4 1/2 feet long, 4 ins square, set 18 ins in the  
ground with mound of stone, scribbled S. E. C<sup>o</sup> So: 1581. —  
No bearings available. —

1452. — to Cor. No 1. The place of beginning. —

---

## Saturday.

Beginning at corner No 1, identical with the Southwest  
corner of the location, — and with Cor. No 4 of the  
Looney Lode. — A pine post, 4 1/2 feet long, 4  
ins square, set 18 inches in the ground with mound of  
stone, scribbled Cor. 1. So: 1581. — whence U. S. Loc. Mon.  
No 1. bears South 10° 50' West 2349. 38 feet dist:  
No other bearings available.

Bearing North 18° 30' West  
Variation 13° 45' East

over rocks and boulders along West slope of High  
Mountain Ridge



# Mineral Survey No 1581.

- 52. <sup>27</sup> intersect Line 2-3 of The Ragney Lode at South  $73^{\circ} 50'$  West  $477\frac{1}{2}$  feet from Cor: M<sup>o</sup> B. —
- 750. West Side Line center, identical with the location and with the East Side Line center of The Loner Lode. — A pine post,  $4\frac{1}{2}$  feet long,  $4$  inches square, set 18 inches in the ground with mound of stone, scribed W. S. L. C<sup>o</sup> Sa: 1581. — No bearings available —
- 1470. — Trail, bears Northwesterly and Southwesterly. —
- 1577. to Cor: N<sup>o</sup> 2. identical with the Northwest corner of the location. — and with corner N<sup>o</sup> 3 of The Loner Lode. — A pine post,  $4\frac{1}{2}$  feet long,  $4$  inches square, set 18 inches in the ground with mound of stone, scribed Cor: 2. Sa: 1581. — No bearings available. —

Traverse North  $71^{\circ} 20'$  East  
Variation  $13^{\circ} 45'$  East

- 30. Trail bears Northwesterly and Southwesterly, ascending along southern slope of ridge. —
- 210. top of ascent and descend
- 300. — North End center, identical with the location. — A pine post,  $4\frac{1}{2}$  feet long,  $4$  inches square, set 18 inches in the ground with mound of stone, scribed N. E. C<sup>o</sup> Sa: 1581. — No bearings available. —
- 400. ascend rocky ridge
- 500. Arroyo — 15 feet wide — Course Northwesterly. —
- 600. to Cor: N<sup>o</sup> 3. identical with the Northeast corner of the location. — A pine post,  $4\frac{1}{2}$  feet long,  $4$  inches square, set 18 inches in the ground with mound of stone, scribed Cor: 3. Sa: 1581. — No bearings available.

Traverse South  $13^{\circ} 30'$  East  
Variation  $13^{\circ} 45'$  East

- Arroyo into Arroyo. —
- 50. — Arroyo 15 feet wide — Course Westerly, thence Northwesterly, ascend high ridge, sloping Westerly
- 750. — East Side line center, identical with the location. A pine post,  $4\frac{1}{2}$  feet long,  $4$  inches square, set 18 inches in the ground with mound of stone scribed E. S. L. C<sup>o</sup> Sa: 1581. — No bearings available. —
- 800. top of ascend, along West slope of ridge
- 1500 to Cor: N<sup>o</sup> 4. identical with the Southwest corner of the location. — A pine post,  $4\frac{1}{2}$  feet long,  $4$  inches square, set 18 inches in the ground with mound of stone scribed Cor: 4. Sa: 1581. — No bearings available. —



# Mineral Survey No. 1581.

71° 30'  
Thence South ~~78° 30'~~ West  
Variation: 13° 45' East

Ascend ridge, dipping Westward. —

- 100. Foot of descent
- 173. 18 intersect line 2. — 2. of the Ragney Lode at S. 78° 50' W.
- 18. 50 feet from Cor. No. 3. —
- 300. — South End Center of the claim, identical with the location. — A pine post, 4 1/2 feet long, 4 in. square, set 18 inches in the ground with mound of stone, marked S. E. C. 2. Sat. 1581. — No bearings available. —
- 370. Cor. descend ridge over boulders and rocky ground to Cor. No. 1, the place of beginning. —

## Satellite Lode.

Beginning at Cor. No. 1, identical with the Southwest corner of the location and with Cor. No. 4 of the Saturn. A pine post, 4 1/2 feet long, 4 in. square set 18 inches in the ground with mound of stone marked Cor. 1. Sat. 1581 — whence U. S. Loc. Mon. No. 1 bears S. 22° 04' W. — 2694. 9 feet dist. — No bearings available. —

Thence North 13° 45' West  
Variation 13° 45' East

along the Eastern Side Line of the Saturn and along West Slope of ridge

- 700. — Ascending
- 750. — West Side Line center, identical with the location and with the East Side Line center of the Saturn. — A pine post, 4 1/2 feet long, 4 in. square set 18 inches in the ground with mound of stone, <sup>scribed U. S. Cr. Sat. 1581.</sup> ~~marked Cor. 2. Sat. 1581.~~ — No bearings available. —

Thence North 71° 30' East  
Variation 13° 45' East

Ascending into Cañon

- 125. Cañon, 20 feet wide, course Southwesterly and ardent.
- 200. — North End Center of the Satellite, identical

Cor No. 2, identical with the location and with  
 Cor 3 Saturn Lode. A pine post 4 1/2 ft long, 4 in sq.  
 set 18 in in the ground, scrib'd with ind. of stone —  
 scrib'd Cor. 2. Sat. 1581. No bearings available

7 1581

Last half-minut



# Mineral Survey No 1581.

with the location, a pine post, 4 1/2 feet long, 4  
inches square, set 18 inches in the ground with  
mound of stone, scribed N. E. c<sup>o</sup> Sat: 1581. —  
No bearings available —

320. Top of ascent and descend

570. Station 15 feet wide, Course Northwesterly

600. — 4<sup>th</sup> Cor. No 3. identical with the Northeast Cor.  
of the location. — A pine post, 4 1/2 feet long,  
4 inches square, set 18 inches in the ground with  
mound of stone, scribed Cor. 3. Sat: 1581. — No  
bearings available. —

Thence South 18° 30' East  

---

Variation 13° 45' East

630. — Station, 15 feet wide, Course Northwesterly around  
600. Top of ridge bears Eastward and Northward and  
descend

750. — East Side Line Center, identical with the location.  
A pine post, 4 1/2 feet long, 4 inches square, set 18  
inches in the ground with mound of stone, scribed  
E. S. I. C<sup>o</sup> 1581. — No bearings available.

950. — Bottom of descent and ascent

1100 Top of ascent and descend

1200. — Bottom of descent and ascent

1350. Top of ascent and descend

1500. — 4<sup>th</sup> Corner No 4. identical with the Southeast Corner  
of the location. A pine post, 4 1/2 feet long, 4 inches  
square, set 18 inches in the ground with mound of  
stone, scribed Cor. 4. Sat: 1581. — No bearings available.

Thence South 7° 30' West  

---

Variation 13° 45' East

descending ridge

600. — South End Center of the claim, identical with  
the location. — A pine post, 4 1/2 feet long, 4  
inches square, set 18 inches in the ground  
with mound of stone scribed S. E. c<sup>o</sup> Sat: 1581. —  
No bearings available.

600. — To Cor. No 1. The place of beginning. —

---

---



# Mineral Survey No 1581.

## Thomas Lode.

Beginning at Cor: No 1. identical with the <sup>Southwest</sup> Southeast corner of the location and with Cor: No 2 of the vindicator. - A pine post, 4 1/2 feet long, 4 inch square, set 18 inches in the ground with mound of stone scribed Cor: 1. Tr: 1581. - whence N. S. Cor: Mon: No 1 bears South 19° 16' East 3540 feet dist: No other bearings available. -

Bearing North 18° 20' East West

Variation 13° 45' East

Ascending hill, sloping westerly -

300. - West End Center, identical with the location, a pine post, 4 1/2 feet long, 4 inches square, set 18 inches in the ground with mound of stone, scribed W. E. C: Tr: 1581. - No bearings available. -

487. <sup>96</sup> intersect the East Side Line of the Native Copper mine, intersected at N - 75° 20' West 300. <sup>60</sup> feet from the South East corner of the claim. -

600. - Cor: No 2. identical with the Northwest corner of the location. - a pine post, 4 1/2 feet long, 4 inches square, set 18 inches in the ground with mound of stone scribed Cor: 2. Tr: 1581. - No bearings available. -

Bearing North 7° 30' East

Variation 13° 45' East

374. <sup>96</sup> intersect the East End Line of the Native Copper Mining Claim at North 14° 40' West 137. <sup>33</sup> feet from the South East corner. -

750. - North Side Line Center, identical with the location. - a pine post, 4 1/2 feet long, 4 inches square set 18 inches in the ground with mound of stone scribed N. S. L. C: Tr: 1581. No bearings available. -

1500. - Cor: No 3. - identical with the Northeast corner of the location. - a pine post 4 1/2 feet long 4 inch square set 18 inches in the ground with mound of stone, scribed Cor: 3. Tr: 1581. - No bearings available. -

Bearing South 18° 30' East

Variation 13° 45' East



# Mineral Survey No 1581

ascending ridge, sloping South westerly. -  
 150 Gulch, 20 feet wide course westerly. -  
 200. East End Center identical with the location. - a pine post, 4 1/2 feet long, 4 inches square set 18 inches in the ground with mound of stone marked E. E. C<sup>2</sup> Th: 1581. No bearings available -

200. At Cor: No 4. - identical with the Southeast corner of the location and with the North End center of the Saturn Lode. - a pine post, 4 1/2 feet long, 4 inches square, set 18 inches in the ground with mound of stone marked Cor: No 4. Th: 1581. - No bearings available. -

Source Lode 7 1/2' 30' West  
Indicator 13' 45' East

along the Northern End Line of the Saturn, Source and Indicator Lodes, ascend ridge over boulders and rocky ground

470. top of ascent and descend  
 250. Trail bears Northwesterly and Southwesterly  
 300. - Cor: 2 of the Saturn and Cor: No 3 of the former Lode. -

ascending North Slope of ridge

500. top of ascent and descend  
 600. North End center of the Source. -

700. South Side side center, identical with the location, a pine post, 4 1/2 feet long, 4 inches square, set 18 inches in the ground with mound of stone marked S. S. L. C<sup>2</sup> Th: 1581. No bearings available. -

800. - corner of the Source and Cor: 3 of the Indicator.  
 200. Gulch - 15 feet wide - course Southwesterly  
 1500. At Cor: No 1. The place of beginning.





Mineral Survey No 1581.

Contention Lode.

Beginning at Corner No 1 identical with the  
Southwest Cor. of the location and with Cor. No 2 of the  
Thomas Lode. - a pine post, 4 1/2 feet long, 4 ins: square,  
set 18 inches in the ground, with mound of stone, scribed Cor.  
1. G. 1581. - whence U. S. Loc: Mon: No 1. bear  
S. 19° 9' East 414 7/8 feet dist: no other bearings  
available. - Thence N 18° 30' W, Var 13° 45' E  
Ascending mesa, sloping Southwestwardly,

300. - West End Center of the Claim, identical with the location.  
A pine post, 4 1/2 feet long, 4 ins: square, set 18 inches in  
the ground with mound of stone, scribed W. E. C. C. 1581. -  
No bearings available. -

488. <sup>85</sup> intersect the North Side Line of the Native Copper  
at S. 75° 20' West - 406. <sup>90</sup> feet from the Northeast  
Corner of said claim. -

600. - to Cor. No 2. identical with the Northwest Corner  
of the location. - a pine post, 4 1/2 feet long, 4 inches  
square set 18 inches in the ground with mound of  
stone, scribed Cor. 2. C. 1581. - No bearings available.

Bearing North 71° 30' East  
Variation 13° 45' East. -

Ascending high mountain ridge, sloping Westwardly,  
750. - Northside Line Center, identical with the location. A  
pine post, 4 1/2 feet long, 4 ins: square, set 18 inches  
in the ground with mound of stone, scribed N. S. I. C. C.  
1581. - No bearings available. -

1500. Cor. No 3. identical with the Northeast corner of  
the location. - A pine post, 4 1/2 feet long, 4 inches  
square, set 18 inches in the ground with mound of  
stone, scribed Cor. 3. C. 1581. - No bearings available. -

Bearing South 18° 30' East  
Variation 13° 45' East

along West Slope of Mountain

200. East End Center of the Claim, identical with the  
location. - A pine post, 4 1/2 feet long, 4 inches  
square, set 18 inches in the ground with mound  
of stone scribed E. E. C. C. 1581. No bearings  
available. -



(12.)

# Mineral Survey No 1581.

14

600. To corner No 4. identical with the Southeast corner of the location and with Cor. No 3 of the Thomas. — A pine post, 4 1/2 feet long, 4 inches square, set 18 inches in the ground with mound of stone, scribed Cor. H. C. 1581. — No bearings available.

Thence South 71° 30' West  
Variation 13° 45' East

750. — along the Northernly Side Line of the Thomas, descending high mountain ridge, sloping Northernly South Side Line center identical with the location and with the North Side line center of the Thomas. — A pine post, 4 1/2 feet long, 4 inches square, set 18 inches in the ground with mound of stone, scribed S. S. I. C. 1581. No bearings available.

1125. 04. intersect the East End Line of the Native Copper Mining claim at N. 14° 40' W. — 137 2/3 feet from the South East corner, & S 14° 40' E. 462 67 ft N. E. cor.

1500. Cor. No 1. and place of beginning. —

---

## Thomas.

Beginning at Cor. No 1. identical with the Northwest corner of the location and with Cor. No 2 of the Contention. — A pine post, 4 1/2 feet long, 4 inches square, set 18 inches in the ground with mound of stone, scribed Cor. 1. Tr. 1581. — whence U. S. Loc. Mon. No 1. bears S. 19° 04' E. 4747. 30 feet dist. No other bearings available. — gently ascending. Thence N. 18° 30' W. Var 13° 45' ~~13° 45' E~~

300. — West End center, identical with the location. A pine post, 4 1/2 feet long, 4 inches square, set 18 inches in the ground with mound of stone scribed W. E. C. Tr. 1581. — No bearings available. —

600. — to Cor. No 2. identical with the Northwest corner of the location. — A pine post, 4 1/2 feet long, 4 inches square, set 18 inches in the ground with mound of stone, scribed Cor. 2. T.R. 1581. — No bearings available.



# Mineral Survey No 1581.

Bearing North 71° 30' East  
Variation 13° 45' East.

Ascending gently

750. - North Side Line Center, identical with the location, a pine post, 4 1/2 feet long, 4 inches square, set 18 inches in the ground with mound of stone, scribed N. S. I. C<sup>2</sup> Tr: 1581. - No bearings available.

1500. - Cor: No 3. identical with the Northeast Cor: of the location. - a pine post, 4 1/2 feet long, 4 in: square, set 18 inches in the ground with mound of stone, scribed Cor: 3. Tr: 1581. - No bearings available.

Bearing South 18° 30' East  
Variation 13° 45' East.

along West Slope of Mountain Ridge

270. - East End Center of the Claim, identical with the location, a pine post, 4 1/2 feet long, 4 inches square, set 18 inches in the ground with mound of stone scribed E. E. C<sup>2</sup> Tr: 1581. No bearings available.

400. - Cor: No 4 identical with the South East Corner of the location and with Cor: No 3. of the Contention. - a pine post, 4 1/2 feet long, 4 inches square, set 18 inches in the ground with mound of stone, scribed Cor: 4. Tr: 1581. - No bearings available.

Bearing South 71° 30' West  
Variation 13° 45' East

along the Northernly Side Line of the Contention, descending high Mountain Ridge, Laying Westerly.

750. - South Side Line Center, identical with the location. - a pine post, 4 1/2 feet long, 4 inches square, set 18 inches in the ground with mound of stone, scribed S. S. I. C<sup>2</sup> Tr: 1581. - No bearings available.

1500. Cor No 1. place of beginning

Grace L.

Beginning at Cor: No 1. identical with the South East Cor: of the location and with Cor: No 2 of the Vindicator and Cor: No 1. of the Thomas.

(a)



# Mineral Survey N<sup>o</sup> 1581.

A pine post, 4 1/2 feet long, 4 in. square, set 18 inches in the ground with mound of stone, scribed Cor: 1. G. I. 1581. - whence U. S. Loc: Mon: N<sup>o</sup> 1. bears Suda 19° 16' East 3546 feet dist: No other bearings available.

Thence North 14° 40' West  
Variation 13° 45' East.

486. 40 Cor: N<sup>o</sup> 2. identical with the Northeast corner of the location. - A pine post, 4 1/2 feet long, 4 in. square, set 18 inches in the ground with mound of stone, scribed Cor: 2. - G. I. 1581.

32. 59. Thence South 75° 20' West. Variation 13° 45' East intersect line 1. - 2. - of the Thomas at Suda 78° 30' East 112.50 feet from Cor: N<sup>o</sup> 2 of the Thomas. -

115. 5 perpendicular bluff, 50 feet deep,  
203. 20 North <sup>side</sup> End Center of the Claim, identical with the location, a pine post, 4 1/2 feet long, 4 in. square, set 18 inches in the ground with mound of stone, scribed N. S. C<sup>o</sup> G. I. 1581. No bearings available. -

383. 4 Suda Side Line Center of the Native Copper Lode  
406. 4 to Cor: N<sup>o</sup> 3, identical with the location and with the Northeast corner of the Mineral Creek Lode surveyed. - A pine post 4 1/2 feet long, 4 in. square, set 18 inches in the ground with mound of stone, scribed Cor: 3. G. I. 1581. No bearings available. -

Thence South 14° 40' West East  
Variation 13° 45' East

250. along the Earterly End Line of the Mineral Creek Magan Road bears Northwesterly and Southwesterly

300. East End Center of the Mineral Creek Lode - W. E. C. Spack

513. 64 to Cor: N<sup>o</sup> 4 identical with the Southwest corner of the location. - A pine post, 4 1/2 feet long, 4 in. square, set 18 inches in the ground with mound of stone, scribed Cor: 4. G. I. 1581. - No bearings available. -

Thence



# Mineral Survey No. 1581. —

Bearing North  $71^{\circ} 20'$  East  
Variation  $13^{\circ} 45'$  East  
along the North Polar Side Line of the Globe

- 30. ~~Wagon~~ Road bears Northwesterly and Southeasterly
  - 203. <sup>60</sup> ~~Wagon~~ ~~East~~ ~~Center~~, identical with the location. — A pine post,  $4\frac{1}{2}$  feet long, 4 inches square, set 18 inches in the ground with mound of stone marked S. S. C.  $\approx$  G. I. 1581. — No bearings available.
  - 407. <sup>30</sup> to Cor. No. 1. The place of beginning. —
-



Location.

The Rainey, Vindicator, Sooner, Saturne, Satellite, Thomas Contention, Truman and Grace L. Lodes are located on unurveyed land, approximately in Township 3 South, Range 13 East Gila and Salt River Meridian in Mineral Creek Mining District Pinal County, Territory of Arizona, adjoining the Ray Copper Mine as more particularly shown and described on the accompanying plat and field notes. —

The nearest post office is Ray P. O. about 1000 feet Southwesterly from Cor. N<sup>o</sup> 2. of the Vindicator Lode. —

Expenditure of Five Hundred Dollars.

I certify, that the value of the labor and improvements upon these claims placed thereon by the claimant and his grantors is not less than Five Hundred Dollars for each claim and that said improvements consist of:

Rainey Lode.

- N<sup>o</sup> 1. Accessory open cut 4 x 6 feet, 15 feet long, the face of which bears from West End Center N. 78° 50' East 75 feet, 4 feet wide 6 feet face 15 feet long running N. 78° 50' E. — all in rock. Value \$ 100. 00. —
- N<sup>o</sup> 2. A Shaft, 5 x 7 feet, 12 feet deep, which bears from West End Center N. 68° East 318 feet dist. Value \$ 100. 00. —
- N<sup>o</sup> 3. Cut open cut the face of which bears from West End Center N. 53° 30' East 212 feet dist. 4 feet wide, 5 feet face, 20 feet long, running East Value \$ 100. 00. —



# Mineral Survey No. 1581.

19<sup>17</sup>

## Rainey Lode continued:

- N<sup>o</sup>. 4. A Shaft, 5 x 7 feet, 13 feet deep, white bear from the West End Center of the claim South 84° East, 218 feet dist: Value \$ 100. 00. -
- N<sup>o</sup>. 5. A Shaft, 5 x 7 feet, 12 feet deep, white bear from the West End Center of the claim N. 61° East 480 feet dist: Value \$ 100. 00. -

Total Value Rainey Lode: \$ 500. 00.

## Vindicator Lode:

- N<sup>o</sup>. 1. Recovery Shaft, 5 x 6 feet, 25 feet deep, the center of white bear from the North End Center of the claim S. 18° 30' E. - 490 feet dist: all in rock value \$ 300. 00. -
- N<sup>o</sup>. 2. A Shaft, 7 x 8 feet, 33 feet deep, all in rock, the center of white bear from the North End Center of the claim N. 34° 10' East 612 feet dist: Value \$ 750. 00.
- N<sup>o</sup>. 3. An open cut, the face of white bear from the North End Center of the claim S. 35° East 412 feet dist: 4 feet wide, 6 feet face running East 10 feet with shaft in center of cut 4 x 6 feet, 6 feet deep Value \$ 100. 00. -
- N<sup>o</sup>. 4. An open cut, the face of white bear from the Cor: N<sup>o</sup>. 1. N. 50° 30' East 283 feet dist: 4 feet wide 6 feet face, running 10 feet N. 20° East with extension funnel 4 x 6 feet running N. 20° East 42 feet Value \$ 400. 00.
- N<sup>o</sup>. 5. An open cut, and funnel, the face of white bear from Cor: N<sup>o</sup>. 1. N. 53° East 212 feet dist: 4 feet wide, 6 feet face, running N. 25° East 12 feet, Value \$ 100. 00.

Total value Vindicator: \$ 1650. 00.



Satellite Lode:

No 1. Discovery Shaft 4 x 6 feet 13 feet deep, which bears from the South End Center N. 18° 30' West 500 feet, all in rock Value \$ 100. 00.

No 2. An open cut the face of which bears from Cor. No 4. N. 38° West 450 feet dist., 8 feet wide, 5 feet face running N. 20° West 18 feet Value \$ 200. 00. —

No 3. An open cut the face of which bears from Cor. No 1. N. 45° E. — 200 feet dist. 10 feet wide, 6 feet face, running N. 45° E. 20 feet, all in rock Value \$ 200. 00.

No 4. A Shaft 4 x 6 feet 12 feet deep, all in rock, the center of which bears from Cor. No 4. N. 38° West 210 feet. \$ 100. 00.

Total value Satellite \$ 600. 00.

Thomas Lode:

No 1. Discovery Shaft 4 x 6 feet 12 feet deep all in rock, the center of which bears from the West End Center N. 71° 30' E. — 300 feet dist. Value \$ 100. 00.

No 2. A Shaft 7 x 6 feet 18 feet deep all in rock, the center of which bears from West End Center North 81° East 330 feet Value \$ 250. 00.

No 3. A Shaft 7 x 6 feet 19 feet deep all in rock, the center of which bears from West End Center North 86° East 305 feet dist. Value \$ 250. 00.

Total value Thomas Lode \$ 600. 00.



Jovier Lode.

- No 1. Discovery Shaft 4 x 6 feet 12 feet deep, white  
 bears from the North End Center of the claim  
 South 18° 30' East, 500 feet dist. value \$ 100. 00.
- No 2. Cu open cut with Tunnel The face of white  
 bears from the Center of the Discovery Shaft  
 S. 86° East 200 feet dist. 10 feet wide, 6  
 feet face running East 18 feet Value \$ 200. 00. -
- No 3. Cu open cut 8 x 10 x 10 feet <sup>the face of</sup> white bears  
 from the Center of the Discovery Shaft North  
 20° 30' East 150 feet dist. same East  
 Value \$ 200. 00.

Total value Jovier Lode \$ 500. 00. -

Saturn Lode.

- No 1. Discovery Shaft 5 x 6 feet 12 feet deep, The  
 Center of white bears from the North End  
 Center of the claim S. 18° 30' East  
 75 feet dist. Value \$ 100. 00.
- No 2. Cu open cut, the face of white bears from  
 Cor. No 2. South 39° East 330 feet  
 dist. 4 feet wide, 6 feet face, running  
 South 25 feet Value \$ 150. 00. -
- No 3. Cu open cut and tunnel, The face of white  
 bears from the Center of the Discovery Shaft  
 South 51° East 270 feet dist. 4 feet  
 wide, 6 feet face, running South 18° East 22 feet  
 Value \$ 175. 00
- No 4. Cu open cut 6 x 10 feet 16 feet long,  
 all in rock, The face of white bears  
 from the Discovery Shaft South 90° 30' E. -  
 270 feet. 10 feet wide 6 feet face,  
 running S. 18° East 16 feet  
 Value \$ 250. 00.

Total value Saturn \$ 675. 00.



Conteration Lode.

- No. 1. Discovery Shaft 4 x 6 feet - 12 feet deep all in rock. The center of which bears from the West End center of the claim North 70° East 750 feet dist. Value \$ 100. 00.
- No. 2. An open cut the face of which bears from the center of the Discovery Shaft North 84° East 320 feet dist. 5 feet wide, 8 feet face running East 12 feet. Value \$ 100. 00.
- No. 3. A Shaft 5 x 6 feet 20 feet deep, all in rock, the center of which bears from center of Discovery Shaft South 80° East 350 feet dist. Value \$ 200. 00. -
- No. 4. To be credited from expenditure for Tunnel No. 4. of the Indicator \$ 100. 00.

Total value Conteration \$ 500. 00.

Truman Lode.

- No. 1. Discovery Shaft 4 x 6 feet - 12 feet deep, the center of which bears from West End center N. 70° East 750 feet dist. Value \$ 100. 00. -
- No. 2. A Shaft 5 x 7 feet 11 feet deep, the center of which bears from the North Side Line center South 82° East 550 feet, all in rock - Value \$ 100. 00. -
- No. 3. An open cut the face of which bears from the N. Side Line center S. 72° East 620 feet dist. 5 feet wide, 8 feet face running East 27 feet all in rock. Value \$ 200. 00.
- No. 4. To be credited from expenditure for Tunnel No. 4. of the Indicator \$ 100. 00.

Total value Truman \$ 500. 00.



Grace L.

- No 1. Discovery Cut, The face of which bears from the North Side Leister S. 14° 40' E. 200 feet, 6 feet wide, 8 feet face, running S. 14° 40' East 15 feet  
Value \$ 100. 00.
- No 2. A. Tunnel, The mouth of which bears from the East End Leister of the Mineral Creek Lode N. 49° East 274' (= 274') feet running East 54 feet all in  
Value \$ 500. 00.

Total Value Grace L \$ 600. 00.

Recapitulation of values of improvements:

Prairie Lode Value \$ 500. 00.

Widener Value \$ 1650. 00.

Less \$ 200. 00. To be credited to the Contention and Truman Lode with

\$ 100. 00 each \$ 200. 00.

	Net Value \$	
Luner	Value \$	1450. 00
Saturn	Value \$	500. 00
Satellite	"	675. 00
Thomas	"	600. 00
Contention	"	600. 00
Truman	"	500. 00
Grace L.	"	500. 00

Total value of all improvements \$ 5925. 00.



# Mineral Survey No 1581.

24

The tunnel described and included in the estimate of expenditure under No 4 of the Indicator, continued in its present course will also cut the veins of the Contention and Truman Lode at great depth, whereby by one system of workings and one plant of machinery the entire claim can be most advantageously and economically developed and therefore from the expenditure of this tunnel \$2,000.00 must be credited to the Contention and \$100.00 to the Truman Lode. —

Note: J. W. Thomas, who appears as a locator of the Saturne and Satellite lodes no interest directly or indirectly in these claims at the time of making the survey having sold out his interests.

The bearing and distance of the different veins from the discovery shafts are as follows:

Rainey: South  $79^{\circ} 50'$  West 750 feet and N.  $78^{\circ} 30'$  E. 750 feet

Indicator: N.  $18^{\circ} 30'$  West 490 feet and S.  $18^{\circ} 30'$  E. 1004 feet

Lozier: N.  $18^{\circ} 30'$  West 500 feet and S.  $18^{\circ} 30'$  E. 1000 feet

Saturne: N.  $18^{\circ} 30'$  W. 675 feet and S.  $18^{\circ} 30'$  E. 750 feet

Satellite: N.  $18^{\circ} 30'$  W. 1475 feet and S.  $18^{\circ} 30'$  E. 570 feet

Grace L: N.  $75^{\circ} 20'$  E. 203.2 ft feet and S.  $75^{\circ} 20'$  W. 103.2 feet

Thomas S.  $71^{\circ} 30'$  West 800 feet and N.  $71^{\circ} 30'$  E. 1200 feet

Contention S.  $71^{\circ} 30'$  W. 750 feet and N.  $71^{\circ} 30'$  E. 750 feet

Truman S.  $71^{\circ} 30'$  W. 750 feet and N.  $71^{\circ} 30'$  E. 750 feet



# Mineral Survey No. 1581.

		Total	Net
		Area:	
<u>Area.</u>			
1,	Total area Rainey Lode: Less conflict with the Vindicator: <u>Net area Rainey Lode</u>	✓ 20. 00. ✓ 1. 53. -	19. 13.
2,	<u>Total and net area Vindicator:</u>		20. 00.
3,	Total area Loomer Lode Less conflict with the Rainey <u>Net area Loomer Lode:</u>	✓ 20. 00. - ✓ 1. 25. -	19. 41. -
4,	Total area Saturn Lode Less conflict with the Rainey <u>Net area Saturn Lode:</u>	✓ 20. 00. ✓ 0. 24. -	20. 42. -
5,	<u>Total and net area Satellite:</u>		✓ 20. 00. -
6,	Total area Thomas Lode: Less conflict with the Native Copper " " " " " " " " " " " " <u>Net area Thomas Lode:</u>	✓ 20. 00. ✓ 1. 06. 18	<del>19. 50. -</del> 19. 42
7,	Total area Contention Lode: Less conflict with the Native Copper: <u>Net area Contention Lode:</u>	✓ 20. 00. - ✓ 4. 26. -	10. 40. -
8,	<u>Total and net area Truman Lode</u>		20. 00. -
9,	Total area Grace L. Lode <del>Less conflict with the Thomas</del> <u>Net area Grace L. Lode</u>	4. 6650. <del>0. 1021.</del>	<del>4. 48.</del> 4. 6650
<u>Total and net area of all claims ./. .</u>			<u>101. 42.</u>

2006  
124  
79.42

Charles von Döbeln  
United States Deputy Mineral  
Surveyor.



# Mineral Survey No 1581.

## Instrument:

This survey was made with a Gurley Equipped Transit with Saegemittler's Patent Solar Attachment. The courses were deflected from the true Meridian as determined by Mineral Survey No 1244 compared with direct Solar Observations. The distances were measured with 100 feet Steel tapes. —

Muron, September 30<sup>th</sup> 1901.

Charles von Arden

N. S. Deputy Mineral Surveyor.



# Mineral Survey No 1581.

## Calculations of Area:

Sta.	Bearing	Dist.	Latitude		Departure		S. M. D.	Area:	
			N.	S.	E.	W.		+	-
<u>Rayney Lode.</u>									
1,	N. 78° 50' E.	1500.	290.50	-	1471.60	-	1471.60	427499.80	-
2,	S. 11° 10' E.	600.	-	588.64	116.20	-	3059.40	1,870,885.216	-
3,	S. 78° 50' W.	1500.	-	290.50	-	1471.60	1704.00	495012.000	-
4,	N. 11° 10' W.	600.	588.64	-	-	116.20	116.20	68399.968	-
								495,899,768.	2,295,897,216
									495,899,768
								2.)	1,799,997,448.
								43560.)	899,998,724.
									20.66 acres.
<u>Less Conflict with Vindicator:</u>									
1.	N. 18° 30' W.	129.56	122.86	-	-	41.11	+ 860.07	105,668,2002.	-
2.	S. 78° 50' W.	417.38	-	80.83	-	409.48	+ 409.48	83,098,2684.	-
3.	S. 11° 10' E.	184.34	-	180.85	35.70	-	+ 135.70	6456.345.	-
4.	N. 71° 30' E.	437.50	138.82	-	414.89	-	+ 486.29	67,506,7778.	-
			261.68	261.68	450.59	450.59		173,174,9780.	139,554,6134.
								39,554,6134.	-
								2.)	133,620,3646.
								43560.)	66810,1823. = 1.53 acres.
Total area Rayney 20.66 acres Less conflict with Vindicator 1.53 acres Net area Rayney 19.13 acres.									

## Vindicator Lode:

1,	N. 18° 30' W.	1500.	1422.486	-	-	475.957	- 475.957	677,042,1691.	-
2,	N. 71° 30' E.	600.	190.383	-	568.994	-	+ 568.994	108,326,7847.	-
3,	S. 18° 30' E.	1500.	-	1422.486	475.957	-	+ 1613.945	2,295,814,1673.	-
4,	S. 71° 30' W.	600.	-	190.383	-	568.994	+ 1520,908.	289,565,0278.	-
								785,368,9538.	2,585,369,1951.
									785,368,9538
								2.)	1,800,000,2413
								43560.)	900,000,12065.
Total and net area "Vindicator" = 20.66 acres.									



# Mineral Survey No 1581 28

Sta.	Bearing:	Dist.	Latitude		Departure		S. M. S.	Area							
			N.	S.	E.	W.		+	-						
<u>Looner Lode:</u>															
The Calculation of area is the same as of the Vindicator: 20.00 acres Less conflict with the Rayney Lode:															
1.	N. 18° 30' W.	52.35	49.64	-	-	16.61	16.61	824.5204							
2.	S. 78° 50' W.	604.95	-	117.16	-	593.50	626.72	74.326.5152							
3.	S. 18° 30' E.	129.56	-	122.86	41.11	-	1179.11	144.865.4546							
4.	N. 71° 30' E.	600.00	190.38	-	579.000	-	579.00	-	108.326.2202						
								240.02	240.02	610.11	610.11	-	218.291.9698	109.150.7404	
														109.150.7404	

2.) 109.141.2294

43560 ) 54.570.6147 = 1.25 acres

Total area Looner Lode: 20.00 acres  
Less conflict with the Rayney 1.25 "

Net area Looner: 19.41 acres

## Saturn Lode:

The Calculation of area is the same as of the Vindicator: 20.00 acres Less Conflict with the Rayney:															
1.	N. 18° 30' W.	52.35	49.64	-	-	+16.61	+16.61	824.5204							
2.	N. 78° 50' E.	410.17	79.44	-	402.40	-	+402.40	31966.6560							
3.	S. 71° 30' W.	406.81	-	129.08	-	385.79	+419.01	54.085.8108							
								129.08	129.08	402.40	402.40	-	32791.1764	54.085.8108	
														32.791.1764	
														21294.6344	

43560 ) 10647.3172 = 0.24 acres

Total area Saturn Lode 20.00 acres  
Less conflict with Rayney 0.24 "

Net area Saturn: 20.42 acres



# Mineral Survey No. 1581

29

Sta.	Course	Dist.	Latitude		Departure		D. M. D.	Area	
			N.	S.	E.	W.		+	-

## Satellite Lode:

The calculation of area is the same as of the Vindicator. —

Total and net area of the Satellite Lode is 20.66 acres

## Thomas Lode:

1 <sub>1</sub>	N. 71° 30' E.	1500.	475.957.	—	1422.486	—	1422.486.	677.042.1691.	—
2 <sub>1</sub>	S. 18° 30' E.	400.	—	568.994.	190.383.	—	3035.355.	—	1727098.7829
3 <sub>1</sub>	S. 71° 30' W.	1500.	—	475.957.	—	1422.486.	1803.252.	—	858.270.4122.
4 <sub>1</sub>	N. 18° 30' W.	600.	568.994.	—	—	190.383.	190.383.	108.326.7847	—
			1044.951.	1044.951.	1612.869.	1612.869.	—	785.368.9538	2.585.269.1951.
							—	—	785.368.9538.

2.) 1800000.2413

43560.) 900.000.12065.

= 20.66 acres

Less conflict with the Native Copper = 1.06 "

Net area of the Thomas: = 19.60 acres

1 <sub>1</sub>	N. 18° 30' W.	112.50.	106.69.	—	—	35.70.	35.70.	3708.8530.	—
2 <sub>1</sub>	N. 71° 30' E.	374.96.	118.99.	—	355.58.	—	355.58.	42310.4662	—
3 <sub>1</sub>	S. 14° 40' E.	137.33.	—	132.86.	34.77.	—	745.93.	—	99104.2598
4 <sub>1</sub>	S. 75° 20' W.	366.60.	—	92.82.	—	354.65.	426.05.	—	39541.9710.
			225.68	225.68.	390.35.	390.35	—	46019.3192.	138.646.0303

46.019.3192

2.) 92627.7116.

43560.) 46313.8558

= 1.0632 acres

Total area Thomas Lode: 20.66 acres

Less conflict with the Native Copper 1.06 "

Net area Thomas 19.60 acres



# Mineral Survey No 1581.

Sta.	Course	Dist.	Latitude		Departure		S. M. D.		Area			
			N.	S.	E.	W.			+	-		
<u>Conteration Lode.</u>												
The calculation of the area is the same as of the Thomas = 20.00 acres.												
less conflict with the Native Copper												
1.	N. 18° 30' W.	488.85	463.59	-	-	155.11	+ 155.11	71.907	4449	-		
2.	N. 75° 20' E.	406.80	103.00	-	393.54	-	+ 393.54	40.534	6200	-		
3.	S. 14° 40' E.	462.67	-	447.60	117.15	-	+ 904.23	-	404733	3480		
4.	S. 71° 30' W.	274.96	-	118.99	-	255.58	+ 665.80	-	79223	5420		
		566.59	566.59	570.69	510.69	-	-	112.442	0649	483.956	8900	
										112.442	0649	
										2)	371.514	8251
										43560)	185757	4125
										=	4.2643	acres

Total area of the Conteration Lode = 20.00 acres.  
 Conflict with the Native Copper = 4.26 "  
Net area of the Conteration: 16.40 acres.

## Truman Lode:

The calculation of the area is the same as of the Truman Lode. -

Total and Net area of the Truman  
 = 20.00 acres.



# Mineral Survey No 1581.

Sta.	Course:	Dist.	Latitude		Departure		S. M. D.	Area:	
			n.	s.	e.	w.		+	-

## Grace L. Lode.

1.	N. 14° 40' W.	486.41.	470.56.	-	-	123.16.	123.16.	-	57,954.1696
2.	S. 75° 20' W. -	406.40.	-	102.90	-	393.16.	639.48.	65,802.4920	-
3.	S. 14° 40' E.	573.64.	-	496.90.	120.05.	-	902.59.	448496.9710	-
4.	N. 71° 30' E.	407.32.	129.24.	-	386.27.	-	386.27.	-	49921.5348
			599.80.	599.80.	576.32.	576.32.	-	514,299.4630.	107,875.7044

107,875.7044  
 406,423.7586  
 203,211.8793.  
 = 4.6650 acres.

### Less conflict with the Thomas:

1.	N. 18° 30' W.	487.50.	462.31.	-	-	154.69.	154.69.	-	71514.7339.
2.	N. 75° 20' E. -	32.59.	8.26.	-	31.33.	-	277.85	-	2295.0410.
3.	S. 14° 40' E. -	486.41.	-	470.57.	123.16.	-	123.16.	57955.4012	-
			470.57.	470.57.	154.69.	154.69.	-	-	73,809.7749

2) 15854.3737.  
 43560) 7979.18685.  
 = 0.1831 acres.

Total area of the Grace L. Lode = 4.6650 acres  
 Less conflict with the Thomas. . . . . 0.1831 acres

Net area of the Grace L. = 4.4819 acres.



# FINAL OATHS FOR SURVEYS.

## LIST OF NAMES.

A list of the names of the individuals employed by Charles von Melebeu  
 United States Deputy Mineral Surveyor, to assist in running, measuring, and marking the lines  
 corners and boundaries described in the foregoing field notes of the survey of the mining claim  
 of G. G. Whiteford  
 known as the Rainey, Vindicator, Ironer, Saturn, Satellite, Grace L. Thomas, Custeution & Truman  
 and showing the respective capacities in which they acted.

- J. W. Thomas, Chairman.
- A. P. Anderson, Chairman.
- Pedro Pica, Axman.
- Alberto Lopez, Flagman.

## FINAL OATHS OF ASSISTANTS.

We A. P. Anderson Pedro Pica  
 and Alberto Lopez, do solemnly swear that we assisted Charles von  
Melebeu, United States Deputy Mineral Surveyor, in marking the corners and  
 surveying the boundaries of the mining claim of G. G. Whiteford

Rainey, Vindicator,  
Ironer, Saturn, Satellite, Grace L. Thomas, Custeution & Truman, known as the Rainey, Vindicator,  
 represented  
 in the foregoing field notes as having been surveyed by said deputy mineral surveyor and under  
 his direction; and that said survey has been in all respects, to the best of our knowledge and  
 belief, faithfully and correctly executed, and the corner and boundary monuments established  
 according to law and the instructions furnished by the United States Surveyor-General for  
Arizona.

- J. W. Thomas, Chairman.
- A. P. Anderson, Chairman.
- Pedro Pica, Axman.
- Alberto Lopez, Flagman.

Subscribed and sworn to by the above-named persons before me  
 this 26<sup>th</sup> day of July, 1904.

My commission expires  
January 29<sup>th</sup> 1905.

Charles von Melebeu  
 Notary Public.



FINAL OATH OF U. S. DEPUTY MINERAL SURVEYOR

I, Charles von Szeleben, U. S. Deputy Mineral Surveyor, do solemnly swear that, in pursuance of instructions received from the United States Surveyor General for Arizona, dated July 8<sup>th</sup> 1901, I have, in strict conformity to the laws of the United States, the official regulations and instructions thereunder, and the instructions of said Surveyor General, faithfully and correctly executed the survey of the Mining Claim of G. E. Whiteford per W. C. Truman Florence, Agent, known as the Rainey, Vindicator, Loner, Saturn, Satellite, Grace & Thomas, Contention & Truman situate in Mineral Creek Mining District, Sinal County, Arizona, in Section \_\_\_\_\_, Township No. \_\_\_\_\_, Range No. \_\_\_\_\_ and designated as Survey No. 1581, as represented in the foregoing field notes, which accurately show the boundaries of said mining claim as distinctly marked by monuments on the ground, and described in the attached copy of the location certificate, which was received by me from the Surveyor General with said instructions, and that all the corners of said survey have been established and perpetuated in strict accordance with the law, official regulations and instructions thereunder; and I do further solemnly swear that the foregoing are the true and original field notes of said survey and my report therein, and that the labor expended and improvements made upon said mining claim by claimant or his grantors are as therein fully stated, and that the character, extent, location and itemized value thereof are specified therein with particularity and full detail, and that no portion of said labor or improvements so credited to this claim has been included in the estimate of expenditures upon any other claim.

Charles von Szeleben  
U. S. Deputy Mineral Surveyor.

Subscribed and sworn to by the said Charles von Szeleben  
U. S. Deputy Mineral Surveyor Before me J. H. Miller  
a Notary Public this 20<sup>th</sup>  
day of September 1901.

J. H. Miller  
Notary Public  
My commission expires  
April 19<sup>th</sup> 1902.



Affidavit of Five Hundred Dollars Improvements.

we, J. W. Thomas, and A. P. Anderson

of lawful age, being first duly sworn according to law, depose and say: that we are acquainted with the Rainey, Vindicator, Sooner, Saturn, Satellite, Grate L, Thomas, Contention & Thomas mining claims, situate in Mineral Creek Mining district, Yuma County, Arizona Territory, for which G. A. Whiteford

has made application for survey prior to application for patent under the provisions of the Act of Congress, approved May 10, 1872; and that the labor done and improvements made thereon by the applicant and his grantor exceed Five Hundred Dollars in value, for each claim and further that we are not personally interested in said mine.

J. W. Thomas  
A. P. Anderson

TERRITORY OF ARIZONA, }  
County of Yuma } ss:

Sworn to and subscribed before me, this 26<sup>th</sup>

day of July, 1891  
Charles von Reichen

Notary Public.

My commission expires  
January 29<sup>th</sup> 1905.



M.S. 1581

**LOCATION NOTICE.**—Printed and for sale at the TRIBUNE Office, Florence, Arizona.

Notice is hereby given that the Rainey Lode  
 Mining claim, containing mineral bearing quartz, earth or rock, in place, located by  
Nicholas Mathias  
 on this Third day of February, 1899, has been located for mining purposes.  
 Said claim is 1250 feet in length, and 300 claim 300 feet on  
 each said of the discovery shaft, for full length of claim. The general course of the lode, deposit or premises  
 is Easterly & Westerly  
 This claim is situated in the Mineral Creek Mining District  
Pinal County, Arizona, about 800 yards in a Northerly  
 direction from The Reed Mineral Monument  
 # 1.

This claim is bounded and marked as follows, to-wit: Beginning at the West  
 center end of claim being 500 feet Westerly of the discovery  
 shaft, upon which this notice is posted; thence 300 feet in a Northerly  
 direction to a post or monument; thence 625/750 feet in a Easterly direction  
 to a post or monument at the center of the North side of said claim; thence 625/750 feet in a  
Easterly direction to a post or monument; thence 300 feet in a  
Southerly direction to a post or monument, being the center end post or monument of  
East end of said claim, and 750 feet from the discovery shaft; thence 300 feet in a  
Southerly direction to a post or monument; thence 625/750 feet in a Westerly  
 direction to a post or monument, being the center of the South  
 side of claim; thence 625/750 feet in a Westerly direction to a post or monument;  
 thence 300 feet in a Northerly direction to the place of beginning.

Done under and by virtue of the laws of the United States, and the laws of the Territory of Arizona.

Witness:  
G. A. Whiteford  
E. G. Thomas

Nicholas Mathias Ls.  
 \_\_\_\_\_ Ls.  
 \_\_\_\_\_ Ls.  
 Locators.

Filed and recorded at request of G. A. Whiteford  
 on this 4 day of February A.D. 1899, at 2 P.M.  
F. A. Chamberlin Recorder  
 By Thos. G. Peyton Deputy



Territory of Arizona )  
 )  
 County of Pinal )S.S.

I the undersigned, Thos G. Peyton County Recorder  
 in and for the county of Pinal and Territory of Arizona  
 do hereby certify the within and foregoing to be a full, true and  
 correct copy of the Rainey Mining claim as t e same appears of  
 record in Book No. 15 Records of Mines at Page 373 thereof.

Records of Pinal County Arizona.

Witness my hand and official seal this 3rd. day of  
 August 1901.

*Thos. G. Peyton*  
 Recorder Pinal Co  
 Ariz. Terr.



# Amended Location Certificate

Territory of Arizona }  
 County of Pinal } ss

Know all men by these Presents, That, We G. A. Whitford and M. P. Dunham the undersigned, have this 6<sup>th</sup> day of February 1899, amended located, and claimed, and by these presents do amend, locate and claim, by right of discovery and amended location, in compliance with the mining Acts of Congress, approved, May 10<sup>th</sup>, 1872, and all subsequent acts and with the general laws of the Territory of Arizona, and with local customs, laws and regulations 1500 linear feet and horizontal measurement, on the Rainey lode, vein, ledge or deposit, along the vein thereof, with all its dips, angles and variations, as allowed by law, together with 300 feet on each side of the middle of said vein at the surface, so far as can be determined from present developments, and all veins, ledges, or deposits and surface ground within the lines of said claim 750 feet running Easterly from center of discovery point in cut and 750 feet running Westerly from center of discovery



point, said discovery point being situated upon said lode, vein, ledge, or deposit, and within the lines of said claim, in Mineral Creek Mining District, County of Pinal, and Territory of Arizona, described by meters and bounds as follows, to-wit: Beginning at the West center end monument, Thence 300 feet Northwesterly, Thence 750 feet Easterly, Thence 750 feet Easterly, Thence 300 feet Southerly to East end center, Thence 300 feet Southerly, Thence 750 feet Westerly, Thence 750 feet Westerly, Thence 300 feet Northwesterly to the west end center the place of beginning. This being the same lode or vein equally located on the 3rd day of February, 1899, and recorded of the 4th day of February 1899, in Book 15 page 373 of Mining locations, in the office of the Recorder of Pinal County. This further and amended certificate of location is made without waiver of any previously acquired rights, but for the purpose of correcting any errors in the original, location, description, or record.

G. A. Whitford  
M. P. Durham



Filed and recorded at request of  
 J. A. Whiteford on the 6 day of February  
 A.D. 1899. at 10 A.M.

F. A. Chamberlain Recorder  
 By Thos. G. Peyton Deputy

Territory of Arizona }  
 County of Pinal } ss

J. Thos G. Peyton

County Recorder in and for Pinal  
 County, Territory aforesaid, do here-  
 by certify that the above and foregoing  
 is a full, true and correct copy of  
 the Rainey mining claim as the  
 same appears of record in Book  
 No 15 Records of Mines at page 376  
 Records of Pinal County, Arizona  
 Territory. Witness my hand and  
 official seal this 5<sup>th</sup> day of July  
 A.D. 1901.

Thos. G. Peyton  
 County Recorder  
 Pinal County, Ariz



## Location Notice

### Quartz Claim.

To all whom it may Concern: We claim for mining purposes, 600 feet wide and 1500 feet long in the form of a parallelogram, monuments of stones at each corner, at the center of each end and center of each side, lines. This notice is placed in a monument at the discovery shaft 1004 feet from southerly end center of of claim. General direction  $N 18^{\circ} 30' W$ . Situated in Mineral Creek Mining District Pinal County Arizona, about 6 miles North from Riverside Post Office and on the East bank of Mineral Creek. Described by metes and bounds as follows, to-wit: Beginning at Cor No 1. from which Cor No 2 of Burbank Claim bears  $S, 36^{\circ} 40' W 195$  ft.

Thence  $S, 71^{\circ} 30' W 300$  ft to Cor No 2 a monument of stone  
 "  $N 18^{\circ} 30' W 750$  " " " " 3 " " "  
 "  $N 18^{\circ} 30' W 750$  " " " " 4 " " "  
 "  $N 71^{\circ} 30' E 300$  " " " " 5 " " "  
 "  $N 71^{\circ} 30' E 300$  " " " " 6 " " "  
 "  $S 18^{\circ} 30' E 750$  " " " " 7 " " "  
 "  $S 18^{\circ} 30' E 750$  " " " " 8 " " "  
 "  $S 71^{\circ} 30' W 300$  " " " " 1 place of beginning, and shall be known as the



71

"Vindicator" mine. Located January 1<sup>st</sup> 1897

W. C. Dunham Locator  
J. A. Whiteford Locator  
Filed and recorded at request of W. C. Dunham January 26<sup>th</sup> 1897, at 9 am  
F. A. Chamberlain Recorded  
by J. Thurston Deputy

Territory of Arizona }  
County of Pinal }<sup>ss</sup>

S. Thos G. Peyton  
County Recorder in and for Pinal County  
Territory aforesaid do hereby certify that  
the above and foregoing is a full, true  
and correct copy of the Vindicator  
Mining Claim as the same appears  
of record in Book No 14 Records of  
mines at page 495. Records of Pinal  
County, Arizona Territory.

Witness my hand and official seal this 5<sup>th</sup> day of July A.D. 1901

Thos. G. Peyton  
County Recorder  
Pinal County, Ariz



MINERAL SURVEY NO. 1581

Claims	M & B Desc.	Improvements	Loc. Notices
Contention	11	20	8
Grace L.	13	21	4
Rainey	1	16	1
Saturn	5	19	5
Satallite	7	18	6
Sooner	4	19	3
Thomas	9	18	7
Truman	12	20	9
Vindicator	2	17	2



# Notice of Mining Location.

## QUARTZ CLAIM.

To All Whom It May Concern:

This mining claim, the name of which is the Sooner Mining Claim, situate on lands belonging to the United States of America, and in which there are valuable mineral deposits, was entered upon and located for the purpose of exploration and purchase by W. P. Dunham and G. A. Whiteford

the undersigned, on the 29<sup>th</sup> day of June 1899.

The length of this claim is 1500 feet, and 7/8 claim 1000 feet in a Southerly direction and 500 feet in a Northerly direction from the center of the discovery shaft, at which this notice is posted, lengthwise of the claim, together with 300 feet in width of the surface grounds, on each side of the center of said claim. The general course of the lode deposit and premises is from the North to the South

The claim is situated and located in the Mineral Creek Mining District, in Pinal County, in the Territory of Arizona, about 1/2 mile in a Northerly direction from U. S. Min. Mon. No. 1 on Mineral Creek & on the East side of Mineral Cr.

The surface boundaries of the claim are marked upon the ground as follows: Beginning at a post & monument of stone

at a point in a Northerly direction 500 feet from the discovery shaft (at which this notice is posted), being in the center of the North end line of said claim; thence Easterly 300 feet to a post & mon. of stone, being the North East corner of said claim; thence Southerly 300 feet to a post & mon. of stone at the center of the East side line of said claim; thence Southerly 750 feet to a post & mon. of stone being at the South East corner of said claim; thence Westerly 300 feet to a post & mon. of stone at the center of the South end of said claim; thence Westerly 300 feet to a post & mon. of stone, being at the South West corner of said claim; thence Northerly 750 feet to a post & mon. of stone being at the center of the West side line of said claim; thence Northerly 750 feet to a post & mon. of stone at the North West corner of said claim; thence Easterly 300 feet to the place of beginning.

All done under the provisions of Chapter Six, of Title XXXII, of the Revised Statutes of the United States, and of an Act of the General Assembly of Arizona, entitled "An Act Concerning Mines," approved March 20th, 1895.

Note: Dated and posted on the ground this \_\_\_\_\_ day of \_\_\_\_\_ 189 \_\_\_\_\_

The West side line of this G. A. Whiteford claim is identical to the W. P. Dunham East side line of the Locators Vindicator claim. Wit. E. G. Thomas.



# An Act Concerning Mines.

*Be it Enacted by the Legislative Assembly of the Territory of Arizona:*

SECTION 1. Every notice of location of a mining claim shall contain: First, the name of the claim located; second, the name of the locator; third, the date of location; fourth, the number of feet in length of said claim and the number of feet claimed on each side of the center of the discovery shaft, lengthwise of the claim; fifth, the general course of the lode deposit of premises located; sixth, the locality of the claim with reference to some natural object, or permanent monument, as will identify the claim.

Sec. 2. All mining locations hereafter located, the certificate of location of which shall not contain: First, the name of the lode, or premises; second, the name of the locator, or locators; third, the date of location; fourth, the number of feet in length of said claim and the number of feet claimed on each side of the center of the discovery shaft, lengthwise of the claim; fifth, the general course of the lode, or premises, as near as may be; sixth, the locality of the claim with reference to some natural object, or permanent monument, as will identify the claim, shall be void.

Sec. 3. Before filing such location certificate with the County Recorder of the proper County, the discoverer shall locate his claim by: First, sinking a discovery shaft upon the premises so claimed, to a depth of at least ten feet from the lowest part of the rim of such shaft at the surface, and deeper if necessary, until there is shown by such work a lode deposit of mineral in place; second, by posting at the point of discovery, on the surface, a plain sign or notice substantially conforming to the location certificate; third, by marking such claim or premises on the ground, so that its boundaries can be readily traced.

Such surface boundaries shall be marked by **EIGHT** substantial **POSTS**, projecting at least **THREE FEET ABOVE THE SURFACE OF THE GROUND**, or by substantial **STONE MONUMENTS**, at least **THREE FEET HIGH**, to-wit: One at each corner of said claim, and one at the center of each end and side line thereof.

Sec. 5. Any open-cut, cross-cut, adit or tunnel which shall be made as above provided for, as a part of the location of a mining claim, and which shall be equal in amount of work to a shaft ten feet deep and four feet wide by six feet long, and which shall cut a lode or mineral in place at the depth of ten feet from the surface, shall be equivalent, as a discovery work, to a shaft sunk from the surface.

Sec. 6. The discoverer shall have ninety days from the date of discovering the lode and the posting of the notice thereon, to perform said discovery work thereon.

Sec. 7. If at any time the locator of any mining claim heretofore or hereafter located, or his assigns, shall learn that his original certificate was defective, or that the requirements of the law had not been complied with before filing, or shall be desirous of changing his surface boundaries, or of taking in any additional ground which is subject to location, or in case the original certificate was made prior to the passage of this law, and he shall be desirous of securing the benefits of this Act, such locator, or his assigns, may file an amended certificate of location subject to the provisions of this Act, regarding the making of new locations.

Sec. 8. The amount of assessment, or representation, work or improvements to be done or made during each year, after the completion of the location as heretofore provided, and the time for doing the same, shall be as provided by the laws of the United States.

Sec. 9. Within three months after the expiration of the period of time fixed for the performance of annual labor or the making of improvements upon any mining claim or premises, the person on whose behalf such work or improvement was made, or some person for him, knowing the facts, may make and record in the office of the County Recorder of the county wherein such claim is situate an affidavit in substance as follows:

TERRITORY OF ARIZONA,

County, } ss.

..... being duly sworn deposes and says, that he is a citizen of the United States, and more than 21 years of age, and resides at ..... in ..... County, Arizona Territory, and is personally acquainted with the mining claim and premises located and known as ..... Mining District, County of ..... Arizona Territory; that notice of location of which premises is recorded in the office of the County Recorder of said county, in Book ..... of Records of Mines, at page .....; that between the ..... A. D. 189..... and the ..... A. D. 189..... at least ..... dollars worth of work and improvements were done and performed upon said premises or lode, not including the location work of said claim. Such work and improvements were made by and at the expense of ..... owners of said premises for the purpose of complying with the law of the United States pertaining to assessments or annual work, and (here name the miners or men who worked upon the claim in doing the work) were the men employed by said owner and who labored upon said premises, and who did said work and improvements, and said work so done upon said premises is described as follows, to-wit: (Here describe the work done.)

Subscribed and sworn to before me, ..... this ..... day of ..... 189..... (Signature.)

[SEAL] Notary Public.

Sec. 10. Such affidavit when so recorded shall be *prima facie* evidence of the performance of such labor or the making of such improvements, and said original affidavit after it has been recorded, or a certified copy of record of same, shall be received as evidence accordingly by all the Courts of this Territory.

Sec. 11. The relocation of forfeited or abandoned lode claims shall only be made by sinking a new discovery shaft and fixing new boundaries in the same manner and to same extent as is required in making a new location; or the locator may sink the original discovery shaft ten feet deeper than it was at date of commencement of such relocation, and shall erect new or make the old monuments the same as originally required. In either case a new location monument shall be erected, and the location certificate shall state if the whole or any part of the new location is located as abandoned property.

Sec. 12. This Act shall take effect and be in force from and after July 1st, 1895.  
Sec. 13. All Acts and parts of Acts in conflict with this Act are hereby repealed.

This diagram is to give locator a general idea of plan of location under the new law. The Discovery Shaft can be in the center of claim or any distance from either end described. In the diagram it is placed 500 feet from one end and 1000 feet from the other. Commence description of claim at a center end monument, giving its distance and direction from center of Discovery Shaft; thence bound the claim in either direction. In description be careful to state locality of claim with reference to some natural object, or permanent monument, as will identify the claim.

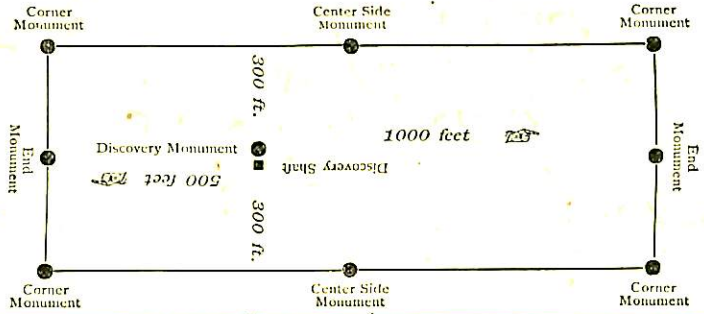

## Notice of Location. QUARTZ CLAIM.

J. Small

Dated June 29 1899

Filed and recorded at request of

Ed. J. Harwood

the 10th day of

August A. D. 1899

at 1 P. M.

Book 16 of Mines

Pages 300

7. A Chamberlain

County Recorder.

By J. S. Carpenter  
Deputy Recorder.

County Recorder.

TERRITORY OF ARIZONA, }  
County of, } ss.

I, ..... County Recorder in and for the County and Territory aforesaid, do hereby certify that the within instrument was filed for record at ..... o'clock, ..... M., on this ..... day of ..... 189....., and duly recorded in Book No. .... of ..... County, Arizona, at pages ..... of .....  
WITNESS my hand and official seal the day and year first above written.

County Recorder.



Territory of Arizona }  
County of Pinal } ss

J. Thos G. Peyton  
County Recorder in and for Pinal  
County, Territory aforesaid do hereby  
certify that the above and foregoing  
is a full, true and correct copy of  
the Loned mining claim as the same  
appears of record in Book No 16 Re-  
cords of Mines at page 300 Records  
of Pinal County, Arizona Territory  
Witness my hand and  
official seal this 17<sup>th</sup> day of July  
AD 1901.

Thos. G. Peyton  
Recorder  
Pinal County, Ariz

charges 75¢



# Notice of Mining Location.

QUARTZ CLAIM.

To All Whom It May Concern:

This mining claim, the name of which is the Grace L.  
Mining Claim, situate on lands belonging to the United States of America, and in which there are valuable mineral  
mineral deposits, was entered upon and located for the purpose of exploration and purchase by  
Edward G. Thomas

the undersigned, on the 24 day of June 1899.  
The length of this claim is about 500 feet,  
and 3 claim Three Hundred (300) feet  
in a Northerly direction and Two  
Hundred (200) feet in a Southerly direction from  
the center of the discovery shaft, at which this notice is posted, lengthwise of the claim, together with  
about 175 feet in width of the surface grounds, on each side of the center of said  
claim. The general course of the lode deposit and premises is from the North  
to the South.

The claim is situated and located in the Mineral Creek Mining District, in  
Pinal County, in the Territory of Arizona, about 3000 ft  
in a Northerly direction from U.S. Min. Mon. No.  
on Mineral Creek, and on the East side of said creek.

The surface boundaries of the claim are marked upon the ground as follows: Beginning at  
a mon of stones

at a point in a Northerly direction 300 feet from  
the discovery shaft (at which this notice is posted), being in the center of the North  
end line of said claim; thence Easterly 175 feet to a mon of  
stones, being the North East corner of said claim; thence  
Southerly 250 feet to a mon of stones at the center of  
the East side line of said claim; thence Southerly 250  
feet to a mon of stones being at the South East corner of said  
claim; thence Westerly 175 feet to a mon of stones  
at the center of the South end of said claim; thence Westerly 175  
feet to a mon of stones, being at the South West  
corner of said claim; thence Northerly 250 feet to a mon of  
stones, being at the center of the West side line of said claim;  
thence Northerly 250 feet to a mon of stones at  
the North West corner of said claim; thence Easterly 175  
feet to the place of beginning.

All done under the provisions of Chapter Six, of Title XXXII, of the Revised Statutes of the United States, and of  
an Act of the General Assembly of Arizona, entitled "An Act Concerning Mines," approved March 20th, 1895.

Dated and posted on the ground this Tweaty Fourth day of June 1899

Edward G. Thomas  
Locater  
Wm. J. Thomas

Note: This claim is a fraction of ground included between the "Native Copper" on the north  
the "Thomas" on the East, the "Globe" on the South, and the "Mineral Creek" on the west.



# An Act Concerning Mines.

*Be it Enacted by the Legislative Assembly of the Territory of Arizona:*

**SECTION 1.** Every notice of location of a mining claim shall contain: First, the name of the claim located; second, the name of the locator; third, the date of location; fourth, the number of feet in length of said claim and the number of feet claimed on each side of the center of the discovery shaft, lengthwise of the claim; fifth, the general course of the lode deposit or premises located; sixth, the locality of the claim with reference to some natural object, or permanent monument, as will identify the claim.

**SECTION 2.** All mining locations hereafter located, the certificate of location of which shall not contain: First, the name of the lode or premises; second, the name of the locator or locators; third, the date of location; fourth, the number of feet in length of said claim and the number of feet claimed on each side of the center of the discovery shaft, lengthwise of the claim; fifth, the general course of the lode or premises, as near as may be; sixth, the locality of the claim with reference to some natural object, or permanent monument, as will identify the claim, shall be void.

**SECTION 3.** Before filing such location certificate with the County Recorder of the proper County, the discoverer shall locate his claim by: First, sinking a discovery shaft upon the premises so claimed, to a depth of at least ten feet from the lowest part of the rim of such shaft at the surface and deeper if necessary, until there is shown by such work a lode deposit of mineral in place; second, by posting at the point of discovery, on the surface, a plain sign or notice substantially conforming to the location certificate; third, by marking such claim or premises on the ground so that its boundaries can be readily traced.

**SECTION 4.** Such surface boundaries shall be marked by **Eight** substantial Posts projecting at least **Three Feet Above the Surface of the Ground**, or by substantial **Stone Monuments** at least **Three Feet High**, to-wit: One at each corner of said claim, and one at the center of each end and side line thereof.

**SECTION 5.** Any open-cut, cross-cut, adit or tunnel which shall be made as above provided for, as a part of the location of a mining claim, and which shall be equal in amount of work to a shaft ten feet deep and four feet wide by six feet long, and which shall cut a lode or mineral in place at the depth of ten feet from the surface, shall be equivalent, as a discovery work, to a shaft sunk from the surface.

**SECTION 6.** The discoverer shall have ninety days from the date of discovering the lode and the posting of the notice thereon, to perform said discovery work thereon.

**SECTION 7.** If at any time the locator of any mining claim heretofore or hereafter located, or his assigns, shall learn that his original certificate was defective, or that the requirements of the law had not been complied with before filing, or shall be desirous of changing his surface boundaries, or of taking in any additional ground which is subject to location, or in case the original certificate was made prior to the passage of this law, and he shall be desirous of securing the benefits of this Act, such locator or his assigns, may file an amended certificate of location subject to the provisions of this Act, regarding the making of new locations.

**SECTION 8.** The amount of assessment, or representation, work or improvements to be done or made during each year, after the completion of the location as heretofore provided, and the time for doing the same, shall be as provided by the laws of the United States.

**SECTION 9.** Within three months after the expiration of the period of time fixed for the performance of annual labor or the making of improvements upon any mining claims or premises, the person on whose behalf such work or improvement was made, or some person for him, knowing the facts, may make and record in the office of the County Recorder of the county wherein such claim is situated an affidavit in substance as follows:

TERRITORY OF ARIZONA,  
 ..... County, ss  
 ..... being duly sworn deposes and says, that he is a citizen of the United States, and more than 21 years of age, and resides at ..... County, Arizona Territory, and is personally acquainted with the mining claim and premises located and known as ..... mining claim or lode, situated in ..... Mining District, County of ..... Arizona Territory, the notice of location of which premises is recorded in the office of the County Recorder of said county, in Book ..... of Records of Mines, at page .....; that between the ..... day of ..... A. D. 189..... and the ..... day of ..... A. D. 189..... and the ..... dollars worth of work and improvements were done and performed upon said premises or lode, not including the location work of said claim. Such work and improvements were made by and at the expense of ..... owners of said premises for the purpose of complying with the law of the United States pertaining to assessments or annual work, and (here name the miners or men who worked upon the claim in doing the work) were the men employed by said owner and who labored upon said premises and who did said work and improvements, and said work so done upon said premises is described as follows, to-wit: (Here describe the work done.)  
 ..... (Signature)  
 Subscribed and sworn to before me ..... this ..... day of ..... 189.....  
 ..... Notary Public.

[SEAL]  
**SECTION 10.** Such affidavit when so recorded shall be prima facie evidence of the performance of such labor or the making of such improvements, and said original affidavit after it has been recorded, or a certified copy of record of same, shall be received as evidence accordingly by all the Courts of this Territory.

**SECTION 11.** The relocation of forfeited or abandoned lode claims shall only be made by sinking a new discovery shaft and fixing new boundaries in the same manner and to same extent as is required in making a new location; or the locator may sink the original discovery shaft ten feet deeper than it was at date of commencement of such relocation, and shall erect new or make the old monuments the same as originally required. In either case a new location monument shall be erected, and the location certificate shall state if the whole or any part of the new location is located as abandoned property.

**SECTION 12.** This Act shall take effect and be in force from and after July 1st, 1895.  
**SECTION 13.** All Acts and parts of Acts in conflict with this Act are hereby repealed.

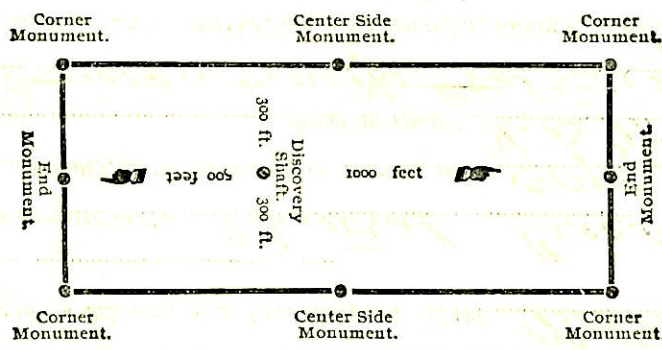

The above diagram is to give the locator a general idea of plan of location under the new law. Your discovery shaft can be in the center of claim or any distance from from either end you desire. In the diagram we have placed it 500 feet from one end and 1000 feet from the other. In description be careful to state locality of claim with reference to some natural object, or permanent monument, as will identify the claim.

TERRITORY OF ARIZONA,  
 County of Pinal ss.  
 ..... F. W. Chamberlain County Recorder in and for the County and Territory aforesaid, do hereby certify that the within instrument was filed for record at ..... o'clock ..... M., on this 5 day of September, 1899, and duly recorded in Book No. 16 of Mines Records of Pinal County, Arizona, at pages 343.

WITNESS my hand and official seal the day and year first above written  
Thos. S. Peyton Deputy ..... F. W. Chamberlain County Recorder.

**Notice of Location.**  
 QUARTZ CLAIM.  
 Grace S.  
 DATED June 24th 1899  
 Filed and recorded at request of .....  
 at ..... A. D. 1..... M.  
 Book.....  
 Pages.....  
 County Recorder.  
 Deputy Recorder.  
 NO. 110, HEERMANS STATIONERY COMPANY, TUCSON.



# Notice of Mining Location.

QUARTZ CLAIM.

To All Whom It May Concern:

This mining claim, the name of which is the Saturn  
Mining Claim, situate on lands belonging to the United States of America, and in which there are valuable mineral  
mineral deposits, was entered upon and located for the purpose of exploration and purchase by

J. M. Thomas and Frank Seeley.

the undersigned, on the 9<sup>th</sup> day of July 1899.

The length of this claim is One thousand five hundred (1500) feet,  
and me claim Seven hundred fifty (750) feet  
in a Northerly direction and Seven Hundred  
& fifty (750) feet in a Southerly direction from  
the center of the discovery shaft, at which this notice is posted, lengthwise of the claim, together with  
Three Hundred (300) feet in width of the surface grounds, on each side of the center of said  
claim. The general course of the lode deposit and premises is from the North  
to the South.

The claim is situated and located in the Mineral Creek Mining District, in  
Pinal County, in the Territory of Arizona, about 3/5 mile  
in a North Easterly direction from U.S. Mine Mon. No 1.  
on Mineral Creek + on East side of said Creek

The surface boundaries of the claim are marked upon the ground as follows: Beginning at a  
mon. of stones, identical to the S. E. corner of  
the Thomas' mining claim

at a point in a Northerly direction 750 feet from  
the discovery shaft (at which this notice is posted), being in the center of the North  
end line of said claim; thence Easterly 300 feet to a mon. of  
stones, being the North East corner of said claim; thence  
Southerly 750 feet to a mon. of stones at the center of  
the East side line of said claim; thence Southerly 750  
feet to a mon. of stones being at the South East corner of said  
claim; thence Northerly 300 feet to a mon. of stones  
at the center of the South end of said claim; thence Northerly 300  
feet to a mon. of stones, being at the South West  
corner of said claim; thence Northerly 750 feet to a mon. of  
stones being at the center of the West side line of said claim;  
thence Northerly 750 feet to a mon. of stones at  
the North West corner of said claim; thence Easterly 300  
feet to the place of beginning.

All done under the provisions of Chapter Six, of Title XXXII, of the Revised Statutes of the United States, and of  
an Act of the General Assembly of Arizona, entitled "An Act Concerning Mines," approved March 20th, 1895.

Dated and posted on the ground this Ninth day of July 1899

J. M. Thomas  
Frank Seeley  
Locators.

*note:*  
The West Side line is  
identical to the East side  
line of the Boover claim.

Wit: E. G. Thomas  
P. U. Schelling



# An Act Concerning Mines.

*Be it Enacted by the Legislative Assembly of the Territory of Arizona:*

**SECTION 1.** Every notice of location of a mining claim shall contain: First, the name of the claim located; second, the name of the locator; third, the date of location; fourth, the number of feet in length of said claim and the number of feet claimed on each side of the center of the discovery shaft, lengthwise of the claim; fifth, the general course of the lode deposit or premises located; sixth, the locality of the claim with reference to some natural object, or permanent monument, as will identify the claim.

**SECTION 2.** All mining locations hereafter located, the certificate of location of which shall not contain: First, the name of the lode or premises; second, the name of the locator or locators; third, the date of location; fourth, the number of feet in length of said claim and the number of feet claimed on each side of the center of the discovery shaft, lengthwise of the claim; fifth, the general course of the lode or premises, as near as may be; sixth, the locality of the claim with reference to some natural object, or permanent monument, as will identify the claim, shall be void.

**SECTION 3.** Before filing such location certificate with the County Recorder of the proper County, the discoverer shall locate his claim by: First, sinking a discovery shaft upon the premises so claimed, to a depth of at least ten feet from the lowest part of the rim of such shaft at the surface and deeper if necessary, until there is shown by such work a lode deposit of mineral in place; second, by posting at the point of discovery, on the surface, a plain sign or notice substantially conforming to the location certificate; third, by marking such claim or premises on the ground so that its boundaries can be readily traced.

**SECTION 4.** Such surface boundaries shall be marked by Eight substantial Posts projecting at least Three Feet Above the Surface of the Ground, or by substantial Stone Monuments at least Three Feet High, to wit: One at each corner of said claim, and one at the center of each end and side line thereof.

**SECTION 5.** Any open-cut, cross-cut, adit or tunnel which shall be made as above provided for, as a part of the location of a mining claim, and which shall be equal in amount of work to a shaft ten feet deep and four feet wide by six feet long, and which shall cut a lode or mineral in place at the depth of ten feet from the surface, shall be equivalent, as a discovery work, to a shaft sunk from the surface.

**SECTION 6.** The discoverer shall have ninety days from the date of discovering the lode and the posting of the notice thereon, to perform said discovery work thereon.

**SECTION 7.** If at any time the locator of any mining claim heretofore or hereafter located, or his assigns, shall learn that his original certificate was defective, or that the requirements of the law had not been complied with before filing, or shall be desirous of changing his surface boundaries, or of taking in any additional ground which is subject to location, or in case the original certificate was made prior to the passage of this law, and he shall be desirous of securing the benefits of this Act, such locator or his assigns, may file an amended certificate of location subject to the provisions of this Act, regarding the making of new locations.

**SECTION 8.** The amount of assessment, or representation, work or improvements to be done or made during each year, after the completion of the location as heretofore provided, and the time for doing the same, shall be as provided by the laws of the United States.

**SECTION 9.** Within three months after the expiration of the period of time fixed for the performance of annual labor or the making of improvements upon any mining claims or premises, the person on whose behalf such work or improvement was made, or some person for him, knowing the facts, may make and record in the office of the County Recorder of the county wherein such claim is situated an affidavit in substance as follows:

TERRITORY OF ARIZONA, } ss  
 ..... County, }  
 ..... being duly sworn deposes and says, that he is a citizen of the United States, and more than 21 years of age, and resides at ..... County, Arizona Territory, and is personally acquainted with the mining claim and premises located and known as ..... Mining District, County of ..... Arizona Territory, the notice of location of which premises is recorded in the office of the County Recorder of said county, in Book ..... of Records of Mines, at page .....; that between the ..... day of ..... A. D. 189..... and the ..... day of ..... A. D. 189..... at least ..... dollars worth of work and improvements were done and performed upon said premises or lode, not including the location work of said claim. Such work and improvements were made by and at the expense of ..... owners of said premises for the purpose of complying with the law of the United States pertaining to assessments or annual work, and (here name the miners or men who worked upon the claim in doing the work) were the men employed by said owner and who labored upon said premises and who did said work and improvements, and said work so done upon said premises is described as follows, to-wit: (Here describe the work done.)  
 ..... (Signature)  
 Subscribed and sworn to before me ..... this ..... day of ..... 189.....  
 ..... Notary Public.

[SEAL]  
**SECTION 10.** Such affidavit when so recorded shall be prima facie evidence of the performance of such labor or the making of such improvements, and said original affidavit after it has been recorded, or a certified copy of record of same, shall be received as evidence accordingly by all the Courts of this Territory.

**SECTION 11.** The relocation of forfeited or abandoned lode claims shall only be made by sinking a new discovery shaft and fixing new boundaries in the same manner and to same extent as is required in making a new location; or the relocater may sink the original discovery shaft ten feet deeper than it was at date of commencement of such relocation, and shall erect new or make the old monuments the same as originally required. In either case a new location monument shall be erected, and the location certificate shall state if the whole or any part of the new location is located as abandoned property.

**SECTION 12.** This Act shall take effect and be in force from and after July 1st, 1895.  
**SECTION 13.** All Acts and parts of Acts in conflict with this Act are hereby repealed.

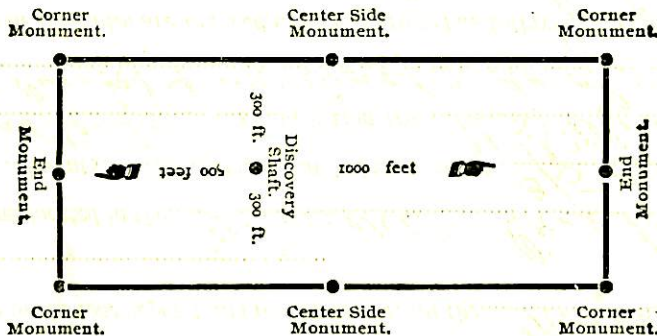

The above diagram is to give the locator a general idea of plan of location under the new law. Your discovery shaft can be in the center of claim or any distance from from either end you desire. In the diagram we have placed it 500 feet from one end and 1000 feet from the other. In description be careful to state locality of claim with reference to some natural object, or permanent monument, as will identify the claim.

TERRITORY OF ARIZONA } ss  
 County of Pinal }  
 ..... F. A. Chamberlain County Recorder in and for the County and Territory aforesaid, do hereby certify that the within instrument was filed for record at ..... o'clock ..... M., on this 5 day of September 1899, and duly recorded in Book No. 16 of Mines Records of Pinal County, Arizona, at pages 340

WITNESS my hand and official seal the day and year first above written.  
Thos. W. Peyton Deputy ..... F. A. Chamberlain  
 County Recorder.

**Notice of Location.**

QUARTZ CLAIM.

Saturn

DATED July 9<sup>th</sup> 1899

Filed and recorded at request of

A. D. 1.....

at ..... M.

Book.....

Pages.....

County Recorder.

Deputy Recorder.

NO. 110, HEERMANS STATIONERY COMPANY, TUCSON.



# Notice of Mining Location.

## QUARTZ CLAIM.

To All Whom It May Concern:

This mining claim, the name of which is the Satellite Mining Claim, situate on lands belonging to the United States of America, and in which there are valuable mineral mineral deposits, was entered upon and located for the purpose of exploration and purchase by J. M. Thomas and Frank Seeley

the undersigned, on the 9th day of July 1899  
The length of this claim is 1500 feet,  
and we claim 1000 feet  
in a Northerly direction and 500 feet in a Southerly direction from the center of the discovery shaft, at which this notice is posted, lengthwise of the claim, together with 300 feet in width of the surface grounds, on each side of the center of said claim. The general course of the lode deposit and premises is from the North to the South

The claim is situated and located in the Mineral Creek Mining District, in Pinal County, in the Territory of Arizona, about 4 1/2 mile in a North Easterly direction from U.S. Min. Mon. No. 1 on Mineral Creek and on east side of said creek.

The surface boundaries of the claim are marked upon the ground as follows: Beginning at a mon of stones 300 ft Easterly from the North East corner of the Saturn claim, at a point in a Northerly direction about 1000 feet from the discovery shaft (at which this notice is posted), being in the center of the North end line of said claim; thence Easterly 300 feet to a mon of stones, being the North East corner of said claim; thence Southerly 450 feet to a mon of stones at the center of the East side line of said claim; thence Southerly 750 feet to a mon of stones being at the South East corner of said claim; thence Westerly 300 feet to a mon of stones at the center of the South end of said claim; thence Westerly 300 feet to a mon of stones, being at the South West corner of said claim; thence Northerly 750 feet to a mon of stones being at the center of the West side line of said claim; thence Northerly 750 feet to a mon of stones at the North West corner of said claim; thence Easterly 300 feet to the place of beginning.

All done under the provisions of Chapter Six, of Title XXXII, of the Revised Statutes of the United States, and of an Act of the General Assembly of Arizona, entitled "An Act Concerning Mines," approved March 20th, 1895.

Dated and posted on the ground this Ninth day of July 1899

J. M. Thomas  
Frank Seeley  
Witness  
E. S. Thomas

Note:  
The West Side line is identical to The East side line of the Saturn claim.



# An Act Concerning Mines.

*Be it Enacted by the Legislative Assembly of the Territory of Arizona:*

**SECTION 1.** Every notice of location of a mining claim shall contain: First, the name of the claim located; second, the name of the locator; third, the date of location; fourth, the number of feet in length of said claim and the number of feet claimed on each side of the center of the discovery shaft, lengthwise of the claim; fifth, the general course of the lode deposit or premises located; sixth, the locality of the claim with reference to some natural object, or permanent monument, as will identify the claim.

**SECTION 2.** All mining locations hereafter located, the certificate of location of which shall not contain: First, the name of the lode or premises; second, the name of the locator or locators; third, the date of location; fourth, the number of feet in length of said claim and the number of feet claimed on each side of the center of the discovery shaft, lengthwise of the claim; fifth, the general course of the lode or premises, as near as may be; sixth, the locality of the claim with reference to some natural object, or permanent monument, as will identify the claim, shall be void.

**SECTION 3.** Before filing such location certificate with the County Recorder of the proper County, the discoverer shall locate his claim by: First, sinking a discovery shaft upon the premises so claimed, to a depth of at least ten feet from the lowest part of the rim of such shaft at the surface and deeper if necessary, until there is shown by such work a lode deposit of mineral in place; second, by posting at the point of discovery, on the surface, a plain sign or notice substantially conforming to the location certificate; third, by marking such claim or premises on the ground so that its boundaries can be readily traced.

**SECTION 4.** Such surface boundaries shall be marked by **Eight substantial Posts projecting at least Three Feet Above the Surface of the Ground, or by substantial Stone Monuments at least Three Feet High, to wit:** One at each corner of said claim, and one at the center of each end and side line thereof.

**SECTION 5.** Any open-cut, cross-cut, adit or tunnel which shall be made as above provided for, as a part of the location of a mining claim, and which shall be equal in amount of work to a shaft ten feet deep and four feet wide by six feet long, and which shall cut a lode or mineral in place at the depth of ten feet from the surface, shall be equivalent, as a discovery work, to a shaft sunk from the surface.

**SECTION 6.** The discoverer shall have ninety days from the date of discovering the lode and the posting of the notice thereon, to perform said discovery work thereon.

**SECTION 7.** If at any time the locator of any mining claim heretofore or hereafter located, or his assignee, shall learn that his original certificate was defective, or that the requirements of the law had not been complied with before filing, or shall be desirous of changing his surface boundaries, or of taking in any additional ground which is subject to location, or in case the original certificate was made prior to the passage of this law, and he shall be desirous of securing the benefits of this Act, such locator or his assignee, may file an amended certificate of location subject to the provisions of this Act, regarding the making of new locations.

**SECTION 8.** The amount of assessment, or representation, work or improvements to be done or made during each year, after the completion of the location as heretofore provided, and the time for doing the same, shall be as provided by the laws of the United States.

**SECTION 9.** Within three months after the expiration of the period of time fixed for the performance of annual labor or the making of improvements upon any mining claims or premises, the person on whose behalf such work or improvement was made, or some person for him, knowing the facts, may make and record in the office of the County Recorder of the county wherein such claim is situated an affidavit in substance as follows:

TERRITORY OF ARIZONA,  
 ..... County, } ss  
 ..... being duly sworn deposes and says, that he is a citizen of the United States, and more than 21 years of age, and resides at ..... County, Arizona Territory, and is personally acquainted with the mining claim and premises located and known as ..... Mining District, County of ..... Arizona Territory, the notice of location of which premises is recorded in the office of the County Recorder of said county, in Book ..... of Records of Mines, at page .....; that between the ..... day of ..... A. D. 189..... and the ..... day of ..... A. D. 189..... at least ..... dollars worth of work and improvements were done and performed upon said premises or lode, not including the location work of said claim. Such work and improvements were made by and at the expense of ..... owners of said premises for the purpose of complying with the law of the United States pertaining to assessments or annual work, and (here name the miners or men who worked upon the claim in doing the work) were the men employed by said owner and who labored upon said premises and who did said work and improvements, and said work so done upon said premises is described as follows, to-wit: (Here describe the work done.)  
 ..... (Signature )  
 Subscribed and sworn to before me ..... this ..... day of ..... 189.....  
 ..... Notary Public.

[SEAL]  
**SECTION 10.** Such affidavit when so recorded shall be prima facie evidence of the performance of such labor or the making of such improvements, and said original affidavit after it has been recorded, or a certified copy of record of same, shall be received as evidence accordingly by all the Courts of this Territory.

**SECTION 11.** The relocation of forfeited or abandoned lode claims shall only be made by sinking a new discovery shaft and fixing new boundaries in the same manner and to same extent as is required in making a new location; or the relocater may sink the original discovery shaft ten feet deeper than it was at date of commencement of such relocation, and shall erect new or make the old monuments the same as originally required. In either case a new location monument shall be erected, and the location certificate shall state if the whole or any part of the new location is located as abandoned property.

**SECTION 12.** This Act shall take effect and be in force from and after July 1st, 1895.  
**SECTION 13.** All Acts and parts of Acts in conflict with this Act are hereby repealed.

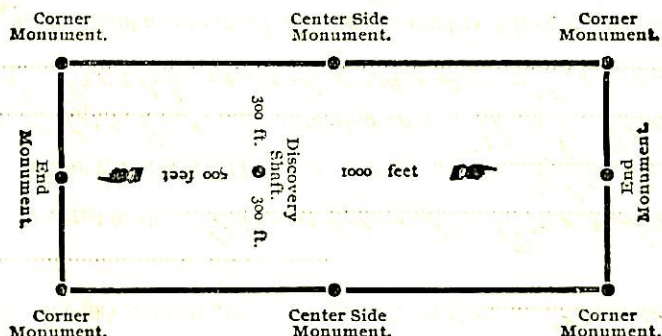

The above diagram is to give the locator a general idea of location under the new law. Your discovery shaft can be in the center of claim or any distance from from either end you desire. In the diagram we have placed it 500 feet from one end and 1000 feet from the other. In description be careful to state locality of claim with reference to some natural object, or permanent monument, as will identify the claim.

TERRITORY OF ARIZONA,  
 County of Pinal } ss.  
 ..... T. A. Chamberlain ..... County Recorder in and for the County and Territory aforesaid, do hereby certify that the within instrument was filed for record at ..... o'clock ..... M., on this ..... day of ..... 189..... and duly recorded in Book No. .... of ..... Records of ..... County, Arizona, at pages. ....

WITNESS my hand and official seal the day and year first above written.  
Thomas Puytan Deputy T. A. Chamberlain  
 County Recorder.

**Notice of Location.**  
 QUARTZ CLAIM.  
 .....  
 .....  
 DATED July 9th 189.....  
 Filed and recorded at request of .....  
 .....  
 at ..... A. D. 1..... M.  
 Book .....  
 Pages .....  
 County Recorder .....  
 Deputy Recorder .....  
 NO. 110, HEERMANS STATIONERY COMPANY, TUCSON.

4 OK

Satellite



# Notice of Mining Location Quartz Claim

To All Whom it may Concern:

This mining claim, the name of which is the Thomas Mining Claim, situate on lands belonging to the United States of America, and in which there are valuable mineral deposits, was entered upon and located for the purpose of exploration and purchase by W. P. Dunham, G. A. Whitford, & G. Thomas, the undersigned, on the 1<sup>st</sup> day of April 1899. The length of this claim is Fifteen Hundred (1500) feet, and we claim Twelve Hundred (1200) feet in an Easterly direction and Three Hundred (300) feet in a Westerly direction from the center of the discovery shaft, at which this notice is posted, lengthwise of the claim, together with Six Hundred (600) feet in width of the surface grounds, on each side of the center of said claim. The general course of the lode deposit and vein is from the West to the East. The claim is situated and located in the Mineral Creek Mining District, in Pinal County, in the Territory of Arizona, about 1 mile in a Northerly direction from U S Mine Mon No 1 on Mineral Creek. The surface



boundaries of the claim are marked <sup>52</sup> on the ground, as follows: Beginning at the center of the West end line which end line is identical to the East end line of the Kasum Mill site, at a point in a Westerly direction (300) feet from the discovery shaft (at which this notice is posted) being in the center of the West end line of said claim; thence North 300 feet to a mon of stones, being the N W corner of said claim; thence East 750 feet to a mon of stones at the center of the North side line of said claim; thence E 750 feet to a mon of stones, being at the N E corner of said claim; thence South 300 feet to a mon of stones at the center of the East end of said claim; thence South 300 feet to a mon of stones, being at the S East corner of said claim; thence West 750 feet to a mon of stones being at the center of the South side line of said claim; thence West 750 feet to a mon of stones at the South West corner of said claim; thence North 300 feet to the place of beginning. All done under the provisions of Chapter Six of Title XXXII, of the Revised Statutes of the



United States, and of an Act of the General Assembly of Arizona, entitled "An Act Concerning mines", approved March 20<sup>th</sup>, 1895. Dated and posted on the ground this 1<sup>st</sup> day of April 1899

M. P. Dunham 7/16 Locator

G. A. Whiteford 7/16 "

E. G. Thomas 2/16 "

The South side line joins the North end line of the "Vindicator" Copper claim.

Witness C. F. Schilling

Filed and recorded at the request of C. F. Schilling on the 1<sup>st</sup> day of April A.D. 1899. at one o'clock p.m.

T. A. Chamberlain Recorder  
by W. H. Loneragan Deputy

Territory of Arizona }  
County of Pinal }<sup>ss</sup>

J. Thos. G. Peyton

County Recorder in and for Pinal County. Territory aforesaid do here by certify that the above and foregoing is a full true and correct copy of the Thomas Mining claim as the same appears of record



in Book No 15 at Page 512 Re-  
-cords of Pinal County Arizona Ter-  
-ritory, Witness my hand and of-  
-ficial seal this 5<sup>th</sup> day of July A.D.  
1901.

Thos. G. Pustan  
County Recorder  
Pinal County, Arizona

11111  
11111  
11111  
11111

11111  
11111  
11111  
11111  
11111



LOCATION NOTICE.—Printed and for sale at the TRIBUNE Office, Florence, Arizona.

Notice is hereby given that the Contention  
 Mining claim, containing mineral bearing quartz, earth or rock, in place, located by  
G. A. Whiteford  
 on this 22<sup>nd</sup> day of Sept., 1899, has been located for mining purposes.  
 Said claim is 1500 feet in length, and S claim 300 feet on  
 each said of the discovery shaft, for full length of claim. The general course of the lode, deposit or premises  
 is N 71 1/2° E & S 71 1/2° W  
 This claim is situated in the Mineral Creek Mining District  
Pinal County, Arizona, about 2700 feet in a North  
 direction from the Ray Mill.

This claim is bounded and marked as follows, to-wit: Beginning at the West  
 center end of Claim being 750 feet S 71 1/2° W of the discovery  
 shaft, upon which this notice is posted; thence 300 feet in a N 15 1/2° W  
 direction to a post or monument; thence 750 feet in a N 71 1/2° E direction  
 to a post or monument at the center of the North side of said claim; thence 750 feet in a  
N 71 1/2° E direction to a post or monument; thence 300 feet in a  
S 15 1/2° E direction to a post or monument, being the center end post or monument of  
East end of said claim, and 750 feet from the discovery shaft; thence 300 feet in a  
S 15 1/2° E direction to a post or monument; thence 750 feet in a S 71 1/2° W  
 direction to a post or monument, being the center of the South  
 side of claim; thence 750 feet in a S 71 1/2° W direction to a post or monument;  
 thence 300 feet in a N 15 1/2° W direction to the place of beginning.

Done under and by virtue of the laws of the United States, and the laws of the Territory of Arizona.  
 Witness: G. A. Whiteford LS.  
 \_\_\_\_\_ LS.  
 \_\_\_\_\_ LS.  
 Locators.

Filed and recorded at request of W. H. Merritt on the  
28<sup>th</sup> day of September 1899 at 1 P. M.  
F. A. Chamberlin Recorder  
 By Thos. G. Peyton Deputy



56  
Territory of Arizona )  
County of Pinal )  
S.S.

I, Thos. G. Peyton County Recorder in and for the  
County of Pinal and Territory aforesaid do hereby certify the  
within and foregoing to be a full true and correct copy of the  
Contention Mining Claim as the same appears of record in Book  
No. 16 Records of Mines at Page 419 thereof. Records of Pinal  
County Arizona Territory.

Witness my hand and official seal this 3rd. day of  
August 1901.

*Thos. G. Peyton*  
Recorder Pinal Co  
Arizona Territory

---



# Notice of Mining Location.

LODE CLAIM.

To All Whom It May Concern:

This mining claim, the name of which is the Truman Mining Claim, situate on lands belonging to the United States of America, and in which there are valuable mineral deposits, was entered upon and located for the purpose of exploration and purchase by H. P. Humham a citizen of the United States

(Locator must insert either "a citizen of the United States," or, "who has declared his intention to become a citizen of the United States.") the undersigned, on the first day of January 1904.

The length of this claim is 1500 feet, and 1 claim 750 feet in a Easterly direction, and 750 feet in a Westerly direction from the center of the discovery shaft, at which this notice is posted, lengthwise of the claim, together with 300 feet in width of the surface grounds, on each side of the center of said claim. The general course of the lode deposit and premises is from the Easterly to the Westerly.

The claim is situated and located in the Mineral Creek Mining District, in Pinal County, in the Territory of Arizona, about One Half mile in a North East direction from Ray Mine and joining the Contention Mine on the North, the North side line of the Contention being the South side line of the Truman.

The surface boundaries of the claim are marked upon the ground as follows: Beginning at The East Center end monument

at a point in a Easterly direction 750 feet from the discovery shaft (at which this notice is posted), being in the center of the East end line of said claim; thence 300 feet to a monument, being the North East corner of said claim; thence 750 feet to a monument at the center of the North side line of said claim; thence 750 feet to a monument, being at the North west corner of said claim; thence 300 feet to a monument at the center of the West end of said claim; thence 300 feet to a monument, being at the South West corner of said claim; thence 750 feet to a monument, being at the center of the South side line of said claim; thence 750 feet to a monument at the South E corner of said claim; thence 300 feet to the place of beginning.

All done under the provisions of Chapter Six, of Title XXXII., of the Revised Statutes of the United States, and of an Act of the General Assembly of Arizona, entitled "An Act Concerning Mines," approved March 20th, 1895, and amended March 2, 1899.

Dated and posted on the ground this First day of January 1904.

*Witness*

J. H. Thomas

H. P. Humham



*M. Thomas*  
*May Arizona*  
*Nov 4, 1901*

TERRITORY OF ARIZONA,  
County of *Pinal*

I, *John P. DePuy* ss

County Recorder in and for the County and

Territory aforesaid, do hereby certify that the within instrument was filed for record at *1* o'clock *P* M.,  
on this *21<sup>st</sup>* day of *March* 190*1*, and duly recorded in Book No. *18*  
of *Mexico* Records of *Pinal* County, Arizona, at pages *268*

WITNESS my hand and official seal the *4th* day of *April* 190*1*

*John P. DePuy*  
County Recorder

# Notice of Location.

LODE CLAIM.

Dated ..... 190.....

Filed and recorded at request of

A. D. 190.....

at ..... M.

Book .....

Pages .....

County Recorder.

By ..... Deputy Recorder.

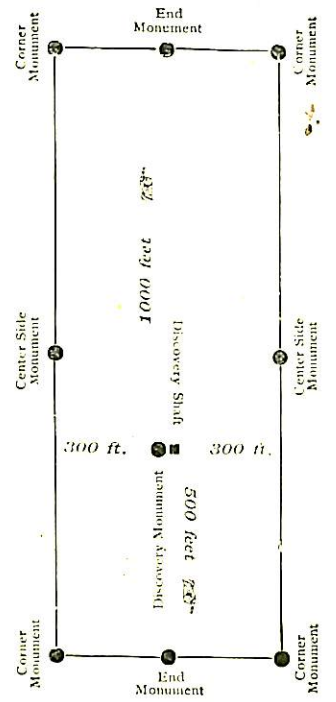

This diagram is to give locator a general idea of plan of location under the new law. The Discovery Shaft can be in the center of claim or any distance from either end desired. In the diagram it is placed 500 feet from one end and 1000 feet from the other. Commence description of claim at a center end monument, giving its distance and direction from center of Discovery Shaft; thence bound the claim in either direction. In description be careful to state locality of claim with reference to some natural object, or permanent monument, as will identify the claim.



(4-687.)

# Surveyor General's Certificate of Approval of Field Notes and Survey of Mining Claim.

Department of the Interior,

Office of U. S. Surveyor General,

Tucson, Arizona

Oct. 14<sup>th</sup> 1901, 18

I, U. S. Surveyor General for Arizona,

do hereby certify that the foregoing and hereto attached Field Notes and Return of the

Survey of the Mining Claim of G. A. Whiteford, per W. C. Truman,

Agent,

known as the *Raines Indicator, Dooner, Saturn, Satellite, Grace L., Thomas, Concession, Truman, and*

situate in Mineral Creek mining district,

Pinal County, Arizona,

in Section approx., Township No. 3 S., Range No. 13 E. (unsurveyed.)

designated as Survey No. 1581.

executed by Charles von Erleben, U. S. Deputy Mineral

Surveyor, July 11-26<sup>th</sup> 1901, 18, under my instructions dated

July 8<sup>th</sup> 1901, 18, have been critically examined and the

necessary corrections and explanations made, and the said Field Notes and Return, and

the Survey they describe, are hereby approved. A true copy of the copy of the location

certificate filed by the applicant for survey is included in the field notes.

*Hugh W. Price*  
U. S. Surveyor General for Arizona



