

**M
S
.**

0

1

6

7

3

Platting 12/16/02 T A

Notes compiled, but not compared

(4-683.)

Mineral Survey No. 1673

Lot No. _____

Prescott

Land District.

FIELD NOTES

OF THE SURVEY OF THE MINING CLAIM OF

Henry Murray Lee & Charles Frederick Reed

KNOWN AS THE

Montezuma & Huron

Big Bend

Mining District,

Yavapai County, Arizona

Section 33, Township 12 N, Range 1 E

Surveyed under ^{Am-} instructions dated Aug. 7th 1902

by J. J. Fisher

U. S. Deputy Mineral Surveyor.

Claim located Jan 1st 1897 & Jan 1st 1898 Amended

Survey commenced Aug 9th 1902

Survey completed Aug 9th 1902

6-160

Address

George W Middleton
Prescott
Arizona

PRELIMINARY OATHS OF ASSISTANTS IN SURVEY OF MINING CLAIM.

We, E. H. Draper and Wm Fisher,
do solemnly swear that we will well and faithfully execute the duties of chain carriers;
that we will level the chain upon even and uneven ground and plumb the tally-pins,
either by sticking or dropping the same; that we will report the true distance to all
notable objects, and the true length of all lines that we assist in measuring, to the best
of our skill and ability, and in accordance with instructions given us, in the survey of
the Mining Claim of Henry Murray Lee & Charles Frederick Reed
Montezuma & Huron, known as the
situate in Big Bay mining district,
Yaoupai County, Arizona
in Section _____, Township No. _____, Range No. _____.

E. H. Draper, Chainman.
Wm Fisher, Chainman.

Subscribed and sworn to by the above-named persons before
My commission expires me this 9th day of August, 1902
May 19, 1900

J. J. Fisher
Notary Public

I, Wm Fisher, do solemnly swear that I will well and
truly perform the duties of axeman, in the establishment of corners and other duties,
according to instructions given me and to the best of my skill and ability, in the survey
of the Mining Claim of Henry Murray Lee & Charles Frederick Reed
known as the Montezuma & Huron,
more fully described in the preceding affidavit.

Wm Fisher, Axeman.

Subscribed and sworn to by the said Wm Fisher
before me this 9th day of

My commission expires
May 19, 1900

August, 1902

J. J. Fisher
Notary Public

I, E. H. Draper, do solemnly swear that I will
well and truly perform the duties of flagman, in the establishment of corners and other
duties, according to instructions given me and to the best of my skill and ability, in the
survey of the Mining Claim of Henry Murray Lee & Charles Frederick
Reed
known as the Montezuma & Huron,
more fully described in the preceding affidavit.

E. H. Draper, Flagman.

Subscribed and sworn to by the said E. H. Draper
before me this 9th day of

My commission expires
May 19, 1900

August, 1902

J. J. Fisher
Notary Public

SURVEY NO.1673.

Feet

MONTEZUMA LODE.

Beginning at discovery shaft No.1,

Thence S.8° 30' W.

Var.14° E.

1135

To S.C.E. Identical with S.C.E. of location, which is also the N.C.E. of the Huron Lode of this Survey.

A porphyry stone 8 x 10 x 30 ins. set 1 ft. in ground and surrounded by a mon. of stones. Stone marked M.No.1673, and N.C.E.H.No.1673.

Thence N.81° 30' W.

Var.14° E.

300

To cor.No.1, which is also cor.No. 2 of the Huron Lode of this Survey.

A slate stone 4 x 12 x 24 ins. set 1 ft. in ground alongside a mon. of stones 3 x 3 ft. Stone marked M.No.1-1673 and H.No.2-1673.

A + on a slate rock in place, marked B.R.M.No.1-1673, brs. N.61° 35' W. 50.5 ft.

A + on a p orphyry rock in place, marked B.R.H.No. 2-1673, brs. N.18° 57' W. 109 ft.

U.S.L.M.No.1538 brs. S. 47° 55' W. 4486.5 ft.

Thence N.8° 30' E.

Var.14° E.

1500

To cor.No.2.

A granite stone 6 x 24 x 34 ins. set 1 ft. in ground, and surrounded by a mon. of stones. Stone marked M.No.2-1673. No brs. available.

SURVEY NO. 1673.

| | |
|------|--|
| Feet | Thence S.81° 30' E. Var.14° E. |
| 300 | To N.C.E. A granite stone 6 x 12 x 24 ins. set 1 ft. in ground and surrounded by a mon. of stones. Stone marked N.C.E.No.1673 |
| 600 | To cor.No.3. A granite stone 6 x 12 x 24 ins. set 1 ft. in ground alongside a mon. of stones 3 x 3 ft. Stone marked M.No. 3-1673. No brs. available. |
| 1500 | Thence S.8° 30' W. Var.14° E. To cor.No 4, which is also cor.No. 3 of the Huron Lode of this survey. A slate stone 4 x 18 x 30 ins. set 1 ft. in ground and surrounded by a mon. of stones, stone marked N. No 4-1673. and H.No.3-1673. A + on a granite rock in place, marked B.R.M.No. 4-1673, bs.N.76° 25' E. 158 ft. A + on a granite rock in place marked B.R.H.No.3-1673 brs.S.47° 50' E. 117 ft. |
| 300 | Thence N.81° 30' W. Var.14° E. To S.C.E., the place of beginning survey of exterior boundaries. |

*

SURVEY NO.1673.

Feet

HURON LODE.

Beginning at discovery shaft ,

Thence S.8° 30' W.

Var.14° E.

1375

To S.C.E.

A slatestone 4 x 8 x 30 ins. set 1 ft. in ground surrounded by a mon. of stones. Stone marked S.C.E H.No.1673.

Thence N.81° 30' W.

Var.14° E.

300

To cor.No.1,

A slate stone 5 x 10 x 30 ins. set 1 ft. in ground and surrounded by a mon. of stones. Stone marked H.No.1-1673.

A + on a slate reef marked B.R.H.No.1-1673 brs. S.52° 35' W. 8.5 ft.

A + on a slate reef marked B.R.H.No.1-1673 brs. S.4° E.9.6 ft.

U.S.L.M.No.1538 brs.S.63° 53' W.3460.8 ft.

Thence N.8° 30' E.

Var.14° E.

1500

To cor.No.2, which is also cor.No.1, of the Montezuma Lode of this Survey. Cor. described above.

Thence S. 81° 30' E.

Var.14° E.

300

To N.C.E. which is also the S.C.E. of the Montezuma Lode of this Survey. Mon. described above.

600

To cor.No. 3, which is also cor.No. 4 of the Montezuma lode of this survey, Cor. described above.

SURVEY NO.1673.

Feet

Thence S.8° 30' W.

Var.14° E.

1500

To cor.No. 4.

A slate stone 4 x 10 x 24 ins. set 1ft. in ground and surrounded by amon. of stones. Stone marked H.No.4-1673. No brs. available.

Thence N.81° 30' W.

Var.14° E.

300

to S.C.E., the place of beginning survey of exterior boundaries.

* * * *

LOCATION.

This claim is located on unsurveyed land approximately in Tp.12 N.R.1 E. G.& S.R.Meridian, in Big Bug Mining District, Yavapai County, Arizona Territory, and is bounded on all sides by government land .

* * * *

AREA.

| | |
|-----------------------|---------------|
| MONTEZUMA LODE | 20.662 Acres |
| HURON LODE | 20.662 " |
| Total Area Lode Claim | <u>41.324</u> |

* * * *

VEIN

MONTEZUMA VEIN, extends from the discovery shaft S.8° 30' W. 1135 ft. and N 8° 30' E. 365 ft.

HURON vein, extends from the discovery shaft S.8° 30' W. 1375 ft. and N.8° 30' E. 125 ft.

* * * *

EXPENDITURE OF FIVE HUNDRED DOLLARS.

I certify that the value of the labor and improvements upon this claim, placed thereon by the claimants and their grantors, is not less than Five Hundred Dollars, and that said improvements consist of:

SURVEY NO.1673.

MONTEZUMA LODGE:

Discovery Shaft No.1, which brs. from the N.C.E. Mon. S.8° 30' W. 365 ft. Shaft 4 x 6 ft. 35 ft. deep..

Value \$350.00

Shaft No. 2 which brs. from the N.C.E. Mon. S.11° 27' W. 598 ft. Shaft 4 x6 ft. 200 ft. deep.

Value \$2000.00

HURON LODGE:

Discovery Shaft No . 1, which brs. from the N.C.E. Mon.S.8° 30' W. 125 ft. Shaft 4 x 6 ft. 35 ft. deep.

Value \$350.00

Shaft No. 2 which brs. from the N.C.E. Mon. S. 22° 30' W. 100 ft. Shaft 4 x 6 ft. 12 ft. deep.

Value \$100.00

Shaft No.3, which brs. from the N.C.E. mon. S. 13° 30' E. 480 ft. Shaft 4 x 6 ft. 10ft. deep.

Value \$100.00

* * * *

INSTRUMENT.

This survey was made with a Gurley Light Mountain Solar Transit,. The courses were deflected from the true meridian, as determined by direct solar observation. The distances were measured with a 75 ft. steel tape.

Note: The Survey of the Montezuma and Huron Lodge are identical with the amended location certificate.

Prescott, Arizona,

Aug. 9, 1902

J. J. Fisher
U.S.D.M.S.

FINAL OATHS FOR SURVEYS.

LIST OF NAMES.

A list of the names of the individuals employed by J. J. Fisher
 United States Deputy Mineral Surveyor, to assist in running, measuring, and marking the lines
 corners and boundaries described in the foregoing field notes of the survey of the mining claim
 of Henry Murray Lee and Charles Frederick Reed
 known as the Montezuma & Huron
 and showing the respective capacities in which they acted.

- E. A. Draper , Chairman.
- W. Fisher , Chairman.
- W. Fisher , Arman.
- E. A. Draper , Flagman.

FINAL OATHS OF ASSISTANTS.

We, E. A. Draper
 and W. Fisher do solemnly swear that we assisted J. J.
Fisher United States Deputy Mineral Surveyor, in marking the corners and
 surveying the boundaries of the mining claim of Henry Murray Lee
and Charles Frederick Reed
and Huron known as the Montezuma
 represented
 in the foregoing field notes as having been surveyed by said deputy mineral surveyor and under
 his direction; and that said survey has been in all respects, to the best of our knowledge and
 belief, faithfully and correctly executed, and the corner and boundary monuments established
 according to law and the instructions furnished by the United States Surveyor-General for
Oregon

- E. A. Draper , Chairman.
- W. Fisher , Chairman.
- W. Fisher , Arman .
- E. A. Draper , Flagman.

Subscribed and sworn to by the above-named persons before me
 this 9th day of August, 1902

My commission expires
 May 19, 1904

J. J. Fisher
 Notary Public

FINAL OATH OF U. S. DEPUTY MINERAL SURVEYOR

I, J. J. Fisher, U. S. Deputy Mineral Surveyor, do solemnly swear that, in pursuance of instructions received from the United States Surveyor General for Arizona, dated Aug. 7th 1902, I have, in strict conformity to the laws of the United States, the official regulations and instructions thereunder, and the instructions of said Surveyor General, faithfully and correctly executed the survey of the Mining Claim of Henry Murray Lee & Charles & Frederick Reed, known as the Montezuma & Heron, situate in Big Bug Mining District, Yavapai County, Arizona, in Section _____, Township No. _____, Range No. _____ and designated as Survey No. 1673, as represented in the foregoing field notes, which accurately show the boundaries of said mining claim as distinctly marked by monuments on the ground, and described in the attached copy of the location certificate, which was received by me from the Surveyor General with said instructions, and that all the corners of said survey have been established and perpetuated in strict accordance with the law, official regulations and instructions thereunder; and I do further solemnly swear that the foregoing are the true and original field notes of said survey and my report therein, and that the labor expended and improvements made upon said mining claim by claimants or their grantors are as therein fully stated, and that the character, extent, location and itemized value thereof are specified therein with particularity and full detail, and that no portion of said labor or improvements so credited to this claim has been included in the estimate of expenditures upon any other claim.

J. J. Fisher
U. S. Deputy Mineral Surveyor.

Subscribed and sworn to by the said J. J. Fisher
U. S. Deputy Mineral Surveyor, before me Thomas C. Joba Notary Public
in Yavapai County Arizona this 11th
day of August 1902. My commission expires July 7. 1903
Thomas C. Joba
Notary Public

Affidavit of Five Hundred Dollars Improvements.

We, E. H. Draper, and Wm Fisher

of lawful age, being first duly sworn according to law, depose and say: that we are acquainted with the Montezuma & Huron mining claim, situate in Big Bend Mining district, Yavapai County, Arizona Territory, for which Henry Murray Lee & Charles Frederick Reed

have made application for survey prior to application for patent under the provisions of the Act of Congress, approved May 10, 1872; and that the labor done and improvements made thereon by the applicant and his grantor exceed Five Hundred Dollars in value, and further that we are not personally interested in said mine.

E. H. Draper
Wm Fisher

TERRITORY OF ARIZONA, }
County of Yavapai } ss:

Sworn to and subscribed before me, this 9th day of August, 1892

J. J. Fisher
Notary Public

My commission expires
May 19, 1904

AMENDED

Notice of Mining Location.

LODE CLAIM.

To All Whom It May Concern:

Huron

This mining claim, the name of which is the.....

Mining Claim, situate on lands belonging to the United States of America, and in which there are valuable mineral deposits,

was entered upon and located for the purpose of exploration and purchase by.....

Lee & Charles Frederick Reed

Henry Murray

.....the undersigned, on the.....

1st

day of.....

August 19*02*

The length of this claim is.....

1500

feet, and.....

we

claim.....

125

feet in a.....

North

.....direction, and.....

1375

feet in a.....

South

.....direction from the center of the discovery monument, at which

this notice is posted, lengthwise of the claim, together with.....

300

feet in

width of the surface grounds, on each side of the center of said claim. The general course of the lode deposit and premises is from the.....

North East

to the.....

South West

The claim is situated and located in the.....

Buy Buy

Mining District,

in.....

Yavapai

County, in the Territory of Arizona, about.....

1/2 mile

in a.....

North

direction from.....

the Grinnell Mine

.....

The surface boundaries of the claim are marked upon the ground as follows: Beginning at.....

a mon.

at a point in a.....

North

direction.....

125

feet from

the discovery monument, (at which this notice is posted), being in the center of the.....

North

end line of said

claim; thence.....

N 81° 30' W 300

feet to a.....

mon.

, being

the.....

N.W.

corner of said claim; thence.....

S 8° 30' W 1500

feet

to a.....

mon.

being at the.....

S.E.

corner of said claim;

thence.....

S 81° 30' E 300

feet to a.....

mon.

at the

center of the.....

South

end of said claim; thence.....

S 81° 30' E 300

feet

to a.....

mon.

, being at the.....

S.E.

corner of said claim;

thence.....

N 8° 30' E 1500

feet to a.....

mon.

at the

.....

N.E.

corner of said claim; thence.....

N 81° 30' W 300

feet to the place of beginning.

All done under the provisions of Chapter Six, of Title XXXII, of the Revised Statutes of the United States, and of an Act of the General Assembly of Arizona, entitled "An Act Concerning Mines," approved March 20th, 1895, and amended March 2nd, 1899.

This is an Amended Location Notice of the.....

Huron

Mining

Claim, located by.....

Charles Kugeley

.....

.....

.....

.....

.....

Dated and posted on the ground this.....

1st

day of.....

August 19*02*

Henry Murray Lee

Charles Frederick Reed

by *G.H. Muldrew*

Agent.

Indexed & indexed
45.30 Compared.

"Huron"

Chas F Reed
Henry M & Co

RECORDED AT REQUEST OF

G. W. Middleton

Aug 4 11. 1902

At 2 40 o'clock P. M.

In Book 4 of lines

Pages 28-30

Records of Yavapai County, Arizona.

L. J. Farley
County Recorder.

By James Balderson

AMENDED

Notice of Mining Location.

LODE CLAIM.

To All Whom It May Concern:

This mining claim, the name of which is the Montezuma Mining Claim, situate on lands belonging to the United States of America, and in which there are valuable mineral deposits, was entered upon and located for the purpose of exploration and purchase by Henry Murray Lee and Charles Frederick Reed

the undersigned, on the 1st day of August 1902

The length of this claim is 1500 feet, and or claim 365 feet in a North direction, and 1135 feet in a South direction, and 300 feet in a South direction from the center of the discovery monument, at which this notice is posted, lengthwise of the claim, together with 300 feet in width of the surface grounds, on each side of the center of said claim. The general course of the lode deposit and premises is from the North East to the South West

The claim is situated and located in the Big Bug Mining District, in Yavapai County, in the Territory of Arizona, about 3/4 mile in a North direction from the Boulder Mine and 1 1/2 miles South East, from Silver Bell Mine

The surface boundaries of the claim are marked upon the ground as follows: Beginning at a mon. of mine

at a point in a North direction 365 feet from the discovery monument, (at which this notice is posted), being in the center of the North end line of said claim; thence N 81° 30' W 300 feet to a mon., being the N.W. corner of said claim; thence S 8° 30' W 1500 feet to a mon., being at the S.W. corner of said claim; thence S 81° 30' E 300 feet to a mon. at the center of the South end of said claim; thence S 81° 30' E 300 feet to a mon., being at the S.E. corner of said claim; thence N 8° 30' E 1500 feet to a mon. at the N.E. corner of said claim; thence N 81° 30' W 300 feet to the place of beginning.

All done under the provisions of Chapter Six, of Title XXXII, of the Revised Statutes of the United States, and of an Act of the General Assembly of Arizona, entitled "An Act Concerning Mines," approved March 20th, 1895, and amended March 2nd, 1899.

This is an Amended Location Notice of the Montezuma Mining Claim, located by J. H. Hicklin

on the 1st day of January 1898, and recorded in Book 50 of Records of Mines, at page 64

in the office of the County Recorder of the aforesaid County of Yavapai to which reference is hereby made, and this Amended Location Notice is made and posted to correct errors in the description in the said original Location Notice.

Dated and posted on the ground this 1st day of August 1902
Henry Murray Lee
Charles Frederick Reed
 by G. W. Middleton
Agent.

Indexed
4519
Montezuma
Combarca

Henry M. Lee
et al

RECORDED AT REQUEST OF

E. H. Middleton
Aug 4 11, 1902
112 1/2 O'Connell St. N.

In Book - at Hand
Pages 26-27

Records of Yavapai County, Arizona

J. J. Hawley
County Clerk
James Baldwin

"MONTEZUMA"

NOTICE OF MINING LOCATION.
Quartz Claim.

To all whom it may concern:

This mining claim, the name of which is the Montezuma Mining Claim, situate on lands belonging to the United States of America, and in which there are valuable mineral deposits, was entered upon and located for the purpose of exploration and purchase by J.H. Hicklin the undersigned, on the First day of January 1898.

The length of this claim is Fifteen Hundred feet, and I claim Seven hundred and fifty feet in a Northerly direction ~~from~~ and seven hundred and fifty feet in a Southerly direction from the center of the discovery shaft, at which this notice is posted, lengthwise of the claim, together with Three Hundred feet in width of the surface grounds, on each side of the center of said claim. The general course of the lode deposit and premises is from the Northerly to the Southerly.

The claim is situated and located in the Big Bug Mining District, in Yavapai County, in the Territory of Arizona, about Three Fourths (3-4) of a mile in a Northerly direction from the Swindler Mine and about 1- $\frac{1}{2}$ miles South Easterly from the Silver Belt Mine.

The surface boundaries of the claim are marked upon the ground as follows: Beginning at stone monument at a point in a Northerly direction 750 feet from discovery shaft (at which this notice is posted), being in the center of the North end line of said claim; thence Easterly 300 feet to a stone monument, being the North east corner of said claim; thence Southerly 750 feet to a stone monument at the center of the East side line of said claim; thence Southerly 750 feet to a stone monument being at the South East corner of said claim; thence Westerly 300 feet to a stone monument at the center of the South end of said claim; thence Westerly 300 feet to a stone monument, being at the South west corner of said claim; thence northerly 750 feet to a stone monument being at the center of the West side line of said claim; thence northerly 750 feet to a stone monument at the North East corner of said claim; thence Easterly 300 feet to the place of beginning.

All done under the provisions of Chapter Six, of Title XXXII, of the Revised Statutes of the United States, and of an Act of the General Assembly of Arizona, entitled "An Act Concerning Mines", approved March 20th 1895.

Dated and posted on the ground this First day of January 1898.

J.H. Hicklin.

Filed and recorded at request of E.S. McRoberts March 14th A.D. 1898, at 2:30 o'clock p.m., Book 50 of Mines, page 64, Records of Yavapai County, Arizona.

(Seal)

W.I. Johnson,

County Recorder.

By E.C. Averyt,

Deputy Recorder.

TERRITORY OF ARIZONA,)
COUNTY OF YAVAPAI.) ss.

I, P.J. FARLEY, County Recorder in and for the County of Yavapai, in the Territory of Arizona, and custodian of the records thereof, do hereby certify that I have compared the above and foregoing with, and the same is a full, true and correct copy of the notice of location of the "MONTEZUMA" mining claim, as the same appears of record in Book 50 of Mines, page 64, Records of Yavapai County, Arizona.

IN WITNESS WHEREOF, I have hereunto set my hand and affixed my official Seal, this 31st day of May, A.D. 1902.



County Recorder.

HURON.

NOTICE OF MINING LOCATION.
Quartz Claim.

This mining claim, the name of which is the HURON Mining Claim, situate on lands belonging to the United States of America, and in which there are valuable mineral deposits, was entered upon and located for the purpose of exploration and purchase by Charles Kingsley, the undersigned on the 1st first day of January 1897.

The length of this claim is 1500 fifteen----feet, and I claim 300 three hundred feet in a Southerly direction and 1200 twelve hundred feet in a Northerly direction from the center of the discovery shaft, at which this notice is posted, lengthwise of the claim, together with 300 three hundred feet in width of the surface grounds, on each side of the center of said claim. The general course of the lode deposit and premises is from the South West to the North East.

The claim is situated and located in Big Bug Mining District, in Yavapai County, in the Territory of Arizona, about one mile in a North west direction from the Boggs Mine, and on the East side of Black Canyon Stage Road.

The surface boundaries of the claim are marked upon the ground as follows:--Beginning at South end center of claim at a point in a Southerly direction three hundred feet from the discovery shaft (at which this notice is posted), being in the center of the South end line of said claim; thence East 300 three hundred feet to a mon. of stone, being the South East corner of said claim; thence North 750 feet to a mon. of stone, at the center of the East side line of said claim; thence North 750 feet to a mon. of stone being at the North East corner of said claim; thence West 300 feet to a mon. of stone at the center of the North end of said claim; thence West 300 feet to a mon. of stone, being at the North West corner of said claim; thence South 750 feet to a mon. of stone, being at the center of the West side line of said claim; thence South 750 feet to a mon. of stone at the South West corner of said claim; thence East 300 feet to the place of beginning.

All done under the provisions of Chapter Six, of Title XXXII, of the Revised Statutes of the United States, and of an Act of the General Assembly of Arizona, entitled "An Act Concerning Mines," approved March 20th, 1895.

Dated and posted on the ground this First day of January 1897.

Charles Kingsley.

Witness: James Murray)
Frank Thornton.)

Filed and recorded at request of Charles Kingsley, March 22nd 1897, at 9:00 o'clock a.m. in Book 45 of Mines, pages 490 and 491, Records of Yavapai County, Arizona.

(Seal) W.I. Johnson,
County Recorder.
By P.J. Farley,
Deputy Recorder.

TERRITORY OF ARIZONA,)
COUNTY OF YAVAPAI.) ss.

I, P.J. FARLEY, County Recorder in and for the County of Yavapai, in the Territory of Arizona, and custodian of the records thereof, do hereby certify that I have compared the above and foregoing with, and the same is a full, true and correct copy of the notice of location of the "HURON" Mining Claim, as the same appears of record in Book 45 of Mines, pages 490-491, Records of Yavapai County, Arizona.

IN WITNESS WHEREOF, I have hereunto set my hand and affixed my Official Seal, this 31st day of May, A.D. 1893.

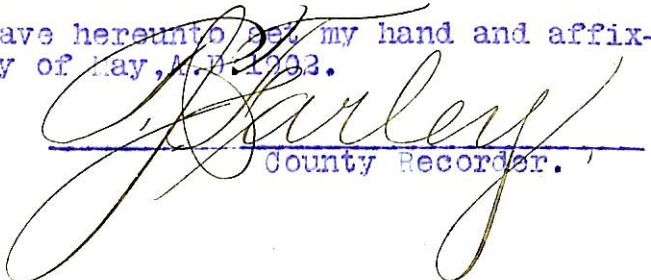
County Recorder.

(4-687.)

Surveyor General's Certificate of Approval of Field Notes and Survey of Mining Claim.

Department of the Interior,

Office of U. S. Surveyor General,

Phoenix, Arizona

Dec 26 - 1902, 18

I, U. S. Surveyor General for *the District of Arizona*,

do hereby certify that the foregoing and hereto attached Field Notes and Return of the Survey of the Mining Claim of *Henry Murray Lee + Charles Frederick Reed*

....., known as the

Montezuma + Huron

situate in *Big Bug* mining district,

Yavapai County, *Arizona*

in Section, Township No., Range No.

....., designated as Survey No. *1673*

executed by *J. J. Fisher*, U. S. Deputy Mineral

Surveyor, *Aug 9 - 1902*, ~~18~~, under my instructions dated

Aug 7 - 1902, 18, have been critically examined and the necessary corrections and explanations made, and the said Field Notes and Return, and

the Survey they describe, are hereby approved. A true copy of the copy of the location certificate filed by the applicant for survey is included in the field notes.

Hugh Price

U. S. Surveyor General for *Arizona*

Survey No 1673
 Prescott Land District.

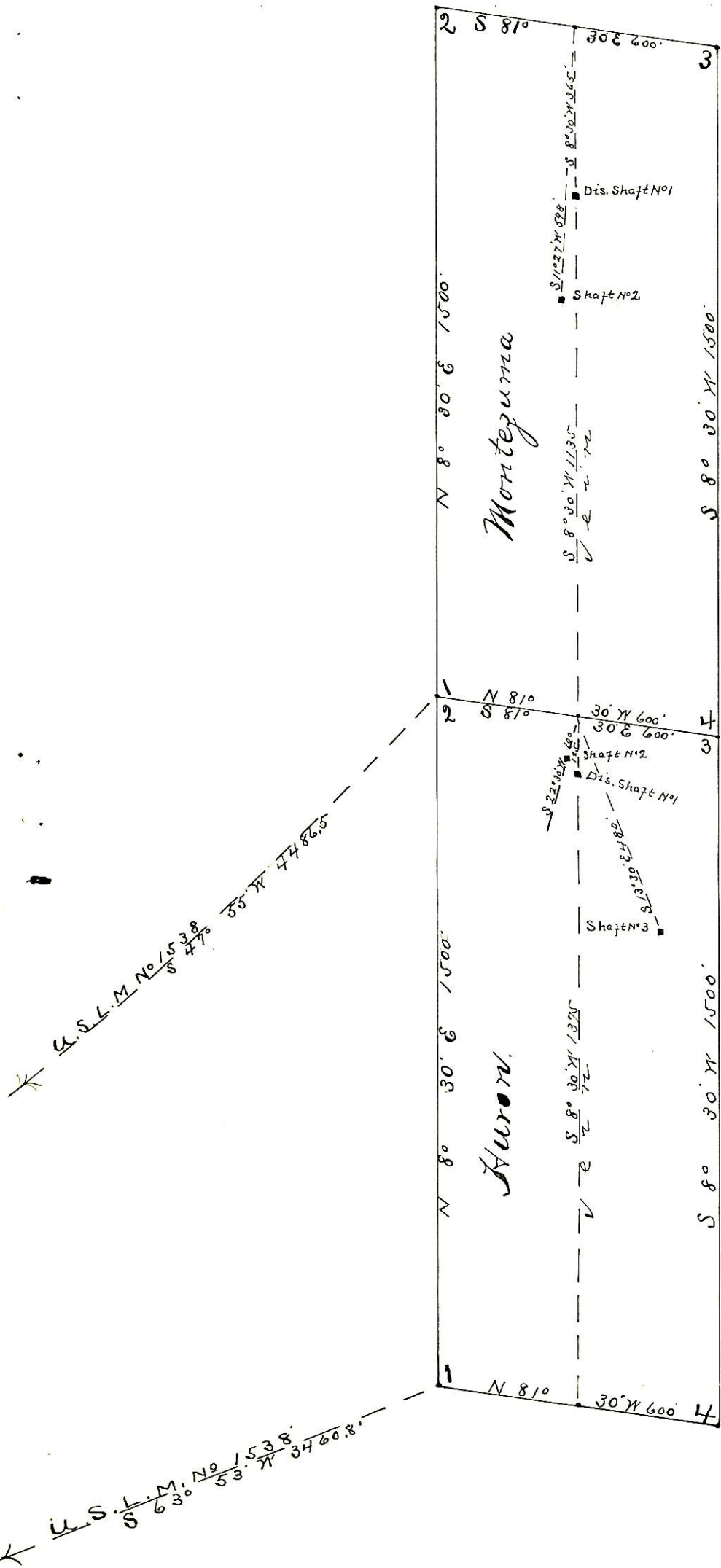

Surveyed Aug. 9th 1902
 by J. J. Fisher
 U.S.D.M.S.