

**MS -**

**0**

**1**

**7**

**5**

**4**

R notes  
April 25/03  
See notices page 2/04

Notes copied by T.  
7/30/03

(4-683.)

Mineral Survey No. 1754

Lot No. \_\_\_\_\_

Prescott Land District.

FIELD NOTES

OF THE SURVEY OF THE MINING CLAIM OF

James Smith per Walter Bennett  
Attorney in fact

KNOWN AS THE

Brooklyn, Side Line, Merrimac, and S. Star Mining & Milling  
Massade, Dummey, Blunderbus, Red Cross, Uncle John, K. 2. Tor, Patanka, and Atlanta...

Castle Creek, Mining District.

Yavapai County, Arizona  
Approx. ~~blunderbus~~ Township ~~7 N~~, Range 2 W (mod)

Surveyed under instructions dated 1/22, 1903.

by James B. Girard  
U. S. Deputy Mineral Surveyor

Claim located See location notices, 1

Survey commenced JANUARY 22, 1903.

Survey completed Feby 17, 1903.

# PRELIMINARY OATHS OF ASSISTANTS IN SURVEY OF MINING CLAIM.

WE, P. W. Latimer and J. R. Batts,

do solemnly swear that we will well and faithfully execute the duties of chain carriers; that we will level the chain upon even and uneven ground and plumb the tally-pins, either by sticking or dropping the same; that we will report the true distance to all notable objects, and the true length of all lines that we assist in measuring, to the best of our skill and ability, and in accordance with instructions given us, in the survey of the Mining Claim of James Smith

known as the K.2. Tor, Patanka, Atlanta, Brooklyn, Side Line, Merrimac, Mand S. Massade, Dumme, Blunderbuss, Red Cross, Unkle John and Star, Mining & Mulsite situate in Castle Creek mining district Yavapai County, Arizona in Section \_\_\_\_\_, Township No. \_\_\_\_\_, Range No. On unincorporated land

P. W. Latimer, Chairman.

J. R. Batts, Chairman.

Subscribed and sworn to by the above-named persons before me this 18<sup>th</sup> day of January, 1903

*My Commission expires April 16, 1905.*

C. W. Herndon  
Notary Public

I, \_\_\_\_\_, do solemnly swear that I will well and truly perform the duties of axman, in the establishment of corners and other duties, according to instructions given me and to the best of my skill and ability, in the survey of the Mining Claim of \_\_\_\_\_

known as the \_\_\_\_\_ more fully described in the preceding affidavit.

\_\_\_\_\_, Axman.

Subscribed and sworn to by the said \_\_\_\_\_ before me this \_\_\_\_\_ day of \_\_\_\_\_, 190\_\_\_\_\_

I, L. W. Hanson, do solemnly swear that I will well and truly perform the duties of flagman, in the establishment of corners and other duties, according to instructions given me and to the best of my skill and ability, in the survey of the Mining Claim of James Smith

known as the K.2. Tor, Patanka, Atlanta, Brooklyn, Side Line, Merrimac, Mand S. Massade, Dumme, Blunderbuss, Red Cross, Unkle John and Star, Mining & Mulsite more fully described in the preceding affidavit.

L. W. Hanson, Flagman.

Subscribed and sworn to by the said L. W. Hanson before me this 18 day of

January, 1903

C. W. Herndon

No. 1.

Feet.

WHIPSAW GROUP.Survey N° 1754ATLANTA LODE CLAIM.

Beginning at Cor. No. 1, the S. E. Cor. of the Claim, identical with the N. E. Cor. of the Patanka, Cor. 1, of same claim/ set a porphyry stone 30 X 12 X 8 ins., 15 ins., in the ground, marked A-1-1754 on N. W. face and P-1-1754 on S. W. face, with a mound of stone alongside. Thence

U. S. L. M. No. 1754 bears N. 14° 45' E., 348.5 Ft.

Smokestack of Smelter bears S 21° 30' W.,

Water Tank on Patanka Claim bears S. 32° 10' W.

No other bearings available.

Thence N° 2° 30' E.,

On East Side Line of Atlanta

378. Wagon Road bears S. E.

409.8 Wagon Road bears E. S. E.

617.8 Wagon Road bears S. E.

710. Wash bears E. N. E., 20 ft. wide.

1490.8 To Cor. No. 2 of the Atlanta, the N. E. Cor.

Set a porphyry stone, 20 x 12 x 6 ins/, 10 ins., in the ground to bedrock, marked A-2, 1754, on the S. W. face, and raised a mound of stone alongside  
Thence,

A porphyry stone 36 x 48 x 26 ins., marked with cross A-2, 1754 B. R. bears N. 33° 13' E., 159.5 ft.

A Peak bears N. 46° 13' E., 1 1/2 Miles Dist.  
No other bearings available.

Thence S 78° W.

Feet.	On North End Line of Atlanta.
98.8	Cross Gulch 30 ft. wide, course N.
300.	To NE. C. of claim a mound of stones.
508.8	To Cor. No. 3, the N. W. Cor. of the claim.
	Set a porphyry stone, 40 x 30 x 20 ins/, 20 ins/, in the ground, marked with a cross for exact cor. point and A-3,1754, on the S. E. face and raised a mound of stone alongside.
	No bearings available.
	<u>Thence S. 2° 30' W.</u>
	On West side line of the Atlanta.
141.8	Top of ridge and descend.
542.	Top of ridge.
743.	Gulch course S. E.
1370.	Gulch 30 ft. wide course S. E.
1490.8	to Cor. No. 4, the S. W. Cor. of the Claim, identical with Cor. No. 4, of the Patanka this survey.
	Set a porphyry stone, 30 x 20 x 10 ins/, 20 ins/, in the ground, marked A-4,1754 on the W. E. and P-4,1754 on the S. E. face, Thence, The N. W. Cor. of Mill bears S. 59° 29' E. Prominent Peak bears N. 26° 15' W., " " " S. 32° E.
	No other bearings available.
	<u>Thence N. 78° E.</u>
	On the S. end line of this claim and the N. end line of the Patanka of this Survey.

- Feet.
- 208.8 To the S. E. C. of the Atlanta and the N. E. C. of Patanka lode of this survey, a mound of stones.
360. Gulch, course Southerly.
- 508.8 To Cor. No. 1, the place of beginning, survey of exterior boundaries.

All Corners are identical with their respective locations.

Mean Magnetic Variation  $14^{\circ} 50'$  E.

-----

PATANKA LODGE CLAIM.

Beginning at Cor. No. 1 Cor. Heretofore Described.

Thence S.  $20^{\circ} 05'$  E.

On the East Side line of this Claim, Descending.

150. Road bears S. W. and N. E. from Mines to Smelter.
700. Road bears S. W. and N. E.
- 780 Road bears S. W. and N. E. to Whipsaw Gulch.
805. To N/ bank of Whipsaw Gulch, 130 feet wide.  
course East and begin ascent.
- 1350 Top of ascent.
1450. To Cor. No. 2,
- Set a porphyry stone  $22 \times 22 \times 18$  ins/,  $30$  ins/ in the ground to bedrock, scribed P-2-1754, and raised a mound of stone alongside, 2 ft. base  $1 \frac{1}{2}$  ft/ high.

No bearings available.

4.

Feet.	<u>Thence S. 78° W.</u>
	On the S. End Line of the Patanka.
300.	Set a porphyry stone 40 x 15 x 10 ins/, 18 ins/, in the ground to bedrock, scribed 1-D.1754 and K-2-T.1754 For. Cor. No. 1 of the Dummey and No. 2, of the K-2 Tor Claims of this Survey, identical with the S. E. C. of the Patanka. No Bearings Available.
360.	To Gulch course South.
508.8	To Cor. No. 3 the S. T. Cor.
	Set a Porphyry stone 28 x 18 x 12 ins/, 18 ins., in the ground to bed rock, scribed P-3-1754, and raised a mound of stone alongside. No bearings.
	<u>Thence N. 20 05' W.,</u>
	On N. <del>XXX</del> Line of Patanka.
1240.	To Whipsaw Gulch course Easterly.
1450.	To Cor. No 4, the N. W. Cor, Cor. Heretofore Described.
	<u>Thence N. 78° E.</u>
	On North End Line of Claim.
208.8	To N. E. C., identical with the S. E. C. of the Atl.
508.8	to Cor. No. 1 the place of beginning.
	All Corners are identical with their respective locations.
	Mean Variation 15° E.

\*\*\*\*\*

Feet.

Mud S. Claim.

Beginning at Cor. No. 1,

Identical with Cor. No. 1-1 of Patanka and Atlanta Lodes of this survey, Stone Scribed on S. E. M-S. 1-1754, Cor. Heretofore described.

Thence N. 3° 30' E.

On East Side line of the Atlanta.

750. To Cor. No. 2, identical with Cor. No. 1 of the Brooklyn a claim of this survey.

Set a porphyry stone, 25 x 12 x 10 ins., 15 ins. in the ground to bed rock, stone scribed M. S. 2-1754 and B. 1-1754, with a cross for exact cor. point, and raise a mound of stone alongside, Thence,

Water Tank on Patanka Claim brs. S. 39° W.

U. S. L. M. No. 1754 Brs. S. 7° 45' E.: 415.9 ft.

Smokestack of Hoist bears S. 61° 20' W.

No other bearings available.

Thence N. 72° E.

On the North End Line of the Mud S.

120. Gulch Course N. E. 30 ft. wide.

300. To N. E. C. Monument a mound of stones

308.8 To Cor. No. 2, of the Side Line a claim of this survey.

I set a porphyry stone, 32 x 12 x 8 ins., 13 ins/, in the ground to bed rock, with a cross for exact corner point, scribed S. L. 1-1754 on the S. E. face and raised a mound of stone alongside, 3ft base 2 ft. high.



Feet.	
412.	To Gulch 35ft. wide, course southeasterly.
600.	To Cor. No. 2, the N. E. Cor. of the Claim.  Set a porphyry stone, 25 x 12 x 6 ins., 12 ins., in the ground to bedrock, scribed 3-1754 M. S. on S. W. face and a cross for exact corner point and raised a mound of stone alongside. No bearings available.
	<u>Thence S. 2° 30' W.</u>
90.	To Gulch course southeasterly 40 ft. wide.
750.	To Cor. No. 4,  Set a porphyry stone, 30 x 15 x 10 ins., 15 ins., in the ground to bed rock, stone scribed 4-1754 M. S. and a cross for exact corner point with a mound of stone alongside. No bearings available.
	<u>Thence S. 20° 05' E.</u>
70.00	Wagon Road bears N. E. & S. W.
310.00	Wagon Road bears N. E. & S. W.
500.00	Wagon Road bears northeasterly and southwesterly.
750.00	To Cor. No. 5, identical with Cor. No. 2, of the Side Line a claim of this survey, On the N. end Line of the Blunderbuss Claim this survey.  Set a porphyry stone, 25 x 15 x 8 ins., 12 ins., in the ground, stone scribed M. S. 5-1754 and S. L. 2-1754 and a cross for exact corner point, and raise a mound of stone alongside.  No bearings available.
	<u>Thence S. 78° W.</u>
	On S. End line of the MAUD-S.
300.	To S. E. C. a mound of stones.

Feet.

600.

To Cor. No. 6, identical with Cor. No. 1, of the Blunderbuss a claim of this survey.

Set a porphyry stone, 24 x 15 x 12 ins., 14 ins., in the ground, scribed with a cross for exact cor. point and M. S. 6-1754 and B. 1-1754, and raise a mound of stone alongside. Thence,

Cor. 1 of Durrey, 2 of K. 2. tor and S. E. C. of the Patanka Lode of this survey bears S. 3° 52' W., N. W. Corner of Barn bears S. 44° E. U. S. L. M. N. 1754 bears N. 9° 13' W., 1055 ft. No other bearings available.

Thence N. 30° 05' W.

52.00

Road bears N. E. & S W.

750.

To Cor. No. 1, the place of beginning.

Survey of Exterior Boundaries.

All Corners are identical with their respective locations.

Mean Variation at all Corners 15° 05' E.

\*\*\*\*\*

BROOKLYN LODE.

Beginning at Cor. No. 1, the S. W. Cor., heretofore described.

U. S. L. M. No. 1754 bears S. 7° 45' E., 415.9 ft.

Thence S. 68° 00' E.

416.

Intersect line 1-2 of the <sup>Side Line</sup> ~~U. S. L. M.~~ S. at S. 20° 05' E.,

22.66ft from Co. No. 1 of the Side Line.

Feet. 616.48	Intersect line 3-4 of the Maud S., at S. 2° 30' W.,
	356.02 ft. from Cor. No. 3 of the Maud S.
949.6	Intersect line 3-4 of the Side Line, at S. 30°
	05' E., 534.04 ft., from Cor. No. 4, of the Side
	Line Claim of this Survey.
1500.	To Cor. No 2, the S. E. Cor. of the Claim.
	<p>Set a porphyry stone 24 x 12 x 8 ins., 12 ins. in the ground scribed B. 2-1754 on the N. W. face and a cross for the exact corner point and raised a mound of stone alongside 3 ft. base 1 1/2 ft/ high. No bearings available.</p> <p style="text-align: center;"><u>Thence N. 2° 30' E.</u></p>
135.	Gulch, course southerly 40 ft. wide.
300.	To E. E. C. a mound of stones.
600.	To Cor. NO. 3, the N. E. Cor. of the claim.
	<p>Set a Granite stone 26 x 14 x 8 ins., 12 ins., in the ground, scribed B.-2-1754 and a cross for exact corner point and raised a mound of stone alongside. No bearings available.</p> <p style="text-align: center;"><u>Thence N. 68° W.</u></p>
	On the North Side line of the Atlanta.
350.	To Gulch course 3.
1500.	To Cor. No. 4, the N. W. Cor., at S. 2° 30' W.?
	140.7 ft. from Cor. No. 2, the N. E. Cor. of the
	Atlanta.
	<p>Set a granite stone, 30 x 22 x 12 ins., 15 ins., in the ground, scribed B. 4-1754 on the S. E. face</p>

Feet.

and raised a mound of stone alongside, Thence

Smokestack of Hoist bears S.  $16^{\circ} 40' N.$

Shaft bears S.  $42^{\circ} 57' E.$ , No. 2. 6 ft.

No other bearings available.

Thence S.  $2^{\circ} 30' E.$ ,

On the East Side Line of the Atlanta Lode of  
this Survey.

300. To T. E. C., a mound of stones.

600. To Cor. No. 1, the Place of Beginning., Survey of  
Exterior Boundaries.

Survey is identical with the location.

Magn Variation  $14^{\circ} 45' E.$ , at corners.

\*\*\*\*\*

S I D E L I N E C L A I M .

Beginning at Cor. No. 1, the N. T. Cor., heretofore  
described.

N. S. E. M. No. 1754 bears S.  $27^{\circ} 21' N.$ ,  $536\frac{1}{2}$  ft.

Thence S.  $20^{\circ} 05' E.$

232.66 Intersect line 1-2 of the Brooklyn, at S.  $68^{\circ} E.$ ,  
416. ft/ from Cor. No. 2,

590. Road bears N. E. & S. T.

734.3 To Cor. NO. 4 of the Maud S.

1484.3 To Cor. No. 2, identical with Cor. No. 5, of the Maud  
S., Corner heretofore described.

Thence N.  $73^{\circ} E.$

On the South end line of the Side Line., and on the  
N. end Line of the Blunderbuss a claim of this  
Survey.

Feet.

200. To S. E. C. of the Claim a Mound of Stones.

400. To Cor. No. 3, the S. E. Cor. at S.  $70^{\circ}$  W., 500.  
Ft. from Cor. No. 4, of the Blunderbuss.

Set a Granite Stone, 24 x 12 x 12 ins.,  
12 ins/, in the Ground for the S. E. Cor. of the  
Side line, scribed 3-1754 and a cross for exact  
corner point and raised a mound of stone alongside.

Thence N.  $20^{\circ}$  05' E.

On the East Side Line of the Side Line.

950.26 Intersect line 1-2 of the Brooklyn at S.  $68^{\circ}$  E.

1100. 949.6 ft. distant from Cor. No. 1 of the Brooklyn.

1400. Gulch, course southerly.

1434.3 To Cor. No. 4 the N. E. Cor.

Set a porphyry stone 24 x 15 x 8 ins., 12 ins.,  
in the ground scribed S. E. 4-1754 and a cross for  
exact corner point, and raise a mound of stone alongside

Thence S.  $70^{\circ}$  E.

42. Gulch course southerly.

103.3 To Cor. No. 3, of the Maud S., at N/  $2^{\circ}$  30' E.,  
356.02 ft. from line 1-2 of the Brooklyn and same  
course 750 ft. from Cor. No. 4, of the Maud S.

200. To N. E. C. of the Claim a mound of stones.

232. Gulch course southerly.

400. To Cor. No. 1 the place of beginning.

Survey of Exterior Boundaries.

The survey is identical with the location.

Mean Variation at corners  $15^{\circ}$  E.

Feet.

BLUNDERBUSH.

Beginning at Cor. No. 1 the N. W. Cor., identical with Cor. No. 6 of the Maul S., Cor. heretofore described.

U. S. L. M. No. 1754 bears N.  $9^{\circ} 13'$  W., 1055. ft.

Thence S.  $20^{\circ} 05'$  E.

64. To ~~Whipsaw~~ Whipsaw Gulch and Road., Gulch bears South-easterly.

300. E. J. C. Mon. a mound of stones.

600. To Cor. No. 2,, the S. W. Cor, at N.  $20^{\circ} 05'$  W., 100 ft. from Cor. No. 2 of the Patanka.

Set a porphyry stone 24 x 12 x 8 ins., 12 ins., in the ground, stone scribed B-2-1754 and a cross for exact corner point, and raise a mound of stone alongside. No Bearings Available.

Thence N.  $78^{\circ}$  E.

550. Cross Gulch course northerly.

1500. To Cor. No. 3,

Set a porphyry stone 24 x 12 x 8 ins., 12 ins., in the ground for Cor. 3, stone scribed B.-3-1754, and a cross for the exact corner point and raise a mound of stone alongside.

No bearings available.

Thence N.  $20^{\circ} 05'$  W.

290. To ~~Whipsaw Gulch and a road.~~

300. To E. J. C. a mound of stones.

420. To Whipsaw Gulch.

600. To Cor. No. 4, the N. E. Cor.

Set a Porphyry stone, 28 x 14 x 10 ins., 12

Feet. ins., in the ground, scribed B-4-1754 and a cross for exact corner point, and raise a mound of stone alongside. *Whence, Rock bluff marked X-B.R. B4-1754 brs N. 17° E. 8.2 feet distant.*

The N.E. Cor. of the Mill bears S. 44° W.

913.4 ft/ dist. No other bearings available.

*Corner falls in middle of road.*

Thence S. 78° W.,

On the North Side Line of the Blunderbus.

500. To Cor. No. 3 of the Side Line.

900. To Cor. 2-5 of the Side Line and ~~and~~ S. claims of this survey.

1200. To S. E. C. of the Mnd S.

1500.00 To Cor. No. 1 the place of beginning.

Survey of Exterior Boundaries.

Mean Variation  $15^{\circ}-08'$  E.

Survey is identical with the location,

\*\*\*\*\*

RED CROSS LODGE.

Beginning at Cor. No. 1 the N. W. Cor., set a porphyry stone, 24 x 12 x 8 ins., 12 ins., in the ground for the N. W. Cor. No. 1 of the Red Cross, scribed B. C. 1-1754 and a cross for exact corner point and raise a mound of stone alongside.

U. S. L. M. No. 1754 bears N. 4° 14' W., 1461. 6 ft.

Thence South.

300. To S. E. C. of the Red Cross and Cors. 1-2 of Dumney and K-t Tor claims of this survey.

600. To Cor. No. 2, the S. W. Cor.

Set a porphyry stone 24 x 12 x 10 ins., 12 ins., ~~in the ground~~

Feet.	<p>in the ground <sup>stone</sup> post scribed R. C. 2, 1754 and a cross for exact corner point and raise a mound of stone alongside. Thence</p> <p>Mill bears N. <math>51^{\circ} 30'</math> E.</p> <p>Smelter bears N. <math>19^{\circ} 41'</math> W.</p> <p>S. T. Cor. of the Atlanta N/ <math>23^{\circ} 32'</math> W.</p> <p>No other bearings available.</p> <p style="text-align: center;"><u>Thence N. <math>88^{\circ} 23'</math> E.</u></p>
220.6	<p>On the South side line of the Red Cross.</p> <p>Intersect line 1-2 of the Dumrey at S. <math>36^{\circ} 45'</math> E., 367.16 ft. dist. from cor. 1 of the Dumrey.</p>
1500.	<p>To Cor. No. 3,</p> <p style="padding-left: 40px;">Set a porphyry stone, 24 x 12 x 9 ins., 12 ins., in the ground, scribed P. C. 3-1754 and a cross for exact corner point and raise a mound of stone alongside.</p> <p>No bearings available.</p>
	<p style="text-decoration: underline;">Thence North.</p>
300.	<p>To E. E. C. a mound of stones.</p>
600.	<p>To cor. No. 4, the N. E. Cor., Set a granite stone 26 x 24 x 12 ins., 12 ins., in the ground marked with a cross for the exact corner point and raise a mound of stone alongside.</p>
	<p style="text-decoration: underline;">Thence S. <math>88^{\circ} 23'</math> E.</p>
437.	<p>Intersect line 2-3 of the Blunderbuss at N/ <math>78^{\circ}</math> E. 821.49 ft. dist. from Cor. No. 2 of the Blunderbuss.</p>
1299.3	<p>Intersect line 1-2 of the Blunderbuss at N/ <math>20^{\circ} 05'</math> W.</p>



158.45 ft. dist. from Cor. No. 2 of the Blunderbush.

1500. To Cor. No. 1 the place of beginning.

The survey is identical with the location.

Mean Variation at Corners  $15^{\circ}$  E.

\*\*\*\*\*

D U M M E Y.

Beginning at Cor. No. 1, the N. E. Cor. Identical with the S. E. C. of the Patanka and Cor. 2, of the K. 2. Tor. Corner heretofore described.

N. S. E. M. NO. 1754 bears N.  $3^{\circ} 31'$  W., 1760.6 ft.

Thence S.  $36^{\circ} 45'$  E.

On the East Side Line of this Claim.

367.16 Intersect line 2-3 of the Red Cross at N.  $88^{\circ} 33'$  E.,  
220.6 ft. dist. from Cor. No. 2 of the Red Cross.

1500. To Cor. No. 2, the S. E. Cor. of the Claim.

Set a porphyry stone 24 x 14 x 10 ins.,  
12 ins/., in the ground, scribed 2-1754 D., and a  
cross for exact corner point and raise a mound of  
stone alongside. Thence,

A granite rock 34 x 60 x 40 ins., mkl. \* B. R.  
D. 2-1754 hrs. N.  $39^{\circ} 51'$  E., 24 ft. dist.

A granite rock 20 x 12 x 30 ft. mkl. with a  
\* B. R. D. 2-1754 hrs. S.  $78^{\circ} 19'$  W., 13.1 ft. dist.

Thence S.  $62^{\circ} 39'$  W.

On the South End Line of Dumey on a Bald Malpai Ridge.

300. S. E. C. A mound of stones.

600. To Cor. No. 3,

Feet. Identical with the S. E. cor. No. 2 of the Uncle John a claim of this survey.

Set a porphyry stone 36 x 14 x 10 ins., 14 ins. in the ground, scribed D. 3-1754 and W. J. 2-1754, and raise a mound of stone alongside.

No bearings available.

Thence N. 36° 45' E.

Along the West side line of the Derry and the East side line of the Uncle John.

1002. To a Gulch 30 ft/ wide, course N. E.

1241. Gulch 20 ft. wide, course N. N. W.

1320. Gulch course N. W. Same.

1500. To Cor. No. 4,

Identical with Cor. No. 3, of the K. 2 Tor, No. 1 of the Uncle John and No. 3 of the Massade All claims of this Survey.

Set a granite stone 24 x 12 x 10 ins., 12 ins., in the ground Scribed. D. 4-1754 on the S. E. K. 2 Tor 3-1754 on the N. E., W. 2-1754 on the N. W. and W. J. 1-1754 on the S. E. faces, and a cross for exact corner point and raise a mound of stone 3 ft. base 2 1/2 ft. high N. of Set stone.

U. S. L. M. No. 1754 hrs. N. 17° 49' E., 2077.4 ft. dist. No other bearings available.

Thence N. 62° 39' E.

On the North End line of this Claim and the South End line of the K. 2 Tor a claim of this Sur.

Feet.  
 300. To N. E. C. identical with the S. E. C. of the K.2  
 Tor a mound of stones.  
 600. To Cor. No. 1, the place of beginning.  
 All Corners are identical with the location.  
 Var.  $14^{\circ}55'$  E. at all four corners.

\*\*\*\*\*

UNCLE JOHN LODE CLAIM.

Beginning at Cor. No. 1 the N. E. Cor. ,  
 Identical with Corners 3 of K. 2 Tor 4 of Dummer and  
 2 of Masade. Corner heretofore described.  
 U. S. L. M. No. 1754 hrs. N.  $11^{\circ}49'$  E., 2077.4 ft.  
Thence S.  $36^{\circ}45'$  E.

On the East side line of this claim and the West  
 Side Line of the Dummer Sur. 1754.

1500. To Cor. No. 2, identical with Cor. No. 3 of the  
 Dummer. Corner heretofore described.

Thence S.  $62^{\circ}29'$  W.,

On the South End line of this Survey.

300. To S. E. C. a mound of stones.

600. To Cor. No. 3, the S. W. Cor.

Set a Granite stone, 26 x 12 x 10 ins., 12 ins.  
 on the ground, scribed U. J. 3-1754 and a cross for  
 exact corner point and raise a mound of stone 3 ft.  
 base  $1\frac{1}{2}$  ft. high alongside.

Thence,

Feet.	Smelter bears N. 5° 55' W. Assay Office bears N. 14° 57' W. Open Cut bears N. 35° 25' E., 780 ft. No other bearings available. <u>Thence N. 36° 45' E.</u> On the West Side Line of this Claim.
602.	Gulch 15 ft. wide, bears N. E.
1200.	Gulch 20 ft. wide, bears N. N. E., and begin ascent.
1500.	To Cor. No. 4, Identical with Cor. No. 3 of the <del>Massade</del> a claim of this survey. Set a porphyry stone 24 x 18 x 14 ins., 12 ins. in the ground, scribed N. J. 4-1754 on the S. E. and M. 3-1754 on the N. E. faces and raise a mound of stone alongside. On easterly slope of Bald Ridge. No bearings avail. <u>Thence N. 62° 39' E.</u> On the North End Line of this claim and the South End line of the <del>Massade</del> a claim of this survey.
105.	Gulch 13ft. wide, course N.
300.	To the N. E. C. of this claim and the S. E. C. of the <del>Massade</del> a mound of stones.
525.	Gulch 20 ft. wide, course N. N. E.
600.	To Cor. No. 1 the Place of Beginning. Survey is identical with the location. Variation at all corners. 14° 55' E.

Feet.

K. 2- Tor.

Beginning at Cor. No. 1 the N. E. Cor.

Identical with the S. E. Cor. 2 of the Merrimac  
a claim of this survey.

U. S. L. M. No. 1754 bears N.  $43^{\circ} 21'$  E., 969.7 ft.

Set a porphyry stone 24 x 18 x 14 ins., 12 ins., in  
the ground scribed K. 2 T-1-1754 on the S. E. and  
U. 2, 1754 on the N. T., and a cross for exact corner  
point and raise a mound of stone alongside.

A shaft bears N.  $68^{\circ} 29'$  W., 222. ft. dist.

No other bearing objects available.

Thence S.  $26^{\circ} 45'$  E.

On the East Side Line of the K-2-Tor

490. To a Gulch 20 ft. wide, course Easterly.

563.8 Intersect line 3-4 of the Patanka Lode Claim at  
N.  $20^{\circ} 05'$  W. 661.2 ft. dist. from the S. T. Cor.  
No. 3 of the Patanka.

1290. To Cor. No. 2, the S. E. Cor., identical with  
Cor. No. 1 of the Dimmey. Cor. heretofore described.

Thence S.  $62^{\circ} 39'$  W.

On the South End Line of this Claim and the N. End  
Line of the Dimmey.

300. To S. E. C. a mound of stones.

400. To a shaft on line.

600. To cor. No. 3, the S. T. Cor. identical with Cor.  
4-Dimmey, 2-Mossale and 1-Junkle John Claims of this Sur.

Feet.	Corner Heretofore described.
	<u>Thence N. 36° 45' W.</u>
	On the West Side Line of this Claim.
120.	Gulch Course N. E. 30 ft. wide., and begin ascent.
540.	Top and Descend.
672.	Gulch course Easterly.
880.	Gulch course Easterly.
1390.	To Cor. No. 4,
	Identical with Cors. Nos. 3 of the Merrimac and 1 of the Massade Claims of this Survey.
	Set a granite stone 24 x 12 x 10 ins.; 12 ins. in the ground scribed 4, K. 2 T., 1754, N. 1-1754 and Mer. 3, 1754 and raise a mound of stone alongside.
	U. S. L. M. No. 1754 bears N. 53° 43' E., 1556.8 ft. dist. No other bearing objects available.
	<u>Thence N. 62° 39' E.,</u>
	On the N. End Line of the K. 3 Tor and South End Line of the Merrimac a claim of this survey.
300.	To N. E. C. identical with the S. E. C. of the Merrimac a mound of stones.
600.	To Cor. No. 1 the place of beginning. Survey is identical with the location. Variation at all corners 14° 55' E.

\*\*\*\*\*

M A S S A D E C L A I M.

Beginning at Cor. No. 1, the N. E. Cor. of the  
Claim, identical with Cor. 3 of the Merrimac and

Feet.	<p>No. 4 of the K. 2 Tor Claims of this survey.  U. S. L. M. No. 1754 hrs. N. <math>53^{\circ} 43'</math> E., 1556.3 ft.  Corner heretofore Described.</p>
	<p style="text-align: center;"><u>Thence S. <math>36^{\circ} 45'</math> E.</u></p>
	<p>On the East side line of this claim and the west  side line of the K. 2 Tor of this survey.</p>
1390.	<p>To Cor. No. <sup>2</sup> &amp; the S. E. Cor.</p>
	<p>Identical with Corners Nos. 4 Dumrey, 1 of Uncle Jh  John and 3 of K. 2 Tor.</p>
	<p>Corner heretofore Described.</p>
	<p style="text-align: center;"><u>Thence S. <math>62^{\circ} 39'</math> W.</u></p>
	<p>Along the South end line of this claim and the  North end line of the Uncle John a claim of this  survey.</p>
300.	<p>To the S. E. C. Mon. a mound of stones.</p>
600.	<p>To Cor. No. 3, the S. T. Cor. identical with  Cor. No. 4 the N. T. Cor. of the Uncle John Corner  heretofore described.</p>
	<p style="text-align: center;"><u>Thence N. <math>36^{\circ} 45'</math> W.</u></p>
	<p>Along the West side line of this claim.</p>
702.	<p>A gulch bearing easterly.</p>
1325.	<p>A gulch bearing easterly.</p>
1390.	<p>To Cor. No. 4, the N. W. Cor.</p>
	<p>Set a granite stone 24 x 12 x 10 ins., 12 ins.,  in the ground, scribed N. 4-1754 and a cross for the  exact corner point and raise a mound of stone alongside.  No bearings available.</p>

Feet.

Thence N. 62° 39' E.

On the North end line of this claim.

140. To a gulch bearing northerly.

300. To N. E. C. a mound of stones.

600. To Cor. No. 1 the place of beginning.

All corners are identical with their respective location

Var. 14° 50' E.

\*\*\*\*\*

MERRIMAC.

Beginning at Cor. No. 1 the N. E. Cor. of the Claim., Identical with the N. W. Cor. No. 4 of the Star lot of this Survey.

Set a granite stone 24 x 12 x 10 ins., 12 Ins., in the ground, scribed Mer. 1-1754 on the S. W. and S. 4-1754 on the S. E. faces; and a cross for exact corner point and raise a mound of stones alongside. Thence, U. S. L. M. No. 1754 bears S. 65° 20' E., 1030.3 ft. dist.

No other bearings available.

Thence S. 11° 45' E.

On the East Side Line of the Merrimac.

1100. To Cor. No. 2, the S. E. Cor. identical with Cor. No. 1 of the K. 2 Tr., Cor. heretofore described.

Thence S. 62° 39' W.

On the South End Line of this Claim.

300. To S. E. C. a Mound of stones.

600. To Cor. No. 3 the S. W. Cor., identical with Cor.



Feet. No. 1 of the Massade and 4 of the K. 2 Tor claims  
of this survey. Cor. heretofore described.

Thence N. 11° 45' W.

On the West Side Line of the Merrimac.

1100. To Cor. No. 4 the N. W. Cor.

Set a granite stone 36 x 12 x 10 ins., 12 ins.  
in the ground, scribed M.-4-1754 on the S. E. face,  
with a cross for exact corner point and raise a  
mound of stone alongside. Thence

An open cut bears N. 74° 09' E., 292.4 ft.

No other bearings available.

Thence N. 62° 30' E.

On the North End line of this Claim.

Along Southern Slope of Mountain ridge.

300. To the N. E. C. of the Claim a mound of stones.

600. To the place of beginning.

Survey is identical with location.

Var. at all cons. 14° 20' E.

\*\*\*\*\*

S T A P L O D E C L A I M.

Beginning at Cor. No. 1 the N. E. Cor., on the  
West side line of the Atlanta Claim of this Survey at  
S. 3° 30' W., 544.08 ft. Dist. from the N. W. Cor.  
No. 3 of the Atlanta.

Set a porphyry stone 24 x 14 x 6 ins., 12 ins., in  
the ground, scribed S.1-1754 on the S. W. face and

Feet.

a cross for exact corner point and raise a mound of stone alongside., Thence,

Cistern bears S.  $45^{\circ} 10'$  E.

Smokestack of hoist bears S.  $56^{\circ} 23'$  E.

H. S. L. N. No. 1754 hrs. S.  $47^{\circ} 14'$  E., 742.14 ft.

No other bearings available.

Thence S.  $5^{\circ} 46' 30''$  E.

On the East side line of the Star.

922.0 Intersect line 1-4 of the Atlanta, at N.  $73^{\circ}$  E.

137 ft. from Cor. No. 4 of the Atlanta.

1471.75 To Cor. No. 2 of the Star Lots, the S. E. Cor. on the West side line of the Patanka lot claim of this survey at S.  $20^{\circ} 05'$  E., 552. ft. dist. from Cor. No. 4 of the Patanka.

Set a porphyry stone 24 x 12 x 10 ins., 12 ins., in the ground, scribed S. 2-1754 on the N. W. face and a cross for exact corner point and raise a mound of stone alongside., Thence

S. W. Cor. of Shelter hrs. N.  $62^{\circ} 55'$  E.

Cistern bears N.  $11^{\circ} 12'$  E.

No other bearings available.

Thence S  $73^{\circ} 57'$  W.

On the South End Line of the Star.

95  
74.0

Intersect line 1-2 of the K. 2 Tor at S.  $26^{\circ} 45'$  E.,

406.0

~~402.0~~ ft. dist. from Cor. No. 1 of the K. 2 Tor.

200.

To the S. E. C/ of the Claim, a mound of stones.

400.0

To Cor. No. 3 the S. W. Cor.

Feet.

Set a granite stone 27 x 12 x 6 Ins., 12 ins.,  
in the ground scribed S. 3-1754 on the Z.N E. face  
and a cross for exact corner point and raise a mound  
of stones alongside.

No bearings available.

Thence N. 5° 46' 30" E.

On the West side line of the Star.

332.45  
~~324.33~~

Intersect line 2-3 of the Merrimac at S. 62°39' W.,  
123.14 ft. dist. from Cor. No. 2 the S. E. Cor.  
of the Merrimac.

1471.75

To Cor. No. 4, the N. E. Cor., identical with  
Cor. No. 1 of the Merrimac, corner heretofore descri-  
bed.

Thence N. 78° 57' E.

Along slope of ridge on the N. End line of this  
Claim.

200.

To the N. E. C. of this claim.

100.

To Cor. No. 1 the place of beginning.

Survey of exterior boundaries.

Survey is identical with the location.

Var. 14° 45' E.

\*\*\*\*\*

L E D G E S.

The presumed courses of the several ledges, as near  
as can be traced upon the ground is as follows,

ATLANTA, N. 2° 30' E., 1490.8 ft. from the S. E. C.  
Mon. to the N. E. C. Mon.

PATANKA, N. 20° 05' W., 1450 ft. from the S. E. C.

Feet. BROOKLYN, S. 68° E., 1500. ft. from the W. E. C. to the E. E. C. of the claim.

MAID S. From the S. E. C. Mon., N. 20° 05' W., 750 ft. Thence N. 2° 30' E. 750 to the N. E. C.

SIDE LINE, N. 20° 05' W., from the S. E. C. to the N. E. C. of the Claim.

REINDERBUSH, N. 78° E., 1500 ft. from the W. E. C. to the E. E. C. of the claim.

RED CROSS, N. 88° 33' E., 1500 ft. from the W. E. C. to the E. E. C. of the claim.

DUMBLEY, N. 36° 45' W., 1500 ft. from the S. E. C. to the N. E. C. of the claim.

UNKLE JOHN, from the S. E. C. N. 36° 45' W., 1500 ft.

K. 2-TOR, from the S. E. C. N. 36° 45' W., 1390 ft.

WASSADE, from the S. E. C. N. 36° 45' W., 1390 ft.

MERRIMAC, from the S. E. C. N. 11° 45' W., 1100 ft.

STAR, from the S. E. C. N. 5° 46' 30" W.,  $\frac{1471.75}{1400.9}$  ft.

\*\*\*\*\*

Improvements.

I certify that the value of the labor and improvements upon these claims, placed thereon by the claimants and their grantors, is not less than five hundred dollars, for each claim and that said improvements consist of,

On the Atlanta Lode,

No. 1 <sup>Open</sup> Open cut, 12 x 6 x 5 ft., the face of which is on the center line, bearing S. 2° 30' W., 167 ft. from the N. E. C. of the claim.

- No. 2 A tunnel 6 x 4 x 60 ft., the mouth of which bears from Cor. No. 4, N.  $10^{\circ} 10'$  E., 580 ft.  
Value, \*\*\*\*\*\$550.00
- No. 3 An open cut, 10 x 20 ft. in rock, the face of which bears from Cor. No. 4 N.  $35^{\circ} 43'$  E., 704.5 ft.  
Value, \*\*\*\*\*\$100.00
- No. 4, A shaft, 15 x 5 x 7 ft. in rock, bears from Cor. No. 4, N.  $39^{\circ} 30'$  E., 654 ft.  
Value, \*\*\*\*\*\$750.00
- No. 5 A shaft, 5x7 x 300 ft. upon which there is a steam hoist, bears from Cor. No. 2 S.  $13^{\circ} 45'$  W., 750 ft.  
Value, \*\*\*\*\*\$3000.00

PATANKA LODI.

- No. 1 <sup>Dis</sup> Main open cut and tunnel, the mouth of which bears S.  $23^{\circ} 46'$  W., 490 ft. from Cor. No. 1 and N.  $30^{\circ} 10'$  W., 65 ft. from the N. E. Cor. of the Smelter., turning thence, N.  $57^{\circ} 57'$  W., 15 ft. to mouth of tunnel; thence on same course, 37.4 ft. to a pt. thence N.  $17^{\circ} 18'$  E., 31 ft. to a point; thence N.  $33^{\circ} 41'$  ft/ to a point. thence N.  $13^{\circ} 57'$  W., 16 ft. to a shaft, 4 x 7 x 130 ft. Dip  $34^{\circ} 30'$ ; thence N.  $23^{\circ} 46'$  W. 62 ft. to a point; thence N.  $7^{\circ} 7'$  W., 55.5 ft. to a point; thence N.  $21^{\circ} 52'$  W., 32.5 ft. to a point; thence N.  $24^{\circ} 20'$  W., 32 ft. to a point; thence N.  $1^{\circ} 30'$  E. 135 ft. to a point; and a shaft 5 x 7 x 116 ft. dip  $45^{\circ}$ ; thence N.  $34^{\circ} 29'$  E., 53.4 ft. to a point; thence N.  $0^{\circ} 33'$  W., 51 ft. to a point; thence N.  $8^{\circ} 25'$  W., 29.7 ft. to a point; Thence N.  $38^{\circ} 43'$  E., 67 ft. to a point; thence

N. 42° 17' W., 27 ft. to a point; thence N. 7° 59' E., 39 ft. to a point; thence N. 6° 57' W., 56 ft. to a point, and a cross cut running westerly 25 ft. and easterly 12 ft.; thence N. 2° 2' E., 53 ft. to a point; thence N. 26° 35' E., 60 ft. to a point; thence N. 35° E., 16 ft. to a point; thence N. 24° 41' E., 72 ft. to a point; thence N. 35° 14' E., 56 ft. to a point; thence N. 14° 39' E., 34 ft. to a point; thence N. 37° 27' E., 200 ft. to a point; thence into slope on Ward S., which is 400 ft. long.

Total value of tunnels which averages 5 x 7 ft. with shafts and slopes and crosscuts,

Value, \*\*\*\*\*\$ 13,000.00

No. 2

An open cut, 10 x 8 x 4 ft., the mouth of which bears from Cor. No. 1, S. 77° W., 310 ft.

Value, \*\*\*\*\*\$ 100.00

No. 3

An open cut, 12 x 10 x 6 ft., the face of which bears from Cor. No. 1, S. 69° 20' W., 290 ft.

Value, \*\*\*\*\*\$ 120.00

BROOKLYN LODGE,

No. 1

<sup>100</sup> A shaft, 5 x 6 x 80 ft., whci bears from Cor. No. 4 S. 43° 57' E., 302.6 ft.

Value, \*\*\*\*\*\$ 800.00

No. 2

An open cut 20 x 10 x 5 ft., the mouth of which hrs. from Cor. No. 1 N. 51° 20' E., 192 ft.

Value, \*\*\*\*\*\$ 200.00

TO BE ACCREDITED TO THIS CLAIM FROM TUNNEL NO. I

ON PATANKA, \*\*\*\*\*\$ 1,000.00

MAIND S.

No. 1 <sup>Dis</sup> A tunnel the mouth of which bears N. 52° W., 360 ft. from Cor. No. 4, Tunnel 5 x 6 x 20 ft. in rock.  
 Value, \*\*\*\*\*\$ 200.00

No. 2 A tunnel, 18 x 5 x 7 ft. in rock, the mouth of which bears S. 30° 30' E., 92 ft. from Cor. No. 1  
 Value, \*\*\*\*\*\$ 200.00

~~No. 3~~ <sup>400</sup> FT. OF STOPE DESCRIBED AT END OF PATANKA MAIN TUNNEL.  
 Value, \*\*\*\*\*\$ 4,000.00

No. 8 A tunnel, 5 x 7 x 71 ft. the mouth of which bears from Cor. No. 1, S. 32° 15' E., 160 ft.  
 Value, \*\*\*\*\*\$ 700.00

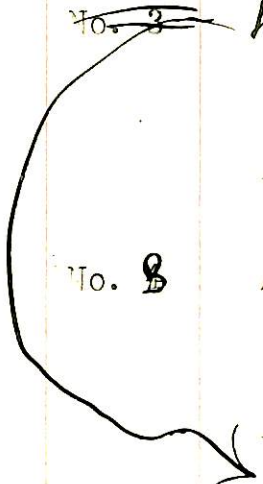

S I D E L I N E.

No. 1 <sup>Dis</sup> A cut, 20 x 5 x 7 ft., the mouth of which bears from the S. E. C. of the claim, N. 20° 5' W., on center line 352 ft.  
 Value, \*\*\*\*\*\$ 250.00

No. 2 A tunnel, 5 x 6 x 30 ft., the mouth of which bears from Cor. No. 3 N. 23° 25' E., 640 ft.  
 Value, \*\*\*\*\*\$ 300.00

1/4 INTEREST IN STAMP MILL ON THE BLUNDERBUS CLAIM  
 Value of 1/4 Interest, \*\*\*\*\*\$ 1,000.00  
BLUNDERBUS.

No. 1 The Dis. an open cut <sup>559°30'E 438.5ft</sup> 4x6x15 which bears from Cor. No. 1  
 Value, \*\*\*\*\*\$ 100.00

No. 2 An open cut, the mouth of which bears from Cor. No. 2 N. 46° 10' E., 255 ft., cut 10 x 12 x 6 ft.  
 Value, \*\*\*\*\*\$ 120.00  
TO BE ACCREDITED FROM A STAMP MILL ON THIS CLAIM,  
 Which bears from Cor. No. 4 S. 44° W., 553.4 ft.  
 1/4 interest, Value, \*\*\*\*\*\$ 1,000.00  
REDCROSS,

No. 1 *ditto* An open cut, 10 x 10 x 6 ft., the mouth of which bears from Cor. No. 2, N. 52° 15' E., 255 ft.  
 Value, \*\*\*\*\*\$ 150.00

No. 2 A tunnel, 5 x 7 the mouth of which bears from Cor. N° 2, 164', <sup>N 82° 10' E</sup> tunnel runs S. 50° E., 48 ft.  
 Value, \*\*\*\*\*\$ 500.00  
TO BE ACCREDITED 1/4 INTEREST IN STAMP MILL ON THE BLUNDERBUS CLAIM, \*\*\*\*\*\$ 1,000.00  
DUMMEY,

No. 1 *ditto* A tunnel, 12 x 5 x 7 ft., the mouth of which bears from Cor. No. 1, S. 54° 40' W., 376.3 ft.  
 Value, \*\*\*\*\*\$ 120.00

No. 2 A tunnel the mouth of which bears from Cor. No. 3 N. 18° 12' W., 900 ft., Tunnel runs S. 28° 30' W. 15 ft. to a shaft, 5 x 6 x 28 ft. thence N. 24° 3' W. 57 ft.; thence N. 54° 13' E., 34.8 ft.  
 Value, \*\*\*\*\*\$ 1,350.00

~~No. 1~~ 1/4 INTEREST IN STAMP MILL ON THE BLUNDERBUS CLAIM TO BE ACCREDITED TO THE DUMMEY, Value, \*\*\*\$ 1,000.00  
UNCLE JOHN,

No. 1 *ditto* A tunnel the mouth of which bears from Cor. No. 3 N. 16° 45' W., 915.5 ft. tunnel runs N. 16° 45' W.,



25 ft. 5 x 7 ft.

Value, \*\*\*\*\*\$ 250.00

No. 2 A tunnel 12 x 6 x 7 ft. bears from same cor.

N. 4° 15' W., 1089. ft.

Value, \*\*\*\*\*\$ 75.00

No. 3 An open cut, 5 x 7 x 10 ft. bears from same cor.

N/ 35° 25' W., 790 ft.

Value, \*\*\*\*\*\$ 100.00

TO BE ACCREDITED TO THIS CLAIM 1/4 INTEREST IN

SMEETER ON PATANKA LODE CLAIM THIS SURVEY:

VALUE OF INTEREST, \*\*\*\*\*\$ 5,000.00

MASSADE.

No. 1 *Dis* shaft 10 x 5 x 7 ft., bears S. 5° 10' W.,

413.5 ft. from cor. No. 1,

Value, \*\*\*\*\*\$ 150.00

No. 2 A tunnel from same point, S. 12° 7' E.,

396.5 ft. tunnel runs S. 40 43' W., 95 ft.

thence W. 40° W., 10 ft.; total length 54 ft.

Value, \*\*\*\*\*\$ 540.00

1/4 INTEREST IN SMEETER ON PATANKA .

VALUE OF INTEREST, \*\*\*\*\*\$ 5,000.00

K 2 TOR,

No. 1 A Dis.Cut <sup>7x7x12'</sup> which bears from S.E.C. N 36° 45' W. 720'

Value, \*\*\*\*\*\$ 100.00

No. 2 A Shaft <sup>4x6x10'</sup> which bears from Cor. N 24° N 2° 07' E 390'

Value, \*\*\*\*\*\$ 100.00

No. 3 A shaft which is on line 2-3 of this claim, at

S. 62° 39' W., 400. ft. from Cor. 2. shaft 20 x 6 x 5

ft. Value, \*\*\*\*\*\$ 200.00

This shaft runs on incline northerly from breast.

1/4 INTEREST IN SMELTER ON PATANKA TO BE ACCREDITED TO THIS CLAIM? VALUE OF INTEREST. \*\*\*\*\*\$5,000.00

REPTAS/

No. ~~1~~ <sup>4</sup>

A tunnel 10 x 7 x 5 ft., bears from Cor. No. 2 N. 63° 23' E., 378 ft.

Value, \*\*\*\*\*\$ 100.00

No. 2

A tunnel 15 x 8 x 4 ft. from same point, and Course dist. 353 ft.

Value, \*\*\*\*\*\$ 150.00

No. 3

A tunnel, 20 x 6 x 4 ft., from the same point on same course, 228 ft. dist.

Value, \*\*\*\*\*\$ 200.00

No. ~~4~~

From Cor. No. 4, <sup>10'</sup> open cut, 20 x 10 x 6 ft., bears N. 74° 9' E., 232.4 ft. dist.

Value, \*\*\*\*\*\$ 200.00

No. 5

An open cut 12 x 6 x 6 ft. from same cor. S. 38° 15' E., 306 ft.

Value, \*\*\*\*\*\$ 120.00

No. 6

An open cut, 20 x 8 x 6 ft. bears from Cor. No. 2 N/ 32° 30' E., 662 ft.

Value/ \*\*\*\*\*\$ 200.00

STAR.

No. 1

<sup>10'</sup> An Open Cut 16' 8" x 12' 5" bears from Cor. No. 1, S 29° W, 330 feet dist.

Value, \$ 100.00

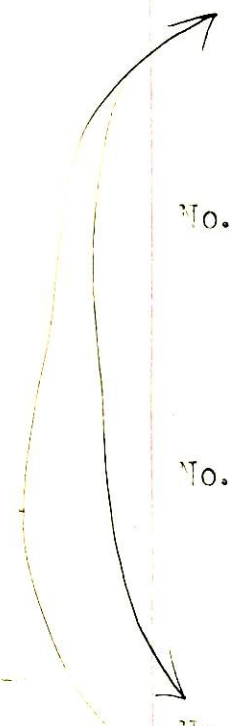

1/4 INTEREST IN SMELTER TO BE ACCREDITED TO THIS

CLAIM. VALUE OF INTEREST\*\*\*\*\*\$ 5,000.00

\*\*\*\*\*

OTHER IMPROVEMENTS.

A road which runs over the Atlanta, Patanka, and S. Side line and the Blunderbus Claims from Smelter To other parts of the claims.

Value,\*\*\*\*\*\$ 4,500.00

A stamp Mill, heretofore mentioned.

Value,\*\*\*\*\*\$ 4,000.00

A steam hoist on the Atlanta Claim, bears from Cor.

No. 4 of the Brooklyn S.  $16^{\circ} 45'$  W., 750 ft.

Value,\*\*\*\*\*\$ 2,000.00

Smelter on Patanka, heretofore mentioned, which bears from Cor. 1 of Patanka S.  $21^{\circ} 30'$  W., 571 ft.

Net value, \$ 20,000.00

Boarding house on the Blunderbus, bearing from

Cor. No. 1 S.  $75^{\circ} 00'$  E., 760 ft.

Value,\*\*\*\*\*\$ 1,000.00

Barn on same claim from cor. No. 1, S.  $44^{\circ}$  E., 312 ft.

Value,\*\*\*\*\*\$ 1000.00

Assay Office on K. 2 Tor, which bears from Cor. 4 same claim S.  $59^{\circ} 45'$  E., 712 ft.

Value,\*\*\*\*\*\$ 2,000.00

Water Tank on the Patanka Claim, bearing from Cor.

No. 1, S.  $32^{\circ} 10'$  W., 520 ft.

Value,\*\*\*\*\*\$ 250.00

Feet.

A R E A.

Acres

Total and Net Area of the Atlanta.		16.85
Total and Net Area of the Patanka,		16.72
Total and Net Area of the Maul S. _____		20.228
Total Area of the Red Cross,	20.65 ✓	
Less Conflict with Patanka, this surv.	1.586 ✓	
Less Conflict with Dumney, " "	.757 ✓	
Less Conflict with Blunderbus " "	<u>1.429</u>	
Net Area of the Red Cross,		<u>16,828</u>
Total Area of Brooklyn,	19.470	
Less Conflict with Side Line, this surv.	<u>1.93</u>	
Less Conflict with Maul S., this surv.	2.392	
Net Area of Brooklyn, .....		<u>15.148</u>
Total Area of Side Line,	13.490 ✓	
Less Conflict with Maul S., this surv.	2.428 ✓	
Net Area of Side Line, .....		<u>11.062</u>
Total and Net Area of BlunderBuss, .....		20.420 ✓
Total and Net Area of Dumney, .....		20.33
Total and Net Area of Uncle John, .....		20.33
Total Area of K. 2 Tor,	18.83 ✓	
Less Conflict with Patanka, this surv.	1.57 ✓	
Net Area of K. 2 Tor, .....		17.26
Total and Net Area of Massade, .....		18.33 ✓
Total and Net Area of Merrimac, .....		14.66 ✓
Total Area of Star,	13.76 ✓	
Less Conflict with Patanka, this surv.	.86 ✓	
Less Conflict with Merrimac,	1.50 ✓	

Less Conflict with K. E. Tor, this surv.	1.315	✓
Less Conflict with Atlanta, this surv.	1.455	✓
Net Area of Star,.....	8.13	
Net Area of Lode Claim,.....	<del>20,749</del>	

216,806

\*\*\*\*\*

LOCATION.

*In Castle Creek, Min. Dist. Yavapai Co. Arizona, on unreserved public lands.*

There are several adjoining claims, names and claimants unknown.

\*\*\*\*\*

INSTRUMENT.

This survey was made with a Leitz Light Mountain Transit. The courses were deflected from the true Meridian, as determined by direct Solar observations checked on Polaris. The distances were measured with a 50 and 200 ft. steel tape.

*James B. Simpson*  
U. S. Deputy Mineral Surveyor.

## ESTABLISHMENT OF U. S. L. M. NO. 1754.

On a Bald Malpai Ridge, I set a Granite stone, 45x  
20 x 10 inches, set 23 ins., in the ground, with a  
mound of stone 5 ft. base and 4 ft. high alongside,  
stone chiseled U. S. L. M. No. 1754, and a + for exact  
corner point of connections, Whence,

Boarding house bears S. 23° 05' E.

Barr bears S. 10° 30' E.

N. E. Cor. of Smelter hrs. S. 17° 15' W.

Shaft with Tim bears S. 27° 31' E.

Tunnel bears S. 27° 41' W.

Tunnel bears S. 40° 57' W.

S. W. Cor. of Side Line S. 41° 15' E.

No other bearings available.

*James B. Beard*  
U. S. Deputy Mineral Surveyor.

# FINAL OATHS FOR SURVEYS.

## LIST OF NAMES.

A list of the names of the individuals employed by James B Girard  
 United States Deputy Mineral Surveyor, to assist in running, measuring, and marking the lines  
 corners and boundaries described in the foregoing field notes of the survey of the mining claim  
 of James Smith  
 known as the Brooklyn, Side Line, Mescal, Maud S, Star Mining & Millsite  
Massade, Dummy, Blunderbus, Red Cross, Uncle John,  
N. 2 Tor. Patanka & Atlanta  
 and showing the respective capacities in which they acted.

P. W. Latimer....., Chainman.

J. R. Batts....., Chainman.

....., Axman.

L. W. Hanson....., Flagman.

## FINAL OATHS OF ASSISTANTS.

We, P. W. Latimer, J. R. Batts  
 and L. W. Hanson....., do solemnly swear that we assisted James  
B. Girard....., United States Deputy Mineral Surveyor, in marking the corners and  
 surveying the boundaries of the mining claim of James Smith.....

....., known as the K. 2 Tor. Star Side Line,  
Star Mining & Millsite and Uncle John  
Patanka, Brooklyn, Mescal, Massade, Dummy, Blunderbus, Maud S, Atlanta, Red Cross,  
 in the foregoing field notes as having been surveyed by said deputy mineral surveyor and under  
 his direction; and that said survey has been in all respects, to the best of our knowledge and  
 belief, faithfully and correctly executed, and the corner and boundary monuments established  
 according to law and the instructions furnished by the United States Surveyor-General for  
Arizona.....

P. W. Latimer....., Chainman.

J. R. Batts....., Chainman.

....., Axman.

L. W. Hanson....., Flagman.

Subscribed and sworn to by the above-named persons before me  
 this 18<sup>th</sup> day of April, 1903

C. W. Herndon  
 Notary Public

My Commission expires April 16, 1905.

FINAL OATH OF U. S. DEPUTY MINERAL SURVEYOR

I, James B. Girard, U. S. Deputy Mineral Surveyor, do solemnly swear that, in pursuance of instructions received from the United States Surveyor General for Arizona, dated Jan 22 - 1903,

I have, in strict conformity to the laws of the United States, the official regulations and instructions thereunder, and the instructions of said Surveyor General, faithfully and correctly executed the survey of the Mining Claim of James H. Smith by Walter Darnell

Attorney at Law, known as the Star Mining & Mill site, PATANKA, BROOKLYN, MERRIMAC, MASSADE, DUMMEY, BLUNDERBUS, MAUD S., ATLANTA, RED CROSS & UNKLE JOHN R-2 TOP SPARK SIDE LINE situate in Castle Creek Mining District,

Yavapai County, Arizona, in Section approx, Township No. 9N, Range No. 2 west and designated as Survey No. 1754

as represented in the foregoing field notes, which accurately show the boundaries of said mining claim as distinctly marked by monuments on the ground, and described in the attached copy of the location certificate, which was received by me from the Surveyor General with said instructions, and that all the corners of said survey have been established and perpetuated in strict accordance with the law, official regulations and instructions thereunder; and I do further solemnly swear that the foregoing are the true and original field notes of said survey and my report therein, and that the labor expended and improvements made upon said mining claim by claimant or his grantors are as therein fully stated, and that the character, extent, location and itemized value thereof are specified therein with particularity and full detail, and that no portion of said labor or improvements so credited to this claim has been included in the estimate of expenditures upon any other claim.

James B. Girard  
U. S. Deputy Mineral Surveyor.

Subscribed and sworn to by the said James B. Girard  
U. S. Deputy Mineral Surveyor, before me J. M. Watts, Clerk U.S. Dist. Court Fourth Judicial Dist. of Arizona this 18th day of April 1903.

J. M. Watts  
Clerk U.S. Dist. Court

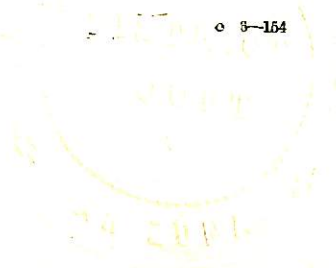



Supplemental Report of Improvements upon or for benefit of the Mining Claims embraced in Survey No.1754 and placed thereon prior to the expiration of the period of Publication of Application for Patent.

I certify that the value of the labor and improvements upon these claims, placed thereon by the claimants and their grantors, is not less than Five Hundred Dollars for each claim, and that said improvements consist of

On the Atlanta Lode.

No.1 Dis. open cut, 12 x 6 x 5 ft., the face of which is on the center line, bearing S. 2° 30' W., 167 ft. from the N. E. C. of the claim.

Value ..... \$120.00

No.2 A tunnel 6 x 4 x 60 ft., the mouth of which bears from Cor. No.4 N. 10° 10' E., 530 ft.

Value..... \$550.00

No.3 An open cut, 10 x 30 ft. in rock, the face of which bears from Cor. No.4, N. 35° 45' E. 704.5 ft.

Value..... \$100.00

No.4 A shaft 15 x 5 x 7 ft. in rock, bears from Cor. No.4, N. 39° 30' E., 654 ft.

Value..... \$150.00

No.5 A shaft, 5 x 7 x 300 ft. upon which there is a steam hoist, bears from Cor. No.2 S. 16° 45' W. 750 ft.

Value..... \$5000.00

PATANKA LODE.

No.1 Dis. Main open cut and tunnel, the mouth of which bears S. 23° 46' W., 490 ft. from Cor. No.1, and N. 30° 10' W., 65 ft. from the N. E. Cor. of the Smelter, Running thence, N. 57° 57' W., 15 ft. to mouth of tunnel; thence on same

2.

course 37.4 ft. to a pt. thence N. 17° 18' W. 31 ft. to a point; thence N. 38° E. 41 ft. to a point. Thence N. 13° 57' W., 16 ft. to a shaft, 4 x 7 x 130 ft. Dip 54° 30'; thence N. 33° 45' W. 62 ft. to a point; thence N. 7° 7' W., 55.5 ft. to a point; thence N. 31° 53' W. 32.5 ft. to a point; thence N. 34° 30' W., 32 ft. to a point; thence N. 1° 30' E. 135 ft. to a point; and a shaft 5 x 7 x 116 ft. dip 45°; thence N. 34° 29' N. 53.4 ft. to a point; thence N. 0° 33' W., 51 ft. to a point; thence N. 3° 35' W., 29.7 ft. to a point; thence N. 38° 48' E., 67 ft. to a point; thence N. 43° 17' W., 27 ft. to a point; thence N. 7° 59' E., 39 ft. to a point; thence N. 6° 57' W., 56 ft. to a point, and a cross cut running westerly 25 ft. and easterly 12 ft.; thence N. 2° 2' E., 53 ft. to a point; thence N. 26° 35' E., 60 ft. to a point; thence N. 55° E. 16 ft. to a point; thence N. 24° 41' E., 72 ft. to a point; thence N. 35° 14' E., 56 ft. to a point; thence N. 14° 39' E., 54 ft. to a point; thence N. 37° 27' E., 300 ft. to a point; thence into stope on Maud S., which is 400 ft. long.

Total value of tunnels which averages 5 x 7 ft. with shafts and stopes and crosscuts.

Value.....\$18,000.00

No.2 An open cut, 10 x 8 x 4 ft., the mouth of which bears from Cor. No.1 S. 77° W., 310 ft.

Value..... \$100.00

No.3 An open cut 12 x 10 x 6 ft. which bears from Cor. No.1 S. 69° 20' W., 280 ft.

Value..... \$120.00

#### BROOKLYN LODGE.

No.1 Dis. a shaft, 5 x 6 x 80 ft. which bears from Cor. No.4 S. 43° 57' E., 302.6 ft.

Value..... \$800.00

No.2 An open cut, 20 x 10 x 5 ft., the mouth of which bears from Cor. No.1 N. 51° 20' E., 198 ft.  
 Value..... \$200.00

TO BE ACCREDITED TO THIS CLAIM FROM TUNNEL NO.1 ON PATANKA ..... \$1000.00

MAUD S.

No.1 Dis. a shaft, the mouth of which bears N. 52° W., 360 ft. from Cor. No.4, Tunnel 5 x 6 x 20 ft. in rock.  
 Value..... \$300.00

No.2 A tunnel 18 x 5 x 7 ft. in rock, the mouth of which bears S. 30° 30' E., 92 ft. from Cor. No.1.  
 Value..... \$300.00

No.3 A tunnel, 5 x 7 x 71 ft. the mouth of which bears from Cor. No.1, S. 32° 15' E., 160 ft.  
 Value..... \$700.00

400 ft. OF STOPE DESCRIBED AT END OF PATANKA MAIN TUNNEL.  
 Value..... \$4,000.00

S I D E L I N E .

No.1 Dis. a cut, 20 x 5 x 7 ft., the mouth of which bears from the S E C of the main claim N. 20° 5' W. on center line 352 ft.  
 Value..... \$250.00

No.2 A tunnel, 5 x 6 x 30 ft., the mouth of which bears from Cor. No.3 N. 23° 25' E., 640 ft.  
 Value..... \$300.00

BLUNDERBUS.

No.1 The Dis. an open cut 4" x 6" x 15" which bears S. 59° 30' E. 438.5 ft. from Cor. No.1.  
 Value..... \$150.00

No.2 An open cut, the mouth of which bears from Cor. No.2 N. 46° 10' E., 235 ft., cut 10 x 12 x 6 ft.  
 Value..... \$300.00

1800 linear feet of Wagon Road on this claim.  
 Value ..... \$900.00

4.

The increase in value of open cuts 1 and 2 on this claim is for the reason that the original estimate was too low.

RED CROSS.

No.1 Dis. an open cut, 10 x 10 x 6 ft., the mouth of which bears from Cor. No.2, N. 52° 15' E., 255 ft.

Value.....\$150.00

No.2 A tunnel 5 x 7, the mouth of which bears from Cor. No.2, 174 ft. N. 82° 10' E., tunnel runs S. 50° E., 48 ft.

Value.....\$500.00

DUMMEY.

No.1 Dis. a tunnel, 12 x 5 x 7 ft., the mouth of which bears from Cor. No.1, S. 54° 40' W., 376.3 ft.

Value.....\$120.00

No.2 A tunnel the mouth of which bears from Cor. No.3 N. 18° 13' W., 900 ft. Tunnel runs S. 28° 30' W. 15 ft. to a shaft, 5 x 6 x 28 ft. Thence N. 24° 8' E., 57 ft; thence N. 54° 13' E., 34.8 ft.

Value.....\$1,350.00

UNKLE JOHN.

No.1 Dis. a tunnel, the mouth of which bears from Cor. No.3 N. 16° 45' W., 915.5 ft. Tunnel runs N. 16° 45' W., 37 ft. 5 x 7 ft.

Value.....\$375.00

No.2 A tunnel 12 x 6 x 7 ft. bears from same Corner, N. 4° 15' W. 1089 ft.

Value.....\$175.00

No.3 An open cut, 5 x 7 x 10 ft. bears from same cor. N. 35° 25' W., 780 ft.

Value.....\$100.00

I have increased the value of the discovery tunnel on account of error in original notes. This tunnel as shown by my field notes, as same appears marked on preliminary plat, reads 37 feet instead of 25 and is larger than the ordinary tunnel; hence the raise.

Also No.2 from \$75.00 to \$175.00, as it is evidently an error in making stenographic copy. My original field notes read \$175.00.

MASSADE.

No.1 Dis. a shaft 15 x 5 x 7 ft., bears S. 5° 10' W., 413.5 ft. from Cor. No.1.

Value.....\$150.00

No.2 A tunnel from same point, S. 12° 7' E., 396.5 ft. tunnel runs S. 40° 43' W., 35 ft. thence N. 40° W., 19 ft; total length 54 ft.

Value.....\$540.00

K 2 TOR.

No.1 A dis. cut, 7' x 7' x 12', which bears from S E C, N. 36° 45' W., 720 ft.

Value.....\$200.00

No.2 A shaft 4' x 6' x 10' which bears from Cor. No.4, N. 3° 07' E. 390 ft.

Value.....\$100.00

No.3 A shaft which is on line 2-3 of this claim, at S. 62° 39' W. 400 ft. from Cor. 2, shaft 20 x 6 x 5 ft.

Value.....\$200.00

This shaft runs on incline northerly from breast.

Assay Office on this claim, which bears from Cor. No.4 S. 59° 45' E. 712 ft.

Value..... \$2,000.00

I have increased the value of the discovery cut on this claim from \$100.00 to \$200.00, for the reason that my first estimate was too low.

MEREIMAC.

No.1 From Cor. No.4, Dis an open cut, 20 x 10 x 6 ft. bears N. 74° 9' E., 282.4 ft. dist.

Value.....\$200.00

No.2 A tunnel 15 x 6 x 4 ft. from same point, and course  
dist. 268 ft.

Value.....\$150.00

No.3 A tunnel, 20 x 6 x 4 ft., from the same point on same  
course, 228 ft. dist.

Value.....\$200.00

No.4 A tunnel, 10 x 7 x 5 ft., bears from Cor. No.2 N. 68°  
28' W., 378 ft.

Value.....\$100.00

No.5 An open cut 12 x 6 x 6 ft. from same cor. S. 36° 15' E.,  
306 ft.

Value.....\$120.00

No.6 An open cut, 20 x 8 x 6 ft. bears from Cor. No.2 N. 32°  
30' W., 662 ft.

Value.....\$200.00

STAR.

No.1 Dis. open cut 6' x 8' x 12' bears from Cor. No.1, S. 29°  
W., 330 feet dist.

Value.....\$200.00

TO BE ACCREDITED TO THIS CLAIM FROM TUNNEL NO.1 ON  
PATANKA, AND FROM CROSS-CUT RUNNING WESTERLY 25 FT.

\$500.00

I have increased the value of open cut on this claim from  
\$100.00 to \$200.00, for the reason that the first estimate  
was too low.

I have accredited a portion of the work in tunnel No.1 on  
the Patanka Claim and the cross-cut running 25 ft. wester-  
ly, because this tunnel was driven for the express purpose  
of developing the ore bodies on the contiguous claims as  
well as those on the Patanka; and the cross-cut to the  
west was made expressly for tapping the ore bodies at  
great depth on the Star:

It is usually estimated that a 4 x 6 x 10 shaft or open cut,  
or 440 cubic feet of rock excavated, is worth \$100.00. In

making my original estimates, believing that the value of the Smelter and Mill was to be apportioned on these claims, not enough attention was given to the actual value of some of these smaller openings. In readjusting and increasing these values, I have taken into consideration the instances wherein these openings are larger than ordinarily run. There would be no known reason for cutting the value of this work as all is in a similar character of rock, which is very hard. From an inspection of the preliminary plat, it will be seen that the location of tunnel No.1 on the Patanka was made with a view of developing the ore bodies on the contiguous claims, and it is just and proper that a portion of this work should be allotted to the several different claims; as, for instance, the cross-cut running 25 feet to the west toward the Star claim, will cut the ore bodies on this claim several hundred feet below the Patanka. This also would undoubtedly be true of the other claims when the work has sufficiently advanced in their direction.

---

#### Other Improvements.

A <u>road</u> which runs over the Atlanta, Patanka, Hard S., Side Line and the Blunderbus claims from Smelter, to other parts of the claims.	Value,	\$4,500.00
A <u>stamp mill</u> , heretofore mentioned,	Value,	\$4,000.00
A <u>steam hoist</u> on the Atlanta claim, brs, from Cor.No.4 of the Brooklyn S. $16^{\circ} 45'$ W. 750 ft.	Value,	\$2,000.00
<u>Smelter on Patanka</u> , heretofore mentioned, which brs. from Cor.No.1, of Patanka S. $31^{\circ} 50'$ W., 571 ft.	Net Value	\$20,000.00
<u>Boarding house</u> , on the Blunderbus. bearing from Cor. No.1, S. $75^{\circ} 00'$ E. 760 ft.	Value,	\$1,000.00
<u>Barn on same claim</u> from Cor. No.1, S. $44^{\circ}$ E. 312 ft.	Value,	\$1,000.00

Water Tank on the Patanka claim, bearing from Cor. No. 1, S. 32° 10' W. 520 ft.

Value, \$250.00

Prescott, Arizona,  
Jan. 25th, 1906.

U. S. Deputy Mineral Surveyor.

*[Handwritten signature]*



DEPARTMENT OF THE INTERIOR,  
Office of the U. S. Surveyor-General,

Phoenix, Arizona, February 13, 1906.

I, Frank S. Ingalls, United States Surveyor-General for the District of Arizona, hereby certify that the improvements upon the mining claims embraced in Mineral Survey No. 1754, Arizona Series, is not less than Five Hundred (\$500.00) dollars upon or for each location embraced in said survey; and more particularly, that the improvements as now set forth in the supplemental report of James B. Girard, U. S. deputy mineral surveyor, upon and for the Blunderbuss Claim is more than Five Hundred, (\$500.00) dollars; and that the increase in the value of the discovery open cut, and open cut No. 2 upon this claim is justifiable from the amount of work reported.

And further, that the eight hundred (800) linear feet of wagon road on this claim, valued at Nine Hundred (\$900.00) dollars is clearly a mining improvement, and the value of same is properly credited to the Blunderbuss Claim under the statutory requirement of Five Hundred (\$500.00) dollars for each lode;

And further, that the improvements for the Uncle John Lode as set forth in the said supplemental report, exceeds Five Hundred (\$500.00) dollars, and the value as now placed upon these improvements is justifiable from the amount of work done;

And further, that the improvements reported upon or for the benefit of the K-2 Tor Lode exceeds

Five Hundred dollars(\$500.00), and the value of these improvements, as reported in the said supplemental report is justified by the amount of work reported;

And further, that the improvements made upon or for the benefit of the Star Lode exceed Five Hundred (\$500.00) dollars in value, and the increase in the value of the discovery out on this claim from \$100.00 to \$200.00 is justifiable from the amount of work reported; also, that the cross-cut from Tunnel No.1 on the Patanka Lode is clearly an improvement for the development of the Star Lode, and the value of same is properly credited to the said Star Claim.

And I further certify that all these improvements were made prior to the expiration of the period of publication of notice of application for patent.

A copy of the supplemental report of James B. Girard, U. S. deputy mineral surveyor, which sets forth in detail the improvements upon or for the benefit of each claim embraced in this survey, which report is the basis of my certificate, is hereto attached.

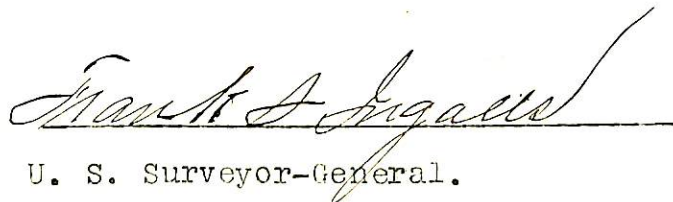
  
U. S. Surveyor-General.

Affidavit of Five Hundred Dollars Improvements.

We, Wm S Pickrell, and Ernest E Ford

of lawful age, being first duly sworn according to law, depose and say: That we are acquainted with the <sup>K.2. For Musignac, Moscade Dummev. Star mining & Melsite</sup> Atlanta Patauna Brooklyn Maud A. mining claims situate in Castle Creek Mining district, Yavapai County, Arizona Territory, for which James H. Smith

has made application for survey prior to application for patent under the provisions of the Act of Congress, approved May 10, 1872; and that the labor done and improvements made thereon by the applicant and his grantors exceed Five Hundred Dollars in value, and further that we are not personally interested in said mine.

Wm S Pickrell

Ernest E Ford

TERRITORY OF ARIZONA, }  
County of Maricopa } ss:

Sworn to and subscribed before me, this 16"

day of April, 1903.

L. W. Coggins  
Notary Public



"MAUD S. LOBE"

NOTICE OF MINING RE-LOCATION.  
Lode claim.

TO ALL WHOM IT MAY CONCERN:

This Mining claim, the name of which is the Maud S. Lode Mining Claim, situate on lands belonging to the United States of America, and in which there are valuable mineral deposits, was entered upon and located for the purpose of exploration and purchase by Frank K. Atkins, Trustee, for himself and William Christy, Frank K. Atkins to have and own an undivided one-half interest and William Christy to have and own an undivided one-half interest, the undersigned, on the 13th day of June, 1899.

The length of this claim is Fifteen hundred (1500) feet, and as such Trustee I hereby claim 350 feet in a Southerly direction and 350 feet in a Northerly direction from the center of the discovery shaft, at which this notice is posted, lengthwise of the claim, together with 300 feet in width of the surface grounds, on each side of the center of said claim. The general course of the lode deposit and premises is from the North, North West to the South, South East. The claim is situated and located in the Castle Creek Mining District, in Yavapai County, in the Territory of Arizona, about one furlong in a Northerly direction from the Whipsaw Hill located on the Blunderbus Mining Claim which adjoins this property being in the Whipsaw Gulch.

The surface boundaries of the claim are marked upon the ground as follows: (This being a relocation of the Maud S. Mining Claim recorded in Book 30, page 377) Beginning at a stone monument and stake at a point in a North West direction about 150 feet from the discovery shaft (at which this notice is posted), being in the center of the West Side line of said claim; thence South, South East 750 feet along the east line of the Patanka mining claim to a stone monument & stake being the South West corner of said claim; thence East North East 300 feet to a stone monument and stake at the center of the South end line of said claim; thence East North East 300 feet to a stone monument and stake being at the South East corner of said claim; thence North, North West 750 feet to a stone monument & stake at the center of the East side line of said claim; thence Northerly parallel with the east side line of Atlanta Mining Claim 750 feet to a stone monument & stake being at the North East corner of said claim; thence West, South West 300 feet to a stone monument and stake being at the center of the North end line of said claim; thence West, South West 300 feet to a stone monument and stake at the North West corner of said claim; thence Southerly along the east side line Atlanta mining claim 750 feet to the place of beginning.

All done under the provisions of Chapter Six, of Title XXXII, of the Revised Statutes of the United States, and of an Act of the General Assembly of Arizona, entitled "An Act Concerning Mines", approved March 20, 1895, and amended March 24, 1899.

Dated and posted on the ground this 13th day of June, 1899.

Frank K. Atkins, Trustee.

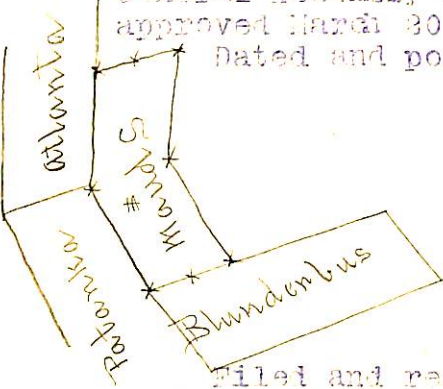

Filed and recorded at request of F. K. Atkins, June 23<sup>rd</sup> A. D. 1899, at 11 o'clock A. M., Book 52 of Mines, page 170, Records of Yavapai County, Arizona.

(Seal) W. J. Johnson, County Recorder  
By E. C. Averyt, Deputy Recorder.

TEREITORY OF ARIZONA,) :SS.  
COUNTY OF YAVAPAI. )

I, P. J. FARLEY, County Recorder in and for the County of Yavapai, in the Territory of Arizona, and Custodian of the Records thereof, do hereby certify that I have compared the above and foregoing with, and the same is a full, true and correct copy of notice of re-location of "MAUD S. LODGE" Mining Claim, as the same appears of record in my office in Book 51 of Mines, page 179, Records of Yavapai County, Arizona..

IN WITNESS WHEREOF, I have hereunto set my hand and affixed my Official Seal, this 19th day of January, A. D. 1905.

  
County Recorder.

"PATANKA LOBE"

NOTICE OF MINING RE-LOCATION.  
Quartz Claim.

TO ALL WHOM IT MAY CONCERN:

This Mining Claim, the name of which is the Patanka Lobe Mining Claim, situate on lands belonging to the United States of America, and in which there are valuable mineral deposits, was entered upon and located for the purpose of exploration and purchase by Frank K. Atkins, Trustee, for himself and William Christy, Frank K. Atkins an undivided one-half interest and William Christy an undivided one half interest, the undersigned, on the 15th day of June, 1898.

The length of the claim is fifteen hundred (1500) feet, and as such Trustee I claim 450 feet Northerly and 1150 feet Southerly on each side of the discovery shaft, at which this notice is posted, lengthwise of the claim. The general course of the lode deposit and premises is from the North, North West to the South, South East.

The claim is situated and located in the Castle Creek Mining District, in Yavapai County, in the Territory of Arizona, about one half mile in a North Westerly direction from the Whipsaw Mill in Whipsaw Gulch, a tributary of Castle Creek.

The surface boundaries of the claim are marked upon the ground as follows: This is a relocation of the Patanka Lobe Mining Claim, the original location certificate of which was filed Nov. 25th, 1891, and recorded in Book 12 at page 330, the title being in the undersigned, the relocation being made to comply with the present laws in relation to mines. Beginning at a stone monument at a point in a N. W. West direction 450 feet from the discovery shaft (at which this notice is posted), being in the center of the North end line of said claim; thence E. by S. 300 feet to a stone monument and stake being the North West corner of said claim; thence N. E. 750 feet to a stone monument and stake at the center of the West side line of said claim; thence N. E. 750 feet to a stone monument and stake being at the South west corner of said claim; thence E. by N. 300 feet to a stone monument and stake at the center of the south end of said claim; thence E. by N. 300 feet to a stone monument and stake, being at the South East corner of said claim; thence N. E. 750 feet to a stone monument and stake being at the center of the East side line of said claim; thence E. N. W. 750 feet to a stone monument and stake at the North East corner of said claim; thence W. by S. 300 feet to the place of beginning.

All done under the provisions of Chapter Six, of title XXXII, of the Revised Statutes of the United States, and of an Act of the Legislative Assembly of Arizona entitled "An Act Concerning Mines", approved March 30, 1895.

Dated and posted on the ground this 15th day of June, 1898.

Frank K. Atkins, Trustee.

Filed and recorded at request of F. K. Atkins, June 23rd A. D. 1898, at 11 o'clock A. M., Book 52 of Mines, page 177, Records of Yavapai County, Arizona.

(Seal) W. I. Johnson, County Recorder

By E. C. Averyt, Deputy Recorder.

TERRITORY OF ARIZONA, )

:ss.

COUNTY OF YAVAPAI. )

I. P. J. FARLEY, County Recorder in and for the County of Yavapai, in the Territory of Arizona, do hereby certify that I have compared the above and foregoing with, and the same is a full, true and correct copy of the notice of re-location of "PATANKA LOBE" Mining Claim, as the same appears of record in my office in Book 52 of Mines, page 177, Records of Yavapai County, Arizona.

IN WITNESS WHEREOF, I have hereunto set my hand and affixed my Official Seal, this 19th day of January, A. D. 1903.

*I. P. J. Farley*  
County Recorder.

"UNKLE JOHN"

NOTICE OF LOCATION.

OF the UNKLE JOHN Mining Claim on the quartz ledge containing Gold and Copper and located as a Quartz mine. The undersigned claim for mining purposes fifteen hundred (1500) feet of this quartz ledge, in length, along the ledge or vein, and three hundred (300) feet on each side of the middle of the vein at the surface, together with all the spurs, dips and angles, and all valuable mineral deposits contained therein, and all timber growing within the limits of said claim, and all water and water privileges thereon or appurtenant thereto, under and according to the provisions of an Act of Congress approved May 10, 1873, entitled An Act to Promote the Development of the Mining Resources of the United States, and all Acts amendatory thereto, and the laws of the Territory of Arizona. This claim commences at this Notice, which is posted in a monument of stone in a conspicuous place on the ledge at the West end center; thence Northerly 300 feet to Monument of stone at E. W. corner; thence 1500 feet Easterly to Monument of stone N. E. corner; thence 300 feet Southerly to Monument of Stone S. E. corner; thence 1500 feet Westerly to Monument of Stone S. W. corner; thence Northerly 300 feet to place of beginning. Castle Creek Mining District, Yavapai Co. A. T., south side of Dury Mine.

Dated on the ground this 25 day of November, A. D. 1890.

Signed Oliver C. Finn.

Filed for record at the request of O. C. Finn, Dec. 30<sup>th</sup> A. D. 1890, at the hour of 9:55 o'clock A. M., in Book 30 of Mining Records of Yavapai County, Arizona Territory, page 327.

(J.S.) Charles H. Akers,

County Recorder

By J. W. Akers, Deputy.

\*\*\*\*\*

TERRITORY OF ARIZONA, )

1890. )

COUNTY OF YAVAPAI. )

I, P. J. BARLEY, County Recorder in and for the County of Yavapai, in the Territory of Arizona, and custodian of the Records thereof, do hereby certify that I have compared the above and foregoing with, and the same is a full, true and correct copy of notice of location of "UNKLE JOHN" Mining Claim, as the same appears of record in my office in Book 30 of Mines, page 327, Records of Yavapai County, Arizona.

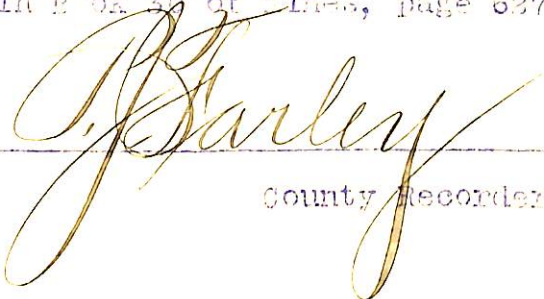
  
 \_\_\_\_\_  
 County Recorder.

"STAR MINING & MILLSITE CLAIM"NOTICE OF MINING RE-LOCATION.  
Quartz Claim.

TO ALL WHOM IT MAY CONCERN:

This Mining Claim, the name of which is the Star Lode Mining Claim and the Star Mill-Site, situate on lands belonging to the United States of America, and in which there are valuable mineral deposits, was entered upon and located for the purpose of exploration and purchase by Frank K. Atkins, Trustee for himself and William Christy, Frank K. Atkins to have and own an undivided one half interest and William Christy to have and own an undivided one-half interest, the undersigned, on the 15th day of June, 1899.

The length of the claim is fifteen hundred (1500) feet, and as such Trustee I claim 450 feet northerly and 1150 feet southerly, respectively on each side of the discovery shaft, at which this notice is posted, lengthwise of the claim. The general course of the lode deposit and premises is from the North to the South.

The claim is situated and located in Castle Creek Mining District, in Yavapai County, in the Territory of Arizona, about one half mile in a North Westerly direction from the Whipsaw Mill, in Whipsaw Gulch and adjoining the Atlanta and Patanka mining claims on the West.

The surface boundaries of the claim are marked upon the ground as follows: (This is a re-location of the Star Mining Claim and Star Mill Site, recorded in Book 33, page 156) Beginning at a stone monument and stake at a point in a Northerly direction 450 feet from the discovery shaft (at which this notice is posted), being in the center of the North end line of said claim; thence Westerly 300 feet to a stone monument and stake being the North West corner of said claim; thence Southerly 750 feet to a stone monument and stake at the center of the west side line of said claim; thence Southerly 750 feet to a stone monument and stake being at the South West corner of said claim; thence Easterly 300 feet to a stone monument and stake at the center of the South end of said claim; thence Easterly 300 feet to a stone monument and stake, being at the Southeast corner of said claim; thence Northerly 750 feet to a stone monument and stake being at the center of the East side line of said claim; thence Northerly 750 feet to a stone monument and stake at the North east corner of said claim; thence Westerly 300 feet to the place of beginning. The Star Mill Site is located down the Whipsaw Gulch from the Whipsaw Mill about one furlong and is bounded by stone monuments.

All done under the provisions of Chapter Six, of Title XXXII, of the Revised Statutes of the United States, and of an Act of the Legislative Assembly of Arizona, entitled "An Act Concerning Mines", approved March 30, 1895.

Dated and posted on the ground this 15th day of June, 1899.

Frank K. Atkins, Trustee.

Filed and recorded at request of F. K. Atkins, June 18<sup>th</sup> A. D. 1899, at 11 o'clock A. M., Book 52 of Mines, page 134, Records of Yavapai County, Arizona.

(Seal) W. I. Johnson, County Recorder  
By E. C. Avery, Deputy Recorder.



TERRITORY OF ARIZONA,)
:SS.
COUNTY OF YAVAPAI.)

I, P. J. FARLEY, County Recorder in and for the County of Yavapai, in the Territory of Arizona, and Custodian of the Records thereof, do hereby certify that I have compared the above and foregoing with, and the same is a full, true and correct copy of record of location of "STAR LODGE MINING CLAIM AND BEAR HILL SITE", as the same appears of record in my office in Book 52 of Mines, page 134, Records of Yavapai County, Arizona.

IN WITNESS WHEREOF I have hereunto set my hand and affixed my Official Seal, this 19th day of January, A. D. 1903.

[Handwritten signature of P. J. Farley]
County Recorder.

"MERRIMAC LODGE"

NOTICE OF MINING LOCATION.  
Quartz Claim.

TO ALL WHOM IT MAY CONCERN:

This Mining Claim, the name of which is the Merrimac Lode Mining Claim, situats on lands belonging to the United States of America, and in which there are valuable mineral deposits, was entered upon and located for the purpose of exploration and purchase by Frank K. Atkins, of Briggs, Arizona the undersigned, on the 23d day of May, 1899.

The length of the claim is fifteen hundred (1500) feet and I claim 50 feet Northerly and 1450 feet southerly on each side of the discovery shaft, at which this notice is posted, lengthwise of the claim. The general course of the lode deposit and premises is from the North to the South.

The claim is situated and located in the Castle Creek Mining District, in Yavapai County, in the Territory of Arizona, about one half mile in a Westerly direction from the Whipsaw mill, being above the mill in Whipsaw Gulch near Briggs Post Office.

The surface boundaries of the claim are marked upon the ground as follows: Beginning at a stone monument located at a point in a Northerly direction Fifty (50) feet from the discovery shaft (at which this notice is posted), being in the center of the North end line of said claim; thence Westerly 300 feet to a stone monument being the North West corner of said claim; thence Southerly 750 feet to a stone monument at the center of the West side line of said claim; thence Southerly 750 feet to a stone monument being at the South West corner of said claim; thence Easterly 300 feet to a stone monument at the center of the South end of said claim; thence Easterly 300 feet to a stone monument, being at the South East corner of said claim; thence Northerly 750 feet to a stone monument being at the center of the East side line of said claim; thence Northerly 750 feet to a stone monument at the North East corner of said claim; thence Westerly 300 feet to the place of beginning.

All done under the provisions of Chapter Six, of Title XXXII, of the Revised Statutes of the United States, and of an Act of the Legislative Assembly of Arizona, entitled "An Act Concerning Mines", approved March 30, 1895.

Dated and posted on the ground this 23d day of May, 1899.  
Frank K. Atkins.

Filed and recorded at request of F. K. Atkins, June 22<sup>nd</sup> A. D. 1899, at 11 o'clock A. M., Book 52 of Mines, page 131, Records of Yavapai County, Arizona.

(Seal) W. I. Johnson, County Recorder  
By E. C. Averyt, Deputy Recorder.

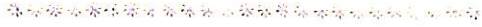

TERritORY OF ARIZONA, )  
:SS.  
COUNTY OF YAVAPAI. )

I, P. J. FARLEY, County Recorder in and for the County of Yavapai, in the Territory of Arizona, and Custodian of the Records thereof, do hereby certify that I have compared the above and foregoing with, and the same is a full, true and correct copy of the notice of location of "MERRIMAC LODGE" Mining Claim, as the same appears of record in my office in Book 52 of Mines, page 131, Records of Yavapai County, Arizona.

IN WITNESS WHEREOF, I have hereunto set my hand and affixed my Official Seal, this 19th day of January, A. D. 1903.

  
County Recorder.

"K 2 TOR LODE".NOTICE OF MINING RE-LOCATION.  
Lode Claim.

TO ALL WHOM IT MAY CONCERN:

This Mining Claim, the name of which is the K. 2 Tor Lode Mining Claim, situate on lands belonging to the United States of America, and in which there are valuable mineral deposits, was entered upon and located for the purpose of exploration and purchase by Frank K. Atkins, Trustee, for himself and William Christy. Frank K. Atkins to have and own an undivided one-half interest and William Christy an undivided one half interest, the undersigned, on the 18th day of June, 1899.

The length of this claim is Fifteen Hundred (1500) feet, and as such Trustee I hereby claim 750 feet in a North Westerly direction and 750 feet in a South Easterly direction from the center of the discovery shaft, at which this notice is posted, lengthwise of the claim, together with 300 feet in width of the surface grounds, on each side of the center of said claim. The general course of the lode deposit and premises is from the North West to the South East.

The claim is situated and located in the Castle Creek Mining District, in Yavapai County, in the Territory of Arizona, about one half mile in a Westerly direction from the Whipsaw Mill in Whipsaw Gulch. The southwesterly side line of the K. 2 Tor being same as the North Easterly side line of the Massade mining claim.

The surface boundaries of the claim are marked upon the ground as follows: (This is a relocation of the K. 2 Tor mining claim, erroneously recorded as the "K 2 Tor" mining claim, Book 48, page 67) Beginning at a stone monument at a point in a North Westerly direction 750 feet from the discovery shaft (at which this notice is posted), being in the center of the North Westerly end line of said claim; thence West South West 300 feet to a stone monument and stake being the North Westerly corner of said claim; thence South East 750 feet to a stone monument and stake at the center of the South Westerly side line of said claim; thence South East 750 feet to a stone monument being at the South Westerly corner of said claim; thence East North East 300 feet to a stone monument being at the center of the South Easterly end of said claim; thence East North East 300 feet to a stone monument, being at the South Easterly corner of said claim; thence North West 750 feet to a stone monument being at the center of the North Easterly side line of said claim; thence North West 750 feet to a stone monument at the North Easterly corner of said claim; thence West South West 300 feet to the place of beginning.

All done under the provisions of Chapter Six, of Title XXXII, of the Revised Statutes of the United States, and of an Act of the General Assembly of Arizona, entitled "An Act Concerning Mines", approved March 20, 1895 and amended March 2d, 1899.

Dated and posted on the ground this 18th day of June, 1899.

Frank K. Atkins, Trustee.

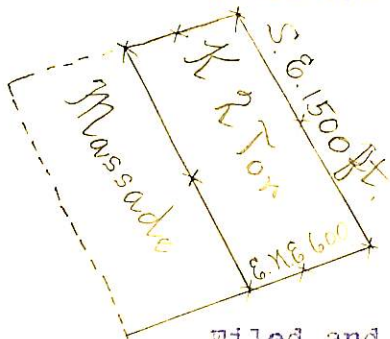

Filed and recorded at request of F. K. Atkins, June 23<sup>rd</sup> A. D. 1899, at 11 o'clock A. M., Book 52 of Mines, page 130, Records of Yavapai County, Arizona.

(Seal) W. I. Johnson, County Recorder  
By E. C. Averyt, Deputy Recorder.

TERRITORY OF ARIZONA, )  
                                  :SS.  
COUNTY OF YAVAPAI.     )

I, P. J. FARLEY, County Recorder in and for the County of Yavapai, in the Territory of Arizona, and Custodian of the Records thereof, do hereby certify that I have compared the above and foregoing with, and the same is a full, true and correct copy of notice of Re-location of "K 2 TOR LODGE" Mining Claim as the same appears of record in my office in Book 52 of Mines, page 130, Records of Yavapai County, Arizona.

IN WITNESS WHEREOF, I have hereunto set my hand and affixed my Official Seal, this 19th day of January, A. D. 1903.

  
\_\_\_\_\_  
County Recorder.

"RED CROSS"

## NOTICE OF LOCATION.

KNOW ALL MEN BY THESE PRESENTS:

That the undersigned have this day located 1500 feet of this vein or lode, bearing precious metals, with all dips, spurs, angles and variations, with surface ground 300 feet on each side of vein, with all mineral deposits contained therein, and all timber and water thereon or appurtenant thereto, according to the provisions of the United States Mining Laws.

The exterior boundaries are as follows:

Commencing at this Monument and Notice and running 300 feet in an northerly direction to monument at N. W. corner; thence in an easterly direction parallel with the ledge, 1500 feet to monument at N. E. corner; thence at right angles across the ledge in a southerly direction 300 feet to monument at S. E. corner; thence parallel with the lode in a Westerly direction 1500 feet to monument at S. W. corner; thence at right angles across the ledge in an north-easterly direction 300 feet to place of beginning.

This claim is in Castle Creek Mining District, Yavapai County, Arizona, and may be more generally described as situated on south side of Whipsaw Gulch about 300 ft. south of the boarding house at mouth of Dunny Gulch, and shall be known as the RED CROSS Mining Claim.

Dated on the ground this 15 day of May, 1903.

O. J. Finn.

Recorded at request of O. J. Finn, June 19th, A. D. 1903, at 12:00 o'clock M. in Book 33 of Mines, pages 493 & 494, Records of Yavapai County, Arizona.

(L.S.)

Alex. O. Brodie,

County Recorder.

\*\*\*\*\*

TERRITORY OF ARIZONA, )

:SS.

COUNTY OF YAVAPAI, )

I, P. J. FARLEY, County Recorder in and for the County of Yavapai, in the Territory of Arizona, and Custodian of the Records thereof, do hereby certify that I have compared the above and foregoing with, and the same is a full, true and correct copy of notice of location of "RED CROSS" Mining Claim, as the same appears of record in my office in Book 33 of Mines, at pages 493-494, Records of Yavapai County, Arizona.

IN WITNESS WHEREOF, I have hereunto set my hand and affixed my official seal, this 19th day of January, A. D. 1903.



County Recorder.

"BROOKLYN LODE"

NOTICE OF MINING RE-LOCATION.  
Quartz Claim.

TO ALL WHOM IT MAY CONCERN:

This Mining Claim, the name of which is the Brooklyn Lode Mining Claim, situate on lands belonging to the United States of America, and in which there are valuable mineral deposits, was entered upon and located for the purpose of exploration and purchase by Frank K. Atkins the undersigned, on the 16th day of June, 1899,

The length of the claim is fifteen hundred (1500) feet, and I hereby claim 300 ft. North Westerly and 1200 feet South Easterly on each side respectively, of the discovery shaft, at which this notice is posted, lengthwise of the claim. The general course of the lode deposit and premises is from the North West to the South East.

The claim is situated and located in the Castle Creek Mining District, in Yavapai County, in the Territory of Arizona, about one half mile in a North Westerly direction from the Whipsaw Mill in Whipsaw Gulch, the west end line of the Brooklyn extending to the East side line of the Atlanta Mining Claim.

The surface boundaries of the claim are marked upon the ground as follows: (This is a re-location of the Brooklyn Lode Mining Claim, recorded in Book 50, page 518) Beginning at a monument and stake at a point in a westerly direction about 300 feet from the discovery shaft (at which this notice is posted), being in the center of the West end line of said claim; thence southerly along the east side line of the Atlanta Mining claim 300 feet to a stone monument and stake being the Southwesterly corner of said claim; also the center side line Atlanta claim; thence southeasterly 750 feet to a stone monument and stake at the center of the southerly side line of said claim; thence South Easterly 750 feet to a stone monument and stake being at the South Easterly corner of said claim; thence Northerly parallel with Atlanta claim 300 feet to a stone monument and stake at the center of the East end line of said claim; thence Northerly parallel with Atlanta claim 300 feet to a stone monument and stake, being at the North Easterly corner of said claim; thence North Westerly 750 feet to a stone monument and stake being at the center of the Northerly side line of said claim; thence North west-erly 750 feet to a stone monument & stake at the North Westerly corner of said claim; thence Southerly along east side line Atlanta Claim 300 feet to the place of beginning.

All done under the provisions of Chapter Six, of Title XXXII, of the Revised Statutes of the United States, and of an Act of the Legislative Assembly of Arizona, entitled "An Act Concerning Mines", approved March 20, 1895.

Dated and posted on the ground this 16th day of June, 1899.  
Frank K. Atkins.

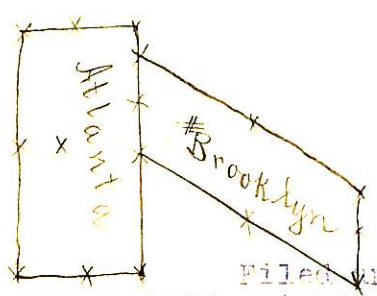

Filed and recorded at request of F. K. Atkins, June 18<sup>th</sup> A. D. 1899, at 11 o'clock A. M. Book 52 of Mines, page 183, Records of Yavapai County, Arizona.

(Seal) W. I. Johnson, County Recorder.  
By E. G. Avenet, Deputy Recorder.

TERRITORY OF ARIZONA,)
   
 ) 187.
   
 COUNTY OF YAVAPAI. )

I, P. J. FARLEY, County Recorder in and for the County of Yavapai, in the Territory of Arizona, and Custodian of the Records thereof, do hereby certify that I have compared the above and foregoing with, and the same is a full, true and correct copy of notice of location of "BROOKLYN LODGE" mining claim, as the same appears of record in my office in Book 52 of Mines, page 133, Records of Yavapai County, Arizona.

IN WITNESS WHEREOF, I have hereunto set my hand and affixed my Official Seal, this 12th day of January, A. D. 1903.

*P. J. Farley*  
 \_\_\_\_\_  
 County Recorder.

"MASSADE LODGE"

NOTICE OF MINING RE-LOCATION.  
Lode Claim.

TO ALL WHOM IT MAY CONCERN:

This Mining Claim, the name of which is the Massade Lode Mining Claim, situate on lands belonging to the United States of America, and in which there are valuable mineral deposits, was entered upon and located for the purpose of exploration and purchase by Frank K. Atkins, Trustee, for himself and William Christy, Frank K. Atkins to have and own an undivided one half interest and William Christy to have and own an undivided one half interest, the undersigned, on the 16th day of June, 1899.

The length of this claim is fifteen hundred (1500) feet, and as such Trustee, I hereby claim 500 feet in a North Westerly direction and 1000 feet in a South Easterly direction from the center of the discovery shaft, at which this notice is posted, lengthwise of the claim, together with 300 feet in width of the surface grounds, on each side of the center of said claim. The general course of the lode deposit and premises is from the North West to the South East.

The claim is situated and located in the Castle Creek Mining District, in Yavapai County, in the Territory of Arizona, about one half mile in a Westerly direction from the Whipsaw Mill, the North Easterly side line of Massade being same as the South Westerly side line of "K & TOR" mining claim <sup>all land</sup> in Whipsaw Gulch.

The surface boundaries of the claim are marked upon the ground as follows: (This is a re-location of the Massade Mining Claim, recorded in Book 50, page 90) Beginning at a stone monument at a point in a North Westerly direction 500 feet from the discovery shaft (at which this notice is posted), being in the center of the North Westerly end line of said claim; thence West, South West 300 feet to a stone monument and stake being the North Westerly corner of said claim; thence South East 750 feet to a stone monument at the center of the South Westerly side line of said claim; thence South East 750 feet to a stone monument being at the South Westerly corner of said claim; thence East North East 300 feet to a stone monument being at the center of the south Easterly end of said claim; thence East North East 300 feet to a stone monument, being at the South Easterly corner of said claim; thence North West 750 feet to a stone monument and stake being at the center of the North Easterly side line of said claim; thence North West 750 feet to a stone monument and stake at the North Easterly corner of said claim; thence West South West 300 feet to the place of beginning.

All done under the provisions of Chapter Six, of Title XXXII, of the Revised Statutes of the United States, and of an Act of the General Assembly of Arizona, entitled "An Act Concerning Mines", approved March 20, 1895, and amended March 2d, 1899.

Dated and posted on the ground this 16th day of June, 1899.

Frank K. Atkins, Trustee.

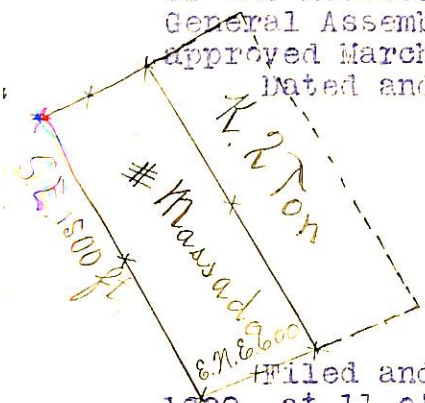

Filed and recorded at request of F. K. Atkins, June 22<sup>nd</sup> A. D. 1899, at 11 o'clock A. M., Book 52 of Mines, page 182, Records of Yavapai County, Arizona.

(Seal) W. I. Johnson, County Recorder  
By E. C. Averyt, Deputy Recorder.



TERritORY OF ARIZONA,) )  
:SS.  
COUNTY OF YAVAPAI. ) )

I, P. J. FARLEY, County Recorder in and for the County of Yavapai, in the Territory of Arizona, and Custodian of the Records thereof, do hereby certify that I have compared the above and foregoing with, and the same is a full, true and correct copy of notice of location of "KASSABE LODE" Mining Claim, as the same appears of record in Book 52 of Mines, page 133, Records of Yavapai County, Arizona.

IN WITNESS WHEREOF, I have hereunto set my hand and affixed my Official Seal, this 19th day of January, A. D. 1903.

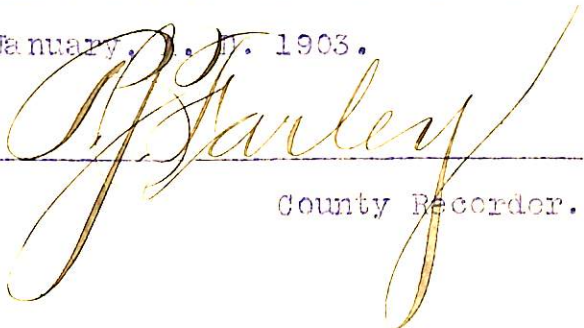
  
County Recorder.

RELOCATION.

"ATLANTA LODE"

NOTICE OF MINING LOCATION  
Quartz Claim.

TO ALL WHOM IT MAY CONCERN:

This Mining Claim, the name of which is the Atlanta Lode Mining Claim, situate on lands belonging to the United States of America, and in which there are valuable mineral deposits, was entered upon and located for the purpose of exploration and purchase by Frank K. Atkins, Trustee, for himself and William Christy, Frank K. Atkins an undivided one-half interest and William Christy an undivided one-half interest, the undersigned, on the 14th day of June, 1897.

The length of the claim is Fifteen hundred (1500) feet, and as such Trustee I claim Seven hundred and fifty (750) feet on each side of the discovery shaft, at which this notice is posted, lengthwise of the claim. The general course of the lode deposit and premises is from the North to the South.

The claim is situated and located in the Castle Creek Mining District, in Yavapai County, in the Territory of Arizona, about one half mile in a North Westerly direction from the Whipsaw mill, in Whipsaw Gulch, a tributary of Castle Creek. This is a relocation of the Atlanta Lode Mining Claim, original notice of which was dated Jan'y. 1st, 1885 and recorded in Book 20 at page 376, and of the Whipsaw Lode mining claim, dated Jan'y. 27th, 1893 and recorded in Book 36 at page 395, the title as to both having merged by deeds in said Frank K. Atkins, Trustee, name Atlanta retained. Beginning at a stone monument and stake at a point in a northerly direction seven hundred and fifty (750) feet from the discovery shaft (at which this notice is posted, being in the center of the North end line of said claim; thence Westerly 300 feet to a stone monument and stake being the North West corner of said claim; thence Southerly 750 feet to a stone monument and stake at the center of the West side line of said claim; thence Southerly 750 feet to a stone monument and stake being at the South West corner of said claim; thence Easterly 300 feet to a stone monument and stake at the center of the South end of said claim; thence Easterly 300 feet to a stone monument and stake, being at the South East corner of said claim; thence Northerly 750 feet to a stone monument and stake being at the center of the East side line of said claim; thence Northerly 750 feet to a stone monument and stake at the North East corner of said claim; thence Westerly 300 feet to the place of beginning.

All done under the provisions of Chapter Six, of Title XXXII, of the Revised Statutes of the United States, and of an Act of the <sup>Legis. Council</sup> ~~Assembly~~ of Arizona, entitled "An Act Concerning Mines", approved March 20, 1895.

Dated and posted on the ground this 14th day of June, 1897.  
Frank K. Atkins, Trustee.

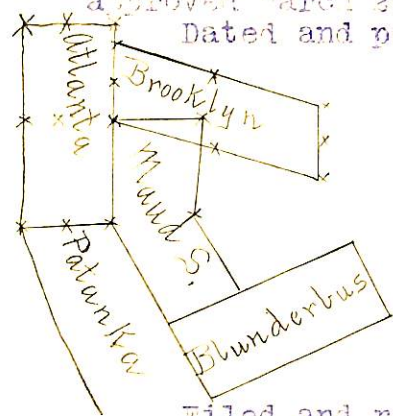

Filed and recorded at request of F. K. Atkins, June 23rd A. D. 1897, at 11:00 o'clock A. M., Book 53 of Mines, page 173, Records of Yavapai County, Arizona,

(Se 1) W. L. Johnson, County Recorder  
By E. C. Averyt, Deputy Recorder.

TERRITORY OF ARIZONA,)
   
COUNTY OF YAVAPAI. ) NO.

I, P. J. FARLEY, County Recorder in and for the County of Yavapai, in the Territory of Arizona, and Custodian of the Records thereof, do hereby certify that I have compared the above and foregoing with, and the same is a full, true and correct copy of notice of Re-location of "ATLANTA LODGE" Mining Claim, as the same appears of record in my office in Book 53 of Mines, page 176, Records of Yavapai County, Arizona.

IN WITNESS WHEREOF, I have hereunto set my hand and affixed my Official Seal, this 19th day of January, A. D. 1905.

  
County Recorder.

"BLUNDERBUS"

NOTICE OF MINING RE-LOCATION.  
Lode Claim.

TO ALL WHOM IT MAY CONCERN:

This Mining Claim, the name of which is the Blunderbus Mining Claim, situate on lands belonging to the United States of America, and in which there are valuable mineral deposits, was entered upon and located for the purpose of exploration and purchase by Frank K. Atkins, Trustee, for himself and William Christy, Frank K. Atkins to have and own an undivided one half interest and William Christy an undivided one half interest, the undersigned, on the 15th day of June, 1899.

The length of this claim is fifteen hundred (1500) feet, and as such Trustee I hereby claim 350 feet in a westerly direction and 350 feet in an easterly direction from the center of the discovery shaft, at which this notice is posted, lengthwise of the claim, together with 300 feet in width of the surface grounds, on each side of the center of said claim. The general course of the lode deposit and premises is from the West South West to the East North East.

The claim is situated and located in the Castle Creek Mining District, in Yavapai County, in the Territory of Arizona, about three quarters of a mile in a Westery direction from the intersection of the Whipsaw Gulch with Castle Creek. This is a re-location of the Blunderbus Mining Claim, recorded in Book 31, page 336, and of the Contention mining claim recorded in Book 35, page 310, the title to both having been merged in said Frank K. Atkins, by deeds from the previous owners, - the name "Blunderbus" being re-tained, and is relocated for the purpose of complying with the existing laws, with respect to surface boundaries and monuments. Beginning at a stone monument and stake at a point in a W. S. West direction 350 feet from the discovery shaft) at which this notice is posted), being in the center of the West end line of said claim; thence S. S. East 300 feet to a stone monument and stake being the South West corner of said claim; thence E. N. East 750 feet to a stone monument and stake at the center of the south side line of said claim; thence E. N. East 750 feet to a stone monument and stake being at the South East corner of said claim; thence E. N. West 300 feet to a stone monument and stake at the center of the East end of said claim; thence N. W. West 300 feet to a stone monument and stake, being at the North East corner of said claim; thence W. S. West 750 feet to a stone monument and stake being at the center of the North side line of said claim; thence W. S. West 750 feet to a stone monument and stake at the North west corner of said claim; thence S. S. East 300 feet to the place of beginning.

All done under the provisions of Chapter Six, of Title XXVII, of the Revised Statutes of the United States, and of an Act of the General Assembly of Arizona, entitled "An Act Concerning Mines", approved March 20, 1895, and amended March 21, 1899.

Dated and posted on the ground this 15th day of June, 1899.

Frank K. Atkins, Trustee.

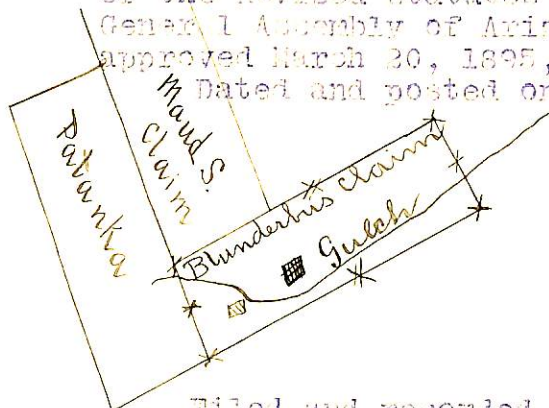

Filed and recorded at request of F. K. Atkins, June 23<sup>rd</sup> A. D. 1899, at 11 o'clock A. M., Book 52 of Mines, page 173, Records of Yavapai County, Arizona.

(Seal) W. I. Johnson, County Recorder  
By E. C. Averyt, Deputy Recorder.

TERRITORY OF ARIZONA,)
   
 ) 1903.
   
 COUNTY OF YAVAPAI. )

I, P. J. FARLEY, County Recorder in and for the County of Yavapai, in the Territory of Arizona, and Custodian of the Records thereof, do hereby certify that I have compared the above and foregoing with, and the same is a full, true and correct copy of notice of Re-location of "BLUNDERBUS" Mining Claim, as the same appears of record in my office in Book 54 of Mines, page 172, Records of Yavapai County, Arizona.

IN WITNESS WHEREOF, I have hereunto set my hand and affixed my Official Seal, this 19th day of January, A. D. 1903.

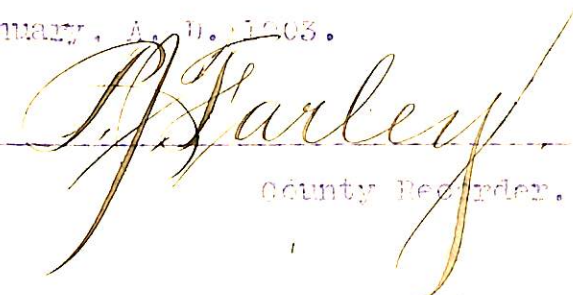
  
 County Recorder.

"SIDE LINE"

NOTICE OF LOCATION.

KNOW ALL MEN BY THESE PRESENTS:

That I the undersigned have this day located Fifteen hundred feet linear measure of this vein or lode bearing precious metals, with all dips, spurs, angles and variations, with surface ground three hundred (300) feet on each side of center of vein, with all mineral deposits contained therein and all timber growing within the limits of said claim and all water and water privileges thereon or appurtenant thereto, under and according to the provisions of the mining laws of the United States under which it is located, this claim commences at this monument and notice placed upon the ledge and runs seven hundred and fifty (750) feet in a southeasterly direction and seven hundred and fifty (750) feet in a Northwesterly direction along the ledge; the exterior boundaries are as follows:

Commencing at this monument and notice and running three hundred (300) feet in a Northeasterly direction to Monument on Northeast side line; thence in a Northwest direction seven hundred and fifty (750) feet parallel with lode to a monument of stone and stake at North corner; thence three hundred (300) feet in a southwest direction to a monument of stone and stake at southwest center of claim; thence in a three hundred feet in a southwest direction to a monument of stone and stake at west corner; thence in a southeasterly direction parallel with lode fifteen hundred (1500) feet to monument of stone and stake south corner; thence in a Northeasterly direction three hundred (300) feet to a monument of stone and stake at southeast center of claim; thence three hundred (300) feet in a Northeasterly direction to a monument of stone and stake at East corner; thence in a Northwesterly direction parallel with lode seven hundred and fifty (750) feet to place of beginning.

This claim may be more generally described as situated on Whipsaw Gulch, Northeast and joining Maud S. mine in Castle Creek Copper Mining District, Yavapai County, Arizona Territory, and shall be known as the Side Line Mining Claim.

Dated on ground this the 15th day of January, 1888.

H. Durand,  
Witness.

G. O. Roberts.

Recorded at request of G. O. Roberts, Jan. 20, A. D. 1888, at 5 o'clock P. M., in Book 25 of Mines, pages 100-101, Records of Yavapai County, Arizona.

(L.S.)

E. J. F. Horne,

County Recorder.

\*\*\*\*\*

TERritORY OF ARIZONA.)

:SS.

COUNTY OF YAVAPAI. )

I, P. J. FARLEY, County Recorder in and for the County of Yavapai, in the Territory of Arizona, and Custodian of the Records thereof, do hereby certify that I have compared the above and foregoing with, and the same is a full, true and correct copy of notice of location of the "SIDE LINE" Mining Claim, as the same appears of record in my office in Book 25 of Mines, pages 100-101, Records of Yavapai County, Arizona.

IN WITNESS WHEREOF, I have hereunto set my hand and affixed my Official Seal, this 19th day of January, A. D. 1903.



County Recorder.

"DUMMEY"

NOTICE OF LOCATION

of the DummeY Mining Claim-on the DummeY Quartz ledge containing Gold, silver and Copper and located as a Gold quartz mine.

The undersigned claim for mining purposes, Fifteen Hundred (1500) feet of this quartz ledge in length along the ledge or vein, and three hundred (300) feet on each side of the middle of the vein at the surface, together with all dips, spurs, and angles, and all valuable mineral deposits contained therein, and all timber growing within the limits of said claim, and all water and water privileges thereon or appurtenant thereto, under and according to the provisions of an Act of Congress, approved May 10, 1872, entitled "An Act to promote the Development of the Mining Resources of the United States", and all acts amendatory thereto, and the Laws of the Territory of Arizona.

This claim commences at this Notice, which is posted in a Monument of Stone in a conspicuous place on the ledge at the N. E. end centre boundary of the claim, and running thence three hundred (300) feet in a N. W. direction to a monument of stone and a stake marked N. W. corner; thence fifteen hundred (1500) feet in a S. W. direction to a monument of stone and a stake marked S. W. corner; thence three hundred (300) feet in a N. E. direction to a monument of stone and a stake marked S. W. center monument, S. W. boundary; thence ~~three~~ three hundred (300) feet in a N. E. direction to a monument of stone and a stake marked S. E. corner; thence fifteen hundred (1500) feet in a N. E. direction to a monument of stone and a stake marked N. E. corner; thence three hundred (300) feet in a N. W. direction to the place of beginning.

This claim may be more generally described as situated in Castle Creek Mining District, Yavapai County, Arizona Territory, on Spring gulch about one thousand feet South west of and above where said gulch runs into Whipsaw Gulch, and shall be known as the DUMMEY Mining Claim.

Dated on the ground this 7th day of May, A. D. 1885.

Signed:---- John W. Osborn  
Rosario Groom

R.W.Groom, Witness.

Recorded at the request of John W. Osborn, July 2nd, A. D. 1885, at the hour of 9 o'clock A. M., in Book 21 of Mining Records of Yavapai County, Arizona Territory, pages 222 & 223.

William Wilkerson,  
County Recorder.

\*\*\*\*\*

Territory of Arizona,) :SS.  
County of Yavapai. )

I, P. J. FARLEY, County Recorder in and for the County of Yavapai, in the Territory of Arizona, and Custodian of the Records thereof, do hereby certify that I have compared the above and foregoing with, and the same is a full, true and correct copy of notice of location of "DUMMEY" Mining Claim, as the same appears of record in my office in Book 21 of Mines, pages 222-223, Records of Yavapai County, Arizona.

IN WITNESS WHEREOF, I have hereunto set my hand and affixed my Official Seal, this 8th day of May, A. D. 1885.



*P. J. Farley*  
County Recorder.

4-687.

SURVEYOR-GENERAL'S CERTIFICATE OF APPROVAL OF FIELD NOTES AND SURVEY OF MINING CLAIM.

Department of the Interior.

Office of U. S. Surveyor-General,

Phoenix, Arizona.

July 8<sup>th</sup>, 1903

I, U. S. Surveyor-General for the district of Arizona.

do hereby certify that the foregoing and hereto attached Field Notes and Return of the Survey of the Mining Claim of James Smith,

Brooklyn, Side Line, Merrimac, Maud S., Star Mining & Millsite, Massade, Dummev, Blunderbus, Red Cross, Unkle John, K. 2 Tor. Patanká and Atlanta. known as the

situate in Castle Creek, mining district, Yavapai, County, Arizona.

in Section, Township No., Range No., designated as Survey No. 1754,

executed by James B. Girard, U. S. Deputy Mineral

Surveyor, Jan. 22, to Feb. 17, 1903, 190, under my instructions dated

Jan. 22, 1903, 190, have been critically examined and the necessary cor-

rections and explanations made, and the said Field Notes and Return, and the Survey they describe,

are hereby approved. A true copy of the copy of the location certificate filed by the applicant for

survey is included in the field notes.

Hugh H. Big

U. S. Surveyor-General for Arizona.



ESTABLISHMENT OF MIN MON NO 1754

By James L. Girard  
U.S. Deputy Min. Surk.

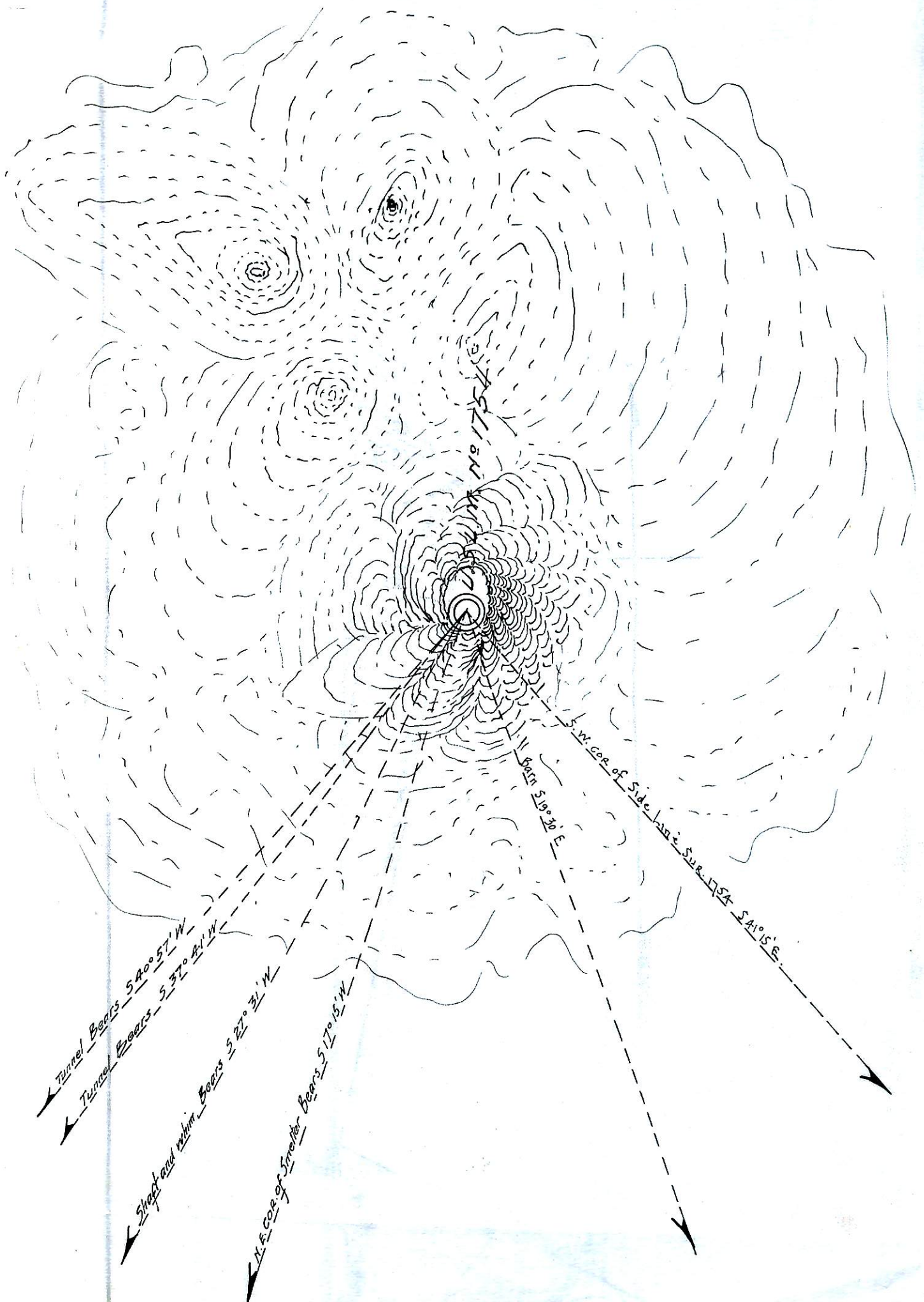

LARGE  
MAP