

**M  
S  
-**

**0**

**1**

**7**

**6**

**4**



MINERAL SURVEY NO. 1764 A & B

Claims	M & B Desc.	Improvements	Loc. Notices
Campbell	7	12	7
Globe	4	11	5
Katie L.	1	10	1
Minnie L.	2	11	3
Pine Tree	3	11	4
Stevens	8	13	8
Tiger	5	11	2
Tonto	6	12	6
Millsite			
Lakeman	9	15	9

*Recd. & filed*

*3/20/03. Report 6/17/03*

*Notes and forms copied  
also compared by Taylor.*

(4-683.)

Mineral Survey No. 1764 AXB

Lot No. \_\_\_\_\_

Gila

Land District.

FIELD NOTES

OF THE SURVEY OF THE MINING CLAIM OF

Sophie R. Labrum

KNOWN AS THE

Katie L. Morrison, Pine Tree, Globe, Pign Point  
Campbell Stevens, and Labrum Mill Site, Coffin Mountain Mining District,  
Graham County, Arizona

Section 19-20-24-25-30 Township 4 S, Range 28-29-30

Surveyed under instructions dated Feb 21<sup>st</sup>, 1903

by H. M. Whitaker,  
U. S. Deputy Mineral Surveyor.

Claim, located Dec 1<sup>st</sup> 1902, 1

Survey commenced Mar 2 1903, 1

Survey completed Mar 20 1903, 1



# PRELIMINARY OATHS OF ASSISTANTS IN SURVEY OF MINING CLAIM.

We, J. R. Edwards and \_\_\_\_\_,  
do solemnly swear that we will well and faithfully execute the duties of chain carriers; that we will level the chain upon even and uneven ground and plumb the tally-pins, either by sticking or dropping the same; that we will report the true distance to all notable objects, and the true length of all lines that we assist in measuring, to the best of our skill and ability, and in accordance with instructions given us, in the survey of the Mining Claim of Daphne R. Lapham

known as the Ruby L. Minnie L. Pinta, A. W. Pinta, Pinta Campbell  
Stevens and Lapham Millable  
situate in Copper Mountain M. mining district  
Graham County, Oregon  
in Section \_\_\_\_\_, Township No. \_\_\_\_\_, Range No. \_\_\_\_\_

J. R. Edwards \_\_\_\_\_, Chainman.  
\_\_\_\_\_, Chainman.

Subscribed and sworn to by the above-named persons before me this \_\_\_\_\_ day of March, 1903

Frank B. Lane  
Notary Public  
MY COMMISSION EXPIRES NOV. 20th, 1905.

I, \_\_\_\_\_, do solemnly swear that I will well and truly perform the duties of axman, in the establishment of corners and other duties, according to instructions given me and to the best of my skill and ability, in the survey of the Mining Claim of \_\_\_\_\_

known as the \_\_\_\_\_  
more fully described in the preceding affidavit.  
\_\_\_\_\_, Axman.

Subscribed and sworn to by the said \_\_\_\_\_  
before me this \_\_\_\_\_ day of \_\_\_\_\_, 190\_\_\_\_

I, \_\_\_\_\_, do solemnly swear that I will well and truly perform the duties of flagman, in the establishment of corners and other duties, according to instructions given me and to the best of my skill and ability, in the survey of the Mining Claim of \_\_\_\_\_

known as the \_\_\_\_\_  
more fully described in the preceding affidavit.  
\_\_\_\_\_, Flagman.

Subscribed and sworn to by the said \_\_\_\_\_  
before me this \_\_\_\_\_ day of \_\_\_\_\_, 190\_\_\_\_



## Survey No 1764 A.

Katie L. Lode

Beginning at Cor No 1.

Identical with the S.W. Cor of the location  
and with Cor. Nos 2 & 4 Minnie Land

Pine tree Lodes respectively of this Survey.

A pine post 5 ft long 4 ins. square set 18 ins  
in ground surrounded by mound of stones,

scribed 1-2-4-1764A Whence

S 72° 20' W 1269.1 Ft

U. S. L. M No 1764 bears ~~S 72° 20' W 1269.1 Ft~~A Cedar tree 6 ins diameter blazed and  
scribed B.P. 1-2-4 1764A bears N 61° 22' W 59.50 Ft

Thence N 58° 38' E

Var 13° 40' E

1433.90 To Cor No 2.

Identical with N.W. Cor of the location

A pine post 4 ft long 4 ins x 6 ins, set 18 ins  
in ground surrounded by mound of  
stones, scribed 2-1764A. WhenceA 2' x 2' granite face in ledge x and chiselled  
B.P. 2-1764A Bears N 25° 10' W 35.83 Ft.

Thence S 31° 22' E

Var 13° 39' E

300 N.E. End Center of location.

345 Intersect a gulch

600 To Cor. No 3.

Identical with N.E. Cor of location.

A pine post 5 ft long 4 ins square  
set 18 ins in ground surrounded  
by mound of stones, scribed 3-1764A.

Whence

A porphyry stone x and chiselled

B.P. 3-1764A bears N 38° 59' E 13.50 Ft.

Thence S 58° 38' W

Var 13° 40' E

150 Intersect a gulch.

1433.90 To Cor No 4.

Identical with S.E. Cor of location

A pine post 5 ft long 4 ins square  
set 18 ins in ground surrounded  
by mound of stones, scribed 4-1764A

Whence

A 1.5' x 2' x 2' porphyry stone x and



Survey No 1764 2,  
Katie L. Lode Contd.

Chiselled B.R 4-1764 A bears  $S 80^{\circ} 36' W 32.32 FT.$

Thence  $N. 31^{\circ} 22' W$   
Var  $13^{\circ} 26' E$

300  
600

Q. W. End Center of location  
To place of beginning at Cor No 1.

Minnie L. Lode,

Beginning at Cor No 1

Identical with Q. W. Cor of location  
and with Cors. Nos 1 of Pine Tree  
Tiger and Globe Lodes, this Survey.  
A pine post 5ft long 4ins square set  
18 ins in ground surrounded by  
mound of stones, scribed H-1764 A.  
Whence

U. O. L. M. No 1764 bears  $S 74^{\circ} 58' E 267.00 FT.$

A 4'x5' lime rock x and chiselled  
B.R. H-1764 A Bears  $S 9^{\circ} 23' E 13.40 FT.$

Thence  $N. 77^{\circ} 51' E$   
Var  $13^{\circ} 30' E$

1500

To Cor No 2  
Identical with N. W. Cor of location.

Thence  $S 31^{\circ} 22' E$   
Var  $13^{\circ} 40' E$

317.70  
600.00  
635.40

NE End Center of location  
Cor No 4 Katie L. this Survey.  
To Cor No 3.

Identical with the N. E. Cor of the  
location.  
A pine post 5ft long 4 ins square  
set 18 ins in ground surrounded  
by mound of stones, scribed  
3-1764 A whence

a 1.5x2' face in porphyry x and chiselled  
B.R 3-1764 A Bears  $S 13^{\circ} 03' E 18.80 FT.$

Thence  $S 77^{\circ} 51' W$   
Var.  $13^{\circ} 26' E$

1500

To Cor No. 4.  
Identical with the Q. E. Cor of the  
location

a pine post 5ft long 4 ins square



Winnie L. Lode Contd.

set 18 ins in ground, surrounded by mound of stones, Scribed 4-1764A  
Whence

a 1' x 2' face in porphyry x and chiselled  
B.R. 4-1764A Bears N 84° 57' W 11.70

Whence N 31° 22' W

Var 13° 30' E

- 35.18 Cor No. 2. Globe Lode, this Survey.
- 317.70 S.W. End Center of location
- 635.40 Place of beginning at Cor No. 1.

Pine Tree Lode

Beginning at Cor No 1

Identical with S.E. Cor of location.

Whence

U.S.L.M. No 1764 Bears S 74° 58' E 267.00 Ft.

Whence N 29° 56' W

Var 13° 30' E

- 300 S.W. End Center of location
- 600 To Cor No. 2, Pine gulch

Identical with S.W. Cor of location and with Cor No. 2 Tiger Lode, this Survey.

A pine post 5 ft long 4 ins square set 18 ins in ground, Scribed 22-1764A, surrounded by mound of stones whence a lime rock x and chiselled B.R. 2-1764A  
Bears S 4° 16' E 20. Ft.

Whence N 77° 51' E

Var 13° 30' E

- 1500 To Cor No. 3.

Identical with N.W. Cor of location.

A pine post 5 ft long 4 ins square set 18 ins in ground. Surrounded by mound of stones, Scribed 3-1764A.

Whence

a 1' x 2' porphyry rock x and chiselled  
B.R. 3-1764 A. Bears S 16° 03' E 21.40 Ft.

Whence S 29° 56' E

Var 13° 07' E

- 300.00 N.E. End Center of location
- 600 To Cor No 4.



Survey No 1764. A.

Pine Tree Lode Cont'd.

1500

Identical with N.E. Cor of location

Thence S 77° 51' W

Var 13° 40' E

To place of beginning at Cor No. 1.

A Lobe Lode

Beginning at Cor No. 1.

Identical with N.W. Cor of location  
whence

U. O. L. M. No 1764 Bears. S 74° 58' E 2.67.00 Ft.

Thence S 31° 22' E

Var 13° 30' E

300.11

N. E. E nd Centn of location

600.22

To Cor No 2

Identical with N.E. Cor of location.

A pine post 5ft long 4 ins square

set 18 ins in ground surrounded by

Mound of stones, described 2-1764 A.

whence

A 1' x 1.5' line face in ledge x and

chiselled B.R. 2-1764 A. Bears S 84° 36' W 11.90

Thence S 60° 12' W

Var 13° 30' E

920.60

To Cor No. 3.

Identical with S.E. Cor of location.

A pine post 4ft long 4 ins square

set on rock surrounded by Mound

of stones, described 3-1764 A. whence

a 1' x 1.5' porphyry face in ledge x and

chiselled B.R. 3-1764 A. Bears N 23° 10' E 14 Ft.

Thence N 31° 22' W

Var 13° 10' E

300.11.

S. W. E nd Centn of location.

600.22.

To Cor No 4.

Identical with S.W. Cor of location

and with Cors Nos 1-4-1 of T onto, Tignor

and Campbell respectively, this survey.

A pine post 5ft long 4 ins square

set on rock surrounded by Mound

of stones described 1-4-1764 A. whence



Survey No 1764 A.

Globe Lode Contd.

A 2'x2'x4' porphyry rock x and chiselled  
B.B. 1-1-44 1764. A Bears S 28° 36' W 10.70 FT.

Thence N 60° 12' E  
Var 13° 12' E

920.60 To place of beginning at Cor No. 1.

Pigeon Lode.

Beginning at Cor. No. 1.

Identical with N. E. Cor of location whence  
U.O.L.M No 1764 bears S 74° 58' E 267.00 FT.

Thence N 29° 56' W  
Var 13° 30' E

300 N. E. End Center of location

600 To Cor No 2

Identical with N.W. Cor of location

Thence S 60° 12' W

310 Interest gulch. Var 13° 30' E

920.60 To Corner No 3.

Identical with S.W. Cor of location

A pine post 5 ft long 4 ins square  
set 18 ins in ground surrounded  
by mound of stones described 3-1764A  
whence

whence a 2x13' lime rock x and  
chiselled B.B. 3-1764 A. Bears S 72° 14' W 1020 ft.

Thence S 29° 56' E  
Var 13° 12' E

40 Interest a gulch

300 S.W. End Center of location

600 To Cor No 4

Identical with S.E. Cor of location.

Thence N 60° 12' E  
Var 13° 12' E

920.60 To place of beginning at Cor No. 1.



Survey No. 1764, A.  
Ponto Lode

Beginning at Cor No. 1.

Identical with N.W. Cor of location  
whence

U. S. L. M. No. 1764. Bears  $N 69^{\circ} 49' E$  125.85.

Thence  $\curvearrowright$   $53^{\circ} 51' W$

Var  $13^{\circ} 12' E$

1190.70 To Cor No 2

Identical with S.W. Cor of location  
and with Cor No. 2 - 1 Campbell and

Stevens lodes respectively, this survey.

A pine post 5 ft long 4 ins square  
set 18 ins in ground surrounded  
by mound of stones scribed 1-2-2-1764, A.

Whence a Cedar tree 5 ins. in diameter  
blazed and scribed BT 1-2-2-1764 A.

Bears.  $N 72^{\circ} 41' E$  32.80 FT.

Thence  $\curvearrowright$   $31^{\circ} 22' E$

Var  $13^{\circ} 43' E$

301.05 W. End Center location

602.10 To Cor No 3

Identical with O. E. Corner of location.

A pine post 5 ft long 4 ins square  
set 18 ins. in ground surrounded  
by Mound of Stones scribed 3-1764 A.

whence

A 3' x 4' face in line X and chiselled  
B.R 3-1764, A. Bears  $N 55^{\circ} 07' W$  65.26 FT.

Thence  $N 53^{\circ} 51' E$

Var  $13^{\circ} 35' E$

1190.70 To Cor No 4

Identical with N. E. Cor of location  
A pine post 5 ft long 4 ins square  
set on rock surrounded by

Mound of Stones scribed 4-1764 A.

whence a 1' x 1.5' porphyry face in ledge  
bears  $N 17^{\circ} 21' E$  15.15 FT.

Thence  $N 31^{\circ} 22' W$

Var  $13^{\circ} 10' E$

1.88

Cor No 3 Globe this survey.

301.05

N. E. End Center Location

602.10

Place of beginning at Cor. No. 1.



Survey No 1764 A.  
Campbell Lode.

Beginning at Cor No. 1.

Identical with N.E. Cor of location  
whence

U. S. L. M No 1764 Bears  $N 69^{\circ} 49' E$  1125.85 ft.

Thence  $S 53^{\circ} 51' W$

Var  $13^{\circ} 12' E$

1190.70

To Cor No. 2.

Identical with S.E. Cor of Location

Thence  $N 29^{\circ} 56' W$

Var  $13^{\circ} 43' E$

301.77  
570  
603.54

To S.W. End Center of location  
Intersect gulch

To Cor No. 3.

Identical with S.W. Cor of location  
and with Cor No. 2. Stevens Lode this survey

A pine post 5 ft long 4" in square  
set 18 in in ground surrounded by

mound of stone. Scribed 3-2-1764 A.

whence a line face in ledge X and  
chiselled B.R. 3-2-1764 A Bears

$S 33^{\circ} 5' E$  51.86 FT.

Thence  $N 53^{\circ} 51' E$

Var  $13^{\circ} 43' E$

1190.70

To Corner No. 4.

Identical with N.W. Cor of location

A pine post 5 ft long 4" in square  
set 18 in in ground surrounded  
by mound of stones scribed 4-1764 A

whence a line face 2' X 13" (X) and  
chiselled B.R. 4-1764 A Bears

$S 72^{\circ} 14' W$  10.00 ft.

Thence  $S 29^{\circ} 56' E$

Var  $13^{\circ} 17' E$

3.54

Cor. No 3. Tigon this survey

301.77

N.E. End Center of location

603.54

Place of beginning at Cor. No. 1.



Stevens Lode.

Beginning at Cor No. 1.

Identical with N.E. Cor of location,  
 Whence U.S.L.M. No 1764 Bears ~~N 61° 40' E 22929.0 Ft.~~ <sup>N 61° 37' E 22946 Ft.</sup>

Thence N 29° 56' W.

Var 13° 43' E

301.77

N.E.E.C. of location.

603.54

To Cor. No. 2.

Identical with N.W. Ca of location.

Thence S 53° 51' W

Var 13° 43' E

1500

To Cor No. 3.

Identical with S.W. Cor of location.

A pine post 5 ft long 4 in square set  
 18 ins. in ground surrounded by mound  
 of stones, scribed 3-1764A. Whence

a 2' x 4' gophery face x and chiselled  
 B.R 3-1764A Bears S 24° 53' W 10.35 Ft.

Thence S 29° 56' E

Var 13° 30' E

301.77

S.W. End Center of location

603.54

To Cor No. 4.

Identical with N.E. Cor of location.

A pine post 5 ft long 4 ins square  
 set 18 ins in ground surrounded  
 by mound of stones, scribed 4-1764A  
 Whence

A 1.5' x 2' lime rock x and  
 Chiselled B.R 4-1764A Bears  
 S 43° 04' E 8.30.

Thence N 53° 51' E

Var 13° 30' E

775

Intersect Gulech

1500

No place of beginning at Cor No. 1.



## Survey No 1764 B

## Lapen an Mill site

Beginning at Cor No 1

Identical with N.E. Cor of location  
a pine post 5 ft long 4 ins square  
set 18 ins in ground surrounded  
by Mound of Stones, Scribed 1-1764 B  
Whence

U.S. L.M. No 1764 <sup>B</sup> Bears  $N 52^{\circ} 48' E 1063.60 FT$   
Cor No 4 Stevens Survey No 1764 A Bears  
 $N 78^{\circ} 04' E 150.53 FT$

To Eagle River  $N 78^{\circ} 04' E 5700$ .

No permanent bearing.

Thence West

Var  $12^{\circ} 30' E$ 

466.69

To Cor No 2

Identical with N.W. Cor of location  
a pine post 5 ft long 4 ins square  
set 18 ins in ground surrounded  
by Mound of Stones Scribed 2-1764 B.  
Whence a Malpais rock x and chiselled  
B.R. 2-1764 B bears North 12 FT.

Thence South

208

Var  $12^{\circ} 30' E$   
Whence a spring bears  $S 16^{\circ} 43' E 33 FT$

240

Intersect a gulch

466.69

To Cor No 3 Identical with S.W. Cor  
of location.

a pine post 5 ft long 4" ins square  
set on rock surrounded by Mound  
of Stones, scribed 3-1764 B

Whence a x on Malpais bluff chiselled  
B.R. 3-1764 B Bears South 2 FT.

Thence East

466.69

Var  $12^{\circ} 30' E$   
To Cor No 4 In gulch

Identical with S.E. Cor of location  
a pine post 5 ft long 4 ins square  
set 18 ins in ground surrounded  
by Mound of Stones Scribed 4-1764 B  
Whence a 3x4 Malpais rock x and  
chiselled <sup>bears</sup> South 3.40 FT

Thence North

466.69

To place of beginning at Cor No 1

Containing 4.999 Acres. ✓



## Survey No 1764 A

## Acreas

	Acreas.
Net Ana Katie L. Lode	19.750 ✓
Net Acreas Minnie Lode	20.661 ✓
Net Acreas Pine Tree Lode	19.673 ✓
Net Acreas Globe Lode	12.680 ✓
Net Ana Tiger Lode	12.680 ✓
Net Ana Ponto Lode	16.401 ✓
Net Ana Campbell Lode	16.401 ✓
Net Ana Stevens Lode	<u>20.661</u> ✓
Total	138.907

The Surveys of the respective lodes are identical with their locations

## Location

The Claims are located on unsurveyed lands of the United States in Copper Mountain Mining District, Graham County, Arizona.

## Expenditure of Five Hundred Dollars

I certify that the value of labor and improvements upon these claims placed thereon by the claimant and his grantor is not less than Five Hundred Dollars and that said improvements consist of the following.

The discovery cut of the Katie L. Lode, the face of which bears from the D. W. End Center of Katie L. N 36° 07' E 80.60 4.5 FT wide 10 FT Face running N 35° 53' W 22 FT in rock

Value

\$100.00

Value of discovery cut



A

Minnie L  
bis shaft no 1  
open cut no 2

The discovery shaft of the Minnie L which bears from the SW. End Center of Katie L, on end line of Minnie L S 75° 42' W 299.20 FT. a 5 X 6.5 shaft 10 FT deep.  
Value \$75.00.

No 1

An open cut on the Minnie L the face of which bears from the SW. End Center of Katie L, on end line of Minnie L, S 71° 46' W 387 FT. 4 FT wide 10 FT. Face running N 38° 56' E 23 FT in rock  
Value \$100.00

Pine Tree  
bis shaft no 1  
bis shaft no 2  
bis shaft no 3

The discovery <sup>cut</sup> of the "pine tree" the face of which bears from Cor No 3 Pine tree S 51° 40' W 512 FT 4 FT wide 10 FT Face running N 76° 25' E 10 FT in rock  
Value \$50.00

No 2

A 5 X 7 Tunnel the face of the cut bears from Cor No 3 of Pine tree S 46° 33' W 564.32 FT. Hence @ 25° 35' E 14 FT to face of tunnel, 35 FT to breast of tunnel.  
Value \$100.00

No 3

A 6 X 8' shaft 47' FT deep, which bears from Cor No 3 "pine tree" @ 25° 22' E 143 FT  
Value \$470.00

Piger  
bis shaft no 1

The discovery cut of the Piger the face of which bears from N.E End Center Piger S 13° 32' W 319.70 FT 4' wide 10 FT face running S 9° 42' W 14 FT in earth and rock  
Value 70.00

Globe  
bis shaft no 1

The discovery cut of the Globe the face of which bears from N.E End Center Globe



## Survey No 1764 A

S 49° 51' W 266 FT. 5 FT wide 10 FT face  
running N 68° 44' W 22.20 FT in earth  
and rock.

Value

\$100.00

The discovery cut of the Ponto-Lode  
The face of which bears from  
D.W.E.C. center Ponto N 45° 09' E 402.10 FT.  
4 FT wide 10' face running N 58° 36' E 18 FT  
in rock.

Value

\$90.00

102 An open cut the face of which  
bears from D.W. End Center Ponto N 25° 25' E  
126.70 FT 4' wide 8' face running S 11° 45' E  
15 ft in earth and rock.

Value

\$75.00

The discovery cut of the Campbell  
The face of which bears from Cor No 3  
Campbell N 88° 09' E 621.20 FT 4 FT wide  
10 FT face running S 49° 46' E 36 ft  
in earth and rock

Value

\$150.00.

102 A 4x6 Tunnel beginning at breast of  
discovery cut of the Campbell, Thence  
S 49° 46' E 90 FT. to a point denoted by  
"A" Thence S 45° 54' E 49.40 FT. Thence  
S 47° 51' E 58 FT. Thence S 56° 04' E 74 FT to breast.

Beginning at Point "A" Thence N 59° 21' E  
2 FT to face, 35 FT. Thence N 68° 41' E 23.30 FT.  
whence N 88° 41' E 4 FT face of cut 11 FT breast  
Thence N 54° 48' E 23 FT to shaft from above  
67 FT to center of 4x6 wigge 10 FT deep 76 FT  
Thence N 69° 27' E 36.00 FT. Thence N 72° 26' E  
8.40 FT Thence N 67° 14' E 40.20 FT Thence  
N 87° 14' E 33. FT. Breast

Total length of tunnel work 528.60 FT 10 FT wigge

Value

\$2743.00.



## Survey No 1764. A.

103 A 4'x6' tunnel The face of cut bears from Cor No. 3. Campbell  $S 81^{\circ} 11' E$  651.60 FT  
 Thence  $N 88^{\circ} 20' E$  15 FT face of tunnel  
 23 Breast of tunnel  
 Value \$100.00

104 A 6'x8' shaft 6' deep which bears from Cor No 3 Campbell  $S 84^{\circ} E$  834.70 FT  
 Value \$30.00

105 A 3'x8' shaft The west edge of which bears  $N 88^{\circ} 29' E$  781.70 FT from Cor No 3 of Campbell. Thence  $N 56^{\circ} 14' E$  to center of shaft; Shaft 57 ft vertical whence  $S 38^{\circ} 38' E$  Dip  $72^{\circ} 30'$  15.00 to connection in tunnel. Thence  $N 56^{\circ} 14' E$  4 edge of shaft and mouth of cut 4 FT wide 20 FT Face. Thence  $N 56^{\circ} 14'$  38 FT to breast of cut and face of 4x6 tunnel, Thence  $N 63^{\circ} 14' E$  Dip  $35^{\circ} 00'$  3.5 FT and 16.00 level to breast  
 Value of shaft \$800.00  
 " " Cut and tunnel \$350.00

106 A 4ft x 6ft tunnel The face of the cut bears from Cor No 1 Campbell  $S 65^{\circ} 06' W$  123.70 Thence  $N 49^{\circ} 38' E$  15 FT to face of tunnel 36 FT to edge of a 4'x9' shaft 11 FT deep from surface 45 FT to Breast.  
 Value \$300.00

The discovery tunnel of the Stevens  
 The face of the cut bears  $S 59^{\circ} 06' W$  132.50 from N.E. End Center of Stevens  
 Thence  $N 35^{\circ} 34' E$  14 to face of 4x6 tunnel  
 22 FT to breast.  
 Value \$100.00

107 An open cut The face of which bears  $S 57^{\circ} 47' W$  236.70 FT from N.E. End Center of Stevens.  
 8 ft wide 10 FT face running  $S 59^{\circ} 40' W$  15 FT in rock  
 Value \$125.00

Stevens  
 The tunnel No 1  
 Open cut No 2.  
 Then cut No 3.  
 tunnel No 4.



## Survey No 1764A.

1103 An open cut the face of which bears from N. E. End Center of Stevens S 64° 11' W 429 FT 4 FT wide 10' Face running S 79° 06' W 12 FT in rock.  
Value \$60.00

1104 A 4 ft X 6 ft tunnel the face of the cut bears from Cor No 2 Stevens S 49° 23' W 201.40 ft hence S 81° 49' W 12 FT to face of tunnel 18 FT to breast.  
Value \$90.00

Total Value of improvements  
\$6078.00

4  
Note: - The lodes, as far as development work discloses, appear to be on the center of the claims.

The surface embraced by this claim ascends rapidly from the mouth of the tunnel, described on the Campbell lode, towards the Ponto Tiger, Globe Pine Tree, Minnie L and Katie L. Lodes, these claims being from 200 - 700 feet higher than said tunnel. Also by means of winze in said tunnel the Stevens lode can be worked advantageously. The tunnel also would cut a portion of the Stevens lode.

By means of the workings, described and included in the estimate of expenditure, continued will cut the lodes of the several locations at good depth whereby one system of workings the entire claim can be most advantageously and economically developed.



## Survey No 1764 A

Expenditure of \$500,

Beginning at point A in Campbell Tunnel. Thence N 59° 21' E 2 ft face of cut 35 FT Thence N 68° 41' E 23.30 FT Thence N 54° 48' E 30 FT being 86.30 Feet of work to be credited to the Tiger Lode this Survey. Thence N 54° 48' E 46 FT Thence N 69° 27' E 36 FT being 82 feet of work to be credited to Minnie Lode this Survey.

Thence N 72° 56' E 8.40 FT Thence N 67° 14' E 40.50 FT Thence N 87° 14' E 33 FT being 81.90 FT of work to be credited to Katie L. Lode, this Survey.

A wing in tunnel to be credited to Stevens.

Beginning at Point A in Campbell Tunnel Thence S 46° 24' E 49 to be credited to Stevens Lode this Survey.

Thence S 45° 54' E 39.40 FT Thence S 47° 51' E 30 FT being 69.40 FT to be credited to Ponto Lode this Survey.

Thence S 47° 51' E 28 FT S 56° 04' E 74 FT 102 FT of work to be credited to Globe Lode this Survey

Katie L Lode	81.90 FT	Value	409.50
	Disc. cut	..	<u>100.00</u> \$509.50

Minnie L Lode	82 FT	Value	410.00
	Disc. shaft and open cut	..	<u>175.00</u> \$585.00

Tiger Lode	86.30 FT	Value	431.50
	Disc cut	..	<u>70.00</u> \$501.50

Globe Lode	102 FT	Value	510.00
	Disc cut	..	<u>100.00</u> \$610.00

Ponto Lode	69.40 FT	..	347.00
	Disc cut and open cut	..	<u>165.00</u> \$512.00

Stevens Lode	10 ft wing	Value	100.00
	10 FT tunnel	..	50

Other work described			375.00 \$75.00
----------------------	--	--	----------------



Survey No 1764 B.

Lake on Mill site

The Survey is identical with  
the location

Surveys No 1764 A & B were  
made with a Gurvey light  
Mountain Transit

The courses were deflected  
from the true Meridian as  
determined by Solar observations  
with a Burt Solar Attachment

The distances were measured  
with 50 and 500 ft steel tapes

Note: The disagreements between  
these field notes and the location  
Certificate of the respective locations embraced  
in this survey with regards to the  
position of the discovery point, courses  
and distances are due to errors in  
the latter.

U.S. L.M. No 1764 A  
Not knowing of any U.S. L.M. within  
two miles of the claims I established  
a U.S. L.M. No 1764. A pine post  
6" x 8" 10 FT long set 2 ft. in crevice  
of a rock and surrounded by mound  
of stones described U.S. L.M. No 1764  
whence a 2" x 4" granite rock bears N  
40° 45' E 8.30 FT Van 13° 30' E.

U.S. L.M. No 1764 B. Established  
a Cedar post 8 ins diameter 8 feet  
long set 18 ins in ground  
surrounded by mound of stones  
described U.S. L.M. No 1764 B.  
whence a Geological Survey Mon. on  
American Mountain bears N 55° 30' E  
Peak at Guthrie bears S 52° 15' E  
Junction of two gulches in sight bears  
S 80° 25' W Van 12° 30' E

H.M. W. H. Baker

U.S. Dep. Min. Sur.



# FINAL OATHS FOR SURVEYS.

## LIST OF NAMES.

A list of the names of the individuals employed by H.M. Whitaker

United States Deputy Mineral Surveyor, to assist in running, measuring, and marking the lines corners and boundaries described in the foregoing field notes of the survey of the mining claim

of Sophie R. Lohman

known as the Katie L. Minnie L. Pine Tree, Globe, Tiger, Pinto, Campbell Stevens and Lohman Mills

and showing the respective capacities in which they acted.

J. R. Edwards, Chairman.

....., Chairman.

....., Axman.

....., Flagman.

## FINAL OATHS OF ASSISTANTS.

We, J. R. Edwards

and ....., do solemnly swear that we assisted H.M. Whitaker

....., United States Deputy Mineral Surveyor, in marking the corners and surveying the boundaries of the mining claim of Sophie R. Lohman

....., known as the Katie L. Minnie L. Pine Tree, Globe, Tiger, Pinto, Campbell, Stevens and Lohman Mills, represented

in the foregoing field notes as having been surveyed by said deputy mineral surveyor and under his direction; and that said survey has been in all respects, to the best of our knowledge and belief, faithfully and correctly executed, and the corner and boundary monuments established according to law and the instructions furnished by the United States Surveyor-General for

Arizona

J. R. Edwards, Chairman.

....., Chairman.

....., Axman.

....., Flagman.

Subscribed and sworn to by the above-named persons before me

this 27th day of March, 1 903

Frank B. Lane  
Notary Public



(4-686.)

FINAL OATH OF U. S. DEPUTY MINERAL SURVEYOR

I, H. M. Whitaker, U. S. Deputy Mineral Surveyor, do solemnly swear that, in pursuance of instructions received from the United States Surveyor General for Arizona, dated Feb. 21 - 1903, I have, in strict conformity to the laws of the United States, the official regulations and instructions thereunder, and the instructions of said Surveyor General, faithfully and correctly executed the survey of the Mining Claim of Daphne R. Lakeman, known as the Kate L. Minnie L. Pine Tree, Globe, Pigeon, Porto Campbell, Stevens, and Lakeman, Mitchell Mining District, situate in Copper Mountain County, Arizona, in Section Araban, Township No. \_\_\_\_\_, Range No. \_\_\_\_\_, and designated as Survey No. 1764 AXB, as represented in the foregoing field notes, which accurately show the boundaries of said mining claim as distinctly marked by monuments on the ground, and described in the attached copy of the location certificate, which was received by me from the Surveyor General with said instructions, and that all the corners of said survey have been established and perpetuated in strict accordance with the law, official regulations and instructions thereunder; and I do further solemnly swear that the foregoing are the true and original field notes of said survey and my report therein, and that the labor expended and improvements made upon said mining claim by claimant or her grantors are as therein fully stated, and that the character, extent, location and itemized value thereof are specified therein with particularity and full detail, and that no portion of said labor or improvements so credited to this claim has been included in the estimate of expenditures upon any other claim.

H. M. Whitaker  
U. S. Deputy Mineral Surveyor.

Subscribed and sworn to by the said H. M. Whitaker  
U. S. Deputy Mineral Surveyor, before me Francis B. Loring  
A Notary Public this 27  
day of March 1903

Francis B. Loring  
Notary Public



MY COMMISSION EXPIRES NOV. 20th, 1903



Affidavit of Five Hundred Dollars Improvements.

We, L. H. Miner, and E. E. Frye

of lawful age, being first duly sworn according to law, depose and say: That we are acquainted with the Kati, L. Mannist, Pine Tree, & Lobe, Pigeon mining claim, situate in Copper Mountain Mining district, Graham County, Arizona Territory, for which Daphne R. Labrum

has made application for survey prior to application for patent under the provisions of the Act of Congress, approved May 10, 1872; and that the labor done and improvements made thereon by the applicant and her grantor exceed Five Hundred Dollars in value, and further that we are not personally interested in said mine.

L. H. Miner

E. E. Frye

TERRITORY OF ARIZONA,  
County of Graham ss:

Sworn to and subscribed before me, this 27

day of March, 1903

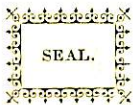

Francis Blaney  
Notary Public

MY COMMISSION  
EXPIRES NOV. 20th, 1905.



# American Notice of Mining Location.--L. le Claim.

To All Whom it May Concern:

This mining claim, the name of which is the Katie L. 22 Mining Claim, situate on lands belonging to the United States of America, and in which there are valuable mineral deposits, was entered upon and located for the purpose of exploration and purchase by

Dophie R. Lakenan, a Citizen of the United States

the undersigned, on the First day of December 1902

The length of this claim is 1433.90 feet, and 1 claim 1363.90 feet,

in a North Easterly direction, and

70 feet in a South Westerly direction from the center of the discovery shaft, at which this notice is posted, lengthwise of the claim, together with

Three Hundred feet in width of the surface grounds, on each side of the center of said claim. The general course of the lode deposit and premises is from the

North East to the South West

The claim is situated and located in the Copper Mountain Mining District, in Graham County, in the Territory of Arizona, about

in a North West direction from This claim adjoins the "Palma" claim on the North West and the Minnie L on the South West. This claim is situated between Gold and Silver Gulches.

The surface boundaries of the claim are marked upon the ground as follows: Beginning at A Mound of Stones

at a point in a North Easterly direction 1363.90 feet from the discovery shaft (at which this notice is posted), being in the center of the North East end line of said claim; thence S 31° 22' E 300 feet to a 4" X 4" pine post, being the North East corner of said claim; thence S 58° 38' W 1433.90 feet to a 4" X 4" pine post being at the South East corner of said claim; thence N 31° 22' W 300 feet to a Mound of Stones being the center of the South West end of said claim; thence N 31° 22' W 300 feet to a 4" X 4" pine post being at the South West corner of said claim; thence N 58° 38' E 1433.90 feet to a 4" X 4" pine post at the North West corner of said claim; thence S 31° 22' E 300 feet to the place of beginning.

All done under the provisions of Chapter Six, of Title XXXII, of the Revised Statutes of the United States, and of an Act of the General Assembly of Arizona, entitled "An Act to Codify and Revise the Laws of the Territory of Arizona," approved March 16th, 1901.

This is an Amended Location Notice of the Katie L. Mining Claim, located by Richard Lakenan a Citizen of the United States on the 18<sup>th</sup> day of November 1897, and recorded in book 9 of Records of Mines, at page 394, in the office of the County Recorder of the aforesaid County of Graham to which reference is hereby made, and this Amended Location Notice is made and posted to correct errors in the description in the said original Location Notice.

Dated and posted on the ground this First day of December 1902

Witness L.H. Mines Dophie R. Lakenan



County of \_\_\_\_\_

} ss.

County Recorder in and for the County and Territory aforesaid, do hereby certify that the within instrument was filed for record at \_\_\_\_\_ o'clock \_\_\_\_\_ M., on this \_\_\_\_\_ day of \_\_\_\_\_, 190\_\_\_\_, and duly recorded in Book No \_\_\_\_\_ of \_\_\_\_\_ Records of \_\_\_\_\_ County, Arizona, at pages \_\_\_\_\_

Witness my hand and seal the day and year first above written

County Recorder

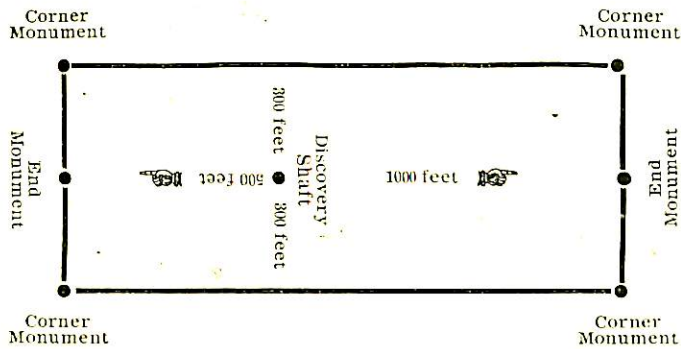

The above diagram is to give the locator a general idea of the plan of location under the new law. Your discovery shaft may be in the center of claim, or any distance from either end you desire. In the diagram we have placed it 500 feet from one end and 1000 feet from the other. In description be careful to state locality of claim with reference to some natural object, or permanent monument, so as to identify the claim.

~~1777~~  
4200

AMENDED

# Notice of Location

LODE CLAIM

*Nate L. Brit*  
*Joseph W. Brit*

*Richard Q. Labernan*

Dated *Dec. 1st* 190*2*

Filed and recorded at request of

*Richard Labernan*

*December 18th* A. D. 190*2*

at *Prescott* A. M.

Book *16* Record of Mines

Pages *23*

*Thomas Smith*

County Recorder.

By *L. Stearns*  
Deputy Recorder.



Amer led Notice of Mining Location.--Lode Claim.

To All Whom it May Concern:

This mining claim, the name of which is the Piquen Mining Claim, situate on lands belonging to the United States of America, and in which there are valuable mineral deposits, was entered upon and located for the purpose of exploration and purchase by

Sophie R. Lakenan, a Citizen of the United States

the undersigned, on the First day of December 1902

The length of this claim is 920.60 feet, and 9 claim 215 feet, in a North Easterly direction, and 705.60 feet in a South Westerly direction from the center of the discovery shaft, at which this notice is posted, lengthwise of the claim, together with

300 feet in width of the surface grounds, on each side of the center of said claim. The general course of the lode deposit and premises is from the

North Easterly to the South Westerly

The claim is situated and located in the Copper Mountain Mining District, in Graham County, in the Territory of Arizona, about

in a North Easterly direction from and adjoins the "Pine Tree" on the North East, the "Campbell" on the South West, and the "Globe" on the South East. This claim is situated between Gold and Silver Gulches

The surface boundaries of the claim are marked upon the ground as follows: Beginning at A Mound of Stones

at a point in a North Easterly direction 215 feet from the discovery shaft (at which this notice is posted), being in the center of the North East end line of said claim: thence S 29° 56' 300 feet to a 4" X 4" pine post, being the North East corner of said claim: thence S 60° 12' W 920.60 feet to a 4" X 4" pine post being at the South East corner of said claim: thence N 29° 56' W 300 feet to a Mound of Stone being the center of the South West end of said claim: thence N 29° 56' W 300 feet to a 4" X 4" pine post being at the South West corner of said claim: thence N 60° 12' E 920.60 feet to a 4" X 4" pine post at the North West corner of said claim: thence S 29° 56' E 300.11 feet to the place of beginning.

All done under the provisions of Chapter Six, of Title XXXII, of the Revised Statutes of the United States, and of an Act of the General Assembly of Arizona, entitled "An Act to Codify and Revise the Laws of the Territory of Arizona," approved March 16th, 1901.

This is an Amended Location Notice of the Piquen Mining Claim, located by Richard Lakenan, a Citizen of the United States

on the 4th day of February 1889, and recorded in book 6 of Records of Mines, at

page 131, in the office of the County Recorder of the aforesaid County of Graham to which reference is hereby made, and this Amended Location Notice is made and posted to correct errors in the description in the said original Location Notice.

Dated and posted on the ground this First day of December 1902

witness

L. N. Miner

Sophie R. Lakenan



TERRITORY OF ARIZONA,

ss.

County of \_\_\_\_\_

County Recorder in and for the County and

Territory aforesaid, do hereby certify that the within instrument was filed for record at \_\_\_\_\_

o'clock \_\_\_\_\_ M., on this \_\_\_\_\_ day of \_\_\_\_\_, 190\_\_\_\_, and

daily recorded in Book No \_\_\_\_\_ of \_\_\_\_\_ Records of \_\_\_\_\_

County, Arizona, at pages \_\_\_\_\_

Witness my hand and seal the day and year first above written

County Recorder

231.35.7

2/1/10

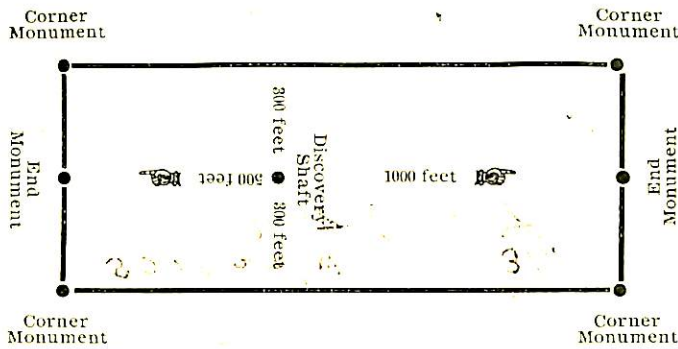

The above diagram is to give the locator a general idea of the plan of location under the new law. Your discovery shaft may be in the center of claim, or any distance from either end you desire. In the diagram we have placed it 500 feet from one end and 1000 feet from the other. In description be careful to state locality of claim with reference to some natural object, or permanent monument, so as to identify the claim.

4194

AMENDED

# Notice of Location

LODE CLAIM

*Travis*  
*Epifanio M. Scott*

*Stephen P. Sabers*

Dated *Dec. 1st* 190*9*

Filed and recorded at request of

*Richard Sabers*

*December 18th* A. D. 190*9*

at *Prescott, A.* M.

Book *16* Records of *Minerals*

Pages *19-28*

*Thomas Smith*

County Recorder.

*B. S. Ostrum*  
Deputy Recorder.

ERA PRINT, CLIFTON



**American Notice of Mining Location.--L. le Claim.**

To All Whom it May Concern:

This mining claim, the name of which is the Minnie L Mining Claim, situate on lands belonging to the United States of America, and in which there are valuable mineral deposits, was entered upon and located for the purpose of exploration and purchase by Dophie R. Lakenan, a Citizen of the United States.

the undersigned, on the First day of December 1902  
The length of this claim is Fifteen Hundred feet,  
and 1 claim 300 feet,  
in a North Easterly direction, and

1200 feet in a South westerly direction from the center of the discovery shaft, at which this notice is posted, lengthwise of the claim, together with Three Hundred feet in width of the surface grounds, on each side of the center of said claim. The general course of the lode deposit and premises is from the North Easterly to the South westerly

The claim is situated and located in the Copper Mountain Mining District, in Graham County, in the Territory of Arizona, about

in a North Easterly direction from This claim adjoins the "Pine tree" claim on the Northwest and the Katie L on the North East. This claim is situated between Gold and Silver Gulches.

The surface boundaries of the claim are marked upon the ground as follows: Beginning at

A Mound of Stones

at a point in a North Easterly direction 300 feet from the discovery shaft (at which this notice is posted), being in the center of the North East end line of said claim; thence S 31° 22' W 317.70 feet to a 4" X 4" pine post, being the North East corner of said claim; thence S 77° 51' W 1500 feet to a 4" X 4" pine post being at the South East corner of said claim; thence N 31° 22' E 317.70 feet to a Mound of Stones being the center of the South West end of said claim; thence N 31° 22' W 317.70 feet to a 4" X 4" pine post being at the South West corner of said claim; thence N 77° 51' E 1500 feet to a 4" X 4" pine post at the North West corner of said claim; thence S 31° 22' E 317.70 feet to the place of beginning.

All done under the provisions of Chapter Six, of Title XXXII, of the Revised Statutes of the United States, and of an Act of the General Assembly of Arizona, entitled "An Act to Codify and Revise the Laws of the Territory of Arizona," approved March 16th, 1901.

This is an Amended Location Notice of the Minnie L Mining Claim, located by Richard Lakenan, a Citizen of the United States on the 18th day of November 1897, and recorded in book 9 of Records of Mines, at page 395, in the office of the County Recorder of the aforesaid County of Graham to which reference is hereby made, and this Amended Location Notice is made and posted to correct errors in the description in the said original Location Notice.

Dated and posted on the ground this First day of December 1902

Witness L. H. Miner  
Dophie R. Lakenan



TERRITORY OF ARIZONA,

County of \_\_\_\_\_ } ss.

County Recorder in and for the County and Territory aforesaid, do hereby certify that the within instrument was filed for record at \_\_\_\_\_ o'clock \_\_\_\_\_ M., on this \_\_\_\_\_ day of \_\_\_\_\_ 190\_\_\_\_, and duly recorded in Book No \_\_\_\_\_ of \_\_\_\_\_ Records of \_\_\_\_\_ County, Arizona, at pages \_\_\_\_\_

Witness my hand and seal the day and year first above written

County Recorder

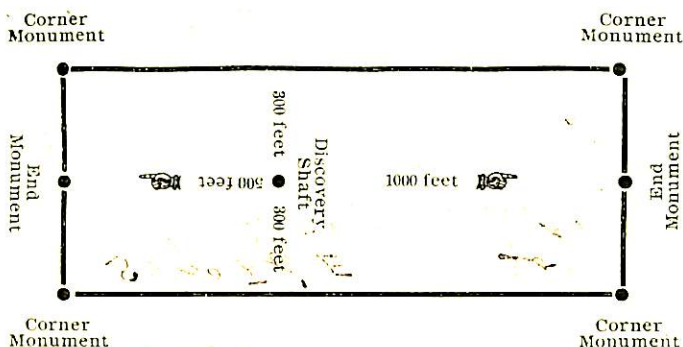

The above diagram is to give the locator a general idea of the plan of location under the new law. Your discovery shaft may be in the center of claim, or any distance from either end you desire. In the diagram we have placed it 500 feet from one end and 1000 feet from the other. In description be careful to state locality of claim with reference to some natural object, or permanent monument, so as to identify the claim.

4207

AMENDED

# Notice of Location

LODE CLAIM

*Yiminie L.*

*Stephen Mountain*

*District*

*Stephen P. Sabersman*

Dated *Dec. 1st* 190*2*

Filed and recorded at request of

*Richard Sabersman*

*Dec. 18th* A. D. 190*2*

at *Prescher A.* M.

Book *16* Record of *Miners*

Pages *20*

*Thomas Smith*

County Recorder.

By *S. Stearns*

Deputy Recorder.

ERA PRINT, CLIFTON



# American Notice of Mining Location.--Lode Claim.

To All Whom it May Concern:

This mining claim, the name of which is the Pine Tree Mining Claim, situate on lands belonging to the United States of America, and in which there are valuable mineral deposits, was entered upon and located for the purpose of exploration and purchase by

Dophie R. Lakerman, a Citizen of the United States

the undersigned, on the first day of December 1902

The length of this claim is Fifteen Hundred feet, and 1 claim 230 feet, in a North Easterly direction, and

1270 feet in a South westerly direction from the center of the discovery shaft, at which this notice is posted, lengthwise of the claim, together with 285.66 feet in width of the surface grounds, on each side of the center of said claim. The general course of the lode deposit and premises is from the

North East to the South West

The claim is situated and located in the Copper Mountain Mining District, in Graham County, in the Territory of Arizona, about and adjoins the in a Galena on direction from the North East. This claim is situated between gold and silver Gulches.

The surface boundaries of the claim are marked upon the ground as follows: Beginning at a Mound of Stones

at a point in a North Easterly direction 230 feet from the discovery shaft (at which this notice is posted), being in the center of the North East end line of said claim: thence S 29° 56' E 300 feet to a 4" X 4" pine post, being the North East corner of said claim; thence S 77° 51' W 1500 feet to a 4" X 4" pine post being at the South East corner of said claim; thence N 29° 56' W 300 feet to a a Mound of Stones being the center of the South West end of said claim; thence N 29° 56' W 300 feet to a 4" X 4" pine post being at the South West corner of said claim; thence N 77° 51' E 1500 feet to a 4" X 4" pine post at the North West corner of said claim; thence S 29° 56' E 300 feet to the place of beginning.

All done under the provisions of Chapter Six, of Title XXXII, of the Revised Statutes of the United States, and of an Act of the General Assembly of Arizona, entitled "An Act to Codify and Revise the Laws of the Territory of Arizona," approved March 16th, 1901.

This is an Amended Location Notice of the Pine tree Mining Claim, located by Richard Lakerman on the 25th day of

March 1891~~190~~, and recorded in book 7 of Records of Mines, at page 109, in the office of the County Recorder of the aforesaid County of Graham to which reference is hereby made, and this Amended Location Notice is made and posted to correct errors in the description in the said original Location Notice.

Dated and posted on the ground this first day of December 1902

Witness  
J. H. Mines  
Dophie R. Lakerman



TERRITORY OF ARIZONA,

County of .....

} ss.

..... County Recorder in and for the County and Territory aforesaid, do hereby certify that the within instrument was filed for record at ..... o'clock ..... M., on this ..... day of ..... 190....., and duly recorded in Book No ..... of ..... Records of ..... County, Arizona, at pages .....

Witness my hand and seal the day and year first above written

County Recorder

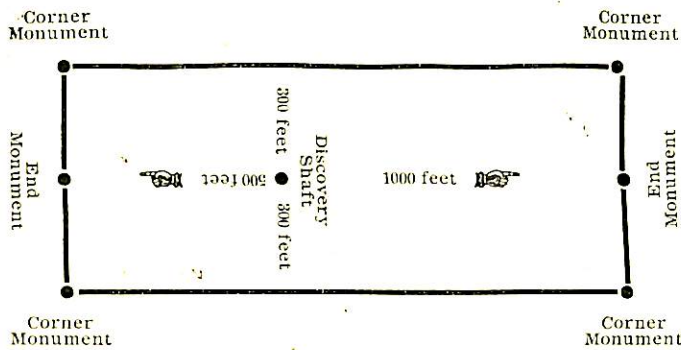

The above diagram is to give the locator a general idea of the plan of location under the new law. Your discovery shaft may be in the center of claim, or any distance from either end you desire. In the diagram we have placed it 500 feet from one end and 1000 feet from the other. In description be careful to state locality of claim with reference to some natural object, or permanent monument, so as to identify the claim.

41198

AMENDED

# Notice of Location

LODE CLAIM

*Prize Tree*

*Boyer's Mt District*

*Johnie P. Sabrum*

Dated *Dec. 1st* 190*2*

Filed and recorded at request of

*Richard Sabrum*

*Recorded 18 " A. D. 190 2*

at *9 o'clock* A. M.

Book *16* Record of *Minis*

Pages

*22*

*Thomas Smith*  
County Recorder.

By *L. Stearns*  
Deputy Recorder.



# American Notice of Mining Location.--Lode Claim.

To All Whom it May Concern:

This mining claim, the name of which is the Globe Mining Claim, situate on lands belonging to the United States of America, and in which there are valuable mineral deposits, was entered upon and located for the purpose of exploration and purchase by

Daphne R. Lakerman, a Citizen of the United States

the undersigned, on the first day of December 1902

The length of this claim is 920.60 feet,

and 4 claim 260.00 feet,

in a North Easterly direction, and

660.60 feet in a South Westerly direction from the center of the discovery shaft, at which this notice is posted, lengthwise of the claim, together with

300 feet in width of the surface grounds, on each side of the center of said claim. The general course of the lode deposit and premises is from the

North Easterly to the South Westerly

The claim is situated and located in the Copper Mountain Mining District, in Graham County, in the Territory of Arizona, about

in a North Easterly direction from and adjoins the "Minnie Lane"

the North East, "The Ponto" on the South West,

and the "Piper" on the North West. This claim

is situated between Gold and Silver Gulches,

The surface boundaries of the claim are marked upon the ground as follows: Beginning at

A Mound of Stones

at a point in a North Easterly direction 260 feet from the discovery shaft (at which this notice is posted), being in the center of the North East

end line of said claim; thence S 31° 22' E 300.11 feet to a 4"X4" pine post

, being the North East corner of said claim; thence

S 60° 12' W 920.60 feet to a 4"X4" pine post being at the

South East corner of said claim; thence N 31° 22' W 300.11

feet to a Mound of Stones being the center of the South West end

of said claim; thence N 31° 22' W 300.11 feet to a 4"X4" pine post

being at the South West corner of said claim; thence N 60° 12' E

920.60 feet to a 4"X4" pine post at the

North West corner of said claim; thence S 31° 22' E 300.11

feet to the place of beginning.

All done under the provisions of Chapter Six, of Title XXXII, of the Revised Statutes of the United States, and of an Act of the General Assembly of Arizona, entitled "An Act to Codify and Revise the Laws of the Territory of Arizona," approved March 16th, 1901.

This is an Amended Location Notice of the Globe

Mining Claim, located by Ignacio Campbell, a Citizen of the United States on the 11<sup>th</sup> day of

July 1890, and recorded in book 6 of Records of Mines, at page 1389, in the office of the County Recorder of the aforesaid County of Graham

to which reference is hereby made, and this Amended Location Notice is made and posted to correct errors in the description in the said original Location Notice.

Dated and posted on the ground this first day of December 1902

Witness

J. H. Miner

Daphne R. Lakerman



TERRITORY OF ARIZONA,

ss.

County of \_\_\_\_\_

County Recorder in and for the County and

Territory aforesaid, do hereby certify that the within instrument was filed for record at \_\_\_\_\_ o'clock \_\_\_\_\_ M., on this \_\_\_\_\_ day of \_\_\_\_\_ 190\_\_\_\_, and duly recorded in Book No \_\_\_\_\_ of \_\_\_\_\_ Records of \_\_\_\_\_ County, Arizona, at pages \_\_\_\_\_

Witness my hand and seal the day and year first above written

County Recorder

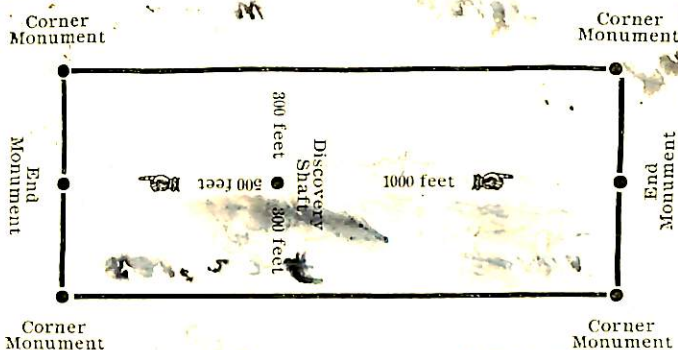

The above diagram is to give the locator a general idea of the plan of location under the new law. Your discovery shaft may be in the center of claim, or any distance from either end you desire. In the diagram we have placed it 500 feet from one end and 1000 feet from the other. In description be careful to state locality of claim with reference to some natural object, or permanent monument, so as to identify the claim.

4198

# Notice of Location

AMENDED  
LODE CLAIM

*W. C. Cole*  
*Bookkeeper Mountain*  
*Mining District*  
*John W. P. Saberman*

Dated *Dec. 1st* 190*2*

Filed and recorded at request of  
*Richard Saberman*

*Dec. 18<sup>th</sup>* A. D. 190*2*

at *Prescott A.* M.

Book *16* Record of Mines

Pages *20-21*

*Thomas Smith*  
County Recorder.

By *W. C. Clifton*  
Deputy Recorder.



Ame. led Notice of Mining Location.--Lode Claim.

To All Whom it May Concern:

This mining claim, the name of which is the Ponto Mining Claim, situate on lands belonging to the United States of America, and in which there are valuable mineral deposits, was entered upon and located for the purpose of exploration and purchase by

Jophie R. Lakinan, a Citizen of the United States

the undersigned, on the First day of December 1902

The length of this claim is 1190.70 feet, and claim 800 feet, in a North Easterly direction, and 390.70 feet in a South Westerly direction from the center of the discovery shaft, at which this notice is posted, lengthwise of the claim, together with

300 feet in width of the surface grounds, on each side of the center of said claim. The general course of the lode deposit and premises is from the North Easterly to the South Westerly

The claim is situated and located in the Copper Mountain Mining District, in Graham County, in the Territory of Arizona, about

in a North Easterly direction from and adjoins the "Globe" on the North East end The Campbell on the North West. This claim is situated between Gold and Silver Gulches.

The surface boundaries of the claim are marked upon the ground as follows: Beginning at

A Mound of Stones

at a point in a North Easterly direction 800 feet from the discovery shaft (at which this notice is posted), being in the center of the North East end line of said claim; thence S 31° 22' E 301.05 feet to a 4" X 4" pine post, being the North East corner of said claim; thence S 53° 51' W 1190.70 feet to a 4" X 4" pine post being at the South East corner of said claim; thence N 31° 22' W 301.05 feet to a Mound of Stones being the center of the South West end of said claim; thence N 31° 22' W 301.05 feet to a 4" X 4" pine post being at the South West corner of said claim; thence N 53° 51' E 1190.67 feet to a 4" X 4" pine post at the North West corner of said claim; thence S 31° 22' E 301.05 feet to the place of beginning.

All done under the provisions of Chapter Six, of Title XXXII, of the Revised Statutes of the United States, and of an Act of the General Assembly of Arizona, entitled "An Act to Codify and Revise the Laws of the Territory of Arizona," approved March 16th, 1901.

This is an Amended Location Notice of the Ponto

Mining Claim, located by Richard Lakinan

a Citizen of the United States on the twenty third day of

January 1891, and recorded in book 7 of Records of Mines, at page 69, in the office of the County Recorder of the aforesaid County of Graham

to which reference is hereby made, and this Amended Location Notice is made and posted to correct errors in the description in the said original Location Notice.

Dated and posted on the ground this First day of December 1902

Witness

S. H. Miner

Jophie R. Lakinan



TERRITORY OF ARIZONA,

} ss.

County of .....

County Recorder in and for the County and Territory aforesaid, do hereby certify that the within instrument was filed for record at ..... o'clock ..... M., on this ..... day of ..... 190....., and duly recorded in Book No ..... of ..... Records of ..... County, Arizona, at pages .....

Witness my hand and seal the day and year first above written

County Recorder

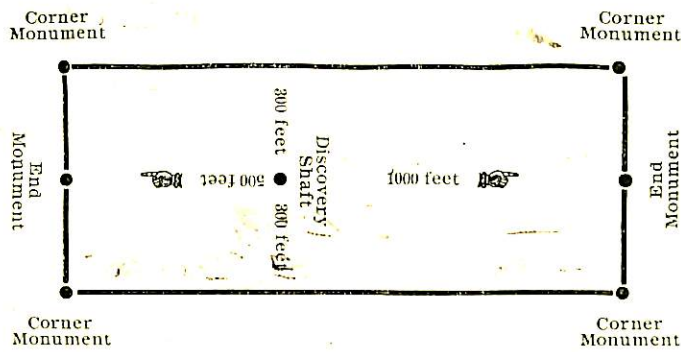

The above diagram is to give the locator a general idea of the plan of location under the new law. Your discovery shaft may be in the center of claim, or any distance from either end you desire. In the diagram we have placed it 500 feet from one end and 1000 feet from the other. In description be careful to state locality of claim with reference to some natural object, or permanent monument, so as to identify the claim.

4197

4197

AMENDED

# Notice of Location

LODE CLAIM

Travis Paul Blain  
Leopold Mt. Quartz

Joseph P. Sabersman

Dated December 1st 1902

Filed and recorded at request of

Richard Sabersman

Dec. 18th A. D. 1902

at Prescott, Ariz. M.

Book 16 Records of Miners

Pages 21-22

Thomas Smith

County Recorder.

By S. D. Thornton  
Deputy Recorder.



Amended Notice of Mining Location.--Lode Claim.

To All Whom it May Concern:

This mining claim, the name of which is the Campbell Mining Claim, situate on lands belonging to the United States of America, and in which there are valuable mineral deposits, was entered upon and located for the purpose of exploration and purchase by

34

Sophie R. Lakinan

the undersigned, on the First day of December 1902

The length of this claim is 1190.70 feet, and 900 claim 900 feet, in a North Easterly direction, and 290.70 feet in a South Westerly direction from the center of the discovery shaft, at which this notice is posted, lengthwise of the claim, together with

300 feet in width of the surface grounds, on each side of the center of said claim. The general course of the lode deposit and premises is from the North Easterly to the South Westerly

The claim is situated and located in the Copper Mountain Mining District, in Graham County, in the Territory of Arizona, about

in a direction from and adjoining the "Pig" on the North east, "The Stevens" on the South west and the "Porto" on the South East.

The surface boundaries of the claim are marked upon the ground as follows: Beginning at A Mound of Stones

at a point in a North Easterly direction 900 feet from the discovery shaft (at which this notice is posted), being in the center of the North East end line of said claim; thence S 29° 56' E 301.77 feet to a 4" X 4" pine post, being the North East corner of said claim; thence S 53° 51' W 1190.70 feet to a 4" X 4" pine post being at the South East corner of said claim; thence N 29° 56' W 301.77 feet to a Mound of Stones being the center of the South West end of said claim; thence N 29° 56' W 301.77 feet to a 4" X 4" pine post being at the South West corner of said claim; thence N 53° 51' E 1190.70 feet to a 4" X 4" pine post at the North West corner of said claim; thence S 29° 56' E 301.77 feet to the place of beginning.

All done under the provisions of Chapter Six, of Title XXXII, of the Revised Statutes of the United States, and of an Act of the General Assembly of Arizona, entitled "An Act to Codify and Revise the Laws of the Territory of Arizona," approved March 16th, 1901.

This is an Amended Location Notice of the Campbell Mining Claim, located by Ignacio Campbell on the 20th day of

June 1890 ~~1900~~, and recorded in book 6 of Records of Mines, at page 389-390, in the office of the County Recorder of the aforesaid County of Graham to which reference is hereby made, and this Amended Location Notice is made and posted to correct errors in the description in the said original Location Notice.

Dated and posted on the ground this First day of December 1902

Witness: L. N. Miner

Sophie R. Lakinan



TERRITORY OF ARIZONA,

} ss.

County of ..... County Recorder in and for the County and Territory aforesaid, do hereby certify that the within instrument was filed for record at ..... o'clock ..... M., on this ..... day of ..... 190....., and duly recorded in Book No ..... of ..... Records of ..... County, Arizona, at pages .....

Witness my hand and seal the day and year first above written

County Recorder

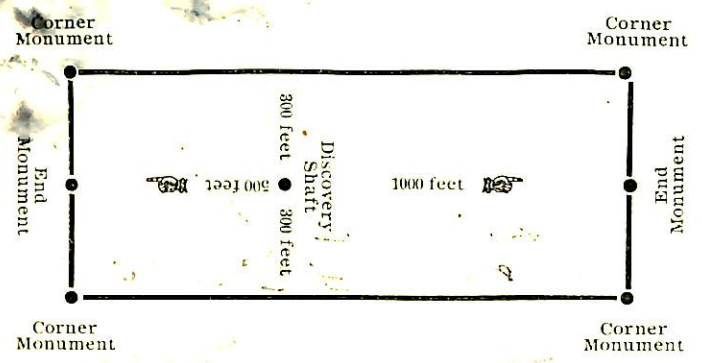

The above diagram is to give the locator a general idea of the plan of location under the new law. Your discovery shaft may be in the center of claim, or any distance from either end you desire. In the diagram we have placed it 500 feet from one end and 1000 feet from the other. In description be careful to state locality of claim with reference to some natural object, or permanent monument, so as to identify the claim.

4207 12/1906

AMENDED  
Notice of Location  
LODE CLAIM

*Bampflett*  
*Captain Mt. Pitt*

*Joseph A. Saberson*

Dated *Dec 1<sup>st</sup>* 190*6*

Filed and recorded at request of

*Richard Saberson*

*December 18<sup>th</sup>* A. D. 190*6*

at *Prescott A.* M.

Book *16* Record of Mines

Pages *21*

*Thomas Smith*  
County Recorder.

*B. J. Stevenson*  
Deputy Recorder.



8

**American Notice of Mining Location.--Lode Claim. 36**

To All Whom it May Concern:

This mining claim, the name of which is the *Stevens* Mining Claim, situate on lands belonging to the United States of America, and in which there are valuable mineral deposits, was entered upon and located <sup>amended</sup> for the purpose of exploration and purchase by

*Sophie R. Lapeman, a Citizen of the United States*

the undersigned, on the *First* day of *December* 190*2*.

The length of this claim is *1500* feet, and *4* claim *135* feet, in a *North Easterly* direction, and *1365* feet in a *South Westerly* direction from the center of the discovery shaft, at which this notice is posted, lengthwise of the claim, together with

*300* feet in width of the surface grounds, on each side of the center of said claim. The general course of the lode deposit and premises is from the *North East* to the *South West*

The claim is situated and located in the *Copper Mountain* Mining District, in *Graham* County, in the Territory of Arizona, about *and adjoins the* in a *Campbell* direction from *on the North East*.

*This claim is situated on the north side of Gold Gulch; This gulch intersects the N.E. end line and the S.E. side line of said claim.*

The surface boundaries of the claim are marked upon the ground as follows: Beginning at *A Mound of Stones*

at a point in a *North Easterly* direction *135* feet from the discovery shaft (at which this notice is posted), being in the center of the *North East* end line of said claim: thence *S 29° 56' E 301.77* feet to a *4" X 4" pine post*, being the *North East* corner of said claim; thence *S 53° 51' W 1500* feet to a *4" X 4" pine post* being at the *South East* corner of said claim; thence *N 29° 56' W 301.77* feet to a *Mound of Stones* being the center of the *South West* end of said claim; thence *N 29° 56' W 301.77* feet to a *4" X 4" pine post* being at the *South West* corner of said claim; thence *N 53° 51' E 1500* feet to a *4" X 4" pine post* at the *North West* corner of said claim; thence *S 29° 56' E 301.77* feet to the place of beginning.

All done under the provisions of Chapter Six, of Title XXXII, of the Revised Statutes of the United States, and of an Act of the General Assembly of Arizona, entitled "An Act to Codify and Revise the Laws of the Territory of Arizona," approved March 16th, 1901.

This is an Amended Location Notice of the *Stevens* Mining Claim, located by *Richard Lapeman* a Citizen of the United States on the *18<sup>th</sup>* day of *November 1897*, and recorded in book *9* of Records of Mines, at page *343*, in the office of the County Recorder of the aforesaid County of *Graham* to which reference is hereby made, and this Amended Location Notice is made and posted to correct errors in the description in the said original Location Notice.

Dated and posted on the ground this *First* day of *December* 190*2*

witness

*S. H. Mines*

*Sophie R. Lapeman*



TERRITORY OF ARIZONA,

ss.

County of .....

County Recorder in and for the County and

Territory aforesaid, do hereby certify that the within instrument was filed for record at .....

o'clock ..... M., on this ..... day of ..... 190....., and

duly recorded in Book No ..... of ..... Records of .....

County, Arizona, at pages .....

Witness my hand and seal the day and year first above written

County Recorder

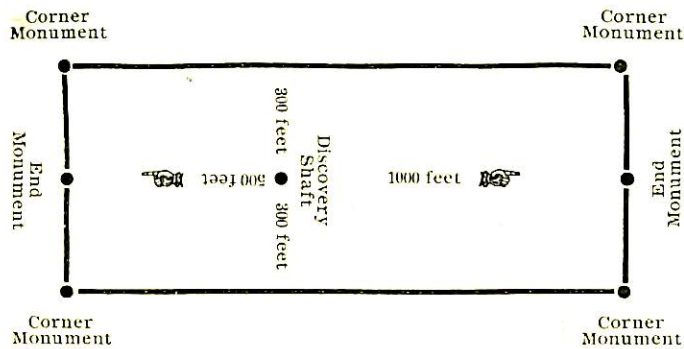

The above diagram is to give the locator a general idea of the plan of location under the new law. Your discovery shaft may be in the center of claim, or any distance from either end you desire. In the diagram we have placed it 500 feet from one end and 1000 feet from the other. In description be careful to state locality of claim with reference to some natural object, or permanent monument, so as to identify the claim.

41909

AMENDED

# Notice of Location

LODE CLAIM

*Stevens*  
*Copied Mt. Diet*

*Joseph P. Saberman*

Dated *December 1* 190*2*

Filed and recorded at request of

*Richard Saberman*

*December 18<sup>th</sup>* A. D. 190*2*

at *9 o'clock* A. M.

Book *16* Record of Mines

Pages *22-23*

*Thomas Smith*

County Recorder.

By *J. D. Clifton*  
Deputy Recorder.



TO ALL WHOM THESE PRESENTS MAY CONCERN:

Know ye that I, Sophie R. Lakenan of the City of New York, County of New York, State of New York do hereby declare and publish as a legal notice to all the world that I have a valid right to the possession, occupation and enjoyment of all and singular that tract or parcel of land, not exceeding five acres, situate, lying and being in the Copper Mountain Mining District, in the County of Graham, Territory of Arizona, bounded and described as follows, to wit:

The Lakenan Mill-Site, beginning at Corner No. One, a monument of stone about one mile in a Westerly direction from Eagle River, opposite the mouth of Gold Gulch; Thence South 466.7 feet to the Southeast corner; thence West 466.7 feet to the Southwest corner; thence North 466.7 feet to the Northwest corner; thence East 466.7 feet to the place of beginning.

This mill-site is located in connection with the Lakenan Group of mines in said Copper Mountain Mining District and is intended as a mill-site for use in working and developing said mines.

This is intended as an amended location notice of the Lakenan mill-site, located November 17, 1894, by R. Lakenan and amended January 1, 1903, by Richard Lakenan, the original notice of said location being Recorded in Book one Records of Mill-Sites, Records of Graham County, Arizona, at page 115 and said amended location being recorded at pages 126 and 127 of said Book one Record of Mill-sites.

Dated and posted on the ground this

28th day of January, 1903. Sophie R. Lakenan,

By her Attorney-in-Fact,

*John R. Hampton*



4780

Mill site Notice  
Amended Notice  
of Lakeraw Millsite  
Leopfer Mountain  
Jan'y 28<sup>th</sup> 1903

5  
2  
7  
2  
2

1  
2  
3  
4  
5  
6  
7  
8  
9  
10  
11  
12  
13  
14  
15  
16  
17  
18  
19  
20  
21  
22  
23  
24  
25  
26  
27  
28  
29  
30  
31  
32  
33  
34  
35  
36  
37  
38  
39  
40  
41  
42  
43  
44  
45  
46  
47  
48  
49  
50  
51  
52  
53  
54  
55  
56  
57  
58  
59  
60  
61  
62  
63  
64  
65  
66  
67  
68  
69  
70  
71  
72  
73  
74  
75  
76  
77  
78  
79  
80  
81  
82  
83  
84  
85  
86  
87  
88  
89  
90  
91  
92  
93  
94  
95  
96  
97  
98  
99  
100

Recorder's Office,  
GRAHAM COUNTY, ARIZONA. }  
Filed for record the 4<sup>th</sup> day of  
Feb 1903 at 9 o'clock A.M.  
and recorded in Book One  
Millsites on page  
179 at the request of J.A. Hempton  
mit. Lemmon  
COUNTY RECORDER.



4-687.

SURVEYOR-GENERAL'S CERTIFICATE OF APPROVAL OF FIELD NOTES AND SURVEY OF MINING CLAIM.

Department of the Interior.

Office of U. S. Surveyor-General,

Phoenix, Ariz.

July 20<sup>th</sup>, 1903

I, U. S. Surveyor-General for the district of Arizona

do hereby certify that the foregoing and hereto attached Field Notes and Return of the Survey of the

Mining Claim of Sophie R. Lakenan,

Natie L. Minnie L. Pine Tree, Globe, Pinar, Ponto, Campbell, Stevens & Lakenan Millsite, known as the

situate in Copper Mountain mining district,

Graham County, Arizona

in Section ; Township No. , Range No.

designated as Survey No. 1764 A & B.

executed by A. M. Whitaker, U. S. Deputy Mineral

Surveyor, March 20<sup>th</sup>, 1903, under my instructions dated

Feb 21<sup>st</sup>, 1903, have been critically examined and the necessary cor-

rections and explanations made, and the said Field Notes and Return, and the Survey they describe, are hereby approved. A true copy of the copy of the location certificate filed by the applicant. for survey is included in the field notes.

Hugh H. Price

U. S. Surveyor-General for Arizona