

MS
.

0

1

8

7

6

71
Copied 1/17/11
FEB 24 1904
C. Manning
L. E. J.

(4-683.)

Mineral Survey No. 1876

Lot No. _____

Gila Land District.

FIELD NOTES

OF THE SURVEY OF THE MINING CLAIM OF

Desert Queen Gold Co.

KNOWN AS THE

Desert Queen No. 1, 2, 3, 4, 5, 6, 7, 8, 9, 10 and 11

BLONDIE Mining District,

YUMA County, ARIZONA

Section _____, Township 37, Range 7

Surveyed under instructions dated November 11, 1902;

by Frank B. Jacobs,
U. S. Deputy Mineral Surveyor.

Claim located See location notes, 1

Survey commenced December 1, 1902, 1

Survey completed December 5, 1902, 1

o 6-180

Address of Claimant: John J. Wyatt.

Gen'l. Manager, Desert Queen Gold Co.

Quartzsite, Yuma Co., Arizona.

PRELIMINARY OATHS OF ASSISTANTS IN SURVEY OF MINING CLAIM.

WE, Alfred E. Anderson and Louis Anderson do solemnly swear that we will well and faithfully execute the duties of chain carriers; that we will level the chain upon even and uneven ground and plumb the tally-pins, either by sticking or dropping the same; that we will report the true distance to all notable objects, and the true length of all lines that we assist in measuring, to the best of our skill and ability, and in accordance with instructions given us, in the survey of the Mining Claim of Desert Queen Gold lco. known as the Copper Bottom nos. 1, 2, 3, 4, 5, 6, 7, 8, 9, 10 and 11 situate in Plomosa Mining mining district Yuma County, Arizona in Section, Township No., Range No.

Alfred E. Anderson, Chairman. Louis Anderson, Chairman.

Subscribed and sworn to by the above-named persons before me this 1 day of December, 1903

Francis B. Jacobs my commissioner & Notary Public march 2, 1904

I, Louis Anderson, do solemnly swear that I will well and truly perform the duties of axman, in the establishment of corners and other duties, according to instructions given me and to the best of my skill and ability, in the survey of the Mining Claim of Desert Queen Gold lco.

known as the Copper Bottom nos. 1, 2, 3, 4, 5, 6, 7, 8, 9, 10 and 11 more fully described in the preceding affidavit.

Louis Anderson, Axman.

Subscribed and sworn to by the said Louis Anderson before me this 1 day of December, 1903

Francis B. Jacobs my commissioner & Notary Public march 2, 1904

I, Alfred E. Anderson, do solemnly swear that I will well and truly perform the duties of flagman, in the establishment of corners and other duties, according to instructions given me and to the best of my skill and ability, in the survey of the Mining Claim of Desert Queen Gold lco.

known as the Copper Bottom nos. 1, 2, 3, 4, 5, 6, 7, 8, 9, 10 and 11 more fully described in the preceding affidavit.

Alfred E. Anderson, Flagman.

Subscribed and sworn to by the said Alfred E. Anderson before me this 1 day of December, 1903

Francis B. Jacobs my commissioner & Notary Public march 2, 1904

SURVEY No. 1876.Copper Bottom No. 1 Lode.

December 1, 1903; I set off $21^{\circ}42'$ S. on the decl. arc; at the camp at the West end of the groupe, at 12h, M.l,m,t, observe the sun on the meridan; the resulting lat. is $33^{\circ}35'$

Beginning at Cor. No. 1.

Identical with Cor. No.1 of the location.

A quartz stone $30 \times 14 \times 8$ ins. set 12 ins. in the ground, with mound of stone, chiseled 1-1876 whence U. S. Location Monument No.1876 bears S. $15^{\circ}35'$ W. 103 ft.

No other bearings available.

December 1, at 1h, Om,p,m,l,m,t; I set off $21^{\circ}42'$ S. on the decl. arc; $33^{\circ}35'$ N. on the lat arc and determine a true meridan with the solar, and run

Thence S. 61° W.

Ascend.

110

Sharpe ridge, bears North and South.

Descend

385

Trail bears N. E. and S. W.

1500

To Cor. No.2

Identical with Cor. No.2 of the location and intersection of the East side line of Ruthane claim, unsurveyed, C. D. Chamberlin claimant.

A quartz stone $20 \times 10 \times 7$ ins. set 12 ins. in the ground chiseled 2-1876 whence the N. E. Cor. of the Ruthane claim bears N. 42° W. 415 ft.

No other bearings available.

Thence S. $2^{\circ}45'$ E.

300

End center location monument

600

To Cor. No. 3.

Identical with a cor. of the location.

A schist stone $18 \times 12 \times 5$ ins. set 12 ins. in the ground chiseled 3-1876. With mound of stone

No bearings available.

Thence N. 61° E.

250

Ascend steep mountain.

389.5

Intersect N. E. side line Ruthane claim (unsurveyed) at N. 42° W. 88 ft. from the S.E. cor and

967.2 ft from N. E. Cor. of the location

1500

To Cor. No.4.

Identical with a cor. of the location.

A cross at Cor. point, and 4-1876 chiseled on a schist rock in place, $24 \times 15 \times 12$ ins above ground. with mound of stone. No bearings available.

Thence N. $2^{\circ}45'$ W.

265

Ascend.

Ridge bears S. E. and N. W.

300
600

Descend.
End center location Monument.
To Cor. No. 1, the place of beginning.

C O P P E R B O T T O M No. 2, Lode.

Beginning at Cor. No.1.
Identical with the N. W. Cor. of location, and
Cor No.1 Copper Bottom No.1 lode this survey. I
chisel 1-1876 on S. E. face of stone already
set. whence
U. S. Location Monument No. 1876 bears S. 15 35' ✓
W. 103 Ft.

Thence N. 87°15' E.

73
1500

Descend steep mountain.
Trail bears S. E. and N. W.
To Cor. No. 2.
Identical with the N. E. Cor. of the location.
A Schist stone 20x12x8 ins. set 12 ins. in the
ground with mound of stone, chiseled 2-1876, whence
A Paloverde 8 ins. in diam. bears S. 87 1/2°
W. 30 ft. marked 2-1876 B. T.
A Paloverde 6 ins. in diam. bears S. 7°20'
W. 106 ft. marked 2-1876 B. T.

Thence S. 2°45' E.

225
300
600

Ascend.
Trail bears E. and W.
End center location Monument.
To Cor. No. 3.
Identical with the S. E. Cor. of the loc-
ation.
A cross at Cor. point and mound of stone,
chiseld 3-1876 on Quartz reef in place 15 ft.
high facing N. bears E. and W. No bearings
available.

Thence S. 87°15' W.

1240
1500

Ascend.
High ridge bears S. E. and N. W.
Descend.
To Cor. No.4.
Identical with the S. W. Cor. of the location
and Cor. No.4 ~~S. W. Cor.~~ No. 1 lode this survey. I
chisel 4-1876 on N. E. of the cross on rock in
place.

Thence N. 2°45' W.

300
600

End center Location Monument.
To Cor. No. 1, the place of beginning.

C O P P E R B O T T O M No.3 Lode.

Beginning at Cor. No. 1.
Identical with the S. W. Cor of the location and
Cor. No. 3 Copper Bottom No. 2 lode this
survey.
I chisel 1-1876 on the rock in place N. E.
of cross.
Whence

U. S. Location Monument No. 1876 bears N. 74°
 $36'$ W. 1612.6 ft.

Thence N. $2^{\circ}45'$ W.

300 End center location Monument.
 600 To Cor. No. 2.
 Identical with the N. W. Cor. of the location
 and Cor. No. 2 Copper Bottom No. 2 lode this sur-
 vey.
 I chisel-2-1876 on the S. E. face of the stone
 already set.

Thence N. $87^{\circ}15'$ E.

Descend.
 1405 Gulch 20 ft. wide course S. 70° E.
 1415 Trail bears N. E. and S. W.
 1500 To Cor. No. 3
 Identical with the N. E. Cor. of the loc-
 ation.
 A schist stone 18x12x7 ins. set 13 ins. in the
 ground with mound of stone, chiseled 3-1876,
 whence.
 A Paloverde 6 ins. in diam. bears S. $79\frac{1}{4}^{\circ}$
 W. 47 ft. marked 3-1876 B. T.

Thence S. $2^{\circ}45'$ E.

35 Gulch 20 ft. wide course N. 80° E
 45 Ascend.
 300 End center location monument.
 600 To Cor. No. 4.
 Identical with the S. E. Cor. of the loc-
 ation.
 A Schist stone 18x10x5 ins. set 12 ins. in the
 ground. with mound of stone, chiseled 4-1876.
 No bearings available.

Thence S. $87^{\circ}15'$ W.

Ascend.
 1500 To Cor. No. 1 the place of beginning.

C O P P E R B O T T O M No. 4 Lode.

Beginning at Cor. No. 1.
 Identical with the S. W. Cor of the location
 and Cor. 4 Copper Bottom No. 3 lode of this
 survey, whence
 U. S. Location Monument No. 1876 bears N. $83^{\circ}21'$
 W. 3073.3.
 No other bearings available.

Thence N. $2^{\circ}45'$ W.

300 End center location monument.
 600 To Cor. No. 2.
 Identical with Cor. of the location, and
 Cor. No. 3 Copper Bottom. No 3 lode this
 survey.
 I chisel 2-1876 on S. E. face of the
 stone already set.

Thence N. 87°15' E.670
1500Gulch 25 ft. wide course N. 80 E.
To Cor. No. 3.

Identical with the N. E. Cor. of the location.
 A Schist 18x12x5 ins. set 12 ins. in the
 ground, chiseled 3-1876, whence
 A Paloverde 5 ins. in diam. bears S. 84 1/4°
 E. 14.5 ft. marked 3-1876 B. T.
 A Paloverde 8 ins. in diam. bears N. 69 1/2°
 W. 107 ft. marked 3-1876 B. T.

Thence S. 2°45' E.50
300
600Ascend steep mountain.
End center location monument.
To Cor. No. 4.

Identical with the S. E. Cor. of the loc-
 ation.
 A Schist stone 18x10x8 ins. set 12 ins. in
 the ground with mound of stone, chiseled 4-1876.
 No bearings available.

Thence S. 87°15' W.

1500

Along North slope of ridge.
To Cor. No. 1. the place of beginning.C O P P E R B O T T O M No. 5 Lode.

Beginning at Cor. No. 1.
 Identical with the N. W. Cor. of the location
 and Cor. No. 4. Copper Bottom No. 3 lode, Cor. No
 1 Copper Bottom No. 4 lode this survey.

I chisel 1, on S. E. face of the stone
 already set, whence,

U. S. Location Monument No. 1876 bears N.
 83° 27' W. 3073.3 ft.

Thence N. 87°15' E.

1500

To Cor. No. 2.
Identical with the N. W. Cor of the loc-
ation and Cor. No. 4 Copper Bottom No. 4 lode
this survey.

I chisel 2-1876 on the S. W. face of the
 stone already set.

Thence S. 2°45' E.

250

Ascend very steep ridge.
Ridge bears E. and W.

300

Descend very abruptly.
End center location monument.

600

To Cor. No. 3.

Identical with the S. E. Cor. of the
 location.

A Schist stone 24x10x6 ins. set 12 ins.
 in the ground with mound of stone, chiseled 3-1876.
 No bearings available.

Thence S. 87°15' W.

820

Ascend.
Ridge bears N. E. and S. W.
Descend.

1500

To Cor. No. 4.

Identical with the S. W. Cor. of the loc-
 ation.

A Schist stone 24x8x5 ins. set 12 ins. in the
 ground with mound of stone, chiseled 4-1876.
 No bearings available.

Thence N. 2°45' W.

300
600

Descend.

End center Location Monument.
To Cor. No.1 and place of beginning.

C O P P E R B O T T O M No. 6, Lode.

Beginning at Cor. No. 1.
Identical with the N. E. Cor. of the location
and Cor. No. 4 Copper Bottom No. 1 lode and
Copper Bottom No. 2 lode, this survey.

I chisel 1-1876 of rock S. W. of cross
, whence,

U. S. Location Monument No. 1876 bears N.
6°26' W. 503.3ft.

December 4, at 8h.20m A. M. l,m,t, I set
off 33°35' N. on the lat. arc; 22°5' S. on the
decl. arc, and determine a true meridian with
the solar, and run from Cor. No.1.

Thence S. 61° W.

1110.5

Descend.

To Cor. No.2.

Identical with the N. W. Cor. of the loc-
ation and the intersection of the N. E. side line
Ruthane claim. (unsurveyed)

A Slate stone 18x14x4 ins. set 12 ins. in
the ground, chiseled 2-1876, whence

A Paloverde 6 ins. in diam. bears S. 22°W.
34 ft. marked 2-1876 B. T.

The S. E. Cor. of the Ruthane claim bears
S. 42°E. 88ft.

Thence S. 42° E.

300
600

Along west slope of mountain.

End center Location Monument.

To Cor. No. 3.

Identical with the S. W. Cor. of the loc-
ation and on the N. E. side line of the White
Cross Lode(unsurveyed) C. D. Chamberlin
claimant..

A cross at corner point, and 3-1876 chiseled
on a slate rock in place 14x14x12 ins. above
ground. whence, The N. E. Cor of the White Cross
Lode bears N. 42°W. 512 ft. No other bearings
available.

Thence N. 61° E.

1110.5

Ascend.

To. Cor. No. 4.

Identical with the S. E. Cor. of the loc-
ation.

A cross at corner point and 4-1876 chiseled
on face of bluff, 20 ft high, near base with
mound of stone at base of bluff on west of Cor.

No bearings available.

Thence N. 42°W.

Ascend.
 285 Rock Reef bears N. E. and S. W.
 Descend.
 300 End center Location Monument.
 600 To Cor. No. 1, and place of beginning.

C O P P E R B O T T O M No. 7 Lode.

Beginning at Cor. No. 1.
 Identical with the N. W. Cor. of the location
 and Cor. No. 1 Copper Bottom. No. 6 lode Cor. No.
 4 Copper Bottom No. 1, and Copper Bottom No. 2
 lodes. I chisel 1 on S. E. of cross on rock.
 U. S. Location Monument No. 1876 bears N. 6°26'
 W. 503.3 ft.

Thence N. 87°15' E.

1500 To Cor. No. 2.
 Identical with the N. E. Cor. of the location
 and Cor. No. 3 Copper Bottom No. 2 lode Cor.
 No. 1 Copper Bottom No. 3 lode this survey.
 I chisel 2, S. W. of cross on rock in place.

Thence S. 2°45' E.

Ascend very steep mountain.
 300 End center Location Monument.
 600 To Cor. No. 3.
 Identical with the S. E. Cor. of the location.
 A cross at corner point, and 3-1876 chi s-
 eled on a Quartz rock in place 18x24x10 ins.
 above ground, with mound of stone.
 No bearings available.

Thence S. 87°15' W.

Ascend.
 150 Ridge bears S. E. and N. W.
 1395 Intersect line 3-4 Copper Bottom No. 6 lode, this
 survey, at S. 61°W. 306.2 ft. from Cor. No. 4.
 1500 To Cor. No. 4.
 Identical with the S. W. Cor. of the loc-
 ation.
 A Schist stone 20x12x7 ins. set 12 ins. in
 the ground, with mound of stone, chiseled 4-1876.
 No bearings available.

Thence N. 2°45' W.

300 End center Location Monument.
 600 To Cor. No. 1, the place of beginning.

C O P P E R B O T T O M No. 8, Lode.

Beginning at Cor. No. 1
 Identical with the N. W. Cor. of the location
 and Cor. No. 3 Lode No. 2- Cor. No. 1, Lode No. 3
 and Cor. No. 2, Lode No. 1 this survey.
 I chisel 1, S. E. of the cross on the rock
 in place. whence
 U. S. Location Monument No. 1876 bears N. 74°
 36' W. 1612.6 ft.

Thence N. 87°15' E.

1500

To Cor. No. 2.

Identical with the N. E. Cor. of the location, and Cor. No. 4 Copper Bottom No. 3 lode Cor. No. 1 Copper Bottom No. 4 lode and Copper Bottom No. 5 lodes, this survey.

I chisel 2 on the S. W. face of the stone already set.

300

600

Thence S. 2°45' E.

End center Location Monument.

To Cor. No. 3.

Identical with the S. E. Cor. of the location and Cor. No. 4 Copper Bottom No. 5 lode, this survey.

I chisel 3 on the N. W. face of the stone already set.

1500

Thence S. 87°15' W.

Ascend along North slope of ridge near top.

To Cor. No. 4.

Identical with the S. W. Cor. of the location, and Cor. No. 3 Copper Bottom No. 7 lode, this survey.

I chisel 4, N. E. of cross on rock in place.

300

600

Thence N. 2°45' W.

End center location Monument.

To Cor. No. 1 the place of beginning.

C O P P E R B O T T O M No. 9, Lode.

Beginning at Cor. No. 1.

Identical with the S. E. Cor. of the location, and Cor. No. 1 Copper Bottom No. 1 and Copper Bottom No. 2 lodes, whence, U. S. Location Monument No. 1876 bears S. 15° 35' W. 103 ft.

Thence S. 61° W.

1500

To Cor. No. 2.

Identical with the S. W. Cor. of the location and Cor. No. 2 Copper Bottom No. 1 lode, this survey.

I chisel 2 on the N. E. face of the stone already set.

300

450

415

600

Thence N. 42° W.

End center location monument.

Summit Cunningham Pass.

N. E. Cor. of the Ruthane Lode, (unsurveyed.)

To Cor. No. 3.

Identical with the N. W. Cor. of the location.

A cross at the corner point, and 3-1876 chiseled on a schist rock in place 12x10x8 ins. above ground, with mound of stone. No bearings available.

Thence N. 61° E.

150

1500

Ascend very steep mountain.

To Cor. No. 4.

Identical with the N. E. Cor. of the location.
A Schist 24x16x6 ins. 12 ins. in the ground,
with mound of stone, chiseled 4-1876.
No bearings available.

Thence S. 42° E.

300
600

Ascend a very steep mountain.
End center Location Monument.
To Cor. No. 1, the place of beginning.

C O P P E R B O T T O M No. 10, Lode.

Beginning at Cor. No. 1.
Identical with the S. E. Cor. of the location.
A Schist stone 20x 10x5 ins. set 12 ins. in
the ground, with mound of stone, chiseled 1-1876
whence, U. S. Location Monument No. 1876 bears N.
84° 56' E. 1344.3 ft. No other bearings avail-
able.

Thence N. 55° W.

125.5
350
1500

Descend.
Intersect line 3-4 Copper Bottom No. 9, this
survey at N. 61° E. 279 ft. from Cor. No. 3.
Foot of mountain bears N. E. and S. W.
To Cor. No. 2

Identical with the N. E. Cor. of the loc-
ation.

A Schist stone 18x10x6 ins. set 12 ins. in
the ground, chiseled 2-1876, whence

An Ironwood 6 ins. in diam. bears S. 59 1/2°
E. 22ft. marked 2-1876 B. T.

Thence S. 48° W.

240
275
300
600

Descend.
Gulch 30 ft. wide course N. W.
End center Location Monument.
To Cor. No. 3.

Identical with the N. W. Cor. of the loc-
ation.

A cyanite stone 18x8x5 ins. set 12 ins. in the
ground chiseled 3-1876, whence

An Ironwood 6 ins. in diam. bears S. 34° 45' E. 30
ft. chiseled 3-1876 B. T.

Thence S. 55° E.

450
1100
1500

Ascend steep mountain.
Descend.
To Cor. No. 4

Identical with the S. W. Cor. of the loc-
ation, and the N. W. End center of the Ruthane lode
unsurveyed.

A Schist stone 18x10x6 ins. set 12 ins.
in the ground chiseled 4-1876, with mound of stone.
No bearing available.

Thence N. 48° E.

300

To end center Location Monument, which is also
the N. E. Cor. of the Ruthane lode unsurveyed
and intersection line 2-3 Copper Bottom No. 9
lode, this survey at S. 42° E. 185 ft. from Cor.
No 3.

600 To Cor. No. 1, the place of beginning.

C O P P E R B O T T O M No. 11 lode.

Beginning at Cor. No. 1.
Identical with the N. W. Cor. of the location.
A Schist stone 24x12x8 ins. set 12 ins. in
the ground with mound of stone, chiseled 1-1876
whence United States Location Monument No. 1876,
bears N. 11°20' E. 994.9ft.
No other bearings available.

Thence S. 58°E.

332.57 Intersect line ^{Copper Bottom} 3-4 Lode No. 6 this survey at N. 61°
E. 686. ft. from Cor. No. 3.
1310 Gulch 12 ft. wide course N. W.
Ascend steep bluff.
1500 Ridge bears E. and W.
To Cor. No. 2.
Identical with the N. E. Cor. of the loc-
ation.
A Schist stone 18x12x5 ins. set 12 ins. in
the ground., with mound of stone, chiseled 2-1876.
No bearings available.

Thence S. 32°W.

Descend.
300 End center Location Monument.
600 To Cor. No. 3.
Identical with the S. E. Cor. of the location.
A cross at corner point and 3-1876 chiseled
on a quartz stone in place 18x24x12 ins. above
ground, with mound of stone.
No bearings available.

Thence N. 58°W.

1500 To Cor. No. 4.
Identical with the S. W. Cor. of the loc-
ation, and Cor. No. 3 Copper Bottom No. 6 lode
this survey.
I chisel 4 on the rock in place east of cross.

Thence N. 32°E.

Ascend.
300 End center Location Monument.
600 To Cor. No. 1, the place of beginning.

POOR QUALITY

The following pages are scanned at the best possible quality setting. The original pages are of poor quality and this is the best possible reproduction.

The Variation at all corners is $13^{\circ}40'E$.

The survey of all of the claims embraced in this survey are identical with the respective locations.

D O D E S .

The Copper Bottom No.1 Lode runs from the N.E.end center of the claim $S.61^{\circ} W. 1305,25$ ft. to the intersection of the N.E.side line of the Ruthane claim.

The Copper Bottom No.2 Lode runs from the N.end center $N.87^{\circ} 15' E. 1500$ ft. to the N.end center of the claim.

The Copper Bottom No.3 Lode runs from the W. end center $N.87^{\circ} 15' E. 1500$ ft. through the center of this claim thence continuing same course 1500 ft. through the center of Copper Bottom No.4 claim.

The Copper Bottom No.5 Lode runs from the E. end center $S.87^{\circ} 15' W. 1500$ ft. to the W.end center of the claim thence continuing same course 1500 ft. through the center of Copper Bottom No.3 claim, thence continuing same course $1333,75$ ft. through the center of Copper Bottom No.7 claim to the intersection of the N.E.end line of Copper Bottom No.6 claim.

Copper Bottom No.6 Lode runs from the N.W.end center $S.61^{\circ} W. 1110,5$ ft. to the S.W.end center of the claim.

Copper Bottom No.9 Lode runs from the N.E.end center of the claim $S.61^{\circ} W. 1500$ ft. to the S.E.end center of the claim.

Copper Bottom No.10 Lode runs from the S.E.end center of the claim $N.55^{\circ} W. 1500$ ft. to the N.W.end center of the claim.

Copper Bottom No. 11 Lode runs from the S.E.end center of the claim $N.58^{\circ} W. 1333,75$ ft. to the intersection of the N.E.end line, Copper Bottom No.6 lode.

A R E A .

Total area Copper Bottom No.1 lode.....	18,530 ^{ac.}
Less area in conflict with Ruthane lode, unsurveyed.....	<u>2,406["]</u>
Net area Copper Bottom No.1 lode.....	16,124 ["]
Total and Net area Copper Bottom No.2 lode	20,661 ["]
Total and Net area Copper Bottom No.3 lode	20,661 ["]
Total and Net area Copper Bottom No.4 lode	20,661 ["]
Total and Net area Copper Bottom No.5 lode	20,661 ["]
Total and Net area Copper Bottom No.6 lode	14,904 ["]
Total area Copper Bottom No.7 lode	20,661
Less area in conflict with Copper Bottom No.6 lode, this survey.....	<u>3,75["]</u>
Net area Copper Bottom No.7 lode.....	16,911 ["]
Total and net area Copper Bottom No.8 lode	20,661 ["]
Total and Net area Copper Bottom No.9 lode	20,132 ["]

Total area Copper Bottom No.10 lode	20,137	acres
Less area in conflict with Copper Bottom No.9 lode this survey	998	
Net area Copper Bottom No.10 lode	19,134	"
Total area Copper Bottom No.11 lode	20,861	"
Less area in conflict with Copper Bottom No.6 lode, this survey,.....	2,290	"
Net area Copper Bottom No.11 lode	18,571	"
Net area of claim.....	209,853	"

LOCATION.

This claim is located on unsurveyed land, in the Cholla Mountains about 8 miles West South West from Quartzsite and about the same distance East South East from Ehrenburg.

ADJOINING CLAIMS.

The adjoining claims are the "Ruthans" and "White Cross" lodes, on the west end of this group Charles D. Chamberlin, claimant.

EXPENDITURE OF FIVE HUNDRED DOLLARS.

I certify that the value of the labor and improvements upon this claim, placed thereon by the claimant and their grantors, is not less than five hundred, and that said improvements consist of:

- No.1.
The discovery tunnel of the Copper Bottom No.1 lode which bears from the center of the N.E. end line S. 31° E. 400 ft. 4 x 6 ft. 20 ft. long, also cut approach to tunnel 16 ft. wide, 20 ft. long and 12 ft. at face all in rock..... Value \$300.
- No.2.
A tunnel which bears from the center of the N.E. end line of Copper Bottom No.1 lode S. 52° W. 810 ft. 4 x 6 ft. 10 ft. long in rock..... Value \$100.
- No.3.
A shaft, which bears, from the center of the N.E. end line of Copper Bottom No.1 lode S. 62° 40' W 1200 ft. 6 x 10 ft. 35 ft. deep in rock..... Value \$525.
- No.4.
A tunnel, the portal of which bears from the center of the N.E. End line of Copper Bottom No.1 lode S. 61° 40' W. 830 ft. 5 x 7 ft. running N. 61° 37' E. 320 ft. in rock..... Value \$5120.

This tunnel is in course of construction for the development of the Copper Bottom group of claims and is being driven at the rate of 120 ft. per month.

- No.1.
The discovery cut, the face of which bears from the center of the West end line of Copper Bottom No.2 lode N. 87° 15' E. 750 ft. 5 ft. wide, 8 ft. at face running S. 10 ft. in rock..... Value \$100.
- No.2.
A shaft, which bears from the center of the West end line of Copper Bottom No.2 lode N. 85° E. 325 ft. 5 x 8 ft. 8 ft. deep in rock..... Value \$80.
- No.3.
A tunnel which bears from the center of the West end line of Copper Bottom No.2 lode N. 87° E. 1400 ft. 4 x 6 ft. running S. 10 ft. in rock.... Value \$100.

Note:-16 ft. of tunnel No.4, Copper Bottom No.1 lode is credited to Copper Bottom No.2 lode, Value \$256.

No. 1,

The discovery cut and tunnel of Copper Bottom No. 3 lode, the face of cut and mouth of tunnel which bears from Cor. No. 2 S. 70° E. 750 ft. cut 5 ft. wide 10 ft at face, running South 20 ft. Tunnel 4 x 6 ft. running S. 20 ft. all in rock..... Value \$350.

No. 2,

A cut, the face of which bears from Cor. No. 2 Copper Bottom No. 3 lode S. 38° E. 510 ft. 8 ft. wide 10 ft. at face, running S. 7° E. 12 ft. in rock. Value \$100.

No. 3,

A cut, which bears from Cor. No. 2, Copper Bottom No. 3 lode, S. 72° E. 600 ft. 8 ft. wide 8 ft. at face, running S. 10° E. 30 ft. in rock..... Value \$200.

No. 1,

The discovery shaft of Copper Bottom No. 4 lode, which bears from the center of the West end line N. 87° 15' E. 875 ft. 4 x 6 ft. 12 ft. deep in rock, Value \$120.

Note:

25 ft. of tunnel No. 4 on Copper Bottom No. 1 lode is credited to Copper Bottom No. 4 lode. Value \$400.

No. 1,

The discovery cut of Copper Bottom No. 5 lode, the face of which bears from the center of the West end line, N. 37° 15' E. 260 ft. 8 ft. wide, 8 ft. face running N. 37° E. 15 ft. in rock..... Value \$100.

Note: 27 ft. of the tunnel No. 4, Copper Bottom No. 1 lode is credited to Copper Bottom No. 5 lode Value \$180.

No. 1,

The discovery cut of Copper Bottom No. 6 lode, which bears from the center of the West end line, N. 61° E. 500 ft. 5 ft. wide 10 ft. face, running N. 37° 15' E. 12 ft. in rock..... Value \$100.

Note: 27 ft. of tunnel No. 4, Copper Bottom No. 1 lode is credited to Copper Bottom No. 6 lode, Value \$180.

No. 1,

The discovery cut of Copper Bottom No. 7 lode, which bears from the center of the East end line S. 37° 15' W. 50 ft. 5 ft. wide 10 ft. face running S. 37° 15' W. 12 ft. Value \$100.

Note: 27 ft. of tunnel No. 4 Copper bottom No. 1 lode is credited to Copper Bottom No. 7 lode, Value \$400.

No. 1,

The discovery cut of Copper Bottom No. 8 lode, which bears from center of the West end line N. 37° 15' E. 800 ft. 8 ft. wide 10 ft. face, running N. 37° 15' E. 12 ft. in rock..... Value \$100.

Note: 27 ft. of tunnel No. 4, Copper Bottom No. 1 lode is credited to Copper Bottom No. 8 lode, Value \$432.

No. 1,

The discovery shaft of Copper Bottom No. 9 lode, which bears from the center of the E. W. end line, N. 61° E. 350 ft. 4x6 ft. 10 ft deep in rock, Value \$100.

No. 3,

A tunnel, the mouth of which bears from the center of the S. W. end line N. 63° E. 270 ft. 4x6 ft. running N. 45° 30' E. 20 ft. in rock..... Value \$300.

Note: 15 of tunnel No. 4, Copper Bottom No. 1 lode is credited to Copper Bottom No. 9 lode, value \$240.

No. 1,

The discovery cut of Copper Bottom No. 10 lode, the face of which bears from the center of the S. E. end line N. 55° W. 70 ft. 5 ft. wide 10 ft. face, running N. 70° W. 12 ft., in rock..... Value \$100.

Note: 27 ft. of the tunnel No. 4, Copper Bottom No. 1 lode is credited to Copper Bottom No. 10 lode Value \$432.

No. 1.

The discovery cut of Copper Bottom No. 11 lode, the face of which bears from the center of the N.W. end line S. 58° E. 650 ft. 5 ft. wide, 10 ft. face, running N. 53° W. 10 ft. in rock..... Value #100.

Note; 27 ft. of tunnel No. 4 Copper Bottom No. 1 lode is credited to Copper Bottom No. 11 lode, Value \$432.

The surface embraced by this claim descends very rapidly from the westerly end of the group to the West end of the Copper Bottom Nos. 2 and 7, this point being about 600 ft. higher than the mouth of tunnel No. 3, Copper Bottom No. 1 lode; then descends very rapidly to near the East end of the group. The high mountain running N.W. through lodes 9 and 10.

I N S T R U M E N T .

This survey was made with a Gurley Light Mountain Transit. The courses were deflected from the true meridian as determined by direct solar observations.

The distances were measured with a 200 ft. steel tape.

Note:- The disagreements between these field notes and the location certificates of Copper Bottom Nos. 1, 2, 4, 5 and 6 lodes, with regards to the position of the discovery work and the course of the boundary lines, are due to errors in the latter.

Francis J. Jacoby
U.S. Deputy Mineral Surveyor.

Phoenix, Arizona.
February 13, 1904.

U. S. LOCATION MONUMENT? No. 1878

APR 9 - 1904

Phoenix Mining District

Yuma County,

Arizona.

Established in connection with the survey of Copper Bottom groups of lode mining claims, Survey No. 1878. Desert Queen Gold & Co. claimant, November 3, 1903.

Established on unsurveyed land, in the Cholla Mountains about 9 miles S. 60° W. from the town of Quartzsite, Yuma County, Arizona.

MONUMENT.

A Schist stone 24 X 14 X 3 ins. set 16 ins. in the ground, chiseled U. S. L. M. - 1878 and marked (+) at the center point, and I raise a post of stone 5 ft. base 4 ft. high, with post projecting 1 ft. above top, W. of stone 3 ft. dist.

BEARINGS.

A deep well being drilled by Pease Brothers, bears N. 88° E. about 3½ miles.

A very prominent Mountain Peak bears S. 88° W. about 12 miles.

Portal of main tunnel on Copper Bottom No. 1 lode of this survey, bears S. 50° 50' W.

Cumington Pass bears S. 78° 25' W. 1600 feet.

There is a large mountain to the west about two miles beyond which the Colorado River is plainly visible about 3 miles distant; at the point where the River passes behind this mountain bears N. 70° 10' W. the point where the River emerges from behind this Mountain bears N. 85° 30' W.

Francis B. Jacoby
U. S. Deputy Minister, Surveyor.

Assistants.
O. Lewis Anderson.
Alfred Anderson.

Phoenix, Arizona, April 7, 1904.

SUPPLEMENTAL REPORT OF IMPROVEMENTS.

Survey No. 1876.

Plomosa Mining District, Yuma County, Arizona.

Copper Bottom lodes Nos. 1 to 11 inc.

Desert Queen Gold Co., claimant.

I certify that the value of the labor and improvements upon this claim, placed thereon by the claimant and its grantors, exceeds the sum of five hundred dollars per lode, and that said improvements consist of:

Copper Bottom No. 1,

No. 1, the discovery tunnel, which bears from the center of the N.E. end line of Copper Bottom No. 1 lode, $S 31^{\circ} W$. 400 ft., 6 x 7 ft. running $N. 87^{\circ} E$. 115 ft.

within the tunnel there is, at 65 ft. a crosscut

running north 12 ft. thence an upraise 5 x 7 ft. 55 ft.

to the surface, at 75 ft. there is a winze 22 ft.

deep, thence a drift 18 ft. long, at 88 ft. there is

an upraise 23 ft. high, at 100 ft. there is a crosscut running $N. 18^{\circ} E$. 18 ft. Total value \$5020.00

A 1/11 interest, ^{therein} credited to this lode, \$ 456.4

No. 2, a tunnel, which bears from the center of the N.E. end line of Copper Bottom No. 1 lode, $S. 52^{\circ} W$. 810 ft. 4 x 6 ft. 10 ft. long, Value, \$100.00

No. 3, a shaft, which bears from the center of the N.E. end line of Copper Bottom No. 1 lode, $S. 62^{\circ} 40' W$. 1200 ft. 6 x 10 ft. 35 ft. deep, Value, \$525.00

No. 4, a tunnel, which bears from the center of the N.E. end line of Copper Bottom No. 1 lode, $S. 61^{\circ} 40' W$. 830 ft. 6 x 7 ft. running $N. 61^{\circ} 37' E$. 600 ft., at 585 ft. into the tunnel there is a crosscut running $S. 69^{\circ} 30' E$. 18 ft. Total value, \$12360.00

A 1/11 interest, ^{therein} credited to this lode, \$1123.6

No. 5, a tunnel, which bears from the center of the N.E. end line of Copper Bottom No. 1 lode, $S. 68^{\circ} W$. 370 ft. 6 x 7 ft. running $S. 80^{\circ} E$. 40 ft. Value, \$480.00

No. 6, a cut, which bears from the center of the N.E. end line of Copper Bottom No. 1 lode, $N. 75^{\circ} W$. 200 ft.

8 ft. wide, 15 ft. deep, running east 15 ft. Value \$100.00

No. 7, a cut, which bears from the center of the N.E. end line of Copper Bottom No.1 lode, S.65 W. 400 ft.
7 ft. wide, 30 ft. deep, running S.65°E. 40 ft.
Value, \$200.00

Copper Bottom No. 2,

No. 1, the discovery cut, which bears from the center of the west end line of Copper Bottom No.2 lode, N.87°15'E. 750 ft. 5 ft. wide, 8 ft. deep, running south 10 ft.
Value, \$100.00

No. 2, a shaft, which bears from the center of the west end line of Copper Bottom No.2 lode, N.85°E. 825 ft. 5 x 8 ft. 8 ft. deep,
Value, \$ 80.00

No. 3, a tunnel, which bears from the center of the west end line of Copper Bottom No.2 lode, N.87°E. 1400 ft. 5 x 7 ft. running south 40 ft. Value, \$600.00

A 1/11 interest in tunnels Nos. 1 and 4 on the Copper Bottom No. 1 lode credited to this lode, Value, \$1580.00

Copper Bottom No. 3

No. 1, the discovery tunnel, which bears from Cor. No.2 Copper Bottom No.3 lode, S.70°E. 720 ft. 4 x 6 ft. running south 20 ft. Value, \$350.00

No. 2, a cut, which bears from Cor. No. 2, Copper Bottom No. 3 lode, S.68°E. 510 ft. 8 ft. wide, 10 ft. deep running S.7° E. 12 ft. Value, \$100.00

No. 3, a cut, which bears from Cor. No.2, Copper Bottom No.3 lode, S.72°E. 600 ft. 8 ft. wide, 8 ft. deep, running S.10° E. 30 ft. Value, \$200.00

No. 4, a tunnel, which bears from the center of the east end line of Copper Bottom No.3 lode, S.87 W. 180 ft. 5 x 7 ft. running S.5°E. 17 ft. Value, \$204.00

A 1/11 interest in tunnels Nos. 1 and 4 on the Copper Bottom No. 1 lode credited to this lode, Value, \$1580.00

Copper Bottom no. 4

No. 1, the discovery shaft, which bears from the center of the west end line of Copper Bottom No.4 lode, N.87°15'E. 875 ft. 4 x 6 ft. 12 ft. deep,
Value, \$120.00

A 1/11 interest in tunnels Nos. 1 and 4 on the Copper Bottom No. 1 lode credited to this lode, Value, \$1580.00

Copper Bottom No. 5.

No. 1, the discovery cut, which bears from the center of the west end line of Copper Bottom No. 5 lode, N. 87° 15' E. 260 ft. 6 ft. wide, 10 ft. deep, running south 20 ft. Value, \$140.00

No. 2, a cut, which bears from the center of the west end line, of Copper Bottom No. 5 lode, N. 86° E. 1275 ft. 11 ft. wide, 20 ft. deep, running south 31 ft. Value, \$362.00

No. 3, a shaft, which bears from the west end line of the center of Copper Bottom No. 5 lode, N. 87° 15' E. 460 ft.

4 x 5 ft. 8 ft. deep, Value, \$ 40.00

Copper Bottom No. 6

A 1/11 interest in tunnels Nos. 1 and 4 on the Copper Bottom No. 1 lode credited to this lode, Value, \$1580.00

No. 1, the discovery cut, which bears from the center of the S.W. end line of Copper Bottom No. 6 lode, N. 61° E.

500 ft., 5 ft. wide, 10 ft. deep, running N. 87° 15' E. 12 ft. Value, \$100.00

No. 2, a tunnel, which bears from the center of the S.W. end line of Copper Bottom No. 6 lode, N. 29° E. 490 ft.

5 x 7 ft. running N. 30° E. 25 ft. Value, \$400.00

Copper Bottom No. 7

A 1/11 interest in tunnels Nos. 1 and 4 on the Copper Bottom No. 1 lode credited to this lode, value, \$1580.00

No. 1, the discovery cut, which bears from the center of the east end line of Copper Bottom No. 7 lode, S. 87° 15' W.

50 ft., 5 ft. wide, 10 ft. deep, running S. 87° 15' W. 10 ft. Value, \$100.00

A 1/11 interest in tunnels Nos. 1 and 4 on the Copper Bottom No. 1 lode credited to this lode, Value, \$1580.00

Copper Bottom No. 8.

No. 1, the discovery cut, which bears from the center of of Copper Bottom No. 8 lode,

the west end line N. 87° 15' E. 800 ft., 5 ft. wide, 10 ft. deep, running N. 87° 15' E. 12 ft. Value, \$100.00

A 1/11 interest in tunnels Nos. 1 and 4 on the Copper Bottom No. 1 lode credited to this lode, Value, \$1580.00

Copper Bottom No. 9.

No. 1. the discovery shaft, which bears from the center of the S.W. end line of Copper Bottom No. 9, N. 61° E. 250 ft.

4 x 6 ft. 10 ft. deep, Value \$100.00

No. 2, a tunnel, which bears from the center of the S.W. end line of Copper Bottom No.9 lode, N.68°E. 270 ft.

4 x 6 ft. running N.46°30' E. 20 ft. Value, \$200.00

No. 3, a tunnel, which bears from the center of the S.W. end line, of Copper Bottom No.9 lode, N.61°E. 290 ft.

5 x 7 ft. running N.61°E. 24 ft. Value, \$288.00

A 1/11 interest in tunnels Nos. 1 and 4 on the Copper Bottom No. 1 lode credited to this lode, Value, \$1580.00

Copper Bottom No. 10

No. 1, the discovery cut, which bears from the center of the S.E. end line of Copper Bottom No.10 lode, N.55°W.

140 ft., 5 ft. wide, 10 ft. deep, running N.70°W. 12 ft. Value, \$100.00

No. 2, a cut, which bears from the center of the S.E. end line of Copper Bottom No. 10 lode, N.52°W. 1160 ft.

7 ft. wide, 8 ft. deep, running S.W. 12 ft. Value, \$100.00

No. 3, a tunnel, which bears from the center of the S.E. end line of Copper Bottom No.10 lode, N.72°W. 650 ft. 5 x 7 ft. running N.25°E.

28 ft. Value, \$336.00

No. 4, a cut, which bears from the center of the S.E. end line of Copper Bottom No.10 lode, N.36°W., 375 ft.

5 ft. wide, 10 ft. deep, running S.3°W. 16 ft. Value, \$128.00

A 1/11 interest in tunnels Nos. 1 and 4 on the Copper Bottom No. 1 lode credited to this lode, Value, \$1580.00

Copper Bottom No. 11

No. 1, the discovery cut, which bears from the center of the N.W. end line of Copper Bottom No.11 lode, S.58°E., 350 ft. 5 ft. wide,

10 ft. deep, running N.58°W. 10 ft. Value, \$100.00

A 1/11 interest in tunnels Nos. 1 and 4 on the Copper Bottom No. 1 lode credited to this lode, Value, \$1580.00

In addition to the improvements noted above there has been considerable work done along the ledge on Copper Bottom lodes Nos. 1,2,3,4,5,6,7,8, and 11, which cannot be classed as cuts, shafts or tunnels; at various points along the ledges named above they have blasted away the face of the cliffs or bluffs exposing the ledges and the ore, which is a material improvement to the property; I estimate the value of this work as follows:

On Copper Bottom No. 1 lode,	\$600.00
On Copper Bottom No. 2 lode,	\$275.00
On Copper Bottom No. 3 lode,	\$150.00
On Copper Bottom No. 4 lode,	\$550.00
On Copper Bottom No. 5 lode,	\$225.00
On Copper Bottom No. 6 lode,	\$275.00
On Copper Bottom No. 7 lode,	\$500.00
On Copper Bottom No. 8 lode,	\$425.00
On Copper Bottom No. 11 lode,	\$450.00

The ore body on this property is in a blanket ledge, the outcrop of which is on the precipitous bluffs on Copper Bottom lodes Nos. 1, 6 and 11 and dips east at 32° from the horizontal, the ore bodies may be reached and developed by the system of tunnels, drifts and crosscuts in course of construction, and as tunnels Nos. 1 and 4 on the Copper Bottom No. 1 lode, values \$5020 and \$12360, respectively, total value \$17380, are common improvements for the benefit and development of all the claims in this group, an undivided 1/11 interest therein, value \$1580.00, is credited to each of the eleven claims in this group.

I have examined the report, made to the Desert Queen Gold Co., claimant herein, by Mr. Frank L. Fowler, Manager of the property, dated December 28, 1908.

I quote his summary of expenses to date, as follows:

" Total Cost of development to date."

"Copper Bottom No. 1	26,817.84
" " " 2	1,290.00
" " " 3	915.00
" " " 4	575.00
" " " 5	825.00
" " " 6	750.00
" " " 7	625.00
" " " 8	550.00
" " " 9	675.00
" " " 10	535.00
" " " 11	575.00

Claims 1 to 11 inclusive	34,114.84
Roads and Trails	2,700.00
Buildings, etc.	750.00
Engineers report	1,400.00
TOTAL	<u>\$38,964.84</u>

The examination of this property preparatory to making this report, was made by me personally, with two assistants, whose affidavit is made a part of this report, on the 8, 9 and 10 days of January, 1909.

Francis P. Jacobs
U.S. Deputy Mineral Surveyor.

Subscribed and sworn to before me, a Notary Public,
this 13, day of January, A.D. 1909,

Mary A. Boyd.
My commission expires
Nov. 27th 1912.

Notary Public.

Wickenburg, Ariz. Jan. 14, 1909.

I certify that all of the labor and improvements noted in my Supplemental Report as having been performed and made upon the Copper Bottom lode mining claims Nos. 1 to 11 inclusive, Plomosa Mining District, Yuma County, Arizona, and designated as Survey No. 1876, by the Desert Queen Gold Co. and its grantors, was placed thereon prior to the expiration of the period of publication of the notice of application for patent for the said Copper Bottom lodes Nos. 1 to 11 inclusive.

And that no part of said improvements has been credited to any other claim.

Francis B. J. J. J.
U.S. Deputy Min. Surveyor.

Subscribed and sworn to before me, a Notary Public, this 14, day of January, A.D. 1909.

My commission expires *Mary A. Boyd* Notary Public.

Nov. 27th - 1912.

We *I. C. Hoover* and *L. C. Carroll* do solemnly swear that we assisted Francis B. Jacobs, U.S. Deputy Mineral Surveyor, in making his supplemental survey, and measuring the various improvements, of the Copper Bottom lode claims numbers 1, 2, 3, 4, 5, 6, 7, 8, 9, 10 and 11, Plomosa Mining District, Yuma County, Arizona; That the improvements are of the character and extent ~~of the improvements as~~ as stated in the foregoing report of the said Francis B. Jacobs, U.S. Deputy Mineral Surveyor, and the value of the said improvements exceeds the sum of twenty two thousand dollars.

Deponents further swear that we are in no way interested in said Copper Bottom lode claims Nos. 1, 2, 3, 4, 5, 6, 7, 8, 9, 10 and 11.

I. C. Hoover

L. C. Carroll

Subscribed and sworn to before me, by the above named persons this //, day of January, 1909.

Francis Jacobs

 U. S. Mineral Surveyor.

(4-691.)

Certificate of U. S. Surveyor General

AS TO

EXPENDITURES REPORTED AFTER RETURN OF SURVEY OF MINING CLAIM.

I, U. S. Surveyor General for..... District of Arizona,.....
do hereby certify that Five Hundred Dollars' worth of labor has been expended or
improvements made by claimant or.....^{or for each of} grantors, upon [^]the mining claim ^Sof
..... Desert Queen Gold Co.

.....
known as the Copper Bottom Nos. 1, 2, 3, 4, 5, 6, 7, 8, 9, 10 and 11 lodes,
situate in Plomosa mining district,
..... Yuma County, Arizona

..... in Section Approx., Township No. 3 N., Range No. 20 W., Unsur.;
that said improvements consist of 11 tunnels, 5 shafts, 14 cuts,
2 upraises, 48 ft. of crosscuts, 1 winze and 1 drift, total
value \$23,133. Tunnels Nos. 1 and 4 on the Copper Bottom No.
1 lode, total value \$17380, are common improvements for the
benefit and development of all the claims in this group, and
therefore an undivided one-eleventh interest therein, value
\$1580, is properly credited to each of the eleven claims in
this survey.

....., and that no portion of said labor or improvements has been
included in the estimate of expenditures upon any other claim. A copy of the report of
..... Francis E. Jacobs, U. S. Deputy Mineral Surveyor, dated
January 13, 1909, ~~18~~, is hereto attached.

..... Frank S. Ingalls,,
U. S. Surveyor General for Arizona.

Office of U. S. Surveyor General,
..... Phoenix, Arizona,,
..... January 15,, 1909. .

FINAL OATHS FOR SURVEYS.

LIST OF NAMES.

A list of the names of the individuals employed by Francis B Jacobs
 United States Deputy Mineral Surveyor, to assist in running, measuring, and marking the lines
 corners and boundaries described in the foregoing field notes of the survey of the mining claim
 of Desert Queen Gold Co.
 known as the Copper Bottom Nos. 1, 2, 3, 4, 5, 6, 7, 8, 9, 10 and 11
 and showing the respective capacities in which they acted.

Alfred E. Anderson, Chairman.

O. Lewis Anderson, Chainman.

O. Lewis Anderson, Azman.

Alfred E. Anderson, Flagman.

FINAL OATHS OF ASSISTANTS.

We, Alfred E. Anderson,
 and O. Lewis Anderson, do solemnly swear that we assisted Francis B
Jacobs, United States Deputy Mineral Surveyor, in marking the corners and
 surveying the boundaries of the mining claim of Desert Queen
Gold Co.

known as the Copper
Bottom Nos. 1, 2, 3, 4, 5, 6, 7, 8, 9, 10 and 11, represented
 in the foregoing field notes as having been surveyed by said deputy mineral surveyor and under
 his direction; and that said survey has been in all respects, to the best of our knowledge and
 belief, faithfully and correctly executed, and the corner and boundary monuments established
 according to law and the instructions furnished by the United States Surveyor-General for
Arizona.

Alfred E. Anderson, Chairman.

O. Lewis Anderson, Chainman.

O. Lewis Anderson, Azman.

Alfred E. Anderson, Flagman.

Subscribed and sworn to by the above-named persons before me
 this 7 day of December, 1904

Francis B Jacobs
 my Public
 my commission expires
March 2, 1904

(4-686.)

FINAL OATH OF U. S. DEPUTY MINERAL SURVEYOR

I, Francis B. Jacobs, U. S. Deputy Mineral Surveyor, do solemnly swear that, in pursuance of instructions received from the United States Surveyor General for Arizona, dated November 25, 1903, I have, in strict conformity to the laws of the United States, the official regulations and instructions thereunder, and the instructions of said Surveyor General, faithfully and correctly executed the survey of the Mining Claim of Desert Queen Gold Co, known as the Copper Bottom Nos. 1-2-3-4-5-6-7-8-9-10 and 11, situate in Plomosa Mining District, Yuma County, Arizona, in Section _____, Township No. _____, Range No. _____ and designated as Survey No. 1876, as represented in the foregoing field notes, which accurately show the boundaries of said mining claim as distinctly marked by monuments on the ground, and described in the attached copy of the location certificate, which was received by me from the Surveyor General with said instructions, and that all the corners of said survey have been established and perpetuated in strict accordance with the law, official regulations and instructions thereunder; and I do further solemnly swear that the foregoing are the true and original field notes of said survey and my report therein, and that the labor expended and improvements made upon said mining claim by claimant or its grantors are as therein fully stated, and that the character, extent, location and itemized value thereof are specified therein with particularity and full detail, and that no portion of said labor or improvements so credited to this claim has been included in the estimate of expenditures upon any other claim.

Francis B. Jacobs
U. S. Deputy Mineral Surveyor.

Subscribed and sworn to by the said Francis B. Jacobs

U. S. Deputy Mineral Surveyor, before me E. J. Deemuth

a Notary Public

this 23

day of February - 1904.

E. J. Deemuth
Notary Public

APR 9 - 1904

Affidavit of Five Hundred Dollars Improvements.

We, Grant Lewis, and W. E. Syer,

of lawful age, being first duly sworn according to law, depose and say: That we are acquainted with the Copper Bottom (Elwin) mining claims, situate in Plomosa Mining district, Yuma County, Arizona Territory, for which Desert Queen Gold lco.

has made application for survey prior to application for patent under the provisions of the Act of Congress, approved May 10, 1872; and that the labor done and improvements made thereon by the applicant and its grantors exceed Five Hundred Dollars in value, and further that we are not personally interested in said mine.

Grant Lewis
W. E. Syer

TERRITORY OF ARIZONA, }
County of Yuma } ss:

Sworn to and subscribed before me, this 8th

day of March, 1904



W. E. Scott
Notary Public.

69861500-2-03

My Commission
Expires Mar. 16th 1905.

Amendment to Notice of Mining Location

LODE CLAIM

To All Whom it May Concern: *This to amend the location notice of the mining claim, Copper Bottom Number One*
 This Mining Claim, the name of which is the *Copper Bottom Number One*
 Mining Claim, situate on lands belonging to the United States of America, and in which there are valuable mineral deposits, was entered upon and located for the purposes of exploration and purchase by *E. S. Moore and J. B. Butler, citizens of the United States and twenty one years of age,*
 (Locator must insert either "a citizen of the United States," or, "who has declared his intention to become a citizen of the United States.")
 the undersigned, on the *first* day of *January*, 190*1*.

The length of this claim is *fifteen thousand* feet,
 and *they claimed five hundred* feet,
 in a *westerly* direction and *one thousand*
 and *three hundred* feet in a *eastly* direction from
 the center of the discovery shaft, at which this notice is posted, lengthwise of the claim, together
 with *three hundred* feet in width of the surface grounds, on each
 side of the center of said claim. The general course of the lode deposit and premises is from the
west to the *East*.

The claim is situated and located in the *Plomosa* Mining District, in
Yuma County, in the Territory of Arizona, about *twelve miles*
 in a *South Westly* direction from *Tipon* now known as
Quartzite and about *fifteen miles East* of
 the *Colorado River*.

The surface boundaries of the claim are marked upon the ground as follows: Beginning at
a monument of stone

at a point in a *westerly* direction *five hundred* feet from
 the discovery shaft (at which this notice is posted), being in the center of the *west*
 end line of said claim; thence *Southly 500* feet to a *monument*
of stone, being the *Northwesterly* corner of said claim; thence
Eastly 1500 feet to a *monument of stone*, being at the
South Eastly corner of said claim; thence *Southly 500* feet
 to a *monument of stone* at the center of the *Eastly* end of said claim;
 thence *Southly 500* feet to a *monument of stone*, being at the
South easterly corner of said claim; thence *westerly 1500*
 feet to a *monument of stone* at the *Southwesterly* corner of said claim;
 thence *Northly 500* feet to the place of beginning. *the whole or part*
of said claim being forfeited claim name unknown.

All done under the provisions of Chapter Six, of Title XXXII, of the Revised Statutes of
 the United States, and of an Act of the General Assembly of Arizona, entitled "An Act to
 Revise and Codify the Laws of the Territory of Arizona," approved March 16, 1901.

Dated and posted on the ground this *18th* day of *July*, 190*1*.

Desert Queen Gold Company
 By *John J. Wyatt, Mgr.* *Grant & Co.*

Recorded at request of *Edward Boyle*
 at *1:45 P.M.*, *July 21*, 190*3*.

E. S. Cronin
 County Recorder.

By *W. J. Riley*
 Deputy.

TERRITORY OF ARIZONA,
 County of } ss

I,, County Recorder in and for the County and Territory aforesaid, do hereby certify that the within instrument was filed for record at o'clock, M., on this day of 190... and duly recorded in Book No. of Records of County, Arizona, at pages.....

WITNESS my hand and official seal the day and year first above written.

County Recorder.

Notice of Location.

LODE CLAIM.

.....

Dated 190.....

Filed and recorded at the request of

.....

..... A. D. 190.....

at M.

Book

Page

..... County Recorder.

By

..... Deputy Recorder.

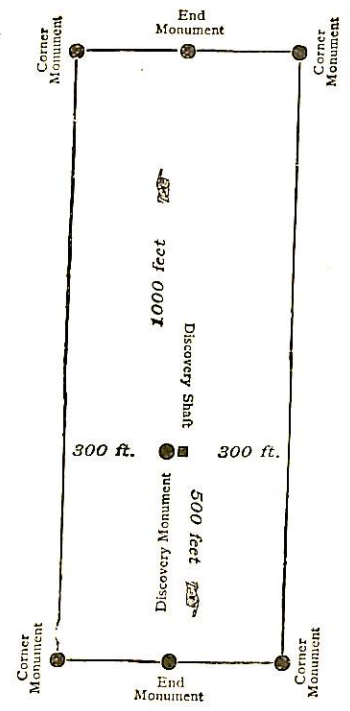

This diagram is to give locator a general idea of plan of location under the new law. The Discovery Shaft can be in the center of claim or any distance from either end desired. In the diagram it is placed 500 feet from one end and 1000 feet from the other. Commence description of claim at a center end monument, giving its distance and direction from center of Discovery Shaft; thence bound the claim in either direction. In description be careful to state locality of claim with reference to some natural object, or permanent monument, as will identify the claim.

TERRITORY OF ARIZONA, }
County of Yuma. } ss.

I, C. P. CROWN, COUNTY RECORDER in and for the County of Yuma,
Territory of Arizona, do hereby certify that the foregoing is a true, full and correct copy of
Amendment to Mining Location Notice of Copper Bottom No. One
as filed for record in my office on the 18 day of July, A. D. 1905, and as appears
of record in Book 0 of Mines, Page 611, et seq., Records
of Yuma County aforesaid.

In Witness Whereof, I have hereunto set my hand and affixed my seal
of office this 19 day of October, A. D. 1905.

C. P. Crown
County Recorder, Yuma County, Arizona Territory.



Amendment to Notice of Mining Location

LODE CLAIM

To All Whom it May Concern: *This is to amend the location notice of the*

~~This~~ Mining Claim, the name of which is the *Coffin Bottom Number Two* Mining Claim, situate on lands belonging to the United States of America, and in which there are valuable mineral deposits, was entered upon and located for the purposes of exploration and purchase by *E. S. Moore and J. B. Butler, citizens of the United States, and twenty-four years of age.*

(Locator must insert either "a citizen of the United States," or, "who has declared his intention to become a citizen of the United States.")
~~the undersigned~~, on the *first* day of *January*, 190*1*.

The length of this claim is *fifteen hundred* feet, and *they* claimed *five hundred* feet, in a *South westly* direction and *one thousand* feet in a *Northeastly* direction from the center of the discovery shaft, at which this notice is posted, lengthwise of the claim, together with *three hundred* feet in width of the surface grounds, on each side of the center of said claim. The general course of the lode deposit and premises is from the *Southwestly* to the *North Easterly*.

The claim is situated and located in the *Plomosa* Mining District, in *Yuma* County, in the Territory of *Arizona*, about *1 1/2* miles in a *Southwestly* direction from *Tipson* known known as *Quartzite* and about *fifteen* miles *East* of the *Colorado River*.

The surface boundaries of the claim are marked upon the ground as follows: Beginning at *a monument of stone*

at a point in a *Southwestly* direction *five hundred* feet from the discovery shaft (at which this notice is posted), being in the center of the *South westly* end line of said claim; thence *Southwestly 500* feet to a *monument of stone*, being the *Southwestly* corner of said claim; thence *Northeastly 1500* feet to a *monument of stone*, being at the *Northeastly* corner of said claim; thence *Northeastly 500* feet to a *monument of stone* at the center of the *Northeastly* end of said claim; thence *Northeastly 500* feet to a *monument of stone*, being at the *Southwestly* corner of said claim; thence *Southwestly 1500* feet to a *monument of stone* at the *Southwestly* corner of said claim; thence *Southwestly 500* feet to the place of beginning, *the whole or part being on forfeited claim, value unknown.*

All done under the provisions of Chapter Six, of Title XXXII, of the Revised Statutes of the United States, and of an Act of the General Assembly of Arizona, entitled "An Act to Revise and Codify the Laws of the Territory of Arizona," approved March 16, 1901.

Dated and posted on the ground this *18th* day of *July*, 190*1*.

Recorded at request of *Edward Boyle* *Desert Queen Gold Company*
at *1:45 P.M.*, *July 24*, 1903. By *John J. Wyatt, Mgr.* *Grantee.*

By *W. J. Riley, Deputy* *C. P. Gorin*
County Recorder.

TERRITORY OF ARIZONA,
County of..... } ss

I,....., County Recorder in and for the County and Territory aforesaid, do hereby certify that the within instrument was filed for record at..... o'clock,..... M., on this..... day of..... 190... and duly recorded in Book No..... of..... Records of..... County, Arizona, at pages.....

WITNESS my hand and official seal the day and year first above written.

.....
County Recorder.

Notice of Location.

LODE CLAIM.

Dated..... 190.....

Filed and recorded at the request of.....

..... A. D. 190.....

at..... M.

Book.....

Page.....

.....
County Recorder.

By.....

.....
Deputy Recorder.

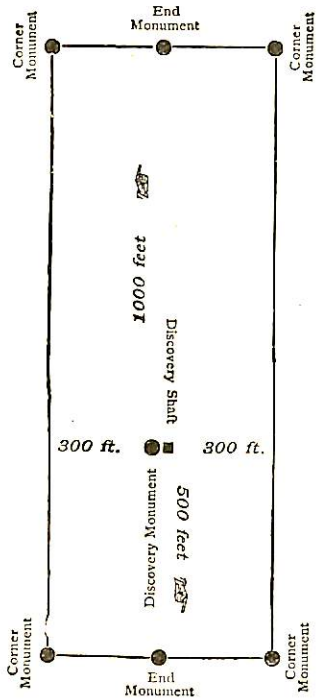

This diagram is to give locator a general idea of plan of location under the new law. The Discovery Shaft can be in the center of claim or any distance from either end desired. In the diagram it is placed 500 feet from one end and 1000 feet from the other. Commence description of claim at a center end monument, giving its distance and direction from center of Discovery Shaft; thence bound the claim in either direction. In description be careful to state locality of claim with reference to some natural object, or permanent monument, as will identify the claim.

TERRITORY OF ARIZONA, }
County of Yuma. } ss.

I, C. P. CRONIN, COUNTY RECORDER in and for the County of Yuma, Territory of Arizona, do hereby KINDLY certify that the foregoing is a true, full and correct copy of Amendment to Mining Location Notice of "Copper Bottom No. Two" as filed for record in my office on the 18 day of July, A. D. 1903, and as appears of record in Book 0 of Times July, Page 613, et seq., Records of Yuma County aforesaid.

In Witness Whereof, I have hereunto set my hand and affixed my seal of office this 19 day of October, A. D. 1903.
C. P. Cronin
County Recorder, Yuma County, Arizona Territory.



Amendment to Notice of Mining Location

LODE CLAIM

To All Whom it May Concern: *This is to amend the location notice of the* Mining Claim, the name of which is the *Copper Bottom Number Three* Mining Claim, situate on lands belonging to the United States of America, and in which there are valuable mineral deposits, was entered upon and located for the purposes of exploration and purchase by *E. P. Moore and J. B. Butler, citizens of the United States and twenty one years of age*

(Locator must insert either "a citizen of the United States," or, "who has declared his intention to become a citizen of the United States.")

the undersigned, on the *first* day of *July* 190*1*.

The length of this claim is *fifteen hundred* feet, and they claim *id five hundred* feet, in a *westerly* direction and *one thousand* feet in a *Eastely* direction from

the center of the discovery shaft, at which this notice is posted, lengthwise of the claim, together with *three hundred* feet in width of the surface grounds, on each side of the center of said claim. The general course of the lode deposit and premises is from the

westerly to the *Eastely* direction.

The claim is situated and located in the *Plomosa* Mining District, in *Yuma* County, in the Territory of Arizona, about *twelve miles* in a *Southwesterly* direction from *Tyson* known now as *Quartzite* and *fifteen miles east of the Colorado River*.

The surface boundaries of the claim are marked upon the ground as follows: Beginning at *monument of stone*

at a point in a *westerly* direction *five hundred* feet from the discovery shaft (at which this notice is posted), being in the center of the *westerly* end line of said claim; thence *Southely 500* feet to a *monument of stone*, being the *Southwesterly* corner of said claim; thence *Eastely fifteen hundred* feet to a *monument of stone*, being at the *Northwesterly* corner of said claim; thence *Southely 500* feet to a *monument of stone* at the center of the *Eastely* end of said claim; thence *Southely 500* feet to a *monument of stone*, being at the *South easterly* corner of said claim; thence *westerly 1500* feet to a *monument of stone* at the *South westerly* corner of said claim; thence *Southely 500* feet to the place of beginning *the whole or part being on forfeited claim, name unknown*.

All done under the provisions of Chapter Six, of Title XXXII, of the Revised Statutes of the United States, and of an Act of the General Assembly of Arizona, entitled "An Act to Revise and Codify the Laws of the Territory of Arizona," approved March 16, 1901.

Dated and posted on the ground this *18* day of *July* 190*1*.

Recorded at request of *Edward Boyle* *Desert Queen Gold Company, Grantee.*
By John J. Wyatt, Mgr.
July 21 1901.

W. J. Riley
 County Recorder.

TERRITORY OF ARIZONA,
 County of } ss

I,, County Recorder in and for the County and Territory aforesaid, do hereby certify that the within instrument was filed for record at o'clock, M., on this day of 190..., and duly recorded in Book No. of Records of County, Arizona, at pages

WITNESS my hand and official seal the day and year first above written.

County Recorder.

Notice of Location.

LODE CLAIM.

Dated 190.....

Filed and recorded at the request of

..... A. D. 190.....

at M.

Book

Page

County Recorder.

By

Deputy Recorder.

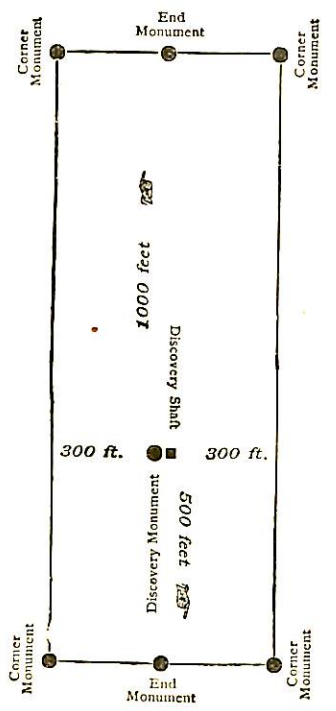

This diagram is to give locator a general idea of plan of location under the new law. The Discovery Shaft can be in the center of claim or any distance from either end desired. In the diagram it is placed 500 feet from one end and 1000 feet from the other. Commence description of claim at a center end monument, giving its distance and direction from center of Discovery Shaft; thence bound the claim in either direction. In description be careful to state locality of claim with reference to some natural object, or permanent monument, as will identify the claim.

TERRITORY OF ARIZONA, }
County of Yuma, } ss.

I, C. P. CRONIN, COUNTY RECORDER in and for the County of Yuma, Territory of Arizona, do hereby certify that the foregoing is a true, full and correct copy of Amendment to Notice of Mining Location Copper Bottom No. Three, as filed for record in my office on the 21 day of July, A. D. 1903, and as appears of record in Book 0 of Mines, Page 616, et seq., Records of Yuma County aforesaid.

In Witness Whereof, I have hereunto set my hand and affixed my seal of office this 19 day of October, A. D. 1903.

C. P. Cronin
County Recorder, Yuma County, Arizona Territory.



Notice of Mining Location

34

LODE CLAIM

To All Whom it May Concern:

This Mining Claim, the name of which is the Copper Bottom No. 4 Mining Claim, situate on lands belonging to the United States of America, and in which there are valuable mineral deposits, was entered upon and located for the purposes of exploration and purchase by J. D. Butler, a citizen of the United States,

(Locator must insert either "a citizen of the United States," or, "who has declared his intention to become a citizen of the United States") the undersigned, on the First day of January 1905.

The length of this claim is Fifteen hundred (1500) feet, and I claim Fifteen hundred (1500) feet, in a Eastward direction and _____ feet in a _____ direction from

the center of the discovery shaft, at which this notice is posted, lengthwise of the claim, together with Three hundred (300) feet in width of the surface grounds, on each side of the center of said claim. The general course of the lode deposit and premises is from the Westerly to the Eastward.

The claim is situated and located in the Plomosa Mining District, in Yuma County, in the Territory of Arizona, about 11 miles in a Southwesterly direction from Quartzite Post Office, and about 7 miles south from Choyas Placer and Bee-hive group of Patented claims.

The surface boundaries of the claim are marked upon the ground as follows: Beginning at a monument of stone, which also marks the East-centre end of Copper Bottom No. 5, and is the ~~at a point in a~~ location of my ~~direction~~ _____ feet from ~~the~~ discovery shaft (at which this notice is posted), being in the center of the westerly end line of said claim; thence 300 feet to a monument of stone, being the South west corner of said claim; thence 1500 feet to a monument of stone, being at the North east corner of said claim; thence 300 feet to a monument of stone at the center of the Eastward end of said claim; thence 300 feet to a monument of stone, being at the South east corner of said claim; thence 1500 feet to a monument of stone at the South west corner of said claim; thence 300 feet to the place of beginning.

All done under the provisions of Chapter Six, of Title XXXII, of the Revised Statutes of the United States, and of an Act of the General Assembly of Arizona, entitled "An Act to Revise and Codify the Laws of the Territory of Arizona," approved March 16, 1901.

Dated and posted on the ground this 1st day of January 1905.

Witness C. D. Chambelin

J. D. Butler

Recorded at request of John J. Wyatt March 4th 1905, at 9 A. M.
By W. J. Riley, Deputy
C. P. Cronin
County Recorder

TERRITORY OF ARIZONA,
 County of } ss

I,
 Territory aforesaid, do hereby certify that the within instrument was filed for record at o'clock, M.,
 on this day of 190..., and duly recorded in Book No.
 of Records of County, Arizona, at pages

WITNESS my hand and official seal the day and year first above written.

.....
 County Recorder.

Notice of Location
 LODE CLAIM

Dated 190.....

Filed and recorded at request of

..... 190.....

at M.

Book

Pages

County Recorder.

By
 Deputy Recorder.

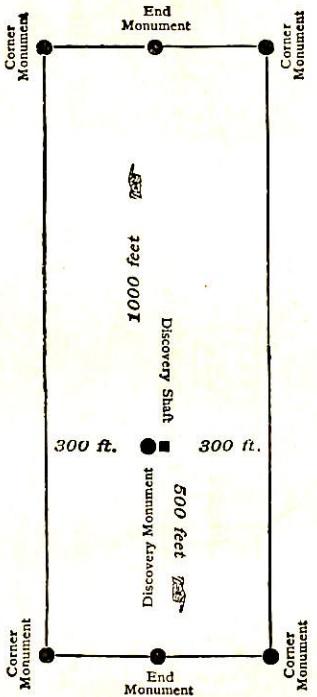

This diagram is to give locator a general idea of plan of location under the new law. The Discovery Shaft can be in the center of claim or any distance from either end desired. In the diagram it is placed 500 feet from one end and 1000 feet from the other. Commence description of claim at a center end monument, giving its distance and direction from center of Discovery Shaft; thence bound the claim in either direction. In description be careful to state locality of claim with reference to some natural object, or permanent monument, as will identify the claim

TERRITORY OF ARIZONA, }
County of Yuma. } ss.

I, C. P. CRONIN, COUNTY RECORDER in and for the County of Yuma, Territory of Arizona, do hereby certify that the foregoing is a true, full and correct copy of Mining Location Notice of Upper Bottom No. 4 as filed for record in my office on the 1st day of January, A. D. 1909, and as appears of record in Book 0 of mines, page 31, et seq., Records of Yuma County aforesaid.

In Witness Whereof, I have hereunto set my hand and affixed my seal of office this 19 day of October, A. D. 1907.

C. P. Cronin
County Recorder, Yuma County, Arizona Territory.



Notice of Mining Location

36

LODE CLAIM

To All Whom it May Concern:

This Mining Claim, the name of which is the Copper Bottom No. 5 Mining Claim, situate on lands belonging to the United States of America, and in which there are valuable mineral deposits, was entered upon and located for the purposes of exploration and purchase by J. B. Butler, a citizen of the United States

(Locator must insert either "a citizen of the United States," or, "who has declared his intention to become a citizen of the United States")
the undersigned, on the 1st day of January, 1905.

The length of this claim is Fifteen hundred (1500) feet, and 7 claim Seven hundred and fifty (750) feet, in a ----- easterly direction and Seven hundred and fifty (750) feet in a ----- westerly direction from the center of the discovery shaft, at which this notice is posted, lengthwise of the claim, together with Three hundred (300) feet in width of the surface grounds, on each side of the center of said claim. The general course of the lode deposit and premises is from the ----- Westerly to the ----- Easterly.

The claim is situated and located in the Plomosa Mining District, in Yuma County, in the Territory of Arizona, about 11 miles in a South westerly direction from Quartzsite Post Office and about 7 miles south from Choyas placers and Beehive group of Patented claims.

The surface boundaries of the claim are marked upon the ground as follows: Beginning at a monument of stone

at a point in a westerly direction 750 feet from the discovery shaft (at which this notice is posted), being in the center of the westerly end line of said claim; thence 300 feet to a monument of stone, being the South-west corner of said claim; thence 1500 feet to a monument of stone, being at the South east corner of said claim; thence 300 feet to a monument of stone at the center of the Easterly end of said claim; thence 300 feet to a monument of stone, being at the South east corner of said claim; thence 1500 feet to a monument of stone at the South west corner of said claim; thence 300 feet to the place of beginning.

All done under the provisions of Chapter Six, of Title XXXII, of the Revised Statutes of the United States, and of an Act of the General Assembly of Arizona, entitled "An Act to Revise and Codify the Laws of the Territory of Arizona," approved March 16, 1901.

Dated and posted on the ground this 1st day of January, 1905.

Witness C. D. Chambulin J. B. Butler
Quoted at request of John J. Wyatt March 4th 1903, at 9 A. M.
C. D. Gouin, County Recorder
By W. J. Riley, Deputy

TERRITORY OF ARIZONA,
 County of..... } ss

I,....., County Recorder in and for the County and Territory aforesaid, do hereby certify that the within instrument was filed for record at..... o'clock,..... M., on this..... day of..... 190..., and duly recorded in Book No..... of..... County, Arizona, at pages.....

WITNESS my hand and official seal the day and year first above written.

.....
 County Recorder.

Notice of Location
LODE CLAIM

.....

Dated..... 190.....

Filed and recorded at request of

..... 190.....

at..... M.

Book.....

Pages.....

County Recorder.

By.....

Deputy Recorder.

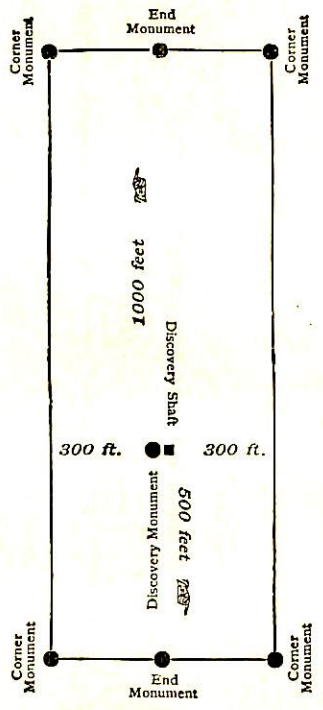

This diagram is to give locator a general idea of plan of location under the new law. The Discovery Shaft can be in the center of claim or any distance from either end desired. In the diagram it is placed 500 feet from one end and 1000 feet from the other. Commence description of claim at a center end monument, giving its distance and direction from center of Discovery Shaft; thence bound the claim in either direction. In description be careful to state locality of claim with reference to some natural object, or permanent monument, as will identify the claim

TERRITORY OF ARIZONA, } ss.
County of Yuma.

I, C. P. CROWN, COUNTY RECORDER in and for the County of Yuma, Territory of Arizona do hereby CERTIFY that the foregoing is a true, full and correct copy of Mining Location Notice of Copper Bottom No. 5 as filed for record in my office on the 1st day of January, A. D. 1903, and as appears of record in Book 0 of Mines, Page 33 et seq., Records of Yuma County aforesaid.

In Witness Whereof, I have hereunto set my hand and affixed my seal of office this 19 day of October, A. D. 1903.
C. P. Crown
County Recorder, Yuma County, Arizona Territory.



Notice of Mining Location

LODE CLAIM

To All Whom it May Concern:

This Mining Claim, the name of which is the "Copper Bottom No. 6" Mining Claim, situate on lands belonging to the United States of America, and in which there are valuable mineral deposits, was entered upon and located for the purposes of exploration and purchase by John J. Wyatt, a citizen of the United States (Locator must insert either "a citizen of the United States," or, "who has declared his intention to become a citizen of the United States") the undersigned, on the 18 day of March, 1905.

The length of this claim is 1500 feet, and 1100 claim 1100 feet, in a westerly direction and 400 feet in a easterly direction from the center of the discovery shaft, at which this notice is posted, lengthwise of the claim, together with 300 feet in width of the surface grounds, on each side of the center of said claim. The general course of the lode deposit and premises is from the East to the West.

The claim is situated and located in the Plomosa Mining District, in Yuma County, in the Territory of Arizona, about 9 in a Southwesterly direction from Quartzsite, A. T. and adjoining the Copper Bottom claims Nos. 1-2-3-4 + 5.

The surface boundaries of the claim are marked upon the ground as follows: Beginning at

at a point in a easterly direction 400 feet from the discovery shaft (at which this notice is posted), being in the center of the East end line of said claim; thence 300 feet to a monument, being the S. E. corner of said claim; thence 1500 feet to a monument, being at the N. W. corner of said claim; thence 300 feet to a monument at the center of the West end of said claim; thence 300 feet to a monument, being at the N. E. corner of said claim; thence 1500 feet to a monument at the S. W. corner of said claim; thence 300 feet to the place of beginning.

All done under the provisions of Chapter Six, of Title XXXII, of the Revised Statutes of the United States, and of an Act of the General Assembly of Arizona, entitled "An Act to Revise and Codify the Laws of the Territory of Arizona," approved March 16, 1901

Dated and posted on the ground this 18 day of March, 1905.

Recorded at request of John J. Wyatt John J. Wyatt
at 7 A. M., July 2 17 - 1908.

S. P. Gowin
County Recorder.

By W. J. Riley

TERRITORY OF ARIZONA, }
 County of } ss
 I,, County Recorder in and for the County and

Territory aforesaid, do hereby certify that the within instrument was filed for record at o'clock, M.,
 on this day of 190..., and duly recorded in Book No.
 of Records of County, Arizona, at pages

WITNESS my hand and official seal the day and year first above written.

County Recorder.

Notice of Location

LODE CLAIM

Dated 190.....

Filed and recorded at request of

..... 190.....

at M.

Book

Pages

County Recorder.

By Deputy Recorder.

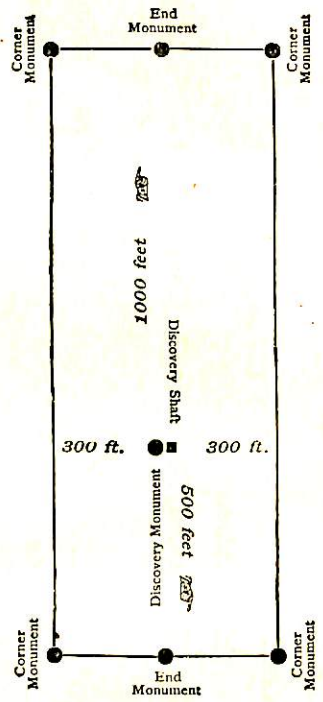

This diagram is to give locator a general idea of plan of location under the new law. The Discovery Shaft can be in the center of claim or any distance from either end desired. In the diagram it is placed 500 feet from one end and 1000 feet from the other. Commence description of claim at a center end monument, giving its distance and direction from center of Discovery Shaft; thence bound the claim in either direction. In description be careful to state locality of claim with reference to some natural object, or permanent monument, as will identify the claim.

TERRITORY OF ARIZONA, } ss.
County of Yuma.

I, C. P. CROFT, COUNTY RECORDER in and for the County of Yuma, Territory of Arizona, do hereby certify that the foregoing is a true, full and correct copy of Running Location Notice of "Copper Bottom No. 6" as filed for record in my office on the 18th day of March, A. D. 1903, and as appears of record in Book 0 of Nines, Page 476, et seq., Records of Yuma County aforesaid.

In Witness Whereof, I have hereunto set my hand and affixed my seal of office this 19 day of October A. D. 1903.

C. P. Croft
County Recorder, Yuma County, Arizona Territory.



TERRITORY OF ARIZONA, }
COUNTY OF YUMA. } SS.

40

I, ~~W. E. Marvin~~, County Recorder in and for said county, do hereby certify that I have compared the within and foregoing instrument, and the same is a full, true and correct copy of buffer Bottom No. 7. Mining
claim
as the same appears of record in Book C. of Mines
page _____ et seq. _____
in records of Yuma County, Arizona.

In witness whereof I have hereunto set my hand and affixed my official seal this 9th day of November 1903.

C. F. Cronin
County Recorder.
By C. F. Bondesson, Deputy

Notice of Mining Location

41

LODE CLAIM

To All Whom it May Concern:

This Mining Claim, the name of which is the Copper Bottom No. 7 Mining Claim, situate on lands belonging to the United States of America, and in which there are valuable mineral deposits, was entered upon and located for the purposes of exploration and purchase by Desert Queen Gold Co.

(Locator must insert either "a citizen of the United States," or, "who has declared his intention to become a citizen of the United States.")

the undersigned, on the 22 day of October 1903

The length of this claim is 1500 feet, and it claim 50 feet,

in a n easterly direction and

1450 feet in a Westerly direction from the center of the discovery shaft, at which this notice is posted, lengthwise of the claim, together with 300 feet in width of the surface grounds, on each

side of the center of said claim. The general course of the lode deposit and premises is from the East to the West

The claim is situated and located in the Plomosa Mining District, in Yuma County, in the Territory of Arizona, about 11 miles in a Southwest direction from Quartzsite Postoffice and 3 miles South from the Chollos Haens and Beehive groups of patented claims

The surface boundaries of the claim are marked upon the ground as follows: Beginning at a Monument of stone

at a point in an easterly direction 50 feet from the discovery shaft (at which this notice is posted), being in the center of the easterly end line of said claim; thence N 2° 45' W 300 feet to a Monument of stone, being the N.E. corner of said claim; thence N 87° 15' W 1500 feet to a Monument of stone, being at the N.W. corner of said claim; thence S 2° 45' E 300 feet to a Monument of stone at the center of the Westerly end of said claim; thence same course 300 feet to a Monument of stone, being at the S.W. corner of said claim; thence N. 87° 15' E 1500 feet to a Monument of stone at the S.E. corner of said claim; thence N 2° 45' W 300 feet to the place of beginning.

All done under the provisions of Chapter Six, of Title XXXII, of the Revised Statutes of the United States, and of an Act of the General Assembly of Arizona, entitled "An Act to Revise and Codify the Laws of the Territory of Arizona," approved March 16, 1901.

Dated and posted on the ground this 22 day of October 1903

Desert Queen Gold Co.
By John J. Hyatt
Manager

TERRITORY OF ARIZONA,
County of..... } ss

I,....., County Recorder in and for the County and Territory aforesaid, do hereby certify that the within instrument was filed for record at..... o'clock..... M., on this..... day of..... 190..., and duly recorded in Book No..... of..... Records of..... County, Arizona, at pages.....

WITNESS my hand and official seal the day and year first above written.

County Recorder.

Notice of Location.

LODE CLAIM.

"Certified Copy"
"Copper Bottom"
No 7.

Dated..... 190.....

Filed and recorded at the request of

John J. Hyatt

No. 9 A. D. 190...*3*

at..... *9-a* - M.

Book.....

Page.....
C. P. Brown
County Recorder.

By *C. P. Bonderson*
Deputy Recorder.

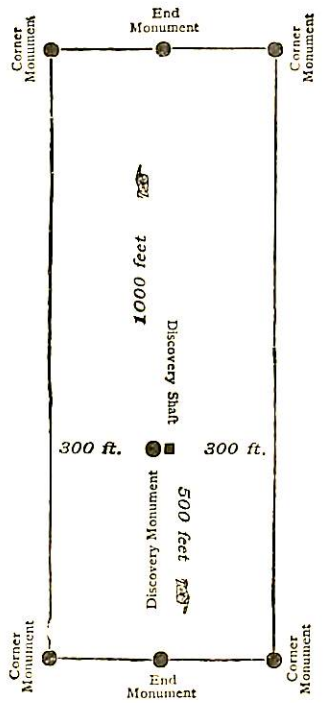

This diagram is to give locator a general idea of plan of location under the new law. The Discovery Shaft can be in the center of claim or any distance from either end desired. In the diagram it is placed 500 feet from one end and 1000 feet from the other. Commence description of claim at a center end monument, giving its distance and direction from center of Discovery Shaft; thence bound the claim in either direction. In description be careful to state locality of claim with reference to some natural object, or permanent monument. as will identify the claim.

TERRITORY OF ARIZONA, }
 COUNTY OF YUMA. } ss.

I, ~~W. E. Martin~~, County Recorder in and for said county, do hereby certify that I have compared the within and foregoing instrument, and the same is a full, true and correct copy of Copper Bottom No. 8. Mining Claim as the same appears of record in Book P. J. Minors page _____ et seq. in records of Yuma County, Arizona.

In witness whereof I have hereunto set my hand and affixed my official seal this 9th day of November, 1903.

C. C. Cronin
 County Recorder.
 By C. J. Bondesson, Deputy.

Notice of Mining Location

44

LODE CLAIM

To All Whom it May Concern:

This Mining Claim, the name of which is the Copper Bottom No. 8.
Mining Claim, situate on lands belonging to the United States of America, and in which there
are valuable mineral deposits, was entered upon and located for the purposes of exploration and
purchase by Desert Queen Gold Co.

(Locator must insert either "a citizen of the United States," or, "who has declared his intention to become a citizen of the United States.")

the undersigned, on the 22, day of October 1903

The length of this claim is 1500 feet,
and it claim 5 800 feet,

in a Westerly direction and

700 feet in an easterly direction from
the center of the discovery shaft, at which this notice is posted, lengthwise of the claim, together
with 300 feet in width of the surface grounds, on each

side of the center of said claim. The general course of the lode deposit and premises is from the
East to the West

The claim is situated and located in the Plomosa Mining District, in

Yuma County, in the Territory of Arizona, about 1 1/2

in a South westerly direction from from Quartzsite

Post Office and about 3 miles south from

the Chello Placers and Beehive group of

patented claims

The surface boundaries of the claim are marked upon the ground as follows: Beginning at

a monument of stone

at a point in a Westerly direction 800 feet from

the discovery shaft (at which this notice is posted), being in the center of the Westerly

end line of said claim; thence N. 2° 45' W. 300 feet to a monument

of stone, being the N. W. corner of said claim; thence

N. 87° 15' E. 1500 feet to a monument of stone, being at the

N. E. corner of said claim; thence S. 2° 45' E. 300 feet

to a monument of stone at the center of the easterly end of said claim;

thence same course 300 feet to a monument of stone, being at the

S. E. corner of said claim; thence S. 87° 15' W. 1500

feet to a monument of stone at the S. W. corner of said claim;

thence N. 2° 45' W. 300 feet to the place of beginning.

All done under the provisions of Chapter Six, of Title XXXII, of the Revised Statutes of
the United States, and of an Act of the General Assembly of Arizona, entitled "An Act to
Revise and Codify the Laws of the Territory of Arizona," approved March 16, 1901.

Dated and posted on the ground this 22 day of October 1903

Desert Queen Gold Co.

By John J. Hyatt

Manager

TERRITORY OF ARIZONA,

County of..... } ss

I,....., County Recorder in and for the County and Territory aforesaid, do hereby certify that the within instrument was filed for record at.....o'clock,..... M., on this.....day of.....190..., and duly recorded in Book No..... of.....Records of.....County, Arizona, at pages.....

WITNESS my hand and official seal the day and year first above written.

County Recorder.

Notice of Location.

LODE CLAIM.

Certified Copy

Copper Bottom
No. 8.

Dated.....190.....

Filed and recorded at the request of

John J. Hyatt

Nov 9th A. D. 190*3*

at.....*9 a. m.*

Book.....

Page.....

C. O. Brown
County Recorder.

W. P. Bondison
Deputy Recorder.

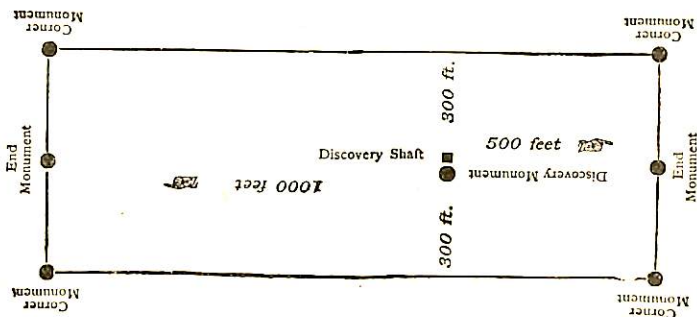

This diagram is to give locator a general idea of plan of location under the new law. The Discovery Shaft can be in the center of claim or any distance from either end desired. In the diagram it is placed 500 feet from one end and 1000 feet from the other. Commence description of claim at a center end monument, giving its distance and direction from center of Discovery Shaft; thence bound the claim in either direction. In description be careful to state locality of claim with reference to some natural object, or permanent monument, as will identify the claim.

TERRITORY OF ARIZONA, }
 COUNTY OF YUMA. } SS.

I, ~~W. E. Mason~~ *C. P. Cronin*, County Recorder in and for said county, do hereby certify that I have compared the within and foregoing instrument, and the same is a full, true and correct copy of *Copper Bottom No. 9 Mining*

Claim
 as the same appears of record in Book *P of Mines*
 page _____ et seq. _____

in records of Yuma County, Arizona.

In witness whereof I have hereunto set my hand and affixed my official seal this *7th* day of *November, 1903.*

C. P. Cronin

County Recorder.

By *O. O. Bondesson, Deputy*

Notice of Mining Location

LODE CLAIM

To All Whom it May Concern:

This Mining Claim, the name of which is the Copper Butte No. 9 Mining Claim, situate on lands belonging to the United States of America, and in which there are valuable mineral deposits, was entered upon and located for the purposes of exploration and purchase by Desert Queen Gold Co.

(Locator must insert either "a citizen of the United States," or, "who has declared his intention to become a citizen of the United States.")

the undersigned, on the 23 day of October 1903

The length of this claim is 1500 feet, and 2 claims 250 feet,

in a South West direction and 1250 feet in a North East direction from

the center of the discovery shaft, at which this notice is posted, lengthwise of the claim, together with 300 feet in width of the surface grounds, on each

side of the center of said claim. The general course of the lode deposit and premises is from the South West to the North East

The claim is situated and located in the Plomosa Mining District, in Yuma County, in the Territory of Arizona, about 11 miles in a South West direction from Quartzsite Post Office and about 3 miles South from Challo Placer and Beckins group of patented claims

The surface boundaries of the claim are marked upon the ground as follows: Beginning at a monument of stone

at a point in a South West direction 250 feet from the discovery shaft (at which this notice is posted), being in the center of the P.N.

end line of said claim; thence N 42° W 300 feet to a monument of stone, being the N.W. corner of said claim; thence

N 61° E. 1500 feet to a monument of stone, being at the N.E. corner of said claim; thence S 42° E. 300 feet

to a monument of stone at the center of the N.E. end of said claim; thence same course 300 feet to a monument of stone, being at the

S.E. corner of said claim; thence S 61° W 1500 feet to a monument of stone at the P.N. corner of said claim;

thence N 42° W 300 feet to the place of beginning.

All done under the provisions of Chapter Six, of Title XXXII, of the Revised Statutes of the United States, and of an Act of the General Assembly of Arizona, entitled "An Act to Revise and Codify the Laws of the Territory of Arizona," approved March 16, 1901.

Dated and posted on the ground this 23 day of October 1903

Desert Queen Gold Co.
By John J. Nyath
Manager

TERRITORY OF ARIZONA, }
County of..... } ss

I,....., County Recorder in and for the County and Territory aforesaid, do hereby certify that the within instrument was filed for record at.....o'clock,..... M., on this.....day of.....190..., and duly recorded in Book No..... of.....Records of.....County, Arizona, at pages.....

WITNESS my hand and official seal the day and year first above written.

.....
County Recorder.

Notice of Location.

LODE CLAIM.

Crested Copay
"Copper Bottom"
"W. No. 9."

Dated..... 190.....

Filed and recorded at the request of

John J. Hyatt

.....
Nov 9th. A. D. 1903
at..... 9a-M.

Book.....

Page.....

C. C. Brown
County Recorder.

By *C. C. Bonderson*
Deputy Recorder.

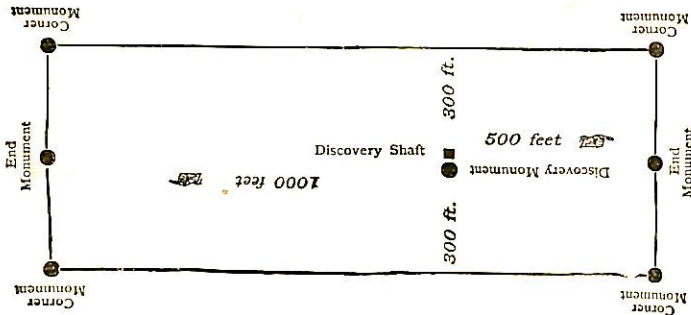

This diagram is to give locator a general idea of plan of location under the new law. The Discovery Shaft can be in the center of claim or any distance from either end desired. In the diagram it is placed 500 feet from one end and 1000 feet from the other. Commence description of claim at a center end monument, giving its distance and direction from center of Discovery Shaft; thence bound the claim in either direction. In description be careful to state locality of claim with reference to some natural object, or permanent monument, as will identify the claim.

TERRITORY OF ARIZONA, }
COUNTY OF YUMA. } SS.

49

I, ~~W. E. Marvin~~ *C. P. Cronin*, County Recorder in and for said county, do hereby certify that I have compared the within and foregoing instrument, and the same is a full, true and correct copy of *Copper Bottom No. 10,*
Mining Claim
as the same appears of record in Book *P. of Mines*
page _____ et seq. _____
in records of Yuma County, Arizona.

In witness whereof I have hereunto set my hand and affixed my official seal this *9th* day of *November, 1903.*

C. P. Cronin

County Recorder.

By *C. P. Bondarsson, Deputy*

Notice of Mining Location

LODE CLAIM

To All Whom it May Concern:

This Mining Claim, the name of which is the Copper Batton No. 10. Mining Claim, situate on lands belonging to the United States of America, and in which there are valuable mineral deposits, was entered upon and located for the purposes of exploration and purchase by Desert Queen Gold Co.

(Locator must insert either "a citizen of the United States," or, "who has declared his intention to become a citizen of the United States")
the undersigned, on the 28 day of October 1903

The length of this claim is 1500 feet,
and 140 claim 140 feet,
in a South Easterly direction and 1360
feet in a North westerly direction from
the center of the discovery shaft, at which this notice is posted, lengthwise of the claim, together
with 300 feet in width of the surface grounds, on each
side of the center of said claim. The general course of the lode deposit and premises is from the

South East to the North West

The claim is situated and located in the Plomosa Mining District, in
Yuma County, in the Territory of Arizona, about 11 miles
in a South westerly direction from Quartzsite Post Office
and 3 miles south from the Challa Placers
and Behler group of Patented claims

The surface boundaries of the claim are marked upon the ground as follows: Beginning at
a monument of stone

at a point in a S. E. direction 140 feet from
the discovery shaft (at which this notice is posted), being in the center of the P. E.
end line of said claim; thence N. 48° E. 300 feet to a Monument
of stone, being the P. E. corner of said claim; thence
N. 55° W. 1500 feet to a Monument of stone, being at the
N. E. corner of said claim; thence N. 48° W. 300 feet
to a Monument of stone at the center of the N. W. end of said claim;
thence same course 300 feet to a Monument of stone, being at the
N. W. corner of said claim; thence N. 55° E. 1500
feet to a Monument of stone at the P. W. corner of said claim;
thence N. 48° E. 300 feet to the place of beginning.

All done under the provisions of Chapter Six, of Title XXXII, of the Revised Statutes of
the United States, and of an Act of the General Assembly of Arizona, entitled "An Act to
Revise and Codify the Laws of the Territory of Arizona," approved March 16, 1901.

Dated and posted on the ground this 28 day of October 1903

Desert Queen Gold Co
By John J. Hyatt
Manager

TERRITORY OF ARIZONA, }
County of..... } ss

I,....., County Recorder in and for the County and Territory aforesaid, do hereby certify that the within instrument was filed for record at.....o'clock,.....M., on this.....day of.....190..., and duly recorded in Book No..... of.....Records of.....County, Arizona, at pages.....

WITNESS my hand and official seal the day and year first above written.

.....
County Recorder.

Notice of Location

LODE CLAIM

Certified Copy

"Copper Bottom No. 10"

Dated.....190.....

Filed and recorded at request of
John J. Gray
Prop. of L. 1903
at.....9-11 A.M.

Book.....

Pages.....
C. C. Bondz
County Recorder.

By *C. C. Bondz*
Deputy Recorder.

THE H. H. MCNEIL CO., PRINTERS, PHOENIX, ARIZONA.

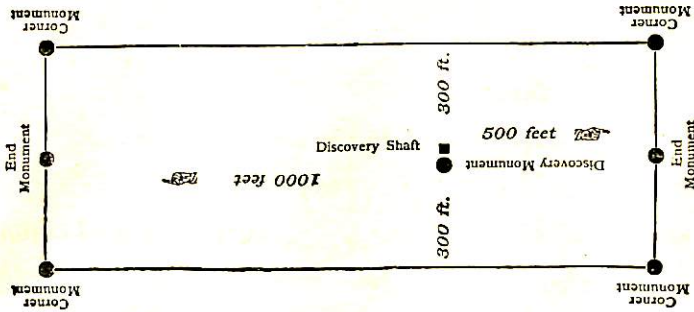

This diagram is to give locator a general idea of plan of location under the new law. The Discovery Shaft can be in the center of claim or any distance from either end desired. In the diagram it is placed 500 feet from one end and 1000 feet from the other. Commence description of claim at a center end monument, giving its distance and direction from center of Discovery Shaft; thence bound the claim in either direction. In description be careful to state locality of claim with reference to some natural object, or permanent monument, as will identify the claim



TERRITORY OF ARIZONA, }
COUNTY OF YUMA. } ss.

52

I, ~~W. E. Marvin~~, County Recorder in and for said county, do hereby certify that I have compared the within and foregoing instrument, and the same is a full, true and correct copy of Copper Bottom No. 11.

Mining Claim
as the same appears of record in Book P. of Mines
page _____ et seq. _____

in records of Yuma County, Arizona.

In witness whereof I have hereunto set my hand and affixed my official seal this 9th day of November 1903

C. F. Cronin

County Recorder.

By C. F. Bondarsson, Deputy.

Notice of Mining Location

53

LODE CLAIM

To All Whom it May Concern:

This Mining Claim, the name of which is the Copper Bottom No. 11 Mining Claim, situate on lands belonging to the United States of America, and in which there are valuable mineral deposits, was entered upon and located for the purposes of exploration and purchase by Desert Luan Gold Co.

(Locator must insert either "a citizen of the United States," or, "who has declared his intention to become a citizen of the United States")

the undersigned, on the 27 day of October 1903

The length of this claim is 1500 feet, and it claims 650 feet, in a North West direction and 850 feet in a South East direction from the center of the discovery shaft, at which this notice is posted, lengthwise of the claim, together with 300 feet in width of the surface grounds, on each side of the center of said claim. The general course of the lode deposit and premises is from the

North West to the South East

The claim is situated and located in the Plomosa Mining District, in Yuma County, in the Territory of Arizona, about 11 miles in a South westerly direction from Quartzsite Post Office and 3 miles South from the Challas Plains and Beehive group of patented claims.

The surface boundaries of the claim are marked upon the ground as follows: Beginning at a monument of stone

at a point in a North West direction 650 feet from the discovery shaft (at which this notice is posted), being in the center of the N. W. end line of said claim; thence N 32° E. 300 feet to a monument of stone, being the N. W. corner of said claim; thence S 58° E. 1500 feet to a monument of stone, being at the N. E. corner of said claim; thence S 32° W. 300 feet to a monument of stone at the center of the S. E. end of said claim; thence same course 300 feet to a monument of stone, being at the S. W. corner of said claim; thence N. 58° W. 1500 feet to a monument of stone at the N. W. corner of said claim; thence N 32° E. 300 feet to the place of beginning.

All done under the provisions of Chapter Six, of Title XXXII, of the Revised Statutes of the United States, and of an Act of the General Assembly of Arizona, entitled "An Act to Revise and Codify the Laws of the Territory of Arizona," approved March 16, 1901.

Dated and posted on the ground this 27 day of October 1903

Desert Luan Gold Co.
By John J. Hyatt
Manager

TERRITORY OF ARIZONA,

ss

I, _____, County Recorder in and for the County and Territory aforesaid, do hereby certify that the within instrument was filed for record at _____ o'clock, _____ M., on this _____ day of _____, 190____, and duly recorded in Book No. _____ of _____ Records of _____ County, Arizona, at pages _____.

WITNESS my hand and official seal the day and year first above written.

County Recorder.

Notice of Location
LODE CLAIM

Certified Copy

Robert Bottom
Apr. 11

Dated _____ 190____

Filed and recorded at request of
John J. Spawth
March - 9 - 1903
at _____ 9 - a M.

Book _____

Pages _____

W. B. Brown
County Recorder.
By *W. B. Brown*
Deputy Recorder.

THE H. H. MICHELL CO., PRINTERS, PHOENIX, AR. U.S.A.

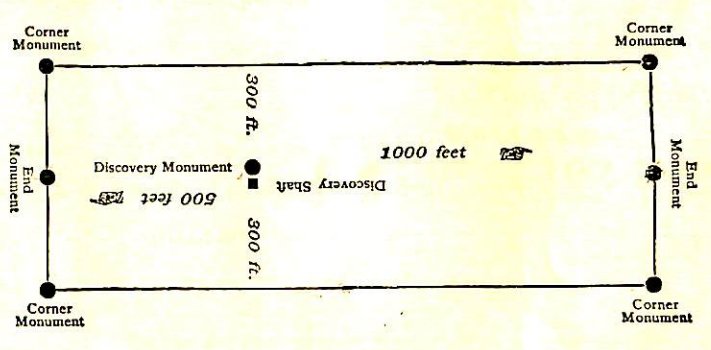

This diagram is to give locator a general idea of plan of location under the new law. The Discovery Shaft can be in the center of claim or any distance from either end desired. In the diagram it is placed 500 feet from one end and 1000 feet from the other. Commence description of claim at a center end monument, giving its distance and direction from center of Discovery Shaft; thence bound the claim in either direction. In description be careful to state locality of claim with reference to some natural object, or permanent monument, as will identify the claim

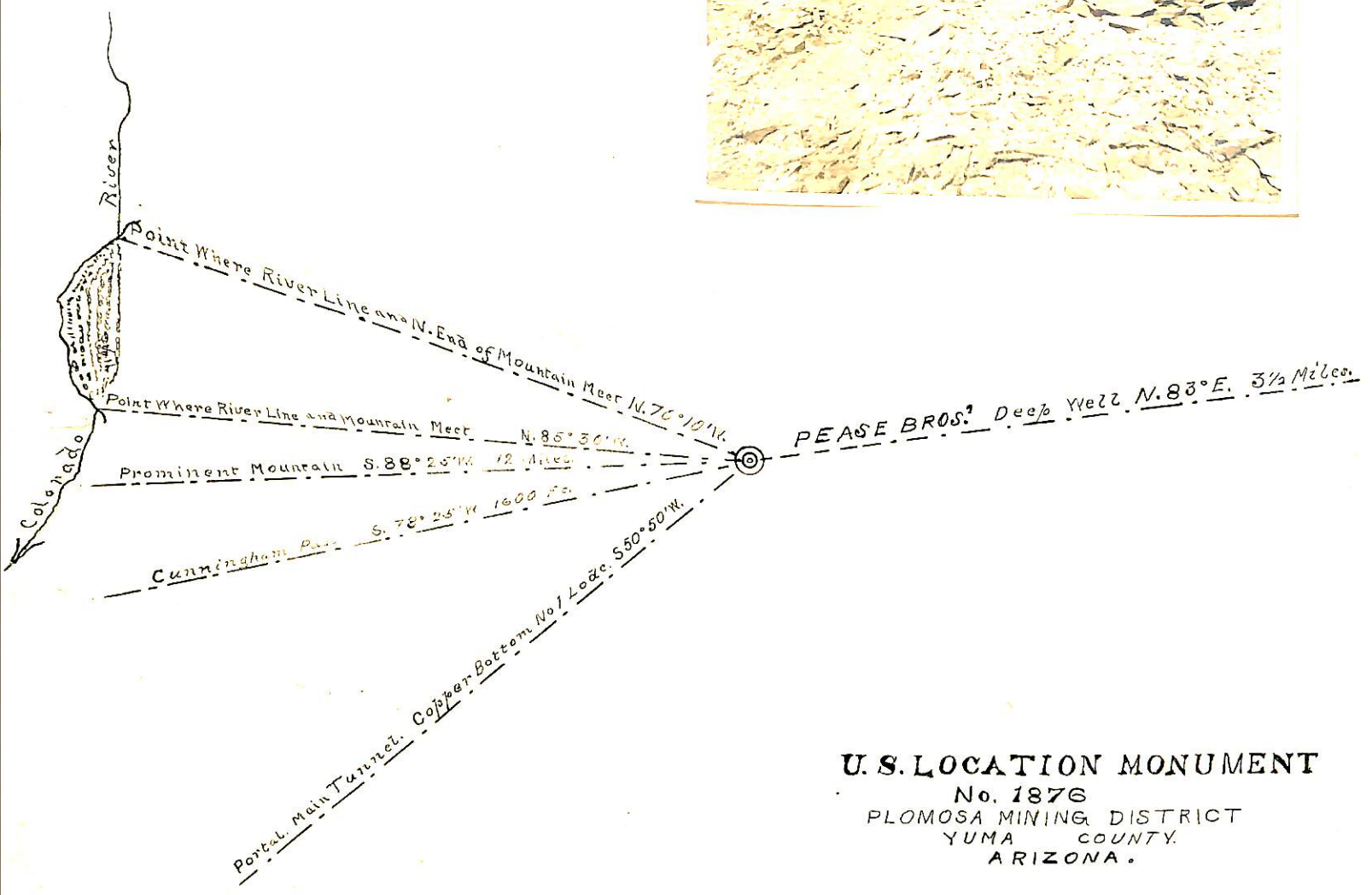

U. S. LOCATION MONUMENT
 No. 1876
 PLOMOSA MINING DISTRICT
 YUMA COUNTY,
 ARIZONA.

4-687.

SURVEYOR-GENERAL'S CERTIFICATE OF APPROVAL OF FIELD NOTES AND SURVEY OF MINING CLAIM.

Department of the Interior.

Office of U. S. Surveyor-General,

Phoenix, Arizona

April 22, 1907

I, U. S. Surveyor-General for District of Arizona

do hereby certify that the foregoing and hereto attached Field Notes and Return of the Survey of the Mining Claim of Desert Queen Gold Co.

known as the Copper Bottom Nos. I, 2, 3, 4, 5, 6, 7, 8, 9, 10 and II.

situate in Plomosa mining district,

Yuma County, Arizona

in Section, Township No., Range No.

designated as Survey No. I 8 7 6

executed by Francis B. Jacobs, U. S. Deputy Mineral

Surveyor, December 1-5, 1903, under my instructions dated

November 25, 1903, have been critically examined and the necessary cor-

rections and explanations made, and the said Field Notes and Return, and the Survey they describe,

are hereby approved. A true copy of the copy of the location certificate filed by the applicant. for

survey is included in the field notes.

Frank J. Ingalls

U. S. Surveyor-General for Arizona

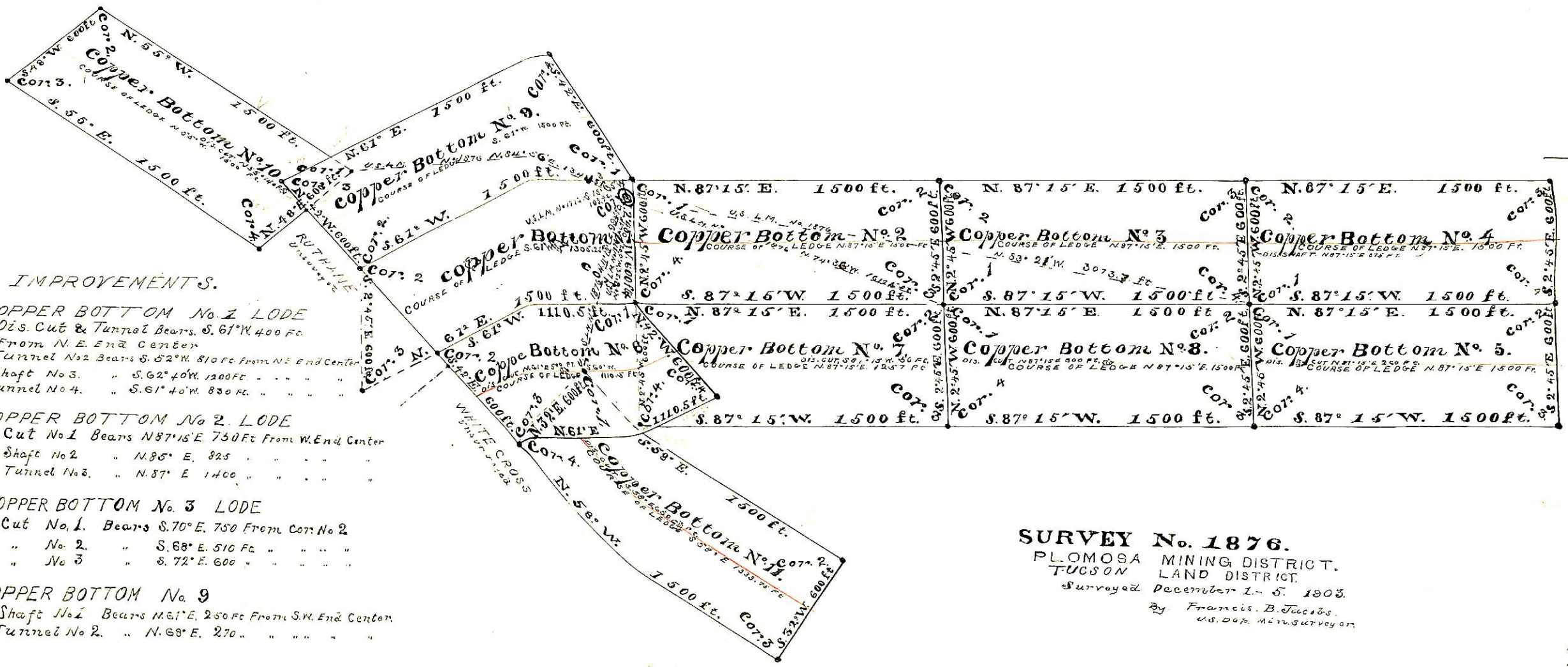

IMPROVEMENTS.

COPPER BOTTOM No. 1 LODE

Dis. Cut & Tunnel Bears S. 61° W. 400 Ft.
 From N. E. End Center
 Tunnel No 2 Bears S. 52° W. 810 Ft. From N. E. End Center
 Shaft No 3. " S. 62° 40' W. 1200 Ft. " " " "
 Tunnel No 4. " S. 61° 40' W. 830 Ft. " " " "

COPPER BOTTOM No. 2 LODE

Cut No 1 Bears N 87° 15' E. 750 Ft From W. End Center
 Shaft No 2 " N. 85° E. 325 " " " " "
 Tunnel No 3. " N. 87° E. 1400 " " " " "

COPPER BOTTOM No. 3 LODE

Cut No. 1. Bears S. 70° E. 750 From Cor. No 2
 " No. 2. " S. 68° E. 510 Ft. " " " "
 " No 3 " S. 72° E. 600 " " " " "

COPPER BOTTOM No. 9

Shaft No 2 Bears N. 61° E. 250 Ft From S. W. End Center.
 Tunnel No 2. " N. 68° E. 270 " " " " "

SURVEY No. 1876.

PLOMOSA MINING DISTRICT.
 TUCSON LAND DISTRICT.

Surveyed December 1-5, 1903.

By Francis B. Jacobs,
 U.S. Dep. Min. Surveyor