

MS.

01953

MINERAL SURVEY NO. 1953

Claims	M & B Desc.	Improvements	Loc. Notices
Belcher	Pg. 2	Pg. 13	1
Bryen	1	13	4
Copper Crown	5	14	6
George Washington	9	14	5
Lily Fraction	6	14	7
Penobscott	4	13	2
Red Cloud	8	14	8
Sunnyside	10	15	3

1
SEP 2-1904
2061-2 J20

Copied by amt
9/22/09

(4-683.)

Mineral Survey No. 1953

Lot No. _____

Tila

Land District.

FIELD NOTES

OF THE SURVEY OF THE MINING CLAIM OF

(?) B. J. Graham, President
Bisbee Queen Development Co
KNOWN AS THE
Bryant, Belcher, Terrahscott, Copper Queen
Tilly, Tracton, Red Cloud, George Washington
Sunyside, situated in Warner Mining District,

Cochise County, Arizona
Section affinal, Township 23 S, Range 24 E Sec 10

Surveyed under instructions dated June 3rd, 1904
by Geo Clark
U. S. Deputy Mineral Surveyor

Claim located Permittees . 1
Survey commenced August 1st . 1 904
Survey completed August 20th . 1 904

P.O. Address of claimant
Douglas, Cochise County
Arizona

1/2
Buck

PRELIMINARY OATHS OF ASSISTANTS IN SURVEY OF MINING CLAIM.

We, Frank Rajoth and J. A. Gillette,

do solemnly swear that we will well and faithfully execute the duties of chain carriers; that we will level the chain upon even and uneven ground and plumb the tally-pins, either by sticking or dropping the same; that we will report the true distance to all notable objects, and the true length of all lines that we assist in measuring, to the best of our skill and ability, and in accordance with instructions

given us, in the survey of the Mining Claim of B. S. Graham, President
Bisbee Queen Development Co
known as the Bryson-Beecher, Percobscott-Copper Crown
Lily Fractured Island, George Washington, Sunnyside
situate in Warren mining district

Cochise County, Arizona
approx in Section, Township No. 23S, Range No. 24 E. 4 S. 18 R. 27 N.

Frank Rajoth, Chainman.
J. A. Gillette, Chainman.

Subscribed and sworn to by the above-named persons before me this 28th day of July, 1904

Cora E. Smith
Notary Public for the Territory of Arizona
My Comm. Expires March 21, 1908

I, _____, do solemnly swear that I will well and truly perform the duties of axman, in the establishment of corners and other duties, according to instructions given me and to the best of my skill and ability, in the survey of the Mining Claim of

known as the _____
more fully described in the preceding affidavit.

_____, Axman.

Subscribed and sworn to by the said _____
before me this _____ day of _____, 190____

I, _____, do solemnly swear that I will well and truly perform the duties of flagman, in the establishment of corners and other duties, according to instructions given me and to the best of my skill and ability, in the survey of the Mining Claim of

known as the _____
more fully described in the preceding affidavit.

_____, Flagman.

Subscribed and sworn to by the said _____
before me this _____ day of _____, 190____

Bryer.

Feet

Beginning at Cor. No. 1, whence NW. cor.,
 Little Elsie lode unsurveyed brs. N. $4^{\circ}49'W$. 506.8 ft
 a pine post 4 ft. long 4 ins. sq. set 1 ft. in the ground
 in a mound of stones and scribed 1-1953 B.L., whence a
 pine post of same dimensions and scribed W. C. 1-1953
 brs. S. $43^{\circ}52'W$. 50 ft., and a second pine post of
 same dimensions and scribing brs. N. $43^{\circ}52'E$. 50 ft.,
 and W. $\frac{1}{2}$ Cor. Sec. 30 tp. 23 S. R. 25 E. G & S R B & M brs.
 S. $77^{\circ}19'E$. 4757.1 ft.

Thence S. $43^{\circ}52'W$

138.1 to Cor. No. 2, the SE. cor., a pine post 4 ft. long 4 ins
 sq. set 1 ft. in the ground in a mound of stones and
 scribed 2-1953 B.L., whence a pine post of same dimen-
 sions and scribed W. C. 2-1953 brs. N. $69^{\circ}38'30''W$.
 50 ft., and a second pine post of same dimensions and
 scribing brs. S. $69^{\circ}38'30''E$. 50 ft., and original
 location for SE. cor. brs. S. $69^{\circ}38'30''E$. 108.3 ft.

Thence N. $69^{\circ}38'30''W$.

327.15 along N. side line of Gold Hill lode, unsurveyed to
 original location for W end center,

654.3 same bearing to Cor. No. 3, the SW. cor., identical with
 location, a pine post 4 ft. long 4 ins. sq. set 1 ft.
 in the ground in a mound of stones and scribed 3-1953
 B.L., whence a pine post of same dimensions and scribed
 W. C. 3-1953 brs. N. $43^{\circ}52'E$. 50 ft., and a second
 pine post of same dimensions and scribing brs. S. 43°
 $52'W$. 50 ft.

Thence N. $43^{\circ}52'E$.

536.8 to Cors. No. 1 and 2 respectively of Cave and Yukon
 lodes, Survey No. 1781

691.8 same bearing to Cor. No. 4 the NW. cor., identical with
 location, and at the point of intersection of line 2-3
 Belcher lode, of this survey, S. $56^{\circ}55'E$. 16.3 ft.
 from Cor. No. 3, a pine post 4 ft. long 4 ins. sq. set

Bryen (Con)

Feet

1 ft. in the ground in a mound of stones and scribed 4-1953 B.L., whence a pine post of same dimensions and scribed W. C. 4-1953 brs. N. 43° 52' E. 50 ft., and a second pine post of same dimensions and scribing brs. S. 43° 52' W. 50 ft.,

Thence S. 69° 38' 30" E.

327.15

to Cor. No. 5 the NE. cor., identical with original location for E. end center, a pine post 4 ft. long 4 ins. sq. set 1 ft in the ground in a mound of stones and scribed 5-1953 B.L., whence a pine post of same dimensions and scribed W. C. 5-1953 brs. S. 08° 32' W. 50 ft., and a second pine post of same dimensions and scribing brs. N. 08° 32' E. 50 ft. and original location for NE. cor brs S. 69° 38' 30" E. 100 ft

Thence S. 08° 32' W.

79.2

to the intersection of line 2-3 Belcher lode of this survey at $\frac{S}{W}$. 56° 55' $\frac{E}{N}$. ~~131.7~~^{368.3} ft. from Cor. No. ³~~2~~, from which point the NW. cor. of Little Elsie lode, unsurveyed brs N. 56° 55' W. 128.6 ft.

518.2

same bearing to Cor. No. 1, the place of beginning.

Ledge.

The presumed course of the vein on this claim is from the W end center of location N. 43° 52' E. 691.8 ft.

BELCHER.

Beginning at Cor. No. 1, the NE. cor., identical with location and with Cors. No. 2, 3 and 5 respectively of Penobscot, Lily Fraction and Red Cloud lodes of this survey, a pine post 4 ft. long 4 ins. sq. set 1 ft. in the ground in a mound of stones and scribed 1-1953 Be.L. whence a pine post of same dimensions and scribed W.C. 1-2-3-5-1953 brs. N. 44° 53' E. 50 ft., and a second pine post of same dimensions and scribing brs. S. 44° 53' W. 50 ft. and W. $\frac{1}{4}$ Cor. Sec. 30 Tp. 23 S. R. 25 E. G & S R B & M brs. S. 67° 59' E. 3449.1 ft.

Thence S. 44° 53' W.

304.75

along line 5-4 Red Cloud lode of this survey to original

Feet

609.5 location for E. end center,
same bearing to Cor.No.2, the SE. cor., identical with location and with Cor.No.4 Red Cloud lode of this survey a pine post 4 ft.long 4 ins. sq. set 1 ft inthe ground in a mound of stones and scribed 2-1953 Be.L., whence a pine post of same dimensions and scribed W. C. 2-4-1953 brs. N. 56° 55' W. 50 ft., and a second pine post of same dimensions and scribing brs. S. 56° 55' E. 50 ft.,
Thence N. 56° 55' W.

750.00 along N. side line Little Elsie lode unsurveyed, original location for S. side center,

1131.7 same bearing to the intersection of line 5-1 Bryen lode of this survey,

1260.4 same bearing to NW. cor. Little Elsie lode unsurveyed,

1483.7 same bearing to Cor.No.4, Bryen lode of this survey, and at the point of intersection of line 2-1 Yukon lode Survey No.1781 at S. 43° 52' W. 345 ft. from Cor.No.1,

1500.0 same bearing to Cor.No.3, the SW. cor., identical with location, a pine post 4 ft.long 4 ins. sq. set 1 ft.in the ground in a mound of stones and scribed 3-1953 B.e.L whence a pine post of same dimensions and scribed W.C. 3-1953 brs.N. 44° 53'E. 50 ft. and a second pine post of same dimensions and scribing brs. S. 44° 53' W.50 ft.
Thence N. 44° 53' E.

304.75 to original location for W. end center

344.0 same bearing to the intersection of line1-5 Yukon lode Survey No.1781(which line being common with line 2-3 Sitka lode) at N. 68° 46' W. 10.7 ft. from Cor.No.1,

347.65 same bearing to Cor. No.4 Hobo lode Survey No.1962 from which point Cors.No.2 and 1 Sitka and Yukon lodes Survey No.1781, which cors are identical, brs.S. 48°50'E 9.8 ft.,

447.2 same bearing to the intersection of line 1-4 Sitka lode, Survey No.1781, at N. 52° 55' W. 8.1 ft. from Cor.No.1

Belcher (Con 2)

Feet

609.5 along line 4-3 Hobo lode, Survey No.1962 to Cor.No.4 the NW. cor., identical with location and with Cor.No. 3 Penobscot lode of this survey, a pine post 4 ft. long 4 ins. sq. set 1 ft in the ground in a mound of stones and scribed 4-1953 Be.L., whence a pine post of same dimensions and scribed W. C. 3-4-1953 brs. N. $44^{\circ}53'E$. 50 ft., and a second pine post of same dimensions and scribing brs. S. $44^{\circ}53'W$. 50 ft.,

Thence S. $56^{\circ}55'E$.

750.00 along line 3-2 Penobscot lode of this survey to original location for N. side center, 1500 ft. same bearing to Cor.No.1 the place of beginning.

Ledge.

The presumed course of the vein on this claim is from the E. end center of location N. $56^{\circ}55'W$. 1500 ft.

PENOBSCOTT

Beginning at Cor.No.1, the NE. cor., identical with Cors. No.1 and 4 respectively of Copper Crown and Lily Fraction lodes of this survey and with the SW. cor. of Horseshoe lode, unsurveyed, and identical with location a pine post 4 ft. long 4 ins. sq. set 1 ft. in the ground in a mound of stones and scribed 1-1953 P.L., whence a pine post of same dimensions and scribed W. C. 1-4-1953 brs. N. $44^{\circ}53'E$. 50 ft., and a second pine post of same dimensions and scribing brs. S. $44^{\circ}53'W$. 50 ft. and W. $\frac{1}{4}$ Cor. Sec. 30 Tp 23 S R 25 E G & S R B & M brs S. $52^{\circ}04'E$ 3261.0 ft.

Thence S. $44^{\circ}53'W$.

304.75 along line 4-3 Lily Fraction lode of this survey to original location for E. end center,

609.5 same bearing to Cor.No.2 the SE. cor., identical with location and with Cors.No.1,5 and 3 respectively of Belcher, Red Cloud and Lily Fraction lodes of this survey a pine post etc, scribed 2-1953 P.L.,

Feet

Thence N. 56° 55' W.
750.0 along line 1-4 Belcher lode of this survey, original
location for S. side center,
1500.0 same bearing, to Cor.No.3, the SW. cor., identical
with location and with Cor.No.4 Belcher lode of this
survey a pine post etc, and scribed 3-1953 P.L.,
Thence N. 44° 53' E.
304.75 along line 4-3 Hobo lode, Survey No.1962 to original
location for W. end center,
609.5 same bearing to Cor.No.4 the NW. cor., identical with
location and with Cor.No.2 Copper Crown lode of this
survey, a pine post 4 ft. long 4 ins. sq. set 1 ft in
the ground in a mound of stones and scribed 4-1953
P.L., whence a pine post of same dimensions and scribed
W. C. 2-4-1953 Brs. N. 44° 53' E. 53 ft. and a second
pine post of same dimensions and scribing brs. S. 44°
53' W. 47 ft.
Thence S. 56° 55' E.
750.0 along line 2-1 Copper Crown lode of this survey to
original location for N. side center,
1500 same bearing to Cor.No.1 the place of beginning.

Ledge.

The presumed course of the vein on this claim is
from the E. end center of location N. 56° 55' W. 1500 ft.

COPPER CROWN.

Beginning at Cor.No.1 the SE. cor., identical
with location and with Cors. No.1 and 4 respectively
of Penobscott and Lily lodes of this survey and with the
SW. cor. Horseshoe lode unsurveyed, a pine post 4 ft.
long 4 ins. sq. set 1 ft. in the ground in a mound of
stones and scribed 1-1953 C.C.L. whence a pine post of
same dimensions and scribed W. C. 1-4-1953 brs. N. 44° 53'
E. 50 ft., and a second pine post of same dimensions
and scribing brs. S. 44° 53' W. 50 ft. and W. 1/4 Cor. Sec. 30
Tp 23 S. R. 25 E G & S R B & M brs. S. 58° 04' E. 3261 ft.

Feet

1500.0 Thence N. 56° 55' W.
 along N. side line Penobscott lode of this survey to Cor.
 No. 2 the SW. cor., identical with location and with Cor
 No. 4 Penobscott lode of this survey, a pine post 4 ft.
 long 4 ins. sq. set 1 ft. in the ground in a mound of stones
 and scribed 2-1953 C.C.L.,

3.0 Thence N. 44° 53' E.
 to Cor. No. 3 Hobo lode, Survey No.1962,
 304.7 same bearing to original location for W. end center,
 456.0 same bearing to Cor.No.3, the NW. cor., identical with
 location, a pine post 4 ft.long 4 ins. sq.set 1ft in the
 ground in a mound of stones and scribed 3-1953 C.C.L.,
 whence a pine post of same dimensions and scribed W.C.
 3-1953 brs. S. 62° 26' 30" E. 50 ft., and a second pine
 post of same dimensions and scribing brs. S. 44° 53' W50ft.

1532.1 Thence S. 62° 26' 30" E.
 to Cor.No.4, the NE. cor., identical with location a pine
 post 4 ft.long 4 ins. sq. set 1 ft in the ground in a
 mound of stones and scribed 4-1953 C.C.L., whence a pine
 post of same dimensions and scribed W. C. 4-1953 brs.N.
 62° 26' 30" W. 50 ft., and a second pine post of same
 dimensions and scribing brs. S. 44° 53' W. 50 ft.

302.6 Thence S. 44° 53' W.
 to original location for E. end center,
 607.2 same bearing to Cor.No.1, the place of beginning.

Ledge

The presumed course of the vein on this claim is
 from the E. end center of location N. 56° 55' W.1500 ft.

LILY FRACTION.

Beginning at Cor.No.1, the NE. cor., identical with
 location and with the SE. cor. of Horseshoe lode, unsur-
 veyed a pine post 4 ft.long 4 ins. sq.set 1ft in the ground
 in a mound of stones and scribed 1-1953 L.F.L., whence
 a pine post of same dimensions and scribed W. C. 1-1953

Feet

brs. S. 44° 53' W. 50 ft., and a second pine post of same dimensions and scribing brs. N. 44° 53' E. 50 ft. and W. $\frac{1}{4}$ Cor. Sec 30 Tp. 23 S. R 25 E. G & S R B & M brs. S. 75° 29' E. 1972.6 ft.

Thence S. 44° 53' W.

207.5 along line 4-3 George Washington lode of this survey to Cors No. 3 and 5 respectively of George Washington lode of this survey and James Carretto lode Survey No. 1958,

251.9 same bearing to Cor. No. 4 James Carretto lode, Survey No. 1958,

304.75 same bearing to original location for E. end center,

609.5 same bearing to Cor. No. 2, the SE. cor., identical with location and with Cor. No. 1 Red Cloud lode of this survey, a pine post 4 ft. long 4 ins. sq. set 1 ft. in the ground in a mound of stones and scribed 2-1953 L.F.L.,

Thence N. 34° 53' W.

1500 along N. side line Red Cloud lode of this survey to Cor. No. 3 the SW. cor. identical with location and with Cors No. 1, 2 and 5 respectively of Belcher, Penobscott and Red Cloud lodes of this survey, a pine post etc., and scribed 3-1953 L.F.L.,

Thence N. 44° 53' E.

304.75 along line 2-1 Penobscott lode of this survey to original location for W. end center,

609.5 same bearing to Cor. No. 4, the NW. cor., identical with location and with Cors. No. 1 of Copper Crown and Penobscott lodes of this survey, a pine post etc and scribed 4-1953 L.F.L.,

Thence S. 34° 53' E.

1500.0 along S. side line Horsehoe lode, unsurveyed to Cor. No. 1 the place of beginning.

Ledge.

The presumed course of the vein on this claim is from the W end center of location S. 34° 53' E. 1500 ft.

Survey No. 1953.

Feet.

RED CLOUD

Beginning at Cor.No.1, the NE. cor., identical with location and with Cor.No.2 Lily Fraction lode of this survey, a pine post 4 ft. long 4 ins. sq. set 1 ft. in the ground in a mound of stones and scribed 1-1953 R.C.L., whence a pine post of same dimensions and scribed W. C. 1-2-1953 brs. S. $44^{\circ} 53' W.$ 25 ft., and a second pine post of same dimensions and scribing brs. N. $44^{\circ} 53' E.$ 50 ft. and W. $\frac{1}{2}$ Cor. Sec. 30 Tp. 23 S. R 25 E. G & S R B & M brs. S. $88^{\circ} 28' E.$ 2340.6 ft.

Thence S. $44^{\circ} 53' W.$

34.6 to the intersection of N. side line of Junebird lode unsurveyed, which line brs. S. $56^{\circ} 55' E.$

304.75 same bearing to Cor.No 2, the SE. cor., identical with original location for E. end center, a pine post 4 ft. long 4 ins. sq. set 1 ft. in the ground in a mound of stones and scribed 2-1953 R.C.L., whence a pine post of same dimensions and scribed W. C. 2-1953 brs. S. $44^{\circ} 53' W.$ 50 ft and a second pine post of same dimensions and scribing brs. N. $44^{\circ} 53' E.$ 50 ft. and original location for S.E Cor. brs. S. $44^{\circ} 53' W.$ 100 ft.

Thence N. $41^{\circ} 24' W.$

988.8 to Cor.No.3, on the N. side line of Junebird lode, unsurveyed, N. $56^{\circ} 55' W.$ 1008.0 ^{ft} From the point of intersection of line 1-2 a pine post 4 ft. long 4 ins. sq. set 1 ft in the ground in a mound of stones and scribed 3-1953 R.C.L., whence a pine post of same dimensions and scribed W. C. 3-1953 brs. N. $56^{\circ} 55' W.$ 50 ft., and a second pine post of same dimensions and scribing brs. S. $56^{\circ} 55' E.$ 50 ft.

Thence N $56^{\circ} 55' W.$

500.0 to Cor.No.4, the SW. cor., identical with location and with Cor.No.2 Belcher lode of this survey, a pine post etc., and scribed 4-1953 R.C.L.,

Thence N. $44^{\circ} 53' E.$

Feet

- 304.75 along line 2-1 Belcher lode of this survey to original location for W. end center,
- 609.5 same bearing to Cor.No.5, the NW. cor., identical with location and with Cors.No.1,2 and 3 ^{respectively} Belcher, Penobscott and Lily Fraction lodes of this survey, a pine post etc scribed 5-1953 R.C.L.,
- Thence S. 34° 53' E.
- 1500.0 along line 32 Lily Fraction lode of this survey to Cor. No.1, the place of beginning.
- Ledge.
- The presumed course of the vein on this claim is from the W. end center of location S. 34° 53' E. 1500 ft.
- GEORGE WASHINGTON.
- Beginning at Cor.No.1, the SE. cor., identical with location and with Cor. No. 5, Sunnyside lode of this survey, a pine post 4 ft.long 4 ins. sq. set 1 ft.in the ground in a mound of stones and scribed 1-1953 G.W.L., whence a pine post of same dimensions and scribed W.C. 1-5-1953 brs. S. 58° 56' E. 50 ft., and a second pine post of same dimensions and scribing brs. N. 58° 56' W. 50 ft., and W. $\frac{1}{2}$ Cor. Sec. 30 Tp. 23 S. R. 2 5 E. G & S R B & M brs. S. 30° 59' E. 770.5 ft.
- Thence S. 72° 14' W.
- 1493.7 along the N. side line of Sunnyside lode of this survey to Cor.No.2 the SW. cor., identical with location and with Cor.No.4 Sunnyside lode of this survey, a pine post 4 ft.long 4 ins. sq. set 1 ft.in the ground in a mound of stones scribed 2-1953 G.W.L., whence a pine post of same dimensions and scribed W. C. 2-4-1953 brs. N. 58° 56' W. 50 ft., and a second pine post of same dimensions and scribing brs. S. 58° 56' E 50 ft.
- Thence N. 58° 56' W.
- 276.9 along line 1-5 James Garretto lode, Survey No.1958 to Cor.No.3 the NW. cor., identical with original location

Feet.

for W. end center, a pine post 4 ft.long 4 ins. sq. set 1 ft in the ground in a mound of stones and scribed 3-1953 G.W.L., whence a pine post of same dimensions and scribed W.C.3-1953 brs. N. 58° 56' W. 50 ft., and a second pine post of same dimensions and scribing brs. S. 58° 56' E. 50 ft., and original location for NW. cor., brs. N. 58° 56' W. 100 ft.

Thence N. 44° 53' E.

207.5 to Cor.No.1 Lily Fraction lode of this survey,

816.2 same bearing to Cor.No.4, a pine post 4 ft.long 4 ins. sq. set 1 ft.in the ground in a mound of stones and scribed 4-1953 G.W.L., whence a pine post of same dimensions and scribed W. C. 4-1953 brs. N. 44° 53' E. 50 ft., and a second pine post of same dimensions and scribing brs. S. 44° 53' W. 50 ft.

Thence N. 79° 06'E.

496.3 to Cor.No.5, the NE. cor., a pine post 4 ft.long 4 ins. sq. set 1 ft in the ground in a mound of stones and scribed 5-1953 G.W.L., whence a pine post of same dimensions and scribed W. C. 5-1953 brs. S. 58° 56' E. 50 ft., and a second pine post of same dimensions and scribing brs. N. 58°56' W. 50 ft., and original location for NE. cor. brs. N. 58° 56' W 286 ft.

Thence S. 58° 56' E.

300.0 to original location for E. end center,

696.2 same bearing to Cor.No.1 the place of beginning.

Ledge.

The presumed course of the vein on this claim is from the E end center of location S. 72° 14' W. 600 ft. thence S. 65° 57'W. 820.1 ft.

SUNNYSIDE.

Beginning at Cor.No.1, the SE. cor., a pine post 4 ft.long 4 ins. sq. set 1ft.in the ground in a mound of stones and scribed 1-1953 S.L., and a pine post of same dimensions and scribed W. C. 1-1953 brs. S. 58° 56'E

Feet

SUNNYSIDE.

- 50 ft., and a second pine post of same dimensions and scribing brs. N. $58^{\circ} 56'$ W. 50 ft., and W. $\frac{1}{2}$ Cor. Sec. 30. Tp. 23SR.25 E. G & S R B & M brs S. $17^{\circ} 15'$ W. 371.6ft and original location brs. S. $58^{\circ} 56'$ E. 203.7 ft.
Thence S, $63^{\circ} 21'$ W.
Tp.23 S.
- 119.2 to the intersection of the W. line of R. 25 E. at a point ^{cor} N. $0^{\circ} 41'45''$ E. 301.4 ft. from W. $\frac{1}{2}$ of Sec.30 Tp.23 S. R.25 E. G & S R B & M and S. $0^{\circ} 41'45''$ W. 2370.4 ft. from NW. cor. Sec.30 Tp.23 S. R.25 E G & S R B & M.
- 992.7 same bearing to Cor.No.2, identical with a cor. of Moonlight lode, unsurveyed and with Cor. No. 1 Copper Reef lode, Survey No. 1748, a pine post 4 ft.long 4 ins. sq. set 1 ft.in the ground in a mound of stones and scribed 2-1953 S. L., whence a pine post of same dimensions and scribed W. C. 2-1953 brs. S. $63^{\circ} 21'$ W. 50 ft., and a second pine post of same dimensions and scribing brs. N. $63^{\circ} 21'$ E. 50 ft.,
Thence S. $72^{\circ} 14'$ W.
- 378.8 to Cor.No.3, the SW. cor., identical with location and on the point of intersection of line 1-2 Copper Reef lode Survey No. 1748 with line 1-5 James Carretto lode, Survey 1958, a pine post 4 ft.long 4 ins. sq. set 1 ft.in the ground in a mound of stones and scribed 3-1953 S.L., whence a pine post of same dimensions and scribed 3-1953 W.C. brs.N $58^{\circ} 56'$ W. 50 ft., and a second pine post of same dimensions and scribing brs. N. $72^{\circ} 14'$ E. 50 ft.,
Thence N. $58^{\circ} 56'$ W.
- 397.75 along line 1-5 James Carretto lode, Survey No.1958 to original location for W. end center,
- 795.5 same bearing to Cor.No.4, the NW. cor., identical with location and with Cor.No.2 George Washington lode, of this survey, a pine post etc., and scribed 4-1953 S.L.,
Thence N. $72^{\circ} 14'$ E.
- 1498.7 along S. side line George Washington lode of this survey to Cor.No.5, the NE. cor., identical with location and with Cor.No.1 George Washington lode, a pine post etc.,

Feet

scribed 5-1953 S.L.,

Thence S. 58°56' E.

397.75 to original location for E. end center, T₂₃ S.

469.1 same bearing to intersection of the W. line of R. 25 E.
at a point N. 00°41'45"E. 418.2 ft. from W. [^]Cor. of Sec.

30 T₂₃ S R. 25 E G & S R B & M and S. 00° 41'45"W.

2253.6 ft. from NW. cor. Sec. 30 T₂₃ S R 25 E G & S R
B&M,

591.8 same bearing to Cor. No. 1, the place of beginning.

Ledge.

The presumed course of the vein on this claim is
from the W. end center of location N. 72°14'E. 1493.7 ft.

A R E A.

Total area Bryen lode,	✓ 7.623 Acres	
Less area in conflict with Belcher lode of this survey,	✓ <u>.291</u>	
Less Area in conflict with Little Elsie lode unsurveyed	✓ <u>0.590</u>	✓ <u>6.742</u>
Net area Bryen lode,		<u>6.742</u>
Total area Belcher lode,	✓ 20.545	
Less area in conflict with Sitka, nominal Less area in conflict with Yukon, lode Survey No. 1781,	✓ <u>.102</u>	✓ <u>20.443</u>
Net area Belcher lode,		<u>20.443</u>
Total and net area Penobscott, lode,		✓ 20.545
" " " " Copper Crown lode,		✓ 17.921
" " " " Lily Fraction		✓ 20.654
Total area Red Cloud lode,	✓ 13.973 A.	
Less area in Conflict with Junebird lode unsurveyed	✓ <u>3.060</u>	✓ 10.913
Net area Red Cloud lode,		✓ 10.913
Total and net area George Washington lode,		✓ 15.174
Total and net area Sunnyside,		✓ <u>18.572</u>
Total area group,		<u>127.422</u> 130.964

I hereby certify that the value of the labor and improvements on these claims placed thereon by claimant or its grantors is as follows:

BRYEN.

No.1	Discovery shaft 4x6x10 ft. brs.from W.end center of location N. 43° 52'E.500 ft., Value,	\$100.00	
	An undivided interest in ^{cut} shaft No. 3 Belcher lode of this survey,	100.00	<i>Cut</i>
	An undivided interest in ^{cut} shaft No.4 Belcher lode of this survey,	<u>100.00</u>	<i>Cut</i>
	Total improvements Bryen lode,		300.00

BELCHER.

No.1	Discovery cut 6x14x20 ft. brs.from Cor.No.3 S.82°51'E.690 ft., Value,	100.00	
No.2	Open Cut 6x10x18 ft. brs.from same point N.76°15' E. 135 ft., Value	100.00	
Note	Open Cuts No.3 and 4 so situated as to develop and improve the Bryen lode of this survey, have been allotted entirely to the Bryen lode of this survey.		
No.3	Open Cut 4x12x9 ft. brs.from same point S.72°30'E. 475 ft., Value,	\$100.00	
No.4	Open Cut 5x12x9 ft. brs.from same point S.67°10'E. 465 ft., Value,	\$100.00	
No.5	Open Cut 3x8x5 ft. brs.from same point N.82°10'E. 830 ft. Val.,	25.00	
No.6	Open Cut 4x16x8 ft. brs.from same point N.82°50'E. 840 ft., Value,	<u>100.00</u>	
	Total improvements Belcher lode,		325.00

PENOBSCOTT.

No.1	Discovery Cut 5x15x10 ft. brs.from Cor.No.1 S.55°30'W. 177 ft., Value,	\$100.00	
No.2	Open Cut 5x10x8 ft. brs.from same point S.51°54'W. 185 ft., Value,	100.00	
No.3	Open Cut 5x9x6 ft. and shaft 5x6x6 ft. brs.from same point S.47°30'W.203 ft., Value,	<u>100.00</u>	300.00

COPPER CROWN		
No. 1	Discovery Cut 6x16x12 ft. brs. from Cor. No. 1 N. 19° 40' E. 260 ft., Value,	\$100.00
No. 2	Open Cut 4.5x14x6 ft. shaft 4.5x8x4 ft. br. from same point N. 44° 34' W. 150 ft., Value,	100.00
No. 3	Open Cut 5x15x8.5 ft. brs. from same point N. 48° 49' W. 155 ft., Value,	100.00
No. 4	Open Cut 4.5x14x5 ft. brs. from same point N. 7° 10' E. 240 ft Value,	<u>50.00</u>
Total improvements on Copper Crown,		350.00
LILY FRACTION.		
No. 1	Discovery cut 4.5x12x8 ft. brs. from Cor. No. 3 N. 64° 26' E. 355 ft., Value,	100.00
No. 2	Shaft 4x6x10 ft. open cut 5x24x7 ft., brs. from Cor. No. 2 N. 24° 01' E. 625 ft., Value,	<u>200.00</u>
Total improvements Lily Fraction lode,		300.00
RED CLOUD.		
No. 1	Discovery shaft 4x6x10 ft. brs. from Cor. No. 5 S. 26° 29' E. 560 ft., Value,	100.00
No. 2	Open Cut 4x15x9 ft. brs. from same point S. 6° 50' E. 250 ft., Value,	100.00
No. 3	Shaft 4.5x6x10 ft. brs. ^{from a pt. S 44° 53' W. 34.6 ft} from Cor. No. 1 N. 55° 10' W. 170 ft., Value,	100.00
No. 4	Shaft 5x6x15 ft., brs. from same point N. 36° 20' W. 95 ft. Value,	150.00
No. 5	Shaft 5x6x5 ft. brs. from same point N. 19° 30' W. 90 ft. Value,	<u>50.00</u>
Total improvements Red Cloud,		500.00
GEORGE WASHINGTON		
No. 1	Discovery shaft 5x6x10 ft. brs. from Cor. No. 3 N. 89° 40' E. 240 ft., Value,	100.00
No. 2	Open Cut 4x16x10 ft. brs. from same point N. 72° 10' E. 600 ft., Value,	100.00
No. 3	Open Cut 5x16x12 ft. brs. from same point N. 73° 00' E. 605 ft. Value,	<u>100.00</u>
Total improvements George Washington lode		300.00

From a point S 44° 53' W. 34.6 ft.

Survey No. 1953.
SUNNYSIDE. --IMPROVEMENTS.

No. 1	Discovery cut 4.5x10x15 ft. hrs. from Cor. No. 3 N. 01° 01' E. 245 ft. Value,	\$100.00
No. 2	Open Cut 4x11x14 ft. hrs. from same point N. 04° 46' E 245 ft., Value,	100.00
No. 3	Shaft 4x7x10 ft. hrs. from same point N. 29° 59' W. 450 ft., Value,	100.00
No. 4	Shaft 6x8x10 ft. hrs. from same point N. 12° 58' W. 465 ft., Value,	175.00
No. 5	Shaft 3x5x4 ft. hrs. from same point N. 35° 49' W. 340 ft. Value	25.00
Total improvements Sunnyside lode,		<u>\$500.00</u>
Total improvements on group		<u>\$2875.00</u>

ADJOINING CLAIMS.

- North. Blaine, and Horseshoe lodes, unsurveyed, owned by applicants herein.
- East. Moonlight lode, unsurveyed, same owners.
- South Copper Reef lode, Survey No. 1748, Houghton Dev. Co. owner. James Carretto lode, survey No. 1958, owned by applicants herein. Junebird, Little Elsie and Gold Hill lodes, unsurveyed, owned by applicant herein.
- West. Cave, Yukon and Sitka lodes, Survey No. 1781 Jacob Pirrung et al owners. Hobo lode, Survey No. 1962, G. J. McCabe, et al owners.

LOCATION.

This group is located about $3\frac{1}{2}$ mi. in a SE. direction from the City of Bisbee on unsurveyed lands, in Warren Mining District in Cochise County, Arizona, approximately in Tp. 23 S. R. 24 E. G & S R B & M.

INSTRUMENT.

This survey was made with a Leitz Mountain and Mining transit. The courses were deflected from the true meridian as determined by solar observation, checked by an observation on Polaris. The distances were measured with a 300 foot steel tape.

Magnetic variation $12^{\circ} 30'$

R. C. Clark

U.S. Deputy Mineral Surveyor.

Yuma, Arizona,

20th August 1904.

Note. Any discrepancies between the courses and distances and section line intersections of this survey and those of the adjoining approved surveys, are due to errors in the latter.

Note: Complete affidavit of \$500 improvements on this group for each location thereof will be filed before the expiration of publication.

FINAL OATHS FOR SURVEYS.

LIST OF NAMES.

A list of the names of the individuals employed by

Geo Clark

United States Deputy Mineral Surveyor, to assist in running, measuring, and marking the lines corners and boundaries described in the foregoing field notes of the survey of the mining claim

of *B. J. Graham, Pres. Bisbee Queen Lavo*
Bryce, Belcher, Penobscott, Copper Crown,
known as the *Lily Traction, Red Cloud, George Washington Sunnyside*

and showing the respective capacities in which they acted.

Frank Rafath, Chairman.
J. A. Gillette, Chairman.
_____, Axman.
_____, Flagman.

FINAL OATHS OF ASSISTANTS.

We,

Frank Rafath

and

J. A. Gillette

do solemnly swear that we assisted

Geo Clark

_____, United States Deputy Mineral Surveyor, in marking the corners and

surveying the boundaries of the mining claim of *B. J. Graham President*
of the Bisbee Queen Lavo

Penobscott-Copper Crown, George Washington Sunnyside, known as the *Bryce-Belcher*
Lily Traction, Red Cloud represented

in the foregoing field notes as having been surveyed by said deputy mineral surveyor and under his direction; and that said survey has been in all respects, to the best of our knowledge and belief, faithfully and correctly executed, and the corner and boundary monuments established according to law and the instructions furnished by the United States Surveyor-General for

Arizona

Frank Rafath, Chairman.
J. A. Gillette, Chairman.
_____, Axman .
_____, Flagman.

Subscribed and sworn to by the above-named persons before me
this *20th* day of *August*, 190*4*

Coop Smith

NOTARY PUBLIC
In and for the County of Cochise, Territory of Arizona,
My Commission Expires March 21, 1905.

(4-686.)

FINAL OATH OF U. S. DEPUTY MINERAL SURVEYOR

I, Geo Clark, U. S. Deputy Mineral

Surveyor, do solemnly swear that, in pursuance of instructions received from the United

States Surveyor General for Arizona, dated

June 3rd 1904, have, in strict conformity to the laws of the

United States, the official regulations and instructions thereunder, and the instructions

of said Surveyor General, faithfully and correctly executed the survey of the Mining

Claim of B. S. Graham President Bishop

Queen, Deo Co. Penobscott, Copper Crown known as the

Wagon Road, Red Cloud, George Washington - Sunnyside

situate in Warren Mining District,

Cochise County, Arizona in Section

approx, Township No. 33S, Range No. 21E G. S. R. B. and M

and designated as Survey No. 1953, as represented

in the foregoing field notes, which accurately show the boundaries of said mining claim

as distinctly marked by monuments on the ground, and described in the attached copy

of the location certificate, which was received by me from the Surveyor General with

said instructions, and that all the corners of said survey have been established and per-

petuated in strict accordance with the law, official regulations and instructions there-

under; and I do further solemnly swear that the foregoing are the true and original

field notes of said survey and my report therein, and that the labor expended and

improvements made upon said mining claim by claimant or his grantors

are as therein fully stated, and that the character, extent, location and itemized value

thereof are specified therein with particularity and full detail, and that no portion of

said labor or improvements so credited to this claim has been included in the estimate

of expenditures upon any other claim.

Geo Clark
U. S. Deputy Mineral Surveyor.

Subscribed and sworn to by the said Geo Clark

U. S. Deputy Mineral Surveyor, before me

this 20th

day of August, 1904

Cora Smith
NOTARY PUBLIC

In and for the County of Cochise, Territory of Arizona

My Commission Expires March 21, 1908

DEPARTMENT OF THE INTERIOR,
OFFICE OF THE U.S. SURVEYOR-GENERAL,
Phoenix, Arizona, Nov. 8, 1905.

To the Commissioner of the General Land Office,
Washington, D.C.

Sir:

In accordance with your instructions, dated August 4, 1905, I hereby certify that from the records of this office, the $8/23$ interest in the three compartment shaft, situate on the June Bird lode, unsurveyed, which adjoins the Red Cloud lode, Survey No. 1953, is the only portion of said shaft that had been credited to any official survey under the statutory requirement of \$500.00 improvement for each claim, at the time the Red Cloud lode was surveyed.

The remaining $15/23$ interest appears to have been unappropriated.

(signed) Frank S. Ingalls,
U.S. Surveyor-General

NOTICE OF MINING LOCATION.

Lode Claim.

22

TO ALL WHOM IT MAY CONCERN:

This mining claim, the name of which is the Belcher Mining Claim, situate on lands belonging to the United States of America, and in which there are valuable mineral deposits, was entered upon and located for the purpose of exploration and purchase by A. K. Campbell the undersigned, on the 18th day of December 1900.

The length of this claim is fifteen hundred (1500) feet, and I claim four hundred (400) feet in a westerly direction and eleven hundred (1100) feet in an easterly direction from the center of the discovery shaft, at which this notice is posted, lengthwise of the claim together with three hundred (300) feet in width of the surface grounds, on each side of the center of said claim. The general course of the lode deposit and premises is from the West to the East.

The claim is situated and located in the Warren Mining District, in Cochise County, in the Territory of Arizona, about three miles in an Easterly direction from Bisbee being an extension of the Baker and Strong property and adjoining the James Reilly group.

The surface boundaries of the claim are marked upon the ground as follows: Beginning at a Stone monument at a point in a Westerly direction four hundred (400) feet from the discovery shaft (at which this notice is posted) being in the center of the Westerly end line of said claim; thence three hundred (300) feet to a stone monument, being the North West corner of said claim; thence seven hundred & fifty (750) feet to a stone monument at the center of the North side line of said claim; thence seven hundred & fifty (750) feet to a stone monument, being at the North east corner of said claim; thence three hundred (300) feet to a stone monument at the center of the Easterly end of said claim; thence three hundred (300) feet to a stone monument, being at the South East corner of said claim; thence seven hundred & fifty (750) feet to a stone monument, being at the center of the South side line of said claim; thence seven hundred & fifty feet to a stone monument at the S. W. corner of said claim; thence three hundred (300) feet to the place of beginning.

All done under the provisions of Chapter Six (6) of title
XXXII, of the Revised Statutes of the United States, and of an Act
of the General Assembly of Arizona, entitled "An Act Concerning
Mines", approved March 20th, 1895 and amended March 2nd, 1899. 23

Dated and posted on the ground this 18th day of December,
1900.

Witnessed by A. K. Campbell.
C. E. Cummings.

Filed and recorded at request of N. J. Mitchell, Dec/ 22nd
A. D. 1900 at 9 A. M. in Book 18, Records of Mines, at page 374.

Territory of Arizona, (
County of Cochise. :SS. (

I, Frank Hare, County Recorder in and for said County,
hereby certify that I have compared the foregoing copy with the
original Location Notice of the Belcher Mining Claim, filed and
recorded in my office on the 22nd day of December, 1900, in Book
18, Records of Mines, at page 374, and that the same is a full,
true and correct copy of such original and of the whole thereof.

Witness my hand and seal of office, this 28th day of
April, 1904.

County Recorder.

NOTICE OF MINING LOCATION.

24

Lode Claim.

TO ALL WHOM IT MAY CONCERN:

This mining claim, the name of which is the Penobscott Mining Claim, situate on lands belonging to the United States of America, and in which there are valuable mineral deposits, was entered upon and located for the purpose of exploration and purchase by A. K. Campbell the undersigned, on the 18th day of December 1900.

The length of this claim is fifteen hundred (1500) feet, and I claim four hundred (400) feet in a westerly direction and eleven hundred (1100) feet in an Easterly direction from the center of the discovery shaft, at which this notice is posted, lengthwise of the claim, together with three hundred (300) feet in width of the surface grounds on each side of the center of said claim. The general course of the lode deposit and premises is from the West to the East.

The claim is situated and located in the Warren Mining District, in Cochise County, in the Territory of Arizona, about three miles in an Easterly direction from Bisbee being an extension of the Baker & Strong property and paralleling the Belcher Claim.

The surface boundaries of the claim are marked upon the ground as follows: Beginning at a monument of stone at a point in a westerly direction of four hundred feet from the discovery shaft (at which this notice is posted), being in the center of the westerly end line of said claim; thence three hundred (300) feet to a stone monument, being the north west corner of said claim; thence seven hundred & fifty (750) feet to a stone monument at the center of the North side line of said claim; thence seven hundred & fifty (750) feet to a stone monument, being at the North east corner of said claim; thence three hundred (300) feet to a stone monument at the center of the East end of said claim; thence three hundred (300) feet to a stone monument, being at the south east corner of said claim; thence seven hundred & fifty (750) feet to a stone monument being at the center of the South side line of said claim; thence seven hundred & fifty (750) feet to a stone monument at the S. W. corner of said claim; thence Three hundred (300) feet to the place of beginning.

All done under the provisions of Chapter Six (6) of Title
XXXII, of the Revised Statutes of the United States, and of an Act 25
of the General Assembly of Arizona, entitled "An Act Concerning
Mines", approved March 20th, 1895 and amended March 2nd, 1899.

Dated and posted on the ground this 18th day of December
1900.

Witnessed by A. K. Campbell,
C. E. Cummings.

Filed and recorded at request of N. J. Mitchell, Dec 22nd A. D. 1900
at 9 A. M. Book 18, Records of Mines, at page 373.

Territory of Arizona, (
County of Cochise.) :SS. (

I, Frank Hare, County Recorder in and for said County,
hereby certify that I have compared the foregoing copy with the
original Location Notice of the Penobscott Mining Claim, filed and
recorded in my office on the 22nd day of December, 1900 in Book 18,
Records of Mines, at page 373, and that the same is a full, true
and correct copy of such original and of the whole thereof.

Witness my hand and seal of office, this 28th day of
April, 1904.

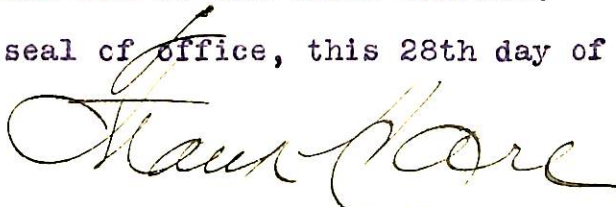
County Recorder.

Territory of Arizona, ()
 County of Cochise ()

I, Frank Hare, County Recorder in and for said County, hereby certify that I have compared the foregoing copy with the Original Location Notice of the Sunnyside Mining Claim, filed and recorded in my office on the 19 day of Nov 1902, in Book 22, Records of Mines, at page 265, and that the same is a full, true and correct copy of such original and of the whole thereof.

Witness my hand and seal of office, this 1st day of April 1904.

Frank Hare

County Recorder.

Notice of Mining Location

LODE CLAIM

To All Whom it May Concern:

This Mining Claim, the name of which is the Sunnyside Mining Claim, situate on lands belonging to the United States of America, and in which there are valuable mineral deposits, was entered upon and located for the purposes of exploration and purchase by John Barrietto

(Locator must insert either "a citizen of the United States," or, "who has declared his intention to become a citizen of the United States.")

the undersigned, on the 13th day of November 1902,

The length of this claim is 1500 feet, and 750 claim 750 feet,

in a westerly direction and 750 feet in a easterly direction from

the center of the discovery shaft, at which this notice is posted, lengthwise of the claim, together with 300 feet in width of the surface grounds, on each

side of the center of said claim. The general course of the lode deposit and premises is from the easterly to the westerly

The claim is situated and located in the Marner Mining District, in Cochise County, in the Territory of Arizona, about 3 miles

in a easterly direction from Bisbee

The surface boundaries of the claim are marked upon the ground as follows: Beginning at

a monument of stones

at a point in a easterly direction 750 feet from

the discovery shaft (at which this notice is posted), being in the center of the east end line of said claim; thence 300 feet to a monument

of stones, being the southeast corner of said claim; thence 1500 feet to a monument of stones, being at the

southwest corner of said claim; thence 300 feet to a monument of stones at the center of the west end of said claim;

thence 300 feet to a monument of stones, being at the northwest corner of said claim; thence 1500 feet to a monument of stones at the northeast corner of said claim;

thence 300 feet to the place of beginning.

All done under the provisions of Chapter Six, of Title XXXII, of the Revised Statutes of the United States, and of an Act of the General Assembly of Arizona, entitled "An Act to Revise and Codify the Laws of the Territory of Arizona," approved March 16, 1901.

Dated and posted on the ground this 13th day of November 1902

Witness:

A. K. Campbell

John Barrietto

Filed and recorded at request of John Barrietto Nov. 19, 1902 at 11 A. M. Book 22 Record of Mines page 265.

TERRITORY OF ARIZONA,
 County of..... } ss

I,....., County Recorder in and for the County and Territory aforesaid, do hereby certify that the within instrument was filed for record at..... o'clock,..... M., on this..... day of..... 190..., and duly recorded in Book No..... of..... Records of..... County, Arizona, at pages.....

WITNESS my hand and official seal the day and year first above written.

.....
 County Recorder.

Notice of Location.

LODE CLAIM.

Dated..... 190.....

Filed and recorded at the request of

..... A. D. 190.....

at..... M.

Book.....

Page.....

County Recorder.

By.....

Deputy Recorder.

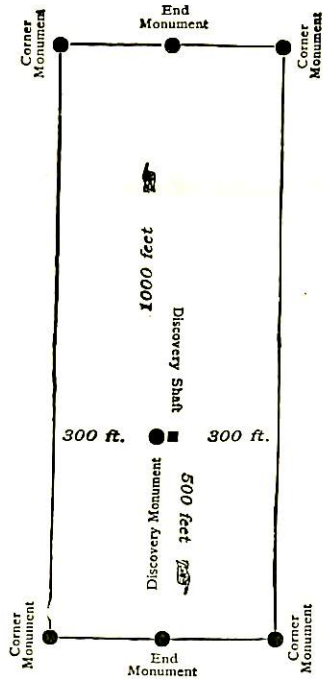

This diagram is to give locator a general idea of plan of location under the new law. The Discovery Shaft can be in the center of claim or any distance from either end desired. In the diagram it is placed 500 feet from one end and 1000 feet from the other. Commence description of claim at a center end monument, giving its distance and direction from center of Discovery Shaft; thence bound the claim in either direction. In description be careful to state locality of claim with reference to some natural object, or permanent monument, as will identify the claim.

Territory of Arizona, ()
County of Cochise. (:SS.)

I, Frank Hare, County Recorder in and for said County, hereby certify that I have compared the foregoing copy with the Original Location Notice of the Bryen Mining Claim, filed and recorded in my office on the 15th day of January, 1903, in Book 22, Records of Mines, at page 532, and that the same is a full, true and correct copy of such original and of the whole thereof.

Witness my hand and seal of office this 28th day of April, 1904.

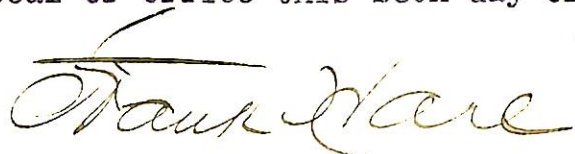

County Recorder.

Notice of Mining Location

2

LODE CLAIM

To All Whom it May Concern:

This Mining Claim, the name of which is the Bryens
Mining Claim, situate on lands belonging to the United States of America, and in which there
are valuable mineral deposits, was entered upon and located for the purposes of exploration and
purchase by A. K. Campbell

(Locator must insert either "a citizen of the United States," or, "who has declared his intention to become a citizen of the United States.")

the undersigned, on the 2nd day of January 1903

The length of this claim is (1500) feet,
and L claim (500) feet,

in a n Easterly direction and 100
feet in a Westerly direction from

the center of the discovery shaft, at which this notice is posted, lengthwise of the claim, together
with 300 feet in width of the surface grounds, on each

side of the center of said claim. The general course of the lode deposit and premises is from the
Easterly to the Westerly

The claim is situated and located in the Warren Mining District, in
Cochise County, in the Territory of Arizona, about 3 miles

in a n Easterly direction from Bisbee A. T. adjoining the
Gold Hill Mining Claim on the North and the Little Elsie on West

The surface boundaries of the claim are marked upon the ground as follows: Beginning at
a monument of stones

a point in a Westerly direction 500 feet from
discovery shaft (at which this notice is posted), being in the center of the West
line of said claim; thence 300 feet to a monument of
stones, being the Northwest corner of said claim; thence
1500 feet to a Monument of stone, being at the
North East corner of said claim; thence 300 feet
to a monument of stone at the center of the East end of said claim;
thence 300 feet to a monument of stone, being at the
South east corner of said claim; thence 1500
feet to a monument of stone at the South West corner of said claim;
thence 300 feet to the place of beginning.

All done under the provisions of Chapter Six, of Title XXXII, of the Revised Statutes of
the United States, and of an Act of the General Assembly of Arizona, entitled "An Act to
Revise and Codify the Laws of the Territory of Arizona," approved March 16, 1901.

Dated and posted on the ground this 2nd day of January 1903

Witnessed by

A. K. Campbell.

Ben Gerdes.

Filed and recorded at request of B. F. Graham & Co., Jan 15 A. D.
1903 at 2 P. M. in Book 22, Records of Mines, at page 532.

TERRITORY OF ARIZONA,
 County of..... } ss

I,....., County Recorder in and for the County and Territory aforesaid, do hereby certify that the within instrument was filed for record at..... o'clock,..... M., on this..... day of..... 190..., and duly recorded in Book No..... of..... Records of..... County, Arizona, at pages.....

WITNESS my hand and official seal the day and year first above written.

.....
 County Recorder.

Notice of Location.

LODE CLAIM.

Dated..... 190.....

Filed and recorded at the request of.....

..... A. D. 190.....

at..... M.

Book.....

Page.....

County Recorder.

By.....

Deputy Recorder.

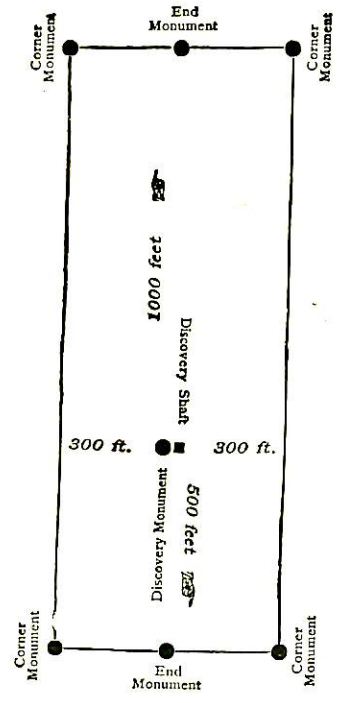

This diagram is to give locator a general idea of plan of location under the new law. The Discovery Shaft can be in the center of claim or any distance from either end desired. In the diagram it is placed 500 feet from one end and 1000 feet from the other. Commence description of claim at a center end monument, giving its distance and direction from center of Discovery Shaft; thence bound the claim in either direction. In description be careful to state locality of claim with reference to some natural object, or permanent monument, as will identify the claim.

Territory of Arizona, ()
County of Cochise :SS. ()

I, Frank Hare, County Recorder in and for said County, hereby certify that I have compared the foregoing copy with the Original Location Notice of the George Washington Mining Claim, filed and recorded in my office on the 19 day of Nov, 1902, in Book 22, Records of Mines, at page 266, and that the same is a full, true and correct copy of such original and of the whole thereof.

Witness my hand and seal of office, this 28th day of April 1904.

Frank Hare

County Recorder.

Notice of Mining Location

31

LODE CLAIM

To All Whom it May Concern:

This Mining Claim, the name of which is the George Washington Mining Claim, situate on lands belonging to the United States of America, and in which there are valuable mineral deposits, was entered upon and located for the purposes of exploration and purchase by John Carretto

(Locator must insert either "a citizen of the United States," or, "who has declared his intention to become a citizen of the United States.")

the undersigned, on the 15th day of November 1902

The length of this claim is 1500 feet, and 1300 claim 1300 feet,

in a easterly direction and 200 feet in a westerly direction from

the center of the discovery shaft, at which this notice is posted, lengthwise of the claim, together with 300 feet in width of the surface grounds, on each

side of the center of said claim. The general course of the lode deposit and premises is from the

easterly to the westerly

The claim is situated and located in the Warner Mining District, in Cochoise County, in the Territory of Arizona, about 3 1/2 miles

in a easterly direction from Bisbee

The surface boundaries of the claim are marked upon the ground as follows: Beginning at

a monument of stones

at a point in a westerly direction 200 feet from

the discovery shaft (at which this notice is posted), being in the center of the west end line of said claim; thence 300 feet to a monument

of stones, being the northwest corner of said claim; thence 1500 feet to a monument of stones being at the

northeast corner of said claim; thence 300 feet to a monument of stones at the center of the east end of said claim;

thence 300 feet to a monument of stones being at the

southeast corner of said claim; thence 1500 feet to a monument of stones at the southwest corner of said claim;

thence 300 feet to the place of beginning.

All done under the provisions of Chapter Six, of Title XXXII, of the Revised Statutes of the United States, and of an Act of the General Assembly of Arizona, entitled "An Act to Revise and Codify the Laws of the Territory of Arizona," approved March 16, 1901.

Dated and posted on the ground this 18th day of November 1902

Witness:

J. Marandino

Antonio Berutto

John Carretto

Filed and recorded at request of John Carretto Nov. 19, 1902 at 11 a.m. Book 22 Record of Mines, page 266.

I,....., County Recorder in and for the County and Territory aforesaid, do hereby certify that the within instrument was filed for record at.....o'clock,..... M., on this.....day of.....190..., and duly recorded in Book No..... of.....Records of.....County, Arizona, at pages.....

WITNESS my hand and official seal the day and year first above written.

..... County Recorder.

Notice of Location.

LODE CLAIM.

Dated.....190.....

Filed and recorded at the request of.....

..... A. D. 190.....

at.....M.

Book.....

Page.....

..... County Recorder.

By..... Deputy Recorder.

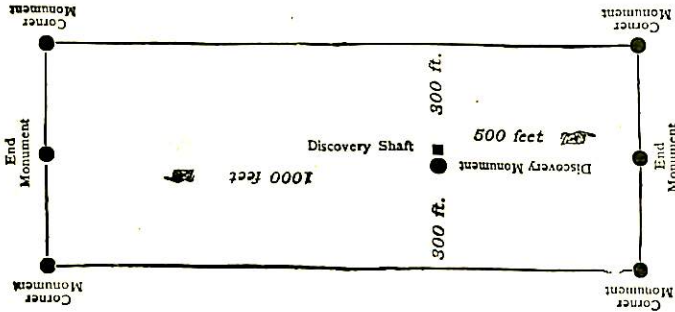

This diagram is to give locator a general idea of plan of location under the new law. The Discovery Shaft can be in the center of claim or any distance from either end desired. In the diagram it is placed 500 feet from one end and 1000 feet from the other. Commence description of claim at a center end monument, giving its distance and direction from center of Discovery Shaft; thence bound the claim in either direction. In description be careful to state locality of claim with reference to some natural object, or permanent monument, as will identify the claim.

Republic of Wisconsin,
County of Dodge,)
()
()

I, Frank Stone, County Recorder in and for said County,
hereby certify that I have compared the foregoing copy with the original
Amended Location Notice of the Stephen Leamon Mining Claim,
filed and recorded in my office on the 5th day of April, 1903, in
Book, 28, Records of Mines, at page 639, and that the same is
a full, true and correct copy of such original and of its whole
contents.

Witness my hand and seal of office, this 25th day of

April, 1904.

Frank Stone

County Recorder.

AMENDED
Notice of Mining Location
LODE CLAIM

To All Whom it May Concern:

This Mining Claim, the name of which is the Copper Brown
Mining Claim, situate on lands belonging to the United States of America, and in which there
are valuable mineral deposits, was entered upon and located for the purposes of exploration and
purchase by A. K. Campbell

(Locator must insert either "a citizen of the United States," or, "who has declared his intention to become a citizen of the United States.")

the undersigned, on the 18th day of December 1900

The length of this claim is Fifteen Hundred feet,
and 1 claim One Hundred feet,
in an easterly direction and Fourteen
hundred feet in a westerly direction from
the center of the discovery shaft, at which this notice is posted, lengthwise of the claim, together
with Three Hundred feet in width of the surface grounds, on each
side of the center of said claim. The general course of the lode deposit and premises is from the

easterly to the westerly

The claim is situated and located in the Warren Mining District, in
Cochoise County, in the Territory of Arizona, about three miles
in an easterly direction from city of Bisbee, Arizona and
paralleling the Penobscott mining claim, on the
north side and adjoining the Horse Shoe on the west end
and lying at the head of Gold Gulch

The surface boundaries of the claim are marked upon the ground as follows: Beginning at
a monument

at a point in an easterly direction One hundred feet from
the discovery shaft (at which this notice is posted), being in the center of the east
end line of said claim; thence Three Hundred feet to a monument
, being the southeast corner corner of said claim; thence
Fifteen hundred feet to a monument, being at the
southwest corner of said claim; thence Three hundred feet
to a monument at the center of the west end of said claim;
thence Three hundred feet to a monument, being at the
North west corner of said claim; thence Fifteen hundred
feet to a monument at the North east corner of said claim;
thence Three hundred feet to the place of beginning.

All done under the provisions of Chapter Six, of Title XXXII, of the Revised Statutes of
the United States, and of an Act of the General Assembly of Arizona, entitled "An Act to
Revise and Codify the Laws of the Territory of Arizona," approved March 16, 1901.

This is an Amended Location Notice of the Copper Brown
Mining Claim, located by A. K. Campbell

on the 18th day of
December 1900, and recorded in Book 18 of Record of Mines, at
page 375, in the office of the County Recorder of the aforesaid County of Cochoise
to which reference is hereby made, and this amended Location Notice is made and posted to
correct errors in the description in the said original Location Notice.

Dated and posted on the ground this 2nd day of September 1903
Witness: A. K. Campbell
C. E. Cummings

Filed and recorded at request of B. F. Graham 16th Sept
5th A. D. 1903 at 9 A. M. Book 28 Records of Mines page 639

TERRITORY OF ARIZONA, }
 County of..... } ss

I,, County Recorder in and for the County and Territory aforesaid, do hereby certify that the within instrument was filed for record at.....o'clock,.....M., on this.....day of.....190..., and duly recorded in Book No..... of.....Records of.....County, Arizona, at pages.....

WITNESS my hand and official seal the day and year first above written.

..... County Recorder.

AMENDED
 Notice of Location.
 LOBE CLAIM.

.....
 Dated 190.....
 Filed and recorded at the request of

.....
 at M.
 Book
 Page
 County Recorder.
 Deputy Recorder.

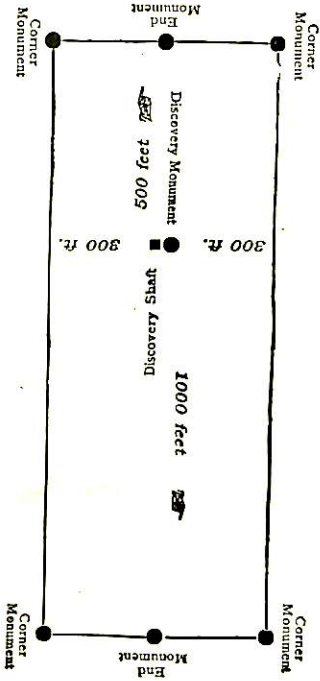

This diagram is to give locator a general idea of plan of location under the new law. The Discovery Shaft can be in the center of claim or any distance from either end and 500 feet from one end and 1000 feet from the other. Commence description of claim at a center end monument, giving its distance and direction from center of Discovery Shaft; thence bound the claim in either direction. In description be careful to state locality of claim with reference to some natural object, or permanent monument, as will identify the claim.

Territory of Arizona, ()
 County of Cochise :SS. ()

I, Frank Ware, County Recorder in and for said County, hereby certify that I have compared the foregoing copy with the Original ^{Amended} Location Notice of the Lily Fraction Mining Claim, filed and recorded in my office on the 15 day of Jan'y. 1904., in Book 30, Records of Mines, at page 31, and that the same is a full, true and correct copy of such original and of the whole thereof.

Witness my hand and seal of office, this 28th day of April 1904.

Frank Ware
 County Recorder.

copy

AMENDED

Notice of Mining Location

LODE CLAIM

To All Whom it May Concern:

This Mining Claim, the name of which is the Lily Fraction Mining Claim, situate on lands belonging to the United States of America, and in which there are valuable mineral deposits, was entered upon and located for the purposes of exploration and purchase by A. K. Campbell (now owned by the Bisbee Queen Development Company) a citizen of the United States. (Locator must insert either "a citizen of the United States," or, "who has declared his intention to become a citizen of the United States.")

the undersigned, on the 24th day of July 1902

The length of this claim is 1500 feet, and 128 1/2 feet, in a northwesterly direction and 137 1/2 feet in a southeasterly direction from the center of the discovery shaft, at which this notice is posted, lengthwise of the claim, together with 300 feet in width of the surface grounds, on each side of the center of said claim. The general course of the lode deposit and premises is from the northwest to the southeast

The claim is situated and located in the Warren Mining District, in Cochise County, in the Territory of Arizona, about 3 miles in an easterly direction from the city of Bisbee, in the upper part of Gold Gulch and about 1 1/2 miles north-east of the Postage Lake Shaft and Hoist.

The surface boundaries of the claim are marked upon the ground as follows: Beginning at a monument of stones

at a point in a northwesterly direction 128 1/2 feet from the discovery shaft (at which this notice is posted), being in the center of the northwest end line of said claim; thence 300 feet to a monument of stones, being the northwest corner of said claim; thence 1500 feet to a monument of stones, being at the northeast corner of said claim; thence 300 feet to a monument of stones at the center of the southeast end of said claim; thence 300 feet to a monument of stones being at the southeast corner of said claim; thence 1500 feet to a monument of stones at the southwest corner of said claim; thence 300 feet to the place of beginning.

All done under the provisions of Chapter Six, of Title XXXII, of the Revised Statutes of the United States, and of an Act of the General Assembly of Arizona, entitled "An Act to Revise and Codify the Laws of the Territory of Arizona," approved March 16, 1901.

This is an Amended Location Notice of the Lily Fraction Mining Claim, located by A. K. Campbell

on the 24th day of July 1902, and recorded in Book 2-1 of Record of Mines, at page 93 1/2, in the office of the County Recorder of the aforesaid County of Cochise to which reference is hereby made, and this amended Location Notice is made and posted to correct errors in the description in the said original Location Notice.

Dated and posted on the ground this 31st day of December 1903

The Bisbee Queen Development Company, a corporation, owner - A. K. Campbell, original locator.

Filed and recorded at request of John McEowan Jany, 15th A. D. 1904 at 9 a.m. Book 30 Records of Mines, page 31.

TERRITORY OF ARIZONA,
 County of..... } ss

I....., County Recorder in and for the County and Territory aforesaid, do hereby certify that the within instrument was filed for record at..... o'clock,..... M., on this..... day of..... 190..., and duly recorded in Book No..... of..... Records of..... County, Arizona, at pages.....

WITNESS my hand and official seal the day and year first above written.

.....
 County Recorder.

AMENDED
Notice of Location.
 LODE CLAIM.

.....

Dated..... 190.....

Filed and recorded at the request of

.....
 A. D. 190.....

at..... M.

Book.....

Page.....

County Recorder.

By.....

Deputy Recorder.

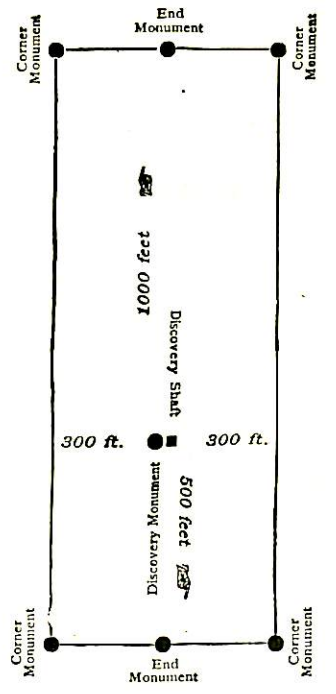

This diagram is to give locator a general idea of plan of location under the new law. The Discovery Shaft can be in the center of claim or any distance from either end desired. In the diagram it is placed 500 feet from one end and 1000 feet from the other. Commence description of claim at a center end monument, giving its distance and direction from center of Discovery Shaft; thence bound the claim in either direction. In description be careful to state locality of claim with reference to some natural object, or permanent monument, as will identify the claim.

Territory of Arizona, ()
 County of Cochise. (:SS.)

I, Frank Hare, County Recorder in and for said County, hereby certify that I have compared the foregoing copy with the Original Amended Location Notice of the Red Cloud Mining Claim, filed and recorded in my office on the 13 day of Feb 190³ in Book, 23, Records of Mines, at page 131, and that the same is a full, true and correct copy of such original and of the whole thereof.

Witness my hand and seal of office, this 28th day of April, 1904.

Frank Hare

County Recorder.

Relocate abandoned property formerly located by Cate Johnson and known as the Last Chance

AMENDED

Notice of Mining Location

37

LODE CLAIM

To All Whom it May Concern:

This Mining Claim, the name of which is the Red Cloud Mining Claim, situate on lands belonging to the United States of America, and in which there are valuable mineral deposits, was entered upon and located for the purposes of exploration and purchase by H. R. Freeman

citizen of the U.S.
(Locator must insert either "a citizen of the United States," or, "who has declared his intention to become a citizen of the United States.")

the undersigned, on the 1st day of January, 1903

The length of this claim is Fifteen Hundred 1500 feet, and 1 claim One Thousand 1000 feet, in a Southeasterly direction and Five Hundred (500) feet in a Northwesterly direction from the center of the discovery shaft, at which this notice is posted, lengthwise of the claim, together with (300) ft. on the north & 200 on the south feet in width of the surface grounds, on each side of the center of said claim. The general course of the lode deposit and premises is from the Northwesterly to the Southeasterly

The claim is situated and located in the Warren Mining District, in Cochise County, in the Territory of Arizona, about five miles in a southeasterly direction from Bisbee and lays among the group of claims known as the Riley & Green group. It joins the Jane Bird on the east the Hilly Fraction on the west & the Belcher on the southwest.

The surface boundaries of the claim are marked upon the ground as follows: Beginning at a monument of stones

at a point in a northerly direction five hundred (500) feet from the discovery shaft (at which this notice is posted), being in the center of the northwest end line of said claim; thence Three hundred (300) feet to a 4x4 post & rock monument, being the north corner of said claim; thence Fifteen hundred (1500) feet to a 4x4 post & monument being at the East corner of said claim; thence Two hundred (200) feet to a monument at the center of the southeast end of said claim; thence Two hundred (200) feet to a 4x4 post & monument being at the South corner of said claim; thence fifteen hundred (1500) feet to a 4x4 post & monument at the west corner of said claim; thence Three hundred (300) feet to the place of beginning.

All done under the provisions of Chapter Six, of Title XXXII, of the Revised Statutes of the United States, and of an Act of the General Assembly of Arizona, entitled "An Act to Revise and Codify the Laws of the Territory of Arizona," approved March 16, 1901.

This is an Amended Location Notice of the Red Cloud Mining Claim, located by H. R. Freeman

on the 1st day of January, 1903, and recorded in Book 23 of Record of Mines, at page 131, in the office of the County Recorder of the aforesaid County of Cochise

to which reference is hereby made, and this amended Location Notice is made and posted to correct errors in the description in the said original Location Notice.

Dated and posted on the ground this 1st day of January, 1903
Witness of Location: H. R. Freeman

Thomas Garner
Geo. Pemberton

Filed and recorded at request of B. F. Graham Feb. 13 A.D. 1903 at 9 A.M. Book 23 Record of Mines page 131

TERRITORY OF ARIZONA, }
County of..... } ss

I,....., County Recorder in and for the County and Territory aforesaid, do hereby certify that the within instrument was filed for record at.....o'clock,.....M., on this.....day of.....190..., and duly recorded in Book No..... of.....Records of.....County, Arizona, at pages.....

WITNESS my hand and official seal the day and year first above written.

.....
County Recorder.

AMENDED
Notice of Location.
LODE CLAIM.

Dated.....190.....

Filed and recorded at the request of

.....
A. D. 190.....

at.....M.

Book.....

Page.....

.....
County Recorder.

By.....
Deputy Recorder.

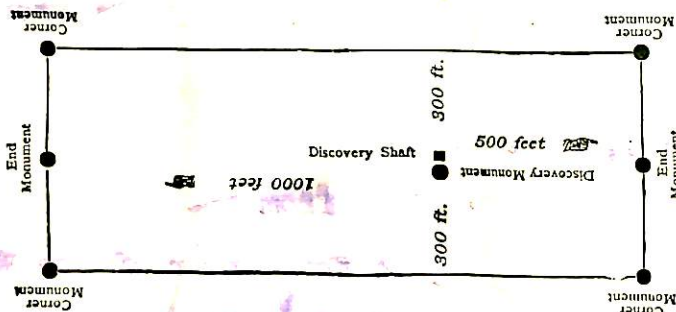

This diagram is to give locator a general idea of plan of location under the new law. The Discovery Shaft can be in the center of claim or any distance from either end desired. In the diagram it is placed 500 feet from one end and 1000 feet from the other. Commence description of claim at a center end monument, giving its distance and direction from center of Discovery Shaft; thence bound the claim in either direction. In description be careful to state locality of claim with reference to some natural object, or permanent monument, as will identify the claim.

4-687.

SURVEYOR-GENERAL'S CERTIFICATE OF APPROVAL OF FIELD
NOTES AND SURVEY OF MINING CLAIM.

Department of the Interior,

Office of U. S. Surveyor-General,

Phoenix, Arizona.

Oct. 18", 1904

I, U. S. Surveyor-General for..... the district of Arizona.....

do hereby certify that the foregoing and hereto attached Field Notes and Return of the Survey of the
Mining Claim of..... B. F. Graham, President, Bisbee Queen Dev. Co.,.....

..... known as the
Bryen, Belcher, Penobscott, Copper Crown, Lily Fraction, Red
Cloud, George Washington, Sunnyside.

situate in..... Warren..... Mining District,
..... Cochise..... County,..... Arizona.....

~~Section~~ APPROX....., Township No. 23 S....., Range No. 24 E. G. & S. R. B. & M
....., designated as Survey No. 1953.....

executed by..... GEO. C. Clark....., U. S. Deputy Mineral
Surveyor,..... Aug. 1st to 20th 1904....., 190....., under my instructions dated

..... June 3rd 1904....., 190....., have been critically examined and the necessary cor-
rections and explanations made, and the said Field Notes and Return, and the Survey they describe,
are hereby approved. A true copy of the copy of the location certificate filed by the applicant.. for
survey is included in the field notes.

Frank S. Johnson

U. S. Surveyor-General for..... Arizona.....

Improvements Survey No. 1953.

Note.

Upon the Junebird Lode which adjoins the Red Cloud Lode of this Survey No. 1953, a three compartment shaft has been sunk for the purpose of developing the underground ore deposits of the entire property of the Bisbee Queen Development Company, and consequently an undivided 1/23 interest in this shaft has been allotted to each of the claims of this group. This Junebird shaft bears from Corner No. 2 Red Cloud Lode South $12^{\circ} 3'$ West 572.0 feet, 6 X 17.7 X 62 three compartment, timbered; value \$4600.00

I certify that the value of the labor and improvements on or for the benefit of this group placed thereon by the claimant, or its grantors, is not less than \$500.00 for each location thereof, and that said improvements consist of:

BRYEN.

- No. 1. Discovery shaft 4 X 6 X 10 bears from West end center of location North $45^{\circ} 52'$ East 500 feet; value \$100.00
- No. 2. An undivided interest in shaft No. 3 Belcher Lode of this Survey; \$100.00
- No. 3. An undivided interest in shaft No. 4 Belcher Lode of this Survey, \$100.00.
- No. 4. An undivided 1/23 interest in Junebird shaft, \$200.00.
- Total improvements Bryen Lode \$500.00.

BELCHER.

- No. 1. Discovery cut 6 X 14 X 20 feet bears from corner No. 3 South $82^{\circ} 51'$ East 690 feet; value \$100.00.
- No. 2. Open cut 6 X 10 X 18 feet bears from same point North $76^{\circ} 15'$ East 135 feet; value \$100.00.
- Note. Open cuts Nos. 3 and 4 so situated as to develop and improve the Bryen Lode of this survey have been allotted wholly to the Bryen Lode.
- No. 3. Open cut 4 X 12 X 9 feet bears from same point South $72^{\circ} 30'$ East 435 feet; value \$100.00.
- No. 4. Open cut 5 X 12 X 9 feet bears from same point South $67^{\circ} 10'$ East 465 feet; value \$100.00.

Improvements Survey No. 1953, Continued.

No. 5.	Open cut 3 X 8 X 5 feet bears from same point North 82° 10' East 830 feet;	value	\$ 25.
No. 6.	Open cut 4 X 16 X 8 feet bears from same point North 82° 55' East 840 feet;	value	\$100.
No. 7.	An undivided 1/23 interest in Junebird shaft;	value	\$200.
	Total Improvements Belcher Lode,		\$525.
PENOBSCOTT.			
No. 1.	Discovery cut 5 X 15 X 10 feet bears from corner No. 1 South 55° 30' West 177 feet;	value	\$100.
No. 2.	Open cut 5 X 10 X 8 feet bears from same point South 51° 54' West 185 feet;	value	\$100.
No. 3.	Open cut 5 X 9 X 6 feet, and shaft 5 X 6 X 4 feet bears from same point South 47° 30' West 203 feet;	value	\$100.
No. 4.	An undivided 1/23 interest in Junebird shaft.	value	\$200.
	Total improvements Penobscott Lode		\$500.
COPPER CROWN.			
No. 1.	Discovery cut 6 X 16 X 12 feet bears from corner No. 1 North 19° 40' East 260 feet;	value	\$100.
No. 2.	Open cut 4.5 X 14 X 6 shaft 4.5 X 8 X 4 bears from same point North 44° 34' West 150 feet;	value	\$100.
No. 3.	Open cut 5 X 15 X 8.5 feet bears from same point North 48° 49' West 155 feet;	value	\$100.
No. 4.	Open cut 4.5 X 14 X 5 feet bears from same point North 7° 10' East 240 feet;	value	\$ 50.
No. 5.	An undivided 1/23 interest in Junebird shaft,		\$200.
	Total improvements Copper Crown Lode		\$550.
LILY FRACTION.			
No. 1.	Discovery cut 4.5 X 12 X 8 feet bears from corner No. 3 North 64° 26' East 355 feet;	value	\$100.
No. 2.	Shaft 4 X 6 X 10 feet, open cut 5 X 24 X 7 feet bears from corner No. 2 North 24° 01' East 625 feet;	value	\$200.
No. 3.	An undivided ^{1/23} interest in Junebird shaft,		\$200.
	Total improvements Lily Fraction Lode		\$500.

Improvements Survey 1953, continued.

RED CLOUD.			
No. 1.	Discovery shaft 4 X 6 X 10 feet bears from corner No. 5 South 26° 29' East 560 feet	value	\$100.
No. 2.	Open cut 4 X 15 X 9 bears from same point South 6° 50' East 250 feet;	value	\$100.
No. 3.	Shaft 4.5 X 6 X 10 feet bears from corner No. 1 North 55° 10' West 170 feet;	value	\$100.
No. 4.	Shaft 5 X 6 X 15 feet bears from same point North 36° 20' West 95 feet;	value	\$150.
No. 5.	Shaft 5 X 6 X 5 feet bears from same point North 19° 30' West 90 feet;	value	\$ 50.
No. 6.	An undivided 1/23 interest in Junebird shaft,		\$200.
	Total improvements Red Cloud Lode		\$700.
GEORGE WASHINGTON.			
No. 1.	Discovery shaft 5 X 6 X 10 feet bears from corner No. 3 North 89° 40' East 240 feet;	value	\$100.
No. 2.	Open cut 4 X 16 X 10 feet bears from same point North 72° 10' East 600 feet;	value	\$100.
No. 3.	Open cut 5 X 16 X 12 bears from same point North 73° 0' East 605 feet;	value	\$100.
No. 4.	An undivided 1/23 interest in Junebird shaft		\$200.
	Total improvements George Washington Lode		\$500.
SUNNYSIDE.			
No. 1.	Discovery cut 4.5 X 10 X 15 feet bears from corner No. 3 North 1° 01' East 2450 feet;	value	\$100.
No. 2.	Open cut 4 X 11 X 14 feet bears from same point North 4° 46' East 245 feet;	value	\$100.
No. 3.	Shaft 4 X 7 X 10 feet bears from same point North 29° 59' West 450 feet;	value	\$100.
No. 4.	Shaft 6 X 8 X 10 feet bears from same point North 12° 58' West 465 feet;	value	\$175.
No. 5.	Shaft 3 X 5 X 4 feet bears from same point North 35° 49' West 340 feet;	value	\$ 25.
No. 6.	An undivided 1/23 interest in June Bird Shaft		\$200.
No. 7.	Total improvements Sunnyside Lode		\$700.

Improvements Survey 1953, continued.

Total improvements on group

\$4475.

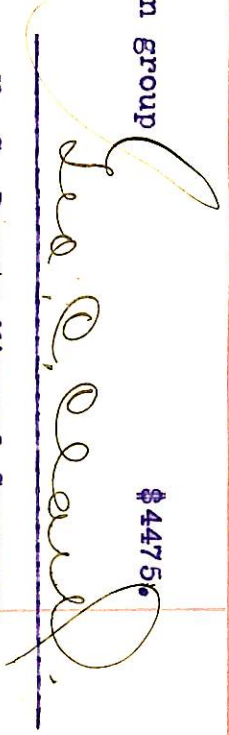
A handwritten signature in cursive script, appearing to read "J. A. Deane", is written over a horizontal line.

U. S. Deputy Mineral Surveyor.

Bisbee, Arizona, Dec. 15th, 1904.

DEC 23 1904

Affidavit of Five Hundred Dollars Improvements.

We, Hugh Millington, and Frank Ragoth

of lawful age, being first duly sworn according to law, depose and say: That we are acquainted with the Bryen, Belcher, Tenabscott, Copper Crown Lily Naclim, Red Cloud, George Washington Pennyside mining claim, situate in Warren Mining district, Cochise County, Arizona Territory, for which Bushie Queen Development Co. by B. J. Graham Trust

has made application for survey prior to application for patent under the provisions of the Act of Congress, approved May 10, 1872; and that the labor done and improvements made thereon by the applicant and its grantors exceed Five Hundred for each location thereof Dollars in value, and further that we are not personally interested in said mine.

Hugh Millington

Frank Ragoth

TERRITORY OF ARIZONA, }
County of Cochise } ss:

Sworn to and subscribed before me, this 15th

day of December, 1904

Corra Smith



(4-691.)

Certificate of U. S. Surveyor General

AS TO

EXPENDITURES REPORTED AFTER RETURN OF SURVEY OF MINING CLAIM.

I, U. S. Surveyor General for Dist. of Arizona,
do hereby certify that Five Hundred Dollars' worth of labor has been expended or
improvements made by claimant or its grantors, upon the mining claim of
Bisbee Queen Development Company

Bryen, Belcher, Penabscott, Copper Crown, Lily Fraction,
known as the Red Cloud, George Washington and Sunnyside,
situate in Warren mining district,
Cochise County, Arizona,
in Section _____, Township No. _____, Range No. _____;
that said improvements consist of 10 shafts, 20 cuts and 8/23 interest
in Junebird working shaft, total value \$4475.00

_____, and that no portion of said labor or improvements has been
included in the estimate of expenditures upon any other claim. A copy of the report of
Franklin W. Smith, U. S. Deputy Mineral Surveyor, dated
Dec. 15, 1904, 18 _____, is hereto attached.



U. S. Surveyor General for Arizona

Office of U. S. Surveyor General,

Phoenix, Arizona,

Dec. 24, 1904, 18 _____

UNITED STATES DEPARTMENT OF THE INTERIOR
 BUREAU OF LAND MANAGEMENT
 ARIZONA STATE OFFICE

9630 (942)
 Group 715

November 28, 1994

Memorandum

To: Chief, Office Section, Branch of Cadastral Survey

From: Chief Cadastral Surveyor

Subject: Notice of Cancellation of Surveys, Navajo Special Meridian, Arizona

Effective November 28, 1994, the surveys of the following townships of the Navajo Special Meridian, Arizona are cancelled.

<u>Surveyed Townships</u>	<u>Partially Surveyed Townships</u>
T. 1 N., Rs. 7, 9, 10, and 11 W.	T. 1 N., Rs. 5, and 8 W.
T. 2 N., Rs. 7, 10, and 11 W.	T. 2 N., Rs. 5, 8, and 9 W.
T. 3 N., Rs. 6, 7, 10, and 11 W.	T. 3 N., Rs. 5, 8, and 9 W.
T. 4 N., Rs. 6, 10, and 11 W.	T. 4 N., Rs. 5, 7, 8, and 9 W.
*T. 5 N., Rs. 6, 10, and 11 W.	T. 5 N., Rs. 5, 7, 8, and 9 W.
T. 6 N., Rs. 6, 7, 9, 10, and 11 W.	T. 6 N., Rs. 5, and 8 W.
T. 7 N., Rs. 7, 9, 10, and 11 W.	T. 7 N., Rs. 5, 6, and 8 W.

Also effective November 28, 1994, the suspension is lifted on the plat approved June 23, 1933, and accepted January 6, 1934, T. 5 N., R. 10 W.

*Portions of T. 5 N., R. 10 W., were resurveyed in 1933 under Group 183 and in 1940-42 under Group 235 for the primary purpose of preserving the identification of the Boundary of Canyon De Chelly National Monument. The portions of those surveys resurveyed in 1991-92 under Group 715, plat accepted August 16, 1994, and the subdivision of sections 10, 22, 25 and 26 in the 1940-42 resurvey are the only portions of the Navajo Special Meridian that remain uncanceled.

This cancellation is to include the 1869 survey of the South and West Boundaries, by Treaty of June 1, 1868, and the subsequent 1919-20 resurvey of the West Boundary of the Navajo Indian Reservation.

Townships surveyed or partially surveyed in New Mexico under the Navajo Special Meridian were cancelled by Memorandum dated June 17, 1936 under memorandum file #1643519 "E" and included the following townships:

T. 1 N., Rs. 1, 2, and 3 W.	T. 9 N., Rs. 1, 2, 3, and 4 W.
T. 2 N., Rs. 1, and 5 W.	T. 10 N., Rs. 1, 2, 3, 4, and 5 W.
T. 3 N., Rs. 1, and 5 W.	T. 11 N., Rs. 1, 2, 3, 4, and 5 W.
T. 4 N., Rs. 1, 2, and 5 W.	T. 12 N., Rs. 3, 4, and 5 W.
T. 5 N., Rs. 1, and 2 W.	T. 13 N., Rs. 1, 2, 3, 4, and 5 W.
T. 6 N., Rs. 1, 2, 3, and 4 W.	T. 14 N., Rs. 3, 4, and 5 W.
T. 7 N., Rs. 1, 2, and 3 W.	
T. 8 N., Rs. 1, 2, 3, and 4 W.	

By Directors' Letter dated May 11, 1951, the surveys executed in Arizona under the Navajo Special Meridian in Tps. 8, 9, 10, 11, 12, 13, 14, 15 N., Rs. 5, 6, 7, 8, 9, 10, and 11 W. were cancelled. In particular they are:

Surveyed

T. 8 N., Rs. 9, 10, and 11 W.
 T. 9 N., Rs. 9, 10, and 11 W.
 T. 10 N., Rs. 5, 9, and 10 W.
 T. 11 N., Rs. 5, 9, 10, and 11 W.
 T. 12 N., Rs. 9, 10, and 11 W.
 T. 13 N., Rs. 9, 10, and 11 W.
 T. 14 N., Rs. 5, 6, 7, 8, 9, 10, and 11 W.
 T. 15 N., Rs. 7, 8, 9, and 10 W.

Partially Surveyed

T. 8 N., Rs. 6, 7, and 8 W.
 T. 9 N., Rs. 5, 6, and 8 W.
 T. 10 N., Rs. 6, 7, 8, and 11 W.
 T. 11 N., Rs. 6, 7, and 8 W.
 T. 12 N., Rs. 5, and 6 W.
 T. 13 N., Rs. 5, 6, 7, and 8 W.
 T. 15 N., Rs. 5, 6, and 11 W.

Unsurveyed

T. 8 N., R. 5 W.
 T. 9 N., R. 7 W.
 T. 12 N., Rs. 7, and 8 W.

By Memorandum dated January 29, 1992, File No. 9630 (942), this office, Tps. 1 and 2 N., R. 6 W. were cancelled.

A copy of this memorandum will be placed at the front of each of the following original field note books, located at the Arizona State Cadastral Survey Office, containing the field notes of the affected surveys.

BOOK: 1932, 1933, 1934, 1935, 1936, 1937, 1938, 1939, 1940, 1941, 1942, 1943, 1944, 1945, 1946, 1947, 1948, 1949, 1950, 1951, 1952, 1953, 1954, 1955, 1956, 2627, 3342, 3502, 3966, 4288

The notation, "Cancelled November 28, 1994 per Memorandum File No. 9630 (942) Group 715, Arizona," will be made on the following plats:

Approved February 28, 1870

T. 1 N., Rs. 9, and 10 W.
 T. 2 N., R. 10 W.
 T. 3 N., R. 10 W.
 T. 4 N., R. 10 W.
 T. 5 N., R. 10 W.
 T. 6 N., R. 10 W.
 T. 7 N., R. 10 W.

Approved May 7, 1870

T. 6 N., R. 9 W.
 T. 7 N., R. 9 W.

Approved May 23, 1870

T. 1 N., R. 7 W.
 T. 2 N., R. 7 W.
 T. 3 N., Rs. 6, and 7 W.
 T. 4 N., R. 6 W.
 T. 5 N., R. 6 W.
 T. 6 N., Rs. 6, and 7 W.
 T. 7 N., R. 7 W.

Approved March 7, 1871

T. 1 N., R. 11 W.
 T. 2 N., Rs. 5, and 11 W.
 T. 3 N., Rs. 5, and 11 W.
 T. 4 N., Rs. 5, and 11 W.
 T. 5 N., R. 11 W.
 T. 6 N., R. 11 W.
 T. 7 N., R. 11 W.

The notation, "Cancelled November 28, 1994, except for those portions resurveyed in 1991-92, Group 715, plat accepted August 16, 1994, and the survey of the subdivision of sections 10, 22, 25 and 26 on this plat, per Memorandum File No. 9630 (942) Group 715, Arizona," will be made on the following plat:

T. 5 N., R. 10 W., approved December 3, 1943, and accepted December 23, 1943.

The notation, "Suspension Lifted, November 28, 1994, per Memorandum File No. 9630 (942) Group 715, Arizona," will be made on the following plat:

T. 5 N., R. 10 W., approved June 23, 1933, and accepted January 6, 1934.

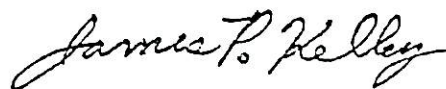

James P. Kelley

MAR