

**MS -**

**0**

**2**

**1**

**2**

**0**



# **POOR QUALITY**

**The following pages are scanned at the best possible quality setting. The original pages are of poor quality and this is the best possible reproduction.**

MINERAL SURVEY NO. 2120

Claims	M & B Desc.	Improvements	Loc. Notices
	Pg.	Pg.	
Devereux	3	10	137205
Happie	8	10	
Old Soldier	8	10	
Station	5	10	
U.S.	7	10	
William	1	10	

JUL 3-1905 1

(4-683.)

Mineral Survey No. <sup>2120</sup> ~~2085~~

Lot No. \_\_\_\_\_

Gila Land District.

### FIELD NOTES

OF THE SURVEY OF THE MINING CLAIM OF

Novae A Smith

KNOWN AS THE

William "U. S." Station "Happy" Old Soldier  
Deveraux  
Warren Mining District.

Cochise County, Arizona

Section approx, Township 23 S, Range 24 E ~~9th S. 18th W.~~ unsurveyed

Surveyed under instructions dated June 20<sup>th</sup>, 1905-

by Franklin W Smith  
U. S. Deputy Mineral Surveyor

Claim located see notices 1

Survey commenced June 22<sup>nd</sup> 1905

Survey completed June 24<sup>th</sup> 1905

Post office address of claimant  
Bushy, Cochise County  
Arizona

Trail corrected ✓  
Ledges ✓  
Dike ✓  
area ✓

Feet

No. 2120  
William

1

Beginning at <sup>0</sup>Cor. No. 1 the SE cor., situated on the N end line of Station lode of this survey, and identical with Cor. No. 4 Devereux lode of this survey, a pine post 4 ft long 4 ins sq set 1 ft in the ground in a mound of stones and scribed 1-2120 W L, hence a pine post of same dimensions and scribed B. P. 1-2120 brs. N. 40° 24' E 25 ft and a second pine post of same dimensions and scribing brs. N. 41° <sup>35'</sup>~~35'~~ W. 25 ft no bearing monuments available, and NW or Sec 2 Tp 24 S R 24 E G & S R B & M brs. S. 3° <sup>32' 30"</sup>~~30'~~ W. 7316.8 ft., and original location brs. S. 41° 35' E. 100 ft.  
Thence N. 41° 35' W

300.  
~~291.8~~

to original location for S E C

600.0

same bearing to Cor. No. 2, the SW cor., identical with location, with Cor. No. 3 Gap lode, Survey No. 1873 and Cors. No. 3 and 4 respectively of Station and Happie lodes of this survey a pine post 4 ft long 4 ins sq set 1 ft in the ground in a mound of stones and scribed 2-2120 W L whence a pine post of same dimensions and scribed B.P. 2-3-4-2120 brs. N. 41° 35' W. 25 ft and a second pine post of same dimensions and scribing brs. S. 41° 35' E. 25ft., no bearing monuments available,

Thence N. 40° 24' E.

1500.0

to Cor. No. 3, the NW cor identical with location and with Cors. No. 2, 2 and 1 respectively of Gap lode, Survey No. 1873, McKinley and Rhine lodes survey No. 1872, a pine post 4 ft long 4 ins sq set 1 ft in the ground in a mound of stones and scribed <sup>1-2-2-3-2120-B.P. brs.</sup> S. 40° 24' W. 25 ft, and a second pine post of same dimensions and scribing brs. S. 41° 35' E. 25 ft., no bearing monuments available,

Thence S. 41° 35' E.

300.  
~~280.0~~

along line 1-2 Rhine lode, Survey No. 1872 to original location for N E C,

571.2

same bearing to Cor. No. 4, the NE cor., identical with location and at the point of intersection of line ~~1-2-3~~ Rhine lode, Survey No. 1872



with line 1-4 Helena lode, Survey No.1918 a pine post 4 ft long 4 ins sq set 1 ft in the ground in a mound of stones and scribed 4-2120 W L whence a pinepost of same dimensions and scribed B. P. 4-2120 brs.N.  $41^{\circ} 35' W.$  <sup>3</sup> 35 ft., and a second pine post of same dimensions and scribing brs. S.  $44^{\circ} 13' W.$  25 ft., no bearing monuments available,

Thence S.  $44^{\circ} 13' W.$

551.5 along line <sup>1-4</sup> 4-3 Helena lode, Survey No.1918 to Cors.No.4 and 1 respectively of Helena and Ivanhoe lodes, Survey No.1918

1152.1 same bearing to Cor.No.5, identical with Cor.No.4 Ivanhoe lode Survey No.1918 a pine post 4 ft long 4 ins sq set 1 ft in the ground in a mound of stones and scribed 5-2120 W. L, whence a pine post of same dimensions and scribed B. P. 5-2120 brs. S,  $55^{\circ} 34' E.$  25 ft., and a second pine post of same dimensions and scribing brs. N.  $44^{\circ} 13' E.$  25 ft., no bearing monuments available,

Thence S.  $55^{\circ} 34' E.$

92.5 along line 4-3 Ivanhoe lode, Survey No.1918 to the intersection of line 4-1 Bridge lode of the same survey, at S.  $30^{\circ} 54' W.$  30.5 ft from Cor.No.1 Bridge lode, which point being cor No.6, a pine post 4 ft long 4 ins sq set 1 ft in the ground in a mound of stones and scribed 6-2120 W L, whence a pine post of same dimensions and scribed 6-2120 brs. N.  $55^{\circ} 34' W.$  25 ft and a second pine post of same dimensions and scribing brs. S.  $30^{\circ} 54' W$  25 ft. no bearing monuments available,

Thence S.  $30^{\circ} 54' W.$

85.4  
854

along line 1-4 Bridge lode, Survey No.1918 to Cor.No.7 identical with Cor.No.5 Devereux lode of this survey, a pine post 4 ft long 4 ins sq set 1 ft in the ground in a mound of stones and scribed 7-2120 W L whence a pine post of same dimensions and scribed B. P. 5-7-2120 brs N.  $30^{\circ} 54' E.$  25 ft and a second pine post of same dimensions and scribing brs. S.  $40^{\circ} 24' W.$  25 ft., no bearing monuments

available,

Thence S. 40° 24' W

279.9 to Cor.No.1 the place of beginning.

Ledge.

The presumed course of the vein on this claim is from the S E C location N. 40° 24' E. 1500 ft.,

-----  
Devereux.

Beginning at Cor.No.1 the SE cor identical with location and with Cor.No.3 Bridge lode, Survey No.1918 a pine post 4 ft long 4 ins sq set 1 ft in the ground in a mound of stones and scribed 1-2120 D L whence a pine post of same dimensions and scribed B. P. 1-2120 brs N. 57° 56' W. 25 ft., and a second pine post of same dimensions and scribing brs. N. 10° 13' E. 25 ft., no bearing monuments available, and NW cor Sec 2 Tp 24 S R 24 E G & S R B & M brs. ~~S. 05° 33' W. 73~~ S. 5° 28' ~~49'~~ W. 634.8 ~~634.85~~ ft.,

Thence N. 57° 56' W.

280.0 to original location for S E C.

540.4  
540.4 same bearing to Cor.No.2 the SW cor identical with location and situated on line 1-2 Station lode of this survey a pine post 4 ft long 4 ins sq set 1 ft in the ground in a mound of stones and scribed 2-2120 DL whence a pine post of same dimensions and scribed B. P. 2-2120 brs. S. 57° 56' E. 25 ft and a second pine post of same dimensions and scribing brs. N. 26° 31' E. 25 ft., no bearing monuments available,

Thence N. 26° 31' E.

50.5 to the intersection of line 1-4 Bridge lode, Survey No. 1918 at N. 52° 40' W. 547.6 ft. from Cor.No.3, Bridge lode,

726.7 same bearing to the intersection of line 4-1 Bridge lode Survey No.1918 at N. 30° 54' E. 668.5 ft. from Cor.No.4

5  
Feet

4 Station

754.2 same bearing to Cor.No.3 identical with Cor.No. ~~2~~ ~~Bridge~~ lode of this survey, a pine post 4 ft long 4 ins sq set 1 ft in the ground in a mound of stones and scribed 3-2120 D L whence a pine post of same dimensions and scribed B.P 3-4-2120 brs. S.  $26^{\circ} 31' W.$  25 ft and a second pine post of same dimensions and scribing brs. N.  $41^{\circ} 35' W.$  25 ft no bearing monuments available,

Thence N.  $41^{\circ} 35' W.$

46.2 to Cor.No.4, situated on line 4-3 Station lode of this survey and identical with Cor.No.1 William lode of this survey a pine post etc scribed 4-2120 D L,

Thence N.  $40^{\circ} 24' E.$

279.9 to Cor.No.5 the NW cor identical with Cor.No.7 William lode of this survey and situated on line 4-1 Bridge lode Survey No.1918 N.  $30^{\circ} 54' E.$  985.8 ft from Cor.No.4, a pine post etc and scribed 5-2120 D L, and original location for NW cor brs. N.  $57^{\circ} 56' W.$  100 ft.,

Thence S.  $57^{\circ} 56' E.$

100.0 to original location for N E C

200.0 same bearing to Cor.No.6 the NE cor identical with location a pine post 4 ft long 4 ins sq set 1 ft in the ground in a mound of stones and scribed 6-2120 D L whence a pine post of same dimensions and scribing <sup>ed BP 6-2120</sup> brs. S.  $10^{\circ} 13' W.$  25 ft and a second pine post of same dimensions and scribing brs. N.  $57^{\circ} 56' W.$  25 ft., no bearing monuments available,

Thence S.  $10^{\circ} 13' W.$

1121.1 to Cor.No.1 the place of beginning.

Ledge

The presumed course of the vein on this claim is from the  $\text{N E C}$  location S.  $19^{\circ} 13' W.$  1067.6 ft.,



Beginning at Cor.No.1 the SE cor identical with location a pine post 4 ft long 4 ins sq set 1 ft in the ground in a mound of stones and scribed 1-2120 S L, whence a pize post of same dimensions and scribed B B 1-2120 brs. N. 26° 31' E. 25 ft and a second pine pot of same dimensions and scribing brs. N. <sup>41</sup>21° 35' W. 25 ft no bearing monuments available, and NW cor Sec. 2 Tp 24 S R 24 E G & S R B & M. brs. S. 1° 48' <sup>30"</sup>E. ~~5928.6~~ <sup>5928.6</sup> ft.,

Thence N. 41° 35' W.

323.1

to original location for S E C,

646.2

same bearing to Cor.No.2, the SW cor., identical with location and with Cor.No.1 Happie lode of this survey, a pine post etc scribed 2-2120 S L,

Thence N. 26° 31' E. ~~36~~

360.0

to the intersection of the E P & S W R R *Cause N. H. to Don Lund*

1500.0

same bearing to Cor.No.3 the NW cor., identical with location and with Cors.No.2 and 4 William and Happie lodes of this survey and Cor.No.3 Gap lode, Survey No.1873, a pine post etc scribed 3-2120 S L,

Thence S. 41° 35' E.

323.1

to ororiginal location for N E C.,

~~660.0~~

same bearing to <sup>Cors</sup> ~~re~~ No.1 <sup>and 4 respectively</sup> William lodes of this survey, <sup>and Devereux</sup>

646.2

same bearing to Cor.No.4 the NE cor identical with location and with Cor.No.3 Devereux lode of this survey a pine post etc scribed 4-2120 <sup>5</sup> S L,

Thence S. 26° 31' W.

27.5

to the intersection of line 4-1 Bridge lode, Survey No.1918 at N. 30° 54' E. 668.5 ft. from CorNo.4,

703,7

same bearing to the intersection of line 3-4 Bridge lode Survey No.1918 at S. 52° 40' E. 52 ft from Cor.No.4,

754.2

same bearing to Cor.No.2 Devereux lode of this survey

850.0

same bearing to the intersection of the Douglas branch of the E.P & S W R R *Co. cause, S.E.*

870.0

same bearing to the intersection of the Osborne branch to the of the E P & S W R R, *cause S.E.*

1500.0

same bearing to Cor.No.1 the place of beginning.

Ledge.

The presumed course of the vein on this claim is from the S E C location N. 26° 31' E. 1500 ft.

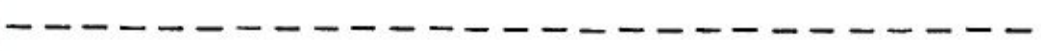

Happle.

Beginning at Cor.No.1 the SE cor identical with location and with Cor.No.2 Station lode of this survey, a pine post 4 ft long 4 ins sq set 1 ft in the ground in a mound of stones and scribed 1-2120 H L whence a pine post of same dimensions and scribed B. P. 1-2-2120 brs. S. 41° 35' E. 25 ft and a second pine post of same dimensions and scribing brs. N. 41° 35' W. 25 ft., and no bearing monuments available, and NW cor Sec 2 Tp 24 S R 24 E G & S R B & M. brs. S. 5° 29' <sup>30''</sup> E. <sup>6438.3</sup> ~~6455.2~~ ft.,

Thence N. 41° 35' W.

295.9<sup>9</sup> to original location for S E C.

595.9 same bearing to CorNo.2, the SW cor identical with location and with Cor.No.1 U S lode of this survey, a pine post etc scribed 2-2120 H L

Thence N. 26° 31'E.

90.0 to the intersection of the Don Luis branch of the E.P. & S.W.R.R., *bearing N.W. direction*

1500.0 same bearing to Cor.No.3 the NW cor identical with location, with Cor.No.4 U.S.lode of this survey and with Cors.No.3 and 4 respectively of Reed and Gap lodes, Survey No.1873, a pine post 4 ft long 4 ins sq set 1 ft in the ground in a mound of stones and scribed 3-2120 H L whence a pine post of same dimensions and scribed B.P. 3-4-2120 brs N. 41° 35' W. 25 ft and a second pine post of same dimensions and scribing brs. S. 41° 35' E. 25 ft.,

Thence S. 41° 35' E.

300.0 along line 4-3 Gap lode, Survey No.1873 to original location for N E C.,

595.9 same bearing to Cor.No.4 the NE cor., identical with Cors No.3 and 2 respective of Station and William lodes of this survey and Cor.No.3 Gap lode Survey No.1873 a pine post

etc scribed 4-2120 H L

Thence S. 26° 31' W.

1140.0  
1500

to the intersedtion of the EP. & S W R R., *course N. W. to*  
same bearing to Cor.No.1, the place of beginning.

*Don Luis*

Ledge.

The presumed course of the vein on this claim is from the S E C location N. 26° 31' E. 1500 ft.,

U. S..

Beginning at Cor.No.1, the SE cor identical with location and with Cor.No.2 Happie lode of this survey a pine post 4 ft long 4 ins sq set 1 ft in the ground in a mound of stones and scribed 1-2120 U S L, whence a pine post of same dimensions and scribed B. P.1-2-2120 brs.N. 41° 35' W. 25 ft and a xecond pine post o same dimensions and scribing brs. S. 41° 35' E. 25 ft., no bearing monuments available, and NW cor Sec 2 Tp 24 S R 24 E G & S R B & M Brs. S. 8° 23' 30" E. 6928. <sup>9</sup> ft.,

Thence N. 41° 35' W.

190  
319.0  
534.4  
599.0

to the intersection of the Don Luis Brank <sup>a</sup> of the E P & S W R R. *bearing N.W. direction*

same bearing to original location for S E C .,

same bearing to the intersection of the E side line of the Old Statton lode, unsurveyed S. 0° 39' E. 1352.1 ft from the NE cor.,

same bearing to Cor.No.2, the SW cor identical with location a pine post 4 ft long 4 ins sq set 1 ft in the ground in a mound of stones and scribed 2-2120 U S L whence a pine post of same dimensions and scribed B.P. 2-2120 brs.S.41° 35' E. 25 dft and a second pine post of same dimensions and scribing. brs. N. 26° 31' E. 25 ft no bearing monuments available,

Thence N. 26° 31' E.

92.7

to Cor.No.1 Old Soldier lode of this survey, being the point of intersection of the E side line of Old Statton



lode, unsurveyed, at S. 0° 39' E. 1220.8 ft from the NE cor.,

1500.0 same bearing to Cor.No.3 the NW cor identical with location, with Cor.No.4 Old Soldier lode of this survey and with Cors.No.3 and 4 respectively of Gage and Reed lodes, Survey No.1873, a pine post 4 ft long 4 ins sq set 1 ft in the ground in a mound of stones and scribed 3-2120 U S L, whence a pine post of same dimensions and scribed B. P. 3-4-2120 brs N. 41° 35' W. 25 ft and a second pine post of same dimensions and scribing brs S 41° 35' E. 25 ft no bearing monuments available,

Thence S. 41° 35' E.

280.0 to original location for N E C.,

599.0 same bearing to Cor.No4, the NE cor., identical with location with Cor.No.3 Happie lode of this survey and with Cors No.3 and 4 respectively Reed and Gap lodes Survey No.1873, a pine post etc scribed 4-2120 U S L

Thence S. 26° 31' W

1410.0 to the intersection of the E P. & S W R R., *from NW to Don Luis*

1500.0 same bearing to Cor.No.1 the place of beginning.

Ledge.

The presumed course of the vein on this claim is from the S E C location N. 26° 31' E. 1500 ft.

-----  
Old Soldier.

Beginning at Cor.No.1 the SE cor identical with location situated on line 2-3 U. S lode of this survey and on the E side line of Old Stratton lode <sup>d. unsurveyed</sup> S. 0° 39' E 1220.8 ft from the NE cor, a pine post 4 ft long 4 ins sq set 1 ft in the ground in a mound of stones and scribed <sup>1-2/20, O.S.L.</sup> ~~3-2120~~ <sup>U.S.L.</sup> whence a pine post of same dimensions and scribed B. P. 3-2120 brs. N. 41 ° 35' W. 25 ft and a second pine post of same dimensions and scribing brs. N. 26° 31' E. 25 ft., no bearing monuments available, and NW cor Sec 2 Tp 24 S R 24 E G & S R B & M brs.S.10° 29' 30" E. <sup>7511.4</sup> ~~7508.6~~ ft.

Thence N. 41° 35' W.

290.9 to original location ~~to~~ S E C

600.9 same bearing to Cor.No.2 the SW cor., identical with location a pine post 4 ft long 4 ins sq set 1 ft in the ground in a mound of stones and scribed 2-2120 0 S L whence a pine post of same dimensions and scribed B.P. 2-2120 brs. N. 26° 31' E. ~~25~~<sup>4</sup> ft and a second pine post of same dimensions and scribing brs. S. 41° 35' ~~N~~<sup>E</sup> 25 ft no bearing monuments available,

Thence N. 26° 31' E.

862.0 to the NE cor Old Stratton lode, unsurveyed,

1407.3 same bearing to Cor.No.3, the N W cor identical with location with Cors.No.3 and 4 respectively of Alger and Gage lodes, Survey No. 1873 and with the NE cor of Goden ~~Eagle~~<sup>Eagle</sup> lode unsurveyed, a pine post ~~4~~<sup>2</sup> ft long 4 ins sq set 1 ft in the ground in a mound of stones and scribed 3-2120 0 S L, whence a pine post of same dimensions and scribed B.P. 3-2120 S. 26° 31' W. 25 ft and a second pine post of same dimensions and scribing brs. S. 41° 35' E. 25 ft., no bearing monuments available,

Thence S. 41° 35' E. ~~310~~

310.0 along line 4-3 Gage lode, Survey No.1873 to original location for N E C.

600.9 same bearing to Cor.No.4 the NE cor identical with location and with Cor.No.3 U S lode of this survey and with Cors No.3 and 4 respectively of Gage and Reed lodes, Survey No.1873, a pine post etc scribed 4-2120 0 S L,

Thence S. 26° 31' W.

1407.3<sup>3</sup> to Cor.No.1 the place of beginning.

Ledge.

The presumed course of the vein on this claim is from the S E C location N. ~~26° 31'~~<sup>26° 31'</sup> E. 1407.3

AREA

Total area Old Soldier lode,	✓ 18.012 ✓ ac
Less area in conflict with Old Stratton lode unsurveyed,	✓ 5.516 ✓
Net area Old Soldier lode	✓ 12.496 ✓ ac
Total area U.S.	✓ 19.138 ✓
Less area in conflict with Old Stratton lode unsurveyed	✓ 0.064 ✓
Net area U S.	✓ 19.074 ✓
Total and net area Happie lode,	✓ 19.039 ✓
Total area Station lode,	✓ 20.646 ✓
Less area in conflict with Bridge lode Survey No. 1918	✓ 0.426 ✓
Net area Station lode	✓ 20.220 ✓
Total area Devereux lode,	✓ 9.201 ✓
Less area in conflict with Bridge lode Survey No. 1918	✓ 8.734 ✓
Net area Devereux lode,	✓ 0.467 ✓
Total and net area William lode,	✓ 18.687 ✓
Net area group	✓ 89.983 ✓ <i>as</i>

IMPROVEMENTS.

I certify that the value of the labor and improvements on this group placed thereon by the claimant or his grantors is as follows:

William.		
No.1	Discovery shaft 4x6x10 ft brs from S E C location N. 40° 24' E. 170 ft., Value	100.00
Devereux,		
No.1	Discovery shaft 4x6x10 ft. brs from S E C location N 19° 13' W. 10 ft., Value	100.00
Station,		
No.1	Discovery shaft 4x6x10 ft brs from N E C location S. 26° 31' W. 250 ft., Value	100.00
Happie		
No.1	Discovery shaft 4x6x10 ft brs from N E C locati n S. 26° 31' W. 180 ft., Value	100.00
U. S.		
No.1	Discovery shaft 4x6x10 ft brs from N E C location S. 26° 31' W. 240 ft., Value	100.00



## Improvements on Old Soldier

No. 1 Discovery shaft 4x6x10 ft hrs from N E Clocation S.

26° 31' W. 230 ft; Value

100.00

Note

Complete affidavit of \$500 improvements will be furnished before the expiration of publication.

## ADJOINING CLAIMS.

North Alger, Gage, Reed and Gap lodes Survey No. 1873  
M. J. Cunningham et al owners; McKinley and Rhine lodes  
No. ~~1788~~<sup>1872</sup> same owners;

East Bridge, Helena and Ivanhoe lodes Survey No. 1918 owned by  
I. W. Wallace et al.,

South Unsurveyed ground owners unknown.

West Old Stratton lode unsurveyed, John Kinsella et al owners.  
Golden Eagle lode, unsurveyed, Jacob Pirrung owner.

## LOCATION.

This claim is located about 1 mi in an E direction from the Don Luis Station on the E P & S W R R on unsurveyed lands in the Warren<sup>e</sup> Mining District, Cochise County Territory of Arizona, approximately in Tp 23 S R 24 E G & S R B & M.

## INSTRUMENTAL

This survey was made with a C. L. Berger & Sons No. 1 C transit the courses were deflected from the true meridian as determined by solar observation checked by an observation on polaris; the distances were measured by a 300 ft steel tape. Magnetic variation 12° 30' E.

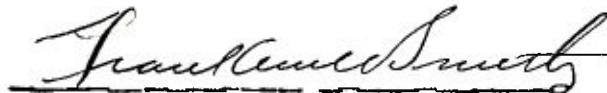

U. S. Deputy Mineral Surveyor.

Dated at Bisbee, Arizona.

June 27<sup>th</sup> 19 05.

Note

Any discrepancies between the courses and distances of this survey and those of the adjoining approved surveys are due to errors in the latter.

0 1d Soldier. *etal*  
*See No 2120*

*NOTE* :- The NW cor of Sec 2 Tp 28 S. R 24 E G & S R B & M  
having been established, the claims embraced in this  
survey have been tied to that cor. and not No. U S M M  
No. 1872.

DIRECTIONS.—1. Carry out the area in acres to three decimals, and all other calculations to two decimals only.

2. In balancing Lat. and Dep. do not obliterate or change the original figures:

Put the corrected figure or figures above in red ink. Do not change the footing of the original figures, but put below them the corrected footing in red ink.

The corrections for balancing fallings should be proportional to the lengths of the lines.

3. In calculations of fallings take result to nearest hundredth. In calculations of N. and S. areas drop all after second decimal. Deputies are cautioned not to use tables that do not give results exact to the decimal specified.

TABLING AND CALCULATIONS OF Happy & William. SURVEY No. \_\_\_\_\_

No.	COURSE.	DISTANCE.	LATITUDES.		DEPARTURES.		DOUBLE M. D.	N. AREAS.	S. AREAS.
			NORTH.	SOUTH.	EAST.	WEST.			
<i>Happy</i>									
	N 26° 31' E	150000	134220		66969		66969	89885792	
	S 41° 35' E	59590		44573	39550		173488		77328806
	S 26° 31' W	150000		134220		66969	146069		196053812
	N 41° 35' W	59590	44573		39550		39550	17628621	
								<u>107514413273382618</u>	
									19.039
<i>William</i>									
	N 40° 24' E	150000	114231		97218		97196	111049346	
	S 41° 35' E	57120		42726	37910		232293		99230924
	S 44° 13' W	115211		82572		80344	189832		156715808
	S 55° 34' E	9250		5230	7629		117098		6123054
	S 30° 54' W	8540		7328		4386	120339		8817239
	S 40° 24' W	27920		21316		18140	97808		20844841
	N 41° 35' W	60000	44877		39823		39832	17879788	
								<u>128929134291731866</u>	
								128929134	
								162862732	
								81401366	
								43560	
								378413	
								348480	
								299336	
								261360	
								379766	
								348480	
								<u>312560</u>	18.687



---

**TRAVERSE SHEET.**

---

*Survey No.*.....

*Claim*.....

---

---

DIRECTIONS.—1. Carry out the area in acres to three decimals, and all other calculations to two decimals only.

2. In balancing Lat. and Dep. do not obliterate or change the original figures:  
Put the corrected figure or figures above in red ink. Do not change the footing of the original figures, but put below them the corrected footing in red ink.

3. In calculations of fallings take result to nearest hundredth. In calculations of N. and S. areas drop all after second decimal. Deputies are cautioned not to use tables that do not give results exact to the decimal specified.

TABLING AND CALCULATIONS OF United States Station, SURVEY No. \_\_\_\_\_

No.	COURSE.	DISTANCE.	LATITUDES.		DEPARTURES.		DOUBLE M. D.	N. AREAS.	S. AREAS.	Acres	
			NORTH.	SOUTH.	EAST.	WEST.					
<u>(United States) Area in Conflict with Old Stratton</u>											
	N 26° 31' E ✓	9270	8295 ✓		4139 ✓		4139 ✓	343371 ✓			
	S 0° 39' E ✓	13130		13128 ✓	149 ✓		8426 ✓		1106165 ✓		
	N 41° 35' W ✓	6460	4832 ✓			4287 ✓	4287 ✓	207148 ✓			
	<u>Net Area U.S. 19.074</u>								550519	1106165	0.064 ✓
<u>Station</u>											
	N 26° 31' E ✓	150000	134220 ✓		66969 ✓		66969 ✓	89885792 ✓			
	S 41° 35' E ✓	64620		48335 ✓	42889 ✓		176827 ✓		85469330 ✓		
	S 26° 31' W ✓	150000		134220 ✓		66969 ✓	152747 ✓		205017023 ✓		
	N 46° 35' W ✓	64620	48335 ✓			42889 ✓	42889 ✓	20730398 ✓			
									110616190290486353		
<u>Area of Station in Conflict with Bridge</u>											
	N 30° 54' E ✓	66850	57362 ✓		34330 ✓		34327 ✓	19688937 ✓			
	S 26° 31' W ✓	67620		60506 ✓		30189 ✓	38462 ✓		23273741 ✓		
	N 52° 40' W ✓	5200	3154 ✓			4135 ✓	4135 ✓	130418 ✓			
									19688937	23404159	0.426 ✓
<u>Net Area Station - 20.220 Acres.</u>											

---

**TRAVERSE SHEET.**

---

*Survey No.*.....

*Claim*.....

---



- DIRECTIONS.—1. Carry out the area in acres to three decimals, and all other calculations to two decimals only.  
 2. In balancing Lat. and Dep. do not obliterate or change the original figures:  
 Put the corrected figure or figures above in red ink. Do not change the footing of the original figures, but put below them the corrected footing in red ink.  
 The corrections for balancing fallings should be proportional to the lengths of the lines.  
 3. In calculations of fallings take result to nearest hundredth. In calculations of N. and S. areas drop all after second decimal. Deputies are cautioned not to use tables that do not give results exact to the decimal specified.

TABLING AND CALCULATIONS OF Old Soldier, SURVEY No. \_\_\_\_\_

No.	COURSE.	DISTANCE.	LATITUDES.		DEPARTURES.		DOUBLE M. D.	N. AREAS.	S. AREAS.	Acres.
			NORTH.	SOUTH.	EAST.	WEST.				
	N 26° 31' E	140730	125925		62830		62830	79118677		
	S 41° 35' E	60090		44946	39883		165543		74404957	
	S 26° 31' W	140730		125925		62830	142596		179564013	
	N 41° 35' W	60090	44946		39883		39883	17925813		
								<u>97044090253968970</u>		18.012
<i>Area in Conflict with Old Stratton</i>										
	N 26° 31' E	86200	77132		38483		38489	29686566		
	S 0° 39' E	122080		122073	1385		78369		95668957	
	N 41° 35' W	60090	44946		39883		39880	17924066		
								<u>47610632</u>	<u>95668957</u>	5.516
<i>Net Area Old Soldier - 12.496 Acres.</i>										
<i>U. S.</i>										
<i>United States</i>										
	N 26° 31' E	150000	134220		66969		66969	89885792		
	S 41° 35' E	59900		44805	39756		173694		77823597	
	S 26° 31' W	150000		134220		66969	146481		196606798	
	N 41° 35' W	59900	44805		39756		39756	17812676		
								<u>107698468274430395</u>		19.138
										<u>107698468</u>
										<u>166731927</u>
										<u>83365963</u>

---

---

## TRAVERSE SHEET.

---

*Survey No.*.....

*Claim*.....

---

---



DIRECTIONS.—1. Carry out the area in acres to three decimals, and all other calculations to two decimals only.

2. In balancing Lat. and Dep. do not obliterate or change the original figures:

Put the corrected figure or figures above in red ink. Do not change the footing of the original figures, but put below them the corrected footing in red ink.

The corrections for balancing fallings should be proportional to the lengths of the lines.

3. In calculations of fallings take result to nearest hundredth. In calculations of N. and S. areas drop all after second decimal. Deputies are cautioned not to use tables that do not give results exact to the decimal specified.

TABLING AND CALCULATIONS OF Deveraux, SURVEY No. \_\_\_\_\_

No.	COURSE.	DISTANCE.	LATITUDES.		DEPARTURES.		DOUBLE M. D.	N. AREAS.	S. AREAS.	Acres
			NORTH.	SOUTH.	EAST.	WEST.				
	N 26° 31' E ✓	75420	67486 <sup>7</sup>		33672 <sup>68</sup>		33668	22721523		
	N 41° 35' W ✓	4620	3456			3066	64270	2221171		
	N 40° 24' E ✓	27996	21316		18140 <sup>39</sup>		79343	16912754		
	S 57° 56' E ✓	20000		10618	16949 <sup>85</sup>		114430		12150177	
	S 10° 13' W ✓	112110		110332 <sup>0</sup>		19885 <sup>90</sup>	111488		123004710	
	N 57° 56' W ✓	54040	28689			45796 <sup>9</sup>	45799	13139275		
								<u>54994723135154887</u>		
								54994723		
								801.601.64		9.201
								40080082		

Area in conflict with Bridge.

	N 26° 31' E ✓	67620	60506 <sup>8</sup>		30187 <sup>85</sup>		30188	18266155		
	N 30° 54' E ✓	31730	27226 <sup>7</sup>		16294 <sup>85</sup>		76669	20874669		
	S 57° 56' E ✓	20000		10618 <sup>7</sup>	16949 <sup>85</sup>		109910		11669145	
	S 10° 13' W ✓	112110		110332 <sup>29</sup>		19885 <sup>7</sup>	106971		118020035	
	N 52° 40' W ✓	54760	33210 <sup>1</sup>			43541 <sup>22</sup>	43542	14460734		
								<u>53601558129689180</u>		
								53601558		
								76087622		
								38043811		
								345450		
								319581		
								304920		
								146611		
								130680		
								<u>159310</u>		8.739

Net Area Deveraux — 0.467 Acres.



**TRAVERSE SHEET.**  

---

*Survey No.*.....*Claim*.....

# FINAL OATHS FOR SURVEYS.

## LIST OF NAMES.

A list of the names of the individuals employed by Franklin W. Smith

United States Deputy Mineral Surveyor, to assist in running, measuring, and marking the lines, corners, and boundaries described in the foregoing field notes of the survey of the mining claim of.....

Novae a Smith

known as the Happe, Station, U.S. William, "Old Soldier

Severus

and showing the respective capacities in which they acted.

- R. A. Jesner ..... Chainman.
- D. E. Curry ..... Chainman.
- ..... Axman.
- ..... Flagman.

## FINAL OATHS OF ASSISTANTS.

We, R. A. Jesner

and D. E. Curry, do solemnly swear that we assisted Franklin

W. Smith, United States Deputy Mineral Surveyor, in marking the corners and surveying

the boundaries of the mining claim of Novae a Smith

known as the William, U.S. Station Happe Old Soldier Severus

represented in the foregoing field notes as having been surveyed by said deputy mineral surveyor and under his direction; and that said survey has been in all respects, to the best of our knowledge and belief, faithfully and correctly executed, and the corner and boundary monuments established according to law and the instructions furnished by the United States Surveyor-General for Arizona

- R. A. Jesner ..... Chainman.
- D. E. Curry ..... Chainman.
- ..... Axman.
- ..... Flagman.

Subscribed and sworn to by the above-named persons before me this 24<sup>th</sup>

day of June, 1905.

Cora Ed Smith

NOTARY PUBLIC  
for the County of Coconino, Territory of Arizona.  
My Commission Expires March 21, 1908.

FINAL OATH OF U. S. DEPUTY MINERAL SURVEYOR

I, Franklin W Smith, U. S. Deputy Mineral Surveyor, do solemnly swear that, in pursuance of instructions received from the United States Surveyor General for Arizona, dated June 20<sup>th</sup>, 1905, I have, in strict conformity to the laws of the United States, the official regulations and instructions thereunder, and the instructions of said Surveyor General, faithfully and correctly executed the survey of the Mining Claim of Novala Smith

known as the "William" "U.S." "Station", "Happy" "Old Soldier" Deveraux situate in Warren Mining District, Cochise County, Arizona, in Section approx, Township No. 23 S, Range No. 24 E ~~and~~ and designated as Survey No. 2120, as represented

in the foregoing field notes, which accurately show the boundaries of said mining claim as distinctly marked by monuments on the ground, and described in the attached copy of the location certificate, which was received by me from the Surveyor General with said instructions, and that all the corners of said survey have been established and perpetuated in strict accordance with the law, official regulations and instructions thereunder; and I do further solemnly swear that the foregoing are the true and original field notes of said survey and my report therein, and that the labor expended and improvements made upon said mining claim by claimant or his grantors are as therein fully stated, and that the character, extent, location and itemized value thereof are specified therein with particularity and full detail, and that no portion of said labor or improvements so credited to this claim has been included in the estimate of expenditures upon any other claim.

Franklin W Smith  
U. S. Deputy Mineral Surveyor.

Subscribed and sworn to by the said Franklin W Smith, U. S. Deputy Mineral Surveyor, before me Cora E Smith this 24<sup>th</sup> day of June, 1905.

Cora E Smith

NOTARY PUBLIC  
for the County of Cochise, Territory of Arizona,  
My Commission Expires March 21, 1908.



# Notice of Mining Location

## LODE CLAIM

To All Whom It May Concern:

This Mining Claim, the name of which is the Severely Mining Claim, situate on lands belonging to the United States of America, and in which there are valuable mineral deposits, was entered upon and located for the purposes of exploration and purchase by Haral A. Smith

(Locator must insert either "a citizen of the United States," or, "who has declared his intention to become a citizen of the United States.") the undersigned, on the 9th day of June 1905

The length of this claim is 1500 feet, and 1 claim 300 feet, in a southerly direction and 1200 feet in a northerly direction from the center of the discovery shaft, at which this notice is posted, lengthwise of the claim, together with 300 feet in width of the surface grounds, on each side of the center of said claim. The general course of the lode deposit and premises is from the North to the South

The claim is situated and located in the Warren Mining District, in Cochise County, in the Territory of Arizona, about 3500 feet in a southerly direction from U. S. M. M. # 1872 and is bounded N by William, E by Bridge, West by Station

The surface boundaries of the claim are marked upon the ground as follows: Beginning at a monument

at a point in a southerly direction 200 feet from the discovery shaft (at which this notice is posted), being in the center of the south end line of said claim; thence easterly 300 feet to a monument, being the S. E. corner of said claim; thence northerly 1500 feet to a monument, being at the N. E. corner of said claim; thence Westerly 300 feet to a monument at the center of the North end of said claim; thence Westerly 300 feet to a monument, being at the N. W. corner of said claim; thence southerly 1500 feet to a monument at the S. W. corner of said claim; thence easterly 300 feet to the place of beginning.

All done under the provisions of Chapter Six, of Title XXXII, of the Revised Statutes of the United States, and of an Act of the General Assembly of Arizona, entitled "An Act to Revise and Codify the Laws of the Territory of Arizona," approved March 16, 1901.

Dated and posted on the ground this 9 day of June 1905

Witness Haral A. Smith  
J. A. Sherwood.

Filed and recorded at request of E. W. Armstrong  
Jun 14, A. D. 1905 at 9 a. m., Book 34, Record of Mines, page 214

I,..... County Recorder in and for the County and Territory aforesaid, do hereby certify that the within instrument was filed for record at..... o'clock,..... M., on this..... day of..... 190..., and duly recorded in Book No..... of..... Records of..... County, Arizona, at pages.....

WITNESS my hand and official seal the day and year first above written.

County Recorder.

# Notice of Location

## LODE CLAIM

.....  
 .....  
 .....  
 .....  
 .....  
 .....  
 .....

Dated..... 190.....

Filed and Recorded at request of.....

..... A. D. 190.....

at..... M.

Book.....

Pages.....

County Recorder.

By.....

Deputy Recorder.

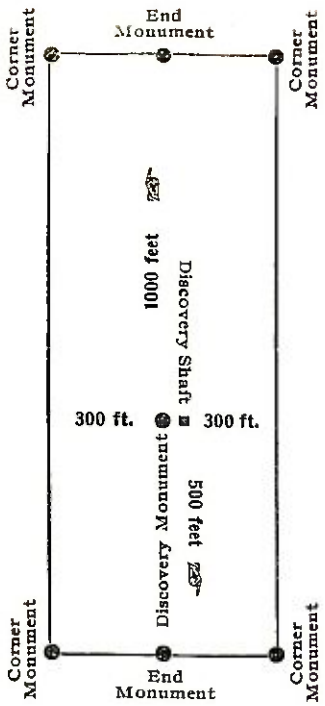

This diagram is to give locator a general idea of plan of location under the new law. The Discovery Shaft can be in the center of claim or any distance from either end desired. In the diagram it is placed 500 feet from one end and 1000 feet from the other. Commence description of claim at a center end monument, giving its distance and direction from center of Discovery Shaft; thence bound the claim in either direction. In description be careful to state locality of claim with reference to some natural object, or permanent monument, as will identify the claim.

Territory of Arizona, (   
 County of Cochise. (ss. (

I, Frank Hare, County Recorder in and for the said County, hereby certify that I have compared the for-going copy with the original Location Notice of the Devereux Mining Claim, filed and recorded in my office on the 14th day of June 1905 in Book 34, at page 216, Record of Mines, and that the same is a full, true and correct copy of such original and of the whole thereof.

Witness my hand and seal of office this 15th day of June, 1905.

*Frank Hare*  
 County Recorder



# Notice of Mining Location

LODE CLAIM

To All Whom it May Concern:

This Mining Claim, the name of which is the Station Mining Claim, situate on lands belonging to the United States of America, and in which there are valuable mineral deposits, was entered upon and located for the purposes of exploration and purchase by Hoval A. Smith a citizen of the United States

(Locator must insert either "a citizen of the United States," or, "who has declared his intention to become a citizen of the United States.")

the undersigned, on the 14th day of June 1905

The length of this claim is 1500 feet,

and I claim about 100 feet,

in a notherly direction and about 1400

feet in a Southerly direction from

the center of the discovery shaft, at which this notice is posted, lengthwise of the claim, together

with 300 feet in width of the surface grounds, on each

side of the center of said claim. The general course of the lode deposit and premises is from the

North to the South

The claim is situated and located in the Warren Mining District, in

Cochise County, in the Territory of Arizona, about 2700

in a Southerly direction from U.S.M.M.No.1872

and is bounded on North, William; East, Bridge; West, Happie.

.....

The surface boundaries of the claim are marked upon the ground as follows: Beginning at monument

at a point in a Northerly direction about 100 feet from

the discovery shaft (at which this notice is posted), being in the center of the Northeast

end line of said claim; thence Northwesterly 300 feet to a monument

, being the North corner of said claim; thence

Southerly 1500 feet to a monument, being at the

West corner of said claim; thence Southeasterly 300 feet

to a monument at the center of the Southwest end of said claim;

thence Southeasterly feet to a monument, being at the

South corner of said claim; thence Northerly 1500

feet to a monument at the East corner of said claim;

thence Northwesterly 300 feet to the place of beginning.

All done under the provisions of Chapter Six, of Title XXXII, of the Revised Statutes of the United States, and of an Act of the General Assembly of Arizona, entitled "An Act to Revise and Codify the Laws of the Territory of Arizona," approved March 16, 1901.

This is an Amended Location Notice of the Station Mining Claim, located by Jacob Pirrung, Dan. Hankins, Will. Hankins

February on the 8th day of 1902, and recorded in Book 20 of Record of Mines, at

page 78, in the office of the County Recorder of the aforesaid County of Cochise

to which reference is hereby made, and this amended Location Notice is made and posted to correct errors in the description in the said original Location Notice and to include additional ground.

Dated and posted on the ground this 14th day of June 1905

HOVAL A. SMITH.

Witness:

J.A. Sherwood.

County of COCHISE } ss.

I, *Frank Star*, County Recorder in and for the County and

Territory aforesaid, do hereby certify that the within instrument was filed for record at ..... o'clock, M.,

on this JUN 16 1905 day of ..... 190..., and duly recorded in Book No. 34

of MINING Records of COCHISE County, Arizona, at pages 234

WITNESS my hand and official seal the day and year first above written.

*Frank Star*  
County Recorder.

No. 3485

AMENDED

Notice of Location.

LODE CLAIM.

Dated JUN 16 1905

Filed and Recorded at request of

*E. W. Armstrong*

JUN 16 1905 A. D. 1905

at *9 A* M.

Book *34 Record p. 234*

Pages *234*  
*E. W. Armstrong*  
County Recorder.

By *E. W. Armstrong* Deputy Recorder.

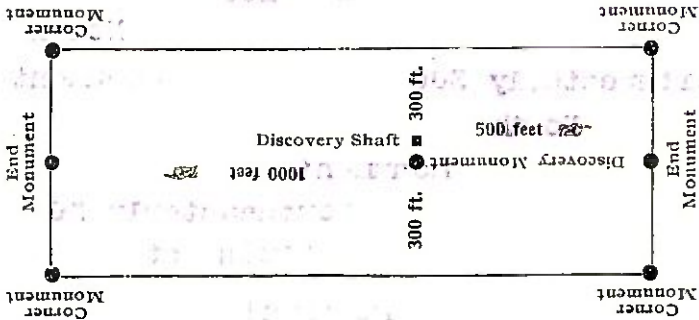

This diagram is to give locator a general idea of plan of location under the new law. The Discovery Shaft can be in the center of claim or any distance from either end desired. In the diagram it is placed 500 feet from one end and 1000 feet from the other. Commence description of claim at a center end monument, giving its distance and direction from center of Discovery Shaft; thence bound the claim in either direction. In description be careful to state locality of claim with reference to some natural object, or permanent monument, as will identify the claim.

COMPARET



AMENDED

# Notice of Mining Location

LODE CLAIM

To All Whom it May Concern:

This Mining Claim, the name of which is the Happle Mining Claim, situate on lands belonging to the United States of America, and in which there are valuable mineral deposits, was entered upon and located for the purposes of exploration and purchase by Hoval A. Smith, a citizen of the United States

(Locator must insert either "a citizen of the United States," or, "who has declared his intention to become a citizen of the United States.")

the undersigned, on the 14th day of June 1905

The length of this claim is 1500 feet,

and I claim about 100 feet,

in a Northerly direction and about 1400

feet in a Southerly direction from

the center of the discovery shaft, at which this notice is posted, lengthwise of the claim, together

with 300 feet in width of the surface grounds, on each

side of the center of said claim. The general course of the lode deposit and premises is from the

North to the South

The claim is situated and located in the Warren Mining District, in

Cochise County, in the Territory of Arizona, about 2500 ft

in a Southerly direction from U.S.M.M. No. 1873

and is bounded North, Gap, Survey No. 1873, East, Station; West,

U.S.

The surface boundaries of the claim are marked upon the ground as follows: Beginning at monument of stones

at a point in a northerly direction about 100 feet from

the discovery shaft (at which this notice is posted), being in the center of the North east

end line of said claim; thence Northwesterly 300 feet to a monument

, being the North corner of said claim; thence

Southerly 1500 feet to a monument at West cor, being at the

West cor corner of said claim; thence Southeasterly 300 feet

to a monument at the center of the S W end of said claim;

thence Southeasterly 300 feet to a monument, being at the

South corner of said claim; thence northerly 1500

feet to a monument at the East corner of said claim;

thence northwesterly 300 feet to the place of beginning.

All done under the provisions of Chapter Six, of Title XXXII, of the Revised Statutes of the United States, and of an Act of the General Assembly of Arizona, entitled "An Act to Revise and Codify the Laws of the Territory of Arizona," approved March 16, 1901.

This is an Amended Location Notice of the Happle

Mining Claim, located by Jacob Pirrung, Dan Hankins, Geo. Toles

on the 5th day of

February 1905, and recorded in Book 20 of Record of Mines, at

page 71, in the office of the County Recorder of the aforesaid County of Cochise

to which reference is hereby made, and this amended Location Notice is made and posted to correct errors in the description in the said original Location Notice.

Dated and posted on the ground this 14th day of June 1905

HOVAL A. SMITH

Witness:

J. A. Sherwood.



TERRITORY OF ARIZONA,

County of MOHAVE } ss.

I, Frank H. Jones

County Recorder in and for the County and

Territory aforesaid, do hereby certify that the within instrument was filed for record on this JUN 16 1905 day of JUN 16 1905 at 9 o'clock P. M.,

on this 16 day of JUN 16 1905 and fully recorded in Book No. 34

of MINING Records of COCHISE County, Arizona, at pages 237

WITNESS my hand and official seal this day and year first above written.

Frank H. Jones  
County Recorder.

No. 3488

# AMENDED Notice of Location. LODE CLAIM.

.....  
.....  
.....  
.....  
.....  
.....

Dated 16 1905

Filed and Recorded at request of  
E. W. Armstrong

JUN 16 1905 A. D. 1905

at 9 A M.

Book 34 Record of Mines

Pages 237  
Frank H. Jones

County Recorder.

By .....

Deputy Recorder.

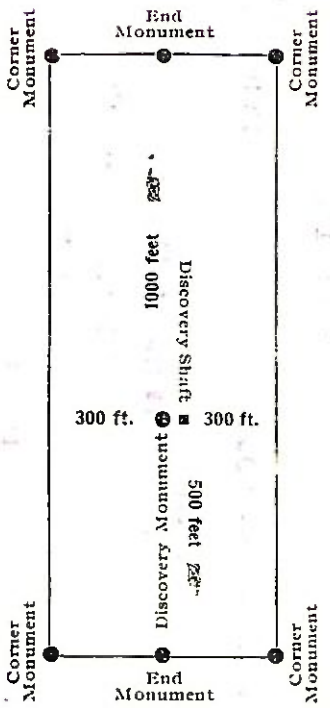

This diagram is to give locator a general idea of plan of location under the new law. The Discovery Shaft can be in the center of claim or any distance from either end desired. In the diagram it is placed 500 feet from one end and 1000 feet from the other. Commence description of claim at a center end monument, giving its distance and direction from center of Discovery Shaft; thence bound the claim in either direction. In description be careful to state locality of claim with reference to some natural object, or permanent monument, as will identify the claim.

AMENDED

# Notice of Mining Location

LODE CLAIM

To All Whom it May Concern:

This Mining Claim, the name of which is the Old Soldier Mining Claim, situate on lands belonging to the United States of America, and in which there are valuable mineral deposits, was entered upon and located for the purposes of exploration and purchase by Hoval A. Smith, a citizen of the United States

(Locator must insert either "a citizen of the United States," or, "who has declared his intention to become a citizen of the United States.")

the undersigned, on the 14th day of June 1905

The length of this claim is 1500 feet, and I claim about 100 feet, in a northerly direction and 1400 feet in a southerly direction from the center of the discovery shaft, at which this notice is posted, lengthwise of the claim, together with 300 feet in width of the surface grounds, on each side of the center of said claim. The general course of the lode deposit and premises is from the North to the South

The claim is situated and located in the Warren Mining District, in Cochise County, in the Territory of Arizona, about 1800 ft in a Southerly direction from U.S.M.M. No. 1872

Bounded on the North, Gage, Survey 1873; East by U.S.; West by Old Statton and Golden Eagle;

The surface boundaries of the claim are marked upon the ground as follows: Beginning at monument

at a point in a northerly direction about 100 feet from the discovery shaft (at which this notice is posted), being in the center of the Northeast end line of said claim; thence Northwesterly 300 feet to a monument being the North corner of said claim; thence Southerly 1500 feet to a monument, being at the West corner of said claim; thence Southeasterly 300 feet to a monument at the center of the Southwest end of said claim; thence Southeasterly 300 feet to a monument, being at the South corner of said claim; thence Northerly 1500 feet to a monument at the East corner of said claim; thence Northwesterly 300 feet to the place of beginning.

All done under the provisions of Chapter Six, of Title XXXII, of the Revised Statutes of the United States, and of an Act of the General Assembly of Arizona, entitled "An Act to Revise and Codify the Laws of the Territory of Arizona," approved March 16, 1901.

This is an Amended Location Notice of the Old Soldier Mining Claim, located by Jacob Pirrung, Dan Hankins, Geo Toles

on the 5th day of February 1905, and recorded in Book 20 of Record of Mines, at

page 76, in the office of the County Recorder of the aforesaid County of Cochise

to which reference is hereby made, and this amended Location Notice is made and posted to

correct errors in the description in the said original Location Notice. and to include additional ground

Dated and posted on the ground this 14th day of June 1905

Witness: HOVAL A. SMITH

J.A. Sherwood.



County of COCHISE } ss.

*Frankston*

County Recorder in and for the County and

Territory aforesaid, do hereby certify that the within instrument was filed for record at 9 o'clock, A.M.,

on this 16 day of JUN 16 1905

MINING

COCHISE

of Records of County, Arizona, at pages 34

WITNESS my hand and official seal the 16th day and year first above written.

*Frankston*

County Recorder.

AMENDED  
Notice of Location.  
LODE CLAIM.

Dated 1905

Filed and Recorded at request of

*E.W. Amstutz*

JUN 16 1905

A. D. 1905

at 9 A.M.

Book 34 Records of Mines

Pages 236

*Frankston*

County Recorder.

By Deputy Recorder.

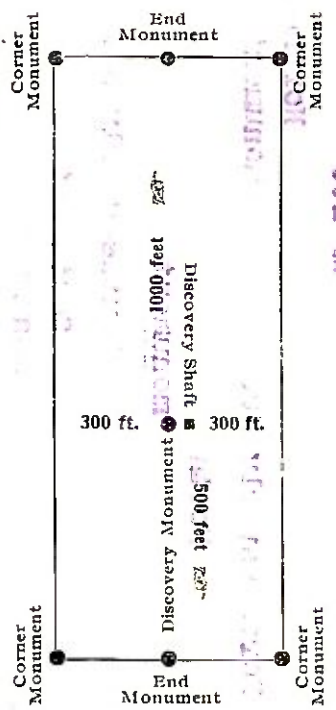

This diagram is to give locator a general idea of plan of location under the new law. The Discovery Shaft can be in the center of claim or any distance from either end desired. In the diagram it is placed 500 feet from one end and 1000 feet from the other. Commence description of claim at a center end monument, giving its distance and direction from center of Discovery Shaft; thence bound the claim in either direction. In description be careful to state locality of claim with reference to some natural object, or permanent monument, as will identify the claim.

COMPARED. No. 3487



AMENDED

# Notice of Mining Location

LODE CLAIM

To All Whom it May Concern:

This Mining Claim, the name of which is the William Mining Claim, situate on lands belonging to the United States of America, and in which there are valuable mineral deposits, was entered upon and located for the purposes of exploration and purchase by Howal A Smith a citizen of the U.S.

(Locator must insert either "a citizen of the United States," or, "who has declared his intention to become a citizen of the United States.") the undersigned, on the 14 day of June 1905

The length of this claim is 1500 feet, and 9 claim about 1400 feet, in a southwesterly direction and about 100 feet in a northeasterly direction from the center of the discovery shaft, at which this notice is posted, lengthwise of the claim, together with 300 feet in width of the surface grounds, on each side of the center of said claim. The general course of the lode deposit and premises is from the northeast to the southwest

The claim is situated and located in the Warren Mining District, in Cochise County, in the Territory of Arizona, about 1800 ft in a S E direction from U.S.M.M. 1872 and is bounded on the North by Rhine, Survey No. 1872; East, Helena, Ivanhoe and Bridge, Survey No. 1918; South by Station, West; Gap, Survey No. 1873.

The surface boundaries of the claim are marked upon the ground as follows: Beginning at a monument

at a point in a Northeasterly direction about 100 feet from the discovery shaft (at which this notice is posted), being in the center of the N E end line of said claim; thence N W 300 feet to a post, being the North corner of said claim; thence Southwesterly 1500 feet to a post, being at the West corner of said claim; thence Southeasterly 300 feet to a monument at the center of the SW end of said claim; thence Southeasterly 300 feet to a post, being at the South corner of said claim; thence Northeasterly 1500 feet to a post at the East corner of said claim; thence Northwesterly feet to the place of beginning.

All done under the provisions of Chapter Six, of Title XXXII, of the Revised Statutes of the United States, and of an Act of the General Assembly of Arizona, entitled "An Act to Revise and Codify the Laws of the Territory of Arizona," approved March 16, 1901.

This is an Amended Location Notice of the William Mining Claim, located by Jacob Pirrung, William Hankins, Daniel Hankins on the 2nd day of January 1905, and recorded in Book 20 of Record of Mines, at page 72, in the office of the County Recorder of the aforesaid County of Cochise to which reference is hereby made, and this amended Location Notice is made and posted to correct errors in the description in the said original Location Notice.

Dated and posted on the ground this 14th day of June 1905

Witness: HOWAL A. SMITH

J.A. Sherwood.

County of COCHISE } ss.

I, *Frank J. Clark*

County Recorder in and for the County and

Territory aforesaid, do hereby certify that the within instrument was filed for record at 9 o'clock P.M.

on this 16 day of JUN 16 1905, and duly recorded in Book No. 34

of MINING Records of COCHISE County, Arizona, at pages 253

WITNESS my hand and official seal this day and year first above written.

*Frank J. Clark*  
County Recorder.

No. 3484

AMENDED Notice of Location.

LODE CLAIM.

Dated 1905

Filed and Recorded at request of

*E. W. Armstrong*

JUN 16 1905 A. D. 1905

at 9 A.M.

Book 34 Record of Mines

Pages 253  
*Frank J. Clark*

County Recorder.

By \_\_\_\_\_

Deputy Recorder.

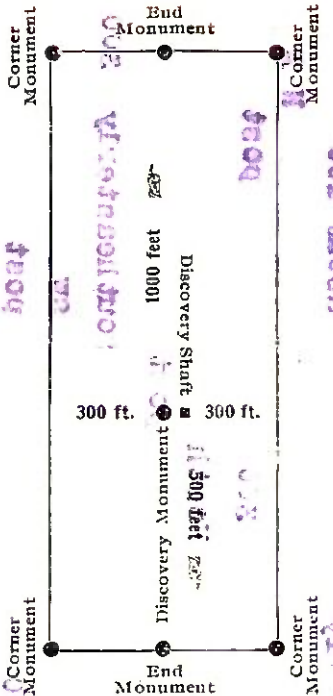

This diagram is to give locator a general idea of plan of location under the new law. The Discovery Shaft can be in the center of claim or any distance from either end desired. In the diagram it is placed 500 feet from one end and 1000 feet from the other. Commence description of claim at a center end monument, giving its distance and direction from center of Discovery Shaft; thence bound the claim in either direction. In description be careful to state locality of claim with reference to some natural object, or permanent monument, as will identify the claim.



AMENDED

# Notice of Mining Location

LODE CLAIM

To All Whom it May Concern:

This Mining Claim, the name of which is the U. S. Mining Claim, situate on lands belonging to the United States of America, and in which there are valuable mineral deposits, was entered upon and located for the purposes of exploration and purchase by Hoval A. Smith, a citizen of the United States

(Locator must insert either "a citizen of the United States," or, "who has declared his intention to become a citizen of the United States.")

the undersigned, on the 14th day of June 190 5

The length of this claim is 1500 feet, and I claim about 100 in a northerly direction and 1400

feet in a Southerly direction from the center of the discovery shaft, at which this notice is posted, lengthwise of the claim, together with 300 feet in width of the surface grounds, on each side of the center of said claim. The general course of the lode deposit and premises is from the North to the South

The claim is situated and located in the Warren Mining District, in Cochise County, in the Territory of Arizona, about 1800 in a Southerly direction from U.S.M.M. No. 1873 and is bounded on the North by Reed, Survey No. 1873, East by Hapdie, West, by Old Soldier.

The surface boundaries of the claim are marked upon the ground as follows: Beginning at monument

at a point in a northerly direction about 100 feet from the discovery shaft (at which this notice is posted), being in the center of the NE end line of said claim; thence Northwesterly 300 feet to a monument, being the North corner of said claim; thence Southerly 1500 feet to a monument, being at the West corner of said claim; thence Southeasterly 300 feet to a monument at the center of the SW end of said claim; thence Southeasterly 300 feet to a monument, being at the South corner of said claim; thence Northerly 1500 feet to a monument at the East corner of said claim; thence northwesterly 300 feet to the place of beginning.

All done under the provisions of Chapter Six, of Title XXXII, of the Revised Statutes of the United States, and of an Act of the General Assembly of Arizona, entitled "An Act to Revise and Codify the Laws of the Territory of Arizona," approved March 16, 1901.

This is an Amended Location Notice of the U. S. Mining Claim, located by Jacob Pirrung, Dan Hankins, Geo. Tole s

on the 5th day of February 190 2, and recorded in Book 20 of Record of Mines, at page 74, in the office of the County Recorder of the aforesaid County of Cochise

to which reference is hereby made, and this amended Location Notice is made and posted to correct errors in the description in the said original Location Notice, and to include additional ground.

Dated and posted on the ground this 14th day of June, 190 5  
HOVAL A. SMITH

Witness:

J. A. Sherwood.



County of MOHAVE ss.

I, Frankston, County Recorder in and for the County and Territory aforesaid, do hereby certify that the within instrument was filed for record at 7 o'clock, 9 M., on this 16 day of JUNE, 1905, and duly recorded in Book No. 34 of MINING Records of MOHAVE County, Arizona, at pages 235

WITNESS my hand and official seal this 16 day and year first above written.

Frankston County Recorder.

COMPARED, No. 3486

AMENDED

Notice of Location.

LODE CLAIM.

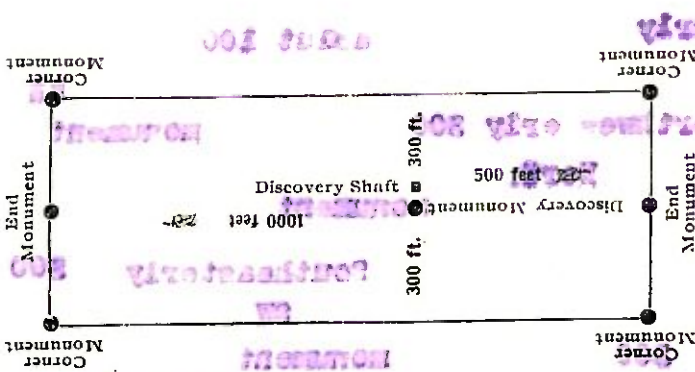

This diagram is to give locators a general idea of plan of location under the new law. The Discovery Shaft can be in the center of claim or any distance from either end desired. In the diagram it is placed 500 feet from one end and 1000 feet from the other. Commence description of claim at a center end monument, giving its distance and direction from center of Discovery Shaft; thence bound the claim in either direction. In description be careful to state locality of claim with reference to some natural object, or permanent monument, as will identify the claim.

Filed and Recorded at request of W. Amstrong

JUN 16 1905 A. D. 190

at Book 34 Record of Mines

Pages 235  
By Frankston County Recorder.  
Deputy Recorder.

U. S. SURVEYOR-GENERAL'S FINAL CERTIFICATE ON FIELD NOTES.

Department of the Interior,

OFFICE OF U. S. SURVEYOR-GENERAL,

Phoenix, Arizona.

Aug 2, 1905.

I, U. S. Surveyor-General for the district of Arizona.

do hereby certify that the foregoing transcript of the Field Notes, return and approval of the survey of the mining claim of Hoval A. Smith,

known as the William, U. S., Station, Happie, Old Soldier, Devereux. situate in Warren

Mining District, Cochise County, Arizona.

in Section approx., Township No. 23 S., Range No. 24 E. unsurveyed, and designated as Survey No. 2120

has been correctly copied from the originals on file in this office; that said Field Notes furnish such an accurate description of said mining claim as will, if incorporated into a patent, serve fully to identify the premises, and that such reference is made therein to natural objects or permanent monuments as will perpetuate and fix the locus thereof.

And I further certify that <sup>less than</sup> five hundred dollars' worth of labor has been expended or improvements made upon said mining claim by claimant or his grantors, and that said improvements consist of, at time of survey, 6 shafts, total value \$600.00

[Large handwritten flourish or signature mark]

and that no portion of said labor or improvements has been included in the estimate of expenditures upon any other claim.

I further certify that the plat thereof, filed in the U. S. Land Office at Tucson, Arizona, is correct and in conformity with the foregoing Field Notes.

( Signed ) Frank S. Ingalls,

United States Surveyor-General for Arizona.

4-687.

SURVEYOR-GENERAL'S CERTIFICATE OF APPROVAL OF FIELD NOTES AND SURVEY OF MINING CLAIM.

Department of the Interior,

Office of U. S. Surveyor-General,

Phoenix, Arizona.

Aug 2, 1905.

I, U. S. Surveyor-General for the district of Arizona.

do hereby certify that the foregoing and hereto attached Field Notes and Return of the Survey of the Mining Claim of Howal A. Smith,

known as the William, U. S., Station, Happie, Old Soldier, Devereux.

situate in Warren Mining District, Cochise County, Arizona.

in Section approx., Township No. 23 S., Range No. 24 E. unsurveyed, designated as Survey No. 2120

executed by Franklin W. Smith, U. S. Deputy Mineral Surveyor, June 22nd to 24th 1905.

June 20th 1905, 1905, have been critically examined and the necessary corrections and explanations made, and the said Field Notes and Return, and the Survey they describe, are hereby approved. A true copy of the copy of the location certificate filed by the applicant. for survey is included in the field notes.

Handwritten signature of the Surveyor-General.

U. S. Surveyor-General for Arizona.



owned by Hoval A. Smith, and situated in Warren Mining District, Cochise County, Territory of Arizona.

IMPROVEMENTS.

I certify that the value of the labor and improvements on this group, placed thereon by the claimant or his grantors is not less than \$500 for each location thereof, and that said improvements were placed on the claim before the 18th day of September, 1905, and prior to the expiration of the period of publication of the application for patent. That said improvements are as follows:

WILLIAM:

No.1	Discovery shaft 4x6x10 ft brs from S E C location N.40° 24'E. 170 ft., Value,	\$100.00
No.2	Shaft 4x6x10 ft brs from Cor.No.4 N. 53° 30' W. 405 ft Value,	100.0
No.3	Shaft 4x6x10 ft brs from Cor.No.4 N. 71° W. 520 ft., Value,	100.00
No.4	Shaft 4x6x10 ft brs from Cor.No.2. S. 77° 40' E. 416 ft., Value,	100.00
No.5	Shaft 4x6x10 ft brs from Cor.No.2, S. 69° 20' E. 372 ft., Value,	<u>100.00</u>
	Total improvement William lode,	\$500.00

STATION.

No.1	Discovery shaft 4x6x10 ft brs from N E C location S. 26° 31' W. 250 ft., Value	100.00
No.2	Shaft 5x7x10 ft brs from Cor.No.3 S. 21° E. 225 ft., Value,	110.00
No.3	Shaft 4x6x10 ft brs from Cor.No.3 S. 1 <sup>3</sup> / <sub>4</sub> ° 40' E. 262 ft., Value,	100.00
No.4	Shaft 5x7x10 ft. brs from Cor.No.3 S. 1 <sup>2</sup> / <sub>8</sub> ° E. 374 ft., Value,	110.00
No.5	Shaft 4x6x10 ft brs from Cor.No.3 S. 7° 45' E. 342 ft., Value,	100.00

STATION (con)		
No. 6	Shaft 4x6x10 ft brs from Cor. No. <del>3</del> S. 7° 30' E. 211 ft., Value	\$100.00
No. 7	Shaft 4x6x10 ft brs from Cor. No. 1 N. 7° E. 248 ft., Value,	100.00
No. 8	Shaft 4x6x10 ft brs from Cor. No. 1 N. 20° 31' E 100 ft., Value,	100.00
No. 9	Shaft 4x8x10 ft brs from Cor. No. 1 N. 19° 50' E. 815 ft., Value,	<u>125.00</u>
Total improvements Station lode,		\$945.00
HAPPIE.		
No. 1	Discovery shaft 4x6x10 ft brs from N. E. C location S. 26° 31' W. 180 ft., Value,	100.00
No. 2	Shaft 4x6x10 ft brs from Cor. No. 4. N. 65° 10' W 420 ft., Value,	100.00
No. 3	Shaft 4x8x10 ft brs from Cor. No. 4, N. 68° 50' W. 412 ft., Value,	125.00
No. 4	Shaft 4x6x10 ft brs from Cor. No. 4, N. 74° W. 302 ft., Value,	100.00
No. 5	Shaft 4x6x10 ft brs from Cor. No. 4 N. 78° 50' W. 267 ft., Value,	100.00
No. 6	Shaft 5x7x10 ft brs from Cor. No. 4 N. 83° 40' W. 258 ft., Value,	<u>110.00</u>
Total improvements Happie lode,		\$635.00
U. S.		
No. 1	Discovery shaft 4x6x10 ft brs from N. E. C location S. 26° 31' W 240 ft., Value,	\$100.00
No. 2	No. 2 Shaft 4x6x10 ft brs from Cor. No. 3 S. 10° 35' E. 420 ft., Value,	100.00
No. 3	Shaft 4x6x10 ft brs from Cor. No. 3 S. 10° 40' W. 340 ft Value,	100.00

owned by Hoval A. Smith, and situated in Warren Mining  
 District, Cochise County, Territory of Arizona.

IMPROVEMENTS.

I certify that the value of the labor and improve-  
 ments on this group, placed thereon by the claimant or  
 his grantors is not less than \$500 for each location  
 thereof, and that said improvements were placed on the  
 claim before the 18th day of September, 1905, and prior  
 to the expiration of the period of publication of the appli-  
 cation for patent. That said improvements are as follows:

WILLIAM:

No.1	Discovery shaft 4x6x10 ft brs from S E C location N. 40° 24' E. 170 ft., Value,	\$100.00
No.2	Shaft 4x6x10 ft brs from Cor.No.4 N. 53° 30' W. 405 ft Value,	100.0
No.3	Shaft 4x6x10 ft brs from Cor.No.4 N. 71° W. 520 ft., Value,	100.00
No.4	Shaft 4x6x10 ft brs from Cor.No.2. S. 77° 40' E. 416 ft., Value,	100.00
No.5	Shaft 4x6x10 ft brs from Cor.No.2, S. 69° 20' E. 372 ft., Value,	<u>100.00</u>
	Total improvement William lode,	\$500.00

STATION.

No.1	Discovery shaft 4x6x10 ft brs from N E C location S. 26° 31' W. 250 ft., Value	100.00
No.2	Shaft 5x7x10 ft brs from Cor.No.3 S. 21° E. 225 ft., Value,	110.00
No.3	Shaft 4x6x10 ft brs from Cor.No.3 S. 1 <sup>3</sup> / <sub>2</sub> ° 40' E. 262 ft., Value,	100.00
No.4	Shaft 5x7x10 ft. brs from Cor.No.3 S. 1 <sup>2</sup> / <sub>8</sub> ° E. 374 ft., Value,	110.00
No.5	Shaft 4x6x10 ft brs from Cor.No.3 S. 7° 45' E. 342 ft., Value,	100.00



## U. S. (con)

No. 4	Shaft 4x9x10 ft brs from Cor. No. 3 S. 22° W. 1100 ft Value	\$150.00
No. 5.	Shaft 5x7x25 ft brs from Cor. No. 3 S. 20° 18' W. 1430 ft., Value,	<u>300.00</u>
Total improvements U S lode,		\$750.00
OLD SOLDIER.		
No. 1	Discovery Shaft 4x6x10 ft brs from N E C location S. 26° 31' W 230 ft., Value,	\$100.00
No. 2	Shaft 4x6x10 ft brs from Cor. No. 4 N. 77° 30' W. 326 ft Value	100.00
No. 3	Shaft 4x6x10 ft brs from Cor. No. 4 N. 20° 10' W 394 ft., Value,	100.00
No. 4	Shaft 4x6x10 ft brs from Cor. No. 4 N. 85° W. 321 ft., Value	100.00
No. 5	Shaft 6x9x10 ft brs from N E C location S. 0° W. 270 ft., Value,	<u>150.00</u>
Total improvements OLD SOLDIER LODE,		\$550.00
DEVEREUX.		
No. 1	Discovery shaft 4x6x10 ft brs from S E C location N 19° 13' W. 10 ft., Value,	\$100.00
No. 2	Shaft 4x6x10 ft brs from Cor. No. 1 N. 53° 20' W. 390 ft., Value,	100.00
No. 3	Shaft 4x6x10 ft brs from Cor. No. 1 N. 54° 30' W. 400 ft. Value	100.00
No. 4	Shaft 4x6x10 ft brs from Cor. No. 5 S. 38° 10' W. 200 ft Value	100.00
No. 5	Shaft 4x6x10 ft brs from Cor. No. 5 S. 35° 32' W. 255 ft Value,	<u>100.00</u>
Total improvements Devereux lode,		\$500.00
Total improvements on group		\$38 <del>50</del> <sup>5</sup> .00

*Franklin W. Smith,*

U. S. Deputy Mineral Surveyor.

Dated at Bisbee, Arizona,  
September 18, 1905.

Affidavit of Five Hundred Dollars Improvements.

We, W. J. [unclear] and F. C. [unclear]

of lawful age, being first duly sworn according to law, depose and say: That we are acquainted with the "William" Station "Happy" "U.S." "Old Soldier" "Reverent" mining claim, situate in Paria

mining district, Cochise County, Arizona Territory, for which

Corral Smith

has made application for survey prior to application for patent under the provisions of the Act of Congress approved May 10, 1872; and that the labor done and improvements made thereon by the applicant... and his grantor... exceed five hundred dollars in value, and further that we are not personally interested

in said mine.

W. J. [unclear]  
F. C. [unclear]

TERRITORY OF ARIZONA,  
COUNTY OF Cochise } ss:

Sworn to and subscribed before me this 9th day of September, 1905

[SEAL.]

Corral Smith

17171b400-3-05

In and for the County of Cochise, Territory of Arizona  
My Commission Expires March 21, 1906.

# Certificate of U. S. Surveyor General

AS TO

EXPENDITURES REPORTED AFTER RETURN OF SURVEY OF MINING CLAIM.

I, U. S. Surveyor General for .....the district of Arizona....., do hereby certify that Five Hundred Dollars' worth of labor has been expended or improvements made by claimant or his .....grantors, upon the mining claim of ..... Hoval A. Smith. ....

known as the William, Station, Happie, U.S., Old Soldier, Devereux, situate in ..... Warren ..... mining district, ..... Cochise ..... County, Arizona. ....

in Section ..... Township No. .... Range No. ....; that said improvements consist of On William lode, 5 shafts, value \$500. On Station lode, 9 shafts, value \$945. : On Happie lode, 6 shafts value \$635, + On U. S. lode, 5 shafts, value \$750.: On Old Soldier lode, 5 shafts, value \$550. : On Devereux lode, 5 shafts, value \$500. ....

....., and that no portion of said labor or improvements has been included in the estimate of expenditures upon any other claim. A copy of the report of Franklin W. Smith, ..... U. S. Deputy Mineral Surveyor, dated Sep. 18, 1905. ...., 18 .., is hereto attached.

*Frank S. Lyack*  
U. S. Surveyor General for ..... Arizona. ....

Office of U. S. Surveyor General,  
Phoenix, Arizona. ....

....., 18 ..