

**M
S
-**

0

2

1

3

3

AUG. 12 1905 ¹

copied by [unclear] 5/11/05

checked by [unclear] C. S. L. K.

(4-683.)

Mineral Survey No. 7133

Lot No. _____

Silas

Land District.

FIELD NOTES

OF THE SURVEY OF THE MINING CLAIM OF

August Daley and Charles Clason

KNOWN AS THE

*Morning Star
Warren*

Mining District,

Cochise County, *Arizona*

Section *Approx*, Township *23A*, Range *24E* ~~*24E*~~

Surveyed under instructions dated *July 20th*, 1905 *Unsurveyed*

by *Franklin W. Smith*

U. S. Deputy Mineral Surveyor

Claim located	<i>See notices</i>	. 1
Survey commenced	<i>July 23rd</i>	. 1905
Survey completed	<i>Aug 8th</i>	. 1905

6-171

*Claimants address
Bisbee, Cochise County Arizona*

*Tr. ✓
Lodge ✓
Dist ✓
Area ✓*

Survey No. 2133
Morning Star lode mining claim.

Feet

Beginning at Cor.No.1 identical with Cor.No.2 at
Nassau lode, Survey No. 1387, a pine post 4 ft long 4 ins
sq set 1 ft in the ground in a mound of stones and scribed
1-2133 M S L whence a pine post of same dimensions and
scribed ^{BB} 1-2133 brs. N. 6° 42' E. 5 ft and a second pine
post of same dimensions and scribing brs. S. 54° 28' W
50 ft and original location for NE cor brs N. 54° 28' E
50 ft and Cor.No.1 Quartzite Strip Survey No.20 10 brs
N 55° 38' W. 94.9 ft., and U S M M No. 1 Warren Mining
District brs S. 31° 32' E. 3872.4 ft.,

Thence S. 54° 28' W

370.1

to original location for E E C.,

531.8

identical with a corner of Bangor Lode, Unsurveyed
same bearing to Cor.No.2 the SE cor, a pine post 4 ft long
4 ins sq set 1 ft in the ground in a mound of stones and
scribed 2-2133 M S L whence a pine post of same dimensions
and scribed ^{BB} 2-2133 brs. N. 54° 28' E. 50 ft and a second
pine post of same dimensions and scribing brs. N. 86°
30' W. 50 ft., and original location for SE cor brs
S. 54° 28' W. 290 ft.,

Thence N. 86° 30' W. ~~746 ft~~ along line 1-4

746

Along line 1-4

Contention lode, Survey No.1670 to Cor.No.3, identical
with Cor.No.4 Contention lode, Survey No.1670 a pine post
4 ft long 4 ins sq set 1 ft in the ground in a mound
of stones and scribed 3-2133 M S L, whence a pine post
of same dimensions and scribed B. P. 3-2133 brs S. 86°
30' E. 50 ft and a second pine post of same dimension
and scribing brs. S. 24° 37' W. 10 ft.,

Thence S. 24° 37' W.

25.3

along line 4-3 Contention lode, Survey No.1670
to Cor.No.4, a pine post 4 ft long 4 ins sq set 1 ft in
the ground in a mound of stones and scribed 4-2133
M S L, whence a pine post of same dimensions and
scribed B. P. 4-2133 brs N. 24° 37' E. 153 ft and a sec-
ond pine post of same dimensions and scribing brs. N.
74° 54' W. 50 ft.

Feet

904.0 Thence N. $74^{\circ} 54' W.$
 to Cor.No.5, the SW cor a pine post 4 ft long 4 ins sq
 set 1 ft in the ground in a mound of stones and scribed
 5-2133 M S L, whence a pine post of same dimensions and
 scribed B. P. 5-2133 brs. S. $74^{\circ} 54' E.$ 50 ft., and a sec-
 ond pine post of same dimensions and scribing brs. N.
 $54^{\circ} 28' E.$ 50 ft., Cor No.5 being identical with location
 Thence N. $54^{\circ} 28' E.$

388 to original location for W E C
 776 same bearing to Cor.No.6 the NW cor identical with lo-
 cation a pine post 4 ft long 4 ins sq set 1 ft in the
 ground in a mound of stones and scribed 6-2133 M S L
 whence a pine post of same dimensions and scribed B.P.
 6-2133 brs S. $54^{\circ} 28' W.$ 50 ft., and a second pine post
 of same dimensions and scribing brs. S. $74^{\circ} 54' E.$ 50 ft.
 Thence S. $74^{\circ} 54' E.$

1482.0 to Cor.No.7, a pine post 4 ft long 4 ins sq set 1 ft in
 the ground in a mound of stones and scribed 7-2133 M S L
 whence a pine post of same dimensions and scribed B. P
 7-2133 brs N. $74^{\circ} 54' W.$ 50 ft., and a second pine post
 of same dimensions and scribing brs. S. $6^{\circ} 42' W.$ 4 ft
 Thence S. $6^{\circ} 42' W.$

14.0 ~~along line 7-8, of Al Hadda lode, Survey No. 1307 to Cor~~
 No 1 the place of beginning.

Ledge.

The presumed course of the vein on this claim is
 from the W E C location S. $74^{\circ} 54' E.$ 1495.4

Total and net area Morning Star lode,

19.204³ acres.

FINAL OATHS FOR SURVEYS.

LIST OF NAMES.

A list of the names of the individuals employed by Franklin W. Smith
 United States Deputy Mineral Surveyor, to assist in running, measuring, and marking the lines
 corners and boundaries described in the foregoing field notes of the survey of the mining claim
 of August Lacey and Charles Clason
 known as the Morning Star
 and showing the respective capacities in which they acted.

R. R. Boyd, Chairman.
C. A. Winfrey, Chairman.
 _____, Axman.
 _____, Flagman.

FINAL OATHS OF ASSISTANTS.

We, R. R. Boyd
 and C. A. Winfrey, do solemnly swear that we assisted Franklin W. Smith,
 United States Deputy Mineral Surveyor, in marking the corners and
 surveying the boundaries of the mining claim of
August Lacey and Charles Clason,
 known as the Morning Star, represented
 in the foregoing field notes as having been surveyed by said deputy mineral surveyor and under
 his direction; and that said survey has been in all respects, to the best of our knowledge and
 belief, faithfully and correctly executed, and the corner and boundary monuments established
 according to law and the instructions furnished by the United States Surveyor-General for
Arizona.

R. R. Boyd, Chairman.
C. A. Winfrey, Chairman.
 _____, Axman.
 _____, Flagman.

Subscribed and sworn to by the above-named persons before me
 this 10th day of August, 1905

Cora Smith
 NOTARY PUBLIC
 and for the County of Cochise, Territory of Arizona,
 My Commission Expires March 21, 1908.

FINAL OATH OF U. S. DEPUTY MINERAL SURVEYOR

I, Franklin W. Smith, U. S. Deputy Mineral Surveyor, do solemnly swear that, in pursuance of instructions received from the United States Surveyor General for Arizona, dated July 20th, 1905, I have, in strict conformity to the laws of the United States, the official regulations and instructions thereunder, and the instructions of said Surveyor General, faithfully and correctly executed the survey of the Mining Claim of August Daley and Charles Clason, known as the Morning Star, situate in Wenden Mining District, Cochise County, Arizona, in Section approx., Township No. 732, Range No. 24E by D.R. Brown and designated as Survey No. 2133, as represented in the foregoing field notes, which accurately show the boundaries of said mining claim as distinctly marked by monuments on the ground, and described in the attached copy of the location certificate, which was received by me from the Surveyor General with said instructions, and that all the corners of said survey have been established and perpetuated in strict accordance with the law, official regulations and instructions thereunder; and I do further solemnly swear that the foregoing are the true and original field notes of said survey and my report therein, and that the labor expended and improvements made upon said mining claim by claimant or these grantors are as therein fully stated, and that the character, extent, location and itemized value thereof are specified therein with particularity and full detail, and that no portion of said labor or improvements so credited to this claim has been included in the estimate of expenditures upon any other claim.

Franklin W. Smith
U. S. Deputy Mineral Surveyor.

Subscribed and sworn to by the said Franklin W. Smith
U. S. Deputy Mineral Surveyor, before me Cora E. Smith
this 10th
day of August, 1905.
Cora E. Smith

Notice of Mining Location.

LODE CLAIM.

To All Whom it May Concern:

This Mining Claim, the name of which is the Morning Star

Mining Claim, situate on lands belonging to the United States of America, in which there are valuable mineral deposits, was entered upon and located for the purposes of exploration and purchase by Aug. Draley

and Charles Blason
(Locator must insert either "a citizen of the United States," or "who has declared his intention to become a citizen of the United States.")

the undersigned, on the 4th day of May 1903

The length of this claim is 1500 feet

and we claim 750 feet

in a westerly direction and

750 feet in a easterly direction from

the center of the discovery shaft, at which this notice is posted, lengthwise of the claim, together with 300

feet in width of the surface grounds, on each side of the center of said claim.

The general course of the lode deposit and premises is from the East

to the West

The claim is situated and located in the Warren Mining District, in

Cochise County, in the Territory of Arizona, about 1/4 of a mile

in a westerly direction from town of

Bisbee and adjoining the patented claim contention on the south.

The Surface boundaries of the claim are marked upon the ground as follows: Beginning at monument

at a point westerly direction 750 feet from

the discovery shaft (at which this notice is posted), being in the center of the westerly

end line of said claim; thence 300 feet to a monument

, being the south west corner of said claim; thence

1500 feet to a monument, being at the

south east corner of said claim; thence 300 feet

to a monument at the center of the easterly end of said claim;

thence 300 feet to a monument being at the

north east corner of said claim; thence 1500

feet to a monument at the north west corner of said claim;

thence 300 feet to the place of beginning.

All done under the provisions of Chapter Six, of Title XXXII, of the Revised Statutes of the United States, and of an Act of the General Assembly of Arizona, entitled "An Act to Revise and Codify the Laws of the Territory of Arizona," approved March 16, 1901.

Dated and posted on the ground this 4th day of May 1903

Witness
R. E. Todd
J. A. Hoopes

A. D. Alley
Charles Blason

Cochise

I,

County Recorder in and for the County and

Territory aforesaid, do hereby certify that the within instrument was filed for record at *9* o'clock *PM* M.,

on this *11th* day of *July* 190*3*, and duly recorded in Book No. *27*

of *Summary* Records of *Cochise* County, Arizona, at pages *248*

WITNESS my hand and official seal the day and year first above written.

Frankston
County Recorder.

*Please return to Charles
Clason box 645
Bisbee Ariz.*

Notice of Location.

LODE CLAIM.

Summary

Dated *11th* 190*3*

Filed and recorded at request of

Charles Clason
July 11th A. D. 190*3*

at *9* M.

Book *27* Records *Marie*.

Pages *248*.

Frankston

County Recorder.

Deputy Recorder.

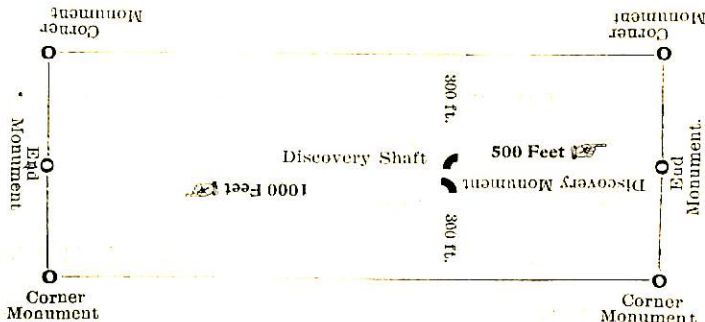

This diagram is to give locator a general idea of plan of location under the new law. The Discovery Shaft can be in the center of claim or any distance from either end desired. In the diagram it is placed 500 feet from one end and 1000 feet from the other. Commence description of claim at a center end monument, giving its distance and direction from center to Discovery Shaft; thence bound the claim in either direction. In description be careful to state locality of claim with reference to some natural object, or permanent monument, as will identify the claim.

U. S. SURVEYOR-GENERAL'S FINAL CERTIFICATE ON FIELD NOTES.

Department of the Interior,

OFFICE OF U. S. SURVEYOR-GENERAL,

Phoenix, Arizona.

Sept. 14", 1905

I, U. S. Surveyor-General for the district of Arizona. do hereby certify that the foregoing transcript of the Field Notes, return and approval of the survey of the mining claim of August Daley and Charles Clason

known as the Morning Star

situate in Warren

Mining District, Cochise County, Arizona.

in Section APPROX., Township No. 23 S., Range No. 24 E. unsurveyed, and

designated as Survey No. 2133, has been correctly copied from the originals on file in

this office; that said Field Notes furnish such an accurate description of said mining claim as will, if incorporated into a patent, serve fully to identify the premises, and that such reference is made therein to natural objects or permanent monuments as will perpetuate and fix the locus thereof.

And I further certify that less than five hundred dollars' worth of labor has been expended or improvements made upon said mining claim by claimant or their grantors, and that said improvements consist of, at time of survey, 1 dis. shaft, value \$100.00

and that no portion of said labor or improvements has been included in the estimate of expenditures upon any other claim.

I further certify that the plat thereof, filed in the U. S. Land Office at Tucson, Arizona. is correct and in conformity with the foregoing Field Notes.

(Signed) Frank S. Ingalls,

United States Surveyor-General for Arizona.

4-687.

SURVEYOR-GENERAL'S CERTIFICATE OF APPROVAL OF FIELD
NOTES AND SURVEY OF MINING CLAIM.

Department of the Interior,

Office of U. S. Surveyor-General,

Phoenix, Arizona.

Sept 14, 1905.

I, U. S. Surveyor-General for ~~the district of Arizona.~~

do hereby certify that the foregoing and hereto attached Field Notes and Return of the Survey of the
Mining Claim of August Daley and Charles Clason,

....., known as the
Morning Star

situate in Warren Mining District,
Cochise County, Arizona.

in Section approx., Township No. 23 S., Range No. 24 E. unsurveyed
....., designated as Survey No. 2133

executed by Franklin W. Smith, U. S. Deputy Mineral
Surveyor, July 23-Aug. 8th 1905., 190....., under my instructions dated

July 20th 1905., 190....., have been critically examined and the necessary cor-
rections and explanations made, and the said Field Notes and Return, and the Survey they describe,
are hereby approved. A true copy of the copy of the location certificate filed by the applicant.. for
survey is included in the field notes.

Frank A. Sigsbee

U. S. Surveyor-General for Arizona.

Survey No. 2133, Morning Star lode.

Situated in Warren Mining District, Cochise County, Territory of Arizona, and owned by August Daley et al.

AFFIDAVIT OF \$500.00 IMPROVEMENTS.

I hereby certify that the value of the labor and improvements on this claim placed thereon by the claimants or their grantors is not less than \$500., and said improvements were placed on the claim before the 1st day of February 1906, and prior to the expiration of the period of publication of the application for patent, and said improvements are as follows:

No. 1	Discovery shaft 4 x 6 x 10 ft. brs from W E C S. 74° 54' E. 750.0 ft. on ledge, value	100.00
No. 2	Open cut 4 x 10 x 18 ft with tunnel 4 x 6 x 35 ft. at face bearing N. 5° E brs from Cor. No. 2 N. 63° 46' W. 152.0 ft., value	400.00
	Total improvements on claim	\$ 500.00

Franklin W. Smith

U. S. Deputy Mineral Surveyor.

Dated at Bisbee, Arizona.

February 9th, 1906.

Affidavit of Five Hundred Dollars Improvements.

We, R. A. Ziesemer and F. P. Severus

of lawful age, being first duly sworn according to law, depose and say: That we are acquainted with the Warring Star mining claim, situate in Warren

mining district, Cochise County, Arizona Territory, for which

August Daley et al

have made application for survey prior to application for patent under the provisions of the Act of Congress

approved May 10, 1872; and that the labor done and improvements made thereon by the applicant, and

him grantor, exceed five hundred dollars in value, and further that we are not personally interested in said mine.

R. A. Ziesemer
F. P. Severus

TERRITORY OF ARIZONA,
COUNTY OF Cochise } ss:

Sworn to and subscribed before me this 9th day

[SEAL.]

of February, 1906.

Clara L. Ralph

11786b400-2-04

NOTARY PUBLIC
In and for the County of Cochise, Territory of Arizona.

My Commission Expires Dec. 20/1909.

(4-691.)

Certificate of U. S. Surveyor General

AS TO

EXPENDITURES REPORTED AFTER RETURN OF SURVEY OF MINING CLAIM.

I, U. S. Surveyor General for the district of Arizona.,
do hereby certify that Five Hundred Dollars' worth of labor has been expended or
improvements made by claimant or their grantors, upon the mining claim of
August Daley et al,

known as the Morning Star,
situate in Warren mining district,
Cochise County, Arizona,
in Section _____, Township No. _____, Range No. _____;

that said improvements consist of Shaft, cut and tunnel, value \$500.00

_____, and that no portion of said labor or improvements has been
included in the estimate of expenditures upon any other claim. A copy of the report of
Franklin W. Smith, U. S. Deputy Mineral Surveyor, dated
Feb. 9, 1906., 18 _____, is hereto attached.

(Signed) Frank S. Ingalls,

U. S. Surveyor General for Arizona.

Office of U. S. Surveyor General,

Phoenix, Arizona.

Feb. 13, 1906, 18 _____

SURVEY NO.
2133

MORNING STAR
SCALE 300 FT = 1 IN

