

MS

0

2

1

4

9

823-1205
35713

Copied by C.L.
Oct 6-1905

copy

(4-683.)

Mineral Survey No. 7149

Lot No. _____

Lawrence Land District.

FIELD NOTES

OF THE SURVEY OF THE MINING CLAIM OF

Naval A Smith

KNOWN AS THE

California, Gregory Lawrence Grant
Warden Mining District,

Cochise County, Arizona

Section 4 Township 23 S, Range 74 E SPB
unsurveyed

Surveyed under instructions dated August 16th, 1905

by Franklin W. Smith
U. S. Deputy Mineral Surveyor

Claim located See notices, 1

Survey commenced August 19th, 1905

Survey completed August 26th, 1905

6-161

Claimants address
Bisbee, Cochise County
Arizona

Ties ✓
Ledges ✓
Dikes ✓
Area ✓

Feet

Beginning at Cor. No. 1 the SE cor identical with location and with Cor. No. 4 Greely lode of this survey, a pine post 4 ft long 4 ins sq set 1 ft in the ground in a mound of stones and scribed 1-2149 C L whence a pine post of same dimensions and scribed B.P. 1-2149 brs $S. 6^{\circ} 56' W. 50$ ft and a second pine post of same dimensions and scribing brs. $N. 6^{\circ} 56' E. 50$ ft and NW cor Sec 2 Tp 24 S R 24 E G & S E & M brs $S. 12^{\circ} 30' 30'' W. 5398.9$ ft.,

Thence $N. 58^{\circ} 46' W.$

- 445.0 to the intersection of Y at French station on the E. P & S. W. R. R. brg. S to Osborne station,
- 650.0 same bearing to Cor. No. 3 and 4 respectively of Greely and Lawrence lodes of this survey,
- 950.0 same bearing to intersection of Y at French station on the E. P & S. W. R. R. brg S to Osborne station, brg W to Don Luis station and brg N through Black Gap to Lovell,
- 1300.0 same bearing to Cor. No. 3 and the NE cor respectively of Lawrence lode of this survey and North Star lodes unsurveyed
- 1500.0 same bearing to Cor. No. 2, the SW cor identical with location a pine post 4 ft long 4 ins sq set 1 ft in the ground in a mound of stones and scribed 2-2149 C L, whence a pine post of same dimensions and scribed B.P. 2-2149 brs $N. 6^{\circ} 56' E. 50$ ft and a second pine post of same dimensions and scribing brs $S. 58^{\circ} 46' W. 50$ ft.,

Thence $N. 6^{\circ} 56' E.$

- 34.1 to the intersection of Line 1-4 Station lode, Survey No. 2120 at $N. 26^{\circ} 31' E. 175.2$ ft from Cor. No. 1,
- 329.0 same bearing to original location for W. E. C.,
- 515.0 same bearing to the intersection of E. P & S. W. R. R. brg W to Don Luis station,
- 653.0 same bearing to Cor. No. 3 the NW cor identical with location a pine post 4 ft long 4 ins sq set 1 ft in the ground in a mound of stones and scribed 3-2149 C L, hence a pine post of same dimensions and scribed B.P. 3-2149 brs $S. 6^{\circ} 56' W. 50$ ft and a second pine post of same dimensions and scribing brs $N. 58^{\circ} 46' E. 50$ ft.,

Feet

209.9
~~25.9~~

Thence S. 58° 46' E.

to Cor. No. 4, identical with Cor. No. 2 Devereux lode, Survey No. 2120, and situated on line 1-4 Station lode, Survey No. 2120 N. 26° 31' E. 745.3 ft from Cor. No. 1, a pine post 4 ft long 4 ins sq set 1 ft in the ground in a mound of stones and scribed 4-2149 C L thence a pine post of same dimensions and scribed B.P. 4-2149 brs N. 58° 46' W. 50 ft and a second pine post of same dimensions and scribing brs S. 57° 56' E. 50 ft

500.0 *to intersection of the Black Gap cut-off of E. P. & S. J. R.R. bearing north to Lowell Station*
540.0 *same bearing* to Cor. No. 5, identical with Cor. No. 1, 2 and 3 respectively Devereux lode, Survey No. 2120, Bridge and Hot Stuff lodes, Survey No. 1918, a pine post 4 ft long 4 ins sq set 1 ft in the ground in a mound of stones and scribed 5-2149 C L, thence a pine post of same dimensions and scribed B.P. 5-2149 brs N. 57° 56' W. 10 ft and a ^{second} pine post of same dimensions and scribing brs S. 50° 22' E. 50 ft.,

Thence S. 50° 22' E.

815.9 along line 3-2 Hot Stuff lode, Survey No. 1918 to Cor. No. 6 the NE cor situated on line 2-3 Don Francisco lode, Survey No. 2111, a pine post 4 ft long 4 ins sq set 1 ft in the ground in a mound of stones and scribed 6-2149 C L, thence a pine post of same dimensions and scribed B.P. 6-2149 brs N. 50° 22' E. 50 ft and a second pine post of same dimensions and scribing brs S. 6° 58' W. 50 ft ⁵⁰ and original location for NE cor brs N. 6° 58' E. 150 ft.,

Thence S. 6° 58' W.

132.0 along line 3-2 Don Francisco lode, Survey No. 2111 to the intersection of the Y at the French station or the E P & S W R R brg West to Don Luis station,
9.7 ~~132.0~~ same bearing to original location for east end center

4

Survey No. 2149
California (Con)

Feet

250.0 same bearing to the intersection of the "Y" at French station on the E P & S W R R bearing south to Osborne,
269.0 same bearing to Cor.No.2 and 3 respectively of Don Francisco lodes, Survey No.2111, and ~~Saint~~^{Saint} Ansgar lode, Survey No.2112,
518.7 same bearing to Cor.No.1 the place of beginning.

Ledge.

The presumed course of the vein on this claim is from the S E C location N. $58^{\circ} 46'$ W. 1500 ft.

GREELY

Beginning at Cor.No.1 the ~~D~~ cor identical with location and with Cor.No.4 Grant lode of this survey a pine post 4 ft long 4 ins sq set 1 ft in the ground in a mound of stones and scribed 1-2149 G L whence a pine post of same dimensions and scribed B. P. 1-2149 brs. N. $6^{\circ} 58'$ E. 50 ft., and a second pine post of same dimensions and scribing brs. S. $6^{\circ} 56'$ W. 50 ft., and NW cor sec 2 Tp 24 S R 24 E G & S R B & M brs. S. $14^{\circ} 39'$ W. 3908.6 ft.,

Thence N. $58^{\circ} 46'$ W

335.0 to original location for S E C.,

650.0 same bearing to Cor.No.2 the SW cor identical with location and with Cor.No.1 Lawrence lode of this survey, a pine post etc scribed 2-2149 G L,

Thence N. $6^{\circ} 56'$ E

1295.0 to the intersection of the "Y" at French Station on the E.P & S W R R bearing South to Osborne,

1500.0 same bearing to Cor.No.3, the NW cor identical with location and with Cor.No.4 Lawrence lode of this survey a pine post 4 ft long 4 ins sq set 1 ft in the ground in a mound of stones and scribed 3-2149 G L whence a pine post of same dimensions and scribed B. P. 3-4-2149 brs. N. $58^{\circ} 43'$ W. 50 ft and a second pine post of same dimensions and scribing brs S. $58^{\circ} 46'$ E. 50 ft.,

(3)

Feet

Thence S. $58^{\circ} 46'$ E.
 325.0 along line 2-1 California lode of this survey to original
 location for NE C.,
 650.0 same bearing to Cor.No. 4 the NE cor identical with loca-
 tion and with Cor.No.1 California lode of this survey a
 pin post etc and scribed 4-2149 G L,
 Thence S. $6^{\circ} 56'$ W.
 378.9 to Cors.No.2 and 3 respectively of *Saint* Ansgar and Osage
 lodes, Survey No.2112,
 1007.5 same bearing to Cors No.2 and 3 respectively of Osage and
 Mitchell lodes, Survey No.2112,
 1500.0 same bearing to Cor.No.1 the place of beginning.

Ledge.

The presumed course of the vein on this claim is
 from the N E C location brs. S. $6^{\circ} 56'$ W. 1500 ft.

 LAWRENCE
 O

Beginning at Cor.No.1, the SE cor identical with lo-
 cation and with Cor.No.2 Greely lode of this survey a pine
 post 4 ft long 4 ins sq set 1 ft in the ground in a mound
 of stones and scribed 1-2149 L E whence a pine post of
 same dimensions and scribed B. P.21-2149 brs. S. $58^{\circ} 46'$ E
 50 ft and a second pine post of same dimensions and scribing
 brs. N. $58^{\circ} 46'$ W. 50 ft., and NW cor Sec 2 Tp 24 S R 24
 E G & S R E2 M brs. S. $5^{\circ} 59' 30''$ W. 4141.3 ft.,

Thence N. $58^{\circ} 46'$ W.

187.1 to the intersection of the E P & S W R R ., bearing S. to
 Osborne station,
 325.0 same bearing to original location for S E C.,
 650.0 same bearing to Cor.No.2, the SW cor identical with lo-
 cation and with the SE cor of North Star lode, unsurveyed
 a pine post 4 ft long 4 ins sq set 1 ft in the ground in a
 mound of stones and scribed 2-2149 L L, and a pine post of

Feet

same dimensions and scribed B. P. 2-2149 brs S. 58° 46'E
50 ft and a second pine post of same dimensions and scribing
brs. N. 6° 56' E. 50 ft.,

Thence N. 6° 56' E

1500.0 to Cor.No.3, the NE cor identical with location and with
the NE cor North Star lode, unsurveyed, a pine post 4 ft
long 4 ins sq set 1 ft in the ground in a mound of stones
and scribed 3-2149 L L whence a pine post of same dimensions
and scribed B. P. 3-2149 brs. S. 58° 46' E. 50 ft and a
second pine post of same dimensions and scribing brs.
S. 6° 56' W. 50 ft.,

Thence S. 58° 46'E.

325.0 to original location for N E C.,

650.0 same bearing to Cor.No.4, the NE cor identical with lo-
cation and with Cor.No.3 Greely lode of this survey a pine
post etc and scribed 4-2149 L L

Thence S. 6° 56' W.

1500.0 to Cor.No.1 the place of beginning.

Legal.

The presumed course of the vein on this claim is from
the NE C location S. 6° 56' W. 1500 ft.

G R A N T.

Beginning at Cor No.1, the SE cor identical with lo-
cation and with Cor.No.5, Square lode, Survey No.2150
a pine post 4 ft long 4 ins sq set 1 ft in the ground in
a mound of stones and scribed 1-2149 GrL whence a pine
post of same dimensions and scribed B. P. 1-2149 brs N
56° 48' W. 50 ft and a second pine-post of same dimensions
and scribing brs. N. 6° 56' E. 50 ft., and NW cor Sec 2
Tp 24S R 24 E G & S R B & M brs. S. 16° 12' W. 3257.8 ft.

Thence N. 58° 46' W

816.6 to the intersection of the W P & S W R R., bearing S. to
(5)

Feet

- Osborne station
- 1440.6 same bearing to the intersection of the E E line of Wolverine lode, unsurveyed at S. $5^{\circ} 15' W$. 297.3 ft from the NE cor.,
- 1462.1 same bearing to Cor.No.2, the SW cor identical with location a pine post 4 ft long 4 ins sq set 1 ft in the ground in a mound of stones and scribed 2-2149 Gr L whence a pine post of same dimensions and scribed B. P. 2-2149 brs S. $58^{\circ} 46' E$ 50 ft and a second pine post of same dimensions and scribing brs. N. $6^{\circ} 56' E$. 50 ft..
- 297.3 Thence N. $6^{\circ} 56' E$. to the intersection of the N side line of Wolverine lode unsurveyed at N. $58^{\circ} 15' W$. 170 ft from the NE and the intersection of S side line of Bisbee lode unsurveyed at N. $58^{\circ} 15' W$. 12 ft from the SW cor
- 329.0 same bearing to original location for W E C.
- 658.0 same bearing to Cor.No.3 the NW cor identical with location whence S.E. Cor. Bisbee lode brs. S. $5^{\circ} 15' W$ 369.9 ft. and the NE cor of Bisbee lode, unsurveyed, a pine post 4 ft long 4 ins sq set 1 ft in the ground in a mound of stones and scribed 3-2149 Gr L, whence a pine post of same dimensions and scribed B.P.3-2149 brs. S. $6^{\circ} 56' W$. 50 ft and a second pine post of same dimensions and scribing brs. S. $58^{\circ} 46' E$. 50 ft.,
- Thence S. $58^{\circ} 46' E$.
- 162.1 to the SE and Cor.No.2 respectively of North Star lode unsurveyed and Lawrence lode of this survey,
- 812.1 same bearing to Cors.No.1 and 2 respectively of Lawrence and Greely lodes of this survey,
- 1462.1 same bearing to Cor.No.4, the NE cor identical with location and with Cor.No.1 Greely lode of this survey, a pine post etc and scribed 4-2149 Gr L,
- Thence S. $6^{\circ} 56' W$.
- 125.1 to Cors.No.2 and 3 respectively of Mitchell lode, Survey No.2112, and Carpenter lode, Survey No.2117,

Feet

329.0 same bearing to original location for H E C.,
652.0 same bearing to Cor.No.1 the place of beginning.

Ledge.

The presumed course of the vein on this claim is
from the H. E. C location N. 58° 46' W. 1462.1 ft.,

A R E A .

Total area California lode,	19, 445 ⁴³⁸ ac ✓
Less area in conflict with Station lode Survey No. 2120	<u>1, 444³⁷⁰ ac.</u>
Net area California lode,	18,068 ac. ✓
Total and net area Greely, Lawrence,	20,400 ✓ 20,400 ✓
Total area Grant lode,	20,129 ac ✓
Less area in conflict with Bisbee lode, unsurveyed,	0.046 ✓
Less area in conflict with Wolverine lode, unsurveyed,	<u>0.103 ✓ .149 ✓</u>
Net area Grant lode	<u>19,980 ac.</u> ✓
Net area group,	78,848 ac. ✓

IMPROVEMENTS.

I certify that the value of the labor and improvements
on this group placed thereon by the claimant or his grantors
is not less than \$500 for each location thereof, and that
said improvements consist of:

California.

No.1	Discovery shaft 4x6x10 ft brs from W E C location S. 52° 46' E. 180 ft. Value,	\$100.00
No.2	Shaft 4x6x10 ft brs from W E C. S. 58° 46' E. 258 ft.	100.00
No.3.	Shaft 4x6x10 ft brs from W E C location S. 58° 46' E. 324 ft., Value,	100.00
No.4	Shaft 4x6x10 ft brs from W E C. location S. 58° 46' E. 388 ft., Value,	100.00
No.5	Shaft 4x6x10 ft (discovery shaft) brs from W E C S. 58° 46' E. 450 ft., Value,	<u>100.00</u>
	Total improvements	500.00

California, et al (con)

Improvements.

Greely.		
No.1	Discovery shaft 4x6x10 ft brs from S E C N. 6° 56' E. 200 ft Value,	\$100.00
No.2	Shaft 4x6x10 ft brs from Cor.No.2 N. 52° 45' E. 245 ft., Value,	100.00
No.3	Shaft 4x6x10 ft brs from Cor.No.2, N. 48° 38' E. 260 ft Value,	100.00
No.4	Shaft 4x6x10 ft brs from Cor.No.3, S.10° 57'E.220 ft., Value,	100.00
No.5	Shaft 5x7x20 ft brs from CorNo.3, S.21° 11'E.375 ft., Value,	<u>200.00</u>
	Total improvements Greely lode,	600.00
Lawrence.		
No.1	Discovery shaft 4x6x10 ft brs from S E C location N. 6° 56' E. 620 ft., Value,	\$100.00
No.2	Shaft 4.8x10 ft brs from Cor.No.3, S.35° 13'E.315 ft Value,	120.00
No.3	Shaft 5x7x20 ft brs from Cor.No.3, S. 40° 35' E. 305 ft Value,	200.00
No.4	Shaft 4x6x10 ft brs from Cor.No.3, S.43° 15' E. 145 ft Value,	<u>100.00</u>
No.5	Total improvements Lawrence lode,	5 ² 40.00
Grant.		
No.1	Discovery shaft 4x6x10 ft brs from E E C location N 53° 46' W. 770 ft., Value,	\$100.00
No.2	Shaft 4x6x10 ft brs from Cor.No.4, S. 59° 15' W. 418 ft., Value,	100.00
No.3	Shaft 4x6x10 ft brs from Cor.No.4 N. 75° 10' W. 595 ft., Value,	100.00
No.4	Shaft 4x6x20 ft brs from Cor.No.4, N. 72° 22' W. 602 ft., Value,	<u>200.00</u>
	Total improvements Grant lode,	500.00 <u>500.00</u>
(8)	Total improvements on group	\$ 21 ² 20.00

Survey No. 2149
California et al lodes,

Adjoining claims.

North Bridge and Hot Stuff lodes, Survey No. 1912, I. W. Wallace et al owners; Devereux lode, Survey No. 2120, owned by applicant herein.

East Don Francisco lode, Survey No. 2111, Saint Amgar, Osage and Mitchell lodes, Survey No. 2112, and Carpenter lode, Survey No. 2117, same owner.

South. Square lode, Survey No. 2150, same owner"

West. Wolverine, ^{Triangle} Bisbee, North Star, lodes unsurveyed, and Station lode, Survey No. 2120, same owner.

Location.

This survey is located about $\frac{1}{4}$ mi South of Black Gap and about 2 mi in an easterly direction from Don Luis Station on the M P & S W R R on unsurveyed lands in Warren Mining District, Cochise County, Arizona, approximately in T₂₃ S R 24 E G & S R B & M.,

Instrument.

This survey was made with a J. L. Berger & Son No. 1 G transit, the courses were deflected from the true meridian as determined by solar observation checked by an observation on Polaris. The distances were measured with a 300-ft. steel tape.

Magnetic variation 12° 30' E.

Sept 2nd 1905

Franklin W. Smith
U. S. Deputy Mineral Surveyor.

Note.

Any discrepancies between the courses and distances of this survey and those of the adjoining approved surveys are due to errors in the latter.

FINAL OATHS FOR SURVEYS.

LIST OF NAMES.

A list of the names of the individuals employed by Franklin W Smith

United States Deputy Mineral Surveyor, to assist in running, measuring, and marking the lines, corners, and boundaries described in the foregoing field notes of the survey of the mining claim of _____

Howel A Smith
known as the California, Greeley, Lawrence, Grant

and showing the respective capacities in which they acted.

W. A. Ziesemer Chairman.
F. C. Beverence, Chairman.

_____, Arman.

_____, Flagman.

FINAL OATHS OF ASSISTANTS.

We, W. A. Ziesemer

and F. C. Beverence do solemnly swear that we assisted Franklin W Smith

United States Deputy Mineral Surveyor, in marking the corners and surveying the boundaries of the mining claim of Howel A Smith

known as the California, Greeley, Lawrence, Grant

represented in the foregoing field notes as having been surveyed by said deputy mineral surveyor and under his direction; and that said survey has been in all respects, to the best of our knowledge and belief, faithfully and correctly executed, and the corner and boundary monuments established according to law and the instructions furnished by the United States Surveyor-General for Arizona

W. A. Ziesemer, Chairman.

F. C. Beverence, Chairman.

_____, Arman.

_____, Flagman.

Subscribed and sworn to by the above-named persons before me this 2nd

day of September, 1902.

Corral Smith

(4-686.)

FINAL OATH OF U. S. DEPUTY MINERAL SURVEYOR

I, Franklin W Smith, U. S. Deputy Mineral Surveyor, do solemnly swear that, in pursuance of instructions received from the United States Surveyor General for Arizona, dated August 16th 1905, I have, in strict conformity to the laws of the United States, the official regulations and instructions thereunder, and the instructions of said Surveyor General, faithfully and correctly executed the survey of the Mining Claim of Hovard A Smith

California, Gentry, Lawrence, Grant, known as the Warrant situate in Coconino Mining District, Coconino County, Arizona, in Section 36 Township No. 23 N Range No. 7 E Grand Staircase and designated as Survey No. 2149, as represented

in the foregoing field notes, which accurately show the boundaries of said mining claim as distinctly marked by monuments on the ground, and described in the attached copy of the location certificate, which was received by me from the Surveyor General with said instructions, and that all the corners of said survey have been established and perpetuated in strict accordance with the law, official regulations and instructions thereunder; and I do further solemnly swear that the foregoing are the true and original field notes of said survey and my report therein, and that the labor expended and improvements made upon said mining claim by claimant or his grantors are as therein fully stated, and that the character, extent, location and itemized value thereof are specified therein with particularity and full detail, and that no portion of said labor or improvements so credited to this claim has been included in the estimate of expenditures upon any other claim.

Franklin W Smith
U. S. Deputy Mineral Surveyor.

Subscribed and sworn to by the said Franklin W Smith
U. S. Deputy Mineral Surveyor, before me Lora E Smith
this 25
day of September, 1905

Lora E Smith

Affidavit of Five Hundred Dollars Improvements.

We, R.A. Giesemer and J.C. Severens

of lawful age, being first duly sworn according to law, depose and say: That we are acquainted with the California, Greeley Lawrence, Grant mining claim, situate in Marion

mining district, Cochise County, Arizona Territory, for which

Harold A. Smith

has made application for survey prior to application for patent under the provisions of the Act of Congress

approved May 10, 1872; and that the labor done and improvements made thereon by the applicant and

his grantor for each location exceed five hundred dollars in value, and further that we are not personally interested

in said mine.

R.A. Giesemer
J.C. Severens

TERRITORY OF ARIZONA, }
COUNTY OF Cochise } ss:

Sworn to and subscribed before me this 2nd day

of September, 1905

[SEAL.]

Carroll Smith

Territory of Arizona, (ss.)
County of Cochise.

...in the place of being...
...of Title 28... Revised Statutes of...
...approved March 12, 1901

I, Frank Hare, County Recorder in and for said County, hereby certify that I have compared the foregoing copy with the Amended Location Notice of the Grant Mining Claim, filed and recorded in my office on the 11th day of August 1905, in Book 34, at page 409, Record of Mines, and that the same is a full, true and correct copy of such original and of the whole thereof.

Witness my hand and seal of office this 12th day of August, 1905.

Frank Hare
County Recorder.

...at ... of ... 1905 ...
... Book 34, Record of Mines ...

AMENDED

Notice of Mining Location

LODE CLAIM

To All Whom it May Concern:

This Mining Claim, the name of which is the Grant Mining Claim, situate on lands belonging to the United States of America, and in which there are valuable mineral deposits, was entered upon and located for the purposes of exploration and purchase by Walter J. Smith

a citizen of the United States
(Locator must insert either "a citizen of the United States," or, "who has declared his intention to become a citizen of the United States.")

the undersigned, on the 8th day of August 1905

The length of this claim is Eight Hundred (800) feet, and I claim Seven Hundred (700) feet, in a westerly direction and Eight Hundred (800) feet in a Easterly direction from the center of the discovery shaft, at which this notice is posted, lengthwise of the claim, together with Three Hundred feet in width of the surface grounds, on each side of the center of said claim. The general course of the lode deposit and premises is from the East to the West.

The claim is situated and located in the Maricopa Mining District, in Pochise County, in the Territory of Arizona, about 4 miles in a South Easterly direction from Dodge and is bounded on the North by Lawrence and Sully Mining Claims and on the East by the Garretts Agency No. 7117.

The surface boundaries of the claim are marked upon the ground as follows: Beginning at a post

at a point in a westerly direction about 700 feet from the discovery shaft (at which this notice is posted), being in the center of the west end line of said claim; thence northwesterly about 300 feet to a post and monument, being the north west corner of said claim; thence easterly about 1500 feet to a post and monument, being at the north East corner of said claim; thence southerly about 300 feet to a post and monument at the center of the east end of said claim; thence southerly about 300 feet to a post and monument, being at the south east corner of said claim; thence westerly about 1500 feet to a post and monument at the south west corner of said claim; thence northwesterly about 300 feet to the place of beginning.

All done under the provisions of Chapter Six, of Title XXXII, of the Revised Statutes of the United States, and of an Act of the General Assembly of Arizona, entitled "An Act to Revise and Codify the Laws of the Territory of Arizona," approved March 16, 1901.

This is an Amended Location Notice of the Grant Mining Claim, located by Walter J. Smith and D. St. Anderson on the 8th day of July 1905, and recorded in Book 22 of Record of Mines, at page 174, in the office of the County Recorder of the aforesaid County of Pochise to which reference is hereby made, and this amended Location Notice is made and posted to correct errors in the description in the said original Location Notice.

Dated and posted on the ground this 8th day of August 1905

Walter J. Smith
Walter J. Smith

Filed and recorded at request of E.W. Armstrong, Aug. 11, 1905 at 9 A. M. Book 34, Record of Mines at page 409.

TELEPHONE
COUNTY
OFFICE
RECORDS
DEPARTMENT
PHOENIX

Territory of Arizona, (corner
 (ss.
 County of Cochise.

I, Frank Hare, County Recorder in and for said County, hereby certify that I have compared the foregoing copy with the Amended Location Notice of the Leely Mining Claim, filed and recorded in my office on the 11th day of August of 1905, in Book 21 at page 48, Record of Mines, and that the same is a full, true and correct copy of such original and of the whole thereof.

Witness my hand and seal this 12th day of August, 1905.

Mining Claim, located by

Frank Hare
 County Recorder.

AMENDED

Notice of Mining Location

LODE CLAIM

To All Whom it May Concern:

This Mining Claim, the name of which is the Greely Mining Claim, situate on lands belonging to the United States of America, and in which there are valuable mineral deposits, was entered upon and located for the purposes of exploration and purchase by Arval G. Smith

a citizen of the United States.
(Locator must insert either "a citizen of the United States," or, "who has declared his intention to become a citizen of the United States.")

the undersigned, on the 8th day of August 1905

The length of this claim is Fifteen Hundred (1500) feet, and 2 claim Two Hundred (200) feet, in a Southerly direction and North Hundred (100) feet in a Westerly direction from the center of the discovery shaft, at which this notice is posted, lengthwise of the claim, together with Three Hundred (300) feet in width of the surface grounds, on each side of the center of said claim. The general course of the lode deposit and premises is from the North to the South

The claim is situated and located in the Greely Mining District, in Yochimo County, in the Territory of Arizona, about 2 miles in a South Easterly direction from Greely, and is bounded on the North by the California and on the East by the Grege and St. Inegal Lode Claims Survey No. 7117

The surface boundaries of the claim are marked upon the ground as follows: Beginning at a post

at a point in a Southerly direction about 200 feet from the discovery shaft (at which this notice is posted), being in the center of the South end line of said claim; thence westerly about 300 feet to a post and monument, being the North West corner of said claim; thence northerly about 150 feet to a post and monument, being at the North West corner of said claim; thence easterly about 300 feet to a post at the center of the North end of said claim; thence easterly about 300 feet to a post and monument, being at the North East corner of said claim; thence southerly about 150 feet to a post and monument at the South East corner of said claim; thence westerly about 300 feet to the place of beginning.

All done under the provisions of Chapter Six, of Title XXXII, of the Revised Statutes of the United States, and of an Act of the General Assembly of Arizona, entitled "An Act to Revise and Codify the Laws of the Territory of Arizona," approved March 16, 1901.

This is an Amended Location Notice of the Greely Mining Claim, located by Arval G. Smith on the 7th day of July 1902, and recorded in Book 22 of Record of Mines, at page 71, in the office of the County Recorder of the aforesaid County of Yochimo to which reference is hereby made, and this amended Location Notice is made and posted to correct errors in the description in the said original Location Notice.

Dated and posted on the ground this 8th day of August 1905

Witness Arval G. Smith

Filed and recorded at request of E.W. Armstrong, Aug. 11, 1905 at 9 A. M. Book 34, Record of Mines, at page 408.

TERRITORY OF ARIZONA,
 County of..... } ss

I....., County Recorder in and for the County and
 Territory aforesaid, do hereby certify that the within instrument was filed for record at..... o'clock..... M.,
 on this..... day of..... 190... and duly recorded in Book No.....
 of..... Records of..... County, Arizona, at pages.....
 WITNESS my hand and official seal the day and year first above written.

County Recorder.

AMENDED
Notice of Location.
 LODE CLAIM.

W. J. Kelly

Dated..... 190.....

Filed and Recorded at request of

..... A. D. 190.....

at..... M.

Book

Pages

County Recorder.

By..... Deputy Recorder.

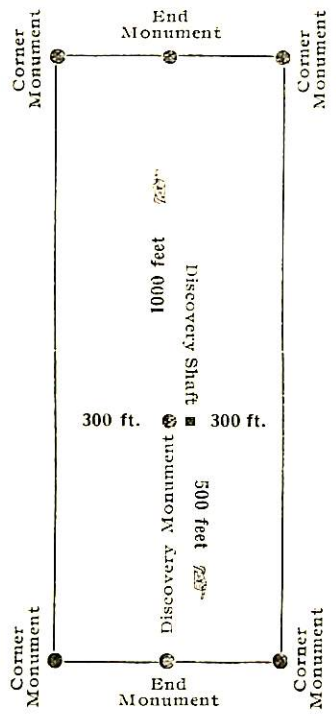

This diagram is to give locator a general idea of plan of location under the new law. The Discovery Shaft can be in the center of claim or any distance from either end desired. In the diagram it is placed 500 feet from one end and 1000 feet from the other. Commence description of claim at a center end monument, giving its distance and direction from center of Discovery Shaft; thence bound the claim in either direction. In description be careful to state locality of claim with reference to some natural object, or permanent monument, as will identify the claim.

J. B. ROBERT, J. J. ... TO ...
 ...
 ...

Territory of Arizona, {
County of Cochise. { ss.

I, Frank Hare, County Recorder in and for said County, hereby certify that I have compared the foregoing copy with the Amended Location Notice of the Lawrence Mining Claim, filed and recorded in my office on the 11th day of August, 1905 in Book 34, at page 412, Record of Mines, and that the same is a full, true and correct copy of such original and of the whole thereof.

Witness my hand and seal of office this 12th day of August, 1905

Frank Hare
County Recorder.

Filed for record in the office of the County Recorder, Arizona, August 11, 1905

W. H. ...

...

AMENDED

Notice of Mining Location

LODE CLAIM

To All Whom it May Concern:

This Mining Claim, the name of which is the Lawrence Mining Claim, situate on lands belonging to the United States of America, and in which there are valuable mineral deposits, was entered upon and located for the purposes of exploration and purchase by Novel J. Smith

a citizen of the United States
(Locator must insert either "a citizen of the United States," or, "who has declared his intention to become a citizen of the United States.")

the undersigned, on the 8th day of August 1905

The length of this claim is Fifteen Hundred (1500) feet, and 1 claim Six Hundred (600) feet, in a Southerly direction and Nine Hundred (900) feet in a Northerly direction from the center of the discovery shaft, at which this notice is posted, lengthwise of the claim, together with Three Hundred (300) feet in width of the surface grounds, on each side of the center of said claim. The general course of the lode deposit and premises is from the North to the South.

The claim is situated and located in the Yavapai Mining District, in Yavapai County, in the Territory of Arizona, about 4 miles in a South Westerly direction from Bisbee, and is bounded on the west by the North Star Claim, on the north by the California Claim and on the East by the Tracy.

The surface boundaries of the claim are marked upon the ground as follows: Beginning at a post

at a point in a southerly direction about 600 feet from the discovery shaft (at which this notice is posted), being in the center of the south end line of said claim; thence westwardly about 300 feet to a post and monument, being the south west corner of said claim; thence westwardly about 1500 feet to a post and monument, being at the westward corner of said claim; thence eastwardly about 600 feet to a post at the center of the north end of said claim; thence eastwardly about 300 feet to a post and monument, being at the north east corner of said claim; thence southerly about 1500 feet to a post and monument at the south east corner of said claim; thence westwardly about 300 feet to the place of beginning.

All done under the provisions of Chapter Six, of Title XXXII, of the Revised Statutes of the United States, and of an Act of the General Assembly of Arizona, entitled "An Act to Revise and Codify the Laws of the Territory of Arizona," approved March 16, 1901.

This is an Amended Location Notice of the Lawrence Mining Claim, located by Chas. Mills and A. W. Anderson on the 10th day of February 1902, and recorded in Book 70 of Record of Mines, at page 211, in the office of the County Recorder of the aforesaid County of _____ to which reference is hereby made, and this amended Location Notice is made and posted to correct errors in the description in the said original Location Notice.

Dated and posted on the ground this 8th day of August 1905

Witness Novel J. Smith
A. W. Anderson

Filed and recorded at request of E.W. Armstrong, Aug. 11, 1905 at 9 A. M. Book 34, Record of Mines, XX page 412.

TERRITORY OF ARIZONA,
County of..... } ss

I,..... County Recorder in and for the County and Territory aforesaid, do hereby certify that the within instrument was filed for record at..... o'clock,..... M., on this..... day of..... 190... and duly recorded in Book No..... of..... Records of..... County, Arizona, at pages.....
WITNESS my hand and official seal the day and year first above written.
County Recorder.

AMENDED
Notice of Location.

LODE CLAIM.

Lawrence

Dated..... 190.....

Filed and Recorded at request of

..... A. D. 190.....

at..... M.

Book

Pages

County Recorder.

By

Deputy Recorder.

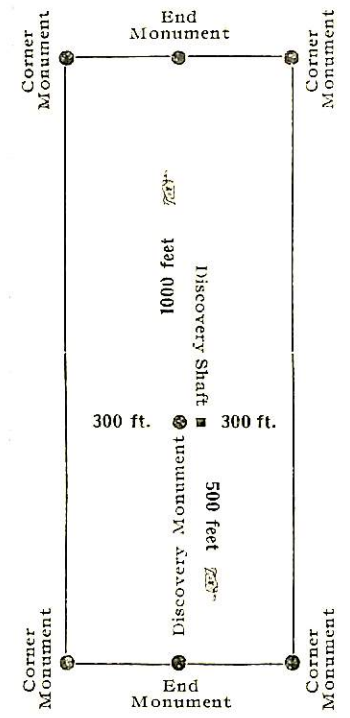

This diagram is to give locator a general idea of plan of location under the new law. The Discovery Shaft can be in the center of claim or any distance from either end desired. In the diagram it is placed 500 feet from one end and 1000 feet from the other. Commence description of claim at a center end monument, giving its distance and direction from center of Discovery Shaft; thence bound the claim in either direction. In description be careful to state locality of claim with reference to some natural object, or permanent monument, as will identify the claim.

TO THE REGISTER OF DEEDS, PHOENIX, ARIZONA, FOR RECORD AND INDEXING TO PROOF OF LOCATION.

Territory of Arizona, (ss.)
County of Cochise. (

I, Frank Hare, County Recorder in and for said County, hereby certify that I have compared the foregoing copy with the Amended Location Notice of the California ~~YV~~ Mining Claim, filed and recorded in my office on the 11th day of August, 1905, in Book 39 at page 414, Record of Mines, and that the same is a full, true and correct copy of such original and of the whole thereof.

Witness my hand and seal this 12th day of August, 1905.

This is an amended location notice of the Mining Claim known as

Frank Hare
County Recorder.

... in Book ... of ...
... Location Notice ...
... said original Location Notice

... on the ground ...

AMENDED
Notice of Mining Location
LODE CLAIM

To All Whom it May Concern:

This Mining Claim, the name of which is the California
Mining Claim, situate on lands belonging to the United States of America, and in which there
are valuable mineral deposits, was entered upon and located for the purposes of exploration and
purchase by Stoval T. Smith

A citizen of the United States
(Locator must insert either "a citizen of the United States," or, "who has declared his intention to become a citizen of the United States.")

the undersigned, on the 8th day of August 1905

The length of this claim is Fifteen Hundred (1500) feet,
and 4 claim Four Hundred (400) feet,
in a westerly direction and Eleven
Hundred West feet in a Easterly direction from
the center of the discovery shaft, at which this notice is posted, lengthwise of the claim, together
with Three Hundred (300) feet in width of the surface grounds, on each
side of the center of said claim. The general course of the lode deposit and premises is from the
East to the West

The claim is situated and located in the Maricopa Mining District, in
Yavapai County, in the Territory of Arizona, about 1 mile
in a North westerly direction from Dische and is
bounded on the North by the Bridge and
Key-Well Mining Claims Survey 1918 and on the
East by the San Francisco Lode Survey No 711

The surface boundaries of the claim are marked upon the ground as follows: Beginning at
a post

at a point in a Westerly direction about 400 feet from
the discovery shaft (at which this notice is posted), being in the center of the west
end line of said claim; thence Northwesterly about 300 feet to a post and
monument, being the North west corner of said claim; thence
westerly about 1500 feet to a post of monument, being at the
north east corner of said claim; thence southwesterly about 300 feet
to a post at the center of the east end of said claim;
thence southwesterly about 300 feet to a post of monument, being at the
south East corner of said claim; thence westerly about 1500
feet to a post and monument at the south west corner of said claim;
thence Northwesterly about 300 feet to the place of beginning.

All done under the provisions of Chapter Six, of Title XXXII, of the Revised Statutes of
the United States, and of an Act of the General Assembly of Arizona, entitled "An Act to
Revise and Codify the Laws of the Territory of Arizona," approved March 16, 1901.

This is an Amended Location Notice of the California
Mining Claim, located by Stoval T. Smith and
A. J. Anderson on the 10th day of
February 1902, and recorded in Book 70 of Record of Mines, at
page 202, in the office of the County Recorder of the aforesaid County of Yavapai
to which reference is hereby made, and this amended Location Notice is made and posted to
correct errors in the description in the said original Location Notice.

Dated and posted on the ground this 8th day of August 1905

Witness A. J. Anderson Stoval T. Smith

Filed and recorded at request of E.W. Armstrong, Aug. 11, 1905 at
9 A. M. Book 34, Record of Mines, at page 414

TERRITORY OF ARIZONA,
County of..... } ss

I....., County Recorder in and for the County and Territory aforesaid, do hereby certify that the within instrument was filed for record at..... o'clock..... M., on this..... day of..... 190..., and duly recorded in Book No..... of..... County, Arizona, at pages.....
WITNESS my hand and official seal the day and year first above written.
County Recorder.

AMENDED
Notice of Location.
LODE CLAIM.

Salisbury

Dated..... 190.....

Filed and Recorded at request of

..... A. D. 190.....

at..... M.

Book

Pages

County Recorder.

By..... Deputy Recorder.

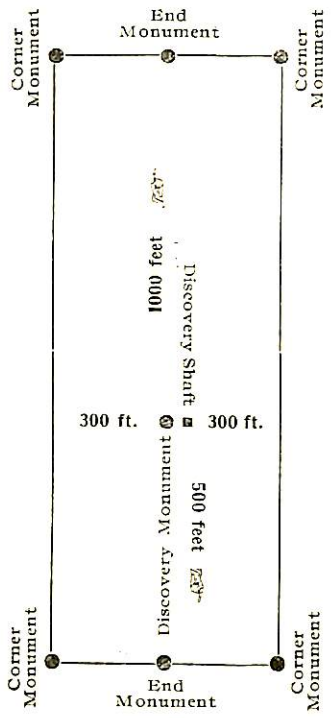

This diagram is to give locator a general idea of plan of location under the new law. The Discovery Shaft can be in the center of claim or any distance from either end desired. In the diagram it is placed 500 feet from one end and 1000 feet from the other. Commence description of claim at a center end monument, giving its distance and direction from center of Discovery Shaft; thence bound the claim in either direction. In description be careful to state locality of claim with reference to some natural object, or permanent monument, as will identify the claim.

IN ANSWER TO A RESOLUTION PASSED BY THE BOARD OF SUPERVISORS OF THE COUNTY OF COCONINO, ARIZONA, ON THE 11TH DAY OF MARCH, 1908, RELATIVE TO THE LOCATION OF LODE CLAIMS.

4-688.

U. S. SURVEYOR-GENERAL'S FINAL CERTIFICATE ON FIELD NOTES.

Department of the Interior,

OFFICE OF U. S. SURVEYOR-GENERAL,

Phoenix, Arizona.

Oct 20, 1905

I, U. S. Surveyor-General for Arizona

do hereby certify that the foregoing transcript of the Field Notes, return and approval of the survey of the mining claim of Hoval A. Smith

known as the California, Greely, Lawrence, Grant.

situate in Warren

Mining District, Cochise County, Arizona

in Section Approx., Township No. 23 S., Range No. 24 E. (unsur), and designated as Survey No. 2149, has been correctly copied from the originals on file in this office; that said Field Notes furnish such an accurate description of said mining claim as will, if incorporated into a patent, serve fully to identify the premises, and that such reference is made therein to natural objects or permanent monuments as will perpetuate and fix the locus thereof.

And I further certify that five hundred dollars' worth of labor has been expended or improvements made upon ^{each of} said mining claim by claimant or his grantors, and that said improvements consist of 18 Shafts, Total Value, \$21,200.00, at least \$500. of which is on each claim.

and that no portion of said labor or improvements has been included in the estimate of expenditures upon any other claim.

I further certify that the plat thereof, filed in the U. S. Land Office at Phoenix Arizona is correct and in conformity with the foregoing Field Notes.

(Signed) Frank S. Ingalls.

United States Surveyor-General for Arizona.

4-687.

SURVEYOR-GENERAL'S CERTIFICATE OF APPROVAL OF FIELD NOTES AND SURVEY OF MINING CLAIM.

Department of the Interior,

Office of U. S. Surveyor-General,

Phoenix, Arizona

Oct. 20, 1905

I, U. S. Surveyor-General for Arizona

do hereby certify that the foregoing and hereto attached Field Notes and Return of the Survey of the Mining Claim of Hoval A. Smith

known as the California, Greely, Lawrence, Grant.

situate in Warren Mining District, Cochise County, Arizona

in Section APPROX., Township No. 23 S., Range No. 24 E. (unsur.) designated as Survey No. 2149

executed by Franklin W. Smith, U. S. Deputy Mineral

Surveyor, August 19th to August 26th, 1905, under my instructions dated

August 16th, 1905, have been critically examined and the necessary cor-

rections and explanations made, and the said Field Notes and Return, and the Survey they describe,

are hereby approved. A true copy of the copy of the location certificate filed by the applicant for

survey is included in the field notes.

[Handwritten signature]

U. S. Surveyor-General for Arizona.

SURVEY NO

2149

SCALE 300 FT. = 1 IN.

