

**M  
S**  
-

**0**

**2**

**1**

**7**

**1**

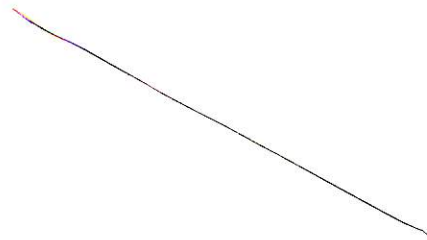

002191905 1

(4-683.)

Mineral Survey No. 2171

Lot No. ....

Yuma Land District.

### FIELD NOTES

OF THE SURVEY OF THE MINING CLAIM OF

Stirling Gold and Copper Co

KNOWN AS THE

Chispa and Rincon  
West Huachuca Mining District,  
Cochise County, Arizona

Section     , Township 23S, Range 20 E. unsurveyed

Surveyed under instructions dated Sept 28, 1905

by John A. Rockfellow  
U. S. Deputy Mineral Surveyor.

Claim located See notices, 1

Survey commenced Sept 30, 1905

Survey completed Oct 5, 1905

o 6-160

Address of Claimants  
Daniel McPherson - Pres & Genl Manager  
1308 to 1350 Sixteenth St  
San Francisco  
Cal

## SURVEY, NO. 2171.

## CHIRSPA LODE.

Beginning at Cor. No. 1, the N. W. Cor. of location, a mound of stone; set a juniper post 4 ft. long, 7 inches diameter, 6 ins in the ground to bed rock, ~~in~~ a mound of stone, scribed N W C - C 1 -2171.

## Whence:

- 1) U. S. L. M. No. 2171 bears S 62° 07' E, 96.0 ft.
- 2) A stone monument bears S 75° 15' W, 7 ft.

Thence N 75° 12' E, Va. 13° 05' E.

286.9 To Cor. No. 2, identical with Location, a stone monument; set a juniper post 4 ft. long, 8 ins. diameter, 10 ins. in the ground to bed rock, in mound of stone, scribed N. C. E. - C, 2 - 2171,

## Whence:

- 1) A cross (X) and B T 2-2171, scribed on a blaze on a juniper tree 16 ins in diameter bears <sup>S.</sup> 70° 00' E, 24.2 ft.
- 2) A cross (X) and B T 2-2171, scribed on a blaze on an oak tree 9 ins. diameter bears N 5° 30' W, 12.7 ft.

Thence N 87° 51' E; Va. 13° 05' E.

300.0 To Cor. No. 3, set a <sup>Juniper</sup> post 4 ft. long, 5 ins. diameter, 12 ins. in ground to bed rock in a mound of stone, scribed N E C - C - 3 - 2171,

## Whence:

- 1) A cross (X) and B T 3-2171 scribed on a blaze on a juniper tree 15 ins. diameter bears S 36° 40' E, 24.4 ft.
- 2) A cross (X) and B R <sup>3-2171</sup> chiseled on a porphyry rock 36 X 24 X 18 ins. bears N 31° 30' E, 9.9 ft.
- 3) Location Cor. a mound of stone bears N 31° E, 8 ft.

Thence S 12° 58' W, Va. 13° 05' E.

989.0 To Cor. No. 4, identical with location and with Cor. No. 2 Rincon Lode of this survey, (a stone monument.) Set an oak post 4 ft. long, 5 ins. diameter, 7 ins in ground to bed rock, scribed S E C - C, N E C - R 4 -2 - 2171,

## Whence:

- 1) A cross (X) and B R 4 - 2 - 2171, chiseled on a porphyry

rock 36 X 24 X 10 ins. bears S 85° 30' E, 5.65 ft.

2) A cross (X) and B T 4 - 2 - 2171, scribed on a blaze on an oak tree, 12 ins. diameter bears N 19° 50' E, 6½ ft.

Thence S 87° 51' W, Va. 13° 05' E.

236.0 Center of gulch 6 ft. wide, course S S W.

284.6 South Center End, identical with location and with North Center End Rincon Lode of this survey, a monument of stone. Set an oak post 5 ft. long, 6 ins. diameter, 10 ins in the ground to bed rock, in a mound of stone, scribed S C E - C N C E - R 2171.

522.5 To Cor. No. 5, identical with Cor No. 1 Rincon Lode. Set an oak post 4 ft. long, 7 ins. diameter, 4 ins. in ground to bed rock, in mound of stone, scribed S W C - C N W C - R 5-1-2171.

Whence;

1) A cross (X) and B T 5-1-2171, scribed on a blaze on an oak tree 10 ins. diameter bears N 28° 35' W 41.6 ft.

2) A cross (X) and B T 5-1-2171 scribed on a blaze on an oak tree, 10 ins. diameter bears N 44° 22' E, 33.4 ft.

3) Discovery shaft of Sunny Slope claim unsurveyed bears S 20° 00' W, 113 ft.

4) Location corner bears S 15° W, 8 ft. a stone monument.

Thence N 10° 31' E, Va. 13° 05' E.

914.2 To Cor. No. 1, the place of beginning.

#### RINCON LODE.

Beginning at Cor. No. 1, identical with Cor. No. 5 Chirspa Lode of this survey and heretofore described.

Whence:

1) U. S. L. M. No. 2171 bears N 16° 25' E, 890.2 ft.

2) Location Cor., a post in a mound of stone bears N 2° 11' W, 54.5 ft.

Thence N 87° 51' E, Va. 13° 05' E

237.9 North Center End, identical with location and with South Center End of Chirspa Lode, heretofore described.

522.5 To Cor. No. 2, identical with location and with Cor. No. 4

Chirspa lode, heretofore described.

Thence S 3°00' W, Va. 13° 05' E.

1266.0 Trail bears N E & S W.

1277.7 To Cor. No. 3, set a juniper post 4 ft. long, 5 ins diameter, 8 ins. in the ground to bed rock, in a mound of stone, scribed S E C - R 3-2171.

Whence:

1) A cross (X) and B T 3-2171 scribed on a blaze on an oak tree, 8 ins. diameter bears N 74° 35' W, 24.9 ft.

2) A cross (X) and B T 3-2171 Scribed on a blaze on an oak tree 12 ins diameter bears N 74° 00'E, 19.5 ft.

3) Location Cor. a stone monument bears N 65° 32' E, 76.5 ft

Thence S 65° 32' W, Va. 13° 10' E.

19.0 Trail general course S 65° 32' W.

330.0 Leave trail which bears N E & S W.

340.5 To Cor. 4, identical with location, a stone monument, set an oak post 4 ft. long, 6 ins. in diameter, 8 ins in ground to bed rock, in a mound of stone, scribed S C E - R 4-2171.

Whence:

1) A cross (X) and B T 4-2171 scribed on a blaze on an oak tree 9 ins diameter bears S 39° 21'W, 15.1 ft.

2) A cross (X) and B T 4-2171, scribed on a blaze on a juniper tree 18 ins. diameter bears N 58° 00' E, 23.1 ft.

3) Notch in top of Sutherland Peak bears S 55° E about 2 miles.

Thence S 87° 51' W, Va 13° 10' E.

250.0 To Cor. No. 5, set an oak post 4<sup>1</sup>/<sub>2</sub> ft. long, 7 ins. diameter 8 ins. in ground to bed rock, in a mound of stone, scribed S W C-R 5 - 2171.

Whence:

1) A cross (X) and B T 5-2171, scribed <sup>a blaze on</sup> on an oak tree 5 ins. diameter bears S 30° 45' E, 12.2 ft.

2) A cross (X) and B R 5-2171 chiseled on a porphyry rock 24 X 18 ins., 18 ins. high bears S 89° 55' W, 18.2 ft.

3) Location Cor. a stone monument bears S <sup>45°</sup> W., 2 ft.

4) Discovery shaft of Sunny South No 4 lode unsurveyed bears N 70° 58' W, 151.5 ft.

5) A stone monument bears S 12° 48' E, 176.0 ft.

Thence N 4° 15' E.

430.4 Point whence an unknown monument built around a small oak tree bears S 47° 20' E, 27.0 ft.

532.1 Point whence S E Cor. Sunny Slope lode unsurveyed bears S 12° 45' E, 36.5 ft.

664.0 Trail bears N N E & S S W.

970.0 Gulch 10 ft. wide course S W.

1400.0 Wagon road bears E & W.

1410.2 To Cor. No. 1, the place of beginning.

-----  
Area, Chirspa Lode.....11.735 Acres

" Rincon " .....16.857 "

Total area.....28.592 "  
4

-----  
Location.

This claim is located <sup>in</sup> West Huachuca Mining District on the S. W. slope of the Huachuca Mts., approximately in what will be when surveyed Tp 23 S R 20 E, G & S Meridian, <sup>R. Base</sup> Cochise County, Arizona.

The course of the lode is as follows:

Chirspa; from South Center End N 12° 06' E presumably to North Center End or Cor. No. 2, 985.1 ft.

Rincon; from North Center End S 3° 46' W, presumably to South Center End or Cor. No. 4, 1408.9 ft.

Adjoining claims are:

on the East Sunny South No. 1;

on the South, Sunny South No. 3;

on the West, Sunny South No. 4, and Sunny Slope lodes all unsurveyed.

Expenditure of \$500.00

I certify that the labor and improvements upon this claim, placed thereon by the claimant and his grantors, is

not less than \$1,000.00, and that said improvements consist of:

NOTE: The point of discovery of both the Chirspa and Rincon lodes is at the South Center End of the Chirspa and North Center End of the Rincon and is approached in both cases by incline shafts.

On the Chirspa;

From South Center End,

1) Discovery shaft or inclined tunnel, the mouth of which bears N 73° 15' E, 33 ft. Incline 6 X 5 ft. course N 75° W, angle of dip from horizontal 30°, depth 37 ft.,  
Value, at \$12. per foot \$444.00

2) From this shaft at bottom connection has been made with the Rincon Discovery shaft and ore stoped out nearly to the surface.

Estimated value of <sup>this</sup> work on this lode \$200.00

3) A shaft which bears N 7° 50' W, 184.0 ft. caved, value nominal.

4) A shaft which bears N 11° 15' W, 319.0 ft.

Shaft, incline 6 X 5 ft., 30 ft. deep,

Value at \$12.00 per foot \$360.00.

5) Work described in connection Rincon Shaft, Value \$959.00  
On the Rincon.

From North Center End:

1) Discovery cut and incline shaft, the mouth of which cut bears S 56° 33' E, 36.5 ft. course of cut and incline N 75° 15' W, incline 6½ X 5 ft., depth to water 86 ft (said to be 140 ft deep) Value, 86 ft at \$12.00 per foot \$1032.00

2) In above incline at a depth of 37 ft., a drift 6 X 4 ft. extends northerly, connecting with Chirspa shaft and stopes, length on Rincon 12 ft. Value at \$10.00 per foot \$120.00

3) At depth of 62 ft. a drift 6 X 4 ft. southerly 27.5 ft. Value at \$10.00 per ft. \$275.00

4) At same depth a drift 6 X 4 ft. Northerly 50 ft.

Value 7½ on Rincon at \$10.00 per ft. \$75.00

42½ ft. on Chirspa at \$10.00 per ft. \$425.00

5) At depth of 73.5 ft. a drift 6 X 4 ft, extends northerly 41 ft.



Value, 2 ft. on Rincon at \$10.00 per ft. \$20.00

39 ft. on Chirspa at \$10.00 per ft. \$390.00

6) In above drift on Chirspa ground a winze 6 X 5 ft.,

12 ft. deep, Value at \$12.00 per ft. \$144.00

-----  
Other improvements.

On the Rincon Lode:

From the North Center End a board building used as black-smith shop, the N.W. Cor. of which bears S 36° 37' E, 33ft. building 12 ft. N & S by 8 ft.

-----  
Instrument.

This survey was made with a Young & Sons mountain transit, No. 6855, provided with a Smith solar attachment. The courses were deflected from true meridians as determined by direct solar observations. The distances were measured with 50 ft. and 500ft. steel tapes.

Tombstone, Arizona.

October 17, 1905.

*John A. Rockefeller*  
U. S. Deputy Mineral Surveyor.

Established October 2nd, 1905.

There being no public survey corner or U. S. L. M. within the statutory two miles of a portion of this survey, I proceed to establish U. S. L. M. No. 2171.

I select a point on a prominent ridge extending S. W. from the main divide of the Huachuca Mts., in approximately Tp 23 S R 20 E, unsurveyed, and within the boundaries of the Chirspa Lode claim. I set a pine post 10 ft. long, 7 ins. diameter, 12 ins in ground to bed rock, in a mound of stone 7 ft. base and 5ft. high, scribed "U. S. L. M., No. 2171."

Whence Va.  $13^{\circ} 03' E$ .

Latitude by noon orservation  $31^{\circ} 23' N$ .

- 1) A cross (X) and B. T. - U S L M 2171, scribed on a blaze on an oak tree 14 ins. diameter bears S  $66^{\circ} 38' W$ , 13.4 ft.
- 2) A cross (X) and B R- U S L M - 2171, chiseled on a quartzite reef bears S  $44^{\circ} 52' E$ , 36.2 ft.
- 3) A cross (X) and B T- U S L M - 2171, scribed on a blaze on a oak tree, 4 ins. diameter bears N  $66^{\circ} 20' E$ , 9.1 ft.
- 4) A cross (X) and B R - U S L M-2171, chiseled on quartzite bed rock bears N  $49^{\circ} 45' W$ , 26.6 ft.
- 5) The Easterly of two smelter stacks at Cananea, Mex. bears S  $40^{\circ} 02' E$ , about 30 miles.
- 6) The Westerly stack bears S  $4^{\circ} 00' E$ .
- 7) An oak tree on the summit of Rattlesnake Mt. bears N  $40^{\circ} 14' W$ . about one and one-half miles.
- 8) A rock at summit of Carr Peak bears S  $78^{\circ} 31' E$ , about four miles.
- 9) Finger Peak, Sonora, Mex. bears S  $42^{\circ} 56' W$ .
- 10) Crest of an immense quartz cropping bears N  $32^{\circ} 56' E$  about two miles.
- 11) Cor. Nos. 2 Mendota Lode and 4 Smuggler lode, Survey No. 2067 bears N  $20^{\circ} 35' W$ , 6892.0 ft.

Tombstone, Ariz. Oct. 13, 1905.

*John A. Rockefeller*  
U. S. Deputy Mineral Surveyor.

## FINAL OATHS FOR SURVEYS.

## LIST OF NAMES.

A list of the names of the individuals employed by John A. Rockfellow  
 United States Deputy Mineral Surveyor, to assist in running, measuring, and marking the lines, corners, and  
 boundaries described in the foregoing field notes of the survey of the mining claim of.....

Sterling Gold and Copper Co.  
 known as the Chiricahua and Rincon

and showing the respective capacities in which they acted.

E. J. Hoyt, Chainman.  
Chas. Sanders, Chainman.  
John Wakefield, Arman.  
 \_\_\_\_\_, Flagman.

## FINAL OATHS OF ASSISTANTS.

We, E. J. Hoyt, Chas. Sanders  
 and John Wakefield, do solemnly swear that we assisted John  
A. Rockfellow, United States Deputy Mineral Surveyor, in marking the corners and surveying  
 the boundaries of the mining claim of Sterling Gold and Copper Co.

known as the Chiricahua and Rincon

represented in the foregoing field notes as having been surveyed by said deputy mineral surveyor and under his  
 direction; and that said survey has been in all respects, to the best of our knowledge and belief, faithfully and  
 correctly executed, and the corner and boundary monuments established according to law and the instructions  
 furnished by the United States Surveyor-General for Arizona

E. J. Hoyt, Chainman.  
Chas. Sanders, Chainman.  
John Wakefield, Arman.  
 \_\_\_\_\_, Flagman.

Subscribed and sworn to by the above-named persons before me this 6<sup>th</sup>

day of October, 1905.

John A. Rockfellow  
Mary Public

FINAL OATH OF U. S. DEPUTY MINERAL SURVEYOR

I, John A. Rockefeller, U. S. Deputy Mineral Surveyor, do solemnly swear that, in pursuance of instructions received from the United States Surveyor General for Arizona, dated Sept 28 1905. I have, in strict conformity to the laws of the United States, the official regulations and instructions thereunder, and the instructions of said Surveyor General, faithfully and correctly executed the survey of the Mining Claim of Sterling Gold and Copper Company, known as the Whisper and Rincon, situate in West Huachuca Mining District, Cochise County, Arizona, in Section \_\_\_\_\_, Township No. 23S Range No. 20 E Unsurveyed and designated as Survey No. 2171, as represented in the foregoing field notes, which accurately show the boundaries of said mining claim as distinctly marked by monuments on the ground, and described in the attached copy of the location certificate, which was received by me from the Surveyor General with said instructions, and that all the corners of said survey have been established and perpetuated in strict accordance with the law, official regulations and instructions thereunder; and I do further solemnly swear that the foregoing are the true and original field notes of said survey and my report therein, and that the labor expended and improvements made upon said mining claim by claimant or its grantors are as therein fully stated, and that the character, extent, location and itemized value thereof are specified therein with particularity and full detail, and that no portion of said labor or improvements so credited to this claim has been included in the estimate of expenditures upon any other claim.

John A. Rockefeller  
U. S. Deputy Mineral Surveyor.

Subscribed and sworn to by the said John A. Rockefeller  
U. S. Deputy Mineral Surveyor, before me L. H. Crable  
a Notary Public this 17<sup>th</sup>  
day of October, 1905

L. H. Crable  
Notary Public  
Com. exp. Nov. 18, 1908.

Affidavit of Five Hundred Dollars Improvements.

We, John Wakefield and John Burke

of lawful age, being first duly sworn according to law, depose and say: That we are acquainted with the

Chusca and Pincen mining claim, situate in West Huachuca

mining district, Cochise County, Arizona Territory, for which

Sterling Gold and Copper Co

has made application for survey prior to application for patent under the provisions of the Act of Congress

approved May 10, 1872; and that the labor done and improvements made thereon by the applicant and

~~these~~ <sup>its</sup> grantor exceed ~~five hundred~~ <sup>one thousand</sup> dollars in value, and further that we are not personally interested

in said mine.

John Wakefield  
John Burke

TERRITORY OF ARIZONA,  
COUNTY OF Cochise } ss:

Sworn to and subscribed before me this 6<sup>th</sup> day

[SEAL.]

of October 5, 1905

John A. Proffers  
Notary Public

My Commission Expires March 14, 1907.

Location Notice.

Notice is hereby given that the undersigned, in compliance with the requirements of the mining Act of Congress, approved May 10, 1872, <sup>has</sup> ~~XXX~~ this day located and claim <sup>1500</sup> hundred linear feet along the course of this lead, lode or vein of mineral bearing quartz, and <sup>300</sup> feet in width on each side of the middle of said lead, lode or vein, situate in the <sup>Huachuca Mts</sup> Mining District, County, of Cochise <sup>Arizona,</sup> and more particularly described as follows, to wit:

Commencing at this monument of stones, being the center of the Southend of claim, and upon which this notice is posted; thence <sup>Easterly 300</sup> feet to a monument of stones; thence <sup>Northerly 1500</sup> feet to a monument of stones; thence <sup>Westerly 300</sup> feet to a monument of stones; being the center of the North end of claim; thence <sup>Westerly 300</sup> feet to a monument of stones; thence <sup>Southerly 1500</sup> feet to a monument of stones; thence <sup>Easterly 300</sup> feet to place of beginning.

This claim is situated on the west slope of the Huachuca mountains about one mile Easterly from the south end of Lone Mountain and Thomas Ranch

and shall be known as <sup>Chirspa</sup> mine.  
 Located July 21st, 1891.

S. G. Harper, Locator

Filed and recorded at request of S. G. Harper August 11th, A.D.  
 1891 at 1 P. M. Book 12 page 375 , Record of Mines.

Territory of Arizona, )  
 )  
 County of Cochise. )  
 I, Frank Ware County Recorder in and for said County, hereby certify that I have compared the above copy with the original location notice of the " Chirspa " Mining Claim, filed and recorded in my office on the 11th day of August, 1891 in Book 12 page 375 , Record of Mines, and that the same is a full, true and correct copy of such original and of the whole thereof. Witness my hand and seal of office, this 23<sup>rd</sup> day of September 1905.

*Frank Ware*  
 County Recorder.

Location Notice.

Notice is hereby given that the undersigned, in compliance with the requirements of the mining Act of Congress, approved May 10, 1872, has ~~now~~ this day located and claim 1500 hundred linear feet along the course of this lead, lode or vein of mineral bearing quartz, and 300 feet in width on each side of the middle of said lead, lode or vein, situate in the Huachuca Mts Mining District, County, of Cochise Arizona, and more particularly described as follows, to wit:

Commencing at this monument of stones, being the center of the North End of claim, and upon which this notice is posted; thence running Easterly 300 feet to a monument of stones; Thence Southerly 1500 feet to a monument of stones; thence Westerly 300 feet to a monument of stones; being the center of the South end of claim; thence Westerly 300 feet to a monument of stones; thence Northerly 1500 feet to a monument of stones; thence Easterly 300 feet to place of beginning.

This Claim is situated on the West slope of the Huachuca Mountains about one mile Easterly from the South end of Lone Mountain and Thomas Ranch and is the first South Extension of the Chirspa Mine

and shall be known as Rincon Mine.  
Located July 21st, 1891.

S. G. Harper, Locator

Filed and recorded at request of S. G. Harper August 11th A.D. 1891  
at 1 P. M. Book 12 page 376, Record of Mines.

Territory of Arizona, )  
:SS.  
County of Cochise. )

I, Frank Hare County Recorder in and for said County, hereby certify that I have compared the above copy with the original location notice of the "Rincon Mining Claim," filed and recorded in my office on the 11th day of August, 1905 in Book 12 page 376, Record of Mines, and that the same is a full, true and correct copy of such original and of the whole thereof. Witness my hand and seal of office, this 23<sup>rd</sup> day of September 1905

*Frank Hare*  
County Recorder.

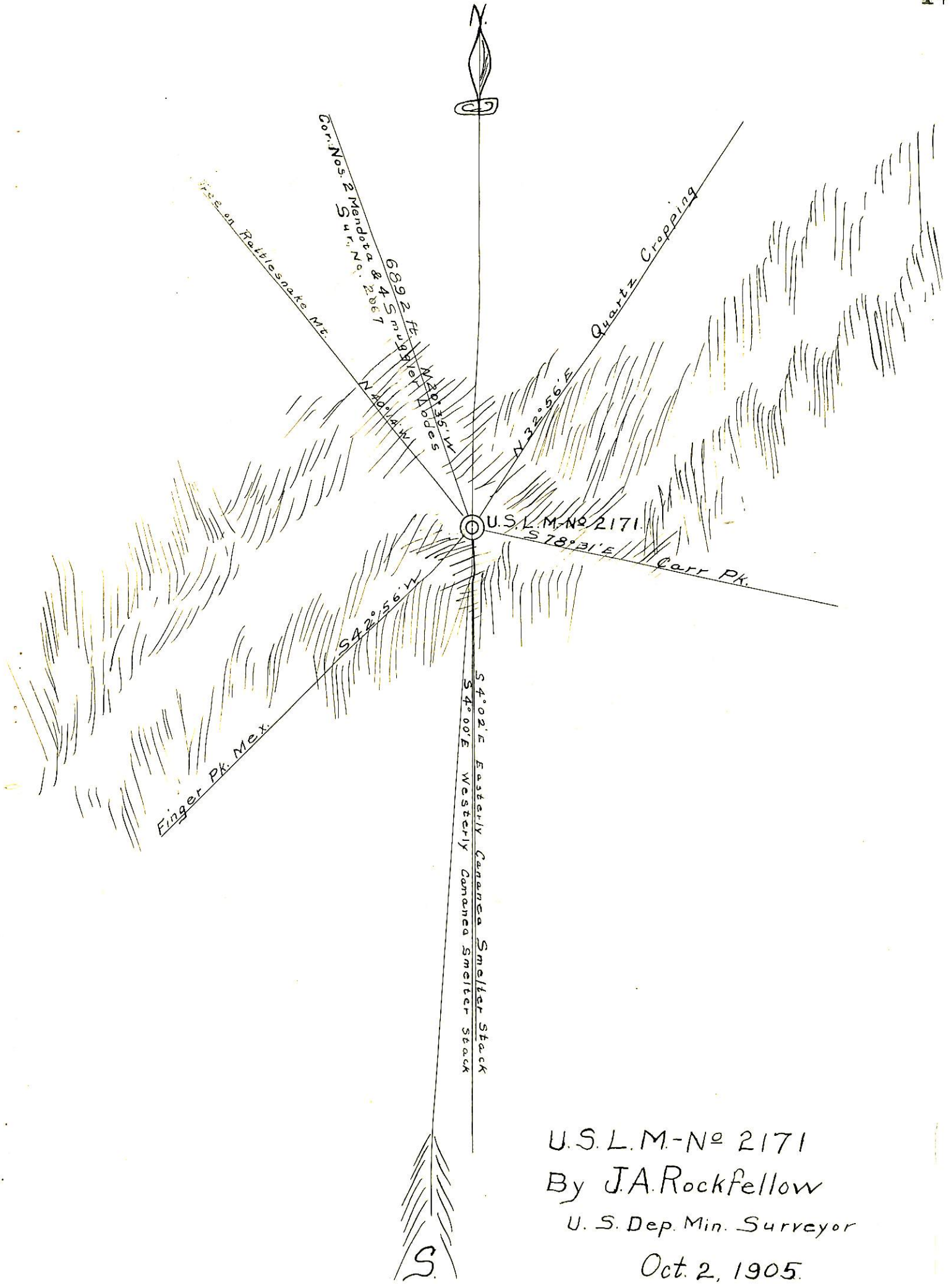

U.S.L.M.-No 2171  
 By J.A. Rockfellow  
 U. S. Dep. Min. Surveyor  
 Oct. 2, 1905.



15  
Loc. 4 ft.  
N 31° 00' E

CoR. No. 3

S 12° 58' W 989.0 ft.

CoR. No. 4 CoR. No. 2

Sunny South No. 1 unsurveyed

S 3° 00' W 1277.7 ft.

CoR. No. 3

CHIRSPA

RINCON

CoR. No. 3

N 87° 51' E 300.0 ft.

CoR. No. 2

985.1 ft. N 12° 06' E

Discovery blacksmith shop  
Discovery

1408.9 ft. N 3° 46' E

Sunny South No. 3  
Sunny unsurveyed

N 75° 12' E 286.9 ft.

CoR. No. 1

U.S.L.M. No 2171

890.2 ft. N 16° 25' E

shaft

shaft

N 10° 31' E

914.2 ft.

S 87° 51' W 522.5

522.5

237.9

CoR. No. 5 CoR. No. 1

1410.2 ft.

N 4° 15' E

CoR. No. 4

Trail

Sunny Slope unsurveyed

Sunny South No. 4. unsurveyed



SURVEY No 2171

GILA LAND DISTRICT

Surveyed Sept 30-Oct 5, 1905.

by John A Rockfellow

U.S. Dep. Min. Surveyor.

Scale 200 ft = 1 in.

4-688.

U. S. SURVEYOR-GENERAL'S FINAL CERTIFICATE ON FIELD NOTES.

Department of the Interior,

OFFICE OF U. S. SURVEYOR-GENERAL,

Phoenix, Arizona

Nov. 7, 1905

I, U. S. Surveyor-General for Arizona do hereby certify that the foregoing transcript of the Field Notes, return and approval of the survey of the mining claim of Sterling Gold and Copper Co.

known as the Chirspa and Rincon situate in West Huachuca

Mining District, Cochise County, Arizona

in Section, Township No. 23 S., Range No. 19 E. (unsur.)

designated as Survey No. 2171, has been correctly copied from the originals on file in this office; that said Field Notes furnish such an accurate description of said mining claim as will, if incorporated into a patent, serve fully to identify the premises, and that such reference is made therein to natural objects or permanent monuments as will perpetuate and fix the locus thereof.

And I further certify that five hundred dollars' worth of labor has been expended or improvements made upon said mining claim by claimant or its grantors, and that said improvements consist of 4 shafts, drifts, stops and winze, total, \$ 3485.70

and that no portion of said labor or improvements has been included in the estimate of expenditures upon any other claim.

I further certify that the plat thereof, filed in the U. S. Land Office at Phoenix, Arizona is correct and in conformity with the foregoing Field Notes.

(Signed) Frank S. Ingalls.

United States Surveyor-General for Arizona.

(4-687.)

# Surveyor General's Certificate of Approval of Field Notes and Survey of Mining Claim.

Department of the Interior,

Office of U. S. Surveyor General,

Phoenix, Arizona,

Nov. 7<sup>th</sup> 1905, 18<sup>th</sup>.

I, U. S. Surveyor General for Arizona,  
do hereby certify that the foregoing and hereto attached Field Notes and Return of the  
Survey of the Mining Claim of Sterling Gold and Copper Co.  
Chirspa and Rincon, known as the  
situate in West Huachuca, mining district,  
Cochise County, Arizona,  
in Section           , Township No. 23 S., Range No. 19 E. (unsur.)  
          , designated as Survey No. 2171  
executed by John A. Rockefeller, U. S. Deputy Mineral  
Surveyor, Sept. 30 to Oct. 5, 1905, under my instructions dated  
Sept. 28, 1905, have been critically examined and the  
necessary corrections and explanations made, and the said Field Notes and Return, and  
the Survey they describe, are hereby approved. A true copy of the copy of the location  
certificate filed by the applicant for survey is included in the field notes.

*Frank A. Sycamore*

U. S. Surveyor General for Arizona.

