

**M
S
-**

0

2

2

4

0

Nov 23 1906

Nov 13 1906

*Copy filed
11/13/06*

(4-683.)

Mineral Survey No. 2240 A and B

Lot No.

Arizona

Land District.

FIELD NOTES

OF THE SURVEY OF THE MINING CLAIM OF

West Gold Road Mining Company

KNOWN AS THE

Eclipse, Tom Tit, Comet, Iron Rod and Fraction lodes and Tom
Tit Mill Site, San Francisco Mining District,

Mohave County, Arizona

Section approximately in Township 20 N., Range 19 W.

Surveyed under instructions dated April 9th and May 17th, 1906.

by Peter McCardell,

U. S. Deputy Mineral Surveyor.

See location notice

Claim located *Eclipse Aug 8th 1900, Tom Tit April 20th 1900, Comet Dec 2nd 1900 Iron Rod May 21st 1900
Fraction Sep. 5th 1900, Tom Tit mill site April 6th 1900*

Survey commenced *April 14th*, 1906

Survey completed *May 24th*, 1906

o 6-100

Address,

Chas. M. Tozer,
Atty. in fact,
Goldroad, Mohave County,
Arizona.

*Filed
Lodge
via
Anas*

Ft.

SURVEY No. 2240 A.

Eclipse.

Beginning at Cor. No. 1.

Identical with Cor. No. 1 Tom Tit lode of this survey,
A pine post 4 1/2 ft. long, 4 ins. square, set 24 ins.
in the ground, with mound of rock and earth, scribed
1-1-2240 A, whence

A cross (x) and B. O. 1-1-2240 A scribed on the N. W.
Cor. of House 5 ft. above the general surface, bears
N. 51° 28' E. 63.73 ft. and a cross (x) and B. R. 1-1-
2240 A chiseled 4 ft. above the ground on a lava rock
bears S. 50° 06' E. 101.2 ft.

U. S. L. M. No. 1699 bears N. 43° 57' W. 316.1 ft.

Thence S. 52° 49' E.

Va. 14° 34' E.

91 Road, course E. & W.
147.62 To Cor. No. 2.

Identical with Cor. No. 1-1-Gold Road ~~Survey No. 1699A~~

Tip Top and Silver Kollar, Sur. No. 1699A.

A pine post, 4 1/2 ft. long, 4 ins. square, set 24
ins. in the ground with mound of stone, scribed 2-2240
A., whence

A cross (x) and B. R. 2-2240 A. chiseled 5 ft. above
the general surface on a lava cliff, bears N. 40° 01'
E. 134 ft., and a cross (x) and B. O. 2-2240 A scribed
4 ft. above the ground on the N. E. corner of a house,
bears S. 3° 05' E. 10.05 ft.

Thence S. 40° 17' W.

Va. 15° 05' E.

9.5 House on line.
285 Intersect lode line whence discovery bears N. 53° 20'
W. 50 ft.
340 Gulch drains N. 55° W.

Ft.
 585 To Cor. No. 3.
 A redwood post, 4 ft. long, 4 ins. square, set 24 ins. in the ground, with mound of stone, scribed 3-2240 A., whence
 A cross (x) and B. R. 3-2240 A chiseled 3 ft. above the ground on a lava rock, bears S. 60° 47' W. 58.2 ft. and a cross (x) and B. R. 3-2240 A chiseled 5 ft. above the ground on a lava rock, bears S. 23° 52' E. 88.1 ft. Cor. No. 4 Gold Road Survey No. 1699A bears S. 38° 56' W. 15 ft.

Thence N. 53° 20' W.
 Va. 14° 32' E.

147.7 To Cor. No. 4.
 Identical with Cor. No. 2 Tom Tit lode of this survey, A redwood post 4 ft. long, 4 ins. square, set 24 ins. in the ground, with mound of stone, scribed ~~3~~-2-2240 A, whence
 A cross (x) and B. R. ~~3~~-2-2240 A, chiseled 5 ft. above the ground on a lava rock, bears S. 9° 39' E. 96.97 ft., and a cross (x) and B. R. ~~3~~-2-2240 A chiseled 3 ft. above the ground on a lava rock, bears S. 55° 35' E. 90.7 ft.

Thence N. 40° 17' E.
 Va. 14° 40' E.

240 Gulch, drains N. 60° W.
 300 Intersect lode line, whence discovery bears S. 53° 20' E. 97.7 ft.
 490 House on line.
 515 Road, course E. & W.
 586.35 To Cor. No. 1, the place of beginning.

T O M T I T .

Ft. Beginning at Cor. No. 1. . . .
 Identical with Cor. No. 1 Eclipse lode of this survey and heretofore described. . . .
 Whence U.S.L.M.No. 1699 San Francisco Mining District bears N. 43° 57' W. 316.1 ft.
 Thence S. 40° 17' W.
 Along line 1-4 Eclipse lode of this Survey
 286.35 Intersect lode line whence discovery bears N. 53° 20' W. 630 ft.
 586.35 To Cor. No. 2.
 Identical with Cor. No. 4 Eclipse ^{Lode} of this survey and heretofore described.

 Thence N. 53° 20' W.
 Va. 14° 40' E.
 458 Road, course S. 35° W.
 711 Gulch, drains S. 70° W.
 942 Gulch, drains N. 20° W.
 1500 To Cor. No. 3.
 A pine post 4 1/2 ft. long, 4 ins. square, set 24 ins. in the ground, with mound of earth and stone, scribed 3-2-2240 A, whence
 A cross (x) and B. R. 3-2-2240 A chiseled 2 ft. above the ground on a lava rock, bears S. 22° 13' E. 97.02 ft. and a cross (x) and B. R. 3-2-2240 A chiseled 2 ft. above the ground on a lava rock, bears S. 86° 43' W. 78.39 ft.

 Thence N. 40° 17' E.
 Va. 15° 07' E.
 160 Gulch, drains N. 50° W.
 300 Intersect lode line, whence discovery bears S. 53° 20' E. 870 ft.

Ft.
 536 Road, course N.W. and S.E. .
 600 To Cor. No. 4.
 Identical with Cor. No. 1 Comet lode of this Survey,
 A pine post, 4 1/2 ft. long, 4 ins. square, set 24
 ins. in the ground with mound of stone, scribed
 4-1-2240 A, whence
 A cross (x) and B. R. 4-1-2240 A chiseled 2 ft. above
 the ground on a lava rock, bears S. 4° 54' E. 31.8 ft.

No other bearing objects available.

Thence S. 52° 49' E.

Va. 15° E.

1499.2 To Cor. No. 1 the place of beginning.

C O M M E N T .

Ft.

Beginning at Cor. No. 1.

Identical with Cor. No. 4 Tom Tit lode of this survey and heretofore described, whence

U. S. L. M. No. 1699 San Francisco Mining District bears S. 55° 10' E. 1187.9 ft.

Thence S. 40° 17' W.

Va. 15° E.

Along line 4-3 Tom Tit lode of this survey

300 Intersect lode line, whence discovery bears N. 51° 25' W. 1395 ft.

600 To Cor. No. 2.

Identical with Cor. No. 3 Tom Tit lode of this survey and heretofore described.

Thence N. 51° 25' W.

Va. 15° 07' E.

925 Gulch, drains S. 50° W.

1115 Intersect East end line Jay Gould lode unsurveyed at S. 40° 17' W. 210 ft. from the S. E. cor.

1495 To Cor. No. 3.

A pine post, 4 1/2 ft. long, 4 ins. square, set 24 ins. in the ground, with mound of earth and stone, scribed 3-2240 A, whence

A cross (x) and B. R. 3-2240 A chiseled 1 ft. above the ground on a lava rock bears N. 82° 40' E. 25.65 ft. and a cross (x) and B. R. 3-2240 A chiseled on a quartz rock, 4 ft. above the ground, bears S. 81° 03' W. 108.3 ft.

Thence N. 40° 17' E.

Va. 14° 59' E.

Ft.	
123	Gulch, drains N. 25° W.
210	Intersect North side line Jay Gould lode unsurveyed at N. 51° 25' W. 380 ft. from S. E. Corner.
300	Intersect lode line whence discovery bears S. 51° 25' E. 100 ft.
505.3	Road, course N. W. and S. E.
600	To Cor. No. 4 on line 1-2 Gold Dollar Extension lode Survey No. 1699A at N. 47° 36' W. 578.9 ft. from Cor. No. 1. A pine post, 4 1/2 ft. long, 4 ins. square, set 24 ins. in the ground, with mound of earth and stone, scribed 4-2240 A, whence A cross (x) and B. R. 4-2240 A chiseled 1 foot above the ground on a lava rock bears S. 78° 21' W. 47.47 ft. and a cross (x) and B. R. 4-2240 A chiseled 1 1/2 ft. above the ground on a lava rock bears S. 21° 29' W. 74.46 ft.
	Thence, S. 51° 25' E. Va. 15° 07' E.
578.74	Intersect line 1-4 Gold Dollar Extension lode, also line 2-3 Gold Dollar lode, both of Survey No. 1699A at N. 40° 15' E. 33.55 ft. from Cor. No. 1-2.
1472.12	Intersect line 1-2 Gold Dollar Survey No. 1699A at N. 53° 53' W. 556.77 ft. from Cor. No. 1 and S. 53° 53' E. 895.33 ft. from Cor. No. 2.
1495	To Cor. No. 1 the place of beginning.

Ft.

I R O N R O D .

Beginning at Cor. No. 1.

A pine post, 4 1/2 ft. long, 4 ins. square, set 24 ins. in the ground, with mound of earth and stone, scribed 1-2240 A, whence

A cross (x) and B. R. 1-2240 A chiseled 3 ft. above the ground on a lava rock bears N. 9° 49' W. 214 ft.

U. S. L. M. No. 1699 San Francisco Mining District bears N. 78° 43' 36" E. 1088.5 ft. No other bearing objects available.

Thence S. 61° 36' W.

Va. 15° 08' E.

300 Intersect lode line, whence discovery bears N. 28° 24' W. 498 ft.

600 To Cor. No. 2.

A pine post, 4 1/2 ft. long, 4 ins. square, set 24 ins. in the ground, with mound of earth and stone scribed 2-2240 A, whence

A cross (x) and B. R. 2-2240 A chiseled 2 1/2 ft. above the ground on a lava rock bears N. 43° 19' E. 74.3 ft. and a cross (x) and B. R. 2-2240 A chiseled 3 ft. above the ground on a lava rock, bears N. 84° 40' E. 17.7 ft.

Thence N. 28° 24' W.

Va. 15° 41' E.

1500 To Cor. No. 3.

A pine post, 4 1/2 ft. long, 4 ins. square, set 24 ins. in the ground with mound of stone, scribed 3-2240 A, whence

A cross (x) and B. R. 3-2240 A chiseled 2 ft. above the ground on a lava rock bears S. 18° 30' W. 166.4 ft. No other bearing objects available.

	Thence N. 61° 36' E.
	Va. 15° 02' E.
113	Gulch, drains N. 25° W.
131	Intersect line 2-3 Comet lode of this survey at N. 51° 25' W. 1062.50 from Cor. No. 2.
300	Intersect lode line whence discovery bears S. 28° 24' E. 1002 ft.
447	Road, course N. 60° W. and S. 60° E.
600	To Cor. No. 4.
	A pine post, 4 1/2 ft. long, 4 ins. square, set 24 ins. in the ground, with mound of earth and stone, scribed 4-2240 A, whence
	A cross (x) and B. E. 4-2240 A chiseled 1 1/2 ft. above the ground on a lava rock, bears N. 21° 12' W. 19.3 ft. and a cross (x) and B. E. 4-2240 A chiseled 2 1/2 ft. above the ground on a lava rock, bears N. 89° 40' E. 126.3 ft.

	Thence S. 28° 24' E.
	Va. 15° 21' E.
280	Road, course N. & W.
573	Gulch, drains N. 65° W.
957.08	Intersect line 1-2 Comet lode, also line 3-4 Tom Tit lode, both of this survey at N. 40° 17' E. 57.56 ft. from Cor. No. 2-3.
1093.35	Intersect line 2-3 Tom Tit lode of this survey at S. 53° 20' E. 127.2 ft. from Cor. No. 3, and N. 53° 20' W. 1372.8 ft. from Cor., No. 2.
1500	To Cor. No. 1 the place of beginning.

Ft.

F R A C T I O N .

Beginning at Cor. No. 1 on line 2-3 Tom Tit lode of this survey, at N. $53^{\circ} 20'$ W. 955.84 ft. from Cor. No. 2.

A pine post, 4 $1/2$ ft. long, 4 ins. square, set 24 ins. in the ground, with mound of stone, scribed 1-2240 A, whence

A cross (x) and B. R. 1-2240 A chiseled 3 ft. above the ground on a lava rock, bears S. $36^{\circ} 07'$ W. 28.85 ft. and a cross (x) and B. R. 1-2240 A chiseled 1 ft. above the ground on a lava rock, bears N. $87^{\circ} 55'$ W. 11 ft.

U. S. L. M. No. 1699 bears N. $83^{\circ} 35' 24''$ E. 932.26 ft.

Thence S. $29^{\circ} 18'$ W.

Va. $15^{\circ} 08'$ E.

14 Location Corner of Gold Hill lode unsurveyed..

242.2 Intersect lode line whence discovery bears N. $53^{\circ} 20'$ W. 83 ft.

520.2 Location Corner of Gold Hill lode unsurveyed,

542.2 To Cor. No. 2.

A redwood post, 4 ft. long, 4 ins. square, set 24 ins. in the ground with mound of earth and stone, scribed 2-2240 A, whence

A cross (x) and B. R. 2-2240 A chiseled 2 ft. above the ground on a lava rock, bears N. $40^{\circ} 07'$ E. 19.2 ft. and a cross (x) and B. R. ^{2-2240A} chiseled 2 ft. above the ground on a lava rock, bears S. $73^{\circ} 02'$ W. 69.88 ft.

Thence N. $53^{\circ} 20'$ W.

Va. $14^{\circ} 56'$ E.

287.96 Intersect line 1-2 Iron Rod lode of this survey at S. $61^{\circ} 36'$ W. 403.93 ft. from Cor. No. 1.

Ft.

416.96 To Cor. No. 3.

A redwood post, 4 ft. long, 4 in. square, set 24 ins. in the ground with mound of earth and stone, scribed 3-2240 A, whence

A cross (x) and B. R. 3-2240 A chiseled 2 ft. above the ground on a lava rock bears S. $13^{\circ} 34'$ E. 57.7 ft. No other bearing objects available.

Thence N. $29^{\circ} 18'$ E.

Va. $14^{\circ} 40'$ E.

300 Intersect lode line whence discovery bears S. $53^{\circ} 20'$ E. 333.96 ft.

542.2 To Cor. No. 4, at the intersection of lines 2-3 Tom Tit and 1-4 Iron Rod lodes both of this survey at S. $53^{\circ} 20'$ E. 127.2 ft. from Cor. No. 3 and N. $28^{\circ} 24'$ W. 406.65 ft. from Cor. No. 1 respectively.

A redwood post, 4 ft. long, 4 ins. square, set 24 ins. in the ground, with mound of earth and stone, scribed 4-2240 A, whence

A cross (x) and B. R. 4-2240 A chiseled 3 ft. above the ground on a lava rock bears S. $25^{\circ} 24'$ E. 79.5 ft. and a cross (x) and B. R. 4-2240 A chiseled 4 ft. above the ground on a lava rock, bears S. $1^{\circ} 23'$ W. 64.7 ft.

Thence S. $53^{\circ} 20'$ E.

Va. $15^{\circ} 07'$ E.

416.96 To Cor. No. 1 the place of beginning.

The adjoining claims are the Gold Hill on the south, the Jay Gould and Iron King on the west, all unsurveyed, the Silver Dollar, Gold Dollar and Gold Dollar Extension, all of Survey No. 1699-4 on the north, the Gold

Road Survey No. 1699~~A~~ on the East

A R E A .

ECLIPSE	=	1.982	ACRES	✓
<hr/>				
TOM TIT		20.385	"	✓
<hr/>				
TOTAL AREA COMET		20.583 ⁵⁸³	"	✓
AREA in conflict with				
Survey No. 1699 A Gold Dollar		.395	"	✓
Survey No. 1699 A Gold Dollar Extension		.255	"	✓
JAY GOULD (unsurveyed)		1.831	"	✓
		<hr/>	2.481	"
<hr/>				
Total Area Comet			20.583 ⁵⁸³	
Less area in conflict with				
Survey No. 1699 A Gold Dollar		.395	"	✓
Survey No. 1699 A Gold Dollar Extension		.255	"	✓
Jay Gould (unsurveyed)		1.831	"	✓
		<hr/>	= 2.481	
<hr/>				
Net Area Comet			18.171 ¹⁰²	
<hr/>				
Total Area Iron Rod		20.661	ACRES	✓
Area in conflict with				
Tom Tit of this survey		.083	"	✓
Comet of this survey		5.853	"	✓
<hr/>				
Total Area Iron Rod		20.661	"	✓
Less area in conflict with				

Tom Tit of this survey	.083 acres ✓		
Comet of this survey	5.853 ✓ " =	5.936	ACRES ✓
		<u>725</u>	
Net Area Iron Rod		14.715	"
<hr/>			
Total Area Fraction =		5.147	" ✓
Less Area in conflict with			
Iron Rod of this survey		2.681	" ✓
		<hr/>	
Net Area Fraction		2.466	"

Ft.

T O M T I T M I L L S I T E .

Beginning at Cor. No. 1.

An 8 x 10 x 5 ft. high lava rock, chiseled on top
1-2240 B cross (x) for corner point, whence

A cross (x) and B. R. 1-2240 B chiseled 5 ft. above
the ground on a lava rock, bears N. 84° 12' W. 47.1 ft.
and a cross (x) and B. R. 1-2240 B chiseled 1 1/2 ft.
above the ground on a lava rock, bears S. 43° 12' W.
45 ft.

U. S. L. M. No. 1699 San Francisco Mining District,
bears S. 9° 32' 10" W. ~~666.2~~^{666.2} ft.

Thence S. 42° 21' E.

Va. 15° 40' E.

100.5 Cottonwood Creek, 10 in. wide, flows S. 41° W.

466.69 To Cor. No. 2,

A 7 x 10 x 16 ins. lava stone, set 10 ins. in the
ground with mound of stone chiseled 2-2240 B, cross (x)
for corner point, whence

A cross (x) and B. R. 2-2240 B chiseled 6 ft. above
the ground on a lava cliff, bears S. 64° 03' E. 69.46
ft. and a cross (x) and B. R. 2-2240 B chiseled 2 ft.
above the ground on a lava rock, bears N. 78° 13' E.
27.2 ft.

Thence S. 47° 39' W.

Va. 16° 05' E.

388 Gulch, drains N. 20° W.

466.69 To Cor. No. 3

On top of rock cliff, chiseled 3-2240 B cross (x)
for corner point, whence

A cross (x) and B. R. 3-2240 B chiseled 5 ft. above
the ground on a lava cliff, bears S. 50° 39' E. 40.4

Ft.

ft. and a cross (x) and B. R. 3-2240 B chiseled 5 ft. above the ground on a lava cliff, bears N. 74° 26' E. 49.5 ft,

Cor. No. 1 Comet lode of this survey bears S. 21° 22' W. ~~5596.9~~^{5622.8} ft.,

Thence N. 42° 21' W.

Va. 15° 49' E.

95.4 Gulch, drains S. 45° W.

281.2 Cottonwood Creek 10 in. wide flows S. 40° W.

466.69 To Cor. No. 4,

A 9 x 12 x 16 ins. lava rock, set 10 ins. in the ground, with mound of stone, chiseled 4-2240 B cross (x) for corner point, whence

A cross (x) and B. R. 4-2240 B chiseled 1 ft. above the ground on a lava rock, bears N. 44° 07' W. 95.1 ft. No other bearing objects available.

Thence N. 47° 39' E.

Va. 15° 20' E.

466.69 To Cor. No. 1 the place of beginning.

Containing 5 acres.

There are no adjoining claims to the Tom Tit Mill Site.

The survey of the Eclipse, Tom Tit, Comet, Iron Rod and Frac-tion lodes and Tom Tit Mill Site are identical with the respective locations.

Ft.

The courses and distances of the lode lines of this survey are as follows:

Eclipse, N. $53^{\circ} 20'$ W. 147.7 ft. from S. E. end to N. W. end of lode.

Tom Tit, N. $53^{\circ} 20'$ W. 1500 ft. from S. E. end to N. W. end of lode.

Comet, N. $51^{\circ} 25'$ W. 1495 ft. from S. E. end to N. W. end of lode.

Iron Rod, N. $22^{\circ} 24'$ W. 1500 ft. from S. E. end to N. W. end of lode.

Fraction, N. $53^{\circ} 20'$ W. 416.96 ft. from S. E. end to N. W. end of lode.

EXPENDITURE OF FIVE HUNDRED DOLLARS.

I certify that the value of the labor and improvements upon this claim, placed thereon by the claimants and their grantors, is not less than Five Hundred Dollars for each location and that said improvements consist of:

Eclipse

The discovery shaft of Eclipse lode which bears from Cor. No. 2 S. $50^{\circ} 06' 20''$ W. 292.4 ft. 4 x 6 ft., 363 ft. deep, timbered; at the 160 ft. level is a crosscut running S. 40° W. 60 ft., 4 ft. wide, 6 ft. high; at 40 ft. on this crosscut is drift running N. 50° W. 25 ft. 4 x 6 ft. high, all in rock,

Value of shaft, crosscut and drift \$8,000.

Tom Tit

No. 1, the discovery shaft of the Tom Tit lode which bears from Cor. No. 2 N. $27^{\circ} 13' 30''$ W. 680.6 ft., 4 x 6 ft., 21 ft. deep in rock,

Value \$ 150.

No. 2, a shaft which bears from Cor. No. 4 S. $31^{\circ} 01'$ E. 513 ft., 4 x 6 ft., 18 ft. deep in rock,

Value \$ 140.

Comet

No. 1, the discovery shaft of the Comet lode which bears from Cor. No. 4 S. 21° 41' W. 313.34 ft. 4 x 6 ft., 10 ft. deep in earth and rock,

Value \$ 50.

No. 2, a shaft which bears from Cor. No. 4 S. 33° 34' E. 573 ft. 4 x 6 ft. 20 ft. deep in rock,

Value \$ 160.

Iron Rod.

No. 1, an open cut the discovery of the Iron Rod Lode the face of which bears from Cor. No. 1 N. 59° 28' W. 581.39 ft., 5 ft. wide, 12 ft. face running S. 60° W. 20 ft. in rock,

Value \$ 45.

No. 2, a shaft which bears from Cor. No. 3 S. 64° 43' E. 392 ft. 4 x 6 ft. 15 ft. deep in rock,

Value \$ 100.

Fraction.

No. 1 the discovery ^{cut} of the Fraction lode the face of which bears from Cor. No. 1 S. 48° 52' W. 245.75 ft. 5 ft. wide, 10 ft. face, running S. 5° E. 16 ft. in rock,

Value \$ 40.

The labor and improvements upon the Eclipse lode shaft is for the benefit of all the lode claims in this survey and was intended for drainage and exploration of said claims and is to be credited to each claim as follows:

The first 160 ft. of Eclipse lode shaft and 60 ft. drift is to be credited to the Eclipse lode,

Value \$4,000.

Next 50 ft. of said shaft to be credited to the Tom Tit lode,

Value, \$1,000.

The next 50 ft. of shaft to be credited to the Comet lode,

Value, \$ 1,000.

The next 50 ft. of said shaft to be credited to the Iron Rod lode,

Value, \$ 1,000.

The next and last 53 ft. of said shaft to be credited to the Fraction lode,

Value, \$ 1,000.

O T H E R I M P R O V E M E N T S

A shaft house the N. E. Cor. of which bears from Cor. No. 1 Eclipse lode S. 24° 34' W. 240 ft., 12 x 24 ft. course of long side N. 54° W.

Blacksmith shop, the N. E. Cor. of which bears from Cor. No. 1 Eclipse lode S. 36° 22' W. 210 ft. 12 x 12 ft. running N. 58° W.

A house, the N. E. Cor. of which bears from Cor. No. 1 Eclipse lode S. 42° W. 80 ft. 33 x 40 ft. course of long side N. 10° E.

A house, the S. E. Cor. of which bears from Cor. No. 2 Eclipse lode S. 5° E. 10.5 ft. 50 x 82 ft. course of long side N. 49° E.

An office building, the N. W. Corner of which bears from Cor. No. 4 Tom Tit, S. 34° 30' E. 622.3 ft. 24 x 28 ft. course of long side N. 50° 20' W.

A house the S. E. Cor. of which bears from Cor. No. 1 Tom Tit *N.* 73° 08' W. 498 ft. 24 x 24 ft. course N. 51° W.

I find the following errors in lines of former approved surveys:

Survey No. 1699A Gold Dollar Extension lode line 1-2 N. $47^{\circ} 36'$ W. instead of N. $47^{\circ} 40'$ W.

Gold Dollar lode Survey No. 1699A, line 1-2 N. $53^{\circ} 53'$ W. 1452.1 ft. instead of N. $53^{\circ} 55'$ W. 1450 ft. The tie lines from Corner 1-1-1 Gold Road, Silver Dollar and Tip Top lodes respectively, Survey No. 1699A to U. S. L. M. No. 1699 is N. $46^{\circ} 46'$ W. 462.5 ft. instead of N. $46^{\circ} 50'$ W. 462.2 ft. as approved.

I N S T R U M E N T .

This survey was made with a Buff and Berger No. 2 Transit. The courses were deflected from the true meridian as determined by direct solar observation and observation on Polaris. The distances were measured with 50-ft. and 500-ft. steel tapes.

FINAL OATHS FOR SURVEYS.

LIST OF NAMES.

A list of the names of the individuals employed by Peter McCardell

United States Deputy Mineral Surveyor, to assist in running, measuring, and marking the lines, corners, and boundaries described in the foregoing field notes of the survey of the mining claim of West Gold

Road Mining Co
known as the Eclipse Tom Tit, Cornet, Iron Rod and Fraction Lodes
and Tom Tit mill site
and showing the respective capacities in which they acted.

Charles G Southland, Chainman.

....., Chainman.

Michael O Meara, Azman.

....., Flagman.

FINAL OATHS OF ASSISTANTS.

We, Charles G Southland

and Michael O Meara, do solemnly swear that we assisted

Peter McCardell, United States Deputy Mineral Surveyor, in marking the corners and surveying the boundaries of the mining claim of West Gold Road Mining Co

known as the Eclipse Tom Tit Cornet, Iron Rod and Fraction Lode and Tom Tit mill site

represented in the foregoing field notes as having been surveyed by said deputy mineral surveyor and under his direction; and that said survey has been in all respects, to the best of our knowledge and belief, faithfully and correctly executed, and the corner and boundary monuments established according to law and the instructions furnished by the United States Surveyor-General for Arizona

Charles G Southland, Chainman.

....., Chainman.

Michael O Meara, Azman.

....., Flagman.

Subscribed and sworn to by the above-named persons before me this 27th

day of May, 1904

Rose H Blakely Clerk Dist Court
By Peter McCardell Deputy

(4-686.)

FINAL OATH OF U. S. DEPUTY MINERAL SURVEYOR

I, Peter McCordell, U. S. Deputy Mineral Surveyor, do solemnly swear that, in pursuance of instructions received from the United States Surveyor General for Arizona, dated April 10th and May 17th 1906, I have, in strict conformity to the laws of the United States, the official regulations and instructions thereunder, and the instructions of said Surveyor General, faithfully and correctly executed the survey of the Mining Claim of West Gold Road Mining Co., known as the Eclipse, Tom Lit. Conit, Iron Rod and Fraction Lode and Tom Lit Mill Site, situate in San Francisco Mining District, Mohave County, Arizona approximately in Section in, Township No. 20 N., Range No. 19 West and designated as Survey No. 2240 A and B, as represented in the foregoing field notes, which accurately show the boundaries of said mining claim as distinctly marked by monuments on the ground, and described in the attached copy of the location certificate, which was received by me from the Surveyor General with said instructions, and that all the corners of said survey have been established and perpetuated in strict accordance with the law, official regulations and instructions thereunder; and I do further solemnly swear that the foregoing are the true and original field notes of said survey and my report therein, and that the labor expended and improvements made upon said mining claim by claimant or its grantors are as therein fully stated, and that the character, extent, location and itemized value thereof are specified therein with particularity and full detail, and that no portion of said labor or improvements so credited to this claim has been included in the estimate of expenditures upon any other claim.

Peter McCordell

U. S. Deputy Mineral Surveyor.

Subscribed and sworn to by the said Peter McCordell,

U. S. Deputy Mineral Surveyor, before me a clerk of the district court, in and for the County of Mohave, Arizona, this 26th day of May, 1906.

Ross H. Blakely
clerk district court.

Affidavit of Five Hundred Dollars Improvements.

We, Charles G. Southland and William P. Byrner

of lawful age, being first duly sworn according to law, depose and say: That we are acquainted with the Eclipse, Tom Tit, Comet, Iron Rod and Fraction Lode and Tom Tit Mill site mining claim, situate in San Francisco

mining district, Mohave County, Arizona Territory, for which West Gold Road Mining Co.

has made application for survey prior to application for patent under the provisions of the Act of Congress approved May 10, 1872; and that the labor done and improvements made thereon by the applicant and its grantor exceed five hundred dollars in value, and further that we are not personally interested in said mine.

Charles G. Southland
William P. Byrner

TERRITORY OF ARIZONA,
COUNTY OF Mohave } ss:

Sworn to and subscribed before me this 24th day of May, 1906

[SEAL.]

Ross H. Blakely Clerk Dist Court
By Peter McCardell Deputy

Notice of Mining Location.

MINERAL LOPE.

To All Whom It May Concern:

This mining claim, the name of which is the Iron Rod Mining Claim, situate on lands belonging to the United States of America, and in which there are valuable mineral deposits, was entered upon, and located for the purpose of exploration and purchase by J. H. Sample, John Little and J. E. Jimison

the undersigned, citizen of the United States of America, on the 21st day of May 1900.

The length of this claim is fifteen hundred (1500) feet, and the claim One Thousand (1000) feet in a Northwesterly direction and Five Hundred (500) feet in a Southeasterly direction from the center of the discovery shaft at which this notice is posted, lengthwise of the claim, together with three hundred (300) feet in width of the surface grounds, on each side of the center of said claim. The general course of the lode deposit and premises is from the Northwest to the Southeast.

The claim is situated and located in the San Francisco Mining District, in Mohave County, in the Territory of Arizona, about three miles in a Westerly direction from San O'Leary's or what was formerly known as the old Hardy Mine, and laps the "Tom Tit" Mining Claim on its Westerly end line.

The surface boundaries of the claim are marked upon the ground as follows: Beginning at a monument of stone at a point in a Northwesterly direction One Thousand (1000) feet from the discovery shaft (at which this notice is posted), being in the center of the Northwest end line of said claim; thence Northeasterly three hundred (300) feet to a monument of stone, being the Northeasterly corner of said claim; thence Southeasterly, seven hundred and fifty (750) feet to a monument of stone at the center of the Northeasterly side line of said claim; thence Southeasterly, seven hundred and fifty (750) feet to a monument of stone being at the Southeasterly corner of said claim; thence Southwesterly, three hundred (300) feet to a monument of stone at the center of the Southeasterly end of said claim; thence Southwesterly, three hundred (300) feet to a monument of stone, being at the Southwesterly corner of said claim; thence Northwesterly, seven hundred and fifty (750) feet to a monument of stone, being at the center of the Southwesterly side line of said claim; thence Northwesterly, seven hundred and fifty (750) feet to a monument of stone at the Northwesterly corner of said claim; thence Northeasterly, three hundred (300) feet to the place of beginning.

All done under the provisions of Chapter Six, of Title XXXII, of the Revised Statutes of the United States, and of an Act of the General Assembly of Arizona, entitled "An Act Concerning Mines," approved March 2nd, 1899.

Dated and posted on the ground this 21st day of May 1900, at min. past o'clock M.

J. H. Sample
John Little
J. E. Jimison

Filed and Recorded at request of J. E. Jimison August 2nd A.D. 1900 at 15 minutes past 9 o'clock A.M. in Book Q page 2 Records of Mohave County, Arizona Territory.

Geo. P. Feeny
County Recorder.

An Act Concerning Mines.

Be it enacted by the Legislative Assembly of the Territory of Arizona :

That Act No. 42 of the Eighteenth Legislative Assembly of the Territory of Arizona, approved March 5th, 1895, be amended so as to read as follows:

SECTION 1. Every notice of location of a lode mining claim shall contain: First, the name of the claim located; second, the name of the locator; third, the date of location; fourth, the number of feet in length of said claim and the number of feet claimed on each side of the center of the discovery shaft, lengthwise of the claim; fifth, the general course of the lode, deposit or premises located; sixth, the locality of the claim with reference to some natural object, or permanent monument, that will identify the claim; and shall be filed with the County Recorder for record within ninety (90) days after same shall have been located.

All lode mining locations hereafter located, the certificate of location of which shall not contain: First, the name of the lode or premises; second, the name of the locator or locators; third, the date of the location; fourth, the number of feet in length of said claim and the number of feet claimed on each side of the center of the discovery shaft, lengthwise of the claim; fifth, the general course of the lode or premises, as near as may be; sixth, the general locality of the claim with reference to some natural object or permanent monument that will identify the claim, shall be void.

Before filing such location certificate with the County Recorder of the proper County, the discoverer shall locate his lode claim by: First, sinking a discovery shaft upon the premises so claimed, to a depth of at least ten feet from the lowest part of the rim of said shaft at the surface, and deeper if necessary, until there is shown by such work a lode deposit or mineral in place; second, by posting at the point of discovery on the surface, a plain sign, or notice, substantially conforming to the location certificate; third, by marking such claim or premises on the ground so that its boundaries can be readily traced.

Such surface boundaries shall be marked by eight substantial posts projecting at least three feet above the surface of the ground, or by substantial stone monuments at least three feet high, to-wit: One at each corner of said claim, and one at the center of each end and side line thereof.

Any open cut, adit or tunnel, which shall be made as above provided for, as a part of the location of a lode mining claim, and which shall be equal in amount of work to a shaft ten feet deep and four feet wide by six feet long, and which shall cut a lode or mineral in place at a depth of ten feet from the surface, shall be equivalent as a discovery work, to a shaft sunk from the surface.

The discoverer shall have ninety days from the date of discovering the lode and the posting of the notice thereon, to perform said discovery work thereon.

If at any time the locator of any mining claim heretofore or hereafter located, or his assigns, shall learn that his original certificate was defective, or that the requirements of the law had not been complied with before filing, or shall be desirous of changing his surface boundaries or of taking in any additional ground which is subject to location, or in case the original certificate was made prior to the passage of this law, and he shall be desirous of securing the benefits of this Act, such locator or his assigns, may file an amended certificate of location subject to the provisions of this Act regarding the making of new locations.

The amount of assessment, or representation work, or improvements, to be done or made during each year, after the completion of the location as heretofore provided, and the time for doing the same shall be as provided by the laws of the United States.

Within three months after the expiration of the period of the time fixed for the performance of annual labor or the making of improvements upon any lode mining claim or premises, the person on whose behalf such work or improvement was made, or some person for him, knowing the facts, may make and record in the office of the County Recorder of the County wherein such claim is situated an affidavit in substance as follows:

TERRITORY OF ARIZONA,)
 County of.....) ss.
 and more than twenty-one years of age, and resides at..... being duly sworn, deposes and says, that he is a citizen of the United States, and is personally acquainted with the lode mining claim and premises known as..... mining claim or lode, situated in..... County, Arizona Territory, and is personally acquainted with the lode mining claim and premises known as..... Mining District, Arizona Territory, the notice of which premises, is recorded in the office of the County Recorder of said County in Book..... of Records of Mines, at page..... that between the..... day of..... A. D., and the..... day of..... A. D., at least..... dollars worth of work and improvements were done and performed upon said premises or lode, not including the location work of said claim. Such work and improvements were made by and at the expense of..... owners of said premises, for the purpose of complying with the law of the United States pertaining to assessments or annual work, and (here name the miners or men who worked upon the claim in doing the work) were the men employed by said owner and who labored upon said premises, and who did said work and improvements, and said work so done upon said premises is described as follows, to-wit: (Here describe the work done.)

Subscribed and sworn to before me..... this..... day of..... (Signature.)
 My commission as Notary Public expires on the..... day of..... A. D.....
 [Notarial Seal]..... Notary Public.

Such affidavit when so recorded shall be prima facie evidence of the performance of such labor or the making of such improvements and said original affidavit after it has been recorded, or a certified copy of record of same, or the record of same shall be received as evidence accordingly by all the Courts of this Territory. The relocation of forfeited or abandoned lode claims shall only be made by sinking a new discovery shaft and fixing new boundaries in the same manner and to the same extent as is required in making a new location; or the relocater may sink the original discovery shaft ten feet deeper than it was at the date of the commencement of such relocation, and shall erect anew, or make the old monuments the same as originally required. In either case a new location monument shall be erected and the location certificate shall state if the whole or any part of the new location is located as abandoned property.

Notice of Location. MINERAL LODGE.

Dated..... 1900

Filed and recorded at request of.....

at..... M. A. D. 1900

Book.....

Pages.....

By..... Deputy Recorder

County Recorder

This diagram is to give locator a general idea of plan of location under the new law. The Discovery Shaft can be in the center of claim or any distance from either end from the other. Commence direction of claim at a center and shaft; then, beyond the distance and either direction, giving its distance and direction from center of Discovery Shaft; then, beyond the claim in either direction. In description be careful to state locality of claim with reference to some natural object, or permanent monument, as will identify the claim.

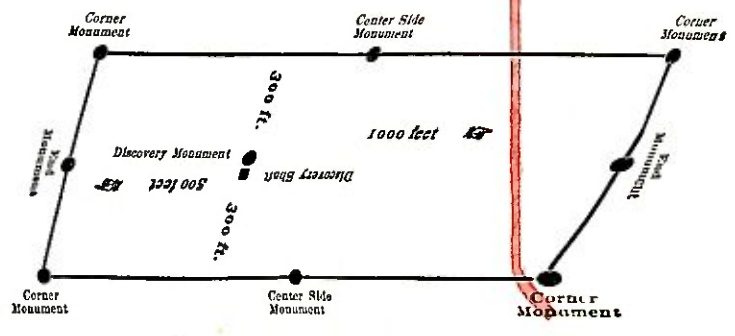

Amended Location Certificate

Know All Men by these Presents, That the West Gold Road Mining Company, By C. M. Tozer Attorney in fact
 the undersigned citizen of the United States, over the age of twenty-one years, having complied with all the requirements of the laws of the United States and the Territory of Arizona, relating to mining claims, and with the local laws, customs, rules and regulations of San Francisco
 Mining District, hereby make and file this their amended location of the Tom Tit Lode, claiming by right of discovery, location, primal appropriation and possession 1500 feet, linear and horizontal measurement, on this vein or lode of quartz, or other rock in place, bearing Gold and other valuable minerals, with all dips, variations and angles, the same being 630 feet along the ledge in a S 53° 20' E direction from the discovery stake and 870 feet along the ledge in a N 53° 20' W direction therefrom, together with 300 feet in width on each side of the middle of said ledge, and all veins, lodes, ledges, mineral deposits, mineral and surface ground within the lines of said claim.

Situate in San Francisco Mining District, County of Mohave, Territory of Arizona, in Tp 18 N R 19 W and more particularly described as follows, to-wit:

Beginning at the discovery of the claim where a monument is established and this notice posted; Thence S 53° 20' E 630 ft to the S. E. End Center; Thence S 40° 17' W 300 ft to the S. W. Corner; Thence N 53° 20' W 1500 ft to the N. W. Corner; Thence N 40° 17' E 300 ft to N. W. End Center and 600 ft to the N. E. Corner; Thence S 52° 49' E 1499.2 ft to the S. E. Corner where M. S. Location Monument No 1699 bears N 43° 57' W 316.1 ft; Thence S 40° 17' W 286.35 ft to the place of beginning

THIS AMENDED LOCATION is made in conformity with the original location, made May 21st 1900, recorded Aug 2nd 1900, in Book 5, Page 2, of Quartz Locations, in the office of the Recorder of said County, and it is made for the purpose of appropriating all ground within the boundaries hereinbefore described, and of more definitely describing the situation and boundaries of said lode, correcting any irregularities, informalities or errors, supplying omissions and correcting any defects which may have existed in the original location, or the record thereof, hereby waiving no rights acquired under and by virtue of said original location. And if the original location or the certificate thereof is void, then this location shall be an original location and this certificate an original certificate.

Date of Original Discovery, May 21st A. D. 1900
 Date of Amended Location, April 23rd A. D. 1906

Attest: West Gold Road Mining Company
By C. M. Tozer, Attorney in fact

No.

Amended Location Certificate

LODE.

Recorded at the request of

P. M. Cardell

at *40* minutes past *9* o'clock

A.M., *April 23rd* 190*6*

in Book *X* of Mining Claims,
page*s* *125, 126 and 127,*

Records of Mohave County, Arizona.

Thos. McNeely

County Recorder.

By _____ Deputy.

Transferred _____ 190_____

Book _____ Mining Claims, page _____

County Recorder.

By _____ Deputy.

the H. H. McNeil Co., Printers, Phoenix, Arizona

TERRITORY OF ARIZONA,
County of _____ } ss.

I, _____, County Recorder in and for the County and

Territory aforesaid, do hereby certify that the within instrument was filed for record at _____ o'clock, _____ M.,

on this _____ day of _____ 190____, and duly recorded in Book No. _____

of _____ Records of _____ County, Arizona, at pages _____

WITNESS my hand and official seal the day and year first above written.

County Recorder.

NOTICE OF LOCATION

Quartz Claim

know all Men by These Presents: That we, the undersigned, citizens of the United States over the age of twenty-one years, having made discovery of mineral and rock in place, do locate and claim by right of discovery and location, in accordance with the U. S. Revised Statutes, and with local laws and customs, and the rules and regulations of the Mining District; and do hereby give Notice of the location of the within mentioned Quartz Mining Claim and have posted upon the discovery monument a duplicate of this said notice with the following particulars, to-wit:

Commencing at This Monument & Notice. We Claim all Vacant Ground in this fractional Claim. Of about 5 acres and is bounded as follows On the East by the Cold Hill Mining Claim. On the west by the Iron Rod. On the North by the Tom Tit; On the South name of Claim Unknown.

This Quartz Claim is situated in the San Francisco Mining District Mohave County Arizona Territory

And is otherwise described as follows. About 1/4 of a mile west of the Cold Road Mine.

Measuring -- linear feet, horizontally, in length, on the vein, being -- feet from said discovery monument erected on said claim and ___ feet therefrom; the general course of the vein is ___ and at right angles therewith, and along either side of said vein, making parallel end lines, ___ linear feet from the center of said Quartz lode, vein, ledge or deposit and along the same, including all its dips variations, spurs, angles and all veins, ledges, lodes or deposits within the lines of this claim, together with all water and timber appurtenant, allowed by law, are hereby claimed.

This claim shall be known as the Fraction Quartz Mining Claim and is situated in the San Francisco Mining District Section _____, Township _____, Range _____, Meridian _____ County of Mohave, Territory of Arizona.

Located this 5th day of Sept 1905

The date of discovery and posting of this notice is the Fifth, day of Sept 1905.

Witness

Charles Harris

Located by

J. D. Spargo

For the West Gold Road Mining Comp.
Locators.

Recorded at request of Lovin & Withers, September 14th A.D. 1905, at 1 o'clock P.M., in Book X, Page 57 of Mining Records of Mohave County, Arizona Territory.

Thos. McNeely,
County Recorder.

Form for Lode Running East and West.

NOTICE OF MINING LOCATION .

Mineral Lode.

To All Whom It May Concern:

This mining claim, the name of which is the Eclipse Mining Claim, situate on lands belonging to the United States of America, and in which there are valuable mineral deposits, was entered upon and located for the purpose of exploration and purchase by O. A. Eshom and J. E. Talbot, the undersigned, citizens of the United States of America, on the 8th day of August 1900

The length of this claim is two hundred (200) feet, and we claim one hundred (100) feet in a Easterly direction and one hundred (100) feet in a Westerly direction from the center of the discovery shaft at which this notice is posted, lengthwise of the claim, together with three hundred (300) feet in width of the surface grounds, on each side of the center of said claim. The general course of the lode deposit and premises is from the East to the West.

The claim is situated and located in the San Francisco Mining District, in Mohave County, in the Territory of Arizona, about 25 miles in a westerly direction from the town of Kingman, and adjoining on the west boundary line of the Gold Road Mining claim, and on the East boundary line of Tom Titt Mining claim.

The surface boundaries of the claim are marked upon the ground as follows: Beginning at a monument of stone at a point in an Easterly direction one hundred (100) feet from the discovery shaft (at which this notice is posted), being in the center of the East end line of said claim; thence South three hundred (300) feet to a monument of stone, being the Southeast corner of said claim; thence West, one hundred (100) feet to a monument of stone at the center of the South side line of said claim; thence West, one hundred (100) feet to a monument of stone, being at the Southwest corner of said claim; thence North, three hundred (300) feet to a monument of stone at the center of the West end of said claim; thence North, three hundred (300) feet to a monument of stone, being at the Northwest corner of said claim; thence East, one hundred (100) feet to a monument of stone, being at the center of the North side line of said claim; thence East, one hundred (100) feet to a monument of stone at the Northeast corner of said claim; thence South three hundred (300) feet to the place of beginning.

All done under the provisions of Chapter Six, of title XXXII., of the Revised Statutes of the United States, and of an Act of the General Assembly of Arizona, entitled "An Act Concerning Mines," approved March 2, 1899.

Dated and posted on the ground this 8th day of August 1900, at 5 o'clock P.M.

Witness

J. B. Anderson.

O. A. Eshom

J. E. Talbot.

Locators.

Filed and Recorded at request of O.A.Eshom, Nov. 5th A.D., 1900 at 20 minutes past 9 o'clock A.M., in Book S. page 9 Records of Mohave County, Arizona Territory.

Jno P. Feeny,

County Recorder.

Notice of Mining Location.

Mineral Claim.

To All Whom It May Concern:

This Mining Claim, the name of which is the Comet Mining Claim, situate on lands belonging to the United States of America, and in which there are valuable mineral deposits, was entered upon and located for the purpose of exploration and purchase by O. A. Eshom, J. E. Talbot and Fred Leonard, the undersigned citizens, on the 2nd day of December 1901

The length of this claim is Fifteen Hundred (1500) feet, and we claim One Hundred and fifty (150) feet in a Southeasterly direction, and Thirteen Hundred and fifty (1350) feet in a Northwesterly direction from the center of the discovery shaft, at which this notice is posted, lengthwise of the claim together with Three Hundred (300) feet in width of the surface grounds, on each side of the center of said claims. The general course of the lode deposit and premises is from the Southeast to the Northwest

The claim is situated and located in the San Francisco Mining District, in Mohave County, in the Territory of Arizona, about 1660 feet in a Northwesterly direction from the original Gold Road Mining Claim located by Jose Jeres and Henry Lovin and is on the same lode.

The surface boundaries of the claim are marked upon the ground as follows: Beginning at a monument of stone at a point in a Southeasterly direction One hundred and fifty (150) feet from the discovery shaft (at which this notice is posted), being in the center of the Southeasterly end line of said claim; thence Northeasterly Three Hundred (300) feet to a monument of stone, being the Northeasterly corner of said claim; thence Northwesterly Seven Hundred and Fifty (750) feet to a monument of stone, at the center of the Northwesterly side line of said claim; thence Northwesterly Seven Hundred and Fifty (750) feet to a monument of stone, being at the Northwesterly corner of said claim; thence Southwesterly Three Hundred (300) feet to a monument of stone at the center of the Southwesterly end of said claim; thence Southwesterly Three Hundred (300) feet to a monument of stone being at the Southwesterly corner of said claim; thence Southeasterly Seven Hundred and Fifty (750) feet to a monument of stone, being at the center of the Southeasterly side line of said claim; thence Southeasterly Seven Hundred and Fifty (750) feet to a monument of stone at the Southeasterly corner of said claim; thence Northeasterly Three Hundred (300) feet to the place of beginning.

All done under the provisions of Chapter Six, of Title XXXII, of the Revised Statutes of the United States, and of an Act of the General Assembly of Arizona, entitled "An Act Concerning Mines," approved March 2d, 1899, and March 16th, 1901, and all acts and parts of acts enacted up to and including the date of this location.

Dated and posted on the ground this 2nd day of December 1901.

O. A. Eshom
J. E. Talbott
Fred Leonard Locators

Filed and Recorded at request of O. A. Eshom this 25th day of February A. D. 1902, at 4 o'clock 10 minutes P.M.

Jno. P. Feeny,
County Recorder.

(Recorded in Book "U", page 41 of Mining Records.)

TERRITORY OF ARIZONA,)
) ss.
 County of Mohave.)

I, Thos. McNeely, Recorder of Mohave County, Territory of Arizona, do hereby certify that I have compared the foregoing copies of Notice of Location of the ECLIPSE, TOM TIT, COMET, IRON POP and FRACTION Mining Claims and of the endorsements thereupon with the original records of the same on file in this office and that the same are correct transcripts therefrom and of the whole of said original records.

WITNESS my hand and the seal of said office
 this 7th day of April 1906.



Thos. McNeely
 Recorder of Mohave County.

A M E N D E D L O C A T I O N O F
T O M T I T M I L L S I T E .

TO ALL WHOM THESE PRESENTS MAY CONCERN:-

Know Ye that the West Gold Road Mining Company, a duly organized corporation, doing business under the laws of Arizona, and in the County of Mohave, Arizona, do hereby declare and publish as a legal notice to all the world that we have a valid right to the occupation, possession and enjoyment of all and singular that tract or parcel of land, not exceeding five (5) acres, situate, lying and being in the San Francisco Mining District, Mohave County, Arizona, bounded and described as follows, to-wit:-

Beginning at the N. E. Corner of the claim where a monument is located and this notice posted; thence west 466.7 feet to the N. W. Corner; thence south 466.7 feet to the S. W. Corner; thence east 466.7 feet to the S. E. Corner; thence north 466.7 feet to the N. E. Corner, the place of beginning; containing five (5) acres.

This amended location is made in conformity with the original location made August 11th, 1905, recorded August 14th, 1905, in Book "1", Mill Sites, at Pages "505 - 506", in the office of the Recorder of said County, and is made for the purpose of more definitely describing the situation and boundaries

of said Mill Site, correcting any irregularities, informalities or errors, supplying omissions and correcting any defects which may have existed in the original location, or the record thereof, hereby waiving no rights acquired under and by virtue of said original location. And if the original location, or the certificate thereof is void, then this location shall be an original location, and this certificate an original certificate.

Date of original location, August 11th, 1905.

Date of amended location, April 5th, 1906.

*West Gold Road Mining Co.
By C. M. Tozer Attorney
in fact.*

4-688.

U. S. SURVEYOR-GENERAL'S FINAL CERTIFICATE ON FIELD NOTES.

Department of the Interior,

OFFICE OF U. S. SURVEYOR-GENERAL,

Phoenix, Arizona,

July 18, 1906.

I, U. S. Surveyor-General for District of Arizona do hereby certify that the foregoing transcript of the Field Notes, return and approval of the survey of the mining claim of West Gold Road Mining Co.

known as the Eclipse, Tom Tit, Comet, Iron Rod and Fraction Lodes and Tom Tit Mill Site situate in San Francisco

Mining District, Mohave County, Arizona

in Section approx., Township No. 20 N., Range No. 19 W., and

designated as Survey No. 2240 A & B, has been correctly copied from the originals on file in this office; that said Field Notes furnish such an accurate description of said mining claim as will, if incorporated into a patent, serve fully to identify the premises, and that such reference is made therein to natural objects or permanent monuments as will perpetuate and fix the locus thereof.

And I further certify that five hundred dollars' worth of labor has been expended or improvements made upon said mining claims by claimant or its grantors, and that said improvements consist of 6 shafts, 2 cuts, 1 cross cut and 1 drift, total value \$8345.00

and that no portion of said labor or improvements has been included in the estimate of expenditures upon any other claim.

I further certify that the plat thereof, filed in the U. S. Land Office at Phoenix, Arizona is correct and in conformity with the foregoing Field Notes.

Frank S. Ingalls

United States Surveyor-General for Arizona.

4-687.

SURVEYOR-GENERAL'S CERTIFICATE OF APPROVAL OF FIELD
NOTES AND SURVEY OF MINING CLAIM.

Department of the Interior,

Office of U. S. Surveyor-General,

Phoenix, Arizona

July 12, 1906

I, U. S. Surveyor-General for District of Arizona

do hereby certify that the foregoing and hereto attached Field Notes and Return of the Survey of the
Mining Claim of West Gold Road Mining Co.

known as the
Eclipse, Tom Tit, Comet, Iron Rod and Fraction lodes and Tom Tit
Mill Site
situate in San Francisco Mining District,

MoHAVE County, Arizona

in Section approx., Township No. 20 N., Range No. 19 W.

designated as Survey No. 2240 A & B.

executed by Peter McCardell, U. S. Deputy Mineral

Surveyor, April 14 May 24, 1906, under my instructions dated

April 9 & May 17, 1906, have been critically examined and the necessary cor-

rections and explanations made, and the said Field Notes and Return, and the Survey they describe,

are hereby approved. A true copy of the copy of the location certificate filed by the applicant for

survey is included in the field notes.

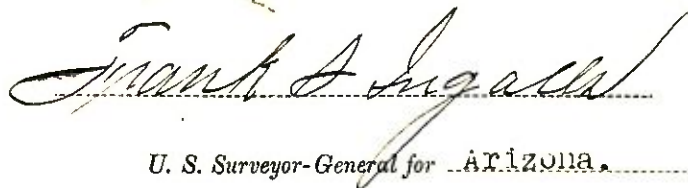

U. S. Surveyor-General for Arizona

Recorded at request of

P. McCardell

April 6th A. D. 1906

at 30 minutes past 10 o'clock

A. M., in Book 1 Pages 520

and 521 of Mill Sites & Water
Rights
Records of Mohave County, Arizona Territory.

Thos. McNeely

County Recorder.

Large
maps