



M
S
0
2
3
1
1

NOV 3 1906

E. A. J.
Nov. 9, '06

(4-683.)

Mineral Survey No. 2311

Lot No. _____

~~Populist, Cottonwood, J. K. L. American Boy, Belle~~
Arizona Land District.

FIELD NOTES

OF THE SURVEY OF THE MINING CLAIM OF

Globe Boston Copper Mining Company

KNOWN AS THE

Populist, Cottonwood, J. K. L. American Boy, Belle
Globe Mining District.

Gila County, Arizona

Section 13, 14, 23, 24, Township 1 N., Range 15 E. T. 8 S. R. B. & M.

Surveyed under instructions dated Aug 18th, 1906.

by Robert R. Boyd,
U. S. Deputy Mineral Surveyor

Claim located see location notices, 1

Survey commenced September 5th, 1906

Survey completed October 5th, 1906

6-101

Post Office address of Claimants atty.
S. E. Hazzard, Bisbee Arizona

V
m

Feet

BELLE LODE MINING CLAIM.

Beginning at cor No. 1 the N W cor, identical with location and situated on line 5-1 Aztec lode, survey No. 820 Lot No. 76, N 56° 47' W 40.6 ft. from cor No. 1 and N 56° 47' W 322.0 ft from cor No. 2, a pine post 4 ft long 4 in square, set 18 in. in the ground in a mound of stones and scribed 1-2311-B L, whence a Limestone Cropping 2 x 4 ft and level with the surface of the ground, chiseled X-2311-B R, bears S 17° 03' E 9.6 ft and W 1/4 Cor Sec 13, T 1 N, R 15 E, G & S R B & M, bears N 29° 41' W 1087.3 ft and cor No. 5, Stallo & Moody Lode, Survey No. 2299, bears S 52° 58' W 9.4 ft.

Note The course and distance of line 2-1-5 Aztec Lode, (N 66° 14' W 591.0 ft) as reported in Survey No. 820 Lot No. 76, being the patent survey of the Aztec Claim is in error.

1266.1 Thence N 52° 58' E along line 5-4 Stallo & Moody Lode, Survey No. 2299, to cor No. 2, the N E cor identical with location and with corners Nos. 1, 3 and 4, respectively, of Satisfaction Lode, Survey No. 2306, Pinal Lode Lot No. 75 *Sur. No. 819* and Stallo & Moody Lode Survey No. 2299, a pine post 4 ft long 4 in square, set 18 in. in the ground in a mound of stones and scribed 2-2311-B L, whence a monument of stones 4 ft high bears N 50° W 20.0 ft.

300.0 Thence S 51° 31' E along line 1-5 Satisfaction Lode Survey No. 2306 to the original location for N E E C,
600.0 same bearing to cor No. 3, the S E cor, identical with location, with cor No. 2 American Boy lode of this survey and with corners nos. 2 and 5, respectively, of Amber and Satisfaction Lodes Survey No. 2306, a pine post 4 ft long, 4 in. square, set 18 in. in the ground in a mound of stones and scribed 3-2-2311-B L, whence a monument of stones permanently set 4 ft high bears N 3° 24' E 46.4 ft.

1250.6 Thence S 53° 03' W to the intersection of line 3-4 I X L Lode of this survey at N 48° 33' W 281.13 ft from cor No. 3;
1266.2 same bearing to cor No. 4, the S W cor, identical with location, a pine post 4 ft long, 4 in square, set 18 in. in the ground in a mound of stones and scribed 4-2311-B L, whence a Quartzite Ledge in place 2 ft wide and 1 ft above the surface of the ground, chiseled X-2311-B R bears N 13° 20' W 16.5 ft.

278.4 Thence N 51° 31' W to the intersection of line 2-3 I X L Lode of this survey at S 41° 30' W 29.6 ft from cor No. 3. Cor No. 3 I X L of this survey is identical with cor No. 2 Aztec Lode Survey No. 820 Lot No. 76.
300.0 same bearing to original location for S W E C,
597.5 same bearing to cor No. 1, the place of beginning.

LEDGE.

The presumed course of the vein on this claim is from the S W E C of location N 53° 03' E 1266.2 feet.

AMERICAN BOY LODE MINING CLAIM.

Beginning at cor No. 1, the N W cor, identical with location, a pine post 4 ft long 4 in. square, set 18 in. in the ground in a mound of stones and scribed 1-2311-A B L, whence a Quartzite Cropping in place 2 ft x 1 1/2 ft and 1 ft high, chiseled X-2311-B R, bears N 37° 00' W 65.8 ft and S W cor Sec 13 T 1 N, R 15 E, G & S R B & M bears S 36° 38' W 1484.0 ft.

Thence N 53° 03' E

163.3 to cor No. 4 Belle Lode of this survey,
 178.9 same bearing to the intersection of line 3-4 I X L Lode
 of this survey at ~~N 48° 33' W~~ ^{310.07} ft from cor No. 4,
 360.0 same bearing to the intersection of bottom of dry wash,
 course about N 30° W, and extending above side line
 150.0 ft. This Dry Wash connects with the Big Johnny
 Wash at about 150.0 ft in a southeasterly direction.
 1120.0 same bearing to the intersection of the bottom of Dry
 Wash, bearing about N 25° W and extending above side
 line 365.0 ft. This Wash also connects with the Big
 Johnny Wash in a southeasterly direction about 125.0 ft.
 1429.5 same bearing to cor No. 2, the N E cor, identical with
 location, with cor No. 3 Belle Lode of this survey, a
 pine post etc. and scribed 2-3-2311-A B L.

Thence S 51° 41' E

50.0 along line 2-1 Amber Lode Survey No. 2306 to the
 intersection of the north side of the Big Johnny Wash,
 running in a general northeasterly direction, parallel
 to line 1-2 American Boy Lode, as indicated on map
 attached herewith.
 120.0 same bearing to the intersection of the southeasterly
 side of same Wash,
 298.0 same bearing to original location for N E E C,
 533.0 same bearing to the intersection of line 3-4 Triangle
 Lode Survey No. 1656 at N 46° 08' E 322.5 ft from cor
 No. 3, which point of intersection is identical with
 cor No. 1 Amber Lode Survey No. 2306,
 599.0 same bearing to cor No. 3, the S E cor, identical with
 location, a pine post 4 ft long, 4 in. square, set 18 in.
 in the ground in a mound of stones and scribed 3-2311-
 A B L, whence
 a Quartzite Cropping 1 ft x 1 ft and 6 in. above the
 surface of the ground, chiseled X-2311-B R, bears N
 16° 05' E 8.9 ft.

Thence S 53° 03' W

331.3 to cor No. 2 Tip Top Lode Survey No. 1656, identical
 with cor No. 2 Triangle Lode of the same survey, from
 which point cor No. 3 Triangle Lode bears N 49° 15' W
 26.0 ft.

Note The course of line 3-4 Triangle Lode Survey No. 1656
 which is N 45° 50' E is in error.

1429.5 same bearing along line 2-1 Tip Top Lode Survey No.
 1656 to cor No. 4, S.W. cor, identical with location,
 and with the S E cor of Osceola Lode unsurveyed, a pine
 post 4 ft long 4 in square, set 18 in. in the ground in
 a mound of stones and scribed 4-2311-ABL, whence a
 Diabase Boulder 4 ft x 4 ft and 3 ft high, chiseled X-~~23~~
 2311-B R, bears S 23° 30' W 33.0 ft and cor No. 1 Tip
 Top Lode Survey No. 1656 bears S 53° 01' W 377.8 ft.

Note The distance of line 1-2 Tip Top Lode Survey No. 1656
 which is *1479 feet*
 is in error.

Thence N 51° 41' W

252.0 to the intersection of line 1-4 I X L Lode of this
 survey at S 41° 09' W 156.1 ft from cor No. 4, which
 point of intersection is identical with the N E cor of
 Osceola Lode unsurveyed.
 301.0 same bearing to the original location for S W E C,
 310.0 same bearing to the intersection of the south side ~~line~~
 of the Big Johnny Wash, which bears in a general
 southwesterly direction to cor No. 1 I, X, L Lode of this
 survey,
 345.0 same bearing to the intersection of the north side of
 said Wash,
 599.0 same bearing to cor No. 1, the place of beginning.

LEDGE

The presumed course of the vein on this claim is from the S W E C of location N 53° 03' E 1429.5 feet.

I X L LODE MINING CLAIM.

Beginning at cor No. 1, the S W cor, identical with location, with cor No. 1 Cottonwood Lode of this survey and with the N W cor of Osceola Lode unsurveyed, and situated at the southerly edge of the Big Johnny Wash, a pine post 4 ft long, 4 in square, set 18 in in the ground in a mound of stones and scribed 1-2311-IXL, whence a Boulder of Dacite 6 x 6 x 2 ft high, chiseled X-2311-B R, bears N 6° 00' W 28.3 ft, and a Ledge of Lime, level with the surface of the ground, chiseled X-2311-B R, bears S 48° 50' E 6.0 ft and a Boulder of Dacite 4 x 6 x 4 ft high, chiseled X-2311-B R, bears S 77° 19' W 22.4 ft, and N W cor Sec 24, T 1 N. R. 13 E. G & S R B & M bears N 88° 21' W 297.6 ft,

Thence N 48° 33' W

- 12.7 to the intersection of the north side line of Sec 24 T 1 N R 15 E at S 89° 58' E 288.0 ft from the N W cor and N 89° 58' W ~~228.4~~ ft from the N 1/4 Corner of Sec 24,
- 300.0 same bearing to original location for S W E C,
- 397.2 same bearing to the intersection of the west line of the S W 1/4 Sec 13 T 1 N R 15 E at N 01' W 254.34 feet from the S W cor and S 01' E 305.76 ft from the Closing Cor established by Segregation Survey on line 2-3 Aztec Lode survey No. 820 Lot No. 76,
- 600.0 same bearing to cor No. 2, the N W cor identical with location, with cor No. 3 Aztec Lode Survey No. 820 Lot No. 76 and with corners Nos. 4 and 1 respectively of Cottonwood and Populist Lodes of this survey, a pine post 4 ft long 4 in square set 18 in. in the ground in a mound of stones and scribed 1-2-4 -2311-IXL, whence a Boulder of Dacite, chiseled X-2311-B R, bears N 16° 18' W 16.3 ft, and another Boulder of Dacite in place, chiseled X-2311-B R, bears S 8° 09' W 6.0 feet.

Thence N 41° 30' E

- 229.3 to Closing Corner established on line 3-2 Aztec Lode, Survey No. 820 Lot No. 76, by Segregation Survey, from which point S W cor Sec 13 bears S. 01' E 560.1 ft.
- Note It will be seen that the Closing Corners established in the Segregation Survey of the Aztec Lode, Survey No. 820 Lot No. 76 are not on line between the S W cor of Sec 13 and the W 1/4 cor for the same Section. This is evidently due to the fact that the original Public Land Survey was in error and in making the Segregation Survey, the engineer ran north from the southwest cor of Sec 13, according to the notes of the original survey. The Closing Corners being permanently set, I consider that they establish the direction of the west line of the S W 1/4 of Sec 13 and have, therefore, made my claim line intersections with the section line as modified by the Closing Corners.
- 1433.7 same bearing to the intersection of line 1-4 Belle Lode of this survey,
- 1463.3 same bearing to cor No. 3, the N E cor, identical with location, a pine post 4 ft long 4 in square set 18 in. in the ground in a mound of stones and scribed 3-2311-IXL, whence a Quartzite Ledge 2 ft x 2 ft x 1 ft, chiseled X-2311-B R, bears N 16° 05' W 16.2 ft.

Thence S 48° 33' E

- 281.13 to the intersection of line 3-4 Belle Lode of this survey and the intersection of line 2-1 American Boy Lode, also of this survey
- 300.0 same bearing to original location for N.E.E.C.
488. Bank of Big Johnny Wash
532. opposite bank of Big Johnny Wash

FEET

4

- 591.2 ~~ledge of this survey,~~ same bearing to cor No. 4, the S E cor, identical with location, a pine post 4 ft long 4 in-square, set 18 in. in the ground in a mound of stones and scribed 4-2311-IXL, whence a Diabase Boulder 4 ft x 4 ft x 3 ft, chiseled X-2311-BR, bears N 24° 42' W 73.0 ft.
- 156.1 Thence S 41° 09' W to the intersection of line 1-4 American Boy Lode of this survey,
- 1452.2 same bearing to the intersection of the south side line of Sec 13 T 1 N R 15 E at N 89° 56' W 304.8 ft from the S W cor of Sec 13 and 2267.4 ft from the S 1/4 cor of Sec 13 T 1 N R 15 E,
- 1463.3 same bearing to cor No. 1, the place of beginning.

LEDGE.

The presumed course of the vein on this claim is from the S W E C of location N 41° 30' E 1463.3 feet.

COTTONWOOD LODE MINING CLAIM.

Beginning at cor No. 1, the S E cor, identical with location and with cor No. 1 IXL Lode of this survey, a pine post 4 ft long 4 in square, set 18 in. in the ground in a mound of stones and scribed 1-2311-C L, whence the N W cor Sec 24 T 1 N R 15 E, G & S R B & M, bears N 88° 21' W 297.6 ft.

- 275.0 Thence S 50° 19' W to southerly edge of Big Johnny Cañon,
- 388.2 same bearing to the intersection of the west side line of Sec 24 T 1 N R 15 E at S 0° 17' W 256.45 ft from the N W cor and N 0° 17' E 2366.0 ft from the W 1/4 cor Sec 24,
- 768.0 same bearing to the intersection of the southerly *edge* of Big Johnny Cañon,
- 1083.0 same bearing to the intersection of the southern boundary of the Big Johnny Cañon, as indicated on map inclosed herewith,
- 1441.0 same bearing to cor No. 2, the S W cor, identical with location, being an X^{or 2 234-8-L} deeply chisled on a Boulder of Dacite 4 ft x 7 ft x 3 ft high with a monument of stones permanently set 3 ft in diameter and 3 ft high alongside whence a Boulder of Dacite, chiseled X-2311-B R, said boulder being 3 x 4 x 1 ft high, bears S 46° 00' W 9.5 ft.

- 300.0 Thence N 48° 33' W to original location for S W E C,
- 355.5 same bearing to the intersection of southerly *edge* of Big Johnny Cañon,
- 550.0 same bearing to the intersection of the northerly side line of Big Johnny Cañon. Where line 2-3 Cottonwood Lode intersects the Big Johnny Cañon, the Canon is 125 ft in depth.
- 600.0 same bearing to cor No. 3, the N W cor, identical with location and with cor No. 2 Populist Lode of this survey, being an X^{or 2 237-4-L} deeply chiseled in a Boulder of Dacite 4 ft x 4 ft x 3 ft high, with a monument of stones permanently set and 3 ft high alongside, whence a Boulder of Dacite 8 x 12 x 4 ft high, chiseled X-2311-B R, bears N 81° 30' E 16.5 ft.

- 833.5 Thence N 50° 19' E to the intersection of the north side line of Sec 23 T 1 N R 15 E at N 89° 56' W 619.8 ft from the N E cor of Sec 23 and S 89° 56' E 2017.4 ft from the N 1/4 cor of Sec 23,
- 1441.0 same bearing to cor No. 4, the N E cor, identical with location, with cor nos. 1 and 2 respectively of Popuist

and IXL Lodes of this survey and with cor No. 3 Aztec Lode, Survey No. 820 Lot No. 76, a pine post etc. and scribed 1-2-4-2311-C L,

- Thence S 48° 33' E
- 202.8 to the intersection of the line joining the S W cor of Sec 13 and the Closing Corner established by Segregation Survey on line 2-3 Aztec Lode, Survey No. 820 Lot No. 76 at N 01' W 254.34 ft from the Section Corner and S 01' E 305.76 ft from the Closing Corner,
- 245.0 same bearing to the intersection of a Dacite Cliff, marking the northern limit of Big Johnny Cañon,
- 300.0 same bearing to original location for N E E C,
- 587.3 same bearing along line 2-1 I X L Lode of this survey to the intersection of the south line of Sec 13 T 1 N R 15 E,
- 600.0 same bearing to cor No. 1, the place of beginning.

LEDGE.

The presumed course of the vein on this claim is from the S W E C of location N 50° 19' E 1441.0 feet.

POPULIST LODE MINING CLAIM.

Beginning at cor No. 1, the S E cor, identical with location, with cor No. 3 Aztec Lode, Survey No. 820 Lot No. 76 and with cor nos. 2 and 4 respectively of IXL and Cottonwood lodes of this survey, a pine post 4 ft long, 4 in square, set 18 in. in the ground in a mound of stones and scribed 1-2-4-2311-P L, whence a Boulder of Dacite 4 x 6 x 2 ft high, chiseled X-2311-B R, bears N 16° 18' W 16.3 ft and another Boulder of Dacite 4 x 3 x 4 ft high, chiseled X-2311-B R, bears S 8° 09' W 6.0 ft. and S E cor Sec 14, T 1 N R 15 E G & S R B & M bears S 21° 24' E 417.4 ft.

- Thence S 50° 19' W
- 607.5 to the intersection of the south line of Sec 14 T 1 N R 15 E,
- 1441.0 same bearing to cor No. 2, the S W cor, identical with location, and with cor No. 3 Cottonwood Lode of this survey, an X deeply chiseled on a Dacite Boulder etc. *as heretofore described*
- Thence N 66° 06' W
- 348.55 to original location for S W E C,
- 697.1 same bearing to cor No. 3, the N W cor, identical with location, an X^{417.4} deeply chiseled on a Dacite Boulder 2 x 5 x 3 ft high with a monument of stones permanently set and 3 ft high alongside, whence a Dacite Boulder 2 x 4 x 2 ft high, chiseled X-2311-B R, bears N 85° 00' E 3.7 ft.
- Thence N 54° 38' E
- 431.5 to the intersection of the north line of Sec 23, T 1 N R 15 E, at N 89° 56' W 1546.2 ft from the N E cor of Sec 23 and S 89° 56' E 1091.0 ft from the N 1/4 cor of Sec 23,
- 1500.0 same bearing to cor No. 4, the N E cor identical with location and with cor nos. 1 and 4 respectively of Crancey Lode, Survey No. 2299, and Aztec Lode, Survey No. 820 Lot No. 76, a pine post 4 ft long, 4 in. square, set to Bedrock in a mound of stones and scribed 4-2311-P L, whence a Dacite Boulder, chiseled X-2311-B R, bears S 53° 12' W 18.6 ft,
- Thence S 66° 06' E
- 348.55 along line 4-3 Aztec Lode, Survey No. 820 Lot No. 76, to original location for N E E C,
- 571.7 same bearing to cor No. 1, the place of beginning.

LEDGE

The presumed course of the vein on this claim is from the S W E C of location N 54° 38' E 1500.0 feet.

	AREA	acres	acres
Total Area Belle Lode		16.848 ✓	
Less Area in conflict with Aztec Lode Survey No. 820 Lot No. 76	0.108		
Less Area in conflict with I X L Lode of this survey	0.141 ✓		
Total Area in conflict		0.249	
Net Area of Belle Lode			16.599 ✓
Total Area of American Boy Lode		19.102	
Less Area in conflict with Triangle Lode, Survey No. 1656	0.339		
Less Area in conflict with I X L Lode of this survey	1.245		
Total Area in conflict		1.584	
Net Area American Boy Lode			17.428 ✓
Total and Net Area IXL Lode			20.008
Total and Net Area Cottonwood Lode			19.611
Total and Net Area Populist Lode			18.786
Net Area of Group			92.432

IMPROVEMENTS.

I certify that the value of the labor and improvements on each claim of this group, placed thereon by the claimant, or its grantors, is as follows:

BELLE

No. 1 Discovery Shaft 4 x 6 x 22 ft deep, S W cor of which bears from S W E C of location on Ledge N 53° 03' E 246.0 ft.
Value \$200.00

AMERICAN BOY

No. 1 Discovery Shaft 4 x 7 x 26 ft deep, on Ledge, N W cor of which bears from S W E C of location N 53° 03' E 638.0 ft.
Value \$260.00

I X L

No. 1 Discovery Open Cut 4 x 10 x 18 ft, course of Cut in a northwesterly direction at right angles to vein, center of mouth of Open Cut bears from N E E C of location on vein S 41° 30' W 453.0 ft.
Value \$ 50.00

COTTONWOOD

No. 1 Discovery Open Cut 4 x 10 x 18 ft, center of face of which bears along Ledge from N E E C of location S 50° 19' W 520.0 ft.
Value \$ 50.00

POPULIST

No. 1 Discovery Shaft 4 x 7 x 11 ft deep in Solid Dacite Formation, extremely hard, center of the N E side of which bears from the N E E C of location S 54° 38' W 10.0 ft.
Value \$125.00

Note Complete affidavit of \$500.00 for each location hereon will be furnished prior to the expiration of the period of publication of the application for patent.

ADJOINING CLAIMS.

N W Unsurveyed claim Frank Gill et al owners.
Crancer Lode, Survey No. 2299, owned by applicant herein.
Aztec Lode, Survey No. 820 Lot No. 76, Mrs. Susan Mills, owner.
Stallo & Moody Lode, Survey No. 2299, owned by applicant herein. *Sum. No. 819*
Pinal Lode, Lot No. 75, owned by Mrs. Susan Mills.

N E Amber and Satisfaction Lodes, Survey No. 2306, owned
by applicant herein.
S E Triangle and Tip Top Lodes, Survey No. 1656, owned by
C. E. Taylor,
Osceola Lode, unsurveyed, Globe Consolidated Copper
Company owner,
Darius Lode, unsurveyed, Old Dominion Copper Mining &
Smelting Company owner,
Copper King Lode, unsurveyed, Lyman C. Woods, et al,
owners,
S W Cañon Lode, unsurveyed, Globe Consolidated Copper
Company owner.

INSTRUMENT

This survey was made with a C. L. Berger & Sons No. 5194 Complete Mining Transit. The course were deflected from the true meridian, as determined by direct solar observation, checked by an observation on Polaris. The distances were measured with a 300 ft. steel tape. Magnetic variation $13^{\circ} 15'$ E at all corners.

Robert R. Boyd
U. S. Deputy Mineral Surveyor.

Dated: Globe, Gila Co., Arizona,
31st October, 1906.

I beg to report the following courses and distances of Survey No. 820 Lot No. 76 in error:
2-3 S $41^{\circ} 22'$ W 1493.0 ft.
3-4 N $66^{\circ} 14'$ W 572.5 ft. R. R. B.,

LOCATION.

These claims are located in Sec. 13, 14, 23 & 24, T. 1 N., R. 15 E., G. & S.R.B. & M., in the Globe Mining Dist. Gila County, Arizona, about two and a half miles in a Northeasterly direction from the town of Globe.

FINAL OATHS FOR SURVEYS.

LIST OF NAMES.

A list of the names of the individuals employed by Robert R. Boyd

United States Deputy Mineral Surveyor, to assist in running, measuring, and marking the lines, corners, and boundaries described in the foregoing field notes of the survey of the mining claim of.....

Globe-Boston Copper Mining Co.

known as the Populist, Cottonwood, I.T.L., American Boy, Belle

and showing the respective capacities in which they acted.

D.E. Curry....., Chainman.

E.E. Barker....., Chainman.

....., Axman.

....., Flagman.

FINAL OATHS OF ASSISTANTS.

We, D.E. Curry.

and E.E. Barker....., do solemnly swear that we assisted Robert

R. Boyd....., United States Deputy Mineral Surveyor, in marking the corners and surveying

the boundaries of the mining claim of Globe-Boston Copper Mining Co

known as the Populist Cottonwood, I.T.L. American Boy, Belle

represented in the foregoing field notes as having been surveyed by said deputy mineral surveyor and under his

direction; and that said survey has been in all respects, to the best of our knowledge and belief, faithfully and

correctly executed, and the corner and boundary monuments established according to law and the instructions

furnished by the United States Surveyor-General for Arizona

D.E. Curry....., Chainman.

E.E. Barker....., Chainman.

....., Axman.

....., Flagman.

Subscribed and sworn to by the above-named persons before me this 30th

day of October, 1906

My commission expires Jan. 13, 1910

G. F. Dodge,
Notary Public in and
for the County of Gila,
Territory of Arizona

(4-686.)

FINAL OATH OF U. S. DEPUTY MINERAL SURVEYOR

I, Robert R. Boyd, U. S. Deputy Mineral Surveyor, do solemnly swear that, in pursuance of instructions received from the United States Surveyor General for Arizona, dated August 18th, 1906, I have, in strict conformity to the laws of the United States, the official regulations and instructions thereunder, and the instructions of said Surveyor General, faithfully and correctly executed the survey of the Mining Claim of Globe Boston Copper Mining Co, known as the Populist Cottonwood, I. X. L. American Boy Belle, situate in Globe Mining District, Gila County, Arizona, in Section 13, 14, 23, 24; Township No. 7 N, Range No. 15 E G & S R B & M, and designated as Survey No. 2311, as represented in the foregoing field notes, which accurately show the boundaries of said mining claim as distinctly marked by monuments on the ground, and described in the attached copy of the location certificate, which was received by me from the Surveyor General with said instructions, and that all the corners of said survey have been established and perpetuated in strict accordance with the law, official regulations and instructions thereunder; and I do further solemnly swear that the foregoing are the true and original field notes of said survey and my report therein, and that the labor expended and improvements made upon said mining claim by claimant or its grantors are less than 500 \$ for each location, as therein fully stated. ~~are as therein fully stated~~, and that the character, extent, location and itemized value thereof are specified therein with particularity and full detail, and that no portion of said labor or improvements so credited to this claim has been included in the estimate of expenditures upon any other claim, and complete affidavit of 500 improvements for each location hereof, will be furnished prior to the expiration of the period of publication

Robert R. Boyd
U. S. Deputy Mineral Surveyor.

Subscribed and sworn to by the said Robert R. Boyd,
U. S. Deputy Mineral Surveyor, before me G. F. Dodge
Notary Public this 30th
day of October 1906.

N A R L

my commission
expired Jan. 13, 1910

• 6-154

G. F. Dodge
Notary Public in and
for the County of Gila
Territory of Arizona.

AMENDED

Notice of Mining Location

LODE CLAIM

To All Whom It May Concern:

This Mining Claim, the name of which is the Belle
Mining Claim, situate on lands belonging to the United States of America, and in which there are valuable mineral deposits, was entered upon and located for the purpose of exploration and purchase by Globe-Boston Copper Mining Co, successors to W. J. Mallory, a citizen of the United States
(Locator must insert either "a citizen of the United States," or, "who has declared his intention to become a citizen of the United States.")
the undersigned, on the 25th day of July 1906.

The length of this claim is Fifteen Hundred (1500) feet,
and We claim One Hundred and Fifty (150) feet,
in a South Westerly direction and Thirteen Hundred and Fifty (1350) feet in a North Easterly direction from the center of the discovery shaft, at which this notice is posted, lengthwise of the claim, together with Three Hundred (300.0) feet in width of the surface grounds, on each side of the center of said claim. The general course of the lode deposit and premises is from the North East to the South West.

The claim is situated and located in the Globe Mining District, in Gila County, in the Territory of Arizona, about 600 feet in a North Easterly direction from the I. X. L Shaft

The surface boundaries of the claim are marked upon the ground as follows: Beginning at

a monument of stones
at a point in a South Westerly direction 150.0 feet from the discovery shaft (at which this notice is posted,) being in the center of the South West end line of said claim; thence North Westerly 300 feet to a monument of stones, being the North West corner of said claim; thence North Easterly 1500 feet to a monument of stones, being at the North East corner of said claim; thence South Easterly 300 feet to a monument of stones at the center of the North East end of said claim; thence South Easterly 300 feet to a monument of stones, being at the South East corner of said claim; thence South Westerly 1500 feet to a monument of stones at the South West corner of said claim; thence North Westerly 300 feet to the place of beginning.

All done under the provisions of Chapter Six, of Title XXXII, of the Revised Statutes of the United States, and of an Act of the General Assembly of Arizona, entitled "An Act to Revise and Codify the Laws of the Territory of Arizona," approved March 16, 1901.

This is an Amended Location Notice of the Belle
Mining Claim, located by W. J. Mallory
on the 25th day of February 1890, and recorded in Book 3 of Records of Mines, at page 47 in the office of the County Recorder of the aforesaid County of Gila to which reference is hereby made, and this amended Location Notice is made and posted to correct errors in the description in the said original Location Notice.

Dated and posted on the ground this 25 day of July 1906

Globe-Boston Copper Mining Company
By George Stoneman
attorney

TERRITORY OF ARIZONA, }
 County of..... } ss.

I....., County Recorder in and for the County and Territory aforesaid, do hereby certify that the within instrument was filed for record at.....o'clock,.....M., on this.....day of.....190..., and duly recorded in Book No..... of.....Records of.....County, Arizona, at pages.....

WITNESS my hand and official seal the day and year first above written.

.....
 County Recorder.

No. 2311

AMENDED
Notice of Location.
 LODE CLAIM.

Dated.....190.....

Filed and Recorded at Request of.....

.....
 A. D. 190.....

at.....M.

Book.....

Pages.....

.....
 County Recorder.

By.....
 Deputy Recorder.

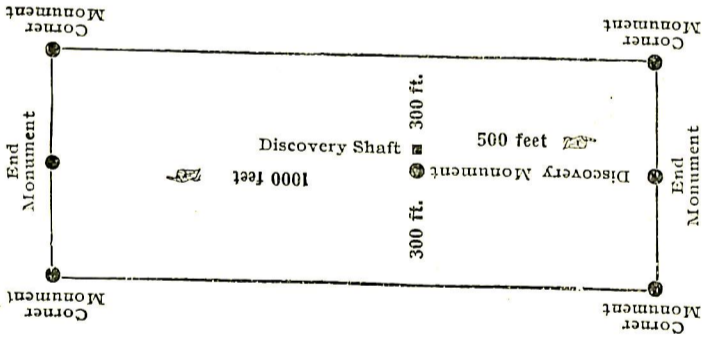

This diagram is to give locator a general idea of plan of location under the new law. The Discovery Shaft can be in the center of claim or any distance from either end desired. In the diagram it is placed 500 feet from one end and 1000 feet from the other. Commence description of claim at a center end monument, giving its distance and direction from center of Discovery Shaft; thence bound the claim in either direction. In description be careful to state locality of claim with reference to some natural object, or permanent monument, as will identify the claim.

Belle

[Faint purple ink stamp and handwritten notes]

E. W. Armstrong
 25 July 1903

367
 of Mines

Richard Fleming
 Deputy Recorder

Reviewed Compared

E. W. Armstrong

AMENDED

Notice of Mining Location

LODE CLAIM

To All Whom It May Concern:

This Mining Claim, the name of which is the American Boy Mining Claim, situate on lands belonging to the United States of America, and in which there are valuable mineral deposits, was entered upon and located for the purpose of exploration and purchase by Globe-Boston Copper Mining Co.

(Locator must insert either "a citizen of the United States," or, "who has declared his intention to become a citizen of the United States.")

the undersigned, on the 24th day of July 1906

The length of this claim is 1500.0 feet,

and WE claim 650.0 feet,

in a South Westerly direction and 850.0

feet in a North Easterly direction from

the center of the discovery shaft, at which this notice is posted, lengthwise of the claim, together

with 300.0 feet in width of the surface grounds, on each

side of the center of said claim. The general course of the lode deposit and premises is from the

North East to the South West

The claim is situated and located in the Globe Mining District, in

Gila County, in the Territory of Arizona, about 1000.0 feet

in a North easterly direction from the I. X. L. Shaft.

The surface boundaries of the claim are marked upon the ground as follows: Beginning at

A pine post

at a point in a South westerly direction 650.0 feet from

the discovery shaft (at which this notice is posted,) being in the center of the South West

end line of said claim; thence North westerly 300.0 feet to a pine post

, being the North West corner of said claim; thence

North easterly 1500.0 feet to a pine post, being at the

North East corner of said claim; thence South easterly 300.0 feet

to a pine post at the center of the North East end of said claim;

thence South easterly 300.0 feet to a pine post, being at the

South East corner of said claim; thence South westerly 1500.0

feet to a pine post at the South West corner of said claim;

thence North westerly 300.0 feet to the place of beginning.

All done under the provisions of Chapter Six, of Title XXXII, of the Revised Statutes of

the United States, and of an Act of the General Assembly of Arizona, entitled "An Act to Revise

and Codify the Laws of the Territory of Arizona," approved March 16, 1901.

This is an Amended Location Notice of the American Boy

Mining Claim, located by W. J. Mallory

on the 5th day of

June 1891, and recorded in Book 3 of Records of Mines, at

page 512, in the office of the County Recorder of the aforesaid County of Gila

to which reference is hereby made, and this amended Location Notice is made and posted to

correct errors in the description in the said original Location Notice.

Dated and posted on the ground this 24th day of July 1906

and to take in the ground embraced by the American Boy mining location

Globe-Boston Copper Mining Co.

By

George J. Starnes

Attorney

TERRITORY OF ARIZONA, }
 County of..... } ss.

I,....., County Recorder in and for the County and Territory aforesaid, do hereby certify that the within instrument was filed for record at.....o'clock,.....M., on this.....day of.....190..., and duly recorded in Book No..... of.....Records of.....County, Arizona, at pages.....

WITNESS my hand and official seal the day and year first above written.

.....
 County Recorder.

AMENDED
Notice of Location.
 LODE CLAIM.

Dated.....190.....

Filed and Recorded at Request of

.....
 A. D. 190.....

at.....M.

Book.....

Pages.....

County Recorder.

By.....
 Deputy Recorder.

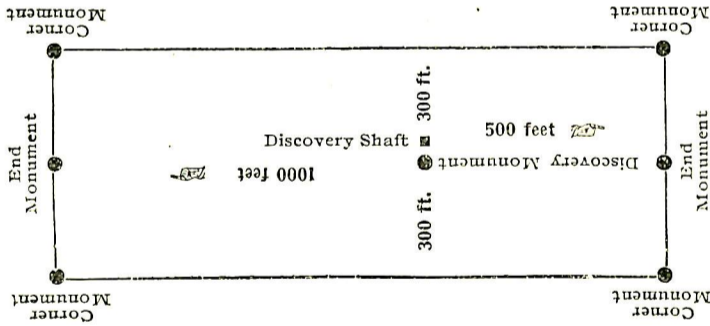

This diagram is to give locator a general idea of plan of location under the new law. The Discovery Shaft can be in the center of claim or any distance from either end desired. In the diagram it is placed 500 feet from one end and 1000 feet from the other. Commence description of claim at a center end monument, giving its distance and direction from center of Discovery Shaft; thence bound the claim in either direction. In description be careful to state locality of claim with reference to some natural object, or permanent monument, as will identify the claim.

American Boy

TERRITORY OF ARIZONA } ss.
 County of Gila.

I, E. M. Armstrong, Recorder of Gila County, do hereby certify that the within instrument was filed for record at.....

.....
 E. M. Armstrong
 Recorder

at.....
 July 15-190...

Book No. 364
 Page 8
 Records

By.....
 County Recorder.

By Richard Fleming
 Deputy Recorder

Indexed
 Compared

AMENDED

Notice of Mining Location

LODE CLAIM

To All Whom It May Concern:

This Mining Claim, the name of which is the I. X. L. Mining Claim, situate on lands belonging to the United States of America, and in which there are valuable mineral deposits, was entered upon and located for the purpose of exploration and purchase by Globe-Boston Copper Mining Company

(Locator must insert either "a citizen of the United States," or, "who has declared his intention to become a citizen of the United States.") the undersigned, on the 25 day of July 1906

The length of this claim is 1500.0 feet, and WE claim 450.0 feet, in a northeasterly direction and 1050.0 feet in a southwesterly direction from the center of the discovery shaft, at which this notice is posted, lengthwise of the claim, together with 300.0 feet in width of the surface grounds, on each side of the center of said claim.

The general course of the lode deposit and premises is from the northeast to the southwest

The claim is situated and located in the Globe Mining District, in Gila County, in the Territory of Arizona, about 1/4 miles in a northerly direction from The Old Dominion Smelter

The surface boundaries of the claim are marked upon the ground as follows: Beginning at a pine post

at a point in a northeasterly direction 450.0 feet from the discovery shaft (at which this notice is posted,) being in the center of the northeast end line of said claim; thence southeasterly 300 feet to a pine post, being the southeast corner of said claim; thence southwesterly 1500. feet to a pine post, being at the southwest corner of said claim; thence northwesterly 300 feet to a pine post at the center of the southwest end of said claim; thence northwesterly 300 feet to a pine post, being at the northwest corner of said claim; thence northeasterly 1500.0 feet to a pine post at the northeast corner of said claim; thence southeasterly 300.0 feet to the place of beginning.

All done under the provisions of Chapter Six, of Title XXXII, of the Revised Statutes of the United States, and of an Act of the General Assembly of ARIZONA, entitled "An Act to Revise and Codify the Laws of the Territory of Arizona," approved March 16, 1901.

This is an Amended Location Notice of the I. X. L. Mining Claim, located by George Bird

on the 8th day of October 1880, and recorded in Book 7 of Records of Mines, at page 149, in the office of the County Recorder of the aforesaid County of Gila to which reference is hereby made, and this amended Location Notice is made and posted to correct errors in the description in the said original Location Notice.

Dated and posted on the ground this 25 day of July 1906

Globe-Boston Copper Mining Co. By George Storeman atty.

TERRITORY OF ARIZONA,

County of..... } ss.

I,....., County Recorder in and for the County and Territory aforesaid, do hereby certify that the within instrument was filed for record at.....o'clock,.....M., on this.....day of.....190..., and duly recorded in Book No..... of.....Records of.....County, Arizona, at pages.....

WITNESS my hand and official seal the day and year first above written.

..... County Recorder.

AMENDED
Notice of Location.
LODE CLAIM.

Dated.....190.....

Filed and Recorded at Request of

.....A. D. 190.....

at.....M.

Book.....

Pages.....

..... County Recorder.

By..... Deputy Recorder.

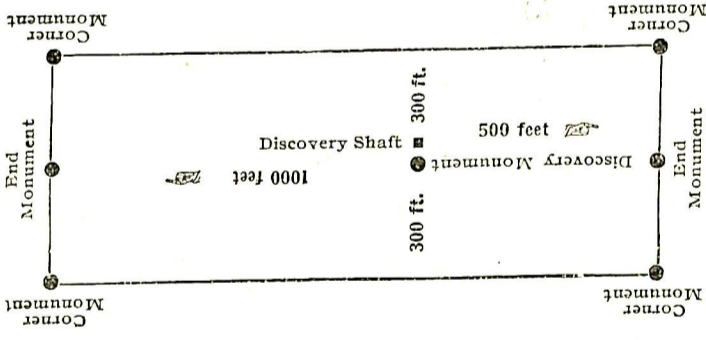

This diagram is to give locator a general idea of plan of location under the new law. The Discovery Shaft can be in the center of claim or any distance from either end desired. In the diagram it is placed 500 feet from one end and 1000 feet from the other. Commence description of claim at a center end monument, giving its distance and direction from center of Discovery Shaft; thence bound the claim in either direction. In description be careful to state locality of claim with reference to some natural object, or permanent monument, as will identify the claim.

1. X. L.

.....
 County of..... } ss.
 Filed for record in County of
 Liberty, Arizona, on the 25th day of
 July, 1906, at the office of the
 County Recorder, in and for the
 County of Liberty, Arizona Territory.
 E. M. Armstrong
 July 25, 1906
 366
 of mine
 W. D. Fish
 County Recorder

By Richard Fleming
 Deputy Recorder

Amended Notice of Mining Location, of
AMENDED

Notice of Mining Location

LODE CLAIM

To All Whom It May Concern:

This Mining Claim, the name of which is the Cottonwood
Mining Claim, situate on lands belonging to the United States of America, and in which there
are valuable mineral deposits, was entered upon and located for the purpose of exploration and
purchase by Globe-Boston Copper Mining Co., successor to
W. J. Mallory, a citizen of the United States
(Locator must insert either "a citizen of the United States," or "who has declared his intention to become a citizen of the United States.")
the undersigned, on the 25th day of July 1906.

The length of this claim is Fifteen Hundred (1500) feet,
and we claim One Thousand (1000) feet,
in a South Westerly direction and Five Hundred
(500) feet in a North Easterly direction from
the center of the discovery shaft, at which this notice is posted, lengthwise of the claim, together
with Three Hundred (300) feet in width of the surface grounds, on each
side of the center of said claim. The general course of the lode deposit and premises is from the
North East to the South West

The claim is situated and located in the Globe Mining District, in
Gila County, in the Territory of Arizona, about 700 feet
in a South Westerly direction from the I. X. L. Shaft

The surface boundaries of the claim are marked upon the ground as follows: Beginning at
A monument of stone

at a point in a North Easterly direction about 500 feet from
the discovery shaft (at which this notice is posted,) being in the center of the North East
end line of said claim; thence South Easterly 300 feet to a pine post 4 feet
long 4 inches square, being the South East corner of said claim; thence
South Westerly 1500 feet to a monument of stone, being at the
South West corner of said claim; thence North Westerly 300 feet
to a monument of stone at the center of the South West end of said claim;
thence North Westerly 300 feet to a monument of stone being at the
North West corner of said claim; thence North Easterly 1500
feet to a Pine Post 4" x 4" at the North East corner of said claim;
thence South Easterly 300 feet to the place of beginning.

All done under the provisions of Chapter Six, of Title XXXII, of the Revised Statutes of
the United States, and of an Act of the General Assembly of Arizona, entitled "An Act to Revise
and Codify the Laws of the Territory of Arizona," approved March 16, 1901.

This is an Amended Location Notice of the amended location notice of the Cottonwood
Mining Claim, located by Globe Boston Copper Mining Company,
George Storeman, atty. on the 7th day of
April 1906, and recorded in Book 8 of Records of Mines, at
page 355, in the office of the County Recorder of the aforesaid County of Gila
to which reference is hereby made, and this amended Location Notice of the amended location notice
corrects errors in the description in the said original Location Notice.

Dated and posted on the ground this 25th day of July 1906.

Globe-Boston Copper Mining
Company, By George Storeman, atty.

I,....., County Recorder in and for the County and Territory aforesaid, do hereby certify that the within instrument was filed for record at.....o'clock,.....M., on this.....day of.....190., and duly recorded in Book No..... of.....Records of.....County, Arizona, at pages.....

WITNESS my hand and official seal the day and year first above written.

.....
 County Recorder.

AMENDED
Notice of Location.
 LODGE CLAIM.

Dated.....190.....

Filed and Recorded at Request of

.....
 A. D. 190.....

at.....M.

Book.....

Pages.....

.....
 County Recorder.

By.....
 Deputy Recorder.

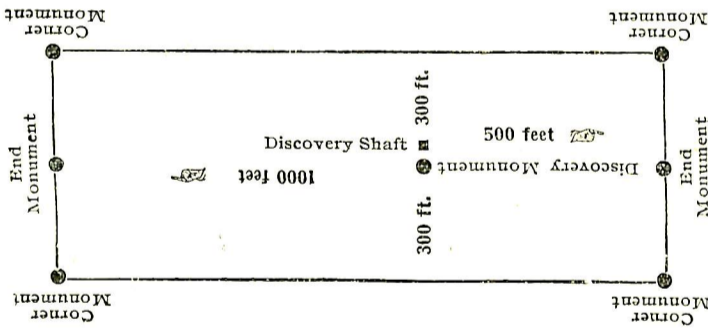

This diagram is to give locator a general idea of plan of location under the new law. The Discovery Shaft can be in the center of claim or any distance from either end desired. In the diagram it is placed 500 feet from one end and 1000 feet from the other. Commence description of claim at a center end monument, giving its distance and direction from center of Discovery Shaft; thence bound the claim in either direction. In description be careful to state locality of claim with reference to some natural object, or permanent monument, as will identify the claim.

Cottonwood

W. D. Fisk
 Recorder
 July 25
 366
 8
 Records
 of
 Mores
 W. D. Fisk
 Deputy Recorder
 Compared
 By Richard Fleming
 Deputy Recorder
 300

AMENDED
Notice of Mining Location
LODE CLAIM

To All Whom It May Concern:

This Mining Claim, the name of which is the Populist Mining Claim, situate on lands belonging to the United States of America, and in which there are valuable mineral deposits, was entered upon and located for the purpose of exploration and purchase by Globe-Boston Copper Mining Company

(Locator must insert either "a citizen of the United States," or, "who has declared his intention to become a citizen of the United States.")
the undersigned, on the 25 day of July 1906

The length of this claim is 1500.0 feet, and WE claim 10.0 feet, in a north easterly direction and 1490.0 feet in a South westerly direction from the center of the discovery shaft, at which this notice is posted, lengthwise of the claim, together with 300.0 feet in width of the surface grounds, on each side of the center of said claim. The general course of the lode deposit and premises is from the

north east to the south west

The claim is situated and located in the Globe Mining District, in Gila County, in the Territory of Arizona, about 1000.0 feet in a westerly direction from the I. X. L. Shaft.

The surface boundaries of the claim are marked upon the ground as follows: Beginning at a monument of stone

at a point in a north easterly direction 10. feet from the discovery shaft (at which this notice is posted,) being in the center of the north east end line of said claim; thence south easterly 300.0 feet to a pine post, being the southeast corner of said claim; thence south westerly 1500. feet to a pine post, being at the south west corner of said claim; thence north westerly 300.0 feet to a pine post at the center of the south west end of said claim; thence north westerly 300.0 feet to a pine post, being at the north west corner of said claim; thence north easterly 1500. feet to a pine post at the north east corner of said claim; thence southeasterly 300.0 feet to the place of beginning.

All done under the provisions of Chapter Six, of Title XXXII, of the Revised Statutes of the United States, and of an Act of the General Assembly of Arizona, entitled "An Act to Revise and Codify the Laws of the Territory of Arizona," approved March 16, 1901.

This is an Amended Location Notice of the Populist Mining Claim, located by W. J. Mallory on the 1st day of January ¹⁸⁹⁵~~190~~, and recorded in Book 4 of Records of Mines, at page 372 in the office of the County Recorder of the aforesaid County of Gila to which reference is hereby made, and this amended Location Notice is made and posted to correct errors in the description in the said original Location Notice.

Dated and posted on the ground this 25 day of July 1906
Globe-Boston Copper Mining Co.
By George Sturman
att'y.

TERRITORY OF ARIZONA, }
County of..... } ss.

I,....., County Recorder in and for the County and Territory aforesaid, do hereby certify that the within instrument was filed for record at.....o'clock,.....M., on this.....day of.....190..., and duly recorded in Book No..... of.....Records of.....County, Arizona, at pages.....

WITNESS my hand and official seal the day and year first above written.

.....
County Recorder.

AMENDED
Notice of Location.
LODE CLAIM.

Dated.....190.....

Filed and Recorded at Request of

.....
A. D. 190.....

at.....M.

Book.....

Pages.....

.....
County Recorder.

By.....
Deputy Recorder.

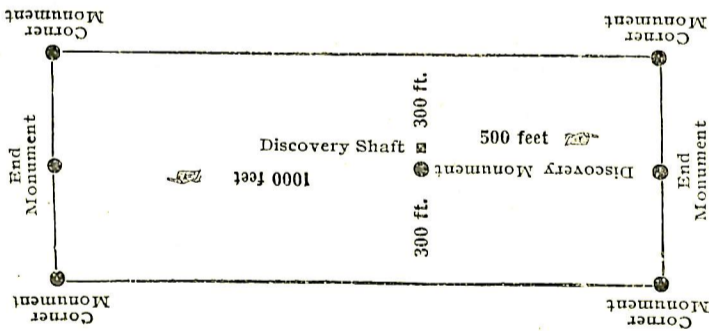

This diagram is to give locator a general idea of plan of location under the new law. The Discovery Shaft can be in the center of claim or any distance from either end desired. In the diagram it is placed 500 feet from one end and 1000 feet from the other. Commence description of claim at a center end monument, giving its distance and direction from center of Discovery Shaft; thence bound the claim in either direction. In description be careful to state locality of claim with reference to some natural object, or permanent monument, as will identify the claim.

AM Richard Deputy Recorder

Checked
Indexed

367
of mine
Chas. County, Arizona Territory
M. S. Ford

E. M. Armistead

1907
1908
1909
1910
1911
1912
1913
1914
1915
1916
1917
1918
1919
1920
1921
1922
1923
1924
1925
1926
1927
1928
1929
1930
1931
1932
1933
1934
1935
1936
1937
1938
1939
1940
1941
1942
1943
1944
1945
1946
1947
1948
1949
1950

✓
Copies

U. S. SURVEYOR-GENERAL'S FINAL CERTIFICATE ON FIELD NOTES.

Department of the Interior,

OFFICE OF U. S. SURVEYOR-GENERAL,

Phoenix, Arizona

December 22, 1906

I, U. S. Surveyor-General for District of Arizona

do hereby certify that the foregoing transcript of the Field Notes, return and approval of the survey of the mining claim of

GLOBE-BOSTON COPPER MINING COMPANY

known as the Populist, Cottonwood, I.X.L., American Boy, Belle

situate in GLOBE

Mining District, Gila County, Arizona

in Section 13, 14, 23, 24 Township No. 1 N., Range No. 15 E. G. & S. R. B. & M. and

designated as Survey No. 2311, has been correctly copied from the originals on file in

this office; that said Field Notes furnish such an accurate description of said mining claim as will, if incorporated into a patent, serve fully to identify the premises, and that such reference is made therein to natural objects or permanent monuments as will perpetuate and fix the locus thereof.

And I further certify that less than five hundred dollars' worth of labor has been expended or improvements made upon said mining claim by claimant or its grantors, and that said improvements consist of at time of survey, Belle, 1 Dis. shaft, valued at \$200.00; American Boy, 1 Dis. shaft, valued at \$260.00; I. X. L., 1 Dis. open cut, valued at \$50.00; Cottonwood, 1 Dis. open cut, valued at \$50.00; Populist, 1 Dis. shaft, valued at \$125.00, total value of improvements on group \$685.00

and that no portion of said labor or improvements has been included in the estimate of expenditures upon any other claim.

I further certify that the plat thereof, filed in the U. S. Land Office at Phoenix, Arizona

is correct and in conformity with the foregoing Field Notes.

Frank S. Ingalls

United States Surveyor-General for Arizona

4-687.

SURVEYOR-GENERAL'S CERTIFICATE OF APPROVAL OF FIELD
NOTES AND SURVEY OF MINING CLAIM.

Department of the Interior,

Office of U. S. Surveyor-General,

Phoenix, Arizona

December 22, 1906.

I, U. S. Surveyor-General for..... District of Arizona

do hereby certify that the foregoing and hereto attached Field Notes and Return of the Survey of the
Mining Claim of.....

GLOBE-BOSTON COPPER MINING COMPANY

....., known as the

Populist, Cottonwood, I.X.L., American Boy, Belle

situate in..... GLOBE..... Mining District,

GILA

County,

ARIZONA

in Section 13, 14, 23, 24, Township No. 1 N., Range No. 15 E. G. & S. E. B. & M.

....., designated as Survey No. 2311

executed by Robert R. Boyd, U. S. Deputy Mineral

Surveyor, Sept. 5 - Oct. 5, 1906, under my instructions dated

Aug. 18, 1906, have been critically examined and the necessary cor-

rections and explanations made, and the said Field Notes and Return, and the Survey they describe,

are hereby approved. A true copy of the copy of the location certificate filed by the applicant for

survey is included in the field notes.

Frank A. Sgall

U. S. Surveyor-General for Arizona

SURVEY NO. 2311.
IMPROVEMENTS.

I hereby certify that on May 10, 1907, which was before the expiration of the sixty day period of publication of notice of application for patent, the value of the labor and improvements on the group of claims included in this survey, placed thereon by the claimant or its grantors, was not less than five hundred dollars for each location, and that on said date said improvements consisted of the following:

I. X. L.

No. 1. Dis. open cut, 4 x 10 x 18 ft., course of cut in a northwesterly direction at right angles to vein. Center of mouth of open cut bears from N.E.E.C. of location on vein, S. 41° 30' W. 453.0 ft., Value, \$ 50.00

From the center of the face of the open cut a tunnel extends N. 31° 40' W. 58.0 ft. to Station 1, thence N. 33° 25' W., 62.7 ft. to Station 2, thence N. 51° 30' W. 28.2 ft. to Station 3, thence N. 75° W. 34.6 ft. to Station 4, thence N. 66° 10' W. 22.5 ft. to Station 5, thence N. 32° W. 33.6 ft. to Station 6; thence N. 14.0 ft. to Station 7, thence N. 40° W. 11.5 ft. to face. From station 1 a drift runs N. 40° 30' E. 46.5 ft. to face; a second drift runs S. 41° W. 17.0 ft. to face. From Station 3 a drift runs N. 10° 20' E. 15.0 ft., thence N. 58° E. 22.0 ft. to face. From Station 3 a drift runs N. 89° W. 34.6 ft. to face. Total length of tunnels and drifts 401.2 ft., Value, \$2800.00

No. 2. Open cut 4 x 12 x 12 ft. leading to a tunnel, 4 x 6 x 12 ft., extending in a N. 10° W. direction, with a 4 x 6 winze 20 ft. deep at the end of tunnel. Center of mouth of open cut bears from Cor.No.4, S. 75° 40' W. 332.0 ft., Value, \$ 375.00

No. 3. Shaft 4 x 8 x 20 ft. deep, the N.E. Cor. of which bears from Cor.No.4, S. 76° 55' W., 382.0 ft., Value, \$ 200.00

No. 4. Shaft 4 x 7 x 30 ft. deep, the N.E. Cor. of which bears from Cor.No.4, N. 89° W. 461.0 ft., Value, \$ 350.00

No. 5. Tunnel 4 x 6 x 32 ft. in length, bearing in a N. 70° W. direction, the center of the mouth of which bears from Cor.No.3 S. 38° W. 521.0 ft., Value, \$ 180.00

No. 6. Main working shaft for group, consisting of two 5 x 5 ft. compartments, the N.E. Cor. of which bears from Cor. No.3, S. 20° 03' W. 672.0 ft. Total depth of shaft 570.0 ft. to bottom of the pump, fully timbered. Value at \$40. per foot, \$22,800.00

At a depth of 125 ft. from the collar of shaft a level is run with 475 ft. of laterals. At 200 ft. a level is run with 510 ft. of laterals. At 460 ft. a level is run with 1100 ft. of laterals. From this level a winze is sunk to a depth of 100 ft. with 40 ft. of drifting at the bottom. Total value of drifts at \$10. per ft. \$21,250.00
Total value of winze at \$20. per ft., 2,000.00
Total value of workings (No.6), 46,050.00

The shaft was sunk and its laterals were run for the purpose of developing all the claims in this group, and also a contiguous group composed of the Stallo & Moody, Red Cloud and Crancer claims which belong to the claimant herein. It has been proved that valuable deposits of copper ore are to be found only at great depth, and that the most economical method of reaching those deposits is to sink a shaft to a depth of several hundred feet and to run drifts and workings from the shaft. That plan has been followed in the case of this shaft. The shaft and its various workings tend to develop and explore all the ground included in the eight claims. A body of ore has been opened up in the I. X. L. claim. I am informed that the present plan of development includes sinking the shaft to a depth of at least 1000 ft. The laterals now run will be extended and the laterals will be run from the 250-ft. level and the 1000-ft. level. These operations will more thoroughly develop all the eight claims. I have allotted the value of the shaft and its workings as follows:

I. X. L. claim,	1/8 interest,
Populist claim,	1/8 interest,
Cottonwood claim,	1/8 interest,
American Boy claim,	1/8 interest,
Pelle claim,	1/8 interest,
Stallo & Moody claim,	1/8 interest,
Red Cloud claim,	1/8 interest,
Crancer claim,	1/8 interest,

1/8 interest in main shaft and laterals,	\$5756.00
Total value improvements on and for I.X.L. claim,	9711.00

POPULIST.

No.1. Dis. shaft 4 x 7 x 11 ft. deep in solid formation, extremely hard, center of northeast side of which bears from the N. E. E. C. of location S. 54° 38' W. 10 ft.	Value,	\$ 125.00
No.2. Shaft 5 x 6 x 10 ft. deep, center of which bears from Cor. No.4 S. 61° 55' E. 180.9 ft. Formation extremely hard,	Value,	\$ 100.00
1/8 interest in I.X.L. shaft,	\$5756.00	
Total value of improvements on and for Populist lode,	\$5981.00	

COTTONWOOD.

No.1. Dis. open cut 4 x 10 x 18 ft., center of face of which bears along the ledge from N.E.E.C. of location S. 50° 19' W. 520 ft.,	Value,	\$ 50.00
No.2. Open cut 5 x 14 x 18 ft. leading to a tunnel 5 x 7 x 20 ft., extending in a S. 30° E. direction, center of mouth of which bears from Cor.No.1 S. 64° 40' W. 507 ft.	Value,	\$ 125.00
1/8 interest in I.X.L. shaft,	\$5756.00	
Total value of improvements on and for Cottonwood lode,	\$5931.00	

AMERICAN BOY.

No.1.	Dis. shaft 4 x 7 x 26 ft. deep on ledge, the N.W. Cor. of which bears from the S.W.E.C. of location N. 53° 3' E. 638 ft.	
	Value,	\$ 260.00
No.2.	Shaft 5 x 6 x 50 ft. deep, the center of which bears from Cor.No.4 N. 11° 10' E. 609 ft.,	
	Value,	\$ 500.00
	1/8 interest in I. X. L. shaft,	\$5756.00
	Total value improvements on and for American Boy lode,	\$6516.00

BELLE.

No.1.	Dis. shaft 4 x 6 x 22 ft. deep, the S.W. Cor. of which bears from the S.W.E.C. of location on ledge N. 53° 3' E. 246 ft.,	
	Value,	\$ 200.00
No.2.	Shaft 4 x 6 x 45 ft. deep, the N.W. Cor. of which bears from the S.W.E.C. of location N. 36° 10' E. 121 ft.,	
	Value,	\$ 450.00
	1/8 interest in I. X. L. shaft,	\$5756.00
	Total value of improvements on and for Belle lode,	\$6406.00

Robert R. Boyd
 U. S. Deputy Mineral Surveyor

Dated at Globe, Arizona, July 30, 1907.

Affidavit of Five Hundred Dollars Improvements.

We, E. H. Armstrong and E. E. Barker

of lawful age, being first duly sworn according to law, depose and say: That we are acquainted with the S. X. L., Populist, Cottonwood American Boy, Belle mining claim, situate in Globe

mining district, Gila County, Arizona Territory, for which Globe-Boston Copper Mining Co

has ~~made~~ application for survey prior to application for patent under the provisions of the Act of Congress approved May 10, 1872; and that the labor done and improvements made thereon by the applicant—and its grantors ~~exceed~~ exceed five hundred dollars in value, and further that we are not personally interested in said mine.

E. H. Armstrong
E. E. Barker

TERRITORY OF ARIZONA,
COUNTY OF Gila } ss:

Sworn to and subscribed before me this 31st day

[SEAL.]

of July, 1907

J. Weinberger
Notary Public

My commission expires
March 26 - 1910

U. S. SURVEYOR GENERAL'S FINAL CERTIFICATE ON FIELD NOTES.

---oOo---

DEPARTMENT OF THE INTERIOR

Office of U. S. Surveyor General,

Phoenix, Arizona,

September 10, 1907.

I, U. S. Surveyor-General for District of Arizona do hereby certify that the foregoing transcript of the Field Notes, return and approval of the survey of the mining claim of Globe-Boston Copper Mining Company, known as the Populist, Cottonwood, I.X.L., American Boy, Belle situate in Globe Mining District, Gila County, Arizona, in Sections 13, 14, 23, 24, Township No. 1 N., Range No. 15 E., G. & S.R.B. & K., and designated as Survey No. 2311, has been correctly copied from the originals on file in this office; that said Field Notes furnish such an accurate description of said mining claim as will, if incorporated into a patent, serve fully to identify the premises, and that such reference is made therein to natural objects or permanent monuments as will perpetuate and fix the locus thereof.

And I further certify that five hundred dollars' worth of labor has been expended or improvements made upon or for the benefit of the Populist, Cottonwood, I.X.L., American Boy and Belle lodes, and that the main working shaft designated as Shaft No. 6 on the I.X.L. claim is a common improvement made for the development of all the claims of this survey and the three claims of Survey No. 2299, and a $1/8$ interest therein is properly credited to each claim of these two surveys and that no portion of

said labor or improvements has been included in the estimate of expenditures upon any other claim. A copy of the report of Robert R. Boyd, U. S. Deputy Mineral Surveyor, dated July 30, 1907, is hereto attached.

I further certify that the plat thereof, filed in the U. S. Land Office at Phoenix, Arizona, is correct and in conformity with the foregoing Field Notes.

Frank S. Ingalls
U. S. Surveyor General for Arizona.

SURVEY NO. 2311
IMPROVEMENTS

I certify that the value of the labor and improvements on this group, placed thereon by the claimant or its

grantors, is not less than \$500 for each location, and said improvements consist of the following:

I.X.L.

- No. 1 Discovery Open Cut 4 x 10 x 18 ft, course of Cut in a northwesterly direction at right angles to vein. Center of mouth of Open Cut bears from N E E C of location on vein S 41° 30' W 453.0 ft.
Value \$50 00
- From the center of the face of the Open Cut, a Tunnel extends N 31° 40' W 58.0 ft to Station 1, thence N 33° 25' W 62.7 ft to Station 2, thence N 51° 30' W 28.2 ft to Station 3, thence N 75° W 34.6 ft to Station 4, thence N 66° 10' W 22.5 ft to Station 5, thence N 32° W 33.6 ft to Station 6, thence N 14.0 ft to Station 7, thence N 40° W 11.5 ft to face. From Station 1, a Drift runs N 40° 30' E 46.5 ft to face; a second Drift runs S 41° W 17.0 ft to face. From Station 3, a Drift runs N 10° 20' E 15.0 ft, thence N 58° E 22.0 ft to face. From Station 3, a Drift runs N 89° W 34.6 ft to face. Total length of Tunnels and Drifts 401.2 ft.
Value 2800 00
- No. 2 Open Cut 4 x 12 x 12 ft, leading to a Tunnel 4 x 6 x 13 ft, extending in a N 10° W direction, with a 4 x 6 Winze 20 ft deep at the end of the Tunnel. Center of mouth of Open Cut bears from cor No 4 S 75° 40' W 332.0 ft.
Value 375 00
- No. 3 Shaft 4 x 8 x 20 ft deep, the N E cor of which bears from cor No 4 S 76° 55' W 332.0 ft.
Value 200 00
- No. 4 Shaft 5 x 7 x 30 ft deep, the N E cor of which bears from cor No 4 N 89° W 461.0 ft.
Value 350 00
- No. 5 Tunnel 4 x 6 x 32 ft in length, bearing in a N 70° W direction, the center of the mouth of which bears from cor No. 3 S 28° W 521.0 ft.
Value 180 00
- No. 6 Main Working Shaft for Group, consisting of two 5 ft x 5 ft compartments, the N E cor of which bears from cor No 3 S 20° 03' W 672.0 ft. Total depth of shaft 470.0 ft to the bottom of the sump, fully timbered. Value at \$40. per foot 18800 00
- At a depth of 125 ft from the collar of shaft, a level is run with 475 ft of laterals. At 200 ft, a level is run with 880 ft of laterals. At 460 ft, a level is run with 1200 ft of laterals. From this level, a winze is sunk to a depth of 100 ft with 40 ft of drifting at the bottom.
Total value of Drifts at \$10. per foot 25950 00
- Value of Winze at \$20. per foot 2000 00
Total Value of Workings (No. 6) \$46750 00
- This shaft was designed as a development shaft for exploring the following claims: Populist, Cottonwood, I. X. L., Aztec, American Boy, Belle, Crancer and Red Cloud, and work is now under progress by the present operating company, who also hold an option from Susan E. Mills on the Aztec Lode. The plans of the present company include the enlargement of the shaft for mining purposes in extracing the ore already opened up on the I.X.L Lode, the sinking of the shaft to a depth of at least 1000 ft, and the extension of the laterals to more thoroughly develop the surrounding claims. I am informed that it is the present plans of the management to extend the drift on the 200-ft

level, which is shown on the sketch as cutting the ledge on the Azrec Lode, on through the Crancer and into the Red Cloud lode, and also the west drift on the 460 ft level is to be further extended. In view of the fact that a copper deposit can be proven up only by deep exploration and the plans of the company embrace the exploration of adjacent ground from the main I X L shaft, I have allotted an interest in said shaft, winzes and laterals to the following claims in the proportion indicated:

Red Cloud Lode	1/8 interest	
Crancer Lode	1/8 "	
Populist Lode	1/8 "	
Cottonwood Lode	1/8 "	
American Boy Lode	1/8 "	
Belle Lode	1/8 "	
I X L Lode	1/8 "	
1/8 interest in Main Shaft and Laterals		5843.50
Total value of improvements on and for the I.X.L. Claim		<u>9798 50</u>

POPULIST

No. 1	Discovery Shaft 4 x 7 x 11 ft deep, in solid formation extremely hard, center of the N E side of which bears from the N E E C of location S 54° 38' W 10.0 ft.	Value	125 00
No. 2	Shaft 5 x 6 x 10 ft deep, center of which bears from cor No 4 S 61° 55' E 180.9 ft. Formation extremely hard.	Value	100 00
	1/8 interest in I.X.L. shaft		<u>5843.50</u>
	Total value of improvements on and for the Populist Lode		6068 50

COTTONWOOD

No. 1	Discovery Open Cut 4 x 10 x 18 ft, center of face of which bears along the ledge from N E E C of location S 50° 19' W 520.0 ft.	Value	50 00
No. 2	Open Cut 5 x 14 x 18 ft, leading to a Tunnel 5 x 7 x 20 ft, extending in a S 30° E direction. <i>(Bears from cor No. 1 S 64° 40' W 507 ft. Center of mouth of which)</i>	Value	125 00
	1/8 interest in the I.X.L. shaft		<u>5843.50</u>
	Total value of improvements on and for the Cottonwood Lode		6018 50

AMERICAN BOY

No. 1	Discovery Shaft 4 x 7 x 26 ft deep, on ledge, the N W cor of which bears from the S W E C of location N 53° 03' E 638.0 ft.	Value	260 00
No. 2	Shaft 5 x 6 x 50 ft deep, the center of which bears from cor No 4 N 11° 10' E 609.0 ft.	Value	500 00
	1/8 interest in I.X.L. Shaft		<u>5843 50</u>
	Total value of improvements on and for the American Boy Lode		6603 50

BELLE

No. 1	Discovery Shaft 4 x 6 x 22 ft deep, the S W cor of which bears from the S W E C of location on ledge N 53° 03' E 246.0 ft.	Value	200 00
No. 2	Shaft 4 x 6 x 45 ft deep, the N W cor of which bears from the S W E C of location N 36° 10' E 121.0 ft.	Value	450 00
	1/8 interest in the I.X.L. shaft		<u>5843 50</u>
	Total value of improvements on and for the Belle Lode		6493 50

Robert R. Boyd
U. S. Deputy Mineral Surveyor

Alamo Basin Jan 3d 1907.

Affidavit of Five Hundred Dollars Improvements.

We, Edgar E. Barker, and K. H. Pearson

of lawful age, being first duly sworn according to law, depose and say: That we are acquainted with the 1 X L Populist Cottonwood Belle ^{American Boy} mining claim, situate in Globe Mining district, Gila County, Arizona Territory, for which Globe Boston Copper Mining Co.

have made application for survey prior to application for patent under the provisions of the act of Congress, approved May 10, 1872; and that the labor done and improvements made thereon by the applicant and its grantor exceed Five Hundred Dollars in value, and further that we are not personally interested in said mine.

Edgar E. Barker
K. H. Pearson

TERRITORY OF ARIZONA, }
County of GILA } ss:



Sworn to and subscribed before me, this 15th

day of January, 1907

My commission expires January 13th, 1910.

G. F. Dodge
Notary Public in and for the County of Gila, Territory of Arizona.

(4-691.)

Certificate of U. S. Surveyor General

AS TO

EXPENDITURES REPORTED AFTER RETURN OF SURVEY OF MINING CLAIM.

I, U. S. Surveyor General for District of Arizona.....
do hereby certify that Five Hundred Dollars' worth of labor has been expended or
improvements made by claimant or its.....grantors, ^{or for each of} upon ^{the} mining claims of
Globe-Boston Copper Mining Company.....
.....
known as the I. X. L., Populist, Cottonwood, American Boy, Belle ,
situate in Globe..... mining district,
.....
Gila County, Arizona.....
in Section....., Township No., Range No. ;
that said improvements consist of I. X. L., 2 Cuts, 3 tunnels, 2 shafts
and drifts, valued at \$3955.00 and Main Working Shaft, with
laterals and winze, valued at \$46750.00, 1/8 interest of this
working credited to this lode, valued at \$5843.50, total value
of improvements \$9798.50; POPULIST, 2 shafts valued at \$225.00,
1/8 interest in Main Working shaft and laterals I.X.L. lode,
\$5843.50, total value of improvements \$6068.50; COTTONWOOD, 2
cuts and 1 tunnel valued at \$175.00, 1/8 interest in Main Working
shaft and laterals I.X.L. lode, \$5843.50, total value of improve-
ments, \$6018.50; AMERICAN BOY, 2 shafts, valued at \$760.00 1/8
interest in Main Working shaft and laterals I.X. L. lode, \$5843.50
total value of improvements \$6603.50; Belle, 2 shafts, valued at
\$650.00 1/8 interest Main Working shaft and laterals of I. L. X.
lode, \$5843.50, total value of improvements \$6493.50-----

....., and that no portion of said labor or improvements has been
included in the estimate of expenditures upon any other claim. A copy of the report of
Robert R. Boyd....., U. S. Deputy Mineral Surveyor, dated
January 3rd, 1907....., 18 .., is hereto attached.

U. S. Surveyor General for Arizona.....

Office of U. S. Surveyor General,

Phoenix, Arizona,.....

.....January 22, 1907, 1 ..

MAR 9