

**M
S
-**

0

2

3

4

9

Copied E. J. Oak 24/06

1
OCT 1900
OCT 1900

(4-683.)

Mineral Survey No. 2349

Lot No. _____

Arizona

Land District.

FIELD NOTES

OF THE SURVEY OF THE MINING CLAIM OF

Gold & Copper Consolidated
Mining & Milling Co

KNOWN AS THE

Avanna, Manilla, Sankiso & Pto Res's

Hessdayampe

Mining District,

Yucopai County, Arizona

Section _____, Township _____, Range _____

Surveyed under instructions dated

Sept. 13th 1906

by

J. J. Feshier

U. S. Deputy Mineral Surveyor.

Claim located

see loc. Certificate, 1

Survey commenced

Sept. 20th

1906

Survey completed

" 23rd

1906

6-100

Address

Norris & Ross

Atty for Agent

Prescott

Arizona

*Test & report
done
and see report*

POOR QUALITY

The following pages are scanned at the best possible quality setting. The original pages are of poor quality and this is the best possible reproduction.

Survey No. 100.

1000

SECTION 100.

Containing of ... 1-1 ...

1-

... 3653.8 ft
9.9

1100

1200

397.9 entered line 1-2 Havana side at N. 46° 5' E. at 40.3 ft. from cor. No. 1

1300

1400

Whence cor. No. 1 Havana side lrs. N. 42° W. 300. ft.

2

2

1

U.S. M.M. No. 1. H.D. bus. N 29° 57' W ^{3653.8 f} ~~3657.9~~ ft.

3

Cov. No. 3 on

3

3

3

4

4

4

4

and 225.5 ft. from cor. No 2.

1

17' 29.9

2

3

1

2

0 8.9

3

27
28
To cor. no. 4, cor

28

1	100.00	✓
2	100.00	✓
3	100.00	✓
4	100.00	✓
5	100.00	✓
6	100.00	✓
7	100.00	✓
8	100.00	✓
9	100.00	✓
10	100.00	✓
11	100.00	✓
12	100.00	✓
13	100.00	✓
14	100.00	✓
15	100.00	✓
16	100.00	✓
17	100.00	✓
18	100.00	✓
19	100.00	✓
20	100.00	✓
21	100.00	✓
22	100.00	✓
23	100.00	✓
24	100.00	✓
25	100.00	✓
26	100.00	✓
27	100.00	✓
28	100.00	✓
29	100.00	✓
30	100.00	✓
31	100.00	✓
32	100.00	✓
33	100.00	✓
34	100.00	✓
35	100.00	✓
36	100.00	✓
37	100.00	✓
38	100.00	✓
39	100.00	✓
40	100.00	✓
41	100.00	✓
42	100.00	✓
43	100.00	✓
44	100.00	✓
45	100.00	✓
46	100.00	✓
47	100.00	✓
48	100.00	✓
49	100.00	✓
50	100.00	✓
51	100.00	✓
52	100.00	✓
53	100.00	✓
54	100.00	✓
55	100.00	✓
56	100.00	✓
57	100.00	✓
58	100.00	✓
59	100.00	✓
60	100.00	✓
61	100.00	✓
62	100.00	✓
63	100.00	✓
64	100.00	✓
65	100.00	✓
66	100.00	✓
67	100.00	✓
68	100.00	✓
69	100.00	✓
70	100.00	✓
71	100.00	✓
72	100.00	✓
73	100.00	✓
74	100.00	✓
75	100.00	✓
76	100.00	✓
77	100.00	✓
78	100.00	✓
79	100.00	✓
80	100.00	✓
81	100.00	✓
82	100.00	✓
83	100.00	✓
84	100.00	✓
85	100.00	✓
86	100.00	✓
87	100.00	✓
88	100.00	✓
89	100.00	✓
90	100.00	✓
91	100.00	✓
92	100.00	✓
93	100.00	✓
94	100.00	✓
95	100.00	✓
96	100.00	✓
97	100.00	✓
98	100.00	✓
99	100.00	✓
100	100.00	✓

89
~~80~~
 14.068

584

0

refer to each location.

This tunnel as near as can be determined cuts the same vein as extends through the Porto Rico claim, and therefore develops the Porto Rico.

Value, = = = = 1000.00

The first of the above mentioned items
 amounting to \$100.00 was paid on the 10th day
 of the month of June 1884. The balance
 of \$100.00 was paid on the 10th day
 of the month of July 1884. The balance
 of \$100.00 was paid on the 10th day
 of the month of August 1884. The balance
 of \$100.00 was paid on the 10th day
 of the month of September 1884. The balance
 of \$100.00 was paid on the 10th day
 of the month of October 1884. The balance
 of \$100.00 was paid on the 10th day
 of the month of November 1884. The balance
 of \$100.00 was paid on the 10th day
 of the month of December 1884.

The second of the above mentioned items
 amounting to \$100.00 was paid on the 10th day
 of the month of June 1884. The balance
 of \$100.00 was paid on the 10th day
 of the month of July 1884. The balance
 of \$100.00 was paid on the 10th day
 of the month of August 1884. The balance
 of \$100.00 was paid on the 10th day
 of the month of September 1884. The balance
 of \$100.00 was paid on the 10th day
 of the month of October 1884. The balance
 of \$100.00 was paid on the 10th day
 of the month of November 1884. The balance
 of \$100.00 was paid on the 10th day
 of the month of December 1884.

J. J. Fisher

FINAL OATHS FOR SURVEYS.

LIST OF NAMES.

A list of the names of the individuals employed by

J. J. Leshee

United States Deputy Mineral Surveyor, to assist in running, measuring, and marking the lines, corners, and boundaries described in the foregoing field notes of the survey of the mining claim of

Gold & Copper

Consolidated Mining & Milling Co.

known as the *Havanna, Manila, Lumbago & Potosi Rico.*

and showing the respective capacities in which they acted.

- A. N. Chier* Chainman.
- James A. Humphrey* Chainman.
- James A. Humphrey* Axman.
- A. N. Chier* Flagman.

FINAL OATHS OF ASSISTANTS.

We,

A. N. Chier

and *James A. Humphrey* do solemnly swear that we assisted

J. J.

Leshee, United States Deputy Mineral Surveyor, in marking the corners and surveying the boundaries of the mining claim of

Gold & Copper Consolidated Mining & Milling Co.

known as the *Havanna, Manila, Lumbago & Potosi Rico*

represented in the foregoing field notes as having been surveyed by said deputy mineral surveyor and under his direction; and that said survey has been in all respects, to the best of our knowledge and belief, faithfully and correctly executed, and the corner and boundary monuments established according to law and the instructions furnished by the United States Surveyor-General for

August

- A. N. Chier* Chainman.
- James A. Humphrey* Chainman.
- James A. Humphrey* Axman.
- A. N. Chier* Flagman.

Subscribed and sworn to by the above-named persons before me this

23rd

day of *September*, 190*6*

J. J. Leshee

Notary Public

My commission expires
May 10
My commission expires
May 10, 1908

FINAL OATH OF U. S. DEPUTY MINERAL SURVEYOR

I, J. J. Fisher, U. S. Deputy Mineral Surveyor, do solemnly swear that, in pursuance of instructions received from the United States Surveyor General for Arizona, dated September 13, 1906, I have, in strict conformity to the laws of the United States, the official regulations and instructions thereunder, and the instructions of said Surveyor General, faithfully and correctly executed the survey of the Mining Claim of Gold & Copper Consolidated Mining, Milling & Co, known as the Heranna, Mazilla, Santiago & Porto Rico, situate in Harveycamp Mining District, Yavapai County, Arizona, in Section _____, Township No. _____, Range No. _____, and designated as Survey No. 2349, as represented in the foregoing field notes, which accurately show the boundaries of said mining claim as distinctly marked by monuments on the ground, and described in the attached copy of the location certificate, which was received by me from the Surveyor General with said instructions, and that all the corners of said survey have been established and perpetuated in strict accordance with the law, official regulations and instructions thereunder; and I do further solemnly swear that the foregoing are the true and original field notes of said survey and my report therein, and that the labor expended and improvements made upon said mining claim by claimant or its grantors are as therein fully stated, and that the character, extent, location and itemized value thereof are specified therein with particularity and full detail, and that no portion of said labor or improvements so credited to this claim has been included in the estimate of expenditures upon any other claim.

J. J. Fisher
U. S. Deputy Mineral Surveyor.

Subscribed and sworn to by the said J. J. Fisher
U. S. Deputy Mineral Surveyor, before me a Notary Public in and for Yavapai County Arizona this 29th
day of September 1906

Thomas C. Job
Notary Public

My Commission Expires July 9, 1907.

Affidavit of Five Hundred Dollars Improvements.

We, A. G. Florin and James A. Humphrey

of lawful age, being first duly sworn according to law, depose and say: That we are acquainted with the Academie. Manila, Santiago & Potosi Rico mining claim, situate in Assayumpu mining district, Yavapai County, Arizona Territory, for which Gold & Copper Consolidated Mining & Milling Co.

has made application for survey prior to application for patent under the provisions of the Act of Congress approved May 10, 1872; and that the labor done and improvements made thereon by the applicant... and its grantor do exceed five hundred dollars in value, and further that we are not personally interested in said mine.

A. G. Florin
James A. Humphrey

TERRITORY OF ARIZONA,
COUNTY OF Yavapai } ss:

Sworn to and subscribed before me this 23rd day of September, 1906

[SEAL.]

J. J. Freshet
Notary Public

17171b400-3-05

My commission expires
May 19, 1906

"HAVANNA".

NOTICE OF LOCATION.

Know all men by these presents:

That we the undersigned, have this day located fifteen hundred (1500) linear feet of this vein or lode, bearing precious metals, with all dips, spurs, angles and variations, with surface ground three hundred (300) feet on each side of the center of vein, with all mineral deposits contained therein, and all timber growing within the limits of said claim, and all water and water privileges thereon or appurtenant thereto, under and according to the provisions of the United States Mining Laws, under which it is located.

This claim commences at this monument and notice placed upon the ledge, and runs 1300 feet in a Northerly direction and 200 feet in a Southerly direction along the ledge, from discovery shaft.

The exterior boundaries are as follows, viz:

Commencing at a monument of stone on west boundary line, distant three hundred (300) feet in a westerly direction from the discovery monument; thence in a Northerly direction parallel with the ledge 1300 feet to monument of stone at N. W. corner of claim; thence in a Easterly direction at right angles across the ledge Six hundred (600) feet to Monument of stone at N. E. corner of claim; thence in a Southerly direction parallel with the ledge fifteen hundred (1500) feet to monument of stone at S. E. corner of claim; thence at right angles across the ledge in a westerly direction Six hundred (300) feet to monument of stone at S. W. corner of claim; thence in a Northerly direction parallel with the ledge 300 feet to monument on west boundary and place of beginning.

This ledge may be more generally described as situated on the head waters of the Hassayampa river and about 1 1/2 mile from Chicago Co's quartz mill in an easterly direction, in Hassayampa Mining District, Yavapai County, Arizona Territory, and shall be known as the Havanna Mining Claim.

Dated on the ground this First day of April, 1899.

A. J. Pickrell 1/2

R. A. Sweet 1/2

Recorded at request of C. C. Keeler June 30th A. D. 1899, at 2:15 o'clock p. m., in Book 49 of Mines, page 389, Records of Yavapai County, Arizona.

By _____, (Seal) W. I. Johnson,
Deputy. County Recorder.

* * * * *

"PORTO RICO".

NOTICE OF LOCATION.

Know all men by these presents:

That we the undersigned, have this day located fifteen hundred (1500) linear feet of this vein of lode, bearing precious metals, with all dips, spurs, angles and variations, with surface ground three hundred (300) feet on each side of the center of vein, with all mineral deposits contained therein, and all timber growing within the limits of said claim, and all water and water privileges thereon or appurtenant thereto, under and according to the provisions of the United States Mining Laws, under which it is located.

This claim commences at this monument and notice placed upon the ledge, and runs 1000 feet in a Northerly direction and 500 feet in a southerly direction along the ledge from discovery shaft.

The Exterior boundaries are as follows, viz:-

Commencing at a monument of stone on west boundary line, distant three hundred (300) feet in a Westerly direction from Discovery Monument; thence in a Northerly direction parallel with the ledge 1000 feet to monument of stone at N. W. corner of claim; thence in a Easterly direction at right angles across the ledge six hundred (600) feet to monument of stone at N. E. corner of claim; thence in a Southerly direction parallel with the ledge fifteen hundred (1500) feet to monument of stone at S. E. corner of claim; thence at right angles across the ledge in a Westerly direction six hundred (600) feet to monument of stone at S. W. corner of claim; thence in a Northerly direction parallel with the ledge 500 feet to monument on west boundary and place of beginning.

This ledge may be more generally described as situated on the head waters of the Hassayampa River and about 3/4 of a mile from the Chicago Co's quartz Mill, in an easterly direction. the North end of this claim joins the South end of the Santiago mining claim, in Hassayampa Mining District, Yavapai County, Arizona Territory, and shall be known as the Porto Rico Mining Claim.

Dated on the ground this First day of April 1899.

A. J. Pickrell 1/2

R. A. Sweet 1/2

Recorded at request of C. C. Keeler, June 30th A. D. 1899, at 2:15 o'clock P. M., in Book 49 of Mines, page 387, Records of Yavapai County, Arizona.

By _____, (Seal) W. I. Johnson, Deputy. County Recorder.

"MANILLA".

NOTICE OF LOCATION.

Know all men by these presents:

That we the undersigned, have this day located fifteen hundred (1500) linear feet of this vein or lode, bearing precious metals, with all dips, spurs, angles and variations, with surface ground three hundred (300) feet on each side of the center of vein, with all mineral deposits contained therein, and all timber growing within the limits of said claim, and all water and water privileges thereon or appurtenant thereto, under and according to the provisions of the United States Mining Laws, under which it is located.

This claim commences at this monument and notice placed upon the ledge, and runs 100 feet in a Northerly direction and 1400 feet in a Southerly direction along the ledge from discovery shaft.

The exterior boundaries are as follows, viz:

Commencing at a monument of stone on west boundary line, distant three hundred (300) feet in a westerly direction from Discovery monument; thence in a Northerly direction parallel with the ledge 100 feet to Monument of Stone at N. W. corner of claim; thence in a Easterly direction at right angles across the ledge Six hundred (600) feet to monument of stone at N. E. corner of claim; thence in a Southerly direction parallel with the ledge Fifteen hundred (1500) feet to monument of stone at S. E. corner of claim; thence at right angles across the ledge in a westerly direction Six hundred (600) feet to monument of stone at S. W. corner of claim; thence in a Northerly direction parallel with the ledge 1400 feet to monument on west boundary and place of beginning.

This ledge may be more generally described as situated on the head waters of Hassayampa river and about 1 1/2 mile easterly from the Chicago Co's quartz mill, in Hassayampa Mining District, Yavapai County, Arizona Territory, and shall be known as the Manilla Mining Claim.

Dated on the ground this First day of April, 1899.

A. J. Pickrell 1/2

R. A. Sweet 1/2

Recorded at request of C. C. Keeler June 30th A. D. 1899, at 2:15 o'clock P. M., in Book 49 of Mines, page 388, records of Yavapai County, Arizona.

(Seal) W. I. Johnson,
County Recorder.

By _____,
Deputy.

* * * * *

"SANTIAGO".

NOTICE OF LOCATION.

Know all men by these presents:

That we the undersigned, have this day located fifteen hundred (1500) linear feet of this vein or lode, bearing precious metals, with all dips, spurs, angles and variations, with surface ground three hundred (300) feet on each side of the center of vein, with all mineral deposits contained therein, and all timber growing within the limits of said claim, and all water and water privileges thereon or appurtenant thereto, under and according to the provisions of the United States Mining Laws, under which it is located.

This claim commences at this monument and notice placed upon the ledge, and runs 500 feet in a Northerly direction and 1000 feet in a Southerly direction along the ledge, from discovery shaft.

The exterior boundaries are as follows, viz:-

Commencing at a monument of stone on west boundary line, distant three hundred (300) feet in a westerly direction from Discovery monument; thence in a Northerly direction parallel with the ledge 500 feet to monument of stone at N. W. corner of claim; thence in a Easterly direction at right angles across the ledge six hundred (600) feet to monument of stone at N. E. corner of claim; thence in a Southerly direction parallel with the ledge fifteen hundred (1500) feet to monument of stone at S. E. corner of claim; thence at right angles across the ledge in a Westerly direction six hundred (600) feet to monument of stone at S. W. corner of claim; thence in a Northerly direction parallel with the ledge 1000 feet to monument on west boundary and place of beginning.

This ledge may be more generally described as situated on the head waters of the Hassayampa river, and about 1 1/2 mile easterly from the Chicago Gold Mining Co's quartz mill, in Hassayampa Mining District, Yavapai County, Arizona Territory, and shall be known as the Santiago Mining Claim.

Dated on the ground this First day of April 1899.

A. J. Pickrell 1/2

R. A. Sweet 1/2

Recorded at request of C. C. Keeler June 30" A. D. 1899, at 2:15 o'clock p. m., in Book 49 of Mines, page 390, records of Yavapai County, Arizona.

(Seal) W. I. Johnson,
County Recorder.

By _____,
Deputy.

TERRITORY OF ARIZONA,)
 County of Yavapai.) ss.

I, ROLAND MOSHER, County Recorder in and for the County of Yavapai, in the Territory of Arizona, and custodian of the records of said office, do hereby certify that I have compared the above and foregoing with, and the same contains a full, true and correct copy of the Notice of Location of each of the following described mining claims, as the same appears from the record thereof in my said office, viz:

PORTO RICO Mining Claim, notice of location whereof is of record in Book 49 of Mines, page 387, records of Yavapai County, Arizona;

MANILLA Mining Claim, notice of location whereof is of record in Book 49 of Mines, page 388, said records;

HAVANNA Mining Claim, notice of location whereof is of record in Book 49 of Mines, page 389, said records;

SANTIAGO Mining Claim, notice of location whereof is of record in Book 49 of Mines, page 390, said records.

IN WITNESS WHEREOF, I have hereunto set my hand and affixed my official seal, this 14th day of September, A. D. 1906.

Roland Mosher

 County Recorder.

U. S. SURVEYOR-GENERAL'S FINAL CERTIFICATE ON FIELD NOTES.

Department of the Interior,
OFFICE OF U. S. SURVEYOR-GENERAL,

Phoenix, Arizona,

Oct. 25, 1906.

I, U. S. Surveyor-General for Arizona,
do hereby certify that the foregoing transcript of the Field Notes, return and approval of the survey
of the mining claim of Gold and Copper Consolidated Mining and Milling
Company,
known as the Havana, Manilla, Santiago and Porto Rico
situate in Hassayampa
Mining District, Yavapai County, Arizona,
in Section _____, Township No. _____, Range No. _____, and
designated as Survey No. 2349, has been correctly copied from the originals on file in
this office; that said Field Notes furnish such an accurate description of said mining claim as will, if
incorporated into a patent, serve fully to identify the premises, and that such reference is made therein
to natural objects or permanent monuments as will perpetuate and fix the locus thereof.

And I further certify that five hundred dollars' worth of labor has been expended or improve-
ments made upon said mining claim by claimant or its grantors, and that said improvements
consist of 4 shafts and 3 tunnels, total value \$4600.00

and that no portion of said labor or improvements has been included in the estimate of expenditures
upon any other claim.

I further certify that the plat thereof, filed in the U. S. Land Office at Phoenix,
Arizona, is correct and in conformity with the foregoing Field Notes.

Frank S. Ingalls,

United States Surveyor-General for Arizona.

4-687.

SURVEYOR-GENERAL'S CERTIFICATE OF APPROVAL OF FIELD
NOTES AND SURVEY OF MINING CLAIM.

Department of the Interior,

Office of U. S. Surveyor-General,

Phoenix, Arizona,

Oct. 25, 1906.

I, U. S. Surveyor-General for Arizona,

do hereby certify that the foregoing and hereto attached Field Notes and Return of the Survey of the Mining Claim of ~~Gold and Copper Consolidated Mining and Milling~~ Company,

known as the Havana, Manila, Santiago and Porto Rico

situate in Hassayama Mining District,
Yavapai County, Arizona,

in Section _____, Township No. _____, Range No. _____

designated as Survey No. 2349

executed by J. J. Fisher, U. S. Deputy Mineral

Surveyor, Sept. 20--23, 1906, 190____, under my instructions dated

September 13, 1906, 190____, have been critically examined and the necessary cor-

rections and explanations made, and the said Field Notes and Return, and the Survey they describe,

are hereby approved. A true copy of the copy of the location certificate filed by the applicant.. for

survey is included in the field notes.

Frank S. Ingalls

U. S. Surveyor-General for Arizona.

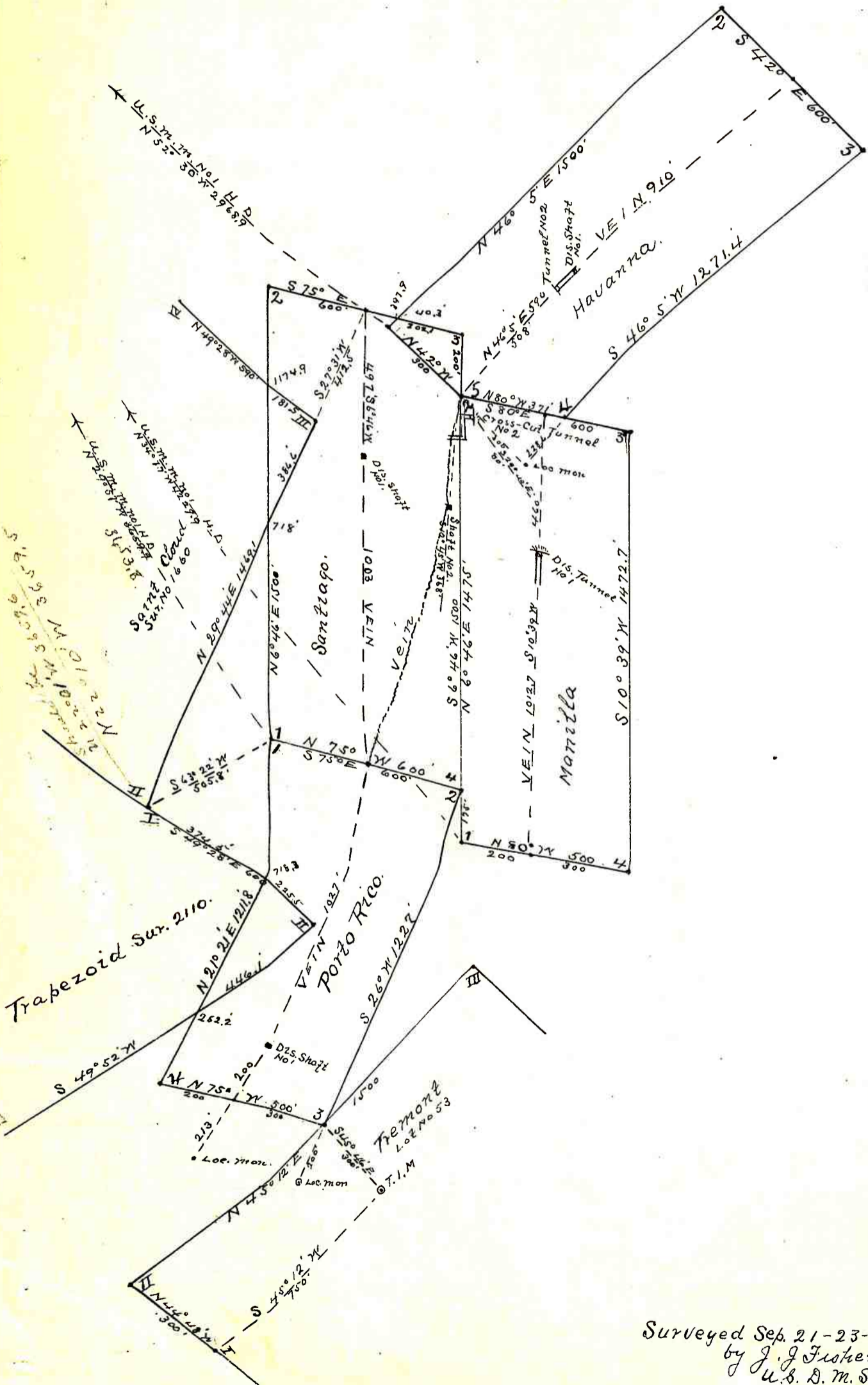

Surveyed Sep. 21-23-1906
 by J. J. Foster.
 U.S. D. M. S.