

M
S
-

0

2

4

5

0

AUG. 6 - 1907

(4-683.)

Mineral Survey No. 2450

Lot No. _____

Arizona Land District.

FIELD NOTES

OF THE SURVEY OF THE MINING CLAIM OF

O. T. Smith

KNOWN AS THE

Baltimore

Cochise

Mining District.

Cochise County, Arizona

Section approx., Township 15 S, Range 22 E - Unsurveyed

Surveyed under instructions dated July 23, 1907.

by Eneat L. Robinson,

U. S. Deputy Mineral Surveyor

Claim located See location notice, 1

Survey commenced July 26, 1907

Survey completed July 27, 1907

6-153

Address of

Claimant's Attorney

D. L. Cunningham

Tombstone

Ariz.

Survey No. 2450.

Baltimore Lode.

Beginning at Cor. No. 1, the S E Cor of the claim, a pine post 4 ins square, 4 ft long set 8 ins in ground to bed rock, in a mound of stone; scribed S.E. C - B - 1 - 2450, whence:

U.S.L.M - No. 2450 bears N. 80° 51' E - 7149 ft.

Location cor a stone monument bears S 46° 45' E 31 ft.

A cross (X) and B.T. - 1 - 2450 scribed on a blaze on a mesquite tree 10 ins diameter, bears S 85° 10' E - 18.5 ft.

A cross (X) and B.T.- 1 - 2450 scribed on a blaze on a mesquite tree 16 ins diameter, bears S 9° 54' E - 56.3 ft.

Thence N 83° 20' W - Va 13° 15' E

300 South center end identical with location a pine post 4 ins square 4 ft long set 1 ft in ground to bed rock in a mound of stone, scribed SCE - B - 2450,

600 to cor No. 2, a pine post 4 ins square 4 ft long set 10 ins in ground to bed rock, in a mound of stone, and scribed S. W. C - B - 2 - 2450, whence:

Location cor a stone monument bears S 11° 50' W - 105 ft.

A cross (X) and B R - 2 - 2450 chiseled on quartzite bed rock ^{bears} N 28° 47' E - 24.8 ft.

A cross (X) and B T - 2 - 2450 scribed on a blaze on a mesquite tree 8 ins diameter bears S 72° 43' E - 51.6 ft.

Thence N 6° 40' E - Va 13° 15' E

730 Center of gulch 20 ft wide, course N.W.

1500 to cor No.3, a pine post 4 ins square, 4 ft long set 5 ins in the ground to bed rock in a mound of stone and scribed N.W. C - B - 3 - 2450, whence;

- Location cor a monument of stone bears N 2° 35' E -
282 ft
- A cross (X) and B T - 3 - 2450, scribed on a blaze on
mesquite tree - 10 ins in diameter bears S 31° 41' W -
46 ft
- A cross (X) and B R - 3 - 2450, chiseled on shistose
bed rock bears S 88° 15' W - 28.6 ft.
- Thence S 83° 20' E - Va 13° 15' E
- 300 North center end, a pine post 4 ins square, 4 ft long
set 1 ft in the ground in a mound of stone, and scribed
N.C.E. - B - 2450, whence: location center end a stone
monument bears N 6° 40' E 205 ft.
- 600 to cor No. 4 a pine post 4 ins square 4 ft long set 10
ins in ground, ^{to bed rock} in a mound of stone, and scribed N.E.C. - B
4 - 2450, whence:
- Location cor a monument of stone bears N 32° 15' E -
175 ft
- A cross (X) and B. R. - 4 - 2450 chiseled on granite
bed rock bears S 56° 13' W - 18.6 ft
- A cross (X) and B.T. - 4 - 2450 scribed on a blaze on
a mesquite tree 4 ins in diameter bears S 61° E 4.55 ft.
- Thence S 6° 40' W - Va 13° 15' E
- 1190 Center of gulch 20 ft wide course N.W.
- 1500 to cor No. 1 the place of begining.

Area 20.661 acres.

Location

This claim is located in Cochise mining district,
Cochise County, Arizona, approximately in Tp 15 S - R 22
E, unsurveyed.

Vein

The lode extends presumably the length of the claim
from center end to center end, S 6° 40' W - 955 ft and
N 6° 40' E 545 ft from discovery shaft.

Adjoining Claims.

No adjoining claims so far as known.

Expenditure of Five Hundred Dollars.

I certify that the value of the labor and improvements
upon this claim, placed thereon by the claimants and

^{his}
~~their~~ grantors, is not less than five hundred dollars,
 and that said improvements consist of:

1) Discovery shaft which bears from S center end, N 6°
 40' E - 955 ft, shaft 6 x 4 ft 10 ft deep. Value at \$10
 per ft \$100.

From cor No. 1;

2) A shaft which bears N 25° 21' W, 712 ft, shaft 6 x 4
 ft, 34 ft deep, Value at \$10 per ft, \$ 340

3) A shaft which bears N 3° 20' W 906 ft shaft 6 x 4 ft,
 21 ft deep. Value at \$10 per ft. \$210.

4) Irregular workings the center of which bears N 3° 20'
 W 874 ft. Value \$25

Other Improvements.

An adobe cabin 14' E and W, 12' N and S, the S.E. cor of
 which bears from ^{Cor} No. 1 N 18° 30' W - 605 ft.

O.T. Smith claimant.

Instrument.

This survey was with a Young and Sons transit. The courses
 were deflected from the true Meridian as determined by
 direct solar observations, and an observation on Polaris
 at Eastern Elongation.

The distances were measured ^{with} 50 ft and 500 ft steel tapes.

Tombstone, Arizona

Aug. 1st 1907

Ernest L. Robinson

U.S. Deputy mineral Surveyor

U. S. L. M. - 2450

Select a point on a high ridge extending northeast -
erly and southwesterly, set a pine post 6 ins square, 8
ft long, 1 ft in ground to bed rock, in a mound of stone
6½ ft base and 5 ft high. Post is scribed U. S. L.M. -
No. - 2450. Exact point from which bearings were taken is
marked by a tack in top of post, whence:

Rincon peak bears S 88° 50' W.

Mt. Wrightson, Santa Rita Mts, bears S 55° 15' W.

U.S.G.S. monument on Lime mountain bears S 73° 32' E.

Highest peak Galuira mts bears N 4° 30' E.

A cross (X) and B.R. - U.S.L.M. - 2450 chiseled on
gneiss bed rock bears S 14° 05' W - 26.4 ft.

A cross (X) and B.R. - U.S.L.M. - 2450 chiseled on
gneiss bed rock bears N 20° 02' W - 18.1 ft.

A cross (X) and B.T. - U.S.L.M. - 2450 scribed on a
blaze on the most westerly of three stems of a mesquite,
10 ins in diameter bears S 80° 32' E - 79.5.

Variation 13° 15' E.

Latitude 32° 07' N.

Tombstone, Arizona.

Aug. 2, 1907.

Ernest L. Robinson

U.S. Deputy Mineral Surveyor.

AUG 26 1907

Final oath of assistant

I, Bert Caldwell, do solemnly swear that I assisted Ernest L. Robinson, United States deputy mineral ^{surveyor}, in marking the corners and surveying the boundaries of the mining claim of C. T. Smith, known as the Baltimore lode, represented in the foregoing field notes as having been surveyed by said deputy mineral surveyor and under his direction; and that said survey has been made in all respects, to the best of my knowledge and belief, faithfully executed, and the corner and boundary monuments established according to law and the instructions furnished by the United States Surveyor General for Arizona.

Bert Caldwell Chairman
subscribed and sworn to by the above named person before me this 29th day of July, 1907,

Mary F. Titus.

Notary Public.

July 29, 1907

MY COMMISSION EXPIRES SEPTEMBER 4, 1910

MY COMMISSION EXPIRES SEPTEMBER 4, 1910

FINAL OATH OF U. S. DEPUTY MINERAL SURVEYOR

I, Ernest L. Robinson, U. S. Deputy Mineral Surveyor, do solemnly swear that, in pursuance of instructions received from the United States Surveyor General for Arizona, dated July 23-1907, I have, in strict conformity to the laws of the United States, the official regulations and instructions thereunder, and the instructions of said Surveyor General, faithfully and correctly executed the survey of the Mining Claim of O. T. Smith, known as the Baltimore, situate in Cochise Mining District, Cochise County, Arizona, in Section Approx., Township No. 15S, Range No. 22 E - unsurveyed, and designated as Survey No. 2450, as represented in the foregoing field notes, which accurately show the boundaries of said mining claim as distinctly marked by monuments on the ground, and described in the attached copy of the location certificate, which was received by me from the Surveyor General with said instructions, and that all the corners of said survey have been established and perpetuated in strict accordance with the law, official regulations and instructions thereunder; and I do further solemnly swear that the foregoing are the true and original field notes of said survey and my report therein, and that the labor expended and improvements made upon said mining claim by claimant or his grantors are as therein fully stated, and that the character, extent, location and itemized value thereof are specified therein with particularity and full detail, and that no portion of said labor or improvements so credited to this claim has been included in the estimate of expenditures upon any other claim.

Ernest L. Robinson
U. S. Deputy Mineral Surveyor.

Subscribed and sworn to by the said Ernest L. Robinson
U. S. Deputy Mineral Surveyor, before me Frank C. Willard
a Notary Public this 3rd
day of August 1907.

Frank C. Willard
Notary Public

My Comm. expires Mar 2, 1910

Affidavit of Five Hundred Dollars Improvements.

We, G. E. Brown, and C. Glennon

of lawful age, being first duly sworn according to law, depose and say: That we are acquainted with the Baltimore mining claim, situate in Cochise Mining district, Cochise County, Arizona Territory, for which O. T. Smith

has made application for survey prior to application for patent under the provisions of the act of Congress, approved May 10, 1872; and that the labor done and improvements made thereon by the applicant and his grantor exceed Five Hundred Dollars in value, and further that we are not personally interested in said mine.

G. E. Brown

C. Glennon

TERRITORY OF ARIZONA, }
County of Cochise } ss:

Sworn to and subscribed before me, this 6

day of August, 1907

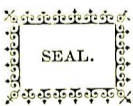

M. G. Crowley
Notary Public

14396b400-8-04

My commission Expires
Jan 11 1909

Notice of Mining Location

LODE QUARTZ CLAIM

To All Whom It May Concern:

THIS MINING CLAIM, the name of which is the BALTIMORE Mining Claim, situate on lands belonging to the United States of America, and in which there are valuable mineral deposits, was entered upon and located for the purpose of exploration and purchase by O. T. Smith

the undersigned, on the 21 day of June 1900.

The length of this claim is 1500 feet, and this claim Seven Hundred and fifty feet, in a North direction and 750 feet in a South direction from the center of the discovery shaft, at which this notice is posted, lengthwise of the claim, together with 300 feet in width of the surface grounds, on each side of the center of said claim. The general course of the lode deposit and premises is from the North to the South

The claim is situated and located in Cochise Mining District, in Cochise County, in the Territory of Arizona, about 7 miles in a West direction from Johnsonville and takes in the well and premises formerly known as the Steep Mountain Ranch

The surface boundaries of the claim are marked upon the ground as follows: Beginning at Monument of stones

at a point in a North direction 750 feet from the discovery shaft, at which this notice is posted, being in the center of the North end line of said claim; thence West 300 feet to a monument being the North West corner of said claim; thence South 750 feet to a monument at the center of the West side line of said claim; thence South 750 feet to a monument being at the South West corner of said claim; thence East 300 feet to a monument at the center of the South end of said claim; thence East 300 feet to a monument, being at the South East corner of said claim; thence North 750 feet to a monument being at the center of the East side line of said claim; thence North 750 feet to a monument at the North East corner of said claim; thence West 300 feet to the place of beginning.

All done under the provisions of Chapter Six, ⁽⁶⁾ of Title XXXII, of the Revised Statutes of the United States, and of an Act of the General Assembly of Arizona, entitled "An Act Concerning Mines," approved March 20th, 1895. and amended March 2nd. 1899.

Dated and posted on the ground this 21 day of June 1900.

Witness James Busebank

O. T. SMITH

Filed and recorded at request of O.T. Smith August 1st, A.D. 1900, at 9 A.M. in Book 18 Records of Mines Page 178.

TERRITORY OF ARIZONA,)
County of Cochise.) ss.

I, C. A. McDonald, County Recorder in and for said County hereby certify that I have compared the annexed and foregoing copy with the record of the original location notice of the BALTIMORE mining claim, filed and recorded in my office on the 1st day of August, 1900 in Book 18 Records of Mines at Page 178; and that the same is a full, true and correct copy of said original and of the whole thereof.

Witness my hand and seal of office this 19th day of July, A. D. 1907.

C. A. McDonald

County Recorder.

4-688.

U. S. SURVEYOR-GENERAL'S FINAL CERTIFICATE ON FIELD NOTES.

Department of the Interior,

OFFICE OF U. S. SURVEYOR-GENERAL,

Phoenix, Arizona,

October 5, 1907

I, U. S. Surveyor-General for District of Arizona

do hereby certify that the foregoing transcript of the Field Notes, return and approval of the survey of the mining claim of

C. T. Smith

known as the BALTIMORE

situate in Cochise

Mining District, Cochise County, Arizona

in Section Approx., Township No. 15 S., Range No. 22 E., Unsur., and

designated as Survey No. 2450, has been correctly copied from the originals on file in this office; that said Field Notes furnish such an accurate description of said mining claim as will, if incorporated into a patent, serve fully to identify the premises, and that such reference is made therein to natural objects or permanent monuments as will perpetuate and fix the locus thereof.

And I further certify that five hundred dollars' worth of labor has been expended or improvements made upon said mining claim by claimant or his grantors, and that said improvements consist of 3 shafts and 1 cut, total value \$675.00

and that no portion of said labor or improvements has been included in the estimate of expenditures upon any other claim.

I further certify that the plat thereof, filed in the U. S. Land Office at Phoenix, Arizona

is correct and in conformity with the foregoing Field Notes.

Frank S. Ingalls,

United States Surveyor-General for Arizona.

(4-687.)

Surveyor General's Certificate of Approval of Field Notes and Survey of Mining Claim.

Department of the Interior,

Office of U. S. Surveyor General,

.....*Phoenix, Arizona,*.....

.....*October 5,*....., 1907.

I, U. S. Surveyor General for*District of Arizona*.....,

do hereby certify that the foregoing and hereto attached Field Notes and Return of the Survey of the Mining Claim of

.....*O. T. Smith*.....

....., known as the

.....*BALTIMORE*.....,

situate in*Cochise*..... mining district,

.....*Cochise*..... County,*Arizona*.....,

in Section*Approx.*....., Township No.*15 S.* Range No.*22 E., Unsur.*.....

....., designated as Survey No.*2450*.....

executed by*Ernest L. Robinson*....., U. S. Deputy Mineral

Surveyor,*July 26-27*....., 1907, under my instructions dated

.....*July 23*....., 1907, have been critically examined and the

necessary corrections and explanations made, and the said Field Notes and Return, and

the Survey they describe, are hereby approved. A true copy of the copy of the location

certificate filed by the applicant for survey is included in the field notes.

Frank S. Ingalls

U. S. Surveyor General for*Arizona.*.....

UNITED STATES
DEPARTMENT OF THE INTERIOR
GENERAL LAND OFFICE
PUBLIC SURVEY OFFICE

(C O P Y)

Phoenix, Arizona, February 4, 1931.

District Cadastral Engineer,
Phoenix, Arizona.

Sir:

I note herein field connections to the Baltimore Claim, Mineral Survey No. 2450, situated in Sec. 24, T. 15 S., R. 21 E., G. & S. R. E. & M., Arizona:

From the $\frac{1}{4}$ sec. cor. of secs. 13 and 24, which is an iron post, 1 in. diam., 18 ins. above ground, supported in a mound of stone, marked on brass cap

$$\frac{1}{4} \begin{array}{l} S 13 \\ S 24 \\ 1916 \end{array}$$

S. 62° 53' E., 9.66 chs. to a pine post, 4 ins. square, 3 ft. above ground, firmly set in a mound of stone, marked NW CB on the SE. face, 3-2450 on the NW. face, which is cor. No. 3 of the Baltimore Claim, Survey 2450.

Respectfully,

(S) Dupree R. Averill,

Nov. 24, 1930.

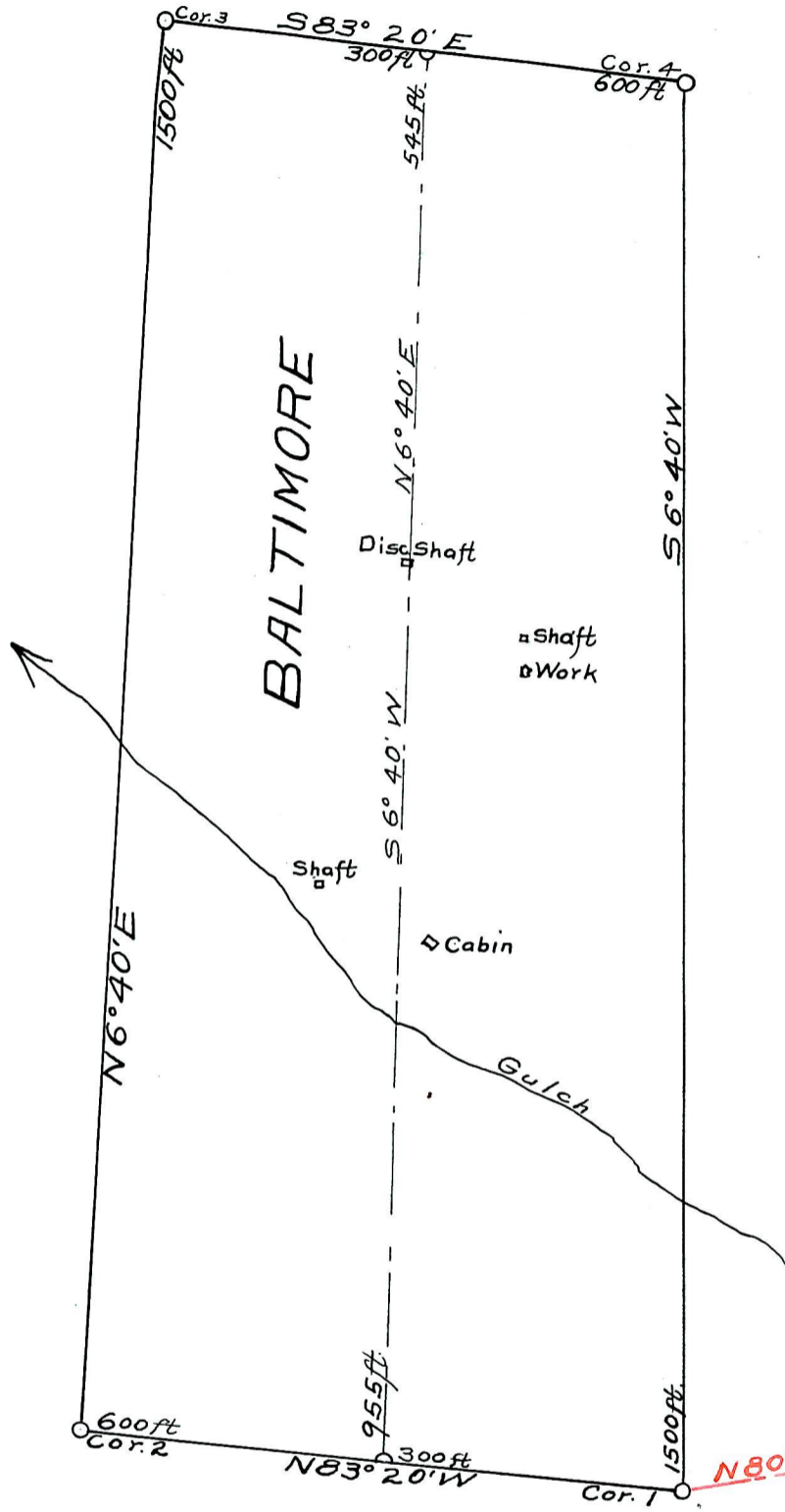

SURVEY No 2450
 GILA LAND DISTRICT
 Surveyed July 26 & 27-1907
 By Ernest L. Robinson
 U.S. Dep. Min. Surveyor
 Scale 200 ft = 1 in.

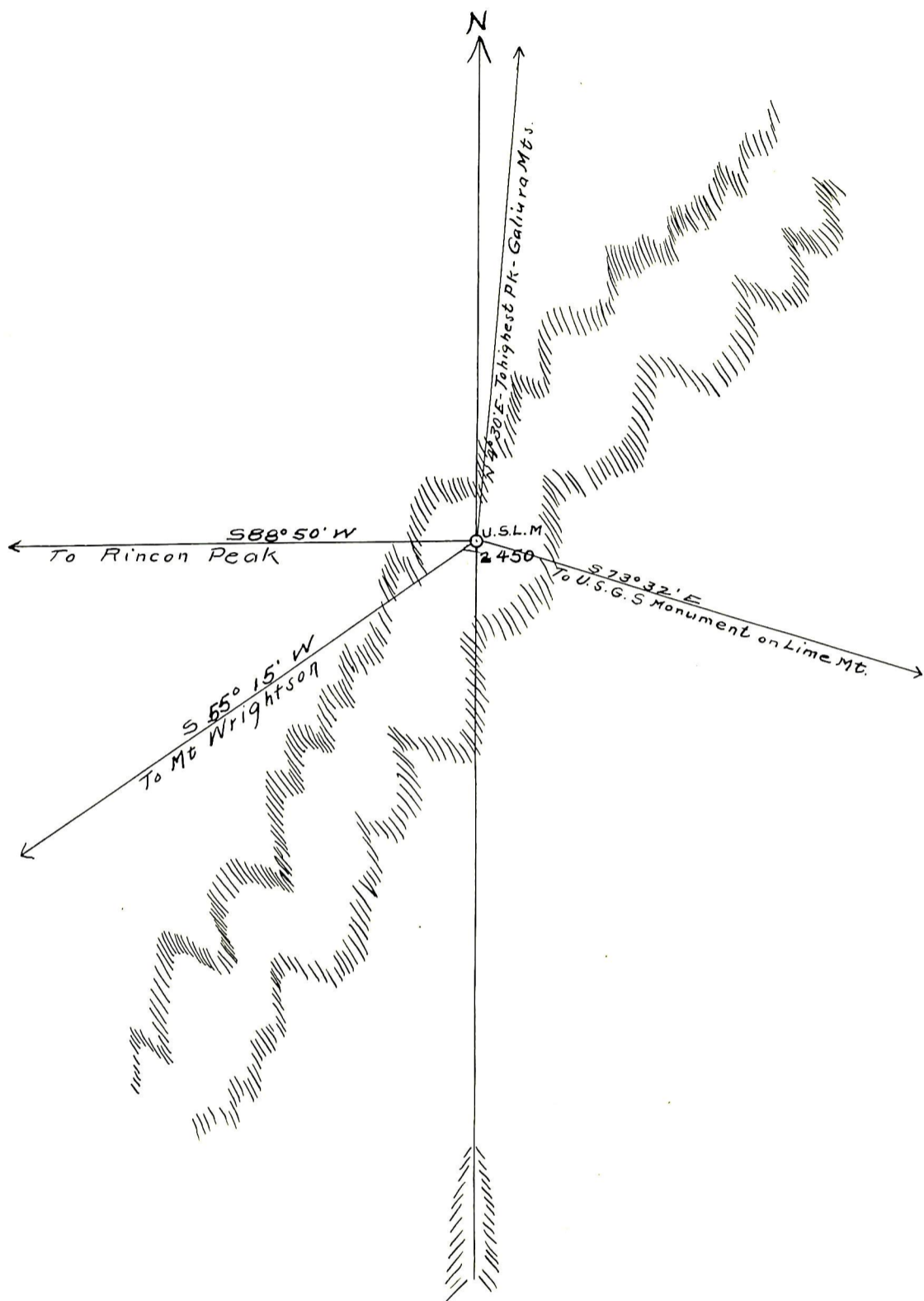

U.S.L.M. - No 2450
 T_p 15 S - R 22 E - unsurveyed.
 Cochise Mining District - Cochise County - Arizona.
 Located July 26-1907, by Ernest L. Robinson,
 U.S. Deputy Mineral Surveyor.