

**MS**

**0**

**2**

**6**

**1**

**8**



MINERAL SURVEY NO. 2618

Claims	M & B Desc.	Improvements	Loc. Notices
Big Bluff	Pg. 17	Pg. 27	14
Big Iron No. 1	9	24	9
" 2	10	25	10
" 3	11	25	11
" 4	12	25	12
" 5	17	27	13
Breach	13	25	8
Gill	15	26	1
Hechtman	14	26	2
Iron Hive	6	23	5
Iron Hive No. 2	7	23	6
Los Angeles	19	28	15
Mineral Farm	1	21	16
Mineral Farm No. 1	2	22	17
" 2	3	22	18
" 3	4	22	19
" 4	5	22	20
" 5	6	23	21
Moonlight	8	24	4
New Orleans	18	27	7
Vacy-Constance	15	26	3

102



*platted*

JUL 16 1909

AUG 9 1909

4-683.

MINERAL SURVEY No. 2618

LOT No.

Arizona Land District.

FIELD NOTES

OF THE SURVEY OF THE MINING CLAIM OF

Globe Mining Company

KNOWN AS THE Mineral Farm, Mineral Farm  
No. 1, Mineral Farm No. 2, Mineral Farm No. 3, Mineral Farm No. 4,  
Mineral Farm No. 5, Iron Hive, Iron Hive No. 2, Moonlight, Big Iron  
No. 1, Big Iron No. 2, Big Iron No. 3, Big Iron No. 4, Breach, Hechtman,  
Gill, Vacy-Constance, Big Iron No. 5, Big Bluff, New Orleans,  
Los Angeles, Globe Mining District,

Gila County, Arizona

Sections 1, 12 & 13, Approx. 6, 7 Township 1 N., Range 15 E., Unsur. 16 E.

Surveyed under instructions dated March 29, 1909.

by H. C. Hopkins  
U. S. Mineral Surveyor.

Claim located See Location Notices, 19

Survey commenced April 1, 1909.

Survey completed June 1, 1909.

6-822 Address of Agent:  
J. F. Hechtman, President,  
Globe, Arizona.



## SURVEY 26I8.

## MINERAL FARM LODE.

## FEET

Beginning at Cor. No. I.

On line 4-5, of the Mineral Farm No. 2 lode of this survey.

A pine post, 4 ft. long, 4 ins. sq., set 18 ins. in the ground, in mound of stone, scribed 1-26I8-MF, whence

The SE Cor. of Sec. 12, T. 1 N., R. 15 E., G. & S. R. 8-M., bears S. 19° 29' W., 1107.5 ft.; a syenite boulder, projecting 2 by 1 by 1 ft. above the ground, chiseled BRX 1-26I8-MF, bears S. 69° 46' E., 16.5 ft.

-----  
Thence N. 30° 14' E.

Mag. Var. 12° 50' E.

20.75 To Cor. No. 2, Breach lode, of this survey.

717.65 To Cors. Nos. 4-6, Mineral Farm No. 2 and Mineral Farm No. I lodes, of this survey.

I462.6 To Cor. No. 2

A pine post, 4 ft. long, 4 ins. sq., set 18 ins. in the ground, in mound of stone, scribed 11-26I8-MF, whence

Black Peak bears S. 26° 24' E.

No bearings available

-----  
Thence S. 53° 31' E.

Mag. Var. 13° 50' E.

301.6 To East end center of the location, a pine post, 4 ft. long, 4 ins. sq., in mound of stone.

567.4 To Cor. No. 3.

On line 5-6, Surv. No. 842, Yuma lode.

A pine post, 4 ft. long, 4 ins. sq., set 18 ins. in the ground, in mound of stone, scribed 111-26I8-MF, whence

A quartzite boulder, projecting 1 by 2½ by 1 ft. above the ground, chiseled BRX 111-MF 4-M 26I8, bears S. 35° 23' E., 49 ft.

-----  
Thence S. 47° 53' W.

Mag. Var. 13° 30' E.

276.8 To Cor. No. 4.

Identical with Cor. No. 6. Surv. No. 842, Yuma lode.

A pine post, 4 ins. sq., set in the ground, in mound of stone, scribed Y-No. 6, to which I added 1v-26I8-MF.

No bearings available.

-----  
Thence S. 51° 24' E.

Mag. Var. 14° 00' E.

I04.7 To Cor. No. 5.

On line 6-I, Surv. No. 842, Yuma lode.

A pine post, 4 ft. long, 4 ins. sq., set 18 ins. in the ground, in mound of stone, scribed v-26I8-MF.

No bearings available.

-----  
Thence S. 30° 00' W.

Mag. Var. 14° 00' E.

I.5 To Cor. No. 5, Surv. No. 433, O'Dougherty lode.

II86.4 To Cor. No. 6.

On line 5-6, Surv. No. 433, O'Dougherty lode.

A pine post, 4 ft. long, 4 ins. sq., set 18 ins. in the ground, in mound of stone, scribed vi-26I8-MF, whence

A quartzite boulder, projecting 1 by 1½ by 2 ft. above the ground, chiseled BRX vi-MF, 111-B 26I8, bears



( 4-2618 )

FEET	MINERAL FARM NO. 3. LODGE. continued.
	----- Thence S. 50° 22' W. Mag. Var. 12° 50' E.
265	Big Johnnie Gulch, course South, and road, course North and South.
324.2	Intersect the east boundary of Sec. 12 at N. 00° 04' E., 632.8 ft from the SE. Cor. and S. 00° 04' W. 20056 ft. from the E. $\frac{1}{4}$ Cor. of said Sec.
396.9	To Cor. No. 1, the place of beginning.
	----- MINERAL FARM NO. 3. LODGE. Beginning at Cor. No. 1. Identical with Cor. No. 1. Mineral Farm No. 2. lode, of this survey, which I scribe i-MF3 on the west face, in addition to the marks heretofore scribed thereon, whence The SE. Cor. Sec 12, T. 1N. R. 15 E. G. & S.R. B & M., bears S. 5° 23' E., 589.2 ft.
	----- Thence S. 50° 22' W. Mag. Var. 13° 50' E.
904.5	Intersect the south boundary of Sec. 12 at N. 89° 16' W., 751.8 ft. from the SE. Cor. and S. 89° 16' E. 4487.2 ft. from the SW. Cor. of said Sec.
1072.4	Intersect line 4-I of the Hechtman lode of this survey at S. 51° 19' E. 388.2 ft. from Cor. No. 4.
1471.4	To Cor. No. 2. A pine post, 4 ft. long, 4 ins. sq., set 18 ins. in the ground, in mound of stone, scribed ii-2618-MF3, whence A syenite boulder, projecting 12 by 15 by 4 ins. above the ground, chiseled BRX ii-2618-MF3, bears N. 13° 43' W., 30.7 ft.
	----- Thence N. 28° 23' W. Mag. Var. 13° 20' E.
183.5	To the West end center of the location, a pine post, 4 ft. long, 4 ins. sq., in mound of stone.
420.28	Intersect the south boundary of Sec. 12 at N. 89° 16' W., 1388.2 ft. from the S.E. Cor. and S. 89° 16' E., 3850.8 ft from the SW. Cor. of said Sec.
421.1	Intersect line 3-4 of the Hechtman lode of this survey at S. 58° 13' W., 240.4 ft. from Cor. No. 4.
445.3	To Cor. No. 3. A pine post, 4 ft. long, 4 ins. sq., set 18 ins. in the ground, in mound of stone, scribed iii-MF3-2618, whence A quartzite boulder, projecting 2 by 3 by 3 ft. above the ground, chiseled BRX iii-MF3 ii-LA 2618, bears S. 37° 11' W., 13.4 ft.
	----- Thence N. 50° 22' E. Mag. Var. 13° 30' E.
1471.4	To Cor. No. 4. Identical with Cor. No. 2. Mineral Farm No. 2 lode, of this survey, which I scribe iv-MF3 on the south face, in addition to the marks heretofore scribed thereon.
	----- Thence S. 28° 23' E. Mag. Var. 13° 45' E.
261.8	To the East end center of the location, a pine post, 4 ft. long, 4 ins. sq., in mound of stone.
445.3	To Cor. No. 1. the place of beginning.
	-----



- MINERAL FARM NO. 1. LODE - CONTINUED.
- FEET.  
248.3 Intersect the ledge.  
258.3 To the West end center of the location, a pine post,  
4 ft. long, 4 ins. sq., in mound of stone.  
598.3 To Cor. No. 1, the place of beginning.
- 
- MINERAL FARM NO. 2. LODE.
- Beginning at Cor. No. 1.  
A pine post, 4 ft. long, 4 ins. sq., set 18 ins. in  
the ground, in mound of stone, scribed i-MF2-2618,  
whence  
The SE. Cor. of Sec. 12, T. 1N., R. 15 E., G. & S. R.  
S.M. bears S. 5° 23' E., 589.2 ft.; a quartzite boulder,  
projecting 1½ by 4 by 2 ft. above the ground, chiseled  
BRX i-MF2 i-MF3 2618, bears S. 50° 22' W., 46.2 ft.; a  
quartzite boulder, projecting 30 by 40 by 12 ins. above  
the ground, chiseled BRX i-MF2 i-MF3 2618, bears N. 71°  
52' W., 21.5 ft.; a quartzite boulder, projecting 2 by 2 by  
1 ft. above the ground, chiseled BRX i-MF2 i-MF3 2618,  
bears N. 28° 23' W. 26.8 ft.
- 
- Thence N. 28° 23' W.  
Var. 13° 50' E.
- 105.3 To the West end center of the location, a pine post.  
4 ft. long, 4 ins. sq., in mound of stone.  
445.3 To Cor. No. 2.  
A pine post, 4 ft. long, 4 ins. sq., set 18 ins. in the  
ground, in mound of stone, scribed ii-MF2-2618,  
whence  
A quartzite boulder, projecting 2 by 2 by 1 ft. above  
the ground, chiseled BRX ii-MF2 iv-MF3 i-LA iii-MF5  
2618, bears N. 28° 23' W., 8 ft.
- 
- Thence N. 30° 29' E.  
Var. 13° 45' E.
356. Big Johnnie Gulch, Course South  
529.5 Intersect the east boundary of Sec. 12 at S. 00° 04' W.,  
1204.2 ft. from the E. ¼ Cor. and N. 00° 04' E.; 1434.2  
ft from the SE. Cor. of said Sec.  
1206.9 Wagon road, course North and South.  
1406.9 To Cor. No. 3.  
Identical with Cor. No. 1, Mineral Farm No. 1. Lode, of  
this survey, which I scribed iii-MF2 on the south  
face, in addition to the marks heretofore scribed  
thereon.
- 
- Thence S. 28° 23' E.  
Var. 13° 10' E.
- 340 To the East end center of the location, a pine post, 4  
ft. long, 4 ins. sq., in mound of stone.  
598.3 To Cor. No. 4.  
On line I-2 Mineral Farm lode, of this survey.  
Identical with Cor. No. 6; Mineral Farm No. 1 lode of  
this survey, which I scribe iv-MF2 on the west face,  
in addition to the marks heretofore scribed thereon.
- 
- Thence S. 30° 14' W.  
Var. 13° 00' E.
- 696.9 To Cor. No. 2. Breach lode, of this survey.  
717.65 To Cor. No. 1. Mineral Farm lode, of this survey  
954.5 To Cor. No. 5.  
A pine post, 4 ft. long, 4 ins. sq., set 18 ins. in the  
ground, in mound of stone, scribed v-2618-MF2,  
whence  
A quartzite boulder, projecting 18 by 30 by 12 ins. above  
the ground, chiseled BRX v-MF2 i-B 2618, bears N. 89°  
23' E., 32.9 ft.



**MISSING**

**PAGE(S)**



FEET	MINERAL FARM NO. 4. LODE.
	Beginning at Cor. No. I. On line 4-I of the Big Iron No. I lode of this survey, A pine post, 4 ft. long, 4 ins. sq., set 18 ins. in the ground, in mound of stone, scribed i-2618-MF4, whence The E. $\frac{1}{2}$ Cor. of Sec 12, T.1 N., R. 15 E. G. & S.R. B.M., bears S. $63^{\circ}17'W.$ , 177.7 ft.; a syenite boulder, projecting 8 by 15 by 6 ins. above the ground, chiseled BRX i-MF4 i-MF5 2618, bears S. $47^{\circ}04'E.$ , 47.7 ft.
	Thence N. $30^{\circ}29'E.$ Var. $13^{\circ}10'E.$
490 729.4	North fork of road, course NW and S.E. To Cor. No. 2. A pine post 4 ft. long, 4 ins. sq., set 18 ins. in the ground, in mound of stone, scribed ii-2618-MF4, whence An iron boulder, projecting 2 by 4 by 2 ft. above the ground, chiseled BRX ii-MF4 iv-BII. 1-BI2 2618, bears S. $79^{\circ}29'W.$ , 45.8 ft.
	Thence N. $47^{\circ}49'E.$ Var. $13^{\circ}00'E.$
746.2	To Cor. No. 3. On line 4-I of the Big Iron No. 2 lode of this survey, A quartzite rock, projecting 2 by 4 by $1\frac{1}{2}$ ft. above the ground, chiseled iii-2618-MF4, with $\frac{1}{2}$ inch iron pin, 3 ins. long, set 2 ins. deep in drill hole at exact corner point, whence A quartzite rock, projecting 12 by 18 by 10 ins. above the ground, chiseled BRX iii-2618-MF4, bears N. $00^{\circ}14'W.$ , 20 ft.
	Thence S. $28^{\circ}23'E.$ Var. $13^{\circ}15'E.$
298 300	South fork of the road, course NE. and SW. To the East end center of the location, a pine post, 4 ft. long, 4 ins. sq., in mound of stone.
308.4 592.4	Intersect the ledge. To Cor. No. 4. Identical with Cor. No. 3. of the Mineral Farm No. I lode of this survey, which I scribe iv-MF4 on the west face, in addition to the marks heretofore scribed thereon.
	Thence S. $47^{\circ}51'W.$ Var. $14^{\circ}00'E.$
734.6	To Cor. No. 5. Identical with Cor. No. 2 of the Mineral Farm No. I lode of this survey, which I scribe v-MF4 on the north face, in addition to the marks heretofore scribed thereon.
	Thence S. $30^{\circ}11'W.$ Var. $13^{\circ}00'E.$
744.7	To Cor. No. 6. Identical with Cor. No. I. of the Mineral Farm No. I and Cor. No. 3 of the Mineral Farm No. 2 lodes of this survey, which I scribe vi-MF4 on the north face, in addition to the marks heretofore scribed thereon.
	Thence N. $28^{\circ}23'W.$ Var. $13^{\circ}10'E.$
100 260	South fork of road, course NE. and SW. North fork of road, course North and South.



( 6-26I8)

FEET.	MINERAL FARM NO. 4 LODGE- continued.
300	To the West end center of the location, a pine post, 4 ft. long, 4 ins. sq., in mound of stone.
340	Intersect the ledge.
600	To Cor. No. I, the place of beginning.
-----	
MINERAL FARM NO. 5. LODGE.	
Beginning at Cor. No. I.	
Identical with Cor. No. I, Mineral Farm No. 4. lode, of this survey, which I scribe i-MF5 on the south face, in addition to the marks heretofore scribed thereon, whence	
The E. $\frac{1}{4}$ Cor. Sec. I2, T. I N., R. I5 E. G. & S. R. 8 & M., bears S. 63° 17' W., 177.7 ft.	
-----	
Thence S. 28° 23' E. Mag. Var. 13° 10' E.	
300	To the East end center of the location, a pine post, 4 ft. long, 4 ins. sq., in mound of stone.
340	The north fork of the road. Course N. and S.
500	The south fork of the road. Course NE. and SW.
600	To Cor. No. 2.
Identical with Cor. No. I. of the Mineral Farm No. I, Cor. No. 3, Mineral Farm No. 2. and Cor. No. 6., Mineral Farm No. 4., lodes of this survey, which I scribe ii-MF5 on the west face, in addition to the marks heretofore scribed thereon.	
-----	
Thence S. 30° 29' W. Mag. Var. 13° 10' E.	
200	Road. Course North and South.
877.4	Intersect the east boundary of Sec. I2 at S. 00° 04' W., 1204.2 ft. from the E. $\frac{1}{4}$ Cor. and N. 00° 04' E., 1434.2 ft. from the SE. Cor. of said Sec.
1050	Big Johnnie Gulch. Course South
1406.9	To Cor. No. 3.
Identical with Cor. No. 2. of the Mineral Farm No. 2 and Cor. No. 4 of the Mineral Farm No. 3 lodes, of this survey, which I scribe iii-MF5 on the north face, in addition to the marks heretofore scribed thereon.	
-----	
Thence N. 28° 23' W. Mag. Var. 13° 45' E.	
300	To the West end center of the location, a pine post, 4 ft. long, 4 ins. sq., in mound of stone.
600	To Cor. No. 4.
A pine post, 4 ft. long, 4 ins. sq., set 18 ins. in the ground, in mound of stone, scribed iv-26I8-MF5, whence	
A syenite boulder, projecting 2 by 3 by 3 ft. above the ground, chiseled BRX iv-MF5 iv-LA ii BB 26I8, bears S. 33° 29' W., 20.3 ft.	
-----	
Thence N. 30° 29' E. Mag. Var. 13° 40' E.	
640	Big Johnnie Gulch. Course South.
707.5	To Cor. Nos. I-I, Big Bluff and Big Iron No. I lodes, of this survey.
1093.6	Intersect the east boundary of Sec. I2 at S. 00° 04' W., 190.1 ft. from the E. $\frac{1}{4}$ Cor. N. 00° 04' E., 2448.3 ft. from the S.E. Cor. of said Sec.
1406.9	To Cor. No. I, the place of beginning.
-----	
IRON HIVE LODGE.	
Beginning at Cor. No. I.	
A pine post, 4 ft. long, 4 ins. sq., set 18 ins. in the ground, in mound of stone, scribed i-26I8-IH, whence	
The NE. Cor. of Sec. I2, T. I N., R. I5 E., G. & S. R.	



FEET

## IRON HIVE LODE - continued

BRM., bears N.  $19^{\circ}56'$  E., 335.2 ft.; a syenite boulder, projecting 2 by 2 by 1 ft. above the ground, chiseled BRX i-IH i-VC i-IH2 2618, bears S.  $14^{\circ}38'$  E., 33 ft.

Thence S.  $29^{\circ}11'$  W.

Var.  $14^{\circ}30'$  E.

240  
I464.8

Big Johnnie Gulch, course South.

To Cor. No. 2.

A pine post, 4 ft. long, 4 ins. sq., set 18 ins. in the ground, in mound of stone, scribed ii-IH-2618,

whence

A quartzite boulder, projecting 5 by 6 by 2 ft. above the ground, chiseled BRX ii-IH iv-IH2 2618, bears N.  $26^{\circ}32'$  W., 57.6 ft.

Thence N.  $54^{\circ}38'$  W.

Var.  $13^{\circ}30'$  E.

300

intersect the presumed course of ledge at N.  $29^{\circ}11'$  E., 1 ft. from the West end center of the location, a pine post 4 ft. long, 4 ins. sq., in mound of stone.

305.5

To Cor. No. 3.

A pine post, 4 ft. long, 4 ins. sq., set 18 ins. in the ground, in mound of stone, scribed iii-2618-IH,

whence

A quartzite boulder, projecting 4 by 4 by 2 ft. above the ground, chiseled BRX iii-2618-IH, bears N.  $54^{\circ}38'$  W., 12 ft.

Thence N.  $50^{\circ}03'$  W.

Var.  $14^{\circ}00'$  E.

295.8

To Cor. No. 4.

A pine post, 4 ft. long, 4 ins. sq., set 18 ins. in the ground, in mound of stone, scribed iv-2618-IH,

whence

A quartzite boulder, projecting 4 by 3 by 2 ft. above the ground, chiseled BRX iv-2618-IH, bears N.  $22^{\circ}34'$  W. 30.1 ft.

Thence N.  $29^{\circ}12'$  E.

Var.  $14^{\circ}50'$  E.

I403.3

intersect the north boundary of Sec. 12 at S.  $89^{\circ}51'$  W., 620.7 ft. from the NE. Cor. N.  $89^{\circ}51'$  E., 2024.8 ft. from the N  $\frac{1}{4}$  Cor. of said Sec.

I441

To Cor. No. 5.

A pine post, 4 ft. long, 4 ins. sq., set 18 ins. in the ground in mound of stone, scribed v-2618-IH, whence

A syenite boulder, projecting 35 by 16 by 12 ins. above the ground, chiseled BRX v-IH iivC 2618, bears S.  $42^{\circ}02'$  E., 29.7 ft.

Thence S.  $54^{\circ}38'$  E.

Var.  $14^{\circ}30'$  E.

56.5

intersect the north boundary of Sec. 12 at S.  $89^{\circ}51'$  W., 556.2 ft. from the NE. Cor. and N  $89^{\circ}51'$  E., 2089.3 ft. from the N  $\frac{1}{4}$  Cor. of said Sec.

297.2

To the East end center of the location, a pine post, 4 ft. long, 4 ins. sq., in mound of stone.

517

Big Johnnie Gulch, course south.

597.2

To Cor. No. I, the place of beginning.

## IRON HIVE NO.2 LODE.

Beginning at Cor. No. I.

Identical with Cor. No. I. Iron Hive lode, of this survey, which I scribe i-IH2 on the south face, in addition to the marks heretofore scribed thereon, whence



( 8-2618)

FEET.

## IRON HIVE NO. 2 LODGE - continued.

The NE. Cor. Sec. 12 T. 1 N., R 15, E. G. & S.R. B7M,  
bears N. 19° 56' E., 335.2 ft.

Thence S. 39° 34' E.  
Var. 14° 30' E.

- 179.4 Intersect the east boundary of Sec. 12 at South 453.4  
ft. from the NE. Cor., North 2199.3 ft. from the  
E  $\frac{1}{4}$  Cor. of said Sec.  
300 To the East end center of the location, a pine post, 4 ft  
long, 4 ins. sq., in mound of stone.  
571.5 To Cor. No. 2.  
A pine post, 4 ft. long, 4 ins. sq., set 18 ins. in the  
ground, in mound of stone, scribed 11-IH2-2618,  
whence  
A syenite boulder, projecting 1 by 2 by 1 ft. above the  
ground, chiseled, BRX 11-IH2 2618, bears S. 82° 40' E.,  
14.8 ft.

Thence S. 29° 11' W.  
Var. 14° 30' E.

- 57.7 To Cor. No. 3, Big Iron No. 4 lode, of this survey.  
512.3 Intersect the east boundary of Sec. 12 at South 1202.9  
ft. from the NE. Cor. and 1449.8 ft. from the E  $\frac{1}{4}$  Cor.  
740 Big Johnnie Gulch. Course Southeast.  
793 To Cors. Nos. 2-5, Big Iron No. 4. and Big Iron No. 3  
lodes of this survey.  
1464.8 To Cor. No. 3.  
A pine post, 4 ft. long, 4 ins. sq., set 18 ins. in the  
ground, in mound of stone, scribed 111-IH2-2618,  
No bearings available.

Thence N. 39° 34' W.  
Var. 12° 55' E.

- 271.5 To West end center of the location, a pine post, 4 ft.  
long, 4 ins. sq., in mound of stone.  
571.5 To Cor. No. 4.  
Identical with Cor. No. 2, Iron Hive lode, of this  
survey, which I scribe 1v-IH2 on the east face, in  
addition to the marks heretofore scribed thereon.

Thence N. 29° 11' E.  
Var. 13° 30' E.

- 1224.8 Big Johnnie Gulch, course South.  
1464.8 To Cor. No. 1, the place of beginning.

## MOONLIGHT BODE

Beginning at Cor. No. 1.  
Identical with Cor. No. 2, Mineral Farm and Cor. No.  
5 Mineral Farm No. 1 lodes, of this survey, which I  
scribe 1-M on the east face, in addition to the marks  
heretofore scribed thereon, whence  
The E.  $\frac{1}{4}$  Cor. of Sec 12, T. 1 N., R. 15 E., G. & S.R.  
B7M, bears N. 73° 19' W., 1152 ft.

Thence N. 47° 53' E.  
Var. 13° 50' E.

- 734.2 To Cors. Nos. 4-5, Mineral Farm No. 1 and New Orleans  
lodes, of this survey.  
1426 To Cor. No. 2.  
A pine post, 4 ft. long, 4 ins. sq., set 18 ins. in the  
ground, in mound of stone, scribed 11-M-2618, whence  
A quartzite boulder, projecting 8 by 12 by 8 ins. above  
the ground, chiseled BRX 11-M 1v-No 2618, bears  
S. 36° 59' W., 22.5 ft.



FEET	MOONLIGHT LODE- continued.
	----- Thence S. 53° 31' E. Mag. Var. 14° 00' E.
267.4	To the East end center of the location, a pine post, 4 ft. long, 4 ins. sq., in mound of stone.
567.4	To Cor. No. 3. A pine post, 4 ft. long, 4 ins. sq., set 18 ins. in the ground, in mound of stone, scribed iii-2618-M, whence A quartzite boulder, projecting 12 by 16 by 10 ins. above the ground, chiseled BRX iii-2618-M, bears N. 46° 39' W., 149.8 ft.
	----- Thence S. 47° 53' W. Mag. Var. 13° 45' E.
268.4 1426	To Cor. No. 5; Surv. No. 842, Yuma lode. To Cor. No. 4. On line 5-6, Surv. No. 842, Yuma lode. Identical with Cor. No. 3; Mineral Farm lode, of this survey, which I scribe iv-M on the north face, in addition to the marks heretofore scribed thereon.
	----- Thence N. 53° 31' W. Mag. Var. 13° 30' E.
300	To the West end center of the location, a pine post, 4 ft. long, 4 ins. sq., in mound of stone.
567.4	To Cor. No. I, the place of beginning.
	-----
	BIG IRON NO. I. LODE.
	Beginning at Cor. No. I. On line 4-I, Mineral Farm No. 5 lode, of this survey. A pine post, 4 ft. long, 4 ins. sq., set 18 ins. in the ground, in mound of stone, scribed i-BII-2618, whence The E. $\frac{1}{4}$ Cor. of Sec 12, T.1 N., R. 15 E., G. & S.R. B.M., bears N. 20° 33' E., 558.3 ft.; a syenite boulder projecting 18 by 24 by 12 ins. above the ground, chiseled, BRX i-BII i-BB 2618, bears N. 16° 02' E., 23.5 ft.
	----- Thence N. 12° 47' W. Mag. Var. 13° 30' E.
1050 285.9	Big Johnnie Gulch, course South. To the West end center of the location, a pine post, 4 ft. long, 4 ins. sq., in mound of stone.
595:9	To Cor. No. 2. On line I-2, Big Iron No. 3 lode, of this survey. A pine post, 4 ft. long, 4 ins. sq., set 18 ins. in the ground, in mound of stone, scribed ii-BII-2618, whence A syenite boulder, projecting 12 by 18 by 6 ins. above the ground, chiseled BRX ii-BII vi-BB 2618, bears S. 21° 11' W., 13 ft.
	----- Thence N. 30° 29' E. Mag. Var. 13° 00' E.
646.3	Intersect the east boundary of Sec 12. at North 615.35 ft. from the E. $\frac{1}{4}$ Cor., and south 2037.35 ft. from the NE. Cor. of said Sec.
685	To Cor. Nos. I-I Big Iron No. 3 and Big Iron No. 4 lodes of this survey.
738.8 1428.8	Big Johnnie Gulch, course South. To Cor. No. 3.

B-11



( IO-26I8)

FEET.

## BIG IRON NO. I. LODE, - continued.

- A pine post, 4 ft. long, 4 ins. sq., set 18 ins. in the ground, in mound of stone, scribed iii-BII-26I8.  
No bearings available.
- Thence S.  $12^{\circ}47'$  E.  
Mag. Var.  $13^{\circ}00'$  E.
- 310 To the East end center of the location, a pine post, 4 ft. long, 4 ins. sq., in mound of stone.
- 595.9 To Cor. No. 4.  
Identical with Cor. No. 2, Mineral Farm No. 4 lode, of this survey, which I scribe iv-BII on the west face, in addition to the marks heretofore scribed thereon.
- Thence S.  $30^{\circ}29'$  W.  
Mag. Var.  $13^{\circ}00'$  E.
- 239.4 North fork of road, Course NW. and SE.
- 729.4 To Cors. Nos. I-I, Mineral Farm No. 4 and Mineral Farm No. 5 lodes, of this survey.
- I042.7 Intersect the east boundary of Sec. I2 at S.  $00^{\circ}04'$  W., 190.1 ft. from the E.  $\frac{1}{4}$  Cor. and N.  $00^{\circ}04'$  E., 2448.3 ft. from the S.E. Cor. of said Sec.
- I428.8 To Cor. No. I, the place of beginning.

## BIG IRON NO. 2 LODE.

- Beginning at Cor. No. I.  
Identical with Cor. No. 2, Mineral Farm No. 4, and Cor. No. 4, Big Iron No. I lodes, of this survey, which I scribe i-BI2 on the north face, in addition to the marks heretofore scribed thereon, whence  
The E.  $\frac{1}{4}$  Cor. of Sec I2, T.IN., R.15 E., G. & S.R. B7M., bears S.  $36^{\circ}44'$  W., 884.1 ft.
- Thence N.  $12^{\circ}47'$  W.  
Mag. Var.  $13^{\circ}00'$  E.
- 285.9 To the West end center of the location, a pine post, 4 ft long, 4 ins. sq., in mound of stone.
- 595.9 To Cor. No. 2.  
Identical with Cor. No. 3, Big Iron No. I lode, of this survey, which I scribe ii-BI2 on the east face, in addition to the marks heretofore scribed thereon.
- Thence N.  $47^{\circ}49'$  E.  
Mag. Var.  $13^{\circ}00'$  E.
- 745.4 To Cor. No. 5, Big Iron No. 4 lode, of this survey.
- I493.5 To Cor. No. 3.  
A pine post, 4 ft. long, 4 ins. sq., set 18 ins. in the ground, in mound of stone, scribed iii-26I8-BI2, whence  
A quartzite boulder, projecting 9 by 18 by 10 ins. above the ground, chiseled BRX iii-26I8-BI2, bears N.  $21^{\circ}41'$  W., 14 ft.
- Thence S.  $12^{\circ}47'$  E.  
Mag. Var.  $13^{\circ}25'$  E.
- 310 To the East end center of the location, a pine post, 4 ft. long, 4 ins. sq., in mound of stone.
- 595.9 To Cor. No. 4.  
A pine post, 4 ft. long, 4 ins. sq., set 18 ins. in the ground, in mound of stone, scribed iv-26I8-BI2.  
No bearings available.



FREEP

## BIG IRON NO. 2 LODE, --, continued.

Thence S.  $47^{\circ}49'$  W.  
 Var.  $13^{\circ}00'$  E.

747.3 To Cor. No. 5. Mineral Farm No. 4 lode, of this survey.  
 1493.5 To Cor. No. 1, the place of beginning.

## BIG IRON NO. 3 LODE.

Beginning at Cor. No. 1.

On line 2-3, Big Iron No. 1 lode, this survey.

A pine post, 4 ft. long, 4 ins. sq., set 18 ins. in the ground, in mound of stone, scribed i-2618-BI3, whence,

The E.  $\frac{1}{4}$  Cor. of Sec. 12, T. 1 N., R. 15 E., G. & S. R. B. M., bears South  $1^{\circ}44'$  W., 649 ft.; a syenite boulder, projecting 2 by 3 by 2 ft. above the ground, chiseled BRX i-BI3 i-BI4 2618, bears N.  $36^{\circ}32'$  E., 43.3 ft.

Thence S.  $30^{\circ}29'$  W.  
 Var.  $12^{\circ}20'$  E.

38.7 Intersect the east boundary of Sec. 12 at North 615.35 ft. from the E.  $\frac{1}{4}$  Cor., and South 2037.35 ft. from the NE. Cor. of said Sec.  
 685 To Cor. No. 2, Big Iron No. 1 lode, of this survey.  
 1367.3 To Cor. No. 2.  
 A pine post, 4 ft. long, 4 ins. sq., set 18 ins. in the ground, in mound of stone, scribed ii-2618-BI3, whence  
 A syenite boulder, projecting 18 by 18 by 6 ins. above the ground, chiseled BRX ii-BI3 v-BB i-BI5 2618, bears S.  $2^{\circ}04'$  W., 49.8 ft.

Thence N.  $15^{\circ}43'$  W.  
 Var.  $13^{\circ}30'$  E.

300 To the West end center of the location; a pine post, 4 ft. long, 4 ins. sq., in mound of stone:  
 588.8 To Cor. No. 3.  
 A pine post, 4 ft. long, 4 ins. sq., set 18 ins. in the ground, in mound of stone, scribed iii-BI3-2618, whence  
 An iron boulder, projecting 4 by 6 by 6 ft. above the ground, chiseled BRX iv-BI5 iii-BI3 2618, bears N.  $35^{\circ}19'$  E., 12.5 ft.

Thence N.  $32^{\circ}24'$  E.  
 Var.  $13^{\circ}00'$  E.

689 To Cor. No. 4.  
 Identical with Cor. No. 3, Iron Hive No. 2 lode, of this survey, which I scribe iv-BI3 on the south face, in addition to the marks heretofore scribed thereon.

Thence N.  $29^{\circ}11'$  E.  
 Var.  $12^{\circ}55'$  E.

671.8 To Cor. No. 5.  
 On line 2-3, Iron Hive No. 2 lode, this survey.  
 A pine post, 4 ft. long, 4 ins. sq., set 18 ins. in the ground, in mound of stone, scribed v-2618-BI3, whence  
 A syenite boulder, projecting 2 by  $1\frac{1}{2}$  by 1 ft. above the ground, chiseled BRX v-BI3 ii-BI4 2618, bears N.  $47^{\circ}02'$  W., 14.7 ft.



( I2-26I8)

FEET

## BIG IRON NO. 3 LODE,--continued.

- Thence S.  $15^{\circ}43'$  E.  
Mag. Var.  $12^{\circ}10'$  E.
- 277.7 To East end center of location, a pine post, 4 ft. long, 4 ins. sq., in mound of stone.
- 505.23 Intersect the east boundary of Sec. I2 at North 718.45 ft. from the E.  $\frac{1}{4}$  Cor. and South 1934.25 ft. from the NE. Cor. of said Sec.
- 577.7 To Cor. No. I, the place of beginning.

## BIG IRON NO. 4 LODE.

Beginning at Cor. No. I.  
Identical with Cor. No. I. of the Big Iron No. 3 lode of this survey, which I scribe i-BI4 on the north face, in addition to the marks heretofore scribed thereon, whence  
The E.  $\frac{1}{4}$  Cor. Sec. I2 T. I N., R I5 E., G. & S. R. B & M., bears S.  $1^{\circ}44'$  W., 649 ft.

- Thence N.  $15^{\circ}43'$  W.  
Mag. Var.  $12^{\circ}20'$  E.
- 72.47 Intersect the east boundary of Sec. I2 at North 718.45 ft. from the E.  $\frac{1}{4}$  Cor., and South 1934.25 ft. from the NE. Cor. of said Sec.
- 300 To the West end center of the location, a pine post, 4 ft. long, 4 ins. sq., in mound of stone.
- 366.75 Intersect the presumed course of ledge.
- 577.7 To Cor. No. 2.  
Identical with Cor. No. 5, Big Iron No. 3 lode, of this survey, which I scribe ii-BI4 on the east face, in addition to the marks heretofore scribed thereon.

B&amp;W

- Thence N.  $29^{\circ}11'$  E.  
Mag. Var.  $12^{\circ}10'$  E.
- 53 Intersect Big Johnnie Gulch, course south east.
- 280.7 Intersect the east boundary of Sec. I2 at South 1202.9 ft. from the NE. Cor., and North 1449.8 ft. from the E.  $\frac{1}{4}$  Cor. of said Sec.
- 735.3 To Cor. No. 3.  
On line 2-3, Iron Hive No. 2 lode, this survey.  
A pine post, 4 ft long, 4 ins. sq., set 18 ins. in the ground, in mound of stone, scribed iii-BI4-26I8, whence  
A syenite boulder projecting 20 by 24 by 20 ins. above the ground, bears S.  $29^{\circ}11'$  W., 1.5 ft. A Cor. of the location bears N.  $29^{\circ}11'$  E. . 57.7 ft.

- Thence N.  $47^{\circ}38'$  E.  
Mag. Var.  $14^{\circ}30'$  E.
- 766.7 To Cor. No. 4.  
A pine post, 4 ft. long, 4 ins. sq., set 18 ins. in the ground, in mound of stone, scribed iv- 26I8-BI4, whence  
A quartzite boulder, projecting 14 by 15 by 10 ins. above the ground, chiseled BRX iv-26I8-BI4, bears S.  $4^{\circ}12'$  W., 28.7 ft.

- Thence S.  $15^{\circ}43'$  E.  
Mag. Var.  $14^{\circ}00'$  E.
- 228.55 Intersect the ledge.
- 287.3 To the East end center of the location, a pine post, 4 ft. long, 4 ins. sq., in mound of stone.
- 595.3 To Cor. No. 5.



FEET.

BIG IRON NO. 4 LODE, - continued.

On line 2-3 of the Big Iron No. 2 lode of this survey.  
A pine post, 4 ft. long, 4 ins. sq., set 18 ins. in the ground, in mound of stone, scribed V-26I8-BI4, whence

A quartzite boulder, projecting 12 by 18 by 12 ins. above the ground, chiseled BRX v-26I8-BI4, bears N. 41° 37' W., 14.4 ft.

-----  
Thence S. 47° 49' W.  
Var. 14° 15' E.

745.4

To Cor. No. 6.  
Identical with Cor. No. 3, Big Iron No. I, and Cor. No. 2, Big Iron No. 2 lodes of this survey, which I scribe vi-BI4 on the north face, in addition to the marks heretofore scribed thereon.

-----  
Thence S. 30° 29' W.  
Var. 13° 00' E.

690 Big Johnnie Gulch, course south.  
743.8 To Cor. No. I, the place of beginning .

-----  
BREACH LODE.

Beginning at Cor. No. I.  
Identical with Cor. No. 5, Mineral Farm No. 2 lode, of this survey, which I scribe i-B on the east face, in addition to the marks heretofore scribed thereon, whence  
The S.E. Cor. of Sec 12, T. 1N., R. 15 E., G. & S.R. B.M. bears S. 16° 36' W., 875.9 ft.

-----  
Thence N. 30° 14' E.  
Var. 12° 50' E.

236.85 To Cor. No. I, Mineral Farm lode, of this survey.  
257.6 To Cor. No. 2.

On line I-2, Mineral Farm lode, of this survey.  
A pine post, 4 ft. long, 4 ins. sq., set 18 ins. in the ground, in mound of stone, scribed ii-26I8-B, whence  
A syenite boulder, projecting 12 by 20 by 20 ins. above the ground, chiseled BRX ii-26I8-B, bears S. 46° 00' E., 15 ft.

-----  
Thence S. 51° 32' E.  
Var. 12° 50' E.

301.6 To the East end center of the location, a pine post, 4 ft. long, 4 ins. sq., in mound of stone.

595.1 To Cor. No. 3.  
Identical with Cor. No. 6, Mineral Farm lode, of this survey, which I scribe iii-B on the west face, in addition to the marks heretofore scribed thereon.  
This Cor. is S. 53° 31' E., 592.1 ft. from Cor. No. 1, Mineral Farm lode.

-----  
Thence S. 30° 00' W.  
Var. 13° 30' E.

257.9 To Cor. No. 4  
Identical with Cor. No. 6, Surv. No. 433, O'Dougherty lode, Cor. No. 6, Surv. No. 434, Big Johnnie lode.  
A pine post, 4 ft. long, 4 ins. sq., set 18 ins. in the ground, in mound of stone, scribed iv-26I8-B, whence  
A quartzite boulder, projecting 6 by 6 by 2 ft. above the ground, chiseled BRX iv-26I8-B, bears N. 7° 40' W., 4 ft.

-----  
Thence E. 51° 32' W.  
Var. 13° 30' E.



( I4-2618 )

FEET.

BREACH LODE.-- continued.

- 294.1 To the West end center of the location.  
595.7 To Cor. No. I, the place of beginning.

## HECHTMAN LODE.

Beginning at Cor. No. I.

A pine post, 4 ft. long, 4 ins. sq., set 18 ins. in the ground, in mound of stone, scribed i-2618-H, whence The SE. Cor. of Sec. 12, T. 15 N., R. 15 E., G. & S. R. B. & M., bears N.  $73^{\circ}04'$  E., 759.3 ft.; a quartzite boulder, projecting 3 by 4 by 2 ft. above the ground, chiseled BRX i-H i-G 2618, bears S.  $4^{\circ}50'$  W., 38 ft.; Black Peak bears N.  $79^{\circ}05'$  E.; Cor. No. 2, Mineral Farm No. 3 lode, of this survey, bears S.  $74^{\circ}11'$  W., 480 ft.

Thence S.  $58^{\circ}18'$  W.  
Var.  $13^{\circ}00'$  E.

- 1005.5 To Cor. No. 2.  
Identical with Cor. No. I, Surv. No. 2324, Eastern Star lode, and Cor. No. 5, Sur. No. 2300, Garrett lode.  
A pine post, 4 ft. long, 4 ins. sq., set 18 ins. in the ground, in mound of stone, which I scribe ii-2618-H on the north face, in addition to the marks heretofore scribed thereon, whence  
A quartzite boulder, projecting 20 by 20 by 8 ins. above the ground, chiseled BRX ii-H iv-G 2618, bears, N.  $27^{\circ}32'$  E., 18.3 ft.
- Thence N.  $51^{\circ}49'$  W.  
Var.  $13^{\circ}10'$  E.
- 300 To the West end center of the location, a pine post, 4 ft. long, 4 ins. sq., in mound of stone.
- 561.8 To Cor. Nos. 4-I, Eastern Star and Silver Star lodes, Sur. No. 2324.
- 584.7 To Cor. No. 3.  
On line 4-I, Silver Star lode, Sur. No. 2324.  
A pine post 4 ft. long, 4 ins. sq., set 18 ins. in the ground, in mound of stone, scribed iii-2618-H, whence  
A quartzite boulder, projecting 25 by 30 by 24 ins. above the ground, chiseled BRX iii-2618-H, bears N.  $34^{\circ}03'$  E., 52.5 ft.
- Thence N.  $58^{\circ}13'$  E.  
Var.  $13^{\circ}10'$  E.
- 763.27 Intersect the south boundary of Sec. 12 at N.  $89^{\circ}16'$  W., 1389.72 ft. from the SE. Cor. and S.  $89^{\circ}16'$  E., 3849.28 ft. from the SW. Cor. of said Sec.
- 764.6 Intersect line 2-3, Mineral Farm No. 3 lode, of this survey at N.  $28^{\circ}23'$  W., 421.1 ft. from Cor. No. 2.
- 1005 To Cor. No. 4.  
A pine post, 4 ft. long, 4 ins. sq., set 18 ins. in the ground, in mound of stone, scribed iv-2618-H, whence  
A quartzite boulder, projecting 12 by 20 by 10 ins. above the ground, chiseled BRX iv-2618-H, bears N.  $70^{\circ}28'$  E., 7 ft.
- Thence S.  $51^{\circ}19'$  E.  
Var.  $13^{\circ}20'$  E.,
- 211.37 Intersect the south boundary of Sec. 12 at N.  $89^{\circ}16'$  W., 1019.2 ft. from the SE. Cor. and S.  $89^{\circ}16'$  E., 4219.8 ft. from the SW. Cor. of said Sec.
- 286.2 To the East end center of the location, a pine post, 4 ft. long, 4 ins. sq., in mound of stone.
- 388.2 Intersect line 1-2, Mineral Farm No. 3 lode, of this survey at N.  $50^{\circ}22'$  E., 399 ft. from Cor. No. 2.



( I5-26I8)

FEET

## HECHTMAN LODE - continued.

586.2 To Cor. No. I, the place of beginning

## GILL LODE.

Beginning at Cor. No. I.

Identical with Cor. No. I, Hechtman lode, of this survey, which I scribe i-G on the south face, in addition to the marks heretofore scribed thereon, whence

The SE. Cor. Sec. 12.T.I N., R 15,E., G.& S.R. B+M, bears N. 73° 04' E., 759.3 ft.

-----  
Thence S. 51° 30' E.

Mag. Var. 13° 00' E.

295.6 To East end center of the location, a pine post, 4 ft. long, 4 ins. sq., in mound of stone.

355 Big Johnnie Gulch, course south west, and road, course northeast and southwest.

398.4 To Cor. No. 5, Sur. No. 434, Big Johnnie lode.

595.6 To Cor. No. 2.

Identical with Cor. No. I, Sur. No. 2302, Rooster lode.

A pine post, 3 ft. long, 4 ins. sq., set 18 ins. in the ground, in mound of stone, which I scribe ii-26I8-G on the west face, in addition to the marks heretofore scribed thereon, whence

A quartzite boulder, projecting 30 by 40 by 15 ins. above the ground, chiseled BRx ii-26I8-G, bears S. 73° 29' E., 52.3 ft.

-----  
Thence S. 58° 13' W.

Mag. Var. 13° 15' E.

400 Big Johnnie Gulch, course southwest and road, course northeast and southwest.

1005 To Cor. No. 3.

Identical with Cor. No. 6, Sur. No. 2302, Rooster lode, Cor. No. I, Sur. No. 2300, Garrett lode.

A pine post, 4 ins. sq., properly set in mound of stone, which I scribe iii-G-26I8 on the north face, in addition to the marks heretofore scribed thereon.

No bearings available.

-----  
Thence N. 51° 30' W.

Mag. Var. 13° 15' E.

300 To the West end center of the location, a pine post, 4 ft. long, 4 ins. sq., in mound of stone.

597.I To Cor. No. 4.

Identical with Cor. No. 2, Hechtman lode, of this survey, Cor. No. 5, Garrett lode, Sur. No. 2300 and Cor. No. I, Eastern Star lode, Sur. No. 2324, which I scribe iv-G on the east face, in addition to the marks heretofore scribed thereon.

-----  
Thence N. 58° 18' E.

Mag. Var. 13° 10' E.

1005.5 To Cor. No. I, the place of beginning.

## VACY-CONSTANCE LODE.

Beginning at Cor. No. I.

Identical with Cors. Nos. I-I, Iron Hive and Iron Hive No. 2 lodes of this survey, which I scribe i-VC on the north face, in addition to the marks heretofore scribed thereon, whence



( I6-26I8)

FEET

VACY-CONSTANCE LODE--continued.

The NE. Cor. Sec. I2, T. I N., R. I5 E., G. & S.R. ~~G.M.~~  
bears N.  $19^{\circ} 56'$  E., 335.2 ft.

Thence N.  $54^{\circ} 38'$  W.  
Mag. Var.  $14^{\circ} 30'$  E.

- 80.2 Big Johnnie Gulch, course south.  
300 To the West end center of the location, a pine post, 4  
ft. long, 4 ins. sq., in mound of stone.  
540.7 Intersect the north boundary of Sec. I2 at S.  $89^{\circ} 51'$  W.,  
556.2 ft. from the NE. Cor., N.  $89^{\circ} 51'$  E., 2089.3 ft.  
from the N.  $\frac{1}{4}$  Cor. of said Sec.  
597.2 To Cor. No. 2.  
Identical with Cor. No. 5, Iron Hive lode, of this  
survey, which I scribe ii-VC on the east face, in  
addition to the marks heretofore scribed thereon.

Thence N.  $38^{\circ} 44'$  E.  
Mag. Var.  $14^{\circ} 30'$  E.

- 952.3 Intersect the east boundary of Sec. I. at N.  $00^{\circ} 24'$  W.,  
773.5 ft. from the SE. Cor., and S.  $00^{\circ} 24'$  E., 1794.1  
ft. from the E.  $\frac{1}{4}$  Cor. of said Sec.  
I467.4 To Cor. No. 3.  
A pine post, 4 ft. long, 4 ins. sq., set 18 ins. in the  
ground, in mound of stone, scribed iii-26I8-VC, whence  
A quartzite boulder, projecting 2 by 2 by 1 ft. above  
the ground, chiseled BRX iii-26I8-VC, bears S.  $57^{\circ} 11'$   
E., 10.4 ft.

Thence S.  $54^{\circ} 38'$  E.  
Mag. Var.  $13^{\circ} 00'$  E.

- 297.2 To the East end center of the location, a pine post, 4  
ft. long, 4 ins. sq., in mound of stone.  
597.9 To Cor. No. 4.  
A pine post, 4 ft. long, 4 ins. sq., set 18 ins. in the  
ground, in mound of stone, scribed iv-26I8-VC, whence  
A syenite boulder, projecting 15 by 20 by 15 ins. above  
the ground, chiseled BRX iv-26I8-VC, bears N.  $78^{\circ} 19'$   
W., 33.6 ft.

Thence S.  $38^{\circ} 46'$  W.  
Mag. Var.  $12^{\circ} 30'$  E.

- I282.9 Intersect the east boundary of Sec. I2 at South 174.5  
ft. from the NE. Cor. and North 2478.2 ft. from the  
E.  $\frac{1}{4}$  Cor. of said Sec.  
I467.2 To Cor. No. I, the place of beginning.

BIG IRON NO. 5 LODE.

Beginning at Cor. No. I.

Identical with Cor. No. 2, Big Iron No. 3 lode, of this  
survey, which I scribe i-BI5 on the west face, in  
addition to the marks heretofore scribed thereon,  
whence

The E.  $\frac{1}{4}$  Cor. of Sec. I2, T. I N., R. I5 E., G. & S.R. ~~D.M.~~  
bears N.  $51^{\circ} 50'$  E., 857.2 ft.

Thence S.  $47^{\circ} 58'$  W.  
Mag. Var.  $13^{\circ} 30'$  E.

- 758.4 To Cor. No. 4, Big Bluff lode, of this survey.  
I485.3 To Cor. No. 2.  
A pine post, 4 ft. long, 4 ins. sq., set 18 ins. in the  
ground, in mound of stone, scribed ii-26I8-BI5, whence  
A quartzite boulder, projecting 3 by 2 by 2 ft. above the



- FEEET BIG BLUFF LODE-- continued.
- Thence N.  $47^{\circ}58'$  E.  
Var.  $13^{\circ}40'$  E.
- 758.4 To Cor. No. 5 .  
Identical with Cor. No. 2, Big Iron No. 3 and Cor. No. I.  
Big Iron No. 5: lodes of this survey, which I scribe  
v-BB on the south face, in addition to the marks  
heretofore scribed thereon.
- Thence N.  $30^{\circ}29'$  E.  
Var.  $13^{\circ}30'$  E.
- 682.3 To Cor. No. 6.  
On line I-2, Big Iron No. 3 lode, of this survey.  
Identical with Cor. No. 2, Big Iron No. I lode, of this  
survey, which I scribe vi-BB on the south face, in  
addition to the marks heretofore scribed thereon.
- Thence S.  $12^{\circ}47'$  E.  
Var.  $13^{\circ}00'$  E.
- 310 To the East end center of the location, a pine post, 4  
ft. long, 4 ins. sq., in mound of stone.  
375 Intersect the presumed course of the ledge.  
545.4 To the Big Johnnie Gulch, course south.  
595.9 To Cor. No. 1, the place of beginning.

## NEW ORLEANS LODE.

- Beginning at Cor. No. I.  
Identical with Cor. No. 3, Mineral Farm No. I and  
Cor. No. 4, Mineral Farm No. 4 lodes of this survey, which  
I scribe i-NO on the east face, in addition to the  
marks heretofore scribed thereon, whence  
The E.  $\frac{1}{4}$  Cor. of Sec. I2, T. I N., R. I5 E., G. & S. R.  
B. M. bears S.  $63^{\circ}12'$  W., I527. I ft.
- Thence N.  $48^{\circ}22'$  E.  
Var.  $14^{\circ}00'$  E.
- I439.4 To Cor. No. 2.  
A pine post, 4 ft. long, 4 ins. sq., set I8 ins. in the  
ground, in mound of stone, scribed i1-26I8-NO.  
No bearings available.
- Thence S.  $28^{\circ}23'$  E.  
Var.  $14^{\circ}20'$  E.
- 298.8 To the East end center of the location, a pine post, 4  
ft. long, 4 ins. sq., in mound of stone.
592. I To Cor. No. 3.  
A pine post, 4 ft. long, 4 ins. sq., set I8 ins. in the  
ground, in mound of stone, scribed i11-26I8-NO,  
whence,  
A quartzite boulder, projecting I8 by 20 by I5 ins. above  
the ground, chiseled BRx i11-26I8-NO, bears N.  $32^{\circ}38'$   
E. 8. I ft.
- Thence S.  $48^{\circ}20'$  W.  
Var.  $14^{\circ}30'$  E.
- 749.2 To Cor. No. 4.  
Identical with Cor. No. 2, Moonlight lode, of this  
survey, which I scribe iv-NO on the north face, in  
addition to the marks heretofore scribed thereon.
- Thence S.  $47^{\circ}53'$  W.  
Var.  $14^{\circ}00'$  E.
- 69I.8 To Cor. No. 5.  
Identical with Cor. No. 4, Mineral Farm No. I lode, of

100



( I7-26I8

FEET

## BIG IRON NO. 5 LODE - continued.

ground, chiseled BRX ii-26I8-BI5, bears S.  $15^{\circ}43'$  E.,  
7.4 ft.

-----  
Thence N.  $15^{\circ}43'$  W.  
Mag. Var.  $13^{\circ}30'$  E.

- 300 To the West end center of the location, a pine post, 4  
ft. long, 4 ins. sq., in mound of stone.  
588.8 To Cor. No. 3.  
A pine post 4 ft. long, 4 ins. sq., set 18 ins. in the  
ground, in mound of stone, scribed iii-26I8-BI5,  
No bearings available.

-----  
Thence N.  $47^{\circ}58'$  E.  
Mag. Var.  $13^{\circ}30'$  E.

- I485.3 To Cor. No. 4.  
Identical with Cor. No. 3, Big Iron No. 3 lode, of this  
survey, which I scribe iv-BI5 on the south face, in  
addition to the marks heretofore scribed thereon.

-----  
Thence S.  $15^{\circ}43'$  E.  
Mag. Var.  $13^{\circ}00'$  E.

- 288.8 To the East end center of the location, a pine post, 4  
ft. long, 4 ins. sq., in mound of stone.  
588.8 To Cor. No. I, the place of beginning.

## BIG BLUFF LODE.

Beginning at Cor. No. I.  
Identical with Cor. No. I, Big Iron No. I. lode, of this  
survey, which I scribe i-BB on the west face, in addition  
to the marks heretofore scribed thereon, whence  
The E.  $\frac{1}{4}$  Cor. Sec. I2, T. I N., R. I5 E., G. & S. R. B & M,  
bears N.  $20^{\circ}33'$  E., 558.3 ft.

-----  
Thence S.  $30^{\circ}29'$  W.  
Mag. Var.  $13^{\circ}30'$  E.

- 67.5 Big Johnnie Gulch.  
707.5 To Cor. No. 2.  
Identical with Cor. No. 4, Mineral Farm No. 5 lode, of  
this survey, which I scribe ii-BB on the north face,  
in addition to the marks heretofore scribed thereon.

-----  
Thence S.  $50^{\circ}22'$  W.  
Mag. Var.  $13^{\circ}40'$  E.

- 722.5 To Cor. No. 3.  
On line 3-4, Los Angeles lode, of this survey.  
A pine post, 4 ft. long, 4 ins. sq., set 18 ins. in the  
ground, in mound of stone, scribed iii-26I8-BB.  
No bearings available.

-----  
Thence N.  $12^{\circ}47'$  W.  
Mag. Var.  $13^{\circ}30'$  E.

- I94.5 Intersect the presumed course of the ledge.  
259.7 To the West end center of the location, a pine post, 4  
ft. long, 4 ins. sq., in mound of stone.  
569.7 To Cor. No. 4.  
On line I-2, Big Iron No. 5. lode, of this survey.  
A pine post, 4 ft. long, 4 ins. sq., set 18 ins. in the  
ground, in mound of stone, scribed iv-26I8-BB, whence  
A quartzite boulder, projecting 20 by 24 by 18 ins. above  
the ground, chiseled BRX iv-26I8-BB, bears S.  $18^{\circ}24'$   
W.. 17 ft.



FEET

## NEW ORLEANS LODE- continued.

At this survey, which I scribe v-NO on the north face, in addition to the marks heretofore scribed thereon.

-----  
Thence N. 28° 23' W.

Var. 14° 10' E.

- 300 To the West end center of the location, a pine post, 4 ft. long, 4 ins. sq., in mound of stone.  
598.8 To Cor. No. 1, the place of beginning.

## LOS ANGELES LODE.

-----  
Beginning at Cor. No. 1.

Identical with Cor. No. 2, Mineral Farm No. 2, Cor. No. 4, Mineral Farm No. 3, and Cor. No. 3, Mineral Farm No. 5 lodes of this survey, which I scribe i-LA on the west face in addition to the marks heretofore scribed thereon, whence

The SE. Cor. of Sec. 12, T. 1 N., R. 15 E., G. & S. R. B. & M. bears S. 15° 16' E., 1014.1 ft.

-----  
Thence S. 50° 22' W.

Var. 13° 45' E.

- 1471.4 To Cor. No. 2.  
Identical with Cor. No. 3, Mineral Farm No. 3 lode of this survey, which I scribe ii-LA on the north side, in addition to the marks heretofore scribed thereon.

-----  
Thence N. 28° 23' W.

Var. 13° 30' E.

- 300 To the West end center of the location, a pine post, 4 ft. long, 4 ins. sq., in mound of stone.  
600 To Cor. No. 3  
A quartzite rock, projecting 4 by 4 by 5 ft. above the ground, chiseled iii-2618-LA, with  $\frac{3}{4}$  inch drill hole, 3 ins. deep, at exact corner point, whence  
A quartzite boulder, projecting 4 by 4 by 2 ft. above the ground, chiseled BRX iii-2618-LA, bears S. 00° 27' E., 17.3 ft.

-----  
Thence N. 50° 22' E.

Var. 13° 30' E.

- 748.9 To Cor. No. 3, Big Bluff lode, of this survey.  
1471.4 To Cor. No. 4.  
Identical with Cor. No. 4, Mineral Farm No. 5 and Cor. No. 2, Big Bluff lodes of this survey, which I scribe iv-LA on the south face, in addition to the marks heretofore scribed thereon.

-----  
Thence S. 28° 23' E.

Var. 13° 40' E.

- 300 To the East end center of the location, a pine post, 4 ft. long, 4 ins. sq., in mound of stone.  
600 To Cor. No. 1, the place of beginning.

## LODE LINES.

As near as can be determined from present developments the veins of the several locations embraced in this survey extend as follows from their respective discovery points.

Mineral Farm lode, 1267.6 ft., N. 30° 14' E., and 195 ft., S. 30° 14' W.



( 20-2618)

## LODE LINES - continued.

Mineral Farm No. I lode, 100 ft., S. 30° 11' W., and 800 ft. N. 30° 11' E., 598.9 ft. N. 47° 38' E.  
This lode line follows the ledge as it outcrops on the ground.

Mineral Farm No. 2 lode, 54 ft. N. 30° 29' E., and 1352.9 ft. S. 30° 29' W.

Mineral Farm No. 3 lode, 696.4 ft. N. 50° 22' E., and 775 ft. S. 50° 22' W.

Mineral Farm No. 4 lode, 100 ft. S. 30° 02' W., and 457.6 ft. N. 30° 02' E., 900 ft. N. 47° 49' E.

This lode line follows the ledge as it outcrops on the ground.

Mineral Farm No. 5 lode, 36 ft. N. 30° 29' E., and 1370.9 ft. S. 30° 29' W.

Iron Hive lode, 37 ft. N. 29° 11' E., and 1427.8 ft. S. 29° 11' W.

Iron Hive No. 2 lode, 70 ft. S. 29° 11' W., and 1394.8 ft. N. 29° 11' E.

Moonlight lode, 250 ft. S. 47° 53' W., and 1176 ft. N. 47° 53' E.

Big Iron No. 1 lode, 78 ft. N. 30° 29' E., and 1350.8 ft. S. 30° 29' W.

Big Iron No. 2 lode, 212 ft. S. 47° 49' W., and 1281.5 ft. N. 47° 49' E.

Big Iron No. 3 lode, 20 ft. N. 30° 29' E., and 1347.3 ft. S. 30° 29' W.

Big Iron No. 4 lode, 319 ft. S. 39° 09' 30" W., and 1153.2 ft. N. 39° 09' 30" E.

Breach lode, 240.6 ft. N. 30° 14' E., and 17 ft. S. 30° 14' W.

Hechtman lode, 373 ft. S. 58° 18' W., and 632.5 ft. N. 58° 18' E.

Gill lode, 120 ft. N. 58° 13' E., and 885 ft. S. 58° 13' W.

Vacy-Constance lode, 730.4 ft. N. 38° 44' E., and 737 ft. S. 38° 44' W.

Big Iron No. 5 lode, 25 ft. N. 47° 58' E., and 1460.3 ft. S. 47° 58' W.

Big Bluff lode, 257 ft. N. 39° 42' E., and 1167.1 ft. S. 39° 42' W.

New Orleans lode, 20 ft. S. 48° 22' W., and 1419.4 ft. N. 48° 22' E.

Los Angeles lode, 78 ft. N. 50° 22' E., and 1393.4 ft. S. 50° 22' W.

## AREA.

	Aeres.
Total Area, Mineral Farm lode -----	19.275
Total Area, Mineral Farm No. 1 lode -----	18.539
Total Area, Mineral Farm No. 2 lode -----	15.922
Total Area, Mineral Farm No. 3 lode -----	14.753
Total Area, Mineral Farm No. 4 lode -----	18.419
Total Area, Mineral Farm No. 5 lode -----	16.587
Total Area, Iron Hive lode -----	19.896
Total Area, Iron Hive No. 2 lode -----	17.911
Total Area, Moonlight lode -----	18.208



AREA - continued.

Total Area, Big Iron No. 1 lode - - - - -	13.397
Total Area, Big Iron No. 2 lode - - - - -	17.801
Total Area, Big Iron No. 3 lode - - - - -	12.918
Total Area, Big Iron No. 4 lode - - - - -	16.365
Total Area, Breach lode - - - - -	3.486
Area in conflict with Mineral Farm lode	.140
Total Area, Hechtman lode - - - - -	12.730
Area in conflict with Mineral Farm No. 3 lode	2.901
Total Area, Gill lode - - - - -	12.952
Total Area, Vacy-Constance lode - - - - -	20.095
Total Area, Big Iron No. 5 lode - - - - -	17.996
Total Area, Big Bluff lode - - - - -	15.322
Total Area, New Orleans lode - - - - -	19.106
Total Area, Los Angeles lode - - - - -	19.878

The survey of each lode in this location is identical with the respective amended locations as staked upon the ground, with the following exceptions.

In the Iron Hive lode, the west end center of the location bears S. 29° 11' W., 1 ft., from the corresponding end center of this survey.

A Cor. of the location of Big Iron No. 4 lode bears N. 29° 11' E., 57.7 ft. from Cor. No. 3.

LOCATION.

This survey is located in Secs. 1, 12 and 13, T. 1 N., R. 15 E. and approx. Secs. 6 and 7, T. 1 N., R. 16 E., unsurveyed, Crook National Forest, Globe Mining District, Gila County, Arizona.

IMPROVEMENTS.

I certify that the value of the labor and improvements made upon, or for the benefit of each of the locations embraced in this survey by the claimant or its grantors is not less than five hundred dollars, and that said improvements consist of:

MINERAL FARM.

No. 1. The discovery tunnel of the Mineral Farm lode, the discovery point in which is on the lode line 195 ft. from the west end center of the location, 4 by 6 ft., running N. 44° 48' W., 20 ft., N. 49° 31' W., 124 ft. to the mouth, S. 44° 48' E., 49 ft., S. 29° 53' E., 138 ft. to the face.

Value, \$ 3300.00

No. 2. A shaft, which bears from Cor. No. 4 S. 62° 43' W., 418.5 ft., 6 by 6 ft., 10 ft. deep.

Value \$25.00

No. 3. A cut, the face of which bears S. 36° 30' W., 43 ft. from a point on line 5-6, 641.8 ft. from Cor. No.



( 22-2618 )

## IMPROVEMENTS - continued.

5, 7 ft. wide, 10 ft. face, running N. 60° W., 25 ft., to the mouth, at the face of which is a shaft, 4 by 6 ft., 25 ft. deep.

Value \$ 300.  
An undivided 1/2I interest in the value of Shaft No. 4 on the Big Iron No. I lode is credited to this lode,  
Value \$ 685.70

## MINERAL FARM NO. 1.

No. 1. The discovery, a ledge 5 ft. wide, the discovery point being on the lode line 100 feet from a point on line 6-I, 248.3 ft. from Cor. No. 6.  
No. 2. A shaft which bears N. 30° 11' E., 50 ft. from the west end center of the location 4 by 6 ft., 10 ft. deep.

Value \$ 50.  
An undivided 1/2I interest in the value of shaft No. 4. on the Big Iron No. I lode is credited to this lode.  
Value \$ 685.70

## MINERAL FARM NO. 2.

No. 1. The discovery shaft, on the lode line 54 ft. from the east end center of the location, 3 by 6 ft., 7 ft. deep.

Value \$ 25.  
No. 2. A cut, the mouth of which bears from a point on line 4-5 717.65 ft. from Cor. No. 4, identical with Cor. No. 1, Mineral Farm lode, N. 28° 45' W., 407 ft., 3 ft. wide, 6 ft. face, running N. 30° W., 25 ft. to the face.

Value \$ 25.  
No. 3. A shaft, which bears from the east end center of the location S. 63° 45' W., 339 ft., 5 by 6 ft., 12 ft. deep.

Value \$ 50.  
An undivided 1/2I interest in the value of shaft No. 4. on the Big Iron No. I lode is credited to this lode.  
Value \$ 685.70

## MINERAL FARM NO. 3.

No. 1. The discovery cut, the face of which, being the discovery point, is on the lode line 775. ft. from the west end center of the location, 4 ft. wide, 10 ft. face, running N. 50° W., 12 ft. to the mouth. Value \$ 25.

An undivided 1/2I interest in the value of shaft No. 4 on the Big Iron No. I lode is credited to this lode.  
Value 685.70

## MINERAL FARM NO. 4.

No. 1. The discovery, a ledge 50 ft. wide, the discovery point being on the lode line 100 ft. from a point on line 6-I, 340 ft. from Cor. No. 6.

No. 2. A shaft, which bears from a point on line 2-3, 320 ft. from Cor. No. 2, S. 42° 20' E., 74 ft., 5 by 7 ft., 10 ft. deep.

Value \$ 25.  
No. 3. A shaft, bears N. 30° 29' E., 83 ft. from the west end center of the location, 4 by 6 ft., 10 ft. deep.  
Value, \$ 25.

An undivided 1/2I interest in the value of shaft No. 4 on the Big Iron No. 1 lode is credited to this lode.  
Value, \$ 685.70



## MINERAL FARM NO. 5.

No. 1. The discovery, the discovery point being a ledge on the lode line 36 ft. from the east end center of the location, outcropping 5 ft. wide.

No. 2. A shaft, which bears from Cor. No. 2, N. 46° 18' W., 112 ft. 6 by 8 ft., 10 ft. deep.

Value \$ 25.00

An undivided 1/2I interest in the value of shaft No. 4 on the Big Iron No. 1 lode is credited to this lode.

Value \$ 685.70

-----  
IRON HIVE.

No. 1. The discovery shaft on the lode line 37 ft. from the east end center of the location, 4 by 6 ft., 10 ft. deep.

Value \$ 25.00

No. 2. A cut, the mouth of which bears from Cor. No. I, S. 50° 30' W., 703 ft., 4 ft. wide, 6 ft. face, running N. 45° W., 30 ft.

Value \$ 25.00

No. 3. A cut, the mouth of which bears from Cor. No. I, S. 51° 15' W., 686 ft., 3 ft. wide, 10 ft. face, running N. 35° W., 10 ft.

Value \$ 25.00

No. 4. A cut, the mouth of which bears from Cor. No. I, S. 48° 20' W., 691 ft., 5 ft. wide, 10 ft. face, running North 20 ft. to the face.

Value, \$ 50.00

No. 5. A cut, the mouth of which bears from Cor. No. I, S. 43° 05' W., 595 ft., 4 ft. wide, 6 ft. face, running N. 45° W., 15 ft.

Value \$ 25.00

No. 6. A cut, the mouth of which bears from Cor. No. I, S. 39° W., 542 ft., 3 ft. wide, 4 ft. face, running West 25 ft.

Value \$ 25.00

No. 7. A shaft, which bears from Cor. No. I, S. 32° 30' W., 368 ft., 4 by 4 ft., 10 ft. deep.

Value \$ 25.00

No. 8. A cut, the mouth of which bears N. 65° 34' W., 73 ft. from a point on line I-2, 1017 ft. from Cor. No. I, 3 ft. wide, 4 ft. face, running N. 60° W., 24 ft.

Value \$ 25.00

An undivided 1/2I interest in the value of shaft No. 4 on the Big Iron No. 1 lode is credited to this lode.

Value \$ 685.70

-----  
IRON HIVE NO. 2.

No. 1. The discovery shaft on the lode line 70 ft. from the west end center of the location, 3 by 5 ft., 5 ft. deep.

Value, \$ 25.00

No. 2. A cut, the mouth of which bears from a point on line 2-3 793 ft. from Cor. No. 2.. identical with Cor. No. 5, Big Iron No. 3 lode, N. 20° 49' W., 270 ft. 4 ft. wide, 10 ft. face, running East 17 ft.

Value \$ 25.00

No. 3. A cut, the mouth of which bears from Cor. No. I, S. 13° 25' W., 609 ft., 10 ft. wide, 10 ft. face,



( 24-2618)

## IMPROVEMENTS - continued.

-----  
IRON HIVE NO. 2. continued.

running S. 65° E., 12 ft.

Value \$ 25.00

No. 4. A cut, the mouth of which bears from Cor. No. I, S. 8° 30' W., 423 ft., 4 ft. wide, 8 ft. face, running East 12 ft.

Value \$ 25.00

No. 5. A tunnel, the mouth of which bears from Cor. No. I, S. 7° W., 450 ft., 4 by 6 ft., running East 32 ft.

Value \$ 250.00

No. 6. A cut, the mouth of which bears from the west end center of the location S. 65° 34' E., 250 ft., 4 ft. wide, 5 ft. face, running S. 60° E., 10 ft.

Value \$ 25.00

An undivided 1/2I interest in the value of shaft No. 4 on the Big Iron No. I lode is credited to this lode.

Value \$ 685.70

-----  
MOONLIGHT.

No. 1. The discovery cut, the face of which being the discovery point, is on the lode line 250 ft. from the west end center of the location, 3 ft. wide, 4 ft. face, running S. 50° W., 18 ft.

Value \$ 25.00

No. 2. A cut, the mouth of which bears from Cor. No. I, N. 74° 30' E., 418.5 ft., 4 ft. wide, 12 ft. face, running N. 80° E., 10 ft.

Value \$ 25.00

An undivided 1/2I interest in the value of shaft No. 4 on the Big Iron No. I lode is credited to this lode.

Value \$ 685.70

-----  
BIG IRON NO. I.

No. 1. The discovery, the discovery point being a ledge outcropping 150 ft. wide on the lode line, 78 ft. from the east end center of the location.

No. 2. A tunnel, the mouth of which bears from a point on line 2-3, 685 ft. from Cor. No. 2, identical with Cor. No. 1, Big Iron No. 3 lode, S. 28° 37' E., 303 ft. 4 by 6 ft., running S. 30° E., 30 ft.

Value \$ 240.00

No. 3. A shaft, which bears from a point on line 2-3, 685 ft. from Cor. No. 2, identical with Cor. No. 1, Big Iron No. 3 lode, S. 14° 43' E., 246 ft., 5 by 6 ft., 30 ft. deep, timbered 12 ft.

Value \$ 250.00

No. 4. A shaft, which bears from a point on line 4-I, 404 ft. from Cor. No. 4, N. 10° 30' W., 233 ft., 4 by 7 ft., in the clear, timbered one and one half compartments, 412 ft. deep. Course of long axis of shaft, N. 50° E.

Value, \$ 14,400.00



## IMPROVEMENTS - continued.

## BIG IRON N. I. - continued.

This claim is situated in a large basin, and extends onto the surrounding hills. The only way to conduct extensive mining operations on this group is through a shaft, or shafts. The Shaft No. 4 of the Big Iron No. 1 lode is centrally and conveniently located and easy of access, and is being sunk for the purpose of exploring, developing and operating the entire group through one system of workings, and one plant of machinery.

I credit an equal portion of the value of this shaft to each of the locations in this survey.

Value of 1/21 interest, \$ 685.70

## BIG IRON No. 2.

No. 1. The discovery cut, the face of which being the discovery point, is on the lode line 212 ft. from the west end center of the location, 3 ft. wide, 10 ft. face, running S. 50° E. 15 ft.

value \$ 25.

An undivided 1/21 interest in the value of shaft No. 4 on the Big Iron No. 1 lode is credited to this lode.

Value \$ 685.70

## BIG IRON No. 3.

No. 1. The discovery shaft of the Big Iron No. 3 lode, is on the lode line 20 ft. from the east end center of the location, 4 by 6 ft., 12 ft. deep.

Value \$ 25.

An undivided 1/21 interest in the value of shaft No. 4 on the Big Iron No. 1 lode is credited to this lode.

Value \$ 685.70

## BIG IRON NO. 4.

No. 1. The discovery shaft on the lode line 319 ft. from a point on line I-2, 366.75 ft. from Cor. No. 1, 4 by 6 ft., 10 ft. deep.

Value \$ 25.

No. 2. A cut, the mouth of which bears from Cor. No. 6, N. 60° 40' W., 138 ft., 4 ft. wide, 10 ft. face, running N. 60° W., 19 ft.

Value, \$ 25.

No. 3. A shaft, which bears from Cor. No. 6, N. 4° 30' E., 197.5 ft., 6 by 6 ft., 10 ft. deep.

Value \$ 25.

No. 4. A shaft, bears from Cor. No. 2, S. 60° 50' E., 205 ft., 4 by 6 by 6 ft. deep.

Value, \$ 25.

An undivided 1/21 interest in the value of shaft No. 4 on the Big Iron No. 1 lode is credited to this lode.

Value, \$ 685.70

## BREACH.

No. 1. The discovery shaft on the lode line 17 ft.



( 26-2618 )

## BREACH - continued.

from the west end center of the location, 4 by 6 ft.,  
12 ft. deep.

value, \$ 25.

No. 2. A cut, the mouth of which bears from Cor. No. 1, S. 82°42'E., 111.5 ft., 5 ft. wide, 5 ft. face, running S. 80°E., 10 ft.

value, \$ 25.

An undivided 1/2I interest in the value of shaft No. 4 on the Big Iron No. 1 lode is credited to this lode.

Value, \$ 685.70

-----  
HECHTMAN.

No. 1. The discovery cut, the face of which being the discovery point, is on the lode line 373 ft. from the west end center of the location, 3 ft. wide, 6 ft. face, running S. 60°W. 10 ft.

value, \$ 25.

No. 2. A cut, the mouth of which bears from Cor. No. 2, N. 22°30'E., 370 ft., 4 ft. wide, 10 ft. face, running N. 45°E., 12 ft.

value, \$ 25.

An undivided 1/2I interest in the value of shaft No. 4 on the Big Iron No. 1 lode is credited to this lode.

Value, \$ 685.70.

-----  
GILL.

No. 1. The discovery tunnel, the discovery point in which is on the lode line 120 ft. from the east end center of the location, 4 by 6 ft., running S. 50°E., 10 ft. to the mouth, N. 50°W., 51 ft. to the face.

Value, \$ 610.

An undivided 1/2I interest in the value of shaft No. 4 on the Big Iron No. 1 lode is credited to this lode.

Value, \$ 685.70

-----  
VACY-CONSTANCE.

No. 1. The discovery shaft on the lode line 737 ft. from the west end center of the location, 5 by 7 ft., inclined 70°, running N. 80°E., timbered one and one-half compartments, 160 ft. deep; from the 22 ft. level of which an adit, 4 by 6 ft., runs S. 10°E., 18 ft. to a winze 3 by 3 ft., connecting with the 39 ft. level, thence 25 ft. to mouth; from the 39 ft. level of which a drift 4 by 6 ft. runs S. 10°E., 18 ft. to bottom of winze heretofore described; from the 130 ft. level of which the center of a stope, 20 ft. in diameter, 12 ft. high, bears S. 80°W., 20 ft., a drift 4 by 15 ft. runs N. 10°E., 50 ft., a drift 4 by 6 ft. runs S. 75°E., 70 ft. The upper 130 ft. of the shaft, the workings on the 22 ft. and 39 ft. levels, the drift running N. 10°E., 20 ft. of the drift running S. 75°E., and one half of the work done in the stope, on the 130 ft. level, was done by former locators. The remainder of the workings previously named, together with the timbering of the shaft for its entire length, and cleaning out filled material from the 80 ft. level to the 130 ft. level



## VACY-CONSTANCE- continued.

was done by the claimants herein.

Value of shaft and drifts. \$2100

No. 2. A tunnel, the mouth of which bears from Cor.  
No. 1, N. 4° 25' E., 408 ft., 4 by 6 ft. running N. 45° W.,  
37 ft.  
value, \$ 300.

No. 3. A tunnel, the mouth of which bears from Cor.  
No. 2, N. 63° 35' E., 875 ft., 4 by 6 ft. running S. 80°  
E., 30 ft.  
value, \$ 240.

An undivided 1/2I interest in the value of shaft No.  
4 on the Big Iron No. 1 lode is credited to this lode.  
Value, \$ 685.70

## BIG IRON NO. 5.

No. 1. The discovery shaft, on the lode line 25 ft.  
from the east end center of the location, 4 by 6 ft.,  
12 ft. deep.  
Value, \$ 40.

No. 2. A shaft which bears from a point on line 3-4.  
694 ft. from Cor. No. 3, N. 49° 18' E., 50 ft., 4 by 6  
ft., 9 ft. deep.  
Value, \$ 25.

An undivided 1/2I interest in the value of shaft No.  
4 on the Big Iron No. 1 lode is credited to this lode.  
Value, \$ 685.70

## BIG BLUFF.

No. 1. The discovery shaft on the lode line 257 ft.  
from a point on line 6-1, 375 ft. from Cor. No. 6,  
4 by 6 ft., 10 ft. deep.  
Value, \$ 25.

No. 2. A cut, the mouth of which bears from Cor. No.  
4, S. 86° 19' E., 197 ft., 4 ft. wide, 10 ft. face,  
running East 12 ft.  
Value, \$ 25.

No. 3. A shaft, bears from the east end center of the  
location, S. 30° W., 20 ft. 4 by 6 ft., 10 ft. deep.  
Value, \$ 25.

An undivided 1/2I interest in the value of shaft No.  
4 on the Big Iron No. 1 lode is credited to this lode.  
Value, \$ 685.70

## NEW ORLEANS.

No. 1. The discovery cut, the face of which being  
the discovery point, is on the lode line 20 ft. from the  
west end center of the location, 3 ft. wide, 10 ft. face,  
running S. 45° W., 6 ft. to the mouth.  
Value, \$ 25.

No. 2. A shaft, which bears from Cor. No. 5, N. 25° 12'  
W., 320 ft., 4 by 6 ft., 10 ft. deep.  
Value, \$ 25.



( 28-2618 )

## NEW ORLEANS - continued.

No. 3. A shaft, which bears from Cor. No. 5, N. 25° 22' E., 427 ft., 7 by 8 ft., 8 ft. deep.  
Value \$ 50.

No. 4. A cut, the mouth of which bears from Cor. No. 5, N. 22° 49' E., 387 ft., 4 ft. wide, 6 ft. face, running S. 75° E., 12 ft.  
Value \$ 25.

No. 5. A cut, the face of which bears from Cor. No. 5, N. 9° 5' E., 255 ft., 10 ft. wide, 25 ft. face, running S. 50° W., 45 ft. to the mouth.  
Value \$ 100.

An undivided 1/2I interest in the value of shaft No. 4 on the Big Iron No. 1 lode is credited to this lode.  
Value, \$685.70

## LOS ANGELES.

No. 1. The discovery cut, the face of which being the discovery point is on the lode line, 78 ft. from the east end center of the location, 3 ft. wide, 6 ft. face, running N. 50° E., 10 ft. to the mouth.  
Value \$ 25.

No. 2. A cut, which bears from Cor. No. 2, N. 38° E., 760 ft. 6 ft. wide, 12 ft. face, running N. 10 ft.  
Value \$ 25.

An undivided 1/2I interest in the value of shaft No. 4 on the Big Iron No. 1 lode is credited to this lode.  
Value \$ 685.70

A shaft, which bears from Cor. No. 2, Vacy-Constance lode, N. 69° 10' E., 793 ft. 4 by 6 ft., 18 ft. deep. Sunk by former locators.

A cut, the mouth of which bears from Cor. No. 2 Vacy-Constance lode, N. 58° 42' E., 824 ft., 4 ft. wide, 35 ft. face, running N. 60° E., 40 ft. Made by other locators.

## OTHER IMPROVEMENTS.

A frame house, the north west corner of which bears from a point on line I-2, Mineral Farm No. 4. lode, 325.4 ft. from Cor. No. 1, S. 76° 16' E., 55 ft., 14 by 28 ft. Course of long sides N. 50° E.

A frame house, the southwest corner of which bears from a point on line I-2, Mineral Farm No. 4 lode, 325.4 ft. from Cor. No. 1, N. 43° 35' E., 176 ft., 10 by 12 ft. Course of long sides N. 70° E.

A frame house, the southeast corner of which bears from a point on line 4-1, Big Iron No. 1 lode, 404 ft. from Cor. No. 4, N. 61° 26' W., 259 ft., 12 by 24 ft. Course of long sides N. 55° W.

A frame boarding house, the southeast corner of which bears from a point on line 4-1, Big Iron No. 1



## OTHER IMPROVEMENTS - continued.

lode, 404 ft. from Cor. No. 4, N.  $64^{\circ}41' W.$ , 172 ft.,  
17 by 28 ft. Course of long sides S.  $5^{\circ} W.$

Surface plant at Shaft No. 4 on Big Iron No. 1 lode,  
consisting of,

One geared hoist, 8x10" cylinders, with hoisting  
capacity to 800 ft. in depth.

One 60 H.P. return tubular boiler. <sup>g</sup>

One 3-drill Gordon-Dunn-Laidlaw air compressor.

The above in an iron building, the Southeast corner of  
which bears from a point on line 4-1, Big Iron No. 1  
lode, 404 ft. from Cor. No. 4, N.  $15^{\circ}26' W.$ , 253.5  
ft.. 24 by 36 ft. Course of long sides N.  $40^{\circ} W.$

An iron tank, 7 ft. dia. the center of which bears from  
a point on line 4-1, Big Iron No. 1 lode, 404 ft.  
from Cor. No. 4, N.  $1^{\circ}51' W.$ , 310 ft.

An iron tank, 10 ft. dia., the center of which bears  
from a point on line 4-1, Big Iron No. 1 lode, 404  
ft. from Cor. No. 4, N.  $20^{\circ}36' W.$ , 250 ft.

An iron tank,  $7\frac{1}{2}$  ft. dia., the center of which bears  
from a point on line 4-1, Big Iron No. 1 lode, 404  
ft. from Cor. No. 4, N.  $23^{\circ}36' W.$ , 241 ft.

An iron tank,  $7\frac{1}{2}$  ft. in dia. the center of which bears  
from a point on line 4-1, Big Iron No. 1 lode, 404  
ft. from Cor. No. 4, N.  $22^{\circ}46' W.$ , 232 ft.

A blacksmith shop, the Southeast corner of which bears  
from a point on line 4-1, Big Iron No. 1 lode, 404  
ft. from Cor. No. 4, N.  $9^{\circ}11' W.$ , 200 ft., 13 by 19  
ft. Course of long sides, S.  $45^{\circ} W.$

A framing shed, the Northwest corner of which bears from  
a point on line 4-1, Big Iron No. 1 lode, 404 ft.  
from Cor. No. 4, N.  $9^{\circ}11' W.$ , 200 ft., 10 by 18 ft.  
Course of long sides N.  $45^{\circ} E.$

-----  
INSTRUMENT.

This survey was made with a G.L. Berger mining  
transit No. 7180. The courses were deflected from the  
true meridian as determined by direct solar observations.  
The distances were measured with a 650 ft. steel tape.

-----  
ADJOINING CLAIMS.

This survey is bounded on the southeast by the Sur.  
No. 2302, Rooster lode, Globe Consolidated Copper Co.,  
claimant, Little Jennie lode, unsurveyed, Geo. H.  
Thwaites, claimant, <sup>Big Iron No. 1 lode, Sur. No. 433,</sup> O'Dougherty lode, Sur.  
No. 842, Yuma lode, United Globe Mines, (inc.) claimant;  
Magnet lode, unsurveyed, Superior & Globe Mining Co.,  
claimant:

On the northeast by the Magnet No. 1, Magnet No. 3,  
Magnet No. 4, and Magnet No. 6 lodes, unsurveyed,  
Superior & Globe Mining Co., claimant; U.S. Grant and  
Livingstone lodes, unsurveyed, claimant unknown, and an  
unknown claim:

On the northwest by unknown claims:

On the southwest by the Essex and Oneida lodes,  
unsurveyed, F. Thum et al, claimants, unknown claims and  
the Turkey and Ridge lodes, unsur., F. Thum, claimant; Sur. No.  
2324, Silver Star and Eastern Star lodes, Sur. No. 2300,  
Garrett lode, Globe Consolidated Copper Co., claimant.



( 30-2618)

## REPORT.

The NE. Cor. of Sec. 12, T. 1 N., R. 15 E., G. & S.R. B.M., is a syenite stone chiseled one notch on the north face, five notches on the south face.

The E.  $\frac{1}{4}$  of Sec. 12, is a syenite stone chiseled  $\frac{1}{4}$  S on the west face.

The SE. Cor. of Sec. 12, is a syenite stone chiseled two notches on the north face and four notches on the south face.

Although I examined the ground thoroughly I failed to find the S.  $\frac{1}{4}$  Cor. of Sec. 12.

The SW. Cor. of Sec 12 is a sandstone chiseled one notch on the east face and four notches on the south face.

The N.  $\frac{1}{4}$  Cor. of Sec. 12 is a quartzite stone chiseled  $\frac{1}{4}$  S. on the south face.

The E.  $\frac{1}{4}$  Cor. of Sec. 1 is a quartzite stone chiseled  $\frac{1}{4}$  S on the west face.

I find the line from the SE. Cor. of Sec. 12, to the SW. Cor. to be N.  $89^{\circ}16'$  W., 5239 ft.

I find the line from the SE. Cor. of Sec. 12 to the E.  $\frac{1}{4}$  Cor. of said Sec. to be N.  $00^{\circ}04'$  E., 2638.4 ft.

I find the line from the E.  $\frac{1}{4}$  Cor. of Sec. 12 to the NE. Cor. of said Sec. to be N. 2652.7 ft.

I find the line from the NE. Cor. of Sec. 12 to the N.  $\frac{1}{4}$  Cor. of said section to be S.  $89^{\circ}51'$  W., 2645.5 ft.

I find the line from the NE. Cor. of Sec. 12 to the E.  $\frac{1}{4}$  Cor. of Sec. 1 to be N.  $00^{\circ}24'$  W., 2567.6 ft.

Sur. No. 842, Yuma lode:

Cor. No. 1 is a pine post properly set and scribed Y-No. 1.

Cor. No. 5 is a cedar post, in mound of stone, scribed Y-No. 5.

Cor. No. 6 is a pine post, properly set, scribed Y-No. 6.

Line 5-6 I found to be S.  $47^{\circ}53'$  W., 1434.4 ft.

Line 6-1 I found to be S.  $51^{\circ}24'$  E.

Sur. No. 433, O'Dougherty lode:

Cor. No. 5 is a cedar post, in mound of stone, scribed OD-No. v.

Cor. No. 6 is a very crooked cedar post, properly set, scribed OD-No. vi. and BJ-No. vi. not suitable for the additional scribing necessary for this survey. Therefore I set a post, for Cor. No. 4, Breach lode, of this survey, alongside, so that the exact corner point is identical with the corner point of the O'Dougherty and Big Johnnie lodes as near as can be determined.

Line 5-6, O'Dougherty lode, I found to be S.  $30^{\circ}$  W., 1442.8 ft.

Sur. No. 434, Big Johnnie lode:

Cor. No. 5 is a pine post, in mound of stone, scribed BJ-No. v.

Cor. No. 6 is identical with Cor. No. 6, Sur. No. 433, O'Dougherty lode, previously described.

Line 5-6 I find by calculation to be N.  $50^{\circ}23'$  E., 1469.6 ft.

Sur. No. 2302, Rooster lode:

Corners 1 and 6 are pine posts properly set and scribed with the number of the corner and survey,

I find line 6-1 to be N.  $58^{\circ}13'$  E., 1005. ft.



## REPORT,- continued.

Sur. No. 2300, Garrett lode:  
Corners 1 and 5 are pine posts properly set and  
scribed with the number of the corner and survey.  
I find line 5-1 to be S. 51° 30' E., 597.1 ft.

Sur. No. 2324, Eastern Star and Silver Star lodes.  
Corners 1, Eastern Star, 4-1 Eastern Star and Silver  
Star, and 4, Silver Star lodes, are pine posts properly  
set and scribed with the number of the corner and survey.  
I find line 4-1, Eastern Star lode, to be S. 51° 19'  
E., 561.8 ft.  
I find line 4-1, Silver Star lode, to be S. 51° 19'  
E.

NOTE: The discrepancies between these notes and the  
location notices; Survey No. 842, Yuma lode;  
Survey No. 433, O'Dougherty lode; Survey No. 434,  
Big Johnnie lode; Survey No. 2302, Rooster lode;  
Survey No. 2300, Garrett lode; Survey No. 2324,  
Eastern Star and Silver Star lodes; and the lines  
of the public land surveys are due to errors in  
the latter.



# FINAL OATHS FOR SURVEYS.

## LIST OF NAMES.

A list of the names of the individuals employed by H.C. Hopkins  
 United States Mineral Surveyor, to assist in running, measuring, and marking the lines, corners, and  
 boundaries described in the foregoing field notes of the survey of the mining claim of \_\_\_\_\_  
 \_\_\_\_\_ Globe Mining Company \_\_\_\_\_  
 known as the \_\_\_\_\_ Sec " FINAL OATHS OF ASSISTANTS " \_\_\_\_\_  
 and showing the respective capacities in which they acted.

\_\_\_\_\_ Howard L. Way \_\_\_\_\_, *Chainman.*  
 \_\_\_\_\_ Jesse B. Fox \_\_\_\_\_, *Chainman.*  
 \_\_\_\_\_ P. L. Minder \_\_\_\_\_ Chainman  
 \_\_\_\_\_, *Flagman.*

## FINAL OATHS OF ASSISTANTS.

We, \_\_\_\_\_ Howard L. Way, Jesse B. Fox \_\_\_\_\_  
 and \_\_\_\_\_ P. L. Minder \_\_\_\_\_, do solemnly swear that we assisted H. C. Hopkins  
 \_\_\_\_\_, United States Mineral Surveyor, in marking the corners and surveying  
 the boundaries of the mining claim of \_\_\_\_\_ Globe Mining Company \_\_\_\_\_  
 known as the Mineral Farm, Mineral Farm No.1, Mineral Farm No.2, Mineral Farm  
No.3 Mineral Farm No.4, Mineral Farm No.5, Iron Hive, Iron Hive No.2,  
Moonlight, Big Iron No.1, Big Iron No.2, Big Iron No.3, Big Iron No.4,  
Breach, Hechtman, Gill, Vacy-Constance, Big Iron No.5, Big Bluff,  
 known as the \_\_\_\_\_ New Orleans, Los Angeles \_\_\_\_\_  
 represented in the foregoing field notes as having been surveyed by said mineral surveyor and under his  
 direction; and that said survey has been in all respects, to the best of our knowledge and belief, faithfully  
 and correctly executed, and the corner and boundary monuments established according to law and the instruc-  
 tions furnished by the United States Surveyor-General for \_\_\_\_\_ Arizona \_\_\_\_\_

\_\_\_\_\_ Howard L. Way \_\_\_\_\_, *Chainman.*  
 \_\_\_\_\_ Jesse B. Fox \_\_\_\_\_, *Chainman.*  
 \_\_\_\_\_ P. L. Minder \_\_\_\_\_ Chainman  
 \_\_\_\_\_, *Flagman*

Subscribed and sworn to by the above-named persons before me this \_\_\_\_\_ 14th \_\_\_\_\_  
 day of \_\_\_\_\_ June \_\_\_\_\_, 1909.  
 My commission expires November 9, 1911.

\_\_\_\_\_ Grace D. Nagrin \_\_\_\_\_  
 Notary Public in and for the  
 County of Gila, Territory of \_\_\_\_\_ Arizona.  
6-1043





# FINAL OATH OF U. S. MINERAL SURVEYOR.

I, H. C. Hopkins, U. S. Mineral Surveyor, do solemnly swear that, in pursuance of instructions received from the United States Surveyor General for Arizona, dated March 29th, 1909., I have, in strict conformity to the laws of the United States, the official regulations and instructions thereunder, and the instructions of said Surveyor General, faithfully and correctly executed the survey of the Mining Claim of Globe Mining Company, known as the See Note Below, situate in Globe Mining District, Gila County, Arizona, in Sections 1, 12 & 13 Approx. 6, 7 Township No. 1 N., Ranges No. 15 E., 16 E., Unsur., and designated as Survey No. 2618, as represented in the foregoing field notes, which accurately show the boundaries of said mining claim as distinctly marked by monuments on the ground, and described in the attached copy of the location certificate, which was received by me from the Surveyor General with said instructions, and that all the corners of said survey have been established and perpetuated in strict accordance with the law, official regulations and instructions thereunder; and I do further solemnly swear that the foregoing are the true and original field notes of said survey and my report therein, and that the labor expended and improvements made upon said mining claim by claimant or its grantors are as therein fully stated, and that the character, extent, location, and itemized value thereof are specified therein with particularity and full detail, and that no portion of said labor or improvements so credited to this claim has been included in the estimate of expenditures upon any other claim. Note: Mineral Farm, Mineral Farm No. 1, Mineral Farm No. 3, Mineral Farm No. 4, Mineral Farm No. 5, Iron Hive, Iron Hive No. 2, Moonlight, Big Iron No. 1, Big Iron No. 2, Big Iron No. 3, Big Iron No. 4, Breach, Hechtman, Gill, Vacy-Constance, Big Iron No. 5, Big Bluff, New Orleans, Los Angeles, Mineral Farm No. 2.

H. C. Hopkins  
U. S. Mineral Surveyor.

Subscribed and sworn to by the said H. C. Hopkins  
U. S. Mineral Surveyor, before me Grace D. Naquin, Notary Public,  
this 12th  
day of June, 1909.

My commission expires Nov. 9, 1911.  
Grace D. Naquin

Notary Public in and for the  
County of Gila, Territory of Arizona.



Affidavit of Five Hundred Dollars Improvements.

We, P. K. Mayhew and J. H. Simpson

of lawful age, being first duly sworn according to law, depose and say: That we are acquainted with the See Note Below mining claim, situate in Globe Mining district, Gila County, Arizona Territory, for which Globe Mining Company

has made application for survey prior to application for patent under the provisions of the act of Congress, approved May 10, 1872; and that the labor done and improvements made thereon by the applicant and its grantors exceed Five Hundred Dollars in value, and further that we are not personally interested in said mine.

PK Mayhew
JH Simpson

TERRITORY OF ARIZONA,

County of Gila

ss:

Sworn to and subscribed before me, this 11th

day of June, 1909.



USG Commission Expires SEP-15-1912

V B Graves Notary Public

NOTE: Mineral Farm, Mineral Farm No.1, Mineral Farm No.2, Mineral Farm No.3, Mineral Farm No.4, Mineral Farm No.5, Iron Hive, Iron Hive No.2, Moonlight, Big Iron No.1, Big Iron No.2, Big Iron No.3, Big Iron No.4, Breach, Hechtman, Gill, Vacy-Constance, Big Iron No.5, Big Bluff, New Orleans, Los Angeles.



NOTICE OF MINING LOCATION  
LODE CLAIM.

TO ALL WHOM IT MAY CONCERN:

This Mining Claim, the name of which is the Gill Mining Claim, situate on lands belongin to the United States of America, and in which there are valuable mineral deposits, was entered upon and located for the purposes of exploration and purchase by Citizens of the United States, J.F. Hechtman, George Goodwin and Frank Gill, the undersigned, on the 1st day of January 1904.

The length of the claim is 1100 feet, and we claim 1100 feet in a S.W. direction from the discovery Tunnel at which this notice is posted, lengthwise of the claim, together with 300 feet in width of the surface grounds, on each side of the center of said claim. The general course of the lode deposit and premises is from the Northeast to the Southwest.

The claim is situated and located in the Globe Mining District, in Gila County, in the Territory of Arizona, about 2 1/2 miles in a Northerly direction from the town of Globe, and is a partial S.W. extension of the Big Johnny claim owned by the United Globe Co. and also a partial extension of the Little Jennie claim owned by C. H. Thwaites and lies along the N.W. side of the Rooster claim owned by the Globe-Boston Co. It is a relocation of an abandoned claim.

The surface boundaries of the claim are marked upon the ground as follows: Beginning at a post and monument of stone at a point near the discovery tunnel (at which this notice is posted), being in the center of the N.E. end line of said claim; thence S.E. 300 feet to a post and monument being the S.E. corner of said claim; thence S.W. 1100 feet to a post and monument, being at the S.W. corner of said claim; thence N.W. 300 feet to a post and monument at the center of the S.W. end of said claim; thence N.W. 300 feet to a post and monument, being at the N.W. corner of said claim; thence N.E. 1100 feet to a post and monument at the N.E. corner of said claim; thence 300 feet to the place of beginning.

All done under the provisions of chapter Six, of title ~~XXXII~~, of the Revised Statutes of the United States, and of an act of the General Assembly of Arizona, entitled "An Act to Revise and Codify the Laws of the Territory of Arizona," approved March 16, 1901.

Dated and posted on the ground this 1st day of January 1904.

J. F. Hechtman  
George Goodwin  
Frank Gill

Filed and recorded at the request of J.F. Hechtman on the 19th day of March A.D. 1904, at 40 minutes past 11 o'clock A. M.

W. D. Fisk County Recorder.



NOTICE OF MINING LOCATION  
LODE CLAIM.

TO ALL WHOM IT MAY CONCERN:

This Mining Claim, the name of which is the Hechtman Mining Claim, situate on lands belonging to the United States of America, and in which there are valuable mineral deposits, was entered upon and located for the purposes of exploration and purchase by Citizens of the United States J.F. Hechtman, George Goodwin and Frank Gill the undersigned, on the 20th day of January 1904.

The length of the claim is 1100 feet, and we claim 600 feet in a S.W. direction and 500 feet in a N.E. from the discovery cut, at which this notice is posted, lengthwise of the claim together with 300 feet in width of the surface grounds, on each side of the center of said claim. The general course of the lode deposit and premises is from the Northeast to the Southwest.

The claim is situated in the Globe Mining District, in Gila County, in the Territory of Arizona, about 2 1/2 miles in a Northerly direction from the town of Globe. It is a partial S.W. extension of the Little Jennie claim owned by S. H. Thwaites and overlaps a portion of the Mineral Farm No. 3 claim and abuts the N.E. end of the Eastern Star claim owned by the Globe Boston Co.

The surface boundaries of the claim are marked upon the ground as follows Beginning at a post and monument 500 feet N.E. from the discovery cut (at which this notice is posted), being in the center of the N.E. end line of said claim; thence S.E. 300 feet to a post and monument, being the S.E. corner of said claim; thence S.W. 1100 feet to a post and monument, being at the S.W. corner of said claim; thence N.W. 300 feet to a post and monument at the center of the S.W. end of said claim; thence N.W. 300 feet to a post and monument, being at the N.W. corner of said claim; thence N.E. 1100 feet to a post and monument at the N.E. corner of said claim; thence 300 feet to the place of beginning.

All done under the provisions of Chapter Six, of Title XXXII, of the Revised Statutes of the United States, and of an Act of the General Assembly of Arizona, entitled "An Act to Revise and Codify the Laws of the Territory of Arizona," approved March 16, 1901.

Dated and posted on the ground this 20th day of January 1904.

J.F. Hechtman  
George Goodwin  
Frank Gill

Filed and recorded at the request of J.F. Hechtman on the 19th day of March A.D. 1904 at 40 minutes past 11 o'clock A. M.

W. D. Fisk County Recorder.



Notice of Mining Location  
Lode Claim.

TO ALL WHOM IT MAY CONCERN:

This Mining Claim, the name of which is the Vacy-Constance Mining Claim, situate on lands belonging to the United States of America, and in which there are valuable mineral deposits, was entered upon and located for the purposes of exploration and purchase by Citizens of the United States, the undersigned on the 12th day of Nov. 1903.

The length of this claim is 1500 feet and we claim 750 feet, in a North Easterly direction and 750 feet in a South Westerly direction from the center of the discovery shaft, at which this notice is posted, lengthwise of the claim, together with 300 feet in width of the surface grounds, on each side of the center of said claim. The general course of the lode deposit and premises is from the North East to the South West.

The claim is situated and located in the Globe Mining District, in Gila County, in the Territory of Arizona, about 3 1/2 miles in a Northerly direction from the town of Globe & about 4000 ft north of the Big Johnny claim, owned by the United Globe Mines Co. It is a relocation of an abandoned mine, formerly known as the Miama Mine; at one time owned by Burt Young.

The surface boundaries of the claim are marked upon the ground as follows Beginning at a post and monument at a point in a N.E. direction 750 feet from the discovery shaft (at which this notice is posted), being in the center of the N.E. end line of said claim; thence N.W. 300 feet to a post and monument being the N.E. corner of said claim; thence S.W. 1500 feet to a post & monument, being at the N.W. corner of said claim; thence S.E. 300 feet to a post & monument at the center of the S.W. end of said claim; thence S.E. 300 feet to a post & monument being at the S.W. corner of said claim; thence N.E. 1500 feet to a post & monument at the S.E. corner of said claim; thence N.W. 300 feet to the place of beginning.

All done under the provisions of Chapter Six, of Title XXXII, of the Revised Statutes of the United States, and of an Act of the General Assembly of Arizona, entitled "An Act to Revise and Codify the Laws of the Territory of Arizona, approved March 16, 1901.

Dated and posted on the ground this 12th day of Nov. 1903.

J. F. Hechtman  
George Goodwin  
Frank Gill

Filed and recorded at the request of J.F. Hechtman on the 3rd day of February A.D. 1904 at 25 minutes past 3 o'clock P.M.  
W. D. Fish County Recorder.

8/68  
J →



LOCATION NOTICE

NOTICE IS HEREBY GIVEN, that the Moonlight Mining Claim, containing mineral-bearing quartz, earth or rock in place, located by J.F.Hechtman, George Goodwin and Frank Gill citizens of the United States on this 22nd day of July, 1903, has been located for mining purposes. Said claim is 1,500 feet in length, and we claim 300 feet on each side of the center point of discovery shaft, for full length of claim. The general course of this lode, deposit or premises, is North-easterly & Southwesterly.

This claim is situated in Globe Mining District, Gila County Territory of Arizona, about three miles in a Northerly direction from the town of Globe, and is the Northeast extension of the Mineral Farm Mining Claim, owned by the Globe Mining Co., and lies parallel, and partly adjoins the Yuma Mining Claim, which is patented, on the northwest side thereof.

This claim is bounded and marked as follows, to-wit: Beginning at the S.W. center end post or monument, being 100 feet S.W. of the center of the point of discovery shaft upon which the notice is posted; thence 300 feet in a S.E. direction to a post or monument; thence 750 1500 feet in a N.E. direction to a post or monument ~~at the center of the side line of claim; thence 750 feet in a direction to a post or monument; thence 300 feet in a N.W. direction to a post or monument, being the center end post or monument of N.E. end of said claim and 1400 feet N.E. from the center of the point of discovery shaft; thence 300 feet in a N.W. direction to a post or monument; thence 750 1500 feet in a S.W. direction to a post or monument, being the center of the side line of claim; thence 750 feet in a direction to a post or monument;~~ thence 300 feet in a S.E. direction to the place of beginning.

Done under and by virtue of the laws of the United States, and the laws of the Territory of Arizona.

J.F.Hechtman  
George Goodwin  
Frank Gill  
Locators.

Recorded at request of J.F.Hechtman at 40 minutes past 2 o'clock P.M. September 9, A.D.1903.  
W.D.Fisk County Recorder.

7/16/03

J →







AMENDED  
Notice of Mining Location

LODE CLAIM

To All Whom It May Concern:

This Mining Claim, the name of which is the Iron Hive  
Mining Claim, situate on lands belonging to the United States of America, and in which there  
are valuable mineral deposits, was entered upon and located for the purposes of exploration and  
purchase by Geo. Goodwin, Chas. Mueller and J.F. Hechtman, citizens  
of the United States, and amended by Globe Mining Co., an  
Arizona Corporation, (Lodge of the United States, or, "who has declared his intention to become a citizen of the United States.")  
the undersigned, on the 22<sup>nd</sup> day of March 1909

The length of this claim is 1465.2 feet,  
and we claim 37 feet,  
in a Northeasterly direction and 1428.8  
feet in a Southwesterly direction from  
the center of the discovery shaft, at which this notice is posted, lengthwise of the claim, together  
with 300 feet in width of the surface grounds, on each  
side of the center of said claim. The general course of the lode deposit and premises is from the  
Northeasterly to the Southwest

The claim is situated and located in the Globe Mining District, in  
Gila County, in the Territory of Arizona, about three miles  
in a Northerly direction from Globe  
and joins the north side of the Iron Hive No. 2 and west end  
of Vacy-Constance.

The surface boundaries of the claim are marked upon the ground as follows: Beginning at  
a 3" x 3" post

at a point in a Northeasterly direction 37 feet from  
the discovery shaft (at which this notice is posted,) being in the center of the East  
end line of said claim; thence S. 54° 41' East 300 feet to a 4" x 4" post  
, being the Southeast corner of said claim; thence  
S. 29° 12' West 1465.2 feet to a 4" x 4" post, being at the  
Southwest corner of said claim; thence N. 54° 41' West 300 feet  
to a 4" x 4" post at the center of the West end of said claim;  
thence S. 54° 41' West 298.1 feet to a 4" x 4" post, being at the  
Northwest corner of said claim; thence N. 29° 12' East 1465.2  
feet to a 4" x 4" post at the Northeast corner of said claim;  
thence S. 54° 41' East 298.1 feet to the place of beginning.

All done under the provisions of Chapter Six, of Title XXXII, of the Revised Statutes of  
the United States, and of an Act of the General Assembly of Arizona, entitled "An Act to Revise  
and Codify the Laws of the Territory of Arizona," approved March 16, 1901.

This is an Amended Location Notice of the Iron Hive  
Mining Claim, located by Geo. Goodwin, Chas. Mueller and J.F. Hechtman, and  
amended by the Globe Mining Co. on the 29th day of  
December 1908, and recorded in Book 15 of Records of Mines, at  
page 243, in the office of the County Recorder of the aforesaid County of Gila  
to which reference is hereby made, and this Amended Location Notice is made and posted to  
correct errors in the description in the said original Location Notice.

Dated and posted on the ground this 22<sup>nd</sup> day of March 1909  
Filed and recorded at the re-  
quest of J. F. Hechtman at 10 Globe Mining Co.  
minutes past 9 o'clock A. M.  
on the 22 day of March A.D. 1909. By J. F. Hechtman  
E. T. Stewart County Recorder. President



TERRITORY OF ARIZONA, }  
 County of..... } ss.

I,....., County Recorder in and for the County and Territory aforesaid, do hereby certify that the within instrument was filed for record at.....o'clock,.....M., on this.....day of.....190..., and duly recorded in Book No..... of.....Records of.....County, Arizona, at pages.....

WITNESS my hand and official seal the day and year first above written.

.....  
 County Recorder.

AMENDED  
**Notice of Location.**  
 LODGE CLAIM.

Dated.....190.....

Filed and Recorded at request of

.....  
 A. D. 190.....

at.....M.

Book.....

Pages.....

.....  
 County Recorder.

By.....  
 Deputy Recorder.

THE H. H. MCNEIL CO., PRINTERS, PHOENIX, ARIZ.

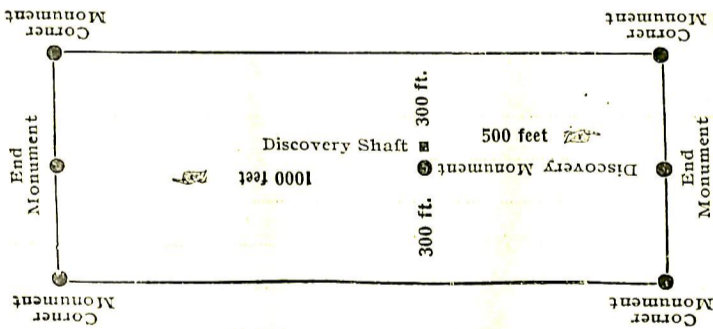

This diagram is to give locator a general idea of plan of location under the new law. The Discovery Shaft can be in the center of claim or any distance from either end desired. In the diagram it is placed 500 feet from one end and 1000 feet from the other. Commence description of claim at a center end monument, giving its distance and direction from center of Discovery Shaft; thence bound the claim in either direction. In description be careful to state locality of claim with reference to some natural object, or permanent monument, as will identify the claim.



AMENDED  
**Notice of Mining Location**

43

**LODE CLAIM**

To All Whom It May Concern:

This Mining Claim, the name of which is the Iron Hive No. 2 Mining Claim, situate on lands belonging to the United States of America, and in which there are valuable mineral deposits, was entered upon and located for the purposes of exploration and purchase by Geo. Goodwin and J.H. Hechtman, citizens of the United States and was amended by Globe Mining Co., an Arizona Corporation the under

(Locator must insert either "a citizen of the United States," or, "who has declared his intention to become a citizen of the United States.")

the undersigned, on the 22<sup>nd</sup> day of March 1909

The length of this claim is 1465.2 feet, and we claim 59 feet,

in a Southwesterly direction and

1406.2 feet in a Northeasterly direction from the center of the discovery shaft, at which this notice is posted, lengthwise of the claim, together with 300 feet in width of the surface grounds, on each

side of the center of said claim. The general course of the lode deposit and premises is from the Southwest to the Northeast

The claim is situated and located in the Globe Mining District, in Gila County, in the Territory of Arizona, about three miles in a Northerly direction from Globe and joins the Big Iron No. 3 and Big Iron No. 4, and Iron Hive mining claims.

The surface boundaries of the claim are marked upon the ground as follows: Beginning at 4" x 4" post

at a point in a Southwesterly direction 59 feet from the discovery shaft (at which this notice is posted,) being in the center of the West end line of said claim; thence No. 39° 32' East 300 feet to a 4" x 4" post, being the Northwest corner of said claim; thence No. 29° 12' East 1465.2 feet to 4" x 4" post, being at the Northeast corner of said claim; thence No. 39° 32' East 300 feet to 4" x 4" post at the center of the East end of said claim; thence No. 39° 32' East 271.1 feet to a 4" x 4" post, being at the Southeast corner of said claim; thence No. 29° 12' West 1465.2 feet to a 4" x 4" post at the Southwest corner of said claim; thence No. 39° 32' West 271.1 feet to the place of beginning.

All done under the provisions of Chapter Six, of Title XXXII, of the Revised Statutes of the United States, and of an Act of the General Assembly of Arizona, entitled "An Act to Revise and Codify the Laws of the Territory of Arizona," approved March 16, 1901.

This is an Amended Location Notice of the Iron Hive No. 2 Mining Claim, located by Geo. Goodwin and J. F. Hechtman on the 2<sup>nd</sup> day of December 1902, and recorded in Book 7 of Records of Mines, at page 634, in the office of the County Recorder of the aforesaid County of Gila to which reference is hereby made, and this Amended Location Notice is made and posted to correct errors in the description in the said original Location Notice.

Dated and posted on the ground this 22<sup>nd</sup> day March 1909 Filed and recorded at the request of J. F. Hechtman at 10 minutes past 9 o'clock A. M. on the 22 day of March A.D. 1909. By J. F. Hechtman President  
E. T. Stewart County Recorder.



TERRITORY OF ARIZONA, } ss.  
County of.....

I,....., County Recorder in and for the County and Territory aforesaid, do hereby certify that the within instrument was filed for record at.....o'clock,.....M., on this.....day of.....190..., and duly recorded in Book No..... of.....Records of.....County, Arizona, at pages.....

WITNESS my hand and official seal the day and year first above written.

.....  
County Recorder.

AMENDED  
**Notice of Location.**  
LODE CLAIM.

Dated.....190.....

Filed and Recorded at request of

.....  
A. D. 190.....

at.....M.

Book.....

Pages.....

.....  
County Recorder.

By.....  
Deputy Recorder.

THE H. H. MCNEIL CO., PRINTERS, PHOENIX, ARIZ.

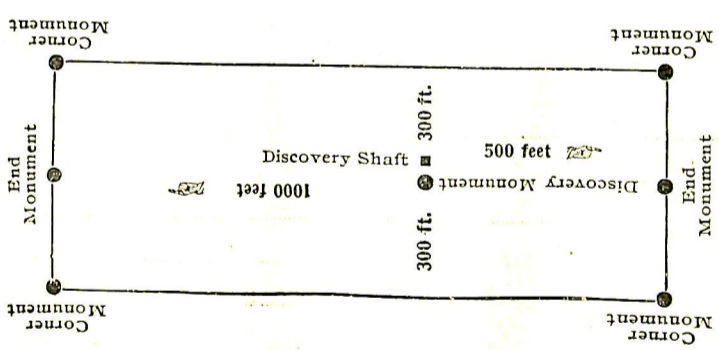

This diagram is to give locator a general idea of plan of location under the new law. The Discovery Shaft can be in the center of claim or any distance from either end desired. In the diagram it is placed 500 feet from one end and 1000 feet from the other. Commence description of claim at a center end monument, giving its distance and direction from center of Discovery Shaft; thence bound the claim in either direction. In description be careful to state locality of claim with reference to some natural object, or permanent monument, as will identify the claim.



# AMENDED Notice of Mining Location

## LODE CLAIM

To All Whom It May Concern:

This Mining Claim, the name of which is the New Orleans Mining Claim, situate on lands belonging to the United States of America, and in which there are valuable mineral deposits, was entered upon and located for the purposes of exploration and purchased by J. F. Hechtman, Geo. Goodwin and Frank Gill, citizens of the United States, and amended by the Globe Mining Co., an Arizona Corporation.

(Locator must insert either "a citizen of the United States," or "who has declared his intention to become a citizen of the United States.")  
the undersigned, on the 22<sup>nd</sup> day of March 1909

The length of this claim is 1450.4 feet, and we claim 20 feet, in a Southwesterly direction and 1430.4 feet in a Northeasterly direction from the center of the discovery shaft, at which this notice is posted, lengthwise of the claim, together with 300 feet in width of the surface grounds, on each side of the center of said claim. The general course of the lode deposit and premises is from the Southwest to the Northeast

The claim is situated and located in the Globe Mining District, in Gila County, in the Territory of Arizona, about Three miles in a Northerly direction from Globe and joins Moonlight and Mineral Farm No. 1 mining claims.

The surface boundaries of the claim are marked upon the ground as follows: Beginning at a 4" x 4" post

at a point in a Southwesterly direction 20 feet from the discovery shaft (at which this notice is posted), being in the center of the West end line of said claim; thence N. 28° 23' W. 298.5 feet to a 4" x 4" post, being the Northwest corner of said claim; thence N. 48° 22' E. 1450.4 feet to a 4" x 4" post, being at the Northeast corner of said claim; thence S. 28° 23' E. 298.5 feet to a 4" x 4" post at the center of the East end of said claim; thence S. 28° 23' E. 293.6 feet to a 4" x 4" post, being at the Southeast corner of said claim; thence S. 48° 22' W. 749.6 ft.; thence S. 47° 52' W. 702.2 feet to a 4" x 4" post at the Southwest corner of said claim; thence N. 28° 23' W. 300 feet to the place of beginning.

All done under the provisions of Chapter Six, of Title XXXII, of the Revised Statutes of the United States, and of an Act of the General Assembly of Arizona, entitled, "An Act to Revise and Codify the Laws of the Territory of Arizona," approved March 16, 1901.

This is an Amended Location Notice of the New Orleans Mining Claim, located by J. F. Hechtman, Geo. Goodwin and Frank Gill amended by them ~~on~~ on the 12th day of June 1903 and recorded in Book 9 of Records of Mines, at

page 168 in the office of the County Recorder of the aforesaid County of Gila to which reference is hereby made, and this Amended Location Notice is made and posted to correct errors in the description in the said original Location Notice.

Dated and posted on the ground this 22<sup>nd</sup> day of March 1909

Filed and recorded at the request of J. F. Hechtman at 10 minutes past 9 o'clock A. M. on the 22 day of March A.D. 1909.

Globe Mining Co.  
BY J. F. Hechtman  
President

E. T. Stewart County Recorder.



TERRITORY OF ARIZONA,

County of..... } ss.

I,....., County Recorder in and for the County and Territory aforesaid, do hereby certify that the within instrument was filed for record at.....o'clock.....M., on this.....day of.....19....., and duly recorded in Book No..... of.....Records of.....County, Arizona, at pages.....

WITNESS my hand and official seal the day and year first above written.

..... County Recorder.

AMENDED  
**Notice of Location.**  
LODE CLAIM.

Dated.....19.....

Filed and Recorded at request of.....

..... A. D. 19.....

at..... M.

Book.....

Pages.....

..... County Recorder.

By..... Deputy Recorder.

The H. H. McNeil Co., Printers, Phoenix, Arizona

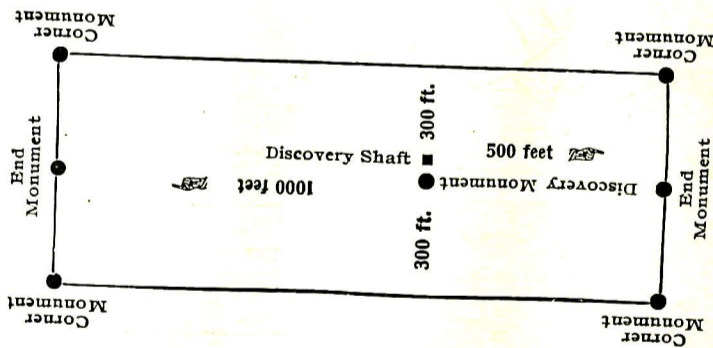

This diagram is to give locator a general idea of plan of location under the new law. The Discovery Shaft can be in the center of claim or any distance from either end desired. In the diagram it is placed 500 feet from one end and 1000 feet from the other. Commence description of claim at a center end monument, giving its distance and direction from center of Discovery Shaft; thence bound the claim in either direction. In description be careful to state locality of claim with reference to some natural object, or permanent monument, as will identify the claim.



AMENDED  
**Notice of Mining Location**

45

**LODE CLAIM**

To All Whom It May Concern:

This Mining Claim, the name of which is the Breach Mining Claim, situate on lands belonging to the United States of America, and in which there are valuable mineral deposits, was entered upon and located for the purposes of exploration and purchase by J. F. Hechtman, Geo. Goodwin and Frank Gill, citizens of the United States, and amended by Globe Mining Co., an Arizona corporation.

(Locator must insert either "a citizen of the United States," or, "who has declared his intention to become a citizen of the United States.")

the undersigned, on the 22<sup>nd</sup> day of March 1909

The length of this claim is 258.5 feet,  
and we claim 13 feet,  
in a Southwesterly direction and 245.5

feet in a Northeasterly direction from  
the center of the discovery shaft, at which this notice is posted, lengthwise of the claim, together  
with 300 feet in width of the surface grounds, on each

side of the center of said claim. The general course of the lode deposit and premises is from the  
Southwest to the Northeast

The claim is situated and located in the Globe Mining District, in  
Gila County, in the Territory of Arizona, about three miles  
in a Northerly direction from Globe

and joins Little Jennie, O'Dougherty, Mineral Farm and Mineral Farm No. 2 mining claims.

The surface boundaries of the claim are marked upon the ground as follows: Beginning at  
a 4" x 4" post

at a point in a Southwesterly direction 13 feet from  
the discovery shaft (at which this notice is posted,) being in the center of the West  
end line of said claim; thence N. 51° 30' W. 301.6 feet to a 4" x 4" post  
, being the Northwest corner of said claim; thence  
N. 30° 13' E. 258.5 feet to a 4" x 4" post, being at the  
Northeast corner of said claim; thence S. 51° 30' E. 301.6 feet  
to a 4" x 4" post at the center of the East end of said claim;  
thence S. 51° 30' E. 295.4 feet to a 4" x 4" post, being at the  
Southeast corner of said claim; thence S. 29° 57' W. 258.5  
feet to a 4" x 4" post at the Southwest corner of said claim;  
thence N. 51° 30' West 295.4 feet to the place of beginning.

All done under the provisions of Chapter Six, of Title XXXII, of the Revised Statutes of the United States, and of an Act of the General Assembly of Arizona, entitled "An Act to Revise and Codify the Laws of the Territory of Arizona," approved March 16, 1901.

This is an Amended Location Notice of the Breach Mining Claim, located by J. F. Hechtman, Geo. Goodwin and Frank Gill on the 19th day of January 1904, and recorded in Book 8 of Records of Mines, at page 91, in the office of the County Recorder of the aforesaid County of Gila to which reference is hereby made, and this Amended Location Notice is made and posted to correct errors in the description in the said original Location Notice.

Dated and posted on the ground this 22<sup>nd</sup> day of March 1909  
Filed and recorded at the request of J. F. Hechtman at Globe Mining Co.  
10 minutes past 9 o'clock A. M. By J. F. Hechtman  
on the 22 day of March A. D. 1909. President  
E. T. Stewart County Recorder.



TERRITORY OF ARIZONA, }  
 County of..... } ss.

I,....., County Recorder in and for the County and Territory aforesaid, do hereby certify that the within instrument was filed for record at.....o'clock,.....M., on this.....day of.....190..., and duly recorded in Book No..... of.....Records of.....County, Arizona, at pages.....

WITNESS my hand and official seal the day and year first above written.

.....  
 County Recorder.

AMENDED  
**Notice of Location.**  
 LODE CLAIM.

Dated.....190.....

Filed and Recorded at request of

.....  
 A. D. 190.....

at.....M.

Book.....

Pages.....

.....  
 County Recorder.

By.....  
 Deputy Recorder.

THE H. H. MCNEIL CO., PRINTERS, PHOENIX, ARIZ.

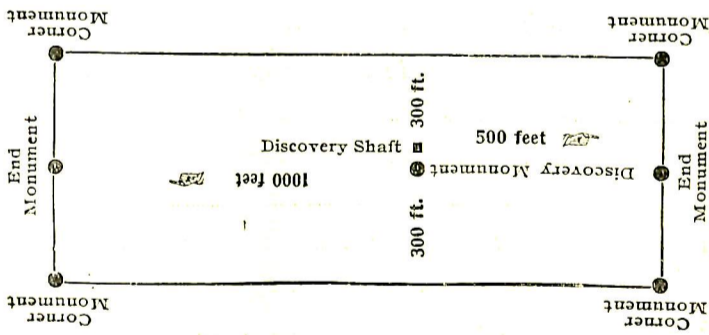

This diagram is to give locator a general idea of plan of location under the new law. The Discovery Shaft can be in the center of claim or any distance from either end desired. In the diagram it is placed 500 feet from one end and 1000 feet from the other. Commence description of claim at a center end monument, giving its distance and direction from center of Discovery Shaft; thence bound the claim in either direction. In description be careful to state locality of claim with reference to some natural object, or permanent monument, as will identify the claim.



AMENDED  
Notice of Mining Location

LODE CLAIM

To All Whom It May Concern:

This Mining Claim, the name of which is the Big Iron No. 1 Mining Claim, situate on lands belonging to the United States of America, and in which there are valuable mineral deposits, was entered upon and located for the purposes of exploration and purchase by J. F. Hechtman, Geo. Goodwin and Chas. Mueller, citizens of the United States, and amended by Globe Mining Company, an Arizona Corporation.

(Locator must insert either "a citizen of the United States," or, "who has declared his intention to become a citizen of the United States.")

the undersigned, on the 22<sup>nd</sup> day of March 1909.

The length of this claim is 1429.5 feet, and we claim 78 feet, in a Northeasterly direction and 1351.5 feet in a Southwesterly direction from the center of the discovery shaft, at which this notice is posted, lengthwise of the claim, together with 300 feet in width of the surface grounds, on each side of the center of said claim. The general course of the lode deposit and premises is from the Northeast to the Southwest.

The claim is situated and located in the Globe Mining District, in Gila County, in the Territory of Arizona, about three miles in a Northerly direction from Globe and joins Big Iron Nos. 2, 3 and 4, Mineral Farm Nos. 4 and 5, and Big Bluff mining Claims.

The surface boundaries of the claim are marked upon the ground as follows: Beginning at a 4" x 4" post.

at a point in a Northeasterly direction 78 feet from the discovery shaft (at which this notice is posted,) being in the center of the East end line of said claim; thence S. 12° 47' E. 286 feet to a 4" x 4" post, being the Southeast corner of said claim; thence S. 30° 32' West 1429.5 feet to a 4" x 4" post, being at the Southwest corner of said claim; thence N. 12° 47' West 286 feet to a 4" x 4" post at the center of the West end of said claim; thence N. 12° 47' West 310 feet to a 4" x 4" post, being at the Northwest corner of said claim; thence N. 30° 32' East 1429.5 feet to a 4" x 4" post at the Northeast corner of said claim; thence S. 12° 47' East 310 feet to the place of beginning.

All done under the provisions of Chapter Six, of Title XXXII, of the Revised Statutes of the United States, and of an Act of the General Assembly of Arizona, entitled "An Act to Revise and Codify the Laws of the Territory of Arizona," approved March 16, 1901.

This is an Amended Location Notice of the Big Iron No. 1 Mining Claim, located by J. F. Hechtman, Geo. Goodwin and Chas. Mueller, and amended by the Globe Mining Co. on the 29 day of December 1908, and recorded in Book 15 of Records of Mines, at page 244, in the office of the County Recorder of the aforesaid County of Gila to which reference is hereby made, and this Amended Location Notice is made and posted to correct errors in the description in the said original Location Notice.

Dated and posted on the ground this 22<sup>nd</sup> day of March 1909.  
Filed and recorded at the request of J. F. Hechtman at 10 minutes past 9 o'clock A. M. on the 22 day of March A.D. 1909.  
Globe Mining Co.  
By J. F. Hechtman President  
E. T. Stewart County Recorder.



TERRITORY OF ARIZONA,  
County of..... } ss.

I,....., County Recorder in and for the County and Territory aforesaid, do hereby certify that the within instrument was filed for record at.....o'clock,.....M., on this.....day of.....190..., and duly recorded in Book No..... of.....Records of.....County, Arizona, at pages.....

WITNESS my hand and official seal the day and year first above written.

.....  
County Recorder.

AMENDED  
**Notice of Location.**  
LODE CLAIM.

.....  
.....  
.....  
.....

Dated.....190.....

Filed and Recorded at request of

.....  
.....

.....A. D. 190.....

at.....M.

Book.....

Pages.....

.....  
County Recorder.

By.....  
Deputy Recorder.

THE H. H. MCNEIL CO., PRINTERS, PHOENIX, ARIZ.

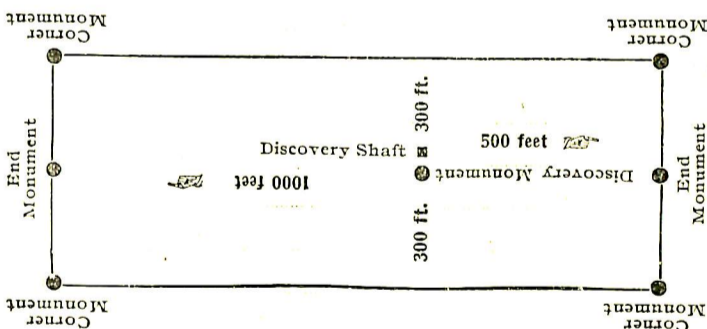

This diagram is to give locator a general idea of plan of location under the new law. The Discovery Shaft can be in the center of claim or any distance from either end desired. In the diagram it is placed 500 feet from one end and 1000 feet from the other. Commence description of claim at a center end monument, giving its distance and direction from center of Discovery Shaft; thence bound the claim in either direction. In description be careful to state locality of claim with reference to some natural object, or permanent monument, as will identify the claim.



AMENDED  
Notice of Mining Location

LODE CLAIM

To All Whom It May Concern:

This Mining Claim, the name of which is the Big Iron No. 2 Mining Claim, situate on lands belonging to the United States of America, and in which there are valuable mineral deposits, was entered upon and located for the purposes of exploration and purchase by J. F. Hechtman and George Goodwin, citizens of the United States, and was amended by Globe Mining Co., an Arizona Corporation (Locator must insert either "a citizen of the United States," or, "who has declared his intention to become a citizen of the United States.")

the undersigned, on the 22<sup>nd</sup> day of March 1909

The length of this claim is 1485.1 feet, and we claim 195 feet, in a Southwesterly direction and 1290.1 feet in a Northeasterly direction from the center of the discovery shaft, at which this notice is posted, lengthwise of the claim, together with 300 feet in width of the surface grounds, on each side of the center of said claim. The general course of the lode deposit and premises is from the Southwest to the Northeast

The claim is situated and located in the Globe Mining District, in Gila County, in the Territory of Arizona, about three miles in a Northerly direction from Globe and joins Big Iron No. 1, Big Iron No. 4, and Mineral Farm No. 4 mining claims.

The surface boundaries of the claim are marked upon the ground as follows: Beginning at 4" x 4" post

at a point in a Southwesterly direction 195 feet from the discovery shaft (at which this notice is posted,) being in the center of the West end line of said claim; thence N. 12° 47' West 310 feet to a 4" x 4" post, being the Northwest corner of said claim; thence N. 47° 49' East 1485.1 feet to a 4" x 4" post, being at the Northeast corner of said claim; thence S. 12° 47' East 310 feet to a 4" x 4" post at the center of the East end of said claim; thence S. 12° 47' East 286 feet to a 4" x 4" post, being at the Southeast corner of said claim; thence S. 47° 49' West 1485.1 feet to a 4" x 4" post at the Southwest corner of said claim; thence N. 12° 47' West 286 feet to the place of beginning.

All done under the provisions of Chapter Six, of Title XXXII, of the Revised Statutes of the United States, and of an Act of the General Assembly of Arizona, entitled "An Act to Revise and Codify the Laws of the Territory of Arizona," approved March 16, 1901.

This is an Amended Location Notice of the Big Iron No. 2 Mining Claim, located by J. F. Hechtman and George Goodwin on the 22<sup>nd</sup> day of November 1909, and recorded in Book 7 of Records of Mines, at page 635, in the office of the County Recorder of the aforesaid County of Gila to which reference is hereby made, and this Amended Location Notice is made and posted to correct errors in the description in the said original Location Notice.

Dated and posted on the ground this 22<sup>nd</sup> day of March 1909  
Filed and recorded at the request of J. F. Hechtman at 10 minutes past 9 o'clock A. M. on the 22 day of March A.D. 1909. By J. F. Hechtman President  
E. T. Stewart County Recorder



TERRITORY OF ARIZONA,  
 County of..... } ss.

I,....., County Recorder in and for the County and Territory aforesaid, do hereby certify that the within instrument was filed for record at.....o'clock,.....M., on this.....day of.....190..., and duly recorded in Book No..... of.....Records of.....County, Arizona, at pages.....

WITNESS my hand and official seal the day and year first above written.

.....  
 County Recorder.

AMENDED  
**Notice of Location.**  
 LODE CLAIM.

Dated..... 190.....

Filed and Recorded at request of

..... A. D. 190.....

at..... M.

Book.....

Pages.....

.....  
 County Recorder.

By.....  
 Deputy Recorder.

THE H. H. MCNEIL CO., PRINTERS, PHOENIX, ARIZ.

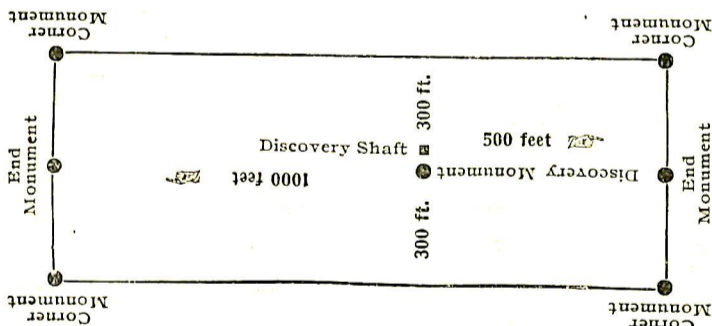

This diagram is to give locator a general idea of plan of location under the new law. The Discovery Shaft can be in the center of claim or any distance from either end desired. In the diagram it is placed 500 feet from one end and 1000 feet from the other. Commence description of claim at a center end monument, giving its distance and direction from center of Discovery Shaft; thence bound the claim in either direction. In description be careful to state locality of claim with reference to some natural object, or permanent monument, as will identify the claim.



AMENDED  
Notice of Mining Location

LODE CLAIM

To All Whom It May Concern:

This Mining Claim, the name of which is the Big Iron No. 3  
Mining Claim, situate on lands belonging to the United States of America, and in which there  
are valuable mineral deposits, was entered upon and located for the purposes of exploration and  
purchase by J. F. Hechtman and George Goodwin, and was amended by  
Globe Mining Co., an Arizona Corporation

(Locator must insert either "a citizen of the United States," or, "who has declared his intention to become a citizen of the United States.")  
the undersigned, on the 22<sup>nd</sup> day of March 1909

The length of this claim is 1367.6 feet,  
and we claim 20 feet,  
in a Northeasterly direction and 1347.6  
feet in a Southwesterly direction from  
the center of the discovery shaft, at which this notice is posted, lengthwise of the claim, together  
with 300 feet in width of the surface grounds, on each  
side of the center of said claim. The general course of the lode deposit and premises is from the  
Northeast to the Southwest

The claim is situated and located in the Globe Mining District, in  
Gila County, in the Territory of Arizona, about three miles  
in a Northerly direction from Globe  
and joins Big Iron 1, Big Iron No. 4 and Big Iron No. 5, Iron  
Hive No. and Big Bluff mining claims.

The surface boundaries of the claim are marked upon the ground as follows: Beginning at  
4" x 4" post

at a point in a Northeasterly direction 20 feet from  
the discovery shaft (at which this notice is posted,) being in the center of the East  
end line of said claim; thence S. 15° 40' East 300 feet to 4" x 4" post  
, being the Southeast corner of said claim; thence  
S. 30° 32' West 1367.6 feet to a 4" x 4" post, being at the  
Southwest corner of said claim; thence N. 15° 40' West 300 feet  
to a 4" x 4" post at the center of the West end of said claim;  
thence No. 15° 40' West 285.7 feet to a 4" x 4" post, being at the  
Northwest corner of said claim; thence N. 32° 27' E. 689.4; N. 29° 12'  
East 671.6 feet to a 4" x 4" post at the Northeast corner of said claim;  
thence S. 15° 40' East 277.8 feet to the place of beginning.

All done under the provisions of Chapter Six, of Title XXXII, of the Revised Statutes of  
the United States, and of an Act of the General Assembly of Arizona, entitled "An Act to Revise  
and Codify the Laws of the Territory of Arizona," approved March 16, 1901.

This is an Amended Location Notice of the Big Iron No. 3  
Mining Claim, located by J. F. Hechtman and George Goodwin  
on the 2nd day of  
December 1902, and recorded in Book 7 of Records of Mines, at  
page 635, in the office of the County Recorder of the aforesaid County of Gila  
to which reference is hereby made, and this Amended Location Notice is made and posted to  
correct errors in the description in the said original Location Notice.

Dated and posted on the ground this 22<sup>nd</sup> day of March 1909  
Filed and recorded at the re-  
quest of J. F. Hechtman at 10  
minutes past 9 o'clock A. M. Globe Mining Co.  
on the 22 day of March A.D. 1909. By J. F. Hechtman  
E. T. Stewart County Recorder. President



TERRITORY OF ARIZONA, }  
 County of..... } ss.

I,....., County Recorder in and for the County and Territory aforesaid, do hereby certify that the within instrument was filed for record at.....o'clock,.....M., on this.....day of.....190..., and duly recorded in Book No..... of.....Records of.....County, Arizona, at pages.....

WITNESS my hand and official seal the day and year first above written.

.....  
 County Recorder.

AMENDED  
**Notice of Location.**  
 LODGE CLAIM.

.....  
 .....

Dated.....190.....

Filed and Recorded at request of

.....  
 .....

at.....A. D. 190.....M.

Book.....

Pages.....

.....  
 County Recorder.

By.....  
 Deputy Recorder.

THE H. H. MCNEIL CO., PRINTERS, PHOENIX, ARIZ.

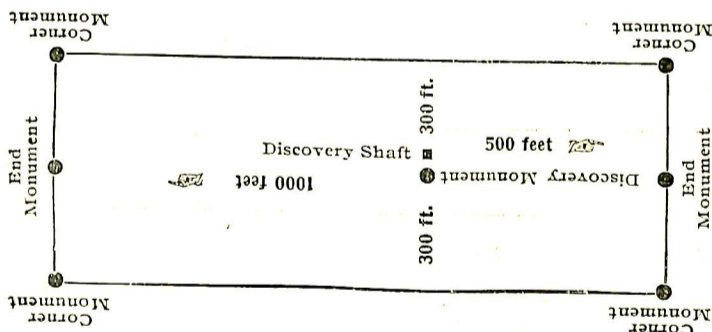

This diagram is to give locator a general idea of plan of location under the new law. The Discovery Shaft can be in the center of claim or any distance from either end desired. In the diagram it is placed 500 feet from one end and 1000 feet from the other. Commence description of claim at a center end monument, giving its distance and direction from center of Discovery Shaft; thence bound the claim in either direction. In description be careful to state locality of claim with reference to some natural object, or permanent monument, as will identify the claim.



AMENDED  
**Notice of Mining Location**

LODE CLAIM

To All Whom It May Concern:

This Mining Claim, the name of which is the Big Iron No. 4  
Mining Claim, situate on lands belonging to the United States of America, and in which there  
are valuable mineral deposits, was entered upon and located for the purposes of exploration and  
purchase by J. F. Hechtman and George Goodwin, citizens of the  
United States, and was amended by the Globe Mining Co., an Arizona  
Corporation.  
(Locators must insert either "a citizen of the United States," or, "who has declared his intention to become a citizen of the United States.")

the undersigned, on the 22<sup>nd</sup> day of March 1909  
The length of this claim is 1484.6 feet,  
and we claim 191 feet,  
in a S. 30° 32' W direction and 552.7 North 30° 32'  
E; 740.9 feet in a N. 47° 49' E. direction from  
the center of the discovery shaft, at which this notice is posted, lengthwise of the claim, together  
with 300 feet in width of the surface grounds, on each  
side of the center of said claim. The general course of the lode deposit and premises is from the  
Southwest to the Northeast

The claim is situated and located in the Globe Mining District, in  
Gila County, in the Territory of Arizona, about three miles  
in a Northerly direction from Globe  
and joins the Big Iron Nos. 1, 2 and 3, Iron Hive No. 2  
mining claims.

The surface boundaries of the claim are marked upon the ground as follows: Beginning at  
a 4" x 4" post  
at a point in a S. 30° 32' W direction 191 feet from  
the discovery shaft (at which this notice is posted,) being in the center of the West  
end line of said claim; thence N. 15° 40' W. 277.8 feet to a 4" x 4" post  
N. 29° 12' E. 793.5 feet being the Northwest corner of said claim; thence  
N. 53° 9' E. 686.4 feet to a 4" x 4" post, being at the  
Northeast corner of said claim; thence S. 15° 40' E 242.8 feet  
to a 4" x 4" post at the center of the East end of said claim;  
thence S. 15° 40' E. 300 feet to a 4" x 4" post, being at the  
Southeast corner of said claim; thence S. 47° 49' West 740.9 feet,  
thence 30° 32' W. 743.7 feet to a 4" x 4" post at the Southwest  
thence N. 15° 40' W 300 feet to the place of beginning.

All done under the provisions of Chapter Six, of Title XXXII, of the Revised Statutes of  
the United States, and of an Act of the General Assembly of Arizona, entitled "An Act to Revise  
and Codify the Laws of the Territory of Arizona," approved March 16, 1901.

This is an Amended Location Notice of the Big Iron No. 4  
Mining Claim, located J. F. Hechtman and Geo. Goodwin  
on the 2nd day of  
December 1902, and recorded in Book 7 of Records of Mines, at  
page 636, in the office of the County Recorder of the aforesaid County of Gila  
to which reference is hereby made, and this Amended Location Notice is made and posted to  
correct errors in the description in the said original Location Notice.

Dated and posted on the ground this 22<sup>nd</sup> day of March 1909  
Filed and recorded at the re- Globe Mining Co.  
quest of J. F. Hechtman at 10  
minutes past 9 o'clock A. M. on BY J. F. Hechtman  
the 22 day of March A.D. 1909. President  
E. T. Stewart County Recorder.



TERRITORY OF ARIZONA, }  
 County of..... } ss.

I,....., County Recorder in and for the County and Territory aforesaid, do hereby certify that the within instrument was filed for record at.....o'clock,.....M., on this.....day of.....190..., and duly recorded in Book No..... of.....Records of.....County, Arizona, at pages.....

WITNESS my hand and official seal the day and year first above written.

.....  
 County Recorder.

AMENDED  
**Notice of Location.**  
 LODE CLAIM.

Dated.....190.....

Filed and Recorded at request of

.....  
 A. D. 190.....

at.....M.

Book.....

Pages.....

.....  
 County Recorder.

By.....  
 Deputy Recorder.

THE H. H. MCNEIL CO., PRINTERS, PHOENIX, ARIZ.

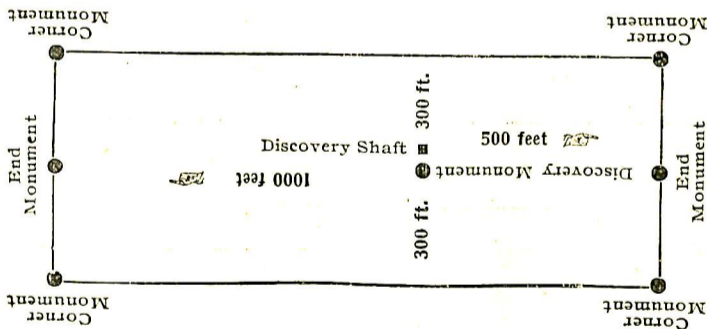

This diagram is to give locator a general idea of plan of location under the new law. The Discovery Shaft can be in the center of claim or any distance from either end desired. In the diagram it is placed 500 feet from one end and 1000 feet from the other. Commence description of claim at a center end monument, giving its distance and direction from center of Discovery Shaft; thence bound the claim in either direction. In description be careful to state locality of claim with reference to some natural object, or permanent monument, as will identify the claim.



# AMENDED Notice of Mining Location

## LODE CLAIM

To All Whom It May Concern:

This Mining Claim, the name of which is the Big Iron No. 5  
Mining Claim, situate on lands belonging to the United States of America, and in which there  
are valuable mineral deposits, was entered upon and located for the purposes of exploration and  
purchased by J. F. Hechtman, Geo. Goodwin and Frank Gill, citizens of  
the United States, and amended by the Globe Mining Co., an  
Arizona Corporation.

(Locator must insert either "a citizen of the United States," or "who has declared his intention to become a citizen of the United States.")

the undersigned, on the 22<sup>nd</sup> day of March 1909

The length of this claim is 1484.8 feet,  
and we claim 20 feet,  
in a Northeasterly direction and 1484.8  
feet in a Southwesterly direction from  
the center of the discovery shaft, at which this notice is posted, lengthwise of the claim, together  
with 300 feet in width of the surface grounds, on each  
side of the center of said claim. The general course of the lode deposit and premises is from the  
Northeast to the Southwest

The claim is situated and located in the Globe Mining District, in  
Gila County, in the Territory of Arizona, about three miles  
in a Northerly direction from Globe  
and joins the Big Iron No. and Big Bluff mining claims.

The surface boundaries of the claim are marked upon the ground as follows: Beginning at  
a 4" x 4" post

at a point in a Northeasterly direction 20 feet from  
the discovery shaft (at which this notice is posted), being in the center of the East  
end line of said claim; thence S. 15° 40' E. 300 feet to a 4" x 4" post  
, being the Southeast corner of said claim; thence  
S. 47° 57' W. 1484.8 feet to a 4" x 4" post, being at the  
Southwest corner of said claim; thence N. 15° 40' W. 300 feet  
to a 4" x 4" post at the center of the West end of said claim;  
thence N. 15° 40' W. 285.7 feet to a 4" x 4" post, being at the  
Northwest corner of said claim; thence N. 47° 57' E. 1484.8  
feet to a 4" x 4" post at the Northeast corner of said claim;  
thence S. 15° 40' E. 285.7 feet to the place of beginning.

All done under the provisions of Chapter Six, of Title XXXII, of the Revised Statutes of  
the United States, and of an Act of the General Assembly of Arizona, entitled, "An Act to Revise and  
Codify the Laws of the Territory of Arizona," approved March 16, 1901.

This is an Amended Location Notice of the Big Iron No. 5  
Mining Claim, located by J. F. Hechtman, Geo. Goodwin and Frank Gill  
and amended by them on the 8th day of  
March 1904 and recorded in Book 8 of Records of Mines, at

page 91 in the office of the County Recorder of the aforesaid County of Gila  
to which reference is hereby made, and this Amended Location Notice is made and posted to correct  
errors in the description in the said original Location Notice.

Dated and posted on the ground this 22<sup>nd</sup> day of March 1909

Filed and recorded at the request of  
J. F. Hechtman at 10 minutes past Globe Mining Co.  
9 o'clock A. M. on the 22 day  
of March A.D. 1909 By J. F. Hechtman  
President

E. T. Stewart County Recorder.



TERRITORY OF ARIZONA, }  
 County of ..... } ss.

I, ..... County Recorder in and for the County and Territory aforesaid, do hereby certify that the within instrument was filed for record at ..... o'clock ..... M., on this ..... day of ..... 19....., and duly recorded in Book No. .... of ..... Records of ..... County, Arizona, at pages .....

WITNESS my hand and official seal the day and year first above written.

.....  
 County Recorder.

AMENDED  
**Notice of Location.**  
 LOPE CLAIM.

Dated ..... 19.....

Filed and Recorded at request of .....

..... A. D. 19.....

at ..... M.

Book .....

Pages .....

..... County Recorder.

By ..... Deputy Recorder.

The H. H. McNeil Co., Printers, Phoenix, Arizona

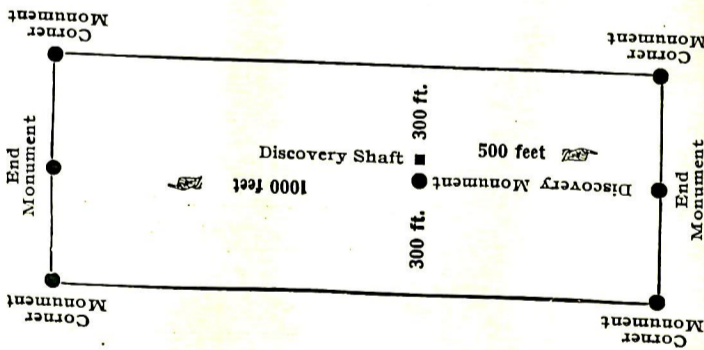

This diagram is to give locator a general idea of plan of location under the new law. The Discovery Shaft can be in the center of claim or any distance from either end desired. In the diagram it is placed 500 feet from one end and 1000 feet from the other. Commence description of claim at a center end monument, giving its distance and direction from center of Discovery Shaft; thence bound the claim in either direction. In description be careful to state locality of claim with reference to some natural object, or permanent monument, as will identify the claim.



AMENDED  
Notice of Mining Location

LODE CLAIM

To All Whom It May Concern:

This Mining Claim, the name of which is the Big Bluff  
Mining Claim, situate on lands belonging to the United States of America, and in which there  
are valuable mineral deposits, was entered upon and located for the purposes of exploration and  
purchase by J. F. Hechtman, Geo. Goodwin and Frank Gill, citizens of  
the United States, and amended by the Globe Mining Co., an  
Arizona Corporation.

(Locator must insert either "a citizen of the United States," or, "who has declared his intention to become a citizen of the United States.")

the undersigned, on the 22<sup>nd</sup> day of March 1909

The length of this claim is 1398.1 feet,  
and we claim 10 feet,  
in a N.30° 32' E direction and 671.7' S.30°32' W.  
thence 716.4 feet in a S.47° 57' W. direction from

the center of the discovery shaft, at which this notice is posted, lengthwise of the claim, together  
with 300 feet in width of the surface grounds, on each  
side of the center of said claim. The general course of the lode deposit and premises is from the  
Northeast to the Southwest

The claim is situated and located in the Globe Mining District, in  
Gila County, in the Territory of Arizona, about three mile  
in a Northerly direction from Globe  
and joins the southwest end of the Big Iron No.1 mining claim.

The surface boundaries of the claim are marked upon the ground as follows: Beginning at  
a 4" x 4" post

at a point in a N.30° 32' E. direction 10 feet from  
the discovery shaft (at which this notice is posted,) being in the center of the East  
end line of said claim; thence S.12° 47' E. 286 feet to a 4" x 4" post  
S.30°32' W. 707 feet; being the Southeast corner of said claim; thence  
S.50° 21' W. 680 feet to a 4" x 4" post, being at the  
Southwest corner of said claim; thence N.12° 47' W. 216.2 feet  
to a 4" x 4" post at the center of the West end of said claim;  
thence N.12° 47' W. 310 feet to a 4" x 4" post, being at the  
Northwest corner of said claim; thence N.47° 57' E. 716.4 feet;  
thence N.30°32' E. 681.7  
feet to a 4" x 4" post at the Northeast corner of said claim;  
thence S.12° 47' E. 310 feet to the place of beginning.

All done under the provisions of Chapter Six, of Title XXXII, of the Revised Statutes of  
the United States, and of an Act of the General Assembly of Arizona, entitled "An Act to Revise  
and Codify the Laws of the Territory of Arizona," approved March 16, 1901.

This is an Amended Location Notice of the Big Bluff  
Mining Claim, located by J. F. Hechtman, Geo. Goodwin and Frank Gill, and  
amended by them on the 8th day of  
March 1909, and recorded in Book 8 of Records of Mines, at  
page 90, in the office of the County Recorder of the aforesaid County of Gila  
to which reference is hereby made, and this Amended Location Notice is made and posted to  
correct errors in the description in the said original Location Notice.

Dated and posted on the ground this 22<sup>nd</sup> day of March 1909  
Filed and recorded at the re-  
quest of J. F. Hechtman at 10 Globe Mining Co.  
minutes past 9 o'clock A. M. on By J. F. Hechtman  
the 22 day of March A.D. 1909. President  
E. T. Stewart County Recorder.



TERRITORY OF ARIZONA,  
 County of..... } ss.

I,....., County Recorder in and for the County and Territory aforesaid, do hereby certify that the within instrument was filed for record at.....o'clock,.....M., on this.....day of.....190..., and duly recorded in Book No..... of.....Records of.....County, Arizona, at pages.....

WITNESS my hand and official seal the day and year first above written.

.....  
 County Recorder.

AMENDED  
**Notice of Location.**  
 LODGE CLAIM.

Dated.....190.....

Filed and Recorded at request of

.....  
 A. D. 190.....

at.....M.

Book.....

Pages.....

.....  
 County Recorder.

By.....  
 Deputy Recorder.

THE H. H. MCNEIL CO., PRINTERS, PHOENIX, ARIZ.

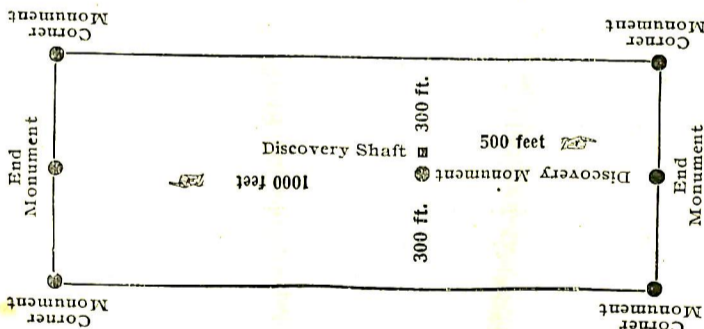

This diagram is to give locator a general idea of plan of location under the new law. The Discovery Shaft can be in the center of claim or any distance from either end desired. In the diagram it is placed 500 feet from one end and 1000 feet from the other. Commence description of claim at a center end monument, giving its distance and direction from center of Discovery Shaft; thence bound the claim in either direction. In description be careful to state locality of claim with reference to some natural object, or permanent monument, as will identify the claim.



292

AMENDED

# Notice of Mining Location

## LODE CLAIM

To All Whom It May Concern:

This Mining Claim, the name of which is the Los Angeles Mining Claim, situate on lands belonging to the United States of America, and in which there are valuable mineral deposits, was entered upon and located for the purposes of exploration and purchase by J. F. Hechtman, Geo. Goodwin and Frank Gill, citizens of the United States, and amended by Globe Mining Co., an Arizona Corporation.

(Locator must insert either "a citizen of the United States," or, "who has declared his intention to become a citizen of the United States.")

the undersigned, on the 22<sup>nd</sup> day of March 1909

The length of this claim is 0 1472 feet, and 78 claim 78 feet,

in a Northeasterly direction and 1398 feet in a Southwesterly direction from

the center of the discovery shaft, at which this notice is posted, lengthwise of the claim, together with 300 feet in width of the surface grounds, on each

side of the center of said claim. The general course of the lode deposit and premises is from the Northeast to the Southwest

The claim is situated and located in the Globe Mining District, in Gila County, in the Territory of Arizona, about three miles

in a Northerly direction from Globe and joins Mineral Farm No. 3, Mineral Farm No. 5 and Big Bluff

mining claims.

The surface boundaries of the claim are marked upon the ground as follows: Beginning at a 4" x 4" post

at a point in a Northeasterly direction 78 feet from the discovery shaft (at which this notice is posted), being in the center of the East

end line of said claim; thence S. 28° 23' E. 300 feet to a 4" x 4" post, being the Southeast corner of said claim; thence

S. 50° 21' W. 1472 feet to a 4" x 4" post, being at the Southwest corner of said claim; thence N. 28° 23' W. 300 feet

to a 4" x 4" post at the center of the West end of said claim; thence N. 28° 23' W. 300 feet to a 4" x 4" post, being at the

Northwest corner of said claim; thence N. 50° 21' E. 1472 feet to a 4" x 4" post at the Northeast corner of said claim; thence S. 28° 23' E. 300 feet to the place of beginning.

All done under the provisions of Chapter Six, of Title XXXII, of the Revised Statutes of the United States, and of an Act of the General Assembly of Arizona, entitled "An Act to Revise and Codify the Laws of the Territory of Arizona," approved March 16, 1901.

This is an Amended Location Notice of the Los Angeles Mining Claim, located by J. F. Hechtman, Geo. Goodwin and Frank Gill, and

amended by them x on the 8th day of March 1904, and recorded in Book 8 of Records of Mines, at

page 90, in the office of the County Recorder of the aforesaid County of Gila to which reference is hereby made, and this Amended Location Notice is made and posted to correct errors in the description in the said original Location Notice.

Dated and posted on the ground this 22<sup>nd</sup> day of March 1909

Filed and recorded at the request of J. F. Hechtman at 10 minutes past 9 o'clock A. M., on the 22 day of March A.D. 1909.

Globe Mining Co.  
By J. F. Hechtman  
President

E. T. Stewart County Recorder.



TERRITORY OF ARIZONA, }  
 County of..... } ss.

I,....., County Recorder in and for the County and Territory aforesaid, do hereby certify that the within instrument was filed for record at.....o'clock,.....M., on this.....day of.....190..., and duly recorded in Book No..... of.....Records of.....County, Arizona, at pages.....

WITNESS my hand and official seal the day and year first above written.

.....  
 County Recorder.

AMENDED  
**Notice of Location.**  
 LODE CLAIM.

Dated..... 190.....

Filed and Recorded at request of.....

.....  
 A. D. 190.....

at..... M.

Book.....

Pages.....

.....  
 County Recorder.

By.....  
 Deputy Recorder.

The H. H. McNeil Co., Printers, Phoenix

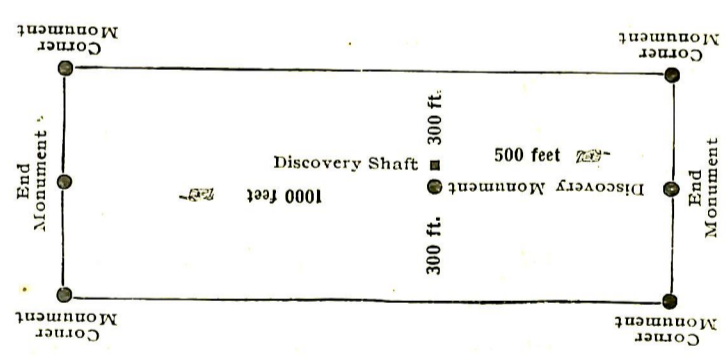

This diagram is to give locator a general idea of plan of location under the new law. The Discovery Shaft can be in the center of claim or any distance from either end desired. In the diagram it is placed 500 feet from one end and 1000 feet from the other. Commence description of claim at a center end monument, giving its distance and direction from center of Discovery Shaft; thence bound the claim in either direction. In description be careful to state locality of claim with reference to some natural object, or permanent monument, as will identify the claim.



258

# AMENDED Notice of Mining Location

## LODE CLAIM

To All Whom It May Concern:

This Mining Claim, the name of which is the Mineral Farm Mining Claim, situate on lands belonging to the United States of America, and in which there are valuable mineral deposits, was entered upon and located for the purposes of exploration and purchase by J. F. Hechtman, Geo. Goodwin and Chas. Mueller, citizens of the United States, and amended by the Globe Mining Co., an Arizona Corporation.

(Locator must insert either "a citizen of the United States," or, "who has declared his intention to become a citizen of the United States.")

the undersigned, on the 22<sup>nd</sup> day of March 1909.

The length of this claim is 1442.1 feet, and we claim 70 feet,

in a Northeasterly direction and 1372.1 feet in a Southwesterly direction from

the center of the discovery shaft, at which this notice is posted, lengthwise of the claim, together with 300 feet in width of the surface grounds, on each

side of the center of said claim. The general course of the lode deposit and premises is from the

Northeast to the Southwest

The claim is situated and located in the Globe Mining District, in

Gila County, in the Territory of Arizona, about three miles

in a Northerly direction from Globe

and joins the O'Dougherty, Yuma, Moonlight, Mineral Farm No. 1, Mineral Farm No. 2 and Breach Mining Claims

The surface boundaries of the claim are marked upon the ground as follows: Beginning at

4" x 4" post at a point in a Northeasterly direction 8

at a point in a Northeasterly direction 70 feet from

the discovery shaft (at which this notice is posted,) being in the center of the Northeast

end line of said claim; thence South 53° 30' 266 feet to a 4" x 4"

post, being the Southwest corner of said claim; thence

S. 26° 11' W. 279.8 ft.; thence S. 29° 37' W. 1445.3 feet to a 4" x 4" post, being at the

Southwest corner of said claim; thence N. 53° 30' W. 295.4 feet

to a 4" x 4" post at the center of the West end of said claim;

thence N. 53° 30' W. 301.6 feet to a 4" x 4" post, being at the

Northwest corner of said claim; thence N. 30° 13' E. 1463

feet to a 4" x 4" post at the Northeast corner of said claim;

thence S. 53° 30' E. 301.6 feet to the place of beginning.

All done under the provisions of Chapter Six, of Title XXXII, of the Revised Statutes of the United States, and of an Act of the General Assembly of Arizona, entitled "An Act to Revise and Codify the Laws of the Territory of Arizona," approved March 16, 1901.

This is an Amended Location Notice of the Mineral Farm Mining Claim, located by J. F. Hechtman, Geo. Goodwin and Chas. Mueller

on the 2nd day of

December 1902, and recorded in Book 7 of Records of Mines, at

page 532, in the office of the County Recorder of the aforesaid County of Gila

to which reference is hereby made, and this Amended Location Notice is made and posted to

correct errors in the description in the said original Location Notice.

Dated and posted on the ground this 22<sup>nd</sup> day of March 1909

Filed and recorded at the Globe Mining Co. request of J. F. Hechtman at 10 minutes past 9 o'clock A. M. By J. F. Hechtman on the 22 day of March A.D. 1909. President

E. T. Stewart County Recorder.



TERRITORY OF ARIZONA,

County of..... } ss.

I,....., County Recorder in and for the County and Territory aforesaid, do hereby certify that the within instrument was filed for record at.....o'clock,.....M., on this.....day of.....190..., and duly recorded in Book No..... of.....Records of.....County, Arizona, at pages.....

WITNESS my hand and official seal the day and year first above written.

..... County Recorder.

AMENDED Notice of Location. LODE CLAIM.

Dated.....190.....

Filed and Recorded at request of

.....A. D. 190.....

at.....M.

Book.....

Pages.....

.....County Recorder.

By.....Deputy Recorder.

THE H. H. MCNEIL CO., PRINTERS, PHOENIX, ARIZ.

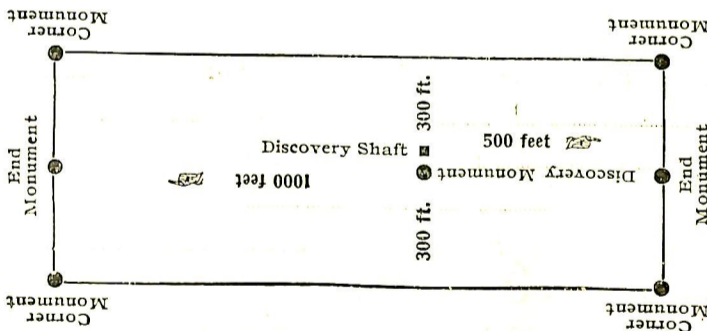

This diagram is to give locator a general idea of plan of location under the new law. The Discovery Shaft can be in the center of claim or any distance from either end desired. In the diagram it is placed 500 feet from one end and 1000 feet from the other. Commence description of claim at a center end monument, giving its distance and direction from center of Discovery Shaft; thence bound the claim in either direction. In description be careful to state locality of claim with reference to some natural object, or permanent monument, as will identify the claim.



# AMENDED Notice of Mining Location

## LODE CLAIM

To All Whom It May Concern:

This Mining Claim, the name of which is the Mineral Farm No. 1 Mining Claim, situate on lands belonging to the United States of America, and in which there are valuable mineral deposits, was entered upon and located for the purposes of exploration and purchase by J. F. Hechtman, Geo. Goodwin and Chas. Mueller, citizens of the United States, and amended by Globe Mining Co., an Arizona Corporation.

(Locator must insert either "a citizen of the United States," or, "who has declared his intention to become a citizen of the United States.")

the undersigned, on the 22<sup>nd</sup> day of March 1909.

The length of this claim is 1500 feet, and the claim 38 feet, in S. 30° 13' W. direction and 872 ft. in a N. 30° 13' E. thence 590 ft. N. 47° 52' E. feet in a \_\_\_\_\_ direction from the center of the discovery shaft, at which this notice is posted, lengthwise of the claim, together with 300 feet in width of the surface grounds, on each side of the center of said claim. The general course of the lode deposit and premises is from the Southwest to the Northeast.

The claim is situated and located in the Globe Mining District, in Gila County, in the Territory of Arizona, about three miles in a North erly direction from Globe and joins Mineral Farm, Mineral Farm Nos. 2 and 4, Moonlight and New Orleans mining claims.

The surface boundaries of the claim are marked upon the ground as follows: Beginning at a 4" x 4" post

at a point in a Southwesterly direction 38 feet from the discovery shaft (at which this notice is posted), being in the center of the West end line of said claim; thence N. 28° 23' W. 340 feet to a 4" x 4" post being the Northwest corner of said claim; thence N. 30° 13' W. 745 ft.; thence N. 47° 52' E. 734.8 feet to a 4" x 4" post, being at the Northeast corner of said claim; thence S. 28° 23' E. 298.5 feet to a 4" x 4" post at the center of the East end of said claim; thence S. 28° 23' E. 300 feet to a 4" x 4" post, being at the Southwest corner of said claim; thence S. 47° 52' W. 734.8 ft.; thence S. 30° 13' W. 745 feet to a 4" x 4" post at the Southwest corner of said claim; thence N. 28° 23' W. 258 feet to the place of beginning.

All done under the provisions of Chapter Six, of Title XXXII, of the Revised Statutes of the United States, and of an Act of the General Assembly of Arizona, entitled "An Act to Revise and Codify the Laws of the Territory of Arizona," approved March 16, 1901.

This is an Amended Location Notice of the Mineral Farm No. 1 Mining Claim, located by J. F. Hechtman, Geo. Goodwin and Chas. Mueller on the 22<sup>nd</sup> day of November 1902, and recorded in Book 7 of Records of Mines, at page 632, in the office of the County Recorder of the aforesaid County of Gila to which reference is hereby made, and this Amended Location Notice is made and posted to correct errors in the description in the said original Location Notice.

Dated and posted on the ground this 22<sup>nd</sup> day of March 1909.

Filed and recorded at the request of J. F. Hechtman at 10 minutes past 9 o'clock A. M. on the 22 day of March A.D. 1909.  
By J. F. Hechtman President  
E. T. Stewart County Recorder.



TERRITORY OF ARIZONA, }  
 County of..... } ss.

I,....., County Recorder in and for the County and Territory aforesaid, do hereby certify that the within instrument was filed for record at.....o'clock,.....M., on this.....day of.....190..., and duly recorded in Book No..... of.....Records of.....County, Arizona, at pages.....

WITNESS my hand and official seal the day and year first above written.

.....  
 County Recorder.

AMENDED  
**Notice of Location.**  
 LODGE CLAIM.

.....  
 .....

Dated.....190.....

Filed and Recorded at request of

.....  
 .....

A. D. 190.....

at.....M.

Book.....

Pages.....

County Recorder.

By.....  
 Deputy Recorder.

The H. H. McNeil Co., Printers, Phoenix

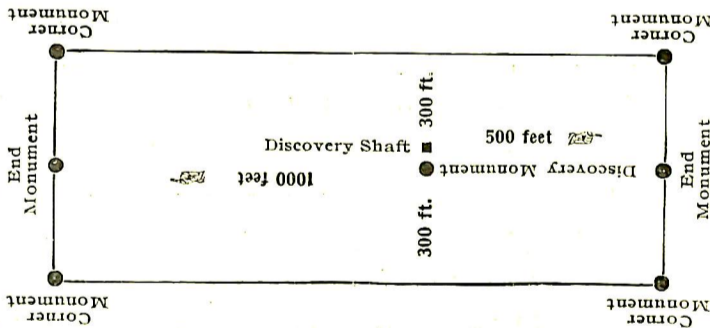

This diagram is to give locator a general idea of plan of location under the new law. The Discovery Shaft can be in the center of claim or any distance from either end desired. In the diagram it is placed 500 feet from one end and 1000 feet from the other. Commence description of claim at a center end monument, giving its distance and direction from center of Discovery Shaft; thence bound the claim in either direction. In description be careful to state locality of claim with reference to some natural object, or permanent monument, as will identify the claim,



AMENDED  
**Notice of Mining Location**

55

**LODE CLAIM**

To All Whom It May Concern:

This Mining Claim, the name of which is the Mineral Farm No. 2  
Mining Claim, situate on lands belonging to the United States of America, and in which there  
are valuable mineral deposits, was entered upon and located for the purposes of exploration and  
purchase by J. F. Hechtman, Geo. Goodwin and Chas. Mueller, citizens  
of the United States, and amended by the Globe Mining Co., an  
Arizona Corporation.  
(Locator must insert either "a citizen of the United States," or, "who has declared his intention to become a citizen of the United States.")

the undersigned, on the 22<sup>nd</sup> day of March 1909

The length of this claim is 1406.2 feet,  
and no claim 49 feet,

in a Northeasterly direction and

1357.2 feet in a Southwesterly direction from

the center of the discovery shaft, at which this notice is posted, lengthwise of the claim, together  
with 300 feet in width of the surface grounds, on each

side of the center of said claim. The general course of the lode deposit and premises is from the  
Northeast to the Southwest

The claim is situated and located in the Globe Mining District, in  
Gila County, in the Territory of Arizona, about three miles

in a Northerly direction from Globe

and joins the Mineral Farm, Breach, Little Jennie, Mineral Farm  
No. 3, Mineral Farm No. 5 and Mineral Farm No. 1 mining claims.

The surface boundaries of the claim are marked upon the ground as follows: Beginning at  
4" x 4" post

at a point in a Northeasterly direction 49 feet from

the discovery shaft (at which this notice is posted,) being in the center of the East  
end line of said claim; thence South 28° 23' E. 258 feet to a 4" x 4" post

, being the Southeast corner of said claim; thence  
South 30° 13' W. 957.6 feet to a 4" x 4" post, being at the

Southwest corner of said claim; thence No. 28° 23' West 105.9 feet  
to a 4" x 4" post at the center of the West end of said claim;

thence No. 28° 23' West 340 feet to a 4" x 4" post, being at the  
Northwest corner of said claim; thence No. 30° 29' West 1406.2

feet to a 4" x 4" post at the Northeast corner of said claim;  
thence So. 28° 23' East 340 feet to the place of beginning.

All done under the provisions of Chapter Six, of Title XXXII, of the Revised Statutes of  
the United States, and of an Act of the General Assembly of Arizona, entitled "An Act to Revise  
and Codify the Laws of the Territory of Arizona," approved March 16, 1901.

This is an Amended Location Notice of the Mineral Farm No. 2  
Mining Claim, located by J. F. Hechtman, George Goodwin and Charles  
Mueller on the 22nd day of

November 1902, and recorded in Book 7 of Records of Mines, at  
page 633, in the office of the County Recorder of the aforesaid County of Gila

to which reference is hereby made, and this Amended Location Notice is made and posted to  
correct errors in the description in the said original Location Notice.

Dated and posted on the ground this 22<sup>nd</sup> day of March 1909

Filed and recorded at the re- Globe Mining Co.  
quest of J. F. Hechtman at 10  
minutes past 9 o'clock A. M. By J. F. Hechtman  
on the 22 day of March A.D. 1909. President

E. T. Stewart County Recorder.



TERRITORY OF ARIZONA,

County of..... } ss.

I,....., County Recorder in and for the County and Territory aforesaid, do hereby certify that the within instrument was filed for record at.....o'clock,.....M., on this.....day of.....190..., and duly recorded in Book No..... of.....Records of.....County, Arizona, at pages.....

WITNESS my hand and official seal the day and year first above written.

County Recorder.

AMENDED Notice of Location. LODE CLAIM.

Dated.....190.....

Filed and Recorded at request of

.....A. D. 190.....

at.....M.....

Book.....

Pages.....

.....County Recorder.

By.....Deputy Recorder.

THE H. H. McNEIL CO., PRINTERS, PHOENIX, ARIZ.

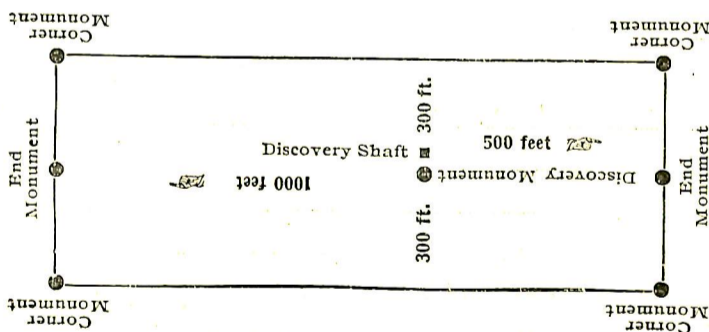

This diagram is to give locator a general idea of plan of location under the new law. The Discovery Shaft can be in the center of claim or any distance from either end desired. In the diagram it is placed 500 feet from one end and 1000 feet from the other. Commence description of claim at a center end monument, giving its distance and direction from center of Discovery Shaft; thence bound the claim in either direction. In description be careful to state locality of claim with reference to some natural object, or permanent monument, as will identify the claim.



# AMENDED Notice of Mining Location

## LODE CLAIM

### To All Whom It May Concern:

This Mining Claim, the name of which is the Mineral Farm No. 3  
Mining Claim, situate on lands belonging to the United States of America, and in which there  
are valuable mineral deposits, was entered upon and located for the purposes of exploration and  
purchased by J. F. Hechtman, Geo. Goodwin and Frank Gill, citizens  
of the United States, and amended by the Globe Mining Co., an  
Arizona Corporation.

(Locator must insert either "a citizen of the United States," or "who has declared his intention to become a citizen of the United States.")

the undersigned, on the 22<sup>nd</sup> day of March 1909.

The length of this claim is 1472 feet,  
and we claim 382 feet,  
in a Southwesterly direction and 1090  
feet in a Northeasterly direction from  
the center of the discovery shaft, at which this notice is posted, lengthwise of the claim, together  
with 300 feet in width of the surface grounds, on each  
side of the center of said claim. The general course of the lode deposit and premises is from the  
Southwest to the Northeast

The claim is situated and located in the Globe Mining District, in  
Gila County, in the Territory of Arizona, about three miles  
in a Northerly direction from Globe  
and joins Little Jennie, Hechtman, Los Angeles, and Mineral  
Farm No. 2 mining claims.

The surface boundaries of the claim are marked upon the ground as follows: Beginning at  
a 4" x 4" post

at a point in a Southwesterly direction 382 feet from  
the discovery shaft (at which this notice is posted), being in the center of the West  
end line of said claim; thence N. 28° 23' W. 260 feet to a 4" x 4" post  
, being the Northwest corner of said claim; thence  
N. 50° 21' E. 1472 feet to a 4" x 4" post, being at the  
Northeast corner of said claim; thence S. 28° 23' E. 260 feet  
to a 4" x 4" post at the center of the East end of said claim;  
thence S. 28° 23' E. 185.9 feet to a 4" x 4" post, being at the  
Southeast corner of said claim; thence S. 50° 21' W. 1472  
feet to a 4" x 4" post at the Southwest corner of said claim;  
thence N. 28° 23' W. 185.9 feet to the place of beginning.

All done under the provisions of Chapter Six, of Title XXXII, of the Revised Statutes of  
the United States, and of an Act of the General Assembly of Arizona, entitled, "An Act to Revise and  
Codify the Laws of the Territory of Arizona," approved March 16, 1901.

This is an Amended Location Notice of the Mineral Farm No. 3  
Mining Claim, located by J. F. Hechtman, Geo. Goodwin and Frank Gill  
on the 23rd day of  
June 1903, and recorded in Book 9 of Records of Mines, at  
page 170, in the office of the County Recorder of the aforesaid County of Gila  
to which reference is hereby made, and this Amended Location Notice is made and posted to correct  
errors in the description in the said original Location Notice.

Dated and posted on the ground this 22<sup>nd</sup> day of March 1909.

Filed and recorded at the re-  
quest of J. F. Hechtman at 10  
minutes past 9 o'clock A. M., on  
the 22 day of March A.D. 1909.

Globe Mining Co.  
By J. F. Hechtman  
President

E. T. Stewart County Recorder



TERRITORY OF ARIZONA,

County of.....

ss.

I,....., County Recorder in and for the County and Territory aforesaid, do hereby certify that the within instrument was filed for record at.....o'clock.....M., on this.....day of.....19....., and duly recorded in Book No..... of.....Records of.....County, Arizona, at pages.....

WITNESS my hand and official seal the day and year first above written.

..... County Recorder.

AMENDED  
**Notice of Location.**  
LODE CLAIM.

Dated.....19.....

Filed and Recorded at request of.....

.....A. D. 19.....

at.....M.

Book.....

Pages.....

..... County Recorder.

By..... Deputy Recorder.

The H. H. McNeil Co., Printers, Phoenix, Arizona

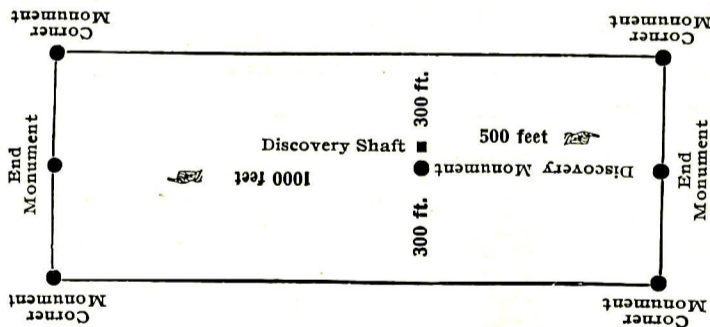

This diagram is to give locator a general idea of plan of location under the new law. The Discovery Shaft can be in the center of claim or any distance from either end desired. In the diagram it is placed 500 feet from one end and 1000 feet from the other. Commence description of claim at a center end monument, giving its distance and direction from center of Discovery Shaft; thence bound the claim in either direction. In description be careful to state locality of claim with reference to some natural object, or permanent monument, as will identify the claim.



290

20

AMENDED

# Notice of Mining Location

## LODE CLAIM

To All Whom It May Concern:

This Mining Claim, the name of which is the Mineral Farm No. 4 Mining Claim, situate on lands belonging to the United States of America, and in which there are valuable mineral deposits, was entered upon and located for the purposes of exploration and purchase by J. F. Hechtman, Geo. Goodwin and Chas. Mueller, citizens of the United States, and amended by the Globe Mining Co., an Arizona Corporation of the United States," or, "who has declared his intention to become a citizen of the United States."

the undersigned, on the 22<sup>nd</sup> day of March 1909

The length of this claim is 1467.5 feet, and we claim 83 feet, in a Southwesterly direction and N.30°32' E. 647.4 feet; thence 737.1 feet in a N.47° 49' E. direction from the center of the discovery shaft, at which this notice is posted, lengthwise of the claim, together with 300 feet in width of the surface grounds, on each side of the center of said claim. The general course of the lode deposit and premises is from the

Southwest to the Northeast.

The claim is situated and located in the Globe Mining District, in Gila County, in the Territory of Arizona, about three miles in a Northerly direction from Globe and joins Mineral Farm No. 1 and No. 5, and Big Iron Nos. 1 and 2 mining claims.

The surface boundaries of the claim are marked upon the ground as follows: Beginning at a 4" x 4" post

at a point in a Southwesterly direction 83 feet from the discovery shaft (at which this notice is posted), being in the center of the West end line of said claim; thence N.28° 23' W. 300 feet to a 4" x 4" post being the Northwest corner of said claim; thence N. 30° 32' E. 730.4 feet Thence 47°49' E. 737.1 feet to a 4" x 4" post, being at the Northeast corner of said claim; thence S.28° 23' E. 300 feet to a 4" x 4" post at the center of the East end of said claim; thence S. 28° 23' E. 292.4 feet to a 4" x 4" post, being at the Southwest corner of said claim; thence S.47° 52' W. 734.8 feet thence S.30° 13' W. 745 feet to a 4" x 4" post at the Southwest corner of said claim; thence N.28° 23' W. 300 feet to the place of beginning.

All done under the provisions of Chapter Six, of Title XXXII, of the Revised Statutes of the United States, and of an Act of the General Assembly of Arizona, entitled "An Act to Revise and Codify the Laws of the Territory of Arizona," approved March 16, 1901.

This is an Amended Location Notice of the Mineral Farm No. 4 Mining Claim, located by J. F. Hechtman, Geo. Goodwin and Chas. Mueller on the 2nd day of December 1909, and recorded in Book 7 of Records of Mines, at page 633, in the office of the County Recorder of the aforesaid County of Gila to which reference is hereby made, and this Amended Location Notice is made and posted to correct errors in the description in the said original Location Notice.

Dated and posted on the ground this 22<sup>nd</sup> day of March 1909.

Filed and recorded at the request of J. F. Hechtman at 10 minutes past 9 o'clock A. M. on the 22 day of March A.D. 1909.

Globe Mining Co.

By J. F. Hechtman President

E. T. Stewart County Recorder.



TERRITORY OF ARIZONA, }  
County of..... } ss.

I,....., County Recorder in and for the County and Territory aforesaid, do hereby certify that the within instrument was filed for record at.....o'clock,.....M., on this.....day of.....190..., and duly recorded in Book No..... of.....Records of.....County, Arizona, at pages.....

WITNESS my hand and official seal the day and year first above written.

.....  
County Recorder.

AMENDED  
**Notice of Location.**  
LODE CLAIM.

.....  
.....  
.....  
.....

Dated.....190.....

Filed and Recorded at request of

.....  
.....

.....A. D. 190.....

at.....M.....

Book.....

Pages.....

.....County Recorder.

By.....Deputy Recorder.

.....  
The H. H. McNeil Co., Printers, Phoenix

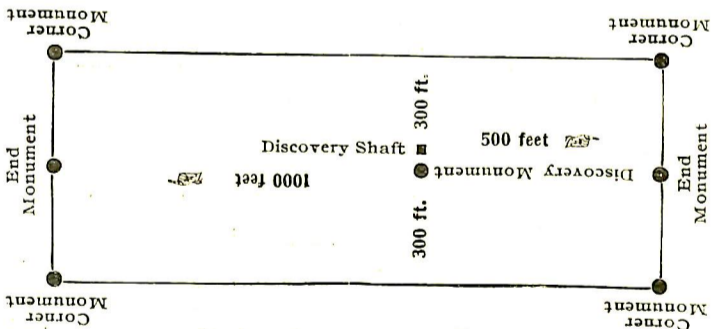

This diagram is to give locator a general idea of plan of location under the new law. The Discovery Shaft can be in the center of claim or any distance from either end desired. In the diagram it is placed 500 feet from one end and 1000 feet from the other. Commence description of claim at a center end monument, giving its distance and direction from center of Discovery Shaft; thence bound the claim in either direction. In description be careful to state locality of claim with reference to some natural object, or permanent monument, as will identify the claim.



AMENDED  
Notice of Mining Location

LODE CLAIM

To All Whom It May Concern:

This Mining Claim, the name of which is the Mineral Farm No. 5  
Mining Claim, situate on lands belonging to the United States of America, and in which there  
are valuable mineral deposits, was entered upon and located for the purposes of exploration and  
purchase by J. F. Hechtman and Geo. Goodwin, citizens of the  
United States, and amended by the Globe Mining Co., an Arizona  
Corporation.

(Locator must insert either "a citizen of the United States," or, "who has declared his intention to become a citizen of the United States.")  
the undersigned, on the 22<sup>nd</sup> day of March 1909.

The length of this claim is 1406.2 feet,  
and we claim 36 feet,  
in a Northeasterly direction and 1370.2  
feet in a Southwesterly direction from  
the center of the discovery shaft, at which this notice is posted, lengthwise of the claim, together  
with 300 feet in width of the surface grounds, on each  
side of the center of said claim. The general course of the lode deposit and premises is from the  
Northeast to the Southwest

The claim is situated and located in the Globe Mining District, in  
Gila County, in the Territory of Arizona, about three miles  
in a Northerly direction from Globe  
and joins Mineral Farm No. 2, Mineral Farm No. 4, Big Iron No. 1,  
Big Bluff and Los Angeles.

The surface boundaries of the claim are marked upon the ground as follows: Beginning at  
4" x 4" post

at a point in a Northeasterly direction 36 feet from  
the discovery shaft (at which this notice is posted,) being in the center of the East  
end line of said claim; thence So. 28° 23' East 300 feet to a 4" x 4" post  
, being the Southeast corner of said claim; thence  
So. 30° 29' West 1406.2 feet to a 4" x 4" post, being at the  
Southwest corner of said claim; thence No. 28° 23' East 300 feet  
to a 4" x 4" post at the center of the West end of said claim;  
thence No. 28° 23' West 300 feet to a 4" x 4" post, being at the  
Northwest corner of said claim; thence No. 30° 29' East 1406.2  
feet to a 4" x 4" post at the Northeast corner of said claim;  
thence So. 28° 23' East 300 feet to the place of beginning.

All done under the provisions of Chapter Six, of Title XXXII, of the Revised Statutes of  
the United States, and of an Act of the General Assembly of Arizona, entitled "An Act to Revise  
and Codify the Laws of the Territory of Arizona," approved March 16, 1901.

This is an Amended Location Notice of the Mineral Farm No. 5  
Mining Claim, located by J. F. Hechtman, and George Goodwin  
on the 2nd day of  
December 1902, and recorded in Book 7 of Records of Mines, at  
page 634, in the office of the County Recorder of the aforesaid County of Gila  
to which reference is hereby made, and this Amended Location Notice is made and posted to  
correct errors in the description in the said original Location Notice.

Dated and posted on the ground this 22<sup>nd</sup> day of March 1909.

Filed and recorded at the re-  
quest of J. F. Hechtman at 10 Globe Mining Co.  
minutes past 9 o'clock A. M. By J. F. Hechtman  
on the 22 day of March A.D. 1909. President  
E. T. Stewart County Recorder,



TERRITORY OF ARIZONA, }  
 County of..... } ss.

I,....., County Recorder in and for the County and Territory aforesaid, do hereby certify that the within instrument was filed for record at.....o'clock,.....M., on this.....day of.....190..., and duly recorded in Book No..... of.....Records of.....County, Arizona, at pages.....

WITNESS my hand and official seal the day and year first above written.

.....  
 County Recorder.

AMENDED  
**Notice of Location.**  
 LODE CLAIM.

.....  
 .....

Dated.....190.....

Filed and Recorded at request of

.....  
 .....

A. D. 190.....

at.....M.

Book.....

Pages.....

County Recorder.

By.....  
 Deputy Recorder.

THE H. H. MCNEIL CO., PRINTERS, PHOENIX, ARIZ.

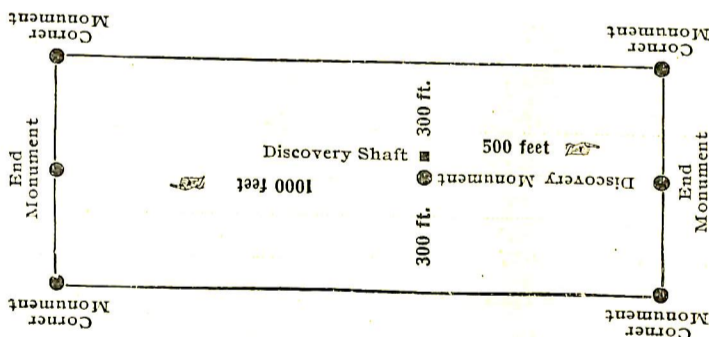

This diagram is to give locator a general idea of plan of location under the new law. The Discovery Shaft can be in the center of claim, or any distance from either end desired. In the diagram it is placed 500 feet from one end and 1000 feet from the other. Commence description of claim at a center end monument, giving its distance and direction from center of Discovery Shaft; thence bound the claim in either direction. In description be careful to state locality of claim with reference to some natural object, or permanent monument, as will identify the claim.



Territory of Arizona,)
   
County of Gila. ) :ss.

I, E. T. Stewart, County Recorder in and for the County of Gila, Territory of Arizona, do hereby certify that the above and foregoing contain and constitute full, true and correct copies of Amended Location Notices as the same appear of record in my office in the Book and Pages as follows, to-wit:

Mineral Farm	Book 15	Records of Mines	Page 286
Mineral Farm No. 1	" 15	" " "	" 287
Mineral Farm No. 2	" 15	" " "	" 288
Mineral Farm No. 3	" 15	" " "	" 289
Mineral Farm No. 4	" 15	" " "	" 290
Mineral Farm No. 5	" 15	" " "	" 291
Los Angeles	" 15	" " "	" 292
Big Bluff	" 15	" " "	" 293
New Orleans	" 15	" " "	" 294
Breach	" 15	" " "	" 295
Big Iron No. 1	" 15	" " "	" 296
Big Iron No. 2	" 15	" " "	" 297
Big Iron No. 3	" 15	" " "	" 298
Big Iron No. 4	" 15	" " "	" 299
Big Iron No. 5	" 15	" " "	" 300
Iron Hive	" 15	" " "	" 301
Iron Hive No. 2	" 15	" " "	" 302

that I have compared the same with the original record, and that the same are true transcripts and of the whole thereof.

Given under my hand and seal of office this 24th day of March A.D. 1909.

E. T. Stewart County Recorder.

By

Belle Maldonado  
Deputy Recorder.



4-688.

## U. S. SURVEYOR-GENERAL'S FINAL CERTIFICATE ON FIELD NOTES.

## Department of the Interior,

OFFICE OF U. S. SURVEYOR-GENERAL,

Phoenix, Arizona,

October 14, 1909

I, U. S. Surveyor-General for District of Arizona,

do hereby certify that the foregoing transcript of the Field Notes, return and approval of the survey

of the mining claim of Globe Mining Company, known as the  
 MINERAL FARM, MINERAL FARM NO. 1, MINERAL FARM NO. 2, MINERAL  
 FARM NO. 3, MINERAL FARM NO. 4, MINERAL FARM NO. 5, IRON HIVE,  
 IRON HIVE NO. 2, MOONLIGHT, BIG IRON NO. 1, BIG IRON NO. 2,  
 BIG IRON NO. 3, BIG IRON NO. 4, BREACH, HECHTMAN, GILL, VACY-  
 CONSTANCE, BIG IRON NO. 5, BIG BLUFF, NEW ORLEANS, LOS ANGELES,  
 situate in Globe

Mining District, Gila County, Arizona,  
 1, 12 & 13 1 N. 15 E.  
 in Sections Approx. 6, 7 Township No. 1 N., Range No. 16 E. Unsur. and  
 designated as Survey No. 2618, has been correctly copied from the originals on file in

this office; that said Field Notes furnish such an accurate description of said mining claim as will, if  
 incorporated into a patent, serve fully to identify the premises, and that such reference is made therein  
 to natural objects or permanent monuments as will perpetuate and fix the *locus* thereof.

And I further certify that five hundred dollars' worth of labor has been expended or improve-  
 ments made upon <sup>or for each of</sup> said mining claim<sup>s</sup> by claimant or its grantors, and that said improvements  
 consist of 6 tunnels, 27 cuts, 25 shafts and 60 ft. of underground  
 workings, total value \$23,330.00. Shaft No. 4 on the Big Iron  
 No. 1 lode being a common improvement for the benefit and devel-  
 opment of the twenty-one lodes of this survey, value \$14,400,  
 an undivided 1/21 interest therein, value \$685.70, is properly  
 credited to each of the claims in this survey.

and that no portion of said labor or improvements has been included in the estimate of expenditures  
 upon any other claim.

I further certify that the plat thereof, filed in the U. S. Land Office at Phoenix,  
 Arizona, is correct and in conformity with the foregoing Field Notes.

Frank S. Ingalls,

United States Surveyor-General for Arizona.



4-687.

**SURVEYOR-GENERAL'S CERTIFICATE OF APPROVAL OF FIELD  
NOTES AND SURVEY OF MINING CLAIM.**

**Department of the Interior,**

*Office of U. S. Surveyor-General,*

Phoenix, Arizona,

October 14, 1909

I, U. S. Surveyor-General for District of Arizona,

do hereby certify that the foregoing and hereto attached Field Notes and Return of the Survey of the

Mining Claim of Globe Mining Company, known as the

MINERAL FARM, MINERAL FARM NO. 1, MINERAL FARM NO. 2, MINERAL  
FARM NO. 3, MINERAL FARM NO. 4, MINERAL FARM NO. 5, IRON HIVE,  
IRON HIVE NO. 2, MOONLIGHT, BIG IRON NO. 1, BIG IRON NO. 2,  
BIG IRON NO. 3, BIG IRON NO. 4, BREACH, HECHTMAN, GILL, VACY-  
CONSTANCE, BIG IRON NO. 5, BIG BLUFF, NEW ORLEANS, LOS ANGELES

situate in Globe Mining District,

Gila County, Arizona

in Sections 1, 12 & 13, Township No. 1 N., Range No. 15 E., Unsur.  
Approx. 6, 7, Township No. 1 N., Range No. 16 E., Unsur.

designated as Survey No. 2618

executed by H. C. Hopkins, U. S. Deputy Mineral

Surveyor, April 1 - June 1, 1909, under my instructions dated

March 29, 1909, have been critically examined and the necessary

corrections and explanations made, and the said Field Notes and Return, and the Survey they describe,

are hereby approved. A true copy of the copy of the location certificate filed by the applicant for

survey is included in the field notes.

*Frank S. Galloway*

U. S. Surveyor-General for Arizona.