

M
S

0

2

6

2

1

MINERAL SURVEY NO. 2621

Claims	M & B Desc.	Improvements	Loc. Notices
Apex	Pg. 3	Pg. 21	Pg. 3
Cochise	9	22	8
El Sobrante	1	21	2
Fireball	5	21	6
Iron Hat	13	23	9
Little Eva	10	22	1
Neptune	7	21	7
Pappoose	15	23	10
Rico	17	23	12
Snow Ball	4	21	4
Valley	19	23	5
Wedge 3	12	22	11

COPIED June 15-09,
A. L. H.

Platted

2
APR 12 1909
MAY 13 1909

JUN 1 - 1909 *error*

4-683.

MINERAL SURVEY No. 2621

LOT No. _____

*Estimate of cost
11-9-01
Complete \$25.
without \$1000
#140*

Arizona

Land District.

FIELD NOTES

OF THE SURVEY OF THE MINING CLAIM OF

SAVAGE GOLD & COPPER CO.

KNOWN AS THE

LITTLE EVA, EL SOBRANTE, APEX, SNOW BALL, VALLEY, FIREBALL, NEPTUNE,
COCHISE, IRON HAT, PAPPOOSE, WEDGE 3, RICO.

CALIFORNIA

Mining District,

COCHISE

County,

ARIZONA

Sections 9, 10, 11, 14, 15 Township 17 S., Range 31 E.

Surveyed under instructions dated JANUARY 23, 1909.

by H. W. JORGENSEN

U. S. Mineral Surveyor.

Claim located *See Location Notices*, 19

Survey commenced FEBRUARY 5, 1909

Survey completed FEBRUARY 14, 1909

6-822

Dates of location notices.

Little Eva,	Aug. 17, 1903.	Neptune,	Apr. 2, 1904.
El Sobrante,	Apr. 28, 1904.	Cochise,	Jan. 12, 1904.
Apex.	Feb. 20, 1904	Iron Hat,	Apr. 30, 1904.
Snow Ball	July 15, 1903.	Pappoose,	Apr. 28, 1904.
Valley,	Apr. 1, 1904.	Wedge 3,	Feb. 12, 1905.
Fireball	Mar. 8, 1905.	Rico,	Apr. 1, 1904.

Claimant's address, Portal, Arizona.

Claimant's attorneys, Richardson & Doan, Douglas, Arizona.

Feet.

SURVEY NO. 2621.
-- El Sobrante lode --

Beginning at Cor. No. 1, the southeast corner, identical with location and on line 3-4 Iron Hat lode of this survey, a pine post 4 ins. sq., 4 ft. long, set 1 ft. in the ground in a monument of stones and scribed on the N.W. side, 1-2621 ESL, whence a limestone boulder 8 ins. X 20 ins. and 12 ins. above the surface, chiseled X-2621BR brs S. 6° 37' W., 6.70 ft., and a limestone boulder 5 ft. X 5 ft. X 3 ft. having the same chiseling brs S. 72° W., 12.7 ft., and the Corner to Secs. 10, 11, 14, and 15, T. 17 S., R. 31 E. brs S. 78° 30' E., 1393.5 ft.

Thence S. 89° 29' 30" W.

44.0 To Cors No. 3 and 4 of the Iron Hat and Apex lodes, respectively, of this survey.

1484.1 Same bearing, to Cor. No. 2, the southwest corner, identical with location and on line 3-4 Apex lode of this survey, a pine post 4 ins. sq., 4 ft. long, set 1 ft. in the ground to bedrock and surrounded by a monument of stones, scribed on the N.E. side, 2-2621 ESL, whence an X-2621BR chiseled on limestone bedrock 2 ft. X 4 ft. and 6 ins. high brs S. 2° 50' W. 24.6 ft., and a similar chiseling on limestone bedrock 10 ft. X 3 ft., and 18 ins. high brs S. 51° 20' E., 15.85 ft.

Thence N. 2° 22' W.

300. To original location for W. E. C., a monument of stones, 3 ft. high and 3 ft. diameter at base.

600.0 Same bearing to Cor. No. 3, the northwest corner, identical with location, a pine post 4 ins. sq., 4 ft. long, set 1 ft. in the ground to bedrock, surrounded by a monument of stones and scribed on the S.E. side, 3-2621 ESL, whence an X-2621BR chiseled on limestone bedrock 5 ft. X 6 ft. and 4 ins. high brs N. 2° 30' W., 3.94 ft., and a similar chiseling on limestone bedrock 3 ft. X 4 ft., and level with the surface brs N. 89° E. 9.79 ft.

Thence N. 89° 29' 30" E.

1484.1 To Cor. No. 4, the northeast corner, identical with location,

Feet

SURVEY NO. 2621.
El Sobrante lode continued.

a pine post 4 ins. sq., 4 ft. long, set 1 ft. in the ground in a mound of stones and scribed on the S.W. side, 4-2621 ESL, whence a limestone boulder 1 ft. X 2 ft. and 10 ins. high, chiseled X-2621BR brs S. 2° 15' W., 12.75 ft., and a similar chiseling on a limestone boulder 18 ins. X 36 ins. and 12 ins. high brs S. 88° 34' W., 13.9 ft.

Thence S. 2° 22' E.

300. To original location for E.E.C., a monument of stones, 2½ ft. high and 3 ft. diameter at base.

600.0 Same bearing to Cor. No. 1, the place of beginning.

Ledge.

The presumed course of the ledge on this claim is from the W.E.C., N. 89° 29' 30" E., 1484.1 feet.

-- Apex lode --

Beginning at Cor. No. 1, the southeast corner, identical with location and with Cor. No. 2 Iron Hat lode of this survey, and on line 4-1 Cochise lode of this survey, a pine post 4 ins. sq., 4 ft. long, set 1 ft. in the ground to bedrock in a mound of stones and scribed on the N.W. side, 1-2621AL, whence an X-2621BR chiseled on limestone bedrock 18 ins. X 18 ins. and 6 ins. high brs S. 15° 42' E., 12.36 ft., and a similar chiseling on a limestone boulder 2 ft. X 3 ft. and 1 ft. high brs S. 84° 47' W., 6.05 ft., and the corner to Secs. 10, 11, 14, and 15, T. 17 S., R. 31 E., brs N. 76° 54' E. 1421.3 feet.

Thence S. 89° 29' 30" W.

146.6 To Cors. No. 4 and 1 of the Cochise and Fireball lodes, respectively, of this survey.

1491.1 Same bearing to intersection with Section line between Secs. 10 and 15 at N. 83° 21' E., 2369.4 ft. from the corner to Secs. 15, 16, 9 and 10, and S. 83° 21' W. 2894.9 ft. from the corner to Secs. 10, 11, 14, and 15.

1500.0 Same bearing to Cor. No. 2, the southwest corner, identical with location and with Cors No. 5 and 4 of the Fireball

Feet.

SURVEY NO. 2621.
Apex lode continued.

and Little Eva lodes, respectively, of this survey, a pine post 4 ins. sq., 4 ft. long, set 1 ft. in the ground to bedrock in a mound of stones and scribed on the N.E. side 2-2621AL, whence an X-2621BR chiseled on limestone bedrock 12 ins. X 30 ins. and 4 ins. high brs S. 21° 50' W., 12.1 ft., and a similar chiseling on limestone bedrock 4 ft. X 4 ft., and 1 ft. high brs S. 57° 10' E., 15.35 ft.

Thence N. 2° 24' W.

300. To original location for W.E.C., a monument of stones, 3½ ft. high and 4 ft. diameter at base.

600.0 Same bearing to Cor. No. 3, the northwest corner, identical with location and with Cor. No. 3 Little Eva lode of this survey, a pine post 4 ins. sq., 4 ft. long, set 1 ft. in the ground to bedrock, in a mound of stones and scribed on the S.E. side 3-2621 AL, whence an X-2621BR chiseled on limestone bedrock 6 ft. X 10 ft., and 8 ins. high brs S. 7° W., 14.95 ft., and a similar chiseling on a sloping limestone face 10 ft. long and 3 ft. high brs S. 85° 30' W., 21.5 ft.

Thence N. 89° 29' 30" E.

59.9 To Cor. No. 2 El Sobrante lode of this survey.

1500.0 Same bearing to Cor. No. 4, the northeast corner, identical with location and with Cor. No. 3 Iron Hat lode of this survey a pine post 4 ins. sq., 4 ft. long set 1 ft. in the ground to bedrock in a mound of stones and scribed on the S.W. side 4-2621 AL, whence an X-2621BR chiseled on a sloping face of limestone 8 ft. long and 3 ft. high brs S. 72° 40' W., 11.58 ft. and a similar chiseling on a limestone boulder 5 ft. X 6 ft. and 13 ins. high brs S. 19° 02' E., 26.9 ft.

Thence S. 2° 24' E.

300. To original location for E.E.C., a monument of stones 3 ft. high and 3 ft. in diameter at base.

440.0 Same bearing to intersection with the section line between Secs. 10 and 15 at N. 83° 21' E., 3863.8 ft. from the corner to Secs. 15, 16, 9, and 10, and S. 83° 21' W. 1400.5 ft. from the corner to Secs. 10, 11, 14, and 15.

Feet.

SURVEY NO. 2621.
Apex lode continued.

6

600.0 Same bearing to Cor.No.1, the place of beginning.

Ledge.

The presumed course of the ledge on this claim is from the W.E.C., N.89°29'30"E., 1500. ft.

-- Snow Ball lode--

Beginning at Cor.No.1, the northeast corner, identical with location and with Cor.No.2 Fireball lode of this survey, and on line 4-3 Cochise lode of this survey, a pine post 4 ins. sq., 4 ft. long, set 1 ft. in the ground to bedrock in a mound of stones and scribed on the S.W. side 1-2621SL, whence an X-2621BR chiseled on limestone bedrock 2 ft. X 4 ft. and level with the surface brs N.27°55'W., 6.73 ft., and a similar chiseling on limestone bedrock 6 ft. X 8 ft., and 1 ft. high brs S.82°25'E., 32.0 ft., and the corner to Secs. 10, 11, 14, and 15, T.17 S., R.31 E. brs N.71°35'E., 1604.7 ft.

Thence S. 2° 39' E.

300. To original location for E.E.C., a monument of stones 2½ ft. high and 3 ft. in diameter at base.

416.0 Same bearing to Cor.No.2, the southeast corner, identical with location and with Cors.No.3 and 5 of the Cochise and Neptune lodes, respectively, of this survey, a pine post 4 ins. sq., 4 ft. long, set 1 ft. in the ground to bedrock in a monument of stones and scribed on the N.W. side 2-2621SL, whence an X-2621BR chiseled on a sloping limestone face 5 ft. X 10 ft. brs N.41°30'E., 8.05 ft., and a similar chiseling on limestone bedrock 6 ft. X 8 ft. and 4 ins. above the surface brs N.64°22'W., 6.68 ft., and Cor.No.4 Neptune lode identical with Cor.No.2 Wedge 3 lode, both of this survey brs N.85°56'W., 523.3 ft.

Thence S.82° 14' W.

409.0 To center of narrow ^ugauge track running N.W. and S.E.

529.2 Same bearing to intersection with line 4-3 Neptune lode identical with line 2-3 Wedge 3 lode, both of this survey, at S.1°32'30"W., 108.7 ft. from Cors No.4 and 2 of the

Feet.

SURVEY NO. 2621.
Snow Ball lode continued.

Neptune and Wedge 3 lodes, respectively.

1210. Same bearing to center of road to mine, running N.W. and S.E.

1505.1 Same bearing to Cor. No. 3, the Southwest corner, identical with location, a pine post 4 ins. sq., 4 ft. long, set 18 ins. in the ground in a monument of stones and scribed on the N.E. side 3-2621 SL, whence a limestone boulder 10 ins. X 18 ins. and 6 ins high chiseled X-2621BR brs N. 22° E., 20.44 ft. and a similar boulder 6 ins. X 14 ins. and 3 ins above the surface, and chiseled the same brs N. 73° 15' E., 54.5 ft.

Thence N. 2° 39' W.

187.5 To Cor. No. 4 Rico lode of this survey, and to intersection with line 2-1 Wedge 3 lode of this survey at S. 86° 53' W. 979.4 ft. from Cor. No. 2.

208. Same bearing to center of road to mine, running N.W. and S.E.

300. Same bearing to original location for W.E.C., a monument of stones 3 ft. high and 4 ft. in diameter at base.

600.0 Same bearing to Cor. No. 4, the northwest corner, identical with location and with Cor. No. 3 Fireball lode of this survey, and on line 3-4 Rico lode of this survey, a pine post, 4 ins. sq., 4 ft. long, set 1 ft. in the ground to bedrock in a mound of stones and scribed on the S.E. side 4-2621SL, whence an X-2621BR chiseled on limestone bedrock 6 ins. X 18 ins. and 3 ins. high brs N. 66° 42' E., 12.10 ft., and a similar chiseling on limestone bedrock 3 ft. X 4 ft. and 6 ins. high brs S. 33° E., 11.84 ft.

Thence N. 89° 15' E.

1499.9 To Cor. No. 1, the place of beginning.

Ledge.

The presumed course of the ledge on this claim is from the W.E.C., N. 89° 15' E., 1499.9 ft.

-- Fireball lode --

Beginning at Cor. No. 1, the northeast corner, identical with location and with Cor. No. 4 Cochise lode of this survey and on line 1-2 Apex lode of this survey, a pine post

4 ins. sq., 4 ft. long, set 18 ins. in the ground to bedrock in a monument of stones and scribed on the S.W. side 1-2621 FL, whence an X-2621BR chiseled on limestone bedrock 4 ft. X 4 ft. and 1 ft. high brs N. 81° E., 9.4 ft., and a similar chiseling on limestone bedrock 6 ft. X 6 ft. and 1 ft. high brs N. 48° 46' W., 13.5 ft., and the corner to Secs. 10, 11, 14, and 15, T. 17 S., R. 31 E., brs N. 73° 04' 30" E., 1564.7 ft.

Thence S. 2° 39' E.

88.0 To original location for E.E.C., a monument of stones 2½ ft. high and 3 ft. in diameter at base.

184.0 Same bearing to Cor. No. 2, the southeast corner, identical with location and with Cor. No. 1 Snow Ball lode of this survey, a pine post as before described, scribed on the N.W. side, 2-2621 FL.

Thence S. 89° 15' W.

1499.9 To Cor. No. 3 the southwest corner, identical with location and with Cor. No. 4 Snow Ball lode of this survey, a pine post as before described, scribed on the N.E. side, 3-2621 FL.

Thence N. 2° 39' W.

96.0 To original location for W.E.C., a monument of stones 4 ft. high, 4 ft. in diameter at base.

173.3 Same bearing to intersection with the Section line between Secs. 10 and 15 at N. 83° 21' E. 2213.5 ft. from the corner to Secs. 9, 10, 15 and 16, and S. 83° 21' W., 3050.8 ft. from the corner to Secs. 10, 11, 14, and 15.

184.0 Same bearing to Cor. No. 4 the northwest corner, identical with location and with Cor. No. 3 Rico lode of this survey, and on line 4-1 Little Eva lode of this survey, a pine post 4 ins. sq., 4 ft. long set 1 ft. in the ground to bedrock in a mound of stones and scribed on the S.E. side, 4-2621 FL whence an X-2621BR chiseled on limestone bedrock 3 ft. X 8 ft. and 4 ins. high brs S. 18° 48' E., 19.69 ft., and a similar chiseling on limestone bedrock 4 ft. X 10 ft. and 1 ft. high brs N. 76° 40' E. 10.5 ft.

Thence N. 87° 02' E.

Feet.

SURVEY NO. 2621.
Fireball lode continued.

146.6 To Cor. No. 5, identical with location and with Cors No. 2 and 4 of the Apex and Little Eva lodes, respectively, of this survey, a pine post as before described, scribed on the S.E. side, 5-2621 FL.

Thence N. 89° 29' 30" E.

8.9 To intersection with the Section line between Secs. 10 and 15 at N. 83° 21' E., 2369.4 ft. from the Corner to Secs. 15, 16, 9, and 10, and S. 83° 21' W. 2894.9 ft. from the Corner to Secs. 10, 11, 14, and 15.

1353.4 Same bearing to Cor. No. 1, the place of beginning.

Ledge.

The presumed course of the ledge on this claim is from the W.E.C, N. 89° 15' E., 1499.9 feet.

-- Neptune lode.--

Beginning at Cor. No. 1, the northeast corner, identical with location and with the N.W. corner of Lewanda 3 lode, unsurveyed, and on line 2-3 Cochise lode of this survey, a pine post 4 ins. sq., 4 ft. long, set on bedrock and surrounded by a monument of stones and scribed on the S.W. side, 1-2621NL, whence an X-2621BR chiseled on limestone bedrock 2 ft. X 6 ft., level with the surface brs S. 46° 02' E., 18.33 ft., and a similar chiseling on a limestone boulder, 18 ins. X 18 ins. and 4 ins. high brs N. 25° 57' E., 12.34 ft., and the Corner to Secs. 10, 11, 14, and 15, T. 17 S., R. 31 E. brs N. 30° 17' E., 1058.5 feet.

Thence S. 1° 32' 30" W.

151.7 To original location for E.E.C., a monument of stones 3 ft. high and 3½ ft. in diameter at base.

370. Same bearing, center of road between camp and mine running southwest and northeast.

451.7 Same bearing, to Cor. No. 2, the southeast corner, identical with location and on the west end line of Lewanda 3 lode unsurveyed, a pine post 4 ins. sq., 4 ft. long set 18 ins. in the ground in a mound of stones and scribed on the N.W.

side, 2-2621NL, whence a limestone boulder 12 ins. X 12 ins. and 6 ins. high, chiseled X-2621BR brs S. 36°14'E., 11.93 ft., and a similar boulder of the same size and with the same chiseling brs N. 56°40'E., 96.8 ft.

Thence S. 85° 25' W.

160. Enter road from camp to mine.
350. Same bearing, leave road from camp to mine.
608. Same bearing, intersect road and gulch, course N.W. and S.E.
720. Same bearing, to the N.W. corner Dixie lode, identical with the N.W. corner Washington lode, identical with the N.E. corner Diamond 1 lode, all unsurveyed.
810. Same bearing, intersect road, course N.W. and S.E., from Portal to mine.
1500. Same bearing, to Cor. No. 3, the southwest corner, identical with location and with Cor. No. 3 Wedge 3 lode of this survey a pine post 4 ins. sq., 4 ft. long, set 1 ft. in the ground in a monument of stones and scribed on the N.E. side, 3-2621 NL, whence a limestone boulder 12 ins. X 12 ins. and 3 ins. above the ground, chiseled X-2621BR brs S. 36°07'W. 16.9 ft., and a similar boulder of the same size and with the same chiseling brs S. 69°45'E., 44.45 ft.
- Thence N. 1° 32' 30" E.
100. Intersect road and gulch, course N.W. and S.E.
300. Same bearing, to original location for W.E.C., a monument of stones 4 ft. high and 4 ft. in diameter at base.
- 491.3 Same bearing, intersect line 2-3 Snow Ball lode of this survey at S. 82°14'W., 529.8 ft. from Cor. No. 2.
562. Same bearing, center of narrow-gauge track, running N.W. and S.E.
600. Same bearing, to Cor. No. 4, the northwest corner, identical with location and with Cor. No. 2 Wedge 3 lode of this survey, a pine post 4 ins. sq., 4 ft. long, set on bedrock and surrounded by a monument of stones, scribed on the S.E. side, 4-2621NL, whence an X-2621BR chiseled on a sloping face of limestone bedrock, 4 ft. X 10 ft. brs S. 38°19'E., 9.54 ft., and a similar chiseling on a sloping face of

Feet.

SURVEY NO. 2621
Neptune lode continued.

limestone bedrock 6 ft. X 6 ft. brs N.14°46' E., 5.35 ft.

Thence S.85° 56' E.

523.3 To Cor.No.5, identical with Cors.No.2 and 3 of the Snow Ball and Cochise lodes, respectively, of this survey, a pine post as before described, scribed on its S.E. side, 5-2621NL

Thence N.89° 29' 30" E.

657.1 Center of narrow-gage^u track running N.E. and S.W.

969.4 Same bearing to Cor.No.1, the place of beginning.

Ledge.

The presumed course of the ledge on this claim is from the W.E.C., N.85°25' E., 1500. feet.

-- Cochise lode.--

Beginning at Cor.No.1, the northeast corner, identical with location and with Cors.No.1 and 1 of the Pappoose and Iron Hat lodes of this survey, a pine post 4 ins. sq., 4 ft. long, set 1 ft. in the ground to bedrock surrounded by a monument of stones and scribed on the S.W. side, 1-2621 CL, whence an X-2621BR chiseled on limestone bedrock 2 ft. X 6 ft., level with the surface brs S.46°02' E., 18.33 ft., and a similar chiseling on a limestone boulder 18 ins. X 18 ins. and 5 ins. high brs N.25°57' E., 12.34 ft., and the Corner to Secs. 10, 11, 14, and 15, T.17 S., R.31 E., brs N.19°58' E. 330.6 ft

Thence S.2° 39' E.

300. To original location for E.E.C., a monument of stones 3½ ft. high and 4 ft. in diameter at base.

600.0 Same bearing to Cor.No.2, the southeast corner, identical with location and with Cor.No.4 Pappoose lode of this survey, a pine post 4 ins. sq., 4 ft. long, set 18 ins. in the ground in a monument of stones and scribed on the N.W. side 2-2621CL, whence an X-2621BR chiseled on limestone bedrock 4 ft. X 4 ft., level with the surface brs S.61°25' W., 66.12 ft., and a similar chiseling on a limestone boulder 12 ins. X 12 ins. and 8 ins. above the surface brs S.20° E., 55.54 ft.

Thence S.89° 29' 30" W.

448.7 To Cor.No.1 Neptune lode of this survey, identical with

the N.W. corner of Lewanda 3 lode, unsurveyed.

761. Same bearing, center of narrow-gage track running N.E. and S.W.
1418.1 Same bearing to Cor. No. 3, the southwest corner, identical with location and with Cors. No. 5 and 2 of the Neptune and Snow Ball lodes, respectively, of this survey, a pine post as before described, scribed on the N.E. side, 3-2621 CL.

Thence N. 2° 39' W.

300. To original location for W.E.C. a monument of stones 2½ ft. high and 3 ft. in diameter at base.

- 416.0 Same bearing to Cors. No. 1 and 2 of the Snow Ball and Fireball lodes, respectively, of this survey.

- 600.0 Same bearing to Cor. No. 4, the northwest corner, identical with location and with Cor. No. 1 Fireball lode of this survey, a pine post as before described, scribed on the S.E. side, 4-2621 CL.

Thence N. 89° 29' 30" E.

- 146.6 To Cors. No. 1 and 2 of the Apex and Iron Hat lodes, respectively, of this survey.
1418.1 Same bearing, to Cor. No. 1, the place of beginning.

Ledge.

The presumed course of the ledge on this claim is from the W.E.C., N. 89° 29' 30" E., 1418.1 feet.

-- Little Eva lode.--

Beginning at Cor. No. 1, the southwest corner, identical with location and with Cors. No. 2 and 4 of the Rico and Valley lodes, respectively, of this survey, a pine post 4 ins. sq. 4 ft. long, set 18 ins. in the ground in a monument of stones and scribed on the N.E. side, 1-2621LEL, whence a limestone boulder 18 ins. X 18 ins. and 6 ins. high, chiseled X-2621BR brs N. 55° 24' E., 198.0 ft., and a similar boulder 18 ins. X 36 ins. and 3 ins. above the ground, chiseled the same, brs N. 17° 30' E., 258.4 ft., and the Corner to Secs. 9, 10, 15, and 16, T. 17 S., R. 31 E., brs S. 77° 02' W., 880.2 ft.

Thence N. 2° 24' W.

300. To original location for W.E.C., a 2 X 4 ins. post, 4 ft. long

Feet.

SURVEY NO. 2621.
Little Eva lode continued.

in a monument of stones 3 ft. high, 4 ft. in diameter at base.
600.0 Same bearing to Cor. No. 2, the northwest corner, identical with location and with Cor. No. 3 Valley lode of this survey, a pine post 4 ins. sq., 4 ft. long, set 1 ft. in the ground in a monument of stones and scribed on the S. E. side, 2-2621 LEL, whence an X-2621BR chiseled on limestone bedrock 2 ft. X 8 ft and 6 ins. high brs S. 76° 20' E., 295. ft., and a similar chiseling on limestone bedrock 6 ins. X 14 ins. and 3 ins. high brs N. 17° 30' E. 258.4 ft.

Thence N. 87° 02' E.

1488.8 To Cor. No. 3 the northeast corner, identical with location and with Cor. No. 3 Apex lode of this survey, a pine post as before described, scribed on the S. W. side, 3-2621 LEL.

Thence S. 2° 24' E.

300. To original location for E. E. C., a monument of stones as before described, being identical with W. E. C. Apex lode.

600.0 Same bearing, to Cor. No. 4, the southeast corner, identical with location and with Cors. No. 2 and 5 of the Apex and Fireball lodes, respectively, of this survey, a pine post as before described, scribed on the N. W. side, 4-2621 LEL.

Thence S. 87° 02' W.

146.6 To Cors. No. 4 and 3 of the Fireball and Rico lodes, respectively, of this survey.

601. Same bearing, center of road to mine, running N. W. and S. E.

1488.8 Same bearing to Cor. No. 1, the place of beginning.

Ledge.

The presumed course of the ledge on this claim is from the W. E. C., N. 87° 02' E., 1488.8 feet.

-- Wedge 3 lode. --

Beginning at Cor. No. 1, the northwest corner, identical with location, on line 4-5 Rico lode of this survey, a pine post 4 ins. sq., 4 ft. long, set 1 ft. in the ground to bedrock surrounded by a monument of stones, and scribed on the S. E. side, 1-2621 W3L, whence a limestone boulder 18 ins. X 18 ins.

and 10 ins. above the surface, chiseled X-2621BR brs
N.11°03'W., 19.7 ft., and a similar boulder, 5 ins. X 12 ins.
and 3 ins. above the surface, chiseled the same, brs S.74°
40'E., 23.65 ft., and the Corner to Secs. 9, 10, 15, and 16,
T.17 S., R.31 E., brs N.78°10'W., 1742.9 feet.

Thence N.86° 53' E.

- 520.6 To Cor.No.4 Rico lode of this survey, and intersection with
line 3-4 Snow Ball lode of this survey at N.2°39'W., 187.5
ft. from Cor.No.3.
560. Same bearing, center of road to mine, running N.W. and S.E.
1272. Same bearing, center of narrow-gage track, running N.W. and S.E.
- 1500.0 Same bearing to Cor.No.2, the northeast corner, identical with
location and with Cor.No.4 Neptune lode of this survey, a
pine post as before described, scribed on the S.W. side
2-2621 W3L.

Thence S.1° 32' 30" W.

38. Center of narrow-gage track, running N.W. and S.E.
- 108.7 Same bearing to intersection with line 3-2 Snow Ball lode
of this survey at N.82°14'E., 975.3 ft., from Cor.No.3
300. Same bearing to original location for E.E.C., a monument
of stones as before described, identical with W.E.C. Neptune lode.
500. Same bearing, center of road and gulch, course N.W. and S.E.
- 600.0 Same bearing to Cor.No.3, the southeast corner, identical with
location and with Cor.No.3 Neptune lode of this survey, a
pine post as before described, scribed on the N.W. side,
3-2621 W3L.

Thence S. 86° 53' W.

730. To the N.W. corner of Diamond 1 lode, unsurveyed.
- 1500.0 Same bearing to Cor.No.4, the southwest corner, identical
with location, a pine post 4 ins. sq. 4 ft. long, set 1 ft.
in the ground to bedrock in a monument of stones and
scribed on the N.E. side, 4-2621 W3L, whence a limestone
boulder 4 ft. X 4 ft. and 1 ft. above ground, chiseled
X-2621BR brs S.30°10'W., 47.8 ft., and a similar chiseling on
limestone bedrock 1 ft. X 1 ft. and 3 ins. above the surface

Feet. SURVEY NO. 2621.
Wedge 3 lode continued.

brs N. 80° W., 19.79 ft.

Thence N. 1° 32' 30" E.

300. To original location for W.E.C., a monument of stones 3 ft. high and 4 ft. in diameter at base.

600.0 Same bearing, to Cor. No. 1, the place of beginning.

Ledge.

The presumed course of the ledge on this claim is from the W.E.C., N. 86° 53' E., 1500. feet.

-- Iron Hat lode.--

Beginning at Cor. No. 1, identical with location and with Cors. No. 1 and 1 of the Pappoose and Cochise lodes, respectively, of this survey, a pine post as described under Cor. No. 1, Cochise lode, scribed on the N.W. side, 1-2621 IHL, whence the Corner to Secs. 10, 11, 14, and 15, T. 17 S., R. 31 E., brs N. 19° 58' E., 330.6 ft.

Thence S. 89° 29' 30" W.

1271.5 To Cor. No. 2, the southwest corner, identical with location and with Cor. No. 1 Apex lode of this survey, a pine post as before described, scribed on the N.E. side, 2-2621 IHL.

Thence N. 2° 24' W.

160.0 To intersection with the Section line between Secs. 10 and 15 at N. 83° 21' E. 3863.8 ft. from the corner to Secs. 9, 10, 15, and 16, and S. 83° 21' W. 1400.5 ft. from the corner to Secs. 10, 11, 14, and 15.

300. Same bearing to original location for W.E.C., identical with E.E.C. Apex lode of this survey, a monument of stones as before described.

600.0 Same bearing to Cor. No. 3, the northwest corner, identical with location and with Cor. No. 4 Apex lode of this survey, a pine post as before described, scribed on the S.E. side 3-2621 IHL.

Thence N. 89° 29' 30" E.

44.0 To Cor. No. 1, El Sobrante lode of this survey.

1271.5 Same bearing to Cor. No. 4, a pine post 4 ins. sq., 4 ft. long,

set 1 ft. in the ground to bedrock in a monument of stones and scribed on its S. side 4-2621 IHL, whence an X-2621BR chiseled on a porphyry boulder 15 ins. X 20 ins. and 8 ins. above the surface brs N. 57° 46' W., 27.06 ft., and a similar chiseling on a porphyry boulder 5 ft. X 7 ft. and 1 ft. high brs S. 25° 57' W., 34.82 ft.

Thence N. 86° 49' 30" E.

139.4 To intersection with the Section line between Secs. 10 and 11 at N. 0° 13' 30" E., 296.5 ft. from the corner to Secs. 10, 11, 14, and 15, and S. 0° 13' 30" W., 2350.2 ft. from the $\frac{1}{4}$ Cor. between Secs. 10 and 11.

328.5 Same bearing to Cor. No. 5, the northeast corner, identical with location and with the N.W. corner of Lewanda 1 lode, unsurveyed, a pine post 4 ins. sq., 4 ft. long, set 1 ft. in the ground in a monument of stones and scribed on the S.W. side 5-2621 IHL, whence an X-2621BR chiseled on a porphyry boulder 15 ins. X 20 ins. and 8 ins. high brs N. 57° 15' W., 73.33 ft., and a similar chiseling on a limestone boulder 12 ins. X 12 ins. and 3 ins. above the surface brs S. 20° 02' W., 23.6 ft.

Thence S. 2° 24' E.

300. To original location for E.E.C., a monument of stones 3 ft. high and 4 ft. in diameter at base.

308.1 Same bearing to intersection with the section line between Secs. 11 and 14 at S. 86° 27' 30" E. 103.2 ft. from the Corner to Secs. 10, 11, 14, and 15, and N. 86° 27' 30" W. 5060.3 ft. from the Corner to Secs. 11, 12, 13, and 14.

600:0 Same bearing to Cor. No. 6, the southeast corner, identical with location and with the S.W. corner of Lewanda 1 lode, unsurveyed, and on line 1-2 Pappoose lode of this survey, a pine post 4 ins. sq. 4 ft. long, set 1 ft. in the ground to bedrock in a monument of stones and scribed on the N.W. side 6-2621 IHL, whence an X-2621BR chiseled on limestone bedrock 12 ins. X 18 ins. level with the surface brs N. 83° 29' W., 55.60 ft., and a similar chiseling on a limestone boulder 10 ins.

Feet.

SURVEY NO. 2621.
Iron Hat lode continued.

X 10 ins. and 3 ins. above the surface brs S.10°41'W.
15.80 ft.

Thence S.86° 49' 30" W.

- 116.7 To intersection with the Section line between Secs.14 and 15 at S.0°13'30"W.,304.5 ft. from the Corner to Secs. 10,11,14, and 15, and N.0°13'30"E.,2335.5 ft. from the theoretical point for $\frac{1}{4}$ Cor. between Secs. 14 and 15.
- 228.5 Same bearing to Cor.No.1, the place of beginning.

Ledge.

The presumed course of the ledge on this claim is from the W.E.C., N.89°29'30"E.,1271.5 ft., thence N.86°49'30"E. 228.5 ft.

-- Pappoose lode.--

Beginning at Cor.No.1, the northwest corner, identical with location and with Cors.No.1 and 1 of the Cochise and Iron Hat lodes, respectively, of this survey, a pine post as described under Cor.No.1 Cochise lode, scribed on the S.E. side, 1-2621 PL, whence the Corner to Secs.10,11,14, and 15 T.17 S., R.31 E. brs N.19°58'E.,330.6 ft.

Thence N.86° 49' 30" E.

- 111.8 To intersection with the Section line between Secs.14 and 15 at S.0°13'30"W.,304.5 ft. from the Corner to Secs. 10,11,14, and 15, and N.0°13'30"E.,2335.5 ft. from the theoretical point for $\frac{1}{4}$ Cor. between Secs.14 and 15.
- 228.5 Same bearing to Cor.No.6 Iron Hat lode of this survey, identical with the S.W. Cor. of Lewanda 1 lode, unsurveyed.
- 276.5 Same bearing, intersect the south end of frame house, tent roof, 14 X 30 ft., at 3.0 ft. from the S.E. corner.
904. Same bearing, intersect road, direction, N.E. and S.W.
1338. Same bearing, center of gulch, 25 ft. wide, course N.E.
- 1483.4 Same bearing, to Cor.No.2, the northeast corner, identical with location, a pine post 4 ins. sq. 4 ft. long, set 1 ft. in the ground to bedrock in a monument of stones and scribed on the S.W. side, 2-2621 PL, whence a limestone boulder

Feet.

SURVEY NO. 2621.
Pappoose lode continued.

18

12 ins. X 5 ins. and 3 ins. above the surface, chiseled
X-2621BR brs S. 75° 27' E., 57.75 ft., and a similar rock,
6 ins. X 6 ins. and 2 ins. above the surface, chiseled the
same brs S. 7° 25' W., 79.74 ft.

Thence S. 2° 39' E.

300. To original location for E.E.C., a monument of stones $3\frac{1}{2}$
ft. high and 4 ft. in diameter at base.

600.0 Same bearing to Cor. No. 3 the southeast corner, identical
with location, a pine post 4 ins. sq. 4 ft. long set 1 ft.
in the ground to bedrock in a monument of stones and
scribed on the N.W. side 3-2621 PL, whence a limestone boulder
8 ins. X 16 ins. and 3 ins. above the surface, chiseled
X-2621BR, brs S. 0° 30' E. 28.10 ft., and a similar chiseling
on limestone bedrock 4 ft. X 13 ins., level with the surface
brs S. 32° 11' W., 44.54 ft.

Thence S. 86° 49' 30" W.

445. To the N.W. corner of Lewanda 4 and the N.E. corner of
Lewanda 3 lodes, both unsurveyed.

1175. Same bearing, center of gulch 25 ft. wide, course N.E.

1401.7 Same bearing to intersection with the Section line between
Secs. 14 and 15 at S. 0° 13' 30" W., 905.6 ft. from the Corner
to Secs. 10, 11, 14, and 15, and N. 0° 13' 30" E., 1734.4 ft. from
the theoretical point for $\frac{1}{2}$ Cor. between Secs. 14 and 15.

1455. Same bearing, center of road running N.E. and S.W.

1483.4 Same bearing to Cor. No. 4 the southwest corner, identical
with location and with Cor. No. 2 Cochise lode of this survey
a pine post as before described, scribed on the N.E. side
4-2621 PL.

Thence N. 2° 39' W.

300. To original location for W.E.C., identical with E.E.C.
Cochise lode of this survey, a monument of stones as
before described.

600.0 Same bearing to Cor. No. 1 the place of beginning.

Ledge.

The presumed course of the ledge on this claim is from

Feet.

SURVEY NO. 2621.
Pappoose lode continued.

the W.E.C., N. 86° 49' 30" E., 1483.4 feet.

-- Rico lode. --

Beginning at Cor. No. 1, the northwest corner, identical with location and with the N.E. Corner of Cant Tell lode, unsurveyed, and on line 4-1 Valley lode of this survey, a pine post 4 ins. sq., 4 ft. long, set 18 ins. in the ground in a monument of stones and scribed on the S.E. side, 1-2621 RL, whence a limestone boulder 18 ins. X 18 ins. and 6 ins. above the surface, chiseled X-2621BR brs N. 64° 19' E., 288.8 ft., and a similar chiseling on limestone bedrock 18 ins. X 36 ins. and 3 ins. above the surface brs N. 33° 58' E., 278.2 ft., and the Corner to Secs. 9, 10, 15, and 16, T. 17 S., R. 31 E. brs S. 76° 22' W., 782.7 ft.

Thence N. 82° 20' E.

98.0 To Cor. No. 2, identical with location and with Cors. No. 4 and 1 of the Valley and Little Eva lodes, respectively, of this survey, a pine post as before described, scribed on the S.E. side, 2-2621 RL.

Thence N. 87° 03' E.

887.8 Center of road to mine, course N.W. and S.E.
1342.2 Same bearing to Cor. No. 3, the northeast corner, identical with location and with Cor. No. 4 Fireball lode of this survey, a pine post as before described, scribed on the S.W. side, 3-2621 RL.

Thence S. 2° 39' E.

10.7 To intersection with the Section line between Secs. 10 and 15 at N. 83° 21' E., 2213.5 ft. from the Corner to Secs. 9, 10, 15, and 16, and S. 83° 21' W., 3050.8 ft. from the Corner to Secs. 10, 11, 14, and 15.
184.0 Same bearing to Cors. No. 3 and 4 of the Fireball and Snow Ball lodes, respectively, of this survey.
300.0 Same bearing, to original location for E.E.C, a monument of stones 4 ft. high and 4 ft. in diameter at base.
576.0 Same bearing, center of road to mine, course N.W. and S.E.

- 598.5 To Cor. No. 4, the southeast corner, identical with location and at the intersection of lines 3-4 Snow Ball lode and 1-2 Wedge 3 lode, both of this survey, a pine post 4 ins. sq., 4 ft. long, set 1 ft. in the ground to bedrock in a monument of stones and scribed on the N.W. side, 4-2621RL, whence a limestone rock 6 ins. X 15 ins. and 6 ins. above the surface, chiseled X-2621 BR brs N. 88° 20' E., 60.84 ft., and a similar rock 12 ins. X 15 ins. and 10 ins. above the surface, having the same marking brs N. 41° 40' E., 94.40 ft.
- Thence S. 86° 53' W.
- 520.6 To Cor. No. 1 Wedge 3 lode of this survey.
- 1342.2 Same bearing, to Cor. No. 5, a pine post 4 ins. sq., 4 ft. long set 18 ins. in the ground with a monument of stones and scribed on the N. side, 5-2621 RL, whence a limestone boulder 3 ft. X 3 ft. and 6 ins. above the surface, chiseled X-2621 BR brs S. 66° 40' E., 153.4 ft., and a similar chiseling on limestone bedrock 4 ft. X 10 ft. and level with the surface brs N. 4° 40' E., 61.86 ft.
- Thence S. 87° 02' W.
- 97.6 To Cor. No. 6, the southwest corner, on the E. end line of Cant Tell lode, unsurveyed, a pine post 4 ins. sq., 4 ft. long set 18 ins. in the ground in a monument of stones and scribed on the N.E. side 6-2621 RL, whence an X-2621 BR chiseled on limestone bedrock, 4 ft. X 10 ft. and level with the surface brs N. 56° 57' E., 122.64 ft., and a similar chiseling on a limestone boulder 3 ft. X 3 ft. and 6 ins. above the surface brs S. 76° 51' E., 244.75 ft. and the original location for the S.W. corner, identical with the S.E. corner of Cant Tell lode, unsurveyed, a pine post 4 ins. sq., 4 ft. long set 18 ins. in the ground in a mound of stones 2 ft. high, brs S. 2° 39' E., 8.0 ft.
- Thence N. 2° 39' W.
300. To W. E. Center, whence original location for W.E.C., a monument of stones 3 ft. high and 4 ft. in diameter at base, brs S. 2° 39' E. 8 ft.
- 496.6 Same bearing to intersection with the Section line between

Feet.

SURVEY NO. 2621.
Rico lode continued.

Secs. 10 and 15 at N. 83° 21' E., 770.2 ft. from the corner to Secs. 9, 10, 15, and 16, and S. 83° 21' W., 4494.1 ft. from the corner to Secs. 10, 11, 14, and 15.

592.0 Same bearing to Cor. No. 1 the place of beginning.

Ledge.

The presumed course of the ledge on this claim is from the E. E. C, S. 87° 02' W., 1439.8 feet.

-- Valley lode.--

Beginning at Cor. No. 1, the southwest corner, identical with location, a pine post 4 ins. sq. 4 ft. long set 18 ins. in the ground in a monument of stones and scribed on the N. E. side 1-2621 VL, whence mahogany trees each 4 ins. in diameter, scribed X-2621 BT bear N. 58° W., 63.6 ft. and S. 84° 20' E. 25.5 ft., and the corner to Secs. 9, 10, 15, and 16, T. 17 S., R. 31 E. brs N. 89° 46' E., 628.8 ft.

Thence N. 2° 24' W.

300. To original location for W. E. C., a monument of stones 3 ft. high and 4 ft. in diameter at base.

600.0 Same bearing to Cor. No. 2, the northwest corner, identical with location, a pine post 4 ins. sq. 4 ft. long set 18 ins. in the ground in a monument of stones and scribed on the S. E. side 2-2621 VL, whence a porphyry boulder 4 ins. X 16 ins. and 4 ins. above the surface chiseled X-2621 BR brs S. 42° 20' W., 26.87 ft., and a similar chiseling on a porphyry boulder 18 ins. X 24 ins. and 12 ins. above the surface brs N. 75° 15' W., 87.3 ft.

Thence N. 82° 20' E.

659.8 To intersection with the Section line between Secs. 9 and 10 at North 684.9 ft. from the Corner to Secs. 9, 10, 15, and 16, and South 1955.1 ft. from the theoretical point for $\frac{1}{4}$ Cor. between Secs. 9 and 10.

1500.0 Same bearing to Cor. No. 3, the northeast corner, identical with location and with Cor. No. 2 Little Eva lode of this survey, a pine post as before described, scribed on the

S.W. side, 3-2621 VL.

Thence S. 2° 24' E.

300. To original location for W.E.C., identical with the W.E.C. of Little Eva lode of this survey, a monument of stones as before described.

600.0 Same bearing to Cor. No. 4, the southeast corner, identical with location and with Cors. No. 1 and 2 of the Little Eva and Rica lodes, respectively, of this survey, a pine post as before described, scribed on the N.W. side, 4-2621 VL.

Thence S. 82° 20' W.

98.0 To Cor. No. 1 Rico lode of this survey and N.E. corner of Cant Tell lode, unsurveyed.

865.5 Same bearing to intersection with the Section line between Secs. 9 and 10 at North 82.1 ft. from the corner to Secs. 9, 10, 15, and 16, and South 2557.9 ft. from the theoretical point for $\frac{1}{2}$ Cor. between Secs. 9 and 10.

1500.0 Same bearing to Cor. No. 1, the place of beginning.

Ledge.

The presumed course of the ledge on this claim is from the W.E.C., N. 82° 20' E., 1500 feet.

--Areas.--

Valley lode,	total area,	
Valley lode,		20.574 A.
Rico "	" "	19.769
Little Eva "	" "	20.506
Iron Hat "	" "	20.651
Pappoose "	" "	20.433
El Sobrante	" "	20.431
Fireball "	" "	6.430
Apex "	" "	20.650
Cochise "	" "	19.519
Snow Ball "	" "	17.482
Neptune "	" "	17.541
Area in conflict with Snow Ball lode,	0.652 A.	
Wedge 3 lode,	total area,	20.593
Area in conflict with Snow Ball lode,	3.309 A.	

SURVEY NO. 2621.
Improvements.

I hereby certify that the value of the labor and improvements on the claims of this survey, or for their benefit, placed thereon by the claimant or its grantors is not less than Five Hundred Dollars for each location, and that said improvements are described as follows.

El Sobrante lode.		
No.1	Discovery shaft, 5 X 6 X 7 ft. brs from Cor.No.4, S.64°40'W., 715 ft., value,	\$ 50.00
No.2	Open cut, 4 X 15 X 10 ft. brs from Cor.No.4 S.81°W., 480 ft., value,	100.
No.3	Incline shaft, 4 X 6 X 40 ft. from bottom of which drifts run E. and W., each 9 ft. in length, shaft brs from Cor.No.4, S.26°30'W., 275 ft., value,	580.
No.4	Shaft 4 X 6 X 10 ft., brs from Cor.No.1 N.81°40'W., 587 ft., value,	100.
	1/12 interest in shaft No.1, Little Eva lode,	508.33
	Total value of improvements,	<u>\$1338.33</u>
Apex lode.		
No.1	Discovery shaft, incline, 4 X 6 X 118 ft. from bottom of which a drift 4 X 6 ft. runs W. 26 ft. from end of drift a crosscut 4 X 6 ft. runs N. 12 ft. Shaft brs from Cor.No.4, S.54°15'W. 507 ft., value,	\$1855.
No.2	Open cut, 4 X 16 X 10 ft. brs from Cor.No.4 S.47°45'W., 210 ft., value,	100.
	1/12 interest in shaft No.1 Little Eva lode,	508.33
	Total value of improvements,	<u>\$2463.33</u>
Snow Ball lode.		
No.1	Discovery shaft, 5 X 7 X 100 ft. from bottom of which a drift 4 X 6 ft. runs S. 38 ft. Shaft brs from Cor.No.3 N.67°20'E., 796 ft., value,	\$1630.
No.2	Shaft 5 X 7 X 100 ft. brs from Cor.No.3 N.68°E., 750 ft. From bottom of shaft an incline 5 X 7 ft. is sunk 85 ft.; at 70 ft. on the incline a winze is sunk 16 ft.; between the 80 and 100 ft. levels in the shaft a stope 6 X 20 ft. runs W. 32 ft.; at 35 ft. from the collar of the shaft a crosscut 4 X 6 X 48 ft. connects with shaft No.1; at 35 ft. from the surface a drift 4 X 6 ft. runs S.W. from the shaft, 15 ft. Value,	4140.
No.3	Open cut 5 X 12 X 10 ft. brs from Cor.No.3 N.72°45'E., 1085 ft., value,	100.
No.4	Open cut, 5 X 12 X 10 ft. brs from Cor.No.3 N.74°25'E., 1030 ft., value,	100.
	1/12 interest in shaft No.1, Little Eva lode,	508.33
	Total value of improvements,	<u>\$6478.33</u>
Fireball lode.		
No.1	Discovery open cut, 4 X 12 X 10 ft. brs from Cor. No.2, N.77°W., 390 ft., value,	\$ 100.
	1/12 interest in shaft No.1, Little Eva lode,	508.33
	Total value of improvements,	<u>\$ 608.33</u>
Neptune lode.		
No.1,	Discovery cut, 5 X 10 X 5 ft. deep brs from Cor.No. 1, S.58°30'W., 330 ft., value,	\$ 50.
No.2	Shaft 4 X 6 X 10 ft. at mouth of open cut, 4 X 12 X 10 ft. shaft brs from Cor.No.1 S.63°20'W. 155 ft., value,	200.
	1/12 interest in shaft No.1, Little Eva lode,	508.33
	Total value of improvements,	<u>\$ 758.33</u>

MISSING

PAGE(S)

SURVEY NO. 2621
Improvements continued.

Rico lode.		
No. 1	Discovery open cut, 4 X 12 X 10 ft. brs from Cor. No. 3, S. 31°45' W., 363 ft., value	\$ 100.00
No. 2	Tunnel 4 X 6 X 23 ft., course W.; mouth of tunnel brs from Cor. No. 3, S. 75°30' W., 250 ft., value	200.
	1/12 interest in shaft No. 1, Little Eva lode,	508.33
	Total value of improvements,	\$ 808.33

Valley lode.		
No. 1	Discovery shaft 4 X 6 X 8 ft.; partly filled; said to have been 10 ft. deep; brs from Cor. No. 4, N. 11°35' W., 303 ft., value,	\$ 50.00
No. 2	Shaft 4 X 6 X 10 ft. brs from Cor. No. 4, N. 19°40' W., 145 ft., value,	100.
No. 3	Shaft, said to have been 10 ft. deep, now filled, brs from Cor. No. 4, N. 64°10' W., 630 ft., value,	0.
	1/12 interest in shaft No. 1, Little Eva lode,	508.33
	Total value of improvements,	\$ 658.33

Iron Hat lode.		
No. 1	Discovery open cut, 4 X 12 X 10 ft. brs from Cor. No. 1, N. 18°20' W., 308 ft., value	\$ 100.
No. 2	Shaft 6 X 6 X 11 ft. brs from Cor. No. 4, S. 16°15' W., 184 ft., value,	100.
No. 3	Incline shaft, 5 X 6 X 20 ft. brs from Cor. No. 4 S. 44°45' W., 145 ft., value,	200.
	1/12 interest in shaft No. 1, Little Eva lode,	508.33
	Total value of improvements,	\$ 908.33

Pappoose lode.		
No. 1	Discovery shaft 4 X 6 X 10 ft. brs from Cor. No. 4, N. 0°45' W., 300 ft., value,	\$ 100.
No. 2	Shaft 4 X 6 X 10 ft. brs from Cor. No. 4 N. 42°E., 221 ft., value,	100.
No. 3	Shaft 4 X 6 X 26 ft. brs from Cor. No. 4 N. 47°E., 228 ft.; said to have drifts at bottom 20 ft. to N. and 30 ft. to S.W.; now contains water; value,	250.
	1/12 interest in shaft No. 1, Little Eva lode,	508.33
	Total value of improvements,	\$ 958.33
	Total value of improvements on group,	\$29479.96

Other improvements.

At shaft No. 1, Little Eva lode. Engine house, 30 X 40 ft. with iron sides and roof; blacksmith shop, 16 X 16 ft. with iron sides and roof; wooden gallows frame, 30 ft. high housed in iron; 1-2000 gallon iron water tank; 1-5000 gallon iron water tank; 1-300 gallon gasoline tank enclosed in cement; 1-80 gallon hoisting bucket; 1 mine cage; 5 ore cars; 4 electric air drills; 3 motors for drills. Engine house contains 1-50 H.P. Otto gasoline engine, 1-35 K.W. Westinghouse generator, 1-25 H.P. electric hoist with 600 feet $\frac{3}{4}$ in. cable.

Smelting machinery. The furnace bears from Cor. No. 1 Cochise lode, S. 50°W., 200 feet. 1-50 ton, water jacket, copper smelting furnace; 1-40 H.P. Atlas boiler; 1-6 X 3 $\frac{1}{2}$ X 6 Knowles Duplex pump; 1 Connerville blowing engine; 2 steel settling pots on trucks; 10 slag pots. The above smelting machinery is set up in place, has not been operated, and is not enclosed in a building. 625 feet 2 $\frac{1}{2}$ in. pipe, 565 feet 2 in. pipe, 1000 feet 1 $\frac{1}{4}$ in. pipe; 275 tons coal, 50 tons coke.

Narrow-gage railroad, the west end of which brs from Cor. No. 4 Neptune lode, N. 89°W., 295 ft., and the east end brs from Cor. No. 1 Cochise lode, S. 66°21' W., 626 ft. 1970 feet of track, 18 in. gage, 12 lb. rails.

Other buildings.

Tent, 12 X 14 ft., the S.W. corner brs from Cor. No. 4 Pappoose lode, N. 75° E., 91 ft.
Tent, 12 X 20 ft., the S.E. corner brs from Cor. No. 4 Pappoose lode, N. 63° 40' E., 177 ft.
Tent 10 X 12 ft., the N.W. corner brs from Cor. No. 4 Pappoose lode, N. 86° 55' E., 122 ft.
Tent, 10 X 12 ft., the S.W. corner brs from Cor. No. 4 Pappoose lode, N. 85° 15' E., 192 ft.
Corral and barn, 20 X 37 ft., the N.W. corner brs from Cor. No. 1 Pappoose lode, S. 40° E., 582 ft.
Barn 10 X 10 ft., the N.W. corner brs from Cor. No. 1 Pappoose lode, S. 28° E., 500 ft.
Corral and barn, 30 X 30 ft., the N.W. corner brs from Cor. No. 1 Pappoose lode, S. 33° 40' E., 510 ft.
Store, 10 X 10 ft., frame, the N.E. corner brs from Cor. No. 1 Pappoose lode, S. 33° 30' E., 484 ft.
House, 16 X 30 ft., frame, the N.E. corner brs from Cor. No. 1 Pappoose lode, S. 33° 20' E., 430 ft.
House 26 X 20 ft., frame, the N.E. corner brs from Cor. No. 1 Pappoose lode, S. 46° 30' E., 464 ft.
Office, 16 X 16 ft., frame, the S.W. corner brs from Cor. No. 1 Pappoose lode, S. 49° 15' E., 570 ft.
Tent, 8 X 10 ft., the S.W. corner brs from Cor. No. 1 Pappoose lode, S. 53° 50' E., 478 ft.
Tent 14 X 16 ft., board sides and floor, the N.E. corner brs from Cor. No. 6 Iron Hat lode, S. 28° 40' E., 65 ft.

Shaft No. 1, Little Eva lode, is considered a common improvement, and its value has been credited in equal portions to each of the twelve claims of this survey. No development work is being done except at this shaft. It is the intention of the Company to drift from the 300 and 400 foot levels, when these depths shall have been reached, and explore the country in all directions up to the limits of their property. All work will be carried on from this point until further development shows a more advantageous location on which to sink a shaft.

The amount of work shown in this shaft is as it existed on February 12; since that time, sinking has been continued, working three shifts per day.

SURVEY NO. 2621.
Adjoining claims.

- North. Unoccupied ground. Unsurveyed claims, names unknown, Clarence May, claimant.
- East. Unoccupied ground. Lewanda 1 lode, unsurveyed, claimed by applicant herein.
- South. Unsurveyed, names of claims and claimants unknown. Diamond 1, Dixie, Lewanda 3, and Lewanda 4 lodes, all unsurveyed, claimed by applicant herein. Washington lode, unsurveyed, J.A. Lewandowski, claimant.
- West. Unoccupied ground. Sant Tell lode, unsurveyed, claimed by applicant herein.

Location.

This survey is located in Sections 9, 10, 11, 14, and 15, T.17 S., R.31 E., G. & S.R.B. & M. in the California Mining District, Cochise County, Arizona.

Instruments.

This survey was made with a Buff & Buff transit. The courses were deflected from the meridian as determined by direct solar observations. The distances were measured with 100 foot and 500 foot steel tapes.

Magnetic variation at all corners, 12° 20' E.

Note. The fact that Cors. No. 2, Rico lode, No. 5 Fireball lode, and No. 1, Iron Hat lode fall outside the lines described in the location notices of these claims is due to errors in the location notices, as these corners are identical with corners of the locations as marked on the ground.

The corner to Secs. 11, 12, 13, and 14, the corner to Secs. 10, 11, 14, and 15, the corner to Secs. 9, 10, 15, and 16, and the $\frac{1}{4}$ corner between Secs. 10 and 11 are the only corners of the public survey I was able to find, though diligent search was made for all the other corners that should have been used in this survey.

A. N. Jorgensen
U. S. Mineral Surveyor.

Bisbee, Arizona, April 8, 1909.

FINAL OATHS FOR SURVEYS.

LIST OF NAMES.

A list of the names of the individuals employed by H. W. Jorgensen

United States Mineral Surveyor, to assist in running, measuring, and marking the lines, corners, and boundaries described in the foregoing field notes of the survey of the mining claim of

Savage Gold & Copper Co.

known as the Little Eva, El Sobrante, Apex, Snow Ball, Fireball, Neptune, Cochise, Iron Hat, Pappoose, Wedge 3, Valley, Rico.

and showing the respective capacities in which they acted.

H. H. Benton, Chainman.

Chainman.

Asman.

Flagman.

FINAL OATHS OF ASSISTANTS.

I ~~We~~, H. H. Benton

and _____, do solemnly swear that ~~we~~ ^I assisted

H. W. Jorgensen, United States Mineral Surveyor, in marking the corners and surveying

the boundaries of the mining claim of Savage Gold & Copper Co.

known as the Little Eva, El Sobrante, Apex, Snow Ball, Fireball, Neptune, Cochise, Iron Hat, Pappoose, Wedge 3, Valley, Rico,

represented in the foregoing field notes as having been surveyed by said mineral surveyor and under his

direction; and that said survey has been in all respects, to the best of ~~our~~ ^{my} knowledge and belief, faithfully

and correctly executed, and the corner and boundary monuments established according to law and the instruc-

tions furnished by the United States Surveyor-General for Arizona.

H. H. Benton, Chainman.

Chainman.

Asman.

Flagman.

Subscribed and sworn to by the above-named persons before me this 6th

day of April, 1904.

My Commission expires June 9, 1909.

4-686.

FINAL OATH OF U. S. MINERAL SURVEYOR.

I, H.W. Jorgensen, U. S. Mineral Surveyor, do solemnly swear that, in pursuance of instructions received from the United States Surveyor General for Arizona, dated January 23, 1909, I have, in strict conformity to the laws of the United States, the official regulations and instructions thereunder, and the instructions of said Surveyor General, faithfully and correctly executed the survey of the Mining Claim of Savage Gold & Copper Co.

known as the Little Eva, El Sobrante, Apex, Snow Ball, Valley, Fireball, Neptune, Cochise, Iron Hat, Pappoose, Wedge 3, Rico, situate in California Mining District, Cochise County, Arizona.

in Sections 9, 10, 11, 14, 15, Township No. 17 S., Range No. 31 E.

and designated as Survey No. 2621, as represented in the foregoing field notes, which accurately show the boundaries of said mining claim as distinctly marked by monuments on the ground, and described in the attached copy of the location certificate, which was received by me from the Surveyor General with said instructions, and that all the corners of said survey have been established and perpetuated in strict accordance with the law, official regulations and instructions thereunder; and I do further solemnly swear that the foregoing are the true and original field notes of said survey and my report therein, and that the labor expended and improvements made upon said mining claim by claimant or its grantors are as therein fully stated, and that the character, extent, location, and itemized value thereof are specified therein with particularity and full detail, and that no portion of said labor or improvements so credited to this claim has been included in the estimate of expenditures upon any other claim.

H.W. Jorgensen, U. S. Mineral Surveyor.

Subscribed and sworn to by the said H.W. Jorgensen, U. S. Mineral Surveyor, before me [Signature] this 10th day of April, 1909.

[Signature] Notary Public

My Commission Expires June 9, 1909

Affidavit of Five Hundred Dollars Improvements.

We, James Reay and H. Mouser

of lawful age, being first duly sworn according to law, depose and say: That we are acquainted with the Little Eva, El Sobrante, Apex, Snow Ball Valley, Fireball, Neptune, Cochise, Iron Hat, Pappoose, Wedge 3, Rico, mining claims situate in California Mining district, Cochise County, Arizona Territory, for which Savage Gold & Copper Co.

has made application for survey prior to application for patent under the provisions of the act of Congress, approved May 10, 1872; and that the labor done and improvements made thereon by the applicant and its grantors exceed Five Hundred Dollars in value, and further that we are not personally interested in said mine.

James Reay
H. Mouser

TERRITORY OF ARIZONA,
County of Cochise } ss:

Sworn to and subscribed before me, this 15th

day of March, 1907



Geoff Harker
Notary Public

27669b1m2-07

My Commission expires Aug 19-1911.

Notice of Mining Location

LODE CLAIM

To All Whom It May Concern:

This Mining Claim, the name of which is the Little Eva
Mining Claim, situate on lands belonging to the United States of America, and in which there
are valuable mineral deposits, was entered upon and located for the purposes of exploration and
purchase by W. H. Smith and E. O. Gill

Citizens of the United States.

(Locator must insert either "a citizen of the United States," or, "who has declared his intention to become a citizen of the United States.")

the undersigned, on the 17th day of August 1903

The length of this claim is Fifteen Hundred (1,500) feet,
and we claim three hundred (300) feet,
in a easterly direction and twelve hundred
(1,200) feet in a westerly direction from
the center of the discovery shaft, at which this notice is posted, lengthwise of the claim, together
with three hundred (300) feet in width of the surface grounds, on each
side of the center of said claim. The general course of the lode deposit and premises is from the
east to the west

The claim is situated and located in the California Mining District, in
Gochise County, in the Territory of Arizona, about three miles
in a easterly direction from U. S. Mineral Monument No 1

The surface boundaries of the claim are marked upon the ground as follows: Beginning at
Monument No 1

at a point in a easterly direction 300 feet from
the discovery shaft (at which this notice is posted), being in the center of the ----
end line of said claim; thence southerly 300 feet to a monument No 2
, being the southeast corner of said claim; thence
westerly 1,500 feet to a monument No. 3, being at the
southwest corner of said claim; thence northerly 300 feet
to a monument No 4 at the center of the west end of said claim;
thence northerly 300 feet to a monument No 5, being at the
northwest corner of said claim; thence easterly 1,500
feet to a monument No 6 at the northeast corner of said claim;
thence southerly 300 feet to the place of beginning.

All done under the provisions of Chapter Six, of Title XXXII, of the Revised Statutes of
the United States, and of an Act of the General Assembly of Arizona, entitled "An Act to
Revise and Codify the Laws of the Territory of Arizona," approved March 16, 1901.

Dated and posted on the ground this 17th day of August 1903.

W. H. Smith

E. O. Gill

Filed and recorded at request of E. O. Gill Oct. 9 1903 at 9 A. M.
Book 29 Records of Mines at page 91.

TERRITORY OF ARIZONA,
 County of..... } ss.

I,....., County Recorder in and for the County and Territory aforesaid, do hereby certify that the within instrument was filed for record at.....o'clock,.....M., on this.....day of.....190..., and duly recorded in Book No..... of.....Records of.....County, Arizona, at pages.....

WITNESS my hand and official seal the day and year first above written.

.....
 County Recorder.

Notice of Location

LODE CLAIM

Dated.....190.....

Filed and Recorded at request of.....

.....A. D. 190.....

at.....M.

Book.....

Pages.....

.....County Recorder.

By.....Deputy Recorder.

THE H. H. McNEIL CO., PRINTERS, PHOENIX, ARIZONA

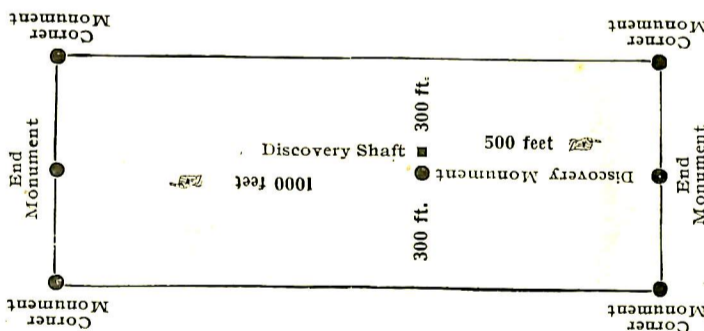

This diagram is to give locator a general idea of plan of location under the new law. The Discovery Shaft can be in the center of claim or any distance from either end desired. In the diagram it is placed 500 feet from one end and 1000 feet from the other. Commence description of claim at a center end monument, giving its distance and direction from center of Discovery Shaft; thence bound the claim in either direction. In description be careful to state locality of claim with reference to some natural object, or permanent monument, as will identify the claim.

Description of the Conflict Between the
El Sobrante Lode, Sur. No. 2621, and the Telluride No. 1.

Beginning at a point on line 2-3, El Sobrante lode, Survey No. 2621, 338.6 feet from Cor. No. 1, being at its intersection with the South side line of the Telluride No. 1 lode, thence along said line 2-3, El Sobrante lode, N. 2° 22' W., 261.4 feet to Corner No. 3, said El Sobrante lode; thence N. 89° 29' 30" E. along line 3-4, El Sobrante lode, 916.65 feet to its intersection with the South side line of the Telluride No. 1 lode; thence along South side line of the Telluride No. 1, lode; S. 73° 26' 30" W., 945 feet to the place of beginning.

Containing 2.749 acres.

I certify that the foregoing is a correct description of the conflict between the El Sobrante lode, Survey No. 2621, and the Telluride No. 1 claim of the Bradshaw, Arizona Mining Company, as appears in the Application to Purchase of the Savage Gold and Copper Company, for the claims embraced in Mineral Survey No. 2621, and that said conflict has been correctly shown in green ink on the plat of survey in this office, the Local Land Office in Phoenix, Arizona, and the General Land Office.

Frank S. Lyall
Surveyor-General for Arizona.

Office of Surveyor-General,

Phoenix, Arizona, March 11, 1911.

104

4-688.

U. S. SURVEYOR-GENERAL'S FINAL CERTIFICATE ON FIELD NOTES.

Department of the Interior,

OFFICE OF U. S. SURVEYOR-GENERAL,

Phoenix, Arizona,

July 12, 1909.

I, U. S. Surveyor-General for District of Arizona,

do hereby certify that the foregoing transcript of the Field Notes, return and approval of the survey of the mining claim of Savage Gold & Copper Co.

Little Eva, El Sobrante, Apex, Snow Ball, Valley, Fireball, known as the Neptune, Cochise, Iron Hat, Pappoose, Wedge 3, Rico situate in California

Mining District, Cochise County, Arizona

14, 15
in Section S 9, 10, 11, Township No. 17 S., Range No. 31 E. and

designated as Survey No. 2621, has been correctly copied from the originals on file in this office; that said Field Notes furnish such an accurate description of said mining claim as will, if incorporated into a patent, serve fully to identify the premises, and that such reference is made therein to natural objects or permanent monuments as will perpetuate and fix the locus thereof.

And I further certify that ^{not less than} five hundred dollars' worth of labor has been expended or improvements made upon ^{or for each of} said mining claim by claimant or its grantors, and that said improvements consist of 20 shafts, 14 cuts, 5 winzes, 3 tunnels, 1 incline, 1 stope, 1 raise, 597 linear ft. of drifts and 310 linear ft. of crosscuts, total value \$29480.00. As shaft No. 1 on the Little Eva lode, value \$6100, is a common improvement for the benefit and development of all the claims in this group, an undivided 1/12 interest therein, value \$508-1/3, is properly credited to each of the twelve claims of this survey.

and that no portion of said labor or improvements has been included in the estimate of expenditures upon any other claim.

I further certify that the plat thereof, filed in the U. S. Land Office at Phoenix, Arizona, is correct and in conformity with the foregoing Field Notes.

Frank S. Ingalls,

United States Surveyor-General for Arizona.

4-687.

SURVEYOR-GENERAL'S CERTIFICATE OF APPROVAL OF FIELD NOTES AND SURVEY OF MINING CLAIM.

Department of the Interior,

Office of U. S. Surveyor-General,

Phoenix, Arizona,

July 12, 1909

I, U. S. Surveyor-General for District of Arizona

do hereby certify that the foregoing and hereto attached Field Notes and Return of the Survey of the

Mining Claim of

Savage Gold & Copper Co.

known as the Little Eva, El Sobrante, Apex, Snow Ball, Valley, Fireball, Neptune, Cochise, Iron Hat, Pappoose, Wedge 3, Rico.

situate in California Mining District,

Cochise County, Arizona

in Section 9, 10, 11, 14, 15 Township No. 17 S., Range No. 31 E.

designated as Survey No. 2621

executed by H. W. Jorgensen, U. S. Deputy Mineral

Surveyor, February 5-14, 1909, under my instructions dated

January 23, 1909, have been critically examined and the necessary

corrections and explanations made, and the said Field Notes and Return, and the Survey they describe,

are hereby approved. A true copy of the copy of the location certificate filed by the applicant for

survey is included in the field notes.

Handwritten signature of Frank S. Jorgensen

U. S. Surveyor-General for Arizona

TERRITORY OF ARIZONA)
County of Cochise)ss.
)

I, G. A. McDonald, County Recorder in and for said County and Territory do hereby certify that I have compared the annexed and foregoing copy with the Original Location Notice of the LittleEva Mining Claim filed for record in my office on the 9th day of Oct. 1903 and recorded in Book 29 Records of Mines at page 91 and that the same is a full true and correct copy of said original and of the whole thereof.

Given under my hand and seal of office this 19th day of January A. D. 1909.

 G. A. McDonald
County Recorder.

Notice of Mining Location

LODE CLAIM

To All Whom It May Concern:

This Mining Claim, the name of which is the El Sobrante Mining Claim, situate on lands belonging to the United States of America, and in which there are valuable mineral deposits, was entered upon and located for the purposes of exploration and purchase by J. A. Lewandowski

a citizen of the United States

(Locator must insert either "a citizen of the United States" or "who has declared his intention to become a citizen of the United States.")

the undersigned, on the 28th day of April 1904

The length of this claim is Fifteen Hundred feet, and I claim seven hundred & fifty feet, in an easterly direction and seven hundred & fifty feet in a westerly direction from the center of the discovery shaft, at which this notice is posted, lengthwise of the claim, together with Three Hundred feet in width of the surface grounds, on each side of the center of said claim. The general course of the lode deposit and premises is from the east to the west

The claim is situated and located in the California Mining District, in Cochise County, in the Territory of Arizona, about 2 $\frac{1}{2}$ miles in an easterly direction from U. S. Mineral Monument No 1

The surface boundaries of the claim are marked upon the ground as follows: Beginning at a monument of stone

at a point in an easterly direction 750 feet from the discovery shaft (at which this notice is posted), being in the center of the east end line of said claim; thence northerly 300 feet to a monument of stone, being the northeast corner of said claim; thence westerly 1500 feet to a monument, being at the northwest corner of said claim; thence southerly 300 feet to a monument at the center of the west end of said claim; thence southerly 300 feet to a monument, being at the south west corner of said claim; thence easterly 1500 feet to a monument at the southeast corner of said claim; thence northerly 300 feet to the place of beginning.

All done under the provisions of Chapter Six, of Title XXXII, of the Revised Statutes of the United States, and of an Act of the General Assembly of Arizona, entitled "An Act to Revise and Codify the Laws of the Territory of Arizona," approved March 16, 1901.

Dated and posted on the ground this 28th day of April 1904

J. A. Lewandowski

Filed and recorded at request of E. Lewandowski June 18 1904 at 9 A. M.
Book 31 Records of Mines at page 368.

TERRITORY OF ARIZONA,
 County of..... } ss.

I,....., County Recorder in and for the County and Territory aforesaid, do hereby certify that the within instrument was filed for record at.....o'clock,.....M., on this.....day of.....190..., and duly recorded in Book No..... of.....Records of.....County, Arizona, at pages.....

WITNESS my hand and official seal the day and year first above written.

.....
 County Recorder.

Notice of Location

LODE CLAIM

Dated.....190.....

Filed and Recorded at request of

.....A. D. 190.....

at.....M.

Book.....

Pages.....

.....County Recorder.

.....Deputy Recorder.

THE H. H. McNEIL CO., PRINTERS, PHOENIX, ARIZONA

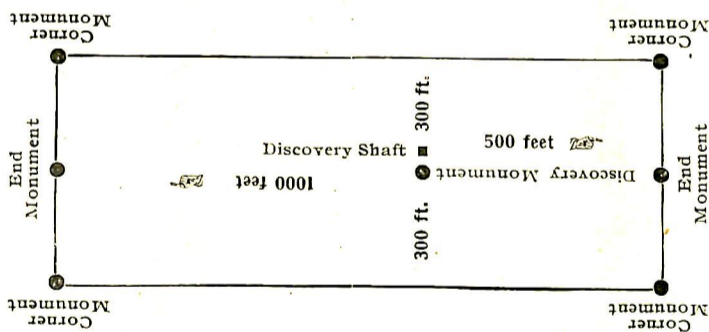

This diagram is to give locator a general idea of plan of location under the new law. The Discovery Shaft can be in the center of claim or any distance from either end desired. In the diagram it is placed 500 feet from one end and 1000 feet from the other. Commence description of claim at a center end monument, giving its distance and direction from center of Discovery Shaft; thence bound the claim in either direction. In description be careful to state locality of claim with reference to some natural object, or permanent monument, as will identify the claim.

TERRITORY OF ARIZONA)
)ss.
County of Cochise)

I, C. A. McDonald, County Recorder, in and for the County of Cochise, and Territory of Arizona, do hereby certify that I have compared the annexed and foregoing copy with the Original Location Notice of the El Sobrante Mining Claim filed for record in my office on the 18th day of June 1904 and recorded in Book 31 Records of Mines at page 368 and that the same is a full, true and correct copy of the said original and of the whole thereof.

Given under my hand and seal of office this 19th day of January
A D. 1909.

--- *C. A. McDonald* ---
County Recorder.

Notice of Mining Location

LODE CLAIM

To All Whom It May Concern:

This Mining Claim, the name of which is the Apex
Mining Claim, situate on lands belonging to the United States of America, and in which there
are valuable mineral deposits, was entered upon and located for the purposes of exploration and
purchase by E. O. Gill, a citizen of the United States

(Locator must insert either "a citizen of the United States," or, "who has declared his intention to become a citizen of the United States.")

the undersigned, on the 20th day of February 1904

The length of this claim is 1,500 feet,
and 1 claim 500 feet,
in a Easterly direction and 1,000
feet in a Westerly direction from
the center of the discovery shaft, at which this notice is posted, lengthwise of the claim, together
with 300 feet in width of the surface grounds, on each
side of the center of said claim. The general course of the lode deposit and premises is from the
East to the West

The claim is situated and located in the California Mining District, in
Cochise County, in the Territory of Arizona, about 3 $\frac{1}{2}$ miles
in a Easterly direction from U. S. Mineral monument No 1

The surface boundaries of the claim are marked upon the ground as follows: Beginning at
A monument of stone

at a point in a Easterly direction 500 feet from
the discovery shaft (at which this notice is posted), being in the center of the East
end line of said claim; thence northerly 300 feet to a Monument of stone
northeast corner of said claim; thence
westerly 1,500 feet to a monument, being at the
northwest corner of said claim; thence southerly 300 feet
to a monument at the center of the West end of said claim;
thence southerly 300 feet to a monument, being at the
southwest corner of said claim; thence Easterly 1,500
feet to a monument at the Southeast corner of said claim;
thence northerly 300 feet to the place of beginning.

All done under the provisions of Chapter Six, of Title XXXII, of the Revised Statutes of
the United States, and of an Act of the General Assembly of Arizona, entitled "An Act to
Revise and Codify the Laws of the Territory of Arizona," approved March 16, 1901.

Dated and posted on the ground this 20th day of February 1904

E. O. Gill

Filed and recorded at request of E. O. Gill May 4 A. D. 1904, at 11 A. M.
Book 31 Records of Mines at page 87.

TERRITORY OF ARIZONA,
 County of..... } ss.

I,....., County Recorder in and for the County and Territory aforesaid, do hereby certify that the within instrument was filed for record at.....o'clock,.....M., on this.....day of.....190., and duly recorded in Book No..... of.....Records of.....County, Arizona, at pages.....

WITNESS my hand and official seal the day and year first above written.

.....
 County Recorder.

Notice of Location

LODE CLAIM

Dated..... 190.....

Filed and Recorded at request of

..... A. D. 190.....

at..... M.

Book.....

Pages.....

..... County Recorder.

By..... Deputy Recorder.

THE H. H. McNEIL CO., PRINTERS, PHOENIX, ARIZONA

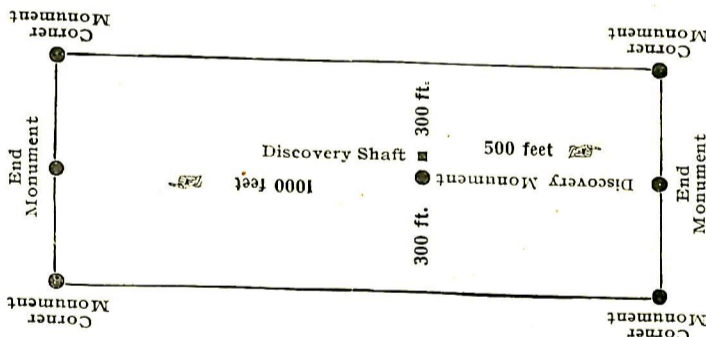

This diagram is to give locator a general idea of plan of location under the new law. The Discovery Shaft can be in the center of claim or any distance from either end desired. In the diagram it is placed 500 feet from one end and 1000 feet from the other. Commence description of claim at a center end monument, giving its distance and direction from center of Discovery Shaft; thence bound the claim in either direction. In description be careful to state locality of claim with reference to some natural object, or permanent monument, as will identify the claim.

TERRITORY OF ARIZONA)
County of Cochise)ss.

I, G. A. McDonald, County Recorder, in and for said County and Territory, do hereby certify that I have compared the annexed and foregoing copy with the Original Location Notice of the Apex Mining Claim filed for record in my office on the 4th day of May 1904, and recorded in Book 31 Record of Mines at page 87 and that the same is a full, true and correct copy of said original and of the whole thereof.

Given under my hand and seal of office this 19th of January A D 1909.

County Recorder.

Notice of Mining Location

40

LODE CLAIM

To All Whom It May Concern:

This Mining Claim, the name of which is the Snow Ball
Mining Claim, situate on lands belonging to the United States of America, and in which there
are valuable mineral deposits, was entered upon and located for the purposes of exploration and
purchase by W. H. Smith and E. O. Gill

Citizens of the United States

(Locator must insert either "a citizen of the United States," or, "who has declared his intention to become a citizen of the United States.")

the undersigned, on the 15th day of July 1903.

The length of this claim is fifteen hundred (1,500) feet,
and we claim seven hundred and fifty (750) feet,
in a easterly direction and seven hundred
and fifty (750) feet in a westerly direction from
the center of the discovery shaft, at which this notice is posted, lengthwise of the claim, together
with three hundred (300) feet in width of the surface grounds, on each
side of the center of said claim. The general course of the lode deposit and premises is from the
east to the west

The claim is situated and located in the California Mining District, in
Cochise County, in the Territory of Arizona, about three miles
in a easterly direction from U. S. Mineral monument No 1

The surface boundaries of the claim are marked upon the ground as follows: Beginning at
a monument

at a point in a easterly direction 750 feet from
the discovery shaft (at which this notice is posted), being in the center of the easterly
end line of said claim; thence southerly 300 feet to a monument
, being the southeast corner of said claim; thence
westerly 1,500 feet to a monument, being at the
southwest corner of said claim; thence northerly 300 feet
to a monument at the center of the west end of said claim;
thence northerly 300 feet to a monument, being at the
northwest corner of said claim; thence easterly 1,500
feet to a monument at the northeast corner of said claim;
thence southerly 300 feet to the place of beginning.

All done under the provisions of Chapter Six, of Title XXXII, of the Revised Statutes of
the United States, and of an Act of the General Assembly of Arizona, entitled "An Act to
Revise and Codify the Laws of the Territory of Arizona," approved March 16, 1901.

Dated and posted on the ground this 15th day of July 1903.

W. H. Smith

E. O. Gill

Filed and recorded at request of E. O. Gill Oct. 9 1903 at 9 A. M. Book
29 Records of Mines at page 92.

TERRITORY OF ARIZONA,
 County of..... } ss.

I,....., County Recorder in and for the County and Territory aforesaid, do hereby certify that the within instrument was filed for record at.....o'clock,.....M., on this.....day of.....190..., and duly recorded in Book No..... of.....Records of.....County, Arizona, at pages.....

WITNESS my hand and official seal the day and year first above written.

.....
 County Recorder.

Notice of Location

LODE CLAIM

Dated.....190.....

Filed and Recorded at request of.....

.....A. D. 190.....

at.....M.

Book.....

Pages.....

.....
 County Recorder.

By.....
 Deputy Recorder.

THE H. H. McNEIL CO., PRINTERS, PHOENIX, ARIZONA

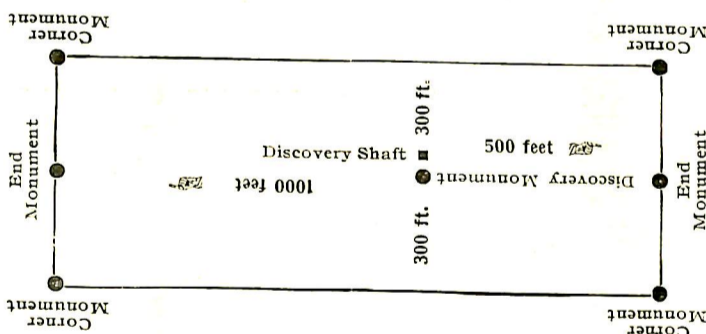

This diagram is to give locator a general idea of plan of location under the new law. The Discovery Shaft can be in the center of claim or any distance from either end desired. In the diagram it is placed 500 feet from one end and 1000 feet from the other. Commence description of claim at a center end monument, giving its distance and direction from center of Discovery Shaft; thence bound the claim in either direction. In description be careful to state locality of claim with reference to some natural object, or permanent monument, as will identify the claim.

TERRITORY OF ARIZONA)
County of Cochise)ss.
)

I, C. A. McDonald, County Recorder in and for said County and Territory do hereby certify that I have compared the annexed and foregoing copy with the Original Location Notice of the Snow Ball Mining Claim filed for record in my office on the 9th day of Oct. 1903 and recorded in Book 29 Records of Mines at page 92 and that the same is a full true and correct copy of said original and of the whole thereof.

Given under my hand and seal of office this 19th day of January A. D. 1909.

C. A. McDonald
County Recorder.

158 →

Notice of Mining Location

LODE CLAIM

To All Whom It May Concern:

This Mining Claim, the name of which is the Valley
Mining Claim, situate on lands belonging to the United States of America, and in which there
are valuable mineral deposits, was entered upon and located for the purposes of exploration and
purchase by J. A. Lewandowski

a citizen of the United States
(Locator must insert either "a citizen of the United States," or, "who has declared his intention to become a citizen of the United States.")

the undersigned, on the 1st day of April 1904

The length of this claim is Fifteen hundred feet,
and I claim Four hundred & fifty feet,
in an easterly direction and ten hundred
& fifty feet in a westerly direction from
the center of the discovery shaft, at which this notice is posted, lengthwise of the claim, together
with Three hundred feet in width of the surface grounds, on each
side of the center of said claim. The general course of the lode deposit and premises is from the
east to the west

The claim is situated and located in the California Mining District, in
Cochise County, in the Territory of Arizona, about 2¹/₂ miles
in a north easterly direction from U. S. Mineral monument

The surface boundaries of the claim are marked upon the ground as follows: Beginning at
a monument of stone

at a point in a n easterly direction 450 feet from
the discovery shaft (at which this notice is posted), being in the center of the east
end line of said claim; thence northerly 300 feet to a monument of
stone, being the northeast corner of said claim; thence
westerly 1500 feet to a monument, being at the
north west corner of said claim; thence southerly 300 feet
to a monument at the center of the west end of said claim;
thence southerly 300 feet to a monument, being at the
south west corner of said claim; thence easterly 1500
feet to a monument at the south east corner of said claim;
thence northerly 300 feet to the place of beginning.

All done under the provisions of Chapter Six, of Title XXXII, of the Revised Statutes of
the United States, and of an Act of the General Assembly of Arizona, entitled "An Act to
Revise and Codify the Laws of the Territory of Arizona," approved March 16, 1901.

Dated and posted on the ground this 1st day of April 1904.

J. A. Lewandowski

Filed and recorded at request of E. Lewandowski June 18 1904 at 9 A. M.
Book 31 Records of Mines at page 367.

TERRITORY OF ARIZONA, }
 County of..... } ss.

I,....., County Recorder in and for the County and Territory aforesaid, do hereby certify that the within instrument was filed for record at.....o'clock,.....M., on this.....day of.....190..., and duly recorded in Book No..... of.....Records of.....County, Arizona, at pages.....

WITNESS my hand and official seal the day and year first above written.

.....
 County Recorder.

Notice of Location

LODE CLAIM

Dated.....190.....

Filed and Recorded at request of

.....A. D. 190.....

at.....M.

Book.....

Pages.....

.....
 County Recorder.

.....
 Deputy Recorder.

THE H. H. MONEIL CO., PRINTERS, PHOENIX, ARIZONA

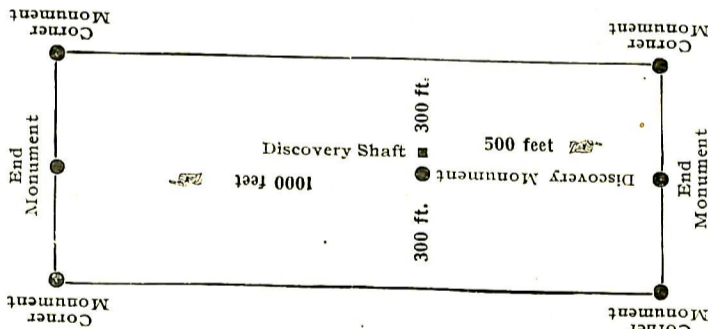

This diagram is to give locator a general idea of plan of location under the new law. The Discovery Shaft can be in the center of claim or any distance from either end desired. In the diagram it is placed 500 feet from one end and 1000 feet from the other. Commence description of claim at a center end monument, giving its distance and direction from center of Discovery Shaft; thence bound the claim in either direction. In description be careful to state locality of claim with reference to some natural object, or permanent monument, as will identify the claim.

TERRITORY OF ARIZONA)
County of Cochise)ss.
)

I, C. A. McDonald, County Recorder, in and for the County of Cochise, and Territory of Arizona, do hereby certify that I have compared the annexed and foregoing copy with the Original Location Notice of the Valley Mining Claim filed for record in my office on the 18th day of June 1904 and recorded in Book 31 Records of Mines at page 367 and that the same is a full, true and correct copy of the said original and of the whole thereof.

Given under my hand and seal of office this 19th day of January A D. 1909.

C. A. McDonald
County Recorder.

PT →

Notice of Mining Location

LODE CLAIM

To All Whom It May Concern:

This Mining Claim, the name of which is the Fireball Mining Claim, situate on lands belonging to the United States of America, and in which there are valuable mineral deposits, was entered upon and located for the purposes of exploration and purchase by J. A. Lewandowski, a citizen of the United States

(Locator must insert either "a citizen of the United States," or, "who has declared his intention to become a citizen of the United States.")

the undersigned, on the 8th day of March 1905.

The length of this claim is Fifteen Hundred feet, and I claim Fifteen Hundred feet, in a easterly direction and - - - - feet in a - - - - direction from the center of the discovery shaft, at which this notice is posted, lengthwise of the claim, together with One Hundred feet in width of the surface grounds, on each side of the center of said claim. The general course of the lode deposit and premises is from the - - - - to the - - - -

The claim is situated and located in the California Mining District, in Cochise County, in the Territory of Arizona, about 2 1/2 miles in a easterly direction from Mineral Monument No 1 and joins the "Snowball" on the South, "Apex," on the north, "Rico" on the West, and "Cochise" on the east.

The surface boundaries of the claim are marked upon the ground as follows: Beginning at This monument of stones

at a point in a - - - - direction - - - - feet from the discovery shaft (at which this notice is posted), being in the center of the west end line of said claim; thence northerly 100 feet to a monument of stones, being the north west corner of said claim; thence easterly 1500 feet to a monument, being at the north east corner of said claim; thence southerly 100 feet to a monument at the center of the east end of said claim; thence southerly 100 feet to a monument, being at the south east corner of said claim; thence westerly 1500 feet to a monument at the south west corner of said claim; thence northerly 100 feet to the place of beginning.

All done under the provisions of Chapter Six, of Title XXXII, of the Revised Statutes of the United States, and of an Act of the General Assembly of Arizona, entitled "An Act to Revise and Codify the Laws of the Territory of Arizona," approved March 16, 1901.

Dated and posted on the ground this 8th day of March 1905.

Witness

James Reay

J. A. Lewandowski

Filed and recorded at request of E. Lewandowski Apr. 13 1905 at 11 A M. Book 33 Record of Mines at page 465.

TERRITORY OF ARIZONA,
 County of..... } ss.

I,....., County Recorder in and for the County and Territory aforesaid, do hereby certify that the within instrument was filed for record at.....o'clock,.....M., on this.....day of.....190..., and duly recorded in Book No..... of.....Records of.....County, Arizona, at pages.....

WITNESS my hand and official seal the day and year first above written.

.....
 County Recorder.

Notice of Location

LODE CLAIM

Dated.....190.....

Filed and Recorded at request of.....

A. D. 190.....

at.....M.

Book.....

Pages.....

County Recorder.

Deputy Recorder.

THE H. H. McNEIL CO., PRINTERS, PHOENIX, ARIZONA

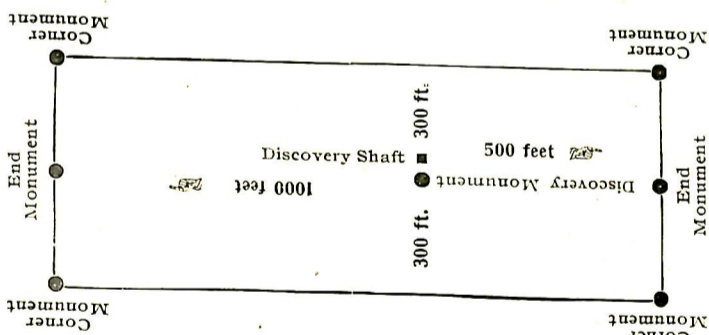

This diagram is to give locator a general idea of plan of location under the new law. The Discovery Shaft can be in the center of claim or any distance from either end desired. In the diagram it is placed 500 feet from one end and 1000 feet from the other. Commence description of claim at a center end monument, giving its distance and direction from center of Discovery Shaft; thence bound the claim in either direction. In description be careful to state locality of claim with reference to some natural object, or permanent monument, as will identify the claim.

TERRITORY OF ARIZONA)
County of Cochise)ss.

I, G. A. McDonald, County Recorder, in and for said County and Territory, do hereby certify that I have compared the annexed and foregoing copy with the Original Location Notice of the Fireball Mining Claim filed for record in my office on the 13th day of April 1905, and recorded in Book 33 Record of Mines at page 465 and that the same is a full, true and correct copy of said original and of the whole thereof.

Given under my hand and seal of office this 19th of January A D 1909.

G. A. McDonald
County Recorder.

Notice of Mining Location

LODE CLAIM

To All Whom It May Concern:

This Mining Claim, the name of which is the Neptune
Mining Claim, situate on lands belonging to the United States of America, and in, which there
are valuable mineral deposits, was entered upon and located for the purposes of exploration and
purchase by J. A. Lewandowski

a citizen of the United States

(Locator must insert either "a citizen of the United States," or, "who has declared his intention to become a citizen of the United States.")

the undersigned, on the 2d day of April 1904

The length of this claim is Fifteen hundred feet,
and I claim Three hundred feet,
in an easterly direction and Twelve hundred
feet in a westerly direction from
the center of the discovery shaft, at which this notice is posted, lengthwise of the claim, together
with three hundred feet in width of the surface grounds, on each
side of the center of said claim. The general course of the lode deposit and premises is from the
east to the west

The claim is situated and located in the California Mining District, in
Cochise County, in the Territory of Arizona, about 3 miles
in a n easterly direction from U. S. Mineral monument No 1

The surface boundaries of the claim are marked upon the ground as follows: Beginning at
a monument of stone

at a point in a n easterly direction three hundred feet from
the discovery shaft (at which this notice is posted), being in the center of the east
end line of said claim; thence northerly 300 feet to a monument of stone
, being the north east corner of said claim; thence
westerly 1500 feet to a monument, being at the
north west corner of said claim; thence southerly 300 feet
to a monument at the center of the west end of said claim;
thence southerly 300 feet to a monument, being at the
south west corner of said claim; thence easterly 1500
feet to a monument at the south east corner of said claim;
thence northerly 300 feet to the place of beginning.

All done under the provisions of Chapter Six, of Title XXXII, of the Revised Statutes of
the United States, and of an Act of the General Assembly of Arizona, entitled "An Act to
Revise and Codify the Laws of the Territory of Arizona," approved March 16, 1901.

Dated and posted on the ground this 2d day of April 1904

J. A. Lewandowski

Filed and recorded at request of E. Lewandowski June 18 1904 at 9 A. M.
Book 31 Records of Mines at page 360.

TERRITORY OF ARIZONA,
 County of..... } ss.

I,....., County Recorder in and for the County and Territory aforesaid, do hereby certify that the within instrument was filed for record at.....o'clock,.....M., on this.....day of.....190..., and duly recorded in Book No..... of.....Records of.....County, Arizona, at pages.....

WITNESS my hand and official seal the day and year first above written.

.....
 County Recorder.

Notice of Location

LODE CLAIM

Dated.....190.....

Filed and Recorded at request of

.....A. D. 190.....

at.....M.

Book.....

Pages.....

.....County Recorder.

.....Deputy Recorder.

THE H. H. McNEIL CO., PRINTERS, PHOENIX, ARIZONA

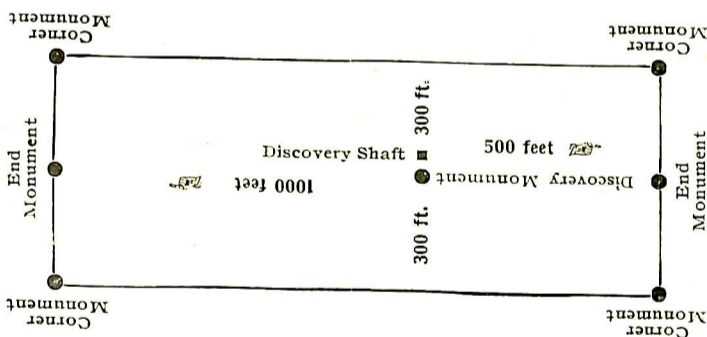

This diagram is to give locator a general idea of plan of location under the new law. The Discovery Shaft can be in the center of claim or any distance from either end desired. In the diagram it is placed 500 feet from one end and 1000 feet from the other. Commence description of claim at a center end monument, giving its distance and direction from center of Discovery Shaft; thence bound the claim in either direction. In description be careful to state locality of claim with reference to some natural object, or permanent monument, as will identify the claim.

Territory of Arizona)
County of Cochise)ss.

I, C. A. McDonald, County Recorder in and for the said County and Territory, do hereby certify that I have compared the annexed and foregoing copy with the Original Location Notice of the Neptune Mining Claim filed for record in my office on the 18th day of June 1904 and recorded in Book 31 Records of Mines at page 360 and that the same is a full true and correct copy of the said original and of the whole thereof.

Given under my hand and seal of office this 19th day of January A. D. 1909.

C. A. McDonald
County Recorder.

Notice of Mining Location

48

LODE CLAIM

To All Whom It May Concern:

This Mining Claim, the name of which is the Cochise Mining Claim, situate on lands belonging to the United States of America, and in which there are valuable mineral deposits, was entered upon and located for the purposes of exploration and purchase by J. A. Lewandowski

A citizen of the United States
(Locator must insert either "a citizen of the United States," or, "who has declared his intention to become a citizen of the United States.")
the undersigned, on the 12th day of January 1904

The length of this claim is Fifteen Hundred feet,
and I claim Two Hundred feet,
in a Westerly direction and Thirteen Hundred
feet in a Easterly direction from
the center of the discovery shaft, at which this notice is posted, lengthwise of the claim, together
with Three Hundred feet in width of the surface grounds, on each
side of the center of said claim. The general course of the lode deposit and premises is from the
East to the West

The claim is situated and located in the California Mining District, in
Cochise County, in the Territory of Arizona, about Two Miles
in a North Westerly direction from Hand Brothers Spring and about
three miles East from the United States Monument #1, at the eastern
entrance to Round Valley, and joining the Snowball Claim to the west

The surface boundaries of the claim are marked upon the ground as follows: Beginning at
A monument of stone

at a point in a Easterly direction 750 feet from
the discovery shaft (at which this notice is posted), being in the center of the East
end line of said claim; thence Northerly 300 feet to a monument
of stone, being the North East corner of said claim; thence
Westerly 1500 feet to a monument, being at the
North West corner of said claim; thence Southerly 300 feet
to a Monument of stone at the center of the West end of said claim;
thence Southerly 300 feet to a monument of Stone, being at the
South West corner of said claim; thence Easterly 1500
feet to a monument at the South East corner of said claim;
thence Northerly 300 feet to the place of beginning.

All done under the provisions of Chapter Six, of Title XXXII, of the Revised Statutes of
the United States, and of an Act of the General Assembly of Arizona, entitled "An Act to
Revise and Codify the Laws of the Territory of Arizona," approved March 16, 1901.

Dated and posted on the ground this 12th day of January 1904.

J. A. Lewandowski

Filed and recorded at request of J. A. Lewandowski Jany. 18th A. D. 1904
at 1 P. M. Book 30 Records of Mines at page 50.

TERRITORY OF ARIZONA, }
 County of..... } ss.

I,....., County Recorder in and for the County and Territory aforesaid, do hereby certify that the within instrument was filed for record at.....o'clock,.....M., on this.....day of.....190..., and duly recorded in Book No..... of.....Records of.....County, Arizona, at pages.....

WITNESS my hand and official seal the day and year first above written.

.....
 County Recorder.

Notice of Location
LODE CLAIM

Dated..... 190.....

Filed and Recorded at request of

..... A. D. 190.....

at..... M.

Book.....

Pages.....

.....
 County Recorder.

By.....
 Deputy Recorder.

THE H. H. McNEIL CO., PRINTERS, PHOENIX, ARIZONA

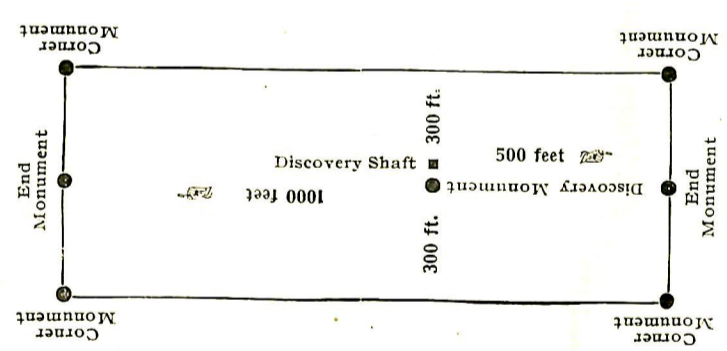

This diagram is to give locator a general idea of plan of location under the new law. The Discovery Shaft can be in the center of claim or any distance from either end desired. In the diagram it is placed 500 feet from one end and 1000 feet from the other. Commence description of claim at a center end monument, giving its distance and direction from center of Discovery Shaft; thence bound the claim in either direction. In description be careful to state locality of claim with reference to some natural object, or permanent monument, as will identify the claim.

TERRITORY OF ARIZONA)
County of Cochise)ss.

I, C. A. McDonald, County Recorder, in and for said County and Territory, do hereby certify that I have compared the annexed and foregoing copy with the Original Location Notice of the Cochise Mining Claim filed for record in my office on the 18th day of January 1904, and recorded in Book 30 Record of Mines at page 50 and that the same is a full, true and correct copy of said original and of the whole thereof.

Given under my hand and seal of office this 19th of January A D 1909.

C. A. McDonald
County Recorder.

Notice of Mining Location

LODE CLAIM

To All Whom It May Concern:

This Mining Claim, the name of which is the Iron Hat
Mining Claim, situate on lands belonging to the United States of America, and in which there
are valuable mineral deposits, was entered upon and located for the purposes of exploration and
purchase by J. A. Lewandowski, a citizen of the United States

(Locator must insert either "a citizen of the United States," or, "who has declared his intention to become a citizen of the United States.")

the undersigned, on the 30th day of April 1904.

The length of this claim is Fifteen hundred feet,
and 1 claim Eleven hundred & fifty feet,
in an easterly direction, and three hundred
& fifty feet in a westerly direction from
the center of the discovery shaft, at which this notice is posted, lengthwise of the claim, together
with three hundred feet in width of the surface grounds, on each
side of the center of said claim. The general course of the lode deposit and premises is from the
east to the west

The claim is situated and located in the California Mining District, in
Cochise County, in the Territory of Arizona, about 3 miles
in a n easterly direction from U. S. Mineral Monument No 1

The surface boundaries of the claim are marked upon the ground as follows: Beginning at
a monument of stone

at a point in an easterly direction 1150 feet from
the discovery shaft (at which this notice is posted), being in the center of the east
end line of said claim; thence northerly 300 feet to a monument
of stone, being the north east corner of said claim; thence
westerly 1500 feet to a monument, being at the
north west corner of said claim; thence southerly 300 feet
to a monument at the center of the west end of said claim;
thence southerly 300 feet to a monument, being at the
South west corner of said claim; thence easterly 1500
feet to a monument at the southeast corner of said claim;
thence northerly 300 feet to the place of beginning.

All done under the provisions of Chapter Six, of Title XXXII, of the Revised Statutes of
the United States, and of an Act of the General Assembly of Arizona, entitled "An Act to
Revise and Codify the Laws of the Territory of Arizona," approved March 16, 1901.

Dated and posted on the ground this 30th day of April 1904.

J. A. Lewandowski

Filed and recorded at request of E. Lewandowski June 18 1904 at 9 A M
Book 31 Records of Mines at page 359.

TERRITORY OF ARIZONA, }
 County of..... } ss.

I,....., County Recorder in and for the County and Territory aforesaid, do hereby certify that the within instrument was filed for record at.....o'clock,.....M., on this.....day of.....190..., and duly recorded in Book No..... of.....Records of.....County, Arizona, at pages.....

WITNESS my hand and official seal the day and year first above written.

.....
 County Recorder.

Notice of Location

LODE CLAIM

Dated..... 190.....

Filed and Recorded at request of.....

..... A. D. 190.....

at..... M.

Book.....

Pages.....

..... County Recorder.

By..... Deputy Recorder.

THE H. H. McNEIL CO., PRINTERS, PHOENIX, ARIZONA

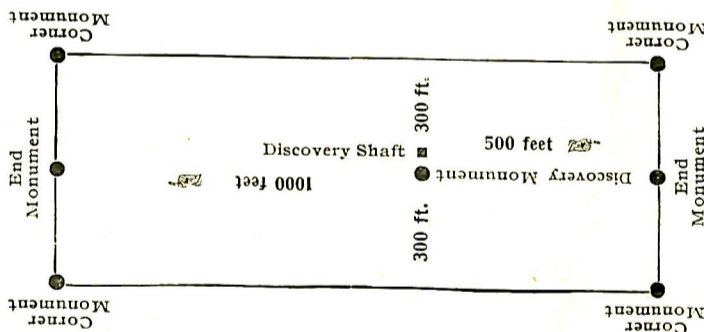

This diagram is to give locator a general idea of plan of location under the new law. The Discovery Shaft can be in the center of claim or any distance from either end desired. In the diagram it is placed 500 feet from one end and 1000 feet from the other. Commence description of claim at a center end monument, giving its distance and direction from center of Discovery Shaft; thence bound the claim in either direction. In description be careful to state locality of claim with reference to some natural object, or permanent monument, as will identify the claim.

Territory of Arizona)
County of Cochise)ss.

I, G. A. McDonald, County Recorder in and for the said County and Territory, do hereby certify that I have compared the annexed and foregoing copy with the Original Location Notice of the Iron Hat Mining Claim filed for record in my office on the 18th day of June 1904 and recorded in Book 31 Records of Mines at page 359 and that the same is a full true and correct copy of the said original and of the whole thereof.

Given under my hand and seal of office this 19th day of January A. D. 1909.

G. A. McDonald
County Recorder.

51 →

Notice of Mining Location

LODE CLAIM

To All Whom It May Concern:

This Mining Claim, the name of which is the Pappoose Mining Claim, situate on lands belonging to the United States of America, and in which there are valuable mineral deposits, was entered upon and located for the purposes of exploration and purchase by J. A. Lewandowski, a citizen of the United States

(Locator must insert either "a citizen of the United States," or, "who has declared his intention to become a citizen of the United States.")

the undersigned, on the 28th day of April 1904.

The length of this claim is Fifteen hundred feet, and I claim Fifteen hundred feet, in a n easterly direction ~~###~~ feet from

the center of the discovery shaft, at which this notice is posted, lengthwise of the claim, together with Three hundred feet in width of the surface grounds, on each side of the center of said claim. The general course of the lode deposit and premises is from the east to the west

The claim is situated and located in the California Mining District, in Cochise County, in the Territory of Arizona, about 3 miles in a n easterly direction from U. S. Mineral Monument No. 1

The surface boundaries of the claim are marked upon the ground as follows: Beginning at a monument of stones

at a point ~~in a~~ direction west feet from the discovery shaft (at which this notice is posted), being in the center of the west end line of said claim; thence northerly 300 feet to a monument of stone, being the north west corner of said claim; thence easterly 1500 feet to a monument, being at the north east corner of said claim; thence southerly 300 feet to a monument at the center of the east end of said claim; thence southerly 300 feet to a monument, being at the southeast corner of said claim; thence westerly feet to a monument at the south west corner of said claim; thence northerly 300 feet to the place of beginning.

All done under the provisions of Chapter Six, of Title XXXII, of the Revised Statutes of the United States, and of an Act of the General Assembly of Arizona, entitled "An Act to Revise and Codify the Laws of the Territory of Arizona," approved March 16, 1901.

Dated and posted on the ground this 28th day of April 1904.

J. A. Lewandowski

Filed and recorded at request of E. Lewandowski June 18 1904 at 9 A M. Book 31 Record of Mines page 363.

TERRITORY OF ARIZONA, }
 County of..... } ss.

I,....., County Recorder in and for the County and Territory aforesaid, do hereby certify that the within instrument was filed for record at.....o'clock,.....M., on this.....day of.....190..., and duly recorded in Book No..... of.....Records of.....County, Arizona, at pages.....

WITNESS my hand and official seal the day and year first above written.

.....
 County Recorder.

Notice of Location

LODE CLAIM

Dated.....190.....

Filed and Recorded at request of.....

.....A. D. 190.....

at.....M.

Book.....

Pages.....

.....County Recorder.

.....Deputy Recorder.

THE H. H. McNEIL CO., PRINTERS, PHOENIX, ARIZONA

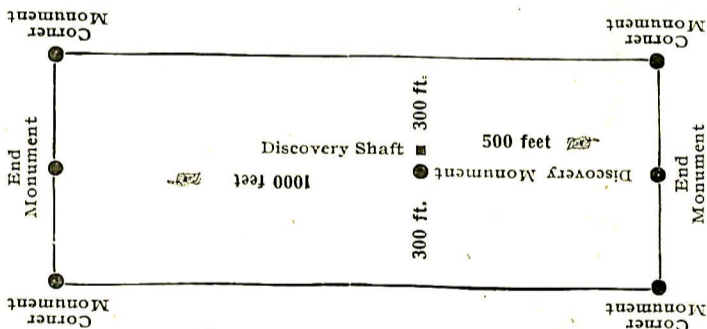

This diagram is to give locator a general idea of plan of location under the new law. The Discovery Shaft can be in the center of claim or any distance from either end desired. In the diagram it is placed 500 feet from one end and 1000 feet from the other. Commence description of claim at a center end monument, giving its distance and direction from center of Discovery Shaft; thence bound the claim in either direction. In description be careful to state locality of claim with reference to some natural object, or permanent monument, as will identify the claim.

Territory of Arizona)
County of Cochise)ss.

I, C. A. McDonald, County Recorder in and for the said County and Territory, do hereby certify that I have compared the annexed and foregoing copy with the Original Location Notice of the Pappoose Mining Claim filed for record in my office on the 18th day of June 1904 and recorded in Book 31 Records of Mines at page 363 and that the same is a full true and correct copy of the said original and of the whole thereof.

Given under my hand and seal of office this 19th day of January
A. D. 1909.

C. A. McDonald
County Recorder.

Notice of Mining Location

54

LODE CLAIM

To All Whom It May Concern:

This Mining Claim, the name of which is the Wedge 3
Mining Claim, situate on lands belonging to the United States of America, and in which there
are valuable mineral deposits, was entered upon and located for the purposes of exploration and
purchase by J. A. Lewandowski, a citizen of United States

(Locator must insert either "a citizen of the United States," or, "who has declared his intention to become a citizen of the United States.")

the undersigned, on the 12th day of February 1905.

The length of this claim is Fifteen hundred feet,
and I claim 1400 feet,
in a westerly direction and 100
feet in a easterly direction from
the center of the discovery shaft, at which this notice is posted, lengthwise of the claim, together
with 300 feet in width of the surface grounds, on each
side of the center of said claim. The general course of the lode deposit and premises is from the
----- to the -----

The claim is situated and located in the California Mining District, in
Cochise County, in the Territory of Arizona, about 3 miles
in a easterly direction from U. S. Mineral Monument No 1
and is bounded on the north by "Snowball" and "Rico" claims and on the
East by "Neptune" claim.

The surface boundaries of the claim are marked upon the ground as follows: Beginning at
this monument of stones
at a point in a easterly direction 100 feet from
the discovery shaft (at which this notice is posted), being in the center of the east
end line of said claim; thence northerly 300 feet to a monument of
stones, being the northeast corner of said claim; thence
westerly 1500 feet to a monument, being at the
north west corner of said claim; thence southerly 300 feet
to a monument at the center of the west end of said claim;
thence southerly 300 feet to a monument, being at the
south west corner of said claim; thence easterly 1500
feet to a monument at the south east corner of said claim;
thence 300 feet to the place of beginning.

All done under the provisions of Chapter Six, of Title XXXII, of the Revised Statutes of
the United States, and of an Act of the General Assembly of Arizona, entitled "An Act to
Revise and Codify the Laws of the Territory of Arizona," approved March 16, 1901.

Dated and posted on the ground this 12th day of February 1905

J. A. Lewandowski

Filed and recorded at request of E. Lewandowski Apr 13 1905 at 11 A. M.
Book 33 Records of Mines at page 459.

TERRITORY OF ARIZONA, }
 County of..... } ss.

I,....., County Recorder in and for the County and Territory aforesaid, do hereby certify that the within instrument was filed for record at.....o'clock,.....M., on this.....day of.....190..., and duly recorded in Book No..... of.....Records of.....County, Arizona, at pages.....

WITNESS my hand and official seal the day and year first above written.

.....
 County Recorder.

Notice of Location

LODE CLAIM

Dated.....190.....

Filed and Recorded at request of

.....
 at.....A. D. 190.....

.....M.

Book.....

Pages.....

.....
 County Recorder.

By.....
 Deputy Recorder.

THE H. H. McNEIL CO., PRINTERS, PHOENIX, ARIZONA

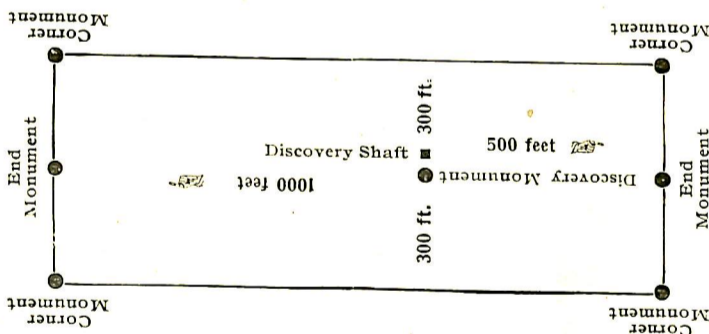

This diagram is to give locator a general idea of plan of location under the new law. The Discovery Shaft can be in the center of claim or any distance from either end desired. In the diagram it is placed 500 feet from one end and 1000 feet from the other. Commence description of claim at a center end monument, giving its distance and direction from center of Discovery Shaft; thence bound the claim in either direction. In description be careful to state locality of claim with reference to some natural object, or permanent monument, as will identify the claim.

TERRITORY OF ARIZONA)
 County of Cochise)ss.

I, C. A. McDonald, County Recorder, in and for said County and Territory, do hereby certify that I have compared the annexed and foregoing copy with the Original Location Notice of the Wedge 3 Mining Claim filed for record in my office on the 13th day of April 1905, and recorded in Book 33 Record of Mines at page 459 and that the same is a full, true and correct copy of said original and of the whole thereof.

Given under my hand and seal of office this 19th of January A D 1909.

--- *C. A. McDonald* ---
 County Recorder.

15 →

Notice of Mining Location

LODE CLAIM

To All Whom It May Concern:

This Mining Claim, the name of which is the Rico Mining Claim, situate on lands belonging to the United States of America, and in which there are valuable mineral deposits, was entered upon and located for the purposes of exploration and purchase by J. A. Lewandowski, a citizen of the United States

(Locator must insert either "a citizen of the United States," or, "who has declared his intention to become a citizen of the United States.")

the undersigned, on the 1st day of April 1904

The length of this claim is Fifteen hundred feet, and I claim Two hundred feet, in an easterly direction and Thirteen hundred feet in a westerly direction from the center of the discovery shaft, at which this notice is posted, lengthwise of the claim, together with Three hundred feet in width of the surface grounds, on each side of the center of said claim. The general course of the lode deposit and premises is from the east to the west

The claim is situated and located in the California Mining District, in Gochise County, in the Territory of Arizona, about 3 miles in an easterly direction from U. S. Mineral Monument No. 1

The surface boundaries of the claim are marked upon the ground as follows: Beginning at a monument of stone

at a point in an easterly direction Two hundred feet from the discovery shaft (at which this notice is posted), being in the center of the east end line of said claim; thence northerly 300 feet to a monument of stone, being the north east corner of said claim; thence westerly 1500 feet to a monument, being at the north west corner of said claim; thence southerly 300 feet to a monument at the center of the west end of said claim; thence southerly 300 feet to a monument, being at the south west corner of said claim; thence easterly 1500 feet to a monument at the southeast corner of said claim; thence northerly 300 feet to the place of beginning.

All done under the provisions of Chapter Six, of Title XXXII, of the Revised Statutes of the United States, and of an Act of the General Assembly of Arizona, entitled "An Act to Revise and Codify the Laws of the Territory of Arizona," approved March 16, 1901.

Dated and posted on the ground this 1st day of April 1904

J. A. Lewandowski

Filed and recorded at request of E. Lewandowski June 18 1904 at 9 A.M
Book 31 Records of mines at page 364.

TERRITORY OF ARIZONA,

County of..... } ss.

I,....., County Recorder in and for the County and Territory aforesaid, do hereby certify that the within instrument was filed for record at.....o'clock,.....M., on this.....day of.....190..., and duly recorded in Book No..... of.....Records of.....County, Arizona, at pages.....

WITNESS my hand and official seal the day and year first above written.

County Recorder.

Notice of Location
LODE CLAIM

Dated.....190.....

Filed and Recorded at request of

A. D. 190.....

at.....M.....

Book.....

Pages.....

County Recorder.

By.....Deputy Recorder.

THE H. H. McNEIL CO., PRINTERS, PHOENIX, ARIZONA

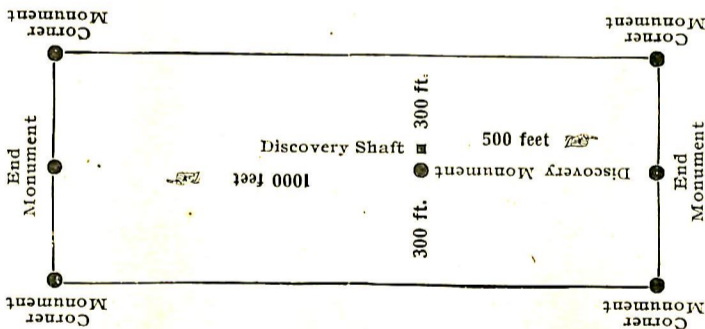

This diagram is to give locator a general idea of plan of location under the new law. The Discovery Shaft can be in the center of claim or any distance from either end desired. In the diagram it is placed 500 feet from one end and 1000 feet from the other. Commence description of claim at a center end monument, giving its distance and direction from center of Discovery Shaft; thence bound the claim in either direction. In description be careful to state locality of claim with reference to some natural object, or permanent monument, as will identify the claim.

Territory of Arizona)
)ss.
 County of Cochise)

I, C. A. McDonald, County Recorder in and for the said County and Territory, do hereby certify that I have compared the annexed and foregoing copy with the Original Location Notice of the Rico Mining Claim filed for record in my office on the 18th day of June 1904 and recorded in Book 31 Records of Mines at page 364 and that the same is a full true and correct copy of the said original and of the whole thereof.

Given under my hand and seal of office this 19th day of January A. D. 1909.

C. A. McDonald
 County Recorder.