

MAR 21 1911

M 2764

4-683.

MINERAL SURVEY No. 2894

LOT No. ....

Arizona Land District.

FIELD NOTES

OF THE SURVEY OF THE MINING CLAIM OF

Mrs Elizabeth A. Connor

KNOWN AS THE

Line Boy Patagonia Mining District,

Santa Cruz County, Arizona

Section ... Township 24 S, Range 16 E Unsurveyed

Surveyed under instructions dated Feb 17, 1911

by John A. Rockwell U. S. Mineral Surveyor.

Claim located See Location Notice 19

Survey commenced March 11, 1911

Survey completed March 13, 1911

6-822

Address of claimant

1409 Montana Street El Paso Tex.

P. K. Hickey Blowing Bl... Phoenix, Ariz.

## Line Boy

Beginning at cor. No.1, set a granite rock 10x5 ins., 26 ins. long one half its length in the ground, chisel a cross (X) at the exact point and 1 - 2894 L.B. witnessed by a monument of stone 4 ft. base 3 ft. high alongside:

Whence

International Boundary Monument No. 113 bears S69° 53'W - 179.6 ft.

Cor. of location a post 4 ins. square, 3 ft. above ground in a mound of stone, scribed L.B. S.E. and C. (painted) bears S18° 11'E - 62.5 ft.

X.B.T. 1 - 2894 chiseled on a blaze on an oak tree, 16 ins. in diameter, bears N 45° 35'E - 8.1 ft.

X.B.T. 1 - 2894 chiseled on a blaze on an oak tree, 12 ins in diameter, bears S86° 04'E - 25.8 ft.

Thence N89° 51'W Va. 12° 40'E

307.3 S. Center end a monument of stone, 3½ ft. base, 3 ft. high:

Whence

S. Center end of location; an oak post in a mound of stone bears S12° 28'E - 63.4 ft.

614.4 To cor. No.2, set a granite rock 12x5 ins. 28 ins. long, one half its length in the ground, chiseled a cross (X) at the exact point and 2 - 2894 L.B. witnessed by a monument of stone, 4 ft. base, 3 ft. high alongside.

Whence

Cor. of location a post, 4 ins. square, 3 ft. above ground in a mound of stone, scribed L.B. S.W. and C. (in paint) bears S7° 02'E - 53.95 ft.

X.B.T. 2 - 2894 scribed on a blaze on an oak tree, 14 ins. in diameter, bears N11° 34'W - 11.3 ft.

X.B.T. 2 - 2894 scribed on a blaze on an oak tree, 10 ins. in diameter, bears N40° 13'E - 50.4 ft.

Thence N12° 28'W Va. 12° 50'E.

1500.0 To cor. No.3 set a granite rock 8x6 ins. 26 ins. long, one half its length in ground, chiseled a cross (X) at exact point and 3 - 2894 L.B., witnessed by a monument, 4 ft. base, 3 ft. high alongside.

Whence

Cor. of location a post, 4 ins. square, 3 ft. above ground in a mound of stone scribed L.B. N.W.C. bears N47° 54'W - 74.9 ft.

X.B.T. 3 - 2894 scribed on a blaze on an oak tree, 18 ins. in diameter, bears N83° 58'E - 47.05 ft.

X.B.T. 3 - 2894 scribed on a blaze on an oak tree 14 ins. in diameter bears N23° 21'W - 21.6 ft.

Thence S89° 51'E Va. 12° 50'E

307.1 N. Center End, a stone monument, 3½ ft. base, 3 ft. high

Whence:

N.C. End of location an oak post in a mound of stone, bears N12° 28'W - 124.5 ft.

X.B.T. 2894 scribed on a blaze on an oak stump, 15 ins. in diameter bears N27° 00'E - 3.15 ft.

610.1 To cor. No.4, set a granite rock 10x8 ins. 28 ins. long,



one half its length in the ground, chiseled a cross at exact point and 4 - 2894 L.B. witnessed by a monument 4 ft. base, 3 ft. high alongside:

Whence

Cor. of location; a post 4 ins. square, 3 ft. above ground in a mound of stone, scribed L.B. N.E. and C. (in paint) bears  $N12^{\circ} 37' W - 183.6$  ft.

X.B.T. 4 - 2894 scribed on a blaze on an oak tree, 16 ins. in diameter, bears  $S17^{\circ} 02' E - 32.7$  ft.

X.B.T: 4 - 2894 scribed on a blaze on an oak tree, 12 ins in diameter, bears  $S64^{\circ} 24' W - 29.5$  ft.

Thence  $S12^{\circ} 37' 30" E$  Va.  $12^{\circ} 45' E$ .

615.0 Center of gulch 15 ft. wide, course easterly.

1500.95 To cor. No.1 the place of beginning.

-----  
A R E A .  
-----

Line Boy Lode 20.574 acres.

-----  
L O C A T I O N .  
-----

This survey is located in Patagonia Mining District, Santa Cruz County, Arizona, in approximately Tp24S R16E, unsurveyed and in the Garces National Forest. VEIN.

The presumed course of the lode is from S. Center End  $N12^{\circ} 28' W$ , 1500 ft. to N. Center End.

ADJOINING CLAIMS.

There are no adjoining claims so far as known.

-----  
E X P E N D I T U R E O F F I V E  
H U N D R E D D O L L A R S .  
-----

I certify that the value of the labor and improvements made upon this location by the claimant or her grantors is not less than five hundred dollars, and that said improvements consist:

No.1. The discovery point is a monument at point on lode

line, 654 ft. from S.C.E. The discovery consists of a blowout of ore and ledge matter, extending easterly and westerly from Improvement No. 7 to Improvement No. 4.

No. 2) Shaft, the center of which bears from a point on lode line at N. 12° 28' W., 654 ft. from S.C. E., N. 77° 32' E., 17 ft. Shaft 6 x 4 ft., 10 ft. deep. Value, \$100.00

From point on lode line at N12° 28'W - 495.6 ft. from S. C. E.  
No. 3) A cut the mouth of which bears N86° 52'E - 87 ft. Course of cut southeasterly, very irregular, 20 ft. face 5 ft. two winzes in bottom, first 5½x5½x5½ second 5x5x3 ft.

Total value of improvement-----\$130.00

No. 4) A shaft the center of which bears N28° 24'E - 215ft. shaft 6x4½ ft. - 45ft. to water.

Value at \$10. per ft. -----\$450.00

From point on lode line at N12° 28'E - 646. ft. from S. C. E.

No. 5) A shaft the center of which bears N84° 16'W - 195 ft shaft 7x5 ft. 25 ft. deep.

Value at \$10. per ft. -----\$250.00

No. 6) An open stope the center of which bears S76° 54'W 106. ft. Work 8x4 ft. 4 ft. deep.

Value \$40.00

No. 7) A shaft the center of which bears N73° 17'W - 111.5 ft. Shaft 6x4 ft. 36 ft. deep. From shaft is a drift 6x4 ft. approximately 20 ft. long course Southeasterly.

Value of shaft and drift at

\$10. per ft. -----\$560.00

From point on lode line at N12° 28'W - 745 ft. from S.C. End.

No. 8) The mouth of cut and tunnel which bears N86° 13'W - 28 ft.

Course southwesterly. Cut 18x4 ft. 9 ft. face.

Tunnel 6x4 ft.

90 ft. to fork thence right 14<sup>ft</sup> connects with  
 bottom of shaft (improvement No.6) left 20 ft.  
 to a face thence drift 5 ft.

Value of cut -----\$100.00

Value of 129 ft. tunnel-----

at \$10. per ft.-----\$1290.00

#### I N S T R U M E N T.

This survey was made with a Young & Sons mountain  
 transit No. 6855 provided with Smith Solar Attachment.  
 The courses were deflected from true meridian as  
 determined by direct solar observations. The distances  
 were measured with 500 ft. and 50 ft. steel tapes.

The International Boundary Monument mentioned is a  
 cast iron shaft about 8 ft. high on a base of cement  
 and on shaft are the raised figures 113. The course  
 of the International Boundary between United States  
 and Mexico between monuments No. 111 and No. 114 is  
 N89° 51'W.

Tombstone, Arizona.

March 17, 1911.

*John A. Rockafellow*  
 U.S. Mineral Surveyor.



# FINAL OATHS FOR SURVEYS.

## LIST OF NAMES.

A list of the names of the individuals employed by John A. Rockefeller  
United States Mineral Surveyor, to assist in running, measuring, and marking the lines, corners, and  
boundaries described in the foregoing field notes of the survey of the mining claim of \_\_\_\_\_

Mrs Elizabeth A O'Connor  
known as the Lin Bay  
and showing the respective capacities in which they acted.

- A. A. Benedict, Chairman.
- \_\_\_\_\_, Chairman.
- \_\_\_\_\_, Axman.
- \_\_\_\_\_, Flagman.

## FINAL OATHS OF ASSISTANTS.

I A. A. Benedict

and \_\_\_\_\_, do solemnly swear that we assisted John A. Rockefeller, United States Mineral Surveyor, in marking the corners and surveying

the boundaries of the mining claim of Mrs Elizabeth

A. O'Connor  
known as the Lin Bay

represented in the foregoing field notes as having been surveyed by said mineral surveyor and under his  
direction; and that said survey has been in all respects, to the best of our knowledge and belief, faithfully  
and correctly executed, and the corner and boundary monuments established according to law and the instruc-  
tions furnished by the United States Surveyor-General for Arizona

- A. A. Benedict, Chairman.
- \_\_\_\_\_, Chairman.
- \_\_\_\_\_, Axman.
- \_\_\_\_\_, Flagman.

Subscribed and sworn to by the above-named persons before me this 18<sup>th</sup>

day of March, 1911

My Commission expires July 6, 1912

Lee O. Woolery  
Notary Public  
Cochise County, Arizona



## FINAL OATH OF U. S. MINERAL SURVEYOR.

I, John A. Rockefeller, U. S. Mineral Surveyor,  
do solemnly swear that, in pursuance of instructions received from the United States  
Surveyor General for Arizona, dated  
Feb 17 1911, I have, in strict conformity to the laws of the

United States, the official regulations and instructions thereunder, and the instructions  
of said Surveyor General, faithfully and correctly executed the survey of the Mining  
Claim of Mrs Elizabeth O'Connor

known as the Line Boy,  
situate in Patagonia Mining District,

Santa Cruz County, Arizona, in Section  
      , Township No. 24 S, Range No. 16 E unsurveyed

and designated as Survey No. 2894, as represented

in the foregoing field notes, which accurately show the boundaries of said mining claim  
as distinctly marked by monuments on the ground, and described in the attached copy  
of the location certificate, which was received by me from the Surveyor General with  
said instructions, and that all the corners of said survey have been established and per-  
petuated in strict accordance with the law, official regulations and instructions there-  
under; and I do further solemnly swear that the foregoing are the true and original  
field notes of said survey and my report therein, and that the labor expended and  
improvements made upon said mining claim by claimant or her grantors  
are as therein fully stated, and that the character, extent, location, and itemized value  
thereof are specified therein with particularity and full detail, and that no portion of  
said labor or improvements so credited to this claim has been included in the estimate  
of expenditures upon any other claim.

John A. Rockefeller  
U. S. Mineral Surveyor.

Subscribed and sworn to by the said John A. Rockefeller

U. S. Mineral Surveyor, before me Lee O. Woolery, a Notary Public

in and for Cochise County, Arizona this 18<sup>th</sup>

day of March, 1911, 1911

My Commission  
expires July 6, 1912

Lee O. Woolery  
Notary Public



# Notice of Mining Location

## LODE CLAIM

To All Whom It May Concern:

This Mining Claim, the name of which is the Five Boy Mining Claim, situate on lands belonging to the United States of America, and in which there are valuable mineral deposits, was entered upon and located for the purposes of exploration and purchase by

A Citizen of the United States  
John Bennis  
(Locator must insert either "a citizen of the United States," or "who has declared his intention to become a citizen of the United States.")

the undersigned, on the 17<sup>th</sup> day of December 1907

The length of this claim is 1500 feet, and 2 claim 700 feet, in a Southerly direction and 800 feet in a Northerly direction from the center of the discovery shaft, at which this notice is posted, lengthwise of the claim, together with 300 feet in width of the surface grounds, on each side of the center of said claim.

The general course of the lode deposit and premises is from the Northerly to the Southerly.

The claim is situated and located in the Patagonia Mining District, in Santa Cruz County, in the Territory of Arizona, about 3 miles in a Southerly direction from the Dupre Postoffice, and about 1 1/2 feet in a Northerly direction from International Monument Number 113

The surface boundaries of the claim are marked upon the ground as follows: Beginning at

at a point in a Southerly direction 700 feet from the discovery shaft (at which this notice is posted), being in the center of the South end line of said claim; thence 300 feet to a Monument, being the Southwest corner of said claim; thence 1500 feet to a Monument, being at the Northwest corner of said claim; thence 300 feet to a Monument at the center of the North end of said claim; thence 300 feet to a Monument, being at the Northwest corner of said claim; thence 1500 feet to a Monument at the Southeast corner of said claim; thence 300 feet to the place of beginning.

All done under the provisions of Chapter Six, of Title XXXII, of the Revised Statutes of the United States, and of an Act of the General Assembly of Arizona, entitled "An Act to Revise and Codify the Laws of the Territory of Arizona," approved March 16, 1901.

Dated and posted on the ground this 17<sup>th</sup> day of December 1907

Witness  
Ignacio Apulo  
Stephen Bennis  
to signatur

John Bennis  
Locator



# An Act to Codify and Revise the Laws of the Territory of Arizona

## SECTIONS I-II.—INC. LOCATION OF CLAIMS

Be it enacted by the Legislative Assembly of the Territory of Arizona:

SECTION 1. On the discovery of mineral in places on the public domain of the United States, the same may be located as a mineral claim by the discoverer for himself, for himself and others, or for others.

SECTION 2. Such location shall be made by erecting at or contiguous to the point of discovery, a conspicuous monument of stones not less than three (3) feet in height, or an upright post securely fixed, projecting at least four (4) feet above the ground, in which monument of stones or on which post, there shall be posted a location notice, which shall be signed by the name or names of the locator or locators. The location notice must contain: First, the name of the claim located; second, the name or names of the locators; third, the date of the location; fourth, the length and width of the claim in feet and the distance in feet from the point of discovery to each end of the claim; fifth, the general course of the claim; sixth, the locality of the claim with reference to some natural object or permanent monument whereby the claim can be identified.

SECTION 3. Until each and all of the above specified things shall have been done no right thereto shall be acquired.  
SECTION 4. From the time of the location of a mining claim as above specified, the locator shall be allowed ninety (90) days within which to do or cause to be done, the following things: First, to cause to be recorded in the office of the County Recorder of the county in which the claim is situated, a copy of the location notice; second, to sink a discovery shaft in the claim to the depth of at least ten (10) feet from the lowest part of the rim of the shaft at the surface, and deeper if necessary until there is discovered in said shaft mineral in place; third, to monument the claim on the ground so that its boundaries can be readily traced.

SECTION 5. The failure to do all the things enumerated in this section in the time and space specified shall be construed into an abandoning of the claim, and all right thereto of the discoverer and locator shall be forfeited.

SECTION 6. Such surface boundaries shall be marked by six (6) substantial posts projecting at least four (4) feet above the surface of the ground, or by substantial stone monuments at least three (3) feet high, to-wit: One at each corner of said claim, and one at the center of each end line thereof.

SECTION 7. Any open-cut, adit or tunnel which shall be made as above provided for as a part of the location of a lode mineral claim, and which shall be equal in amount of work to a shaft ten (10) feet deep and four (4) feet wide by six (6) feet long, and which shall cut the lode or mineral in place at a depth of ten (10) feet from the surface, shall be equivalent as a discovery work to a shaft sunk from the surface.

SECTION 8. Location notice may be amended at any time, and the monument changed to correspond with the amended location; provided, that no change shall be made that will interfere with the rights of others.

SECTION 9. The amount of assessment or representation work or improvements to be done or made during each year, after the completion of the location as heretofore provided, and the time for doing the same shall be as provided by the laws of the United States.

SECTION 10. Within three (3) months after the expiration of the period of the time fixed for the performance of annual labor, or the making of such improvements upon any mining claim, the person on whose behalf such work or improvement was made, or some person for him knowing the facts, may make a record in the office of the County Recorder of the county wherein such claim is situated, an affidavit in substance as follows:

TERRITORY OF ARIZONA,

ss.

..... being duly sworn deposes and says that he is a citizen of the United States and more than twenty-one years of age, resides at..... in..... County, Arizona, Territory, and is personally acquainted with the mining claim known as..... Mining District, Arizona, Territory, the location notice of which is recorded in the office of the County Recorder of said County, in book..... of Records of Mines, at page.....

That between the..... day of..... A. D..... and the..... day of..... A. D..... at least..... dollars worth of work and improvements were done and performed upon said claim, not including the location work of said claim. Such work and improvements were made by and at the expense of..... owners of said claim, for the purpose of complying with the laws of the United States, pertaining to assessments of annual work, and (here name the owners of men who worked upon the claim in doing the work) were the men employed by said owner, and who labored upon said claim, did said work and improvements, the same being as follows, to-wit: (Here describe the work done).

(Signature)

Subscribed and sworn to before me, this..... day of..... A. D.....

My commission as Notary Public expires on the..... day of..... A. D.....

(Notary Seal)

..... Notary Public.

SECTION 11. Such affidavit, when so recorded, shall be prima facie evidence of the performance of such labor or the making of such improvements, and said original affidavit, after it has been recorded, or a certified copy of record of same, or the record of same, shall be received as evidence accordingly by the courts of the Territory. The relocation of forfeited or abandoned lode claims shall only be made by sinking a new discovery shaft and fixing the boundary in the same manner and to the same extent as is required in making an original location; or the relocater may sink the original discovery shaft ten (10) feet deeper than it was at the commencement of such location, and shall erect new, or make the old monuments the same as originally required. In either case a new location monument shall be erected, and the location notice shall state if the whole or any part of the new location is located as abandoned property, else it shall be void.

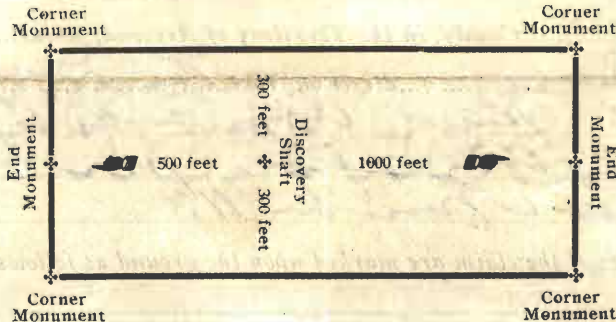

The above diagram is to give the locator a general idea of the plan of location under new law. Your discovery shaft may be in the center of claim, or any distance from either end you desire. In the diagram we have placed it 500 feet from one end and 1000 feet from the other. In description, be careful to state locality of claim with reference to some natural object, or permanent monument, so as to identify the claim.

TERRITORY OF ARIZONA,

ss.

County of.....

..... County Recorder in and for the County and Territory aforesaid; do hereby certify that the within instrument was filed for record at..... o'clock..... M. on this..... day of..... 190..., and duly recorded in Book No. .... of..... Records of..... County, Arizona, at pages.....

WITNESS my hand and official seal the day and year first above written.

..... County Recorder.

**Notice of Location.**  
LODE CLAIM

Dated..... 190...

Filed and Recorded at request of.....

at..... A. D. 190...

Book.....

Pages.....

By..... Deputy Recorder.

..... County Recorder.

1897



U. S. SURVEYOR-GENERAL'S FINAL CERTIFICATE ON FIELD NOTES.

Department of the Interior,

OFFICE OF U. S. SURVEYOR-GENERAL,

Phoenix, Arizona,

April 25, 1911.

I, U. S. Surveyor-General for Arizona,

do hereby certify that the foregoing transcript of the Field Notes, return and approval of the survey of the mining claim of

Mrs. Elizabeth A. O'Connor,

known as the LINE BOY,

situate in Patagonia

Mining District, Santa Cruz County, Arizona,

in Section , Township No. 24 S., Range No. 16 E., unsurveyed, and

designated as Survey No. 2894, has been correctly copied from the originals on file in

this office; that said Field Notes furnish such an accurate description of said mining claim as will, if incorporated into a patent, serve fully to identify the premises, and that such reference is made therein to natural objects or permanent monuments as will perpetuate and fix the locus thereof.

And I further certify that five hundred dollars' worth of labor has been expended or improvements made upon said mining claim by claimant or her grantors, and that said improvements consist of 4 shafts, 2 cuts, 2 winzes, 1 stope, 1 drift and 1 tunnel, total value \$2920.00

and that no portion of said labor or improvements has been included in the estimate of expenditures upon any other claim.

I further certify that the plat thereof, filed in the U. S. Land Office at Phoenix, Arizona,

is correct and in conformity with the foregoing Field Notes.

Frank S. Ingalls,

United States Surveyor-General for Arizona,



4-687.

SURVEYOR-GENERAL'S CERTIFICATE OF APPROVAL OF FIELD  
NOTES AND SURVEY OF MINING CLAIM.

**Department of the Interior,**

Office of U. S. Surveyor-General,

Phoenix, Arizona,

April 25, 1911., 190

I, U. S. Surveyor-General for Arizona,

do hereby certify that the foregoing and hereto attached Field Notes and Return of the Survey of the  
Mining Claim of

Mrs. Elizabeth A. O'Connor,

, known as the

LINE BOY,

situate in Patagonia Mining District,

Santa Cruz County, Arizona,

in Section , Township No. 24 S., Range No. 16 E., unsur-  
veyed, designated as Survey No. 2894,

executed by John A. Rockfellow, U. S. Deputy Mineral

Surveyor, March 11 - 13, 1911., ~~190~~, under my instructions dated

February 17, 1911., ~~190~~, have been critically examined and the necessary cor-

rections and explanations made, and the said Field Notes and Return, and the Survey they describe,

are hereby approved. A true copy of the copy of the location certificate filed by the applicant for

survey is included in the field notes.



U. S. Surveyor-General for Arizona,