

JUL 5- 1912

4-683.

MINERAL SURVEY No. 3004

LOT No.

Arizona Land District.

FIELD NOTES

OF THE SURVEY OF THE MINING CLAIM OF

The Tucson Consolidated Copper Co.

KNOWN AS THE

Black Dyke No. 14, Black Dyke No. 15, Black Dyke No. 18, Black Dyke No. 19, Black Dyke No. 20.

Papago Mining District,

Pima County, Arizona

Sections 23, 24, 25, 26, Township 17 South, Range 10 East.

Surveyed under instructions dated June 10th., 1912.

by Paul E. Fernald

U. S. Mineral Surveyor.

Claim located (see location notices) , 19

Survey commenced June 15th., 1912,

Survey completed June 24th., 1912.

6-821

Address of Claimant:- F.J. Rodee, Secy. Tucson, Arizona.

FIELD NOTES - SURVEY NO. 3004

BLACK DYKE NO. 15 LOBE:

Beginning at Cor.No.1,

Identical with Cor.No.1, Black Dyke No.14 Lode, this survey,

" " the N.W.Cor. " " No.3 Lode, unsurveyed,

" " the S.W.Cor. " " No.2 Lode, " " ,

A pine post, 5½ ft.long, 4 in sq., set 1½ ft.in ground, with mound of stones, scribed 3004, 1-B.D.-15, 3004, 1-B.D.-14,

Whence:- the W ¼ Cor.of Sec.24, T 17 S, R 10 E, G.& S.R.M. bears S 43°35'W, 141.63 ft.

Wildcat Mt. bears N 55°10'W.

thence S 74°29'W,

101.83 Intersects the W.boundary of Sec.24, T 17 S, R 10 E, G.& S.R.M. N 0° 22'W, 75.35 ft.from the W ¼ Cor., and S 0°22'E, 2582.56 ft. from the N.W.Cor.

300.00 To the S.End Center; monument of stones with stake in center.

600.00 To Cor.No.2,

Identical with Cor.No.2, Black Dyke No.14 Lode, this survey;

" " " " 1, " " No.19 " " " ,

" " " " 1, " " No.18 " " " ,

A pine post, 5½ ft.long, 4 in.sq., set 1½ ft.in ground, with mound of stones, scribed 3004, 2-B.D.-15, 3004, 2-B.D.-14, 3004, 1-B.D.-19, 3004, 1-B.D.-18,

Whence:- BaboQuivari Peak bears S 58°14'W.

Thence N 15°41'W

552.00 Intersects road running N.& S.

1422.00 Intersects gulch running W.

1500.00 To Cor.No.3,

Identical with Cor.No.4, Black Dyke No.18 Lode, this survey.

" " the S.E.Cor. " " No.17 Lode, unsurveyed,

" " " S.W.Cor. " " NO.16 Lode, " " ,

A pine post, 5½ ft.long, 4 in.sq., set 1½ ft.in ground, with mound of stones, scribed 3004, 3-B.D.-15, 3004, 4-B.D.-18,

Whence:- BaboQuivari Peak bears S 57°31'W.

Thence N 74°29'E,

300.00 To N.End Center, - monument of stone with stake in center.
 348.00 Intersects gulch running S.W.
 424.00 Intersects road running South.
 579.00 Intersects gulch running W.
 600.00 To Cor.No.4,
 Identical with the S.E.Cor.of Black Dyke No.16 Lode, unsurveyed.
 " " " S.W.Cor." " " No.1 Lode, "
 " " " N.W.Cor." " " No.2 Lode "

A pine post, 5½ ft. long, 4 in sq., set 1½ ft. in ground, with mound of stones, scribed 3004, 4-B.D.15,
 Whence:- The N.W.Cor.of Sec.24, T 17 S, R 10 E, G. & S.R.M. bears N 14°39'E, 1148.50 ft.

Thence S 15°41'E

20.00 Intersects gulch running W.
 1127.89 Intersects the W. boundary of Sec.24, T 17 S, R 10 E, G. & S.R.M. N 0°22'W, 460.86 ft. from the W ¼ Cor, and S 0°22'E, 2197.05 ft. from the N.W. Cor.
 1500.00 To Cor.No.1, the place of beginning

BLACK DYKE NO.18 LODE.

Beginning at Cor.No.1,
 Identical with Cor.No.2, Black Dyke No.15 Lode, this survey previously described:
 Whence:- the W ¼ Cor.of Sec.24, T 17 S, R 10 E, G. & S.R.M., bears N 83°8'E, 483.96 ft.

Thence S 74°29'W

121.50 Intersects road running S.
 300.00 To S.End Center - monument of stone with stake in center.
 490.00 Intersects gulch running W: to N.
 600.00 To Cor.No.2,
 Identical with Cor.No.2, Black Dyke No.19 Lode, this survey.
 " " the N.E.Cor.Black Dyke No.30 Lode, unsurveyed.
 " " " S.E. " " " No.31 Lode, "

SURVEY NO. 3004, - continued.

BLACK DYKE NO. 18 LODE, -Continued.

A pine post, 5½ ft. long, 4 in. sq., set 1½ ft. in ground, with mound of stones, scribed 3004, 2-B.D.-18.
3004, 2-B.D.-19.

Whence:- Wildcat Mt, bears N 54°26'W.

Thence N 15°41'W.

- 184.00 Intersects gulch running W.
- 1500.00 To Cor.No.3,
- Identical with the N.E.Cor.BlackDyke No.3I Lode, unsurveyed.
- " " " S.E.Cor. " " No.33 " "
- " " " S.W.Cor. " " No.17 " "

A pine post, 5½ ft. long, 4 in. sq., set 1½ ft. in ground, with mound of stones, scribed 3004, 3-B.D.18.

No bearing object available.

Thence N 74°29'E.

- 207.00 Intersects gulch running W.
- 300.00 To N.End Center - monument of stones with post in center.
- 600.00 To Cor.No.4,
- Identical with Cor.No.3, Black Dyke No.15 Lode, this survey, previously described.
- Thence S 15°41'E
- 78.00 Intersects gulch running W.
- 948.00 Intersects road running S.
- 1500.00 To Cor.No.1, the place of beginning.

BLACK DYKE NO. 14 LODE.

Beginning at Cor.No.1,
Identical with Cor.No.1, Black Dyke No.15 Lode, this survey, previously described.,

Whence:- The W¼ Cor:of Sec.24, T 17 S, R 10 E, G.& S.R.M., bears S 43°35'W, 141.63 ft.

Thence S 74°29'W

- 101.83 Intersects the W.side of Sec.24, T 17 S, R 10 E, G.& S.R.M., S 0°22'E, 2582.56 ft.from the N.W.Cor, and N 0°22'W, 75.35 ft. from the W ¼ Cor.

300.00 To N.End Center, monument of stone with post in center.

600.00 To Cor.No.2,
 Identical with Cor.No.2, Black Dyke No.15 Lode, this survey,
 previously described:

495.00 Intersects gulch running W.

1397.00 Intersects road running W.

1500.00 To Cor No.3,
 Identical with Cor.No.4, Black Dyke No.19 Lode, this survey,
 " " " No.4, " " No.20 " , " " ,
 " " the N.W.Cor. Black Dyke No.13 Lode, unsurveyed.

A pine post, 5½ ft.long, 4 in.sq., set 1½ ft.in ground, with
 mound of stones, scribed 3004, 3-B.D.14.
 3004, 4-B.D.19.
 3004, 4-B.D.20.

Whence:- a porphery rock, scribed B.R.3004, bears N 29°44'W,
 53.78 ft.

Wild Cat Mt. bears N 54°11'W.
 Baboquivari Peak bears S 58°54'W.

73.06 Intersects the W boundary of Sec.24, T 17 S, R 10 E, G.& S.R.M
 N 0°20'E, 1159.97 ft.from the S.W.Cor., and S 0°20'W, 1483.59
 ft.from the W.¼ Cor..

171.50 Intersects road running W.

300.00 To S.End Center, monument of stones with post in center.

600.00 To Cor.No.4,
 Identical with the N.E.Cor.of Black Dyke No.13 Lode, unsurveyed
 " " " N.W.Cor.of " " No.4 Lode, "
 " " " S.W.Cor.of " " No.3 lode, "

A pine post, 5½ ft.long, 4 in.sq., set 1½ ft.in ground, with
 mound of stones, scribed 3004, 4-B.D.-14.

Whence Wildcat Mt.bears N 54°31'W.

507.50 Intersects gulch running N.W.

N
 Thence, 15°32'W

SURVEY NO. 3004, Continued.

BLACK DYKE NO. 14 LODE, Continued.

1500.00 To Cor.No.I, the place of beginning.

BLACK DYKE NO. 19 LODE,

Beginning at Cor.No.I,

Identical with Cor.No.2, Black Dyke No.15 Lode, this survey,
previously described.

Whence:- the W. $\frac{1}{4}$ Cor.of Sec.24, T 17 S, R 10 E, G.& S.R.M.,
bears N 83°8'E, 483.96 ft..

Thence S 74°29'W

121.50 Intersects road running S.

300.00 To the N.End Center - monument of stones with post in center.

490.00 Intersects gulch bending from W.to N.

600.00 To Cor.No.2,

Identical with Cor.No.2, Black Dyke No.18 Lode, this survey,
previously described.

Thence S 15°32'E

1488.00 Intersects road running W.- S.W.

1500.00 To Cor.No.3,

Identical with Cor.No.3, Black Dyke No.20 Lode, this survey.

" " the N.E.Cor. Black Dyke No.29 Lode, unsurveyed.

" " " S.E. " " " No.30 Lode, "

A pine post, 5 $\frac{1}{2}$ ft.long, 4 in.sq., set 1 $\frac{1}{2}$ ft.in ground, with
mound of stones, scribed 3004, 3-B.D.-19.
3004, 3-B.D.20.

Whence:-Wildcat Mt.bears N 53°50 $\frac{1}{2}$ 'W,

BaboQuivari Peak bears S 58°48'W.

Thence N 74°29'E

300.00 To S.End Center - monument of stones with post in center.

600.00 To Cor.No.4,

Identical with Cor.No.3, Black Dyke No.14 Lode, this survey,
previously described.

Thence N 15°32'W

103.00 Intersects road running W.

1005.00 Intersects gulch running W.

1500.00 To Cor.No.I, the place of beginning.

BLACK DYKE NO. 20 ~~LODE~~

Beginning at Cor.No.1,

Identical with the N.E.Cor., Black Dyke No.21 Lode, unsurveyed

" " " N.W.Cor., " " No.12 Lode, "

" " " S.W.Cor., " " No.13 Lode, "

A pine post, 5½ ft.long, 4 in.sq., set 1½ ft.in ground, with mound of stones, scribed 3004, 1-B.D.-20.

Whence:- the N.W.Cor.of Sec.25, T 17 S, R 10 E, G & S.R.M., bears N 48°28'W, 457.77 ft.

the S ¼ Cor.of Sec.24, T 17 S, R 10 E, G.& S.R.M., bears N 82°34'E, 2323.38 ft.

Wildcat Mt. bears N 53°31'W.

Thence S 74°29'W

- 246.00 Intersects gulch running N.W.
- 300.00 To S.End Center - monument of stones with post in center.
- 359.38 Intersects the W.boundary of Sec.25, T 17 S, R 10 E, G.& S.R.M., S 0°31'W, 399.68 ft.from the N.W.Cor, and N 0°31'E, 2272.76 ft.from the W ¼ Cor.
- 600.00 To Cor.No.2

Identical with the N.W.Cor.of Black Dyke No.21 Lode, unsurvey

" " " N.E.Cor." " " No.28 " "

" " " S.E.Cor." " " No.29 " "

A pine post, 5½ ft.long, 4 in.sq., set 1½ ft.in ground, with mound of stones, scribed 3004, 2-B.D.-20.

Whence:-the W ¼ Cor.of Sec.25, T 17 S, R 10 E, G.& S.R.M., bears S 5°28½'E, 2218.41 ft.

Cor.No.3, King David Lode, Survey No.2890, bears S 36°53'W, 2718.72 ft.

the S.¼ Cor.of Sec.23, T 17 S, R 10 E, G.& S.R.M., bears N 79°21'W, 2447.50 ft.

Wildcat Mt.bears N 53°11'W.

Thence N 15°43'W

- 480.41 Intersects the S.boundary of Sec.23, T 17 S, R 10 E, G.& S.R.M S 89°45'W, 365.56 ft.from the S.E.Cor., and N 89°45'E,, 2275.28 ft.from the S ¼ Cor.

SURVEY NO. 3004, Continued.

BLACK DYKE NO. 20 LODE, Continued.

- 560.00 Intersects gulch running N.W.
 1289.00 Intersects gulch running W.
 1500.00 To Cor.No.3,
 Identical with Cor.No.3, Black Dyke No.19 Lode, this survey,
 previously described.
-
- Thence N 74°29'E
 300.00 To N.End Center - monument of stone with post in center.
 600.00 To Cor.No.4,
 Identical with Cor.No.3, Black Dyke No.14 Lode, this survey,
 previously described.
-
- Thence S 15°43'E
 254.21 Intersects the W.boundary of Sec.24, T 17 S, R 10 E, G. & S.
 R.M., N 0°20'E, 895.71 ft. from the S.W.Cor., and S 0°20'W,
 1747.85 ft. from the W. $\frac{1}{4}$ Cor.
 290.00 Intersects gulch running W.
 1185.00 Intersects the S.boundary of Sec.24, T 17 S, R 10 E, G. & S.
 R.M., S 89°56'E, 257.34 ft. from the S.W.Cor., and N 89°56'W,
 2389.19 ft. from the S. $\frac{1}{4}$ Cor.
 1500.00 To Cor.No.1, the place of beginning.

Magnetic Variation at all Corners - - 13°40' E.

All corners identical with corners of location.

LODE LINES.

As near as can be determined from present developments,
 the veins of the several locations embraced in this survey
 extend as follows from their respective discovery points:-
 Black Dyke No.15, N 15°41'W - 315.ft., and S 15°41'E - 1185.ft.
 " " No.18, N 15°41'W - 500.ft., and S 15°41'E - 1000.ft.
 " " No.14, N 15°32'W - 500.ft., and S 15°32'E - 1000.ft.
 " " No.19, N 15°32'W - 707.ft., and S 15°32'E - 793.ft.
 " " No.20, N 15°43'W - 500.ft., and S 15°43'E - 1000.ft.

AREAS.

Black Dyke No.15 Lode - - - - - 20.661 Acres. ✓
 " " No.18 " - - - - - 20.661 " ✓
 " " No.14 " - - - - - 20.661 " ✓
 " " No.19 " - - - - - 20.661 " ✓
 " " No.20 " - - - - - 20.661 " ✓

LOCATION. This Survey is located in Sections 23, 24, 25, and 26, in T 17 S, R 10 E, G. & S.R.M., in the Papago Mining District, Pima County, Arizona.

ADJOINING CLAIMS.

On the North - Black Dyke No.1, Black Dyke No.16, Black Dyke No.17, and Black Dyke No.32 Lodes, unsurveyed, owned by claimants of this survey.

On the East - Black Dyke No.2, Black Dyke No.3, Black Dyke No.4, and Black Dyke No.13 Lodes, unsurveyed, owned by claimants of this survey.

On the South - Black Dyke No.12, Black Dyke No.21, and Black Dyke No.28 Lodes, unsurveyed, owned by claimants of this survey.

On the West - Black Dyke No.29, Black Dyke No.30, and Black Dyke No.31 Lodes, unsurveyed, owned by claimants of this survey.

IMPROVEMENTS.

I certify that the value of labor and improvements made upon, or for the benefit of, each of the locations embraced in this survey, by the claimant or its grantors, is not less than five hundred dollars, and that said improvements consist of:-

Black Dyke No.15 Lode.

No.1, The Discovery shaft, on the center line, is 315 ft. from the N. End Center. Is 5x7, 8 ft. deep.

Value - - - - - \$40.00

No.2, A cut, the center of face of which bears N 66°12'E,

SURVEY NO. 3004, Continued.

Improvements: Continued.

Black Dyke No. 15 Lode, Continued.

272.00 ft. from point 723.30 - line 2-3, is 5x19 in North, to 10 ft. face, whence Tunnel 4x6 runs in North 28 ft.

Value - - - - - \$237.00

$\frac{1}{4}$ interest in shaft No. 3, Black Dyke No. 18 Lode, this survey, herein after described. - - - - - \$545.00

Black Dyke No. 18 Lode.

No. 1, The Discovery point, on center line 500 ft. from the N End Center, No. 2, cut bears N 7°35'E, from dis. pt. 103 ft. - cut 6x19 to 10 ft. face, in E.

Value - - - - - \$50.00

No. 3, A shaft, the center of which bears N 35°8'W, 467.32 ft. from Cor. No. 1, is 7x8 - 36 $\frac{1}{2}$ ft. deep., Value \$2180.00

Note:- This shaft, being situated at a low point, is a practical and feasible working shaft for the development of the surrounding claims, such that by drifting and crosscutting therefrom, the Black Dyke No. 15, Black Dyke No. 14, and Black Dyke No. 19 Lodes, this survey, may be developed and ore extracted therefrom, as well as Black Dyke No. 18, where shaft is located. A $\frac{1}{4}$ interest is therefore apportioned to each of the above mentioned claims. No interest is allowed Black Dyke No. 20 Lode, as that can better be developed by Shaft No. 5, Black Dyke No. 19 Lode, hereinafter described.

$\frac{1}{4}$ interest assigned to this claim - - - - - \$545.00

No. 4, A hole, N.E. Cor. of which bears N 78°48'W, 342.10 ft. from Cor. No. 1, is 12x3 $\frac{1}{2}$ - 6 ft. deep.

Value - - - - - \$30.00

Black Dyke No. 14 Lode.

No. 1, The Discovery point, on center line, 500 ft. from N. End Center, No. 2, Cut bears N 38°12'W, 50.00 ft. from dis. pt., Cut is 5x16 to 10 ft. face, in N.E.

Value - - - - - \$40.00

1/4 interest in shaft No.3, Black Dyke No.18 Lode, heretofore described, - - - - -

Value - - - - - \$545.00

1/3 interest in Shaft No.5, Black Dyke No.19 Lode, hereinafter described.

Value - - - - - \$1022.00

Black Dyke No.19 Lode.

No.1, Discovery Shaft, on center line, 707.ft.from N. End Center, is 5x6, 8 ft.deep.

Value - - - - - \$50.00

No.2, A cut, center of face of which bears S 8°50'W, 252.ft. from the N.End Center, is 14x4 1/2 to 8 1/2 ft.face, in South.

Value - - - - - \$50.00

No.3, A shaft, center of which is S 8°22'E, 466.ft. from Cor.No.1, is 6x8, 21 1/2 ft.deep.

Value - - - - - \$450.00

No.4, A trench, center of which is N 6°8'E, 538.ft. from Cor.No.3, is 7x10, 4 ft.deep.

Value - - - - - \$20.00

No.5, A shaft, the center of which bears S 82°15'W, 103.ft. from the S.End Center, is 6x8, 132.ft.deep, with drift 4x6, 20.ft.long from bottom, running S.E.Value \$3066.00

Note; This shaft, being located in a low place, is a practical and feasible working shaft for the development of the Black Dyke No.14, Black Dyke No.19, and Black Dyke No.20 lodes, as by drifting and cross-cutting therefrom, ore can be conveniently extracted from the ground covered by each of the above. A 1/3 interest in this improvement is therefore accredited to each of those claims, No interest in this shaft is accredited to Black Dyke No.15 and Black Dyke No.18 Lodes, as they can be developed more advantageously from Shaft No.3, Black Dyke No.18 Lode, heretofore described.

Value assigned to this claim - - - - - \$1022.00

SURVEY NO. 3004, Continued.

IMPROVEMENTS, continued.

Black Dyke No. 19 Lode, continued,

No. 6. A shaft, center of which bears N 18°52'E, 205.ft. from Cor.No.3, is 4x6, 8 ft.deep.

Value - - - - - \$40.00

A 1/4 interest in shaft No.3, Black Dyke No.18 Lode, heretofore described.

Value - - - - - \$545.00

Black Dyke No. 20 Lode.

No.1, The discovery shaft, on center line, 500.ft. from the N.End Center, is 4x6, 8 ft.deep.

Value - - - - - \$40.00

No.2, A trench, center of face of which bears S 20°34'W, 560.ft. from Cor.No.4, is 6x22, 4 ft.deep.

Value - - - - - \$35.00

A 1/3 interest in Shaft No.5, Black Dyke No.19 Lode, heretofore described, Value - - - - - \$1022.00.

INSTRUMENT.

This survey was made with a Buff & Buff No.2 Transit. The courses were deflected from the true meridian as determined by direct solar observations. Distances were measured with a 300.ft. steel tape.

REPORT.

The side and end lines of all claims in this survey were run directly upon the ground, and all tie lines were either run direct, or by traverse, a separate report of same accompanying these notes.

The N.W. Cor. of Sec. 24, T 17 S, R 10 E, G. & S.R.M., is a granite stone, 1x3/4 ft. 1 ft. above ground, scribed 1 on E. and 3 on S. side, with mound of stones 4 ft. W.

The W 1/4 Cor. of Sec. 24, T 17 S, R 10 E, G. & S.R.M., is a flat porphyry stone, 3 in. above ground, scribed 1/4 on W. side. No mound of stone near.

The S.W. Cor. of Sec. 24, T 17 S, R 10 E, G. & S.R.M., is

a granite stone, 1x1 ft. 1 $\frac{1}{2}$ ft. above ground, scribed 1 on E. and 2 on S. sides, with mound of stones 4 ft. W.

The S. $\frac{1}{4}$ Cor. of Sec. 24, T 17 S, R 10 E, G. & S. R. M., is a granite stone, 1x $\frac{3}{4}$ ft. 11 in. above ground, scribed $\frac{1}{4}$ on N side. No mound of stones near.

The W $\frac{1}{4}$ Cor. of Sec. 25, T 17 S, R 10 E, G. & S. R. M., is a porphyry stone, 10x7 in. 8 in. above ground, marked $\frac{1}{4}$ on W side, with mound of stones 3 ft. west.

The S. $\frac{1}{4}$ Cor. of Sec. 23, T 17 S, R 10 E, G. & S. R. M., is a quartzite rock, 10x12 in., 8 in. above ground. Mark indistinct from weathering, and no mound of stones near.

Cor. No. 3, King David Lode, Survey No. 2890. is a 4x4 post scribed 2890, 3-KING DAVID. surrounded by large mound of stones.

All corners of Black Dyke Nos. 1, 2, 3, 4, 13, 12, 21, 28, 29, 30, 31, 32, 17 and 16 Lodes, unsurveyed, Tucson Consolidated Copper Co., claimant, are posts set in mounds of stone, painted white and marked with claim and corner numbers.

Note. I find inconsistencies with respect to positions of discovery holes, between the claims as marked upon the ground, and the location notices, on Black Dyke No. 14, 15, 18, and 19 Lodes, all due to errors in the location notices, as the claims were very clearly marked upon the ground. The data contained in these notes is accurate, and designed to correct said errors in the location notices. On Black Dyke No. 18 and Black Dyke No. 14 Lodes, the Discovery Points mark the center of mineral deposit, the evidence at said points proves conclusively that the formation exists as indicated in my ledge statement; the ore deposit is considered to be of the type of a general mineralization of the country rock rather than a small vein, and holes were dug where physical conditions of the ground were most advantageous.

Paul E. Fernald.
U.S. Mineral Surveyor.

Tucson, Arizona, July 2nd. 1912.

FINAL OATHS FOR SURVEYS.

LIST OF NAMES.

A list of the names of the individuals employed by Paul E. Fernald,
 United States Deputy Mineral Surveyor, to assist in running, measuring, and marking the lines, corners, and
 boundaries described in the foregoing field notes of the survey of the mining claim of The Tucson
Consolidated Copper Co.
 known as the Black Dyke No. 14, Black Dyke No. 15, Black Dyke No. 18, Black
Dyke No. 19, Black Dyke No. 20.
 and showing the respective capacities in which they acted.

Edward Lafave, , *Chainman.*
 , *Chainman.*
 , *Arman.*
 , *Flagman.*

FINAL OATHS OF ASSISTANTS.

We, I - Edward Lafave
 and , do solemnly swear that *we* assisted Paul E. Fernald
 , United States Deputy Mineral Surveyor, in marking the corners and surveying
 the boundaries of the mining claim of The Tucson Consolidated Copper Co.
 known as the Black Dyke No. 14, Black Dyke No. 15, Black Dyke No. 18, Black
Dyke No. 19, Black Dyke No. 20.
 represented in the foregoing field notes as having been surveyed by said deputy mineral surveyor and under his
 direction; and that said survey has been in all respects, to the best of ~~my~~ knowledge and belief, faithfully and
 correctly executed, and the corner and boundary monuments established according to law and the instructions
 furnished by the United States Surveyor-General for Arizona

Edward Lafave , *Chainman.*
 , *Chainman.*
 , *Arman.*
 , *Flagman.*

Subscribed and sworn to by the above-named persons before me this 29th.

day of June, , 1912.

my com. exp. Apr. 19-1916

J. W. Curcell

Notary Public

FINAL OATH OF U. S. DEPUTY MINERAL SURVEYOR

I, Paul E. Fernald, U. S. Deputy Mineral Surveyor, do solemnly swear that, in pursuance of instructions received from the United States Surveyor General for Arizona, dated June 10th, 1912, I have, in strict conformity to the laws of the United States, the official regulations and instructions thereunder, and the instructions of said Surveyor General, faithfully and correctly executed the survey of the Mining Claim of The Tucson Consolidated Copper Co., known as the Black Dyke No. 14, Black Dyke No. 15, Black Dyke No. 18, Black Dyke No. 19, Black Dyke No. 20, situate in Papago Mining District, Pima County, Arizona, in Sections 23, 24, 25, 26, Township No. 17 S., Range No. 10 E., and designated as Survey No. 3004, as represented in the foregoing field notes, which accurately show the boundaries of said mining claim as distinctly marked by monuments on the ground, and described in the attached copy of the location certificate, which was received by me from the Surveyor General with said instructions, and that all the corners of said survey have been established and perpetuated in strict accordance with the law, official regulations and instructions thereunder; and I do further solemnly swear that the foregoing are the true and original field notes of said survey and my report therein, and that the labor expended and improvements made upon said mining claim by claimant or its grantors are as therein fully stated, and that the character, extent, location and itemized value thereof are specified therein with particularity and full detail, and that no portion of said labor or improvements so credited to this claim has been included in the estimate of expenditures upon any other claim.

Paul E. Fernald.
U. S. Deputy Mineral Surveyor.

Subscribed and sworn to by the said Paul E. Fernald
U. S. Deputy Mineral Surveyor, before me
this 29th.

day of June, 1912
My Com Exp. Apr. 19-1906

Notary Public

Notice of Mining Location.

LODE CLAIM

TO ALL WHOM IT MAY CONCERN:

This Mining Claim, the name of which is the Black Dyke No. 14 Mining Claim, situate on lands belonging to the United States of America, and in which there are valuable mineral deposits, was entered upon and located for the purposes of exploration and purchase by Fred. W. Fickett, a citizen of the United States

(Locator must insert either "a citizen of the United States" or "who has declared his intention to become a citizen of the United States."

the undersigned, on the 1st day of May 1907.

The length of this claim is 1500 feet, and 1 claim 1000 feet in a Southerly direction and 500 feet in a Northerly direction from

the center of the discovery shaft, at which this notice is posted, lengthwise of the claim, together with 300 feet in width of the surface grounds, on each side of the center of said claim. The general course of the lode deposit and premises is from the North to the South.

The claim is situated and located in the Papago Mining District, in Pima County, in Arizona, about 28 miles in a southwesterly direction from the city of Tucson, Arizona.

The surface boundaries of the claim are marked upon the ground as follows: Beginning at—
a monument

at a point in a northerly direction 500 feet from the discovery shaft (at which this notice is posted) being in the center of the north end line of said claim; thence east 300 feet to a stake for monument being the north easterly corner of said claim; thence southerly 1500 feet to a stake for monument being at the south easterly corner of said claim; thence westerly 300 feet to a stake for monument at the center of the south end of said claim thence westerly 300 feet to a stake for monument being at the south westerly corner of said claim; thence northerly 1500 feet to a stake at the north westerly corner of said claim; thence 300 feet to the place of beginning.

All done under the provisions of Chapter Six; of Title XXXII, of the Revised Statutes of the United States, and of an Act of the General Assembly of Arizona, entitled "An Act to Revise and Codify the Laws of the Territory of Arizona," approved March 16, 1901.

Dated and posted on the ground this 1st day of May 1907.

Fred W. Fickett

STATE OF ARIZONA, }
COUNTY OF PIMA. } ss.

I, P. E. Howell County Recorder in and for the
County of Pima, do hereby certify that the above and foregoing is a full, true and correct copy Of
Location of Mining Claim BLACK DYKE NO. 14

.....
.....
as appears of record now in my office in Book M. & C. Rec. of Mines Pages 252

IN WITNESS WHEREOF, I have hereunto set my
hand and affixed my official seal, at my office
in Tucson, this 25th day of
June A. D. 1912

P. E. Howell
County Recorder of Pima County,
Arizona.

Notice of Mining Location.

LODE CLAIM

TO ALL WHOM IT MAY CONCERN:

This Mining Claim, the name of which is the **Black Dyke No. 15** Mining Claim, situate on lands belonging to the United States of America, and in which there are valuable mineral deposits, was entered upon and located for the purposes of exploration and purchase by **Fred W. Fickett, a citizen of the United States.**

(Locator must insert either "a citizen of the United States" or "who has declared his intention to become a citizen of the United States.")

the undersigned, on the **1st** day of **May** 19**07**

The length of this claim is **1500** feet, and **1** claim **1000** feet in a **Southerly** direction and **500** feet in a **Northerly** direction from the center of the discovery shaft, at which this notice is posted, lengthwise of the claim, together with **300** feet in width of the surface grounds, on each side of the center of said claim. The general course of the lode deposit and premises is from the **North** to the **South**.

The claim is situated and located in the **Papago** Mining District, in **Pima** County, in Arizona, about **28** miles in a **southwesterly** direction from **the city of Tucson, Arizona.**

The surface boundaries of the claim are marked upon the ground as follows: Beginning at—
a monument
at a point in a **northerly** direction **500** feet from the discovery shaft (at which this notice is posted) being in the center of the **north** end line of said claim; thence **east** **300** feet to a **stake for monument** being the **north easterly** corner of said claim; thence **southerly** **1500** feet to a **stake for monument** being at the **south easterly** corner of said claim; thence **westerly** **300** feet to a **stake for monument** at the center of the **south** end of said claim thence **westerly** **300** feet to a **stake for monument** being at the **south westerly** corner of said claim; thence **northerly** **1500** feet to a **stake** at the **north westerly** corner of said claim; thence **300** feet to the place of beginning.

All done under the provisions of Chapter Six; of Title XXXII, of the Revised Statutes of the United States, and of an Act of the General Assembly of Arizona, entitled "An Act to Revise and Codify the Laws of the Territory of Arizona," approved March 16, 1901.

Dated and posted on the ground this **1st** day of **May** 19**07**.

Fred W. Fickett.

Filed and recorded at request of **Fred W. Fickett**, May 25th, 1907, at 9 A.M.
Chas. A. Shibell, County Recorder.

An Act to Codify and Revise the Laws of the Territory of Arizona

SECTIONS I-II.—INC. LOCATION OF CLAIMS

Be it enacted by the Legislative Assembly of the Territory of Arizona:

SECTION 1. On the discovery of mineral in places on the public domain of the United States, the same may be located as a mineral claim by the discoverer for himself, for himself and others, or for others.

SECTION 2. Such location shall be made by erecting at, or contiguous to the point of discovery, a conspicuous monument of stones not less than three (3) feet in height, or an upright post securely fixed, projecting at least four (4) feet above the ground, in which monument of stones or on which post, there shall be posted a location notice, which shall be signed by the name or names of the locator or locators. The location notice must contain: First, the name of the claim located; second, the name or names of the locators; third, the date of the location; fourth, the length and width of the claim in feet and the distance in feet from the point of discovery to each end of the claim; fifth, the general course of the claim; sixth, the locality of the claim with reference to some natural object or permanent monument whereby the claim can be identified.

SECTION 3. Until each and all of the above specified things shall have been done no right thereto shall be acquired.

SECTION 4. From the time of the location of a mining claim as above specified, the locator shall be allowed ninety (90) days within which to do or cause to be done, the following things: First, to cause to be recorded in the office of the County Recorder of the county in which the claim is situated, a copy of the location notice; second, to sink a discovery shaft in the claim to the depth of at least ten (10) feet from the lowest part of the rim of the shaft a, the surface, and deeper if necessary until there is discovered in said shaft mineral in place; third, to monument the claim on the ground so that its boundaries can be readily traced.

SECTION 5. The failure to do all the things enumerated in this section in the time and space specified shall be construed into an abandoning of the claim, and all right thereto of the discoverer and locator shall be forfeited.

SECTION 6. Such surface boundaries shall be marked by six (6) substantial posts projecting at least four (4) feet above the surface of the ground, or by substantial stone monuments at least three (3) feet high, to-wit: One at each corner of said claim, and one at the center of each end line thereof.

SECTION 7. Any open-cut, adit or tunnel which shall be made as above provided for as a part of the location of a lode mineral claim, and which shall be equal in amount of work to a shaft ten (10) feet deep and four (4) feet wide by six (6) feet long, and which shall cut the lode or mineral in place at a depth of ten (10) feet from the surface, shall be equivalent as a discovery work to a shaft sunk from the surface.

SECTION 8. Location notice may be amended at any time, and the monument changed to correspond with the amended location; provided, that no change shall be made that will interfere with the rights of others.

SECTION 9. The amount of assessment or representation work or improvements to be done or made during each year, after the completion of the location as heretofore provided, and the time for doing the same shall be as provided by the laws of the United States.

SECTION 10. Within three (3) months after the expiration of the period of the time fixed for the performance of annual labor, or the making of such improvements upon any mining claim, the person on whose behalf such work or improvements was made, or some person for him knowing the facts, may make a record in the office of the County Recorder of the county wherein such claim is situated, an affidavit in substance as follows:

TERRITORY OF ARIZONA, }
 } ss.

..... being duly sworn deposes and says that he is a citizen of the United States and more than twenty-one years of age, resides at..... in..... County, Arizona, Territory, and is personally acquainted with the mining claim known as..... Mining District, Arizona Territory, the location notice of which is recorded in the office of the County Recorder of said County, in book..... of Records of Mines, at page..... That between the..... day of..... A. D..... and the..... day of..... A. D..... at least..... dollars worth of work and improvements were done and performed upon said claim, not including the location work of said claim. Such work and improvements were made by and at the expense of..... owners of said claim, for the purpose of complying with the laws of the United States, pertaining to assessments of annual work, and (here name the owners of men who worked upon the claim in doing the work) were the men employed by said owner, and who labored upon said claim, did said work and improvements, the same being as follows, to-wit: (Here describe the work done).

Subscribed and sworn to before me, this..... day of..... A. D..... (Signature)

My commission as Notary Public expires on the..... day of..... A. D.....

(Notary Seal) Notary Public.

SECTION 11. Such affidavit, when so recorded, shall be prima facie evidence of the performance of such labor or the making of such improvements, and said original affidavit, after it has been recorded, or a certified copy of record of same, or the record of same, shall be received as evidence accordingly by the courts of the Territory. The relocation of forfeited or abandoned lode claims shall only be made by sinking a new discovery shaft and fixing the boundary in the same manner and to the same extent as is required in making an original location; or the relocator may sink the original discovery shaft ten (10) feet deeper than it was at the commencement of such location, and shall erect new, or make the old monuments the same as originally required. In either case a new location monument shall be erected, and the location notice shall state if the whole or any part of the new location is located as abandoned property, else it shall be void.

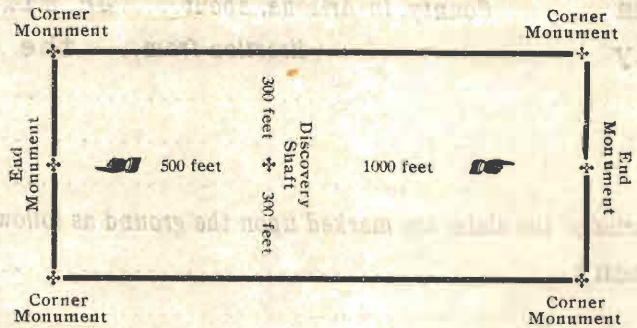

The above diagram is to give the locator a general idea of the plan of location under new law. Your discovery shaft may be in the center of claim, or any distance from either end you desire. In the diagram we have placed it 500 feet from one end and 500 feet from the other. In description, be careful to state locality of claim with reference to some natural object, or permanent monument, so as to identify the claim.

STATE OF ARIZONA, }
 } ss.
 County of.....

I,..... County Recorder in and for the County and State aforesaid, do hereby certify that the within instrument was filed for record at..... o'clock,..... M., on this..... day of..... 19....., and duly recorded in Book No..... of..... Records of..... County, Arizona, at pages.....

WITNESS my hand and official seal the day and year first above written.

County Recorder.

JUN 10. 1912

Notice of Location.
 LODE CLAIM

Black Dyke No. 15.

Dated May 1st, 1907

Filed and Recorded at request of
 Fred W. Fickett.

May 25th, A. D. 1907

at..... A.M.

Book..... M.M.

Pages 293.

By.....
 County Recorder.
 Deputy Recorder.

STATE OF ARIZONA, }
COUNTY OF PIMA. } ss.

I, P. E. Howell, County Recorder in and for the
County of Pima, do hereby certify that the above and foregoing is a full, true and correct copy of
Notice of Location of the BLACK DITCH NO. 15 Mining Claim,

.....
.....
as appears of record now in my office in Book M.M. Rec. of Mines Pages 293

IN WITNESS WHEREOF, I have hereunto set my
hand and affixed my official seal, at my office
in Tucson, this 11th day of
June, A. D. 1912.

P. E. Howell
County Recorder of Pima County,
Arizona.

Notice of Mining Location.

LODE CLAIM

TO ALL WHOM IT MAY CONCERN:

This Mining Claim, the name of which is the... **Black Dyke No. 18**
Mining Claim, situate on lands belonging to the United States of America, and in which there are valuable
mineral deposits, was entered upon and located for the purposes of exploration and purchase by.....
Fred W. Fickett, a citizen of the United States......

(Locator must insert either "a citizen of the United States" or "who has declared his intention to become a citizen of the United States.")

the undersigned, on the..... **1st**..... day of..... **May**..... 19. **07**

The length of this claim is..... **1500**..... feet,
and..... **1**..... claim..... **1000**..... feet
in a..... **Southerly**..... direction and.....
..... **500**..... feet in a..... **Northerly**..... direction from
the center of the discovery shaft, at which this notice is posted, lengthwise of the claim, together with
..... **300**..... feet in width of the surface grounds, on each side of the
center of said claim. The general course of the lode deposit and premises is from the..... **North**.....
to the..... **South**.....

The claim is situated and located in the..... **Papago**..... Mining District, in
..... **Pima**..... County, in Arizona, about..... **28** miles.....
in a..... **southwesterly**..... direction from..... **the city of Tucson,**.....
Arizona......

The surface boundaries of the claim are marked upon the ground as follows: Beginning at—.....
..... **a monument.**.....

at a point in a..... **northerly**..... direction..... **500**..... feet from
the discovery shaft (at which this notice is posted) being in the center of the..... **north**.....
end line of said claim; thence..... **east**..... **300**..... feet to a..... **stake for**.....
monument..... being the..... **north easterly**..... corner of said claim; thence
southerly..... **1500**..... feet to a..... **stake for monument**..... being at the
south easterly..... corner of said claim; thence..... **westerly**..... **300**..... feet
to a..... **stake for monument**..... at the center of the..... **south**..... end of said claim
thence..... **westerly**..... **300**..... feet to a..... **stake for monument**..... being at the
south westerly..... corner of said claim; thence..... **northerly**.....
..... **1500**..... feet to a..... **stake**..... at the..... **north westerly**.....
corner of said claim; thence..... **300**..... feet to the place of beginning.

All done under the provisions of Chapter Six; of Title XXXII, of the Revised Statutes of the United
States, and of an Act of the General Assembly of Arizona, entitled "An Act to Revise and Codify the Laws
of the Territory of Arizona," approved March 16, 1901.

Dated and posted on the ground this..... **1st**..... day of..... **May**..... 19. **07**

..... **Fred W. Fickett,**.....

Filed and recorded at request of Fred W. Fickett, May 25th. 1907, at 9 A.M.
Chas. A. Shibell, County Recorder.

An Act to Codify and Revise the Laws of the Territory of Arizona

SECTIONS I-II--INC. LOCATION OF CLAIMS

Be it enacted by the Legislative Assembly of the Territory of Arizona:

SECTION 1. On the discovery of mineral in places on the public domain of the United States, the same may be located as a mineral claim by the discoverer for himself, for himself and others, or for others.

SECTION 2. Such location shall be made by erecting at or contiguous to the point of discovery, a conspicuous monument of stones or on which post, there shall be posted a location notice, which shall be signed by the name or names of the locator or locators. The location notice must contain: First, the name of the claim located; second, the name or names of the locators; third, the date of the location; fourth, the length and width of the claim in feet and the distance in feet from the point of discovery to each end of the claim; fifth, the general course of the claim; sixth, the locality of the claim with reference to some natural object or permanent monument whereby the claim can be identified.

SECTION 3. Until each and all of the above specified things shall have been done no right thereto shall be acquired.

SECTION 4. From the time of the location of a mining claim as above specified, the locator shall be allowed ninety (90) days within which to do or cause to be done, the following things: First, to cause to be recorded in the office of the County Recorder of the county in which the claim is situated, a copy of the location notice; second, to sink a discovery shaft in the claim to the depth of at least ten (10) feet from the lowest part of the rim of the shaft to the surface, and deeper if necessary until there is discovered in said shaft mineral in place; third, to monument the claim on the ground so that its boundaries can be readily traced.

SECTION 5. The failure to do all the things enumerated in this section in the time and space specified shall be construed into an abandoning of the claim, and all right thereto of the discoverer and locator shall be forfeited.

SECTION 6. Such surface boundaries shall be marked by six (6) substantial posts projecting at least four (4) feet above the surface of the ground, or by substantial stone monuments at least three (3) feet high, to-wit: One at each corner of said claim, and one at the center of each end line thereof.

SECTION 7. Any open-cut, adit or tunnel which shall be made as above provided for as a part of the location of a lode mineral claim, and which shall be equal in amount of work to a shaft ten (10) feet deep and four (4) feet wide by six (6) feet long, and which shall cut the lode or mineral in place at a depth of ten (10) feet from the surface, shall be equivalent as a discovery work to a shaft sunk from the surface.

SECTION 8. Location notice may be amended at any time, and the monument changed to correspond with the amended location; provided, that no change shall be made that will interfere with the rights of others.

SECTION 9. The amount of assessment or representation work or improvements to be done or made during each year, after the completion of the location as heretofore provided, and the time for doing the same shall be as provided by the laws of the United States.

SECTION 10. Within three (3) months after the expiration of the period of the time fixed for the performance of annual labor, or the making of such improvements upon any mining claim, the person on whose behalf such work or improvements was made, or some person for him knowing the facts, may make a record in the office of the County Recorder of the county wherein such claim is situated, an affidavit in substance as follows:

TERRITORY OF ARIZONA, }
 } ss. _____ being duly sworn deposes and says that he is a citizen of the United States and more than twenty-one years of age, resides at _____ in _____ County, Arizona Territory, and is personally acquainted with the mining claim known as _____ mining claim, situated in _____ Mining District, Arizona Territory, the location notice of which is recorded in the office of the County Recorder of said County, in book _____ of Records of Mines, at page _____.

That between the _____ day of _____ A. D. _____ and the _____ day of _____ A. D. _____ at least _____ dollars worth of work and improvements were done and performed upon said claim, not including the location work of said claim. Such work and improvements were made by and at the expense of _____ owners of said claim, for the purpose of complying with the laws of the United States, pertaining to assessments of annual work, and (here name the owners of men who worked upon the claim in doing the work) were the men employed by said owner, and who labored upon said claim, did said work and improvements, the same being as follows, to-wit: (Here describe the work done).

 (Signature)

Subscribed and sworn to before me, this _____ day of _____ A. D. _____

My commission as Notary Public expires on the _____ day of _____ A. D. _____

 Notary Public.

SECTION 11. Such affidavit, when so recorded, shall be prima facie evidence of the performance of such labor or the making of such improvements, and said original affidavit, after it has been recorded, or a certified copy of record of same, or the record of same, shall be received as evidence accordingly by the courts of the Territory. The relocation of forfeited or abandoned lode claims shall only be made by sinking a new discovery shaft and fixing the boundary in the same manner and to the same extent as is required in making an original location; or the locator may sink the original discovery shaft ten (10) feet deeper than it was at the commencement of such location, and shall erect new or make the old monuments the same as originally required. In either case a new location monument shall be erected, and the location notice shall state if the whole or any part of the new location is located as abandoned property, else it shall be void.

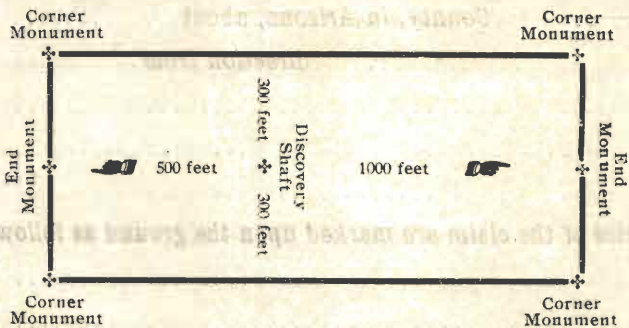

The above diagram is to give the locator a general idea of the plan of location under new law. Your discovery shaft may be in the center of claim, or any distance from either end you desire. In the diagram we have placed it 500 feet from one end and 1000 feet from the other. In description, be careful to state locality of claim with reference to some natural object, or permanent monument, so as to identify the claim.

STATE OF ARIZONA, }
 } ss. _____

County of _____

I, _____, County Recorder in and for the County and State aforesaid, do hereby certify that the within instrument was filed for record at _____ o'clock, _____ M., on this _____ day of _____ 19____, and duly recorded in Book No. _____ of _____ Records of _____ County, Arizona, at pages _____.

WITNESS my hand and official seal the day and year first above written.

 County Recorder.

FILED 10-19-1907

Notice of Location.
 LODGE CLAIM

Black Dyke No. 18

Dated **May 1st. 1907**

Filed and Recorded at request of
Fred W. Fickett

at **May 25th. A. D. 1907**

Book **M.M.**

Pages **296.**

By **County Recorder.**
 Deputy Recorder.

STATE OF ARIZONA, }
COUNTY OF PIMA. } ss.

I, P. E. Howell, County Recorder in and for the
County of Pima, do hereby certify that the above and foregoing is a full, true and correct copy.....
Notice of Location of the BLACK DIKE NO. 18 Mining Claim,

as appears of record now in my office in Book M.M. Rec. of Mines Pages 296

IN WITNESS WHEREOF, I have hereunto set my
hand and affixed my official seal, at my office
in Tucson, this 8th..... day of
June,, A. D. 1912.

P. E. Howell
County Recorder of Pima County,
Arizona.

Notice of Mining Location.

LODE CLAIM

TO ALL WHOM IT MAY CONCERN:

This Mining Claim, the name of which is the... **Black Dyke No. 19**,
Mining Claim, situate on lands belonging to the United States of America, and in which there are valuable
mineral deposits, was entered upon and located for the purposes of exploration and purchase by
Fred W. Fickett, a citizen of the United States,

(Locator must insert either "a citizen of the United States" or "who has declared his intention to become a citizen of the United States.")

the undersigned, on the... **1st**... day of... **May**... 19 **07**

The length of this claim is... **1500**... feet,
and... **1**... claim... **1000**... feet
in a... **1**... southerly... direction and...
... **500**... feet in a... **1**... northerly... direction from
the center of the discovery shaft, at which this notice is posted, lengthwise of the claim, together with
... **300**... feet in width of the surface grounds, on each side of the
center of said claim. The general course of the lode deposit and premises is from the... **north**...
to the... **south**...

The claim is situated and located in the... **Papago**... Mining District, in
... **Pima**... County, in Arizona, about... **38** miles...
in a... **southwesterly**... direction from... the city of **Tucson**,
Arizona...

The surface boundaries of the claim are marked upon the ground as follows: Beginning at—
... **a monument**...

at a point in a... **northerly**... direction... **500**... feet from
the discovery shaft (at which this notice is posted) being in the center of the... **north**...
end line of said claim; thence... **east**... **300** feet to a... **stake**...
for monument... being the... **north easterly**... corner of said claim; thence
southerly... **1500** feet to a... **stake for monument**... being at the
south easterly... corner of said claim; thence... **westerly**... **300**... feet
to a... **stake for monument**... at the center of the... **south**... end of said claim
thence... **westerly**... **300** feet to a... **stake for monument**... being at the
south westerly... corner of said claim; thence... **northerly**...
... **1500** feet to a... **stake**... at the... **north westerly**...
corner of said claim; thence... **300**... feet to the place of beginning.

All done under the provisions of Chapter Six; of Title XXXII, of the Revised Statutes of the United
States, and of an Act of the General Assembly of Arizona, entitled "An Act to Revise and Codify the Laws
of the Territory of Arizona," approved March 16, 1901.

Dated and posted on the ground this... **1st**... day of... **May**... 19 **07**

... **Fred W. Fickett**...

Filed and recorded at request of Fred W. Fickett, May 25th. 1907, at 9 A.M.
Chas. A. Shibell, County Recorder.

An Act to Codify and Revise the Laws of the Territory of Arizona

SECTIONS I-III—LOC. LOCATION OF CLAIMS

Be it enacted by the Legislative Assembly of the Territory of Arizona:

SECTION 1. On the discovery of mineral in places on the public domain of the United States, the same may be located as a mineral claim by the discoverer for himself, for himself and others, or for others.

SECTION 2. Such location shall be made by erecting at or contiguous to the point of discovery, a conspicuous monument of stones not less than three (3) feet in height, or an upright post securely fixed, projecting at least four (4) feet above the ground, in which monument of stones or on which post, there shall be posted a location notice, which shall be signed by the name or names of the locator or locators. The location notice must contain: First, the name of the claim located; second, the name or names of the locators; third, the date of the location; fourth, the length and width of the claim in feet and the distance in feet from the point of discovery to each end of the claim; fifth, the general course of the claim; sixth, the locality of the claim with reference to some natural object or permanent monument whereby the claim can be identified.

SECTION 3. Until each and all of the above specified things shall have been done no right thereto shall be acquired.

SECTION 4. From the time of the location of a mining claim as above specified, the locator shall be allowed ninety (90) days within which to do or cause to be done, the following things: First, to cause to be recorded in the office of the County Recorder of the county in which the claim is situated, a copy of the location notice; second, to sink a discovery shaft in the claim to the depth of at least ten (10) feet from the lowest part of the rim of the shaft to the surface, and deeper if necessary until there is discovered in said shaft mineral in place; third, to monument the claim on the ground so that its boundaries can be readily traced.

SECTION 5. The failure to do all the things enumerated in this section in the time and space specified shall be construed into an abandoning of the claim, and all right thereto of the discoverer and locator shall be forfeited.

SECTION 6. Such surface boundaries shall be marked by six (6) substantial posts projecting at least four (4) feet above the surface of the ground, or by substantial stone monuments at least three (3) feet high, to-wit: One at each corner of said claim, and one at the center of each end line thereof.

SECTION 7. Any open-cut, adit or tunnel which shall be made as above provided for as a part of the location of a lode mineral claim, and which shall be equal in amount of work to a shaft ten (10) feet deep and four (4) feet wide by six (6) feet long, and which shall cut the lode or mineral in place at a depth of ten (10) feet from the surface, shall be equivalent as a discovery work to a shaft sunk from the surface.

SECTION 8. Location notice may be amended at any time, and the monument changed to correspond with the amended location; provided, that no change shall be made that will interfere with the rights of others.

SECTION 9. The amount of assessment or representation work or improvements to be done or made during each year, after the completion of the location as heretofore provided, and the time for doing the same shall be as provided by the laws of the United States.

SECTION 10. Within three (3) months after the expiration of the period of the time fixed for the performance of annual labor, or the making of such improvements upon any mining claim, the person on whose behalf such work or improvements was made, or some person for him knowing the facts, may make a record in the office of the County Recorder of the county wherein such claim is situated, an affidavit in substance as follows:

TERRITORY OF ARIZONA,

..... } ss.
 being duly sworn deposes and says that he is a citizen of the United States and more than twenty-one years of age, resides at in County, Arizona, Territory, and is personally acquainted with the mining claim known as Mining District, Arizona Territory, the location notice of which is recorded in the office of the County Recorder of said County, in book of Records of Mines, at page That between the day of A. D. and the day of A. D. at least dollars worth of work and improvements were done and performed upon said claim, not including the location work of said claim. Such work and improvements were made by and at the expense of owners of said claim, for the purpose of complying with the laws of the United States, pertaining to assessments of annual work, and (here name the owners or men who worked upon the claim in doing the work) were the men employed by said owner, and who labored upon said claim, did said work and improvements, the same being as follows, to-wit: (Here describe the work done).

Subscribed and sworn to before me, this day of A. D. (Signature)

My commission as Notary Public expires on the day of A. D. (Notary Seal)

SECTION 11. Such affidavit, when so recorded, shall be prima facie evidence of the performance of such labor or the making of such improvements, and said original affidavit, after it has been recorded, or a certified copy of record of same, or the record of same, shall be received as evidence accordingly by the courts of the Territory. The relocation of forfeited or abandoned lode claims shall only be made by sinking a new discovery shaft and fixing the boundary in the same manner and to the same extent as is required in making an original location; or the locator may sink the original discovery shaft ten (10) feet deeper than it was at the commencement of such location, and shall erect new, or make the old monuments the same as originally required. In either case a new location monument shall be erected, and the location notice shall state if the whole or any part of the new location is located as abandoned property, else it shall be void.

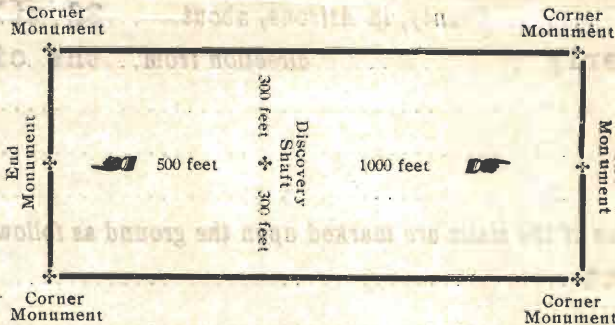

The above diagram is to give the locator a general idea of the plan of location under new law. Your discovery shaft may be in the center of claim, or any distance from either end you desire. In the diagram we have placed it 500 feet from one end and 300 feet from the other. In description, be careful to state locality of claim with reference to some natural object, or permanent monument, so as to identify the claim.

STATE OF ARIZONA, } ss.
 County of

I,, County Recorder in and for the County and State aforesaid, do hereby certify that the within instrument was filed for record at o'clock, M., on this day of 19....., and duly recorded in Book No. of Records of County, Arizona, at pages

WITNESS my hand and official seal the day and year first above written.

County Recorder.

JUN 10 1912

Notice of Location.

LODE CLAIM

Black Dyke No. 19.

Dated, May 1st, 1907.

Filed and Recorded at request of

Fred W. Fickett.

May 25th, A. D. 1907

at 9 A.M.

Book M.M.

Pages 297.

County Recorder.

Deputy Recorder.

3004

Notice of Mining Location.

LODE CLAIM

TO ALL WHOM IT MAY CONCERN:

This Mining Claim, the name of which is the Black Dyke No. 20,
Mining Claim, situate on lands belonging to the United States of America, and in which there are valuable
mineral deposits, was entered upon and located for the purposes of exploration and purchase by
Fred W. Fickett, a citizen of the United States,

(Locator must insert either "a citizen of the United States" or "who has declared his intention to become a citizen of the United States.")

the undersigned, on the 1st day of May 1907

The length of this claim is 1500 feet,
and 1 claim 1000 feet
in a southerly direction and
500 feet in a northerly direction from
the center of the discovery shaft, at which this notice is posted, lengthwise of the claim, together with
300 feet in width of the surface grounds, on each side of the
center of said claim. The general course of the lode deposit and premises is from the north
to the south

The claim is situated and located in the Papago Mining District, in
Pima County, in Arizona, about 28 miles
in a southwesterly direction from the city of Tucson,
Arizona.

The surface boundaries of the claim are marked upon the ground as follows: Beginning at—
a monument
at a point in a northerly direction 500 feet from
the discovery shaft (at which this notice is posted) being in the center of the north
end line of said claim; thence east 300 feet to a stake
for monument being the north easterly corner of said claim; thence
southerly 1500 feet to a stake for monument being at the
south easterly corner of said claim; thence westerly 300 feet
to a stake for monument at the center of the south end of said claim
thence westerly 300 feet to a stake for monument being at the
south westerly corner of said claim; thence northerly
1500 feet to a stake at the north westerly
corner of said claim; thence 300 feet to the place of beginning.

All done under the provisions of Chapter Six; of Title XXXII, of the Revised Statutes of the United
States, and of an Act of the General Assembly of Arizona, entitled "An Act to Revise and Codify the Laws
of the Territory of Arizona," approved March 16, 1901.

Dated and posted on the ground this 1st day of May 1907

Fred W. Fickett

Filed and recorded at request of Fred W. Fickett, May 25th. 1907, at 9 A.M.
Chas. A. Shibell, County Recorder.

An Act to Codify and Revise the Laws of the Territory of Arizona

SECTIONS I-III.—INC. LOCATION OF CLAIMS

Be it enacted by the Legislative Assembly of the Territory of Arizona:

- SECTION 1.** On the discovery of mineral in places on the public domain of the United States, the same may be located as a mineral claim by the discoverer for himself, for himself and others, or for others.
- SECTION 2.** Such location shall be made by erecting at or contiguous to the point of discovery, a conspicuous monument of stones not less than three (3) feet in height, or an upright post securely fixed, projecting at least four (4) feet above the ground, in which monument of stones or on which post, there shall be posted a location notice, which shall be signed by the name or names of the locator or locators. The location notice must contain: First, the name of the claim located; second, the name or names of the locators; third, the date of the location; fourth, the length and width of the claim in feet and the distance in feet from the point of discovery to each end of the claim; fifth, the general course of the claim; sixth, the locality of the claim with reference to some natural object or permanent monument whereby the claim can be identified.
- SECTION 3.** Until each and all of the above specified things shall have been done no right thereto shall be acquired.
- SECTION 4.** From the time of the location of a mining claim as above specified, the locator shall be allowed ninety (90) days within which to do or cause to be done, the following things: First, to cause to be recorded in the office of the County Recorder of the county in which the claim is situated, a copy of the location notice; second, to sink a discovery shaft in the claim to the depth of at least ten (10) feet from the lowest part of the rim of the shaft to the surface, and deeper if necessary until there is discovered in said shaft mineral in place; third, to monument the claim on the ground so that its boundaries can be readily traced.
- SECTION 5.** The failure to do all the things enumerated in this section in the time and space specified shall be construed into an abandoning of the claim, and all right thereto of the discoverer and locator shall be forfeited.
- SECTION 6.** Such surface boundaries shall be marked by six (6) substantial posts projecting at least four (4) feet above the surface of the ground, or by substantial stone monuments at least three (3) feet high, to-wit: One at each corner of said claim, and one at the center of each end line thereof.
- SECTION 7.** Any open-cut, adit or tunnel which shall be made as above provided for as a part of the location of a lode mineral claim, and which shall be equal in amount of work to a shaft ten (10) feet deep and four (4) feet wide by six (6) feet long, and which shall cut the lode or mineral in place at a depth of ten (10) feet from the surface, shall be equivalent as a discovery work to a shaft sunk from the surface.
- SECTION 8.** Location notice may be amended at any time, and the monument changed to correspond with the amended location; provided, that no change shall be made that will interfere with the rights of others.
- SECTION 9.** The amount of assessment or representation work or improvements to be done or made during each year, after the completion of the location as heretofore provided, and the time for doing the same shall be as provided by the laws of the United States.
- SECTION 10.** Within three (3) months after the expiration of the period of the time fixed for the performance of annual labor, or the making of such improvements upon any mining claim, the person on whose behalf such work or improvements was made, or some person for him knowing the facts, may make a record in the office of the County Recorder of the county wherein such claim is situated, an affidavit in substance as follows:

TERRITORY OF ARIZONA, }
 } ss.
 being duly sworn deposes and says that he is a citizen of the United States and more than twenty-one years of age, resides at in County, Arizona, Territory, and is personally acquainted with the mining claim known as Mining District, Arizona Territory, the location notice of which is recorded in the office of the County Recorder of said County, in book of Records of Mines, at page That between the day of A. D. and the day of A. D. at least dollars worth of work and improvements were done and performed upon said claim, not including the location work of said claim. Such work and improvements were made by and at the expense of owners of said claim, for the purpose of complying with the laws of the United States, pertaining to assessments of annual work, and (here name the owners of men who worked upon the claim in doing the work) were the men employed by said owner, and who labored upon said claim, did said work and improvements, the same being as follows, to-wit: (Here describe the work done).
 (Signature)
 Subscribed and sworn to before me, this day of A. D.
 My commission as Notary Public expires on the day of A. D.
 (Notary Seal) Notary Public.

SECTION 11. Such affidavit, when so recorded, shall be prima facie evidence of the performance of such labor or the making of such improvements, and said original affidavit, after it has been recorded, or a certified copy of record of same, or the record of same, shall be received as evidence accordingly by the courts of the Territory. The relocation of forfeited or abandoned lode claims shall only be made by sinking a new discovery shaft and fixing the boundary in the same manner and to the same extent as is required in making an original location; or the locator may sink the original discovery shaft ten (10) feet deeper than it was at the commencement of such location, and shall erect new, or make the old monuments the same as originally required. In either case a new location monument shall be erected, and the location notice shall state if the whole or any part of the new location is located as abandoned property, else it shall be void.

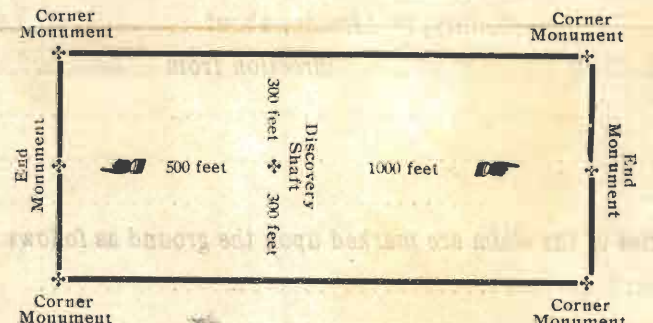

The above diagram is to give the locator a general idea of the plan of location under new law. Your discovery shaft may be in the corner of claim, or any distance from either end you desire. In the diagram we have placed it 500 feet from one end and 1000 feet from the other. In description, be careful to state locality of claim with reference to some natural object, or permanent monument, so as to identify the claim.

STATE OF ARIZONA, }
 } ss.
 County of
 I, County Recorder in and for the County and State aforesaid, do hereby certify that the within instrument was filed for record at o'clock, M., on this day of 19....., and duly recorded in Book No. of Records of County, Arizona, at pages
 WITNESS my hand and official seal the day and year first above written.

County Recorder.

MAY 10 1912

Notice of Location.

LODE CLAIM

Black Dyke No. 20

Dated May 1st. 1907

Filed and Recorded at request of Fred W. Fickstt.

at May 25th. A. D. 1907

9 A.M.

Book M.M.

Pages 298.

By County Recorder. Deputy Recorder.

STATE OF ARIZONA, }
COUNTY OF PIMA. } ss.

I, P. H. Howe, Jr., County Recorder in and for the
County of Pima, do hereby certify that the above and foregoing is a full, true and correct copy
of
Notice of Location of the BLACK DIAM NO. 20 Mining Claim,

as appears of record now in my office in Book M.M. Rec. of Mines Pages 200

IN WITNESS WHEREOF, I have hereunto set my
hand and affixed my official seal, at my office
in Tucson, this 8th day of
June, _____, A. D. 1916.

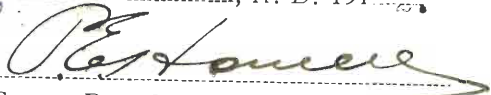
County Recorder of Pima County,
Arizona.

U. S. SURVEYOR-GENERAL'S FINAL CERTIFICATE ON FIELD NOTES.

Department of the Interior,

OFFICE OF U. S. SURVEYOR-GENERAL,

Phoenix, Arizona,

September 10, 1912.

I, U. S. Surveyor-General for Arizona

do hereby certify that the foregoing transcript of the Field Notes, return and approval of the survey of the mining claim of

The Tucson Consolidated Copper Co.

known as the Black Dyke No. 14, Black Dyke No. 15, Black Dyke No. 18,
Black Dyke No. 19, Black Dyke No. 20.
situate in Papago

Mining District, Pima County, Arizona

in Sections 23, 24, 25, 26 Township No. 17 S., Range No. 10 E., and

designated as Survey No. 3004, has been correctly copied from the originals on file in this office; that said Field Notes furnish such an accurate description of said mining claim as will, if incorporated into a patent, serve fully to identify the premises, and that such reference is made therein to natural objects or permanent monuments as will perpetuate and fix the *locus* thereof.

And I further certify that five hundred dollars' worth of labor has been expended or improvements made upon ^{or for each of} said mining claim by claimant or its grantors, and that said improvements consist of 7 shafts, 4 cuts, 1 tunnel, 1 hole, 2 trenches and 1 drift, total value \$6328.00. Shaft No. 3 on the Black Dyke No. 18 lode is a common improvement for the benefit and development of the Black Dyke No. 14, Black Dyke No. 15, Black Dyke No. 18 and Black Dyke No. 19 lodes, and an undivided 1/4 interest therein, \$545, is properly credited to each of said lodes. Shaft No. 5 on the Black Dyke No. 19 lode is a common improvement for the benefit and development of the Black Dyke No. 14, Black Dyke No. 19 and Black Dyke No. 20 lodes, and an undivided 1/3 interest therein, \$1022, is properly credited to each of said lodes.

and that no portion of said labor or improvements has been included in the estimate of expenditures upon any other claim.

I further certify that the plat thereof, filed in the U. S. Land Office at Phoenix,

Arizona, is correct and in conformity with the foregoing Field Notes.

Frank S. Ingalls,

United States Surveyor-General for Arizona.

4-687.

SURVEYOR-GENERAL'S CERTIFICATE OF APPROVAL OF FIELD NOTES AND SURVEY OF MINING CLAIM.

Department of the Interior,

Office of U. S. Surveyor-General,

Phoenix, Arizona.

September 10, 1912.

I, U. S. Surveyor-General for Arizona

do hereby certify that the foregoing and hereto attached Field Notes and Return of the Survey of the Mining Claim of

The Tucson Consolidated Copper Co.

known as the

Black Dyke No. 14, Black Dyke No. 15, Black Dyke No. 18, Black Dyke No. 19, Black Dyke No. 20.

situate in Papago Mining District,

Pima County, Arizona.

in Sections 23, 24, 25, 26, Township No. 17 S., Range No. 10 E.

designated as Survey No. 3004

executed by Paul E. Fernald, U. S. Deputy Mineral

Surveyor, June 15-24, 1912, 190., under my instructions dated

June 10, 1912, 190., have been critically examined and the necessary cor-

rections and explanations made, and the said Field Notes and Return, and the Survey they describe,

are hereby approved. A true copy of the copy of the location certificate filed by the applicant for

survey is included in the field notes.

Frank S. Ingalls

U. S. Surveyor-General for Arizona.