

JUL 2-1913

(4-683.)

Mineral Survey No. 3078

Lot No.

Arizona Land District.

FIELD NOTES

OF THE SURVEY OF THE MINING CLAIM OF

Peter B. Scotland

KNOWN AS THE

Prince

Greenlee Gold Mountain Mining District,

Greenlee County, Arizona.

Section 35, Township 3 South, Range 29 E.G. & S.R. P.M. Uns.

Surveyed under instructions dated June 14, 1913,

by E. T. Morton, U. S. Deputy Mineral Surveyor.

Claim located See location notice, 1913.

Survey commenced June 21, 1913.

Survey completed June 24, 1913.

Address of attorney:

John R. Hampton, Clifton, Arizona.

SURVEY NO. 3078.

PRINCE.

Feet	Beginning at Cor. No. 1 A pine post in place, 4 ins. square, 3 ft. high with mound of stone, scribed P 1-3078, whence U. S. L. M.No.2 bears N. 77° 40' W. 5801.5 ft. Thence N. 17° 59' E.
574.31	Intersect lines 1-2 and 3-4 Sur. No. 1712 Regulation and Good Boy lodes at N. 25° 37' W 245.26 ft. and S. 25° 37' E. 411.94 ft. from Cor's No's 1 and 2 and S. 25° 37' E. 405.18 ft. and N. 25° 37' W. 238.50 ft. from Cor's No's 3 and 4 respectively.
1220.48	To Cor. No. 2 A pine post in place 4 ins. square, 3 ft. high, with mound of stone, scribed P 2 -3078, whence No bearings available. Thence S. 72° 01' E.
300	Northeast end center of the location and lode.
502.23	Intersect line 2-3 Sur. No. 1712 Last Spike lode at S. 64° 23' W. 1217.64 ft. and N. 64° 23' E. 282.36 ft. from Cor's No's 2 and 3 respectively.
549.23	Intersect line 4-1 Sur. No.1712 Good Boy lode at N. 43° 09' E. 904.77 ft. and S. 43° 09' W. 196.99 ft. from Cor's No's 4 and 1 respectively, and N. 43° 09' E. 339.45 ft. from its intersection with line 3-4 Last Spike lode, Sur. No. 1712.
600	To Cor. No. 3. A pine post in place, 4 ins. square, 3 ft. high, with mound of stone scribed P 3-3078, whence, Cor. No. 1 Sur. No. 1712 Good Boy lode bears N. 28° 28' E. 181.32 ft.

Feet
 512.09 Thence S.17° 59' W.
 Intersect line 3-4 Sur. No. 1712 Last Spike lode at
 S. 25° 37' E. 438.26ft.and.N25° 37' W. 161.74 ft.
 from Cor's No's 3 and 4 respectively, and S.25°37' E. 282.95 ft.
 from its intersection with line 4-1 Good Boy lode, Sur. No. 1712.
 935 Intersect Placer Gulch course Southwest
 1220.48 To Cor. No. 4
 A pine post, in place, 4 ins. square, 3 ft. high with
 mound of stone, scribed P 4-3078, whence.
 Cor. No. 1 Sur. No. 1712 Regulation lode bears N. 29°
 23' W. 585.71 ft.

Thence N. 72° 01' W.

190 Intersect Placer Gulch course Southwest
 300 Southwest end center of the location and lode
 593.74 Intersect line 4-1 Sur. No. 1712 Regulation lode at
 N. 40° 18' E. 846.63 ft. and S. 40° 18' W. 428.82 ft.
 from Cor's No's 4 and 1 respectively.
 600 To Cor. No. 1, the place of beginning.

The magnetic variation at all corners is 13° 40' E.
 L O D E L I N E S.

As near as can be determined from the present devel-
 opments the vein of the location embraced in this claim
 extends as follows from the discovery point.

Prince lode, N. 17° 59' E. 1220.48 ft.

A R E A S.

Total area Prince lode	Acres 16.811
------------------------	-----------------

Area in conflict with-

- Sur. No. 1712 Regulation lode ---1.143
- Sur. No. 1712 Good Boy lode -----6.382
- Sur. No. 1712 Good Boy lode
(exclusive of its conflict with
(.669 Acs) with Sur. No. 1712
Sur. No. 1712 Last Spike lode)-- 5.713
- Sur. No. 1712 Last Spike lode ---1.995
- Sur. No. 1712, Last Spike lode
exclusive of its conflict
(.669 Acs.) with Sur.No.1712
Good Boy lode, 1.326 Ac.

The survey of this lode is identical with the amended location as staked upon the ground.

L O C A T I O N .

This survey is located in the Greenlee Gold Mountain Mining District, Greenlee County, Arizona, ~~approximately~~ in Sec. 35, T. 3 S. R. 29 E., G & S. R. B.&M. unsurveyed.

A D J O I N I N G L O D E S

This claim is bounded on the North by the Good Boy lode Sur. No. 1712, Detroit Copper Company of Arizona claimant; on the East by Last Spike lode Sur. No. 1712, Detroit Copper Company of Arizona, claimant; on the South by the Public Domain; on the West by the Regulation lode Sur. No. 1712, Detroit Copper Company of Arizona, claimant.

EXPENDITURE OF FIVE HUNDRED DOLLARS.

I hereby certify that the value of the labor and improvements made upon the location embraced in said mining claim, by the claimant or his grantors is not less than five hundred dollars, and that said improvements consist of:

P R I N C I P A L S .

No. 1. The discovery showing mineral in place. is on the lode line at the Southwest end center of the claim.

No. 2. A shaft, the center of which bears from Cor. No. 4, N. 13° 55' W. 642 ft., 4 x 6 ft. 32 ft. deep.

Value \$320.00

No. 3. A tunnel with an open cut approach to the mouth of which bears from Cor. No. 4 N. 13° 50' W. 508 ft., 5 x 10 ft. cut and 5x6 ft. tunnel running

N. 8° 30' W. 22 ft. and 20 ft. respectively.

Value \$240.00

OTHER IMPROVEMENTS.

Note: All of the following improvements were made by a former locator, who has abandoned his claim.

A cut the mouth of which bears from Cor. No. 4 N. 38° 12' W. 511 ft. 5 x 8 ft. running N. 49° W. 19 ft.

A cut the mouth of which bears from Cor. No. 4 N. 36° 22' W. 445 ft. 5 x 10 running N. 54° W. 18 ft.

A cut the face of which bears N. 17° 10' W. 494 ft. 6 x 12 ft., running N. 73° E. 12 ft.

I N S T R U M E N T.

This survey was made with a Buff and Berger light mountain mining transit. The courses were deflected from the true meridian as determined by Polaris observations. The distances were measured with 5 ft., 50 ft., and 500 ft. steel tapes.

R E P O R T.

U. S. L. M. No. 2 is a pine post 6 ins. square 7 ft. high properly set and scribed.

Sur. No. 1712, Regulation, Good Boy and Last Spike lodes:

All corners were pine posts properly set and scribed.

I find all courses and distances to be correct as approved.

The end centers of this lode are pine posts, 4 ins. square, 3 ft. high, with mound of stone.

After a thorough search I fail to find any corners of the public land surveys within two miles of this survey.

C. J. Moton
U. S. Mineral Surveyor.

FINAL OATHS FOR SURVEYS.

LIST OF NAMES.

A list of the names of the individuals employed by E. T. Morton

United States ~~Deputy~~ Mineral Surveyor, to assist in running, measuring, and marking the lines, corners, and boundaries described in the foregoing field notes of the survey of the mining claim of

Peter B. Scotland

known as the Prince

and showing the respective capacities in which they acted.

J. L. Awalt, Chainman.

Drue Underwood, Chainman.

_____, Axman.

_____, Flagman.

FINAL OATHS OF ASSISTANTS.

We, J. L. Awalt

and Drue Underwood, do solemnly swear that we assisted E. T. Morton

_____, United States ~~Deputy~~ Mineral Surveyor, in marking the corners and surveying the boundaries of the mining claim of Peter B. Scotland

known as the Prince

represented in the foregoing field notes as having been surveyed by said ~~deputy~~ mineral surveyor and under his direction; and that said survey has been in all respects, to the best of our knowledge and belief, faithfully and correctly executed, and the corner and boundary monuments established according to law and the instructions furnished by the United States Surveyor-General for Arizona.

J. L. Awalt, Chainman.

Drue Underwood, Chainman.

_____, Axman.

_____, Flagman.

Subscribed and sworn to by the above-named persons before me this 26th

day of June, 1903

S. B. Rayburn

Notary Public

my Commission expires April 28, 1917



FINAL OATH OF U. S. ~~DEPUTY~~ MINERAL SURVEYOR

I, E. T. Morton, U. S. ~~Deputy~~ Mineral Surveyor, do solemnly swear that, in pursuance of instructions received from the United States Surveyor General for Arizona, dated June 14, 1913, I have, in strict conformity to the laws of the United States, the official regulations and instructions thereunder, and the instructions of said Surveyor General, faithfully and correctly executed the survey of the Mining Claim of Peter B. Scotland, known as the Prince, situate in Greenlee Gold Mountain Mining District, Greenlee County, Arizona, in Section 35, Township No. 3 S., Range No. 29 E., G. & S. R. P. M. Unsurveyed and designated as Survey No. 3078, as represented in the foregoing field notes, which accurately show the boundaries of said mining claim as distinctly marked by monuments on the ground, and described in the attached copy of the location certificate, which was received by me from the Surveyor General with said instructions, and that all the corners of said survey have been established and perpetuated in strict accordance with the law, official regulations and instructions thereunder; and I do further solemnly swear that the foregoing are the true and original field notes of said survey and my report therein, and that the labor expended and improvements made upon said mining claim by claimant or his grantors are as therein fully stated, and that the character, extent, location and itemized value thereof are specified therein with particularity and full detail, and that no portion of said labor or improvements so credited to this claim has been included in the estimate of expenditures upon any other claim.

E. T. Morton
U. S. ~~Deputy~~ Mineral Surveyor.

Subscribed and sworn to by the said E. T. Morton
U. S. ~~Deputy~~ Mineral Surveyor, before me S. B. Rayburn
a Notary Public this 26th
day of June 1913,

S. B. Rayburn
Notary Public

my Commission expires April 28 1917



AMENDED NOTICE OF LOCATION—Lode Claim

To all Whom it may Concern:

This mining claim, the name of which is the Prince Mining Claim, situate on lands belonging to the United States of America, and in which there are valuable mineral deposits, was entered upon and amended for the purpose of exploration and purchase by P.B. Scotland

the undersigned on the 2nd, day of June 1913. -190-

The length of the claim is 1220.48 feet, and I claim 1220.48 feet in a N.17°59'E. direction, and 300 feet in a S.W. direction from the center of the discovery pt. at which this notice is posted, lengthwise of the claim together with 300 feet in width of the surface grounds, on each side of the center of said claim. The general course of the lode deposit and premises is from the N.E. to the S.W.

The claim is situated and located in the Greenlee Gold Mountain Mining District, in Greenlee County, State of Arizona, about na direction from From the S.E. Cor. of this claim Cor.No.1 Regulation lode Sur.No. 1712 bears N.29°23'W.585.71 ft.

The surface boundaries of the claim are marked upon the ground as follows: beginning at a pine post

at a ~~point in a~~ direction feet from the discovery pt. (at which this notice is posted), being in the center of the S.W. end line of said claim; thence N.72°01'W. 300 feet to a pine post, being the S.W. corner of said claim; thence N.17°59'E.1220.48 feet to a pine post, being at the N.W. Cor. corner of said claim; thence S.72°01'E. 300 feet to a pine post being the center of the N.E. end of said claim; thence S.72°01'E. 300 feet to a pine post being at the N.E. corner of said claim; thence S.17°59'W. 1220.48 feet to a pine post at the S.E. Cor. corner of said claim; thence N.72°01'W.300 feet to the place of beginning.

~~All done under the provisions of Chapter Six, of Title XXXII, of the revised Statutes of the United States, and of an act of the General Assembly of the Territory of Arizona, entitled "An Act to Codify and Revise the Laws of the Territory of Arizona," approved March 16th, 1901.~~

This is an Amended Location Notice of the Prince of Wales mining Claim, located by Edmond Lafave

on the 1st, day of January 1909, and recorded in Book 20 of Records of Mines at page 339, in the office of the County Recorder of the aforesaid County of Graham to which reference is hereby made,

Dated and posted on the ground this 2nd, day of June 1913. -190-

P.B. Scotland

8 9 TERRITORY OF ARIZONA,

County of Graham

ss.

I, _____ County Recorder in and for the County and Territory aforesaid, do hereby certify that the within instrument was filed for record at.....

o'clock..... M, on this..... day of..... 190....., and

duly recorded in Book No _____ of _____ Records of Graham County Arizona, at pages.....

Witness my hand and seal the day and year first above written,

County Recorder

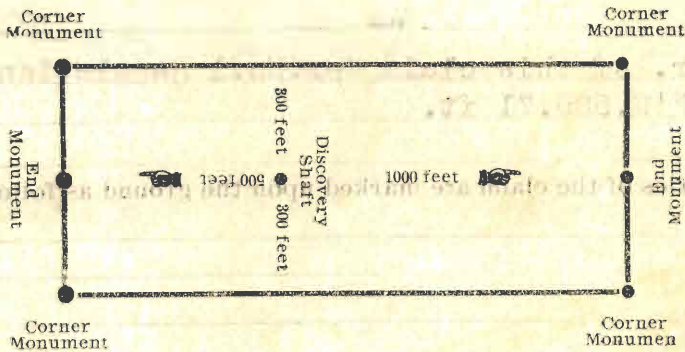

The above diagram is to give the locator a general idea of the plan or location under the new law. Your discovery shaft may be in the center of claim, or any distance from either end you desire. In the diagram we have placed it 500 feet from one end and 1000 feet from the other. In description be careful to state locality of claim with reference to some natural object, or permanent monument, so as to identify the claim.

No. 20026

Amended Notice of Location LODE CLAIM

[Signature]

Dated May 31 1903

Filed and recorded at request of *[Signature]*

June 7 A. D. 1903 at *[Signature]* M.

Book #17 Martin Thomas Pages # 676 *[Signature]* County Recorder.

By *[Signature]* Deputy Recorder.

3078

JUN 14 1913

4-688.

U. S. SURVEYOR-GENERAL'S FINAL CERTIFICATE ON FIELD NOTES.

Department of the Interior,

OFFICE OF U. S. SURVEYOR-GENERAL,

Phoenix, Arizona,

September 16, 1913

I, U. S. Surveyor-General for Arizona

do hereby certify that the foregoing transcript of the Field Notes, return and approval of the survey of the mining claim of

Peter E. Scotland

known as the PRINCE

situate in GREENLEE GOLD MOUNTAIN

Mining District, GREENLEE County, ARIZONA

in Section 35, Township No. 3 S., Range No. 29 E., Unsur., and

designated as Survey No. 3078, has been correctly copied from the originals on file in

this office; that said Field Notes furnish such an accurate description of said mining claim as will, if incorporated into a patent, serve fully to identify the premises, and that such reference is made therein to natural objects or permanent monuments as will perpetuate and fix the locus thereof.

And I further certify that five hundred dollars' worth of labor has been expended or improvements made upon said mining claim by claimant or his grantors, and that said improvements consist of 1 cut and tunnel, and 1 shaft, total value \$560.00

and that no portion of said labor or improvements has been included in the estimate of expenditures upon any other claim.

I further certify that the plat thereof, filed in the U. S. Land Office at Phoenix,

Arizona is correct and in conformity with the foregoing Field Notes.

Frank S. Ingalls,

United States Surveyor-General for Arizona.

4-687.

SURVEYOR-GENERAL'S CERTIFICATE OF APPROVAL OF FIELD NOTES AND SURVEY OF MINING CLAIM.

Department of the Interior.

Office of U. S. Surveyor-General,

Phoenix, Arizona,

September 16, 1913.

I, U. S. Surveyor-General for Arizona

do hereby certify that the foregoing and hereto attached Field Notes and Return of the Survey of the Mining Claim of

Peter B. Scotland

, known as the

PRINCE

situate in GREENLEE GOLD MOUNTAIN mining district,

GREENLEE

County,

ARIZONA

in Section 35, Township No. 3 S., Range No. 29 E. Unsur.

, designated as Survey No. 3078

executed by E. T. Morton, U. S. Deputy Mineral

Surveyor, June 21-24, 1913, 190, under my instructions dated

June 14, 1913, 190, have been critically examined and the necessary cor-

rections and explanations made, and the said Field Notes and Return, and the Survey they describe,

are hereby approved. A true copy of the copy of the location certificate filed by the applicant for

survey is included in the field notes.

Frank Ingalls

U. S. Surveyor-General for Arizona.