

OCT. 23 1913

(4-683.)

Mineral Survey No. 3101

Lot No.

Arizona Land District.

FIELD NOTES

OF THE SURVEY OF THE MINING CLAIM OF

Stevens Copper Mining Company

KNOWN AS THE

Johanner No. 2, Globe, Stonewall Jackson, Susannah, Triangle No. 2, Triangle No. 1, Impraso, Copper Bottom, Evening Star, Morning Star, Painted Cliff, Cata Mount, Square Fraction, Blue Goose, Marescal, Blue and Gray, Bridgeport, Copper Mountain and Greenlee Gold Mountain Mining Districts,

Greenlee County, Arizona

Sections 28, 29, 32, 33, Township 3 S., Range 29 E. Uns., G. & S. R. B. M.

Surveyed under instructions dated October 7, 1913.

by E. T. Morton,

U. S. Deputy Mineral Surveyor

Claim located See location notices, 1

Survey commenced October 9, 1913.

Survey completed October 17, 1913.

Address of attorney:

John R. Hampton,

Clifton, Arizona.

Feet

SURVEY NO. 3101

Johanner No. 2

Beginning at Cor. No. 1

A pine post, in place, 4 ins. square 3 ft. high with mound
of stone, scribed J2-1-3101, whence
U.S.M.M. No. 3 bears S 2°32'E 4065.5 ft.

Thence N 79°53'W

300 South end center of the location and lode.

523.25 To Cor. No. 2

On line 4-1 Sur. No. 3098 Monte Christo No. 2 lode, at
S 16°10'W 260.5 ft. from Cor. No. 4.

A pine post, in place, 4 ins. square, 3 ft. high, with mound
of stone, scribed J2-2-3101 whence

A cross (X) and B R 2-3101 chiseled on quartz porphyry
4x6 ft. facing the East bears N 79°53'W 6.6 ft.

Thence N 16°10'E

260.5 Cor's No's 1 and 4 Sur. No. 3098 Monte Christo and Monte
Cristo No. 2 lodes respectively.

490.5 Intersect gulch course Southeast.

1507.7 To Cor. No. 3.

On line 4-1 Sur. No. 3098 Monte Christo lode at N 16°10'E
1247.2 ft. from Cor. No. 1.

On line 2-3 Globe lode of this survey.

A pine post, in place, 4 ins. square 3 ft. high with mound
of stone, scribed J2-3-3101

No bearings available.

Thence S 79°53'E

20.24 North end center of the location and lode.

320.24 To Cor. No. 4.

Identical with Cor. No. 2 Globe lode of this survey.

On line 2-3 Susannah lode of this survey at S 8°26'W
272.6 ft. from Cor. No. 3.

Feet	
	<p>A pine post, in place 4 ins. square 3 ft. high with mound of stone, scribed G-2-J2-4-3101.</p> <p>No bearings available.</p>
	<p>Thence S 8°26'W</p>
1177.4	Intersect gulch course Southeast.
1227.4	Cor. No. 2. Susannah lode of this survey.
1500	To Cor. No. 1, the place of beginning.
	<p>Globe</p>
	Beginning at Cor. No. 1
	Identical with Cor. No. 2 Stonewall Jackson lode of this survey.
	On line 3-4 Triangle No. 2 lode of this survey at S 8°26'W 272.6 ft. from Cor. No. 4.
	<p>A pine post, in place, 4 ins. square 3 ft. high with mound of stone, scribed S J-2-G-1-3101, whence U.S.L.M. No. 2 bears N 88°15'E 5032.2 ft.</p>
	<p>Thence S 8°26'W</p>
492.4	Intersect gulch course Southeast.
1227.4	Cor.'s No.'s 3 and 3 Triangle No. 2 and Susannah lodes of this survey.
1500	To Cor. No. 2
	On line 2-3 Susannah lode of this survey.
	Identical with Cor. No. 4 Johanner No. 2 lode of this survey heretofore described.
	<p>Thence N 79°53'W</p>
300	South end center of the location and lode.
320.24	<p>Cor. No. 3 Johanner No. 2 lode of this survey also, intersect line 4-1 Sur. No. 3098 Monte Christo lode at S 16°10'W 252.8 ft. from Cor. No. 4</p>
600	To Cor. No. 3.
	<p>A pine post, in place, 4 ins. square 3 ft. high with mound of stone, scribed G-3-3101.</p>

Feet	No bearings available.
	Thence N 9°43'E
353.85	Intersect lines 3-4 and 2-3 Sur.No.3098 Monte Christo and Southern Belle lodes at N 61°32' W 325.43 ft. and 129.43 ft. from Cor's No's 4 and 2 respectively.
1100	Intersect gulch course Southeast.
1499.4	To Cor.No.4. On line 1-2 Sur.No.3098 Southern Belle lode at N 3°50'E 1193.5 ft. from Cor.No.2. Identical with Cor.No.3 Stonewall Jackson lode of this survey. A pine post, in place, 4 ins. square, 3 ft. high with mound of stone, scribed S J-3-G-4-3101. No bearings available.
	Thence S 79°53'E
300	North end center of the location and lode.
566.27	To Cor.No.1, the place of beginning.
	Stonewall Jackson
	Beginning at Cor.No.1, On line 2-3 Triangle No.1 lode of this survey. A pine post, in place, 4 ins. square 3 ft. high with mound of stone, scribed S J-1-3101, whence U.S.L.M. NO.2 bears S 74°33'E 4990 ft.
	Thence S 8°26'W
1228	Cor's No's 2 and 4 Triangle No.1 and Triangle No.2 lodes of this survey respectively.
1500.6	To Cor.No.2. Identical with Cor.No.1, Globe lode of this survey heretofore described.
	Thence N79°53'W
266.27	South end center of the location and lode.

Feet	<p>To Cor.No.3.</p> <p>Identical with Cor.No.4,Globe lode of this survey heretofore described,also on line 1-2 Sur.No.3098 Southern Belle lode at S 3°50'W 306.5 ft.from Cor.No.1</p>
	Thence N 10°04'E
1452.32	<p>Intersect line 2-3 Sur.No.1799 Blue Jay lode at N 7°59'W 47.6 ft.from Cor.No.2.</p>
1500	<p>To Cor.No.4.</p> <p>A pine post, in place,4 ins.square 3 ft.high with mound of stone,scribed S J-4-3101.</p> <p>No bearings available.</p>
	Thence S 79°53'E
299.13	<p>Intersect line 1-2 Sur.No.1799 Blue Jay lode at N 82°01'E 299.11 ft.from Cor.No.2.</p>
300	<p>North end center of the location and lode.</p>
523.5	<p>To Cor.No.1,the place of beginning.</p>
	Susannah
	<p>Beginning at Cor.No.1.</p> <p>Identical with Cor.No.1,Copper Bottom lode of this survey.</p> <p>A pine post, in place, 4 ins.square 3 ft.high with mound of stone,scribed C B-1-S-1-3101 whence,</p> <p>A cross (X) and B R 1-1-3101 chiseled on quartz porphyry 2x4 ft.facing East bears N 82°45'W 9.9 ft.</p> <p>U.S.M.M. No.3 bears S 6°06'W 4267.4 ft.</p>
	Thence N 81°34'W
300	<p>South end center of the location and lode.</p>
600	<p>To Cor.No.2.</p> <p>On line 4-1 Johanner No.2.lode of this survey at N 8°26'E 272.6 ft.from Cor.No.1.</p> <p>A pine post,in place,4 ins.square,3 ft.high with mound of stone,scribed S-2-3101.</p> <p>No bearings available.</p>

Feet	Thence N 8°26'E
50	Intersect gulch course Southeast.
1227.4	Cor's No's 4 and 2 Johanner No2 and Globe lodes of this survey respectively.
1500	To Cor.No.3. Identical with Cor.No.3 Triangle No.2,lode of this survey.
	A pine post,in place,4 ins.square 3 ft.high with mound of stone,scribed T2-3-S-3-3101 whence,
	A cross (X) and B R 3-3-3101 chiseled on limestone 2x3 ft.facing South bears N 28°13'W 7.3 ft.
	Thence S 81°34'E
300	North end center of the location and lode.
600	To Cor.No.4. Identical with Cor's No's 2,3 and 2 Triangle No.2, Evening Star and Copper Bottom lodes of this survey respectively.
	A pine post,in place,4 ins.square 3 ft.high with mound of stone,scribed T2-2-ES-3-CB-2-S-4-3101.
	No bearings available.
	Thence S 8°26'W
1470	Intersect gulch course Southeast.
1500	To Cor.No.1 the place of beginning.
	Triangle No.2
	Beginning at Cor.No.1.
	Identical with Cor's No's 1,2 and 4 Triangle No.1, Morning Star and Evening Star lodes of this survey respectively.
	A pine post,in place,4 ins.square 3 ft.high with mound of stone,scribed T1-1-MS-2-ES-4-T2-1-3101,whence
	U.S.M.M. No.2 bears S. 89°39'E 4396.3 ft.

Feet	
	Thence S 8°26'W
870	Intersect gulch course Southeast.
1500	To Cor.No.2. Identical with Cor's No's 3,2 and 4, Evening Star, Copper Bottom and Susannah lodes of this survey respectively heretofore described.
	Thence N 81°34'W
300	South end center of the location and lode.
600	To Cor.No.3. On line 1-2 Globe lode of this survey. Identical with Cor.No.3 Susannah lode of this survey, heretofore described.
	Thence N 8°26'E
735	Intersect gulch course southeast.
1227.4	Cor's No's 1 and 2 Globe and Stonewall Jackson lodes of this survey, respectively.
1500	To Cor.No.4. Identical with Cor.No.2, Triangle No.1 lode of this survey. A pine post, in place, 4 ins, square 3 ft. high with mound of stone, scribed T1-2-T2-4-3101. No bearings available.
	Thence S 81°34'E
300	North end center of the location and lode.
600	To Cor.No.1, the place of beginning.
	Triangle No.1
	Beginning at Cor.No.1 Identical with Cor's No's 2, 4 and 1, Morning Star, Evening Star and Triangle No.2 lodes of this survey respectively heretofore described, whence U.S.L.M. No.2 bears S. 89°39'E 4396.3 ft.

Feet	Thence N 81°34'W.
300	South end center of the location and lode.
600	To Cor.No.2. On line 2-1 Stonewall Jackson lode of this survey. Identical with Cor.No.4, Triangle No.2, lode of this survey, heretofore described.
	Thence N 8°26'E
1228	Cor.No.1, Stonewall Jackson lode of this survey.
1300.59	Intersect line 1-2 Sur.No.1799 Blue Jay lode at S 82°01'W 67.29 ft. from Cor.No.1.
1500	To Cor.No.3. Identical with Cor.No.2, Impraso lode of this survey. A pine post, in place, 4 ins. square 3 ft. high with mound of stone, scribed I-2-T1-3-3101. No bearings available.
	Thence S 81°34'E
11.4	Intersect line 4-1 Sur.No.1799 Blue Jay lode at N 7°59'W 188.05 ft. from Cor.No.1.
300	North end center of the location and lode.
404	Intersect trail course Northwest to Southeast.
500	Intersect Chase Creek course Southeast.
600	To Cor.No.4. Identical with Cor's No's 1, 2, and 3 Impraso, Painted Cliff and Morning Star lodes of this survey, respectively. A pine post, in place, 4 ins. square 3 ft. high with mound of stone, scribed I-1-PC-2-MS-3-T1-4-3101, whence A cross (X) and B R 1-2-3-4-3101 chiseled on limestone 2x2 ft. facing East bears N 27°35'W 6.2 ft.
	Thence S 8°26'W.
105	Intersect Chase Creek course Southeast.
175	Intersect trail course Southeast to Northwest.

9
01

Feet	
1500	To Cor.No.1, the place of beginning.
	Impraso
	Beginning at Cor.No.1. Identical with Cor's No's 2,3 and 4 Painted Cliff, Morning Star and Triangle No.1, lodes of this survey, respectively, heretofore described.
	U.S.M.M. No.2 bears S 70°06'E 4441.3 ft.
	Thence N 81°34'W
100	Intersect Chase Creek course Southeast.
196	Intersect trail course Southeast to Northwest.
300	South end center of the location and lode.
588.6	Intersect line 4-1 Sur.No.1799 Blue Jay lode at N 7°59'W 188.05 ft. from Cor.No.1.
600	To Cor.No.2. Identical with Cor.No.3, Triangle No.1, lode of this survey heretofore described.
	Thence N 8°26'E
38.7	Cor.No.2 Bridgeport lode of this survey, also intersect line 4-1 Sur.No.1799 Blue Jay lode at N 7°59'W 228.4 ft. from Cor.No.1, Cor. No. 1 said Bridgeport lode brs. N. 82° 01' E. 374.4 ft.
1053	Intersect trail course Southeast to Northwest.
1212	Intersect Chase Creek course Southeast.
1364.2	Cor.No.4 Bridgeport lode of this survey, also intersect line 1-2 Sur.No.1799 Roswell lode at S 82°01'W 225.6 ft. from Cor.No.1. Cor.No.1 said Bridgeport lode brs. S. 7°59' E. 1271.6 ft.
1500	To Cor.No.3. A pine post, in place 4 ins. square 3 ft. high with mound of stone, scribed I-3-3101 whence, Cor.No.1, Sur.No.1799 Roswell lode bears S 63°09'E 228.07 ft.
	Thence S 81°34'E
195.16	Intersect line 4-1 Sur.No.1799 Roswell lode at N 7°59'W

Feet	75.12 ft. from Cor. No. 1.
300	North end center of the location and lode.
600	To Cor. No. 4.
	Identical with Cor. No. 3 Painted Cliff lode of this survey.
	A pine post, in place, 4 ins. square 3 ft. high with mound of stone, scribed PC-3-I-4-3101.
	No bearings available.
	Thence S 8°26'W
1500	To Cor. No. 1, the place of beginning.
	Copper Bottom
	Beginning at Cor. No. 1.
	Identical with Cor. No. 1, Susannah lode of this survey heretofore described.
	U.S.M.M. No. 3 bears S 6°06'W 4267.4 ft.
	Thence N 8°26'E
30	Intersect gulch course Southeast.
1500	To Cor. No. 2.
	Identical with Cor.'s No's 4, 2 and 3 Susannah, Triangle No. 2 and Evening Star lodes of this survey respectively heretofore described.
	Thence S 81°34'E.
300	North end center of the location and lode.
600	To Cor. No. 3.
	Identical with Cor. No. 2, Evening Star lode of this survey
	On line 3-4 Cata Mount lode of this survey.
	A pine post, in place 4 ins. square 3 ft. high with mound of stone, scribed ES-2-CB-3-3101.
	U.S.L.M. No. 2 brs. N. 69° E. 4309 ft.
	No bearings available.
	Thence S 8°26'W
587.7	Intersect gulch course Southeast.

Feet	
1027.7	Cor.No.3,Catal Mount lode of this survey.
1500	To Cor.No.4.
	A pine post,in place,4 ins.square 3 ft.high with mound of stone,scribed CB-4-3101 whence,
	A cross (X) and B R chiseled on Quartz porphyry 5x6 ft. facing South bears N 8°31'W 2.7 ft.
	Thence N 81°34'W
300	South end center of the location and lode.
314	Intersect gulch course Southeast.
600	To Cor.No.1,the place of beginning.
	Evening Star
	Beginning at Cor.No.1.
	Identical with Cor's No's 1,2 and 4 Morning Star,Blue Goose and Square Fraction lodes of this survey respectively
	A pine post,in place,4 ins.square 3 ft.high with mound of stone,scribed MS-1-BG-2-SF-4-ES-1-3101 whence, U.S.L.M. No.2 bears N 89°05'E 3803.2 ft.
	Thence S 8°26'W
1021.7	Intersect gulch course East.
1027.7	Cor's No's 3 and 4 Square Fraction and Cata Mount lodes of this survey,respectively
1500	To Cor.No.2.
	Identical with Cor.No.3 Copper Bottom lodes of this survey heretofore described.
	Thence N 81°34'W
300	South end center of the location and lode.
600	To Cor.No.3.
	Identical with Cor's No's 2,4 and 2 Copper Bottom, Susannah and Triangle No.2,lodes of this survey, respectively,heretofore described.

Feet	
	Thence N 8°26'E
630	Intersect gulch course Southeast.
1500	To Cor.No.4. Identical with Cor's No's 1,1 and 2 Triangle No.2, Triangle No.1, and Morning Star lodes of this survey, respectively, heretofore described.
	Thence S 81°34'E
300	North end center of the location and lode.
600	To Cor.No.1 the place of beginning.
	Morning Star
	Beginning at Cor.No.1. Identical with Cor's No's 2,4 and 1 Blue Goose, Square Fraction and Evening Star lodes of this survey, respec- tively, heretofore described. U.S.N.M. No.2 bears N 89°05'E 3803.2 ft.
	Thence N 81°34'W
300	South end center of the location and lode.
600	To Cor.No.2. Identical with Cor's No's 4,1 and 1 Evening Star, Triangle No.2 and Triangle No.1 lodes of this survey, respectively, heretofore described.
	Thence N 8°26'E
1325	Intersect trail course Northwest to Southeast.
1395	Intersect Chase Creek course Southeast.
1500	To Cor.No.3. Identical with Cor's No's 4,1 and 2 Triangle No.1, Impraso and Painted Cliff lodes of this survey, respectively, heretofore described.
	Thence S 81°34'E
300	North end center of the location and lode.

Feet	
600	To Cor.No.4. Identical with Cor's No's 1,2 and 3 Painted Cliff, Marescal and Blue Goose lodes of this survey respec- tively. A pine post,in place,4 ins.square 3 ft.high with mound of stone,scribed PC-1-M-2-BG-3-MS-4-3101. No bearings available. Thence S 8°26'W
350	Intersect Chase Creek course Southeast.
535	Intersect Chase Creek course Southwest
905	Intersect trail course Southeast to Northwest.
970	Intersect Chase Creek course Southeast.
1500	To Cor.No.1 the place of beginning. Painted Cliff Beginning at Cor.No.1. Identical with Cor's No's 2,3 and 4 Marescal,Blue Goose and Morning Star lodes of this survey respectively, heretofore described,whence U.S.L.M. No.2 bears S 68°20'E 3855 ft. Thence N 81°34'W
300	South end center of the location and lode.
600	To Cor.No.2. Identical with Cor's No's 3,4 and 1 Morning Star, Triangle No.1 and Impraso lodes of this survey,respec- tively,heretofore described. Thence N 8°26'E
1500	To Cor.No.3. Identical with Cor.No.4,Impraso lode of this survey heretofore described. Thence S 81°34'E
300	North end center of the location and lode.

Feet	
600	<p>To Cor.No.4.</p> <p>Identical with Cor.No.3 Marescal lode of this survey.</p> <p>A pine post,in place,4 ins.square 3 ft.high with mound of stone,scribed M-3-PC-4-3101.</p> <p>No bearings available.</p> <p style="text-align: center;">Thence S 8°26'W</p>
1 500	<p>To Cor.No.1,the place of beginning.</p> <p style="text-align: center;">Cata Mount</p> <p>Beginning at Cor.No.1.</p> <p>On line 3-4 Blue and Gray lode of this survey,at S 8°26'W 12.9 ft.from Cor.No.4.- - -</p> <p>Identical with Cor.No.2 Square Fraction lode of this survey.</p> <p>A pine post in place,4 ins.square 3 ft.high with mound of stone,scribed SF-2-CM-1-3101 whence,</p> <p>U.S.L.M. No.2 bears N 70°53'E 3555.1 ft.</p> <p style="text-align: center;">Thence S 8°26'W</p>
7	Intersect gulch course Northeast.
1 448	Cor.No.3,Blue and Gray lode of this survey.
1500	<p>To Cor.No.2.</p> <p>A pine post,in place,4 ins.square 3 ft.high with mound of stone,scribed CM-2-3101 whence,</p> <p>A cross (X) and B R 2-3101 chiseled on quartz porphyry 2x6 ft.facing West bears N 55°11'E 18.8 ft.</p> <p style="text-align: center;">Thence N 81°34'W</p>
300	South end center of the location and lode.
410	Intersect gulch course South. -
600.	<p>To Cor.No.3.</p> <p>On line 3-4 Copper Bottom lode of this survey.</p> <p>A pine post,in place,4 ins.square 3 ft.high with mound of stone,scribed CM-3-3101,whence,</p>

A cross (X) and B R 3-3101 chiseled on quartz porphyry
2x3 ft. facing East bears N 58°29'W 21.8 ft.

, Thence N 8°26'E

440 Intersect gulch course Southeast.
1027.7 Cor's No's 3 and 2 Copper Bottom and Evening Star lodes
of this survey respectively.
1500 To Cor. No. 4.
On line 1-2 Evening Star lode of this survey.
Identical with Cor. No. 3 Square Fraction lode of this
survey.
A pine post, in place, 4 ins. square 3.5 ft. high with mound
of stone, scribed SF-3-CM-4-3101.
No bearings available.

Thence S 81°34'E

300 North end center of the location and lode.
475 Intersect gulch course Southeast.
600 To Cor. No. 1 the place of beginning.

Square Fraction

Beginning at Cor. No. 1 .
Identical with Cor. No. 1 Blue Goose lode of this survey.
A pine post, in place, 4 ins. square 3 ft. high with mound
of stone, scribed BG-1-SF-1-3101 whence,
A cross (X) and B R 1-1-3101 chiseled on quartz porphyry
2x2.5 ft. facing Northeast bears S 22°W 16.7 ft.
U.S.L.M. No. 2 bears N 87°21'E 3212.6 ft.

Thence S 8°26'W

460.7 Intersect line 2-3 and 17-18 Sur. No. 2484 Black Cat Mine
lode and Sur. No. 1088 Garfield lode at S 67°26'E 116.01
ft. from Cor's No's 3 and 18 respectively.
825.56 Intersect line 18-19 Sur. No. 1088 Garfield lode at
S 7°32'E 408.96 ft. from Cor. No. 18.
1014.8 Cor. No. 4 Blue and Gray lode of this survey.

Feet	
1027.7	<p>To Cor.No.2.</p> <p>On line 3-4 Blue and Gray lode of this survey.</p> <p>Identical with Cor.No.1,Cata Mount lode of this survey, heretofore described.</p>
Thence N 81°34'W	
125	Intersect gulch course Southeast.
300	South end center of the location and lode.
600	<p>To Cor.No.3.</p> <p>Identical with Cor.No.4 Cata Mount lode of this survey heretofore described.</p>
Thence N 8°26'E	
6	Intersect gulch course East
1027.7	<p>To Cor.No.4.</p> <p>Identical with Cor's No's 1,1 and 2 Evening Star, Morning Star and Blue Goose lodes of this survey, respectively, heretofore described.</p>
Thence S 81°34'E	
300	North end center of the location and lode.
586.39	<p>Intersect line 3-4 Sur.No.2484 Black Cat Mine lode at N 21°19'E 443.58 ft.from Cor.No.3.</p>
600	To Cor.No.1, the place of beginning.
Blue Goose	
<p>Beginning at Cor.No.1.</p> <p>Identical with Cor.No.1, Square Fraction lode of this survey heretofore described, whence</p> <p>U.S.L.M. No.2 bears N 87°21'E 3212.6 ft.</p>	
Thence N.81°34'W.	
13.61	<p>Intersect line 3-4 Sur.No.2484 Black Cat Mine lode at S 21°19'W 156.42 ft.from Cor.No.4.</p>
300	South end center of the location and lode.
600	<p>To Cor.No.2.</p> <p>Identical with Cor's No's 4,1 and 1 Square Fraction</p>

Feet	
	Evening Star and Morning Star lodes of this survey respectively heretofore described.
	Thence N 8°26'E
530	Intersect Chase Creek course Southeast.
595	Intersect trail course Northwest to Southeast.
965	Intersect Chase Creek course Southwest.
1150	Intersect Chase Creek course Southeast.
1500	To Cor.No.3.
	Identical with Cor's No's 4,1 and 2 Morning Star, Painted Cliff and Marescal lodes of this survey, respectively heretofore described.
	Thence S 81°34'E
300	North end center of the location and lode.
599.78	Intersect line 3-4 Sur.No.1087 Limestone lode at N 8°43'E 891.63 ft.from Cor.No.4.
600	To Cor.No.4.
	Identical with Cor.No.1, Marescal lode of this survey. A pine post, in place 4 ins.square 3 ft.high with mound of stone, scribed M-1-BG-4-3101.
	No bearings available.
	Thence S 8°26'W
892.43	Intersect line 4-1 and 4-1 Sur.No.1087 Limestone lode and Sur.No.2484 Sta Cruz lode at S 71°36'E 4.7 ft. from Cor's No's 4 and 4.
974.41	Intersect line 3-4 Sur.No.2484 Sta Cruz lode at S 5°14'W 82.93 ft. from Cor.No.4.
1440.5	Intersect line 3-4 Sur.No.2484 Black Cat Mine lode at S 21°19'W 95.4 ft. from Cor. No.4.
1445	Intersect Chase Creek course Southeast.
1460	Intersect trail course Southeast to Northwest.
1500	To Cor.No.1, the place of beginning.

Marescal

Beginning at Cor.No.1.

Identical with Cor.No.4, Blue Goose-lode of this survey, heretofore described.

U.S.L.M. No.2 bears S 65°56'E 3273.8 ft.

Thence N 81°34'W

0.22 Intersect line 3-4 Sur.No.1087 Limestone lode at S 8°43'W 550.77 ft.from Cor.No.3.

300 South end center of the location and lode.

600 To Cor.No.2.

Identical with Cor's No's 3,4 and 1, Blue Goose, Morning Star and Painted Cliff lodes of this survey, respectively heretofore described.

Thence N 8°26'E

1500 To Cor.No.3.

Identical with Cor.No.4, Painted Cliff lode of this survey, heretofore described.

Thence S 81°34'E

300 North end center of the location and lode.

600 To Cor.No.4.

A pine post, in place, 4 ins. square 3 ft. high with mound of stone, scribed M-4-3101.

No bearings available.

Thence S 8°26'W

534.24 Intersect line 2-3 Sur.No.3100 Stella No.2 lode at N 29°35'E 521.28 ft.from Cor.No.2.

1 026.8 Intersect line 1-2 Sur.No.3100 Stella No.2 lode at S 79°37'E 188.2 ft.from Cor.No.2.

1 445.83 Intersect line 3-4 Sur.No.1087 Limestone lode at S 8°43'W 506.6 ft.from Cor.No.3.

1500 To Cor.No.1, the place of beginning.

Feet	Blue and Gray
	<p>Beginning at Cor.No.1.</p> <p>On line 19-20 Sur.No.1088 Garfield lode at S 68°21'E 289.57 ft.from Cor.No.19.</p> <p>Identical with Cor.No.4 Sur.No.2484 Camino No.2 lode. A pine post in place,4x6 ins.3 ft.high with mound of stone,scribed BL GR-1-3101,whence, U.S.L.M. No.2 bears N 67°06'E 3292.9 ft.</p> <p style="text-align: center;">Thence S 9°38'W</p>
1454.1	<p>To Cor.No.2.</p> <p>Identical with Cor.No.3,Sur.No.2484 Camino No.2 lode. A pine post in place,4x6 ins.3 ft.high with mound of stone,scribed BL GR-2-3101,whence, A cross (X) and B R 2-3101 chiseled on quartz porphyry 2x3 ft.facing East bears N 71°W 7.4 ft.</p> <p style="text-align: center;">Thence N 68°21'W</p>
152.8	<p>South end center of the location and lode.</p>
318	<p>To Cor.No.3.</p> <p>On line 1-2 Cata Mount lode of this survey at N 8°26'E 52 ft.from Cor.No.2.</p> <p>A pine post,in place,4 ins.square 3 ft.high with mound of stone,scribed BL GR-3-3101.</p> <p>No bearings available.</p> <p style="text-align: center;">Thence N 8°26'E</p>
1441	<p>Intersect gulch course East.</p>
1448	<p>Cor's No's 1 and 2 Cata Mount and Square Fraction lodes of this survey respectively.</p>
1460.9	<p>To Cor.No.4.</p> <p>On line 1-2 Square Fraction lode of this survey.</p> <p>A pine post,in place 4 ins.square 3 ft.high with mound of stone,scribed BL GR-4-3101</p> <p>No bearings available.</p>

Thence S 68°21'E

12 Intersect gulch course Northeast.
 59.63 Cor.No.19 Sur.No.1008 Garfield lode
 165.2 North end center of the location and lode.
 349.2 To Cor.No.1, the place of beginning.

Bridgeport

Beginning at Cor.No.1.

A pine post, in place, 4 ins. square 3 ft. high with mound of stone, scribed B-1-3101, whence,
 U.S.L.M. No.2 bears S 68°58'E 4707 ft.

Thence S 82°01'W.

15 Intersect trail course Southeast to Northwest.
 154.4 South end center of the location and lode.
 374.4 To Cor.No.2.
 On line 2-3 Impraso lode of this survey, at N 8°26'E 38.7 ft. from Cor.No.2, also on line 4-1 Sur.No.1799 Blue Jay lode at N 7°59'W 228.4 ft. from Cor.No.1.
 A pine post, in place, 4 ins. square 3 ft. high with mound of stone, scribed B-2-3101.
 No bearings available.

Thence N 7°59'W

1271.6 To Cor.No.3.
 Identical with Cor's No's 4, 1 and 2 Sur.No.1799 Blue Jay, Guigante and Roswell lodes of this survey respectively.
 A pine post, in place, 4 ins. square 3.5 ft. high with mound of stone, scribed B-3-3101, whence
 A cross (X) and B.R 3-3101 chiseled on granite 4x6 ft. facing Northeast bears S 29°35'E 33.8 ft.

Thence N 82°01'E

220 North end center of the location and lode.

Feet	
280	Intersect trail course Southeast to Northwest.
322	Intersect Chase Creek course Southeast.
374.4	To Cor.No.4.
	On line 2-3 Impraso lode of this survey at S 8°26'W and N.8° 26' E. 1364.2 ft. from Cor. No.2, 135.8 from Cor.No.3, also on line 1-2 Sur.No.1799
	Rosswell lode at S 82°01'W 225.6 ft. from Cor.No.1.
	Thence S 7°59' E
320	Intersect Chase Creek course Southeast.
1271.6	To Cor.No.1, the place of beginning.
	Variation at all corners 13°40' E
	LODE LINES
	As near as can be determined from present develop- ments the veins of the several locations embraced in this claim extend as follows from their respective discovery points:
	Johanner-No.2 lode, 1500 ft. N8°26' E.
	Globe lode, 1499.4 ft. S 9°43' W.
	Stonewall Jackson lode, 10 ft. S 10°04' W and 1490 ft. N 10°04' E.
	Susannah lode, 260 ft. N 8°26' E and 1240 ft. S 8°26' W.
	Triangle No.2 lode, 750 ft. N 8°26' E and 750 ft. S 8°26' W.
	Triangle No.1 lode, 650 ft. S 8°26' W and 850 ft. N 8°26' E.
	Impraso lode, 800 ft. S 8°26' W and 700 ft. N8°26' E.
	Copper Bottom lode, 60 ft. N8°26' E and 1440 ft. S8°26' W.
	Evening Star lode, 270 ft. S 8°26' W and 1230 ft. N 8°26' E.
	Morning Star lode, 590 ft. N 8°26' E and 910 ft. S 8°26' W.
	Painted Cliff lode, 51 ft. S 8°26' W and 1449 ft. N 8°26' E.
	Cata Mount lode, 10 ft. N8°26' E and 1490 ft. S 8°26' W.
	Square Fraction lode, 200 ft. S 8°26' W and 827.7 ft. N8°26' E.
	Blue Goose lode, 150 ft. S8°26' W and 1350 ft. N 8°26' E.
	Marescal lode, 8 ft. S 8°26' W and 1492 ft. N 8°26' E.
	Blue and Gray lode, 40 ft. N8°26' E and 1420.9 ft. S 8°26' W.
	Bridgeport lode, 102 ft. N 7°59' W and 1169.6 ft. S 7°59' E.

AREAS.

	Acres
Total area Johanner No.2 lode-----	14.516
Total area Globe lode-----	20.072
Area in conflict with-	
Sur.No.3098, Monte Christo lode-----	2.059
Sur.No.3098, Southern Belle lode---	1.611
Total area Stonewall Jackson lode-----	18.763
Area in conflict with-	
Sur.No.1799 Blue Jay lode-----	0.327
Total area Susannah lode-----	20.661
Total area Triangle No.2 lode-----	20.661
Total area Triangle No.1 lode -----	20.661
Area in conflict with-	
Sur.No.1799 Blue Jay lode -----	0.171
Total area Impraso lode-----	20.661
Area in conflict with-	
Sur.No.1799 Blue Jay lode -----	0.005
Sur.No.1799 Rosswell lode-----	0.499
Bridgeport lode of this survey----	5.466
Total area Copper Bottom lode -----	20.661
Total area Evening Star lode-----	20.661
Total area Morning Star lode-----	20.661
Total area Painted Cliff lode -----	20.661
Total area Cata Mount lode-----	20.661
Total area Square Fraction lode-----	14.156
Area in conflict with-	
Sur.No.1088 Garfield lode-----	0.471
Sur.No.2484 Black Cat Mine lode---	0.663

Total area Blue Goose lode -----20.661

Area in conflict with-

Sur.No.2484 Black Cat Mine lode---0.009

Sur.No.2484 State Cruz lode-----0.004

Sur.No.1087 Limestone lode-----0.050

Total area Marescal lode-----20.661

Area in conflict with-

Sur.No.1087 Limestone lode-----0.000+

Sur.No.3100 Stella No.2 lode-----1.063

Total area Blue and Gray lode-----10.892

Total area Bridgeport lode-----10.929

LOCATION

This survey is located in the Copper Mountain and Greenlee Gold Mountain Mining Districts, Greenlee County Arizona, approximately in Sec's 28, 29, 32 and 33 T 3 S R 29 E unsurveyed, G & S.R.B.M.

EXPENDITURE OF FIVE HUNDRED DOLLARS

I certify that the value of the labor and improvements made upon, or for the benefit of, each of the locations embraced in said mining claim by the claimant or its grantors is not less than five hundred dollars and that said improvements consist of:

Johanner No.2

No.1. The discovery showing mineral in place is on the lode line at the south end.

No.2. An open cut the mouth of which bears from a point, on line 2-3, 260.5 ft., from Cor.No.2, N 29°30'E 263 ft., 5x10 ft., running N 29°E 15 ft.

Value -----\$100.00

Note: An undivided 1/17 interest in the No.2 tunnel on the Blue Goose lode is accredited to this lode.

Value 1/17 interest 1492.00

Globe

No.1.The discovery showing mineral in place is on the lode line at the north end.

No.2.A tunnel the mouth of which bears from the north end center S 30°15'E 323 ft., 5x6 ft., running N 34°35'E 17 ft., thence N 53°30'E 22 ft., thence N 10°15'E 35 ft., thence N 0°30'W 25 ft., thence N 22°30'W 36 ft., thence N 27°E 44 ft., thence N 19°W 26 ft., thence N 50°15'E 36 ft., thence N 0°20'W 44 ft., thence N 39°30'W 19 ft., thence N 16°15'E 82 ft., thence N 35°50'E 46 ft., thence N 6°15'W 19 ft., thence N 26°45'E 88 ft., thence N 59°15'E 18 ft., thence N 19°50'E 48 ft., thence N 13°25'E 38 ft., thence N 47°E 35 ft., thence N 10°40'E 21 ft., thence N 44°15'E 38 ft., thence N 19°30'W 19 ft., thence N 10°30'E 32 ft. Value \$7880.00

Value first 285 ft.-----\$2850.00

Note:The remainder of this tunnel is on the Stonewall Jackson, Triangle No.2 and Triangle No.1 lodes and the part that is on each of said lodes is accredited thereto

Note:An undivided 1/17 interest in the No.2 tunnel on the Blue Goose lode is accredited to this lode.

Value 1/17 interest-----\$1492.00

Stonewall Jackson

No.1.The discovery showing mineral in place is on the lode line 10 ft., from line 2-3.

No.2.A tunnel with an open cut approach to the mouth of which bears from the South end center N 35°18'E 505 ft., 5x10ft., cut, running S 71°53'E 25 ft., and 5x6 ft. tunnel 80 ft.

Value first 35 ft.-----\$350.00

Note:The last 70 ft., of this tunnel is on the Triangle No.1 lode and is accredited thereto.

Note:219 ft. of the No.2 tunnel on the Globe lode is on this lode and is hereto accredited

Value of 219 ft.-----\$2190.00

Note: An undivided 1/17 interest in the No. 2 tunnel on the Blue Goose lode is accredited to this lode.

Value 1/17 interest ----- \$1492.00

Susannah

No. 1. The discovery showing mineral in place is on the lode line 260 ft. from line 3-4.

No. 2. An open cut the mouth of which bears from Cor. No. 3 S 23° E 371 ft., 5x10 ft. running N 20° E 18 ft.

Value ----- \$100.00

Note: An undivided 1/17 interest in the the No. 2 tunnel on the Blue Goose lode is accredited to this lode.

Value 1/17 interest ----- \$1492.00

Triangle No. 2

No. 1. The discovery showing mineral in place is on the lode line 750 ft. from line 4-1.

Note: 73 ft. of the No. 2 tunnel on the Globe lode is on this lode and is hereto accredited.

Value 73 ft. ----- \$730.00

Note: An undivided 1/17 interest in the the No. 2 tunnel on the Blue Goose lode is accredited to this lode.

Value 1/17 interest ----- \$1492.00

Triangle No. 1

No. 1. The discovery showing mineral in place is on the lode line 650 ft. from line 1-2.

No. 2. A tunnel the mouth of which bears from Cor. No. 4 S 22° 45' W 425 ft., 5x6 ft., running S 25° W 90 ft. At 85 ft. from the mouth a cross cut 5x6 ft. bears N 65° W 43 ft., and one also bears S 65° E 20 ft.

Value ----- \$1530.00

Note: The last 70 ft. of the No. 2 tunnel on the Stonewall Jackson lode is on this lode and is hereto accredited.

Value last 70 ft. ----- \$700.00

Note: The last 42 ft. of the No. 2 tunnel on the Morning Star lode is on this lode and is hereto accredited.

Value last 42 ft. ----- \$420.00

Note: The last 211 ft. of the No. 2 tunnel on the Globe lode is on this lode and is hereto accredited.

Value last 211 ft. ----- \$2110.00

Note: An undivided 1/17 interest in the No. 2 tunnel on the Blue Goose lode is on this lode and is hereto accredited.

Value 1/17 interest ----- \$1492.00

Impraso

No. 1. The discovery showing mineral in place is on the lode line 700 ft. from line 3-4.

No. 2. An open cut, the mouth of which bears from the South end center N 33° 10' E 350 ft., 5x10 ft. running S 30° E. 15 ft.

Value ----- \$75.00

Note: An undivided 1/17 interest in the No. 2 tunnel on the Blue Goose lode is accredited to this lode.

Value 1/17 interest ----- \$1492.00

Copper Bottom

No. 1. The discovery showing mineral in place is on the lode line 60 ft. from line 2-3.

No. 2. An open cut the mouth of which bears from the North end center S 61° E 155 ft., 15x15 ft. running S 55° W 30 ft.

Value ----- \$200.00

Note: The last 588 ft. of the No. 2 tunnel on the Evening Star lode is on this lode and is hereto accredited.

Value last 588 ft. ----- \$5880.00

Note: An undivided 1/17 interest in the No. 2 tunnel on the Blue Goose lode is on this lode and is hereto accredited.

Value 1/17 interest ----- \$1492.00

Evening Star

No.1. The discovery showing mineral in place is on the lode line 270 ft. from line 2-3

No.2. A tunnel the mouth of which bears from Cor. No. 3 N 44°24'E 245 ft. 5x6 ft., running S 7°30'W 234 ft., thence S 73°E 49ft., thence S 37°W 94 ft., thence S 41°W 41 ft., thence S 18°W 77 ft. At 283 ft. from the mouth a cross cut 5x6 ft. bears S 73°E 75 ft., and at 477 ft. from the mouth a cross cut 5x6 ft. bears S 78°E 148 ft. and one of the same dimensions bears N 78°W 70 ft.

Value \$7880.00

Value of first 200 ft.----- \$2000.00

Note: The last 588 ft. of this tunnel is on the Copper Bottom lode and is thereto accredited.

Morning Star

No.1. The discovery showing mineral in place is on the lode line 590 ft. from line 3-4.

No.2. A tunnel with an open cut approach to, the mouth of which bears from Cor. No. 4 S 41°44'W 852.3 ft. 5x10ft. running N 73°40'W 13 ft. and 5x6 ft. tunnel 126 ft., thence N 87°W 32 ft. Value \$1710.00

Value first 129 ft.----- \$1290.00

Note: The last 42 ft., of this tunnel is on the Triangle No. 1 lode and is thereto accredited.

Painted Cliff

No.1. The discovery showing mineral in place is on the lode line 51 ft. from line 1-2

No.2. A shaft the center of which bears from the South end center N 19°W 72 ft., 4x8 ft., 10 ft., deep.

Value ----- \$80.00

Note: An undivided 1/17 interest in the No. 2 tunnel on the Blue Goose lode is accredited to this lode

Value 1/17 interest----- \$1492.00

Cata Mount

No.1.The discovery showing mineral in place is on the lode line 10 ft.from line 4-1.

No.2.A tunnel with an open cut approach to the mouth of which bears from a point on the side line 1027.7 ft. from Cor.No.3,S 42°41'E 284 ft.5x10 ft.cut running S 21°40'W 50ft.and 5x6 ft.tunnel 50 ft.

Value----- \$1000.00

Note:An undivided 1/17 interest in the No.2 tunnel on the Blue Goose lode is accredited to this lode.

Value 1/17 interest----- \$1492.00

Square Fraction

No.1.The discovery showing mineral in place is on the lode line 200 ft.from line 2-3.

Note:An undivided 1/17 interest in the No.2 tunnel on the Blue Goose lode is accredited to this lode.

Value 1/17 interest----- \$1492.00

Blue Goose

No.1.The discovery showing mineral in place is on the lode line 150 ft.from line 1-2.

No.2.A tunnel the mouth of which bears from Cor.No.1 N 51°50'W 299 ft.,6x7 ft.running S ^{71°}42°50'W 691 ft., thence N 66°53'W 192.5 ft.,thence N 73°09'W 207.5 ft., thence N 82°24'W 213 ft.,thence N 81°W 173 ft.,thence N 71°W 131 ft.At a point 236 ft.from the mouth of said tunnel a cross cut 6x7 ft.,bears S 24°10'W 145 ft., thence S 18°56'E 45 ft.,thence S 11°35'E 71 ft.,thence S 2°W 35 ft.,thence S 20°35'W 25 ft.,thence S 24°25'E 100 ft.,thence S 15°W 24 ft.,thence S 39°05'W 164 ft., thence S 75°45'W 97 ft.,thence S 79°50'W 115 ft.,

Value \$25364.00

Value 1/17 interest----- \$1492.00

Note:An undivided 1/17 interest in this working is accredited to each of the 17 lodes embraced in said mining claim as hereinafter explained.

No.3.A shaft the center of which bears from Cor.No.1
N 27°47'W 465 ft., 5x8 ft., 150 ft. deep

Value-----\$3750.00

Marescal

No.1:The discovery cut the mouth of which is on the
lode line 8 ft., from line 1-2 5x8 ft., running N 45°E
15 ft.

Value -----\$50.00

No.2.An open cut the mouth of which bears from Cor.No.1
N 59°W 92 ft., 7x8 ft., running S 81°E 16 ft.

Value-----\$100.00

Note:An undivided 1/17 interest in the No.2 tunnel on
the Blue Goose lode is accredited to this lode.

Value 1/17 interest-----\$1492.00

Blue and Gray

No.1.The discovery shaft is on the lode line 40 ft.
from line 4-1 6x6 ft., 10 ft. deep

Value-----\$100.00

No.2.A shaft the center of which bears from the North
end center S 11°E 375 ft., 6x6 ft., 50 ft., deep.

Value-----\$500.00

Note:An undivided 1/17 interest in the No.2 tunnel on
the Blue Goose lode is accredited to this lode.

Value 1/17 interest-----\$1492.00

Bridgeport

No.1.The discovery cut the mouth of which is on the
lode line 102 ft. from line 3-4 5x10 ft., running
S 55°W 31 ft.

Value-----\$150.00

Note:An undivided 1/17 interest in the No.2 tunnel on
the Blue Goose lode is accredited to this lode.

Value 1/17 interest-----\$1492.00

This claim lies about 1 1/2 miles North of Metcalf Arizona. Chase Creek runs through it and is the only means of egress. A good wagon road extends from Metcalf along Chase Creek to the Garfield lode Sur. No. 1088. From this road a good trail follows Chase Creek through the claim. Owing to the natural topography of the country, which is very rough, each of the seventeen lodes embraced in this claim can be advantageously developed by means of the No. 2 tunnel on the Blue Goose lode. The entire surface of all the lodes is above this tunnel except the Blue Goose, Square Fraction, Cata Mount and Blue and Gray lodes and the most of these four lodes is above it. All of the seventeen lodes can be developed by means of this tunnel at a depth varying from 200 to 1000 ft. which fact makes the No. 2 tunnel on the Blue Goose lode a good common improvement for each lode embraced in this mining claim.

ADJOINING LODES

The adjoining lodes are, on the North, Roswell lode Sur. No. 1799 Detroit Copper Mining Co. of Arizona claimant; on the East, Stella No. 2 lode Sur. No. 3100, Sta. Cruz, Black Cat Mine, and Camino No. 2 lodes Sur. No. 2484, The Arizona Copper Co. claimant, Limestone lode Sur. No. 1087 and Garfield lode Sur. No. 1088 Shannon Copper Co. claimant; on the South by unknown lodes unsurveyed, J. Leszynsky claimant, on the west Monte Christo No. 2, Monte Christo and Southern Belle lodes Sur. No. 3098 and Blue Jay lode Sur. No. 1799 Detroit Copper Mining Co. of Arizona claimant.

INSTRUMENT

This survey was made with a Buff and Berger light mountain transit. The courses were deflected from the true meridian as determined by Polaris observations. The distances were measured with 5, 50, and 500 ft. steel tapes.

REPORT

U.S.L.M.No.2 is a pine post 6 ins.square properly set and scribed.

U.S.M.M. No.3 is a pine post 6 ins.square properly set and scribed.

Sur.No.3098, Monte Christo, Monte Cristo No.2 and Southern Belle lodes:

All corners are pine posts properly set and scribed except Cor.No.3 Monte Christo No.2 lode and Cor.No.1 Southern Belle lode, both of which are stones properly set and scribed.

Sur.No.1799 Blue Jay, Guigante and Roswell lodes:

All corners are pine posts properly set and scribed.

Sur.No.3100 Stella No.2 lode:

Corners 2 and 3 are pine posts and corners 1 and 4 are redwood posts, properly set and scribed.

Sur.No.1087 Limestone lode:

All corners are pine posts properly set and scribed.

Sur.No.1088 Garfield lode:

All corners are pine posts properly set and scribed.

Sur.No.2484 Sta. Cruz, Black Cat Mine and Camino No.2 lodes:

All corners are pine posts properly set and scribed.

The differences between these field notes and the returns on Sur.No.'s 1087, 1088, 1799 and 2484 are due to errors in the latter.

The differences between these field notes and the location certificates are due to errors in the latter. The survey of each lode of this location is identical with the respective amended location certificates as staked upon the ground.

All end centers are pine posts except the ones for the Blue and Gray and the Bridgeport lodes which are mounds of stones.

E. J. Mott
U.S. MINERAL SURVEYOR.

FINAL OATHS FOR SURVEYS.

LIST OF NAMES.

A list of the names of the individuals employed by E. T. Morton

United States ~~Deputy~~ Mineral Surveyor, to assist in running, measuring, and marking the lines, corners, and

boundaries described in the foregoing field notes of the survey of the mining claim of

Stevens Copper Mining Company

known as the Johanner No. 2, Globe, Stonewall Jackson, Susannah, Triangle No. 2, Triangle No. 1, Impraso, Copper Bottom, Evening Star, Morning Star, Painted Cliff, Cata Mount, Square Fraction, Blue Goose, Marescal, Blue and Gray, Bridgeport and showing the respective capacities in which they acted.

L. M. Greenstein, Chainman.

J. L. Awalt, Chainman.

Drue Underwood, Axman.

_____, Flagman.

FINAL OATHS OF ASSISTANTS.

We, L. M. Greenstein, J. L. Awalt

and Drue Underwood, do solemnly swear that we assisted E. T. Morton

_____, United States ~~Deputy~~ Mineral Surveyor, in marking the corners and surveying

the boundaries of the mining claim of Stevens Copper Mining Company

known as the Johanner No. 2, Globe, Stonewall Jackson, Susannah, Triangle No. 2, Triangle No. 1, Impraso, Copper Bottom, Evening Star, Morning Star, Painted Cliff, Cata Mount, Square Fraction, Blue Goose, Marescal, Blue and Gray, Bridgeport represented in the foregoing field notes as having been surveyed by said ~~deputy~~ mineral surveyor and under his

direction; and that said survey has been in all respects, to the best of our knowledge and belief, faithfully and

correctly executed, and the corner and boundary monuments established according to law and the instructions

furnished by the United States Surveyor-General for Arizona

L. M. Greenstein, Chainman.

J. L. Awalt, Chainman.

Drue Underwood, Axman.

_____, Flagman.

Subscribed and sworn to by the above-named persons before me this 18th

day of October, 1903

June 2/16

[Signature]
Notary Public

My commission expires

(4-686.)

FINAL OATH OF U. S. ~~DEPUTY~~ MINERAL SURVEYOR.

I, E.T. Morton, U. S. ~~Deputy~~ Mineral Surveyor, do solemnly swear that, in pursuance of instructions received from the United States Surveyor General for Arizona, dated October 7, 1913, I have, in strict conformity to the laws of the United States, the official regulations and instructions thereunder, and the instructions of said Surveyor General, faithfully and correctly executed the survey of the Mining Claim of Stevens Copper Mining Company

Johanner No. 2, Globe, Stonewall Jackson, Susannah, Triangle No. 2, Triangle No. 1, Impraso, Copper Bottom, Evening Star, Morning Star, Painted Cliff, Cata Mount, Square Fraction, Blue Goose, Marescal, Blue and Gray, Bridgeport. situate in Copper Mountain and Greenlee Gold Mountain Mining Districts,

Greenlee County, Arizona, in Sections 28, 29, 32, 33 Township No. 3 S., Range No. 29 E. Uns., G. & S. R. E. M. and designated as Survey No. 3101

as represented in the foregoing field notes, which accurately show the boundaries of said mining claim as distinctly marked by monuments on the ground, and described in the attached copy of the location certificate, which was received by me from the Surveyor General with said instructions, and that all the corners of said survey have been established and perpetuated in strict accordance with the law, official regulations and instructions thereunder; and I do further solemnly swear that the foregoing are the true and original field notes of said survey and my report therein, and that the labor expended and improvements made upon said mining claim by claimant or its grantors are as therein fully stated, and that the character, extent, location and itemized value thereof are specified therein with particularity and full detail, and that no portion of said labor or improvements so credited to this claim has been included in the estimate of expenditures upon any other claim.

E.T. Morton
U. S. ~~Deputy~~ Mineral Surveyor.

Subscribed and sworn to by the said

U. S. ~~Deputy~~ Mineral Surveyor, before me

day of Oct - 1913

this 18th

E.T. Morton
Notary Public

BY COMMISSION EXPIRES Feb 28 1916.

AMENDED NOTICE OF LOCATION—Lode Claim

To all Whom it may Concern:

This mining claim, the name of which is the Johanner No. 2 Mining Claim, situate on lands belonging to the United States of America, and in which there are valuable mineral deposits, was entered upon and amended for the purpose of exploration and purchase by Stevens Copper Mining Co.

the undersigned on the 1st, day of October 1913. -190-

The length of the claim is 1500 feet, and we claim 1500 feet in a N. 8° 26' E. direction, and ~~feet in a~~ direction from the center of the discovery pt. at which this notice is posted, lengthwise of the claim together with 300 feet in width of the surface grounds, on each side of the center of said claim. The general course of the lode deposit and premises is from the N. E. to the S. W.

The claim is situated and located in the Copper Mountain Mining District, in Greenlee County, State of Arizona, ~~about~~ direction from
From the S. E. Cor. of this claim U. S. M. M. No. 3 bears N 16° 36' W 4237.75 ft.

The surface boundaries of the claim are marked upon the ground as follows: beginning at a monument of stone at

at a point in a direction feet from the discovery pt. (at which this notice is posted), being in the center of the South end line of said claim; thence N. 79° 53' W. 223.25 feet to a pine post, being the S. W. corner of said claim; thence N. 16° 10' E 1507.7 feet to a pine post, being at the N. W. corner of said claim; thence S. 79° 53' E. 20.24 feet to a pine post being the center of the North end of said claim; thence S. 79° 53' E. 300 feet to a pine post being at the N. E. corner of said claim; thence S. 8° 26' W. 1500 feet to a pine post at the S. E. corner of said claim; thence N. 79° 53' W. 300 feet to the place of beginning.

~~All done under the provisions of Chapter Six, of Title XXXII, of the revised Statutes of the United States, and of an act of the General Assembly of the Territory of Arizona, entitled "An Act to Codify and Revise the Laws of the Territory of Arizona," approved March 16th, 1901.~~

This is an Amended Location Notice of the Johanner No. 2 mining Claim, located by Stevens Copper Co.

on the 15th, day of Sept. 1902, and recorded in Book 15 of Records of Mines at page 224, in the office of the County Recorder of the aforesaid County of Graham to which reference is hereby made,

Dated and posted on the ground this 1st, day of Oct. 1913. 190-

Stevens Copper Mining Co.
By Charles E. Shaw Agent.

TERRITORY OF ARIZONA,

County of Graham

ss.

County Recorder in and for the County and

Territory aforesaid, do hereby certify that the within instrument was filed for record at

o'clock M, on this day of 190, and

duly recorded in Book No of Records of Graham County

Arizona, at pages

Witness my hand and seal the day and year first above written,

County Recorder

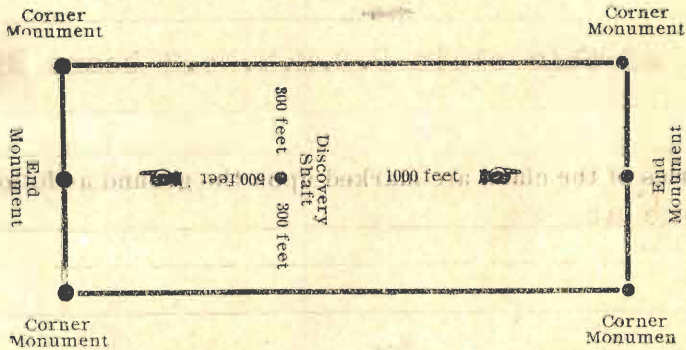

The above diagram is to give the locator a general idea of the plan of location under the new law. Your discovery shaft may be in the center of claim, or any distance from either end you desire. In the diagram we have placed it 500 feet from one end and 1000 feet from the other. In description be careful to state locality of claim with reference to some natural object, or permanent monument, so as to identify the claim.

No 25746

Amended Notice of Location

LODE CLAIM

Shannon No 25

Dated October 1st 1903

Filed and recorded at request of

Samuel Shannon

Oct. 1st A. D. 1903

at 1000 O'clock A. M.

Book Shannon

Pages 688 & 689

J. E. Steed

County Recorder.

By W. C. ... Deputy Recorder.

20107-1072

AMENDED NOTICE OF LOCATION—Lode Claim

35

To all Whom it may Concern:

This mining claim, the name of which is the Globe Mining Claim, situate on lands belonging to the United States of America, and in which there are valuable mineral deposits, was entered upon and amended for the purpose of exploration and purchase by Stevens Copper Mining Co.

the undersigned on the 1st, day of Oct. 1913.

The length of the claim is 1499.4 feet, and we claim 1499.4 feet in a S. 9° 43' W. direction, and 300 feet in a S. 79° 53' E. direction from the center of the discovery pt. at which this notice is posted, lengthwise of the claim together with 300 feet in width of the surface grounds, on each side of the center of said claim. The general course of the lode deposit and premises is from the N. E. to the S. W.

The claim is situated and located in the Copper Mountain Mining District, in Greenlee County, State Territory of Arizona, about

From the N.E. Cor. of this claim U.S.M.M. No. 2 bears S. 88° 14' E. 4996.1 ft.

The surface boundaries of the claim are marked upon the ground as follows: beginning at a pine post

at a point in a S. 9° 43' W. direction 1499.4 feet from the discovery pt. (at which this notice is posted), being in the center of the South end line of said claim; thence N. 79° 53' W. 300 feet to a pine post, being the S. W. corner of said claim; thence N. 9° 43' E. 1499.4 feet to a pine post, being at the N. W. corner of said claim; thence S. 79° 53' E. 300 feet to a pine post being the center of the North end of said claim; thence S. 79° 53' E. 266.27 feet to a pine post being at the N. E. corner of said claim; thence S. 8° 26' W. 1500 feet to a pine post at the S. E. corner of said claim; thence N. 79° 53' W. 300 feet to the place of beginning.

All done under the provisions of Chapter Six, of Title XXXII, of the revised Statutes of the United States, and of an act of the General Assembly of the Territory of Arizona, entitled "An Act to Codify and Revise the Laws of the Territory of Arizona," approved March 16th, 1901.

This is an Amended Location Notice of the Globe mining Claim, located by Charles E. Stevens and Susan Ramsdell

on the 15th, day of Sept. 1902, and recorded in Book 15 of Records of Mines at page 235, in the office of the County Recorder of the aforesaid County of Graham to which reference is hereby made,

Dated and posted on the ground this 1st, day of Oct. 1913.

Stevens Copper Mining Co.
By Charles E. Stevens Agent.

AMENDED NOTICE OF LOCATION—Lode Claim

TERRITORY OF ARIZONA,

County of Graham

ss.

I, _____ County Recorder in and for the County and Territory aforesaid, do hereby certify that the within instrument was filed for record at _____

o'clock _____ M, on this _____ day of _____ 190_____, and

duly recorded in Book No _____ of _____ Records of Graham County

Arizona, at pages _____

Witness my hand and seal the day and year first above written,

County Recorder

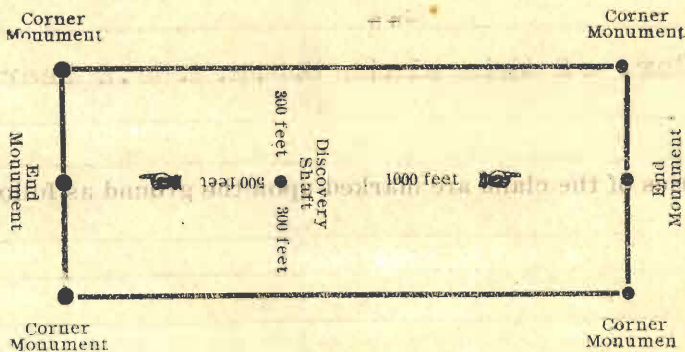

The above diagram is to give the locator a general idea of the plan of location under the new law. Your discovery shaft may be in the center of claim, or any distance from either end you desire. In the diagram we have placed it 500 feet from one end and 1000 feet from the other. In description be careful to state locality of claim with reference to some natural object, or permanent monument, so as to identify the claim.

U.L.C-1913

Amended Notice of Location LODE CLAIM

Shale

Dated

October 1st 1903

Filed and recorded at request of

Samuel Darwin

Oct 1st A. D. 1903

at *10:00 O'clock P. M.*

Book *#178*

Pages *#6814-6821*

M. E. Stealy
County Recorder.

By *M. E. Stealy*
Deputy Recorder.

AMENDED NOTICE OF LOCATION—Lode Claim

To all Whom it may Concern:

This mining claim, the name of which is the Stonewall Jackson Mining Claim, situate on lands belonging to the United States of America, and in which there are valuable mineral deposits, was entered upon and amended for the purpose of exploration and purchase by Stevens Copper Mining Co.

the undersigned on the 1st, day of Oct. 1913.

The length of the claim is 1499.34 feet, and we claim 1489.34 feet in a N.10°04'E. direction, and 10 feet in a S.10°04'W. direction from the center of the discovery pt. at which this notice is posted, lengthwise of the claim together with 300 feet in width of the surface grounds, on each side of the center of said claim. The general course of the lode deposit and premises is from the N.E. to the S.W.

The claim is situated and located in the Copper Mountain Mining District, in Greenlee County, State of Arizona, about

direction from
From the S.E. Cor. of this claim U.S.M.M. No. 2, bears S 88°14'E 4996.1 ft.

The surface boundaries of the claim are marked upon the ground as follows: beginning at pine post

at a point in a S.10°04'W. direction 110 feet from the discovery pt (at which this notice is posted), being in the center of the South end line of said claim; thence N.79°53'W. 300 feet to a pine post, being the S.W. corner of said claim; thence N.10°04 E 1499.34 feet to a pine post, being at the N.W. corner of said claim; thence S.79°53'E. 300 feet to a pine post being the center of the North end of said claim; thence S.79°53'E. 223.5 feet to a pine post being at the N.E. corner of said claim; thence S.8°26'W. 1500 feet to a pine post at the S.E. corner of said claim; thence N.79°53'W. 266.27 feet to the place of beginning.

~~All done under the provisions of Chapter Six, of Title XXXII, of the revised Statutes of the United States, and of an act of the General Assembly of the Territory of Arizona, entitled "An Act to Codify and Revise the Laws of the Territory of Arizona," approved March 10th, 1901.~~

This is an Amended Location Notice of the Stonewall Jackson mining Claim, located by Charles E. Stevens and Susan Ramsdell on the 15th, day of Sept. 1902, and recorded in Book 15 of Records of Mines at page 228, in the office of the County Recorder of the ~~aforsaid~~ County of Graham to which reference is hereby made,

Dated and posted on the ground this 1st, day of Oct. 1913.

Stevens Copper Mining Co.
By Charles E. Stevens Agent.

AMENDED NOTICE OF LOCATION—Lode Claim

TERRITORY OF ARIZONA,

County of Graham

ss.

I, _____ County Recorder in and for the County and Territory aforesaid, do hereby certify that the within instrument was filed for record at _____ o'clock _____ M, on this _____ day of _____ 190____, and duly recorded in Book No _____ of _____ Records of Graham County Arizona, at pages _____

Witness my hand and seal the day and year first above written,

County Recorder

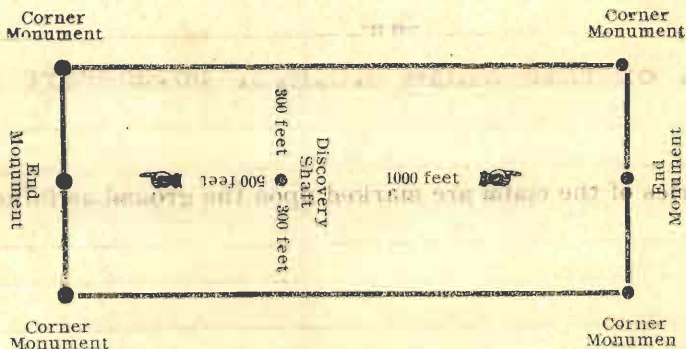

The above diagram is to give the locator a general idea of the plan of location under the new law. Your discovery shaft may be in the center of claim, or any distance from either end you desire. In the diagram we have placed it 500 feet from one end and 1000 feet from the other. In description be careful to state locality of claim with reference to some natural object, or permanent monument, so as to identify the claim.

JUL 16- 1913

107536

Amended Notice of Location

LODE CLAIM

Stewart J. ...

Dated *October 14* 1903

Filed and recorded at request of *Samuel ...*

Oct. 17th A. D. 1903

at *11:00 O'clock* P. M.

Book *107536*
Pages *1 & 2*

County Recorder.

By *W. C. ...*
Deputy Recorder.

AMENDED

Notice of Mining Location.

LODE CLAIM.

To All Whom It May Concern:

This mining claim, the name of which is the Susannah Mining Claim, situate on lands belonging to the United States of America, and in which there are valuable mineral deposits, was entered upon and located for the purpose of exploration and purchase by Chas E Stevens and Susan Ramsdell Citizens of the United States.

(Locator must insert either "a citizen of the United States," or, "who has declared his intention to become a citizen of the United States.")

the undersigned, on the _____ day of _____ 190_____

The length of this claim is Fifteen Hundred feet, and we claim 260 feet in a North Eastly direction, and

1240 feet in a South Westly direction from the center of the discovery shaft, at which this notice is posted, lengthwise of the claim, together with Nine Hundred feet in width of the surface grounds, on each side of the center of said claim.

The general course of the lode deposit and premises is from the North Eastly to the South Westly

The claim is situated and located in the Copper Mountain Mining District, in Archaon County, in the Territory of Arizona, about 4328 FT in a N 10 27' W direction from U. S. Lm. No. 3.

The surface boundaries of the claim are marked upon the ground as follows: Beginning at a 4" x 4" pine post

at a point in a South Westly direction 260. feet from the discovery shaft (at which this notice is posted), being in the center of the South End end line of said claim; thence N 81° 36' W 300 feet to a 4" x 4" pine post, being the South West corner of said claim; thence N 8° 24' E 1500 feet to a 4" x 4" pine post being at the North West corner of said claim; thence S 81° 36' E 300 feet to a 4" x 4" pine post being the center of the North End end of said claim; thence S 81° 36' W 200 feet to a 4" x 4" pine post being at the North East corner of said claim; thence S 8° 24' W 1500 feet to a 4" x 4" pine post at the South East corner of said claim; thence N 81° 36' W feet to the place of beginning.

All done under the provisions of Chapter Six, of Title XXXII, of the Revised Statutes of the United States, and of an Act of the General Assembly of Arizona, entitled "An Act to Codify and Revise the Laws of the Territory of Arizona," approved March 16th, 1901.

Dated and posted on the ground this 15th day of September 1902

Charles E Stevens
Susan Ramsdell

TERRITORY OF ARIZONA,

County of

} ss.

..... County Recorder in and for the County and Territory aforesaid, do hereby certify that the within instrument was filed for record at o'clock M., on this day of 190....., and duly recorded in Book No of Records of County, Arizona, at pages

Witness my hand and seal the day and year first above written.

..... County Recorder.

2735

JUL 16 - 1913

AMENDED

Notice of Location.

LODE CLAIM.

*Suwanah
Cochise Mountain
Mining District*

Dated *Sept 15* 190*2*

Filed and recorded at request of

J. N. Stevens

Oct 28" A. D. 190*2*

at *9 o'clock* A. M.

Book *15* Record of Mines

Pages *286*

Thomas Smith
County Recorder.

County Recorder.

By *Lelia Stevenson*
Deputy Recorder.

ERA PRINT, CLIFTON

AMENDED

Notice of Mining Location.

LODE CLAIM.

To All Whom It May Concern:

This mining claim, the name of which is the Triangle No 2 Mining Claim, situate on lands belonging to the United States of America, and in which there are valuable mineral deposits, was entered upon and located for the purpose of exploration and purchase by Chas E Stevens and Susan Ramsdell Citizens of the United States

(Locator must insert either "a citizen of the United States," or, "who has declared his intention to become a citizen of the United States.")

the undersigned, on the _____ day of _____ 190

The length of this claim is Fifteen Hundred feet, and _____ claim _____ feet

in a _____ direction, and _____ feet in a _____ direction from

the center of the discovery shaft, at which this notice is posted, lengthwise of the claim, together with Three Hundred feet in width of the surface grounds, on each

side of the center of said claim. The general course of the lode deposit and premises is from the North East to the South West

The claim is situated and located in the Copper Mountain Mining District, in Graham County, in the Territory of Arizona, about 5812 FT

in a N 1° 05' E direction from U.S.M. No. 3

The surface boundaries of the claim are marked upon the ground as follows: Beginning at

a 4" x 4" pine post

at a point in a _____ direction _____ feet from

the discovery shaft (at which this notice is posted), being in the center of the South

end line of said claim; thence N 81° 36' W 300 feet to a 4" x 4" pine

post, being the South West corner of said claim; thence

N 8° 24' E 1500 feet to a 4" x 4" pine post being at the

North West corner of said claim; thence S 81° 36' E 300

feet to a 4" x 4" pine post being the center of the North end

of said claim; thence S 81° 36' E 300 feet to a 4" x 4" pine post

being at the North East corner of said claim; thence S 8° 24' W

1500 feet to a 4" x 4" pine post at the

South East corner of said claim; thence N 81° 36' W 300

feet to the place of beginning.

All done under the provisions of Chapter Six, of Title XXXII, of the Revised Statutes of the United States, and of an Act of the General Assembly of Arizona, entitled "An Act to Codify and Revise the Laws of the Territory of Arizona," approved March 16th, 1901.

Dated and posted on the ground this 15th day of September 190

Charles E Stevens
Susan Ramsdell

TERRITORY OF ARIZONA,

County of

} ss.

County Recorder in and for the County and

Territory aforesaid, do hereby certify that the within instrument was filed for record at
o'clock M., on this day of 190....., and
duly recorded in Book No of Records of
County, Arizona, at pages

Witness my hand and seal the day and year first above written.

County Recorder.

3925

APR 1913

AMENDED

Notice of Location.

LODE CLAIM.

Triangle No. 2
Leopold Mountain
Mining Dist
L. C. Stevens et al

Dated Sept 15th 1902

Filed and recorded at request of

L. C. Stevens

Oct 28th A. D. 1902

at 9 o'clock A. M.

Book 15 Record of Mines

Pages 234

Thomas Smith

County Recorder.

By L. C. Stevens
Deputy Recorder.

ERA PRINT, CLIFTON

AMENDED

Notice of Mining Location.

LODE CLAIM.

To All Whom It May Concern:

This mining claim, the name of which is the Triangle No 1
 Mining Claim, situate on lands belonging to the United States of America, and in which there are
 valuable mineral deposits, was entered upon and located for the purpose of exploration and purchase
 by Chas. E. Stevens and Susan Ramsdell
Citizens of the United States
 (Locator must insert either "a citizen of the United States," or, "who has declared his intention to become a citizen of the United States.")

the undersigned, on the _____ day of _____ 190____
 The length of this claim is Fifteen Hundred feet,
 and we claim _____ feet
 in a _____ direction, and _____
 _____ feet in a _____ direction from
 the center of the discovery shaft, at which this notice is posted, lengthwise of the claim, together with
Three Hundred feet in width of the surface grounds, on each
 side of the center of said claim. The general course of the lode deposit and premises is from the

_____ to the _____
 The claim is situated and located in the Copper Mountain Mining District, in
the Sit On Bears County, in the Territory of Arizona, about 7302 FT
 in a N 2° 35' E direction from U. S. L. M. No. 3.

The surface boundaries of the claim are marked upon the ground as follows: Beginning at
a 4" x 4" pine post
 at a point in a _____ direction _____ feet from
 the discovery shaft (at which this notice is posted), being in the center of the South
 end line of said claim; thence N 81° 36' W 300 feet to a 4" x 4" pine
post, being the South West corner of said claim; thence
N 8° 24' E 1500 feet to a 4" x 4" pine post being at the
North West corner of said claim; thence S 81° 36' E 300
 feet to a 4" x 4" pine post being the center of the North end
 of said claim; thence S 81° 36' E 300 feet to a 4" x 4" pine post
 being at the North East corner of said claim; thence S 8° 24' W
1500 feet to a 4" x 4" pine post at the
South East corner of said claim; thence N 81° 36' W 300
 feet to the place of beginning.

All done under the provisions of Chapter Six, of Title XXXII, of the Revised Statutes of the
 United States, and of an Act of the General Assembly of Arizona, entitled "An Act to Codify and
 Revise the Laws of the Territory of Arizona," approved March 16th, 1901.

Dated and posted on the ground this 15th day of September 1902
Charles E. Stevens
Susan Ramsdell

TERRITORY OF ARIZONA,

County of } ss.

..... County Recorder in and for the County and Territory aforesaid, do hereby certify that the within instrument was filed for record at o'clock M., on this day of 190....., and duly recorded in Book No of Records of County, Arizona, at pages

Witness my hand and seal the day and year first above written.

..... County Recorder.

3732

1913

AMENDED

Notice of Location.

LODE CLAIM.

Triangle No. 1
Copper Mt.

Dated Sept 15 1902

Filed and recorded at request of

J. N. Stevens

at 9 o'clock A. M. 1902

Book 15 - Record of Mines
Pages 283

Thomas Smith
County Recorder.

Deputy Recorder.

By Lelia Stevenson

Deputy Recorder.

ERA PRINT, CLIFTON

AMENDED

Notice of Mining Location.

LODE CLAIM.

To All Whom It May Concern:

This mining claim, the name of which is the Impresso Mining Claim, situate on lands belonging to the United States of America, and in which there are valuable mineral deposits, was entered upon and located for the purpose of exploration and purchase by Chas E Stevens and Susan Ramsdell Citizens of the United States.

(Locator must insert either "a citizen of the United States," or, "who has declared his intention to become a citizen of the United States.")

the undersigned, on the _____ day of _____ 190

The length of this claim is Fifteen Hundred feet, and we claim _____ feet in a _____ direction, and _____

_____ feet in a _____ direction from the center of the discovery shaft, at which this notice is posted, lengthwise of the claim, together with One Hundred feet in width of the surface grounds, on each side of the center of said claim. The general course of the lode deposit and premises is from the

North Easterly to the South Westerly.
The claim is situated and located in the Copper Mountain Mining District, in Graham County, in the Territory of Arizona, about 8795.50 FT in a N 3° 34' E direction from U. S. L. M. No. 3.

The surface boundaries of the claim are marked upon the ground as follows: Beginning at A 4" x 4" pine post

at a point in a _____ direction _____ feet from the discovery shaft (at which this notice is posted), being in the center of the South end line of said claim; thence N 81° 36' W 200 feet to a 4" x 4" pine post, being the South West corner of said claim; thence N 8° 24' E 1200 feet to a 4" x 4" pine post being at the North West corner of said claim; thence S 81° 36' E 200 feet to a 4" x 4" pine post being the center of the North end of said claim; thence S 81° 36' E 200 feet to a 4" x 4" pine post being at the North East corner of said claim; thence S 8° 24' W 1200 feet to a 4" x 4" pine post at the South East corner of said claim; thence N 81° 36' W 200 feet to the place of beginning.

All done under the provisions of Chapter Six, of Title XXXII, of the Revised Statutes of the United States, and of an Act of the General Assembly of Arizona, entitled "An Act to Codify and Revise the Laws of the Territory of Arizona," approved March 16th, 1901.

Dated and posted on the ground this 15th day of September 1902
Charles E Stevens
Susan Ramsdell

TERRITORY OF ARIZONA,

County of

} ss.

County Recorder in and for the County and

Territory aforesaid, do hereby certify that the within instrument was filed for record at

o'clock M., on this day of 190....., and

duly recorded in Book No of Records of

County, Arizona, at pages

Witness my hand and seal the day and year first above written.

County Recorder.

3932

518-1013

AMENDED

Notice of Location.

LODE CLAIM.

Imperial
Copper Mountain &
Greenlee Gold Dito

Dated *Sept 15* 190*2*

Filed and recorded at request of

J. N. Stevens

Oct 28th A. D. 190*2*

at *9 o'clock A.* M.

Book *157* Record of Mines

Pages *232*

Thomas Smith
County Recorder.

County Recorder.

By *Lelia Stearns*
Deputy Recorder.

ERA PRINT, CLIFTON

AMENDED

Notice of Mining Location.

LODE CLAIM.

To All Whom It May Concern:

This mining claim, the name of which is the Copper Bottom Mining Claim, situate on lands belonging to the United States of America, and in which there are valuable mineral deposits, was entered upon and located for the purpose of exploration and purchase by Chas E. Stevens and Susan Ramsdell Citizens of the United States

(Locator must insert either "a citizen of the United States," or, "who has declared his intention to become a citizen of the United States.")

the undersigned, on the _____ day of _____ 190 _____

The length of this claim is Fifteen Hundred feet, and we claim 60 feet in a North Easterly direction, and 1440 feet in a South Westerly direction from the center of the discovery shaft, at which this notice is posted, lengthwise of the claim, together with Three Hundred feet in width of the surface grounds, on each side of the center of said claim. The general course of the lode deposit and premises is from the South Easterly to the South Westerly

The claim is situated and located in the Copper Mountain Mining District, in Graham County, in the Territory of Arizona, about 4267 Ft. in a N 60° 31' E direction from U. S. M. No 3

The surface boundaries of the claim are marked upon the ground as follows: Beginning at

A 4" x 4" pine post at a point in a South Westerly direction 1440 feet from the discovery shaft (at which this notice is posted), being in the center of the South end line of said claim; thence N 81° 36' W 300 feet to a 4" x 4" pine post, being the South West corner of said claim; thence N 8° 24' E 1500 feet to a 4" x 4" pine post being at the North West corner of said claim; thence S 81° 36' E 300 feet to a 4" x 4" pine post being the center of the South end of said claim; thence S 81° 36' E 300 feet to a 4" x 4" pine post being at the North East corner of said claim; thence S 8° 24' W 1500 feet to a 4" x 4" pine post at the South East corner of said claim; thence N 84° 36' W 300 feet to the place of beginning.

All done under the provisions of Chapter Six, of Title XXXII, of the Revised Statutes of the United States, and of an Act of the General Assembly of Arizona, entitled "An Act to Codify and Revise the Laws of the Territory of Arizona," approved March 16th, 1901.

Dated and posted on the ground this 15th day of September 190 2

Charles E. Stevens
Susan Ramsdell

3927

1913

AMENDED

Notice of Location.

LODE CLAIM.

Copper Bottom
Copper Maritani
Mining Dist
Chas. C. Stevens et al

Dated Sept 15 1902

Filed and recorded at request of

J. N. Stevens

October 28 A. D. 1902

at 9 o'clock A. M.

Book 189 record of Mines

Pages 227

Thomas Smith

County Recorder.

By Lelia Stevenson

Deputy Recorder.

ERA PRINT. CLIFTON

TERRITORY OF ARIZONA,

County of } ss.

..... County Recorder in and for the County and Territory aforesaid, do hereby certify that the within instrument was filed for record at o'clock M., on this day of 190....., and duly recorded in Book No of Records of County, Arizona, at pages

Witness my hand and seal the day and year first above written.

County Recorder.

AMENDED

Notice of Mining Location.

LODE CLAIM.

To All Whom It May Concern:

This mining claim, the name of which is the Evening Star Mining Claim, situate on lands belonging to the United States of America, and in which there are valuable mineral deposits, was entered upon and located for the purpose of exploration and purchase by Chas E Stevens and Susan Ramsdell Citizens of the United States.

(Locator must insert either "a citizen of the United States," or, "who has declared his intention to become a citizen of the United States.")

the undersigned, on the _____ day of _____ 190 _____

The length of this claim is Fifteen Hundred feet, and we claim 1220 feet in a North Easterly direction, and 270 feet in a South Westerly direction from the center of the discovery shaft, at which this notice is posted, lengthwise of the claim, together with Three Hundred feet in width of the surface grounds, on each side of the center of said claim. The general course of the lode deposit and premises is from the North Easterly to the South Westerly

The claim is situated and located in the Copper Mountain Mining District, in Graham County, in the Territory of Arizona, about 5766 FT in a N 70° 01' E direction from U.S.M. No 3

The surface boundaries of the claim are marked upon the ground as follows: Beginning at a 4" x 4" pine post

at a point in a South Westerly direction 270 feet from the discovery shaft (at which this notice is posted), being in the center of the South end line of said claim; thence N 81° 36' W 200 feet to a 4" x 4" pine post, being the South West corner of said claim; thence N 80° 24' E 1500 feet to a 4" x 4" pine post being at the North West corner of said claim; thence S 81° 36' E 200 feet to a 4" x 4" pine post being the center of the Do North end of said claim; thence S 81° 36' E 200 feet to a 4" x 4" pine post being at the North East Corner corner of said claim; thence S 80° 24' W 1500 feet to a 4" x 4" pine post at the South East corner of said claim; thence N 81° 36' W 200 feet to the place of beginning.

All done under the provisions of Chapter Six, of Title XXXII, of the Revised Statutes of the United States, and of an Act of the General Assembly of Arizona, entitled "An Act to Codify and Revise the Laws of the Territory of Arizona," approved March 16th, 1901.

Dated and posted on the ground this 15th day of September 190 2

Charles E Stevens
Susan Ramsdell

TERRITORY OF ARIZONA,

County of } ss.

..... County Recorder in and for the County and Territory aforesaid, do hereby certify that the within instrument was filed for record at o'clock M., on this day of 190....., and duly recorded in Book No of Records of County, Arizona, at pages

Witness my hand and seal the day and year first above written.

..... County Recorder.

3926

1902

AMENDED

Notice of Location.

LODE CLAIM.

*Evening Star
Leopold Gut.
Manning Ditt
Chas. C. Stevens et al*

Dated *Sept 18* " 1902

Filed and recorded at request of

J. M. Stevens

October 28 " A. D. 1902

at *9* o'clock *A.* M.

Book *15* Record of Mines

Pages *226*

Thomas Smith

County Recorder.

By *Lelia Stevenson*

Deputy Recorder.

Notice of Mining Location.

LODE CLAIM.

To All Whom It May Concern:

This mining claim, the name of which is the Morning Star Mining Claim, situate on lands belonging to the United States of America, and in which there are valuable mineral deposits, was entered upon and located for the purpose of exploration and purchase by Chas E Stevens and Susan Ramsdell Citizens of the United States

(Locator must insert either "a citizen of the United States," or, "who has declared his intention to become a citizen of the United States.")

the undersigned, on the _____ day of _____ 190_____

The length of this claim is Fifteen Hundred feet, and 590 feet in a North Easterly direction, and 910 feet in a South Westerly direction from the center of the discovery shaft, at which this notice is posted, lengthwise of the claim, together with Three Hundred feet in width of the surface grounds, on each side of the center of said claim.

The general course of the lode deposit and premises is from the North Easterly to the South Westerly

The claim is situated and located in the Copper Mountain Mining District, in Archaean County, in the Territory of Arizona, about 7266 FT in a N 70 18' E direction from U. O. L. M. 903

The surface boundaries of the claim are marked upon the ground as follows: Beginning at a 4" x 4" pine post

at a point in a South Westerly direction 910 feet from the discovery shaft (at which this notice is posted), being in the center of the South end line of said claim; thence N 81° 36' W 300 feet to a 4" x 4" pine post, being the South West corner of said claim; thence N 80° 24' E 1500 feet to a 4" x 4" pine post being at the North West corner of said claim; thence S 81° 36' E 200 feet to a 4" x 4" pine post being the center of the North end of said claim; thence S 81° 36' E 300 feet to a 4" x 4" pine post being at the North East corner of said claim; thence S 80° 24' W 1500 feet to a 4" x 4" pine post at the South East corner of said claim; thence N 81° 36' W 200 feet to the place of beginning.

All done under the provisions of Chapter Six, of Title XXXII, of the Revised Statutes of the United States, and of an Act of the General Assembly of Arizona, entitled "An Act to Codify and Revise the Laws of the Territory of Arizona," approved March 16th, 1901.

Dated and posted on the ground this 15th day of September 1901
Charles E Stevens
Susan Ramsdell

3929

6616-1912

AMENDED

Notice of Location.

LODE CLAIM.

Morning Star
Leopold Marcantoni
Grandes Gold Mt.
Morning Diets

Dated Sept 15th 1902

Filed and recorded at request of

A. N. Stevens

Oct 28th A. D. 1902
at 9 o'clock A. M.
Book 16-Record of Mines
Pages 229

Thomas Smith
County Recorder.

By Ed. Stevenson
Deputy Recorder.

ERA PRINT, CLIFTON

TERRITORY OF ARIZONA,

County of } ss.

..... County Recorder in and for the County and Territory aforesaid, do hereby certify that the within instrument was filed for record at o'clock M., on this day of 190....., and duly recorded in Book No of Records of County, Arizona, at pages

Witness my hand and seal the day and year first above written.

..... County Recorder.

AMENDED

44

Notice of Mining Location.

LODE CLAIM.

To All Whom It May Concern:

This mining claim, the name of which is the Painted Cliff Mining Claim, situate on lands belonging to the United States of America, and in which there are valuable mineral deposits, was entered upon and located for the purpose of exploration and purchase by Isaac N. Stevens a citizen of the United States

(Locator must insert either "a citizen of the United States," or, "who has declared his intention to become a citizen of the United States.")

the undersigned, on the _____ day of _____ 190

The length of this claim is Fifteen Hundred feet, and claim 51 feet in a South Westely direction, and 1449 feet in a North Eastely direction from the center of the discovery shaft, at which this notice is posted, lengthwise of the claim, together with Three Hundred feet in width of the surface grounds, on each side of the center of said claim. The general course of the lode deposit and premises is from the North Eastely to the South Westely

The claim is situated and located in the Greenlee Gold Mining District, in Graham County, in the Territory of Arizona, about 8765.50 FT in a N 70 29' E direction from U. S. L. M. No 3

The surface boundaries of the claim are marked upon the ground as follows: Beginning at a 4" x 4" pine post

at a point in a South Westely direction 51 feet from the discovery shaft (at which this notice is posted), being in the center of the South end line of said claim; thence N 81° 36' W 300 feet to a 4" x 4" pine post, being the South West corner of said claim; thence N 80° 24' E 1500 feet to a 4" x 4" pine post being at the North West corner of said claim; thence S 81° 36' E 300 feet to a 4" x 4" pine post being the center of the North end of said claim; thence S 81° 36' E 300 feet to a 4" x 4" pine post being at the North East corner of said claim; thence S 80° 24' W 1500 feet to a 4" x 4" pine post at the South East corner of said claim; thence N 81° 36' W 300 feet to the place of beginning.

All done under the provisions of Chapter Six, of Title XXXII, of the Revised Statutes of the United States, and of an Act of the General Assembly of Arizona, entitled "An Act to Codify and Revise the Laws of the Territory of Arizona," approved March 16th, 1901.

Dated and posted on the ground this 15th day of September 1902
Isaac N. Stevens

TERRITORY OF ARIZONA,

County of } ss.

..... County Recorder in and for the County and Territory aforesaid, do hereby certify that the within instrument was filed for record at o'clock M., on this day of 190....., and duly recorded in Book No of Records of County, Arizona, at pages

Witness my hand and seal the day and year first above written.

..... County Recorder.

3936

3046-1913

AMENDED
Notice of Location.
LODE CLAIM.

Painted Cliff
Gravelled Gold and
Mining Dist

Dated Sept 15 1902

Filed and recorded at request of

J. G. Stevens

Oct 28" A. D. 1902

at 9 A. M.
Book 15 Record of Mines
Pages 237

Thomas Smith

County Recorder.

By L. E. Stevenson
Deputy Recorder.

ERA PRINT. CLIFTON

AMENDED

Notice of Mining Location.

LODE CLAIM.

To All Whom It May Concern:

This mining claim, the name of which is the Cata Mount, Mining Claim, situate on lands belonging to the United States of America, and in which there are valuable mineral deposits, was entered upon and located for the purpose of exploration and purchase by Chas E Stevens and Susan Ramsdell Citizens of the United States.

(Locator must insert either "a citizen of the United States," or, "who has declared his intention to become a citizen of the United States.")

the undersigned, on the _____ day of _____ 190 _____

The length of this claim is Fifteen Hundred feet, and we claim 9.00 feet in a North Easterly direction, and 1491 feet in a South Westerly direction from the center of the discovery shaft, at which this notice is posted, lengthwise of the claim, together with Three Hundred feet in width of the surface grounds, on each side of the center of said claim.

The general course of the lode deposit and premises is from the North Easterly to the South Westerly

The claim is situated and located in the Copper Mountain Mining District, in Graham County, in the Territory of Arizona, about 4758 Ft. in a N 13° 49' E direction from U.S. L.M. No 3

The surface boundaries of the claim are marked upon the ground as follows: Beginning at a 4" x 4" pine post

at a point in a South Westerly direction 1491 feet from the discovery shaft (at which this notice is posted), being in the center of the South end line of said claim; thence N 81° 36' 300 feet to a 4" x 4" pine post, being the South West corner of said claim; thence N 80° 24' E 1500 feet to a 4" x 4" pine post being at the North West corner of said claim; thence S 81° 36' E 300 feet to a 4" x 4" pine post being the center of the North end of said claim; thence S 81° 36' E 300 feet to a 4" x 4" pine post being at the North East corner of said claim; thence S 80° 24' W 1500 feet to a 4" x 4" pine post at the South East corner of said claim; thence N 81° 36' W 300 feet to the place of beginning.

All done under the provisions of Chapter Six, of Title XXXII, of the Revised Statutes of the United States, and of an Act of the General Assembly of Arizona, entitled "An Act to Codify and Revise the Laws of the Territory of Arizona," approved March 16th, 1901.

Dated and posted on the ground this 15th day of September 1902
Charles E Stevens
Susan Ramsdell

TERRITORY OF ARIZONA,

County of

} ss.

..... County Recorder in and for the County and Territory aforesaid, do hereby certify that the within instrument was filed for record at o'clock M., on this day of 190....., and duly recorded in Book No of Records of County, Arizona, at pages

Witness my hand and seal the day and year first above written.

..... County Recorder.

3930

JUL 16- 1913

AMENDED

Notice of Location.

LODE CLAIM.

*Cata Mount
Copper Mountain
Mining District
Chas. C. Stevens et al*

Dated *Sept 15* 190 *2*

Filed and recorded at request of

S. N. Stevens

Oct 28th A. D. 190 *2*
at *9 o'clock A. M.*
Book *159* *second of Mines*
Pages *230*

Thomas Smith
County Recorder.

Lelia Stevenson
Deputy Recorder.

AMENDED

Notice of Mining Location.

LODE CLAIM.

To All Whom It May Concern:

This mining claim, the name of which is the Square Fraction Mining Claim, situate on lands belonging to the United States of America, and in which there are valuable mineral deposits, was entered upon and located for the purpose of exploration and purchase by Chas E. Stevens and Susan Ramsdell Citizens of the United States.

(Locator must insert either "a citizen of the United States," or, "who has declared his intention to become a citizen of the United States.") the undersigned, on the _____ day of _____ 190_____

The length of this claim is 1026.20 feet, and we claim _____ feet in a _____ direction, and _____ feet in a _____ direction from

the center of the discovery shaft, at which this notice is posted, lengthwise of the claim, together with Three Hundred feet in width of the surface grounds, on each side of the center of said claim. The general course of the lode deposit and premises is from the North Easterly to the South Westerly

The claim is situated and located in the Copper Mountain Mining District, in Graham County, in the Territory of Arizona, about 6255 FT in a N 12° 37' E direction from U. O. T. M. 903

The surface boundaries of the claim are marked upon the ground as follows: Beginning at a 4" x 4" pine post

at a point in a _____ direction _____ feet from the discovery shaft (at which this notice is posted), being in the center of the South end line of said claim; thence N 81° 36' W 300 feet to a 4" x 4" pine post, being the South West corner of said claim; thence N 80° 4' E 1026.20 feet to a 4" x 4" pine post being at the North West corner of said claim; thence S 81° 36' E 300 feet to a 4" x 4" pine post being the center of the North end of said claim; thence S 81° 36' E 300 feet to a 4" x 4" pine post being at the North East corner of said claim; thence S 80° 4' W 1026.20 feet to a 4" x 4" pine post at the South East corner of said claim; thence N 81° 36' W 300 feet to the place of beginning.

All done under the provisions of Chapter Six, of Title XXXII, of the Revised Statutes of the United States, and of an Act of the General Assembly of Arizona, entitled "An Act to Codify and Revise the Laws of the Territory of Arizona," approved March 16th, 1901.

Dated and posted on the ground this 15th day of September, 1901
Chas E. Stevens
Susan Ramsdell

TERRITORY OF ARIZONA,

County of } ss.

..... County Recorder in and for the County and Territory aforesaid, do hereby certify that the within instrument was filed for record at o'clock M., on this day of 190....., and duly recorded in Book No of Records of County, Arizona, at pages

Witness my hand and seal the day and year first above written.

..... County Recorder.

3431

0616-1913

AMENDED

Notice of Location.

LODE CLAIM.

*Square Fraction
Alphar Mt Dist*

Chas. E. Stevens

Dated *Sept 15* 190 *2*

Filed and recorded at request of

J. J. Stevens

Oct 28 " A. D. 190 *2*

at *9* o'clock *A.* M.

Book *15* Record *Minis*

Pages *231*

Thomas Smith

County Recorder.

By *Lelah Stevenson*

Deputy Recorder.

AMENDED

Notice of Mining Location.

LODE CLAIM.

To All Whom It May Concern:

This mining claim, the name of which is the Blue Goose Mining Claim, situate on lands belonging to the United States of America, and in which there are valuable mineral deposits, was entered upon and located for the purpose of exploration and purchase by Isaac N. Stevens

A Citizen of the United States

(Locator must insert either "a citizen of the United States," or, "who has declared his intention to become a citizen of the United States.")

the undersigned, on the _____ day of _____ 190 _____

The length of this claim is Fifteen Hundred feet, and we claim 1350 feet

in a North Eastly direction, and 150 feet in a South Westly direction from

the center of the discovery shaft, at which this notice is posted, lengthwise of the claim, together with Three Hundred feet in width of the surface grounds, on each

side of the center of said claim. The general course of the lode deposit and premises is from the North Eastly to the South Westly

The claim is situated and located in the Copper Mountain & Grand Gold Mining District, in Graham County, in the Territory of Arizona, about 7279 FT in a N 12° 02' E direction from U. S. L. M. No 3

The surface boundaries of the claim are marked upon the ground as follows: Beginning at

a 4" x 4" pine post

at a point in a South Westly direction 150 feet from the discovery shaft (at which this notice is posted), being in the center of the South

end line of said claim; thence N 81° 36' W 200 feet to a 4" x 4" pine post, being the South West corner of said claim; thence

N 8° 24' E 1500 feet to a 4" x 4" pine post being at the North West corner of said claim; thence S 81° 36' E 200 feet to a 4" x 4" pine post being the center of the North end

of said claim; thence S 81° 36' E 200 feet to a 4" x 4" pine post being at the North East corner of said claim; thence S 8° 24' W 1500 feet to a 4" x 4" pine post at the South corner of said claim; thence

N 81° 36' W 200 feet to the place of beginning.

All done under the provisions of Chapter Six, of Title XXXII, of the Revised Statutes of the United States, and of an Act of the General Assembly of Arizona, entitled "An Act to Codify and Revise the Laws of the Territory of Arizona," approved March 16th, 1901.

Dated and posted on the ground this 15th day of September 1902

Isaac N. Stevens

TERRITORY OF ARIZONA,

County of

} ss.

County Recorder in and for the County and

Territory aforesaid, do hereby certify that the within instrument was filed for record at

o'clock M., on this day of 190....., and

duly recorded in Book No of Records of

County, Arizona, at pages

Witness my hand and seal the day and year first above written.

County Recorder.

3939

JUL 16 - 1913

AMENDED

Notice of Location.

LODE CLAIM.

Blue Goose
Cochise Mt & Greenlee
Gold Mt District

Dated Sept 18th 1902

Filed and recorded at request of

J. G. Stevens

Oct 28th A. D. 1902
at 9 o'clock A. M.
Book 15 Record of Mines
Pages 240

Thomas Smith
County Recorder.

Deputy Recorder.

Lelia Stevenson
Deputy Recorder.

ERA PRINT, CLIFTON

AMENDED

Notice of Mining Location.

LODE CLAIM.

To All Whom It May Concern:

This mining claim, the name of which is the Mauschal Mining Claim, situate on lands belonging to the United States of America, and in which there are valuable mineral deposits, was entered upon and located for the purpose of exploration and purchase by Isaac N. Stevens a citizen of the United States

(Locator must insert either "a citizen of the United States," or, "who has declared his intention to become a citizen of the United States.")

the undersigned, on the _____ day of _____ 190_____

The length of this claim is Fourteen Hundred feet, and we claim 174 feet in a South West direction, and 1326 feet in a North East direction from the center of the discovery shaft, at which this notice is posted, lengthwise of the claim, together with Three Hundred feet in width of the surface grounds, on each side of the center of said claim. The general course of the lode deposit and premises is from the North East to the South West.

The claim is situated and located in the Greenlee Gold Mountain Mining District, in Arraham County, in the Territory of Arizona, about 8776 FT in a N 11° 24' E direction from U. S. Sm. No. 3.

The surface boundaries of the claim are marked upon the ground as follows: Beginning at a 4" x 4" pine post

at a point in a South West direction 211 feet from the discovery shaft (at which this notice is posted), being in the center of the South end line of said claim; thence N 81° 36' feet to a 4" x 4" pine post, being the South West corner of said claim; thence N 8° 24' E 1500 feet to a 4" x 4" pine post being at the North West corner of said claim; thence S 81° 36' E 300 feet to a 4" x 4" pine post being the center of the North end of said claim; thence S 81° 36' E 300 feet to a 4" x 4" pine post being at the North East corner of said claim; thence S 8° 24' W 1500 feet to a 4" x 4" pine post at the South East corner of said claim; thence N 81° 36' W 300 feet to the place of beginning.

All done under the provisions of Chapter Six, of Title XXXII, of the Revised Statutes of the United States, and of an Act of the General Assembly of Arizona, entitled "An Act to Codify and Revise the Laws of the Territory of Arizona," approved March 16th, 1901.

Dated and posted on the ground this 15th day of September 1901
Isaac N. Stevens

TERRITORY OF ARIZONA,

County of } ss.

..... County Recorder in and for the County and Territory aforesaid, do hereby certify that the within instrument was filed for record at o'clock M., on this day of 190....., and duly recorded in Book No of Records of County, Arizona, at pages

Witness my hand and seal the day and year first above written.

..... County Recorder.

3937

Oct 6 1913

AMENDED

Notice of Location.

LODE CLAIM.

*Maricopa
Greenlee Gold Mt
Mining Dist*

Dated *Sept 15* 190 *2*

Filed and recorded at request of

J. N. Stevens

Oct 28 A. D. 190 *2*

at *9 o'clock A.* M.

Book *15 Record of Mines*

Pages *238*

Thomas Smith
County Recorder.

County Recorder.

Lela Stevenson
Deputy Recorder.

Deputy Recorder.

AMENDED NOTICE OF LOCATION—Lode Claim

To all Whom it may Concern:

This mining claim, the name of which is the Blue and Gray Mining Claim, situate on lands belonging to the United States of America, and in which there are valuable mineral deposits, was entered upon and amended for the purpose of exploration and purchase by Stevens Copper Mining Co.

the undersigned on the 1st, day of Oct. 1913. 190-

The length of the claim is 1460.9 feet, and we claim 40 feet in a N. 8° 26' E. direction, and 1420.9 feet in a S. 8° 26' W direction from the center of the discovery shaft at which this notice is posted, lengthwise of the claim together with 300 feet in width of the surface grounds, on each side of the center of said claim. The general course of the lode deposit and premises is from the N. E. to the S. W.

The claim is situated and located in the Copper Mountain Mining District, in Greenlee State County, Territory of Arizona, about direction from

The S. E. Cor. of this claim is identical with Cor. No. 3 Camino No. 2 Sur. No. 2484.

The surface boundaries of the claim are marked upon the ground as follows: beginning at a monument of stone

at a point in a N. 8° 26' E. direction 40 feet from the discovery shaft (at which this notice is posted), being in the center of the North end line of said claim; thence S. 68° 21' E. 184 feet to a pine post, being the N. E. corner of said claim; thence S. 9° 38' W. 1454.1 feet to a pine post, being at the S. E. corner of said claim; thence N. 68° 21' W. 152.8 feet to a monument of stone being the center of the South end of said claim; thence N. 68° 21' W. 165.2 feet to a pine post being at the S. W. corner of said claim; thence N. 8° 26' E. 1460.9 feet to a pine post at the N. W. corner of said claim; thence S. 68° 21' E. 165.2 feet to the place of beginning.

All done under the provisions of Chapter Six, of Title XXXII, of the revised Statutes of the United States, and of an act of the General Assembly of the Territory of Arizona, entitled "An Act to Codify and Revise the Laws of the Territory of Arizona," approved March 16th, 1901.

This is an Amended Location Notice of the Blue and Gray mining Claim, located by Isaac N. Stevens

on the 1st, day of April 1898 190-, and recorded in Book 10 of Records of Mines at page 62, in the office of the County Recorder of the aforesaid County of Graham to which reference is hereby made,

Dated and posted on the ground this 1st, day of Oct. 1913. 190-

Stevens Copper Mining Co By Charles E. Flinn Agent

TERRITORY OF ARIZONA,

County of Graham

ss.

I, _____ County Recorder in and for the County and Territory aforesaid, do hereby certify that the within instrument was filed for record at _____ o'clock _____ M, on this _____ day of _____ 190_____, and duly recorded in Book No _____ of _____ Records of Graham County Arizona, at pages _____

Witness my hand and seal the day and year first above written,

County Recorder

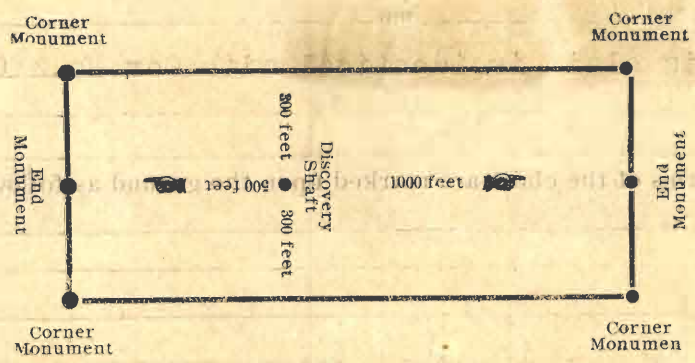

The above diagram is to give the locator a general idea of the plan of location under the new law. Your discovery shaft may be in the center of claim, or any distance from either end you desire. In the diagram we have placed it 500 feet from one end and 1000 feet from the other. In description be careful to state locality of claim with reference to some natural object, or permanent monument, so as to identify the claim.

1010-1913
M. 2533

Amended Notice of Location

LODE CLAIM

" Blue and Gray "

Dated October 1st 1903

Filed and recorded at request of David Swain

Oct 1st A. D. 1903 at 10:00 O'clock A. M.

Book # 19 Graham

Pages # 687 & 688

W. E. Stealy
County Recorder.

By W. C. Murray
Deputy Recorder.

AMENDED NOTICE OF LOCATION—Lode Claim

To all Whom it may Concern:

This mining claim, the name of which is the Bridgeport Mining Claim, situate on lands belonging to the United States of America, and in which there are valuable mineral deposits, was entered upon and amended for the purpose of exploration and purchase by Stevens Copper Mining Co.

the undersigned on the 1st, day of Oct. 1913. 190

The length of the claim is 1271.6 feet, and we claim 102 feet in a N.7°59'W direction, and 1169.6 feet in a S.7°59'E. direction from the center of the discovery pt. at which this notice is posted, lengthwise of the claim together with 300 feet in width of the surface grounds, on each side of the center of said claim. The general course of the lode deposit and premises is from the N.W. to the S.E.

The claim is situated and located in the Copper Mt. and Greenlee Gold Mt. Mining District, in Greenlee County, State of Arizona, about

From the S.E. Cor. of this claim U.S.M.M. No. 2 bears S.68°58'E. 4707 ft.

The surface boundaries of the claim are marked upon the ground as follows: beginning at a monument of stone

at a point in a N.7°59'W direction 102 feet from the discovery pt. (at which this notice is posted), being in the center of the North end line of said claim; thence N.82°01'E. 154.4 feet to a pine post, being the N.E. corner of said claim; thence S.7°59'E. 1271.6 feet to a pine post, being at the S.E. corner of said claim; thence S.82°01'W. 154.4 feet to a monument of stone being the center of the South end of said claim; thence S.82°01'W. 220 feet to a pine post being at the S.W. corner of said claim; thence N.7°59'W. 1271.6 feet to a pine post at the N.W. corner of said claim; thence N.82°01'E. 220 feet to the place of beginning.

All done under the provisions of Chapter Six, of Title XXXII, of the revised Statutes of the United States, and of an act of the General Assembly of the Territory of Arizona, entitled "An Act to Codify and Revise the Laws of the Territory of Arizona," approved March 16th, 1901.

This is an Amended Location Notice of the Bridgeport mining Claim, located by Stevens Copper Co.

on the 1st, day of Jan. 1903, and recorded in Book 5 Transcribed Records of Mining Locations of Records of Mines at page 458, in the office of the County Recorder of the aforesaid County of Greenlee to which reference is hereby made,

Dated and posted on the ground this 1st, day of Oct. 1913. 190

Stevens Copper Mining Co. By Charles E. ... Agent.

TERRITORY OF ARIZONA,

County of Graham

ss.

I, _____ County Recorder in and for the County and Territory aforesaid, do hereby certify that the within instrument was filed for record at _____ o'clock _____ M, on this _____ day of _____ 190_____, and duly recorded in Book No _____ of _____ Records of Graham County Arizona, at pages _____

Witness my hand and seal the day and year first above written,

County Recorder

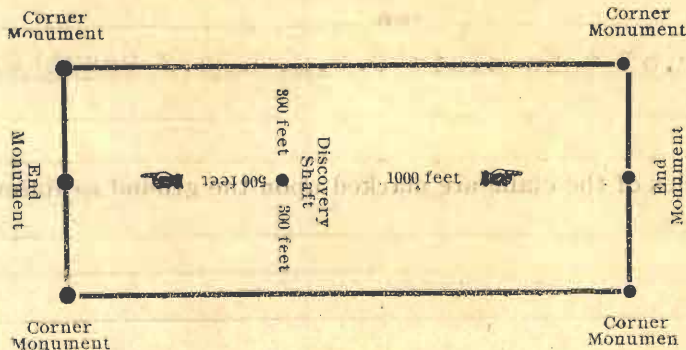

The above diagram is to give the locator a general idea of the plan of location under the new law. Your discovery shaft may be in the center of claim, or any distance from either end you desire. In the diagram we have placed it 500 feet from one end and 1000 feet from the other. In description be careful to state locality of claim with reference to some natural object, or permanent monument, so as to identify the claim.

July 6-1913 3101

No 2539

Amended Notice of Location

LODE CLAIM

Richard J. ...

Dated *October 1st 1913*

Filed and recorded at request of *Samuel ...*

Oct 1st A. D. 1913

at *12:00 O'clock P. M.*

Book *117*

Pages *687*

J. E. Steady
County Recorder.

By *W. ...*
Deputy Recorder.

U. S. SURVEYOR GENERAL'S FINAL CERTIFICATE ON
FIELD NOTES.

DEPARTMENT OF THE INTERIOR,

OFFICE OF U. S. SURVEYOR GENERAL,

Phoenix, Arizona,

February 25, 1914.

I, U. S. Surveyor General for District of Arizona,

do hereby certify that the foregoing transcript of the Field Notes, return and approval

of the Survey of the mining claim of STEVENS COPPER MINING COMPANY, known as the JOHANNER NO. 2, GLOBE, STONEWALL JACKSON, SUSANNAH, TRIANGLE NO. 2, TRIANGLE NO. 1, IMPRASO, COPPER BOTTOM, EVENING STAR, MORNING STAR, PAINTED CLIFF, CATA MOUNT, SQUARE FRACTION, BLUE GOOSE, MARESCAL, BLUE AND GRAY, ~~KNOWNS AS THE~~ BRIDGEPORT,

, situate in COPPER MOUNTAIN AND GREENLEE GOLD MOUNTAIN Mining Districts GREENLEE County,

ARIZONA, in Sections 28, 29, 32, 33, Township No. 3 S., Range No. 29 E., Unsur.

, and designated as Survey No. 3101, has been correctly copied from the originals on file in this office; that said Field Notes furnish such an accurate description of said mining claim as will, if incorporated into a patent, serve fully to identify the premises, and that such reference is made therein to natural objects or permanent monuments as will perpetuate and fix the *locus* thereof.

And I further certify that five hundred dollars' worth of labor has been expended or for each of improvements made upon said mining claims by claimant or its grantors, and that said improvements consist of 10 cuts, 7 tunnels, 6 crosscuts and 4 shafts, total value \$50,919. An undivided 1/17 interest, value \$1492, in tunnel No. 2 on the Blue Goose lode is credited to each of the claims in this survey, said improvement being a common improvement for the benefit and development of all the claims in this group.

and that no portion of said labor or improvements has been included in the estimate of expenditures upon any other claim.

I further certify that the plat thereof, filed in the U. S. Land Office at Phoenix, Arizona, is correct and in conformity with the foregoing Field Notes.

Frank S. Ingalls,

United States Surveyor General for Arizona.

4-687.

SURVEYOR-GENERAL'S CERTIFICATE OF APPROVAL OF FIELD NOTES AND SURVEY OF MINING CLAIM.

Department of the Interior.

Office of U. S. Surveyor-General,

Phoenix, Arizona.

February 25, 1914.

I, U. S. Surveyor-General for District of Arizona

do hereby certify that the foregoing and hereto attached Field Notes and Return of the Survey of the Mining Claim of

STEVENS COPPER MINING COMPANY

known as the JOHANNER NO. 2, GLOBE, STONEWALL JACKSON, SUSANNAH, TRIANGLE NO. 2, TRIANGLE NO. 1, IMPRASO, COPPER BOTTOM, EVENING STAR, MORNING STAR, PAINTED CLIFF, CATA MOUNT, SQUARE FRACTION, BLUE GOOSE, MARESCAL, BLUE AND GRAY, BRIDGEPORT. situate in COPPER MOUNTAIN AND GREENLEE GOLD MOUNTAIN mining district,

GREENLEE County, ARIZONA.

in Sections 28, 29, 32, 33, Township No. 3 S., Range No. 29 E., Unsur., designated as Survey No. 3101

executed by E. T. Morton, U. S. Deputy Mineral Surveyor, Oct. 9-17, 1913, 190, under my instructions dated

Oct. 7, 1913, 190, have been critically examined and the necessary corrections and explanations made, and the said Field Notes and Return, and the Survey they describe, are hereby approved. A true copy of the copy of the location certificate filed by the applicant for survey is included in the field notes.

Handwritten signature of Frank S. Ingalls

U. S. Surveyor-General for Arizona.