

DEC. 22 1913

FEB. 7. 1914

(4-683.)

Mineral Survey No. 3107

Lot No. _____

Arizona

Land District.

FIELD NOTES

OF THE SURVEY OF THE MINING CLAIM OF

Wm. S. Jennings

KNOWN AS THE

Hall-Thompson claims

Salt River

Mining District,

Mancopa

County,

Arizona

Sections 13 U.T.S., Township 15, Range 2 E }
18 U.T.S., Township 1-S-, Range 3-E }

Surveyed under instructions dated Dec. 10th, 1913

by Earl A. Parker,

U. S. ~~Deputy~~ Mineral Surveyor

Claim located See Location Notices, 1913

Survey commenced Dec. 16th, 1913

Survey completed Dec. 18th, 1913

6-171

Address;

Hampton & Arnold, Attys.,

Phoenix, Arizona.

SURVEY NO. 3107.

1.--

Feet	Hall
	Beginning at Cor. No. 1. A Gneiss stone 4 x 6 x 20 ins. set in 12 in. in the ground, marked H 1 - 3107 on the S.W. face with a cross on top, with a mound of stone 2 ft. base 2 ft. high alongside. N. $\frac{1}{4}$ Cor. Sec. 7, T.1.S., R.3.E., G. & S. R. B & M. bears N. 20° 55' 56" E. 8464.7 ft. dist. -No bearings available.- Thence S. 61° 31' W.
98.8	Intersects line 2 - 3 Delta No. 3 lode Survey No. 2900. at a point which bears N. 13° 36' W. 1468.4 ft. from Cor. No. 3 of Delta No. 3 Survey No. 2900.-
280	Cross Wagon road . Runs N & S.-
300	To N. End Center. A 4 x 4 in. post 2 $\frac{1}{2}$ ft. high. Identical with S.E. Center Thompson lode this survey-
350	To Dry Wash.
600	To Cor. No. 2, in dry wash 8 ft. deep 30 ft. wide. A Gneiss stone 6 x 10 x 20 ins. set 14 Ins. in the ground, marked H 2 -3107 on S. E. face, with a cross on top, with a mound of stone 2 ft. Base, 2 ft. high alongside. No bearings available. Thence S. 21° 25' E.
300	Dry Wash 5 ft deep 30 ft wide.
1180	Dry wash, 5 ft deep 30 ft. wide.
1400	Dry wash 5 ft deep 30 ft. wide.
1430	To Cor. No. 3. A Gneiss stone 5 x 7 x 30 ins. set 18 ins. in the ground, marked H 3- 3107 on the N. E. face with a cross on top, with a mound of stone 2 ft. base, 2 ft. high alongside. Identical with Cor. No. 2. or Delta no. 2. and Cor. No. 1 Richard Stanton lode Survey No. 2900--No bearings available. Thence N. 61° 31' E.
20	Dry Wash 4 ft. deep 15 ft. wide.
300	To S. end Center, Identical with Cor. No. 3-Delta No.3 lode. Survey No. 2900.- Thence along line 3-4 Delta No.3 lode

Feet-
600

To Cor. No. 4.

A Gneiss stone 6 x 6 x 30 ins. set 14 ins. in the ground, marked H 4 - 3107 on the N. W. face with a cross on top, with a mound of stone 2 ft. base, 2 ft. high alongside. Identical with Cor. No. 1. Delta No. 2 lode and S. End Center Delta No. 3. lode-both of Survey No. 2900.

No bearings available.-

Thence N. 21° 25' W.

250

Dry Wash 10 ft deep 25 ft. wide .

275

Wagon road runs East & West-
Dry wash.

1175
1430

To Cor. No. 1. The place of Beginning.

Thompson.--

Beginning at Cor. No. 1.

A Gneiss stone 4 x 8 x 20 ins. set 12 ins. in the ground, marked T 1 -3107 on the S. W. face with a cross on top, with a mound of stone 2 ft. base, 2 ft. high alongside.-

N. $\frac{1}{4}$ Cor. Sec. 7. T 1 S. , R. 3.E.G. & S. R. B. & M. bears N. 28° 45' 06" E. 7426.3 ft. dist. No bearings available.

Thence S. 61° 31' W.

300

To the N. End Center-

A Gneiss stone 4 x 6 ins. set 12 ins in ground.

450

To Dry Wash.

600

To Cor. No. 2.-

A Gneiss stone 6 x 8 x 24 ins. set 14 ins in the ground, marked T 1 - 3107 on the S. E. face with a cross on top, with a mound of stone 2 ft. base, 2 ft. high alongside. No bearings available.-

Thence S. 21° 25' E,

1500

To Cor. No. 3. Identical with Cor. No 2. Hall of this survey, heretofore described, - marked T 3 -3107 on the ^{N.E.} face.

Thence N. 61° 31' E.

250

To Dry Wash.

300

To the S. End Center- Identical with N. E. center of Hall lode this survey-

320

To wagon Road.

Feet.

501.2

To intersect line 2 - 3 of Delta No. 3. Survey No 2900 at a point which bears S. 13° 36' E. 31.6 ft. from Cor. No. 2. of Delta No. 3.

600

To Cor. No. 4.--
Identical with Cor. 1. of Hall lode of this survey, heretofore described, marked T 4 - 3107 on N. W. face.
Thence N. 21° 25' W.

30.8

To Intersect line 1 - 2 of Delta No. 3 lode Survey No. 2900- at a point which bears N. 61° 31' E. 94.5 ft. from Cor.No. 2 of Delta No. 3.-

130

To Dry Wash.

1500

To Cor. No. 1. place of beginning.--

Lode lines.

As near as can be determined from present developments the veins of the two locations embraced in this claim extend from their respective discovery points as follows:

Hall.--

N. 21° 25' W. 100 ft. distant -
S. 21° 25' E. 1330 ft. distant .-

Thompson--

N. 21° 25' W. 1400 ft. distant .-
S. 21° 25' E. 100 ft. distant .-

Area.--

Total Area Hall -19.547 A.
Area in conflict with Delta No. 3 lode, survey 2900
6.496 A.
Total area Thompson, 20.503 A.
Area in Conflict with Delta No. 3 lode, Survey No. 2900
-0.068 A.

Location-

These claims are situated in Sec. 18, ^{Uns.} T-1-S., R-3-E., and Sec. 13, ^{Uns.} T-1 S., R. 2-E., ~~unsurveyed~~, in the Salt River (Unorganized) Mining District, Maricopa County, Arizona.

Adjoining Claims.

The Hall claim is bounded on the East by Delta No.3 lode

Survey No. 2900--

On the South by Delta No. 2 lode, Sur. No. 2900, on the West by unsurveyed Government land, on the North by Thompson lode this survey.--

The Thompson is bounded on the North, East, and West by Government Unsurveyed land, on the South by the Hall this Survey, and conflicts on the southeast with the Delta No. 3 lode, Sur. No. 2900.

Expenditure Of Five Hundred Dollars.--

I certify that the value of the labor and improvements made upon, or for the benefit of each of the locations embraced in said mining claim by the claimant or its grantors is not less than five hundred dollars, and that said improvements consist of:

Hall lode.--

No. 1. Discovery shaft 4 x 6 x 10 ft. which bears S. 21° 25' E. 100 ft. distant from N. End Center.

Value, ----- \$100.00

No. 2. Shaft ~~6 x 10~~ 50 ft. which bears N. 16° 00' W. 660 ft. distant from S. End Center.

Value, \$750.00

Thompson Lode.--

No. 1. Discovery Shaft which bears N. 21° 25' W. 100ft. Distant from the S. End Center. 6 x 10 x 50 ft.

Value, \$750.00

Report.--

The lode line of each of the locations in this claim was run directly on the ground and the several corners were established by means of offsets from the lode lines, all lines were run directly on the ground, and all corners and end centers were identical with the location corners and end centers.-- The bearings of the lodes on the location notices are not identical with this survey owing to their being run by a compass.

Variation at all corners is N. 14° 30' E.

Instrument--

This survey was made with a Keuffell & Esser Transit & the Courses were deflected from the true Meridian determined by observations on Polaris. The Distances were measured with 100 and 400 ft. steel tapes--

Note; In my Sur. No. 2900 I looked very carefully for other Cors. of Sec. 7 and could find nothing that I was satisfied were original government corners except the N. $\frac{1}{2}$ Cor., and the same condition exists now.

FINAL OATHS FOR SURVEYS.

LIST OF NAMES.

A list of the names of the individuals employed by Carl H Parker
 United States ~~Deputy~~ Mineral Surveyor, to assist in running, measuring, and marking the lines, corners, and
 boundaries described in the foregoing field notes of the survey of the mining claim of _____
Wm S. Jennings
 known as the Hall & Thompson Lake Claim
 and showing the respective capacities in which they acted.

J. Y. White, Chainman.
F. G. Ayers, Chainman.
 _____, Axman.
 _____, Flagman.

FINAL OATHS OF ASSISTANTS.

We, J. Y. White
 and F. G. Ayers, do solemnly swear that we assisted Carl H Parker
 _____, United States ~~Deputy~~ Mineral Surveyor, in marking the corners and surveying
 the boundaries of the mining claim of Wm S. Jennings
 known as the Hall & Thompson Lake Claim
 represented in the foregoing field notes as having been surveyed by said ~~deputy~~ mineral surveyor and under his
 direction; and that said survey has been in all respects, to the best of our knowledge and belief, faithfully and
 correctly executed, and the corner and boundary monuments established according to law and the instructions
 furnished by the United States Surveyor-General for Arizona

J. Y. White, Chainman.
F. G. Ayers, Chainman.
 _____, Axman.
 _____, Flagman.

Subscribed and sworn to by the above-named persons before me this 19th
 day of December, 1913

My Commission expires Feb. 19, 1916.

R B Parker
 Notary Public
 Maricopa Co, Ariz

FINAL OATH OF U. S. DEPUTY MINERAL SURVEYOR

I, Earl H. Parker, U. S. Deputy Mineral Surveyor, do solemnly swear that, in pursuance of instructions received from the United States Surveyor General for Arizona, dated Dec. 10th 1913, I have, in strict conformity to the laws of the United States, the official regulations and instructions thereunder, and the instructions of said Surveyor General, faithfully and correctly executed the survey of the Mining Claim of Mrs. S. Jennings, known as the Hall-Thompson situate in Salt River Mining District, Maricopa County, Arizona, in Sections 13 ^{Unsur.} 15 Township No. 1-S, Range No. 3-East ^{2-East}, and designated as Survey No. 3107, as represented in the foregoing field notes, which accurately show the boundaries of said mining claim as distinctly marked by monuments on the ground, and described in the attached copy of the location certificate, which was received by me from the Surveyor General with said instructions, and that all the corners of said survey have been established and perpetuated in strict accordance with the law, official regulations and instructions thereunder; and I do further solemnly swear that the foregoing are the true and original field notes of said survey and my report therein, and that the labor expended and improvements made upon said mining claim by claimant or his grantors are as therein fully stated, and that the character, extent, location and itemized value thereof are specified therein with particularity and full detail, and that no portion of said labor or improvements so credited to this claim has been included in the estimate of expenditures upon any other claim.

Earl H. Parker
U. S. Deputy Mineral Surveyor.

Subscribed and sworn to by the said Earl H. Parker
U. S. Deputy Mineral Surveyor, before me R. P. Parker
Notary Public this 22nd
day of December 1913

R. P. Parker
Notary Public
Maricopa County Ariz.

My Commission expires Feb. 15, 1916.

Notice of Mining Location

LODE CLAIM

To All Whom It May Concern:

This Mining Claim, the name of which is the "Hall" quartz lode Mining Claim, situate on lands belonging to the United States of America, and in which there are valuable mineral deposits, was entered upon and located for the purposes of exploration and purchase by Wm. S. Jennings who is a citizen of the United States

(Locator must insert either "a citizen of the United States," or, "who has declared his intention to become a citizen of the United States.") the undersigned, on the 29th day of April 1912

The length of this claim is Fifteen Hundred (1500) feet, and 1 claim one hundred (100) feet, in a Northerly direction and Fourteen hundred feet in a Southerly direction from the center of the discovery shaft, at which this notice is posted, lengthwise of the claim, together with Three hundred feet in width of the surface grounds, on each side of the center of said claim. The general course of the lode deposit and premises is from the north to the to the south

The claim is situated and located in the Salt River Mining District, in Maricopa County, in the State of Arizona, about nine miles in a southerly direction from Phoenix.

The Delta No. 3 Patented Mineral Survey 2900 lies east of the "Hall". Also the Delta No. 2 and Richard Stanton Patented lie south of the "Hall".

The surface boundaries of the claim are marked upon the ground as follows: Beginning at a stone monument which is the south center end line of the "Hall" at a point in a South East direction Eight hundred feet from the discovery shaft (at which this notice is posted), being in the center of the South end line of said claim; thence Easterly 300 feet to a stone monument, being the South East corner of said claim; thence Northerly 1500 feet to a stone monument, being at the North East corner of said claim; thence Westerly 300 feet to a stone monument at the center of the North end of said claim; thence Westerly 300 feet to a stone monument, being at the North West corner of said claim; thence Southerly 1500 feet to a stone monument at the South West corner of said claim; thence Westerly 300 feet to the place of beginning.

All done under the provisions of Chapter Six, of Title XXXII, of the Revised Statutes of the United States, and of an Act of the General Assembly of Arizona, entitled "An Act to Revise and Codify the Laws of the State of Arizona," approved March 16, 1901.

Dated and posted on the ground this 29th day of April 1912

Wm. S. Jennings

INDEXED
5151
COMPARED

Notice of Location LODE CLAIM

Keall

Pay

Wm. S. Jennings

Dated _____ 19__

Filed and Recorded at request of

Wm. S. Jennings

MAY 31 1912 A. D. 19__

at *gno* P. M.

Book *21*

Pages *364*

James D. ...
County Recorder.

By *J. S. Hudson*
Deputy Recorder.

100 THE H. H. MCNEIL CO., PRINTERS, PHOENIX, ARIZ.

*Return to Wm. S. Jennings
Box 175 Phoenix Ariz.*

STATE
TERRITORY OF ARIZONA,
County of _____ State _____
I, _____ County Recorder in and for the
County and Territory aforesaid, do hereby certify that the within instrument was filed for record at _____ o'clock _____ M., on this _____ day of _____, 1913, and duly
recorded in Book No. _____ of _____ Records of _____ County,
Arizona, at pages _____
WITNESS my hand and official seal the day and year first above written.

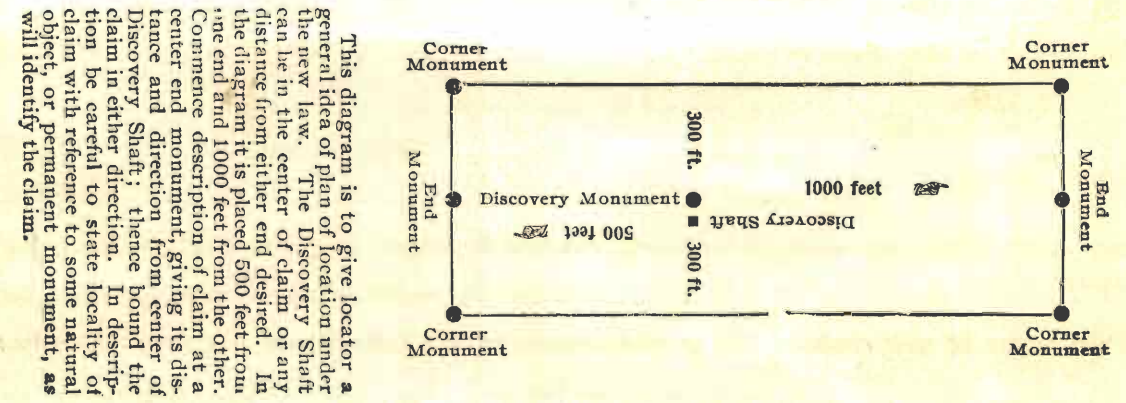

This diagram is to give locator a general idea of plan of location under the new law. The Discovery Shaft can be in the center of claim or any distance from either end desired. In the diagram it is placed 500 feet from one end and 1000 feet from the other. Commence description of claim at a center end monument, giving its distance and direction from center of Discovery Shaft; thence bound the claim in either direction. In description be careful to state locality of claim with reference to some natural object, or permanent monument, as will identify the claim.

Excerpts from the Mining Laws of the State of Arizona.
Title XLVII of the Revised Statutes of 1901, and Amendments Thereto.
Sec. 2. Such location shall be made by erecting at or contiguous to the point of discovery a conspicuous monument of stones not less than three feet in height, or an upright post, securely fixed, projecting at least four feet above the ground, in which monument of stones or on which post there shall be posted a location notice which shall be signed by the name or names of the locator or locators.
Sec. 4. From the time of the location of a mining claim, as above specified, the locator shall be allowed ninety days within which to do or cause to be done the following things:
* * * * *
2. To sink a discovery shaft in the claim to a depth of at least eight feet from the lowest part of the rim of the shaft at the surface, and deeper, if necessary, until there is disclosed in said shaft mineral in place.
Sec. 6. Such surface boundaries shall be marked by six substantial posts projecting at least four feet above the surface of the ground, or by substantial stone monuments at least three feet high, to-wit: One at each corner of said claim and one at the center of each end-line thereof.
Sec. 8. Location notices may be amended at any time and the monuments changed to correspond with the amended location; Provided, That no change shall be made that will interfere with the rights of others.

Notice of Mining Location

LODE CLAIM

To All Whom It May Concern:

This Mining Claim, the name of which is the Thompson quartz lode Mining Claim, situate on lands belonging to the United States of America, and in which there are valuable mineral deposits, was entered upon and located for the purposes of exploration and purchase by Wm S Jennings, who is a citizen of the United States

(Locator must insert either "a citizen of the United States," or, "who has declared his intention to become a citizen of the United States.")

the undersigned, on the 30th day of April 1912

The length of this claim is Fifteen Hundred (1500) feet, and I claim One Hundred (100) feet,

in a southerly direction and Fourteen Hundred feet in a northerly direction from

the center of the discovery shaft, at which this notice is posted, lengthwise of the claim, together with Six Hundred (600) feet in width of the surface grounds, ^{300 feet} on each side of the center of said claim. The general course of the lode deposit and premises is from the South to the North

The claim is situated and located in the Salt River Mining District, in Maricopa County, in the ~~Territory~~ ^{State} of Arizona, about nine miles in a southerly direction from Phoenix.

The Delta No. 3 Patented mineral survey No. 2900 lies east and adjoins this mining claim. The Hall joins on the south.

The surface boundaries of the claim are marked upon the ground as follows: Beginning at a stone monument which is the south center end line of the Thompson

at a point in a southerly direction One hundred feet from the discovery shaft (at which this notice is posted), being in the center of the south end line of said claim; thence Easterly 300 feet to a stone monument, being the south east corner of said claim; thence northerly 1500 feet to a stone monument, being at the north east corner of said claim; thence westerly 300 feet to a stone monument at the center of the north end of said claim; thence westerly 300 feet to a stone monument, being at the north west corner of said claim; thence southerly 1500 feet to a stone monument at the south west corner of said claim; thence Easterly 300 feet to the place of beginning.

All done under the provisions of Chapter Six, of Title XXXII, of the Revised Statutes of the United States, and of an Act of the General Assembly of Arizona, entitled "An Act to Revise and Codify the Laws of the ~~Territory~~ ^{State} of Arizona," approved March 16, 1901.

Dated and posted on the ground this 30th day of April 1912

Wm S Jennings

Excerpts from the Mining Laws of the State ~~of~~ of Arizona.

Title XLVII of the Revised Statutes of 1901, and Amendments Thereto.

Sec. 2. Such location shall be made by erecting at or contiguous to the point of discovery a conspicuous monument of stones not less than three feet in height, or an upright post, securely fixed, projecting at least four feet above the ground, in which monument of stones or on which post there shall be posted a location notice which shall be signed by the name or names of the locator or locators.

Sec. 4. From the time of the location of a mining claim, as above specified, the locator shall be allowed ninety days within which to do or cause to be done the following things:
* * * * *

2. To sink a discovery shaft in the claim to a depth of at least eight feet from the lowest part of the rim of the shaft at the surface, and deeper, if necessary, until there is disclosed in said shaft mineral in place.

Sec. 6. Such surface boundaries shall be marked by six substantial posts projecting at least four feet above the surface of the ground, or by substantial stone monuments at least three feet high, to-wit: One at each corner of said claim and one at the center of each end-line thereof.

Sec. 8. Location notices may be amended at any time and the monuments changed to correspond with the amended location; Provided, That no change shall be made that will interfere with the rights of others.

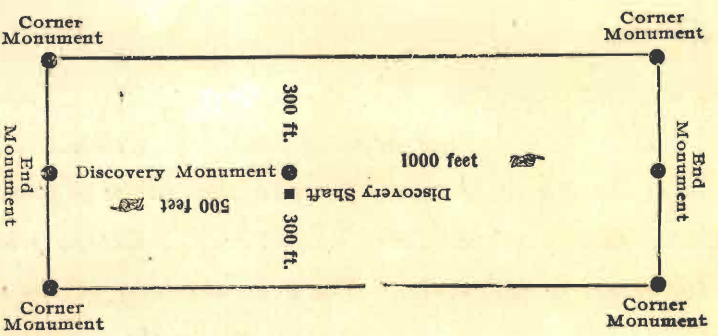

This diagram is to give locator a general idea of plan of location under the new law. The Discovery Shaft can be in the center of claim or any distance from either end desired. In the diagram it is placed 500 feet from one end and 1000 feet from the other. Commence description of claim at a center end monument, giving its distance and direction from center of Discovery Shaft; thence bound the claim in either direction. In description be careful to state locality of claim with reference to some natural object, or permanent monument, as will identify the claim.

INDEXED 5150 COMPARED

Notice of Location
LODE CLAIM

Thompson

Pay

Wm S. Jennings

Dated 19

Filed and Recorded at request of

Wm S. Jennings

MAY 31 1912 A. D. 19

at *Pay* R. M.

Book *91 Minns*

Pages *361-362*

Jennings
County Recorder.

By *J. H. Hudson*
Deputy Recorder.

THE B. H. MOWELL CO., PRINTERS, PHOENIX, ARIZ.

Return to Wm S. Jennings.
Box 175 Phoenix Ariz.

STATE TERRITORY OF ARIZONA, County of *Yavapai*, I, *Wm S. Jennings*, County Recorder in and for the State of *Arizona*, do hereby certify that the within instrument was filed for record at *Pay* day of *May*, 1912, and duly recorded in Book No. *91* of *Minns* Records of *Pay* county, Arizona, at pages *361-362*.
WITNESS my hand and official seal the day and year first above written.

County Recorder.

U. S. SURVEYOR GENERAL'S FINAL CERTIFICATE ON
FIELD NOTES.

DEPARTMENT OF THE INTERIOR,
OFFICE OF U. S. SURVEYOR GENERAL,

Phoenix, Arizona,

May 9, 1914.

I, U. S. Surveyor General for District of Arizona,
do hereby certify that the foregoing transcript of the Field Notes, return and approval
of the Survey of the mining claim of

Wm S. Jennings

, known as the HALL, THOMPSON.

, situate in SALT RIVER

Mining District, MARICOPA County,

ARIZONA, in Sections 13 Uns. T. 1 S.,

R. 2 E.

Range No. 3 E.

, and designated as Survey

No. 3107, has been correctly copied from the originals on
file in this office; that said Field Notes furnish such an accurate description of said
mining claim as will, if incorporated into a patent, serve fully to identify the premises,
and that such reference is made therein to natural objects or permanent monuments as
will perpetuate and fix the locus thereof.

And I further certify that five hundred dollars' worth of labor has been expended
or improvements made upon each of said mining claims by claimant or his grantors, and
that said improvements consist of 3 shafts, total value \$1600.00

and that no portion of said labor or improvements has been included in the estimate of
expenditures upon any other claim.

I further certify that the plat thereof, filed in the U. S. Land Office at Phoenix,
Arizona, is correct and in conformity with the foregoing Field Notes.

Frank S. Ingalls,

United States Surveyor General for Arizona.

4-687.

SURVEYOR-GENERAL'S CERTIFICATE OF APPROVAL OF FIELD NOTES AND SURVEY OF MINING CLAIM.

Department of the Interior.

Office of U. S. Surveyor-General,

Phoenix, Arizona.

May 9, 1914

I, U. S. Surveyor-General for District of Arizona

do hereby certify that the foregoing and hereto attached Field Notes and Return of the Survey of the Mining Claim of

Wm. S. Jennings

known as the

HALL, THOMPSON.

situate in SALT RIVER mining district,

MARICOPA

County,

ARIZONA.

in Section 13 Uns. T 1 S., R. 2 E. 18 Uns., Township No. 1 S., Range No. 3 E.

designated as Survey No. 3107

executed by Earl H. Parker, U. S. Deputy Mineral

Surveyor, December 16-18, 1913, 190, under my instructions dated

December 10, 1913, 190, have been critically examined and the necessary cor-

rections and explanations made, and the said Field Notes and Return, and the Survey they describe,

are hereby approved. A true copy of the copy of the location certificate filed by the applicant for

survey is included in the field notes.

Frank S. Ingalls

U. S. Surveyor-General for Arizona.

(C O P Y)
DEPARTMENT OF THE INTERIOR
GENERAL LAND OFFICE
OFFICE OF ASSISTANT SUPERVISOR OF SURVEYS

Phoenix, Arizona, May 23, 1925.

Mr. Charles M. Donohoe,
U. S. Surveyor General,
Phoenix, Arizona.

Dear Sir:

On dates May 20 and 21, in accordance with Special Instructions for Group No. 135, Arizona, dated April 10, 1925, I made an investigation, on the ground, of the location relative to the public land surveys in Secs. 18 and 19, T. 1 S., R. 3 E., and Secs. 13 and 24, T. 1 S., R. 2 E., Gila Base and Meridian, Arizona, of the following patented mining claims: The Maximillion and Leggat, Mineral Survey No. 2899; the Delta, Delta No. 2, Delta No. 3, and Richard Staunton, Mineral Survey No. 2900; the Hall and Thompson, Mineral Survey No. 3107; and the Oro Grande, Mineral Survey No. 3276.

I find from retracements, that the bearings and lengths of the boundaries of all of these claims, with the exception of the last mentioned, are substantially the same as of record.

The boundaries of the Oro Grande, however, were found to be slightly at variance with the record both in alinement and measurement of the side lines, inasmuch as the end lines of this claim were found to have a bearing and length of S. 73° 20' W., 9.08 chs., instead of S. 75° 26' W., 9.09 chs.; and the side lines a bearing and length of N. 16° 39' W., 22.58 chs., instead of N. 14° 54' W., 22.715 chs., indicated in the record.

From the cor. of Secs. 13, 18, 19 and 24, T. 1 S., R. 2 and 3 E., Cor. No. 4 of Delta No. 3, M. S. No. 2900, brs. S. 35° 17' E., 9.74 chs.; Cor. No. 2, Leggat, M. S. No. 2899, brs. S. 76° 25' E., 34.23 chs.; and Cor. No. 1, of Hall and Cor. No. 4 of Thompson, M. S. 3107, brs. N. 31° 52' W., 11.86 chs. From the quarter-section cor. of Secs. 18 and 19, T. 1 S., R. 3 E., Cor. No. 2, Oro Grande, of M. S. No. 3276, brs. N. 6° 16' W., 32.79 chs.

Attached hereto is a plat of the afore-mentioned sections in T. 1 S., R. 2 and 3 E., on which is shown the true location of said mining claims with relation to same.

(Copy hereof directed to be filed with each of involved M. S., see G.L.O. letter (1174063 "E" WTP) of June 9, 1925).

Very respectfully,
Sidney E. Blout
U. S. Cadastral Engineer.