

Copied March 24, 1916,

1

Platted
A L H

NOV 22 1915

DEC 6- 1915

APR 20 1916

4-683.

DEC 22 1915

JAN 24 1916

Mineral Survey No. 3203

Lot No.

ARIZONA Land District.

FIELD NOTES

OF THE SURVEY OF THE MINING CLAIM OF

JOHN ROARK

KNOWN AS THE

NELLIE BLYE

VERDE Mining District,

YAVAPAI County, ARIZONA.

Sections 23 & 26, Township 16 N., Range 2 E.

Surveyed under instructions dated September 17, 1915,

by J. WILLIAM WAARA,
U. S. ~~Deputy~~ Mineral Surveyor

Claim located See location notice, 1

Survey commenced September 23, 1915, 1

Survey completed September 24, 1915, 1

o 6-169

Address of Attorney
John J. Hawkins,
Prescott Arizona.

*See report of Waara as to
the 579040' W 646.3 ft.
May 24, 1917*

MINERAL SURVEY NO. 3203

NELLIE BLYE

Beginning at cor. No. 1, a porphyry stone 6 x 12 x 24 inches long set twelve inches in the ground with a substantial mound of stone alongside; chiseled N B-1-3203 with cross on top for exact corner point, from which point,

The corner to sections 22-23-26-27, T.16 N.R.2 E. of the Gila and Salt River base and meridian, brs. S.80°-43'W. 666.0 feet.

A rock in place 3 x 2 x 2 feet exposed and chiseled BxR N B-1-3203, brs. S.41°-54'E. 115.8 feet.

A rock in place 6 x 3 x 3 feet exposed and chiseled BxR N B-1-3203, brs. N.21°-10'E. 52.6 feet.

Thence N.46°-49'E.

134.0 Cross road, brs. north to south.

151.0 Intersect line 5-6 No. 7 lode Sur. No. 1213 at N.68°-11'-30"W. 1062.3 feet from Cor. No. 6 and 127.5 feet from its intersection with line 3-4 Lone Star lode Sur. No. 1374.

228.9 NORTH CENTER END, a mound of stone.

252.8 TO COR. NO. 2, on line 3-4 Lone Star Lode Sur. No. 1374 at S.20°-39'E. 146.2 feet from Cor. No. 4 and N.20°-39'W.

1065.0 feet from Cor. No. 3 and 125.1 feet from its intersection with line 5-6 NO. 7 Lode Sur. No. 1213, and also 173.6 feet from N.E. Cor. of Tract "A" ~~in Lone Star Lode~~ from which latter point, the northwest corner of said tract ~~area~~ brs. N.70°-52'W. 177.6 feet; a porphyry stone 6 x 12 x 26 inches long set fifteen inches in the ground with a substantial mound of stone alongside; chiseled N B-2-3203 with cross on top for exact corner point, from which point,

A rock in place 4 x 2 x 0.5 feet exposed and chiseled BxR N B-2-3203 brs. S.30°-57'E. 88.0 feet.

An oak tree 18 inches in diameter and scribed BxT N B-2-3203, brs. S.10°-26'E. 143.9 feet.

Thence S.59°-04'E.

- 547.2 Intersect the line between sections 23 and 26 at S.89°-58'E. 1310.9 feet from Corner to sections 22-23-26-27, and N.89°-58'W. 1327.8 feet from the 1/4 corner between said sections.
- 568.6 Witness corner to Cor. No.3, a syenite stone 7 x 10 x 20 inches long set twelve inches in the ground with a substantial mound of stone alongside, chiseled W C-N B-3-3203 with cross on top for exact corner point.
- 581.6 TO POINT FOR COR.NO.3, on line 5-6 NO.7 Lode Sur. No. 1213, at N.68°-11'-30"W. 445.0 feet from Cor. No.6, which point fell on public highway where it was impracticable to set stone for corner, so I established a witness corner N.59°-04'W. 13.0 feet. from the true point for corner,
 A rock in place 3 x 2 x 0.5 feet exposed and chiseled BxR N B-3-3203, brs. S.56°-01'E. 17.5 feet.
 No other bearings available.
 Thence S.31°-23'E.
- 15.3 intersect line 3-4 Morgan Lode Sur. No. 3202 at N.46°-49'E. 387.3 feet from Cor. No.3
- 125.0 Cross Deception Gulch, flows northeasterly.
- 343.4 TO COR. NO. 4, a malpais stone 5 x 8 x 20 inches long set twelve inches in the ground with a substantial mound of stone alongside, chiseled N B-4-3203 with cross on top for exact corner point,
 No bearings available.
 Thence S.46°-49'W.
- 307.2 SOUTH CENTER END, a mound of stone, identical with N.E.Cor. Remington Lode unsurveyed.
- 322.0 Intersect line 2-3 Morgan Lode Sur. No. 3202 at S.42°-52'E. 321.2 feet from Cor. No.3.
- 460.8 Intersect line 3-4 Lone Star Lode Sur. No.1374, at N.20°-39'W. 95.3 feet from Cor. No.3 and S.20°-39'E. 796.1 feet from ~~point for N.E.Cor of Tract "A" area in Lone Star lode Sur No. 1374,~~ and 71.0 feet from ~~maxi~~ southeast ~~maxixx~~ corner of said tract.
- 614.4 TO COR. NO.5, a rock in place 4 x 2 x 3 feet exposed and chiseled N B-5-3203 with cross for exact corner point, and mound of stone alongside.

No bearings available.

Thence N.26°-15'W.

- 271.1 point for S.W. Corner of Tract "A" ~~area in Lone Star lode~~
~~Sur. No. 1374~~, from which point the ~~most~~ southeast corner
of said tract brs. S.70°-52'E. 219.0 feet, and ~~next~~ north-
west corner brs. N.18°-03'W. 699.3 feet.
- 345.0 Cross Deception Gulch, flows northeasterly.
- 420.0 Cross road, brs. southwest to northeast.
- 716.0 Cross road brs. north to south.
- 816.0 Intersect the line between sections 23 and 26 at S.89°-
58'E. 710.4 feet from Cor. to sections 22-23-26-27, and
N.89°-58'W. 1928.3 feet from the 1/4 corner between said
sections.
- 936.2 TO THE PLACE OF BEGINNING. All corners are identical with
their respective locations. variation at all corners N.15°
-00'E.

LODE LINE

As near as can be determined from the present
developments, the veins on this lode extends as follows
from the discovery:

S.30°-56'E. 753.0 feet, and N.30°-56'W. 163.5 feet.

AREA

	Acres	Acres
NELLIE BLYE lode		
Total area - - - - -		9.979
Area in conflict with		
Lone Star Lode Sur.No.1374	4.177	
NO.7 Lode Sur. No.1213	0.652	
Morgan Lode Sur.No.3202	2.614	
Common conflict with NO.7 lode		
Sur.No. 1213 and Lone Star Lode		
Sur. No. 1374 - - - - -	0.135	
Tract " A " - - - - -		2.536

LOCATION

This survey is located upon surveyed land in sections
23 and 26, T.16 N.R.2 E. of the Gila and Salt River Base
and Meridian, within the Prescott National Forest, Verde
Mining District, Yavapai County, State of Arizona.

EXPENDITURE OF FIVE HUNDRED DOLLARS

I hereby certify that the value of the labor and improvements made upon, or for the benefit of this location by the claimant or his grantors is not less than five hundred dollars, and that said improvements consists of:

No.1 Discovery Shaft, the center of which brs. S.30°-52'E. 163.5 feet from the north center end, 4 x 6x 15 feet deep.

value \$150.00

No.2 Cut and tunnel, the mouth of ^{tunnel} brs. S.31°-30'E. 262 feet from North Center End, cut 4 x 26 x 9 foot face and tunnel 4 x 6 x 29 feet long.

value \$450.00

ADJOINING CLAIMS

On the west by the Lone Star Lode Sur. No. 1374, H.J. Crane et al claimants, on the north by NO.7 Lode Sur.No. 1213, Hull Copper Company, claimant, on the east and south east by the Morgan Lode Sur. No. 3202, United Verde Extension Mining Company claimant, and on the south by the Remington Lode, unsurveyed, Calumet and Jerome Copper Company claimants,

INSTRUMENT

This survey was made with a Lietz Light Mountain transit theodolite, No. 13-5929. The courses were deflected from the true meridian, as determined by observations by the use of the Gaegmuller Solar Attachment. The distances were measured with a 500 foot steel tape.

REPORT

The corner to sections 22-23-26-27, T.16 N.R.2 E. is an iron post properly set and marked as described in the field notes for said section.

Sur. No. 1213

No.7 Lode. The corners 5 and 6 are stones properly set and chiseled with the number of corner and survey. I do not agree with the course of line 5-6 of this survey.

Sur. No. 1374

Lone Star Lode. All corners of this lode are stones properly set and chiseled with the number of corner and survey. I do not agree with the course and distance of ~~the~~ lines of this survey.

Sur. No. 3202

Morgan Lode. The corners of this survey are stones properly set and chiseled with the number of corner and survey.

The discrepancies found existing between the claim as marked by the location monuments, and as described in the location notices are due to errors in the location notices.

The discrepancies between the lines of this survey and prior approved surveys are due to errors in the latter.

William Waara
- U. S. MINERAL SURVEYOR. -

FINAL OATHS FOR SURVEYS.

LIST OF NAMES.

A list of the names of the individuals employed by J. WILLIAM WAARA

United States ~~Deputy~~ Mineral Surveyor, to assist in running, measuring, and marking the lines, corners, and boundaries described in the foregoing field notes of the survey of the mining claim of JOHN ROARK

known as the NELLIE BLYE

and showing the respective capacities in which they acted.

JAMES M. SULLIVAN , *Chainman.*
 , *Chainman.*
 , *Arman.*
 , *Flagman.*

FINAL OATHS OF ASSISTANTS.

We, I, JAMES M. SULLIVAN

and , do solemnly swear that ^I~~we~~ assisted J. WILLIAM

WAARA , United States ~~Deputy~~ Mineral Surveyor, in marking the corners and surveying the boundaries of the mining claim of JOHN ROARK

known as the NELLIE BLYE

represented in the foregoing field notes as having been surveyed by said ~~deputy~~ mineral surveyor and under his direction; and that said survey has been in all respects, to the best of ^{my}~~our~~ knowledge and belief, faithfully and correctly executed, and the corner and boundary monuments established according to law and the instructions furnished by the United States Surveyor-General for ARIZONA

..... , *Chainman.*
James M Sullivan , *Chainman.*
 , *Arman.*
 , *Flagman.*

Subscribed and sworn to by the above-named persons before me this September

day of October, 1905

[Handwritten signature]

 Notary Public

FINAL OATH OF U. S. ~~DEPUTY~~ MINERAL SURVEYOR

I, **J. WILLIAM WAARA**, U. S. ~~Deputy~~ Mineral Surveyor, do solemnly swear that, in pursuance of instructions received from the United States Surveyor General for **ARIZONA**, dated **SEPTEMBER 17, 1915**, I have, in strict conformity to the laws of the United States, the official regulations and instructions thereunder, and the instructions of said Surveyor General, faithfully and correctly executed the survey of the Mining Claim of **JOHN ROARK**

known as the **NELLIE BLYE**, situate in **VERDE** Mining District, **YAVAPAI** County, **ARIZONA**, in Section **23 & 26**, Township No. **16 N.**, Range No. **2 E.** and designated as Survey No. **3203**

as represented in the foregoing field notes, which accurately show the boundaries of said mining claim as distinctly marked by monuments on the ground, and described in the attached copy of the location certificate, which was received by me from the Surveyor General with said instructions, and that all the corners of said survey have been established and perpetuated in strict accordance with the law, official regulations and instructions thereunder; and I do further solemnly swear that the foregoing are the true and original field notes of said survey and my report therein, and that the labor expended and improvements made upon said mining claim by claimant or **his** grantors are as therein fully stated, and that the character, extent, location and itemized value thereof are specified therein with particularity and full detail, and that no portion of said labor or improvements so credited to this claim has been included in the estimate of expenditures upon any other claim.

J. William Waara
U. S. ~~Deputy~~ Mineral Surveyor.

Subscribed and sworn to by the said **J. WILLIAM WAARA**

U. S. ~~Deputy~~ Mineral Surveyor, before me

this **3rd** day of **October**, 19**15**.

Lewis D. Jones
Notary Public

My commission expires **August 23d, 1917.**

AMENDED

Notice of Mining Location

LODE CLAIM

SEP. 17. 1915

TO ALL WHOM IT MAY CONCERN:

This Mining Claim, the name of which is the NELLIE BLYE, Mining Claim, situate on lands belonging to the United States of America, and in which there are valuable mineral deposits, was entered upon and located for the purposes of exploration and purchase by JOHN ROARK, A CITIZEN OF THE UNITED STATES.

Locator must insert either "a citizen of the United States," or "who has declared his intention to become a citizen of the United States." the undersigned, on the 13TH., day of SEPT., 1915..

The length of this claim is 916.4 feet, and I claim 163.5 feet, in a northwesterly direction and 752.9

feet in a southeasterly direction from the center of the discovery shaft, at which this notice is posted, lengthwise of the claim, together with 300 feet in width of the surface grounds, on each side of the center of said claim. The general course of the lode deposit and premises is from the southeast to the northwest

The claim is situated and located in the VERDE Mining District, in YAVAPAI County, in the State of Arizona, about 25 feet in a southerly direction from limits of the Town of Jerome,

The surface boundaries of the claim are marked upon the ground as follows: Beginning at a monument of stone,

at a point in a northwesterly direction 163.5 feet from the discovery shaft (at which this notice is posted,) being in the center of the northerly end line of said claim; thence N.46° - 49'E. 23.9 feet to a mon.of stone, being the most northerly corner of said claim; thence S.59°-04'E. 581.6 feet to a mt.for cor.witnessed by a monument being at the N.59°-04'W.14 ft.from point corner of said claim; thence S.31°-23'E. 343.4 feet to a mon.of stone being the S.E.Cor., Thence S.46°-49'W.307.2 ft. to a mon.of stone, at the center of the southerly end of said claim; thence S.46°-49'W. 307.2 feet to a mon.of stone, being at the S.W. corner of said claim; thence N.26°-15'W. 936.2 feet to a mon.of stone, at the northwest corner of said claim; thence N.46°-49'E. 228.9 feet to the place of the beginning.

All done under the provisions of Chapter Six, of Title XXXII, of the Revised Statutes of the United States, and of an Act of the General Assembly of Arizona, entitled "An Act to Revise and Codify the Laws of the Territory of Arizona," approved March 16, 1901.

This is the Amended Location Notice of the NELLIE BLYE - (amended) Mining Claim, located by JOHN ROARK,

on the 11th., day of JUNE 1915., and recorded in Book 86 of Records of Mines, at page 474, in the office of the County Recorder of the aforesaid County of YAVAPAI, to which reference is hereby made and this Amended Location Notice is made and posted to correct errors in the description in the said amended Location Notice.

Dated and posted on the ground this 13th., day of SEPT., 1915.

JOHN ROARK.

10

County of

I,, County Recorder in and for the County and

State aforesaid, do hereby certify that the within instrument was filed for record ato'clock.....M.,

on this day of, 191....., and duly recorded in Book No.....

of Records of County, Arizona, at pages.....

Witness my hand and official seal the day and year first above written.

County Recorder.

SECOND AMENDED

Notice of Location

LODE CLAIM

.....
.....
.....
.....

Dated 191.....

Filed and Recorded at request of

Jno. J. Hawkins,

Sept., 15th., A. D. 1915.

at **11:20 - 0'clock, A. M.**

Book **86 of Mines.**

Page **513; Records of Yavapai County, Arizona.**

(**SEAL.**) **L.S. Colwell,**
County Recorder.

By **E. A. McGinnis,**
Deputy Recorder.

Printed and for sale by the Prescott Courier

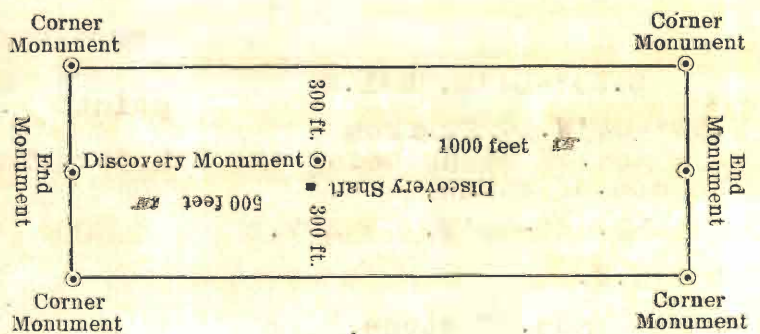

This diagram is to give locator a general idea of plan of location under the new law. The Discovery Shaft can be in the center of claim or any distance from either end desired. In the diagram it is placed 500 feet from one end and 1000 feet from the other. Commence description of claim at a center end monument, giving its distance and direction from center of Discovery Shaft; thence bound the claim in either direction. In description be careful to state locality of claim with reference to some natural object, or permanent monument, as will identify the claim.

U. S. SURVEYOR-GENERAL'S FINAL CERTIFICATE ON FIELD NOTES.

Department of the Interior,

OFFICE OF U. S. SURVEYOR-GENERAL,

Phoenix, Arizona,

April 6, 1916.

I, U. S. Surveyor-General for District of Arizona

do hereby certify that the foregoing transcript of the Field Notes, return and approval of the survey of the mining claim of

JOHN ROARKknown as the NELLIE BLYEsituate in VERDEMining District, YAVAPAI County, ARIZONA.in Sections 23 & 26, Township No. 16 N., Range No. 2 E., anddesignated as Survey No. 3203, has been correctly copied from the originals on file in this office; that said Field Notes furnish such an accurate description of said mining claim as will, if incorporated into a patent, serve fully to identify the premises, and that such reference is made therein to natural objects or permanent monuments as will perpetuate and fix the *locus* thereof.

And I further certify that five hundred dollars' worth of labor has been expended or improvements made upon said mining claim by claimant or his grantors, and that said improvements consist of 1 shaft and 1 cut and tunnel, total value \$600.

and that no portion of said labor or improvements has been included in the estimate of expenditures upon any other claim.

I further certify that the plat thereof, filed in the U. S. Land Office at Phoenix,Arizona, is correct and in conformity with the foregoing Field Notes.Frank P. Trott,United States Surveyor-General for Arizona.

4-687.

**SURVEYOR-GENERAL'S CERTIFICATE OF APPROVAL OF FIELD
NOTES AND SURVEY OF MINING CLAIM.**

Department of the Interior.

Office of U. S. Surveyor-General,

..... Phoenix, Arizona,

..... April 6, 1916.

I, U. S. Surveyor-General for District of Arizona

do hereby certify that the foregoing and hereto attached Field Notes and Return of the Survey of the
Mining Claim of

..... JOHN ROARK

....., known as the

..... NELLIE BLYE

situate in VERDE mining district,

YAVAPAI County, ARIZONA .

in Sections 23 & 26,, Township No. 16 N.,, Range No. 2 E.

....., designated as Survey No. 3203

executed by J. William Waara, U. S. ~~Deputy~~ Mineral

Surveyor, September 23-24,, 1915, under my instructions dated

..... September 17,, 1915, have been critically examined and the necessary cor-

rections and explanations made, and the said Field Notes and Return, and the Survey they describe,

are hereby approved. A true copy of the copy of the location certificate filed by the applicant. for

survey is included in the field notes.



U. S. Surveyor-General for Arizona.