

Aug. 13 1915

4-683.

Mineral Survey No. 3210

Lot No. _____

Arizona

Land District.

FIELD NOTES

OF THE SURVEY OF THE MINING CLAIM OF

W. H. Bones

KNOWN AS THE

Mastodon

Turkey Creek

Mining District,

Yavapai

County, Arizona

Section Approx. 17, Township 12 N, Range 1 W Unsmear

in Prescott National Forest

Surveyed under instructions dated July 8 - , 1915

by William H. Mumt

U. S. ~~Deputy~~ Mineral Surveyor

Claim located See location notes, 1

Survey commenced August 8 - , 1915

Survey completed August 9 - , 1915

Address of Claimant

Robert E. Morrison, Atty

Prescott Arizona

MASTODON

Beginning at Cor. No. 1, the north corner.

Identical with the loc. See also the following.

A Granite stone 3X8X24 ins. set 12 ins. in the ground with mound of stones chiseled X-1-M-3210. Whence :-

U.S.M.M. No. 3.T.C. brs. N 28°43'E 9445.63 ft.

An oak tree 5 ins. diam. scribed X-B-T-1-M-3210 brs. S 50°E 177 ff.

" " " 10 " " " X-B-T-1-M-3210 brs. S 25°W 29.7 ft.

Loc. cor. mound of stones 2X3 ft.

Feet Thence S 44°57'E va. 15°E
195 Cross road course N 38°E & S 38°W
292 " Turkey Creek course S 43°W
300 N.E.C. End identical with the loc. a mound of stones 3X3 ft.

600 To Cor. No. 2, the east corner.

Identical with the loc.

A Porphyry stone 6X10X24 ins. set 12 ins. in the ground with mound of stones chiseled, X-2-M-3210. Whence:-

A Pine tree 8 ins. diam scribed X-B-T-2-M-3210 brs. N 50°E 11. ft,

An oak tree 14 ins. diam. scribed X-B-T-2-M. 3210 brs. S 60°E 26.2 ft.

Loc. cor. mound of stones 3X3 ft.

700 Thence S 45°03'W va. 15°00 E
Cross Turkey ^{Creek} 6 ft. wide course S 22°W

1500 To Cor. No. 3, the south corner.

Identical with the loc.

A Cyanite stone 3X8X24 ins. set 12 ins. in the ground with mound of stones chiseled, X-3-M-3210 Whence:-

A Pine tree 24 ins. diam. scribed X-B-T-M-3-3210 brs. S 28°W 15. ft.

Oak tree 8 ins. diam. scribed X-B-T-3-M-3210 brs. N 60°W 53.4 ft.

Loc. cor. mound of stones 3X2 ft.

Thence N 44°57'W va. 15°E

300 S.W.C. End. identical with the loc. a mound of stones 3X3 ft.

600 To Cor. No. 4, the west corner.

Identical with the loc.

A cyanite stone 10X12X24 ins. set 12 ins. in the ground with mound of stones chiseled X-4-M-3210. Whence:-

An oak tree 8 ins. diam scribed X-B-T-4-M-3210 brs. S 55°E 21 ft.

Juniper tree 30 ins. diam scribed X-B-T-4-M-3210 brs. S 20°W 11 ft.

Loc. cor. mound of stones 3X3 ft.

Survey No. 3210 continued

240
1500

Thence N 45°03'E va. 15°E
Cross road course S 75°E & N 75°W
To Cor. No. 1 the place of beginning

Area 20.661 acres.

LOCATION

This claim is located ^{approximately} in sec. 17, T. 12 N. R. 1 W Unsurveyed, Turkey Creek Mining District, Yavapai Co., Arizona, within Prescott National Forest.

LODE LINE

As near as can be determined from present developments the vein of this location extends as follows.
1500 ft. N 45°03'E from S.W.C. End to the N.E.C. End.

ADJOINING CLAIMS

This claim is bounded on the North by Geo. Freyda lode unsurveyed, owned by Bones Bros! on the East by U.S. Land, on the South by Oldman Hedgen lode, unsurveyed, owned by Bones Bros. and on the West by U.S. Land.

EXPENDITURE OF FIVE HUNDRED DOLLARS

I certify that the value of the labor and improvements ^{made} upon this claim by the claimant or his grantors, is not less than five hundred dollars, and said improvements consist of:

- No. 1 dis. tunnel which is on the lode line, 127 ft. from the S.W.C. End. 4X6X90 f. to course S 46°W value... \$630.00
- No. 2 tunnel which hrs. from cor. No. 1 S 24°W 435 ft. course S 45°W 4X6X20 ft. value... \$140.00

INSTRUMENT

This survey was made with a Surley Solar Transit. The courses were deflected from the meridian as determined by direct Solar observations. The distances were measured with 100-ft. and 500-ft. steel tapes.

The tie line and the lode line of this claim were run direct upon the ground, and the several corners were established by means of offsets from the lode line.

U.S.M.M. No. 3 T.C. Is U.S.M.M. No. 3. T.C. chiseled on granite rock in place 5X2 ft. above the ground with mound of stones 5 ft. base X 4 ft. high, situated on a ridge on the Scookum lode sur. No. 913.

W. J. Merrill
U.S. Mineral Surveyor

FINAL OATHS FOR SURVEYS.

LIST OF NAMES.

A list of the names of the individuals employed by William H. Merritt

United States ~~Deputy~~ Mineral Surveyor, to assist in running, measuring, and marking the lines, corners, and boundaries described in the foregoing field notes of the survey of the mining claim of _____

known as the W. H. Bones,
Mastodon

and showing the respective capacities in which they acted.

- _____, Chainman.
- Geo. Merritt, Chainman.
- _____, Axman.
- _____, Flagman.

FINAL OATHS OF ASSISTANTS.

I Geo. Merritt
and _____, do solemnly swear that I assisted William H. Merritt, United States ~~Deputy~~ Mineral Surveyor, in marking the corners and surveying the boundaries of the mining claim of W. H. Bones,

known as the Mastodon.

represented in the foregoing field notes as having been surveyed by said ~~deputy~~ mineral surveyor and under his direction; and that said survey has been in all respects, to the best of our knowledge and belief, faithfully and correctly executed, and the corner and boundary monuments established according to law and the instructions furnished by the United States Surveyor-General for Arizona

- Geo. Merritt, Chainman.
- _____, Chainman.
- _____, Axman.
- _____, Flagman.

Subscribed and sworn to by the above-named persons before me this 12th day of August, 1915

Ziba O. Brown, Notary Public,
Yavapai County, Arizona

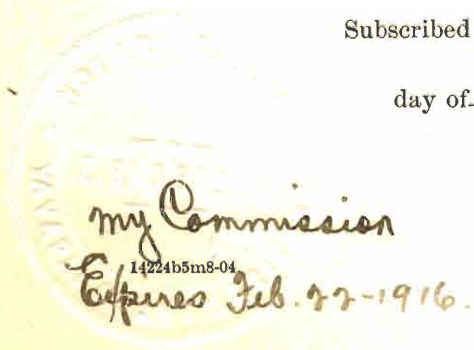

FINAL OATH OF U. S. ~~DEPUTY~~ MINERAL SURVEYOR

I, William H. Merritt, U. S. ~~Deputy~~ Mineral Surveyor, do solemnly swear that, in pursuance of instructions received from the United States Surveyor General for Arizona, dated July 8 - 1915, I have, in strict conformity to the laws of the United States, the official regulations and instructions thereunder, and the instructions of said Surveyor General, faithfully and correctly executed the survey of the Mining Claim of W. H. Jones, known as the Mastodon, situate in Turkey Creek Mining District, Yavapai County, Arizona, in Section Apprx. 17, Township No. 12 N., Range No. 1 W. Unsurveyed and designated as Survey No. 3210, as represented in the foregoing field notes, which accurately show the boundaries of said mining claim as distinctly marked by monuments on the ground, and described in the attached copy of the location certificate, which was received by me from the Surveyor General with said instructions, and that all the corners of said survey have been established and perpetuated in strict accordance with the law, official regulations and instructions thereunder; and I do further solemnly swear that the foregoing are the true and original field notes of said survey and my report therein, and that the labor expended and improvements made upon said mining claim by claimant or his grantors are as therein fully stated, and that the character, extent, location and itemized value thereof are specified therein with particularity and full detail, and that no portion of said labor or improvements so credited to this claim has been included in the estimate of expenditures upon any other claim.

William H. Merritt
U. S. ~~Deputy~~ Mineral Surveyor.

Subscribed and sworn to by the said William H. Merritt
U. S. ~~Deputy~~ Mineral Surveyor, before me a Notary Public in and for
Yavapai County Arizona this 12
day of August 1915

Ziba O. Brown Notary Public
Yavapai County Arizona

my Commission
Expires Feb 22 - 1916.

6
JUL 10-1915

AMENDED
Notice of Mining Location
LODE CLAIM

TO ALL WHOM IT MAY CONCERN:

This Mining Claim, the name of which is the Mastodon
Mining Claim, situate on lands belonging to the United States of America, and in which there are valuable
mineral deposits, was entered upon and located for the purposes of exploration and purchase by
Geo. H. Freyda,

A citizen of the United States,

Locator must insert either "a citizen of the United States," or "who has declared his intention to become a citizen of the United States."

the undersigned, on the 1st., day of January, 1901.

The length of this claim is 1500 feet,
and 1 claim 1400 feet,
in a Northerly direction and 100

feet in a Southerly direction from
the center of the discovery shaft, at which this notice is posted, lengthwise of the claim, together with
300 feet in width of the surface grounds, on each
side of the center of said claim. The general course of the lode deposit and premises is from the
Southerly to the Northerly

The claim is situated and located in the Turkey Creek Mining District, in
Yavapai County, in the State of Arizona, about 5 miles
in a Southwesterly direction from the town of Poland, in said
county.

The surface boundaries of the claim are marked upon the ground as follows: Beginning at
A monument of Stones

at a point in a southerly direction one hundred feet from
the discovery shaft (at which this notice is posted,) being in the center of the southerly
end line of said claim; thence Easterly 300 feet to a like
monument, being the S.E. corner of said claim;
thence northerly 1500 feet to a like monument, being at the
N.E. corner of said claim; thence westerly 300 feet
to a like monument at the center of the northerly end/line of said claim;
thence westerly 300 feet to a like monument, being at the
N.W. corner of said claim; thence southerly 1500
feet to a like monument at the S.W. corner of said claim;
thence easterly 300 feet to the place of the beginning.

All done under the provisions of Chapter Six, of Title XXXII, of the Revised Statutes of the United
States, and ~~as amended by the Revised Statutes of Arizona, 1913.~~
Revised Statutes of Arizona, 1913.

This is an Amended Location Notice of the Mastodon,
Mining Claim, located by Geo. H. Freyda,
on the 1st. day of
January 1901., and recorded in Book 59 of Records of Mines, at
page 166, in the office of the County Recorder of the aforesaid County of Yavapai,
to which reference is hereby made, and this Amended Location Notice is made and posted to correct errors
in the description in the said Original Location Notice.

Dated and posted on the ground this 5th. day of June, 1915.

W. H. Bones

ss.

County of

I, County Recorder in and for the County and State aforesaid, do hereby certify that the within instrument was filed for record ato'clock.....M., on this day of, 191....., and duly recorded in Book No..... of Records of County, Arizona, at pages.....

Witness my hand and official seal the day and year first above written.

..... County Recorder.

AMENDED
Notice of Location
LODE CLAIM

Dated 191.....
Filed and Recorded at request of

Robt. E. Morrison,

June 15th., A. D. 1915.

at 3:49 O'clock, P. M.

Book 86 of Mines ;

Page 475; Records of Yavapai County, Arizona.

(SEAL.) L.S. COLWELL,
County Recorder.

By
James W. Coyne,
Deputy Recorder.

Printed and for sale by the Prescott Courier

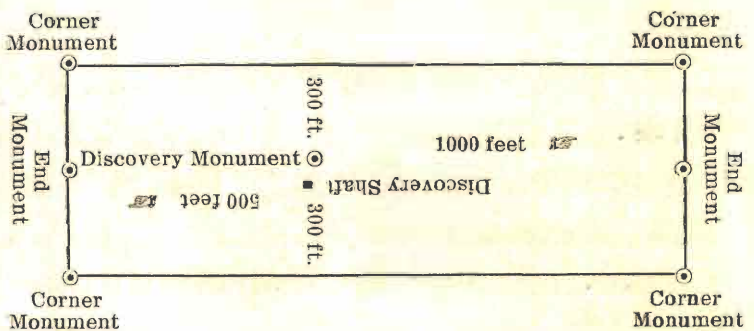

This diagram is to give locator a general idea of plan of location under the new law. The Discovery Shaft can be in the center of claim or any distance from either end desired. In the diagram it is placed 500 feet from one end and 1000 feet from the other. Commence description of claim at a center end monument, giving its distance and direction from center of Discovery Shaft; thence bound the claim in either direction. In description be careful to state locality of claim with reference to some natural object, or permanent monument, as will identify the claim.

U. S. SURVEYOR GENERAL'S FINAL CERTIFICATE ON
FIELD NOTES.

DEPARTMENT OF THE INTERIOR,
OFFICE OF U. S. SURVEYOR GENERAL,

Phoenix, Arizona,

October 13, 1915.

I, U. S. Surveyor General for District of Arizona,
do hereby certify that the foregoing transcript of the Field Notes, return and approval
of the Survey of the mining claim of

W. H. Bones

, known as the Mastodon

, situate in Turkey Creek

Mining District, Yavapai County,

Arizona. Approx, in Section 17, Township No. 12 N,

Range No. 1 W., unsur., and designated as Survey

No. 3210, has been correctly copied from the originals on

file in this office; that said Field Notes furnish such an accurate description of said
mining claim as will, if incorporated into a patent, serve fully to identify the premises,
and that such reference is made therein to natural objects or permanent monuments as
will perpetuate and fix the locus thereof.

And I further certify that five hundred dollars' worth of labor has been expended
or improvements made upon said mining claim by claimant or his grantors, and
that said improvements consist of

and that no portion of said labor or improvements has been included in the estimate of
expenditures upon any other claim.

I further certify that the plat thereof, filed in the U. S. Land Office at Phoenix,
Arizona, is correct and in conformity with the foregoing Field Notes.

Frank S. Ingalls,

United States Surveyor General for Arizona.

4-687.

SURVEYOR-GENERAL'S CERTIFICATE OF APPROVAL OF FIELD NOTES AND SURVEY OF MINING CLAIM.

Department of the Interior.

Office of U. S. Surveyor-General,

Phoenix, Arizona,

October 13, 1915

I, U. S. Surveyor-General for District of Arizona

do hereby certify that the foregoing and hereto attached Field Notes and Return of the Survey of the Mining Claim of

W. H. Bones

, known as the

MAST O DON

situate in TURKEY CREEK mining district,

YAVAPAI

County,

ARIZONA, Approx.

in Section 17, Township No. 12 N., Range No. 1 W., unsur.

, designated as Survey No. 3210

executed by William H. Merritt, U. S. Deputy Mineral

Surveyor, August 8-9, 1915, under my instructions dated

July 8, 1915, have been critically examined and the necessary cor-

rections and explanations made, and the said Field Notes and Return, and the Survey they describe,

are hereby approved. A true copy of the copy of the location certificate filed by the applicant for

survey is included in the field notes.

Handwritten signature of Frank S. Ingalls

U. S. Surveyor-General for Arizona.