

DEC 17 1915

DEC 22 1915

4-683.

Mineral Survey No. 3239

Lot No.

ARIZONA Land District.

FIELD NOTES

OF THE SURVEY OF THE MINING CLAIM OF

HEYWARD M. GIBBES

KNOWN AS THE

GRANNY

VERDE Mining District,

YAVAPAI County, ARIZONA.

Section 22 unsur., Township 16 N., Range 2 E.

Surveyed under instructions dated September 9, 1915,

by J. WILLIAM WAARA, U. S. Deputy Mineral Surveyor

Claim located See location notice, 1

Survey commenced September 19, 1915, 1

Survey completed September 20, 1915., 1

o 6-163

Address of attorney

John J. Hawkins,

Prescott Arizona.

MINERAL SURVEY NO. 3239

GRANNY LODE.

Beginning at Cor. No.1, identical with the point for corner No.4 Silver Giant Lode, and located on line 1-4 NO.13 Lode at N.85°-45'E. 404.9 feet from Cor. No.1; a limestone 6 x 8 x 18 inches long set 12 inches in the ground with a substantial mound of stone alongside; chiseled G-1-3239 and S G-No.4-1284, with a cross on top for exact corner point, from which point,

A rock in place 6 x 2 x 1 ^{ft.} exposed and chiseled B x R - S G _____ and G-1-3239, brs. N.71°-05'W. 18.0 ft.

The corner to sections 22-23, 26-27, T.16 N.R.2 E. of the Gila and Salt River base and meridian, brs. S.79°-42'E. 3592.4 feet.

No other bearings available.

Thence S.85°-45'W.

106.1 SOUTH CENTER END, a mound of stone, whence location monument, 3 foot base and 2 feet high, brs. S.85°-45'W. 15.0 feet.

237.9 Intersect line 1-4 Lucky Boy Lode Sur.No. 1350, at S.11°-02'E. 560.3 feet from the point for Cor.No.1.

404.9 TO COR. NO. 2, identical with Cor. No.1, NO.13 Lode Sur. No. 1284, a limestone 9 x 12 x 12 inches exposed with a substantial mound of stone alongside; chiseled 2-G-3239, NO.13-1-1284, with cross on top for exact corner point, from which point,

A limestone reef, 2 x 0.6 x 0.6 feet exposed and chiseled B x R G-2-3239, brs. N.8°-54'W. 31.3 feet.

No other bearings available.

Thence N.1°-58'W.

559.1 TO COR. NO. 3, identical with the point for Cor.No.1, Lucky Boy Lode, Sur.No.1416, ^{and Cor. No.1 Sunrise lode, Sur. No.3240,} where it was impracticable to set a stone for corner, ^{due to bed rock being too close to the surface.} so I established a Witness Corner N.7°-01'E. 7.1 feet, on a rock in place (limestone reef) five feet high; chiseled W C-G-3-3239 with cross for exact corner point. From point for corner,

A rock in place (limestone reef) five feet high

and chiseled B x R S-1-3240, (no other markings possible)
brs. S.7°-22'W. 8.7 feet.

A rock in place (Limestone reef) five feet high
and chiseled B X R, L B brs. S.41°-43'W. 12.8 feet.

Thence N.7°-01'E.

- 3.6 Intersect line 1-2 Lucky Boy Lode Sur. No. 1350 at West
78.0 feet from the point for corner No.1.
- 7.1 Witness Corner, ^{for Cor. No.3,} previously described.
- 154.2 TO COR.NO.4, ^{on line 1-4 Lucky Boy lode, Sur. No.1416, at S.7°01'W. 93.9 ft. from Cor. No.4,} identical with Cor. No.5 Fisher's Corner Lode,
Sur.No.1284, where I set a new stone for corner, a limestone
27 x 12 x 5 ^{inches/} set twelve inches in the ground with a substan-
tial mound of stone alongside; chiseled G-4-3239 with cross
on top for exact corner point, from which point, the location
monument, 3 ft. base and 2 ft. high, brs S.85°-45'W. 37.0 feet.
A rock in place 3 x 3 x 2 feet exposed and chiseled
B X R F C-5-1284, brs. N.36°-31'E. 32.1 feet. (No other
markings possible)

An outcropping 3 x 4 x 3 feet exposed and chi-
seled B x R-G-4-3239, brs. N.85°-45'E. 90.1 feet.

Thence N.85°-45'E.

- 258.4 NORTH CENTER END, a mound of stone.
- 292.25 Witness Corner to Cor, No.5 of this survey, a diorite
stone 6 x 9 x 20 inches long set twelve inches in the
ground, with a substantial mound of stone alongside;
chiseled W C-G-5-3239 with cross on top for exact corner
point, from which point,
A boulder 4 x 4 x 4 feet exposed and chiseled
B X R F C-No.1-1284, G-5-3239, brs. S.13°-17'W. 32.4 feet.
Cor. No.1 Fisher's Corner Lode Sur.No. 1284,
Brs. S.13°-53'E. 23.85feet.
Cor. No.3 Silver Giant Lode Sur.No. 1284, brs.
N.4°-24'W. 71.5 feet.
- 294.3 TO POINT FOR COR. NO.5 where it was impracticable to set a
corner stone, due to bed rock, so I established a witness
corner as previously described at S.85°-45'W. 2.05 feet.

Thence S.8°-56'E.

23.6 Corner No.1 Fisher's Corner Lode Sur.No. 1284,whence Cor. No.3 Silver Giant Lode Sur.No. 1284, brs. N.6°-47'W. 95.1 feet, and Cor.No.5 Fisher's Corner lode brs. N.89°42'W. 297ft.

712.8 TO THE PLACE OF BEGINNING. All corners are identical with their respective locations except where otherwise mentioned. variation at all corners, 15°-00'E.

LODE LINE

As near as can be determined from the present developments, the vein on this lode extends as follows from the discovery:

S.3°-17'E. 83 .0 feet, and N.3°-17'W. 627.5 feet.

AREA

GRANNY LODGE		Acres.	Acres.
Total area	-----	-----	5.856 ✓
Area in conflict with Fisher's Corner Lode Sur.No. 1284	-----	0.079 ✓	
Lucky Boy Lode, Sur.No.1350	-----	1.573 ✓	

LOCATION

This survey is located upon unsurveyed land in approximately Section 22, T.16 N.R.2 E. of the Gila and Salt River Base and meridian, within the Prescott National Forest, Verde Mining District, Yavapai County, State of Arizona.

EXPENDITURE OF FIVE HUNDRED DOLLARS

I hereby certify that the value of the labor and improvements made upon, or for the benefit of this location by the claimant or his grantors is not less than five hundred dollars, and that said improvements consist of:

No.1, Discovery Cut, the center of which brs. N.3°-17'W. 83 feet from South Center End, 4 x 15 x 10 foot face (caved)

value \$100.00

No.2 Cut and Tunnel, the mouth of tunnel brs. N.46°-17'W. 148 feet from Cor. No.1, cut 4 x 16 x 12 foot face running easterly to its mouth, and tunnel 4 x 6 x 50 feet long running westerly to the breast.

Value	Cut	\$100.00
	Tunnel	\$500.00

OTHER IMPROVEMENTS

No.3 Cut, the mouth of which brs. N.76°-10'W. 152 feet from Cor. No.1, 4 x 16 x 10 foot face.(caved)

No.4 Cut, the mouth of which brs. N.81°-10'W. 162 feet from Cor, No.1, 4 x 24 x 12 foot face.(caved)

ADJOINING CLAIMS

On the west by Lucky Boy Lode Sur.No. 1350, and Lucky Boy Lode Sur. No.1416, Hull Copper Company,claimant, on the north by Fisher's Corner Lode Sur. No. 1284, Hull Copper Company, claimant, on the east by Silver Giant Lode Sur. No. 1284, Hull Copper Company, claimant, and on the south by the No.13 Lode Sur. No. 1284, Hull Copper Company, claimant.

INSTRUMENT

This survey was made with a Lietz Light Mountain Transit-theodolite, no.13-5929. The courses were deflected from the true meridian as determined by observations by the use of the Saegmuller Solar Attachment, and check^{ed}/by direct solar observations. The distances were measured with a 500 foot steel tape.

REPORT

The section corner tied to in this survey is an iron post properly set and chiseled as described in the field notes of said section.

Survey No.1284.

Silver Giant Lode.

Cor.No.3 is a stone properly set and marked with number of corner and survey. Cor.No.4 was out of place, and was reset on line 1-4 NO.13 Lode at the distance from bearing rock as reported in the returns for said lode.

Fisher's Corner Lode.

Cor.No.4 is a stone properly set and marked with

number of corner and survey. Cor.No.5 had been broken off, so I set a stone as previously described, at the point for ^{old corner/} corner. Part of the stone still remained in the ground.

NO.13 Lode.

but the point for corner was determined from the bearing rock as reported in the returns for said survey.

Cor. No.4 is missing, Cor. No.1 is a stone properly set and marked with the number of corner and survey.

Lucky Boy Lode Sur.No.1350

Cor.No.4 is a stone properly set and marked with the number of corner and survey. Cor. No.1 is missing, but was able to determine the point for corner from the bearing rock as reported in the returns for said survey.

Sur. No. 1416

Lucky Boy Lode.

Cor. No.4 is a stone properly set and marked with the number of the corner and survey. Cor. No.1 is missing, but was able to determine the point for corner from the bearing rock as reported in the returns for said survey.

The discrepancies found existing between the claim as marked by the location monuments and as described in the location notices are due to errors in the location notices.

The discrepancies between the lines of this survey and prior approved surveys are due to errors in the latter

William W. W. W.
 - - - U.S. MINERAL SURVEYOR. - - -

FINAL OATHS FOR SURVEYS.

LIST OF NAMES.

A list of the names of the individuals employed by J. WILLIAM WAARA

United States ~~Deputy~~ Mineral Surveyor, to assist in running, measuring, and marking the lines, corners, and boundaries described in the foregoing field notes of the survey of the mining claim of

. HEYWARD M. GIBBES

known as the GRANNY

and showing the respective capacities in which they acted.

JAMES M. SULLIVAN, Chainman.

....., Chainman.

....., Axman.

....., Flagman.

FINAL OATHS OF ASSISTANTS.

~~XXVEX~~ I. JAMES M. SULLIVAN

and, do solemnly swear that we assisted J. WILLIAM

WAARA

, United States ~~Deputy~~ Mineral Surveyor, in marking the corners and surveying

HEYWARD M. GIBBES

the boundaries of the mining claim of

known as the GRANNY

represented in the foregoing field notes as having been surveyed by said ~~deputy~~ mineral surveyor and under his direction; and that said survey has been in all respects, to the best of our knowledge and belief, faithfully and correctly executed, and the corner and boundary monuments established according to law and the instructions

ARIZONA

furnished by the United States Surveyor-General for

James M. Sullivan, Chainman.

....., Chainman.

....., Axman.

....., Flagman.

Subscribed and sworn to by the above-named persons before me this 24th

day of September 1915, 1915.

[Handwritten Signature]
Notary Public

My Commission Expires May 7, 1918.

(4-686.)

FINAL OATH OF U. S. ~~DEPUTY~~ MINERAL SURVEYOR

I, **J. WILLIAM WAARA**, U. S. ~~Deputy~~ Mineral Surveyor, do solemnly swear that, in pursuance of instructions received from the United States Surveyor General for **ARIZONA**, dated **SEPTEMBER 9, 1915**, I have, in strict conformity to the laws of the United States, the official regulations and instructions thereunder, and the instructions of said Surveyor General, faithfully and correctly executed the survey of the Mining Claim of **HEYWARD M. GIBBES**, known as the **GRANNY**, situate in **VERDE** Mining District, **YAVAPAI** County, **ARIZONA**, in Section **22(unsur)** Township No. **16 N.**, Range No. **3 E.** and designated as Survey No. **3239**, as represented in the foregoing field notes, which accurately show the boundaries of said mining claim as distinctly marked by monuments on the ground, and described in the attached copy of the location certificate, which was received by me from the Surveyor General with said instructions, and that all the corners of said survey have been established and perpetuated in strict accordance with the law, official regulations and instructions thereunder; and I do further solemnly swear that the foregoing are the true and original field notes of said survey and my report therein, and that the labor expended and improvements made upon said mining claim by claimant or **his** grantors are as therein fully stated, and that the character, extent, location and itemized value thereof are specified therein with particularity and full detail, and that no portion of said labor or improvements so credited to this claim has been included in the estimate of expenditures upon any other claim.

J. William Waara
 U. S. ~~Deputy~~ Mineral Surveyor.

Subscribed and sworn to by the said **J. WILLIAM WAARA**

U. S. ~~Deputy~~ Mineral Surveyor, before me

this *5th* day of *October*, 1915.

Laisy D. Jones
 Notary Public.

o 3-154

My commission expires
August 25d. 1917.

9

5173-1015

AMENDED
Notice of Mining Location
LODE CLAIM

TO ALL WHOM IT MAY CONCERN:

This Mining Claim, the name of which is the Granny,
Mining Claim, situate on lands belonging to the United States of America, and in which there are valuable mineral deposits, was entered upon and located for the purposes of exploration and purchase by H.M.Gibbes and F.S.Stephen, both citizens of the United States,

Locator must insert either "a citizen of the United States," or "who has declared his intention to become a citizen of the United States."
the undersigned, on the 6, day of Aug., 1915.

The length of this claim is 711 feet,
and 83 claim 83 feet,
in a southerly direction and 628
feet in a northerly direction from
the center of the discovery shaft, at which this notice is posted, lengthwise of the claim, together with
300 feet in width of the surface grounds, on each
side of the center of said claim. The general course of the lode deposit and premises is from the
North to the South

The claim is situated and located in the Verde Mining District, in
Yavapai County, in the State of Arizona, about 1000
in a westerly direction from the United Verde mine
and Smelter.

The surface boundaries of the claim are marked upon the ground as follows: - Beginning at
a monument of stone,

at a point in a southerly direction 83 feet from
the discovery shaft (at which this notice is posted,) being in the center of the
end line of said claim; thence S.86°-02' W. 283.3 feet to a mon., of
stone, being the S.W. corner of said claim;
thence N.3°- 05' W. 710.2 feet to a mon., of stone, being at the
N.W. corner of said claim; thence N.86°-02' E. 298.4 feet
to a mon., of stone, at the center of the northerly end of said claim;
thence N.86°-02' E. 37.0 feet to a mon., of stone, being at the
N.E. corner of said claim; thence S.8°-51' E. 712.7
feet to a mon., of stone, at the S.E. corner of said claim;
thence S.86°-02' W. 123.3 feet to the place of the beginning.

All done under the provisions of Chapter Six, of Title XXXII, of the Revised Statutes of the United States, and of an Act of the General Assembly of Arizona, entitled "An Act to Revise and Codify the Laws of the Territory of Arizona," approved March 16, 1901.

This is an Amended Location Notice of the Granny,
Mining Claim, located by Thomas Fryer,
on the 6, day of
January, 1912., and recorded in Book 92, of Records of Mines, at
page 22, in the office of the County Recorder of the aforesaid County of Yavapai,
to which reference is hereby made, and this Amended Location Notice is made and posted to correct errors in the description in the said Original Location Notice.

Dated and posted on the ground this 6, day of Aug., 1915.

H.M.Gibbes.

F.S.Stephen.

10

County of

ss.

I,, County Recorder in and for the County and State aforesaid, do hereby certify that the within instrument was filed for record ato'clock.....M., on this day of, 191....., and duly recorded in Book No..... ofRecords of County, Arizona, at pages.....

Witness my hand and official seal the day and year first above written.

County Recorder.

AMENDED Notice of Location

LODE CLAIM

Granny.

Dated..... **Aug., 6** 191**5**.

Filed and Recorded at request of

Jno. J. Hawkins,

Aug., 7th....., A. D. 191**5**.

at **3:05- 0'clock**..... **P. M.**

Book **86 of Mines**.....

Page **481; Records of Yavapai**

County, Arizona.

(**SEAL.**) **L.S. Colwell,**

County Recorder.

By **James W. Coyne,**

Deputy Recorder.

Printed and for sale by the Prescott Courier

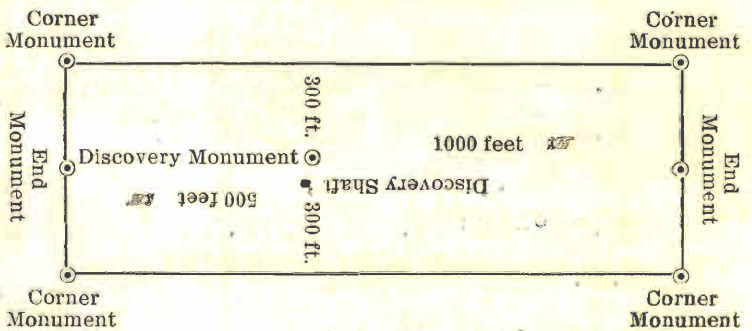

This diagram is to give locator a general idea of plan of location under the new law. The Discovery Shaft can be in the center of claim or any distance from either end, desired. In the diagram it is placed 500 feet from one end and 1000 feet from the other. Commence description of claim at a center end monument, giving its distance and direction from center of Discovery Shaft; thence bound the claim in either direction. In description be careful to state locality of claim with reference to some natural object, or permanent monument, as will identify the claim.

4-688.

U. S. SURVEYOR-GENERAL'S FINAL CERTIFICATE ON FIELD NOTES.

Department of the Interior,

OFFICE OF U. S. SURVEYOR-GENERAL,

Phoenix, Arizona,

January 22, 1916

I, U. S. Surveyor-General for District of Arizona

do hereby certify that the foregoing transcript of the Field Notes, return and approval of the survey of the mining claim of

HEYWARD M GIBBES

known as the GRANNY

situate in VERDE

Mining District, YAVAPAI County, ARIZONA,

in Section 22 unsur., Township No. 16 N., Range No. 2 E., and

designated as Survey No. 3239, has been correctly copied from the originals on file in

this office; that said Field Notes furnish such an accurate description of said mining claim as will, if incorporated into a patent, serve fully to identify the premises, and that such reference is made therein to natural objects or permanent monuments as will perpetuate and fix the locus thereof.

And I further certify that five hundred dollars' worth of labor has been expended or improvements made upon said mining claim by claimant or his grantors, and that said improvements consist of 2 cuts and 1 tunnel, total value \$700.00

and that no portion of said labor or improvements has been included in the estimate of expenditures upon any other claim.

I further certify that the plat thereof, filed in the U. S. Land Office at Phoenix,

Arizona is correct and in conformity with the foregoing Field Notes.

Frank S. Ingalls,

United States Surveyor-General for Arizona.

4-687.

SURVEYOR-GENERAL'S CERTIFICATE OF APPROVAL OF FIELD NOTES AND SURVEY OF MINING CLAIM.

Department of the Interior,

Office of U. S. Surveyor-General,

Phoenix, Arizona,

January 22, 1916

I, U. S. Surveyor-General for District of Arizona

do hereby certify that the foregoing and hereto attached Field Notes and Return of the Survey of the Mining Claim of

HEYWARD M. GIBBES

known as the

GRANNY

situate in VERDE Mining District, YAVAPAI County, ARIZONA.

in Section 22 unsur., Township No. 16 N., Range No. 2 E., designated as Survey No. 3239

executed by J. William Waara, U. S. Deputy Mineral

Surveyor, September 19-20, 1915, under my instructions dated

September 9, 1915, have been critically examined and the necessary cor-

rections and explanations made, and the said Field Notes and Return, and the Survey they describe,

are hereby approved. A true copy of the copy of the location certificate filed by the applicant for

survey is included in the field notes.

Handwritten signature of Frank S. Ingalls

U. S. Surveyor-General for Arizona.