

12.14.1917

MINERAL SURVEY No. 3320

LOT No.

Arizona Land District.

FIELD NOTES

OF THE SURVEY OF THE MINING CLAIM OF

O. D. M. Gaddis, F. M. Townsend

and M. J. Trumble

KNOWN AS THE

Flores West, Flores North, Flores North No. 2 Lodes

Wallapai Mining District,

Mohave County, Arizona

Sections 7 & 12, Township 22 N, Ranges 17 & 18 W. ^{unapproved}

Surveyed under instructions dated June 26, 1916

by Charles M. Becker

U. S. Mineral Surveyor.

Claim located See location notices, 19

Survey commenced July 10, 1916

Survey completed July 14, 1916

Address of claimant O. D. M. Gaddis

Kingman

DATES OF AMENDED LOCATIONS. Arizona

Surrey No. 3320.

Flores West Lode.

Beginning at Cor. No. 1

A pine post, 4 ft Long, 4 ins square set 18 ins in the ground with mound of earth and stone scribed 1-3320, whence.

The W. 1/4 Cor. Section 7, T. 22 N. R. 17 W. of the Gila and Salt River Meridian bears S. 66° 38' 58" W. 724.7 ft.

The Section Corner Common to Sections 6-7-1-12, T. 22 N. Rs 17 and 18 W. of the Gila and Salt River Meridian bears N. 20° 26' 09" W. 2588.26 ft.

The N.W. Cor. of the Location bears N. 30° 03' 18" W. 5 ft. No other bearings available.

Feet. Thence S. 30° 03' 18" E.

1462.08 To Cor. No. 2.

A pine post, 4 ft Long, 4 ins square set 18 ins in the ground with mound of earth and stone scribed 2-3320 whence

A cross (x) and B.R. 2-3320 chiseled on large granite boulder, projecting 2 ft above the ground bears N. 0° 19' W. 14.5 ft.

The S.W. Cor. of the Location bears S. 24° 38' E. 59.14 ft.

Thence N. 71° 44' E.

350.49 To Cor. No. 6, Sur No. 2460 Broken Hills Lode, claimant unknown.

310.44 To South End Center, identical with South End Center of the Location, the exact point falls on the South edge of a large granite boulder in place, and is marked by a cross (x) and the letters S.E.C. 3320 F.W. Chiseled there on.

330.19 To Cor No. 3.

On line 4-5 Sur. No. 630 Flores Lode, O.D. M. Gaddis Et al. claimants, also on line 6-1 Sur. No. 2460 Broken Hills Lode

A pine post 4 ft Long, 4 ins square set 18 ins. in the ground with mound of earth and

stone scribed 3-3320, whence.

Cor. No. 5 Sur. No. 630 Flores Lode bears S. $24^{\circ}55'E$.
193.⁵² ft.

The S.E. Cor. of the Location bears N. $71^{\circ}44'E$. 260 ft.

Thence N. $24^{\circ}55'W$.

1296.⁶⁷ Cor. No. 4, Sur. No. 630, Flores Lode, also intersect
Line 4-1, Flores North Lode of this Survey, at N. 64°
53' E. 154.²³ ft. from Cor. No. 1.

1440.⁹⁰ To Cor. No. 4.

A pine post 4 ft long 4 ins square, set 18 ins in
the ground with mound of earth and stone
scribed 4-3320 whence.

Cor. No. 1, Sur. No. 2832 Gold Nugget Lode, claimant
unknown, bears S. $59^{\circ}42'E$. 175.¹⁹ ft.

The N.E. Cor. of the Location bears N. $71^{\circ}44'E$. 60 ft.

Thence S. $71^{\circ}44'W$.

162.²³ Intersect Line 1-2, Flores North Lode of this Survey at
N. $27^{\circ}20'W$. 163.⁶⁵ ft. from Cor. No. 1.

233.⁷⁰ To North End Center, identical with the North End
Center of Location, a granite stone, 4x8x24 ins. set 1 ft
in the ground with mound of rock chiseled N.E.C. 3320 F.W.
and a cross (x) marking exact point.

461.⁹⁸ To Cor. No. 1, the place of beginning.

Flores North Lode.

Beginning at Cor. No. 1

Identical with the S.W. Cor. of the Location.

A pine post 4 ft long, 4 ins square set 18 ins. in the ground
with mound of earth and stone scribed 1-3320 whence

The W. $\frac{1}{4}$ Cor. Sec. 7, T. 22 N. R. 17 W. of the Gila
and Salt River Meridian bears S. $77^{\circ}02'52''W$. 1051.⁹³ ft.

The Section Corner Common to Sections 6-7-1-12.

T. 22 N. R. 17 and 18 W. of the Gila and Salt River Meridian

bears N. 27° 01' 53" W. 2780.58 ft.

Cor. No. 4, Flores West Lode of this Survey bears N. 21° 54' E. 211.52 ft.

A cross (X) and the letters B.R. 1-3320 chiseled on a flat granite boulder, projecting 2 1/2 ft above the ground bears N. 60° 36' E. 9.18 ft.

Thence N. 27° 20' W.

163.65 Intersect Line 4-1, Flores West Lode of this Survey at S. 71° 44' W. 162.23 ft. from Cor. No. 4.

1268.37 To Cor. No. 2.

Identical with the N.W. Cor. of the Location, and with Cor. No. 3 Flores North No. 2 Lode of this Survey.

A pine post, 4 ft long, 4 ins square, set 18 ins in the ground with mound of earth and stone, scribed 2-3-3320 whence.

A cross (X) and the letters B.R. 2-3-3320 chiseled on the face of a granite outcrop, projecting 4 ft. above the ground bears N. 32° 32' E. 28.96 ft.

Thence N. 64° 53' E.

300.23 To North End Center, identical with the North End Center of Location, a granite stone, 4x8x24 ins, set 12 ins in the ground, with mound of rock, chiseled on South face N.E.C. 3320 F.N., and on the North face S.E.C. 3320 F.N. 2, with a cross (X) chiseled on top marking exact point.

600.46 To Cor. No. 3

Identical with the N.E. Cor. of the Location, and with Cor. No. 2, Flores North No. 2 Lode of this Survey.

A pine post 4 ft. long 4 ins square, set 18 ins in the ground with mound of earth and stone, scribed 3-2-3320 whence.

A cross (X), and B.R. 3-2-3020, chiseled on a large granite boulder, projecting 3 ft above the ground bears S. $31^{\circ} 33' E$. 11.0 ft.

Cor. No. 2 Sur. No. 2832 Gold Nugget Lode bears N. $2^{\circ} 54' W$. 200.3 ft.

Thence S. $27^{\circ} 20' E$.

95.37 Intersect Line 1-2, Sur. No. 2832 Gold Nugget Lode, at N. $10^{\circ} 43' W$. 1210.15 ft. from Cor. No. 1.

1269.37 To Cor. No. 4.

Identical with the S.E. Cor. of the Location

On Line 3-4, Sur. No. 630 Flores Lode, and Line 4-1 Sur. No. 2832 Gold Nugget Lode.

A pine post 4 ft long, 4 ins square set 12 ins in the the ground with mound of earth and stone marked 4-3320 whence.

Cor. No. 3 Sur. No. 630 Flores Lode bears N. $64^{\circ} 53' E$. 140.27 ft.

Cor. No. 4 Sur. No. 2832 Gold Nugget Lode bears N. $64^{\circ} 53' E$. 253.68 ft.

A cross (X) and the letters B.R. 4-3320 chiseled on large flat slab of granite rock projecting 2 ft. above the ground bears N. $58^{\circ} 16' E$. 49.86 ft.

Thence S. $64^{\circ} 53' W$.

300.23 To South End Center, identical with the South End Center of the Location, a granite rock, 6x6x24 ins, set 12 ins. in the ground with mound of earth and stone, chiseled S.E.C. 3320 F.N., with a cross (X) chiseled on top marking exact point.

346.32 Cor. No. 1, Sur. No. 2832 Gold Nugget Lode

446.23 Cor. No. 4, Sur. No. 630 Flores Lode, also intersect

Line 3-4 Flores West Lode of this survey, S. $24^{\circ} 55' E$ 193.52 ft. from Cor. No. 4.

600.46 To Cor. No. 1, the place of beginning

Flores North No. 2 Lode

Beginning at Cor. No. 1.

Identical with the N.E. Cor of the Location
 A pine post, 4 ft long, 4 ins square set 18 ins in the
 ground with mound of earth and stone scribed 1-3320 whence
 The Section Corner Common to Sections 6-7-1-12, T. 22 N.
 R's 17 and 18 W. of the Gila and Salt River Meridian
 bears N. 61° 29' 11" W. 473.⁷⁹ ft.

A cross (x) and B.R. 1-3320 chiseled on large
 granite boulder, projecting 3 ft above the ground bears
 N. 6° 19' E. 8.⁹¹ ft.

Thence S. 42° 56' E.

1187 To Cor. No. 2

Identical with the S.E. Cor. of the Location, and Cor.
 No. 3 Flores North Lode of this survey heretofore described

Thence S. 64° 53' W.

300.23 To South End Center, identical with South End Center
 of Location, and North End Center Flores North Lode of
 this survey heretofore described

600.46 To Cor. No. 3

Identical with the S.W. Cor. of Location and Cor. No.
 2, Flores North Lode of this survey heretofore described

Thence N. 42° 56' W.

911.94 Intersect West Boundary Section 7, at S. 5° 01' 31" E, 685.⁰⁶ ft
 from N.W. Cor. of said Section, and N. 5° 01' 31" W. 2038.⁰² ft
 from the W. 1/4 Cor.

1187 To Cor. No. 4

Identical with the N.W. Cor. of the Location.
 A pine post, 4 ft long, 4 ins square, set 18 ins in
 the ground with mound of earth and stone
 scribed 4-3320 whence

A cross (x) and B.R. 4-3320, chiseled on face of
 granite reef, projecting 3 ft above the ground bears
 S. 65° 09' W. 5.⁶⁹ ft.

Thence N. 64° 53' E.

179.96 Intersect West Boundary Section 7, at S. 5° 01' 31" E 406.²² ft
 from N.W. Cor. of said section, and N. 5° 01' 31" W. 2316.⁰⁶ ft

from the W. 1/4 Cor.

300.23 To North End Center, identical with North End Center of the Location, a granite rock 6 x 8 x 26 ins, set 12 ins in the ground with mould of rock, chiseled N.E.C. F. N. 2 3320, with a cross (X) marking exact point.

600.46 To Cor. No. 1, the place of beginning
Variation at all Corners 14° 45' E.

Lode Lines.

As near as may be determined from present developments, the veins of the several locations embraced in this survey extend as follows from their respective discovery points.

Flores West Lode, 711.5 ft. N. 33° 10' W, and 769.5 ft. S. 33° 10' E.

Flores North Lode, 552 ft. S. 27° 20' E, and 716.5 ft. N. 27° 20' W.

Flores North No. 2 Lode, 107 ft. S. 43° 56' E, and 1080 ft. N. 42° 56' W.

Areas

Total Area Flores West Lode 13.014 acres

Total Area Flores North Lode 17.470 acres.

Area in conflict with

Sur No. 2832 Gold Nugget Lode 4.659 acres

Flores West Lode of this survey 0.556 "

Total Area Flores North No. 2 Lode 15.578 acres.

Location.

This survey is located in the W 1/2 Sec 7, T 22 N. R. 17 W, and the E 1/2 Sec. 12, ^{of unapproved} T. 22 N. R. 18 W. of the Colo and Salt River Meridian

Expenditure of Five Hundred Dollars

I certify that the value of the labor and improvements made upon or for the benefit of each of the Locations embraced is said mining claims by the claimants or their grantors is not less than five hundred dollars and that said improvements consist of.

No. 1. Flores West.

No. 1 The discovery tunnel, the mouth of which bears from Cor. No. 1 S. 47° 50' E. 803.⁸ ft., 4x6 ft, running N. 34° E. 30 ft. to face. Value \$ 250.⁰⁰

No. 2. A shaft which bears from Cor. No. 1, N. 82° 00' E. 324.¹ ft. 4x6 ft. 10 ft deep. Value. \$ 50.⁰⁰

No. 3 A shaft which bears from Cor. No. 1, S. 50° 19' E. 758.⁵ ft. 4x6 ft. 10 ft deep. Value. \$ 50.⁰⁰

No. 4. A Tunnel, the mouth of which bears from Cor. No. 1. S. 45° 15' E. 1137 ft., 4x6 ft., running S. 32° 57' E. 150 ft to face. Value \$ 1500.⁰⁰

No. 5. A shaft which bears from Cor. No. 1, S. 43° 43' E. 1357.⁸ ft. 4x8 ft 30 ft deep. Value. \$ 300.⁰⁰

Flores North

No. 1 The discovery shaft, on the center line, 552 ft from the center of line 4-1, 4x6 ft. 8 ft deep. Value \$ 35.⁰⁰

No. 2 An Open Cut, the mouth of which bears from the center of line 4-1, N. 32° 13' W. 166.⁷ ft. 4x6 ft., running N. 61° 50' E. 33.⁵ ft. to face, at the end of which is a shaft 4x6 ft. 30 ft. deep. Value cut and shaft \$ 500.⁰⁰

No. 3 A shaft, which bears from the center of line 4-1, N. 21° 33' W. 366.⁴ ft. 4x6 ft. 30 ft. deep. Value. \$ 250.⁰⁰

No. 4. A Tunnel the mouth of which bears from the center of line 4-1, N. 22° 57' W. 516.⁰⁰ ft. 4x6 ft, running N. 21° 40' W 75 ft, thence N. 40° 36' W. 21.² ft, thence N. 19° 59' E 9.⁰, thence N. 26° 57' W. 32.⁵ ft. to face. Value. \$ 1500.⁰⁰

No. 5. A shaft which bears from the center of line 4-1,
N. $23^{\circ} 22' W$. 618.⁵ ft. 6x6 ft. 8 ft. deep. Value \$40.⁰⁰

Flores North. No. 2.

No. 1 The Discovery shaft, on the center line, 107 ft from
the center of line 2-3, 4x6 ft. 8 ft. deep. Value \$30.⁰⁰

No. 2. A shaft, which bears from the center of line
2-3, N. $34^{\circ} 43' W$. 47.⁵⁰ ft. 4x6 ft. 6 ft. deep. Value \$20.⁰⁰

No. 3. A shaft, which bears from the center of line 2-3,
N. $34^{\circ} 43' W$. 79.⁰ ft. 4x6 ft. 8 ft. deep. Value. \$25.⁰⁰

No. 4 A tunnel, the mouth of which bears from the
center of line 2-3, N. $38^{\circ} 37' W$. 335.⁸ ft., 4x6 ft.,
running S. $65^{\circ} 55' E$. 33.⁶ ft., thence S. $31^{\circ} 00' E$. 29.⁰ ft. to face.
Value. \$500.⁰⁰

No. 5 A shaft, which bears from the center of line 2-3,
N. $45^{\circ} 39' W$. 609.³ ft., 4x6 ft. 8 ft. deep. Value. \$25.⁰⁰

No. 6. A shaft which bears from the center of line 2-3,
N. $46^{\circ} 14' W$. 735.⁸ ft. 4x6 ft. 8 ft. deep. Value. \$25.⁰⁰

Other Improvements.

An open cut, the mouth of which bears from the
center of line 4-1, Flores North Lode N. $25^{\circ} 31' W$. 73.⁸⁶
ft., 4x6 ft., running N. $1^{\circ} 00' E$. 31.⁵ ft. to face, claimant
unknown.

Instrument.

This survey was made with a Gurley Light Mountain
Transit. The courses were deflected from the true
meridian as determined by direct solar observations.

The distances were measured with 100 ft. and 300 ft.
steel tapes.

Report.

The lode line of each location of this claim
was run directly upon the ground, and the several
corners established by means of offsets from the
Lode Lines. All tie lines were run either directly

upon the ground, or by traverses run upon the ground and submitted in a separate report herewith.

The Section Corner Common to Sections 6-7-1-12, T. 22 N., Rs 17 and 18 W. of the Gila and Salt River Meridian, is a tubular iron post surmounted with brass cap upon which is stamped

T. 22 N.
R. 15 W. R. 17 W.
Sec. 1 Sec. 6
Sec. 12 C S. 7.



This is evidently the C.C. as the std. cor. is not an iron pipe

The W¹/₄ Cor. Sec. 7, T. 22 N. R. 17. W. of the Gila and Salt River Meridian is a tubular iron post surmounted with brass cap upon which is stamped
12 | ¹/₄ 7.

I find the course of the section line between the W¹/₄ cor Sec. 7. and the N.W. Cor. Sec. 7. to be N. 5° 01' 31" W. 2723.⁰⁸ ft.

SUR. No. 630 Flores Lode; Corners 3-4 and 5 are pine posts, 4 ft long, 4 ins square, all badly weathered, they no longer show either the Survey No. or the Cor. No.

I find Line 4-5, SUR No. 630 Flores Lode to be, S. 24° 55' E. 1490.¹⁹ ft, and I find Line 3-4, SUR No. 630 Flores Lode to be S. 64° 53' W. 586.⁵ ft.

SUR. No 2832 Gold Nugget Lode. Corners 1 and 4, are stones properly set and marked. Cor. 2 is a cross (X) and 2-2832 G.N. chiseled on cliff of rock.

I find the Courses and distances of Line 1-2, and line 4-1, SUR. No 2832 Gold Nugget Lode Correct as approved.

I find the Course of Line 6-1, SUR. No. 2460 Broken Hills Lode to be N. 71° 44' E.

SEP. 19. 1916

OCT. 9. 1916

FEB. 14. 1917

FINAL OATHS FOR SURVEYS.

LIST OF NAMES.

A list of the names of the individuals employed by Chas. M. Becker

United States ~~Deputy~~ Mineral Surveyor, to assist in running, measuring, and marking the lines, corners, and

boundaries described in the foregoing field notes of the survey of the mining claim of ODM Gaddis

F. M. Townsend and M. J. Trumble

known as the Flores West, Flores North, Flores North No. 2. lodes

and showing the respective capacities in which they acted.

Louis Diton, Chainman.

....., Chainman.

....., Axman.

....., Flagman.

FINAL OATHS OF ASSISTANTS.

Louis Diton

and, do solemnly swear that ^d we assisted Chas M Becker

....., United States ~~Deputy~~ Mineral Surveyor, in marking the corners and surveying

the boundaries of the mining claim of ODM Gaddis, F. M. Townsend

and M. J. Trumble

known as the Flores West, Flores North, Flores North No. 2. lodes

represented in the foregoing field notes as having been surveyed by said ~~deputy~~ mineral surveyor and under his

direction; and that said survey has been in all respects, to the best of ^{my} ~~our~~ knowledge and belief, faithfully and

correctly executed, and the corner and boundary monuments established according to law and the instructions

furnished by the United States Surveyor-General for Arizona

Louis Diton, Chainman.

....., Chainman.

....., Axman.

....., Flagman.

Subscribed and sworn to by the above-named persons before me this 14th

day of July 1916

L M Seale
Clk Superior Court.
MoHAVE County, Arizona

(4-686.)

FINAL OATH OF U. S. ~~DEPUTY~~ MINERAL SURVEYOR

I, Charles M. Becker, U. S. ~~Deputy~~ Mineral Surveyor, do solemnly swear that, in pursuance of instructions received from the United States Surveyor General for Arizona, dated June 26 1916, I have, in strict conformity to the laws of the United States, the official regulations and instructions thereunder, and the instructions of said Surveyor General, faithfully and correctly executed the survey of the Mining Claim of Edm Gaddis F M Towneud and M J Trumble, known as the Flores west, Flores North, Flores North No 2 lodes situate in Wallapai Mining District, Mohave County, Arizona, in Sections 7812, Township No. 22 N, Range No. 178 unapproved 18 W, and designated as Survey No. 3320, as represented in the foregoing field notes, which accurately show the boundaries of said mining claim as distinctly marked by monuments on the ground, and described in the attached copy of the location certificate, which was received by me from the Surveyor General with said instructions, and that all the corners of said survey have been established and perpetuated in strict accordance with the law, official regulations and instructions thereunder; and I do further solemnly swear that the foregoing are the true and original field notes of said survey and my report therein, and that the labor expended and improvements made upon said mining claim by claimants or their grantors are as therein fully stated, and that the character, extent, location and itemized value thereof are specified therein with particularity and full detail, and that no portion of said labor or improvements so credited to this claim has been included in the estimate of expenditures upon any other claim.

Charles M. Becker
U. S. ~~Deputy~~ Mineral Surveyor.

Subscribed and sworn to by the said Charles M. Becker,
U. S. ~~Deputy~~ Mineral Surveyor, before me _____
this 5th
day of October, 1916,

L M Seale
Clerk Superior Court.
Mohave County, Arizona

Notice of Mining Location

LODE CLAIM

To All Whom It May Concern:

This Mining Claim, the name of which is the Flores West

Mining Claim, situate on lands belonging to the United States of America, and in which there are valuable mineral deposits, was entered upon and located for the purpose of exploration and purchase by

(Locator must insert either "a citizen of the United States," or "who has declared his intention to become a citizen of the United States")

the undersigned, on the Tenth day of January 1912

The length of this claim is Fifteen Hundred feet and I claim Seven Hundred feet in a South Easterly direction and Eight Hundred feet in a North Westerly direction from the center of the discovery shaft, at which this notice is posted, lengthwise of the claim, together with Three Hundred feet in width of the surface grounds, on each side of the center of said claim. The general course of the lode deposit and premises is from the South East to the North West

The claim is situated and located in the Yavapai Mining District, in Mohave County, in the Territory of Arizona, about in a _____ direction from _____

Adjoins Flores Mining Claim on West side

The surface boundaries of the claim are marked upon the ground as follows: Beginning at this monument

at a point in a South East direction Seven Hundred feet from the discovery shaft (at which this notice is posted), being in the center of the end line of said claim; thence Eight Hundred feet to a Monument North West, being the Center corner of said claim; thence three Hundred feet to a Monument, being at the North West corner of said claim; thence Fifteen Hundred feet to a feet South West at the center of the corner end of said claim; thence Eight Hundred feet to a South East, being at the corner of said claim; thence Fifteen Hundred feet to a Monument at the North East corner of said claim; thence 300 feet to center monument feet to the place of beginning.

All done under the provisions of Chapter 6, of Title XXXII, of the Revised Statutes of the United States, and of an Act of the General Assembly of Arizona, entitled "An Act to Revise and Codify the Laws of the Territory of Arizona," approved March 16, 1901.

Dated and posted on the ground this Tenth day of January 1912.
W. B. Campbell

Sec 7 T. 22 N. R. 17 W

Notice of Location

LODE CLAIM

Hog Wash

Dated *Jan 10* 191*2*

Filed and Recorded at request of

H. B. Campbell
March 5th A. D. 191*2*

at *One O'clock* P.M.

Book *H. N. S. Mines*

Pages *73*

By *J. H. Morgan*
County Recorder

Deputy Recorder

The McNeil Co., Phoenix, Arizona

Fees 1.00

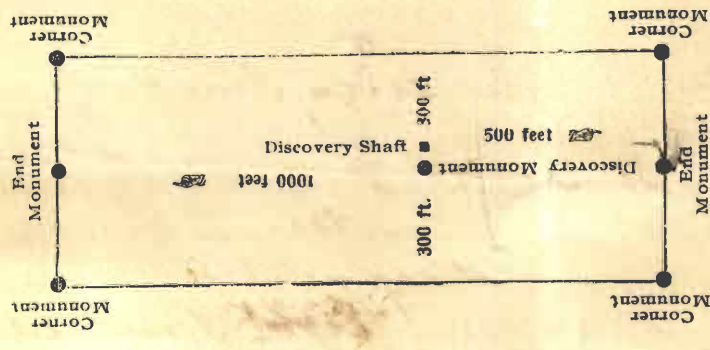

This diagram is to give locator a general idea of plan of location under the new law. The Discovery Shaft can be in the center of claim or any distance from either end desired. In the diagram it is placed 500 feet from one end and 1000 feet from the other. Commence description of claim at a center end monument, giving its distance and direction from center of Discovery Shaft; thence bound the claim in either direction. In description be careful to state locality of claim with reference to some natural object, or permanent monument, as will identify the claim.

12.15 min
3350
MAY 31 1916

Notice of Mining Location

LODE CLAIM

To All Whom It May Concern:

This Mining Claim, the name of which is the Flores North

Mining Claim, situate on lands belonging to the United States of America, and in which there are valuable mineral deposits, was entered upon and located for the purpose of exploration and purchase by

(Locator must insert either "a citizen of the United States," or "who has declared his intention to become a citizen of the United States")

the undersigned, on the Tenth day of January 1912

The length of this claim is Fifteen Hundred feet and 5 claim Five Hundred feet in a South Easterly direction and One Thousand feet in a North Westerly direction from the center of the discovery shaft, at which this notice is posted, lengthwise of the claim, together with _____ feet in width of the surface grounds, on each side of the center of said claim. The general course of the lode deposit and premises is from the _____ to the _____

The claim is situated and located in the Wallapai Mining District, in Mohave County, in the Territory of Arizona, about

in a _____ direction from Adjoining Flores Mining Claim on North End

The surface boundaries of the claim are marked upon the ground as follows: Beginning at this Monument

at a point in a North West direction One thousand feet from the discovery shaft (at which this notice is posted), being in the center of the end line of said claim; thence three hundred feet to a Monument, being the North West corner of said claim; thence the Fifteen Hundred feet to a Monument, being at the South West corner of said claim; thence three hundred feet to a Monument at the center of the South West end of said claim; thence three hundred feet to a Monument, being at the South East corner of said claim; thence Fifteen Hundred feet to a Monument at the North East corner of said claim; thence three hundred feet to the place of beginning.

All done under the provisions of Chapter 6, of Title XXXII, of the Revised Statutes of the United States, and of an Act of the General Assembly of Arizona, entitled "An Act to Revise and Codify the Laws of the Territory of Arizona," approved March 16, 1901.

Dated and posted on the ground this Tenth day of January 1912.

W Campbell

Notice of Location

LODE CLAIM

Stotes Creek

Dated *Jan 10* 191*2*

Filed and Recorded at request of

H. B. Campbell

March 5th A. D. 191*2*

at *One O'clock* P.M.

Book *N.H. of Mass*

Pages *176*

By *J. M. Morgan*

County Recorder

Deputy Recorder

The McNeil Co., Phoenix, Arizona

Fees 1.00 Paid

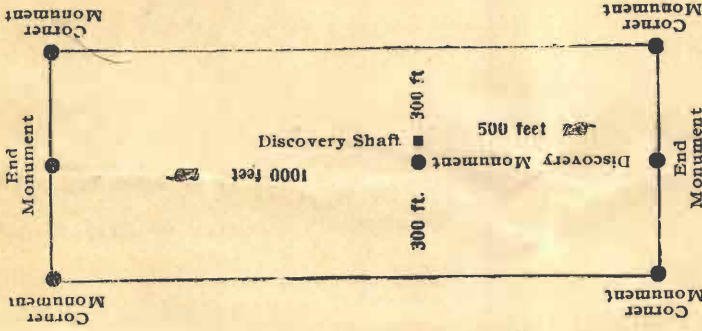

This diagram is to give locator a general idea of plan of location under the new law. The Discovery Shaft can be in the center of claim or any distance from either end desired. In the diagram it is placed 500 feet from one end and 1000 feet from the other. Commence description of claim at a center end monument, giving its distance and direction from center of Discovery Shaft; thence bound the claim in either direction. In description be careful to state locality of claim with reference to some natural object, or permanent monument, as will identify the claim.

Notice of Mining Location.

44151.1914
17

LODE CLAIM

TO ALL WHOM IT MAY CONCERN:

This Mining Claim, the name of which is the Flores Arch No 2
Mining Claim, situate on lands belonging to the United States of America, and in which there are valuable mineral deposits,
was entered upon and located for the purpose of exploration and purchase by.....

M. B. Campbell.

Citizen of U. S.

(Locator must insert either "a citizen of the United States," or "who has declared his intention to become a citizen of the United States.")

the undersigned, on the 28th day of February, 1913

The length of this claim is 1500 feet,
and 1500 feet,
in a North West direction and North West
feet in a North West direction from
the center of the discovery shaft, at which this notice is posted, lengthwise of the claim, together with

300 feet in width of the surface grounds, on each side of the center of said claim. The general course
of the lode deposit and premises is from the North West
to the South East

The claim is situated and located in the Maricopa Mining District, in
Mohave County, in the State of Arizona, about 1500 feet
in a North West direction from the "Flores" Mine, a
patented claim.

The surface boundaries of the claim are marked upon the ground as follows: Beginning at.....

Monument of stone

at a Monument of stone direction South East feet from
the discovery shaft (at which this notice is posted), being in the center of the South East
end line of said claim; thence 300 feet to a Monument
S. E. being the S. E. corner of said claim; thence
1500 feet to a Monument, being at the
S. E. corner of said claim; thence 300 feet
to a Monument at the center of the North West end of said claim;
thence 300 feet to a Monument, being at the
S. W. corner of said claim, thence 1500
feet to a Monument at the S. W. corner of said claim;
thence 300 feet to the place of beginning.

All done under the provisions of Chapter Six, of Title XXXII, of the Revised Statutes of the United States, and
of an Act of the General Assembly of Ariona entitled "An Act to Revise and Codify the Laws of the Territory of Arizona,"
approved March 16, 1901.

Dated and posted on the grounds this 28th day of February, 1913

M. B. Campbell
Locator.

STATE OF ARIZONA,

ss.

County of.....

I, County Recorder in and for the County and State aforesaid, do hereby certify that the within instrument was filed for record at o'clock M., on this day of 191....., and duly recorded in Book No.

..... of Records of County, Arizona, at pages.....

WITNESS my hand and official seal the day and year first above written.

..... County Recorder.....

Notice of Location

LODE CLAIM

Flora Street No 2

Dated Feb 18, 1913

Filed and Recorded at request of

H. B. Campbell

April 5th A. D. 1913

at "Oleick" A. M.,

Book H. H. of Mans

Pages 652

J. M. Morgan

County Recorder.

By Deputy Recorder.

Fee \$100 Paid

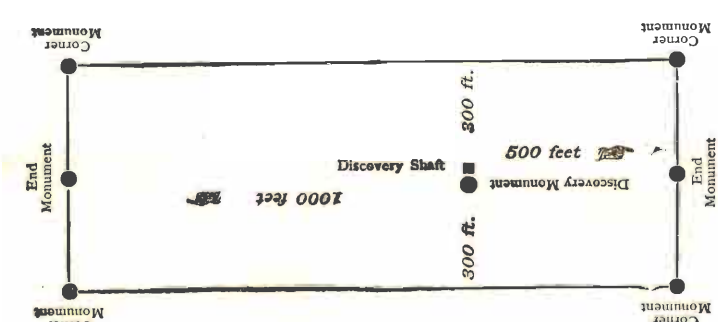

This diagram is to give locator a general idea of plan of location under the new law. The Discovery Shaft can be in the center of claim or any distance from either end desired. In the diagram it is placed 500 feet from one end and 1000 feet from the other. Commence description of claim at a center end monument, giving its distance and direction from center of Discovery Shaft; thence bound the claim in either direction. In description be careful to state locality of claim with reference to some natural object, or permanent monument, as will identify the claim.

- Excerpts from the Mining Laws of the State of Arizona.
- Title XLVII of the Revised Statutes of 1901, and Amendments Thereto.
- Sec. 2. Such location shall be made by erecting at or contiguous to the point of discovery a conspicuous monument of stones not less than three feet in height, or an upright post, securely fixed, projecting at least four feet above the ground, in which monument of stones or on which post there shall be posted a location notice which shall be signed by the name or names of the locator or locators.
- Sec. 4. From the time of the location of a mining claim, as above specified, the locator shall be allowed ninety days within which to do or cause to be done the following things:
- * * * * *
 - 2. To sink a discovery shaft in the claim to a depth of at least eight feet from the lowest part of the rim of the shaft at the surface, and deeper, if necessary, until there is disclosed in said shaft mineral in place.
 - Sec. 6. Such surface boundaries shall be marked by six substantial posts projecting at least four feet above the surface of the ground, or by substantial stone monuments at least three feet high, to-wit: One at each corner of said claim and one at the center of each end-line thereof.
 - Sec. 8. Location notices may be amended at any time and the monuments changed to correspond with the amended location; Provided, That no change shall be made that will interfere with the rights of others.

U. S. SURVEYOR GENERAL'S FINAL CERTIFICATE ON
FIELD NOTES.

DEPARTMENT OF THE INTERIOR,
OFFICE OF U. S. SURVEYOR GENERAL,

Phoenix, Arizona,

June 1, 1917.

I, U. S. Surveyor General for District of Arizona,
do hereby certify that the foregoing transcript of the Field Notes, return and approval
of the Survey of the mining claim of

O. D. M. GADDIS, F. M. TOWNSEND, AND M. J. TRUMBLE,

, known as the FLORES WEST, FLORES NORTH, FLORES NORTH
NO. 2 LODES, situate in WALLAPAI

Mining District, MOHAVE County,

ARIZONA, in Sections 7 & 12, Township No. 22 N.,

Range No. 17 & unapp'd 18 W., and designated as Survey

No. 3320, has been correctly copied from the originals on
file in this office; that said Field Notes furnish such an accurate description of said
mining claim as will, if incorporated into a patent, serve fully to identify the premises,
and that such reference is made therein to natural objects or permanent monuments as
will perpetuate and fix the locus thereof.

And I further certify that five hundred dollars' worth of labor has been expended
or improvements made upon ^{each of} said mining claim^s by claimants or their grantors, and
that said improvements consist of 4 tunnels, 12 shafts and 1 cut, total
value \$5100.

and that no portion of said labor or improvements has been included in the estimate of
expenditures upon any other claim.

I further certify that the plat thereof, filed in the U. S. Land Office at Phoenix,
Arizona is correct and in conformity with the foregoing Field Notes.

Frank P. Trott,

United States Surveyor General for Arizona.

SURVEYOR-GENERAL'S CERTIFICATE OF APPROVAL OF FIELD NOTES AND SURVEY OF MINING CLAIM.

Department of the Interior,

OFFICE OF U. S. SURVEYOR-GENERAL,

Phoenix, Arizona.

June 1, 1917.

I, U. S. Surveyor-General for District of Arizona

do hereby certify that the foregoing and hereto attached Field Notes and Return of the Survey of the Mining Claim of

O. D. M. GADDIS, F. M. TOWNSEND AND M. J. TRUMBLE.

, known as the

FLORES WEST, FLORES NORTH, FLORES NORTH NO. 2 LODES.

situate in WALLAPAI mining district,

MOHAVE County, ARIZONA.

in Sections 7 & 12, Township No. 22 N., Range No. 17 & unapp'd. (18 W.)

, designated as Survey No. 3320

executed by Charles M. Becker, U. S. Deputy Mineral

Surveyor, July 10-14, 1916, under my instructions dated

June 26, 1916, have been critically examined and the necessary cor-

rections and explanations made, and the said Field Notes and Return, and the Survey they describe, are hereby approved. A true copy of the copy of the location certificate filed by the applicant for survey is included in the field notes.

Frank P. Frost

U. S. Surveyor-General for Arizona.