

*Plotted*

NOV 29 1916

4-683

MINERAL SURVEY No. 3341

LOT No. ....

Arizona Land District.

FIELD NOTES

OF THE SURVEY OF THE MINING CLAIM OF

N. J. Ritter

KNOWN AS THE

Manie Lode

Mineral Point Mining District,

Yavapai County, Arizona

Section 21, Township 14 N, Range 1 E

Surveyed under instructions dated Sept 30, 1916

by William H. Marshall  
U. S. Mineral Surveyor.

Claim located See location notice, 1907

Survey commenced Nov 27, 1916

Survey completed Nov 27, 1916

Address of claimant J. M. W. Moore Atty  
Prescott, Arizona

DATES OF AMENDED LOCATIONS.

NOV. 29. 1916

( 1 ) ( 3 )

Survey No. 3341 Mamie lode.

Beginning at Cor. No. 1 the N.W. Cor. Identical with loc.

A Porphyry stone 6X8X24 ins. set 12 ins. in the ground with mound of stones chiseled X-1-M-3341. Whence:

1/4 sec. cor. between secs. 21 & 16 T. 16 N. R. 1. E. brs.

N 42°51'W 1515.2 ft.

No bearings available. Loc. cor. mound of stones 2X2 ft.

Feet Thence S 81°39'E Va. 14.30 E

50 Cross wash 20 ft. wide course S 11°45'W

300 N.C.E. identical with the loc. A mound of stones 2X2 ft.

600 To Cor. No. 2 identical with the loc.

Porphyry stone 8X10X24 ins. set 12 ins. in the ground with mound of stones chiseled X-2-M-3341.

No bearings available. Loc. cor. mound of stones 2X2 ft.

Thence S 8°21'W Va. 14°30' E

1500 To Cor. No. 3. identical with the loc.

Malpai stone 6X12X24 ins. set 12 ins. in the ground with mound of stones chiseled X-3-M-3341.

No bearings available. Loc. cor. mound of stones 2X2 ft.

Thence N 81°39'W Va. 14°30'E

300 S.C.E. identical with the loc. a mound of stones 2X2 ft.

600 To Cor. No. 4 Identical with the loc.

Granite stone 6X6X24 ins. set 12 ins. in the ground with mound of stones chiseled X-4-M-3341

No bearings available. Loc. cor. mound of stones 2X2 ft.

Thence N 8°21'E Va. 14°30'E

600 Cross wash 20 ft. wide course S 11°45'W

1500 To Cor. No. 1 the place of beginning.

Area.

Area.....20.661 acres.

Vein.

As near as can be determined from present developments the vein on this claim extends N 8°21'E 1500 ft. from S.C.E. to the N.C.E.

This c

Location

This claim is located in Sec. 21 T. 16 N. R. 1 E. Mineral Point Mining District Yavapai County Arizona.

Adjoining Claims

This claim is bounded on all sides by U.S. Land.

Expenditure of five hundred dollars.

I certify that the value of the labor and improvements made upon this claim by the claimant or his grantors, is not less than five hundred dollars, and that said improvements consist of.

No. 1 dis. shaft which is on the lode line 750 ft. from the S.C.E. 4X6X120 ft. value.....\$1800.00

Other Improvement.

S.E. Cor. of a Cabin brs. from the S.C.E, N 12:45' W 640 ft. 10X18 ft. course of long side North.

Instrument

This survey was made with a Gurley Solar Transit. The courses were deflected from the meridian as determined by direct solar observations. The distances were measured with 100-ft. and 500-ft. steel tapes.

Report

The lode line of this claim was run direct upon the ground, and the several corners established by means of offsets from the lode line. The tie line was run direct upon the ground.

The 1/4 sec. cor. between secs. 16 and 21 T. 16 N. R. 1 E.

is a pipe properly marked.

*William H. Merritt*  
U.S. Mineral Surveyor.

NOV. 29. 1916

# FINAL OATHS FOR SURVEYS.

## LIST OF NAMES.

A list of the names of the individuals employed by W. H. Merritt

United States ~~Deputy~~ Mineral Surveyor, to assist in running, measuring, and marking the lines, corners, and boundaries described in the foregoing field notes of the survey of the mining claim of N. J. Ritter

known as the Mamie Lode

and showing the respective capacities in which they acted.

- A. J. Jennings, Chainman.
- G. N. Merritt, Chainman.
- ....., Axman.
- ....., Flagman.

## FINAL OATHS OF ASSISTANTS.

We, A. J. Jennings

and G. N. Merritt, do solemnly swear that we assisted William

H. Merritt, United States ~~Deputy~~ Mineral Surveyor, in marking the corners and surveying the boundaries of the mining claim of N. J. Ritter

known as the Mamie Lode

represented in the foregoing field notes as having been surveyed by said ~~deputy~~ mineral surveyor and under his direction; and that said survey has been in all respects, to the best of our knowledge and belief, faithfully and correctly executed, and the corner and boundary monuments established according to law and the instructions furnished by the United States Surveyor-General for Arizona

- A. J. Jennings, Chainman.
- G. N. Merritt, Chainman.
- ....., Axman.
- ....., Flagman.

Subscribed and sworn to by the above-named persons before me this 28<sup>th</sup>

day of December, 1916.

J. M. Moore  
Notary Public

My Commission expires 2/20/1920

(4-686.)

FINAL OATH OF U. S. ~~DEPUTY~~ MINERAL SURVEYOR

I, William H. Merritt, U. S. ~~Deputy~~ Mineral Surveyor, do solemnly swear that, in pursuance of instructions received from the United States Surveyor General for Arizona, dated Sept 30 - 1916, I have, in strict conformity to the laws of the United States, the official regulations and instructions thereunder, and the instructions of said Surveyor General, faithfully and correctly executed the survey of the Mining Claim of N. J. Ritter, known as the Manni lode, situate in Mineral Point Mining District, Yavapai County, Arizona, in Section 21, Township No. 16 N., Range No. 1 E. and designated as Survey No. 3341, as represented in the foregoing field notes, which accurately show the boundaries of said mining claim as distinctly marked by monuments on the ground, and described in the attached copy of the location certificate, which was received by me from the Surveyor General with said instructions, and that all the corners of said survey have been established and perpetuated in strict accordance with the law, official regulations and instructions thereunder; and I do further solemnly swear that the foregoing are the true and original field notes of said survey and my report therein, and that the labor expended and improvements made upon said mining claim by claimant or his grantors are as therein fully stated, and that the character, extent, location and itemized value thereof are specified therein with particularity and full detail, and that no portion of said labor or improvements so credited to this claim has been included in the estimate of expenditures upon any other claim.

William H. Merritt  
U. S. ~~Deputy~~ Mineral Surveyor.

Subscribed and sworn to by the said William H. Merritt  
U. S. ~~Deputy~~ Mineral Surveyor, before me J. M. N. Moore  
a Notary Public this 28<sup>th</sup>  
day of November 1916

My Commission expires 2/20/1920

J. M. N. Moore  
Notary Public

# Notice of Mining Location

## LODE CLAIM

SEP 30, 1916

TO ALL WHOM IT MAY CONCERN:

This Mining Claim, the name of which is the " MAMIE "

Mining Claim, situate on lands belonging to the United States of America, and in which there are valuable mineral deposits, was entered upon and located for the purposes of exploration and purchase by W.C.Bayless and G.H.Coffin, Citizens of the United States.

(Locator must insert either "a citizen of the United States," or "who has declared his intention to become a citizen of the United States.")

the undersigned, on the 2d. day of July, 1907.

The length of this claim is Fifteen Hundred feet, and WE claim 750 feet,

in a Northerly direction and 750

feet in a Southerly direction from the center of the discovery shaft, at which this notice is posted, lengthwise of the claim, together with

Three Hundred feet in width of the surface grounds, on each side of the center of said claim. The general course of the lode deposit and premises is from the

Northerly to the Southerly

The claim is situated and located in the Mineral Point Mining District,

in Yavapai County, in the Territory of Arizona, about 1000 feet

in a Northerly direction from Bridge No. 7, on the line of the United Verde & Pacific Railroad. This Claim was formerly known as the " MAMIE ", and is located as abandoned property.

The surface boundaries of the claim are marked upon the ground as follows: Beginning at A STONE MONUMENT

at a point in a Northerly direction 750 feet from

the discovery shaft (at which this notice is posted), being in the center of the North

end line of said claim; thence Easterly 300 feet to a Stone Monument

, being the Northeast corner of said claim;

thence Southerly 1500 feet to a Stone Monument, being at the

Southeast corner of said claim; thence Westerly 300 feet

to a Stone Monument at the center of the South end of said claim;

thence Westerly 300 feet to a Stone Monument, being at the

Southwest corner of said claim; thence Northerly 1500

feet to a Stone Monument at the Northwest corner of

said claim; thence Easterly 300 feet to the place of the beginning.

All done under the provisions of Chapter Six, of Title XXXII, of the Revised Statutes of the United States, and of an Act of the General Assembly of Arizona, entitled "An Act to Revise and Codify the Laws of the Territory of Arizona," approved March 16, 1901.

Dated and posted on the ground this 2d. day of July, - 1907.

Witness :-

J.W.Archer.

W.C.Bayless, &

G.H.Coffin,

STATE OF ARIZONA,

County of \_\_\_\_\_

ss.

I, \_\_\_\_\_, County Recorder in and for the County and State aforesaid, do hereby certify that the within instrument was filed for record at \_\_\_\_\_ o'clock \_\_\_\_\_ M., on this \_\_\_\_\_ day of \_\_\_\_\_ 191\_\_\_\_, and duly recorded in Book No. \_\_\_\_\_ of \_\_\_\_\_ Records of \_\_\_\_\_ County, Arizona, at pages \_\_\_\_\_

Witness my hand and official seal the day and year first above written.

County Recorder

# Notice of Location

## LODE CLAIM

Dated \_\_\_\_\_, 191\_\_\_\_  
Filed and Recorded at request of

J. W. Archer,

Aug., 16, - , A. D. 1907.

at 9:48 - 0'clock A. M.

Book 82 of Mines;

Page# 375; Records of Yavapai County, Arizona.

(SEAL) I. C. Bradbury,  
County Recorder

By A. C. Gilmore,  
Deputy Recorder

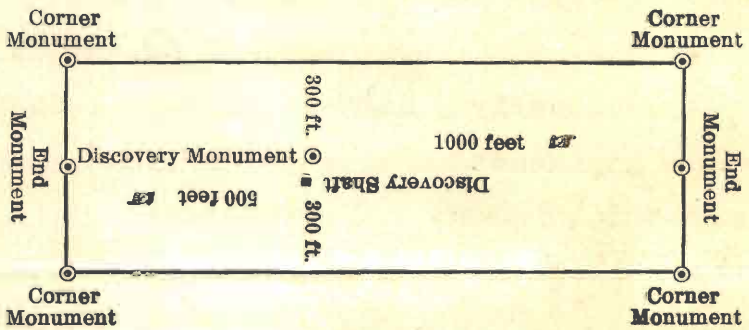

This diagram is to give locators a general idea of plan of location under the new law. The Discovery Shaft can be in the center of claim or any distance from either end desired. In the diagram it is placed 500 feet from one end and 1000 feet from the other. Commence description of claim at a center end monument, giving its distance and direction from center of Discovery Shaft; thence bound the claim in either direction. In description be careful to state locality of claim with reference to some natural object, or permanent monument, as will identify the claim.

### and recorded at record ###

###

### Book ###

###

### Records of Yavapai County, Arizona ##

## (S) ##

### L. S. COLWELL ##  
County Recorder ##

##

### County Recorder ###

STATE OF ARIZONA, }  
COUNTY OF YAVAPAI. } ss.

I, L. S. Colwell, County Recorder in and for the County of Yavapai, State of Arizona, and custodian of the records of such office, do hereby certify that I have compared the foregoing copy with, and that the same is a full, true and correct copy of Notice Of Mining Location, of the "MAMIE" Mining Claim ; Located by W.C.Bayless and G.H.Coffin; on the 2nd., day of July, A.D., 1907; in the Mineral Point Mining District; and, - A.M., filed for record on Aug., 16th., A.D., 1907; at 9:48-0'clock/ and as the same appears of record in my office in Book 82, of MINES; at page# 375; and of the whole thereof.

IN WITNESS WHEREOF, I have hereunto set my hand and affixed my Official Seal this 29th. day of September, A. D., 1916.

*L. S. Colwell*

County Recorder.





U. S. SURVEYOR-GENERAL'S FINAL CERTIFICATE ON FIELD NOTES.

Department of the Interior,

OFFICE OF U. S. SURVEYOR-GENERAL,

Phoenix, Arizona.

May 4, 1917.

I, U. S. Surveyor-General for District of Arizona do hereby certify that the foregoing transcript of the Field Notes, return and approval of the survey of the mining claim of

N. J. RITTER

known as the MAMIE LODE

situate in MINERAL POINT

Mining District, YAVPAI County, ARIZONA.

in Section 21, Township No. 16 N., Range No. 1 E., and

designated as Survey No. 3341, has been correctly copied from the originals on file in

this office; that said Field Notes furnish such an accurate description of said mining claim as will, if incorporated into a patent, serve fully to identify the premises, and that such reference is made therein to natural objects or permanent monuments as will perpetuate and fix the locus thereof.

And I further certify that five hundred dollars' worth of labor has been expended or improvements made upon said mining claim by claimant or his grantors, and that said improvements consist of 1 shaft, value \$1800.

and that no portion of said labor or improvements has been included in the estimate of expenditures upon any other claim.

I further certify that the plat thereof, filed in the U. S. Land Office at Phoenix, Arizona, is correct and in conformity with the foregoing Field Notes.

Frank P. Trott,

United States Surveyor-General for Arizona.

4-687.

SURVEYOR-GENERAL'S CERTIFICATE OF APPROVAL OF FIELD NOTES AND SURVEY OF MINING CLAIM.

Department of the Interior,

OFFICE OF U. S. SURVEYOR-GENERAL,

Phoenix, Arizona,

May 4, 1917.

I, U. S. Surveyor-General for District of Arizona

do hereby certify that the foregoing and hereto attached Field Notes and Return of the Survey of the Mining Claim of

N. J. RITTER

, known as the

MAMIE LODE

situate in MINERAL POINT mining district,

YAVAPAI County, ARIZONA.

in Section 21, Township No. 16 N., Range No. 1 E.

, designated as Survey No. 3341

executed by William H. Merritt, U. S. Deputy Mineral

Surveyor, November 27, 1916, under my instructions dated

September 30, 1916, have been critically examined and the necessary cor-

rections and explanations made, and the said Field Notes and Return, and the Survey they describe,

are hereby approved. A true copy of the copy of the location certificate filed by the applicant for

survey is included in the field notes.

[Handwritten signature]

U. S. Surveyor-General for Arizona.