

Platted

MINERAL SURVEY No. 3367

LOT No.

Arizona Land District.

FIELD NOTES

OF THE SURVEY OF THE MINING CLAIM OF

ARIZONA RAY COPPER CO

KNOWN AS THE
COLORADO, CARNATION, JUAREZ, WEDGE, COMBINATION, ADVENTURE,
CARRIE NATION, COPPER ZONE NO.4, COPPER ZONE NO.5,
COPPER ZONE NO.6, COPPER ZONE NO.7, COPPER ZONE NO.8 lodes.

Mineral Creek Mining District,

Pinal County, Arizona.

Sections I, 2, 11, 12, Township 3 South, Range 13 East, ^{Unapproved,} G. & S.R.M.

Surveyed under instructions dated February 13, 1917.

by Paul E. Fernald
U. S. Mineral Surveyor.

Claim located (See location notices 12, 13, 19)

Survey commenced February 20th., 1917

Survey completed March 20th., 1917

Address of claimant Arizona Ray Copper Co.
Phoenix, Ariz.

MINERAL SURVEY NO. 3367

Claims	M & B Desc.	Improvements	Loc. Notices
	Pg.	Pg.	Red Pg.
Adventure	3	23	11
Carnation	17	27	3
Carrie Nation	8	24	13
Colorado	4	23	1
Combination	16	27	9
Copper Zone No. 4	11	24	15
" "	5	25	17
" "	6	25	19
" "	7	26	21
" "	8	26	23
Juarez	1	22	5
Wedge	5	23	7

JUL 19 1917

(1)2

U.S. MINERAL SURVEY NO. 3367.

(feet) JUAREZ LODE.
 Beginning at Cor.No.I.
 A 1 inch iron pipe. $3\frac{1}{2}$ feet long, with claw base, set $1\frac{1}{2}$ feet in the ground and surrounded by mound of stones.
 Brass cap on pipe stamped U.S.Mineral Survey No.3367, I-Juarez.
 Whence U.S.Mineral Monument No.2718, Arizona Land District, bears N $89^{\circ} 12\frac{1}{2}' W$, 3955.25 feet.
 The S.W.Cor.Tom Payne Lode, unsurveyed, bears S $83^{\circ} 31\frac{1}{2}' W$, 1.12 feet.
 Cor.No.3 Wedge Lode, this survey, identical with Cor.No.2 Adventure Lode, this survey, bears S $16^{\circ} 54' E$, 143.63 feet.
 Thence N $83^{\circ} 31\frac{1}{2}' E$
 15.43 Intersects line 2-3, Wedge Lode, this survey, at point N $10^{\circ} 45' W$, 141.65 feet from Cor.No.3.
 75:00 Crosses center Calumet Mine road, from N.E.
 300.00 North End Center - monument of stones 3 feet high.
 600.00 Cor.No.2, identical with Cor.No.3, Black Warrior Lode, Sur.No.2465, and Cor.No.4, Calumet Lode, Sur.No.2465. Also identical with the S.E.Cor.Tom Payne Lode, Unsurveyed.
 A granite rock, 1 foot above ground, 12x8 inches in cross section, scribed 3367, 2-J, on its west face for this corner; cross on top marks exact corner point.
 Whence the E. $\frac{1}{4}$ Cor. of Section II, T 3 S, R 13 E. G. & S.R. B. & M. (surveyed but not approved) bears N $23^{\circ} 57\frac{1}{2}' E$, 630.19 feet.
 Thence S $11^{\circ} 3' E$
 340.00 Crosses center gulch running S.W.
 1024.88 Cor.No.4, Black Warrior Lode, Survey No.2465, identical with Cor.No.3, Sweepstake Lode, Survey No.2572, which is N $44^{\circ} 34\frac{1}{2}' E$ 737.96 ft. from Cor.No. 2 said Sweepstake lode, and 435.18 ft. from intersection of line 2-3 said Sweepstake lode with the north side line of the
 1226.84 Intersects the North side line of Satellite No.2 Lode, Satellite No.2 lode, unsurveyed. unsurveyed, at point S $71^{\circ} 59' W$, 144.04 feet from the N.E. Corner.
 1500.00 Cor.No.3.
 A 1 inch iron pipe. $3\frac{1}{2}$ feet long, with claw base, set $1\frac{1}{2}$

- feet in the ground and surrounded by mound of stones.
Brass cap on pipe stamped U.S. Mineral Survey No. 3367, 3-Juarez.
- Whence the N.E. Corner of Satellite No. 2, unsurveyed, bears N $15^{\circ} 8' 40''$ E, 323.90 feet. ✓
- Thence S $83^{\circ} 31\frac{1}{2}'$ W
- 300.00 South End Center - monument of stones .3 feet high.
- 424.56 Intersects line 2-3, Adventure Lode, this survey, at point S $17^{\circ} 43'$ E, 1380.44 feet from Cor. No. 2.
- 600.00 Cor. No. 4.
- A 1 inch iron pipe, $3\frac{1}{2}$ feet long, with claw base, set $1\frac{1}{2}$ feet in the ground and surrounded by mound of stones. Brass cap on pipe stamped U.S. Mineral Survey No. 3367, 4-Juarez.
- Whence Cor. No. 2, Sweepstake Lode, Survey No. 2572, bears N $57^{\circ} 3'$ W, 15.28 feet. ✓
- The N.W. Cor. Satellite No. 2 Lode, unsurveyed, bears S $87^{\circ} 20'$ W, 571.38 feet. ✓
- Cor. No. 3, Adventure Lode, this survey, bears S $65^{\circ} 56'$ E, 230.77 feet.
- Thence N $11^{\circ} 3'$ W
- 18.13 Intersects line 2-3 Sweepstake Lode, Survey No. 2572, at point N $44^{\circ} 34\frac{1}{2}'$ E, 13.32 feet from Cor. No. 2 and S $44^{\circ} 34\frac{1}{2}'$ W, 724.64 feet from Cor. No. 3.
- 152.37 Intersects the North side line of Satellite No. 2 Lode, unsurveyed, at point S $71^{\circ} 59'$ W, 746.61 feet from the N.E. Corner, and 240.69 ft. from intersection of said line with line 2-3 Sweepstake lode, Sur. No. 2572.
- 680.00 Crosses center of gulch running S.W.
- 1014.00 Crosses center of drill road running West.
- 1355.15 Intersects line 1-2, Adventure Lode, this survey, at point S $71^{\circ} 17\frac{1}{2}'$ W, 14.77 feet from Cor. No. 2.
- Identically, intersects line 3-4, Wedge Lode, this survey, at point S $71^{\circ} 17\frac{1}{2}'$ W, 14.77 feet from Cor. No. 3.
- 1459.00 Crosses center Calumet Mine road, running West.
- 1500.00 Cor. No. 1, the point of beginning.

U.S. MINERAL SURVEY NO. 3367.

ADVENTURE LODE.

Beginning at Cor.No.1. Identical with Cor.No.2, Colorado Lode, this survey, and lying on line 4-I, Chicago Lode, Survey No.2605.

A 1 inch iron pipe, $3\frac{1}{2}$ feet long, with claw base, set $1\frac{1}{2}$ feet in the ground and surrounded by a mound of stones. Brass cap on pipe stamped U.S.Mineral Survey No.3367, I-Adventure..

Whence U.S.Mineral Monument No.2718 bears N $83^{\circ}36'W$, 3449.82 feet..

Thence N $71^{\circ}17\frac{1}{2}'E$

- 159.00 Crosses drill road running W.-N.W.
- 200.00 Cor.No.4 Wedge Lode, this survey.
- 239.07 Cor.No.4 Chicago Lode, Survey No.2605.
- 300.00 North End Center - monument of stones 3 feet high.
- 400.00 South End Center Wedge Lode, this survey.
- 585.23 Intersects line 4-I Juarez Lode, this survey, at point N. $11^{\circ}3'W$, 1355.15 feet from Cor.No.4.
- 600.00 Cor.No.2, Identical with Cor.No.3 Wedge Lode, this survey.
A 1 inch iron pipe, $3\frac{1}{2}$ feet long, with claw base, set $1\frac{1}{2}$ feet in the ground and surrounded by a mound of stones. Brass cap on pipe stamped U.S.Mineral Survey.No.3367, 2-Adventure.
- Thence S $17^{\circ}43'E$
- 338.00 Crosses drill road running west.
- 560.00 Crosses center gulch running S.W.
- 1194.18 Intersects the North side line of Satellite No.2 Lode, Unsvd. at point S $71^{\circ}59'W$, 592.18 feet from the N.E.Cor.
- 1239.03 Intersects line 2-3 Sweepstake Lode, Survey No.2572, at point N $44^{\circ}34\frac{1}{2}'E$, 205.35 feet from Cor.No.2.
- 1380.44 Intersects line 3-4 Juarez Lode, this survey, at point N $83^{\circ}31\frac{1}{2}'E$, 175.44 feet from Cor.No.4.
- 1500.00 Cor.No.3.
A 1 inch iron pipe, $3\frac{1}{2}$ feet long, with claw base, set $1\frac{1}{2}$ feet in the ground and surrounded by a mound of stones. Brass cap on pipe stamped U.S.Mineral Survey No.3367, 3-

Adventure.

Whence Cor.No.2 Sweepstake Lode, Survey No.2572, bears
N 65° 23'W, 245.88 feet.

Cor.No.1 Sweepstake Lode, Survey No.2572, bears
S 32° 54'E, 374.60 feet.

Thence S 71° 17½'W

93.00 Intersects line I-2 Sweepstake Lode, Survey No.2572, at
point S 45° 41'E, 189.30 feet from Cor.No.2.

300.00 South End Center - monument of stones 3 feet high.

600.00 Corner No.4, identical with Cor.No.3 Colorado Lode, this
survey, hereinafter described.

A 1 inch iron pipe, 3½ feet long, with claw base, set 1½
feet in the ground and surrounded by a mound of stones.

Brass cap on pipe stamped U.S.Mineral Survey No.3367, 4-
Adventure.

Thence N 17° 43'W

187.00 Crosses center of gulch running S.W.

313.07 Intersects the north side line of Satellite No.2 Lode,
unsurveyed, at point N 71° 59'E, 123.98 feet from the
N.W.Corner, and S 71° 59'W 1192.10 ft. from the N.E. Cor

1411.00 Crosses branch road running N.E.

1500.00 Cor.No.1, the point of beginning.

COLORADO LODE.

Beginning at Cor.No.1

A 1 inch iron pipe, 3½ feet long, with claw base, set 1½
feet in the ground and surrounded by mound of stones.

Brass cap on pipe stamped U.S.Mineral Survey No.3367, I-
Colorado.

Whence U.S.Mineral Monument No.2718 bears N 82° 42'W,
3337.95 feet.

On line 4-I Chicago Lode, Sur.No.2605, N 71° 17½'E
236.88 feet from Cor.No.1.

Thence N 71° 17½'E

32.00 North end center - monument of stones 3 feet high.

124.00 Cor.No.2.

Identical with Cor.No.1 Adventure Lode, this survey, here-
tofore described. Brass cap marked 2-Colorado for this

U.S. Mineral Survey No. 3367.

- corner.
- Thence S $17^{\circ}43'E$
- 89.00 Crosses branch road running N.E.
- I186.93 Intersects the N.side line of Satellite No.2 Lode, unsurveyed, at point I23.98 feet, N $71^{\circ}59'E$, from N.W.Corner.
- I313.00 Crosses gulch running S.W.
- I500.00 Cor.No.3, identical with Cor.No.4 Adventure Lode, this survey, heretofore described. Brass cap additionally marked for this corner "3-Colorado".
- Thence S $71^{\circ}17\frac{1}{2}'W$
- 92.00 South end center - monument of stones 3 feet high.
- I19.97 Intersects the west end line of Satellite No.2 Lode, unsurveyed, at point S $18^{\circ}27'E$, 314.58 feet from the N.W.Corner.
- Identically, intersects line 3-4, Thomas Lode, Survey No. I58I, at point S $18^{\circ}27'E$, 314.58 feet from Cor.No.3.
- I24.00 Cor.No.4.
- A 1 inch iron pipe, $3\frac{1}{2}$ feet long, with claw base, set $1\frac{1}{2}$ feet in the ground and surrounded by mound of stones. Brass cap on pipe stamped U.S.Mineral Survey No.3367, 4-Colorado.
- Whence the S.W.Cor.of Satellite No.2 Lode, unsurveyed, bears S $19^{\circ}16'E$, 284.11 feet.
- Thence N $17^{\circ}43'W$
- I85.00 Crosses gulch running W.-S.W.
- 314.62 Cor.No.3 Thomas Lode, Survey I58I, identical with Cor.No.4 Contention Lode, Survey No.I58I, and the N.W.Corner of Satellite No.2 Lode, unsurveyed.
- I906.97 Cor.No.3 Contention Lode, Survey No.I58I, identical with Cor.No.4, Truman Lode, Survey No.I58I.
- I340.00 Crosses branch drill road, running N.E.
- I499.32 Cor.No.3, Truman Lode, Survey No.I58I.
- I500.00 Cor.No.I, the point of beginning.

WEDGE LODE.

Beginning at Cor.No.I.

A 1 inch iron pipe, $3\frac{1}{2}$ feet long, with claw base, set $1\frac{1}{2}$

feet in the ground and surrounded by a mound of stones.
Brass cap on pipe stamped U.S.Mineral Survey No.3367, 1-
Wedge.

Whence U.S.Mineral Monument No.2718 bears S $70^{\circ} 57' W$,
3531.54 feet.

Cor.No.2, Chicago Lode, Survey No.2605, identical
with Cor.No.3, New York Lode, Survey No.2605, bears
S $38^{\circ} 14' W$, 208.62 feet.

Cor.No.2, Marion Lode, Survey No.3055, bears
S $32^{\circ} 18' W$, 1548.96 feet.

Cor.No.3 Marion Lode, Survey No.3055, bears
S $40^{\circ} 30\frac{1}{2}' E$, 271.49 feet.

Cor.No.4 Blue Bell Lode, Survey No.2605, bears
S $64^{\circ} 22' E$, 162.84 feet.

Cor.No.4 Carrie Nation Lode, this survey, bears
N $89^{\circ} 20' E$, 368.71 feet.

Thence N $71^{\circ} 17\frac{1}{2}' E$

166.74 Intersects line 3-4, Blue Bell Lode, Survey No.2605, at
point N $5^{\circ} 7\frac{1}{2}' E$, 124.43 feet from Cor.No.4.

200.00 North end center - monument of stones 3 feet high.

364.99 Intersects line 3-4, Carrie Nation Lode, this survey, at
point N $11^{\circ} 31' W$, 115.10 feet from Cor.No.4.

Identically, intersects the west side line of Tom Payne
Lode, unsurveyed, at point N $11^{\circ} 31' W$, 1351.64 feet from

400.00 the S.W. Corner, 115.10 ft. from its intersection with line 2-3 Chicago lode, Sur.No.2605, 342.74 ft. from its
intersection with line 3-4 said Chicago lode, 599.38 ft. from its intersection with line 3-4 Marion lode, Sur. No.
3055, and 848.12 ft. from its intersection with line 4-1 said Marion lode.
Corner No.2.

A 1 inch iron pipe, $3\frac{1}{2}$ feet long, with claw base, set $1\frac{1}{2}$
feet in the ground and surrounded by a mound of stones.
Brass cap on pipe stamped U.S.Mineral Survey No.3367, 2-
Wedge.

Whence the N.W. Cor. of Tom Payne Lode, unsurveyed, bears
N $24^{\circ} 58' W$, 149.38 feet.

Cor.No.3 Chicago Lode, Survey No.2605, bears
S $28^{\circ} 5' E$, 115.79 feet.

Corner No.4 Marion Lode, Survey No.3055, bears
S $17^{\circ} 45' E$, 770.24 feet.

U.S. MINERAL SURVEY NO. 3367

- Thence S 10° 45' E.
- 115.33 Intersects line 2-3, Chicago Lode, Survey No. 2605, at point S 71° 20' W, 34.83 feet from Cor. No. 3.
 - 237.14 Intersects line 3-4, Chicago Lode, Survey No. 2605, at point N 4° 29½' E, 1359.92 feet from Cor. No. 4, 114.43 ft. from its intersection with the west side line of the Tom Payne lode, unsurveyed, and 306 and 779.60 ft, respectively, from its intersection with lines 3-4 and 4-1 Marion lode, Sur. No. 3055.
 - 639.40 Intersects line 3-4, Marion Lode, Survey No. 3055, at point S 47° 38' E, 435.54 feet from Cor. No. 3, 134.04 ft. from its intersection with line 3-4 Chicago lode, Sur. No. 2605, and 44.41 ft. from its intersection with the west side line of the Tom Payne lode, unsurveyed.
 - 835.15 Intersects line 4-I, Marion Lode, Survey No. 3055, at point S 42° 19' W, 117.52 feet from Cor. No. 4.
 - 1357.62 Intersects the South end line of Tom Payne Lode, unsurveyed, at point N 83° 31½' E, 16.55 feet from the S.W. Corner. Identically, intersects line I-2, Juarez Lode, this survey, at point N 83° 31½' E, 15.43 feet from Cor. No. I.
 - 1394.00 Crosses Calumet Mine road running West.
 - 1499.27 Cor. No. 3, identical with Cor. No. 2, Adventure Lode, this survey, heretofore described. Brass cap additionally marked "3-Wedge". Whence the S.W. Cor. of Tom Payne Lode, unsurveyed, bears N 17° 20' W, 143.83 feet.
 - 14.77 Intersects line 4-I Juarez Lode, this survey, at point S 11° 3' E, 144.85 feet from Cor. No. I.
 - 200.00 South end center - monument of stones 3 feet high.
 - 300.00 North end center monument Adventure Lode, this survey.
 - 360.93 Cor. No. 4, Chicago Lode, Survey No. 2605.
 - 400.00 Cor. No. 4. A 1 inch iron pipe, 3½ feet long, with claw base, set 1½ feet in the ground and surrounded by a monument of stones Brass cap on pipe stamped U.S. Mineral Survey No. 3367, 4-Wedge. Whence Cor. No. I, Chicago Lode, Survey No. 2605, bears S 71° 17½' W, 560.88 feet.
 - 227.00 Crosses Calumet Mine road, running west.
 - 421.71 Intersects line 4-I Marion Lode, Survey No. 3055, at point

Thence N 10° 45' W.

- S $42^{\circ}19'W$, 613.11 feet from Cor.No.4, 210.17 ft. from its intersection with line 3-4 Chicago lode, Sur.No.2605, and 466.49 ft. from its intersection with the west side line of the Tom Payne lode, unsurveyed.
- 1162.29 Intersects line 2-3, Marion Lode, Survey No.3055, at point S $42^{\circ}19'W$, 168.58 feet from Cor.No.3.
- 1383.97 Intersects line 4-I, Carrie Nation Lode, this survey, at point S $71^{\circ}17\frac{1}{2}'W$, 366.54 feet from Cor.No.4.
- 1384.25 Intersects line 2-3, Chicago Lode, Survey No.2605, at point N $71^{\circ}20'E$, 158.92 feet from Cor.No.2, S $71^{\circ}20'W$, 593.72 ft. from Cor.No.3 and 366.52 ft. from its intersection with the west end line of the Tom Payne lode, unsurveyed.
- 1384.29 Intersects line 4-I, Blue Bell Lode, Survey No.2605, at point S $71^{\circ}16'W$, 132.38 feet from Cor.No.4.
- 1499.27 Cor.No.1, the point of beginning.
- CARRIE NATION LODGE.
- Beginning at Cor.No.1.
- A 1 inch iron pipe, $3\frac{1}{2}$ feet long, with claw base, set $1\frac{1}{2}$ feet in the ground and surrounded by a monument of stones. Brass cap on pipe stamped U.S.Mineral Survey No.3367, 1-Carrie N. Whence U.S.Mineral Monument No.2718 bears S $73^{\circ}32'W$, 2383.83 feet. Cor.No.1 Blue Bell Lode, Survey No.2605, identical with Cor.No.3 Boston Lode, Survey No.2605, bears S $71^{\circ}14\frac{1}{2}'W$, 230.51 feet. Thence N $11^{\circ}31'W$
- 300.00 West end center - monument of stones 3 feet high.
- 440.78 Intersects line 4-I, Copper Zone No.I Lode, Survey No.3086, at point S $69^{\circ}7'W$, 107.35 feet from Cor.No.4.
- 540.92 Intersects line 2-3, Blue Bell Lode, Survey No.2605, at point S $76^{\circ}45\frac{1}{2}'W$, 1383.15 feet from Cor.No.3, 87.87 ft. from its intersection with line 3-4 Copper Zone No.1 lode, Sur. No. 3086, and 1253.61 ft. from its intersection with line 3-4 Granite lode, Sur.No. 2465.
- 600.00 Cor.No.2.
- A 1 inch iron pipe, $3\frac{1}{2}$ feet long, with claw base, set $1\frac{1}{2}$ feet in the ground and surrounded by a mound of stones. Brass cap on pipe stamped U.S.Mineral Survey No.3367, 2-Carrie N. Whence Cor.No.4, Copper Zone No.I Lode, Survey No.3086, bears S $48^{\circ}17'E$, 176.95 feet. Identically Cor.No.1, Copper Zone No.4 Lode, this survey, bears S $48^{\circ}17'E$, 176.95 feet. Cor.No.2, Blue Bell Lode, Survey No.2605, bears

U.S. MINERAL SURVEY NO. 3367.

S 34° 17' W, 87.45 feet.

Cor. No. I, Copper Zone No. I Lode, Survey No. 3086, bears S 62° 28' W, 1356.02 feet.

Cor. No. 3, Copper Zone No. I Lode, Survey No. 3086, bears N 13° 54½' W, 445.53 feet.

Thence N 71° 17½' E

74.46 Intersects line 3-4, Copper Zone No. I Lode, Survey No. 3086, at point N 23° 29½' W, 154.43 feet from Cor. No. 4, and 66.24 ft. from its intersection with line 2-3 Blue Bell lode, Sur. No. 2605.

74.47 Intersects line 4-I, Copper Zone No. 4 Lode, this survey, at point N 23° 29½' W, 154.43 feet from Cor. No. I.

671.49 Intersects line 2-3, Copper Zone No. 4 Lode, this survey, at point N 23° 29½' W, 182.35 feet from Cor. No. 2.

Identically, intersects line 4-I, Copper Zone No. 5 Lode, this survey, at point N 23° 29½' W, 182.35 feet from Cor. No. I. This point is 124.98 ft. from intersection of lines 2-3 and 4-I with line 2-3 Blue Bell lode, Sur. No. 2605.

1268.51 Intersects line 2-3, Copper Zone No. 5 Lode, this survey, at point N 23° 29½' W, 210.26 feet from Cor. No. 2.

Identically, intersects line 4-I, Copper Zone No. 6 Lode, this survey, at point N 23° 29½' W, 210.26 feet from Cor. No. I.

1277.04 Intersects line 3-4, Granite Lode, Survey No. 2465, at point N 7° 7' W, 287.91 feet from Cor. No. 4, and 181.70 ft. from its intersection with line 2-3 Blue Bell lode, Sur. No. 2605.

1500.00 Cor. No. 3.

A 1 inch iron pipe, 3½ feet long, set 1½ feet in the ground, with claw base, and surrounded by a mound of stones. Brass cap on pipe stamped U.S. Mineral Survey No. 3367. 3-Carrie N.

Whence Cor. No. 3 Blue Bell Lode, Survey No. 2605, bears S 15° 44' W, 230.78 feet. Cor. No. 4 said Blue Bell lode brs. S 5° 7½' W, 442.29 ft. from Cor. No. 3 thereof, and intersection of line 3-4 said Blue Bell lode with line 1-4 Granite lode, Sur. No. 2465, brs. S 5° 7½' W, 123.12 ft. from Cor. No. 3 said Blue Bell lode.

Cor. No. 4 Granite Lode, Survey No. 2465, bears S 26° 10' W, 397.99 feet

Cor. No. 2, Copper Zone No. 5 Lode, this survey, identical with Cor. No. I Copper Zone No. 6 Lode, this survey, bears S 26° 53½' W, 299.48 feet.

Cor. No. 3, Granite Lode, Survey No. 2465, bears N 46° 24' W, 344.99 feet.

015511

Cor.No.I, Granite Lode, Survey No.2465, bears
S 82° 23'E, 1324.85 feet.

Thence S 11° 31'E
219.92 Intersects line I-2, Copper Zone No.6 Lode, this survey,
at point N 73° 57'E, 186.64 feet from Cor.No.I.

300.00 East end center - monument of stones 3 feet high.

334.37 Intersects line 4-J, Granite Lode, Survey No.2465, at
point N 83° 2½'E 244.06 feet from Cor.No.4, and 141.37 ft. from its
intersection with line 3-4 Blue Bell lode, Sur. No. 2605.

335.24 The N.W.Cor.of Tom Payne Lode, unsurveyed.

484.90 Intersects line I-2, Wedge Lode, this survey, at point
N 71° 17½'E, 364.99 feet from Cor.No.I.

600.00 Cor.No.4.
A 1 inch iron pipe, 3½ feet long, with claw base, set 1½
feet in the ground and surrounded by mound of stones.
Brass cap on pipe stamped U.S.Mineral Survey No.3367. 4-
Carrie N.
Whence Cor.No.4, Blue Bell Lode, Survey No.2605, bears
S 71° 23'W, 234.12 feet.

~~Cor.No.I, Wedge Lode, this survey, bears S 89° 20'W,
368.71 feet.~~

On line 2-3 Chicago Lode, Survey No.2605, at point
S 71° 20'W, 68.28 feet from Cor.No.3, N. 71° 20' E. 525.44 ft. from Cor.
No.2, and 404.86 ft. from its intersection with line 4-1 Blue Bell lode, Sur.No.2605.

Thence S 71° 17½'W
366.54 Intersects line 4-I, Wedge Lode, this survey, at point
S 10° 45'E, 115.30 feet from Cor.No.I.

525.61 Intersects line I-2, Chicago Lode, Survey No.2605, at
point S 4° 42'W, 0.42 feet from Cor.No.2.

Identically, intersects line 3-4, New York Lode, Survey
No.2605, at point S 4° 42'W, 0.42 feet from Cor.No.3. This
point is S. 4° 42'W. 27 ft. from the intersection of said lines 1-2 and 3-4 with line 4-1 Blue Bell lode,
Sur.No.2605.

1126.74 Cor.No.2, New York Lode, Survey No.2605, identical with
Cor.No.4, Boston Lode, Survey No.2605.

Intersects line 4-I, Blue Bell Lode, Survey No.2605, at
point S 71° 16'W, 892.61 feet from Cor.No.4, 601.24 ft. from its
intersection with line 1-2 Chicago lode, and line 3-4 New York lode, both of Sur.No.2605, and
722.65 ft. from its intersection with line 2-3 Chicago lode. Cor.No.3 said New York lode, brs.N.71°
15½'E 601.28 ft.

1500.00 Cor.No.I, the point of beginning.

U.S. MINERAL SURVEY NO. 3367

Copper Zone No. 4 Lode.

Beginning at Cor. No. 1, identical with Cor. No. 4, Copper Zone No. 1 Lode, Survey No. 3086.

A granite stone, 12 inches above ground, 8x18 inches in section, marked for this corner "3367, 1 C.Z. 4".

Whence U.S. Mineral Monument No. 2718 bears S 63° 30' W, 2568.18 feet.

Cor. No. 3, Copper Zone No. 1 Lode, Survey No. 3086 bears N 23° 29½' W, 599.96 feet.

Cor. No. 2, Blue Bell Lode, Survey No. 2605, bears N 75° 55' W, 186.96 feet.

Thence N 73° 57' E.

300.00 South end center - monument of stones 3 feet high.

600.00 Cor. No. 2.

A 1 inch iron pipe, 3½ feet long, with claw base, set 1½ feet in the ground and surrounded by a mound of stones.

Brass cap on pipe stamped U.S. Mineral Survey No. 3367, 2-C.Z. 4.

Thence N 23° 29½' W

57.37 Intersects line 2-3 Blue Bell Lode, Survey No. 2605, at point N 76° 45½' E, 755.16 feet from Cor. No. 2.

182.35 Intersects Line 2-3 Carrie Nation Lode, this survey, at point N 71° 17½' E, 671.49 feet from Cor. No. 2.

1500.00 Cor. No. 3.

A 1 inch iron pipe, 3½ feet long, with claw base, set 1½ feet in the ground and surrounded by a mound of stones.

Brass cap on pipe stamped U.S. Mineral Survey No. 3367, 3-C.Z. 4.

Thence S 73° 57' W

300.00 North end center - monument of stones 3 feet high.

600.00 Cor. No. 4.

A 1 inch iron pipe, 3½ feet long, with claw base, set 1½ feet in the ground and surrounded by a mound of stones.

Brass cap on pipe stamped U.S. Mineral Survey No. 3367, 4-C.Z. 4.

Thence S 23° 29½' E

- 26.71 Cor.No.3, Copper Zone No.3 Lode, Survey No.3088, whence
Cor.No.4, same lode, bears S 23°29'E, 273.24 feet.
- 1345.57 Intersects line 2-3 Carrie Nation Lode, this survey, at
point N 71°17½'E, 74.47 feet from Cor.No.2.
- 1412.79 Intersects line 2-3, Blue Bell Lode, Survey No.2605, at
point N 76°45½'E, 150.59 feet from Cor.No.2.
- 1500.00 Cor.No.1, the point of beginning.
- Copper Zone No.5. Lode.
Beginning at Cor.No.1.
Identical with Cor.No.2, Copper Zone No.4 Lode, this survey,
heretofore described. Brass cap marked additionally
for this corner "1-C.Z.5"
Whence U.S.Mineral Monument No.2718 bears S 65°28½'W,
3160.05 feet.
Thence N 73°57'E
300.00 South end center- monument of stones 3 feet high.
- 548.47 Intersects line 3-4, Granite Lode, Survey No. 2465, at
point N 7°7'W, 76.43 feet from Cor.No.4.
- 600.00 Cor. No.2.
A 1 inch iron pipe, 3½ feet long, with claw base, set
1½ feet in the ground and surrounded by mound of stones.
Brass cap on pipe stamped U.S.Mineral Survey No.3367, 2-
C.Z.5.
Whence Cor.No.4, Granite Lode, Survey No.2465, bears
S 23°59'W, 98.61 feet.
Cor.No.4, Blue Bell Lode, Survey No.2605, bears
S 4°49'20"E, 396.96 feet.
Cor.No.3, Blue Bell Lode, Survey No.2605, bears
N 58°19'E, 85.63 feet.
Cor.No.3, Granite Lode, Survey No.2465, bears
N 12°45½'W, 517.84 feet.
Thence N 23°29½'W
- .27.53 Intersects line 2-3, Blue Bell Lode, Survey No.2605, at
point S 76°45½'W, 86.13 feet from Cor.No.3.
- 180.61 Intersects line 3-4, Granite Lode, Survey No.2465, at
point N 7°7'W, 257.72 feet from Cor.No.4.

U.S. MINERAL SURVEY NO. 3367.

- 210.26 Intersects line 2-3 Carrie Nation Lode, this survey, at
point S $71^{\circ} 17\frac{1}{2}'$ W, 231.49 feet from Cor.No.3.
- 1500.00 Cor.No.3. Situated in Rustler Gulch, but south from
and above channel.
A 1 inch iron pipe, $3\frac{1}{2}$ feet long, with claw base, set $1\frac{1}{2}$
feet in the ground and surrounded by a mound of stones.
Brass cap on pipe stamped U.S. Mineral Survey No. 3367, 3-
C.Z.5.
Thence S $73^{\circ} 57' W$
- 60.00 Crosses channel Rustler gulch, running W.-S.W.
- 174.00 Crosses channel Rustler Gulch, running W.
- 300.00 North end center - monument of stones 3 feet high.
- 600.00 Cor.No.4.
Identical with Cor.No.3, Copper Zone No.4 Lode, this
survey, heretofore described. Brass cap marked addit-
ionally for this lode "4-C.Z.5".
Thence S $23^{\circ} 29\frac{1}{4}' E$
- 1317.65 Intersects line 2-3, Carrie Nation Lode, this survey, at
point N $71^{\circ} 17\frac{1}{2}' E$, 671.49 feet from Cor.No.2.
- 1442.63 Intersects line 2-3 Blue Bell Lode, Survey No.2605, at
point S $76^{\circ} 45\frac{1}{2}' W$, 690.71 feet from Cor.No.3.
- 1500.00 Cor.No.1, the point of beginning.
Copper Zone No.6 Lode.
Beginning at Cor.No.1.
Identical with Cor.No.2, Copper Zone No.5 Lode, this
survey, heretofore described. Brass cap stamped
additionally for this lode "1-C.Z.6".
Whence U.S. Mineral Monument No.2718 bears S $66^{\circ} 49\frac{1}{2}' W$,
3754.55 feet.
Thence N $73^{\circ} 57' E$
- 73.52 Intersects line 3-4, Blue Bell Lode, Survey No.2605, at
point S $5^{\circ} 7\frac{1}{2}' W$, 24.75 feet from Cor.No.3.
- 186.64 Intersects line 3-4, Carrie Nation Lode, this survey, at
point S $11^{\circ} 31' E$, 219.92 feet from Cor.No.3.
- 300.00 South end center - monument of stones 3 feet high.
- 600.00 Cor.No.2.
A 1 inch iron pipe, $3\frac{1}{2}$ feet long, with claw base set $1\frac{1}{2}$

feet in the ground and surrounded by mound of stones.
 Brass cap on pipe stamped U.S.Mineral Survey No.3367, 2-C.Z.6.

Thence N 23° 29 $\frac{1}{4}$ 'W

437.84 Intersects line 2-3 Granite Lode, Survey No.2465, at point N 83° 6 $\frac{1}{2}$ 'E, 520.25 feet from Cor.No.3.

1384.00 Crosses center channel Rustler Gulch, running West.

1500.00 Cor.No.3.

A I inch iron pipe, 3 $\frac{1}{2}$ feet long, with claw base, set I $\frac{1}{2}$ feet in the ground and surrounded by a mound of stones.
 Brass cap on pipe stamped U.S.Mineral Survey No.3367, 3-C.Z.6.

Thence S 73° 57'W.

300.00 North end center - monument of stones 3 feet high.

348.00 Crosses center channel Rustler Gulch, running west.

600.00 Cor.No.4.

Identical with Cor.No.3, Copper Zone No.5 Lode, this survey, heretofore described. Brass cap marked additionally for this lode, "4-C.Z.6".

Thence S 23° 29 $\frac{1}{4}$ 'E.

I289.74 Intersects line 2-3 Carrie Nation Lode, this survey, at point S 71° 17 $\frac{1}{2}$ 'W, 231.49 feet from Cor.No.3.

I319.39 Intersects line 3-4 Granite Lode, Survey No.2465, at point S 7° 7'E, 342.05 feet from Cor.No.3.

I472.47 Intersects line 2-3, Blue Bell Lode, Survey No.2605, at point S 76° 45 $\frac{1}{2}$ 'W, 86.13 feet from Cor.No.3.

1500.00 Cor.No.1, the point of beginning.

Copper Zone No.7 Lode.

Beginning at Cor.No.1.

Identical with Cor.No.2, Copper Zone No.6 Lode, this survey, heretofore described. Brass cap marked additionally for this lode "1-C.Z.7".

Whence U.S.Mineral Monument No.2718 bears S 67° 48'W, 4350.69 feet.

Thence N 73° 57'E

229.00 South end center - monument of stones 3 feet high.

U.S. MINERAL SURVEY NO. 3367

416.00 Cor.No.2.

A 1 inch iron pipe, 3 1/2 feet long, with claw base, set 1 1/2 feet in the ground and surrounded by a mound of stones.

Brass cap on pipe stamped U.S. Mineral Survey No. 3367, 52-C.Z.7.

Whence Cor.No.2, Granite Lode, Survey No. 2465, bears N 44° 41' E, 568.52 feet.

Thence N 23° 29 1/4' W

-368.69 Intersects line 2-3 Granite Lode, Survey No. 2465, at point

S 83° 6 1/2' W, 550.70 feet from Cor.No.2.

1486.00 Witness corner to Cor.No.3.

A 1 inch iron pipe, 3 1/2 feet long, with claw base, set 1 1/2 feet in the ground and surrounded by a mound of stones.

Brass cap on pipe stamped U.S. Mineral Survey No. 3367, 3-C.Z.7, W.C.-14. Set in rocky ground south of channel

of Rustler Gulch, safe from washouts.

1500.00 True point for Cor.No.3. Not set as it falls in channel

of Rustler Gulch and would not be permanent. W.C. set S 23° 29 1/4' E, 14.00 feet as above.

Thence S 73° 57' W (from true Cor. point)

187.00 North end center - monument of stones 3 feet high.

416.00 Cor.No.4.

Identical with Cor.No.3, Copper Zone No. 6 Lode, this survey, heretofore described. Brass cap additionally marked for this corner "4-C.Z.7".

Thence S 23° 29 1/4' E

116.00 Crosses center channel Rustler Gulch running west.

1062.16 Intersects line 2-3 Granite Lode, Survey No. 2465, at point

S 83° 6 1/2' W, 981.18 feet from Cor.No.2.

1500.00 Cor.No.1, the point of beginning.

Copper Zone No. 8. lode.

Beginning at Cor.No.1.

Identical with Cor.No.2, Copper Zone No. 7 Lode, this survey, heretofore described, Brass cap additionally

marked for this lode "1-C.Z.8".

Whence U.S. Mineral Monument No. 2718 bears S 68° 20 1/2' W,

4764.31 feet

Thence N 73° 57' E

300.00 South end center - monument of stones 3 feet high.

451.43 Intersects line I-2, Granite Lode, Survey No. 2465, at point S 6° 57' E, 281.48 feet from Cor. No. 2.

600.00 Cor. No. 2.

A 1 inch iron pipe, 3 1/2 feet long with claw base, set 1 1/2 feet in the ground and surrounded by a mound of stones.

Brass cap on pipe stamped U.S. Mineral Survey No. 3367, 2-C.Z.8.

Whence Cor. I, Granite Lode, Sur. 2465, brs. S 16° 22 1/2' W, 370.30 ft.

Thence N 23° 29 1/4' W

900.00 Cor. No. 4, Combination Lode, this survey.

1200.00 West end center Combination Lode, this survey.

1450.00 Crosses channel Rustler Gulch, running W.-S.W.

1500.00 Cor. No. 3 (identical with Cor. No. 3 Combination Lode, this survey).

A 1 inch iron pipe, 3 1/2 feet long, with claw base, set 1 1/2 feet in the ground and surrounded by a mound of stones.

Brass cap on pipe stamped U.S. Mineral Survey No. 3367. 3-C.Z.8.

Thence S 73° 57' W

300.00 North end center - monument of stones 3 feet high.

600.00 True point for Cor. No. 4, ident. with point for Cor. No. 3, Copper Zone No. 7 Lode, this survey, whence W.C. heretofore described

bears S 23° 29 1/4' E, 14.00 ft.

Thence S 23° 29 1/4' E

14.00 W.C. to Cor. No. 4, identical with W.C. to Cor. No. 3, Copper Zone No. 7 Lode, this survey, heretofore described.

Brass cap marked additionally for this lode "4-C.Z.8"

1131.31 Intersects line 2-3, Granite Lode, Survey No. 2465, at point S 83° 6 1/2' W, 550.70 feet from Cor. No. 2.

1500.00 Cor. No. I, the point of beginning.

Combination Lode.

Beginning at Cor. No. I.

A 1 inch iron pipe, 3 1/2 feet long with claw base, set 1 1/2 feet in the ground and surrounded by a mound of stones.

Brass cap on pipe stamped U.S. Mineral Survey No. 3367, 1-Comb.

U.S. MINERAL SURVEY NO. 3367

Whence U.S.L.M.No.2, Mineral Creek Mining District,
Pinal Co.Ariz. bears N 88° 14'E, 4581.25 feet.

Thence N 23° 29 1/4'W

300.00 East end center - monument of stones 3 feet high.

543.00 Crosses channel Rustler Gulch, running S.W.

600.00 Cor.No.2.

A I inch iron pipe, 3 1/2 feet long, with claw base, set 1 1/2 feet in the ground and surrounded by a mound of stones.

Brass cap on pipe stamped U.S.Mineral Survey No.3367. 2-Comb.

Thence S 53° 24'W

522.00 Crosses channel Rustler Gulch running West.

740.00 Crosses channel Rustler Gulch running south.

1500.00 Cor.No.3. Identical with Cor.No.3 Copper Zone No.8 Lode, this survey, heretofore described. Brass cap marked additionally for this lode "3-Comb."

Thence S 23° 29 1/4'E

50.00 Crosses channel Rustler Gulch running W.-S.W.

300.00 West end center - monument of stones 3 feet high.

600.00 Cor.No.4.

A I inch iron pipe, 3 1/2 feet long, with claw base, set 1 1/2 feet in the ground and surrounded by a mound of stones.

Brass cap on pipe stamped U.S.Mineral Survey No.3367, 4-Comb.

Thence N 53° 24'E

1500.00 Cor.No.I, the point of beginning.

Carnation Lode.

Beginning at Cor.No.I

A I inch iron pipe, 3 1/2 feet long with claw base, set 1 1/2 feet in the ground and surrounded by a mound of stones.

Brass cap on pipe stamped U.S.Mineral Survey No.3367, 1-Carn.

Whence U.S.L.M.No.2, Mineral Creek Mining District, bears S 75° 47'E, 3592.98 feet.

Thence N 23° 29 1/4'W

300.00 East end center - monument of stones 3 feet high.

458.00 Crosses channel Rustler Gulch, running S.W.

600.00 Cor.No.2.

A 1 inch iron pipe, 3 1/2 feet long with claw base, set 1 1/2 feet in the ground and surrounded by a mound of stones. Brass cap on pipe stamped U.S.Mineral Survey No.3367, 2-Carn.

Thence S 46° 57' W

1500.00 Cor.No.3. identical with Cor.No.2, Combination Lode, this survey, heretofore described. Brass cap marked additionally for this lode "3-Carn".

Thence S 23° 29 1/4' E

57.00 Crosses channel Rustler Gulch running S.W.

300.00 West end center - monument of stones 3 feet high.

600.00 Cor.No.4, identical with Cor.No.1, Combination Lode, this survey, heretofore described. Brass cap marked additionally for this lode "4-Carn".

Thence N 46° 57' E

1500.00 Cor.No.1, the point of beginning.

* * * * *

Magnetic Variation at all corners - 14 degrees East.

No suitable bearing objects available from corners except as specifically noted.

All corners of this survey are identical with the respective corners of location.

* * * * *

LODE LINES.

As near as can be determined from the present state of development, the veins of the several locations embraced in this survey, extend as follows from their respective discovery points:-

JUAREZ. N 11° 3' W - 400.feet, and S 11° 3' E - 1100. feet.

ADVENTURE. N 17° 43' W - 210.feet, and S 17° 43' E - 1290.feet.

COLORADO. N 17° 43' W - 30.feet, and S 17° 43' E - 1470. feet.

WEDGE. S 10° 45' E, 1499.27 feet.

CARRIE NATION. N 71° 17 1/2' E - 300. feet, and S 71° 17 1/2' W - 1200.feet.

COPPER ZONE NO.4. N 23° 29 1/4' W - 3.feet, and S 23° 29 1/4' E - 1497.feet.

U.S. MINERAL SURVEY NO. 3367

COPPER ZONE NO. 5. N 23° 29½' W - 65. feet and S 23° 29½' E - 1435. ft.
 COPPER ZONE NO. 6. N 23° 29½' W - 474. feet and S 23° 29½' E - 1026. feet.
 COPPER ZONE NO. 7. N 23° 29½' W - 100. feet and S 23° 29½' E - 1400. feet.
 COPPER ZONE NO. 8. N 23° 29½' W - 810. feet and S 23° 29½' E - 690. feet.
 COMBINATION. S 53° 24' W, 1500. feet.
 CARNATION. N 46° 57' E - 1400. feet and S 46° 57' W - 100. feet.

LOCATION. This survey is located in Sections 1, 2, 11, and 12, T. 3 S, R. 13 E, G. & S. R. B. & M., (surveyed but not yet approved), in the Mineral Creek Mining District, Pinal County, Arizona.

AREAS. (acres).

Total area Juarez Lode 20.595 A. ✓

Area in conflict with:-

Sweepstake lode, Sur. No. 2572 3.386 ✓

Satellite No. 2 lode, unsurveyed. 2.922 ✓

Satellite No. 2 lode, unsvd. excl. its conflict with Sweepstake lode, Sur. No. 2572. 3.368 ✓

Satellite No. 2 lode, unsvd., excl. its conflict with Adventure lode, this survey. 2.285 ✓

Satellite No. 2 lode, unsvd., excl. its conflict with Sweepstake lode, Sur. No. 2572, and Adventure lode, this survey. .044 ✓

Adventure lode, this survey. 2.954 ✓

Adventure lode, this survey, excl. its conflict with Sweepstake lode, Sur. No. 2572. 2.641 ✓

~~Adventure lode, this survey, excl. its conflict with Satellite No. 2 lode, unsvd. 2.317 ✓~~

~~Adventure lode, this survey, excl. its conflict with Sweepstake lode, Sur. No. 2572, and Satellite No. 2 Lode, unsvd. 2.317 ✓~~

Wedge lode, this survey 0.049 ✓

Total area Adventure lode 20.658 ✓

Area in conflict with:-

Sweepstake lode, Sur. No. 2572 0.725 ✓

Satellite No. 2 lode, unsvd. 4.262 ✓

Satellite No. 2 lode, unsvd., excl. its conflict with Sweepstake lode, Sur. No. 2572. 3.537 ✓

SS
21

Total area Colorado lode 4.269 ✓

Area in conflict with:-

Satellite No.2 lode, unsvd. .879 ✓

Thomas lode, Sur.No.I581. .015 ✓

Total area Wedge lode 13.635 ✓

Area in conflict with:-

Marion lode, Sur.No.3055. 5.100 ✓

~~Marion lode, Sur.No.3055, excl.its conflict with Tom Payne lode, unsvd. 4.973 ✓~~

Marion lode, Sur.No.3055, excl.its conflict with Chicago lode, Sur.No.2605. 1.036 ✓

~~Marion lode, Sur.No.3055, excl.its conflict with Tom Payne lode, unsvd., and Chicago lode, Sur.No.2605. .909 ✓~~

Chicago lode, Sur.No.2605. 7.409 ✓

~~Chicago lode, Sur.No.2605, excl.its confl. with Tom Payne lode, unsvd. 7.281 ✓~~

Chicago lode, Sur.No.2605, excl.its confl. with Marion lode, Sur.No.3055. 3.345

~~Chicago lode, Sur.No.2605, excl.its confl. with Tom Payne lode, unsvd., and Marion lode, Sur.No.3055. 3.217 ✓~~

Tom Payne lode, unsvd. .796 ✓

Tom Payne lode, unsvd. excl.its conflict with Marion lode, Sur.No.3055. .669 ✓

Tom Payne lode, unsvd. excl.its conflict with Chicago lode, Sur.No.2605. .668 ✓

~~Tom Payne lode, unsvd. excl.its conflict with Marion lode, Sur.No.3055, and Chicago lode, Sur.No.2605. .541 ✓~~

Blue Bell lode, Sur.No.2605. .391 ✓

Total area Carrie Nation lode. 20.499 ✓

Area in conflict with:-

Granite lode, Survey 2465. 1.656 ✓

Chicago lode, Survey No.2605. .002 ✓

New York lode, Survey No.2605. .003 ✓

Copper Zone No.I lode, Survey No.3086. .325 ✓

Wedge lode, this survey. .959 ✓

Wedge lode, this survey, exclusive its conflict with Chicago lode, Sur.No.2605. .958 ✓

Blue Bell lode Sur.No.2605 14.463 ✓

Blue Bell lode, Sur.No.2605, excl.its conflict with Granite lode, Sur.No.2465 14.163 ✓

U.S. MINERAL SURVEY NO. 3367

Blue Bell lode, Sur.No.2605, excl.its conflict with Chicago lode, Sur.No.2605.	14.463 ✓
Blue Bell Lode, Sur.No.2605, excl. its conflict with New York Lode, Sur.No.2605.	14.462 ✓
Blue Bell lode, Sur.No.2605, excl.its conflict with Copper Zone No.I lode, Sur. No.3086.	14.255 ✓
Blue Bell lode, Sur.No.2605, excl.its conflict with Wedge lode, this survey.	14.072 ✓
Blue Bell lode, Sur.No.2605, excl. its conflicts with Granite lode, Sur.No.2465, Chicago lode - Sur.No.2605, New York lode, -Sur.No.2605, Copper Zone No.I lode, -Sur. No.3086, and Wedge lode - this survey.	13.563 ✓
Total area <u>Copper Zone No.4 lode.</u>	20.487 ✓
Area in conflict with:-	
Carrie Nation lode, this survey.	2.300 ✓
Blue Bell lode, Sur.No.2605	.987 ✓
Carrie Nation lode, this survey, excl. its conflict with Blue Bell lode, Sur.No.2605	1.313 ✓
Total Area <u>Copper Zone No.5 lode.</u>	20.487 ✓
Area in conflict with:-	
Blue Bell lode, Sur.No.2605	.580 ✓
Carrie Nation lode, this survey.	2.681 ✓
Carrie Nation lode, this survey, excl.its conflict with Blue Bell lode, Sur.No.2605.	2.101 ✓
Carrie Nation lode, this survey, excl.its conflict with Granite lode, Sur.No.2465	2.575 ✓
Carrie Nation lode, this survey, excl.its conflict with Blue Bell lode, Sur.No.2605, and Granite lode, Sur.No.2465.	2.026 ✓
Granite lode, Sur.No.2465	.106 ✓
Blue Bell lode, Sur.No.2605, excl.its conflict with Granite lode, Sur.No.2465.	.549 ✓
Total Area <u>Copper Zone No.6 Lode.</u>	20.487 ✓
Area in conflict with; Granite lode, Sur.No.2465	6.266 ✓
" " - " Carrie Nation lode, this sur..	1.026 ✓
" " " " Carrie Nation lode, this sur. excl.its conflict with Granite lode, Sur. No.2465.	.003 ✓
Area in conflict with Blue Bell lode, Sur.No.2605 (this conflict is entirely covered by conflict with Granite lode, Sur.No.2465).	.046 ✓
Total area <u>Copper Zone No.7 lode.</u>	14.204 ✓
Area in conflict with Granite lode, Sur.No.2465.	3.819 ✓

Total area Copper Zone No.8 lode. 20.487 ✓
 Area in conflict with Granite lode, Sur.No.2465. 3.674 ✓
 Total Area Combination lode 20.123 ✓
 " " Carnation lode 19.469 ✓

IMPROVEMENTS:- I certify that the value of the labor and improvements made upon, or for the benefit of each of the locations embraced in this survey, by the claimant or its grantors, is not less than Five Hundred Dollars, and that such improvements consist of:

Juarez Lode. No.1. the discovery cut, the center of which bears S $11^{\circ} 3' E$, 400. feet from the N.end center. Cut is 4x12 feet. to 10 ft.face, running N. Value \$50.00
No.2. shaft 5x7 ft.-7 ft.deep, the center of which bears N $38^{\circ} 56' W$, 410.82 feet from Cor.No.3. Value \$50.00
No.3. Churn drill hole, 531.feet deep, $12\frac{1}{2}$ inch diam. at collar, 6 inch diam at bottom, partly cased. Center bears S $9^{\circ} 5\frac{1}{2}' W$, 841.17 feet from Cor.No.2. It having been demonstrated by extensive developement, that the ore bodies underlying this district (the Ray copper belt), exist as vast bedded or blanket formations, rather than as veins or fissures, a churn drill exploration hole at any point in a group of locations tends to develop the entire group, and therefore constitutes a common improvement benefitting equally each and every location in the claim or group. The value of this improvement is therefore properly divided among the twelve locations in this claim, and an equal $1/12$ th. interest accredited to each location. Total value this improvement \$5310.00
 $1/12$ th.interest accredited to this location - " \$442.50
No.4. Churn drill hole, 571. feet deep, $12\frac{1}{2}$ inch diam. at collar, 6 inch diam. at bottom. Partly cased. The center bears S $27^{\circ} 53' W$, 485.10 feet from Cor.No.2. This working constitutes a common improvement for the 12 locations embraced in this claim (similarly to No.3, this lode) and a $1/12$ th. interest therein is properly accredited to each location in this claim.

U.S. MINERAL SURVEY NO. 3367.

Total value of this improvement	\$5710.00
I/12th. interest accredited to this lode	- \$475.83
No. 5. I/12th. interest in improvement No. 2, Copper Zone No. 6 lode, this survey, hereinafter described	
Value	\$312.50
No. 6. I/12th. interest in Improvement No. 2, Copper Zone No. 4 lode, this survey, hereinafter described	
Value	\$700.00
Adventure lode.	
No. 1. Discovery cut, 4x14 ft. to 10 ft. face, running South. Center bears S 17° 43' E, 210. feet from the north end center.	Value \$50.00
No. 2. I/12th. interest in improvement No. 3, Juarez lode, this survey, heretofore described.	\$442.50
No. 3. I/12th. interest in improvement No. 4, Juarez lode, this survey, heretofore described.	\$475.83
No. 4. I/12th. interest in improvement No. 2, Copper Zone No. 6 lode, this survey, hereinafter described	\$312.50
No. 5. I/12th. interest in improvement No. 2, Copper Zone No. 4 lode, this survey, hereinafter described.	\$700.00
Colorado lode.	
No. 1. Discovery cut, 4x12 ft. to 10 ft. face, running south, the center of which bears S 17° 43' E, 30. feet from the north end center.	Value \$50.00
No. 2. I/12th. interest in improvement No. 3, Juarez lode, this survey, heretofore described	\$442.50
No. 3. I/12th. interest in improvement No. 4, Juarez lode, this survey, heretofore described.	\$475.83
No. 4. I/12th. interest in Improvement No. 2, Copper Zone No. 6 lode, this survey, hereinafter described.	\$312.50
No. 5. I/12th. interest in improvement No. 2, Copper Zone No. 4 lode, this survey, hereinafter described.	\$700.00
Wedge Lode.	
No. 1. Discovery cut, 4x14 ft. to 10 ft. face, running South, the center of mouth being at the north end center.	Value \$50.00
No. 2. I/12th. interest in improvement No. 3, Juarez lode,	

this survey, heretofore described. \$442.50

~~No. 3.~~ I/12th. interest in improvement No. 4, Juarez lode, this survey, heretofore described. \$475.83

~~No. 4.~~ I/12th. interest in improvement No. 2, Copper Zone No. 6 lode, this survey, hereinafter described. \$312.50

~~No. 5.~~ I/12th. interest in improvement No. 2, Copper Zone No. 4 lode, this survey, hereinafter described. \$700.00

Carrie Nation lode.

No. 1. Discovery shaft, 5x6 - 10 ft. deep, the center of which bears S 71° 17½' W, 300. feet from the east end center.

Value \$60.00

~~No. 2.~~ I/12th. interest in improvement No. 3, Juarez lode, this survey, heretofore described. \$442.50

~~No. 3.~~ I/12th. interest in improvement No. 4, Juarez lode, this survey, heretofore described. \$475.83

~~No. 4.~~ I/12th. interest in improvement No. 2, Copper Zone No. 6 lode, this survey, hereinafter described. \$312.50

~~No. 5.~~ I/12th. interest in improvement No. 2, Copper Zone No. 4 lode, this survey, hereinafter described. \$700.00

Copper Zone No. 4. lode.

No. 1. Discovery shaft - 4x6 - 10 feet deep, the center of which lies S 23° 29½' E, 3. feet from the north end center.

Value \$50.00

No. 2. Churn drill hole, 840. feet deep, 13 inch diam. at collar 8 inch diam. at bottom. cased complete. Center bears

S 32° 53' E, 849.57 feet from Cor. No. 4. This working

constitutes a common improvement for the 12 locations

embraced in this claim (similar to Improvement No. 3,

Juarez lode, this survey, heretofore described); and a

I/12th. interest therein is properly accredited to each

location in this claim.

Total value of this improvement \$8400.00

I/12th. interest accredited to this lode. \$700.00

~~No. 3.~~ I/12th. interest in improvement No. 3, Juarez lode, this survey, heretofore described. \$442.50

~~No. 4.~~ I/12th. interest in improvement No. 4, Juarez lode, this

U.S. MINERAL SURVEY NO. 3367.

survey, heretofore described. \$475.83

~~No. 5.~~ I/12th. interest in improvement No. 2, Copper Zone No. 6 lode, this survey, hereinafter described. \$312.50

Copper Zone No. 5 lode.

No. 1. Discovery shaft - 4x6 - 10. ft. deep, the center of which bears S 23° 29 $\frac{1}{4}$ ' E, 65. feet from the north end center. Value \$50.00

No. 2. Cut, 4x13 to 7. ft. face, in south, the center of which bears S 21° 58' W, 85.50 ft. from Cor. No. 3. Value \$50.00

~~No. 3.~~ I/12th. interest in improvement No. 3, Juarez lode, this survey, heretofore described. \$442.50

~~No. 4.~~ I/12th. interest in improvement No. 4, Juarez lode, this survey, heretofore described. \$475.83

~~No. 5.~~ I/12th. interest in improvement No. 2, Copper Zone No. 4 lode, this survey, heretofore described. \$700.00

~~No. 6.~~ I/12th. interest in improvement No. 2, Copper Zone No. 6 lode, this survey, hereinafter described. \$312.50

Copper Zone No. 6 lode.

No. 1. Discovery shaft, 14x6 - 10. feet deep, the center of which bears S 23° 29 $\frac{1}{4}$ ' E, 474. feet from the north end center. Value \$50.00

No. 2 Churn drill hole, 375. feet deep, 13 inch diam. at collar, 8 inch diam. at bottom, partly cased, the center of which bears S 12° 8' E, 625.08 feet from Cor. No. 3. This working constitutes a common improvement for the 12 locations embraced in this claim (similar to improvement No. 3, Juarez lode, this survey, heretofore described), and a I/12th. interest therein is properly accredited to each location in this claim.

Total value of this improvement \$3750.00

I/12th. interest accredited to this location \$312.50

~~No. 3.~~ I/12th. interest in improvement No. 3, Juarez lode, this survey, heretofore described. \$442.50

~~No. 4.~~ I/12th. interest in improvement No. 4, Juarez lode, this survey, heretofore described. \$475.83

85
27

~~No. 5.~~ I/12th. interest in improvement No. 2, Copper Zone No. 4
lode, this survey, heretofore described. . . . \$700.00
Copper Zone No. 7.

No. 1. Discovery cut, 4x14 - 10 ft. face, the center of which
bears S 23° 29' 1/2" E, 100.0 feet from the north end center.
Value . . . \$50.00

No. 2. Vertical shaft, 5 1/2 x 7 1/2 - 75 feet deep (timbered), the
center of which bears N 0° 45' E, 501.0 feet from Cor. No. 1.
Value . . . \$1000.00

~~No. 3.~~ I/12th. interest in improvement No. 3, Juarez lode, this
survey, heretofore described. . . . \$442.50

~~No. 4.~~ I/12th. interest in improvement No. 4, Juarez lode, this
survey, heretofore described. . . . \$475.83

~~No. 5.~~ I/12th. interest in improvement No. 2, Copper Zone No. 4
lode, this survey, heretofore described. . . . \$700.00

~~No. 6.~~ I/12th. interest in improvement No. 2, Copper Zone No. 6
lode, this survey, heretofore described. . . . \$312.50

Copper Zone No. 8.

No. 1. Discovery cut, 5x12 - 11 ft. face, the center of which
bears S 23° 29' 1/2" E, 810.0 feet from the north end center.
Value . . . \$60.00

No. 2. Cut, 6x20 - 14 ft. face, the center of which bears
N 1° 40' W, 720.0 feet from Cor. No. 1.
Value . . . \$100.00

No. 3. Cut, 6x15 - 12 ft. face, the center of which bears
N 1° 40' W, 624.0 feet from Cor. No. 1.
Value . . . \$75.00

~~No. 4.~~ I/12th. interest in improvement No. 3, Juarez lode, this
survey, heretofore described. . . . \$442.50

~~No. 5.~~ I/12th. interest in improvement No. 4, Juarez lode, this
survey, heretofore described. . . . \$475.83

~~No. 6.~~ I/12th. interest in improvement No. 2, Copper Zone No. 4
Lode, this survey, heretofore described. . . . \$700.00

~~No. 7.~~ I/12th. interest in improvement No. 2, Copper Zone No. 6
lode, this survey, heretofore described. . . . \$312.50

U.S. MINERAL SURVEY NO. 3367

Combination.

No. 1. Discovery cut, $5\frac{1}{2} \times 11$ - 10 foot face, in S.W., the center of mouth of which being at the east end center.

Value \$50.00

No. 2. Cut, 4×13 - 12 foot face, in S.W., the center of mouth being at point 339, line I-2 (S $23^{\circ} 29\frac{1}{4}'$ E, 261 feet from Cor. No. 2). Value \$60.00

No. 3. I/12th interest in improvement No. 3, Juarez lode, this survey, heretofore described. \$442.50

No. 4. I/12th interest in improvement No. 4, Juarez lode, this survey, heretofore described. \$475.83

No. 5. I/12th interest in improvement No. 2, Copper Zone No. 4 lode, this survey, heretofore described. \$700.00

No. 6. I/12th interest in improvement No. 2, Copper Zone No. 6 lode, this survey, heretofore described. \$312.50

Carnation lode.

No. 1. Discovery point, on outcrop of ledge, N $46^{\circ} 57'$ E, 100. ft. from the west end center.

No. 2. Discovery cut, 4×12 - 10 ft. face, in N.E. the center of mouth bearing N $23^{\circ} 30'$ W, 28. feet from the discovery point. A large body of mineral bearing quartz being exposed on the surface in this section, and being developed by an old tunnel hereinafter described under "other improvements", in order to avoid conflict with said tunnel and to take advantage of topographical conditions, the discovery cut was made as shown above, at a short distance from the discovery point.

Value \$50.00

No. 3. I/12th interest in improvement No. 3, Juarez lode, this survey, heretofore described. \$442.50

No. 4. I/12th interest in improvement No. 4, Juarez lode, this survey, heretofore described. \$475.83

No. 5. I/12th interest in improvement No. 2, Copper Zone No. 4 lode, heretofore described. \$700.00

No. 6. I/12th interest in improvement No. 2, Copper Zone No. 6 lode, this survey, heretofore described. \$312.50

OTHER IMPROVEMENTS.

Adventure lode. House, 20x16 feet, frame and sheet iron, the N.E. corner of which bears S 9° 10'E, 306.50 feet from Cor.No.2.

Colorado lode. Tunnel, 4x6 - 30 feet long, in south (caved), the center of mouth of which bears S 25° 35'W, 83.53 feet from Cor.No.2. Driven prior to location.

Copper Zone No.5 lode. Tunnel, 4x6½ - 35 feet long, in south, the center of mouth of which bears S 15° 1'E, 91.70 feet from Cor.No.3. Driven prior to location.

Carnation lode. Tunnel 4½x6 - 91 feet long, the center of mouth of which bears N 50° 30'E, 95. feet from the west end center. Driven prior to location.

INSTRUMENT. This survey was made with Buff & Buff Special Transit No.7905. The courses were deflected from the true meridian as determined by direct solar observations. Distances were measured by 350 and 100 foot steel tapes.

ADJACENT OR CONFLICTING CLAIMS.

On the east, this claim conflicts or adjoins the Granite lode, Sur.No.2465; Tom Payne lode, Unsurveyed, Haley & Sufferin, Claimants; Black Warrior lode, Sur.No.2465.

On the south, the Sweepstake lode, Sur.No.2572; Satellite No.2 lode, Unsurveyed, Ray Hercules Copper Co. Claimant.

On the West:- Thomas lode, Sur.No.1581; Contention lode, Sur.No.1581; Truman lode, Sur.No.1581; Marion lode, Sur.No.3055; Chicago lode, Sur.No.2605; New York lode, Sur.No.2605; Boston lode, Sur.No.2605; Blue Bell lode, Sur.No.2605 (surveyed but not patented); Copper Zone No.1 lode, Sur.No.3086; Copper Zone No.2 lode, Sur.No.3087; Copper Zone No.3 lode, Sur.No.3088.

REPORT:- U.S.Mineral Monument No.2718, Arizona Land District, is a porphyry stone, 20x9 inches, 18 inches above ground, marked with cross on top and "U.S.M.M.No.2718" on side. A large mound of stones stands alongside. This monument stands on a small rise of ground near and to the south of the buildings of the Ray lumber Co.

U.S. MINERAL SURVEY NO. 3367.

U.S.L.M.No.2, Mineral Creek Mining District, Pinal Co.

Arizona. A black rock, 9x18 inches, 15½ inches above ground, marked with cross on top and "U.S.L.M.No.2" on south face. 5 feet east from rock is a mound of stones 7 feet high and 6 feet base. This monument is located on a black knob at the north end of a steep slope running down from the top of Scott Mt. The original description is in error and causes difficulty in locating this monument, as it gives "Highest point on Scott Mt. bears S 40 degrees E, 500 ft", whereas the highest point of Scott Mt. bears aprox. S 15 degrees East, over 1500 feet. The E.¼ Cor. Sec.II, T 3 S, R 13 E, G.& S.R.B.& M. is a standard G.L.O. corner - pipe with brass cap marked as above.

Granite lode, Sur.No.2465 .

Cor.No.I:- a Quartzite rock with pointed top, 10x12 inches, 12 inches above ground, marked with cross and " G 1 2465" on N.W.face. Stone monument with 4x4 post 3 feet N.E.

Cor.No.2. Granite rock, 6x6 inches -, 11 inches above ground, marked with cross on top and "G 2 2465"- on S.W.face.

Monument of stones with 4x4 post 3 feet north.

Cor.No.3. A stone 6x9 - 14 inches above ground, marked with cross on top and "G 3 2465" on S.E.face. Monument of stones 3 feet west.

Cor.No.4. A granite stone 18x9 - 18 inches above ground, marked with cross on top and "G 4 2465" on N.E.face.

Monument of stones 3 feet S.W.

Tom Payne lode, Unsurveyed, Haley & Sufferin, Claimants.

N.W.Cor:- a 4x4 post, white with blue top, marked N.W.C. T.P. on S.E.face.

S.W.Cor. a 4x4 post, white with blue top, marked S.W.C. T.P. on N.E.face.

S.E.Cor. a 4x4 post, white with blue top, marked S.E.C. T.P. on N.W.face. Post leans over Cor.No.3

Black Warrior lode, Sur.No.2465, and Cor.point identical with same.

Black Warrior, Sur.No.2465.

Cor.No.3.(identical with Cor.No.4 Calumet lode, Sur.No. 2465). A granite rock, 8x12 inches, 12 inches above ground, marked with cross on top, "B.W.3" on S.E.face, "C 4" on N.E.face. . . Mark on cliff 4 feet to S.- "B.R. X B.W.3 C.4".

Cor.No.4.(identical with Cor.No.3 Sweepstake lode, Sur.No. 2572). A stone 6x12 - 12 inches above ground, marked with cross on top, and "B.W.4 2465" on N.E.face; "3-2572A" on S.E.face. . . Mound of stones with post 3 ft.dist.

Sweepstake lode, Sur.No.2465.

Cor.No.1.A. 4x4 post, white with red top and nail to mark true point. . . Scribed "S.C.S. 1-2572A" on N.face. . . Post solid and in good monument of stones, hence taken as correct as found.

Cor.No.2. 4x4 post 4 feet high, scribed "W.C.S. 2-2572A". Nail in top. . . This post is loose in the ground and leaning, hence corner point taken from tie given to B.R. (S 77° 55'E, - 12.3 feet). . . B.R. is granite rock marked "B.R. 2-2572A" with cross on top.

Cor.No.3. (see Cor.No.4 Black Warrior lode, Sur.No.2465).

Satellite No.2 lode, Unsurveyed, Ray Hercules Copper Co.,

Claimant:-

S.W.Cor.(identical with Cor.No.4 Thomas lode, Sur.No. I581). A stone 10x12 - 12 inches above ground, marked with cross on top, and "S No.2.I" on N.E.face, and "T 4 I581" on West face. . . Monument of stones 3 feet west.

N.W.Cor.(identical with Cor.No.3 Thomas lode, and Cor.No.

4 Contention lode, both Sur.No.I581). - A stone 12x14 - 6 inches above ground, marked with cross on top, and "S No.2- 2" on S.E.face, "I581 T 3" on S.W.face, "I581 C 4" on N.W.face.

N.E.Cor. A stone, marked with cross on top and "S No.2 3" on S.W.face, with monument of stones adjoining.

Thomas lode, Sur.No.I581.

Cor.No.3 (see N.W.Cor.Satellite No.2 Lode, Unsvd.)

Cor.No.4 (see S.W.Cor.Satellite No.2 lode, Unsvd.)

U.S. MINERAL SURVEY NO. 3367.

Contention lode, Sur.No. I58I.

Cor.No.3. (identical with Cor.No.4, Truman lode, Sur.No I58I). This corner having been destroyed, I re-established same at a point on a line between and equidistant from Cor.No.3, Truman lode, Sur.No. I58I, and Cor.No.4, Contention lode, Sur.No. I58I, the original corner being shown by field notes of Sur.No. I58I to have been at this point. I set a 4x4 post with sharp top, $5\frac{1}{2}$ feet long, $1\frac{1}{2}$ feet in the ground, surrounded by a monument of stones. Post scribed " I58I - 4 Tr." on N.W.face, and " I58I - 3 Cont." on S.W.face.

Cor.No.4. (see N.W.Cor.Satellite No.2 lode, unsvd.).

Truman lode, Sur.No. I58I.

Cor.No.3. A 4x4" post, solid in ground and surrounded by monument of stones, scribed "I58I" on east face, and "3 TR" on west face.

Cor.No.4. (see Cor.No.3 Contention lode, Sur.No. I58I).

Marion lode, Survey No. 3055.

Cor.No.1. A lime rock, 8x13 - 12 inches above ground, marked with cross on top, and "M-1 3055" on N.E.face.

Monument of stones 3 feet S.W.

Cor.No.2. A granite rock, 8x9 - 9 inches above ground, marked with cross on top, and "M-2 3055" on east face.

Monument of stones 3 feet S.W.

Cor.No.3. A black rock, 6x20 - 12 inches above ground, marked with cross on top and "M-3 3055" on S.face.

Monument of stones 3 feet south.

Cor.No.4. An andesite rock, 10x12 - 12 inches above ground, marked with cross on top and "M-4 3055" on west face.

Monument of stones 3 feet north.

Chicago lode, Sur.No. 2605.

Cor.No.1. (identical with Cor.No.4 New York lode, Sur.No. 2605). A 4x4 post in mound of stones, scribed "I-2605 C" on the N.E.face. Nail in top for corner point. Solid.

Cor.No.2. (identical with Cor.No.3, New York lode, Sur.No. 2605). A 4x4 post in monument of stones, scribed "2-2605 C" on the S.E.face. Nail in top for corner point.

Post loose in ground - plumbed to vertical position

when position noted.

Cor.No.3. A 4x4 post in mound of stones, scribed "3-2605 C"

on S.W. face. Nail in top for corner point. Post

found loose in ground - plumbed to vertical position

when position noted.

Cor.No.4. A 4x4 post in mound of stones, scribed "4-2605 C"

on west face. Nail in top for corner point. Post

found loose in ground - plumbed to vertical position

when noted.

New York lode, Survey No.2605.

Cor.No.2. (identical with Cor.No.4 Boston lode, Sur.No.

2605). A 4x4 post, solid, in mound of stones, with nail

in top for corner point, scribed "2-2605 N.Y." on S.E.

face, and "4-2605 B" on the S.W. face.

Cor.No.3, identical with Cor.No.2 Chicago lode, Survey No.

2605. Post scribed "3-2605 N.Y." on S.W. face.

Cor.No.4. identical with Cor.No.1 Chicago lode, Survey No.

2605. Post scribed "4-2605 N.Y." on N.W. face.

Boston lode, Survey No.2605.

Cor.No.3, (identical with Cor.No.1 Blue Bell lode, Survey

No.2605). A 4x4 post, badly decomposed, found loose

in ground but plumbed to vertical when position noted.

Post scribed "3-2605 B" on S.E. face, and "1-2605 B.B." on

N.E. face.

Cor.No.4. (see Cor.No.2 New York lode, Sur.No.2605)

Blue Bell lode, Sur.No.2605.

Cor.No.1, (see Cor.No.3 Boston lode, Sur.No.2605).

Cor.No.2, 4x4 post in small mound of stones, with nail in

top of post for corner point. Post scribed "2-2605 BB"

on S.E. face. Post found loose and leaning - plumbed

to vertical when position noted.

Cor.No.3. 4x4 post in mound of stones, nail in top for

point, scribed "3-2605 B.B." on S.W. face. Post found

loose and leaning - plumbed to vertical when position

noted.

Cor.No.4. 4x4 post in mound of stones, with nail in top

U.S. MINERAL SURVEY NO. 3367.

for corner point, scribed "4-2605 B.B." on west face.
Post found solid and in good condition.

Copper Zone No. I. lode, Survey No. 3086.

Cor. No. I, A stone 12 inches above ground, on the east bank of Mineral Creek, marked "I-C.Z. I, 3086" on the N.E. face. Cross on top.

Cor. No. 3. (identical with Cor. No. 4, Copper Zone No. 2 lode, Sur. No. 3087). A granite rock 9x12 - 9 inches above ground, with cross on top, and marked "3-C.Z. I 3086"

on south face, and "4-C.Z. 2. 3087" on north face. Mnt.

of stones 3 feet N.E.

Cor. No. 4. A granite stone, 8x18 - 12 inches above ground, marked with cross on top and "4-C.Z. I 3086" on N.W. face.

Copper Zone No. 2. lode, Sur. No. 3087.

Cor. No. 3, (identical with Cor. No. 4, Copper Zone No. 3 lode, Sur. No. 3088). A sharp topped stone, 12x12 inches at ground, 18 inches above ground, marked with cross on top and "3-C.Z. 2 3087" on south face, "4-C.Z. 3 3088" on north face. Monument of stones 2 feet south.

Cor. No. 4. see Cor. No. 3 Copper Zone No. I lode, Sur. No. 3086.

Copper Zone No. 3 lode, Survey No. 3088.

Cor. No. 3. A sharp topped stone, 6x15 inches at ground, 12 inches above ground, marked with cross on top and "3-C.Z. 3 3088" on south face. Mnt. stones 3 feet north.

Cor. No. 4. See Cor. No. 3 Copper Zone No. 2 lode, Sur. No. 3087.

Note. I find the boundaries of certain locations embraced in this survey, as marked upon the ground, to differ from descriptions contained in their respective location notices, as follows:-

Copper Zone No. 4 lode.. As marked on ground, lode line extends N.W. 3. feet, and S.E. 1497. feet from center of discovery, instead of N.W. 50. feet and S.E. 1450. feet as called in notice.

Copper Zone No. 5. lode.. As marked on ground, lode line extends N.W. 65. feet, and S.E. 1435. feet from center of

discovery, instead of N.W. 100.feet and S.E. 1400. feet
as called in notice.

Copper Zone No.6 lode. As marked on ground, lode line
extends N.W. 474.feet, and S.E.1026.feet from center of
discovery, instead of N.W. 500. feet, and S.E. 1000.ft.
as called in notice.

Copper Zone No.7 lode. As marked on ground, lode line
extends N.W. 100.feet, and S.E. 1400.feet from center of
discovery, instead of N.W.110.feet, and S.E.1390.feet
as called in notice. Also width of location is 187.
feet easterly and 229.feet westerly from lode line,
instead of 190.feet easterly and 240.feet westerly as
called in notice.

The above discrepancies are all due to errors in the

respective location notices.

I find the following errors in the lines of certain prior
official surveys encountered in this survey:-

Granite lode, Sur.No.2465.	As reported.	As marked on ground.
line 1-2.	N 6° 56'W, 600.feet.	N 6° 57'W, 598.00 ft.
" 2-3.	S 83° 4'W, 1500. ft.	S 83° 6½'W, 1501.42
" 3-4.	S 6° 56'E, 600.feet.	S 7° 7'E, 599.77 ft.
Black Warrior lode, Sur.No.2465.		
line 3-4.	S 11° 17'E, 1060.22 ft.	S 11° 3'E, 1024.88 ft.
Sweepstake lode, Sur.No.2572.		
line 2-3.	N 44° 40.8'E, 733.54 ft.	N 44° 34½'E, 737.96ft.
Thomas lode, Sur.No.1581.		
line 3-4.	S 18° 30'E, 600.00 ft.	S 18° 27'E, 598.67 ft.
Contention lode, Sur.No.1581		
line 3-4.	S 18° 30'E, 600.00 ft.	S 17° 43'E, 592.35 ft.
Truman lode, Sur.No.1581.		
line 3-4.	S 18° 30'E, 600.00 ft.	S 17° 43'E, 592.35 ft.
Chicago lode, Sur.No.2605.		
line 1-2.	N 4° 54'E, 1500.00 ft.	N 4° 42'E, 1494.05 ft.
line 2-3.	N 71° 23'E, 600.00 ft.	N 71° 20'E, 593.72 ft.
line 3-4.	S 4° 54'W, 1500.00 ft.	S 4° 29½'W, 1491.15 ft.
line 4-1.	S 71° 23'W, 600.00 ft.	S 71° 17½'W, 599.95 ft.

U.S. MINERAL SURVEY NO. 3367.

New York lode, Sur.No.2605. As reported. As marked on ground.

line 2-3. N 71° 23'E, ^{602.8}~~600.00~~ ft. N 71° 15½'E, 601.28 ft.

line 3-4. (identical line I-2 Chicago lode, Sur.2605)

Boston lode, Sur.No.2605.

line 3-4. N 71° 23'E, ^{604.3}~~600.00~~ ft. N 71° 16'E, 603.81 ft.

Blue Bell lode, Sur.No.2605.

line I-2. N 4° 54'E, 591.90 ft. N 4° 46'E, 591.83 ft.

line 2-3. N 75° 52'E, 1446.47 ft. N 76° 45½'E, 1445.87 ft.

line 3-4. S 4° 54'W, 441.16 ft. S 5° 7½'W, 442.29 ft.

line 4-I. S 71° 23'W, 1500.00 ft. S 71° 16'W, 1496.43 ft.

Copper Zone No.I lode, Sur.No.3086.

line 4-I. S 69° 8'W, 1436.1 ft. S 69° 7'W, 1428.35 ft.

Note. In Surveys 1581 and 2605 it is possible that a portion of the errors noted is due to the damaged condition of the monuments, it being impossible to determine their exact positions as originally set. In all cases where a post was found leaning considerably from the vertical, I plumbed same to vertical when noting position of same.

Respectfully submitted

Paul E. Fernald

U.S. Mineral Surveyor.

Tucson, Ariz. July 18th. 1917.

U.S. MINERAL SURVEY NO. 3367.

Calculation for meridian - Direct Solar Observation. Sunday, March 18th.

1917, Time 5 12 P.M. Lat. 33° 11 $\frac{3}{4}$ ' N.

Decl. S 1° 3' 52.0"

59.31"
 12.2 \checkmark
 11.86 \checkmark
 118.62
 593.1
 723.58" = 12' 3.6" \checkmark

$\frac{12' 3.6''}{0' 51' 48.4''} = S 0' 52''$

Direct:- R 30° 47 $\frac{1}{2}$ ' A = 16° 31' (-3' refr. cor.) = 16° 28'

Reverse:- R 31° 24 $\frac{1}{2}$ '. A = 15° 41' (-3 $\frac{1}{2}$ ' " ") = 15° 37 $\frac{1}{2}$ '
 * * * * *

Direct.

Cos. Q = - sin. 0° 52' = 8.179713 \checkmark
 cos. 33° 11 $\frac{3}{4}$ ' = 9.922624 \checkmark - tan. 33° 11 $\frac{3}{4}$ ' = 9.815762 \checkmark
 8.257089
 cos. 16° 28' = 9.981812 \checkmark tan. 16° 28' = 9.470676 \checkmark
 8.275277 \checkmark 9.286438 \checkmark

8.275277 = log..01885 \checkmark
 9.286438 = log..19339 \checkmark
 .21224 \checkmark = cos. 77° 44 $\frac{3}{4}$ ' \checkmark
 - 30° 47 $\frac{1}{2}$ ' \checkmark
 S 46° 57 $\frac{1}{4}$ ' W. \checkmark

Reverse

cos. 15° 37 $\frac{1}{2}$ ' = 8.257089 \checkmark tan. 15° 37 $\frac{1}{2}$ ' = 9.815762 \checkmark
 9.983646 \checkmark 9.446654 \checkmark
 8.273443 \checkmark 9.262416 \checkmark

8.273443 = log..01877 \checkmark
 9.262443 = log..18298 \checkmark
 .20175 \checkmark = cos 78° 21 $\frac{1}{2}$ ' \checkmark
 - 31° 24 $\frac{1}{2}$ ' \checkmark
 S 46° 57' W. \checkmark

Average S 46° 57' W.

Not in transcript

JUL 19 1917

FINAL OATHS FOR SURVEYS.

LIST OF NAMES.

A list of the names of the individuals employed by Paul E. Fernald

United States ~~Deputy~~ Mineral Surveyor, to assist in running, measuring, and marking the lines, corners, and boundaries described in the foregoing field notes of the survey of the mining claim of

Arizona Ray Copper Co.

known as the COLORADO, CARNATION, JUAREZ, WEDGE, COMBINATION, ADVENTURE, CARRIE NATION, COPPER ZONE NO.4, COPPER ZONE NO.5, COPPER ZONE NO.6, COPPER ZONE NO.7, COPPER ZONE NO.8 lodes.

and showing the respective capacities in which they acted.

C.P. Goodjohn, Chairman.

B. Gowan, Chairman.

Arman.

Flagman.

FINAL OATHS OF ASSISTANTS.

We, C.P. Goodjohn

and B. Gowan, do solemnly swear that we assisted Paul E. Fernald

, United States ~~Deputy~~ Mineral Surveyor, in marking the corners and surveying

the boundaries of the mining claim of Arizona Ray Copper Co.

known as the COLORADO, CARNATION, JUAREZ, WEDGE, COMBINATION, ADVENTURE, CARRIE NATION, COPPER ZONE NO.4, COPPER ZONE NO.5, COPPER ZONE NO.6, COPPER ZONE NO.7, COPPER ZONE NO.8 lodes.

represented in the foregoing field notes as having been surveyed by said ~~deputy~~ mineral surveyor and under his direction; and that said survey has been in all respects, to the best of our knowledge and belief, faithfully and correctly executed, and the corner and boundary monuments established according to law and the instructions furnished by the United States Surveyor-General for Arizona.

C.P. Goodjohn, Chairman.

B. Gowan, Chairman.

Arman.

Flagman.

Subscribed and sworn to by the above-named persons before me this 22nd

day of March, 1917.

C. A. Herule
Notary Public

~~My commission expires~~

JUL 19 1917

(4-686.)

FINAL OATH OF U. S. ~~DEPUTY~~ MINERAL SURVEYOR

I, Paul E. Fernald, U. S. ~~Deputy~~ Mineral Surveyor, do solemnly swear that, in pursuance of instructions received from the United States Surveyor General for Arizona, dated February 13th, 1917, I have, in strict conformity to the laws of the United States, the official regulations and instructions thereunder, and the instructions of said Surveyor General, faithfully and correctly executed the survey of the Mining Claim of Arizona Ray Copper Co.

COLORADO, CARNATION, JUAREZ, WEDGE, COMBINATION, ADVENTURE, CARRIE NATION, COPPER ZONE NO. 4, COPPER ZONE NO. 5, COPPER ZONE NO. 6, COPPER ZONE NO. 7, COPPER ZONE NO. 8 lodes, known as the Mineral Creek Mining District, Pinal County, Arizona, in Section s 1, 2, 11, 12, Township No. 3 S., Range No. 13 E., ^{Unapproved.} G. & S. R. B. & M., and designated as Survey No. 3367

as represented in the foregoing field notes, which accurately show the boundaries of said mining claim as distinctly marked by monuments on the ground, and described in the attached copy of the location certificate, which was received by me from the Surveyor General with said instructions, and that all the corners of said survey have been established and perpetuated in strict accordance with the law, official regulations and instructions thereunder; and I do further solemnly swear that the foregoing are the true and original field notes of said survey and my report therein, and that the labor expended and improvements made upon said mining claim by claimant or its grantors are as therein fully stated, and that the character, extent, location and itemized value thereof are specified therein with particularity and full detail, and that no portion of said labor or improvements so credited to this claim has been included in the estimate of expenditures upon any other claim.

Paul E. Fernald.
U. S. ~~Deputy~~ Mineral Surveyor.

Subscribed and sworn to by the said Paul E. Fernald,
U. S. ~~Deputy~~ Mineral Surveyor, before me C. A. Henkle,
a Notary Public this 22nd
day of March, AD 1917.

C. A. Henkle
Notary Public

~~My Commission expires~~

My Commission Expires April 17, 1920

FEB 12 1917

STATE OF ARIZONA, }
County of Pinal. } SS.

I, W. L. Brown County Recorder, in
and for the County of PINAL, State of Arizona, do hereby certify that the within and following is a full,
true and correct copy of ... Amended Location Notice of the COLORADO ...
..... Mining Claim as the same appears of record in my office in Book
No. 33 of Mines, Records, at page 136 thereof, or under File No.
.....; that I have compared the same with the original record, and that the same is a true tran-
script, and of the whole thereof.

IN WITNESS WHEREOF, I have hereunto set my hand and affixed the seal of my office, this
..... 10th day of February 19. 17., at Florence, the County Seat.

..... W. L. Brown
County Recorder.
By *M. O. Benscoe*
Deputy Recorder.

AMENDED
Notice of Mining Location
LODE CLAIM

TO ALL WHOM IT MAY CONCERN:

This Mining Claim, the name of which is the Colorado
Mining Claim, situate on lands belonging to the United States of America, and in which there are
valuable mineral deposits, was entered upon and located for the purposes of exploration and purchase
by The Arizona Ray Copper Company, an Arizona Corporation

(Locator must insert either "a citizen of the United States," or "who has declared his intention to become a citizen of the United States.")

the undersigned, on the 8th day of February, 1917, 191

The length of this claim is 1500 feet,
and we claim 30 feet,
in a northerly direction and 1470
feet in a cut southerly direction from

the center of the discovery ~~point~~ at at which this notice is posted, lengthwise of the claim, together with
35 feet westerly and 95 feet easterly
~~xxx~~ in width of the surface grounds, on each side
of the center of said claim. The general course of the lode deposit and premises is from the south
to the north

The claim is situated and located in the Mineral Creek Mining District, in
Pinal County in the State of Arizona, about 1 mile
in a northerly direction from town of Ray, and joins the
patented Chicago claim on the north, the Adventure claim on the east
and the patented Truman, Contention and Thomas claims on the west.

The surface boundaries of the claim are marked upon the ground as follows: Beginning at
monument of stones

at a point in northerly direction 30 feet from
the discovery ~~point~~ cut (at which this notice is posted), being in the center of the north
end line of said claim; thence 95 easterly feet to a monument of
stones, being the northeast corner of said claim; thence
southerly 1500 feet to a monument of stones being at the
southeast corner of said claim; thence westerly 95 feet
to a monument of stones at the center of the south end of said claim;
thence westerly 35 feet to a monument of stones being at the
southwest corner of said claim; thence northerly 1500 feet
to a monument of stones at the northwest corner of said claim;
thence east 35 feet to the place of beginning.

All done under the provisions of the laws of the United States, and of the State of Arizona.

This is an Amended Location Notice of the Colorado
Mining Claim, located by the grantors of the Arizona Ray Copper Company
on the 1st day of
March, 1916, and recorded in Book 30 of Records of Mines, at
page 504, in the office of the County Recorder of the aforesaid County of Pinal
to which reference is hereby made, and this amended Location Notice is made and posted to correct
errors in the description in the said original Location Notice

Dated and posted on the ground this 8th day of February, 1917, 19

H. Young
General Manager

Arizona Ray Copper Company

STATE OF ARIZONA,

County of PINAL ss.

I, W. L. BROWN, County Recorder in and for the County and State aforesaid, do hereby certify that the within instrument was filed for record at 9 o'clock a M., on this FEB 10 1917 day of _____, 19____, and duly recorded in Book No. 136 of MINES Records of PINAL County, Arizona, at pages 136

WITNESS my hand and official seal the day and year first above written.

(Recorder's Seal)

W. L. BROWN
County Recorder.
W. L. BROWN
Deputy

AMENDED
Notice of Location
LODE CLAIM

Dated _____, 19____

Filed and Recorded at request of

Arg. Ray Copper Co

FEB 10 1917 A. D. 19____

at 9 a M.,

Book 33 of MINES

Pages 196

W. L. BROWN

County Recorder.

By W. L. BROWN

Deputy Recorder.

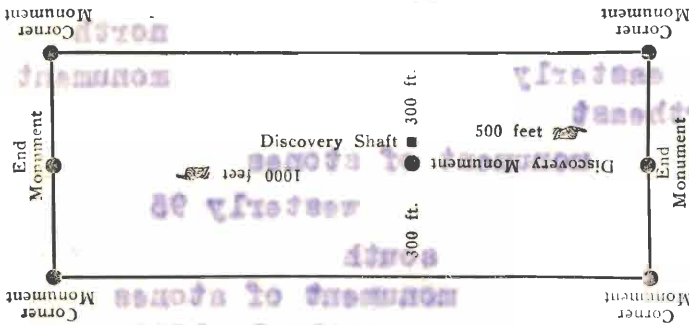

This diagram is to give locator a general idea of plan of location under the new law. The Discovery Shaft can be in the center of claim or any distance from either end desired. In the diagram it is placed 500 feet from one end and 1000 feet from the other. Commence description of claim at a center end monument, giving its distance and direction from center of Discovery Shaft, thence bound the claim in either direction. In description be careful to state locality of claim with reference to some natural object, or permanent monument, as will identify the claim.

INDEXED

Arizona Ray Copper Company
General Manager

February, 1917

8th

Pinal

16

March

The transfer of the Arizona Ray Copper Company

Colorado

MONUMENT OF STONES
east 33

MONUMENT OF STONES

10004

FEB 12 1917

STATE OF ARIZONA, }
County of Pinal. } SS.

I,.....W. L. Brown.....County Recorder, in
and for the County of PINAL, State of Arizona, do hereby certify that the within and following is a full,
true and correct copy of...Amended Notice of Location of the CARNATION.....
.....Mining Claim....., as the same appears of record in my office in Book
No...33..... ofMines.....Records, at page...137..... thereof, or under File No.
.....; that I have compared the same with the original record, and that the same is a true tran-
script, and of the whole thereof.

IN WITNESS WHEREOF, I have hereunto set my hand and affixed the seal of my office, this
.....10th.....day of...February....., 19.17., at Florence, the County Seat.

.....W. L. Brown.....
County Recorder.
By



Deputy Recorder.

AMENDED

Notice of Mining Location

LODE CLAIM

TO ALL WHOM IT MAY CONCERN:

This Mining Claim, the name of which is the Carnation Mining Claim, situate on lands belonging to the United States of America, and in which there are valuable mineral deposits, was entered upon and located for the purposes of exploration and purchase by The Arizona Ray Copper Company, an Arizona corporation

(Locator must insert either "a citizen of the United States," or "who has declared his intention to become a citizen of the United States.")

the undersigned, on the 8th day of February, 1917, 191.....

The length of this claim is 1500 feet, and we claim 1400 feet, in a northeasterly direction and 100 feet in a southwesterly direction from the center of the discovery ~~shaft~~ ^{cut} at which this notice is posted, lengthwise of the claim, together with 300 feet in width of the surface grounds, on each side of the center of said claim. The general course of the lode deposit and premises is from the southwesterly to the northeasterly

The claim is situated and located in the Mineral Creek Mining District, in Pinal County in the State of Arizona, about 2 miles in a northerly direction from the town of Ray and joins the Combination claim on the southwest end and lies along the south side of Rustler gulch.

The surface boundaries of the claim are marked upon the ground as follows: Beginning at a monument of stones

at a point in a northeasterly direction 1400 feet from the discovery ~~shaft~~ ^{cut} (at which this notice is posted), being in the center of the northeasterly end line of said claim; thence southeasterly 300 feet to a monument of stones, being the southeasterly corner of said claim; thence southwesterly 1500 feet to a monument of stones being at the southwest corner of said claim; thence northwesterly 300 feet to a monument of stones at the center of the southwest end of said claim; thence northwesterly 300 feet to a monument of stones being at the northwest corner of said claim; thence northeasterly 1500 feet to a monument of stones at the northeast corner of said claim; thence southeasterly 300 feet to the place of beginning.

All done under the provisions of the laws of the United States, and of the State of Arizona.

This is an Amended Location Notice of the Carnation Mining Claim, located by the grantors of the Arizona Ray Copper Company on the 8th day of Feb. 1917, 19....., and recorded in Book 30 of Records of Mines, at page 499, in the office of the County Recorder of the aforesaid County of Pinal to which reference is hereby made, and this amended Location Notice is made and posted to correct errors in the description in the said original Location Notice

Dated and posted on the ground this 8th day of February 1917

J.E. Young
General Manager

Arizona Ray Copper Company

STATE OF ARIZONA,

County of PINAL

ss.

W. L. BROWN

I, County Recorder in and for the County and State aforesaid, do hereby certify that the within instrument was filed for record at o'clock M., on this FEB 10 1917 day of 19, and duly recorded in Book No. of MINES Records of PINAL County, Arizona, at pages 137

WITNESS my hand and official seal the day and year first above written.

(Recorders Seal)

County Recorder.

INDEXED

AMENDED Notice of Location LODGE CLAIM

Dated February 10, 1917

Filed and Recorded at request of

Arg. Ray Copper Co.

FEB 10 1917 A. D. 19

at 9 a M.

Book 33 of MINES

Pages 137

W. L. BROWN

County Recorder.

By M. J. Benice Deputy Recorder.

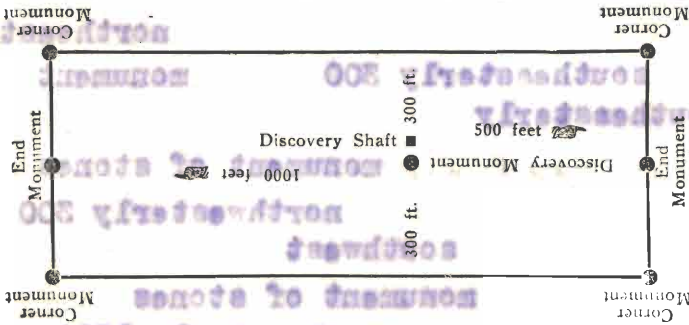

This diagram is to give locator a general idea of plan of location under the new law. The Discovery Shaft can be in the center of claim or any distance from either end desired. In the diagram it is placed 500 feet from one end and 1000 feet from the other. Commence description of claim at a center end monument, giving its distance and direction from center of Discovery Shaft; thence bound the claim in either direction. In description be careful to state locality of claim with reference to some natural object, or permanent monument, as will identify the claim.

FEB 12 1917

STATE OF ARIZONA, }
County of Pinal. } SS.

I, W. L. Brown County Recorder, in
and for the County of PINAL, State of Arizona, do hereby certify that the within and following is a full,
true and correct copy of ... Amended Notice of Location of the JUAREZ
..... Mining Claim as the same appears of record in my office in Book
No. 33 of Mines, Records, at page 145 thereof, or under File No.
.....; that I have compared the same with the original record, and that the same is a true tran-
script, and of the whole thereof.

IN WITNESS WHEREOF, I have hereunto set my hand and affixed the seal of my office, this
10th day of February 19. 17., at Florence, the County Seat.

..... W. L. Brown
County Recorder.

By *M. Bense*
Deputy Recorder.

AMENDED

Notice of Mining Location

LODE CLAIM

TO ALL WHOM IT MAY CONCERN:

This Mining Claim, the name of which is the Juarez Mining Claim, situate on lands belonging to the United States of America, and in which there are valuable mineral deposits, was entered upon and located for the purposes of exploration and purchase by The Arizona Ray Copper Company, an Arizona Corporation,

(Locator must insert either "a citizen of the United States," or "who has declared his intention to become a citizen of the United States.")

the undersigned, on the 8th day of February, 1917, 191.....

The length of this claim is 1500 feet, and no claim 400 feet, in a northerly direction and 1100 feet in a southerly direction from the center of the discovery ~~south~~ ^{out} 300 feet in width of the surface grounds, on each side of the center of said claim. The general course of the lode deposit and premises is from the south to the north

The claim is situated and located in the Mineral Creek Mining District, in Pinal County in the State of Arizona, about 1 mile in a northerly direction from the town of Ray. And joins the Black Warrior patented claim on the east, the Tom Paine claim on the north and conflicts the Sweep Stakes patented claim on the south.

The surface boundaries of the claim are marked upon the ground as follows: Beginning at a monument of stone

at a point in a northerly direction 400 feet from the discovery ~~south~~ ^{out} (at which this notice is posted), being in the center of the north end line of said claim; thence easterly 300 feet to a monument of stones, being the northeast corner of said claim; thence southerly 1500 feet to a monument of stones being at the southeast corner of said claim; thence westerly 300 feet to a monument of stones at the center of the south end of said claim; thence westerly 300 feet to a monument of stones being at the southwest corner of said claim; thence northerly 1500 feet to a monument of stones at the northwest corner of said claim; thence easterly 300 feet to the place of beginning.

All done under the provisions of the laws of the United States, and of the State of Arizona.

This is an Amended Location Notice of the Juarez Mining Claim, located by the grantors of the Arizona Ray Copper Company on the 1st day of March, 1916, and recorded in Book 30 of Records of Mines, at page 503, in the office of the County Recorder of the aforesaid County of Pinal to which reference is hereby made, and this amended Location Notice is made and posted to correct errors in the description in the said original Location Notice

Dated and posted on the ground this 8th day of February, 1917.

J. E. Young
General Manager
Arizona Ray Copper Company

STATE OF ARIZONA,

County of PINAL ss.

I, W. L. BROWN, County Recorder in and for the County and State aforesaid, do hereby certify that the within instrument was filed for record at 9 o'clock AM, on this FEB 1 0 1917 day of FEBRUARY, 1917, and duly recorded in Book No. 33 of MINES Records of PINAL County, Arizona, at pages 145.

WITNESS my hand and official seal the day and year first above written.

(Recorder's Seal)

W. L. BROWN
County Recorder.

Deputy

INDEXED

AMENDED

Notice of Location LODE CLAIM

Dated 9, 1917
Filed and Recorded at request of
Ariz Ray Copper Co

FEB 1 0 1917 A. D. 1917

at 9 A. M.,
Book 33 of MINES

Pages 145
W. L. BROWN
County Recorder.

By W. L. Brown
Deputy Recorder.

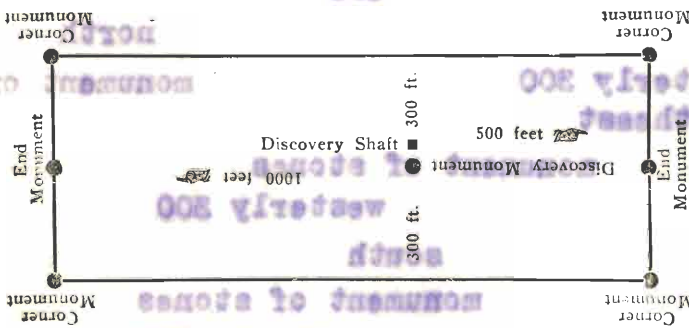

This diagram is to give locator a general idea of plan of location under the new law. The Discovery Shaft can be in the center of claim or any distance from either end desired. In the diagram it is placed 500 feet from one end and 1000 feet from the other. Commence description of claim at a center end monument, giving its distance and direction from center of Discovery Shaft; thence bound the claim in either direction. In description be careful to state locality of claim with reference to some natural object or permanent monument, as will identify the claim.

7843

FEB 12 1917

STATE OF ARIZONA, }
County of Pinal. } SS.

I,.....W. L. Brown.....County Recorder, in
and for the County of PINAL, State of Arizona, do hereby certify that the within and following is a full,
true and correct copy of....Amended Notice of Location of the WEDGE.....
.....Mining Claim....., as the same appears of record in my office in Book
No....33..... ofMines,.....Records, at page...146..... thereof, or under File No.
.....; that I have compared the same with the original record, and that the same is a true tran-
script, and of the whole thereof.

IN WITNESS WHEREOF, I have hereunto set my hand and affixed the seal of my office, this
.....10th.....day of.....February....., 1917... at Florence, the County Seat,

.....W. L. Brown.....
County Recorder.

ByMO Benice.....
Deputy Recorder.

AMENDED
Notice of Mining Location
LODE CLAIM

TO ALL WHOM IT MAY CONCERN:

This Mining Claim, the name of which is the Wedge Mining Claim, situate on lands belonging to the United States of America, and in which there are valuable mineral deposits, was entered upon and located for the purposes of exploration and purchase by The Arizona Ray Copper Company, an Arizona Corporation

(Locator must insert either "a citizen of the United States," or "who has declared his intention to become a citizen of the United States.")

the undersigned, on the 8th day of February, 1917, 191.....

The length of this claim is 1500 feet, and no claim no feet, in a northerly direction and 1500 feet in a southerly direction from the center of the discovery cut shaft, at which this notice is posted, lengthwise of the claim, together with 200 feet in width of the surface grounds, on each side of the center of said claim. The general course of the lode deposit and premises is from the south to the north.

The claim is situated and located in the Mineral Creek Mining District, in Pinal County in the State of Arizona, about and laps the Tom Paine claim on the east and joins the Adventure claim on the south.

The surface boundaries of the claim are marked upon the ground as follows: Beginning at monument of stone at the center of mouth of discovery cut

~~the discovery shaft~~ direction ~~direction~~ direction from ~~the discovery shaft~~ (at which this notice is posted), being in the center of the north end line of said claim; thence easterly 200 feet to a monument of stones, being the northeast corner of said claim; thence southerly 1500 feet to a monument of stones being at the southeast corner of said claim; thence westerly 200 feet to a monument of stones at the center of the south end of said claim; thence westerly 200 feet to a monument of stones being at the southwest corner of said claim; thence north 1500 feet to a monument of stones at the northwest corner of said claim; thence easterly 200 feet to the place of beginning.

All done under the provisions of the laws of the United States, and of the State of Arizona.

This is an Amended Location Notice of the Wedge Mining Claim, located by the grantors of the Arizona Ray Copper Company on the 24th day of Feb. 1916, 19....., and recorded in Book 30 of Records of Mines, at page 503, in the office of the County Recorder of the aforesaid County of Pinal to which reference is hereby made, and this amended Location Notice is made and posted to correct errors in the description in the said original Location Notice

Dated and posted on the ground this 8th day of February 1917 19.....

J. Young
 General Manager
 Arizona Ray Copper Company

STATE OF ARIZONA,

County of PINAL ss.

I, W. L. BROWN, County Recorder in and for the County and State aforesaid, do hereby certify that the within instrument was filed for record at 9 o'clock A. M. on this FEB 1 0 1917 day of FEBRUARY, 1917, and duly recorded in Book No. 33 of MINES Records of PINAL County, Arizona, at pages 146.

WITNESS my hand and official seal the day and year first above written.

(Recorder Seal)

W. L. BROWN
County Recorder.
M. J. Sevens
Deputy

INDEXED
AMENDED
Notice of Location
LODE CLAIM

Dated 19, 1917
Filed and Recorded at request of
Ariz Ray Copper Co.
FEB 1 0 1917 A. D. 1917
at 9 A. M.,
Book 33 of MINES
Pages 146
By W. L. BROWN County Recorder.
M. J. Sevens Deputy Recorder.

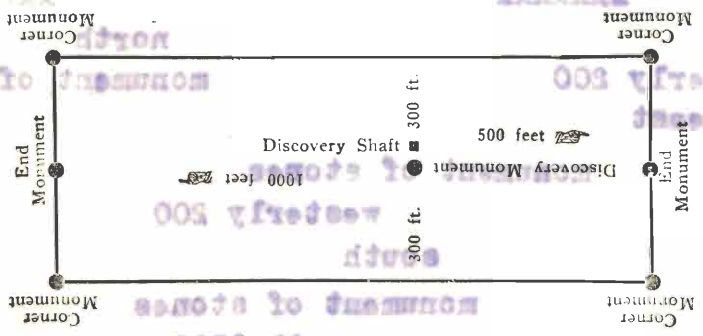

This diagram is to give locator a general idea of plan of location under the new law. The Discovery Shaft can be in the center of claim or any distance from either end desired. In the diagram it is placed 500 feet from one end and 1000 feet from the other. Commence description of claim at a center end monument, giving its distance and direction from center of Discovery Shaft, thence bound the claim in either direction. In description be careful to state locality of claim with reference to some natural object, or permanent monument, as will identify the claim.

the grantors of the Arizona Ray Copper Company
Feb. 1917
Pinal

February 1917
Ariz Ray Copper Company
General Manager

FEB 12 1917

STATE OF ARIZONA, }
County of Pinal. } SS.

I, W. L. Brown County Recorder, in
and for the County of PINAL, State of Arizona, do hereby certify that the within and following is a full,
true and correct copy of Amended Notice of Location of the COMBINATION
..... Mining Claim as the same appears of record in my office in Book
No. 33 of Mines Records, at page 139 thereof, or under File No.
.....; that I have compared the same with the original record, and that the same is a true tran-
script, and of the whole thereof.

IN WITNESS WHEREOF, I have hereunto set my hand and affixed the seal of my office, this
..... 10th day of February 19 17., at Florence, the County Seat.

..... W. L. Brown
County Recorder.

By *M. Benscoe*
Deputy Recorder.

AMENDED

Notice of Mining Location

LODE CLAIM

TO ALL WHOM IT MAY CONCERN:

This Mining Claim, the name of which is the Combination Mining Claim, situate on lands belonging to the United States of America, and in which there are valuable mineral deposits, was entered upon and located for the purposes of exploration and purchase by The Arizona Ray Copper Company, an Arizona corporation

(Locator must insert either "a citizen of the United States," or "who has declared his intention to become a citizen of the United States.")

the undersigned, on the 8th day of February, 1917, 191_____

The length of this claim is 1500 feet, and wa claim no feet,

in a northeasterly direction and 1500 feet in a southwesterly direction from of the mouth of the discovery cut shaft, at which this notice is posted, lengthwise of the claim, together with 300 feet in width of the surface grounds, on each side

of the center of said claim. The general course of the lode deposit and premises is from the southwesterly to the northeasterly

The claim is situated and located in the Mineral Creek Mining District, in Pinal County in the State of Arizona, about 2 miles in a northerly direction from the town of Ray, and joins the Copper Zone No. 8 Claim on the southwest end and lies along the south side of Rustler gulch.

The surface boundaries of the claim are marked upon the ground as follows: Beginning at a monument of stones at the center of mouth of discovery cut

~~XXXXXXXXXXXX~~ ~~XXXXXXXXXX~~ ~~XXXXXXXX~~ XXXXXX (at which this notice is posted), being in the center of the northeast end line of said claim; thence southeasterly 300 feet to a monument of stone, being the southeasterly corner of said claim; thence southwesterly 1500 feet to a monument of stones being at the southwesterly corner of said claim; thence northwesterly 300 feet to a monument of stones at the center of the southwest end end of said claim; thence northwesterly 300 feet to a monument of stones being at the northwest corner of said claim; thence northeasterly 1500 feet to a monument of stones at the northeasterly corner of said claim; thence southeasterly 300 feet to the place of beginning.

All done under the provisions of the laws of the United States, and of the State of Arizona.

This is an Amended Location Notice of the Combination Mining Claim, located by the grantors of the Arizona Ray Copper Company on the 19th day of Dec. 1915, 19_____, and recorded in Book 30 of Records of Mines, at page 499, in the office of the County Recorder of the aforesaid County of Pinal to which reference is hereby made, and this amended Location Notice is made and posted to correct errors in the description in the said original Location Notice

Dated and posted on the ground this 8th day of February, 1917 19____

J. E. Young
General Manager
Arizona Ray Copper Company



County of PINAL ss.

I, W. L. BROWN, County Recorder in and for the County and State aforesaid, do hereby certify that the within instrument was filed for record at 9 o'clock a. M., on this FEB 10 1917 day of 1917, and duly recorded in Book No. 33 of MINES Records of PINAL County, Arizona, at pages 139.

WITNESS my hand and official seal the day and year first above written.

(Recorders Seal)

W. L. BROWN County Recorder. M. O. Benson Deputy

AMENDED Notice of Location LODGE CLAIM

Dated February 10, 1917

Filed and Recorded at request of Ariz. Ray Copper Co.

FEB 10 1917 A. D. 1917

at 9 a. M.

Book 33 of MINES

Pages 139

W. L. BROWN

County Recorder.

By M. O. Benson Deputy Recorder.

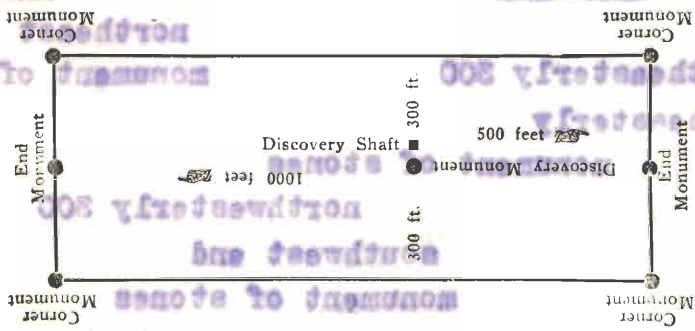

This diagram is to give locator a general idea of plan of location under the new law. The Discovery Shaft can be in the center of claim or any distance from either end desired. In the diagram it is placed 500 feet from one end and 1000 feet from the other. Commence description of claim at a center end monument, giving its distance and direction from center of Discovery Shaft; thence bound the claim in either direction. In description be careful to state locality of claim with reference to some natural object, or permanent monument, as will identify the claim.

the grantors of the Arizona Ray Copper Company

Pinal

February, 1917

SEP

Arizona Ray Copper Company General Manager

INDEXED

7887

FEB 12 1917

STATE OF ARIZONA, }
County of Pinal. } SS.

I, W. L. Brown County Recorder, in
and for the County of PINAL, State of Arizona, do hereby certify that the within and following is a full,
true and correct copy of Amended Location Notice of the ADVENTURE Mining....
..... Claim, as the same appears of record in my office in Book
No. 33 of Mines, Records, at page 135 thereof, or under File No
.....; that I have compared the same with the original record, and that the same is a true tran-
script, and of the whole thereof.

IN WITNESS WHEREOF, I have hereunto set my hand and affixed the seal of my office, this
10th day of February, 19 17., at Florence, the County Seat.

..... W. L. Brown
County Recorder.
By *M. J. Sencer*
Deputy Recorder.

AMENDED
Notice of Mining Location
LODE CLAIM

TO ALL WHOM IT MAY CONCERN:

This Mining Claim, the name of which is the Adventure
Mining Claim, situate on lands belonging to the United States of America, and in which there are
valuable mineral deposits, was entered upon and located for the purposes of exploration and purchase
by The Arizona Ray Copper Company, an Arizona Corporation

(Locator must insert either "a citizen of the United States," or "who has declared his intention to become a citizen of the United States.")

the undersigned, on the 8th day of February, 1917

The length of this claim is 1500 feet,
and we claim 210 feet,

in a northerly direction and 1290

feet in a cut southerly direction from

the center of the discovery ~~stone~~ 300 feet in width of the surface grounds, on each side

of the center of said claim. The general course of the lode deposit and premises is from the

south to to the north

The claim is situated and located in the Mineral Creek Mining District, in
Pinal County in the State of Arizona, about 1 mile

in a northerly direction from the town of Ray, and joins
the Juarez claim on the east and the Colorado claim on the west

The surface boundaries of the claim are marked upon the ground as follows: Beginning at
monument of stone

at a point in a northerly direction 210 feet from
the discovery ~~stone~~ cut (at which this notice is posted), being in the center of the north

end line of said claim; thence easterly 300 feet to a monument of

stone, being the northeast corner of said claim; thence
southerly 1500 feet to a monument of stone being at the

southeast corner of said claim; thence westerly 300 feet

to a monument of stones at the center of the south end of said claim;

thence westerly 300 feet to a monument of stones being at the

southwest corner of said claim; thence northerly 1500 feet

to a monument of stones at the northwest corner of said claim;

thence 300 feet to the place of beginning.

All done under the provisions of the laws of the United States, and of the State of Arizona.

This is an Amended Location Notice of the Adventure
Mining Claim, located by the grantors of the Arizona Ray Copper Company

on the 1st day of
March, 1916, and recorded in Book 30 of Records of Mines, at

page 504, in the office of the County Recorder of the aforesaid County of Pinal

to which reference is hereby made, and this amended Location Notice is made and posted to correct
errors in the description in the said original Location Notice

Dated and posted on the ground this 8th day of February, 1917

J. Young
General Manager
Arizona Ray Copper Company

ss.

County of PINAL

I, W. L. BROWN

County Recorder in and for

the County and State aforesaid, do hereby certify that the within instrument was filed for record at o'clock M., on this FEB 10 1917 day of 19 and duly recorded in Book No. of MINES Records of PINAL County, Arizona, at pages 135

WITNESS my hand and official seal the day and year first above written.

(Recorder's Seal)

W. L. BROWN County Recorder.

Deputy

AMENDED Notice of Location LODGE CLAIM

Dated FEB 10 1917, 19

Filed and Recorded at request of

Ariz. Ray Copper Co

FEB 10 1917 A. D. 19

at 9 A. M.

Book 33 of MINES

Pages 135

W. L. BROWN

County Recorder.

Deputy Recorder.

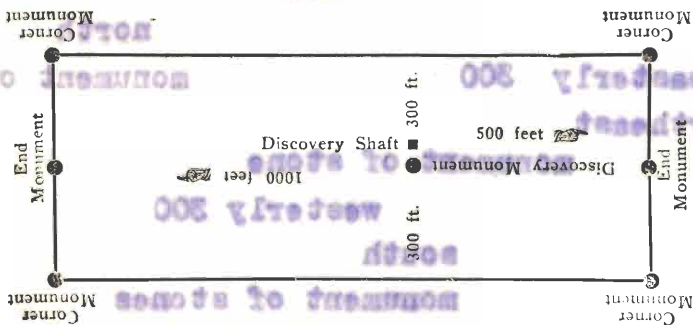

This diagram is to give locator a general idea of plan of location under the new law. The Discovery Shaft can be in the center of claim or any distance from either end desired. In the diagram it is placed 500 feet from one end and 1000 feet from the other. Commence description of claim at a center end monument, giving its distance and direction from center of Discovery Shaft; thence bound the claim in either direction. In description be careful to state locality of claim with reference to some natural object, or permanent monument, as will identify the claim.

INDEXED

7833

FEB 12 1917

STATE OF ARIZONA, }
County of Pinal. } SS.

I,.....W. L. Brown.....County Recorder, in
and for the County of PINAL, State of Arizona, do hereby certify that the within and following is a full,
true and correct copy of...Amended Notice of Location of the CARRIE NATION...
.....Mining Claim....., as the same appears of record in my office in Book
No...33..... ofMines,.....Records, at page....138.... thereof, or under File No.
.....; that I have compared the same with the original record, and that the same is a true tran-
script, and of the whole thereof.

IN WITNESS WHEREOF, I have hereunto set my hand and affixed the seal of my office, this
.....10th.....day of.....February....., 19. 17., at Florence, the County Seat.

.....W. L. Brown.....
County Recorder.
By *MO Renscoe*
Deputy Recorder.



AMENDED

Notice of Mining Location

LODE CLAIM

TO ALL WHOM IT MAY CONCERN:

This Mining Claim, the name of which is the Carrie Nation Mining Claim, situate on lands belonging to the United States of America, and in which there are valuable mineral deposits, was entered upon and located for the purposes of exploration and purchase by The Arizona Ray Copper Company, an Arizona Corporation

(Locator must insert either "a citizen of the United States," or "who has declared his intention to become a citizen of the United States.")

the undersigned, on the 8th day of February, 1917, 191

The length of this claim is 1500 feet, and wa claim 300 easterly feet, in a easterly direction and 1200 feet in a westerly direction from the center of the discovery shaft, at which this notice is posted, lengthwise of the claim, together with 300 feet in width of the surface grounds, on each side of the center of said claim. The general course of the lode deposit and premises is from the east to the west

The claim is situated and located in the Mineral Creek Mining District, in Pinal County in the State of Arizona, about in a direction from and laps the Granite patented claim on the east end and covers ground formerly held by the Bluebell claim abandoned.

The surface boundaries of the claim are marked upon the ground as follows: Beginning at a monument of stones b

at a point in a easterly direction 300 feet from the discovery shaft (at which this notice is posted), being in the center of the east end line of said claim; thence southerly 300 feet to a monument of stones, being the southeast corner of said claim; thence westerly 1500 feet to a monument of stones being at the southwest corner of said claim; thence northerly 300 feet to a monument of stones at the center of the west end of said claim; thence northerly 300 feet to a monument of stones being at the northwest corner of said claim; thence easterly 1500 feet to a monument of stones at the northeast corner of said claim; thence southerly 300 feet to the place of beginning.

All done under the provisions of the laws of the United States, and of the State of Arizona.

This is an Amended Location Notice of the Carrie Nation Mining Claim, located by the grantors of the Arizona Ray Copper Company on the 24th day of Feb. 1916, 1916, and recorded in Book 30 of Records of Mines, at page 502, in the office of the County Recorder of the aforesaid County of Pinal to which reference is hereby made, and this amended Location Notice is made and posted to correct errors in the description in the said original Location Notice

Dated and posted on the ground this 8th day of February, 1917, 19

J. E. Young
General Manager

Arizona Ray Copper Company

STATE OF ARIZONA,

County of FINAL ss.

I, W. L. BROWN, County Recorder in and for the County and State aforesaid, do hereby certify that the within instrument was filed for record at 9 o'clock a M., on this FEB 10 1917 day of _____, 19____, and duly recorded in Book No. 33 of MINES Records of FINAL County, Arizona, at pages 138

WITNESS my hand and official seal the day and year first above written.

Recorders Seal

W. L. BROWN

County Recorder.

M. O. Benisco
Deputy

INDEXED

AMENDED

**Notice of Location
LODE CLAIM**

Dated _____, 19____

Filed and Recorded at request of

Ray Ray Copper Co

FEB 10 1917 A. D. 19____

at 9 a M.,

MINES

Book 33 of

Pages 138

W. L. BROWN

County Recorder.

M. O. Benisco
Deputy Recorder.

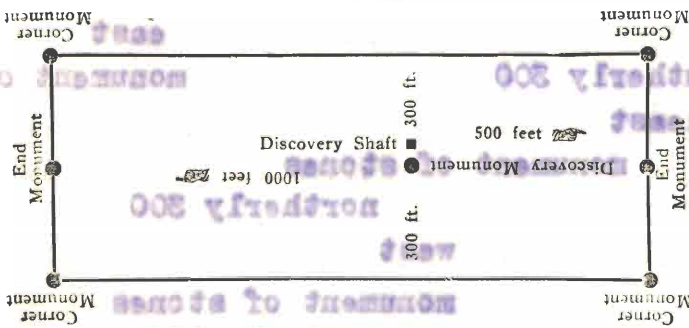

This diagram is to give locator a general idea of plan of location under the new law. The Discovery Shaft can be in the center of claim or any distance from either end desired. In the diagram it is placed 500 feet from one end and 1000 feet from the other. Commence description of claim at a center end monument, giving its distance and direction from center of Discovery Shaft; thence bound the claim in either direction. In description be careful to state locality of claim with reference to some natural object, or permanent monument, as will identify the claim.

the grantors of the Arizona Ray Copper Company

24th

Final

February, 1917

6th

General Manager

Arizona Ray Copper Company

FEB 12 1917

STATE OF ARIZONA, }
County of Pinal. } SS.

I, W. L. Brown County Recorder, in
and for the County of PINAL, State of Arizona, do hereby certify that the within and following is a full,
true and correct copy of .. Amended Location Notice of the COPPER ZONE No. 4 ...
..... Mining Claim as the same appears of record in my office in Book
No. 33 of Mines, Records, at page ... 140 thereof, or under File No.
.....; that I have compared the same with the original record, and that the same is a true tran-
script, and of the whole thereof.

IN WITNESS WHEREOF, I have hereunto set my hand and affixed the seal of my office, this
..... 10th day of February 19. 17., at Florence, the County Seat.

..... W. L. Brown
County Recorder.

By *W. O. Benscoe*
Deputy Recorder.

AMENDED
Notice of Mining Location
LODE CLAIM

TO ALL WHOM IT MAY CONCERN:

This Mining Claim, the name of which is the Copper Zone No. 4
Mining Claim, situate on lands belonging to the United States of America, and in which there are
valuable mineral deposits, was entered upon and located for the purposes of exploration and purchase
by The Arizona Ray Copper Company, an Arizona Corporation

(Locator must insert either "a citizen of the United States," or "who has declared his intention to become a citizen of the United States.")

the undersigned, on the 8th day of February, 1917, 191.....

The length of this claim is 1500 feet,
and we claim 50 feet,
in a northwesterly direction and 1450
feet in a southeasterly direction from
the center of the discovery shaft, at which this notice is posted, lengthwise of the claim, together with
300 feet in width of the surface grounds, on each side
of the center of said claim. The general course of the lode deposit and premises is from the
southeast to the northwest

The claim is situated and located in the Mineral Creek Mining District, in
Pinal County in the State of Arizona, about
in a direction from and joins Copper
Zones Nos. 1, 2, and 3, patented mining claims on the west and
laps the Carrie Nation Claim on the south.

The surface boundaries of the claim are marked upon the ground as follows: Beginning at
a monument of stones

at a point in a northwesterly direction 50 feet from
the discovery shaft (at which this notice is posted), being in the center of the northerly
end line of said claim; thence northeasterly 300 feet to a monument of
stones, being the northeast corner of said claim; thence
southeasterly 1500 feet to a monument of stones being at the
southeast corner of said claim; thence southwesterly 300 feet
to a monument of stones at the center of the southerly end of said claim;
thence southwesterly 300 feet to a monument of stones being at the
southwesterly corner of said claim; thence northwesterly 1500 feet
to a monument of stones at the northwesterly corner of said claim;
thence northeasterly 300 feet to the place of beginning.

All done under the provisions of the laws of the United States, and of the State of Arizona.

This is an Amended Location Notice of the Copper Zone No. 4
Mining Claim, located by the grantors of the Arizona Ray Copper Company
..... on the 24th day of
Feb. 1916, 19....., and recorded in Book 30 of Records of Mines, at
page 500, in the office of the County Recorder of the aforesaid County of Pinal
to which reference is hereby made, and this amended Location Notice is made and posted to correct
errors in the description in the said original Location Notice

Dated and posted on the ground this 8th day of Feb. 1917, 19.....

J. E. Young
General Manager
Arizona Ray Copper Company



STATE OF ARIZONA,

County of PINAL ss.

I, W. L. BROWN, County Recorder in and for the County and State aforesaid, do hereby certify that the within instrument was filed for record at 9 o'clock a M., on this FEB 1 0 1917 day of _____, 19____, and duly recorded in Book No. 33 of MINES Records of PINAL County, Arizona, at pages 140

WITNESS my hand and official seal the day and year first above written.

(Recorders Seal)

W. L. BROWN
County Recorder.
M. J. Benson
Deputy

AMENDED
Notice of Location
LODE CLAIM

Dated _____, 19____

Filed and Recorded at request of

Ariz Ray Copper Co

FEB 1 0 1917 A. D. 19____

at 9 a M.,

Book 33 of MINES

Pages 140

W. L. BROWN
County Recorder.

By *M. J. Benson*
Deputy Recorder.

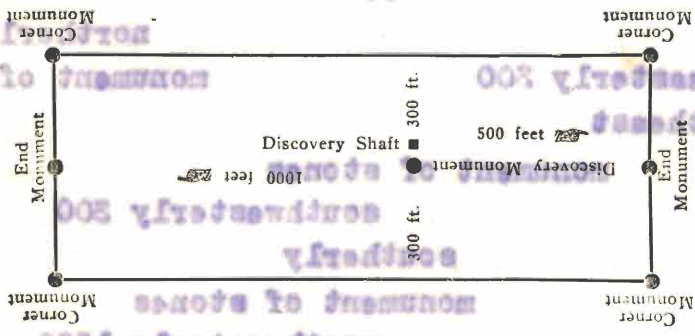

This diagram is to give locator a general idea of plan of location under the new law. The Discovery Shaft can be in the center of claim or any distance from either end desired. In the diagram it is placed 500 feet from one end and 1000 feet from the other. Commence description of claim at a center end monument, giving its distance and direction from center of Discovery Shaft; thence bound the claim in either direction. In description be careful to state locality of claim with reference to some natural object, or permanent monument, as will identify the claim.

the grantors of the Arizona Ray Copper Company
Copper Zone No. 4

Arizona Ray Copper Company
General Manager

INDEXED

7898

FEB 12 1917

STATE OF ARIZONA, }
County of Pinal. } SS.

I, W. L. Brown County Recorder, in
and for the County of PINAL, State of Arizona, do hereby certify that the within and following is a full,
true and correct copy of... Amended Notice of Location of the
. COPPER ZONE No. 5 Mining Claim as the same appears of record in my office in Book
No. 33 of Mines, Records, at page 141 thereof, or under File No.
.....; that I have compared the same with the original record, and that the same is a true tran-
script, and of the whole thereof.

IN WITNESS WHEREOF, I have hereunto set my hand and affixed the seal of my office, this
10th day of February, 19 17., at Florence, the County Seat,

..... W. L. Brown
County Recorder.
By *MO Benscoe*
Deputy Recorder.

AMENDED

Notice of Mining Location

LODE CLAIM

TO ALL WHOM IT MAY CONCERN:

This Mining Claim, the name of which is the Copper Zone No. 5 Mining Claim, situate on lands belonging to the United States of America, and in which there are valuable mineral deposits, was entered upon and located for the purposes of exploration and purchase by The Arizona Ray Copper Company, an Arizona corporation

(Locator must insert either "a citizen of the United States," or "who has declared his intention to become a citizen of the United States.")

the undersigned, on the 8th day of February, 1917, 191.....

The length of this claim is 1500 feet, and wa claim 100 feet, in a northwesterly direction and 1400 feet in a southeasterly direction from

the center of the discovery shaft, at which this notice is posted, lengthwise of the claim, together with 300 feet in width of the surface grounds, on each side of the center of said claim. The general course of the lode deposit and premises is from the southeast to the northwest

The claim is situated and located in the Mineral Creek Mining District, in Pinal County in the State of Arizona, about in a direction from and joins the Copper Zone No. 4 claim on the west and laps the Carrie Nation claim on the south

The surface boundaries of the claim are marked upon the ground as follows: Beginning at a monument of stones

at a point in a northwesterly direction 100 feet from the discovery shaft (at which this notice is posted), being in the center of the northerly end line of said claim; thence northeasterly 300 feet to a monument of stones, being the northeasterly corner of said claim; thence southeasterly 1500 feet to a monument of stones being at the southeasterly corner of said claim; thence southwesterly 300 feet to a monument of stones at the center of the southerly end of said claim; thence southwesterly 300 feet to a monument of stones being at the southwesterly corner of said claim; thence northwesterly 1500 feet to a monument of stones at the northwesterly corner of said claim; thence northeasterly 300 feet to the place of beginning.

All done under the provisions of the laws of the United States, and of the State of Arizona.

This is an Amended Location Notice of the Copper Zone No. 5 Mining Claim, located by the grantors of the Arizona Ray Copper Company on the 24th day of Feb. 1916, 19....., and recorded in Book 30 of Records of Mines, at page 500, in the office of the County Recorder of the aforesaid County of Pinal to which reference is hereby made, and this amended Location Notice is made and posted to correct errors in the description in the said original Location Notice

Dated and posted on the ground this 8th day of February, 1917, 19.....

J. E. Young
General Manager
Arizona Ray Copper Company

STATE OF ARIZONA,

County of PINAL ss.

I, W. L. BROWN, County Recorder in and for the County and State aforesaid, do hereby certify that the within instrument was filed for record at 9 o'clock a M. on this FEB 10 1917 day of _____, 19____, and duly recorded in Book No. 33 of MINES Records of PINAL County, Arizona, at pages 141

WITNESS my hand and official seal the day and year first above written.

(Recorder's Seal)

W. L. BROWN
County Recorder.
W. L. BROWN
Deputy

INDEXED

AMENDED
Notice of Location
LODE CLAIM

Dated _____, 19____
Filed and Recorded at request of
Ariz. Ray Copper Co.

FEB 10 1917 A. D. 19____
at 9 a M.,
Book 33 of MINES
Pages 141
W. L. BROWN
County Recorder.
By W. L. BROWN
Deputy Recorder.

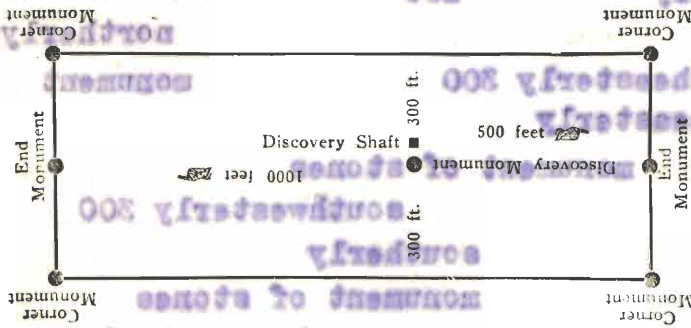

This diagram is to give locator a general idea of plan of location under the new law. The Discovery Shaft can be in the center of claim or any distance from either end desired. In the diagram it is placed 500 feet from one end and 1000 feet from the other. Commence description of claim at a center end monument, giving its distance and direction from center of Discovery Shaft; thence bound the claim in either direction. In description be careful to state locality of claim with reference to some natural object, or permanent monument, as will identify the claim.

Ariz. Ray Copper Co.
General Manager

Ariz. Ray Copper Co.
General Manager

FEB 12 1917

STATE OF ARIZONA, }
County of Pinal. } SS.

I, W. L. Brown County Recorder, in
and for the County of PINAL, State of Arizona, do hereby certify that the within and following is a full,
true and correct copy of Amended Notice of Location of the COPPER ZONE
No. 6 Mining Claim, as the same appears of record in my office in Book
No. 33 of Mines Records, at page 142 thereof, or under File No.
.....; that I have compared the same with the original record, and that the same is a true tran-
script, and of the whole thereof.

IN WITNESS WHEREOF, I have hereunto set my hand and affixed the seal of my office, this
10th day of February, 1917 .., at Florence, the County Seat.

..... W. L. Brown
County Recorder.
By McBenscoe
Deputy Recorder.

AMENDED

Notice of Mining Location

LODE CLAIM

TO ALL WHOM IT MAY CONCERN:

This Mining Claim, the name of which is the Copper Zone No. 6 Mining Claim, situate on lands belonging to the United States of America, and in which there are valuable mineral deposits, was entered upon and located for the purposes of exploration and purchase by The Arizona Ray Copper Company, and Arizona Corporation

(Locator must insert either "a citizen of the United States," or "who has declared his intention to become a citizen of the United States.")

the undersigned, on the 8th day of February, 1917, 191.....

The length of this claim is 1500 feet, and wa claim 500 feet, in a northwesterly direction and 1000 feet in a southeasterly direction from the center of the discovery shaft, at which this notice is posted, lengthwise of the claim, together with 300 feet in width of the surface grounds, on each side of the center of said claim. The general course of the lode deposit and premises is from the southeasterly to the northwesterly

The claim is situated and located in the Mineral Creek Mining District, in Pinal County in the State of Arizona, about in a direction from and joins the Copper Zone No. 5 claim on the west, and laps the patented Granite claim on the south.

The surface boundaries of the claim are marked upon the ground as follows: Beginning at monument of stone

at a point in a northwesterly direction 500 feet from the discovery shaft (at which this notice is posted), being in the center of the northerly end line of said claim; thence northeasterly 300 feet to a monument of stones, being the northeasterly corner of said claim; thence southeasterly 1500 feet to a monument of stones being at the southeasterly corner of said claim; thence southwesterly 300 feet to a monument of stones at the center of the southerly end of said claim; thence southwesterly 300 feet to a monument of stones being at the southwesterly corner of said claim; thence northwesterly 1500 feet to a monument of stones at the northwesterly corner of said claim; thence northeasterly 300 feet to the place of beginning.

All done under the provisions of the laws of the United States, and of the State of Arizona.

This is an Amended Location Notice of the Copper Zone No. 6 Mining Claim, located by the grantors of the Arizona Ray Copper Company on the 24th day of Feb. 1916, 19....., and recorded in Book 30 of Records of Mines, at page 501, in the office of the County Recorder of the aforesaid County of Pinal to which reference is hereby made, and this amended Location Notice is made and posted to correct errors in the description in the said original Location Notice

Dated and posted on the ground this 8th day of February, 1917, 19.....

J. Young
General Manager

Arizona Ray Copper Company

STATE OF ARIZONA,

County of PINAL ss.

I, W. L. BROWN, County Recorder in and for the County and State aforesaid, do hereby certify that the within instrument was filed for record at 9 o'clock a M., on this FEB 10 1917 day of _____, 19____, and duly recorded in Book No. 33 of MINES Records of PINAL County, Arizona, at pages 142

WITNESS my hand and official seal the day and year first above written.

(Recorders Seal)

W. L. BROWN
County Recorder.
M. J. Senese
Deputy

INDEXED

AMENDED
Notice of Location
LODE CLAIM

Dated _____, 19____

Filed and Recorded at request of

Ariz. Ray Copper Co.

FEB 10 1917 A. D. 19____

at 9 a M.,

Book 33 of MINES

Pages 142

W. L. BROWN
County Recorder.

M. J. Senese
Deputy Recorder.

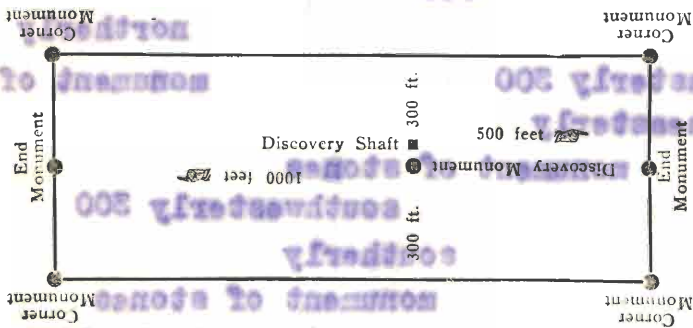

This diagram is to give locator a general idea of plan of location under the new law. The Discovery Shaft can be in the center of claim or any distance from either end desired. In the diagram it is placed 500 feet from one end and 1000 feet from the other. Commence description of claim at a center end monument, giving its distance and direction from center of Discovery Shaft; thence bound the claim in either direction. In description be careful to state locality of claim with reference to some natural object, or permanent monument, as will identify the claim.

the grantors of the Arizona Ray Copper Company
Copper Zone No. 6

Pinal

February, 1917

8th

General Manager

Arizona Ray Copper Company

7840

FEB 12 1917

STATE OF ARIZONA, }
County of Pinal. } SS.

I.....W. L. Brown.....County Recorder, in
and for the County of PINAL, State of Arizona, do hereby certify that the within and following is a full,
true and correct copy of...Amended Notice of Location of the COPPER ZONE No. 7
.....Mining Claim....., as the same appears of record in my office in Book
No...33..... ofMines.....Records, at page...143..... thereof, or under File No.
.....; that I have compared the same with the original record, and that the same is a true tran-
script, and of the whole thereof.

IN WITNESS WHEREOF, I have hereunto set my hand and affixed the seal of my office, this
10th.....day of.....February....., 1917... at Florence, the County Seat.

.....W. L. Brown.....
County Recorder.
ByM. O. Beniscoe.....
Deputy Recorder.

AMENDED

Notice of Mining Location

LODE CLAIM

TO ALL WHOM IT MAY CONCERN:

This Mining Claim, the name of which is the Copper Zone No. 7 Mining Claim, situate on lands belonging to the United States of America, and in which there are valuable mineral deposits, was entered upon and located for the purposes of exploration and purchase by The Arizona Ray Copper Company, an Arizona corporation

(Locator must insert either "a citizen of the United States," or "who has declared his intention to become a citizen of the United States.")

the undersigned, on the 8th day of February, 1917, 191.....

The length of this claim is 1500 feet, and we claim 110 feet, in a northwesterly direction and 1390 feet in a southeasterly direction from

the center of the discovery shaft, at which this notice is posted, lengthwise of the claim, together with 190 feet easterly and 240 feet westerly in width of the surface grounds, on each side of the center of said claim. The general course of the lode deposit and premises is from the southeast to the Northwest

The claim is situated and located in the Mineral Creek Mining District, in Pinal County in the State of Arizona, about in a direction from and joins the Copper Zone No. 6 claim on the west and laps the patented Granite claim on the south.

The surface boundaries of the claim are marked upon the ground as follows: Beginning at monument of stones

at a point in a northwesterly direction 110 feet from the discovery shaft (at which this notice is posted), being in the center of the northerly end line of said claim; thence northeasterly 190 feet to a monument of stones, being the northeasterly corner of said claim; thence southeasterly 1500 feet to a monument of stones being at the southeasterly corner of said claim; thence southwesterly 190 feet to a monument of stones at the center of the southerly end of said claim; thence southwesterly 240 feet to a monument of stones being at the southwesterly corner of said claim; thence northwesterly 1500 feet to a monument of stones at the northwesterly corner of said claim; thence northeasterly 240 feet to the place of beginning.

All done under the provisions of the laws of the United States, and of the State of Arizona.

This is an Amended Location Notice of the Copper Zone No. 7 Mining Claim, located by the grantors of the Arizona Ray Copper Company on the 24th day of Feb. 1917, 19....., and recorded in Book 30 of Records of Mines, at page 501, in the office of the County Recorder of the aforesaid County of Pinal to which reference is hereby made, and this amended Location Notice is made and posted to correct errors in the description in the said original Location Notice

Dated and posted on the ground this 8th day of February, 1917 19.....

H. Young
General Manager
Arizona Ray Copper Company

STATE OF ARIZONA,

County of PINAL SS.

I, W. L. BROWN, County Recorder in and for the County and State aforesaid, do hereby certify that the within instrument was filed for record at 9 o'clock a M., on this FEB 10 1917 day of _____, 19____, and duly recorded in Book No. 33 of MINES Records of PINAL County, Arizona, at pages 143

WITNESS my hand and official seal the day and year first above written.

(Recorder's Seal)

W. L. BROWN
County Recorder.
M. J. ...
Deputy

INDEXED

AMENDED
Notice of Location
LODE CLAIM

Dated _____, 19____

Filed and Recorded at request of

Ariz Ray Copper Co

FEB 10 1917 A. D. 19____

at 9 a M.,

Book 33 of MINES

Pages 143

W. L. BROWN
County Recorder.
M. J. ...
Deputy Recorder.

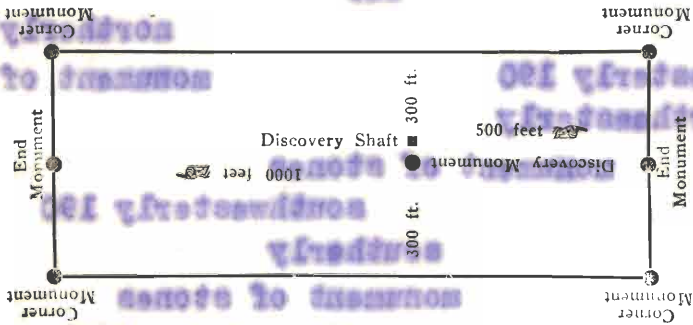

This diagram is to give locator a general idea of plan of location under the new law. The Discovery Shaft can be in the center of claim or any distance from either end desired. In the diagram it is placed 500 feet from one end and 1000 feet from the other. Commence description of claim at a center end monument, giving its distance and direction from center of Discovery Shaft; thence bound the claim in either direction. In description be careful to state locality of claim with reference to some natural object, or permanent monument, as will identify the claim.

Arizona Ray Copper Company
General Manager

February, 1917

Pinal

the grantors of the Arizona Ray Copper Company
Copper Zone No. 7

monument of stones
northwesterly 240

monument of stones
southwesterly 130

monument of stones
northwesterly 100

monument of stones
northwesterly 130

FEB 12 1917

STATE OF ARIZONA, }
County of Pinal. } SS.

I, W. L. Brown County Recorder, in
and for the County of PINAL, State of Arizona, do hereby certify that the within and following is a full,
true and correct copy of ... Amended Notice of Location of the COPPER ZONE No. 8
..... Mining Claim as the same appears of record in my office in Book
No. 33 of Mines, Records, at page 144 thereof, or under File No.
.....; that I have compared the same with the original record, and that the same is a true tran-
script, and of the whole thereof.

IN WITNESS WHEREOF, I have hereunto set my hand and affixed the seal of my office, this
..... 10th day of February 19. 17., at Florence, the County Seat.

..... W. L. Brown
County Recorder.

By *McBennet*
Deputy Recorder.

AMENDED
Notice of Mining Location
 LODE CLAIM

TO ALL WHOM IT MAY CONCERN:

This Mining Claim, the name of which is the Copper Zone No. 8 Mining Claim, situate on lands belonging to the United States of America, and in which there are valuable mineral deposits, was entered upon and located for the purposes of exploration and purchase by The Arizona Ray Copper Company, an Arizona corporation

(Locator must insert either "a citizen of the United States," or "who has declared his intention to become a citizen of the United States.")

the undersigned, on the 8th day of February, 1917, 191.....

The length of this claim is 1500 feet, and wa claim 810 feet, in a northwesterly direction and 690 feet in a southeasterly direction from the center of the discovery shaft, at which this notice is posted, lengthwise of the claim, together with 300 feet in width of the surface grounds, on each side of the center of said claim. The general course of the lode deposit and premises is from the southeasterly to the northwesterly

The claim is situated and located in the Mineral Creek Mining District, in Pinal County in the State of Arizona, about in a direction from and joins the Copper Zone No. 7 claim on the west and laps the Granite patented claim on the south.

The surface boundaries of the claim are marked upon the ground as follows: Beginning at a monument of stones

at a point in a northwesterly direction 810 feet from the discovery shaft (at which this notice is posted), being in the center of the northerly end line of said claim; thence northeast 300 feet to a monument of stones, being the northeasterly corner of said claim; thence southeasterly 1500 feet to a monument of stones being at the southeasterly corner of said claim; thence southwesterly 300 feet to a monument of stones at the center of the southerly end of said claim; thence southwesterly 300 feet to a monument of stones being at the southwesterly corner of said claim; thence northwesterly 1500 feet to a monument of stones at the northwesterly corner of said claim; thence northeasterly 300 feet to the place of beginning.

All done under the provisions of the laws of the United States, and of the State of Arizona.

This is an Amended Location Notice of the Copper Zone No. 8 Mining Claim, located by the grantors of the Arizona Ray Copper Company on the 23d day of April, 1916, 19....., and recorded in Book 30 of Records of Mines, at page 502, in the office of the County Recorder of the aforesaid County of Pinal to which reference is hereby made, and this amended Location Notice is made and posted to correct errors in the description in the said original Location Notice

Dated and posted on the ground this 8th day of February, 1917, 19.....

J. Young
 General Manager
 Arizona Ray Copper Company

STATE OF ARIZONA,

County of PINAL ss.

I, W. L. BROWN, County Recorder in and for the County and State aforesaid, do hereby certify that the within instrument was filed for record at 9 o'clock a M. on this FEB 10 1917 day of _____, 19____, and duly recorded in Book No. 33 of MINES Records of PINAL County, Arizona, at pages 144

(WITNESS my hand and official seal the day and year first above written.)
(Recorder's Seal)

W. L. BROWN
County Recorder.
W. L. BROWN
Deputy

AMENDED
Notice of Location
LODE CLAIM

Dated _____, 19____

Filed and Recorded at request of

Ariz. Ray Copper Co.

FEB 10 1917 A. D. 19____

at 9 a M.,

Book 33 of MINES

Pages 144

W. L. BROWN

County Recorder.

By W. L. BROWN
Deputy Recorder.

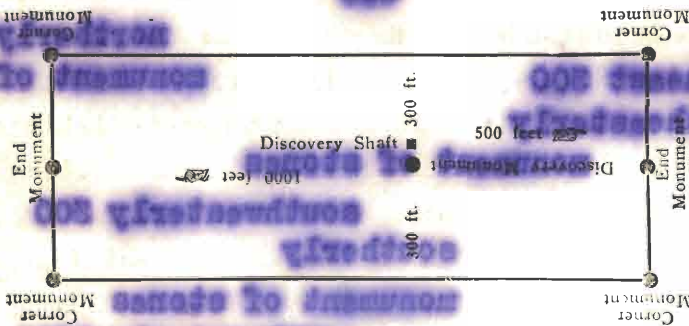

This diagram is to give locator a general idea of plan of location under the new law. The Discovery Shaft can be in the center of claim or any distance from either end desired. In the diagram it is placed 500 feet from one end and 1000 feet from the other. Commence description of claim at a center end monument, giving its distance and direction from center of Discovery Shaft, thence bound the claim in either direction. In description be careful to state locality of claim with reference to some natural object, or permanent monument, as will identify the claim.

Upper Zone No. 8
the grantors of the Arizona Ray Copper Company

Witness my hand

February, 1917

Arizona Ray Copper Company
General Manager

U. S. SURVEYOR-GENERAL'S FINAL CERTIFICATE ON FIELD NOTES.

Department of the Interior,

OFFICE OF U. S. SURVEYOR-GENERAL,

Phoenix, Arizona,

January 25, 1918.

I, U. S. Surveyor-General for District of Arizona

do hereby certify that the foregoing transcript of the Field Notes, return and approval of the survey of the mining claim of

Arizona Ray Copper Co.
 Colorado, Carnation, Juarez, Wedge, Combination, Adventure,
 known as the Carrie Nation, Copper Zone No. 4, Copper Zone No. 5, Copper
 Zone No. 6, Copper Zone No. 7, Copper Zone No. 8 lodes.
 situate in Mineral Creek

Mining District, Pinal County, Arizona.

in Sections 1, 2, 11, 12 Township No. 3 S., Range No. 13 E., unapp'd., and designated as Survey No. 3367

, has been correctly copied from the originals on file in this office; that said Field Notes furnish such an accurate description of said mining claim as will, if incorporated into a patent, serve fully to identify the premises, and that such reference is made therein to natural objects or permanent monuments as will perpetuate and fix the *locus* thereof.

And I further certify that five hundred dollars' worth of labor has been expended or improvements made or for each of said mining claims by claimant or its grantors, and that said improvements consist of 12 cuts, 6 shafts and 4 drill holes, total value, \$25,125.

As improvements 3 and 4 on the Juarez lode, 2 on the Copper Zone No. 4 lode and 2 on the Copper Zone No. 6 lode, are common improvements for the benefit and development of the entire group of claims embraced in this survey, an undivided 1/12 interest, value \$442.50, \$475.83, \$700 and \$312.50, respectively, in said improvements is properly credited to each claim in this survey, and that no portion of said labor or improvements has been included in the estimate of expenditures upon any other claim.

I further certify that the plat thereof, filed in the U. S. Land Office at Phoenix,

Arizona, is correct and in conformity with the foregoing Field Notes.

Frank P. Trott,

United States Surveyor-General for Arizona.

SURVEYOR-GENERAL'S CERTIFICATE OF APPROVAL OF FIELD
NOTES AND SURVEY OF MINING CLAIM.

Department of the Interior,

OFFICE OF U. S. SURVEYOR-GENERAL,

Phoenix, Arizona,

January 25, 1918.

I, U. S. Surveyor-General for District of Arizona

do hereby certify that the foregoing and hereto attached Field Notes and Return of the Survey of the
Mining Claim of

Arizona Ray Copper Co.

known as the
Colorado, Carnation, Juarez, Wedge, Combination, Adventure,
Carrie Nation, Copper Zone No. 4, Copper Zone No. 5, Copper
Zone No. 6, Copper Zone No. 7, Copper Zone No. 8 lodes.

situate in Mineral Creek mining district,

Pinal County, Arizona.

in Sections 1, 2, 11, 12, Township No. 3 S., Range No. 13 E. unapp'd.

designated as Survey No. 3367

executed by Paul E. Fernald, United States Mineral

Surveyor, February 20-March 20, 1917, under my instructions dated

February 13, 1917, have been critically examined and the necessary cor-

rections and explanations made, and the said Field Notes and Return, and the Survey they describe,

are hereby approved. A true copy of the copy of the location certificate filed by the applicant for

survey is included in the field notes.



U. S. Surveyor-General for Arizona.

Recd. with letter
April 25, 1918.

Apr 27 1918

U.S. MINERAL SURVEY NO. 3367

Mr. Frank P. Trotter
U.S. Surveyor General
Phoenix, Ariz.

Sir:- In accordance with directions contained in your letter of March 13th, 1918, I beg to say that on April 11th and 12th I made an examination of that part of my Survey No. 3367, at Ray, Arizona, as reported in error by Mr. O.C. Thompson, in his Survey No. 3381, and give below the results of my examination:-

COLORADO LODE.

From Cor. No. 2, - S 17 44'E ^(O.C.T. 17° 46')
1187.24 Intersects the North side line (line 2-3) Satellite No. 2 Lode, Sur. No. 3381, at point N 71 57½'E, 123.99 feet ^(O.C.T. 124.0) from Cor. No. 2.

1500.00 To Cor. No. 3.

Thence S 71 14½'W

124.01 Cor. No. 4.

Whence Cor. No. 1, Satellite No. 2 Lode, Sur. No. 3381, bears S 19 14'E, 284.03 feet.

Thence N 17 44'W

314.31 Cor. No. 2, Satellite No. 2 Lode, Sur. No. 3381,

Whence Cor. No. 1, this lode, bears S 18 27'E, 598.30 feet. ^{18° 29'}

" Cor. No. 3, " " , bears N 71 57½'E, 1315.61 ft. ^{71° 56'}

" Cor. No. 2, Sweepstake Lode, Sur. No. 2572, bears N 86 23'E, 558.75 feet.

1500.00 Cor. No. 1

* * * * *

ADVENTURE LODE.

From Cor. No. 2, S 17 44'E ^(O.C.T. 17° 46')

1194.40 Intersects line 2-3, Satellite No. 2 Lode, Sur. No. 3381, at point N 71 57½'E, 723.95 feet from Cor. No. 2.

1238.93 Intersects line 2-3 Sweepstakes Lode, Sur. No. 2572, at point N 44° 33'E, 205.66 feet from Cor. No. 2.

1380.62 Intersects line 3-4, Juarez lode, this survey, at point N 83° 30'E, 175.79 feet from Cor. No. 4.

1500.00 Cor. No. 4

Thence S 71 16½'W ^{15 1/2}

93.38 Intersects line 1-2, Sweepstake Lode, Sur. No. 2572, 3381,

at point S 45 42'E, 189.12 feet from Cor.No.2.
 1600.04 Cor.No.4.
 Thence N 17 44'W
 312.76 Intersects line 2-3; Satellite No.2 Lode, Sur.No.338I,
 at point N 71 57 1/2'E, 123.99 feet from Cor.No.2.
 1500.00 Cor.No.1.

JUAREZ LODE :-

From Cor.No.2, S 11 4'E
 1025.01 Cor.No.3, Sweepstake Lode, Sur.No.2572.
 Whence Cor.No.2, this lode, bears S 44 33'W, 737.68 feet.
 1226.88 Intersects line 2-3, Satellite No.2 Lode, Sur.No.338I,
 at point S 71 57 1/2'W, 144.13 feet from Cor.No.3.
 1500.00 Cor.No.3. Whence Cor.No.3, Satellite No.2 Lode, Sur.No.338I
 bears N 15 8 1/2'E, 323.93 feet.
 Thence S 83 30'W
 423.97 Intersects line 2-3, Adventure Lode, this survey, at
 point S 17 44'E, 1380.62 feet from Cor.No.2.
 599.76 Cor.No.4.
 Whence Cor.No.2, Satellite No.2 Lode, Sur.No.338I, bears
 S 87 18'W, 571.05
 Cor.No.3, Adventure lode, this survey, bears S 66 2'E,
 230.93 feet.
 Cor.No.2, Sweepstake Lode, Sur.No.2572, bears N 56 54'W,
 15.26 feet.
 Thence N 11 4'W
 18.12 Intersects line 2-3, Sweepstake Lode, Survey No.2572, at
 point N 44 33'E, 13.26 feet from Cor.No.2.
 152.21 Intersects line 2-3, Satellite No.2 Lode, Sur.No.338I,
 at point S 71 57 1/2' W, 746.42 feet from Cor.No.3.
 1500.00 To Cor.No.1.

REMARKS:- I found Cor.No.4, Colorado Lode, this survey,
 slightly loose, and its surrounding monument of stones
 partly demolished.

Cor.No.2, Sweepstake Lode, Sur.No.2572, a post, I found
 loose and leaning badly to the S.W. Hence I took the
 true corner point as N 77 55'W, 12.30 feet, from its

U.S. MINERAL SURVEY NO. 3367.

bearing rock, as given in original notes, same being in good condition. The location of this corner was determined in the same way in my original survey.

NOTE. Cor.No.4, Truman Lode, Sur.No.1581, formerly set at the east edge and above a steep excavation, I found to have apparently been moved to prevent its loss thru caving. Its present position is 5.43 feet due east from its true point.

Paul E. Fernald.
U.S. Mineral Surveyor
Ajo, Ariz. April 25th. 1918.

STATE OF ARIZONA,

County of Pima ss.

Before me A. B. Thomas, a Notary Public in and for the

County of Pima, State of Arizona, on this day personally appeared Paul E. Fernald and

~~wife of said~~ Paul E. Fernald, known to me to be the persons whose names are subscribed to the foregoing instrument, and acknowledged to me that they executed the same for the purposes and consideration therein expressed.

Given under my hand and seal of office this 25 day of April, A. D. 1918.

A. B. Thomas
Notary Public.

(My Commission Expires)