

Copied 10-8-1917,

A L H

4-683

Platted

May 1 1917
JUL 16 1917

MINERAL SURVEY No. 3390

LOT No.

ARIZONA Land District.

FIELD NOTES

OF THE SURVEY OF THE MINING CLAIM OF

BISBEE WARREN COPPER CO.

KNOWN AS THE

GOLCONDA, APEX, HOLD OVER, HORSE SHOE, SUNSHINE, NANCY HANKS lodes

WARREN Mining District,

COCHISE County, ARIZONA

Section and 18 Unapp'd., Township 23 S., Range 25 E.
13 Unapp'd., Township 23 S., Range 24 E.

Surveyed under instructions dated April 26th, 1917.

by Ralph L. Motz
U. S. Mineral Surveyor.

Claim located see location notices attached

Survey commenced May 8th, 1917.

Survey completed May 16th, 1917.

Address of claimant J.C. Collins, Pres, Box 1129,
Bisbee, Arizona.

Address of claimant's attorney. ~~Fred Sutter, Attorney,~~
Bisbee, Arizona.

DATES OF AMENDED LOCATIONS.

GOLCONDA.lode

Beginning at Cor No 1, the N W Cor, identical with location and with Cors No 1 and 1 of Sur No 3389 Copper Wedge lode and Sunshine lode of this survey, respectively, a pine post 4 ft long 4 ins sq set 18 ins in the ground in a mound of stones and scribed 1-3390 G, whence a sandstone ledge 10 x 15 x 18 ins exposure chiseled BR x 1-3390 brs N 67° 13' E 22.0 ft., and a second sandstone ledge with 14 x 14 x 11 ins exposure and like chiseling brs S 33° 04' W 17.6 ft., and the W 1/4 Cor of Sec 18, T 23 S., R 25 E., G & S R B & M brs N 81° 55' W 157.9 ft.

thence S 88° 55' E

437.7 to Cors No 1, 1 and 5 of Sur No 2425 Delta lode, Sur No 3389 Sulphide and Copper Wedge lodes, respectively,

1494.2 to Cor No 2, the N E Cor, identical with location and with Cor No 1 Sur No 3388 Wildflower lode and situated on line 4-1 Sur No 2425 Delta lode at N 88° 55' W 443.5 ft from Cor No 4, a pine post 4 ft long 4 ins sq set 18 ins in the ground in a mound of stones and scribed 2-3390 G, No bearings available.

thence S 2° 24' W

78.8 along line 1-6 Sur No 3388 Wildflower lode to west end center Sur No 3388 Wildflower lode,

300.0 to original location for east end center, being a mound of stones 3 ft high with a 3 ft base,

378.8 to Cor No 6 and the northwest corner of Sur No 3388 Wildflower lode and Anvil lode unsurveyed, respectively,

600.0 to Cor No 3, the S E Cor, identical with location and with Cor No 2 Hold Over lode of this survey, a pine post 4 ft long 4 ins sq set 18 ins in the ground in a mound of stones and scribed 3-3390 G, whence a sandstone rock in place 8 x 13 x 12 ins above ground chiseled BR x 3-3390 brs N 57° 55' W 16.4 ft, and a second sandstone rock in place 24 x 22 x 6 ins above ground with like chiseling brs S 31° 11' E 34.5 ft.

thence N 88° 55' W

1494.2 to Cor No 4, the S W Cor, identical with location and with Cor No 1 Hold Over lode of this survey, a pine post 4 ft long 4 ins sq set 18 ins in the ground in a mound of stones and scribed 4-3390 G, whence a sandstone ledge with 36 x 12 x 18 ins exposure chiseled BR x 4-3390 brs S 71° 41' E 18.3 ft, and a second sandstone ledge with like chiseling 14 x 22 x 9 ins high exposure brs N 10° 11' E 13.6 ft.

thence N 2° 24' E

300.0 to original location for west end center being a mound of stones 3 ft high with a 3 ft base,

600.0 to Cor No 1 the place of the beginning.

HOLD OVER lode.

Beginning at Cor No 1, the N W Cor, identical with location and with Cor No 4 Golconda lode of this survey, heretofore described to which I add 1-3390 H O for this claim, the W 1/4 Cor of Sec 18, T 23 S., R 25 E., G & S R B & M brs N 11° 55' W 635.4 ft.

thence S 88° 55' E

1494.2 to Cor No 2, the N E Cor, identical with location and with Cor No 3 Golconda lode of this survey, heretofore described to which I add 2-3390 H O for this claim.

thence S 2° 24' W

300.0 to original location for east end center, being a mound of stones 3 ft high with a 3 ft base,

395.8 to the southwest and northwest corners of Anvil and Forge lodes, both unsurveyed, respectively,

600.0 to Cor No 3, the S E Cor, identical with location and with Cor No 3 Horse Shoe lode of this survey, a pine post 4 ft long 4 ins sq set 18 ins in the ground in a mound of stones and scribed 3-3390 H O, whence a sandstone ledge with 19 x 23 x 9 ins high exposure chiseled BR x 3-3390 brs N 45° 13' W 27.9 ft., and a second sandstone rock in place 15 x 18 x 11 ins above ground with like chiseling brs N 75° 35' E 30.9 ft.

1494.2 to Cor No 4, the S W Cor, identical with location and with Cor No 2 Horse Shoe lode of this survey, a pine post 4 ft long 4 ins sq set 18 ins in the ground in a mound of stones and scribed 4-3390 H O, whence a sandstone ledge with 12 x 15 x 8 ins high exposure chiseled BR x 4-3390 brs S 75° E 31.2 ft.

thence N 2° 24' E
 300.0 to original location for west end center being a mound of stones 3 ft high with a 3 ft base,

600.0 to Cor No 1, the place of the beginning.

HORSE SHOE. lode

Beginning at Cor No 1, the S W Cor, identical with location a pine post 4 ft long 4 ins sq set 18 ins in the ground in a mound of stones and scribed 1-3390 H S, whence a sandstone rock in place 19 x 23 x 22 ins above ground chiseled BR x 1-3390 brs S 89° 36' E 19.3 ft, and a second sandstone rock in place 41 x 21 x 21 ins above ground with like chiseling brs N 4° 07' W 23.7 ft., and the Cor for the S W Cor of Sec 18 and the N W Cor of Sec 19, T 23 S., R 25 E., G & S R B & M brs S 8° 25' W 833.2 ft.

thence N 2° 24' E
 300.0 to the west end center location, identical with Cor No 2 Sunshine lode of this survey, and situated on line 2-3 Apex lode of this survey, a pine post 4 ft long 4 ins sq set 18 ins in the ground in a mound of stones and scribed W E Ct H S,

600.0 to Cor No 2, the N W Cor, identical with location and with Cor No 4 Hold Over lode of this survey, heretofore described to which I add 2-3390 H S for this claim.

thence S 88° 55' E
 1494.2 to Cor No 3, the N E Cor, identical with location and with Cor No 3 Hold Over lode of this survey, heretofore described to which I add 3-3390 H S for this claim.

thence S 2° 24' W
 300.0 to original location for east end center, being a mound

of stones 3 ft high with a 3 ft base,

413.8 to southwest corner Forge lode, unurveyed,

494.5 to Cor No 4, the S E Cor, identical with location, a pine post 4 ft long 4 ins sq set 18 ins in the ground in a mound of stones and scribed 4-3390 H S, whence a sandstone ledge with 24 x 35 x 19 ins high exposure chiseled BR x 4-3390 brs S 79° 42' E 22.9 ft., and a second sandstone ledge with 33 x 17 x 11 ins exposure and like chiseling brs S 53° 19' W 32.2 ft.

thence S 87° 03' W

374.9 intersect line 3-4 Apex lode of this survey at S 12° 27' W 191.9 ft from Cor No 3, and N 12° 27' E 208.8 ft from Cor No 4,

1500.3 to Cor No 1, the place of the beginning.

APEX lode.

Beginning at Cor No 1, the S W Cor, identical with location and with Cors No 4 and 2 of Sur No 2454 William B. Moore lode and Vic Roy lode, respectively, a pine post 4 ft long 4 ins sq set 18 ins in the ground in a mound of stones and scribed 1-3390 A, and the Cor for the S W Cor of Sec 18 and the N W Cor of Sec 19, T 23 S., R 25 E., G & S R B & M brs S 19° 29' E 870.9 ft. No bearings available.

thence N 12° 27' E

82.4 to original location for west end center being a mound of stones 3 ft high with a 3 ft base,

132.0 intersect line 2-3 Sunshine lode of this survey, at N 66° 17' E 235.3 ft from Cor No 3, and S 66° 17' W 432.9 ft from Cor No 2,

327.4 to Cor No 2, the N W Cor, identical with location, a pine post 4 ft long 4 ins sq set 18 ins in the ground in a mound of stones and scribed 2-3390 A, whence a sandstone ledge with 18 x 21 x 11 ins exposure chiseled BR x 2-3390 brs S 76° 11' W 18.5 ft, and a second sandstone ledge with 42 x 18 ins exposure with like chiseling brs N 23° 57' E 3.3 ft.

W 125° 45' thence S 87° 18' E

237.6 intersect west boundary of Sec 18, at S 0° 53' W 1515.5 ft. from the W 1/4 Cor of Sec 18, and N 0° 53' E 1129.7 ft. from the S W Cor of Sec 18, T 23 S., R 25 E.,

354.6 to Cor No 2 and the West end center, of Sunshine lode and Horse Shoe lode of this survey, respectively,

1508.6 to Cor No 3, the N E Cor, identical with location, a pine post 4 ft long 4 ins sq set 18 ins in the ground in a mound of stones and scribed 3-3390 A, whence a sandstone ledge with 27 x 27 x 18 ins high exposure chiseled BR x 3-3390 brs S 15° 17' W 37.0 ft., and a second sandstone ledge with like chiseling and 42 x 17 x 34 ins exposure brs S 69° 02' E 28.7 ft.

191.9 intersect line 4-1 of Horse Shoe lode of this survey, 302.6 to original location for east end center being a mound of stones 3 ft high with a 3 ft base,

400.7 to Cor No 4, the S E Cor, identical with location and with Cor No 3 Sur No 2454 Vic Roy lode, a pine post 4 ft long 4 ins sq set 18 ins in the ground in a mound of stones and scribed 4-3390 A, whence a sandstone ledge with 28 x 19 x 21 ins exposure chiseled BR x 4-3390 brs S 68° 17' W 4.2 ft and a second sandstone ledge with 12 x 24 x 14 ins exposure and like chiseling brs N 57° 01' E 6.6 ft.

1193.9 along line 3-2 Sur No 2454 Vic Roy lode, intersect west boundary of Sec 18, at S 0° 53' W 1853.1 ft from the W 1/4 Cor of Sec 18 and N 0° 53' E 792.1 ft from the S W Cor of Sec 18, T 23 S., R 25 E.,

1497.9 to Cor No 1, the place of the beginning.

SUNSHINE lode.

Beginning at Cor No 1, the N E Cor, identical with location and with Cor No 1 Golconda lode of this survey, heretofore described to which I add 1-3390 S for this claim. The W 1/4 Cor of Sec 18, T 23 S., R 25 E., G & S R B & M brs N 81° 55' W 157.9 ft.

thence S 2° 24' W

300.0 to west end center Golconda lode of this survey,

600.0 to Cors No 4 and 1 of Golconda and Hold Over lodes of this survey, respectively.

900.0 to west end center of Hold Over lode of this survey,

1200.0 to Cors No 4 and 2 of Hold Over and Horse Shoe lodes of this survey, respectively,

1500.0 to Cor No 2, the S E Cor, identical with location and with the west end center of Horse Shoe lode of this survey,

heretofore described to which I add 2-3390 S for this

claim, whence a sandstone rock with 12 x 7 x 11 ins ex-

posure chiseled BR x 2-3390 brs N 57° 36' W 24.7 ft., and

a second sandstone ledge with 13 x 8 x 10 ins exposure

and like chiseling brs N 16° 26' E 44.0 ft, and Cor No

2 Apex lode of this survey brs N 87° 18' W 354.6 ft.

thence S 66° 17' W

128.6 intersect west boundary of Sec 18, at S 0° 53' W 1572.8

ft from the W 1/4 Cor of Sec 18, and N 0° 53' E 1072.4 ft

from the S W Cor of Sec 18, T 23 S., R 25 E.,

334.1 to original location for south end center being a mound

of stones 3 ft high with a 3 ft base,

432.9 intersect line 1-2 Apex lode of this survey, S 12° 27' W 195.4 ft.
from Cor. No. 2.

668.2 to Cor No 3, the S W Cor, identical with location and

with Cor No 2 Nancy Hanks lode of this survey, a pine

post 4 ft long 4 ins sq set 18 ins in the ground in a

mound of stones and scribed 3-3390 S, whence a sandstone

ledge with 48 x 30 x 11 ins exposure chiseled BR x 3-3390

brs S 24° 04' W 11.2 ft., and a second sandstone ledge

with 24 x 24 x 4 ins high exposure and like chiseling brs

N 24° 45' E 33.0 ft.

thence N 2° 24' E

1500.0 to Cor No 4, the N W Cor, identical with location and with

Cor No 1 Nancy Hanks lode of this survey and situated on

line 1-2 Sur No 3389 Copper Wedge lode, a pine post 4 ft

long 4 ins sq set 18 ins in the ground in a mound of

stones and scribed 4-3390 S, whence a sandstone ledge with

MINERAL SURVEY NO. 3390 (Cont'd.)

26 x 19 x 13 ins high exposure chiseled BR x 4-3390 brs S $15^{\circ} 45'$ W 57.5 ft and a sandstone rock in place 18 x 18 x 11 ins above ground with like chiseling brs S $8^{\circ} 19'$ E 34.7 ft.

thence N $66^{\circ} 17'$ E

334.1 to original location for north end center being a mound of stones 3 ft. high with a 3 ft. base,

495.9 intersect west boundary of Sec 18, at S $0^{\circ} 53'$ W 91.5 ft from the W $\frac{1}{4}$ Cor of Sec 18, and N $0^{\circ} 53'$ E 2553.7 ft from the S W Cor of Sec 18, T 23 S., R 25 E.

668.2 to Cor No 1, the place of the beginning.

NANCY HANKS. lode.

Beginning at Cor No 1, the N E Cor, identical with location and with Cor No 4 Sunshine lode of this survey, heretofore described to which I add 1-3390 N H for this claim. The W $\frac{1}{4}$ Cor of Sec 18, T 23 S., R 25 E., G & S R B & M brs N $57^{\circ} 26'$ E 540.4 ft.

thence S $2^{\circ} 24'$ W

1500.0 to Cor No 2, the S E Cor, identical with location and with Cor No 3 Sunshine lode of this survey, heretofore described to which I add 2-3390 N H for this claim.

thence S $66^{\circ} 17'$ W

213.6 intersect line 3-4 Sur No 2454 William B. Moore lode at S $82^{\circ} 18'$ W 386.0 ft from Cor No 4, and N $82^{\circ} 18'$ E 203.5 ft from Cor No 3,

334.1 to original location for south end center, being a mound of stones 3 ft high with a 3 ft base,

450.0 intersect line 2-3 Sur No 2454 William B. Moore lode at S $12^{\circ} 16'$ W 69.4 ft from Cor No. 3, and N $12^{\circ} 16'$ E 1423.4 ft from Cor No 2,

668.2 to Cor No 3, the S W Cor, identical with location, a pine post 4 ft long 4 ins sq set 18 ins in the ground in a mound of stones and scribed 3-3390 N H, whence a sandstone ledge with 21 x 42 x 43 ins exposure chiseled BR x 3-3390 brs S $74^{\circ} 30'$ E 30.0 ft and a second sandstone ledge with like chiseling and 34 x 32 x 44 ins exposure brs N 47°

55' E 25.8 ft. Cor No 3 Sur No 2454 William B. Moore lode
 brs N 54° 03' E 265 ft., Cor No 2 Sur No 3137 Jack Pot
 No 2 lode brs N 20° 49' E 356.7 ft.

thence N 2° 24' E

367.5 intersect line 2-3 Sur No 3137 Jack Pot No 2 lode at N 73°
 09' W 116.4 ft from Cor No 2 and S 73° 09' E 1383.6 ft
 from Cor No 3,

987.0 intersect line 4-1 Sur No 3137 Jack Pot No 2 lode at N 73°
 09' W 22.7 ft from Cor No 1 and S 73° 09' E 1477.3 ft
 from Cor No 4. Cor No 2 Sur No 3137 Jack Pot No 2 lode
 brs S 5° 38' E 649.2 ft from Cor No 1 of same survey.

1021.0 intersect line 2-3 Sur No 3389 Carbonate lode at N 77° 57'
 W 413.6 ft from Cor No 2 and S 77° 57' E 118.7 ft from
 Cor No 3,

1500.0 to Cor No 4, the N W Cor, identical with location, a pine
 post 4 ft long 4 ins sq set 18 ins in the ground in a
 mound of stones and scribed 4-3390 N H, whence a sandstone
 ledge with 16 x 14 ins exposure chiseled BR x 4-3390 brs
 S 9° 38' E 9.9 ft and a second sandstone ledge with 24 x
 21 x 4 ins high exposure with like chiseling brs S 75° 40'
 W 18.0 ft. Cor No 2 Sur No 3389 Carbonate lode brs S 34°
 14' E 683.3 ft.

thence N 66° 17' E

334.1 to original location for north end center, being a mound
 of stones 3 ft high with a 3 ft base,

454.1 to Cor No 2 Sur No 3389 Copper Wedge lode, also intersect
 line 1-2 Sur No 3389 Carbonate lode at S 2° 24' W 737.3
 ft from Cor No 1, and N 2° 24' E 748.2 ft from Cor No 2,

668.2 to Cor No 1 the place of the beginning.

LEDGES.

GOLCONDA.

The resumed course of the vein on this claim is from the
 west end center location S 88° 55' E 1494.2 ft.

HOLD OVER.

The presumed course of the vein on this claim is from the
 east end center location N 88° 55' W 1494.2 ft.

HORSE SHOE.

The presumed course of the vein on this claim is from the east end center location N 88° 55' W 1494.2 ft.

APEX.

The presumed course of the vein on this claim is from the east end center location N 85° 08' W 1499.9 ft.

SUNSHINE.

The presumed course of the vein on this claim is from the north end center location S 2° 24' W 1500.0 ft.

NANCY HANKS.

The presumed course of the vein on this claim is from the north end center location S 2° 24' W 1500.0 ft.

AREAS.

Total area of Golconda lode - - - - -	20.576 A.
Total area of Hold Over lode - - - - -	20.576 A.
Total area of Horse Shoe lode - - - - -	18.767 A.
Total area of Sunshine lode - - - - -	20.660 A.
Total area of Nancy Hanks lode - - - - -	20.660 A.
Area in conflict with	
Sur No 2454 William B. Moore ^{lode} - - - - -	0.152 A.
Sur No 3137 Jack Pot No 2 ^{lode} - - - - -	0.958 A.
Sur No. 3389, Carbonate ^{lode} - - - - -	5.743 A.
Total area of Apex lode - - - - -	12.427 A.
Area in conflict with	
Horse Shoe lode of this	
survey - - - - -	6.364 A.
Sunshine lode of this	
survey - - - - -	0.784 A.

IMPROVEMENTS.

I certify that the value of the labor and improvements made upon or for the benefit of each claim of this survey by the claimant or its grantors, was at the time of survey as follows:-

SUNSHINE.

- No.1. Discovery shaft 4 x 6 x 10 ft deep, brs from north end center on lode line 150 ft. Value \$ 60.00
- No.2. Open cut 4.5 x 8 x 12 ft long brg S 70° E, mouth of which brs from Cor No 3 N 32° 36' E 82.0 ft. Value \$ 50.00
- No.3. Open cut 4.5 x 8 x 8 ft long, with tunnel at face 4.5 x 5 x 6 ft long, both brg S 70° E mouth of open cut brs from Cor No 3 N 29° 45' E 100.3 ft. Value \$ 60.00
- No.4. Open cut 4 x 8 x 14 ft long brg S 85° E, mouth of which brs from Cor No 3 N 23° 30' E 102.4 ft. Value \$ 60.00

No.5.	Open cut 4 x 8 x 12 ft long brg east, mouth of which brs from Cor No 3 N 23° 45' E 112.1 ft.	Value \$ 50.00
No.6.	Open cut 4.5 x 8 x 17 ft long brg east, mouth of which brs from Cor No 3 N 16° 21' E 117.9 ft.	Value \$ 80.00
No.7.	Open cut 4 x 8 x 17 ft long brg east, mouth of which brs from Cor No 3 N 10° 30' E 134.2 ft.	Value \$ 75.00
No.8.	Open cut 5 x 10 x 19 ft long, with tunnel at face 5 x 6 x 9 ft long, both brg S 85° E, the mouth of open cut brs from Cor No 1 S 18° 13' W 826.5 ft.	Value \$200.00
No.9.	Open cut 4 x 7 x 17 ft long, brg S 85° E, mouth of which brs from Cor No 1 S 19° 04' W 849.8 ft.	Value \$ 40.00
No.10.	Open cut 5 x 13.5 x 22 ft long, with tunnel at face 4.5 x 6.5 x 81 ft long, both brg S 35° 22' E, the mouth of open cut brs from Cor No 1 S 54° 22' W 174.2 ft. Value of Cut \$195.00 Value of tunnel at \$12.50 per foot \$1125.00. Total \$1320.00 1/4 interest in this tunnel has been allotted to each of the following claims, Nancy Hanks, Sunshine, Hold Over and Horse Shoe. This improvement was done before the location of the Apex and Golconda lodes, for this reason no interest in tunnel has been allotted to these two claims. 1/4 interest allotted to this claim	\$330.00
No.11.	Open cut 8.5 x 10 x 14 ft long, brg N 75° E, mouth of which brs from Cor No 1, S 23° 31' W 773.7 ft.	Value \$100.00
No.12.	Open cut 4 x 8 x 16 ft long, mouth of which brs from Cor No 4 S 6° 03' E 691.0 ft. Cut brs S 60° W.	Value \$100.00
Total		\$1205.00

NANCY HANKS.

No.1.	Discovery shaft 4 x 6 x 10 ft deep, brs from north end center on lode line 500 ft.	Value \$ 60.00
No.2.	Open cut 7 x 10 x 23 ft long, brg S 14° W, mouth of which brs from Cor No 1 S 22° 09' W 600 ft.	Value \$ 225.00
No.3.	Open cut 5 x 10 x 15 ft long, with tunnel in face 4 x 6 x 7 ft long, both brg S 65° W, mouth of open cut brs from Cor No 1 S 37° 28' W 336.8 ft.	Value \$ 110.00
1/4 interested in improvement No 10 Sunshine lode of this survey, allotted to this claim		\$ 330.00
Total		\$ 725.00

HOLD OVER.

No.1.	Discovery open cut 4 x 10 x 15 ft long, brg south, mouth of which brs from west end center on lode line 495.0 ft.	Value \$ 75.00
No.2.	Open cut 8 x 9 x 15 ft long, brg S 17° E, mouth of which brs from Cor No 4 N 63° 24' E 611.0 ft.	Value \$ 135.00

No.3. Open cut 4 x 12 x 19 ft long, with tunnel at face 4 x 6 x 13 ft long, both brg S 30° W, mouth of open cut brs from Cor No 1, S 63° 20' E 522.6 ft. Value \$ 265.00

1/4 interest in improvement No 10 Sunshine lode of this survey, allotted to this claim \$ 330.00

Total \$ 805.00

HORSE SHOE.

No.1. Discovery shaft 4 x 6 x 10 ft deep brs from east end center on lode line 750 ft. Value \$ 60.00

No.2. Open cut 4 x 10 x 26 ft long, brg N 35° W, mouth of which brs from Cor No 2 S 81° 57' E 758.0 ft. Value \$ 175.00

No.3. Shaft 4 x 6 x 10 ft deep brs from Cor No. 2 S 85° 39' E 728.5 ft. Value \$ 60.00

No.4. Shaft 4 x 6 x 10 ft deep brs from Cor No 2 S 87° 45' E 679.0 ft. Value \$ 60.00

1/4 interest in improvement No 10 Sunshine lode of this survey, allotted to this claim \$ 330.00

Total \$ 685.00

GOLCONDA.

No.1. Discovery shaft 4 x 6 x 8 ft deep, brs from west end center on lode line 300 ft. Value \$ 50.00

APEX.

No.1. Discovery open cut 4.5 x 10 x 10 ft long, brg N 17° W, face of which brs from west end center on lode line 60.0 ft. Value \$ 50.00

OTHER IMPROVEMENTS.

GOLCONDA.

Open cut 4 x 10 x 16 ft long, with tunnel in face 4 x 6 x 7 ft long, both brg S 73° E, mouth of open cut brs from Cor No 1 S 68° 57' E 799.0 ft.

Open cut 5 x 10 x 19 ft long brg S 73° E, mouth of which brs from Cor No 1 S 70° 49' E 791.0 ft.

Shaft 4 x 6 x 8 ft deep brs from Cor No 1 S 82° 27' E 800.0 ft.

Open cut 4 x 8 x 14 ft brg west, brs from Cor No 1 S 60° 43' E 590.0 ft.

Open cut 9 x 8 x 18 ft long, brg west, brs from west end center on lode line 520.0 ft.

Open cut 5 x 10 x 19 ft long brg west, brs from Cor No 4 N 70° 50' E 477.5 ft.

APEX.

Open cut 4 x 8 x 14 ft long, brg N 34° E, brs from Cor No 1 N 79° 21' E 182.0 ft.

Open cut 4 x 8 x 15 ft long brg S 60° W brs from Cor No 1 N 82° 40' E 151.0 ft.

Note. Report of additional improvements on the Golconda and Apex lodes will be filed prior to expiration of the period of publication of the notice of application for patent.

ADJOINING CLAIMS.

- North. Sur No 3389 Carbonate, Copper Wedge and Sulphide lodes,
Sur No 2425 Delta lode.
- East. Sur No 3388 Wildflower lode, Anvil, Forge and Copper Era lodes, unsurveyed, owned by John FitzPatrick.
- South. Copper Era lode, unsurveyed, owned by John FitzPatrick,
Sur No 2454 Vic Roy and William B. Moore lodes.
- West. Sur No 3137 Jack Pot No 2 lode, Sur No 3389 Carbonate lode.

LOCATION.

This survey is located in Sec. 13, ^{Unappd,} T 23 S., R 24 E., and
Sec 18, T 23 S., R 25 E., G & S R B & M.

INSTRUMENT.

This survey was made with a Gurley Light Mountain transit.

The courses were deflected from the true meridian as determined by a direct solar observation. The distances were measured with a 300 foot steel tape. Magnetic variation $12^{\circ} 30'$ East at all corners.

REPORT.

The W 1/4 Cor of Sec 18, T 23 S., R 25 E., is an iron pipe 1" in diameter set in the ground, with a 2" brass cap marked 1/4 S 18.

The S W Cor of Sec 18 and the N W Cor of Sec 19, T 23 S., R 25 E., is a sandstone rock 14 x 12 x 8 ins high, chiseled III on east and III on south side. A monument of stones along side.

The witness corner for east 1/4 Cor of Sec 13 T 23 S, R 24 E., brs $S 0^{\circ} 53' W$ 8.5 ft from the W 1/4 Cor. of Sec. 18, T. 23 S., R. 25 E.

The S E Cor of Sec 13 and the N E Cor of Sec 24 T 23 S., R 24 E., brs $S 1^{\circ} W$ 26.0 ft from the S W Cor of Sec 18 T 23 S., R 25 E., This is an iron pipe 2" in diameter, with a 3" brass cap marked S 13 S 24 T 23 S, R 24 E.

Ralph L. Moz

Bisbee, Arizona.

U.S. Mineral Surveyor.

May 22nd, 1917.

*about
10-10-17
13 2425
(see Sur 3389)*

FINAL OATHS FOR SURVEYS.

LIST OF NAMES.

A list of the names of the individuals employed by Ralph L. Motz
 United States ~~Deputy~~ Mineral Surveyor, to assist in running, measuring, and marking the lines, corners, and
 boundaries described in the foregoing field notes of the survey of the mining claim of
Bisbee Warren Copper Co.,
 known as the Apex, Golconda, Hold Over, Horse Shoe, Sunshine, Nancy Hanks lodes
 and showing the respective capacities in which they acted.

J. H. Duncan, Chainman.
 _____, Chainman.
 _____, Assman.
 _____, Flagman.

FINAL OATHS OF ASSISTANTS.

~~We~~ I J. H. Duncan
 and _____, do solemnly swear that ~~we~~ I assisted
Ralph L. Motz, United States ~~Deputy~~ Mineral Surveyor, in marking the corners and surveying
 the boundaries of the mining claim of Bisbee Warren Copper Co.,
 known as the Golconda, Apex, Hold Over, Horse Shoe, Sunshine, Nancy Hanks lode
 represented in the foregoing field notes as having been surveyed by said ~~deputy~~ mineral surveyor and under his
 direction; and that said survey has been in all respects, to the best of ~~our~~ ^{my} knowledge and belief, faithfully and
 correctly executed, and the corner and boundary monuments established according to law and the instructions
 furnished by the United States Surveyor-General for Arizona.

J. H. Duncan, Chainman.
 _____, Chainman.
 _____, Assman.
 _____, Flagman.

Subscribed and sworn to by the above-named persons before me this 22 nd
 day of May, 19 17.

J. W. Ross
 Notary Public in and for the County
 of Cochise, State of Arizona.

(4-686.)

FINAL OATH OF U. S. ~~DEPUTY~~ MINERAL SURVEYOR

I, Ralph L. Motz, U. S. ~~Deputy~~ Mineral Surveyor, do solemnly swear that, in pursuance of instructions received from the United States Surveyor General for Arizona, dated April 26, 1917, I have, in strict conformity to the laws of the United States, the official regulations and instructions thereunder, and the instructions of said Surveyor General, faithfully and correctly executed the survey of the Mining Claim of Bisbee Warren Copper Co., known as the GOLCONDA, APEX, HOLD OVER, HORSE SHOE, SUNSHINE, NANCY HANKS, situate in Warren Mining District, Cochise County, Arizona, in Section 13 & 18, Township No. 23 S, Range No. 24 E 7 25 E G & S R B & M, and designated as Survey No. 3390, as represented in the foregoing field notes, which accurately show the boundaries of said mining claim as distinctly marked by monuments on the ground, and described in the attached copy of the location certificate, which was received by me from the Surveyor General with said instructions, and that all the corners of said survey have been established and perpetuated in strict accordance with the law, official regulations and instructions thereunder; and I do further solemnly swear that the foregoing are the true and original field notes of said survey and my report therein, and that the labor expended and improvements made upon said mining claim by claimant or its grantors are as therein fully stated, and that the character, extent, location and itemized value thereof are specified therein with particularity and full detail, and that no portion of said labor or improvements so credited to this claim has been included in the estimate of expenditures upon any other claim.

Ralph L. Motz
U. S. ~~Deputy~~ Mineral Surveyor.

Subscribed and sworn to by the said Ralph L. Motz,
U. S. ~~Deputy~~ Mineral Surveyor, before me J. W. Ross, Notary
Public this 22 nd
day of May, 1917.

J. W. Ross

Notary Public, in and for the
County of Cochise, State of
Arizona.

My Commission expires Feb'y 21, 1920.

Jan. 26 1917

Notice of Mining Location

LODE CLAIM

TO ALL WHOM IT MAY CONCERN:

This Mining Claim, the name of which is the Golconda

Mining Claim, situate on lands belonging to the United States of America, and in which there are valuable mineral deposits, was entered upon and located for the purpose of exploration and purchase by N. F. D. Nichols and James Ovens

citizens of the United States

(Locator must insert either "a citizen of the United States," or "who has declared his intention to become a citizen of the United States.")

the undersigned, on the 17th day of January, 1917.

The length of this claim is 1500 feet,

and we claim 300 feet,

in a westerly direction and 1200

feet in a easterly direction from

the center of the discovery shaft, at which this notice is posted, lengthwise of the claim, together with

300 feet in width of the surface grounds, on each side

of the center of said claim. The general course of the lode deposit and premises is from the

west to the east

~~the center of~~ this claim is located in the Warren Mining District, in

Cochise County in the State of Arizona, about 1/2 mile

in a northerly direction from the southwest corner of Sec

18, Tp 23 S. R 25 E. It is bounded on the north by the Delta and

Copper Wedge lodes, on the east by unknown claim, on the south by

Holdover, and on the west by the Sunshine.

The surface boundaries of the claim are marked upon the ground as follows: Beginning at

a monument of stones

at a point in a westerly direction 300 feet from

the discovery shaft (at which this notice is posted), being in the center of the west

end line of said claim; thence northerly 300 feet to a post and

monument, being the northwest corner of said claim; thence

easterly 1500 feet to a post and monument, being at the

northeast corner of said claim; thence southerly 300 feet

to a monument at the center of the east end of said claim;

thence southerly 300 feet to a post and monument being at the

southeast corner of said claim; thence westerly 1500 feet

to a post and monument at the southwest corner of said claim;

thence northerly 300 feet to the place of beginning.

Dated and posted on the grounds this 17th day of January, 1917.

N. F. D. Nichols

James Ovens

STATE OF ARIZONA,

County of COCHISE

I, [Signature], County Recorder in and for the County and State aforesaid, do hereby certify that the within instrument was filed for record at 10 o'clock P. M., on this JAN 18 1917 day of [Month], 19[Year], and duly recorded in Book No. 57 of [Page] Records of COCHISE County, Arizona, at pages 105.

Record of Mines

WITNESS my hand and official seal the day and year first above written.

[Signature] County Recorder.

Notice of Location
LODE CLAIM

INDEXED
COMPARED
BLOTTED
630

Dated [Date], 19[Year]

Filed and Recorded at request of Collins & Prothero

JAN 18 1917

A. D. 19[Year]

at [Time] M.

Book 57

Pages 105

[Signature] County Recorder.

[Signature] Deputy Recorder.

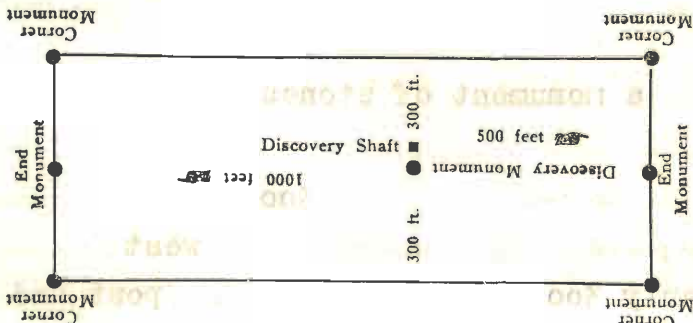

This diagram is to give locator a general idea of plan of location under the new law. The Discovery Shaft can be in the center of claim or any distance from either end desired. In the diagram it is placed 500 feet from one end and 1000 feet from the other. Commence description of claim at a center end monument, giving its distance and direction from center of Discovery Shaft; thence bound the claim in either direction. In description be careful to state locality of claim with reference to some natural object, or permanent monument, as will identify the claim.

Excerpts from the Mining Laws of the State of Arizona.

Title XLVII of the Revised Statutes of 1901, and Amendments thereto.

Sec. 2. Such location shall be made by erecting at or contiguous to the point of discovery a conspicuous monument of stones not less than three feet in height, or an upright post, securely fixed, projecting at least four feet above the ground, in which monument of stones or on which post there shall be posted a location notice which shall be signed by the name or names of the locator or locators.

Sec. 4. From the time of the location of a mining claim, as above specified, the locator shall be allowed ninety days within which to do or cause to be done the following things:

2. To sink a discovery shaft in the claim to a depth of at least eight feet from the lowest part of the rim of the shaft at the surface, and deeper, if necessary, until there is disclosed in said shaft mineral in place.

Sec. 6. Such surface boundaries shall be marked by six substantial posts projecting at least four feet above the surface of the ground, or by substantial stone monuments at least three feet high, to-wit: One at each corner of said claim and one at the center of each end-line thereof.

Sec. 8. Location notices may be amended at any time and the monuments changed to correspond with the amended location; Provided, That no change shall be made that will interfere with the rights of others.

APR 26 1918

Notice of Mining Location

LODE CLAIM

TO ALL WHOM IT MAY CONCERN:

This Mining Claim, the name of which is the APEX
Mining Claim, situate on lands belonging to the United States of America, and in which there are
valuable mineral deposits, was entered upon and located for the purpose of exploration and purchase
by The Bisbee Warren Copper Company
a corporation

(Locator must insert either "a citizen of the United States," or "who has declared his intention to become a citizen of the United States.")

the undersigned, on the 20 th day of March, 1917

The length of this claim is 1500 feet,
and it claim s 60 feet,
in a westerly direction and 1440

feet in a n easterly direction from
the center of the discovery shaft, at which this notice is posted, lengthwise of the claim, together with
300 feet in width of the surface grounds, on each side
of the center of said claim. The general course of the lode deposit and premises is from the

east to the west

~~The length~~ of this claim is situated in the Warren Mining District, in
Cochise County in the State of Arizona, about 3 1/2 miles
in a n easterly direction from Bisbee. Adjoining claims are:-
on the north, Sunshine and Horseshoe; on the east, Copper Era; on
the south, Sur No 2454, Vic Roy.

The surface boundaries of the claim are marked upon the ground as follows: Beginning at
a monument of stones

at a point in a westerly direction 60 feet from
the discovery shaft (at which this notice is posted), being in the center of the west
end line of said claim; thence northerly 300 feet to a post
, being the northwest corner of said claim; thence
easterly 1500 feet to a post, being at the
northeast corner of said claim; thence southerly 300 feet
to a ~~monument~~ monument at the center of the east end of said claim;
thence southerly 100 feet to a post being at the
southeast corner of said claim; thence westerly 1500 feet
to a post at the southwest corner of said claim;
thence northerly 60 feet to the place of beginning.

Dated and posted on the grounds this 20 th day of March, 1917

Bisbee Warren Copper Company
By A. A. Butcher

STATE OF ARIZONA,

County of COCHISE

ss.

I, [Signature] County Recorder in and for the County and State aforesaid, do hereby certify that the within instrument was filed for record at 1 o'clock M., on this MAR 29 1917 day of COCHISE, 19 and duly recorded in Book No. 57 of Records of COCHISE County, Arizona, at pages 481

WITNESS my hand and official seal the day and year first above written.

By J. L. Hutchins [Signature] County Recorder.

Notice of Location
LODE CLAIM

Dated _____, 19____

Filed and Recorded at request of

[Signature]

MAR 29 1917

at _____, A. D. 19____

Book 57

Pages 481

County Recorder.

Deputy Recorder.

Excerpts from the Mining Laws of the State of Arizona.

Title XLVII of the Revised Statutes of 1901, and Amendments thereto.

Sec. 2. Such location shall be made by erecting at or contiguous to the point of discovery a conspicuous monument of stones not less than three feet in height, or an upright post, securely fixed, projecting at least four feet above the ground, in which monument of stones or on which post there shall be posted a location notice which shall be signed by the name or names of the locator or locators.

Sec. 4. From the time of the location of a mining claim, as above specified, the locator shall be allowed ninety days within which to do or cause to be done the following things:

2. To sink a discovery shaft in the claim to a depth of at least eight feet from the lowest part of the rim of the shaft at the surface, and deeper, if necessary, until there is disclosed in said shaft mineral in place.

Sec. 6. Such surface boundaries shall be marked by six substantial posts projecting at least four feet above the surface of the ground, or by substantial stone monuments at least three feet high, to-wit: One at each corner of said claim and one at the center of each end-line thereof.

Sec. 8. Location notices may be amended at any time and the monuments changed to correspond with the amended location; Provided, That no change shall be made that will in terfere with the rights of others.

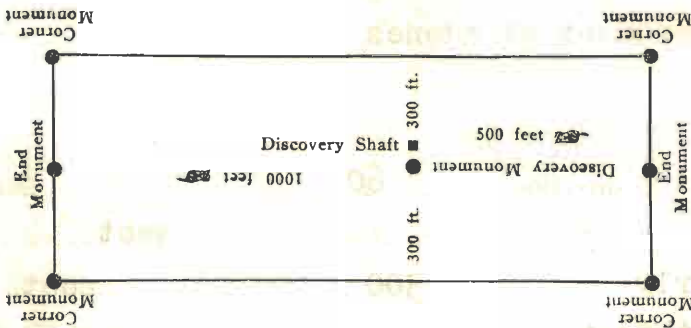

This diagram is to give locator a general idea of plan of location under the new law. The Discovery Shaft can be in the center of claim or any distance from either end desired. In the diagram it is placed 500 feet from one end and 1000 feet from the other. Commence description of claim at a center end monument, giving its distance and direction from center of Discovery Shaft; thence bound the claim in either direction. In description be careful to state locality of claim with reference to some natural object, or permanent monument, as will identify the claim.

2969

INDEXED
COMPARED
FILED

120

Notice of Mining Location

LODE CLAIM

To All Whom It May Concern:

This Mining Claim, the name of which is the Hold Over Mining Claim, situate on lands belonging to the United States of America, and in which there are valuable mineral deposits, was entered upon and located for the purposes of exploration and purchase by N. F. D. Nichols & B. M. McCoy

American Citizens of U.S.
(Locator must insert either "a citizen of the United States," or, "who has declared his intention to become a citizen of the United States.")

the undersigned, on the 11 day of January 1907.

The length of this claim is Fifteen Hundred feet, and we claim 900 feet,

in a Easterly direction and 600 feet in a westerly direction from

the center of the discovery shaft, at which this notice is posted, lengthwise of the claim, together with 300 feet in width of the surface grounds, on each

side of the center of said claim. The general course of the lode deposit and premises is from the East to the west

The claim is situated and located in the Warren Mining District, in Cochise County, in the Territory of Arizona, about 3 1/2 mile

in a Easterly direction from Bisbee

and 1/2 mile in a westerly direction from the Easter Sunday

The surface boundaries of the claim are marked upon the ground as follows: Beginning at

a monument of stone

at a point in a Easterly direction 900 feet from the discovery shaft (at which this notice is posted), being in the center of the

end line of said claim; thence South East 300 feet to a monument

1500 feet to a monument, being at the South west corner of said claim; thence 300 feet

to a monument at the center of the west end of said claim; thence 300 feet to a monument, being at the

north west corner of said claim; thence 1500 feet to a monument at the north East corner of said claim;

thence 300 feet to the place of beginning.

All done under the provisions of Chapter Six, of Title XXXII, of the Revised Statutes of the United States, and of an Act of the General Assembly of Arizona, entitled "An Act to Revise and Codify the Laws of the Territory of Arizona," approved March 16, 1901.

Dated and posted on the ground this 11 day of January 1907

N. F. D. Nichols
Harry B. McCoy

TERRITORY OF ARIZONA,

County of.....COCHISE

SS

I,.....*R. M. Donald*....., County Recorder in and for the County and

Territory aforesaid, do hereby certify that the within instrument was filed for record at.....9.....o'clock,.....M.,

on this.....day of.....MAR 30 1907.....190..., and duly recorded in Book No.....38

of.....MINING.....Records of.....COCHISE.....County, Arizona, at pages.....463

WITNESS my hand and official seal the day and year first above written.

R. M. Donald
County Recorder.

No 20 93

Notice of Location

LODE CLAIM

Dated.....190.....

Filed and Recorded at request of

N. J. & Nicholas

MAR 30 1907 A. D. 190

at.....M.

Book.....*38*.....

Pages.....46 3

By.....*R. M. Donald*.....
County Recorder.

Deputy Recorder.

BISBEE, ARIZ.

Box 17

COMPLETED

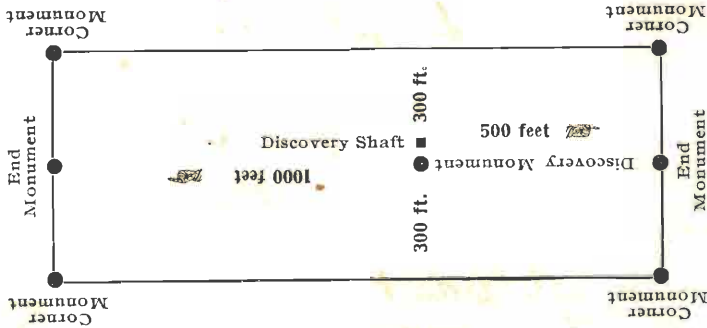

This diagram is to give locator a general idea of plan of location under the new law. The Discovery Shaft can be in the center of claim or any distance from either end desired. In the diagram it is placed 500 feet from one end and 1000 feet from the other. Commence description of claim at a center end monument, giving its distance and direction from center of Discovery Shaft; thence bound the claim in either direction. In description be careful to state locality of claim with reference to some natural object, or permanent monument, as will identify the claim.

Notice of Mining Location.

Mar 26 1917

22

LODE CLAIM.

To All Whom it May Concern:

This Mining Claim, the name of which is the Horse Shoe

Mining Claim, situate on lands belonging to the United States of America, in which there are valuable mineral deposits,

was entered upon and located for the purposes of exploration and purchase by R. F. D. Nichols

Citizen of U.S.
(Locator must insert either "a citizen of the United States," or "who has declared his intention to become a citizen of the United States.")

the undersigned, on the 1st day of January 1904

The length of this claim is 1500 feet

and 1 claim 750 feet

in a easterly direction and 750

feet in a westerly direction from

the center of the discovery shaft, at which this notice is posted, lengthwise of the claim, together with 300

feet in width of the surface grounds, on each side of the center of said claim.

The general course of the lode deposit and premises is from the East

to the West

The claim is situated and located in the Warren Mining District, in

Cochise County, in the Territory of Arizona, about 4 miles

in a easterly direction from Bisbee

and half mile west of the

Golden Eric

The Surface boundaries of the claim are marked upon the ground as follows: Beginning at Monument

of stone

at a point Westerly direction 750 feet from

the discovery shaft (at which this notice is posted), being in the center of the west

end line of said claim; thence 300 feet to a Monument of stone

, being the South west corner of said claim; thence

1500 feet to a Monument of stone, being at the

South east corner of said claim; thence 300 feet

to a Monument of stone at the center of the east end of said claim;

thence 300 feet to a Monument of stone being at the

North east corner of said claim; thence 1500

feet to a Monument of stone at the North west corner of said claim;

thence 300 ft feet to the place of beginning.

All done under the provisions of Chapter Six, of Title XXXII, of the Revised Statutes of the United States, and

of an Act of the General Assembly of Arizona, entitled "An Act to Revise and Codify the Laws of the Territory of

Arizona," approved March 16 1901.

Dated and posted on the ground this 1st day of January 1904

Witness
Jack Kinney

R. F. D. Nichols

23

I, Frank Star County Recorder in and for the County and

Territory aforesaid, do hereby certify that the within instrument was filed for record at 9 o'clock, 2 M.,

on this 25th day of Nov 1904, and duly recorded in Book No. 30

of Mining Records of Cochise County, Arizona, at pages 330

WITNESS my hand and official seal the day and year first above written.

Frank Star
County Recorder.

Notice of Location.

LODE CLAIM.

Dated Nov 25th 1904

Filed and recorded at request of

M. J. Brown
Nov 25th A. D. 1904

at 9 o'clock, 2 M.

Book 30 Record of Mines

Pages 330

Frank Star
County Recorder.

By [Signature]
Deputy Recorder.

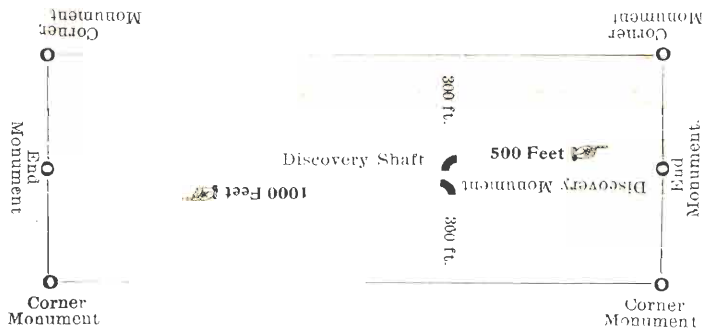

This diagram is to give locator a general idea of plan of location under the new law. The Discovery Shaft can be in the center of claim or any distance from either end desired. In the diagram it is placed 500 feet from one end and 1000 feet from the other. Commence description of claim at a center end monument, giving its distance and direction from center to Discovery Shaft; thence bound the claim in either direction. In description be careful to state locality of claim with reference to some natural object, or permanent monument, as will identify the claim.

APR 26 1911
24

Notice of Mining Location

LODE CLAIM

To All Whom It May Concern:

This Mining Claim, the name of which is the Sunshine Mining Claim, situate on lands belonging to the United States of America, and in which there are valuable mineral deposits, was entered upon and located for the purposes of exploration and purchase by B. F. D. Nichol Citizen of U. S. A.

(Locator must insert either "a citizen of the United States," or, "who has declared his intention to become a citizen of the United States.")
the undersigned, on the 1 day of January 1904

The length of this claim is 1500 feet, and 1 claim 150 feet, in a Southerly direction and 1350 feet in a Southerly direction from the center of the discovery shaft, at which this notice is posted, lengthwise of the claim, together with 300 feet in width of the surface grounds, on each side of the center of said claim. The general course of the lode deposit and premises is from the North to the South

The claim is situated and located in the Warren Mining District, in Cochise County, in the Territory of Arizona, about 4 miles in a eastly direction from Bebe and half mile in westerly direction from Golden Era

The surface boundaries of the claim are marked upon the ground as follows: Beginning at a monument of stone

at a point in a Southerly direction 1300 feet from the discovery shaft (at which this notice is posted), being in the center of the south end line of said claim; thence 300 feet to a monument, being the South west corner of said claim; thence 1500 feet to a monument, being at the North west corner of said claim; thence 300 feet to a monument at the center of the North end of said claim; thence 300 feet to a monument, being at the North east corner of said claim; thence 1500 feet to a monument at the South east corner of said claim; thence 300 feet to the place of beginning.

All done under the provisions of Chapter Six, of Title XXXII, of the Revised Statutes of the United States, and of an Act of the General Assembly of Arizona, entitled "An Act to Revise and Codify the Laws of the Territory of Arizona," approved March 16, 1901.

Dated and posted on the ground this 1st day of January 1904

Witness Jack Kinney B. F. D. Nichol

TERRITORY OF ARIZONA,
County of Cochise } ss

I, Frank Star, County Recorder in and for the County and

Territory aforesaid, do hereby certify that the within instrument was filed for record at 9 o'clock, A.M.,

on this 25th day of Aug 1900, and duly recorded in Book No. 30

of Mining Records of Cochise County, Arizona, at pages 332

WITNESS my hand and official seal the day and year first above written.

Frank Star
County Recorder.

Notice of Location

LODE CLAIM

Dated 1900

Filed and recorded at request of

M. J. Brown

Miner N.M. A. D. 1900

at A M.

Book 30 Records of Mines

Pages 332

Frank Star

County Recorder.

By [Signature] Deputy Recorder.

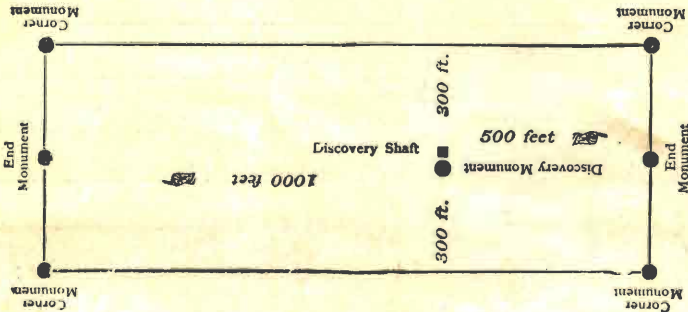

This diagram is to give locator a general idea of plan of location under the new law. The Discovery Shaft can be in the center of claim or any distance from either end desired. In the diagram it is placed 500 feet from one end and 1000 feet from the other. Commence description of claim at a center end monument, giving its distance and direction from center of Discovery Shaft; thence bound the claim in either direction. In description be careful to state locality of claim with reference to some natural object, or permanent monument, as will identify the claim.

Notice of Mining Location

LODE CLAIM

To All Whom It May Concern:

This Mining Claim, the name of which is the Nancy Hanks Mining Claim, situate on lands belonging to the United States of America, and in which there are valuable mineral deposits, was entered upon and located for the purposes of exploration and purchase by N. F. D. Nichols

American citizen of U.S.
(Locator must insert either "a citizen of the United States," or, "who has declared his intention to become a citizen of the United States.")

the undersigned, on the 1 day of January 1904

The length of this claim is 1575 feet,
and 1 claim 500 feet,

in a northely direction and 1000
feet in a Southerly direction from

the center of the discovery shaft, at which this notice is posted, lengthwise of the claim, together with 300 feet in width of the surface grounds, on each

side of the center of said claim. The general course of the lode deposit and premises is from the North to the South

The claim is situated and located in the Warren Mining District, in Cochise County, in the Territory of Arizona, about 4 mile in a Easterly direction from Bisbee ariz 1/2 mile westerly from Golden Crea

The surface boundaries of the claim are marked upon the ground as follows: Beginning at a monument of stone

at a point in a Southerly direction 1000 feet from

the discovery shaft (at which this notice is posted), being in the center of the South end line of said claim; thence 300 feet to a monument

, being the Southwest corner of said claim; thence 1500 feet to a monument, being at the

north west corner of said claim; thence 300 feet to a monument at the center of the North end of said claim;

thence 300 feet to a monument, being at the north east corner of said claim; thence 1500

feet to a South East corner of said claim; thence 300

feet to the place of beginning.

All done under the provisions of Chapter Six, of Title XXXII, of the Revised Statutes of the United States, and of an Act of the General Assembly of Arizona, entitled "An Act to Revise and Codify the Laws of the Territory of Arizona," approved March 16, 1901.

Dated and posted on the ground this 1 day of January 1904

witness Jack Kinney

N. F. D. Nichols

TERRITORY OF ARIZONA,
County of Cochise } ss

I, Frankston, County Recorder in and for the County and Territory aforesaid, do hereby certify that the within instrument was filed for record at 7 o'clock, a M., on this 25th day of April, 1904, and duly recorded in Book No. 30 of Miner Records of Cochise County, Arizona, at pages 331.

WITNESS my hand and official seal the day and year first above written.

Frankston
County Recorder.

Notice of Location
LODE CLAIM

Dated 1904

Filed and recorded at request of

M. J. Brown
Adopted A. D. 1904

at 7 a M.

Book 30 Record of Miner

Pages 331

Frankston
County Recorder.

By [Signature]
Deputy Recorder.

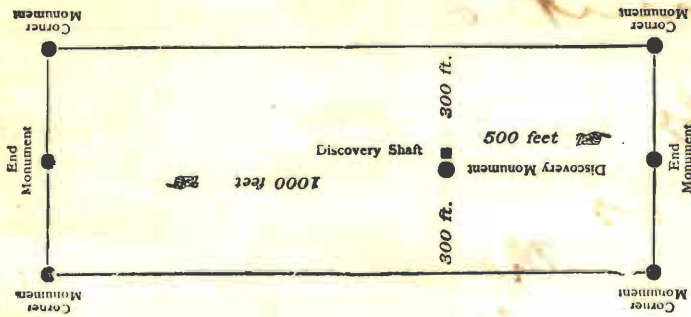

This diagram is to give locator a general idea of plan of location under the new law. The Discovery Shaft can be in the center of claim or sired. In the diagram it is placed 500 feet from one end and 1000 feet from the other. Commence description of claim at a center end monument, giving its distance and direction from center of Discovery Shaft; thence bound the claim in either direction. In description be careful to state locality of claim with reference to some natural object, or permanent monument, as will identify the claim.

U. S. SURVEYOR-GENERAL'S FINAL CERTIFICATE ON FIELD NOTES.

Department of the Interior,

OFFICE OF U. S. SURVEYOR-GENERAL,

Phoenix, Arizona,

October 12, 1917.

I, U. S. Surveyor-General for District of Arizona

do hereby certify that the foregoing transcript of the Field Notes, return and approval of the survey of the mining claim of

BISBEE WARREN COPPER CO.

known as the GOLCONDA, APEX, HOLD OVER, HORSE SHOE, SUNSHINE, NANCY HANKS LODES.

situate in WARREN

Mining District, COCHISE County, ARIZONA.

in Section 18, Township No. 23 S., Range No. 25 E., and Sec. 13 unapp'd. T. 23 S., R. 24 E. designated as Survey No. 3390, has been correctly copied from the originals on file in

this office; that said Field Notes furnish such an accurate description of said mining claim as will, if incorporated into a patent, serve fully to identify the premises, and that such reference is made therein to natural objects or permanent monuments as will perpetuate and fix the locus thereof.

And I further certify that five hundred dollars' worth of labor has been expended or improvements or for each said mining claim by claimant or its grantors, and that said improvements consist of except the Golconda and Apex lodes, by claimant or its grantors, and that said improvements, at time of survey, consisted of 6 shafts, 18 cuts, and 5 tunnels, total value \$3520.

As improvement No. 10 on the Sunshine lode is a common improvement for the benefit and development of the said Sunshine and the Nancy Hanks, Hold Over and Horse Shoe lodes of this survey, an undivided one-fourth interest therein, value \$330,

is properly credited to each of the four said claims. As the work in this improvement was done prior to the location of the Apex and Golconda lodes they do not share in the distribution of values therefrom, and that no portion of said labor or improvements has been included in the estimate of expenditures

upon any other claim.

I further certify that the plat thereof, filed in the U. S. Land Office at Phoenix,

Arizona, is correct and in conformity with the foregoing Field Notes.

Frank P. Trott,

United States Surveyor-General for Arizona.

SURVEYOR-GENERAL'S CERTIFICATE OF APPROVAL OF FIELD NOTES AND SURVEY OF MINING CLAIM.

Department of the Interior,

OFFICE OF U. S. SURVEYOR-GENERAL,

Phoenix, Arizona,

October 12, 1917

I, U. S. Surveyor-General for District of Arizona

do hereby certify that the foregoing and hereto attached Field Notes and Return of the Survey of the Mining Claim of

BISBEE WARREN COPPER CO.

known as the GOLCONDA, APEX, HOLD OVER, HORSE SHOE, SUNSHINE, NANCY HANKS LODES.

situate in WARREN mining district,

COCHISE County, ARIZONA.

in Section 18, Township No. 23 S., Range No. 25 E., and Sec. 13, unapp'd. T 23 S., R. 24 E.

designated as Survey No. 3390

executed by Ralph L. Motz, United States Mineral

Surveyor, May 8-16, 1917, under my instructions dated

April 26, 1917, have been critically examined and the necessary cor-

rections and explanations made, and the said Field Notes and Return, and the Survey they describe,

are hereby approved. A true copy of the copy of the location certificate filed by the applicant for

survey is included in the field notes.

[Handwritten signature]

U. S. Surveyor-General for Arizona.

(4-691.)

Certificate of U. S. Surveyor General

AS TO

EXPENDITURES REPORTED AFTER RETURN OF SURVEY OF MINING CLAIM.

I, U. S. Surveyor General for District of Arizona,
do hereby certify that Five Hundred Dollars' worth of labor has been expended or
improvements made by claimant or its grantors, or for each of upon the mining claim of
Bisbee Warren Copper Co.

known as the Golconda, Apex, Hold Over, Horse Shoe, Sunshine and,
Nancy Hanks lodes
situate in Warren mining district,

Cochise County, Arizona
18 Township No. 23 S., Range No. 25 E.
in Section 13 Unapp'd Township No. 23 S., Range No. 24 E.;

that said improvements consist of 6 shafts, 21 cuts and 8 tunnels, total
value \$5040.

....., and that no portion of said labor or improvements has been
included in the estimate of expenditures upon any other claim. A copy of the report of
Ralph L. Motz, U. S. ~~Deputy~~ Mineral Surveyor, dated
March 11 19, 18 , is hereto attached.



U. S. Surveyor General for Arizona.

Office of U. S. Surveyor General,

Phoenix, Arizona,

March 20, 1918.

MINERAL SURVEY NO. 3390. GOLCONDA ET AL LODES.

SUPPLEMENTAL REPORT OF IMPROVEMENTS.

I hereby certify that the value of the labor performed and improvements made upon the claims of Survey No 3390 by the claimant or its grantors is not less five hundred dollars for each claim, and that said improvements in addition to those which were reported at the time of survey consist of:-

GOLCONDA.

No.2. Open cut 7 x 12 x 16 feet long, with tunnel in face 4 x 6 x 47 feet long brg S 8° E, the mouth of open cut brs from Cor No 2 S 79° 50' W 482.3 feet. Value \$750.00

APEX.

No.2. Open cut 5 x 12 x 12 feet long, with tunnel in face 4 x 6 x 30 ft long brg N 28° W, the mouth of open cut brs from Cor No 1 N 75° 19' E 152.0 ft. Value \$450.00

No.3. Open cut 5 x 8 x 10 ft long, with tunnel in face 4 x 6 x 14 ft long brg N 3° 30' E, the mouth of open cut brs from Cor No 1 N 60° 19' E 95.1 ft. Value \$320.00

Ralph L. Motz
U. S. Mineral Surveyor.

Dated at Bisbee, Arizona.
March 11th, 1918.

I, Ralph L. Motz, U. S. Mineral Surveyor for the District of Arizona, first being duly sworn, depose and say that the above supplemental report is true and correct and that the improvements mentioned therein were made and completed prior to the date of the expiration of the publication of the notice of application for patent to the lands embraced in Mineral Survey No. 3390.

Ralph L. Motz
U. S. Mineral Surveyor.

State of Arizona)
County of Cochise) ss.

Sunsubscribed and sworn to by said Ralph L. Motz, before me a Notary Public in and for the County of Cochise, State of Arizona, this 11th day of March 1918.

JW Ross
Notary Public.

My commission expires February 21st, 1920.