

MINERAL SURVEY No. 3402

LOT No. _____

Arizona Land District.

FIELD NOTES

OF THE SURVEY OF THE MINING CLAIM OF

J. C. Bullard,

KNOWN AS THE
State, Democrat,
Arizona, East. Bean,
Pine Connection
Monroyall
Leaves

_____ Mining District,

Yavapai County, Arizona

Section 10 + 11, Township 8 N, Range 10 W

Surveyed under instructions dated May 25, 1917

by William H. Merritt,
U. S. Mineral Surveyor.

Claim located See heretofore notices, 19

Survey commenced June 7, 1917

Survey completed June 29, 1917

Address of claimant E. S. Clark Atty. Prescott Ariz

DATES OF AMENDED LOCATIONS.

SURVEY NO. 3402

STATE LODE.

Beginning at cor. No. 1. Identical with the loc.

A malpais stone 6x8x24 ins. set 12 ins in the ground with mound of stone. Chiseled x-1S-3402 on side facing this lode. Whence 1/4 sec. cor. secs. 10 and 11, T.8 N., R.10 W. brs. N. 24°33' E. 250 ft.

Cor. 5, Golden Seal lode, survey 1011, brs. N.48°41'E. 239.13 ft. Cor.6, Turk lode, sur.983, cor.2, Neena lode, sur.981, and cor. 2, Menasha lode, sur.1004 brs. N.52°43'E. 284.14 ft.

No bearings available. Loc. cor. mound of stone 3x3 ft.

Feet Thence N. 7° 12' W. Va. 14° E.

99.83 Intersect line 6-1 of Turk lode, sur.983, at S.72°57'W. 249.56 ft. from cor.6.

113.92 Intersect line 4-5 of Golden Seal lode, sur.1011, at S.76°57'W.199.03 ft. from cor.5, which is on line 6-2 Turk lode, Sur. No. 983, S.72° 57'W. 48.60 ft. from Cor. No. 6.

300. West center end. Identical with the loc. A mound of stone 3x3 ft.

600. To cor. No.2. Identical with the loc. A malpais stone 6x14x24 ins. set 12 ins. in the ground with mound of stone. Chiseled x-2S-3402 on side facing this lode. No bearings available. Loc. cor. mound of stone 3x3 ft.

Thence N.82°48' E. Va. 14° E.

166.45 Intersect line 5-6 of Turk lode, sur.983, and line 2-3 of Neena lode, sur.981, at N.17°3'W.464.33 ft. from cor. 6 of Turk lode and cor.2 of Neena lode.

180.37 Intersect sec line between secs.10 and 11, T.8 N., R.10 W. at N.0°1' W.390.04 ft. from 1/4 sec cor. and S.0°1'E. 2249.96 ft. from cor.secs. 2,3,10,11.

600. Cor. 1, Sweepstake lode, sur, 2467.

775.43 Intersect line 5-6 of Neena lode, sur.981, at N.17°3' W. 360.15 ft. from cor. 6. Cor.No.2 said lode brs.S.72° 57' W. 600 ft. from Cor. No.6 thereof.

SURVEY NO. 3402- continued.

Feet STATE LODE -continued.

1415.74 Intersect line 2-3 of Copper Point lode, sur. 993, at
S.36°43'E. 759.40 ft. from cor. 3.

1500. To cor. No. 3. Identical with the loc. and with cor. 4
of Avalanche lode, sur. 2467.

A malpais stone 8x10x12 ins. with mound of stone and marked
x-4A-2467. I chiseled 3S-3402 on side facing this lode.
No bearings available. Loc. cor. mound of stone 3x3 ft.

Thence S. 7°12' E. Va. 14° E.

148.82 Intersect line 2-3 of Copper Point lode, sur. 993, at

N.36°43'W. 569.58 ft. from cor. 2, & S.36°43'E. 930.42 ft. from
Cor. No. 3.

300. East center end. Identical with the loc. A mound of stone
3x3 ft.

600. To cor. No. 4. Identical with the loc. and with cors. 1,
Arizona, 2 Democrat lodes of this survey and 1, Avalanche
lode, sur. 2467.

A malpais stone 4x10x12" with mound of stone and chiseled
x-1A-2467. I chiseled 4S-1AR-2D-3402 on sides facing
these lodes. No bearings available. Loc. cor. mound of
stone 3x3 ft. Whence cor. 2, Copper Point lode, sur.
993 and cor. 3, Oshkosh lode, sur. 994 brs. S.88°12'E.
284.11 ft.

Thence S.82°48'W. Va. 14° E.

300. N. C. E. Democrat lode of this survey.

600. Cors. 1, Democrat and 2, Last Bean lodes of this survey.

620.39 Intersect line 5-6 of Menasha lode, sur. 1004, at S.17°
3'E. 248.83 ft. from cor. 6. Cor. No. 2 said lode is S. 72° 57'W
600 ft. from Cor. No. 6 thereof.

900. N. C. E. Last Bean lode of this survey.

1200. Cor. 1, Last Bean lode of this survey.

1229.37 Intersect line 2-3 of Menasha lode, sur. 1004, at S.17°3'E.
144.65 ft. from cor. 2.

1288.25 Intersect line 5-6 of Golden Seal lode, sur. 1011, at
S.13°3'E. 134.91 ft. from cor. 5.

SURVEY NO. 3402 -continued.

Feet

STATE LODE -continued.

- 1395.24 Intersect line between secs. 10 and 11, T.8 N.,R.10 W. at N.0°1'W. 2425.29 ft. from cor. secs. 10,11,14 and 15, and S.0°1'E. 214.71 ft. from $\frac{1}{4}$ sec. cor.
1500. To cor. No. 1 the place of beginning.

ARIZONA LODE

Beginning at cor. No. 1. Identical with the loc. and with cors. 2, Democrat and 4 State lodes of this survey and 1, Avalanche lode, sur. 2467, hereinbefore described.

Whence $\frac{1}{4}$ sec. cor. between secs. 10 and 11, T.8 N.,R.10 W. brs. N.88°23'W. 1384.85 ft.

Thence N.82°48'E. Va.14°E.

- 255.44 Intersect line 2-3 of Copper Point lode, sur. 993, at N.36°43'W. 51.11 ft. from cor.2.
- 359.18 Intersect line 1-2 of Copper Point lode, sur. 993, and line 3-4 of Oshkosh lode, sur. 994, at N.53°17'E. 90.28 ft. from cors.2, Copper Point and 3, Oshkosh.
- 944.92 Intersect line 5-6 of Oshkosh lode, sur. 994, at S.36°43'E. 288.58 ft. from cor. 5.
- 1134.3 Intersect line 3-4 of Little Chute lode, sur. 996, at N.14°7'E. 12.48 ft. from cor. 3.
1500. To cor. No. 2. Identical with the loc. and with cor. 2 of Avalanche lode, sur. 2467,
A malpais stone 4x6x12 ins. with mound of stone and chiseled x-2A-2467. I chiseled it 2AR-3402 on side facing this lode. No bearings available. Loc. cor. mound of stone 3x3 ft. Cor. No.3 Little Chute lode, Sur. No.996, brs. S.81° W. 370.41 ft.
- Thence S.7°12'E. Va.14°E.
- 156.09 Intersect line 2-3 of Little Chute lode, sur. 996, at S.75°53'E. 397.42 ft. from cor. 3.
300. East center end. Identical with the loc. A mound of stone 3x3 ft.
600. To cor. No. 3. Identical with the loc.

SURVEY NO. 3402 -continued.

ARIZONA LODE -continued.

A malpais stone 6x12x24 ins. set 12 ins. in the ground with mound of stone. Chiseled x-3A-3402 on side facing this lode. No bearings available. Loc. cor. mound of stone 3x3 ft.

- Feet Thence S.82°48'W. Va. 14°E.
- 215.37 Intersect line 5-6 of Oshkosh lode, sur. 994, at N.36°43'W. 521.93 ft. from cor. 6, and S.36°43'E. 978.07 ft. from Cor. No. 5.
- 904.86 Intersect line 2-3 of Oshkosh lode, sur. 994, at S.36°43'E. 638.38 ft. from cor. 3.
1500. To cor. No. 4. Identical with the loc.
- A malpais stone 6x12x24 ins. set 12 ins. in the ground with mound of stone. Chiseled x-4A-3402 on side facing this lode. No bearings available. Loc. cor. mound of stone 3x3 ft.
- Thence N.7°12'W. Va.14°E.
300. West center end. Identical with the loc. A mound of stone 3x3 ft.
600. To cor. No. 1, the place of beginning.

DEMOCRAT LODE

Beginning at cor. No. 1. Identical with the loc. and with cor. 2, Last Bean lode of this survey.

A malpais stone 4x12x30 ins. set 15 ins. in the ground with mound of stone. Chiseled x-1D-2LB-3402 on sides facing these lodes. Whence $\frac{1}{2}$ sec. cor. between secs. 10 and 11, T.8 N., R.10 W. brs. N.81°44'W. 797.31 ft.

No bearings available. Loc. cor. mound of stone 3x3 ft.

Thence N. 82°48'E. Va. 14°E.

300. North center end. Identical with the loc. A mound of stone 3x3 ft.
600. To cor. No. 2. Identical with the loc. and with cors. 4,

SURVEY NO. 3402 -continued

DEMOCRAT LODGE -continued.

Feet State lode, 1, Arizona lode of this survey and 1, Avalanche lode, sur. 2467, hereinbefore described.

Thence S.7°12'E. Va. 14°E.

300. W.C.E. Arizona lode of this survey.

600. Cor. 4, Arizona lode of this survey.

1500. To cor. No. 3. Identical with the loc.

A malpais stone 6x8x24 ins. set 12 ins. in the ground with mound of stone. Chiseled x-3D-3402 on side facing this lode. No bearings available. Loc. cor. mound of stone 3x3 ft.

Thence S.82°48'W. Va. 14°E.

300. South center end. Identical with the loc. A mound of stone 3x3 ft.

600. To cor. No. 4. Identical with the loc. and with cor. 3, Last Bean lode of this survey.

A malpais stone 6x8x24 ins. set 12 ins. in the ground with mound of stone. Chiseled x-4D-3LB-3402 on sides facing these lodes. No bearings available. Loc. cor. mound of stone 3x3 ft. Whence cor. 5, Menasha lode, sur. 1004, brs. N.28°43½'E. 330.07 ft.

Thence N.7°12'W. Va. 14°E.

233.66 Intersect line 4-5 of Menasha lode, sur. 1004, at S.72° 57'W. 196.55 ft. from cor. 5.

750. E.S.C. Last Bean lode of this survey.

1382.57 Intersect line 5-6 of Menasha lode, sur. 1004, at N.17° 3'W. 1131.98 ft. from cor. 5.

1500. To cor. No. 1, the place of beginning.

LAST BEAN LODGE

Beginning at cor. No. 1, identical with the loc.

A malpais stone 4x10x24 ins. set 12 ins. in the ground with mound of stone. Chiseled x-1LB-3402 on side facing this lode. Whence ½ sec. cor. between secs. 10 and 11, T. 8 N., R. 10 W. brs. N.45°35'W. 271.19 ft. No bearings available. Loc. cor. mound of stone 3x3 ft.

SURVEY NO. 3402 -continued.

LAST BEAN LODE -continued.

- Feet Thence N.82°48'E. Va. 14°E.
300. North center end. Identical with the loc. A mound of stone 3x3 ft.
- 579.61 Intersect line 5-6 of Menasha lode, sur. 1004, at S.17° 3'E. 248.83 ft. from cor. 6.
600. To cor. No. 2. Identical with the loc. and with cor. 1, Democrat lode of this survey, hereinbefore described.
- Thence S. 7°12'E. Va. 14°E.
- 117.43 Intersect line 5-6 of Menasha lode, sur. 1004, at S. 17° 3'E. 368.02 ft. from cor. 6.
750. East side center. Identical with the loc. A mound of stone 2x2 ft.
- 1266.34 Intersect line 3-4-5 of Menasha lode, sur. 1004, at N.72° 57'E. 103.45 ft. from cor. 4, and 403.45 ft. from Cor. No. 3.
1500. To cor. No. 3. Identical with the loc. and with cor. 4, Democrat lode of this survey, hereinbefore described.
- Thence S.82°48'W. Va.14°E.
300. South center end. Identical with the loc. A mound of stone 3x3 ft.
600. To cor. No. 4. Identical with the loc.
- A malpais stone 6x8x24 ins. set 12 ins. in the ground with mound of stone. Chiseled x-4LB-3402 on side facing this lode. Whence cor. 3, Menasha lode, sur. 1004, brs. N.43°41'E. 260.98 ft. No bearings available. Loc. cor. mound of stone 3x3 ft.
- Thence N. 7°12'W. Va. 14°E.
258. Cor. 2, Conection lode of this survey.
558. E.C.E. Conection lode of this survey.
750. West side center. Identical with the loc. A mound of stone 2x3 ft.
858. Cor. 1, Conection lode of this survey.

SURVEY NO. 3402 -continued.

LAST BEAN LODE -continued.

Feet

1330.85 Intersect line 2-3 of Menasha lode, sur. 1004, at N.17° 3'W. 1183.67 ft. from cor. 3.

1500. To cor. No. 1, the place of beginning.

CONNECTION LODE.

Beginning at cor. No. 1. Identical with the loc.

A malpais stone 6x8x24 ins. set 12 ins. in the ground with mound of stone. Chiseled x-1C-3402 on side facing this lode. Whence $\frac{1}{4}$ sec. cor. between secs. 10 and 11, T.8 N.,R.10 W. brs. N.18°21'W. 871.20 ft.

Cor. 6, Golden Seal lode, sur. 1011, brs. S.0°24'E. 143.52 ft. No bearings available. Loc. cor. mound of stone 3x3 ft.

Thence S. 7°12'E. Va. 14°E.

108. W.S.C. Last Bean lode of this survey.

300. East center end. Identical with the loc. A mound of stone 3x3 ft.

600. To cor. No. 2. Identical with the loc.

A malpais stone 4x14x24 ins. set 12 ins. in the ground with mound of stone. Chiseled x-2C-3402 on side facing this lode. Whence cor. 6, Fond du Lac lode, sur. 979, brs. N.21°48'W. 265.81 ft. No bearings available.

Loc. cor. mound of stone 3x3 ft.

Thence S.59°31'W. Va. 14°E.

76.49 Intersect line 6-1, Fond du Lac lode, sur. 979, at S.6° 33'E. 287.49 ft. from cor. 6.

404.73 Intersect line between secs. 10 and 11, T. 8 N.,R.10 W. at N.0°1'W. 1012.75 ft. from cor. secs. 10,11,14 and 15;; and S.0°1'E. 1627.25 ft. from $\frac{1}{2}$ sec. cor.

846.83 Intersect line 2-3 of Fond Du Lac lode, sur. 979, at S.83° 27'W. 704.11 ft. from cor. 2.

1000. Cross wash 40 ft. wide, course S.41°E.

SURVEY NO. 3402 -continued.

CONNECTION LODE -continued.

Feet

1500. To cor. No. 3. Identical with the loc.
A schist stone 4x8x24 ins. set 12 ins. in the ground with mound of stone. Chiseled x-3C-3402 on side facing this lode. Whence cor. 6, Apache Boy lode, sur. 980, brs. N.8°4'E. 196.27 ft. No bearings available. Loc. cor. mound of stone 3x3 ft.
-
- Thence N.7°12'W. Va.14°E.
- 162.04 Intersect line 6-1 Apache Boy lode, sur. 980, at S.54° 57'W. 58.46 ft. from cor. 6.
- 264.99 Intersect line 2-3 Fond du Lac lode, sur. 979, at N.83° 27'E. 195.87 ft. from cor. 3, & S.83° 27'W. 1304.13 ft. from Cor. No.2.
- 287.18 Intersect line 5-6 Apache Boy lode, sur. 980, at N.35° 3'W. 110.65 ft. from cor. 6.
300. West center end. Identical with the loc. A mound of stone 3x3 ft.
600. To cor. No. 4. Identical with the loc. and with the S.C.E. Stonewall lode of this survey.
A schist stone 4x10x24 ins. set 12 ins. in the ground with mound of stone. Chiseled x-4C-3402 on side facing this lode. No bearings available. Loc. cor. mound of stone 3x3 ft.
-
- Thence N. 59°31'E. Va. 14°E.
200. Cross wash 40 ft. wide, course S.49°E.
300. Cor. 1, Stonewall lode of this survey.
- 653.23 Intersect line 5-6 of Fond du Lac lode, sur. 979, at S.83°27'W. 710.83 ft. from cor. 6.
- ~~1041.95~~
1041.22 Intersect line ²⁻⁶ 1-2 of Golden Seal lode, sur. 1011, at S.76°57'W. ^{413.71} ~~113.36~~ ft. from cor. ⁶ 1.
- 1182.15 Intersect line between secs. 10 and 11, T.8 N., R.10 W. at N.0°1'W. 1652.02 ft. from cor. of secs. 10, 11, 14 and 15; and S.0°1'E. 987.98 ft. from $\frac{1}{2}$ sec. cor.
- ~~1475.54~~
1476.57 Intersect line 5-6 of Golden Seal lode, sur. 1011, at N.13°3'W. ~~130.43~~ ft. from cor. 6.
129.91

SURVEY NO. 3402 -continued.

CONNECTION LODE -continued.

Feet

1500. To cor. No. 1, the place of beginning.

STONEWALL LODE

Beginning at cor. No. 1. Identical with the loc.

A schist stone 5x6x24 ins. set 12 ins. in the ground with mound of stone. Chiseled x-1S-3402 on side facing this lode. Whence cor. to secs. 10, 11, 14 and 15, T.8N., R.10 W. brs. S.32°16'30" E. 1424.70 ft.

Cor. 5 of Fond du Lac lode, sur. 979, brs. N.79°28'W. 487.78 ft. No bearings available. Loc. cor. mound of stone 3x3 ft.

Thence S59°31'W. Va. 14° E.

100. Cross wash, 40 ft. wide, course S.49° E.

300. South center end. Identical with the loc. and with cor. 4, Connection lode of this survey, hereinbefore described.

446.60 Intersect line 5-6 of Apache Boy lode, sur. 980, at S.35°3'E. 1110.09 ft. from cor. 5.

510.12 Intersect line 3-4⁶ of Fond du Lac lode, sur. 979, at S.6°33'E. 50.23 ft. from cor. 4, & 350.23 ft. from Cor. 5.

600. To cor. No. 2. Identical with the loc.

A schist stone 4x12x24 ins. set 12 ins. in the ground with mound of stone. Chiseled x-2S-3402 on side facing this lode. No bearings available. Loc. cor. mound of stone 3x3 ft.

Thence N.49°42'W.. Va. 14° E.

750. West side center. Identical with the loc. A mound of stone 2x3 ft.

1134.70 Intersect line 3-4⁵ of Apache Boy lode, sur. 980, at S.54°57'W. 139.89 ft. from cor. 4, and 439.89 ft. from Cor. No. 5.

1500. To cor. No. 3. Identical with the loc.

A malpais stone 10x12x24 ins. set 12 ins. in the ground with mound of stone. Chiseled x-3S-3402 on side facing this lode.

SURVEY NO. 3402 -continued.

STONEWALL LODE -continued.

Feet Whence cor. 5, Apache Boy lode, sur. 980, brs. N.88°32'
 E. ^{638.91}~~646.52~~ ft. No bearings available. Loc. cor. mound of
 stone 3x3 ft.

242.02 Thence N.59°31'E. Va. 14° E. Intersect line 2-3 of Crystal lode, sur. 989, at N.17°
 3'W. 119.89 ft. from cor. 2.
 300. North center end. Identical with the loc. A mound of stone
 3x3 ft.
 415. Cross road, bears S.42°E. and N.42°W.
 580. Cross wash, 40 ft. wide, course S. 43°E.
 600. To cor. No. 4. Identical with the loc.

A schist stone 4x6x24 ins. set 12 ins. in the ground
 with mound of stone. Chiseled x-4S-3402 on side facing
 this lode. Whence cor.2 of Crystal lode, sur. 989, brs.
 S.42°42'W. 403.07 ft. No bearings available. Loc. cor.
 mound of stone 3x3 ft.

241.19 Thence S.49°42' E. Va. 14° E. Intersect line 6-1² of Crystal lode, sur. 989, at N.72°
 57'E. 178.31 ft. from cor.1, and 478.31 ft from Cor No.2.

750. East side center. Identical with the loc. A mound of
 stone 3x3 ft.

1303.59 Intersect line 5-6 of Fond du Lac lode, sur. 979, at
 N.83°27'E. 331.98 ft. from cor. 5.

1500. To cor. No. 1, the place of beginning.

LOCATION

This claim is located in secs. 10, unsur. and 11, T.8
 N., R.10 W. G. & S.R. M., Pierce Mining District, Yavapai
 County, Arizona.

SURVEY NO. 3402-continued.

ADJOINING CLAIMS.

This claim is bounded on the North by the Sweepstake and the Avalanche lodes of sur. 2467, by Crystal lode, sur. 989, by Turk lode, sur. 983, by Neena lode, sur. 981, by Copper Point lode, sur. 993, by Little Chute lode, sur. 996, by ~~Fond du Lac lode, sur. 979~~ and by ~~Golden Seal lode, sur. 1011~~, and by U. S. land. On the East by ~~Crystal lode, sur. 989~~, by ~~Fond du Lac lode, sur. 979~~, by Copper Point lode, sur. 993, by Little Chute lode, sur. 996, by Avalanche and by International lodes of sur. 2467 and by U. S. land.

On the South by Oshkosh lode, sur. 994, by Fond du Lac lode, sur. 979, by Apache Boy lode, sur. 980, by ~~Golden Seal lode, sur. 1011~~, and by U. S. land. On the West by Apache Boy lode, sur. 980, by Fond du Lac lode, sur. 979, by Crystal lode, sur. 989, by Golden Seal lode, sur. 1011, by Turk lode, sur. 983, and by U. S. land. It conflicts with the Menasha lode, Sur. No. 1004.

LODE LINES

As near as can be determined from present developments the veins of the several locations embraced in this claim extend as follows from their respective discovery points:

- State lode, 120 ft. N.82°48'E., and 1380 ft. S.82°48'W.
- Arizona lode, 420 ft. N.82°48'E., and 1080 ft. S.82°48'W.
- Democrat lode, 10 ft. N.7°12'W., and 1490 ft. S.7°12'E.
- Last Bean lode, 110 ft. N.7°12'W., and 1390 ft. S.7°12'E.
- Conection lode, 315 ft. N.59°31'E., and 1185 ft. S.59°31'W.
- Stonewall lode, 612 ft. N.49°42'W., and 888 ft. S.49°42'E.

AREA

Total area, State lode.....	20.661	acres
Area in conflict with-		
Sur.993, Copper Point lode.....	0.144	✓
Sur.981, Neena lode.....	5.678	✓
Sur.1004, Menasha lode.....	2.710	✓
Sur.983, Turk lode.....	2.286	✓

SURVEY NO. 3402 -continued.

AREA- continued.

STATE LODE -continued.

Area in conflict with-

Sur. 1011, Golden Seal lode0.585 ✓ acres

Sur. 983, Turk lode(exclusive of its
conflict with sur.1011,Golden Seal lode) 2.254 ✓

Total area, Arizona lode.....20.661 ✓

Area in conflict with-

Sur. 993, Copper Point lode.....0.053 ✓

Sur. 994, Oshkosh lode9.444 ✓

Sur. 996, Little Chute lode.....0.712 ✓

Total area, Democrat lode.....20.661 ✓

Area in conflict with-

Sur. 1004, Menasha lode.....2.554 ✓

Total area, Last Bean lode.....20.661 ✓

Area in conflict with-

Sur. 1004, Menasha lode.....15.340 ✓

Total area, Connection lode.....18.979 ✓

Area in conflict with-

Sur. 1011, Golden Seal lode.....0.617 ✓

Sur. 979, Fond du Lac lode.....13.659 ✓

Sur. 979, Fond du Lac lode(exclusive of
its conflict with sur.980, Apache Boy
lode).....13.656 ✓

Sur. 980, Apache Boy lode..... 0.074 ✓

Total area, Stonewall lode.....19.509 ✓

Area in conflict with-

Sur. 979, Fond du Lac lode.....2.421 ✓

Sur. 979, Fond du Lac lode(exclusive of
its conflict with sur.980, Apache Boy
lode).....2.332 ✓

Sur, 980, Apache Boy lode.....7.492 ✓

Sur. 989, Crystal lode.....1.594 ✓

SURVEY NO. 3402 -continued.

EXPENDITURE OF FIVE HUNDRED DOLLARS.

I certify that the value of the labor and improvements made upon this claim by the claimant or his grantors is not less than five hundred dollars for each claim and that said improvements consist of:-

STATE LODE

No. 1. The discovery shaft which is on the lode line 120 ft. from the east center end, 4x6x8 ft. Value \$70.

No. 2. A cut which brs. from point on line 4-1, 300 ft. from cor. 1, N.45°35'W. 205 ft., 4x6x8 ft. Value \$40.

1/6 of shaft No. 4, Last Bean lode, (\$200.) a common improvement, is credited to this lode, and 1/6 of shaft No. 2, Connection lode, (\$240), a common improvement, is credited to this lode.

Total improvements credited to this lode...\$550.00

ARIZONA LODE

No. 1. The discovery shaft which is on the lode line 420 ft from the east center end , 4x6x8 ft. Value \$70.

No. 2. A cut which brs. from cor. 1, S.77°15'E. 1043 ft. 4x6x25 ft. Value \$50.

No. 3. A cut which brs. from cor. 1, N.89°50'E. 912 ft., 4x6x8 ft. Value \$40.

1/6 of shaft No.4, Last Bean lode, (\$200), a common improvement, is credited to this lode, and 1/6 of shaft No. 2, Connection lode, (\$240), a common improvement, is credited to this lode.

Total improvements credited to this lode\$600.

DEMOCRAT LODE

No. 1. The discovery shaft which is on the lode line 10 ft. from the north center end, 4x6x12 ft. Value \$120.

No. 2. A shaft which brs, from cor. 3, N.9°E. 561 ft. 4x6x10 ft. Value \$100.

No.3. A shaft which brs. from cor. 4, N.33°15'E. 242 ft., 4x6x12 ft. Value \$100.

SURVEY NO. 3402 -continued.

EXPENDITURE OF FIVE HUNDRED DOLLARS -continued.

DEMOCRAT LODE -continued.

1/6 of shaft No. 4, Last Bean lode, (\$200), a common improvement, is credited to this lode, and 1/6 of shaft No. 2, Connection lode, (\$240), a common improvement, is credited to this lode.

Total improvements credited to this lode.....\$760.

LAST BEAN LODE.

No. 1. The discovery cut, which is on the lode line 110 ft from the north center end, 5x7x10 ft. Value \$50.

No. 2. A cut the mouth of which brs. from cor. No.1 S.73°40'E. 443 ft. running N.10°E. 30 ft. to the face. 4 ft. wide 10 ft. face. From the face is a tunnel 4x6 ft. running N.10°E. 50 ft. Value of cut and tunnel \$300.

No. 3. A shaft which brs. from cor. 1 S.70°^{30'}E. 485 ft. 8x8x15 ft. Value \$150.

No. 4. A shaft which brs. from cor. No.1, S.67°45'E. 532 ft. 4x6x100 ft., value \$1200, being a common improvement 1/6 (\$200) is credited to this lode.

No. 5. A shaft which brs. from cor. No. 3, N.26°W. 570 ft. 4x6x75 ft. Value \$750.

No. 6. A shaft which brs. from cor. No. 3, N.29°30'W. 664 ft. 4x6x8 ft. Value \$70.

No. 7. A shaft which brs. from cor. No. 3, N.~~29~~³³°W. 523 ft. 4x6x10 ft. Value \$100.

1/6 of shaft No.2, Connection lode, (\$240), a common improvement, is credited to this lode.

Total improvements credited to this lode\$1860.

CONNECTION LODE.

No. 1. The discovery shaft which is on the lode line 315 ft. from the east center end, 4x6x16 ft. Value \$160.

No.2. A shaft which is on the lode line 1004 ft. from the east center end, 4x6x120 ft. value \$1440, being a common improvement, 1/6 (\$240) is credited to this lode.

Total improvements credited to this lode.....\$

SURVEY NO. 3402 -continued.

EXPENDITURE OF FIVE HUNDRED DOLLARS -continued.

CONNECTION LODE -continued.

1/6 of shaft No.4, Last Bean lode,(\$200), a common improvement, is credited to this lode.

Total improvements credited to this lode.....\$600.

STONEWALL LODE.

No. 1. The discovery tunnel which brs from cor. No.3, S.71°E. 725 ft. 4x5 ft. running S.84°E. 100 ft.

Value \$600.

1/6 of shaft No. 4, Last Bean lode (\$200), a common improvement, is credited to this lode, and 1/6 of shaft No. 2, Connection lode (\$240), a common improvement, is credited to this lode.

Total improvements credited to this lode\$1040.

INSTRUMENT.

This survey was made with a Gurley Solar Transit and the courses were deflected from the meridian as determined from direct solar observations. The distances were measured with 100 ft. and 500 ft. steel tapes.

REPORT.

The lode lines of these claims were run direct upon the ground and the corners established by means of offsets from the lode lines. The tie lines were run direct upon the ground.

The section and $\frac{1}{4}$ section corners to which ties were made are properly marked iron pipes. The corners of sur. 2467 are properly marked stones. The corners for surveys 989, 980, 979, 1011, 1004, 983, 981, 993, 994, and 996 were stone mounds which were located from their tie lines to U.S.M. M. No.1, the original posts having evidently been removed or destroyed, and the conflicts were calculated from courses and distances as given in the notes of said surveys.

SURVEY NO. 3402 -continued.

REPORT -continued

These claims are located on rolling ground and the common improvements, shaft No. 4, Last Bean lode, and shaft No. 2, Connection lode, being at lower elevations, are so located that by drifting all the lodes in this claim can be developed.

William A. Merritt
U.S. Mineral Surveyor.

No. 1. The discovery tunnel which
No. 2. Shaft No. 4, Last Bean lode, a common
No. 3. Shaft No. 2, Connection lode, a common improvement, is
Total improvements on this lode

INSTRUMENTS
This survey was made with a surveying transit and
the corners were determined from the meridian as determined
from direct solar observations. The distances were
measured with 100 ft. steel tapes.

THE CLAIMS
The lode lines of these claims were run direct upon the
ground and the corners established by means of old posts
from the lode lines. The lines were run direct upon
the ground.
The section and section corners to which ties were
made are properly marked from pipes. The corners of
No. 1 and No. 2 are properly marked. The corners for
No. 3 are 880, 775, 1011, 1004, 922, 921, 923, 924, and 925 were
found which were located from their ties to U.S.M.S.
No. 1. The original posts having evidently been removed
or destroyed, and the corners were calculated from
courses and distances as given in the notes of said
surveys.

SURVEY NO. 3402

REPORT-continued.

Apr 2 - 1918

Corners 2 Crystal lode, sur. 989; 5 Apache Boy lode, sur. 980; 5 and 6 Fond du Lac lode, sur. 979; 5 and 6 Golden Seal lode, sur. 1011; 6 Turk lode, sur. 983, 2 Neena lode, sur. 981, and 2 Menasha lode, sur. 1004; 3 and 5 Menasha lode, sur. 1004; 2 Copper Point lode, sur. 993 and 3 Oshkosh lode, sur. 994; and 3 Little Chute lode, sur. 996, all of which are tied to cors. of sur. 3402, are remains of stone mounds. As the exact point for these cors. could not be located on the ground the conflicting areas were calculated from courses and distances and ties to U.S.M.M. No.1 as given in the notes of these old surveys.

U.S.M.M. No.1, Harcuvar Mining District, which bears from cor. No. 1 Stonewall lode, sur. 3402, N.20° 5' E. 469.56 ft., is a post 6"x6"x8', scribed U S M M No 1, set in a mound of stone on the top of a rocky knoll.

William H. Meritt
U. S. Mineral Surveyor.

FINAL OATHS FOR SURVEYS.

LIST OF NAMES.

A list of the names of the individuals employed by William H. Merritt
 United States ~~Deputy~~ Mineral Surveyor, to assist in running, measuring, and marking the lines
 corners and boundaries described in the foregoing field notes of the survey of the mining claim
 of J. C. Bullard
 known as the State of Vermont, Arizona, East Branch, Connecticut & Stone Wall, Lodes
 and showing the respective capacities in which they acted.

- R. L. Merritt, Chairman.
- H. R. Powell, Chairman.
- _____ , Arman.
- _____ , Flagman.

FINAL OATHS OF ASSISTANTS.

We, R. L. Merritt
 and H. R. Powell, do solemnly swear that we assisted William H. Merritt,
 United States ~~Deputy~~ Mineral Surveyor, in marking the corners and
 surveying the boundaries of the mining claim of J. C. Bullard

State of Vermont, Arizona, East Branch, Connecticut & Stone Wall, Lodes, known as the
 _____, represented
 in the foregoing field notes as having been surveyed by said ~~deputy~~ mineral surveyor and under
 his direction; and that said survey has been in all respects, to the best of our knowledge and
 belief, faithfully and correctly executed, and the corner and boundary monuments established
 according to law and the instructions furnished by the United States Surveyor-General for
Arizona

- R. L. Merritt, Chairman.
- H. R. Powell, Chairman.
- _____ , Arman .
- _____ , Flagman.

Subscribed and sworn to by the above-named persons before me
 this 27th day of July, 1917.

J. M. W. Moore
 Notary Public

(4-686.)

JUL 30 1917
JUL 1 1919

FINAL OATH OF U. S. DEPUTY MINERAL SURVEYOR

I, William H Merritt, U. S. ~~Deputy~~ Mineral Surveyor, do solemnly swear that, in pursuance of instructions received from the United States Surveyor General for Arizona May 25 - 1917, dated _____, I have, in strict conformity to the laws of the United States, the official regulations and instructions thereunder, and the instructions of said Surveyor General, faithfully and correctly executed the survey of the Mining Claim of J. C. Bullard, known as the State, Democrat, Arizona, Bart-Bear, conductor, Shinnell, lodes, situate in Pierce Mining District, Gambusi County, Ariz, in Section 19 N 11, Township No. 8 N, Range No. 10 W and designated as Survey No. 3402, as represented in the foregoing field notes, which accurately show the boundaries of said mining claim as distinctly marked by monuments on the ground, and described in the attached copy of the location certificate, which was received by me from the Surveyor General with said instructions, and that all the corners of said survey have been established and perpetuated in strict accordance with the law, official regulations and instructions thereunder; and I do further solemnly swear that the foregoing are the true and original field notes of said survey and my report therein, and that the labor expended and improvements made upon said mining claim by claimant or his grantors are as therein fully stated, and that the character, extent, location and itemized value thereof are specified therein with particularity and full detail, and that no portion of said labor or improvements so credited to this claim has been included in the estimate of expenditures upon any other claim.

William H Merritt
U. S. ~~Deputy~~ Mineral Surveyor.

Subscribed and sworn to by the said William H Merritt
U. S. ~~Deputy~~ Mineral Surveyor, before me J. M. Moore
a Notary Public this 27th
day of July 1917.

J. M. Moore
Notary Public

My commission expires Feb 23 1920
o 3-164

William H. Merritt, U. S. Mineral Surveyor, being first duly sworn according to law, deposes and says; I have carefully checked over all of Surveys Nos. 3402 and 3403 surveyed by R. L. Merritt and H. R. Powell, and find the same to be correct as described in the returns of said surveys, and in the future I will carefully and strictly observe the laws, rules and regulations governing the execution of mineral surveys.

William H. Merritt,
U. S. Mineral Surveyor.

Sworn and Subscribed to before
me this 11th day of February 1919

F. C. Moore,
Notary Public.

My Commission expires 2-19-20.

(Original filed with notes of Sur. 3403.)

Notice of Mining Location

LODE CLAIM

TO ALL WHOM IT MAY CONCERN:

This Mining Claim, the name of which is the STATE

Mining Claim, situate on lands belonging to the United States of America, and in which there are valuable mineral deposits, was entered upon and located for the purposes of exploration and purchase by J. C. BULLARD a citizen of the United States of America

(Locator must insert either "a citizen of the United States," or "who has declared his intention to become a citizen of the United States.")

the undersigned, on the 28 day of March, 1912

The length of this claim is 1500 feet, and I claim 1500 feet,

in a East End line Monument direction and feet in a westerly

direction from the center of the ~~discovery shaft~~, at which this notice is posted, lengthwise of the claim, together with three hundred (300)

feet in width of the surface grounds, on each side of the center of said ~~claim~~. The general course of the lode deposit and premises is from the easterly to the westerly

The claim is situated and located in the Piers Mining District, in Yavapai County, in ~~the State of~~ Arizona, about 1500

in a Easterly direction from the U. S. Monument and ajoining the Avalanche on the West End

The surface boundaries of the claim are marked upon the ground as follows: Beginning at a monument of stones

at a point in a n easterly direction feet from

the discovery shaft (at which this notice is posted), being in the center of the east

end line of said claim; thence northerly 300 feet to a monument of

stones, being the northeast corner of said claim;

thence westerly 1500 feet to a monument of stones, being at the

northwest corner of said claim; thence southerly 300 feet

to a monument of stones at the center of the west end of said claim;

thence southerly 300 feet to a monument of stones, being at the

southwest corner of said claim; thence easterly 1500

feet to a monument of stones being at the southeast corner of

said claim; thence northerly 300 feet to the place of the beginning.

All done under the provisions of Chapter Six, of Title XXXII, of the Revised Statutes of the United States, and of an Act of the General Assembly of Arizona, entitled "An Act ^{concerning mines, approved} to ~~Revise and Codify~~ the ~~Laws of the Territory of Arizona,~~ approved March 16, 1901.

March 20th 1895 and amended March 2d 1899 and

Dated and posted on the ground this 28 day of March, 1912

J. C. BULLIARD

23

ss.

County of

I, _____, County Recorder in and for the County and State aforesaid, do hereby certify that the within instrument was filed for record at o'clock M. on this day of, 191....., and duly recorded in Book No..... of Records of County, Arizona, at pages.....

Witness my hand and official seal the day and year first above written.

County Recorder.

Notice of Location

LODE CLAIM

.....
.....
.....
.....
.....
.....
.....
.....
.....
.....

Dated, 191.....

Filed and Recorded at request of
J. C. BILLARD

APRIL 1, A. D. 191.....

at 3:05 o'clock P. M.

Book 92 of Mines

Pages 12 RECORDS OF YAVAPAI COUNTY, ARIZONA

I. S. COWELL

(SEAL) County Recorder

By
Benj. Powers
Deputy Recorder

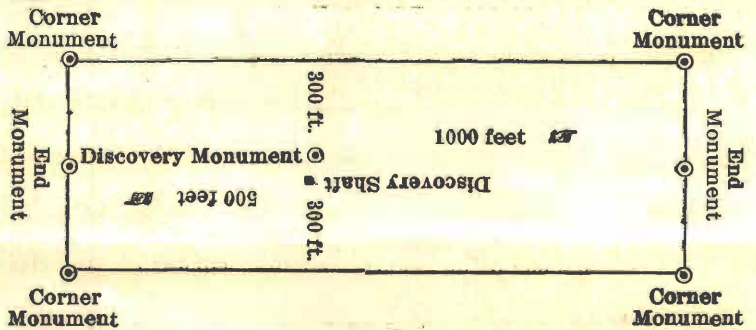

This diagram is to give locator a general idea of plan of location under the new law. The Discovery Shaft can be in the center of claim or any distance from either end desired. In the diagram it is placed 500 feet from one end and 1000 feet from the other. Commence description of claim at a center end monument, giving its distance and direction from center of Discovery Shaft; thence bound the claim in either direction. In description be careful to state locality of claim with reference to some natural object, or permanent monument, as will identify the claim.

Notice of Mining Location

LODE CLAIM

TO ALL WHOM IT MAY CONCERN:

Mar 17, 1917

This Mining Claim, the name of which is the DEMOCRAT

Mining Claim, situate on lands belonging to the United States of America, and in which there are valuable mineral deposits, was entered upon and located for the purposes of exploration and purchase by J. C. BULLARD a citizen of the United States of America

(Locator must insert either "a citizen of the United States," or "who has declared his intention to become a citizen of the United States.")

the undersigned, on the 28 day of Jan, 1917

The length of this claim is 1500 feet,
and I claim 10 feet,
in a Northernly direction and 1490

— feet in a Suthernly direction from
the center of the discovery shaft, at which this notice is posted, lengthwise of the claim, together with
300 feet in width of the surface grounds, on each
side of the center of said claim. The general course of the lode deposit and premises is from the
Northernly to the Southernly

The claim is situated and located in the Piers Mining District,
in Yavapia County, in the Territory State of Arizona, about 600 ft
in a Easterly direction from the U. S. Monument

The surface boundaries of the claim are marked upon the ground as follows: Beginning at
a Monument of stones

at a point in a Northernly direction about 10 feet from
the discovery shaft (at which this notice is posted), being in the center of the North
end line of said claim; thence 300 feet to a Monument
of stones, being the N. W. corner of said claim;
thence 1500 feet to a Monument of Stones, being at the
S. W. corner of said claim; thence Easterly 300 feet
to a Monument of Stones at the center of the South end of said claim;
thence 300 feet to a Monument of Stones, being at the
South East corner of said claim; thence 1500 ft
feet to a Monument of Stone at the North East corner of
said claim; thence 300 feet to the place of the beginning.

All done under the provisions of Chapter Six, of Title XXXII, of the Revised Statutes of the United States, and of an Act of the General Assembly of Arizona, entitled "An Act to Revise and Codify the Laws of the Territory of Arizona," approved March 16, 1901.

Dated and posted on the ground this the 28 day of Jan, 1917

J. C. Bullard

ss.

County of _____

I, _____, County Recorder in and for the County and State aforesaid, do hereby certify that the within instrument was filed for record at _____ o'clock _____ M., on this _____ day of _____, 191____, and duly recorded in Book No. _____ of _____ Records of _____ County, Arizona, at pages _____

Witness my hand and official seal the day and year first above written.

County Recorder.

Notice of Location

LODE CLAIM

Filed and Recorded at request of
J. C. Bullard
 Apr. 1 _____, A. D. 191 2.
 at 5:05 o'clock P.M.
 Book 92 of Mines
 Pages 10 Records of YAVAPAI COUNTY, ARIZONA
I. S. Colwell
 (SEAL) County Recorder
 By **Benj. Powers** Deputy Recorder
 Printed by Prescott Courier

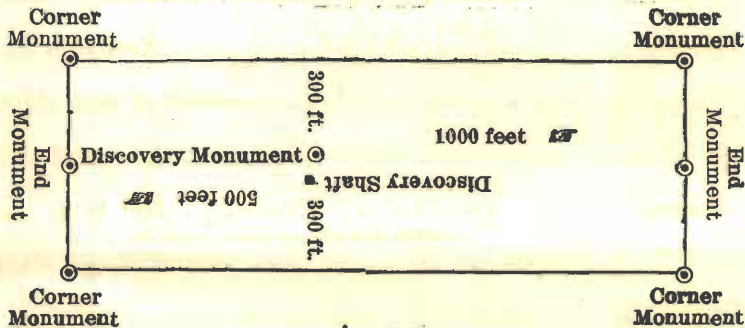

This diagram is to give locator a general idea of plan of location under the new law. The Discovery Shaft can be in the center of claim or any distance from either end desired. In the diagram it is placed 500 feet from one end and 1000 feet from the other. Commence description of claim at a center end monument, giving its distance and direction from center of Discovery Shaft; thence bound the claim in either direction. In description be careful to state locality of claim with reference to some natural object, or permanent monument, as will identify the claim.

Notice of Mining Location

3
26

LODE CLAIM

TO ALL WHOM IT MAY CONCERN:

This Mining Claim, the name of which is the ARIZONA

Mining Claim, situate on lands belonging to the United States of America, and in which there are valuable mineral deposits, was entered upon and located for the purposes of exploration and purchase by

J. C. BULLARD a citizen of the United States of America

(Locator must insert either "a citizen of the United States," or "who has declared his intention to become a citizen of the United States.")

the undersigned, on the 28 day of January, 1912

The length of this claim is 1500 feet,
and 1 claim 400 feet,

in a n easterly direction and 1100
feet in a westerly direction from

the center of the discovery shaft, at which this notice is posted, lengthwise of the claim, together with three hundred

vein (300) feet in width of the surface grounds, on each side of the center of said ~~claim~~. The general course of the lode deposit and premises is from the easterly to the westerly

The claim is situated and located in the Piers Mining District,
in Yavapai County, in the Territory State of Arizona, about 3000 ft

in a Easterly direction from the U. S. Monument and
ajoining the South Side line of the Avalanche

The surface boundaries of the claim are marked upon the ground as follows: Beginning at
a monument of stones

at a point in a easterly direction 400 feet from

the discovery shaft (at which this notice is posted), being in the center of the east

end line of said claim; thence northerly 300 feet to a monument of
stones, being the northeast corner of said claim;

thence westerly 1500 feet to a monument of stones, being at the
northwest corner of said claim; thence southerly 300 feet

to a monument of stones at the center of the west end of said claim;

thence southerly 300 feet to a monument of stones, being at the
southwest corner of said claim; thence easterly 1500

feet to a monument of stones being at the southeast corner of
said claim; thence northerly 300 feet to the place of the beginning.

All done under the provisions of Chapter Six, of Title XXXII, of the Revised Statutes of the United States, and of an Act of the General Assembly of Arizona, entitled "An Act ^{Concerning mines} to Revise and Codify the ^{approved} Laws of the Territory of Arizona," approved March 16, 1901.

Dated and posted on the ground this the 28 day of Jan, 1912

J. C. Bullrd

County of

I,, County Recorder in and for the County and State aforesaid, do hereby certify that the within instrument was filed for record ato'clock.....M. on thisday of, 191....., and duly recorded in Book No.....ofRecords of.....County, Arizona, at pages.....

Witness my hand and official seal the day and year first above written.

County Recorder.

Notice of Location

LODE CLAIM

Filed and Recorded at request of J. C. Bullard April 1, A. D. 1912 at 5:05 o'clock P. M. Book 92 of Mines Page 12 RECORDS OF YAVAPAI COUNTY, ARIZONA

L. S. Colwell County Recorder (SEAL) Benj. Powers Deputy Recorder

Printed by Prescott Courier

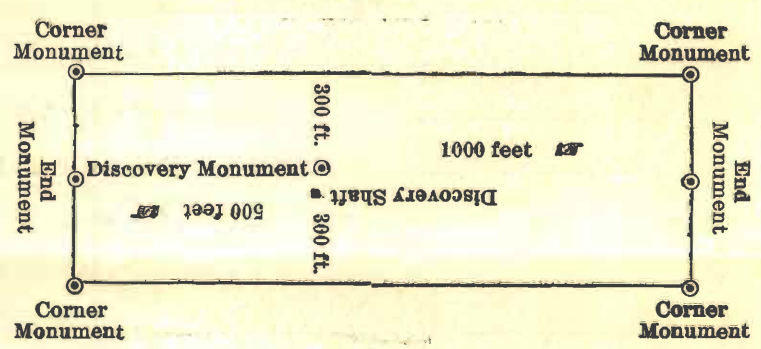

This diagram is to give locator a general idea of plan of location under the new law. The Discovery Shaft can be in the center of claim or any distance from either end desired. In the diagram it is placed 500 feet from one end and 1000 feet from the other. Commence description of claim at a center end monument, giving its distance and direction from center of Discovery Shaft; thence bound the claim in either direction. In description be careful to state locality of claim with reference to some natural object, or permanent monument, as will identify the claim.

NOTICE OF MINING LOCATION
LODE CLAIM

TO ALL WHOM IT MAY CONCERN:

This Mining Claim, the name of which is the LAST BEAN Mining Claim, situate on lands belonging to the United States of America, and in which there are valuable mineral deposits, was entered upon and located for the purpose of exploration and purchase by J. C. BULLARD the undersigned, on the 2nd day of February 1900.

The length of this claim is fifteen hundred feet, and I claim four hundred feet, in a northerly direction and eleven hundred feet in a southerly direction from the center of the discovery shaft, at which this notice is posted, lengthwise of the claim, together with three hundred (300) feet in width of the surface grounds, on each side of the center of said claim. The general course of the lode deposit and premises is from the northerly to the southerly

The claim is situated and located in the Pierce Mining District, in Yavapai County, in the Territory of Arizona, about $\frac{1}{4}$ mile in a Easterly direction from the old Yuma Copper Co. Smelter. This is an abandon claim.

The surface boundaries of the claim are marked upon the ground as follows: Beginning at a monument of stones upon the ledge at a point in a northerly direction four hundred feet from the discovery shaft (at which this notice is posted), being in the center of the north end line of said claim; thence easterly 300 feet to a monument of stones being the northeast corner of said claim; thence southerly 750 feet to a monument at the center of the east side line of said claim; thence southerly 750 feet to a monument of stones being at the southeast corner of said claim; thence westerly 300 feet to a monument of stones at the center of the south end of said claim; thence westerly 300 feet to a monument of stones, being at the southwest corner of said claim; thence northerly 750 feet to a monument of stones being at the center of the west side line of said claim; thence northerly 750 feet to a monument of stones at the northwest corner of said claim; thence easterly 300 feet to the place of beginning.

All done under the provisions of Chapter Six, of Title XXXII, of the Revised Statutes of the United States, and of an Act of the General Assembly of Arizona, entitled "An Act Concerning Mines," approved March 20th, 1895, and amended March 2d, 1899.

Dated and posted on the ground this 2nd day of February 1900.

J. C. BULLARD

Witnessed
R. W. Bullard

Recorded at request of J. C. BULLARD, Feby. 17th A.D. 1900, at 9 o'clock, A.M., Book 53 of Mines, Page 257, Records of Yavapai County, Arizona.

(SEAL) W. I. JOHNSON County Recorder

By P. J. Farley Deputy Recorder

Notice of Mining Location

LODE CLAIM

TO ALL WHOM IT MAY CONCERN:

This Mining Claim, the name of which is the CONNECTION

Mining Claim, situate on lands belonging to the United States of America, and in which there are valuable mineral deposits, was entered upon and located for the purposes of exploration and purchase by J. C. BULLARD a citizen of the United States of America

(Locator must insert either "a citizen of the United States," or "who has declared his intention to become a citizen of the United States.")

the undersigned, on the 28 day of March, 1912

The length of this claim is 1500 feet, and I claim 300 feet, in a n easterly direction and 1200 feet in a westerly direction from

the center of the discovery shaft, at which this notice is posted, lengthwise of the claim, together with three hundred (300) feet in width of the surface grounds, on each side of the center of said ~~claim~~ ^{vain}. The general course of the lode deposit and premises is from the easterly to the westerly

The claim is situated and located in the Piers Mining District, in Yavapai County, in the State of Arizona, about 500 ft in a S. Easterly direction from the U. S. Monument

The surface boundaries of the claim are marked upon the ground as follows: Beginning at a monument of stones

at a point in a n easterly direction 300 feet from the discovery shaft (at which this notice is posted), being in the center of the east end line of said claim; thence northerly 300 feet to a monument of stones, being the northeast corner of said claim; thence westerly 1500 feet to a monument of stones, being at the northwest corner of said claim; thence southerly 300 feet to a monument of stones at the center of the west end of said claim; thence southerly 300 feet to a monument of stones, being at the southwest corner of said claim; thence easterly 1500 feet to a monument of stones being at the southeast corner of said claim; thence northerly 300 feet to the place of the beginning.

All done under the provisions of Chapter Six, of Title XXXII, of the Revised Statutes of the United States, and of an Act of the General Assembly of Arizona, entitled "An Act ^{Concerning Mines} to Revise and Codify the Laws of the Territory of Arizona," approved ^{March 29, 1899 and} ~~March 16, 1901~~ ^{Approved March} 16, 1901.

Dated and posted on the ground this the 28 day of March, 1912

J. C. Bullard

County of _____

I, _____, County Recorder in and for the County and State aforesaid, do hereby certify that the within instrument was filed for record at _____ o'clock _____ M., on this _____ day of _____, 191____, and duly recorded in Book No. _____ of _____ Records of _____ County, Arizona, at pages _____

Witness my hand and official seal the day and year first above written.

County Recorder.

Notice of Location

LODE CLAIM

Dated _____, 191____
Filed and Recorded at request of

J. C. Bullard
April 1 _____, A. D. 191____
at _____ o'clock _____ P. M.
Book 92 of Mines
Page 11 RECORDS OF YAVAPAI COUNTY, ARIZONA

I. S. Colwell
(SEAL) County Recorder
By Benj. Powers
Deputy Recorder

Printed by Prescott Courier

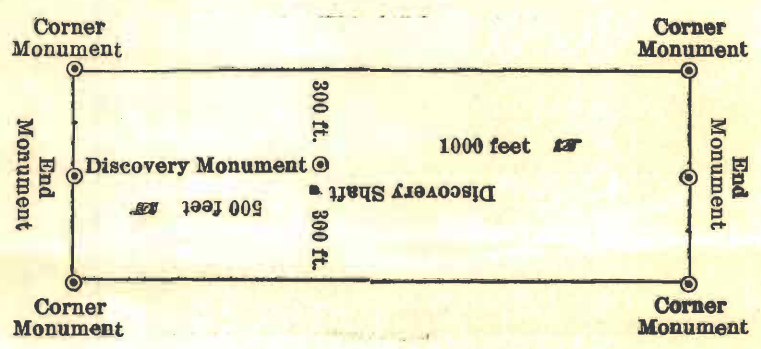

This diagram is to give locator a general idea of plan of location under the new law. The Discovery Shaft can be in the center of claim or any distance from either end desired. In the diagram it is placed 500 feet from one end and 1000 feet from the other. Commence description of claim at a center end monument, giving its distance and direction from center of Discovery Shaft; thence bound the claim in either direction. In description be careful to state locality of claim with reference to some natural object, or permanent monument, as will identify the claim.

STONEWALL

NOTICE OF MINING LOCATION,
QUARTZ CLAIM

TO ALL WHOM IT MAY CONCERN:

This Mining Claim, the name of which is the STONEWALL Mining Claim, situate on lands belonging to the United States of America, and in which there are valuable mineral deposits, was entered upon and located for the purpose of exploration and purchase by J. C. BULLARD, the und undersigned, on the 14th day of February, 1896.

The length of the claim is (1500) fifteen hundred feet and I claim three hundred feet on each side of the discovery shaft at which this notice is posted lengthwise of this claim.

The general course of the lode deposit and premises is from the North to the South. The claim is situated and located in Pierce Mining District, Yavapai County, Territory of Arizona, about one thousand feet in a Westerly direction from U. S. Mineral Monument which is situated on a high bluff. The surface boundaries of the claim are marked upon the ground as follows: Beginning at the North end center monument in which this notice is placed at the discovery shaft; thence running West 300 feet to a monument of stone which is the Northwest corner of claim; thence South 750 feet to a monument of stone being the West side center of claim; thence South 750 feet to a monument of stone being the Southwest corner of said claim; thence East 300 feet to a monument being the South end center of said claim; thence 300 feet East to a monument of stone being Southeast corner of said claim; thence North 750 feet to a monument of stone being the center of the East side line of said claim; thence North 750 feet to a monument of stone being the Northeast corner of said claim; thence West 300 feet to a monument of stone to the place of beginning.

This claim was abandoned property. All done under the provisions of Chapter six of Title XXXI, of the Revised Statutes, of the United States and of an act of the General Assembly of Arizona entitled an act concerning mines, approved March 20th, 1895.

Dated and posted on the ground this 14th day of January, 1896.

Witnesses:
B.M.Crawford
G. S. Burbank
Archie Campbell

JOHN C. BULLARD
Locator

Recorded at request of J. C. BULLARD, March 30th A.D. 1896, at 9 o'clock A.M. in Book 44 of Mines, 119-20, Records of Yavapai County, Arizona.

(SEAL) F. A. Tritle
County Recorder

By M. O. Archibald
Deputy.

State of Arizona,)
 ; -ss.
County of Yavapai.)

I, Edith Ruffner, County Recorder in and for the aforesaid County of Yavapai, State of Arizona, and Custodian of the records of such office, do hereby certify that I have compared the foregoing copies with, and that the same are full, true and complete copies of the Notices of Location of the following named and described Lode Mining Claims, located in the Pierce Mining District, Yavapai County, State of Arizona, namely:-

The DEMOCRAT Mining Claim, recorded in Book 92 of Mines, page 10,
The CONNECTION Mining Claim, recorded in Book 92 of Mines,
at page 11,

The STATE Mining Claim, recorded in Book 92 of Mines, at page 12,

The ARIZONA Mining Claim, recorded in Book 92 of Mines, at page 13,

The LAST BEAN Mining Claim, recorded in Book 53 of Mines, at page 257,

The STONEWALL Mining Claim, recorded in Book 44 of Mines, at page 119.

All in records of Mines, as the same appear of record in my said office.

IN WITNESS WHEREOF. I have hereunto set my hand and affixed my official seal, this 14th day of May, A. D., 1917.



Edith Ruffner
County Recorder,

By _____
Deputy County Recorder

U. S. SURVEYOR-GENERAL'S FINAL CERTIFICATE ON FIELD NOTES.

Department of the Interior,

OFFICE OF U. S. SURVEYOR-GENERAL,

Phoenix, Arizona,

July 11, 1919

I, U. S. Surveyor-General for DISTRICT OF ARIZONA,

do hereby certify that the foregoing transcript of the Field Notes, return and approval of the survey of the mining claim of

J. C. BULLARD,

known as the STATE, DEMOCRAT, ARIZONA, LAST BEAN, CONECTION & STONEWALL Lodes situate in PIERCE

Mining District, YAVAPAI County, ARIZONA,

in Sections 10 Un^{sur}. & 11, Township No. 8 N., Range No. 10 W., and

designated as Survey No. 3402, has been correctly copied from the originals on file in

this office; that said Field Notes furnish such an accurate description of said mining claim as will, if incorporated into a patent, serve fully to identify the premises, and that such reference is made therein to natural objects or permanent monuments as will perpetuate and fix the *locus* thereof.

And I further certify that five hundred dollars' worth of labor has been expended or improved or for each of
 or for each of
 ments made upon said mining claim by claimant or his grantors, and that said improvements consist of 12 shafts, 5 cuts and 2 tunnels, total value \$5410.

As improvements Nos. 4 on the Last Bean lode, and No. 2 on the Conection lode, are common improvements for the benefit and development of this entire group of claims, an undivided interest in each of said improvements, value \$200 and \$240, respectively, is credited to each of the claims in this survey.

and that no portion of said labor or improvements has been included in the estimate of expenditures upon any other claim.

I further certify that the plat thereof, filed in the U. S. Land Office at Phoenix, Arizona is correct and in conformity with the foregoing Field Notes.

Frank P. Trott,

United States Surveyor-General for Arizona.

4-687

SURVEYOR GENERAL'S CERTIFICATE OF APPROVAL OF FIELD NOTES
AND SURVEY OF MINING CLAIM

DEPARTMENT OF THE INTERIOR
OFFICE OF U. S. SURVEYOR GENERAL

Phoenix, Arizona,

July 11, 1919

I, U. S. Surveyor General for DISTRICT OF ARIZONA,

do hereby certify that the foregoing and hereto attached Field Notes and Return of the Survey of the Mining Claim of

J. C. BULLARD,

, known as the

STATE, DEMOCRAT, ARIZONA, LAST BEAN, CONECTION & STONEWALL lodes,

situate in PIERCE mining district,

YAVAPAI County, ARIZONA,

in Sections 10 Unsur., & 11 Township No. 8 N., Range No. 10 W.,

designated as Survey No. 3402

executed by William H. Merritt, U. S. Mineral

Surveyor, June 7-29, 1917, under my instructions dated

May 25, 1917, have been critically examined and the necessary cor-

rections and explanations made, and the said Field Notes and Return, and the Survey they describe,

are hereby approved. The certified copy of the location certificate filed by the applicant for survey is

on file in this office and a true copy of said certified copy of said location certificate is included and made

a part of the transcript of the field notes.



U. S. Surveyor General for Arizona.