

not p. copied 1

8-14-1918 copied ARC  
4-683

2 hrs.

P. Lathel

JAN 11 1918

FEB 11 1918

MINERAL SURVEY No. 3432

Arizona

Land District.

# FIELD NOTES

OF THE SURVEY OF THE MINING CLAIM OF

United Verde Extension Mining Co.

KNOWN AS THE

STAR lode

Verde

Mining District,

Yavapai

County,

Arizona

Section 23

, Township 16 N.

, Range 2 E.

Surveyed under instructions dated Sept. 12th., 1917.

by Harry E. Jones,  
U. S. Mineral Surveyor.

Claim located See location notice, 19

Survey commenced September 27th., 1917.

Survey completed September 28th., 1917.

Address of claimant's Atty. Richard Lamson,  
Jerome, Arizona.

DATES OF AMENDED LOCATIONS.

See location notice.

1  
8 2

SURVEY NO. 3432

Feet	Star Lode
	Beginning at Cor. No. 1
	Identical with location monument, and on line 4-1 Lone Star lode, Sur. No. 1374;
	A 1½ in. by 3½ ft. iron pipe stamped S-1-3432, set 12 ins. in ground, and surrounded with concrete base 12x14x14 ins. with a substantial mound of stone alongside.
	Cor. 1 Lone Star lode, Sur. No. 1374 bears S. 67° 50' W. 102.92 ft.
	The section corner common to Secs. 22-23-26-27, T. 16 N. R. 2 E. G&SRB&M, bears S. 55° 05' W. 480.14 ft.
	A porphyry rock in place 18x24 in. face exposed chiseled BxR-S-1-3432 bears N. 65° 32' W. 7.67 ft.
	A porphyry rock in place 15x30 ins. face exposed chiseled BxR-S-1-3432 bears S. 61° 24' W. 10.05 ft.
	Thence S. 68° 14' E.
0.61	Intersect. line 1-2 Copper Chief lode Sur. No. 1213, at a point which bears N. 0° 49' E. 245.14 ft. from Cor. 1 Copper Chief lode Sur. No. 1213.
35.00	To South End Center, a substantial mound of stone identical with location monument.
112.06	To Cor. No. 2 Identical with location monument A 1½ in. by 3½ ft. iron pipe, stamped S-2-3432, set 12 ins. in ground, and surrounded with concrete base, 12x14x14 ins. with a substantial mound of stone alongside. No bearings available. Thence N. 1° 12' E.
84.70	To Cor. No. 3 Identical with location monument, and intersection of line 4-1 Lone Star lode Sur. No. 1374, and line 5-6 No. 7 lode Sur. No. 1213. Also identical with N. end center Lone Star lode Sur. No. 1374. Replaced stone with a 1½ in. by 3½ ft. iron pipe stamped NEC-LS-1374 and S-3-3432, set 12 ins. in ground, and surrounded with concrete base 12x14x14 ins. with a substantial mound of stone alongside. Cor. 1 Lone Star lode Sur. No. 1374 bears S. 67° 50' W. 217.21 ft. Intersection with line 1-2 Copper Chief lode Sur. No. 1213

Feet with line 4-1 Lone Star lode Sur.No.1374, bears S.67°50'W. 113.67 ft.

Thence N. 68° 14' W.

Along line 6-5 No.7 lode Sur.No.1213.

77.06 To North End-Center, a substantial mound of stone, identical with location monument.

112.06 To Cor: No. 4

Identical with location monument, and Cor.5 No.7 lode Sur. No.1213; On line 1-2 Copper Chief lode Sur.No.1213.

Replaced stone with a 2 in. by 2ft.iron pipe, stamped No.7 -5-1213 and S-4-3432, set 12ins. in ground, and surrounded with concrete base 12x12x12 ins. with a substantial mound of stone alongside.

Cor.1 Copper Chief lode Sur.No.1213 bears S.0°49'W.330.06ft.

Aporphyry rock in place 3x4ft.face exposed chiseled BxR-

No.7-5-1213 and S-4-3432 bears S.29°04'W. 23.95 ft.

A porphyry rock in place 3x5ft.face exposed, chiseled BxR-

S-4-3432 bears S.56°35'W. 30.12 ft.

Intersection of line 4-1 Lone Star lode Sur.No.1374 and

line 1-2 Copper Chief lode Sur.No.1213 bears S.0°49'W.

84.46 ft. No other bearings available.

Thence S. 1° 12' W.

84.70 To Cor: No. 1 the place of beginning.

Variation at all corners 14°45' E.

Lode Line

As near as can be determined from the present development the vein of the location embraced in this claim extends as follows from the discovery point.

N.1°12'E. 24.20ft. and S.1°12'W. 60.50 ft.

Area

Total area Star lode, 0.204 Acres

Area in conflict with--

Lone Star lode Sur.No.1374 0.102 Acres

Copper Chief lode Sur.No.1213 0.001 Acres

Copper Chief lode, Sur.No.1213,

exclusive of its conflict with

Lone Star lode, Sur.No.1374, 0.001 Acres

3

4

### LOCATION

This survey is located in the SW $\frac{1}{4}$  of Section 23, T. 16 N. R. 2 E. G. & S. R. B. & M. In the Verde Mining District; Yavapai County, Arizona. In the Prescott National Forest.

---

### EXPENDITURE OF FIVE HUNDRED DOLLARS

I certify that the value of the labor and improvements made upon or for the benefit of the location embraced in the said mining claim by the claimant or its grantors is not less than five hundred dollars, and that said improvements consist of:

No. 1 Dis. Cut 4x20.5x10 face and tunnel 4x6x50 ft. long both bearing N.68°58'W. and the portal of which bears from Cor.No.3, S.67°50'W. 30.90 ft. The discovery point brs. N. 69°43'35"W. 46.32 ft. from the mouth of cut.

Value	\$ 605.00
-------	-----------

---

### OTHER IMPROVEMENTS

None.

---

### INSTRUMENT

This survey was made with a light mountain W. & L. E. Gurley transit. The courses were deflected from a true meridian as determined by an observation on Polaris at Eastern elongation September 27th. 1917. The distances were measured with 50 and 600 ft. steel tapes.

---

### REPORT

The lines of this claim were run directly upon the ground and the corners established by direct measurements upon these lines. All tie lines were run directly upon the ground. The Public land corner which I had occasion to tie this survey to, was a bronze capped pipe properly marked. The differences of this survey with those which have been approved, are due to errors in the later.

The reason that this survey does not conform more closely to the description of the location notice, is due to error in the later.

  
U. S. Mineral Surveyor.

# FINAL OATHS FOR SURVEYS.

## LIST OF NAMES.

A list of the names of the individuals employed by Harry E. Jones,

United States Mineral Surveyor, to assist in running, measuring, and marking the lines, corners, and boundaries described in the foregoing field notes of the survey of the mining claim of

United Verde Extension Mining Company

known as the STAR lode

and showing the respective capacities in which they acted.

Chas. Troy, Chainman.

Lee Bailey, Chainman.

\_\_\_\_\_, Axman.

\_\_\_\_\_, Flagman.

## FINAL OATHS OF ASSISTANTS.

We, Chas. Troy

and Lee Bailey

, do solemnly swear that we assisted

Harry E. Jones,

United States Mineral Surveyor, in marking the corners and surveying

the boundaries of the mining claim of United Verde Extension Mining Company

known as the STAR lode

represented in the foregoing field notes as having been surveyed by said mineral surveyor and under his

direction; and that said survey has been in all respects, to the best of our knowledge and belief, faithfully

and correctly executed, and the corner and boundary monuments established according to law and the instruc-

tions furnished by the United States Surveyor-General for Arizona

Chas Troy, Chainman.

Lee Bailey, Chainman.

\_\_\_\_\_, Axman.

\_\_\_\_\_, Flagman.

Subscribed and sworn to by the above-named persons before me this

day of November, 1917.

Notary Public.

My commission expires the 7 day of May 1918.

# FINAL OATH OF U. S. MINERAL SURVEYOR.

I, Harry E. Jones, U. S. Mineral Surveyor,  
do solemnly swear that, in pursuance of instructions received from the United States  
Surveyor General for Arizona, dated  
September 12th. 1917., I have, in strict conformity to the laws of the  
United States, the official regulations and instructions thereunder, and the instructions  
of said Surveyor General, faithfully and correctly executed the survey of the Mining  
Claim of United Verde Extension Mining Company  
, known as the  
STAR lode,  
situate in Verde Mining District,  
Yavapai County, Arizona, in Section  
23, Township No. 16 N., Range No. 2 E. G. & S.R.B. & M.,  
and designated as Survey No. 3432, as represented  
in the foregoing field notes, which accurately show the boundaries of said mining claim  
as distinctly marked by monuments on the ground, and described in the attached copy  
of the location certificate, which was received by me from the Surveyor General with  
said instructions, and that all the corners of said survey have been established and per-  
petuated in strict accordance with the law, official regulations and instructions there-  
under; and I do further solemnly swear that the foregoing are the true and original  
field notes of said survey and my report therein, and that the labor expended and  
improvements made upon said mining claim by claimant or its grantors  
are as therein fully stated, and that the character, extent, location, and itemized value  
thereof are specified therein with particularity and full detail, and that no portion of  
said labor or improvements so credited to this claim has been included in the estimate  
of expenditures upon any other claim.

*Harry E. Jones*  
U. S. Mineral Surveyor.

Subscribed and sworn to by the said Harry E. Jones,  
U. S. Mineral Surveyor, before me  
this \_\_\_\_\_  
day of November, 1917.

*[Signature]*  
Notary Public.

My commission expires the 7 day of May 1918.

# Notice of Mining Location

## LODE CLAIM

TO ALL WHOM IT MAY CONCERN:

AUG. 27. 1917

This Mining Claim, the name of which is the Star

Mining Claim, situate on lands belonging to the United States of America, and in which there are valuable mineral deposits, was entered upon and located for the purposes of exploration and purchase by the United Verde Extension Mining Company a corporation organized under the Laws of the State of Delaware

(Locator must insert either "a citizen of the United States," or "who has declared his intention to become a citizen of the United States.")

the undersigned, on the 18th day of January, 1917

The length of this claim is 100 feet, and we claim 250 feet, in a northerly direction and 750

75 feet in a southerly direction from the center of the discovery ~~shaft~~ <sup>cut</sup>, at which this notice is posted, lengthwise of the claim, together with 75 feet in width of the surface grounds, on each side of the center of said claim. The general course of the lode deposit and premises is from the northerly to the southerly

The claim is situated and located in the Verde Mining District, in Yavapai County, in the State of Arizona, about 1/8 miles from Town of Jerome in a southerly direction from Town of Jerome, being all that fractional area lying between the No. 7, Lone Star and Copper Chief patented lode claims

The surface boundaries of the claim are marked upon the ground as follows: Beginning at a monument of stone

at a point in a northerly direction ~~direction~~ 25.0 feet from the discovery ~~shaft~~ <sup>cut</sup> (at which this notice is posted), being in the center of the northerly end line of said claim; thence easterly 75 feet to a mon. of stone, being the N. E. corner of said claim; thence Southerly 150 feet to a mon. of stone, being at the S E corner of said claim; thence Westerly 75 feet to a mon. of stone at the center of the southerly end of said claim; thence westerly 75 feet to a mon. of stone, being at the S. W. corner of said claim; thence northerly 150 feet to a mon. of stone at the N. W. corner of said claim; thence easterly 75 feet to the place of the beginning.

All done under the provisions of Chapter Six, of Title XXXII, of the Revised Statutes of the United States, and of an Act of the General Assembly of Arizona, entitled "An Act to Revise and Codify the Laws of the Territory of Arizona," approved March 16, 1901.

Dated and posted on the ground this 18 day of January, 1917

Witness  
C C Leavitt

United Verde Extension Mining  
Company  
Per L. A. Kehr  
Agent

County of \_\_\_\_\_ } ss.

I, \_\_\_\_\_, County Recorder in and for the County and State aforesaid, do hereby certify that the within instrument was filed for record at \_\_\_\_\_ o'clock \_\_\_\_\_ M., on this \_\_\_\_\_ day of \_\_\_\_\_, 191\_\_\_\_\_, and duly recorded in Book No. \_\_\_\_\_ of \_\_\_\_\_ Records of \_\_\_\_\_ County, Arizona, at pages \_\_\_\_\_.

Witness my hand and official seal the day and year first above written.

\_\_\_\_\_  
County Recorder.

**Notice of Location**

**LODE CLAIM**

\_\_\_\_\_  
\_\_\_\_\_  
\_\_\_\_\_  
\_\_\_\_\_  
\_\_\_\_\_  
Dated \_\_\_\_\_, 191\_\_\_\_\_  
Filed and Recorded at request of

Richard Lamson

Jan 24 \_\_\_\_\_, A. D. 1917

at 11-15 o'clock \_\_\_\_\_ A. M.

Book 104 of Mines

Page 450  
RECORDS OF YAVAPAI COUNTY, ARIZONA

Edith Ruffner  
(SEAL) County Recorder

By Lula McIntosh  
Deputy Recorder

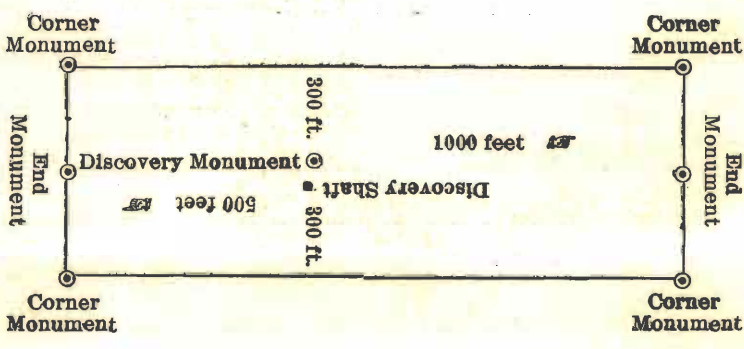

This diagram is to give locator a general idea of plan of location under the new law. The Discovery Shaft can be in the center of claim or any distance from either end desired. In the diagram it is placed 500 feet from one end and 1000 feet from the other. Commence description of claim at a center end monument, giving its distance and direction from center of Discovery Shaft; thence bound the claim in either direction. In description be careful to state locality of claim with reference to some natural object, or permanent monument, as will identify the claim.



STATE OF ARIZONA )  
                          : SS  
COUNTY OF YAVAPAI )

I, EDITH RUFFNER, County Recorder in and for the aforesaid County of Yavapai and State of Arizona, and Custodian of the Records of such Office; DO HEREBY CERTIFY that I have compared the foregoing Copy with, and that the same is a full, true and correct Copy of the Original Location Notice of the STAR Lode Mining Claim, as the same appears of record in Book 104 of Mines, at Page 450, of the records of my said office.

IN WITNESS WHEREOF, I have hereunto set my hand and affixed my Official Seal, this 21st day of August, 1917.

Edith Ruffner  
COUNTY RECORDER  
OF  
YAVAPAI COUNTY  
ARIZONA



By Lollie Butler  
Deputy Recorder

U. S. SURVEYOR-GENERAL'S FINAL CERTIFICATE ON FIELD NOTES.

Department of the Interior,

OFFICE OF U. S. SURVEYOR-GENERAL,

Phoenix, Arizona,

September 7, 1918.

I, U. S. Surveyor-General for Arizona District of Arizona

do hereby certify that the foregoing transcript of the Field Notes, return and approval of the survey of the mining claim of UNITED VERDE EXTENSION MINING CO.,

known as the STAR LODE

situate in VERDE

Mining District, YAVAPAI County, ARIZONA,

in Section 23, Township No. 16 N., Range No. 2 E., and designated as Survey No. 3432, has been correctly copied from the originals on file in this office; that said Field Notes furnish such an accurate description of said mining claim as will, if incorporated into a patent, serve fully to identify the premises, and that such reference is made therein to natural objects or permanent monuments as will perpetuate and fix the *locus* thereof.

And I further certify that five hundred dollars' worth of labor has been expended or improvements made upon said mining claim by claimant or its grantors, and that said improvements consist of 1 cut and tunnel, value \$605.

and that no portion of said labor or improvements has been included in the estimate of expenditures upon any other claim.

I further certify that the plat thereof, filed in the U. S. Land Office at Phoenix, Arizona, is correct and in conformity with the foregoing Field Notes.

Frank P. Trott,

United States Surveyor-General for Arizona.

4-687

SURVEYOR GENERAL'S CERTIFICATE OF APPROVAL OF FIELD NOTES AND SURVEY OF MINING CLAIM

DEPARTMENT OF THE INTERIOR OFFICE OF U. S. SURVEYOR GENERAL

Phoenix, Arizona,

September 7, 1918.

I, U. S. Surveyor General for District of Arizona

do hereby certify that the foregoing and hereto attached Field Notes and Return of the Survey of the Mining Claim of

UNITED VERDE EXTENSION MINING CO.,

known as the

SCAR LOLE

situate in VERDE mining district,

YAVAPAI County, ARIZONA,

in Section 23, Township No. 16 N., Range No. 2 E.,

designated as Survey No. 3432

executed by Harry E. Jones, U. S. Mineral

Surveyor, September 27-28, 1917, under my instructions dated

September 12, 1917, have been critically examined and the necessary cor-

rections and explanations made, and the said Field Notes and Return, and the Survey they describe,

are hereby approved. The certified copy of the location certificate filed by the applicant for survey is

on file in this office and a true copy of said certified copy of said location certificate is included and made

a part of the transcript of the field notes.

U. S. Surveyor General for Arizona.