

Platted

Copied 11-19-1918,

4-683 A L II

MAL-519-8

MINERAL SURVEY No. 3457

Arizona Land District.

FIELD NOTES

OF THE SURVEY OF THE MINING CLAIM OF

M.E.Gibson

KNOWN AS THE

Rustler No.1, Winner No.1, Winner No. II, Winner No.3, Winner No.4, Winner No.5, Winner No.6, Reddington lodes.

Ajo Mining District,

Pima County, Arizona.

Sections 15, 16, 21 & 22, Township 12 S., Range 6 W. (Unsurveyed) G. & S.R.B. & M.

Surveyed under instructions dated Nov. 21st., 1917

by Paul E. Fernald U. S. Mineral Surveyor.

Claim located (See location notices attached)

Survey commenced Jan. 22nd., 19 18

Survey completed Feb. 26th., 19 18

Address of claimant's attorney:- C.T.Reddington, Ajo, Ariz.

MINERAL SURVEY NO. 3457

Claims	M & B Desc.	Improvements	Loc. Notices
Reddington	Pg.1	Pg. 11	Red Pg. 11
Rustler No. 1	9	13	1
Winner No. 1	2	11	3
Winner No. II	3	12	4
Winner No. 3	4	12	5
Winner No. 4	6	12	7
Winner No. 5	7	13	8
Winner No. 6	8	13	9

U.S. MINERAL SURVEY NO. 3457.

Feet.	<u>REDDINGTON LODE:-</u>
	Beginning at Cor.No.1., identical with the S.E. Cor. of Choctaw No.1. Lode, Unsurveyed.
	A 1 inch iron pipe, 3½ feet long with claw base, set 1½ feet in the ground and surrounded by a monument of stones. Brass cap on pipe stamped U.S. Mineral Survey No. 3457, 1-RED.
	Whence U.S.L.M.No. 3161, Ajo Mining District, bears N 64° 54' E, 8228.92 feet.
	Thence N 89° 52' W
300.00	North end center - 4x4 post in monument of stones.
600.00	Cor.No.2, identical with the S.W. Cor. Choctaw Lode, unsvd. A 1 inch iron pipe, 3½ feet long with claw base, set 1½ feet in the ground and surrounded by monument of stones. Brass cap on pipe stamped U.S. Mineral Survey No. 3457, 2-RED.
	Thence S 1 6' W
35.00	Crosses road running S.E., thence S.
659.48	Intersects line 2-3, Winner No.1 lode, this survey, at point N 89 1' W, 35. feet from Cor.No.2.
660.00	Cor.No.3, ident. with S.E. Cor. Edna No.1. Lode, unsvd. A 1 inch iron pipe, 3½ feet long with claw base, set 1½ feet in the ground and surrounded by monument of stones. Brass cap on pipe stamped U.S. Mineral Survey No. 3457, 3-RED.
	Thence S 89 52' E
22.00	Crosses road running south.
35.00	Cor.No.2, Winner No.1 Lode, this survey, identical with Cor.No.3, Luna No.11 Lode, Sur.No.3160. A, hereinafter described, whence the North End Center of said Luna No. II Lode bears N 89 49' 38" E, 298.97 ft.
52.00	Crosses road running E.-N.E. thence E.
300.00	South end center - 4x4 post in mound of stones.
600.00	Cor.No.4. A 1 inch iron pipe, 3½ feet long with claw base, set 1½ feet in the ground, surrounded by monument of stones. Brass cap on pipe stamped U.S. Mineral Survey No. 3457, 4-RED.

Whence Cor.No.4, Luna No.II Lode, Sur.No. 3I60A,
 identical with Cor.No.3, Luna No.I2 Lode; Sur.No.3I60A,
 bears N 88 12'E, 28.72 feet.

The N.End center said Luna No.II Lode; bears N 89 31'10"W
 266.04 feet.

Thence N 1 6'E

1.03 Intersects line from N.End Center to Cor.No.4, Luna No.II
 Lode, Sur.No.3I60A, at point S 89 44½'E, 266.05 from
 the North End Center.

7.00 Crosses road running East.

660.00 Cor.No.I, the point of beginning.

WINNER NO. I LODE.

Beginning at Cor.No.I, identical with Cor.No.2, Winner No.
 II Lode; this survey, and located at point 894.44; line
 2-3, Luna No.II Lode, Survey No.3I60A.

A 1 inch iron pipe, 3½ feet long with claw base, set 1½
 feet in the ground, surrounded by monument of stones.

Brass cap on pipe stamped U.S.Mineral Survey No.3457, I-
 Winner I.

Whence U.S.M.N.No.I, Ajo.Mining.District, Pima County,
 Arizona, bears S 23 38'E, 9015.26 feet.

Thence N 1 5'E.

300.00 East end center - 4x4 post in monument of stones.

520.00 Crosses wash running East.

588.00 Crosses road running N.E.

600.00 Cor.No.2, identical with Cor.No.3, Luna No.II Lode, Sur.
 No.3I60A.

A 4x4 post, solid in the ground and surrounded by large
 monument of stones. Copper plate screwed to S.W.face
 stamped "U.S.Mineral Survey No.3457, 2 Winner I".

On line 3-4, Reddington Lode, this survey, at point
 S 89 52'E, 35.00 feet from Cor.No.3.

Thence N 89 1'W

13.00 Crosses road running South.

35.00 Intersects line 2-3, Reddington Lode, this survey, at
 point N 1 6'E, 0.52 feet from Cor.No.3.

U.S. MINERAL SURVEY NO. 3457.

- 300.00 Crosses road running south.
- 335.00 S.W. Cor. Edna No. 1 lode, unsurveyed, identical with the S.E. Cor. America No. 1 lode, unsurveyed.
- 530.00 Crosses center of wash, running S 80 0'E.
- 635.00 South End Center America No. 1 lode, unsurveyed.
- 928.00 Crosses road running south.
- 935.00 S.W. Cor. America No. 1 lode, unsurveyed, identical with the S.E. Cor. America No. 2 lode, unsurveyed.
- I235.00 South end center America No. 2 lode, unsurveyed.
- I320.00 Cor. No. 3. ident. N.E. Cor. Edna No. 6 lode, unsurveyed.
 A 1 inch iron pipe, 3½ feet long with claw base, set 1½ feet in the ground, surrounded by monument of stones.
 Brass cap on pipe stamped U.S. Mineral Survey No. 3457, 3-Winner I.
 Thence S° I 5'W
- 300.00 West end center - 4x4 post in stones.
- 600.00 Cor. No. 4. identical with Cor. No. 3, Winner No. II lode, this survey.
 A 1 inch iron pipe, 3½ feet long with claw base, set 1½ feet in the ground, surrounded by monument of stones.
 Brass cap on pipe stamped U.S. Mineral Survey No. 3457, 4-Winner I.
 Thence S 89 I'E
- 705.00 Crosses road running south.
- 1011.00 Crosses road running south.
- 1301.00 Crosses road running south.
- I320.00 Cor. No. I, the point of beginning.
WINNER NO. II LODE.
 Beginning at Cor. No. I, identical with Cor. No. 2, Winner No. 3 lode, this survey, and located at point 294.44, # line 2-3, Luna No. 11 lode, Survey No. 3160 A.
 A 1 inch iron pipe, 3½ feet long with claw base, set 1½ feet in the ground, surrounded by monument of stones.
 Brass cap on pipe stamped U.S. Mineral Survey No. 3457, 1-Winner 2.

Whence U.S.Mineral Monument No.1, Ajo Mining District,
Pima County, Arizona, bears S 25 20'E, 8474.23 feet.

Cor.No.1, Luna No.11 lode, Survey No.3160 A, bears
S 63 27'E, 664.21 feet.

Thence N 1 5'E

300.00 East end center, a 4x4 post in monument of stones.

518.00 Crosses road running east.

600.00 Cor.No.2. identical with Cor.No.1, Winner No.1 lode, this
survey, heretofore described. Brass cap on pipe
stamped additionally for this corner "2 Winner 2".

Thence N 89 1'W.

19.00 Crosses road running south.

309.00 Crosses road running south.

615.00 Crosses road running south.

1320.00 Cor.No.3, identical with Cor.No.4, Winner No.1 lode, this
survey, heretofore described. Brass cap on pipe
stamped additionally for this lode "3 Winner 2".

Thence S 1 5'W

40.00 Crosses road running east.

300.00 West end center, 4x4 post in monument of stones.

600.00 Cor.No.4. identical with Cor.No.3, Winner No.3 lode, this
survey.

A 1 inch iron pipe, $3\frac{1}{2}$ feet long with claw base, set $1\frac{1}{2}$
feet in the ground, surrounded by monument of stones.

Brass cap on pipe stamped U.S.Mineral Survey No.3457, 4-
Winner 2.

Thence S 89 1'E

1306.00 Crosses road running south.

1320.00 Cor.No.1, the point of beginning.

WINNER NO.3 LODE.

Beginning at Cor.No.1, identical with Cor.No.2, Winner
No.4 lode, this survey, not set, and falling at point on
line 2-3, Luna No.10 lode, Survey No.3160 A, SO 9'W,
305.58 feet from Cor.No.3.

Whence U.S.Mineral Monument No.1, Ajo Mining District,

U.S. MINERAL SURVEY NO. 3457.

Pima County, Arizona, bears S 27 13 $\frac{1}{2}$ 'E, 7938.79 feet.

Cor.No.4, Luna No.10 lode, Survey No.3160 A, bears
N 63 13'E, .672.70 feet.

This corner, falling in the center of a small wash, could
not be permanent if set, hence a witness corner was set
N. 0° 36 $\frac{1}{2}$ ' E. 20 ft.
^ as hereinafter described.

Thence N. 0° 36 $\frac{1}{2}$ ' E

- 20.00 W.C. to Cor.No.1.
A 1 inch iron pipe, 3 $\frac{1}{2}$ feet long with claw base, set 1 $\frac{1}{2}$
feet in the ground, surrounded by monument of stones.
Brass cap on pipe stamped U.S. Mineral Survey No.3457, I-
Winner 3, W.C. 20.
- 296.00 Crosses road running N.E., thence E.
- 300.00 East end center - 4x4 post in monument of stones.
- 305.59 Intersects line 3-4, Luna No.10 lode, Survey No.3160 A,
at point S 89'46'E, 2.44 feet from Cor.No.3.
Identically, intersects line 1-2, Luna No.11 lode, Sur.
No.3160 A, at point S 89 46'E, 2.44 feet from Cor.No.2.
- 600.00 Cor.No.2, identical with Cor.No.1, Winner No.II Lode, this
survey, heretofore described. Brass cap on pipe
additionally stamped for this corner "2 Winner 3".
Whence Cor.No.2, Luna No.II lode, Survey No.3160 A, bears
S 1 5'W, 294.44 feet.
Thence N 89 1'W
- 14.00 Crosses road running south.
- 1320.00 Cor.No.3, identical with Cor.No.4, Winner No.II lode, this
survey, heretofore described. Brass cap on pipe
additionally stamped for this corner "3 Winner 3".
Thence S 0 36 $\frac{1}{2}$ 'W
- 300.00 West end center - 4x4 post in monument of stones, ident.
with the S.E. Cor. Edna No.6 lode, unsurveyed.
- 600.00 Cor.No.4, identical with Cor.No.3, Winner No.4 Lode, this
survey.
A 1 inch iron pipe, 3 $\frac{1}{2}$ feet long with claw base, set 1 $\frac{1}{2}$
feet in the ground, surrounded by monument of stones.
Brass cap on pipe stamped U.S. Mineral Survey No.3457, 4-

Winner 3.
 Thence S 89 1'E
 1250.00 Center small wash running in from S.W.
 1310.00 Crosses road running south.
 1320.00 Cor.No.1, the point of beginning.
WINNER NO.4 LODE.
 Beginning at Cor.No.1, identical with Cor.No.2, Winner
 No.5 lode, this survey, and located at point 587.54 ff. line
 2-3, Luna No.10 lode, Survey No.3160 A.
 A 1 inch iron pipe, $3\frac{1}{2}$ feet long, set $1\frac{1}{2}$ feet in the
 ground, with claw base and surrounded by monument of stone.
 Brass cap on pipe stamped U.S.Mineral Survey No.3457, 1-
 Winner 4.
 Whence U.S.Mineral Monument No.1, Ajo Mining District,
 Pima County, Arizona, bears S-29 21 $\frac{1}{2}$ 'E, 7411.10 feet.
 Thence N 0 9'E
 300.00 East end center - 4x4 post in monument of stones.
 580.00 W.C. to Cor.No.2, being S 0 9'W, 20.00 feet from true
 corner point.
 A 1 inch iron pipe, $3\frac{1}{2}$ feet long with claw base, set $1\frac{1}{2}$
 feet in the ground and surrounded by monument of stones.
 Brass cap on pipe stamped U.S.Mineral Survey No.3457, 2-
 Winner 4, W.C. 20.
 600.00 ^{Point for} Cor.No.2, identical with ^{point for} Cor.No.1, Winner No.3 lode, this
 survey, not set, W.C. heretofore described, brs. S 0 09' W. 20 ft.
 Thence N 89 1'W
 10.00 Crosses center road running south, in from S.W.
 70.00 Crosses center small wash, running in from S.W.
 1320.00 Cor.No.3, identical with Cor.No.4, Winner No.3 lode, this
 survey, heretofore described. - Brass cap on pipe
 additionally stamped for this lode. "3 Winner 4".
 Thence S 0 9'W
 300.00 West end center, 4x4 post in monument of stones.
 600.00 Cor.No.4, identical with Cor.No.3, Winner No.5 lode, this
 survey.
 A 1 inch iron pipe, $3\frac{1}{2}$ feet long with claw base, set $1\frac{1}{2}$

U.S. MINERAL SURVEY NO. 3457.

- feet in the ground and surrounded by monument of stones.
- Brass cap on pipe stamped U.S. Mineral Survey No. 3457, 4-Winner 4.
- Thence S 89° 1'E
- I299.00 Crosses road running south.
- I320.00 Cor. No. 1, the point of beginning.
- WINNER NO. 5 LODE.
- Beginning at Cor. No. 1, identical with Cor. No. 2, Winner No 6 lode, this survey, and located at point 288.54 ft line 2-3, Luna No. 10 lode, Survey No. 3160 A.
- A 1 inch iron pipe, 3½ feet long with claw base, set 1½ feet in the ground and surrounded by monument of stones.
- Brass cap on pipe stamped U.S. Mineral Survey No. 3457, 1-Winner 5.
- Whence U.S. Mineral Monument No. 1, Ajo Mining District, Pima County, Arizona, bears S 30 32'E, 7152.07 feet.
- Thence N 0 9'E
- I98.00 East end center - 4x4 post in monument of stones.
- 299.00 Cor. No. 2, identical with Cor. No. 1, Winner No. 4 Lode, this survey, heretofore described. Brass cap on pipe additionally stamped for this lode "2 Winner 5".
- Thence N 89° 1'W
- 21.00 Crosses road running south.
- I320.00 Cor. No. 3, identical with Cor. No. 4, Winner No. 4 Lode, this survey, heretofore described. Brass cap on pipe additionally stamped for this lode "3 Winner 5".
- Thence S 0 9'W
- I01.00 West end center - 4x4 post in monument of stones.
- 299.00 Cor. No. 4, identical with Cor. No. 3, Winner No. 6 lode, this survey.
- A 1 inch iron pipe, 3½ feet long with claw base, set 1½ feet in the ground and surrounded by monument of stones.
- Brass cap on pipe stamped U.S. Mineral Survey No. 3457, 4-Winner 5.
- Thence S 89° 1'E
- I302.00 Crosses road running south,

1320.00 Cor.No.I, the point of beginning.

WINNER NO.6 LODE.

Beginning at Cor.No.1, identical with Cor.No.4, Rustler No.1 lode, this survey, and located at point 458.63 # line 2-3, Luna No.17 lode, Survey No.3160 A.

A 1 inch iron pipe, $3\frac{1}{2}$ feet long with claw base, set $1\frac{1}{2}$ feet in the ground and surrounded by monument of stones. Brass cap on pipe stamped U.S.Mineral Survey No.3457, 1-Winner 6.

Whence U.S.Mineral Monument No.1, Ajo Mining District, Pima County, Arizona, bears S 33 4'E, 6635.07 feet.

Cor.No.4, Luna No.17 lode, Survey No.3160 A, bears N 62 $12\frac{1}{2}$ 'E, 662.76 feet.

Cor.No.3, Luna No.17 lode, Survey No.3160 A, bears N 2 38'W, 311.64 feet.

Thence N 1° 17' 40"W

300.00 East end center - 4x4 post in monument of stones.

311.36 Intersects line 3-4, Luna No.17 lode, Survey No.3160 A, at point S 89 47'E, 7.27 feet from Cor.No.3.

Identically intersects line 1-2, Luna No.10 lode, Sur. No.3160 A, at S 89 47'E, 7.27 feet from Cor.No.2.

600.00 Cor.No.2, identical with Cor.No.1, Winner No.5 lode, this survey, heretofore described. Brass cap on pipe additionally stamped for this corner "2 Winner 6".

Whence Cor.No.2, Luna No.10 lode, Survey No.3160 A, bears S 0 9'W, 288.54 feet.

Cor.No.1, Luna No.10 lode, Survey No.3160 A, bears S 64 8'E, 666.66 feet.

Thence N 89 1'W

18.00 Crosses road running south.

1320.00 Cor.No.3, identical with Cor.No.4, Winner No.5 lode, this survey, heretofore described. Brass cap on pipe additionally stamped for this corner "3 Winner 6".

Thence S 1 17'40"E

300.00 West end center - 4x4 post in monument of stones.

600.00 Cor.No.4.

A 1 inch iron pipe, $3\frac{1}{2}$ feet long with claw base, set $1\frac{1}{2}$

U.S. MINERAL SURVEY NO. 3457.

	feet in the ground, and surrounded by a monument of stones. Brass cap on pipe stamped U.S. Mineral Survey No. 3457, 4-Winner 6.
	Thence S 89 1'E
720.00	Cor. No. 3, Rustler No. 1 lode, this survey.
1020.00	North end center - Rustler No. 1 lode, this survey.
1252.00	Crosses road running south.
1320.00	Cor. No. 1, the point of beginning.
	<u>RUSTLER NO. 1 LODE.</u>
	Beginning at Cor. No. 1.
	A 1 inch iron pipe, $3\frac{1}{2}$ feet long with claw base, set $1\frac{1}{2}$ feet in the ground and surrounded by a monument of stones. Brass cap on pipe stamped U.S. Mineral Survey No. 3457, 1-Rustler 1.
	Whence U.S. Mineral Monument No. 1, Ajo Mining District, Pima County, Arizona, bears S 41 10'E, 5395.91 feet.
	Cor. No. 3, Old Ore No. 6 lode, Survey No. 3160 A, bears S 2 23'E, 446.14 feet.
	Thence N 89 1'W
1.36	Intersects line 2-3, Old Ore No. 6 lode, Survey No. 3160 A, at point S 2 33 $\frac{1}{2}$ 'E, 1041.29 feet from Cor. No. 3.
300.00	South end center - 4x4 post in monument of stones.
600.00	Cor. No. 2.
	A 1 inch iron pipe, $3\frac{1}{2}$ feet long with claw base, set $1\frac{1}{2}$ feet in the ground and surrounded by a monument of stones. Brass cap on pipe stamped U.S. Mineral Survey No. 3457, 2-Rustler 1.
	Thence N 2 38'W
1500.00	Cor. No. 3; at point 720 on line 4-5, Winner No. 6 lode, this sur.
1800.00	A 1 inch iron pipe, $3\frac{1}{2}$ feet long with claw base, set $1\frac{1}{2}$ feet in the ground and surrounded by a monument of stones. Brass cap on pipe stamped U.S. Mineral Survey No. 3457, 3-Rustler 1.
	Thence S 89 1'E
300.00	North end center - 4x4 post in monument of stones.
532.00	Crosses road running south.
600.00	Cor. No. 4, identical with Cor. No. 1, Winner No. 6 lode, this

survey, heretofore described. Brass cap additionally stamped "4 Rustler 1" for this corner.

Thence S 2 38'E

458.63 Cor.No.2, Luna No.17 lode, Survey No.3160 A, whence Cor. No.1, same lode, bears S 89 46'E, 599.18 feet.

Identically, Cor.No.3, Old Ore No.6 lode, Survey No.3160 A whence Cor.No.4, same lode, bears N 87 10'E, 599.92 feet.

1500.00 Cor.No.1, the point of beginning.

* * * * *

Magnetic variation at all corners - 14 degrees East.

No natural bearing objects available from corners of this survey.

All corners of this survey are identical with the respective corners of locations.

LODE LINES. As near as can be determined from the present state of development, the veins of the locations embraced in this survey, extend as follows from their respective discovery points:-

Reddington lode, S 1 6'W, 150. feet and N 1 6'E, 510. ft.

Winner No.1 lode, S 89 1'E - 1204. ft. and N 89 1'W, 116.ft.

Winner No.11 lode, S 89 1'E - 1120. ft. and N 89 1'W- 200.ft.

Winner No.3 lode, S 89 1'E - 977. ft, and N 89 1'W -- 343.ft.

Winner No.4 lode, S 89 1'E - 150.ft, and N 89 1'W - 1170.ft.

Winner No.5 lode, S 89 1'E - 150. ft, and N 89 1'W- 1170.ft.

Winner No.6 lode, S 89 1'E - 150.ft. and N 89 1'W - 1170.ft.

Rustler No.1 lode, S 2 38'E - 150. feet, and N 2 38'W - 1350. feet.

LOCATION. This survey is located, approximately, in the East half of Sections 15, ^{16, 21 & 22} and the N.E. 1/4 of Section 8, T. 12 S., R. 6 W., G. & S.R.B. & M, Unsurveyed, in the Ajo Mining District, Pima Co. Arizona.

AREAS:- Total area Reddington lode. 9.090 acres
Reddington lode - conflict with Luna No. 11 lode, Survey No.3160 A .014 "
Reddington lode - conflict with Winner No.1 lode, this survey. .000+ "
Winner No.1 lode, total area 18.182 "
Winner No.11 lode. " " 18.182 "

U.S. MINERAL SURVEY NO. 3457

Winner No.3 lode. total area	18.181 acres
Winner No.3 lode, conflict with Luna No. 11 lode, Survey No.3160 A.	.008 "
Winner No.3 lode, conflict with Luna No. 10 lode, Survey No.3160 A.	.009 "
Winner No.4 lode, total area	18.180 "
Winner No.5 lode, " "	9.060 "
Winner No.6 lode, " "	18.167 "
Winner No.6 lode, conflict with Luna No. 10 lode, Sur.No.3160 A,	.024 "
Winner No.6 lode, conflict with Luna No. 17 lode, Sur.No.3160 A.	.026 "
Rustler No.1 lode, total area.	20.620 "
Rustler No.1 lode, conflict with Old Ore No.6 lode, Sur.No.3160 A.	.016 "

IMPROVEMENTS:-

I certify that the value of the labor and improvements made upon or for the benefit of, the Rustler No.1, Winner No.1 and Winner No.11 locations of this claim, by the claimant or his grantors, is not less than five hundred dollars - that the value of labor and improvements made upon or for the benefit of the Winner No.3, Winner No.4, Winner No.5, Winner No.6 and Reddington locations of this claim, by the claimant or his grantors, is less than five hundred dollars, and that such improvements consist of:-

REDDINGTON LODE.

No.1, Discovery shaft, on center line N 1° 6' E, 150. feet from the south end center. Shaft 4x6 - 8½ feet deep.

Value \$42.50

A 1/8th interest in improvement No.2, Winner No.4 lode, this survey, hereinafter described.

Value \$226.50

WINNER NO.1 LODE.

No.1, Discovery point, on outcrop of formation, on center line S 89° 1' E, 116. feet from West end center.

No.2, ~~Discovery~~ shaft, the center of which bears S 8° 32' E, 25.00 feet from discovery point, apparently thus located to the side of discovery point where the nature of the

ground was more advantageous for sinking. Shaft is
4x5½ - 20 feet deep. Value \$185.00

No.3. Shaft, 4½x6 - 57 feet deep, the center of which bears
S 25° 25' W, 118. feet from point 300.00, line 2-3.

Value \$640.00

A 1/8th. interest in improvement No.2, Winner No.4 lode,
this survey, hereinafter described.

Value \$226.50

WINNER NO. II LODE.

No.1. Discovery point, at outcrop of formation, on center
line S 89° 1' E, 200. feet from the west end center.

No.2. ~~Discovery~~ shaft, the center of which bears S 10° 28' W
15.00 feet from the discovery point, apparently thus
located to the side of discovery point where the nature
of the ground was more advantageous for sinking. Shaft
is 4x6 - 19 feet deep.

Value \$190.00

No.3. Shaft, 4½x4½ - 85 feet deep, the N.W. Cor. of which
bears S 59° 9' W, 264.63 feet from Cor.No.2.

Value \$720.00

A 1/8th. interest in improvement No.2, Winner No.4 lode,
this survey, hereinafter described.

Value \$226.50

WINNER NO.3 LODE.

No.1. Discovery point, at outcrop of formation, on center
line S 89° 1' E, 343. feet from the west end center.

No.2. ~~Discovery~~ shaft, the center of which bears S 2° 55' W
7.25 feet from the discovery point, apparently thus located
to the side of discovery point where the nature of the
ground was more advantageous for sinking. Shaft is
4x6 - 8½ feet deep.

Value \$42.50

A 1/8th. interest in improvement No.2, Winner No.4 lode,
this survey, hereinafter described.

Value \$226.50

WINNER NO.4 LODE.

No.1, Discovery shaft, 4x6 - 8½ feet deep, the center of

U.S. MINERAL SURVEY NO. 3457.

which is on center line, N 89° 1' W, 150. feet from the East end center.

Value \$42.50

No.2. Churn drill hole, the center of which bears S 87° 1' W, 572.21 feet from Cor.No.2.. Hole is 10 inch diameter from top to 16 feet depth, thence 7 5/8th inches diam. to bottom, 145 feet deep, and in process of sinking.

Value at present depth \$1812.00

This drill hole is designed to explore and develop the strata underlying this claim as a whole, the characteristic form of ore deposition throughout the entire district being in the nature of extensive bedded deposits as distinguished from vein formations. Hence this improvement constitutes a common improvement of equal benefit to each location embraced in this claim, and an equal 1/8th. interest in its value is properly accredited to each location in this claim.

1/8th. interest accredited to this location

Value \$226.50

WINNER NO.5 LODE.

No.1. Discovery shaft, 4x6 - 8 1/2 feet deep, on center line 150 feet from the east end center.

Value \$42.50

A 1/8th. interest in improvement No.2, Winner No.4 lode, this survey, heretofore described.

Value \$226.50

WINNER NO.6 LODE.

No.1. Discovery shaft, 4x6 - 8 1/2 feet deep, on center line 150 feet from the east end center.

Value \$42.50

A 1/8th. interest in improvement No.2, Winner No.4 lode, this survey, heretofore described.

Value \$226.50

RUSTLER NO.1 LODE.

No.1. Discovery shaft, 4x6 - 8 1/2 feet deep, on center line 150 feet from the south end center.

Value \$42.50

No.2. Shaft, 4x12 - average $5\frac{1}{2}$ feet deep, the center of which bears N $49^{\circ} 0' W$, 374. feet from Cor.No.1.

Value \$55.00

No.3. Shaft, 4x6 - 20 feet deep, the center of which bears N $37^{\circ} 56' W$, 88.5 feet from point 798.44 ~~f.~~ line 4-1.

Value \$200.00

A $\frac{1}{8}$ th. interest in improvement No.2, Winner No.4 lode, this survey, heretofore described.

Value \$226.50

OTHER IMPROVEMENTS:-

REDDINGTON LODE:

From Cor.No.3.

N $20^{\circ} 17' E$, 216.90 feet to S.W.Cor.frame house $18 \times 40\frac{1}{2}$ ft.

N $41^{\circ} 1' E$, 122.15 feet to S.W.Cor,frame house 24×9 ft.

N $79^{\circ} 1' E$, 80.90 feet to S.W.Cor.frame house 24×9 ft.

From south end center:-

N $48^{\circ} 42' W$, 77.32 feet to S.E.Cor.frame house 20.4×25.3 ft.

WINNER NO.1 LODE.

From point 300.00, line 2-3.

S $45^{\circ} 47' E$, 276.87 feet to N.E.Cor.tent house $9' 10" \times 8'$.

S $31^{\circ} 44' E$, 217.30 feet to N.E.Cor.tent house $17' 9" \times 11' 8"$ with wing $10' \times 8' 4"$.

S $12^{\circ} 36' E$, 108.06 feet to N.W.Cor.frame & iron stable $11' 10" \times 16' 2"$.

S $34^{\circ} 1' W$, 126.00 feet to N.E.Cor.frame house $26' 2" \times 20' 2"$.

S $62^{\circ} 9' W$, 242.45 feet to N.E.Cor.frame house $20' 2" \times 24' 2"$.

From point 900.00, line 2-3.

S $51^{\circ} 0' E$, 215.20 feet to S.W.Cor.frame house $20 \times 12'$.

S $37^{\circ} 22' E$, 172.85 feet to S.W.Cor.tent house $12' \times 9' 8"$.

From Cor.No.3.

S $46^{\circ} 5' E$, 174.35 feet to N.W.Cor.frame house $24' 3" \times 10' 3"$.

S $8^{\circ} 14' E$, 117.41 feet to N.W.Cor.tent house $15' 9" \times 14'$.

From point on center line, 300.00 feet from E.End Center.

S $83^{\circ} 30' E$, 202.95 feet to S.W.Cor.frame house $24' 3" \times 12' 3"$.

S $13^{\circ} 8' E$, 104.15 feet to N.W.Cor.store bldg. $16' 3" \times 36'$.

U.S. MINERAL SURVEY NO. 3457.

S 8° 33'E, 172.95 feet to N.W. Cor. tent house 14'x12'.

S 25° 2'W, 109.55 feet to N.E. Cor. frame house 14'2"x12'2".

S 43° 30'W, 168.90 feet to N.W. Cor. frame house 35'x12'3".

S 46° 21'W, 205.45 feet to N.E. Cor. tent house 15'6"x12'.

S 60° 6'W, 214.00 feet to N.E. Cor. frame house 20'2"x14'2".

N 83° 39'W, 57.92 feet to N.E. Cor. frame house 28'4"x10'2".

From point on center line 637. feet from East end center.

S 82° 6'E, 133.55 feet to S.W. Cor. frame shed 10'2"x16'4".

S 27° 1'E, 117.62 feet to N.W. Cor. frame and iron shed
40'x50'5".

S 11° 23'W, 129.40 feet to N.E. Cor. frame house 31'9"x12'.

S 37° 55'W, 139.27 feet to N.E. Cor. frame house 20'2"x12'8".

N 70° 5'E, 38.05 feet to S.E. Cor. frame house 24'6"x26'2".

From point on center line 900. feet from the east end center.

N 53° 15'E, 25.25 feet to N.W. Cor. frame house 24'4"x14'4".

S 39° 9'E, 146.10 feet to N.W. Cor. frame house 10'2"x22'1".

S 22° 11'E, 121.65 feet to N.E. Cor. tent house 14'x15'10".

S 2° 21'E, 111.88 feet to N.W. Cor. tent house 14'x15'9".

S 26° 33'W, 149.00 feet to N.E. Cor. frame house 12'4"x30'4".

S 21° 49'W, 181.53 feet to N.E. Cor. frame house 12'4"x30'4".

N 81° 50'W, 83.14 feet to S.E. Cor. frame house 12'2"x20'.

S 82° 35'W, 167.96 feet to S.E. Cor. frame house 42'x14'2".

From point 1020. line 4-1.

N 85° 43'W, 148.00 feet to S.E. Cor. tent house 12'2"x14'2".

N 19° 52'W, 290.65 feet to S.E. Cor. frame house 14'2"x12'.

N 26° 10'W, 142.90 feet to S.E. Cor. tent house 27'x7'9".

From point 683. line 4-1.

N 16° 38'W, 57.23 feet to S.E. Cor. store bldg. 34'6"x12'2"

with wing 20'3"x30'.

From point 420. line 4-1.

N 19° 31'E, 25.35 feet to S.W. Cor. tent house 12'1"x35'10".

N 87° 10'E, 19.06 feet to N.W. Cor. frame house 14'1"x12'.

The southern part of this building lies inside

Winner No. 2 lode, this survey.

N 84° 8'E, 86.36 feet to N.W. Cor. frame house 34'2"x18'2".

From Cor. No. 1. being partly within boundaries of Winner No. 2 lode,

N 8° 20'W, 284.55 feet to S.E. Cor. frame house 38'x20'3".

From W.E.C. S. 83° 29' E 160.77 ft. to S.W. Cor. frame house 14 1/2 x 22 ft.

WINNER NO. 11 LODE.

From Cor.No.2.

- S 21° 29' W, 101.98 feet to N.E.Cor.frame bldg. 40'3"x25'4".
- S 42° 2' W, 116.77 feet to N.E.Cor.frame bldg. 28'2"x12'.
- S 55° 16' W, 163.98 feet to N.E.Cor.frame bldg. 20'5"x70'2".

From point 300. line 2-3.

- S 16° 27' E, 99.35 feet to N.W.Cor.frame house 50'4"x30'4"
- S 49° 5' W, 145.32 feet to N.E.Cor.tent house 18'2"x14'6".
- S 61° 10' W, 191.00 feet to N.E.Cor.frame house 24'2"x12'2".
- S 80° 40' W, 168.85 feet to S.E.Cor.frame house 38'2"x18'2".

From point 637. line 2-3.

- S 77° 46' E, 136.95 feet to S.W.Cor.tent house 14'x12'.
- S 49° 7' E, 185.58 feet to N.W.Cor.tent house 7'9"x9'10".
- S 28° 59' E, 109.15 feet to N.W.Cor.frame bldg. 20'5"x16'7".
- S 22° 27' E, 137.75 feet to N.W.Cor.frame bldg. 16'2"x14'5".
- S 11° 14' W, 97.35 feet to N.E.Cor.concrete bldg. 61'8"x27'9".
- S 38° 58' W, 225.40 feet to N.E.Cor.iron shed 16'2"x12'2".
- S 58° 59' W, 186.00 feet to N.E.Cor.frame house 24'2"x16'4".
- S 64° 56' W, 259.50 feet to N.E.Cor.tent house 31'6"x14'2".
- S 75° 46' W, 119.80 feet to S.E.Cor.frame house 64'6"x18'2".

From point 900. line 2-3.

- S 57° 0' W, 176.85 feet to N.E.Cor.tent house 11'8"x9'7".

From Cor.No.3.

- S 41° 54' E, 33.52 feet to S.W.Cor.frame house 30'4"x24'3".

From point on center line 300. feet from east end center.

- S 68° 23' W, 273.00 feet to N.E.Cor.tent house 24'x12'.
- N 86° 23' E, 70. feet to S.W.Cor.frame house 43'11"x24'4".
- S 81° 3' E, 147.24 feet to S.W.Cor.frame house 35'x19'10".
- S 65° 51' E, 230.90 feet to N.W.Cor.frame house 21'x12'.
- S 57° 49' E, 174.50 feet to N.W.Cor.frame house 28'3"x16'3".
- S 9° 31' E, 172.20 feet to N.W.Cor.frame house 16'x22'4".

From point on center line 900. feet from East end center.

- S 87° 10' W, 81.53 feet to S.E.Cor.frame house 40'4"x28'4".
- S 58° 3' E, 198.70 feet to N.W.Cor.frame house 34'7"x14'.

From Cor.No.1.

- N 15° 48' W, 291.60 feet to S.E.Cor.tent house 12'x12'.

U. S. MINERAL SURVEY NO. 3457.

N 6° 6' W, 281.08 feet to S.E. Cor. frame house 26' 4" x 22'.

N 28° 58' W, 72.12 feet to S.E. Cor. frame house 12' 2" x 20'.

N 76° 7' W, 144.40 feet to S.E. Cor. tent house 9' 6" x 14'.

N 61° 22' W, 181.78 feet to N.E. Cor. frame house 42' 4" x 13' 8".

From point 420. line 4-1.

N 86° 19' W, 91.60 feet to S.E. Cor. frame house 20' 2" x 24'.

S 88° 56' E, 138.50 feet to S.W. Cor. frame house 24' 2" x 32' 4".

WINNER NO. 3 LODE.

From point 900. line 2-3.

S 88° 14' W, 240.60 feet to S.E. Cor. frame house 46' 4" x 10'.

S 64° 0' W, 218.00 feet to N.E. Cor. frame house 20' 2" x 20' 2".

S 65° 22' E, 240.63 feet to N.W. Cor. frame house 12' 6" x 20' 4".

From East end center.

N 16° 12' W, 191.57 feet to S.E. Cor. tent house 14' x 7' 9".

N 46° 33' W, 229.40 feet to N.E. Cor. tent house 34' 8" x 9' 9".

N 53° 16' W, 62.45 feet to S.E. Cor. tent house 8' 2" x 10'.

N 70° 17' W, 86.18 feet to S.E. Cor. tent house 14' 1" x 12' 2".

S 16° 40' W, 151.43 feet to N.E. Cor. frame house 10' x 24'.

S 59° 48' W, 166.47 feet to N.E. Cor. tent house 15' 6" x 11' 10".

S 54° 3' W, 201.90 feet to N.E. Cor. frame house 20' 3" x 20'.

From point on center line 300. feet from East end center.

S 30° 41' E, 143.50 feet to N.W. Cor. tent house 25' 1" x 11' 11".

S 12° 48' E, 126.15 feet to N.W. Cor. frame house 20' 2" x 12' 3".

S 5° 9' E, 301. feet to center well, 4½ x 4½ - 36 feet deep.

S 13° 55' W, 251.20 feet to N.E. Cor. frame house 12' x 24' 3".

S 68° 0' W, 233.90 feet to N.E. Cor. frame house 20' x 24' 3".

N 9° 18' W, 297.68 feet to S.E. Cor. frame house 29' x 20' 5".

N 23° 20' W, 129.57 feet to S.E. Cor. tent house 10' x 13' 6".

N 34° 5' W, 193.90 feet to S.E. Cor. tent house 14' x 11' 10".

From point on center line 573.47 feet from East end center.

S 32° 52' W, 272.20 feet to N.E. Cor. frame house 28' x 12'.

S 22° 0' W, 247.15 feet to N.E. Cor. frame house 28' x 12'.

S 2° 45' W, 231.86 feet to N.W. Cor. frame house 16' x 12' 4".

S 2° 3' E, 232.07 feet to N.W. Cor. frame house 20' x 12' 2".

N 2° 1' W, 180.66 feet to S.W. Cor. frame house 21' x 15'.

N 13° 23' E, 184.40 feet to S.E. Cor. frame house 20' 3" x 12' 2".

N 15° 45' E, 308.45 feet to S.W. Cor. frame house 28' x 12' 2".

extending across boundary into Winner No.2 lode, this survey.

From point on center line 795.42 feet from east end center.

S 57°37'W, 237.39 feet to N.W. Cor. house 26'x20'.

INSTRUMENT.

This survey was made with Buff&Buff special transit No.7905. The courses were deflected from the true meridian as determined by direct solar observation. Distances were measured with 350 and 100 foot steel tapes.

ADJOINING AND CONFLICTING CLAIMS.

This claim is adjoined on the north by the America No.1 and America No.2 lodes, unsurveyed, H.T.Lyons, Claimant; the Edna No.1 lode, unsurveyed, J.McNew, Claimant, and the Choctaw No.1 lode, unsurveyed, - Malone, claimant. On the North West by the Edna No.6 lode, unsurveyed, J. McNew, claimant.. On the east by the Luna No.11, Luna No.10, Luna No.17 and Old Ore No.6. lodes, all of Survey No.3160 A, the same conflicting slightly with locations of this survey slightly as shown herein.

REPORT. The lines of this survey were run direct upon the ground.

U.S.L.M.No.3161 is a 6x6 post, 5 feet above ground, surrounded by a monument of stones 3 feet high and with 6 foot base. It is located on the north end of a small black butte rising from flat country. Post is scribed on south face U.S.M.M.No.3161. Two bearing rocks noted.

U.S.Mineral Monument No.1, Ajo Mining District, Pima County, Arizona, is a 2½ inch iron pipe, 19 feet above ground, surrounded by masonry monument 3 feet high. Copper plate soldered to pipe stamped U.S.Mineral Monument No.1, Ajo Mining District, Pima County, Arizona. This monument is situated on high conglomerate knob.

Corners of Edna No.1, Edna No.6 and Choctaw lodes, unsurveyed, are 4x4 pine posts.

Corners of America No.1 and America No.2 lodes, unsurveyed

U.S. MINERAL SURVEY NO. 3457.

are $3\frac{1}{2}$ inch steel pipes, set in concrete, and surrounded by monuments of stone.

All corners of Survey No. 3160A herein noted are 4x4 posts scribed with lode name and corner number, and survey number.

Cor. No. 4, Luna No. 11 Lode, Sur. No. 3160A, identical with Cor. No. 3, Luna No. 12 Lode, same survey, being lost, I re-established on line between the north end centers of the respective lodes (S 89 44 $\frac{1}{2}$ 'E), and at proportionate distances between same - $\frac{294.74}{289.55} = \frac{294.9}{289.7}$ (as reported).

The south end center monument and Cor. No. 1, of Luna No. 11 Lode, Survey No. 3160A - identical with Cor. No. 2, Luna No. 12 Lode, same survey, also Cor. No. 1, Luna No. 12 Lode, same survey, being lost, I re-established Cor. No. 1, Luna No. 11 Lode on line between Cor. No. 2 of that lode, and the south end center of Luna No. 12 lode (S 89 46'E), and at a proportionate distance between these points - $\frac{599.73}{290.97}$ prop. to $\frac{600.00}{291.10}$.

I have to report the following errors in Sur. No. 3160 A: -
Luna No. 11 Lode.

Line 3-4. N 89 49'38"E, 298.97 ft. to N. End Center, thence S 89 44 $\frac{1}{2}$ 'E, 294.74 feet to Cor. No. 4, vice S 89 47'E.

593.9 feet.

Line 2-3, N 1 5'E, 1494.44 ft., vice N 1 2'E, 1496.6 feet.

Luna No. 10 Lode.

Line 1-2, N 89 47'W, 600.63 feet vice N 89 47'W, 600. ft.

Luna No. 17 Lode.

Line 3-4, identical with line 1-2, Luna No. 10 Lode.

" 2-3, N 2 38'W, 770.27 ft. vice N 2 37'W, 771.0 ft.

" 1-2, N 89 46'W, 599.18 ft. vice N 89 47'W, 600.0 ft.

Old Ore No. 6 Lode.

Line 3-4. N 87 10'E, 599.92 ft. vice N 87 10'E, 599.30 ft.

The differences between locations embraced in this survey as marked upon the ground, and as described in the respective location notices, is due to error of description in the location notices.

Paul E. Fernald

Notes on re-establishment
U.S.MINERAL MONUMENT NO.I
Ajo Mining District, Pima Co. Arizona.

Re-Establishment of U.S. Mineral Monument No. I.

Ajo Mining District, Pima County, Arizona.

In connection with U.S. Mineral Survey No. 3457, same being situated on unsurveyed public land, I found that U.S. Mineral Monument No. I, Ajo Mining District, Pima County, Ariz., constituted the nearest established ^{mineral monument} to which to tie the locations of the above survey. This mineral monument I found to have been entirely destroyed by long exposure to the weather, so it was necessary to re-establish same.

The notes of original establishment of U.S.M.M. No I, Ajo Mining District, Pima County, Arizona, are as follows:-

"Monument established Dec. 14, 1882. On apex of large conglomerate rock 40 x 60 feet and 50 feet high, on east side of Gunsight and Gila Bend road, I drilled a hole 4 feet deep, and tamped into same some copper-(Bronze) ore. Also set firmly into same a pine post, 4 x 6 inches, 4½ feet long, dressed and marked on north side "U.S.M.M.No. I" and on S. side "Ajo D", and built mound of stones around post 4 x 4 feet at base and 3½ feet high.

From which post a stone monument on apex of high White mountain bears N 56° W, about one and one fourth miles distant. An old monument of masonry at side of road above mentioned bears N 84 50' W, 1100. feet distant. A large stone monument on apex of Lookout Mountain bears S 87 15' W, about 5000. feet distant. Drilled a hole 4 inches deep in apex of conglomerate rock and tamped same full of copper (Bronze) ore N 70 19' E. 46. feet distant. Magnetic Variation 12 47' E.

(S) L.D. Chillson
U.S. Dep. Min. Sur.

Tucson, A.T.
Jan 27th - 1883.

In re-establishing this monument, I located the large conglomerate rock, and after some search, the drill hole, from which with a miners spoon I dug out some of the copper pyrite (Bronze) ore mentioned. From this point there is no conglomerate rock bearing N 70 19' E, but at S 70 5' E, 45.68 feet, I found a drill hole on top of a conglomerate knob, in which I found particles of the sulphide copper (Bronze) ore mentioned. Locating the drill hole first mentioned as the true point for this monument, I blasted out a hole 2 feet deep in the solid rock, and set therein a 2½ inch iron pipe, 21 feet long, plumbed to vertical position. I filled the excavation with cement mortar, and built around pipe a mound of masonry 3 feet high. Pipe painted red and white in alternate feet, and to it, six feet above ground, I soldered a copper plate, stamped "U.S. Mineral Monument No. I, Ajo Mining District, Pima County, Arizona.

Re-establishment of U.S. Mineral Monument No. 1, Ajo Mining District, Pima County, Arizona.

The surface of the knob on which this monument is located being unsuited for marking for bearing rocks, at three points on same, I drilled holes, and set therein, in concrete, lengths of drill steel. These bear from monument as follows:-

- S 17 31'W, 12.86 feet.
- N 80 47'E, 7.60 feet.
- N 41 46'W, 9.37 feet.

Other bearings taken from monument as follows:-

- N 55 54'W, Monument with post, apex White Mountain.
- S 87 24'W, Stone monument, - top Lookout Mt.
- S 87 13'W, New Cornelia Copper Co. triangulation station L.
- S 65 21'W, Top high sharp peak.
- S 25 29'E, Prominent rock - top black mountain.
- S 70 5'E, 45.68 feet. Old drill hole at top conglomerate knob,
- N 15 58'E, 3648.20 feet. New Cornelia Copper Co. triangulation station J.
- N 7 29'E, Smoke stack; New Cornelia Copper Co. plant.

L.D. Chilson
U.S. Dep. Min. Sur.

Established December 27th. 1917.

Magnetic Variation 14 0'E.

Paul E. Fernald.

U.S. Mineral Surveyor.

In re-establishing this monument, I located the large conglomerate rock, and after some search, the drill hole, from which surveyor U.S. Mineral Surveyor, dug out some of the copper pyrite (Bronze) ore mentioned. From this point there is no conglomerate rock bearing N 70 18'W, but at S 70 5'E, 45.68 feet, I found a drill hole on top of a conglomerate knob, in which I found particles of the sulphide copper (Bronze) ore mentioned. Locating the drill hole first mentioned as the true point for this monument, I blasted out a hole 2 feet deep in the solid rock, and set therein a 2 1/2 inch iron pipe, 21 feet long, plumbed to vertical position. I filled the excavation with cement mortar, and built around pipe a mound of masonry 3 feet high. Pipe painted red and white in alternate feet, and to it, six feet above ground, I soldered a copper plate, stamped "U.S. Mineral Monument No. 1, Ajo Mining District, Pima County, Arizona."

County, Arizona.

U.S. MINERAL SURVEY NO. 3457

DIRECT SOLAR OBSERVATION FOR MERIDIAN:- Jan. 30th. 1918. 10.36 A.M. (Denver Standard)

Lat. N 32 23 1/2'. Decl. S 17 48' 3.8" = 40.74" x 5.6

3'48.1" / S 17 44 1/2'

Direct:-

L 38 7 1/2', Alt. 30 49' (-1 3/4') = 30 47 1/2'

Cos. Q = sin. 17 44 1/2' / cos. 32 23 1/2' = .30466 / .844405 = .36080 / .85907 = .41999

- tan. 32 23 1/2' x tan. 30 47 1/2' = .634415 x .59583 = .37800 / .79799

Defl. / .79799 = Cos. 38 7' 30" / S 1 3' 50" W

Reverse:- .36080 / cos. 31 16 1/2' = .36080 / .854685 = .42214

-.634415 x tan. 31 16 1/2' = .634415 x .60741 = .38535 / .80749

Defl. / .80749 = cos. 37 14' 30" / S 1 5' 30" W

Average direct and reverse S 1 4' 40" W! approx. S 1 5' W.

Base = E.E.C. Winner No. 2 lode, deflections from E. End line.

Natural functions used, and figuring done with Monroe Calculator.

Decl. taken from Grew's Eph. 1918.

do not copy

FINAL OATHS FOR SURVEYS.

LIST OF NAMES.

A list of the names of the individuals employed by Paul E. Fernald

United States ~~Deputy~~ Mineral Surveyor, to assist in running, measuring, and marking the lines, corners, and boundaries described in the foregoing field notes of the survey of the mining claim of M.E. Gibson

known as the Rustler No.1, Winner No.I, Winner No.II, Winner No.3, Winner No.4, Winner No.5, Winner No.6, Reddington, lodes.
and showing the respective capacities in which they acted.

D.Dooley , Chainman.
L.Denio , Chainman.
..... , Axman.
..... , Flagman.

FINAL OATHS OF ASSISTANTS.

We, D.Dooley

and L.Denio , do solemnly swear that we assisted Paul E. Fernald , United States ~~Deputy~~ Mineral Surveyor, in marking the corners and surveying the boundaries of the mining claim of M.E. Gibson

known as the Rustler No.I, Winner No.I, Winner No.II, Winner No.3, Winner No.4, Winner No.5, Winner No.6, Reddington lodes.

represented in the foregoing field notes as having been surveyed by said ~~deputy~~ mineral surveyor and under his direction; and that said survey has been in all respects, to the best of our knowledge and belief, faithfully and correctly executed, and the corner and boundary monuments established according to law and the instructions furnished by the United States Surveyor-General for Arizona

D. Dooley , Chainman.
L. Denio , Chainman.
..... , Axman.
..... , Flagman.

Subscribed and sworn to by the above-named persons before me this 2nd

day of March , 19 18

Corneilus T. Readmyton
Notary Public

(4-686.)

FINAL OATH OF U. S. ~~DEPUTY~~ MINERAL SURVEYOR

I, Paul E. Fernald, U. S. ~~Deputy~~ Mineral Surveyor, do solemnly swear that, in pursuance of instructions received from the United States Surveyor General for Arizona, dated Nov. 21st. 1917, I have, in strict conformity to the laws of the United States, the official regulations and instructions thereunder, and the instructions of said Surveyor General, faithfully and correctly executed the survey of the Mining Claim of M. E. Gibson

known as the Rustler No. 1, Winner No. I, Winner No. II, Winner No. 3, Winner No. 4, Winner No. 5, Winner No. 6, Reddington lodes situate in Ajo Mining District, Pima County, Arizona, in Sections 15, 16, 21 & 22, Township No. 12 S., Range No. 6 W. (Unsurveyed) and designated as Survey No. 3457 G. & S. R. B. & M., as represented in the foregoing field notes, which accurately show the boundaries of said mining claim as distinctly marked by monuments on the ground, and described in the attached copy of the location certificate, which was received by me from the Surveyor General with said instructions, and that all the corners of said survey have been established and perpetuated in strict accordance with the law, official regulations and instructions thereunder; and I do further solemnly swear that the foregoing are the true and original field notes of said survey and my report therein, and that the labor expended and improvements made upon said mining claim by claimant or his grantors are as therein fully stated, and that the character, extent, location and itemized value thereof are specified therein with particularity and full detail, and that no portion of said labor or improvements so credited to this claim has been included in the estimate of expenditures upon any other claim.

Paul E. Fernald.

U. S. ~~Deputy~~ Mineral Surveyor.

Subscribed and sworn to by the said Paul E. Fernald,

U. S. ~~Deputy~~ Mineral Surveyor, before me Cornelius T. Readington a Notary Public of Pima Co. Ariz. this 2nd day of March 1918

Cornelius T. Readington
Notary Public

Notice of Mining Location

LODE CLAIM

TO ALL WHOM IT MAY CONCERN:

This Mining Claim, the name of which is the Rustler No.1
Mining Claim, situate on lands belonging to the United States of America, and in which there are valuable
mineral deposits, was entered upon and located for the purpose of exploration and purchase by
M.E.Gibson Jr. and M.E.Gibson, Sr., citizens of U.S.
(Locator must insert either "a citizen of the United States" or "who has declared his intention to become a citizen of the United States"

the undersigned on the 9th day of October, 1915
The length of this claim is 1500 feet,
and we claim 150 feet
in a southerly direction and 1350
feet in a northerly direction from
the center of the discovery shaft, at which this notice is posted, lengthwise of the claim, together with
300 feet in width of the surface grounds, on each side
of the center of said claim. The general course of the lode deposit and premises is from the north
south to the south

The claim is situated and located in the Ajo Mining District, in
Pima County in the State of Arizona, about 1 1/4 miles
in a northwesterly direction from United States Mineral
Monument No.1

The surface boundaries of the claim are marked upon the ground as follows: Beginning at
at a point in a southerly direction 150 feet from
the discovery shaft (at which this notice is posted), being in the center of the south
end line of said claim; thence westerly 300 feet to a monument
being the south west corner of said claim; thence
north 1500 feet to a monument, being at the
north west corner of said claim; thence easterly 300 feet
to a monument at the center of the north end of said claim;
east 300 feet to a monument being at the
north east C. corner of said claim; thence southerly 1500
feet to a monument at the south east corner of said claim;
thence westerly 300 feet to the place of beginning.

All done under the provisions of Chapter Six, of Title XXXII, of the Revised Statutes of the United States, and of an Act of the General Assembly of Arizona entitled "An Act to Revise and Codify the Laws of the Territory of Arizona," approved March 16, 1901.

Dated and posted on the grounds this 9th day of October, 1915
M.E.Gibson Jr., M.E.Gibson, Sr.

Filed and recorded at request of M.E.Gibson, Jany. 4, A.D. 1916 at 9-10 A.M.
R.B.Vinson, County Recorder
By L.M.Shibell, deputy

Excerpts from the Mining Laws of the State of Arizona

Title XLVII of the Revised Statutes of 1901, and Amendments Thereto

Sec. 2. Such location shall be made by erecting at or contiguous to the point of discovery a conspicuous monument of stones not less than three feet in height, or an upright post, securely fixed, projecting at least four feet above the ground, in which monument of stones or on which post there shall be posted a location notice which shall be signed by the name or names of the locator or locators.

Sec. 4. From the time of the location of a mining claim, as above specified, the locator shall be allowed ninety days within which to do or cause to be done the following things:

2. To sink a discovery shaft in the claim to a depth of at least eight feet from the lowest part of the rim of the shaft at the surface, and deeper, if necessary, until there is disclosed in said shaft, mineral in place.

Sec. 6. Such surface boundaries shall be marked by six substantial posts projecting at least four feet above the surface of the ground or by substantial stone monuments at least three feet high, to-wit: One at each corner of said claim and one at the center of each end-line thereof.

Sec. 8. Location notices may be amended at any time and the monuments changed to correspond with the amended location; Provided, That no change shall be made that will interfere with the rights of others.

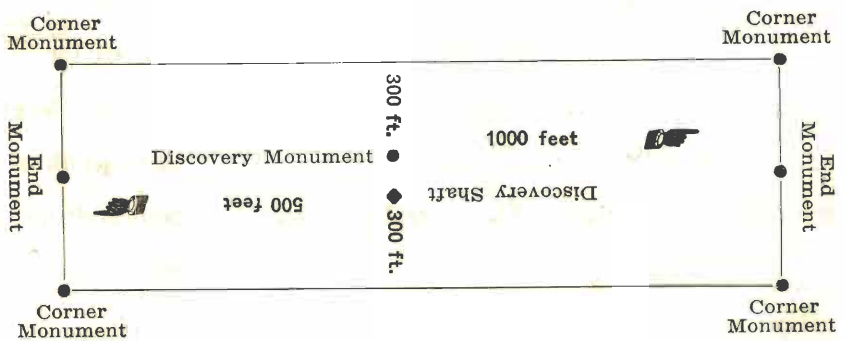

This diagram is to give locator a general idea of plan of location under the new law. The Discovery Shaft can be in the center of claim or any distance from either end extended. In the diagram it is placed 500 feet from one end and 1000 feet from the other. Commence description of claim at a center end monument, giving its distance and direction from center of Discovery Shaft; thence bound the claim in either direction. In description be careful to state locality of claim with reference to some natural object, or permanent monument, as will identify the claim.

Notice of Location
LODE CLAIM

Certified Copy of

Rustler No. 1 Mining Claim,

Dated _____, 19____

Filed and Recorded at request of

M. E. Gibson,

Jany. 4, A. D. 1916

at 9-10 A. M.

Book X.X. Records of Mines,

Pages 110

R. B. Vinson
County Recorder.

By _____
Deputy Recorder.

County Recorder.

STATE OF ARIZONA, }
County of _____ }
I, _____, County Recorder in and for the County and State
aforesaid, do hereby certify that the within instrument was filed for record at _____ o'clock _____ M.,
on this _____ day of _____ 19____, and duly recorded in Book No. _____
of _____ Records _____ County, Arizona, at pages _____.

WITNESS my hand and official seal the day and year first above written.

AMENDED
Notice of Mining Location
LODE CLAIM

NOV 21 1917

To All Whom It May Concern:

This Mining Claim, the name of which is the Winner No 1
Mining Claim, situate on lands belonging to the United States of America, and in which there are valuable mineral deposits, was entered upon and located for the purposes of exploration and purchase by M. E. Gibson a citizen of United States

(Locator must insert either "a citizen of the United States," or, "who has declared his intention to become a citizen of the United States.")
the undersigned, on the 31st day of March 1917

The length of this claim is 1320 feet,
and 1 claim 1204 feet,
in a easterly direction and 116
feet in a westerly direction from
the center of the discovery shaft, at which this notice is posted, lengthwise of the claim, together with
300 feet in width of the surface grounds, on each
side of the center of said claim. The general course of the lode deposit and premises is from the
west to the east

The claim is situated and located in the ago Mining District, in
Pima County, in the State of Arizona, about 8900 feet

in a northwesterly direction from U.S. Mineral Monument No 1
ago Mining District, and the east end line of this claim joins line
2-3 of the Tuna Eleven Claim, Survey No 3160 A; the south side line
of this claim is identical with the north side line of Winner No 2 claim

The surface boundaries of the claim are marked upon the ground as follows: Beginning at
a post

at a point in a Easterly direction 1204 feet from
the discovery shaft (at which this notice is posted,) being in the center of the east
end line of said claim; thence northerly 300 feet to a post
westerly 1320 feet to a post, being at the
northwest corner of said claim; thence southerly 300 feet
to a post at the center of the west end of said claim;
thence southerly 300 feet to a post, being at the
southwest corner of said claim; thence easterly 1320
feet to a post at the southeast corner of said claim;
thence northerly 300 feet to the place of the beginning.

All done under the provisions of Chapter Six, of Title XXXII, of the Revised Statutes of the
United States, and of an Act of the General Assembly of Arizona, entitled "An Act to Revise and
Codify the Laws of the Territory of Arizona," approved March 16, 1901.

This is an Amended Location Notice of the Winner No 1
Mining Claim, located by M. E. Gibson a citizen of United States
on the 31st day of
March 1917, and recorded in Book AAA of Records of Mines, at
page 481, in the office of the County Recorder of the aforesaid County of Pima
to which reference is hereby made, and this amended Location Notice is made and posted to correct
errors in the description in the said original Location Notice.

Dated and posted on the ground this 1st day of November 1917
M. E. Gibson

Witness
C. T. Reddington

STATE OF ARIZONA, }
COUNTY OF PIMA. } ss.

I, R. B. Vinson _____, County Recorder in and for the
County of Pima, State of Arizona, do hereby certify that the above and foregoing is a full, true and correct copy
of a mining location notice, the name of which is the Rustler No. 1.
Dated October 9th, 1915.

as appears of record now in my office in Book X.X. Rec. of mines Pages 110

IN WITNESS WHEREOF, I have hereunto set my hand
and affixed my official seal, at my office in Tucson,
this 20th _____ day of
November _____, A. D. 1917
R. B. Vinson
County Recorder of Pima County, Arizona.

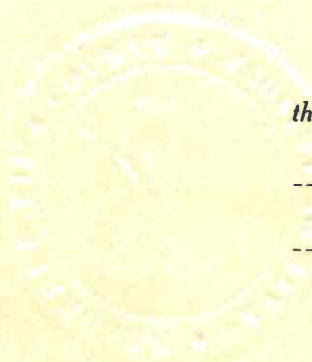

STATE OF ARIZONA, }
COUNTY OF PIMA. } ss.

I, R. B. Vinson _____, County Recorder in and for the
County of Pima, State of Arizona, do hereby certify that the above and foregoing is a full, true and correct copy
of a mining location notice, name of which is Winner No. 1.
Dated November 1st, 1917.

as appears of record now in my office in Book B.B.B. Rec. of mines Pages 296

IN WITNESS WHEREOF, I have hereunto set my hand
and affixed my official seal, at my office in Tucson,
this 20th _____ day of
November _____, A. D. 1917
R. B. Vinson
County Recorder of Pima County, Arizona.

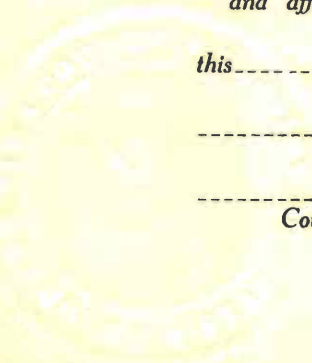

Notice of Mining Location.

LODE CLAIM

NOV 21 1917 32

TO ALL WHOM IT MAY CONCERN:

This mining claim, the name of which is the Winner No. II

Mining Claim, situate on lands belonging to the United States of America, and in which there are valuable mineral deposits, was entered upon and located for the purpose of exploration and purchase by

M.E.Gibson, a citizen of United States

the undersigned, on the 31st day of March 1917

The length of this claim is 1320

feet and I claim 200

feet in a westerly direction and 1120

feet in a easterly direction from

the center of the discovery shaft, at which this notice is posted, lengthwise of the claim, together with

300 feet in width of the surface grounds, on each side of the center of

said claim. The general course of the lode deposit and premises is from the westerly

to the easterly

The claim is situated and located in the Ajo Mining District, in the of Pima

County, in State of Arizona, about two miles

in a north westerly direction from United States Mineral Monument No. 1

The surface boundaries of the claim are marked upon the ground as follows: Beginning at

monument

at a point in a westerly direction 200 feet from

the discovery shaft (at which this notice is posted), being in the center of the west

end line of said claim; thence 300 feet to a monument

being the north west corner of said claim; thence 1320

feet to a monument being at the north east

corner of said claim; thence 300 feet to a monument

at the center of the east end of said claim; thence 300

feet to a monument, being at the south east

corner of said claim; thence 1320 feet to a monument

at the south west corner of said claim; thence 300

feet to the place of beginning.

All done under the provisions of Chapter Six of Title XXXII, of the Revised Statutes of the United States, and of an Act of the General Assembly of Arizona, entitled "An Act to Codify and Revise the Laws of the Territory of Arizona," approved March 16th, 1901.

Dated and posted on the ground this 31st day of March 1917

M.E.Gibson

Filed and recorded at request of M.E.Gibson, June 13, A.D. 1917, at 3-31 P.M.

R.B.Vinson, County Recorder

By L.M.Shibell, deputy

STATE OF ARIZONA, }
COUNTY OF PIMA. } SS.

I, R.B. Vinson _____, County Recorder in and for the
County of Pima, State of Arizona, do hereby certify that the above and foregoing is a full, true and correct copy
of a mining location notice, the name of which is the Winner No. 2.
Dated March 31st, 1917.

as appears of record now in my office in Book A.A.A. Rec. of mines Pages 482

IN WITNESS WHEREOF, I have hereunto set my hand
and affixed my official seal, at my office in Tucson,
this 20th _____ day of
November _____, A. D. 1917

R.B. Vinson
County Recorder of Pima County, Arizona.

Notice of Mining Location

LODE CLAIM

NOV 21 1917

TO ALL WHOM IT MAY CONCERN:

This Mining Claim, the name of which is the Winner No. 3
Mining Claim, situate on lands belonging to the United States of America, and in which there are valuable mineral deposits, was entered upon and located for the purpose of exploration and purchase by M. E. Gibson, a citizen of United States.
(Locator must insert either "a citizen of the United States" or "who has declared his intention to become a citizen of the United States")

the undersigned on the 1st day of November, 1917

The length of this claim is 1500 feet,
and 1 claim 977 feet
in a easterly direction and 523
feet in a westerly direction from
the center of the discovery shaft, at which this notice is posted, lengthwise of the claim, together with
300 feet in width of the surface grounds, on each side
of the center of said claim. The general course of the lode deposit and premises is from the west to the east

The claim is situated and located in the Gro Mining District, in
Pima County in the State of Arizona, about 7800 feet
in a northwesterly direction from United States Mineral Monument No. 1, Gro Mining District, and the north east corner of this claim is on line 2-3 of Luna No. Eleven Claim; the southeast corner of this claim is on line 2-3 of Luna No 10 Claim Survey No 3160 A

The surface boundaries of the claim are marked upon the ground as follows: Beginning at

a post
at a point in a easterly direction 977 feet from
the discovery shaft (at which this notice is posted), being in the center of the east
end line of said claim; thence northerly 300 feet to a post
being the northeast corner of said claim; thence
westerly 1500 feet to a post, being at the
northwest corner of said claim; thence southerly 300 feet
to a post at the center of the west end of said claim;
thence southerly 300 feet to a post being at the
southwest corner of said claim; thence easterly 1500
feet to a post at the southeast corner of said claim;
thence northerly 300 feet to the place of beginning.

All done under the provisions of Chapter Six, of Title XXXII, of the Revised Statutes of the United States, and of an Act of the General Assembly of Arizona entitled "An Act to Revise and Codify the Laws of the Territory of Arizona," approved March 16, 1901.

Dated and posted on the grounds this Nov. 1st day of November, 1917

M E Gibson

C. T. Redington



Excerpts from the Mining Laws of the State of Arizona

Title XLVII of the Revised Statutes of 1901, and Amendments Thereto

Sec. 2. Such location shall be made by erecting at or contiguous to the point of discovery a conspicuous monument of stones not less than three feet in height, or an upright post, securely fixed, projecting at least four feet above the ground, in which monument of stones or on which post there shall be posted a location notice which shall be signed by the name or names of the locator or locators.

Sec. 4. From the time of the location of a mining claim, as above specified, the locator shall be allowed ninety days within which to do or cause to be done the following things:

2. To sink a discovery shaft in the claim to a depth of at least eight feet from the lowest part of the rim of the shaft at the surface, and deeper, if necessary, until there is disclosed in said shaft, mineral in place.

Sec. 6. Such surface boundaries shall be marked by six substantial posts projecting at least four feet above the surface of the ground or by substantial stone monuments at least three feet high, to-wit: One at each corner of said claim and one at the center of each end-line thereof.

Sec. 8. Location notices may be amended at any time and the monuments changed to correspond with the amended location; Provided, That no change shall be made that will interfere with the rights of others.

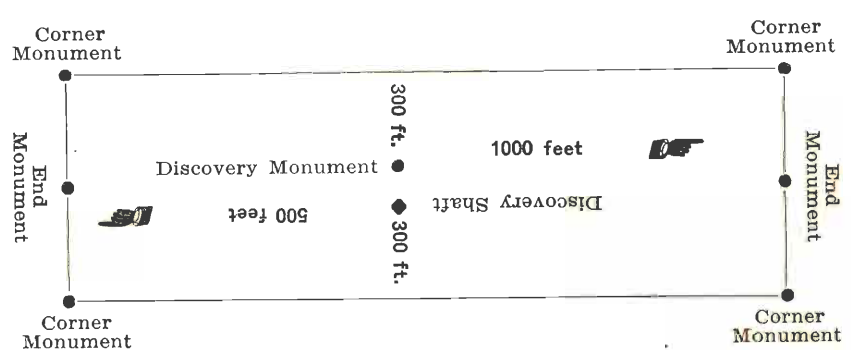

This diagram is to give locator a general idea of plan of location under the new law. The Discovery Shaft can be in the center of claim or any distance from either end desired. In the diagram it is placed 500 feet from one end and 1000 feet from the other. Commence description of claim at a center end monument, giving its distance and direction from center of Discovery Shaft; thence bound the claim in either direction. In description be careful to state locality of claim with reference to some natural object, or permanent monument, as will identify the claim.

Notice of Location

LODE CLAIM

Dated _____, 19____
Filed and Recorded at request of _____
_____, A. D. 19____ M.
at _____ M.
Book _____
Pages _____
_____ County Recorder.
By _____ Deputy Recorder.

I, _____ County Recorder in and for the County and State of _____
aforesaid, do hereby certify that the within instrument was filed for record at _____ o'clock _____ M., on this _____ day of _____ 19____, and duly recorded in Book No. _____ of _____ Records _____ County, Arizona, at pages _____.

WITNESS my hand and official seal the day and year first above written.

_____ County Recorder.

STATE OF ARIZONA,

COUNTY OF PIMA.

} SS.

I, R. B. Vinson

County Recorder in and for the

County of Pima, State of Arizona, do hereby certify that the above and foregoing is a full, true and correct copy of a mining claim, the name of which is Winner No. 3, Dated November 1st, 1917.

as appears of record now in my office in Book B.B.B. Rec., of mines Pages 297

IN WITNESS WHEREOF, I have hereunto set my hand

and affixed my official seal, at my office in Tucson,

this 20th, day of

November, A. D. 1917

R. B. Vinson

County Recorder of Pima County, Arizona.

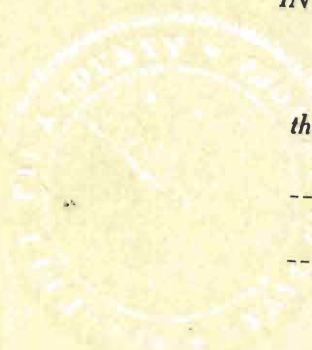

Notice of Mining Location

LODE CLAIM

NOV 21 1917

TO ALL WHOM IT MAY CONCERN:

This Mining Claim, the name of which is the Winner No 4 Mining Claim, situate on lands belonging to the United States of America, and in which there are valuable mineral deposits, was entered upon and located for the purpose of exploration and purchase by

M. E. Gibson a citizen of United States
(Locator must insert either "a citizen of the United States" or "who has declared his intention to become a citizen of the United States")

the undersigned on the 1st day of November, 1917.

The length of this claim is 1500 feet, and 1 claim 150 feet

in a easterly direction and 1350 feet in a westerly direction from

the center of the discovery shaft, at which this notice is posted, lengthwise of the claim, together with 300 feet in width of the surface grounds, on each side

of the center of said claim. The general course of the lode deposit and premises is from the East to the to the west

The claim is situated and located in the Ajo Mining District, in Pima County in the State of Arizona, about 7200 ft.

in a northwesterly direction from U. S. Mineral Monument No 1, Ajo Mining District, and the east end line of this claim joins line 2-3 Luna No 10 Claim Survey No 3160A; and the north side line of this claim joins the south side line of Winner No 3 claim

The surface boundaries of the claim are marked upon the ground as follows: Beginning at a post

at a point in a easterly direction 150 feet from the discovery shaft (at which this notice is posted), being in the center of the east end line of said claim; thence northerly 300 feet to a post

, being the north east corner of said claim; thence westerly 1500 feet to a post, being at the north west corner of said claim; thence southerly 300 feet

to a post at the center of the west end of said claim; thence southerly 300 feet to a post being at the south west corner of said claim; thence easterly 1500 feet to a post at the south east corner of said claim; thence northerly 300 feet to the place of beginning.

All done under the provisions of Chapter Six, of Title XXXII, of the Revised Statutes of the United States, and of an Act of the General Assembly of Arizona entitled "An Act to Revise and Codify the Laws of the Territory of Arizona," approved March 16, 1901.

Dated and posted on the grounds this 1st day of November, 1917

M. E. Gibson

Witness
C. Redington



Excerpts from the Mining Laws of the State of Arizona

Title XLVII of the Revised Statutes of 1901, and Amendments Thereto

Sec. 2. Such location shall be made by erecting at or contiguous to the point of discovery a conspicuous monument of stones not less than three feet in height, or an upright post, securely fixed, projecting at least four feet above the ground, in which monument of stones or on which post there shall be posted a location notice which shall be signed by the name or names of the locator or locators.

Sec. 4. From the time of the location of a mining claim, as above specified, the locator shall be allowed ninety days within which to do or cause to be done the following things:

2. To sink a discovery shaft in the claim to a depth of at least eight feet from the lowest part of the rim of the shaft at the surface, and deeper, if necessary, until there is disclosed in said shaft, mineral in place.

Sec. 6. Such surface boundaries shall be marked by six substantial posts projecting at least four feet above the surface of the ground or by substantial stone monuments at least three feet high, to-wit: One at each corner of said claim and one at the center of each end-line thereof.

Sec. 8. Location notices may be amended at any time and the monuments changed to correspond with the amended location: Provided, That no change shall be made that will interfere with the rights of others.

Notice of Location

LODE CLAIM

Dated _____, 19_____

Filed and Recorded at request of _____

_____ at _____, A. D. 19_____ M.

Book _____

Pages _____

_____ County Recorder.

By _____ Deputy Recorder.

I, _____ County Recorder in and for the County and State of _____ ss.

County of _____

do hereby certify that the within instrument was filed for record at _____ o'clock _____ M., on this _____ day of _____ 19_____ and duly recorded in Book No. _____ of _____ Records _____ County, Arizona, at pages _____

WITNESS my hand and official seal the day and year first above written.

_____ County Recorder.

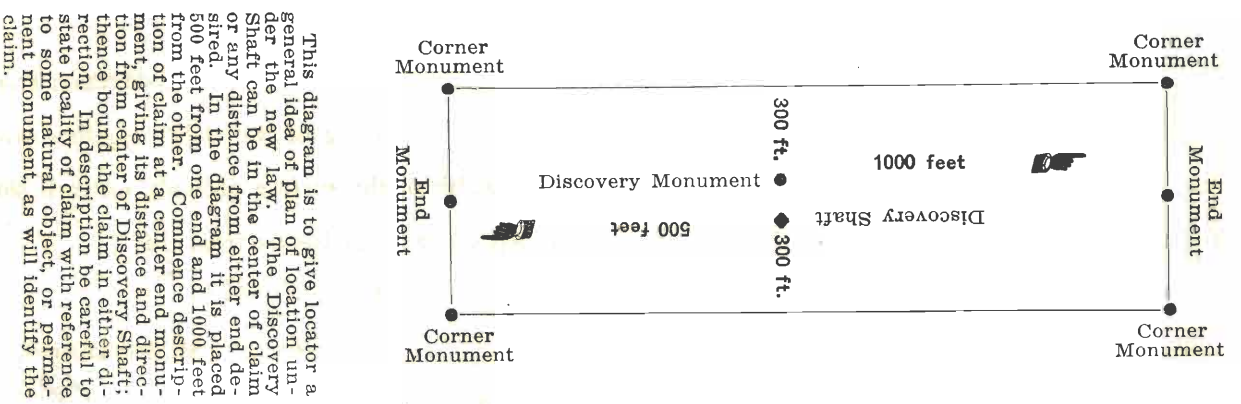

This diagram is to give locator a general idea of plan of location under the new law. The Discovery Shaft can be in the center of claim or any distance from either end desired. In the diagram it is placed 500 feet from one end and 1000 feet from the other. Commence description of claim at a center end monument, giving its distance and direction from center of Discovery Shaft; thence bound the claim in either direction. In description be careful to state locality of claim with reference to some natural object, or permanent monument, as will identify the claim.

STATE OF ARIZONA, }
COUNTY OF PIMA. } ss.

I, R. B. Vinson

County Recorder in and for the

County of Pima, State of Arizona, do hereby certify that the above and foregoing is a full, true and correct copy
of a mining location notice, the name of which is Winner No. 4.

Dated November 1st, 1917

as appears of record now in my office in Book B.B.B. Rec. of mines Pages 298

IN WITNESS WHEREOF, I have hereunto set my hand

and affixed my official seal, at my office in Tucson,

this 20th, day of

November, A. D. 1917

R. B. Vinson
County Recorder of Pima County, Arizona.

Notice of Mining Location

LODE CLAIM

NOV 21 1917

TO ALL WHOM IT MAY CONCERN:

This Mining Claim, the name of which is the Wanner No 5
 Mining Claim, situate on lands belonging to the United States of America, and in which there are valuable
 mineral deposits, was entered upon and located for the purpose of exploration and purchase by.....
M. E. Gibson a citizen of United States.
(Locator must insert either "a citizen of the United States" or "who has declared his intention to become a citizen of the United States"

the undersigned on the 1st day of November 1917
 The length of this claim is 1500 feet,
 and 1 claim 150 feet
 in a easterly direction and 1350
300 feet in a westerly direction from
 the center of the discovery shaft, at which this notice is posted, lengthwise of the claim, together with
300 feet in width of the surface grounds, on each side
 of the center of said claim. The general course of the lode deposit and premises is from the.....
west to the east

The claim is situated and located in the 4th Mining District, in
Pima County in the State of Arizona, about 6800 feet
 in a northwesterly direction from U.S. Mineral Monument No. 1, 4th Mining Dist,
and the east end line of this claim joins line
2-3 Luna No. 10. Claim, Survey No. 3160 A.

The surface boundaries of the claim are marked upon the ground as follows: Beginning at
a post
 at a point in a easterly direction 150 feet from
 the discovery shaft (at which this notice is posted), being in the center of the east
 end line of said claim; thence northerly 300 feet to a post
 being the northeast corner of said claim; thence
westerly 1500 feet to a post, being at the
northwest corner of said claim; thence southerly 300 feet
 to a post at the center of the west end of said claim;
southerly 300 feet to a post being at the
southwest corner of said claim; thence easterly 1500
 feet to a post at the southeast corner of said claim;
 thence northerly 300 feet to the place of beginning.

All done under the provisions of Chapter Six, of Title XXXII, of the Revised Statutes of the United States, and of an Act of the General Assembly of Arizona entitled "An Act to Revise and Codify the Laws of the Territory of Arizona," approved March 16, 1901.

Dated and posted on the grounds this 1st day of November 1917

Witness
C. T. Redington

M. E. Gibson

STATE OF ARIZONA, }
COUNTY OF PIMA. } ss.

I, R. B. Vinson _____, County Recorder in and for the
County of Pima, State of Arizona, do hereby certify that the above and foregoing is a full, true and correct copy
of a mining location notice, the name of which is the Winner No. 5.
Dated November 1st, 1917.

as appears of record now in my office in Book B.B.B. Rec. of mines Pages 299

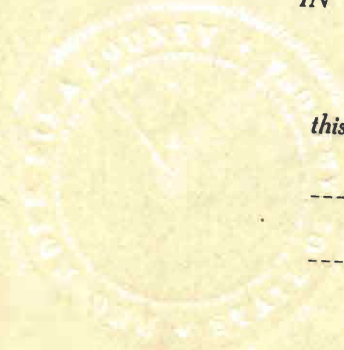

IN WITNESS WHEREOF, I have hereunto set my hand
and affixed my official seal, at my office in Tucson,
this 20th _____ day of
November. _____, A. D. 1917
R. B. Vinson
County Recorder of Pima County, Arizona.

11-121313-P 300 9 41

Notice of Mining Location

LODE CLAIM

NOV 21 1917

TO ALL WHOM IT MAY CONCERN:

This Mining Claim, the name of which is the Winner No 6
Mining Claim, situate on lands belonging to the United States of America, and in which there are valuable mineral deposits, was entered upon and located for the purpose of exploration and purchase by M. E. Gibson a citizen of United States
(Locator must insert either "a citizen of the United States" or "who has declared his intention to become a citizen of the United States"

the undersigned on the 1st day of November, 1917
The length of this claim is 1500 feet,
and 1 claim 150 feet
in a easterly direction and 1350
feet in a westerly direction from
the center of the discovery shaft, at which this notice is posted, lengthwise of the claim, together with
300 feet in width of the surface grounds, on each side
of the center of said claim. The general course of the lode deposit and premises is from the west to the East

The claim is situated and located in the Ajo Mining District, in
Pima County in the State of Arizona, about 6400 feet
in a northwesterly direction from U.S. Mineral Monument No 1, Ajo Mining District, the northeast corner of this claim lies on line 2-3 Luna No. 10, Claim, Survey No 3160A and the southeast corner lies on line 2-3 Luna No. 17, Claim Survey No 3160A.

The surface boundaries of the claim are marked upon the ground as follows: Beginning at
a post
at a point in a easterly direction 150 feet from
the discovery shaft (at which this notice is posted), being in the center of the east
end line of said claim; thence northerly 300 feet to a post
being the Northeast corner of said claim; thence
westerly 1500 feet to a post, being at the
northwest corner of said claim; thence southerly 300 feet
to a post at the center of the west end of said claim;
southerly 300 feet to a post being at the
southwest corner of said claim; thence easterly 1500
feet to a post at the southeast corner of said claim;
thence northerly 300 feet to the place of beginning.

All done under the provisions of Chapter Six, of Title XXXII, of the Revised Statutes of the United States, and of an Act of the General Assembly of Arizona entitled "An Act to Revise and Codify the Laws of the Territory of Arizona," approved March 16, 1901.

Dated and posted on the grounds this 1st day of November, 1917
M. E. Gibson

Witness
C. T. Redington

Excerpts from the Mining Laws of the
State of Arizona

Title XLVII of the Revised Statutes of
1901, and Amendments Thereto

Sec. 2. Such location shall be made by erecting at or contiguous to the point of discovery a conspicuous monument of stones not less than three feet in height, or an upright post, securely fixed, projecting at least four feet above the ground, in which monument of stones or on which post there shall be posted a location notice which shall be signed by the name or names of the locator or locators.

Sec. 4. From the time of the location of a mining claim, as above specified, the locator shall be allowed ninety days within which to do or cause to be done the following things:

2. To sink a discovery shaft in the claim to a depth of at least eight feet from the lowest part of the rim of the shaft at the surface, and deeper, if necessary, until there is disclosed in said shaft, mineral in place.

Sec. 6. Such surface boundaries shall be marked by six substantial posts projecting at least four feet above the surface of the ground or by substantial stone monuments at least three feet high, to-wit: One at each corner of said claim and one at the center of each end-line thereof.

Sec. 8. Location notices may be amended at any time and the monuments changed to correspond with the amended location; Provided, That no change shall be made that will interfere with the rights of others.

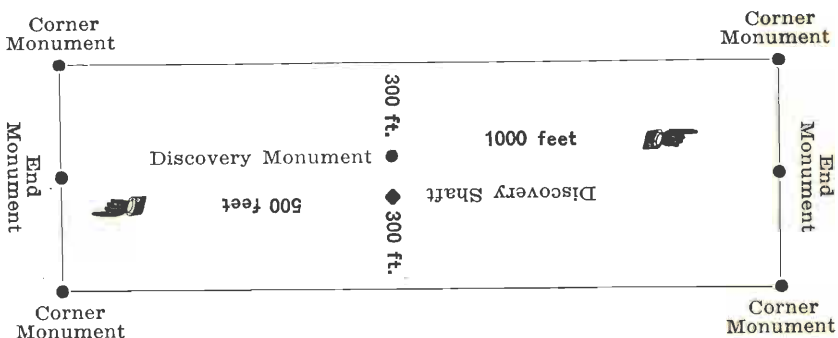

This diagram is to give locator a general idea of plan of location under the new law. The Discovery Shaft can be in the center of claim or any distance from either end desired. In the diagram it is placed 500 feet from one end and 1000 feet from the other. Commence description of claim at a center end monument, giving its distance and direction from center of Discovery Shaft; thence bound the claim in either direction. In description be careful to state locality of claim with reference to some natural object, or permanent monument, as will identify the claim.

Notice of Location
LODE CLAIM

Dated _____, 19____

Filed and Recorded at request of

_____ , A. D. 19____

at _____ M.

Book _____

Pages _____

County Recorder.

By _____ Deputy Recorder.

I, _____, County Recorder in and for the County and State of _____, do hereby certify that the within instrument was filed for record at _____ o'clock _____ M., on this _____ day of _____, 19____, and duly recorded in Book No. _____ of _____ Records _____ County, Arizona, at pages _____

WITNESS my hand and official seal the day and year first above written.

County Recorder.

STATE OF ARIZONA,

COUNTY OF PIMA.

} ss.

I, R. B. Vinson

County Recorder in and for the

County of Pima, State of Arizona, do hereby certify that the above and foregoing is a full, true and correct copy of a mining location notice, the name of which is the Winner No. 6. Dated November 1st, 1917.

as appears of record now in my office in Book B.B.B. Rec. of mines Pages 300

IN WITNESS WHEREOF, I have hereunto set my hand

and affixed my official seal, at my office in Tucson,

this 20th day of

November, A. D. 1917

R. B. Vinson
County Recorder of Pima County, Arizona.

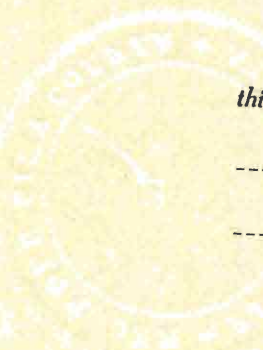

13-1313-P 301 11

Notice of Mining Location

43

LODE CLAIM

NOV. 21, 1917

TO ALL WHOM IT MAY CONCERN:

This Mining Claim, the name of which is the

Reddington

Mining Claim, situate on lands belonging to the United States of America, and in which there are valuable mineral deposits, was entered upon and located for the purpose of exploration and purchase by

M. E. Gibson a citizen of United States

(Locator must insert either "a citizen of the United States" or "who has declared his intention to become a citizen of the United States")

the undersigned on the

1st

day of

November

19*17*

The length of this claim is

1500

feet,

and *2* claim

150

feet

in a

southerly

direction and

1350

feet in a

northerly

direction from

the center of the discovery shaft, at which this notice is posted, lengthwise of the claim, together with

300

feet in width of the surface grounds, on each side

of the center of said claim. The general course of the lode deposit and premises is from the

south

to the

north

The claim is situated and located in the

Agua

Mining District, in

Pima

County in the State of Arizona, about

9450 feet

in a *northwesterly*

direction from

United States Mineral Monument

No 1 ^{*Agua Mining Dist*} *and the south end line of this claim*

joins Line 3-4- of the Luna No Eleven claim, survey

No 3160 A

The surface boundaries of the claim are marked upon the ground as follows: Beginning at

at a point in a

a post
Southerly

direction

150

feet from

the discovery shaft (at which this notice is posted), being in the center of the

south

end line of said claim; thence

westerly

300

feet to a

post

, being the

southwest

corner of said claim; thence

northerly

1500

feet to a

post

, being at the

northwest

corner of said claim; thence

easterly

300

feet

to a

post

at the center of the

north

end of said claim;

thence, easterly

300

feet to a

post

being at the

northeast

corner of said claim; thence

southerly

1500

feet to a

post

at the

southeast

corner of said claim;

thence

westerly

300

feet to the place of beginning.

All done under the provisions of Chapter Six, of Title XXXII, of the Revised Statutes of the United States, and of an Act of the General Assembly of Arizona entitled "An Act to Revise and Codify the Laws of the Territory of Arizona," approved March 16, 1901.

Dated and posted on the grounds this

1st

day of

November, 19*17*

M. E. Gibson

Witness
C. T. Reddington

Excerpts from the Mining Laws of the State of Arizona

Title XLVII of the Revised Statutes of 1901, and Amendments Thereto

Sec. 2. Such location shall be made by erecting at or contiguous to the point of discovery a conspicuous monument of stones not less than three feet in height, or an upright post, securely fixed, projecting at least four feet above the ground, in which monument of stones or on which post there shall be posted a location notice which shall be signed by the name or names of the locator or locators.

Sec. 4. From the time of the location of a mining claim, as above specified, the locator shall be allowed ninety days within which to do or cause to be done the following things:

2. To sink a discovery shaft in the claim to a depth of at least eight feet from the lowest part of the rim of the shaft at the surface, and deeper, if necessary, until there is disclosed in said shaft, mineral in place.

Sec. 6. Such surface boundaries shall be marked by six substantial posts projecting at least four feet above the surface of the ground or by substantial stone monuments at least three feet high, to-wit: One at each corner of said claim and one at the center of each end-line thereof.

Sec. 8. Location notices may be amended at any time and the monuments changed to correspond with the amended location; Provided, That no change shall be made that will interfere with the rights of others.

289
290
291
292
293
294
295

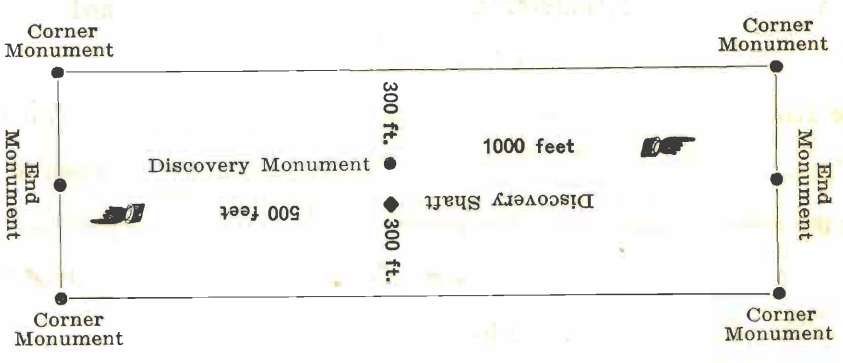

This diagram is to give locator a general idea of plan of location under the new law. The Discovery Shaft can be in the center of claim or any distance from either end and 500 feet from one end and 1000 feet from the other. Commence description of claim at a center end monument, giving its distance and direction from center of Discovery Shaft; thence bound the claim in either direction. In description be careful to state locality of claim with reference to some natural object, or permanent monument, as will identify the claim.

Notice of Location
LODE CLAIM

Dated _____, 19____

Filed and Recorded at request of _____

at _____, A. D. 19____ M.

Book _____

Pages _____

County Recorder.

Deputy Recorder.

I, _____, County Recorder in and for the County and State of _____, do hereby certify that the within instrument was filed for record at _____ o'clock _____ M., on this _____ day of _____, 19____, and duly recorded in Book No. _____ of _____ Records _____ County, Arizona, at pages _____

WITNESS my hand and official seal the day and year first above written.

County Recorder.

STATE OF ARIZONA, }
COUNTY OF PIMA. } ss.

I, R. B. Vinson _____, County Recorder in and for the
County of Pima, State of Arizona, do hereby certify that the above and foregoing is a full, true and correct copy
of a mining location notice, the name of which is the Reddington.
Dated November 1st, 1917.

as appears of record now in my office in Book B.B.B. Rec. of mines Pages 301

IN WITNESS WHEREOF, I have hereunto set my hand
and affixed my official seal, at my office in Tucson,
this 20th, ~~1917~~ XXXXX day of
November, A. D. 1917

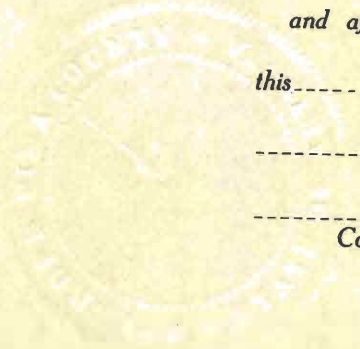

R. B. Vinson
County Recorder of Pima County, Arizona.

U. S. SURVEYOR-GENERAL'S FINAL CERTIFICATE ON FIELD NOTES.

Department of the Interior,

OFFICE OF U. S. SURVEYOR-GENERAL,

Phoenix, Arizona.

November 23, 1918

I, U. S. Surveyor-General for District of Arizona

do hereby certify that the foregoing transcript of the Field Notes, return and approval of the survey of the mining claim of

M. E. Gibson

known as the Rustler No. 1, Winner No. 1, Winner No. II, Winner No. 3, Winner No. 4, Winner No. 5, Winner No. 6, Reddington lodes, situate in Ajo

Mining District, Pima County, Arizona.

in Sections 15, 16, 21, 22 Township No. 12 S., Range No. 6 W. unsur.

designated as Survey No. 3457, has been correctly copied from the originals on file in this office; that said Field Notes furnish such an accurate description of said mining claim as will, if incorporated into a patent, serve fully to identify the premises, and that such reference is made therein to natural objects or permanent monuments as will perpetuate and fix the locus thereof.

And I further certify that five hundred dollars' worth of labor has been expended or improvements made upon said mining claim by claimant or his grantors, and that said improvements consist of or for the benefit of the Rustler No. 1, Winner No. 1 and Winner No. II lodes, and that less than five hundred dollars' worth of labor has been expended or improvements made upon or for the benefit of the Reddington, Winner No. 3, Winner No. 4, Winner No. 5 and Winner No. 6 lodes, by claimant or his grantors, and that said improvements consist of 12 shafts and 1 drill hole, total value \$4057.

As improvement No. 2 on the Winner No. 4 lode is a common improvement for the benefit and development of all the claims in this survey, an undivided one-eighth interest therein, value \$226.50, is properly credited to each of the claims in this survey.

and that no portion of said labor or improvements has been included in the estimate of expenditures upon any other claim.

I further certify that the plat thereof, filed in the U. S. Land Office at Phoenix,

Arizona, is correct and in conformity with the foregoing Field Notes.

Frank P. Trott,

United States Surveyor-General for Arizona.

SURVEYOR GENERAL'S CERTIFICATE OF APPROVAL OF FIELD NOTES AND SURVEY OF MINING CLAIM

DEPARTMENT OF THE INTERIOR OFFICE OF U. S. SURVEYOR GENERAL

Phoenix, Arizona.

November 23, 1918

I, U. S. Surveyor General for District of Arizona

do hereby certify that the foregoing and hereto attached Field Notes and Return of the Survey of the Mining Claim of

M. E. Gibson

known as the

Rustler No. 1, Winner No. 1, Winner No. II, Winner No. 3, Winner No. 4, Winner No. 5, Winner No. 6, Reddington lodes.

situate in Ajo mining district,

Pima County, Arizona

in Sections 15, 16, 21, 22, Township No. 12 S., Range No. 6 W.

designated as Survey No. 3457

executed by Paul E. Fernald, U. S. Mineral

Surveyor, Jan. 22-Feb. 26, 1918, under my instructions dated

Nov. 21, 1917, have been critically examined and the necessary cor-

rections and explanations made, and the said Field Notes and Return, and the Survey they describe,

are hereby approved. The certified copy of the location certificate filed by the applicant for survey is

on file in this office and a true copy of said certified copy of said location certificate is included and made

a part of the transcript of the field notes.

[Handwritten signature]

U. S. Surveyor General for Arizona.

UNITED STATES DEPARTMENT OF THE INTERIOR 9605 (952)
BUREAU OF LAND MANAGEMENT M.S. 3457
ARIZONA STATE OFFICE

NOTICE OF CANCELLATION OF MINERAL SURVEY

The Rustler No. 1, Winner No. 1, II, 3, 4, 5 and 6 and Reddington lodes, Mineral Survey No. 3457, located in sections 15 and 22, Township 12 South, Range 6 West, Gila and Salt River Meridian, Arizona, are hereby canceled.

These claims have not been filed with the Arizona State Office, Bureau of Land Management, in accordance with Section 314, 90 STAT. 2769, (43 U.S.C. 1744).

This cancellation was necessitated to clear the record.

The Mineral Survey Plat should be noted as follows:

"Rustler No. 1, Winner No. 1, II, 3, 4, 5 and 6 and Reddington lodes, M.S. 3457 were canceled December 11, 1998, by memo 9605 (952) M.S. 3457, which is now a part of the original field notes."

December 11, 1998
Date



Chief Cadastral Surveyor of Arizona