

Feb 26 1918

4-683

MINERAL SURVEY No. 3465 *Platted.*

copied Et 6-18-18

ARIZONA Land District.

FIELD NOTES

OF THE SURVEY OF THE MINING CLAIM OF

M. F. Ryan

KNOWN AS THE

Soules lode

Warren Mining District,

Cochise County, Arizona

Sections 13 & 24 Unappd Township 23 South, Range 24 East, G & SR B & M

Surveyed under instructions dated January 19th, 1918.

by Ralph L. Motz
U. S. Mineral Surveyor.

Claim located see location notice attached, 19

Survey commenced February 9th, 1918.

Survey completed February 9th, 1918.

Address of claimant M. F. Ryan, P. O. Box 2129,
Bisbee, Arizona.

DATES OF AMENDED LOCATIONS.

MINERAL SURVEY NO. 3465.

Feet.	SOULES.lode.
	Beginning at Cor No 1, the S E Cor, identical with location and situated at intersection of lines 2-3 and 4-1 Sur No 2454 William B. Moore lode and Sur No 3137 Jack Pot No 5 lode, respectively at S 12° 16' W 987.4 ft and N 12° 16' E 505.4 ft from Cors No 3 and 2 respectively of said No 2454 William B. Moore lode and S 3° 26' E 1202.8 ft and N 3° 26' W 274.8 ft from Cors No 4 and 1 respectively of said 3137 Jack Pot No 5 lode, a pine post 4 ft long 4 ins sq set 18 ins in the ground in a mound of stones and scribed 1-3465 S, whence a sandstone ledge 24 x 41 x 26 ins high exposure chiseled BR x 1-3465 brs S 31° 28' W 10.8 ft, and a second sandstone ledge with 29 x 49 x 33 ins high exposure with like chiseling brs S 45° 14' E 9.0 ft, and the S W Cor of Sec 18, T. 23 S1, R 25 E., G & S R B & M brs N 78° 27' E 1118.2 ft.
50.0	thence N 73° 09' W to original location for south end center being a mound of stones 3 ft high with a 3 ft base,
325.5	to Cor No 2, the S W Cor, identical with location, a pine post 4 ft long 4 ins sq set 18 ins in the ground in a mound of stones and scribed 2-3465 S. No bearings available.
	thence N 12° 16' E
1132.7	to Cor No 3, the N W Cor, identical with location and with Cor No 4 Sur No 3137 Jack Pot No 5 lode, and situated on line 2-3 Sur No 3137 Jack Pot No 2 lode at N 73° 09' W 201.6 ft and S 73° 09' E 1298.4 ft from Cors No 2 and 3 respectively, of said 3137 Jack Pot No 2 lode, a pine post 4 ft long 4 ins sq set 18 ins in the ground in a mound of stones and scribed 3-3465 S. No bearings available.
	thence S 73° 09' E
85.2	along line 3-2 Sur No 3137 Jack Pot No 2 lode, intersect line 3-4 Sur No 3390 Nancy Hanks lode at N 2° 24' E 367.5 ft and S 2° 24' W 1132.5 ft from Cors No 3 and 4 respect-

Feet.

ively of said ~~No 3390~~ Nancy Hanks lode,

201.6 to Cor No 2 Sur No 3137, Jack Pot No 2 lode,

275.5 to original location for north end center, being a mound of stones 3 ft. high with a 3 ft. base,

325.5 to Cor No 4, the N. E. Cor; identical with location, a pine post 4 ft. long 4 ins. sq. set 18 ins in the ground in a mound of stones and scribed 4-3465 S. No bearings available.

Cor No 3 Sur No 3390 Nancy Hanks lode brs S 39° 31' W 385.7 ft.

thence S 12° 16' W

145.3 to Cor No 3 Sur No 2454 William B. Moore lode,

214.7 along line 3-2 Sur No 2454 William B. Moore lode, intersect line 2-3 Sur No 3390 Nancy Hanks lode at N 66° 17' E 218.2 ft and S 66° 17' W 450.0 ft from Cors No 3 and 2 respectively said ~~No 3390~~ Nancy Hanks lode,

1132.7 to Cor No 1, the place of the beginning.

LODE LINE.

The presumed course of the vein on this claim is from the south end center N 12° 16' E 1132.7 ft.

AREA.

Total area, Soules lode- - - - - 8.437 A.

Area in conflict with

Sur. No. 3137 Jack Pot No 5 lode- - -4.219 A.

Sur. No. 3390 Nancy Hanks lode- - -1.417 A.

LOCATION.

This survey is located in Secs. 13 and 24, unapproved, T. 23 S., R. 24 E., G & S R B & M, in the Warren Mining District, Cochise County, Arizona.

IMPROVEMENTS.

I hereby certify that the value of the labor and improvements upon this claim made thereon by the claimant or his grantors was at the time of survey as follows:-

No.1. Discovery shaft 4.5 x 7 x 9 ft deep brs from north end center on lode line 525.0 ft. Value \$ 60.00

Note.

Report for five hundred dollars worth of improvements on this claim will be filed prior to the expiration of the period of publication of the notice of application for patent.

OTHER IMPROVEMENTS.

Open cut 5 x 6 x 13 ft long brg N 57° E, the mouth of which
brs from point on line 4-1 S 12° 16' W 539.8 ft from Cor
No 4 S 57° W 25.6 ft.

Open cut 8 x 13 x 15 ft long brg N 57° E, the mouth of
which brs from same point S 86° 40' W 39.1 ft.

ADJOINING CLAIMS.

North. Sur. No. 3137 Jack Pot No 2 lode
Sur. No. 3390 Nancy Hanks lode.

East. Sur. No. 3390 Nancy Hanks lode.
Sur. No. 2454 William B. Moore lode.

South. Sur. No. 3137 Jack Pot No 5 lode.

West. Sur. No. 3137 Jack Pot No 5 lode.

INSTRUMENT.

This survey was made with a Gurley Light Mountain transit.
The courses were deflected from the true meridian as deter-
mined/a Solar observation. The distances were measured with
a 300 foot steel tape. Magnetic variation 12° 30' East at
all corners.

insert "Report" here

Report

Ralph L. Mox
U. S. Mineral Surveyor.

Dated at Bisbee, Arizona.

February 19th, 1918.

MINERAL SURVEY NO. 3465

REPORT.

S W Cor of Sec 18, T 23 S, R 25 E G & S R B & M is a sandstone rock 14 x 12 x 8 ins above ground chiseled lll on east face and lll on ~~west~~ ^{south} face. Monument of rocks 2 ft east.

Sur No 2454, William B Moore lode, Cors 2 and 3 are p pine posts properly set and scribed.

Sur No 3137, Jack Pot No 2 lode, Cors 2 and 3 are pine posts properly set and scribed.

Sur No 3137, Jack Pot No 5 lode, Cors 1 and 4 are pine posts properly set and scribed.

Sur No 3390, Nancy Hanks lode, Cors 2, 3 and 4 are pine posts properly set and scribed.

Ralph L. Mohr

U. S. Mineral Surveyor.

Dated at Bisbee Arizona.

May 29, 1918.

FINAL OATHS FOR SURVEYS.

LIST OF NAMES.

A list of the names of the individuals employed by Ralph L. Motz

United States Mineral Surveyor, to assist in running, measuring, and marking the lines, corners, and boundaries described in the foregoing field notes of the survey of the mining claim of

M. F. Ryan

known as the Soules lode

and showing the respective capacities in which they acted.

Roy Green, *Chairman.*

....., *Chairman.*

....., *Acman.*

....., *Flagman.*

FINAL OATHS OF ASSISTANTS.

~~xxx~~ I, Roy Green

~~xxx~~, do solemnly swear that ~~we~~^I assisted

Ralph L. Motz, United States Mineral Surveyor, in marking the corners and surveying the boundaries of the mining claim of

M. F. Ryan

known as the Soules lode

represented in the foregoing field notes as having been surveyed by said mineral surveyor and under his

direction; and that said survey has been in all respects, to the best of ^{my}~~our~~ knowledge and belief, faithfully

and correctly executed, and the corner and boundary monuments established according to law and the instruc-

tions furnished by the United States Surveyor-General for Arizona

Roy Green, *Chairman.*

....., *Chairman.*

....., *Acman.*

....., *Flagman.*

Subscribed and sworn to by the above-named persons before me this 19th

day of February, 19 18.

J.W. Ross

Notary Public in and for the County of Cochise, State of Arizona. My commission expires Feb. 21st, 1920.

FINAL OATH OF U. S. MINERAL SURVEYOR.

I, Ralph L. Motz, U. S. Mineral Surveyor,
do solemnly swear that, in pursuance of instructions received from the United States
Surveyor General for Arizona, dated
January 19th, 1918., I have, in strict conformity to the laws of the
United States, the official regulations and instructions thereunder, and the instructions
of said Surveyor General, faithfully and correctly executed the survey of the Mining
Claim of M. F. Ryan
....., known as the
Soules lode,
situate in Warren Mining District,
Unapp'd. Cochise County, Arizona, in Sections
13 and 24 /, Township No. 23 S., Range No. 24 E., G. & S. R. B. & M
and designated as Survey No. 3465, as represented
in the foregoing field notes, which accurately show the boundaries of said mining claim
as distinctly marked by monuments on the ground, and described in the attached copy
of the location certificate, which was received by me from the Surveyor General with
said instructions, and that all the corners of said survey have been established and per-
petuated in strict accordance with the law, official regulations and instructions there-
under; and I do further solemnly swear that the foregoing are the true and original
field notes of said survey and my report therein, and that the labor expended and
improvements made upon said mining claim by claimant or his grantors
are as therein fully stated, and that the character, extent, location, and itemized value
thereof are specified therein with particularity and full detail, and that no portion of
said labor or improvements so credited to this claim has been included in the estimate
of expenditures upon any other claim.

Ralph L. Motz
U. S. Mineral Surveyor.

Subscribed and sworn to by the said Ralph L. Motz
U. S. Mineral Surveyor, before me J. W. Ross, Notary Public
..... this 19th
day of February, 19 18.

J W Ross
Notary Public in and for the County
of Cochise, State of Arizona.
My commission expires Feb. 21st, 1920.

AMENDED

JAN. 13, 1918

Notice of Mining Location
LODE CLAIM

To All Whom It May Concern:

This Mining Claim, the name of which is the Soules
Mining Claim, situate on lands belonging to the United States of America, and in which there are valuable mineral deposits, was entered upon and located for the purpose of exploration and purchase by M. F. Ryan

a citizen of the United States
(Locator must insert either "a citizen of the United States," or "who has declared his intention to become a citizen of the United States.")
the undersigned, on the 6th day of December 19 17

The length of this claim is 1150 feet,
and I claim 525 feet,
in a northerly direction and 625
feet in a southerly direction from
the center of the discovery shaft, at which this notice is posted, lengthwise of the claim, together with 300 feet in width of the surface grounds, on each side of the center of said claim. The general course of the lode deposit and premises is from the south to the north

The claim is situated and located in the Warren Mining District, in Cochise County, in the State of Arizona, about 2 1/4 miles in a n easterly direction from Lowell. The adjoining claims are:- on the north, Sur No 3137 Jack Pot No 2; on the east, Sur No 3390 Nancy Hanks, Sur No 2454 William B. Moore; on the west, Sur No 3137 Jack Pot No 5.

The surface boundaries of the claim are marked upon the grounds as follows: Beginning at a monument of stones

at a point in a northerly direction 525 feet from the discovery shaft (at which this notice is posted,) being in the center of the north end line of said claim; thence easterly 50 feet to a post, being the northeast corner of said claim; thence southerly 1150 feet to a post, being at the southeast corner of said claim; thence westerly 50 feet to a monument of stones at the center of the south end of said claim; thence westerly 300 feet to a post, being at the southwest corner of said claim; thence northerly 1150 feet to a post at the northwest corner of said claim; thence easterly 300 feet to the place of beginning.

All done under the provisions of the laws of the United States, and of the State of Arizona.

This is an Amended Location Notice of the Soules Mining Claim, located by M. F. Ryan on the 22nd day of January 19 17, and recorded in Book 57 of Records of Mines, at page 128, in the office of the County Recorder of the aforesaid County of Cochise to which reference is hereby made, and this amended Location Notice is made and posted to correct errors in the description in the said original Location Notice.

Dated and posted on the ground this 6th day of December 19 17
M. F. Ryan

STATE OF ARIZONA,

ss.

County of COCHISE

I, Ray B Krebs, County Recorder in and for the County and State aforesaid, do hereby certify that the within instrument was filed for record at 12 o'clock, M., on this 19th day of DEC 19 1917, and duly recorded in Book No. 58 of Record of Mines Records of Cochise County, Arizona, at pages 534.

WITNESS my hand and official seal the day and year first above written.

Geo M Stales County Recorder.

INDEXED
COMPARATIVE
BLOTTED
1918

AMENDED
Notice of Location
LODE CLAIM

Dated 19th, 1917

Filed and Recorded at request of
Ray B Krebs

at 12 M.
DEC 19 1917
Record of Mines

Book 58
Pages 534

Geo M Stales
County Recorder.
Deputy Recorder.

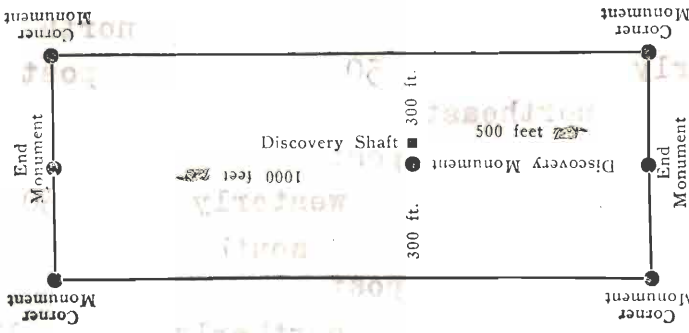

This diagram is to give locator a general idea of plan of location under the new law. The Discovery Shaft can be in the center of claim or any distance from either end desired. In the diagram it is placed 500 feet from one end and 1000 feet from the other. Commence description of claim at a center end monument, giving its distance and direction from center of Discovery Shaft; thence bound the claim in either direction. In description be careful to state locality of claim with reference to some natural object, or permanent monument, as will identify the claim.

U. S. SURVEYOR-GENERAL'S FINAL CERTIFICATE ON FIELD NOTES.

Department of the Interior,

OFFICE OF U. S. SURVEYOR-GENERAL,

Phoenix, Arizona.

June 26, 1918

I, U. S. Surveyor-General for District of Arizona

do hereby certify that the foregoing transcript of the Field Notes, return and approval of the survey of the mining claim of

M. F. Ryan

known as the SOULES Lode

situate in Warren

Mining District, Cochise County, Arizona

in Sections 13 & 24, Unapp'd Township No. 23 S, Range No. 24 E, and

designated as Survey No. 3465, has been correctly copied from the originals on file in this office; that said Field Notes furnish such an accurate description of said mining claim as will, if incorporated into a patent, serve fully to identify the premises, and that such reference is made therein to natural objects or permanent monuments as will perpetuate and fix the locus thereof.

less than

And I further certify that five hundred dollars' worth of labor has been expended or improvements made upon said mining claim by claimant or his grantors, and that said improvements consist of, at time of survey, 1 shaft, value \$60.00

and that no portion of said labor or improvements has been included in the estimate of expenditures upon any other claim.

I further certify that the plat thereof, filed in the U. S. Land Office at Phoenix,

Arizona, is correct and in conformity with the foregoing Field Notes.

Frank P. Trott,

United States Surveyor-General for Arizona.

SURVEYOR-GENERAL'S CERTIFICATE OF APPROVAL OF FIELD NOTES AND SURVEY OF MINING CLAIM.

Department of the Interior,

OFFICE OF U. S. SURVEYOR-GENERAL,

Phoenix, Arizona.

June 26, 1918

I, U. S. Surveyor-General for District of Arizona

do hereby certify that the foregoing and hereto attached Field Notes and Return of the Survey of the Mining Claim of

M. F. Ryan

, known as the

SOULTS Lode

situate in Warren mining district,

Cochise County, Arizona

in Section 13 & 24, Unapp'd., Township No. 23 S., Range No. 24 E.

, designated as Survey No. 3465

executed by Ralph L. Motz, United States Mineral

Surveyor, February 9, 1918, under my instructions dated

January 19, 1918, have been critically examined and the necessary cor-

rections and explanations made, and the said Field Notes and Return, and the Survey they describe,

are hereby approved. A true copy of the copy of the location certificate filed by the applicant for

survey is included in the field notes.

[Handwritten signature]

U. S. Surveyor-General for Arizona.

(4-691.)

Certificate of U. S. Surveyor General

AS TO

EXPENDITURES REPORTED AFTER RETURN OF SURVEY OF MINING CLAIM.

I, U. S. Surveyor General for District of Arizona,
do hereby certify that Five Hundred Dollars' worth of labor has been expended or
improvements made by claimant or his grantors, upon the mining claim of
M. F. Ryan

known as the SOULES Lode,
situate in Warren mining district,
Cochise County, Arizona

in Sections 13 & 24, Township No. 23 S., Range No. 24 E.;

that said improvements consist of, in addition to those reported at time
of survey, 1 cut and shaft, and additional work in improvement
No. 1, value \$500.00

....., and that no portion of said labor or improvements has been
included in the estimate of expenditures upon any other claim. A copy of the report of
Ralph L. Motz, U. S. Deputy Mineral Surveyor, dated
August 10, 1921, is hereto attached.



U. S. Surveyor General for Arizona.

Office of U. S. Surveyor General,

Phoenix, Arizona,

August 23, 1921.

MINERAL SURVEY NO. 3465

SOULES lode.

SUPPLEMENTAL REPORT OF IMPROVEMENTS

I hereby certify that the value of the labor performed and improvements made upon this claim by the claimant or his grantors is not less than five hundred dollars and that said improvements in addition to those which were reported at time of survey consist of:-

- No. 1 Additional shaft 4 x 6 x 31 ft. deep, total depth now 40 ft. Value of additional work - - - - - \$400.00
- No. 2 Open cut 6 x 7 x 12 ft. long brg N 57° E, in bottom is shaft 5 x 6 x 5 ft. deep, mouth of open cut brs from point on line 4-1 S 12° 16' W 539.8 ft. from Cor. No. 4 S 74° 10' W 30.6 ft. Value - - - - - 100.00

Ralph L. Motz
U. S. Mineral Surveyor

Dated at Bisbee, Arizona.

August 10, 1921.

I, Ralph L. Motz, U. S. Mineral Surveyor for the District of Arizona, first being duly sworn, depose and say that the above supplemental report is true and correct and that the improvements mentioned therein were made and completed prior to the date of the expiration of the period of the publication of the notice of application for patent to the lands embraced in Mineral Survey No. 3465.

Ralph L. Motz
U. S. Mineral Surveyor.

State of Arizona)
County of Cochise) ss.

Subscribed and sworn to by said Ralph L. Motz, U. S. Mineral Surveyor, before me Charles R. Woods, a notary public, in and for the county of Cochise, State of Arizona, this 10th day of August, 1921.

Charles R. Woods
Notary Public.

My commissione expires May 23, 1925.