

OCT. 20. 1919

4-683

A

MINERAL SURVEY No. 3474

Arizona Land District.

FIELD NOTES

OF THE SURVEY OF THE MINING CLAIM OF

The United Verde Copper Company

KNOWN AS THE

Sunset Lode Verde

Mining District,

Yavapai County, Arizona

Sections 22 & 27 Unsu., Township 16 N., Range 2 E. G. & R. B. M.

Surveyed under instructions dated Jan 22, 1915

by Joseph McCarthy U. S. Mineral Surveyor.

Claim located See location notice, 19

Survey commenced July 27, 1915

Survey completed July 30, 1918

Address of claimant Anderson & Ellis Atty. Prescott Arizona.

DATES OF AMENDED LOCATIONS.

Mineral Survey No. 3474.

Sunset Lode.

Beginning at Cor. No. 1

A concrete monument 24 in long 12 in diam. at base and 6 to 8 in diam. at top, set 1 ft. in the ground. The core is a 2 in. iron pipe with a cap on top containing a brass disk stamped + S. No. 1, 3474, whence

Alongside is a 4x5 in. post 4 ft. long in a mound of stones. Original mon. a mound of stone, bears  $S55^{\circ}45' E$  18.3 ft. Across on a rock in place marked B+R S-1 3474 bears  $S17^{\circ}19' E$  4.42 ft.

The sec. Cor. common to Sec's 22-23-26-27 T. 16 N. R. 2 E G. & S. P. M. bears  $S179^{\circ}21'10'' E$  3065.82 ft.

Cor No 5 of Walnut Creek lode Sur. No 1615 bears  $S69^{\circ}00' E$  100.96 ft. From Cor. No. 5 of Walnut Creek

lode, Cor. 4 of said lode bears  $S51^{\circ}15' E$  288.77 ft.

Cor. No. 2 of No 13 lode Sur. No. 1284 bears  $S80^{\circ}13'30'' E$  301.98 ft.

Cor. No. 1 of Sullivan lode Sur. No. 1615 bears  $S81^{\circ}15' E$  356.03 ft. Thence  $S55^{\circ}45' E$

Feet

59.02

Intersect line 5-1 Walnut Creek lode Sur No 1615 at  $N78^{\circ}16'30'' E$  45.56 ft. from Cor. No. 5.

60.41

Intersect line 2-3 No 13 lode Sur. No. 1284 at  $N78^{\circ}00'40'' E$  248.26 ft from Cor. No 2 and 45.68 ft. from the intersection of this line with line 4-5

Walnut Creek lode Sur. No 1615, said point of intersection being  $S51^{\circ}15' E$  1.61 ft. from Cor 5 of Walnut Creek.

112

Cross under power wires running northerly.

300

South end center, a mound of stones 3 ft. diam. at base 4 ft high.

345

Cross gulch running southeasterly

386.36

Intersect line 3-4 Walnut Creek lode Sur. No 1615 at  $S11^{\circ}16' E$  0.51 ft. from Cor. No. 4, also intersect line 1-2 Sullivan lode Sur. No. 1615 at  $S11^{\circ}16' E$  166.49 ft. from Cor. No. 1.

599.95

To Cor No 2.

A concrete monument similar to Cor. No 1 of this survey, the brass disk is stamped + S. No. 2, 3474, whence Original mon. a mound of stones 3 ft diam at base and 4 ft high bears  $S32^{\circ}39' E$  17.63 ft.

A cross on a rock in place marked B+R S-2 3474 bears  $N168^{\circ}44' E$  29.78 ft.

Cor. No 1 of Lucky Boy South Extension lode Sur No 1351 identical with Cor. No 4 of Lucky Boy lode

- Sur. No 1350 bears  $N 70^{\circ} 01' 30'' E$  694.64 ft.  
 thence  $N 33^{\circ} 13' 20'' E$   
 131.83 Intersect line 1-5 Sullivan lode Sur No  
 1615 at  $S 51^{\circ} 18' 30'' E$  277.05 ft. from Cov. No. 1.  
 150.87 Intersect line 1-4 Lucky Boy South Extension  
 lode Sur. No. 1351 at  $S 0^{\circ} 14' E$  563.22 ft from Cov. No. 1.  
 824.54 Intersect line 1-2 Lucky Boy South Extension lode  
 Sur. No. 1351 identical with line 3-4 Lucky Boy lode  
 Sur No 1350 at  $N 89^{\circ} 56' 45'' E$  366.80 ft. from  
 Cov's No 1 and 4 respectively  
 920 Cross under power wires, running northeasterly  
 993.12 To Cov. No. 3.  
 A concrete monument similar to Cov. No. 1  
 of this survey, the brass disk is stamped  
 + S. No. 3 3474 whence.  
 A cross on a rock in place marked  
 B+R S-3 3474 bears  $S 26^{\circ} 25' E$  93.44 ft.  
 thence  $N 55^{\circ} - 45' E$   
 260 Cross under power wires running northeasterly  
 299.90 North end center a mound of stones 3 ft. diam at  
 base and 4 ft. high.  
 443.10 Intersect line 1-2 No 13 lode Sur No 1284  
 at  $N 26^{\circ} 00' E$  876.97 ft. from Cov. No 2 and 84.27 ft  
 from the intersection of this line with line 1-4  
 Lucky Boy lode Sur. No. 1350  
 455.59 Intersect line 4-1 Lucky Boy lode Sur No 1350  
 at  $N 11^{\circ} 43' 40'' E$  406.27 ft. from Cov. No. 4 and  
 90.28 ft from the intersection of this line with  
 line 1-2 No 13 lode Sur No 1284.  
 599.90 To Cov No 4.  
 A concrete monument similar to Cov. No. 1 of  
 this survey, the disk is stamped + S. No 4 3474  
 whence  
 A cross on a rock in place marked B+R  
 S-4 3474 bears  $S 18^{\circ} 15' E$  33.46 ft  
 Cov No 2 of No 13 lode Sur No 1284 bears  $S 15^{\circ} 37' E$  915.90 ft.  
 thence  $S 33^{\circ} 13' 30'' E$   
 833 Cross under power wires running northerly  
 993.17 To Cov. No. 1, the place of beginning  
 Mag. Var.  $14^{\circ} 45' E$ .



3

4

# Mineral Survey No 3474.

## Lode Line

As near as can be determined from present developments the vein extends as follows from the discovery point.

147.00 ft. S 33° 13' 30" E and 846.15 ft. N 33° 13' 30" W

## Area

	Acres
Total area Sunset lode	13.676
Area in conflict with -	
Suv. No. 1284 No 13 lode	4.907
Suv. No. 1350 Lucky Boy lode	2.556
Suv No. 1350 Lucky Boy lode (exclusive of its conflict Suv No 1284 No 13 lode)	2.534
Suv. No. 1351 Lucky Boy South Extension lode	2.371
Suv. No. 1615 Sullivan lode	0.793
Suv. No 1615 Walnut Creek lode	0.088
Suv. No 1615 Walnut Creek lode (exclusive of its conflict with Suv 1284 No 13 lode)	0.087

The survey of the location is identical with the location as staked on the ground except as noted.

## Location

This survey is located in <sup>unsurveyed</sup> Secs. 22 + 27 T. 16 N. R. 2 E. G + SRB & M and within the Prescott National Forest.

## Expenditure of Five Hundred Dollars

I certify that the value of the labor and improvements made upon this claim by the claimant is not less than five hundred dollars and that said improvements consist of:-

No. 1. The discovery cut, the discovery point being in the cut 5 ft. from the mouth is on the lode line 147 ft. from the south end center; 4 ft wide, 12 ft. face, 25 ft long running S 46° W to face.

Value \$ 125<sup>00</sup>

No. 2 A cut and tunnel, the face of the cut bearing N 23° 05' E 356.54 ft. from top of No. 1 5 ft wide 11 ft face running S 29° W 30 ft. to mouth.

From the face of the cut a 4 x 6 ft tunnel runs

N 23° 45' 55" ft to face.

Value of cut and tunnel \$700.00

Instrument.

This survey was made with a C. Berger & Sons mining transit. The courses were deflected from the true meridian as determined by direct solar observations. The distances were measured with 660 and 100 ft steel tapes.

Adjoining Claims.

This claim is adjoined on the north by the Lucky Boy lode Sur. No 1350 United Verde Copper Co claimant.

On the east by the

No. 13 lode Sur. No 1284 Hull Copper Co claimant.

On the south by the

Subiran & Walnut Creek lodes Sur. No 1615 Verde Central Mines Inc. claimant.

On the west by the

Lucky Boy South Extension lode Sur. No 1351 United Verde Copper Co claimant.

Report.

The lines of this claim were run upon the ground by a closed traverse and the conflicts tied in from the several traverse points.

The Sec. Cor. common to Secs 22-23-27-26 T16 N R 2 E is a 2 in iron pipe topped by a brass cap marked + T16 N R 2 E S 22 S 23 S 27 S 26

Sur. No 1284 No 13 lode.

All corners are concrete monuments replacing the original stone corners properly marked.

I find line 1-2 to be S 26° 00' E 1455.18 ft instead of S 26° 00' E 1500.00 ft.

I find line 2-3 to be N 86° 00' 40" E 573.66 ft instead of N 86° 02' E 600.00 ft.

Sur. No 1350 Lucky Boy lode.

Cors 1-3-4 are concrete monuments replacing the original stone corners properly marked.

I find bearing of line 4-1 to be N 11° 43' 40" E instead of N 11° 27' E

Mineal Survey No 3474.

I find line 3-4 to be S 89° 56' 45" E 597.74 ft.  
instead of East 600.00 ft.

See No 1351 Lucky Boy South Extension Code.  
All corners are concrete monuments replacing  
the stone corners properly marked.

Line 1-2 is identical with line 4-3 of Lucky Boy Code  
See No 1350.

I find line 4-1 to be N 0-14' 14" E 1499.01 ft.  
instead of North 1500.00 ft.

See No 1615 Sullivan Code.

Cors 1 and 5 are stone monuments properly marked.  
Cor 2 is a + on rock in place and properly marked.

I find the bearing of line 1-2 to be S 11° 16' E  
instead of S 11-45' E.

I find line 5-1 to be N 51° 18' 30" E 281.81 ft.  
instead of N 51° 15' E.

See No 1615 Walnut Creek Code.

Cors 5 and 1 are stone corners properly marked  
Cor 4 could not be found nor its bearing rock

so I give it as being on line 1-2 Sullivan Code,  
of same survey, where a line from Cor 5  
having the call bearing of the end line would  
intersect.

I find line 5-1 to be N 86° 16' 30" E 263.57 ft.  
instead of N 86° 02' E 269.80 ft.

Line 4-5 figures at N 51° 15' E 288.77 ft.  
instead of N 51° 15' E 300.00 ft.



# FINAL OATHS FOR SURVEYS.

## LIST OF NAMES.

A list of the names of the individuals employed by Joseph M. Carthy  
 United States Mineral Surveyor, to assist in running, measuring, and marking the lines, corners, and  
 boundaries described in the foregoing field notes of the survey of the mining claim of \_\_\_\_\_  
The United Verde Copper Company  
 known as the Sunset lode  
 and showing the respective capacities in which they acted.

Philip S. Cowgill, Chairman.  
 \_\_\_\_\_, Chairman.  
 \_\_\_\_\_, Axman.  
 \_\_\_\_\_, Flagman.

## FINAL OATHS OF ASSISTANTS.

~~We~~, Philip S. Cowgill  
 and \_\_\_\_\_, do solemnly swear that ~~we~~ <sup>I</sup> assisted Joseph  
M. Carthy, United States Mineral Surveyor, in marking the corners and surveying  
 the boundaries of the mining claim of The United Verde Copper Company  
 known as the Sunset lode  
 represented in the foregoing field notes as having been surveyed by said mineral surveyor and under his  
 direction; and that said survey has been in all respects, to the best of our knowledge and belief, faithfully  
 and correctly executed, and the corner and boundary monuments established according to law and the instruc-  
 tions furnished by the United States Surveyor-General for Arizona

Philip S. Cowgill, Chairman.  
 \_\_\_\_\_, Chairman.  
 \_\_\_\_\_, Axman.  
 \_\_\_\_\_, Flagman.

Subscribed and sworn to by the above-named persons before me this Tenth

day of August, 19 13

C. S. Gardner

Yavapai County, Arizona

Notary P.

FINAL OATH OF U. S. MINERAL SURVEYOR.

I, Joseph McCarthy, U. S. Mineral Surveyor,  
do solemnly swear that, in pursuance of instructions received from the United States  
Surveyor General for Arizona, dated  
Jan 22, 1918, I have, in strict conformity to the laws of the  
United States, the official regulations and instructions thereunder, and the instructions  
of said Surveyor General, faithfully and correctly executed the survey of the Mining  
Claim of The United Verde Copper Company  
known as the  
Sunset lode  
situate in Verde Mining District,  
Yavapai County, Arizona, in Sections  
22 & 27 Renew, Township No. 16 N, Range No. 2 E 3 & 4 R 8 M and within the  Prescott National  
Forest  
and designated as Survey No. 3474, as represented  
in the foregoing field notes, which accurately show the boundaries of said mining claim  
as distinctly marked by monuments on the ground, and described in the attached copy  
of the location certificate, which was received by me from the Surveyor General with  
said instructions, and that all the corners of said survey have been established and per-  
petuated in strict accordance with the law, official regulations and instructions there-  
under; and I do further solemnly swear that the foregoing are the true and original  
field notes of said survey and my report therein, and that the labor expended and  
improvements made upon said mining claim by claimant or its grantors  
are as therein fully stated, and that the character, extent, location, and itemized value  
thereof are specified therein with particularity and full detail, and that no portion of  
said labor or improvements so credited to this claim has been included in the estimate  
of expenditures upon any other claim.

Joseph McCarthy  
U. S. Mineral Surveyor.

Subscribed and sworn to by the said Joseph McCarthy  
U. S. Mineral Surveyor, before me A Notary Public in and for Yavapai  
County, Arizona this 26th  
day of February, 1919

C. S. Gardner  
NOTARY PUBLIC



# Notice of Mining Location

## LODE CLAIM

TO ALL WHOM IT MAY CONCERN:

SEP 21 1917

This Mining Claim, the name of which is the Sunset

Mining Claim, situate on lands belonging to the United States of America, and in which there are valuable mineral deposits, was entered upon and located for the purposes of exploration and purchase by

Will L Clark

a citizen of the United States

(Locator must insert either "a citizen of the United States," or "who has declared his intention to become a citizen of the United States.")

the undersigned, on the 15th day of April, 1915

The length of this claim is one thousand (1000) feet,  
and I claim one hundred and fifty (150) feet,  
in a southeasterly direction and eight hundred  
fifty (850) feet in a northwesterly direction from  
the center of the discovery shaft, at which this notice is posted, lengthwise of the claim, together with  
three hundred (300) feet in width of the surface grounds, on each  
side of the center of said claim. The general course of the lode deposit and premises is from the  
northwest to the southeast

The claim is situated and located in the Verde Mining District,  
in Yavapai County, in the State of Arizona, about 3/4 mile  
in a southwesterly direction from the Town of Jerome and covers  
all that fractional ground laying between the Lucky Boy, Lucky  
Boy South Extension, Sullivan, Walnut Creek, and No. 13, Mining  
Claims.

The surface boundaries of the claim are marked upon the ground as follows: Beginning at  
monument

at a point in a southeasterly direction 150 feet from  
the discovery shaft (at which this notice is posted), being in the center of the southeast  
end line of said claim; thence northeasterly 300 feet to a monument  
, being the most easterly corner of said claim;  
thence northwesterly 1000 feet to a monument, being at the  
most northerly corner of said claim; thence southwesterly 300 feet  
to a monument at the center of the northwest end of said claim;  
thence southwesterly 300 feet to a monument, being at the  
most westerly corner of said claim; thence southeasterly 1000  
feet to a monument at the most southerly corner of  
said claim; thence northeasterly 300 feet to the place of the beginning.

All done under the provisions of Chapter Six, of Title XXXII, of the Revised Statutes of the United States, and of an Act of the General Assembly of Arizona, entitled "An Act to Revise and Codify the Laws of the Territory of Arizona," approved March 16, 1901.

Dated and posted on the ground this 15th day of April, 1915

Will. L. Clark



County of \_\_\_\_\_ ss.

I, \_\_\_\_\_, County Recorder in and for the County and State aforesaid, do hereby certify that the within instrument was filed for record at \_\_\_\_\_ o'clock \_\_\_\_\_ M., on this \_\_\_\_\_ day of \_\_\_\_\_, 191\_\_\_\_, and duly recorded in Book No. \_\_\_\_\_ of \_\_\_\_\_ Records of \_\_\_\_\_ County, Arizona, at pages \_\_\_\_\_

Witness my hand and official seal the day and year first above written.

\_\_\_\_\_  
County Recorder.

# Notice of Location

## LODE CLAIM

\_\_\_\_\_  
\_\_\_\_\_  
\_\_\_\_\_  
\_\_\_\_\_  
Dated \_\_\_\_\_, 191\_\_\_\_

Filed and Recorded at request of

LEROY ANDERSON

JAN 18 \_\_\_\_\_, A. D. 1917.

at 10:50 o'clock \_\_\_\_\_ A. M.

Book 104 of Mines

Page 400. RECORDS OF YAVAPAI COUNTY, ARIZONA

Edith Ruffner  
(SEAL) County Recorder

By \_\_\_\_\_  
Lula McIntosh  
Deputy Recorder

Printed by Prescott Courier

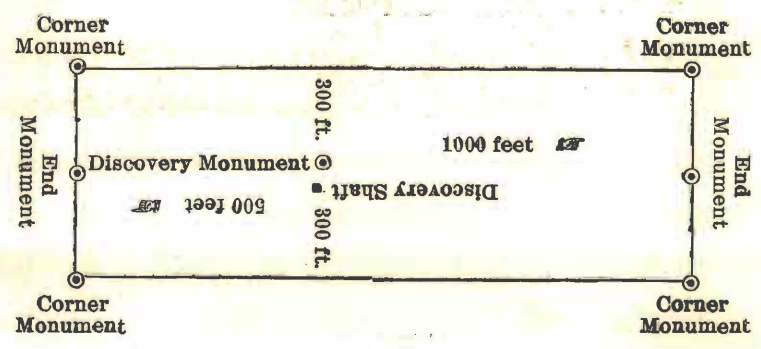

This diagram is to give locator a general idea of plan of location under the new law. The Discovery Shaft can be in the center of claim or any distance from either end desired. In the diagram it is placed 500 feet from one end and 1000 feet from the other. Commence description of claim at a center end monument, giving its distance and direction from center of Discovery Shaft; thence bound the claim in either direction. In description be careful to state locality of claim with reference to some natural object, or permanent monument, as will identify the claim.

STATE OF ARIZONA )  
 : SS  
 COUNTY OF YAVAPAI )

I, EDITH RUFFNER, County Recorder in and for the  
 aforesaid County of Yavapai and State of Arizona, and Custodian  
 of the Records of such Office; DO HEREBY CERTIFY that I have  
 compared the foregoing Copy with, and that the same is a full,  
 true and correct Copy of the Original Location Notice of the  
 SUNSET Lode Mining Claim, as the same appears of Record in  
 Book 104 of Mines, Page 400, of the records of my said office.

IN WITNESS WHEREOF, I have hereunto  
 set my hand and affixed my Official  
 Seal, this 18th day of September,  
 1917.



*Edith Ruffner*  
 COUNTY RECORDER  
 OF  
 YAVAPAI COUNTY  
 ARIZONA

By *Rollie Butler*  
 Deputy Recorder



U. S. SURVEYOR-GENERAL'S FINAL CERTIFICATE ON FIELD NOTES.

Department of the Interior,

OFFICE OF U. S. SURVEYOR-GENERAL,

Phoenix, Arizona,

FEB 18 1920, 191

I, U. S. Surveyor-General for DISTRICT OF ARIZONA,  
do hereby certify that the foregoing transcript of the Field Notes, return and approval of the survey  
of the mining claim of THE UNITED VERDE COPPER COMPANY,  
known as the SUNSET LODGE,  
situate in VERDE  
Mining District, YAVAPAI County, ARIZONA,  
in Sections 22 & 27 <sup>n<sup>sur</sup>.</sup> Township No. 16 N., Range No. 2 E., G&SRB&M, and  
designated as Survey No. 3474, has been correctly copied from the originals on file in  
this office; that said Field Notes furnish such an accurate description of said mining claim as will, if  
incorporated into a patent, serve fully to identify the premises, and that such reference is made therein  
to natural objects or permanent monuments as will perpetuate and fix the *locus* thereof.

And I further certify that five hundred dollars' worth of labor has been expended or improve-  
ments made upon said mining claim by claimant or its grantors, and that said improvements  
consist of two cuts and a tunnel, value \$825.00.

and that no portion of said labor or improvements has been included in the estimate of expenditures  
upon any other claim.

I further certify that the plat thereof, filed in the U. S. Land Office at Phoenix,  
Arizona, is correct and in conformity with the foregoing Field Notes.

Frank P. Trott

United States Surveyor-General for Arizona.

SURVEYOR-GENERAL'S CERTIFICATE OF APPROVAL OF FIELD NOTES AND SURVEY OF MINING CLAIM.

Department of the Interior,

OFFICE OF U. S. SURVEYOR-GENERAL,

Phoenix, Arizona.

FEB 18 1920, 191

I, U. S. Surveyor-General for DISTRICT OF ARIZONA,

do hereby certify that the foregoing and hereto attached Field Notes and Return of the Survey of the Mining Claim of

THE UNITED VERDE COPPER COMPANY

, known as the

SUNSET LODE,

situate in VERDE mining district,

YAVAPAI County, ARIZONA,

in Sections 22 & 27 U<sup>n</sup>sur., Township No. 16 N., Range No. 2 E., C&S RB&M,

, designated as Survey No. 3474

executed by JOSEPH MC CARTHY, United States Mineral

Surveyor, July 27 - 30, 1918, under my instructions dated

Jan. 22, 1918, have been critically examined and the necessary cor-

rections and explanations made, and the said Field Notes and Return, and the Survey they describe,

are hereby approved. A true copy of the copy of the location certificate filed by the applicant for

survey is included in the field notes.

Handwritten signature of the Surveyor-General

U. S. Surveyor-General for Arizona.