

UNITED STATES DEPARTMENT OF THE INTERIOR 9605 (952)
BUREAU OF LAND MANAGEMENT M.S. 3487
ARIZONA STATE OFFICE

NOTICE OF CANCELLATION OF MINERAL SURVEY

The America # 1 and 2 lodes, Mineral Survey No. 3487, located in section 15, Township 12 South, Range 6 West, Gila and Salt River Meridian, Arizona, are hereby canceled.

These claims have not been filed with the Arizona State Office, Bureau of Land Management, in accordance with Section 314, 90 STAT. 2769, (43 U.S.C. 1744).

This cancellation was necessitated to clear the record.

The Mineral Survey Plat should be noted as follows:

"America # 1 and 2 lodes, M.S. 3487 were canceled December 11, 1998, by memo 9605 (952) M.S. 3487, which is now a part of the original field notes."

December 11, 1998
Date



Chief Cadastral Surveyor of Arizona

MAY 5 1918

MAY 25 1918

(4-683.)

Mineral Survey No. 3487 *Platted*

Lot No. _____

Arizona Land District.

FIELD NOTES

OF THE SURVEY OF THE MINING CLAIM OF

H.T.Lyons

KNOWN AS THE

America #1, America #2 lodes

Ajo Mining District,

Pima County, Arizona

Section 15, Township 12 S., Range 6 W. (Unsurveyed)

Surveyed under instructions dated Feb. 26th., 1918,

by Paul E. Fernald,
U. S. ~~Deputy~~ Mineral Surveyor.

Claim located (See location notices attached)

Survey commenced Feb. 27th., 1918

Survey completed March 2nd., 1918

o 6-100

P.O. Address of claimant:- H.T.Lyons, Ajo, Arizona.

U.S. MINERAL SURVEY NO. 3487.

Feet. ~~and on line 2-3 Winner No. 1 lode, unsurveyed~~
AMERICA NO. 1 LODE.
 Beginning at Cor. No. 1
 A 3½ inch steel pipe, 3½ feet long, set 1½ feet in the ground, in cement, and surrounded by monument of stones. Copper cap on pipe stamped U.S.M.S. 3487, 1 AMERICA I. This corner is identical with the S. End Center of Sunrise No. 1 lode, unsurveyed, and with the N.W. Cor. of Edna No. 1 lode, unsurveyed.
 Whence U.S.L.M. No. 3161, bears N 72° 24' E, 8745.50 feet.
 Thence N 89° 01' W
 10.00 Crosses center of road, running North.
 300.00 North end center monument - 4x4 post in mound of stone. Identical with the S.W. Cor. of Sunrise No. 1 lode, unsurveyed, and the S.E. Cor. of Sunrise No. 2 lode, unsurveyed.
 600.00 Cor. No. 2, identical with Cor. No. 1, America No. 2 lode, this survey, and with the South end center of Sunrise No. 2 lode, unsurveyed.
 A 3½ inch steel pipe, 3½ feet long, set 1½ feet in the ground, in cement, and surrounded by monument of stones. Copper cap on pipe stamped U.S.M.S. 3487, 2 America I.
 Thence S 1° 06' W
 1170.00 Crosses center road running N.- N.W.
 1200.00 Crosses center road running W.
 1339.00 Crosses center wash running East.
 1500.00 Cor. No. 3, identical with Cor. No. 4, America No. 2 lode, this survey, and on line 2-3, Winner No. 1 lode, Sur. No. 3457.
 A 3½ inch steel pipe, 3½ feet long, set 1½ feet in the ground, in cement, and surrounded by monument of stones. Copper cap on pipe stamped U.S.M.S. 3487, 3 America I.
 Thence S 89° 01' E
 17.00 Crosses center road running N.
 300.00 South end center monument - palo verde post in mound of stones.
 405.00 Crosses center of wash running E.- S.E.
 600.00 Cor. No. 4, identical with the S.W. Cor. Edna No. 1 lode,

3

unsurveyed, and on line 2-3 Winner No. I lode, Sur. No. 3457.

A 3 1/2 inch steel pipe, 3 1/2 feet long, set 1 1/2 feet in the ground, in cement, and surrounded by monument of stones.

Copper cap on pipe stamped U.S.M.S. 3487, 4 America I.

Whence Cor. No. 2, Winner No. I lode, Sur. No. 3457, bears S 89 1'E, 335.00 feet.

Thence N 106'E

279.00 Crosses center road running west.

1410.00 Crosses center road running N.- N.W.

1500.00 Cor. No. I, the point of beginning.

AMERICA # NO. 2 LODE.

Beginning at Cor. No. I, identical with Cor. No. 2, America # No. I lode, this survey, heretofore described. Copper cap stamped I America 2, additionally for this corner.

Whence U.S.L.M. No. 3161, bears N 73 34 1/2'E, 9316.23 feet.

Thence N 89 01'W

300.00 North end center monument - 4x4" post in mound of earth.

Identical with the S.W. Cor. of Sunrise No. 2 lode, unsurveyed, and with the S.E. Cor. of Sunrise No. 3 lode, unsurveyed.

600.00 Cor. No. 2.

A 3 1/2 inch steel pipe, 3 1/2 feet long, set 1 1/2 feet in the ground, in cement, and surrounded by monument of stones.

Copper cap on pipe stamped U.S.M.S. 3487, 2 America 2.

This corner is identical with the S. End Center of

Sunrise No. 3 lode, unsurveyed, and the N.E. Cor. of

America No. 3 lode, unsurveyed

Thence S. I 6'W

1500.00 Cor. No. 3, identical with the S.E. Cor. of America No. 3 lode, unsurveyed.

A 3 1/2 inch steel pipe, 3 1/2 feet long, set 1 1/2 feet in the ground, in cement, and surrounded by monument of stones.

Copper cap on pipe stamped U.S.M.S. 3487, 3 America 2

Thence S 89 1'E

55.00 Crosses center wash running E.- N.E.

U.S. MINERAL SURVEY NO. 3487.

215.00 -Cor.No.3, Winner No.1 lode, Survey No.3457, identical
 03.34 with the N.E.Cor. Edna No.6 lode, unsurveyed.
 .300.00 South end center - 4x4" post in monument of stones.
 600.00 Cor.No.4, identical with Cor.No.3, America #1 lode,
 00.30 this survey, heretofore described. Copper cap on
 pipe stamped 4 America 2, additionally for this corner.
 .300.00 Thence N 1° 5' E
 161.00 Crosses center of wash, running E.-S.E.
 300.00 Crosses center road running East.
 .330.00 Crosses center road running S.-S.E.
 1500.00 Cor.No.1, the point of beginning.

Magnetic variation at all corners - 14° 0' E.
 No natural bearing objects available from corners.
 All corners are identical with the respective corners
 of location.

LODE LINES:- As near as can be determined from the present state
 of development, the veins of the two locations embraced
 in this survey, extend as follows from their respective
 discovery points:-
 #1
 America No.1 lode, S 1° 5' W, 621. feet, and N 1° 5' E, 879.ft.
 #2
 America No.2 lode, S 1° 5' W, 20.ft., and N 1° 5' E, 1480. ft.

LOCATION:* This survey is located, approximately, in the N.E. 1/4
 of section 5, T 12 S, R 7 W, G. & S.R.B. & M. Unsurveyed,
 in the Ajo Mining District, Pima County, Arizona.

AREAS:-
 Total area America #1 lode, 20.661 acres.
 " " America #2 lode, 20.661 "

IMPROVEMENTS:- I certify that the value of the labor and
 improvements made upon or for the benefit of, each of
 the locations embraced in said mining claim by the
 claimant or its grantors, is not less than Five Hundred
 Dollars, and that such improvements consist of:-

AMERICA #1 LODE.
 No.1. Discovery shaft, on the center line, N 1° 5' E,

621. feet from the S. End Center. Shaft 4x6 - 8 1/2 feet deep. Value \$42.50

No. 2. Shaft, the center of which bears S 37° 0' W, 189. ft. from point 300.00, line 4 - 1, is 4x5 - 76 feet deep. Value \$633.00

AMERICA NO. 2 LODE.

No. 1. Discovery shaft, on the center line, N 1° 06' E, 20. feet from the South end center, is 4x6 - 8 1/2 feet deep. Value \$42.50

No. 2. Shaft, the center of which bears N 83° 49' W, 116. ft. from Cor. No. 4, is 4x5 - 75 feet deep, with cross cut running north from bottom, 4x6 - 25 feet. Value \$875.00

OTHER IMPROVEMENTS.

AMERICA NO. 1 LODE.

Frame house, the S.E. Cor. bearing N 25° 35' W, 21.37 feet from Cor. No. 4. House is 20x28 feet section.

Frame house, 12x22 ft., the N.E. Cor. bearing S 8° 11' W, 209.4 ft. from point 300.00, line 4 - 1.

Frame house, 16x22 ft., the S.E. cor. bearing N 52° 42' W, 36.70 feet from point 300.00, line 4 - 1.

Frame house, 16x12 ft., the S.E. Cor. bearing N 24° 31' W, 67.30 feet from point 300.00, line 4 - 1.

Frame house, 13x20 ft., the S.E. Cor. bearing N 14° 8' W, 106.37 feet from point 300.00, line 4 - 1.

Frame house, 10 1/2 x 14 1/2 ft., the S.E. Cor. bearing N 7° 15' W, 181.75 feet from point 300.00, line 4 - 1.

Frame house, 28x24 ft., the S.E. Cor. bearing N 5° 41' W, 216.15 feet from point 300.00, line 4 - 1.

Frame house, 16 1/2 x 12 1/2 ft. the S.E. Cor. bearing N 18° 35' W, 62.57 feet from point 600.00, line 4 - 1.

Frame house, 12 1/2 x 12 1/2 ft., the S.E. Cor. bearing N 51° 14' W, 263.50 feet from point 600.00, line 4 - 1.

Frame house, 20x12 ft. the S.E. Cor. bearing N 48° 19' W, 38.92 feet from point on center line, N 1° 5' E, 300.00

feet from the S. End Center.

U. S. MINERAL SURVEY NO. 3487.

Tent house, 10x12, the S.W. Cor., bearing N 60° 6' W, 71.47 feet from point on center line, N 1 5' E, 300.00 feet from the S. end center.

Frame house, 24x22½ ft., the S.E. Cor. bearing N 17° 12' W, 107.10 feet from point on center line, N 1 5' E, 300.00 feet from the S. End Center.

Tent house, 12x14 ft., the N.W. Cor. bearing S 41° 35' E, 93.25 feet from point on center line, N 1 5' E, 300.00 feet from the S. End Center.

Frame house, 12x14 ft., the S.W. Cor. bearing N 68° 4' E, 54.90 feet from point 1200.00, line 2 - 3.

Frame house, 12x34½ ft., the S.W. Cor. bearing N 83° 14' E, 54.55 feet from Cor. No. 3.

AMERICA NO. 2 LODE.

Tent house, 12x14 ft., the S.E. Cor. bearing N 43° 31' W, 92. feet from point 300.00, line 4 - 1.

Frame house, 32½x21 ft., the S.E. Cor. bearing N 83° 26' W, 162.00 feet from point 300.00, line 4 - 1.

Frame house, 12x21 ft., the S.E. Cor. bearing N 66° 12' W, 175.20 feet from point 300.00, line 4 - 1.

Frame house, 14x33½ ft., the S.E. Cor. bearing N 41° 53' W, 72.65 feet from Cor. No. 4.

INSTRUMENT: - This survey was made with Buff & Buff Transit No. 7905. The courses were deflected from the true meridian as determined by direct solar observations. Distances were measured with Deitzgen 350 foot steel tape.

ADJOINING CLAIMS: - This survey is adjoined on the East by the Edna No. I lode, unsurveyed, J. McNew, Claimant; on the north by the Sunrise No. I, Sunrise No. 2, Sunrise No. 3 lodes, unsurveyed, D. R. Grant, Claimant; on the West by the America No. 3 lode, unsurveyed, H. T. Lyons, Claimant; and on the south by the Edna No. 6 lode, unsurveyed, J. McNew, Claimant, and Winner No. I lode, Survey No. 3457. There are no conflicts.

REPORT:- The lines of this survey were run direct upon the ground.

U.S.L.M.No.3161 is a 6x6 post, 5 feet above ground, surrounded by a monument of stones 3 feet high and with 6 foot base, It is located on the north end of a small black butte rising from flat country. Post is scribed on South face "U.S.M.M. No.3161." Two bearing rocks noted.

Corners and centers of Edna No.1 lode, Sunrise Nos.1,2 and 3 lodes, America No.3 lode, and Edna No.6 lode, all unsurveyed, are 4x4 pine posts.

Corners No.3 and 3, Winner No.1 lode, Sur.No.3457, is a 1 inch iron pipe, 2 feet above ground, set in monuments of stone, and with brass cap on pipe, stamped with Survey and corner number.

Cor.No.2 is a 4x4 post in monument of stone, with stamped copper sheet on side facing claim, giving survey and corner number. (This corner identical with Cor.No.3, Luna No.II lode, Sur.No.3160 A.)

Respectfully submitted

Paul E. Fernald

U.S.Mineral:Surveyor
Ajo, Ariz. March 4th. 1918.

ADJOINING CLAIMS:- This survey is adjacent on the east by the Luna No.1 lode, unsurveyed, U.M.W., claim; on the north by the Sunrise No.1, Sunrise No.2, Sunrise No.3 lodes, unsurveyed, D.R.Grant, claimant; on the east by the America No.3 lode, unsurveyed, R.T.Lyon, claimant; and on the south by the Edna No.6 lode, unsurveyed, U.M.W., claimant, and Winner No.1 lode, Survey No.3457. There are no south lines.

FINAL OATHS FOR SURVEYS.

LIST OF NAMES.

A list of the names of the individuals employed by Paul E. Fernald
United States Mineral Surveyor, to assist in running, measuring, and marking the lines, corners, and
boundaries described in the foregoing field notes of the survey of the mining claim of _____

H.T. Lyons
known as the America No. 1, America No. 2 lodes

and showing the respective capacities in which they acted.

D. Dooley, *Chainman.*

L. Denio, *Chainman.*

_____, *Arman.*

_____, *Flagman.*

FINAL OATHS OF ASSISTANTS.

We, D. Dooley
and L. Denio, do solemnly swear that we assisted Paul E. Fernald
United States Mineral Surveyor, in marking the corners and surveying
the boundaries of the mining claim of H.T. Lyons

known as the America No. 1, America No. 2 lodes

represented in the foregoing field notes as having been surveyed by said mineral surveyor and under his
direction; and that said survey has been in all respects, to the best of our knowledge and belief, faithfully
and correctly executed, and the corner and boundary monuments established according to law and the instruc-
tions furnished by the United States Surveyor-General for Arizona.

D. Dooley, *Chainman.*

L. Denio, *Chainman.*

_____, *Arman.*

_____, *Flagman.*

Subscribed and sworn to by the above-named persons before me this 2nd

day of March, 1918

Cornelius T. Redding
Notary Public

FINAL OATH OF U. S. MINERAL SURVEYOR.

I, Paul E. Fernald, U. S. Mineral Surveyor, do solemnly swear that, in pursuance of instructions received from the United States Surveyor General for Arizona, dated Feb. 26th. 1918. I have, in strict conformity to the laws of the United States, the official regulations and instructions thereunder, and the instructions of said Surveyor General, faithfully and correctly executed the survey of the Mining Claim of H.T. Lyons, known as the America No. 1, America No. 2 lodes, situate in Ajo Mining District, Pima County, Arizona, in Section 15, Township No. 12 S., Range No. 6 W. (Unsurveyed) G. & S.R.B. & M. and designated as Survey No. 3487, as represented in the foregoing field notes, which accurately show the boundaries of said mining claim as distinctly marked by monuments on the ground, and described in the attached copy of the location certificate, which was received by me from the Surveyor General with said instructions, and that all the corners of said survey have been established and perpetuated in strict accordance with the law, official regulations and instructions thereunder; and I do further solemnly swear that the foregoing are the true and original field notes of said survey and my report therein, and that the labor expended and improvements made upon said mining claim by claimant or his grantors are as therein fully stated, and that the character, extent, location, and itemized value thereof are specified therein with particularity and full detail, and that no portion of said labor or improvements so credited to this claim has been included in the estimate of expenditures upon any other claim.

Paul E. Fernald. U. S. Mineral Surveyor.

Subscribed and sworn to by the said Paul E. Fernald U. S. Mineral Surveyor, before me Cornelius T. Redington a Notary Public of Pima Co. Arizona this 2nd day of March, 1918

Cornelius T. Redington Notary Public

My Commission Expires March 14, 1920.

Feb. 17 1918

AMENDED

Notice of Mining Location

LODE CLAIM

To All Whom It May Concern:

This Mining Claim, the name of which is the America #1 Mining Claim, situate on lands belonging to the United States of America, and in which there are valuable mineral deposits, was entered upon and located for the purposes of exploration and purchase by H. J. Lyons a citizen of the U.S. (Locator must insert either "a citizen of the United States," or "who has declared his intention to become a citizen of the United States.") the undersigned, on the 15th day of November 1917

The length of this claim is 1500 feet, and 621 claim feet, in a Southerly direction and 879 feet in a northerly direction from the center of the discovery shaft, at which this notice is posted, lengthwise of the claim, together with 300 feet in width of the surface grounds, on each side of the center of said claim. The general course of the lode deposit and premises is from the South to the North

The claim is situated and located in the Ajo Mining District, in Pima County, in the State of Arizona, about 10000 ft in a N. by N.W. direction from U.S.M.M. #1 of the Ajo mining district and the south end line of this claim joins the north side line of Miner #1 mining claim.

The surface boundaries of the claim are marked upon the grounds as follows: Beginning at

Post at a point in a Northerly direction 879 feet from the discovery shaft (at which this notice is posted,) being in the center of the end line of said claim; thence westerly 300 feet to a post being the Northwest corner of said claim; thence Southerly 1500 feet to a post, being at the Southwest corner of said claim; thence Easterly 300 feet to a post at the center of the South end of said claim; thence Easterly 300 feet to a post being at the Southeast corner of said claim; thence Northerly 1500 feet to a post at the Northwest corner of said claim; thence Easterly 300 feet to the place of beginning.

All done under the provisions of the laws of the United States, and of the State of Arizona.

This is an Amended Location Notice of the Edna #1 Mining Claim, located by H. J. Lyons on the 27th day of November 1915, and recorded in Book 4-4 of Records of Mines, at page 5, in the office of the County Recorder of the aforesaid County of Pima to which reference is hereby made, and this amended Location Notice is made and posted to correct errors in the description in the said original Location Notice.

Dated and posted on the ground this 15th day of November 1917 H. J. Lyons

County of } ss.

I,, County Recorder in and for the County and State aforesaid, do hereby certify that the within instrument was filed for record at o'clock, M., on this day of 191....., and duly recorded in Book No..... of Records of County, Arizona, at pages

WITNESS my hand and official seal the day and year first above written.

County Recorder.

AMENDED
Notice of Location
LODE CLAIM

Dated, 191.....

Filed and Recorded at request of

N. J. Lyons

Feb. 2. A. D. 1918

at *-9-* A. M.

Book *B. B. Record of Mines*

Pages *507-509*

P. B. Howard
County Recorder.

By *A. M. Shubert*
Deputy Recorder.

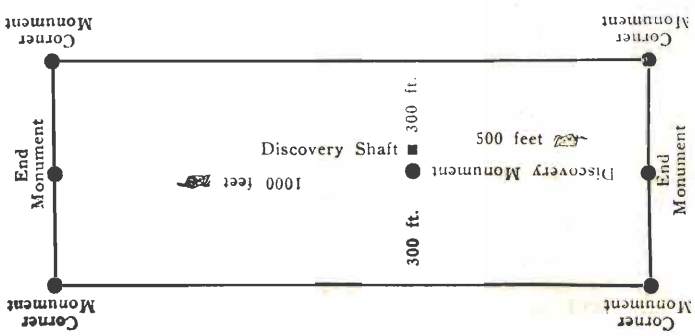

This diagram is to give locator a general idea of plan of location under the new law. The Discovery Shaft can be in the center of claim or any distance from either end desired. In the diagram it is placed 500 feet from one end and 1000 feet from the other. Commence description of claim at a center end monument, giving its distance and direction from center of Discovery Shaft; thence bound the claim in either direction. In description be careful to state locality of claim with reference to some natural object, or permanent monument, as will identify the claim.

mail of Lyons
Apr. day 453
100

RECORDED AND INDEXED
M. G. A. C. M. S.

AMENDED

Notice of Mining Location

LODE CLAIM

To All Whom It May Concern:

This Mining Claim, the name of which is the America # 2 Mining Claim, situate on lands belonging to the United States of America, and in which there are valuable mineral deposits, was entered upon and located for the purposes of exploration and purchase by

H. J. Lyons

A citizen of the U.S.

(Locator must insert either "a citizen of the United States," or "who has declared his intention to become a citizen of the United States.") the undersigned, on the 15 day of November 1917

The length of this claim is 500 feet, and 20 claim feet, in a Southerly direction and 1480 feet in a northerly direction from the center of the discovery shaft, at which this notice is posted, lengthwise of the claim, together with 200 feet in width of the surface grounds, on each side of the center of said claim. The general course of the lode deposit and premises is from the South to the North

The claim is situated and located in the Ajo Mining District, in Pima County, in the State of Arizona, about 10100 ft. in a northerly direction from U.S.M.M.#1 of the Ajo mining district and this claim joins the America # 2 on the East and the Winner # 1 Mining claim on the South.

The surface boundaries of the claim are marked upon the grounds as follows: Beginning at

post

at a point in a Southerly direction 20 feet from the discovery shaft (at which this notice is posted,) being in the center of the South end line of said claim; thence Easterly 300 feet to a post, being the Southeast corner of said claim; thence North 1500 feet to a post, being at the Northeast corner of said claim; thence Westerly 300 feet to a post at the center of the North end of said claim; thence Westerly 300 feet to a post, being at the Northwest corner of said claim; thence Southerly 1500 feet to a post at the Southwest corner of said claim; thence Easterly 300 feet to the place of beginning.

All done under the provisions of the laws of the United States, and of the State of Arizona.

This is an Amended Location Notice of the Edna # 2 Mining Claim, located by H. J. Lyons

on the 27 day of November 1915, and recorded in Book 4-4 of Records of Mines, at page 6, in the office of the County Recorder of the aforesaid County of Pima to which reference is hereby made, and this amended Location Notice is made and posted to correct errors in the description in the said original Location Notice.

Dated and posted on the ground this 15 day of November 1917

H. J. Lyons

STATE OF ARIZONA,

ss.

County of

I,, County Recorder in and for the County and State aforesaid, do hereby certify that the within instrument was filed for record at.....o'clock,M., on this day of..... 191....., and duly recorded in Book No..... of Records of County, Arizona, at pages

WITNESS my hand and official seal the day and year first above written.

County Recorder.

AMENDED
Notice of Location
LODE CLAIM

Dated, 191.....

Filed and Recorded at request of

W. J. Hyman

Feb. 2 A. D. 191*8*

at *-9 -* a. M.

Book *B. B. B. Record of Mines*

Pages *508*

R. B. Vinson
County Recorder.

By *L. M. Shubert*
Deputy Recorder.

*mail to
W. J. Hyman
Apr Ariz 487*

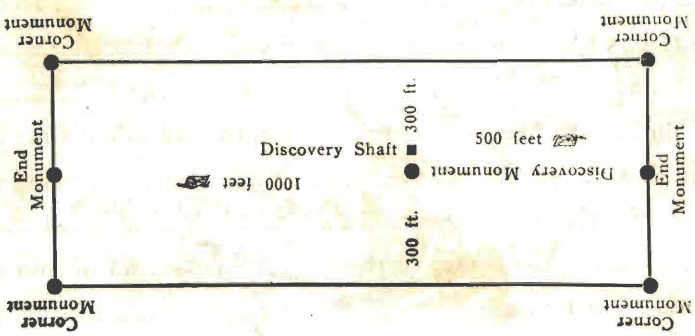

This diagram is to give locator a general idea of plan of location under the new law. The Discovery Shaft can be in the center of claim or any distance from either end desired. In the diagram it is placed 500 feet from one end and 1000 feet from the other. Commence description of claim at a center end monument, giving its distance and direction from center of Discovery Shaft; thence bound the claim in either direction. In description be careful to state locality of claim with reference to some natural object, or permanent monument, as will identify the claim.

AND INBLANK
L. M. Shubert

U. S. SURVEYOR-GENERAL'S FINAL CERTIFICATE ON FIELD NOTES.

Department of the Interior,

OFFICE OF U. S. SURVEYOR-GENERAL,

Phoenix, Arizona.

July 31, 1918

I, U. S. Surveyor-General for District of Arizona

do hereby certify that the foregoing transcript of the Field Notes, return and approval of the survey of the mining claim of

H. P. Lyons

known as the AMERICA #1, AMERICA # 2 lodes

situate in Ajo

Mining District, Pima County, Arizona

in Section 15, Township No. 12 S., Range No. 6 W., Unapp'd, and

designated as Survey No. 3487, has been correctly copied from the originals on file in

this office; that said Field Notes furnish such an accurate description of said mining claim as will, if incorporated into a patent, serve fully to identify the premises, and that such reference is made therein to natural objects or permanent monuments as will perpetuate and fix the locus thereof.

And I further certify that five hundred dollars' worth of labor has been expended or improvements made upon each of said mining claims by claimant or his grantors, and that said improvements consist of 4 shafts and 1 crosscut, total value \$1593.00

and that no portion of said labor or improvements has been included in the estimate of expenditures upon any other claim.

I further certify that the plat thereof, filed in the U. S. Land Office at Phoenix, Arizona is correct and in conformity with the foregoing Field Notes.

Frank P. Trott

United States Surveyor-General for Arizona.

4-687.

SURVEYOR-GENERAL'S CERTIFICATE OF APPROVAL OF FIELD
NOTES AND SURVEY OF MINING CLAIM.

Department of the Interior,

OFFICE OF U. S. SURVEYOR-GENERAL,

Phoenix, Arizona,

July 31, 1918

I, U. S. Surveyor-General for District of Arizona

do hereby certify that the foregoing and hereto attached Field Notes and Return of the Survey of the
Mining Claim of

H. T. Lyons

, known as the

AMERICA #1, AMERICA #2 lodes

situate in Ajo mining district,

Pima County, Arizona

in Section 15, Township No. 12 S, Range No. 6 W., Unapp'd.

, designated as Survey No. 3487

executed by Paul E. Fernald, United States Mineral

Surveyor, February 27 - March 2, 1918, under my instructions dated

February 26, 1918, have been critically examined and the necessary cor-

rections and explanations made, and the said Field Notes and Return, and the Survey they describe,

are hereby approved. A true copy of the copy of the location certificate filed by the applicant for

survey is included in the field notes.



U. S. Surveyor-General for Arizona.