

Copied May 1-1919

A L H

JUN 29 1918

SEP 27 1918 1

OCT 3 1918

(4-683.)

*P. called*

Mineral Survey No. 3499

Lot No. \_\_\_\_\_

Arizona

Land District.

### FIELD NOTES

#### MINERAL SURVEY NO. 3499

Claims	M & B Desc.	Improvements	Loc. Notices
	Pg. 6	Pg. 18	Red Pg. 5
Calumet	11	19	8
Cave	1	16	1
Daily No. 3	3	17	2
Daily No. 5	9	18	7
Daily Extension	8	18	6
Edith	14	20	11
Katherine	5	17	4
Roskruge	4	17	3
Spinx	13	19	10
Wedge No. 2	12	19	9
Wedge No. 3			

Section 17-20 Uns., Township 11 S., Range 16 E.

Surveyed under instructions dated April 12, 1918, 1,

by T.N. Stevens,

U. S. Deputy Mineral Surveyor.

Claim located See location notices, 1

Survey commenced April 28, 1918, 1

Survey completed May 12, 1918, 1

o 6-180

Address of claimant:

Ralph W. Langworthy, Atty,  
~~G.S. Hancock, Attorney in fact,~~

Tucson, Ariz.

Survey No. 3499.

Daily No 3 Lode.

Feet. Beginning at Cor. No 1, identical with Cor. No. 2  
 Daily No. 5 lode of this survey, on line 1-2, Calumet  
 Lode, of this survey, a limestone 5 X 12 X 6 ins., set  
 12 ins. in the ground and chiseled with cross (X) D3-1,  
 D5-2-3499, with md. of stone 3 1/2 ft. base by 3 ft. high  
 alongside, whence the N.W. Cor. Sec. 21, T.11 S., R. 16 E.,  
 G. & S.R.B.M. bears S 79° -50'E., 3024.57 ft.

No bearings are available.

Thence N. 58° -01'W.

Va. 13° -30'E.

159.9 N. end center Calumet lode of this survey,  
 300.0 To S. end center, an oak stump 4 ins. diam., 4 ft.  
 high, blazed and scribed S Cr. D.3  
 508.73 To Cor. No. 2, identical with Cor No. 2 Calumet lode,  
 Cor. No 1 Cave lode, and Cor. No. 2, Wedge No. 3 lodes  
 of this survey, a limestone in place 18 X 18 X 24 ins.  
 chiseled with a cross (X) D3-2, C-2, W3-2, Cave-1-3499,  
 with md of stone 3 1/2 ft. base by 3 ft. high; a limestone  
 cliff 40 ft. long by 20 ft. high, chiseled with a cross  
 (X) D3-2, C-2, W3-2, Cave-1-3499, B.R. Brs. S.47°W.,  
 38.16 ft.

Thence N. 7° -13'E.

Va. 13° -30'E.

300.0 To E. end center Cave lode of this survey,  
 600.0 To Cor. No. 2 Cave lode, identical with Cor. No. 1  
 Daily Extension lode of this survey,  
 900.0 To E. end center Daily Extension lode of this survey,  
 1126.01 To Cor. No. 3, identical with Cor. No 2 Daily Ex-  
 tension lode of this survey and Cor. No 4 Hidden Treas-  
 ure lode, Sur. No. 2871. Claimant unknown.

A pine post 4 ins. sq., 4 ft. long, set firmly in the  
 ground and surrounded with a md. of stone, scribed  
 HT-4-2871 on N.W. face, DE-2-3499 on S.W. face, D3-3-  
 3499 on S. E. face, whence a cross (X) HT 4-2871, DE 2,

Feet	Sur. No. 3499 - continued.
	Daily No. 3 Lode - continued.
	-D3, 3-3499 B. R., chiseled on limestone boulder 6 X 3 X 2 ft. above ground, brs. N. 82° W., 5.9 ft.
	Thence N. 20° E.
	Va. 13° -30' E.
289.08'	Intersect line 2-3, Sur. No. 3017, Eagle No. 2 lode, Copper Queen Consolidated Mining Co. Claimant, at S 61°-31'E, 37.44 ft. from Cor. No. 3,
300.0	To E. end center Hidden Treasure lode,
339.89	Intersect line 3-4, Sur. No. 3017, Eagle No. 2 lode, at N. 59°-16'E, 58.5 ft. from Cor. No. 3
378.75	To Cor. No. 4, a limestone 10 X 10 X 5 ins., set 12 ins. in the ground, chiseled with a cross (X) D3, 4-3499 on S.E. face, with md. of stone 3 1/2 ft. base by 3 ft. high alongside.
	Cor. No. 3, Sur. No. 3017, Eagle No. 2 Lode, brs. S 43° -44' W 91.94 ft.
	No bearings are available.
	Thence S. 58° -01' E.
	Va. 13° -30' E.
27.67'	Intersect line 3-4, Sur. No. 3017, Eagle No. 2 lode, at N. 59° -16' E, 101.27 ft. from Co. No 3;
203.65	To N. end center, an oak post 3 ins. sq. by 4 ft. long, surrounded with md. of stone 3 1/2 ft. base by 3 ft. high, scribed N. Cr. D3.,
503.65	To Cor. No. 5, identical with Cor. No. 3 Daily No. 5 lode of this survey, a limestone boulder in place 10 X 12 X 3 ins., above ground, chiseled with cross (X) D3-5, D5-3, 3499, with md. of stone 3 1/2 ft. base by 3 ft. high alongside.
	No bearings are available.
	Thence S. 10° -15' W.
	Va. 13° -30' E.
60.90	Intersect line 2-3, Sur. No. 3017, Eagle No. 2 lode, at S 61° -31' E, 546.0 ft. from Cor. No. 3.

	Sur. No. 3499-continued.
	Daily No. 3 lode,- continued.
1500.0	To Cor. No. 1, the place of beginning.
	Daily No. 5 Lode.
	Beginning at Cor. No. 1, identical with Cor. No. 2 Sphinx lode of this survey on line 4-1 Edith lode of this survey, a lime boulder in place 5 X 10 X 8 ft. high, chiseled with a cross (X) D5-1, S2-3499, with md. of stone 3 1/2 ft. base by 3 ft. high alongside, whence the N.W. Cor. Sec. 21, T.11 S., R. 16 E. brs. S.85°-25'E., 2442.06 ft., a pine tree 12 ins. diam. brs. N.47° W. 48.1 ft., blazed and scribed D5-1, S2-3499 BT.
	No other bearings available.
	Thence N.58° -01'W.
	Va.13° -30'E.
320.0	To S. end center, a pine post 4 in. sq. by 4 ft. long surrounded with md. of stone 3 1/2 ft. base by 3 ft. high, scribed S. Cr. D5.
451.06	To Cor. No. 1 Calumet, and Cor. No. 4 Edith lodes of this survey,
640.0	To Cor. No. 2, identical with Cor. No. 1 Daily No. 3 lode of this survey, heretofore described..
	Thence N.10° -15'E.
	Va. 13° -30'E.
1439.1	Intersect line 2-3, Sur. No. 3017, Eagle No. 2 lode, at S.61° -31'E, 546.0 ft. from Cor. No. 3.
1500.0	To Cor. No. 3, identical with Cor. No.5, Daily No. 3 lode of this survey, heretofore described.
	Thence S.58° -01'E.
	Va.13° -30'E.
320.0	To N. end center, an oak post 4 ins. sq. by 4 ft. long, surrounded with md. of stone 3 1/2 ft. base by 3 ft. high, blazed and scribed N. Cr. D5,
640.0	To Cor. No. 4, identical with Cor. No. 3, Sphinx lode

Feet

Sur. No. 3499- continued  
Daily No. 5 lode, -cont'd.

of this survey, a limestone 8 X 12 X 3 ins., set 12 ins. in the ground, chiseled with a cross (X) D5-4, S3, -3499, with md. of stone 3 1/2 ft. base by 3 ft high alongside.

No bearings are available.

Thence S. 10°-15'W.

Va. 13°-30'E.

19.79

Intersect line 2-3, Sur. No. 3017, Eagle No. 2 lode, at N. 61°-31'W., 301.07 ft. from Cor. No. 2., and S. 61°31'E. 171.93ft from Cor. No. 3.

1500.0

To Cor. No. 1, the place of beginning.

#### Sphinx Lode.

Beginning at Cor. No. 1, identical with Cor. No. 2, Roskrige lode of this survey, on line 1-4 Edith lode of this survey, a point on ledge of rock 25 ft. long by 10 ft. high, chiseled with cross (X) S1 - R2 - 3499, with md. of stone 3 1/2 ft. base by 3 ft. high alongside, whence the N.W. Cor. Sec. 21, T. 11 S., R. 16 E., brs. N. 85°-39'E., 1896.82 ft; A lime ledge 6 ft. long by 4 ft. high, brs. N. 58°-01'W., 15 ft., chiseled with a cross (X) S1-R2-3499-BR .

No other bearings are available

Thence N. 58°-01'W.

Va. 13°-30'E.

320.0

To S. end center, a pine post 4 ins. sq. by 4 ft. long, surrounded with md. of stone 3 1/2 ft. base by 3 ft. high scribed S. Cr. Sph.

640.0

To Cor. No. 2, identical with Cor. No. 1, Daily No. 5 lode of this survey, heretofore described.

Thence N. 10°-15'E.

Va. 13°-30'E.

1480.21

Intersect line 2-3, Sur. No. 3017, Eagle No. 2 lode, at N. 61°-31'W., 301.07 ft. from Cor. No. 2

1500.0

To Cor. No. 3, identical with Cor. No. 4, Daily No. 5 lode of this survey, heretofore described.

Survey No. 3499 - continued.  
Sphinx Lode - cont'd.

Feet	
	<p>Thence S. 58°-01'E. Va. 13°-30'E.</p>
307.84	<p>To Cor. No. 2, Golden Peak No. 2 lode, Sur. No. 3017, Copper Queen Consolidated Mining Co., claimant, identical with Cor. No. 2, Eagle No. 2 lode of same survey.</p>
320.0	<p>To N. end center, an oak post 4 ins. sq. by 4 ft. long, surrounded with md. of stone 3 1/2 ft. base by 3 ft. high scribed N.Cr. Sph.,</p>
640.0	<p>To Cor. No. 4, identical with Cor. No. 3 Roskruge lode of this survey, a limestone boulder in place 5 ft. long by 2.5 ft. wide, 2 ft. above ground, chiseled with cross (X) S4-R3-3499, with md. of stone 3 1/2 ft. base by 3 ft. high alongside.</p>
	<p>No bearings are available Thence S. 10°-15'W. Va. 13°-30'E.</p>
1500.0	<p>To Cor. No. 1, the place of beginning.</p>
	<p>Roskruge Lode. Beginning at Cor. No. 1, a limestone 18 X 7 X 6 ins. above ground, set 12 ins. in the ground and chiseled with cross (X) R1-3499 on N.W. face, with md. of stone 3 1/2 ft. base by 3 ft. high alongside, whence the N.W. Cor. Sec. 21, T. 11 S., R. 16 E. brs. N. 70°-18'E., 1432.41 ft.</p>
	<p>U.S.M.M. No. 1 brs. S. 35°-28'E., 2909.77 ft., Cor. No. 1, Sur. No. 3056, Major McKinley lode, Copper Queen Consolidated Mining Company, claimant, brs. N. 14°-34'E., 420.74 ft.</p>
	<p>No other bearings are available. Thence N. 58°-01'W. Va. 13°-30'E.</p>
276.02	<p>Intersect line 1-4, Sur. No. 3056, Major McKinley lode at S. 52°-29'W., 428.59 ft. from Cor. No. 1.</p>

Sur, No. 3499 - continued.  
Roskruge lode - cont'd.

Feet 320.0	To S. end center, identical with Cor. No. 1, Edith lode of this sur.,
640.0	To Cor. No. 2, identical with Cor. No. 1, Sphinx lode of this sur., heretofore described. Thence N. $10^{\circ}-15'E$ . Va. $13^{\circ}-30'E$ .
1500.0	To Cor. No. 3, identical with Cor, No. 4, Sphinx lode of this sur., heretofore described. Thence S. $58^{\circ}-01'E$ Va. $13^{\circ}-30'E$ .
320.0	To N. end center, a pine post 4 ins. sq. by 4 ft. long, surrounded with md of stone $3\frac{1}{2}$ ft. base by 3 ft. high, scribed N Cr. Ros.
640.0	To Cor. No. 4, a limestone 6 X 8 X 6 ins. above ground, set 12 ins, in the ground, chiseled with a cross (X) R4-3499, with md. of stone $3\frac{1}{2}$ ft. base by 3 ft. high alongside. No bearings are available. Thence S $10^{\circ}-15'W$ . Va. $13^{\circ}-30'E$ .
1115.35	Intersect line 1-4, Sur. No. 3056, Major McKinley lode, at S. $52^{\circ}-29'W$ ., 47.13 ft. from Cor. No. 1.
1500.0	To Cor. No. 1, the place of beginning. Calumet Lode. Beginning at Cor. No. 1, on line 2-1 Daily No. 5 lode of this Sur., identical with Cor. No. 4 Edith lode of this Sur., a limestone 6 X 12 X 6 ins. above ground, set 12 ins. in the ground and chiseled with a cross (X) C1-E4-3499, with md. of stone $3\frac{1}{2}$ ft. base by 3 ft. high alongside, whence the N.W. Cor. Sec. 21, T. 11 S., R. 16 E. brs. S. $81^{\circ}-14'E$ ., 2850.09 ft. No other bearings are available. Thence N. $58^{\circ}-01'W$ . Va. $13^{\circ}-30'E$ .

Feet	Sur. No. 3499 - continued. Calumet Lode, Con't.,
188.94	To Cor. No. 2, Daily No. 5, lode, identical with Cor. No. 1 Daily No. 3 lode of this Sur., heretofore described.
348.84	To N. end center, a pine post 4 ins. sq. by 4 ft. long, surrounded with md. of stone 3 1/2 ft. base by 3 1/2 ft. high, scribed N. Cr. Cal.
488.94	To S. end center monument Daily No. 3 lode of this Sur., heretofore described.
697.67	To Cor No. 2, identical with Cor. No. 2, Daily No. 3 lode, Cor. No. 1, Cave lode, and Cor. No. 2, Wedge No. 3 lode of this Sur., heretofore described.
	Thence S. 1° -18' W. Va. 13° -30' E.
300.0	To E. end center Wedge No. 3 lode of this Sur.
600.0	To Cor. No. 1, Wedge No. 3 lode, identical with Cor. No. 1, Wedge No. 2 lode, both of this Sur.
900.0	To E. end center, Wedge No. 2 lode of this Sur.
1200.0	To Cor. No. 2. Wedge No. 2 lode, identical with Cor. No. 1, Katherine lode, both of this Sur.
1394.0	To E. end center, Katherine lode of this Sur.
1500.0	To Cor. No. 3, a porphyry rock 8 X 8 X 6 ins. above ground, set 12 ins. in the ground and chiseled with cross (X) <sup>C</sup> 3-3499 on N.E. face, with md. of stone 3 1/2 ft. base by 3 ft. high alongside.
	No bearings are available.
	Thence S. 58° -01' E. Va. 13° -30' E.
348.83	To S. end center, an iron-wood post 4 ins. sq. by 4 ft. long, surrounded with md. of stone 3 1/2 ft. base by 3 ft. high, scribed S. Cr. Cal.
697.67	To Cor. No. 4, on line 3-4, Sur. No. 3056 Wedge lode, Copper Queen Consolidated Mining Co., claimant., a limestone 6 X 18 X 6 ins. above ground, set 12 ins. in the ground and chiseled with cross (X) <sup>C</sup> 4-3499, with md. of stone 3 1/2 ft. base by 3 ft. high alongside.
	No bearings are available.



Feet	
	Sur. No. 3499 - continued. Calumet lode, - cont'd.
	Thence N. $1^{\circ}$ -18'E. Va. $13^{\circ}$ -30'E.
802.33	To Cor. No. 3, Edith lode of this Sur.,
892.4	To Cor. No. 4, Sur. No. 3056, Wedge lode,
1151.16	To W. end center monument Edith lode of this Sur.,
1500.0	To Cor. No. 1, the place of beginning.

## Edith Lode.

Beginning at Cor. No. 1, identical with S. end center Roskruge lode of this Sur., a limestone 12 X 14 X 8 ins. above ground, set 12 ins in the ground, chiseled with a cross (X)E1-3499, S. Cr. R., with md. of stone 3 1/2 ft. base by 3 ft. high alongside, whence the N. W. Cor. Sec. 21, T. 11 S., R. 16 E., brs., N.  $79^{\circ}$ -03'E., 1650.0 ft., Cor. No. 4-1, Sur. No. 3056, Major McKinley and Marble Peak lodes brs. S.  $45^{\circ}$ -05'W., 319.57 ft.

No other bearings are available

Thence S.  $1^{\circ}$ -18'W.  
Va.  $13^{\circ}$ -30'E.

52.87	Intersect line 4-1, Sur. No. 3056, Major KcKinley lode, at S. $52^{\circ}$ -29'W., 477.13 ft. from Cor. No. 1 and N. $52^{\circ}$ -29'E., 283.77' ft. from Cor. No. 4.
348.84	To E. end center, an oak post 4 ins. sq. by 4 ft. long, surrounded with md. of stone 3 1/2 ft. base by 3 ft. high, scribed E. Cr. E.
697.67	To Cor. No. 2, a limestone 12 X 14 X 6 ins. above ground, set 12 ins. in the ground and chiseled with cross (X)E2-3499 on N.W. face, with md. of stone 3 1/2 ft. base by 3 ft. high alongside.
	No bearings are available.
	Thence N. $58^{\circ}$ -01'W. Va. $13^{\circ}$ -30'E.
267.6	Intersect lines 1-2 and 3-4, Sur. No. 3056, Marble Peak and Major McKinley lodes respectively, at S. $2^{\circ}$ -52'W., 330.49 ft. from Cor. Nos. 1, 4.

Sur. No. 3499 - continued.  
 Edith lode, - cont'd.

Feet  
~~638.53~~<sup>9</sup> Intersect <sup>line</sup> 3-4, <sup>Sur. No. 3056</sup> Marble Peak lode, <sup>and line 1-2 Sur. No. 3461 Oversight lode</sup> at S. 2°-52'W.,  
 125.26 ft. from Cor. Nos. 4; <sup>& b</sup> Cor. No. 1, said <sup>Marble Peak</sup> lode, brs.  
 N. 88°-30'E., 325 ft. from Cor. No. 4 thereof, and Cor. No. 4  
 said Oversight lode brs. S. 89°11'40"W. 188.98 ft. from Cor. No. 1 thereof.

854.47 Intersect line 1-2, Sur. No. 3056, Wedge lode, <sup>v</sup> at  
 S. 1°-05'W., 25.08 ft. from Cor. Nos 1 & 4. <sup>and line 3-4 Sur. No. 3461 Oversight lode.</sup>

1411.06 To Cor. No. 3 on line 4-1, Calumet lode of this Sur.,  
 and line 3-4, Sur. No. 3056, Wedge lode, at S. 1°-18'W.,  
 90.07 ft. from Cor. No. 4, a limestone ledge 5 ft. high  
 by 8 ft. long, chiseled with a cross (X) E3-3499, with md.  
 of stone 3 1/2 ft. base by 3 ft. high alongside. <sup>Said</sup>  
<sup>lode is</sup> <sup>the</sup> <sup>same</sup> <sup>as</sup> <sup>the</sup> <sup>one</sup> <sup>described</sup> <sup>in</sup> <sup>the</sup> <sup>report</sup> <sup>of</sup> <sup>the</sup> <sup>U.S. G. S. No. 3461 Oversight lode.</sup>  
 No bearings are available.

Thence N. 1°-18'E.  
 Va. 13°-30'E.

90.07 To Cor. No. 4, Sur. No. 3056, Wedge lode, whence Cor.  
 1, said lode, brs. S. 52°-36'E., 592.3 ft.

348.83 To W. end center, a pine post 4 ins. sq. by 4 ft. long,  
 surrounded with md. of stone 3 1/2 ft. base by 3 ft. high,  
 scribed W. Cr. E.,

697.67 To Cor. No. 4, identical with Cor. No. 1, Calumet lode  
 of this Sur., heretofore described.

Thence S. 58°-01'E  
 Va. 13°-30'E.

451.06 To Cor. Nos 1-2, Daily No. 5 and Sphinx lodes res-  
 pectively, of this Sur., heretofore described,

1091.06 To Cor. Nos 1-2 Sphinx and Roskruge lodes respectively,  
 of this Sur., heretofore described,

1411.06 To Cor. No. 1, the place of beginning.

Daily Extension Lode.

Beginning at Cor. No. 1, identical with Cor. No. 2,  
 Cave lode of this Sur., on line 2-3, Daily No. 3 lode of  
 this Sur., a limestone 8 X 14 X 5 ins. above ground, set  
 12 ins. in the ground, chiseled with cross (X) DE 1-C2-  
 3499, with md. of stone 3 1/2 ft. base by 3 ft. high a-  
 longside, whence the N.W. Cor, Sec. 21, T. 11 S., R 16 E.,  
 brs. S. 67°-14'E., 3614.8 ft.

	<p>Sur. No. 3499 - continued. Daily Extension lode, cont'd.</p> <p>No other bearings are available.</p> <p>Thence N. <math>7^{\circ}-13'E.</math>, Va. <math>13^{\circ}-30'E.</math></p>
300.0	To E. end center, a pine post 4 ins. sq. by 4 ft. long surrounded with md. of stone $3\frac{1}{2}$ ft. base by 3 ft. high, scribed E. Cr. D E.,
526.01	To Cor. No. 2, identical with Cor. No. 3, Daily No. 3 lode of this Sur. and Cor. No. 4, Sur. No. 2871, Hidden Treasure lode, heretofore described.
	<p>Thence N. <math>78^{\circ}W</math> Va. <math>13^{\circ}-30'E.</math></p>
750.0	To Cor. No. 3, a limestone 5 X 7 X 11 ins. above ground, set 12 ins. in the ground and chiseled with a cross (X) DE3-3499 on S. face, with md. of stone $3\frac{1}{2}$ ft. base by 3 ft. high alongside, Cor. No. 3, Sur. No. 2871, Hidden Treasure lode brs. N. $52^{\circ}-52'E.$ , 37.95 ft.
	<p>No other bearings available.</p> <p>Thence S. <math>79^{\circ}W</math>. Va. <math>13^{\circ}-30'E.</math></p>
420.38	Intersect line 2-3, Sur. No. 2871, Hidden Treasure lode, at N. $76^{\circ}-53'-40"E.$ , 300.4 ft. from Cor. No. 2,
713.95	Intersect line 1-2 and 3-4, Sur. No. 2871, Hidden Treasure and Imperial lodes, at N. $20^{\circ}E.$ , 12.87 ft. from Cor. Nos. 2-3,
728.0	To Cor. No. 4, a limestone 12 X 14 X 6 ins. above ground, set 12 ins. in the ground, chiseled with a cross (X) DE4-3499, with md. of stone $3\frac{1}{2}$ ft. base by 3 ft. high alongside, Cor. No. 2, Sur. No. 2871, Hidden Treasure lode, identical with Cor. No. 3, Imperial lode, same Sur., brs. S. $44^{\circ}-53'E.$ , 13.3 ft., a pine tree 12 ins. diam. brs. S. $44^{\circ}E.$ , 11.7 ft., a juniper tree 14 ins. diam. brs. S. $15^{\circ}-58'E.$ , 26.6 ft., both blazed and scribed 2-3-2871, 4-3499 B.T.
	<p>Thence S. <math>7^{\circ}-13'W</math>. Va. <math>13^{\circ}-30'E.</math></p>
7.83	Intersect line 2-3, Sur. No. 2871, Imperial lode, at N. $81^{\circ}W.$ , 10.5 ft from Cor. No. 3,

Feet	Survey No..3499 - continued. Daily Extension lode - con'd.
47.87	To W. end center, a pine post 4 ins.sq. by 4 ft. long, surrounded with md. of stone 3 1/2 ft. base by 3 ft. high, scribed W. Cr. D E,
347.87	To Cor. No. 5, identical with Cor. No. 3, Cave lode, of this Sur., a limestone boulder in place 12 X 18 X 0 ins. above ground, chiseled with a cross (X) DE5-C3-3499, with md. of stone 3 1/2 ft. base by 3 ft. high alongside, an oak 30 ins. diam. brs. S. 16° E., 8.5 ft.
	No other bearings are available.
	Thence S. 82°-16'E Va. 13°-30'E.
1438.9	To Cor. No. 1, the place of beginning.
	Cave Lode.
	Beginning at Cor. No. 1, identical with Cor. No. 2 Daily No. 3 lode, Cor. No. 2 Calumet lode, and Cor. No. 2 Wedge No. 3 lode, of this Sur., heretofore described, whence the N.W. Cor. Sec. 21., T 11 S., R. 16 E., brs. S. 76°-44'E., 3502.14 ft.
	Thence N. 7°-13' E. Va. 13°-30'E.
300.0	To E. end center, a pine post 4 ins. Sq by 4 ft long, set firmly in the ground, surrounded with a md. of stone 3 1/2 ft base by 3 ft. high, scribed E. Cr. C.
600.0	To Cor. No.2, identical with Cor. No.1 Daily Extension lode, on line 2-3 Daily No. 3 lode, both of this Sur., Cor. heretofore described.
	Thence N. 82°-16'W. Va. 13°-30'E.
1438.9	To Cor. No. 3, identical with Cor. No. 5, Daily Extension lode of this Sur., heretofore described.
	Thence S. 7°-13' W. Va. 13°-30' E.
300.0	To W. end center, a pine post 5 ins. in diameter, set firmly in the ground and surrounded with md of stone 3 1/2 ft. base by 3 ft high, scribed W. Cr. C.
600.0	To Cor. No.4, identical with Cor. No. 3 Wedge No.3 lode of this Sur.

	<p>Sur. No. 3499. Cave Lode, Cont'd</p> <p>A limestone 6 X 12 X 10 ins. above ground, set 12 ins. in the ground and chiseled with a cross (X) C 4, -W3-3499, with md. of stone 3 1/2 ft. base by 3 ft. high alongside.</p> <p>A spruce tree 10 ins. diam. brs. S. 50°W., 7 ft. Blazed and scribed 3-4- 3499 BT.</p> <p>The N.E. Cor. Epidote lode, Unsr., E.O. Stratton claimant, brs. N.79°-01' W., 277.0 ft.</p>
1438.9	<p>Thence S. 82°-16' E. Va. 13°-30' E.</p> <p>To Cor. No. 1, the place of beginning.</p> <p>Wedge No. 3 lode.</p> <p>Beginning at Cor. No. 1, identical with Cor. No. 1 Wedge No. 2 lode and on line 2-3 Calumet lode both of this Sur.</p> <p>A quartzite rock 8 X 8 X 12 ins. above ground, set 12 ins in the ground and chiseled with cross (X) W3,1-W2,1-3499, with md of stone 3 1/2 ft base by 3 ft high alongside, whence the N.W. Cor. Sec. 21, T.11 S., R. 16 E., brs. S. 86°-36' E., 3428.24 ft.</p> <p>No other bearings are available.</p>
300.0	<p>Thence N. 1°-18' E Va. 13°-30' E.</p> <p>To E. end center, a pine post 5 ins. diam. set firmly in the ground and surrounded with md of stone 3 1/2 ft base by 3 ft high, blazed and scribed E. Cr. W.3.</p>
600.0	<p>To Cor. NO.2, identical with Cor. No\$ 1-2-2, Cave, Daily No.3, and Calumet lodes respectively of this sur., heretofore described.</p>
1438.9	<p>Thence N. 82°-16' W. Va. 13°-30' E.</p> <p>To Cor. No.3, identical with Cor. No.4 Cave lode of this Sur., heretofore described.</p>
300.0	<p>Thence S. 1°-18' W. Va. 13°-30' E.</p> <p>To W. end center, a pine post 5 ins. diam. by 4 ft long set firmly in the ground, surrounded with md of stone 3 1/2 ft base by 3 ft. high Scribed W. Cr. W3.</p>
425.73	<p>Intersect east line Epidote lode Unsr., E.O. Stratton claimant, at S. 28°-44' E., 545.57 ft. from the N.E. Cor. and N. 28°-44' W., 1666.28 ft. from the S.E. Cor.</p>

Feet	Sur. No 3499 Wedge No. 3 lode-Cont'd.
600.0	<p>To Cor. No.4, identical with Cor. No. 4 Wedge No. 2 lode of this Sur. A limestone 10 X 12 X 6 ins. above ground, set 12 ins. in the ground and chiseled with cross (X) W3;4-W2,4-3499, with md. of stone 3 1/2 ft. base by 3 ft high alongside.</p> <p>A spruce tree 8 ins. diam brs. N. 65° E., 40 ft.</p> <p>No other bearings available.</p> <p>Thence S. 82°-16' E. Va. 13°-30' E.</p>
108.26	<p>Intersect E side line Epidote lode, Unsur. at N. 28°-44' W., 1450.94 ft. from the S.E. Cor.</p>
1438.9	<p>To Cor. No. 1, the place of beginning.</p> <p>WEDGE NO.2 Lode.</p> <p>Beginning at Cor. No.1, Identical with Cor. No.1 Wedge No.3 lode of this Sur., heretofore described, whence the N.W. Cor. Sec. 21, T11 S., R.16 E. brs. S. 86°-36' E., 3428.24 ft.</p> <p>Thence S. 1°-18' W. Va. 13°-30' E.</p>
300.0	<p>To east end center, a pine post 5 ins. diam. by 4 ft long, set firmly in the ground and surrounded with a md of stone 3 1/2 ft base by 3 ft. high, scribed E. Cr. W.2.</p>
600.0	<p>To Cor. No.2, Identical with Cor. No.1 Katherine lode of this Sur. A quartzite rock 6 X 6 X 8 ins above ground, set 12 ins in the ground, chiseled with cross (X) W2-K1-3499, with md. of stone 3 1/2 ft. base by 3 ft high alongside.</p> <p>No bearings are available.</p> <p>Thence N. 82°-16' W. Va. 13°-30' E.</p>
957.22	<p>Intersect east side line, Epidote lode, Unsur., at N. 28°-44' W., 709.56 ft. from the S.E. Cor., &amp; S. 28°-44' E. 1502.29 ft from the N.E. Cor</p>
1438.9	<p>To Cor. No.3, Identical with Cor. No.4 Katherine lode of this Sur. A limestone rock in place 18 X 24 X 18 ins. above ground, chiseled with cross (X) W2-3-K4-3499, with md of stone 3 1/2 ft base by 3 ft. high alongside.</p> <p>A cross (X) W2,3-K4-BR. chiseled on limestone ledge 10 ft long by 8 ft high brs. N.1°-18' E., 7 ft.</p> <p>No other bearings are available.</p> <p>Thence N.1°-18' E. Va. 13°-30' E.</p>
300.0	<p>To W. end center, a pine post 4 ins. diam. by 4 ft long surrounded with md. of stone 3 1/2 ft base by 3 ft high, scribed W. Cr. W.2</p>

Sur. No. 3499  
WEDGE No 2 Lode- Cont'd.

- 600.0 To Cor. No.4, identical with Cor. No.4, Wedge No.3 lode of this Sur. heretofore described.
- Thence S.  $82^{\circ}-16'E$ .  
Va.  $13^{\circ}-30'E$ .
- 108.26 Intersect East line Epidote lode, Unsur. at S.  $28^{\circ}-44'E$ . 760.91 ft. from N.E. Cor.
- 1438.9 To Cor. No.1, the place of beginning.
- KATHERINE Lode.
- Beginning at Cor. No.1, identical with Cor. No.2 Wedge No.2 lode of this Sur., heretofore described, whence the N.W. Cor. Sec 21, T.11 S., R. 16 E. brs. N.  $83^{\circ}-25'E$ ., 3458.7 ft.
- Thence S.  $1^{\circ}-18'W$ .  
Va.  $13^{\circ}-30'E$ .
- 194.0 To E. end center, a pine post 4 ins diam., 4 ft. long, surrounded with md. of stone  $3\frac{1}{2}$  ft base by 3 ft high/ Scribed E. Cr. K.
- 300.0 To Cor No.3 Calumet lode of this Sur. heretofore described.
- 494.0 To Cor No.2.  
A limestone 8 X 12 X 10 ins. above ground, set 12 ins in the ground and chiseled with a cross (X) K2-3499 with md. of stone  $3\frac{1}{2}$  ft Base by 3 ft. high alongside.  
No bearings are available.
- Thence N.  $82^{\circ}-16'W$ .  
Va.  $13^{\circ}-30'E$ .
- 649.78 Intersect east side line Epidote lode, Unsur., at N.  $28^{\circ}-44'W$ . 99.16 ft. from the S.E. Cor.
- 1438.9 To Cor. No.3  
A quartzite rock 6 X 8 X 12 ins. above ground, set 12 ins in the ground and chiseled with a cross (X) K3-3499 with md. of stone  $3\frac{1}{2}$  ft. base by 3 ft high alongside.  
No bearings are available.
- Thence N.  $1^{\circ}-18'E$ .  
Va.  $13^{\circ}-30'E$ .
- 300.0 To W. end center, a pine post 4 ins. diam. by 4 ft long, surrounded with md. of stone  $3\frac{1}{2}$  ft base by 3 ft high. Scribed W. Cr. K.
- 494.0 To Cor. No. 4, identical with Cor. No.3, Wedge No. 2 lode of this Sur. heretofore described.
- Thence S.  $82^{\circ}-16'E$ .  
Va.  $13^{\circ}-30'E$ .
- 481.68 Intersect east line Epidote lode, Unsur. at N.  $28^{\circ}-44'W$ . 709.56 ft from S.E. Cor.
- 1438.9 To Cor. No. 1, the place of beginning.

Sur. No. 3499

Lode Lines.

As near as can be determined from the present developments the veins of the several locations embraced in this claim extend as follows from their respective discovery points:

- Daily No.3 Lode, 120 ft.N.10°-15'E., and 1380 ft.S.10°-15'W.
- Daily No.5 Lode, 270 ft.N.10°-15'E., and 1230 ft.S.10°-15'W.
- Sphinx Lode, 600 ft.N.10°-15'E., and 900 ft.S.10°-15'W.
- Roskruge Lode, 750 ft.N.10°-15'E., and 750 ft.S.10°-15'W.
- Calumet Lode, 700 ft.S.1°-18'W., and 800 ft. N. 1°-18'E.
- Edith Lode, 225 ft.N.58°-01'W., and 1186.06 ft.S.58°-01'E.
- Daily Extension Lode, 170 ft. S. 82°-16'E., and 1268.9 ft. N.82°-16'W.
- Cave Lode, 350 ft.S.82°-16'E., and 1088.9 ft,N.82°-16'W
- Wedge No. 3 Lode,590 ft.N.82°-16'W., and 848.9 ft.S.82°-16'E
- Wedge No.2 Lode,300 ft.S.82°-16'E.,and 1138.9 ft.N.82°-16'W.
- Katherine Lode, 600 ft.S.82°-16'E.,and 838.9 ft.N.82°-16'W.

AREAS.

	Acres.
Total area, Daily No. 3 Lode -----	17.275
Area in conflict with -	
Sur. No. 3017 Eagle No,2 lode ---	0.833
Total area, Daily No. 5 lode -----	20.472
Area in conflict with -	
Sur. No.3017 Eagle No.2 lode -----	0.551
Total area, Sphinx lode -----	20.472
Area in conflict with -	
Sur. No.3017 Eagle No.2 lode -----	0.065
Total Area, Roskruge lode,-----	20.472
Area in conflict with -	
Sur. No.3056 Major McKinley lode -	1.132
Total area, Calumet lode,-----	20.661
Total Area, Edith lode, -----	19.436
Area in conflict with -	
Sur. No. 3056 Major McKinley lode--	2.523.
Sur. No. 3056 Marble Peak lode----	1.694
Sur. No. 3056 Wedge lode, -----	0.632
Sur. No. 3461 Oversight lode,	0.360



Sur. No. 3499 - continued  
Area - con'd.

	Acres
Total area, Daily Extension lode -----	16.884
Area in conflict with -	
Sur. No. 2871 Hidden Treasure Lode --	0.037
Sur. No. 2871 Imperial lode -----	0.003
Total area, Cave lode, -----	19.819
Total area, Wedge No. 3 lode -----	19.695
Area in conflict with -	
Epidote lode, Uns. -----	0.215
Total area, Wedge No. 2 lode -----	19.695
Area in conflict with -	
Epidote lode, Uns. -----	4.037
Total area, Katherine lode -----	16.215
Area in conflict with -	
Epidote lode, Uns. -----	7.160

The survey of each lode of this location is identical with the respective amended location as staked upon the ground.

LOCATION.

This survey is located in Secs. 17-20, unsurveyed, T. 11 S., R. 16 E., G & S.R. B.M., within the Coronado Nat'l forest.

EXPENDITURE OF FIVE HUNDRED DOLLARS.

I certify that the value of the labor and the improvements made upon, or for the benefit of each of the locations embraced in said mining claim by the claimant, or its grantors, is not less than five hundred dollars, and that said improvements consist of

Daily No. 3 Lode

No. 1. - The discovery cut of the Daily No. 3 lode, the face of which being the discovery point, is on the lode line, 120 ft. from a point on line 4-5, 300 ft. from Cor. No. 5 - 5 ft. wide, 10 ft. face, running S. 10° W., 12 ft. to mouth.

Value \$100.00

No. 2. - A cut, the mouth of which brs. from Cor. No. 5,

Sur. No. 3499 continued.  
Expenditure of Five Hundred Dollars - Cont'd.

S. 63°-30'W., 275 ft., 5 ft. wide, 10 ft. face,  
running N 5 W., 12.0 ft.-----Value \$100.0

No. 3 cut, the face of which brs. from Cor. No.1, N.1°-45'W., 345 ft.  
5 ft. wide, 6 ft. face, running N. 10 ft. to mouth? from face is  
a tunnel 4 by 6 ft. running S. 5 ft. to face.

Value of cut and tunnel \$125.0

An undivided 1/12 interest in tunnel No. 7, Sur.

No. 3500, Copper Princess lode, credited to this lode.

\$500.00

Daily No. 5 Lode.

No. 1. The discovery cut of the Daily No. 5 lode, the  
face of which is the discovery point, is on the lode  
line 270 ft. from the center of line 3-4, 5 ft. wide,  
18 ft. face, running east 24 ft.; at the face is a  
tunnel 5 X 6 ft., running west 7 ft.

Value of cut and tunnel \$170.00

No. 2. A cut, the mouth of which brs. from Cor. No.4  
S. 71°-30'W, 210 ft., 7 ft. wide, 12 ft. face, running  
S. 71°W. 16 ft.

Value \$100.00

An undivided 1/12 interest in tunnel No. 7, Sur.

No. 3500, Copper Princess lode, credited to this lode.

\$500.00

Sphinx Lode.

No. 1. The discovery cut of the Sphinx lode, the  
face of which being the discovery point, is on the  
lode line 600 ft. from the center of line 3-4, 5 ft.  
wide, 8 ft. face, running S. 10°W. 12 ft.

Value \$ 80.00

An undivided 1/12 interest in tunnel No. 7, Sur.

No. 3500, Copper Princess lode, credited to this lode.

\$500.00

Roskruge Lode.

No. 1. The discovery cut of the Roskruge lode, the face  
of which being the discovery point, is on the lode  
line 750 ft. from the center of line 3-4, 8 ft. wide,  
8 ft. face, running N. 45°E. 12 ft. to mouth. From  
face is a tunnel running S. 45°W. 11 ft. to face.

Value of cut and tunnel \$110.00

Sur. No. 3499 - continued.

Expenditure of Five Hundred Dollars - cont'd.

No. 2. A shaft; the center of which brs. from Cor.

No. 4, S. 19°-30'W. 490 ft., 4 X 6 ft., 40 ft. deep.

Value \$400.00

No. 3. A cut, the face of which brs. from Cor. No. 4  
S. 13°-45'W. 460 ft., 4 ft. wide, 6 ft. face, running  
South 8 ft.

Value \$ 50.00

An undivided 1/12 interest in tunnel No. 7, Sur. No.  
3500, Copper Princess lode, credited to this lode.

\$ 500.00

Calumet Lode.

No. 1. The discovery cut of the Calumet lode, the  
the mouth of which being the discovery point, is on  
the lode line 700 ft. from the center of line 3-4,  
5 ft. wide, 9 ft. face, running N. 50° W. 10 ft. to  
face.

Value \$100.00

An undivided 1/12 interest in tunnel No. 7, Sur.  
No. 3500, Copper Princess lode, credited to this lode.

\$500.00

Edith Lode.

No. 1. The discovery cut of the Edith lode, the face  
of which being the discovery point, is on the lode  
line 225 ft. from the center of line 3-4, 5 ft. wide,  
8 ft. face, running South 12 ft. to mouth.

Value \$100.00

An undivided 1/12 interest in tunnel No. 7, Sur.  
No. 3500, Copper Princess lode, credited to this lode.

\$500.00

Daily Extension Lode.

No. 1. The discovery cut of the Daily Extension lode,  
the mouth of which is on the lode line 1-2, 170 ft  
from a point on line 1-2, 300 ft  
from Cor. No. 1, 4.5 ft. wide, 10 ft. face, running  
S. 65° W. 11 ft. to face.

Value \$100.00

Sur. No. 3499 - continued.  
Expenditure of Five Hundred Dollars, Cont'd.  
Daily Extension Lode, - cont'd.

An undivided 1/12 interest in tunnel No. 7, Sur. No. 3500, Copper Princess lode, credited to this lode.  
\$500.00

Cave Lode.

No. 1: The discovery cut of the Cave lode, the face of which being the discovery point, is on the lode line 350 ft. from the center of line 1-2, running N. 60° E., 12 ft. to mouth.

Value \$100.00

An undivided 1/12 interest in tunnel No. 7, Sur. No. 3500, Copper Princess lode, credited to this lode.  
\$500.00

Wedge No. 3 Lode.

No. 1. The discovery cut of the Wedge No. 3 lode, the face of which being the discovery point, is on the lode line 590 ft. from the center of line 3-4, 4 ft. wide, 10 ft. face, running west 10 ft. to mouth.

Value \$100.00

An undivided 1/12 interest in tunnel No. 7, Sur. No. 3500, Copper Princess lode, credited to this lode.  
\$500.00

Wedge No. 2 Lode.

No. 1. The discovery cut of the Wedge No. 2 lode, the face of which being the discovery point, is on the lode line 300 ft. from the center of line 1-2 6 ft. wide, 12 ft. face, running N. 50° E. 18 ft. to mouth.

Value \$100.00

No. 2. A cut, the mouth of which is on the lode line 210 ft. from the center of line 3-4, 6 ft. wide, 10 ft face, running N. 10° W., 21 ft. to face.

Value. \$100.00

An undivided 1/12 interest in tunnel No. 7, Sur. No. 3500, Copper Princess lode, credited to this lode.  
\$500.00

Sur. No. 3499 - continued.  
Expenditure of Five Hundred Dollars, cont(d).

Katherine Lode.

No. 1. The discovery cut of the Katherine lode, the face of which being the discovery point, is on the lode line 600 ft. from a point on line 1-2, 300 ft. from Cor. No. 2, 4.5 ft. wide, 10 ft. face, running N. 82°W. 10 ft. to mouth.

Value \$100.00

No. 2. A cut, the mouth of which is on the lode line 10 ft. from a point on line 1-2, 300 ft. from Cor. No. 2, 5 ft. wide, 9 ft. deep, running N. 80°W. 10 ft. to face.

Value \$100.00

An undivided 1/12 interest in tunnel No. 7, Sur. No. 3500, Copper Princess lode, credited to this lode.

\$500.00

INSTRUMENT.

This survey was made with a Gurley mountain transit; courses were deflected from the true meridian as determined by direct solar observations, The distances were measured with a 500 ft. steel tape.

ADJOINING CLAIMS.

This Group is bounded on the north by the Hidden Treasure lode, Sur. No. 2871, claimant unknown, The Oversight lode, Uns. E.O. Stratton claimant, Eagle No. 2 and Golden Peak No. 2 lodes both of Sur. No. 3017, Copper Queen Consolidated Mining Co. Claimant.

On the east by Chalcopyrite lode, Uns. E.O. Stratton, Claimant.

On the south by Major Mc Kinley, Marble Peak and Wedge lodes all of Sur. No. 3056, Copper Queen Consolidated Mining Co. claimant. The Oversight lode, Uns., <sup>Sur. No. 3461</sup> claimant unknown, The Embersite and Epidote lodes Uns., E.O. Stratton, Claimant.

On the west by Epidote lode, Uns., and Imperial lode, Sur. No. 2871.

Sur. No. 3499  
REPORT.

The lode line of each location of this claim was run directly upon the ground, and the corners were established by running around the claim. All tie lines were run directly upon the ground.

The N.W. Cor. Sec. 21, T.11 S., R.16 E., G. & S.R. BM is a porphyry stone 10 X 10 X 6 ins. above ground, chiseled with four notches on the E. face, and three notches on the S. face,

Near it are two witness trees blazed and scribed. This is the nearest corner of the public survey.

Sur. No. 3017, Golden Peak No.2 and Eagle No.2 lodes. All the corners are pine posts properly set and scribed with the number of the corner and the survey. Line 1-2 Golden Peak No.2 lode fails to furnish the length as approved, and line 2-3 Eagle No.2 lode fails to furnish the course and distance as approved. The same are properly given in these field notes.

(N.58°-01'W., 1371.9ft)  
(N.62°-05'W., 1475.5ft)

Sur. No. 3056, Major Mc Kinley, Marble Peak and Wedge lodes. All the corners are pine posts properly set and scribed with the number of the corner and the Sur. I find the courses and distances to be correct as approved, except line 4-1 Major Mc Kinley lode which fails to furnish the length and the same is properly given in these field notes.

(N.52°-29'E., 787.6ft.)

Sur. No. 2871 Hidden Treasure and Imperial lodes. (E.C. Dietrich)  
Cor. No.3 Imperial lode and Cor. NO.2, 3 Hidden Treasure lode are stones set firmly in the ground, and chiseled with the number of the corners and the Sur., corners No.4, and 5 Hidden Treasure lode are pine posts set firmly in the ground and scribed with the number of the corner and the survey. Cor. No.1 Hidden Treasure lode and Cor. No.4 Imperial lode, is an oak post 4 ins. diam. properly set and scribed with the number of the Corners and the Sur. Lines 2-3, and 3-4 Hidden Treasure lode fail to furnish the courses and distances as approved, and line 4-5 fails to furnish the length as approved. The above are properly given in these field notes.

(N.79°E., 750.ft)(S.78E.750ft)  
(N.20°E., 600)

The N.E. and S.E. Cors. of Epidote lode are monuments of stone.

Sur. No. 3461, Oversight lode. I find all corners properly set and scribed with the number of the corner and survey.

Sur. No. 3499.  
REPORT Cont'd

Direct Solar observation taken Monday April 29, 1918 at 1.51 P.M.

Solar time, Sun bisected. Lat. 32-28' Lon. 110-44'

Dif. in time 9hr.-15' → Apparent Dec'l 14-17'-37"  
7-14"  
Declination--- 14-10'-23"

$$\sin 1/2 A = \sqrt{\frac{\sin (S-L) (S-H)}{\cos L \cos H}}$$

$$P \ 90^\circ - \text{Dec'l} = 90^\circ$$
$$\frac{14^\circ - 10' - 23''}{75^\circ - 49' - 37''} = P$$

L=32-28'  
H=58-04' = Ver. Ang. diminished by refraction.  
P=75-50'  
2 ) 166-22'  
S 83-11'

S-L=50-43' 9.8887547  
S-H=25-07' 9.6278397  
0.0738099  
0.2766000  
2) 19.8670043  
9.9335021 = 59-06' = 1/2 A.  
118-12' = A

180-  
118-12'  
S. 61-48' W. = Course of sun.  
119-30' = Ang. to right from sun.  
181-18'  
180-  
N. 1-18' E. = Course of line 3-4 Wedge No.2 lode.

Set up at Cor. No.3 Wedge No.2 lode- F.S. Cor. No.4 Wedge No.2

T.A.

# FINAL OATHS FOR SURVEYS.

## LIST OF NAMES.

A list of the names of the individuals employed by T.N.Stevens

United States Mineral Surveyor, to assist in running, measuring, and marking the lines, corners, and boundaries described in the foregoing field notes of the survey of the mining claim of

~~Daily-Arizona Consolidated Copper Company~~

known as the Daily No3, Daily No 5, Sphinx, Roskruge, Calumet, Edith, Daily Extension, Cave, Wedge No 3, Wedge No 2, Katherine Lodes and showing the respective capacities in which they acted.

W.H.Coplen, Chainman.

Chainman.

Axman.

Flagman.

## FINAL OATHS OF ASSISTANTS.

~~We~~ I, W.H.Coplen

and \_\_\_\_\_, do solemnly swear that ~~we~~ assisted

T.N.Stevens, United States Mineral Surveyor, in marking the corners and surveying the boundaries of the mining claim of

~~Daily-Arizona Consolidated Copper Company~~

known as the Daily No3, Daily No 5, Sphinx, Roskruge, Calumet, Edith, Daily Extension, Cave, Wedge No 3 Wedge No 2, Katherine Lodes represented in the foregoing field notes as having been surveyed by said mineral surveyor and under his

direction; and that said survey has been in all respects, to the best of our knowledge and belief, faithfully and correctly executed, and the corner and boundary monuments established according to law and the instructions furnished by the United States Surveyor-General for Arizona

W.H.Coplen, Chainman.

Chainman.

Axman.

Flagman

Subscribed and sworn to by the above-named persons before me this 21<sup>st</sup>

day of May, 1918

*My Commission Expires February 19, 1920*

Geo. P. Meyers  
Notary Public



# FINAL OATH OF U. S. MINERAL SURVEYOR.

I, T. N. Stevens, U. S. Mineral Surveyor, do solemnly swear that, in pursuance of instructions received from the United States Surveyor General for Arizona, dated April 12, 1918, I have, in strict conformity to the laws of the United States, the official regulations and instructions thereunder, and the instructions of said Surveyor General, faithfully and correctly executed the survey of the Mining Claim of Daily Arizona Consolidated Copper Company, known as the Daily No.3, Daily No.5, Sphinx, Roskrige, Calumet, Edith, Daily Extension, Cave, Wedge No. 3, Wedge No.2 and Katherine lodes situate in Old Hat Mining District, Pima County, Arizona, in Section 16-17-Unsur., Township No. 11 S, Range No. 16 E., G & S.R.B.M., and designated as Survey No. 3499, as represented in the foregoing field notes, which accurately show the boundaries of said mining claim as distinctly marked by monuments on the ground, and described in the attached copy of the location certificate, which was received by me from the Surveyor General with said instructions, and that all the corners of said survey have been established and perpetuated in strict accordance with the law, official regulations and instructions thereunder; and I do further solemnly swear that the foregoing are the true and original field notes of said survey and my report therein, and that the labor expended and improvements made upon said mining claim by claimant or ~~their~~ its grantors are as therein fully stated, and that the character, extent, location, and itemized value thereof are specified therein with particularity and full detail, and that no portion of said labor or improvements so credited to this claim has been included in the estimate of expenditures upon any other claim.

T. N. Stevens  
U. S. Mineral Surveyor.

Subscribed and sworn to by the said

U. S. Mineral Surveyor, before me

T. N. Stevens  
Geo. P. Myers, a Notary  
Public in Pima County Arizona this 11<sup>th</sup>  
day of June, 1918

My Commission Expires }  
February 19, 1920 }

Geo. P. Myers  
Notary Public

STATE OF ARIZONA, }  
COUNTY OF PIMA. } ss.

I, ----- R. B. Vinson, -----, County Recorder in and for the  
County of Pima, State of Arizona, do hereby certify that the above and foregoing is a full, true and correct copy  
of the Second Amended Location Notice of the Daily No. 3 Mining  
Claim situated in the Old Hat District, and now owned by the Daily-  
Arizona Consolidated Conner Company, dated Nov. 26th, 1917, -----  
as appears of record now in my office in Book B.B.B. Record of Mines Pages 368 -----

IN WITNESS WHEREOF, I have hereunto set my hand  
and affixed my official seal, at my office in Tucson,  
this eighth ----- day of  
January -----, A. D. 1917  
-----  
County Recorder of Pima County, Arizona.

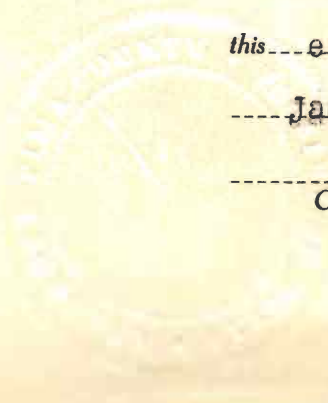

SECOND AMENDED  
Notice of Mining Location  
LODE CLAIM

TO ALL WHOM IT MAY CONCERN:

This Mining Claim, the name of which is the DAILY NO 3 Mining Claim, situate on lands belonging to the United States of America, and in which there are valuable mineral deposits, was entered upon and located for the purpose of exploration and purchase by W. H. DAILY, a citizen of the United States, grantor

(Locator must insert either "a citizen of the United States," or "who has declared his intention to become a citizen of the United States.")

the undersigned, on the 3rd day of January, 1907.

The length of the claim is 1500 feet, and we claim 120 feet, in a N 10°-15' E direction and 1380 feet in a S 10°-15' W direction from the center of the discovery shaft, at which this notice was posted, lengthwise of the claim, together with 300 feet in width of surface grounds, on each side of the center of said claim. The general course of the lode deposit and premises is from the N 10°-15' E to the S 10°-15' W.

The Claim is situated and located in the Old Hat Mining District, in Pima County in the State of Arizona, about one mile direction from S E Cor of claim the N W cor of Sec 21, T 11 S, R 16 E, bears S 79°-30' E, 3024.57 Ft.

The surface boundaries of the claim are marked upon the ground as follows: Beginning at a monument of stone

at a point in a N 10°-15' E direction 120 feet from the discovery shaft (at which this notice is posted), being in the center of the North end line of said claim; thence N 58°-01' W 178.79 feet to a monument being the Northwest corner of said claim; thence S 19°-10' W to a monument at a point on the West side line; thence S 7°-13' W 1129.3 feet to a monument, being at the Southwest corner of said claim; thence S 58°-01' E 188.73 feet to a monument at the center of the South end of said claim; thence S 58°-01' E, 320 feet to a monument being at the Southeast corner of said claim; thence N 10°-15' E, 1500 feet to a monument at the Northeast corner of said claim; thence N 58°-01' W, 320 feet to the place of beginning.

All done under the provisions of Chapter Six, of Title XXXII, of the Revised Statutes of the United States, and of an Act of the General Assembly of Arizona, entitled "An Act to Revise and Codify the Laws of the Territory of Arizona," approved March 16, 1901.

This is Second an Amended Location Notice of the DAILY NO 3 Mining Claim, located by W. H. Daily, grantor of the undersigned owner on the 3rd day of January, 1907, and recorded in Book MM of Records of Mines, at page 5, in the office of the County Recorder of the aforesaid County of Pima to which reference is hereby made, and this amended Location Notice is made and posted to correct errors in the description in the said original Location Notice.

Dated and posted on the ground this 26th day of Jan, 1917

DAILY-ARIZONA CONSOLIDATED COPPER COMPANY  
(Present owner)

By P Hancock  
Its Attorney in Fact.

STATE OF ARIZONA,

County of .....

ss.

I ....., County Recorder in and for the County and State aforesaid, do hereby certify that the within instrument was filed for record at ..... o'clock ..... M., on this ..... day of ..... 19 ....., and duly recorded in book No. .... of ..... Records of ..... County, Arizona, at pages .....

WITNESS my hand and official seal the year first above written.

Country Recorder.

AMENDED  
Notice of Location  
LODE CLAIM

Dated ....., 19 .....

Filed and Recorded at request of

*R. W. Paquet*

at *Due 11-30* A. D. 19*14* -  
M.,

Book *R. B. B. Record of Mineral*

Pages *268*

By *R. B. Finson*  
County Recorder.  
*P. M. Hubbell*  
Deputy Recorder.

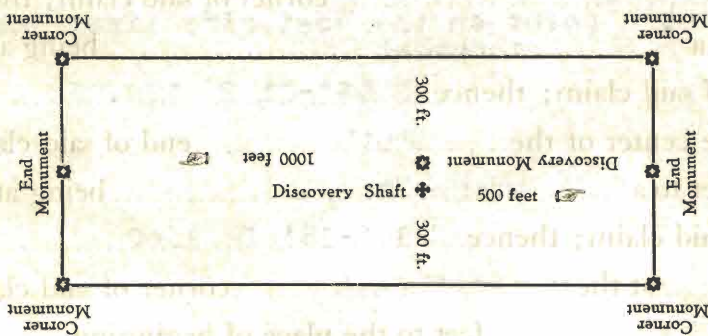

This Diagram is to give locator a general idea of plan of location under the new law. The Discovery Shaft can be in the center of the claim or any distance from either end desired. In the diagram it is placed 500 feet from one end and 1000 ft. from the other. Commence description of claim at a center end monument, giving its distance and direction from center of Discovery Shaft; thence bound the claim in either direction. In description be careful to state locality of claim with reference to some natural object, or permanent monument, as will identify the claim.

STATE OF ARIZONA, }  
COUNTY OF PIMA. } ss.

I, ----- R. B. Vinson -----, County Recorder in and for the

County of Pima, State of Arizona, do hereby certify that the above and foregoing is a full, true and correct copy  
of the Second Amended Location Notice of the Daily No. 5 Mining  
Claim situated in the Old Hat Mining District, and now owned by  
Daily-Arizona Consolidated Copper Company, dated Nov. 26th, 1917  
as appears of record now in my office in Book B.B.B. Record of Mines Pages 369 -----

IN WITNESS WHEREOF, I have hereunto set my hand

and affixed my official seal, at my office in Tucson,

this Eighth ----- day of

January -----, A. D. 1917.

  
-----  
County Recorder of Pima County, Arizona.

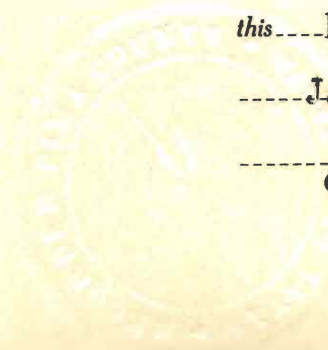

30

SECOND AMENDED  
**Notice of Mining Location**  
**LODE CLAIM**

TO ALL WHOM IT MAY CONCERN:

This Mining Claim, the name of which is the **DAILY NO. 5** Mining Claim, situate on lands belonging to the United States of America, and in which there are valuable mineral deposits, was entered upon and located for the purpose of exploration and purchase by **WM. H. DAILY, a citizen of the United States,** grantor of

(Locator must insert either "a citizen of the United States." or "who has declared his intention to become a citizen of the United States.")  
the undersigned, on the **fourth** day of **January**, 1907

The length of the claim is **1500** feet, and **we** claim **270** feet, in a **N. 10°-15' E** direction and **1230** feet in a **S. 10°-15' W** direction from the center of the discovery shaft, at which this notice was posted, lengthwise of the claim, together with **300** feet in width of surface grounds, on each side of the center of said claim. The general course of the lode deposit and premises is from the **N. 10°-15' E** to the **S. 10°-15' W**

The Claim is situated and located in the **OLD HAT** Mining District, in **PIMA** County in the State of Arizona, about **1/4** **mi** **SE** from **S E Cor Claim the N W Cor Sec 21, T 11 S, R 16 E, bears S 85°-25' E, 2442.06 ft.**

The surface boundaries of the claim are marked upon the ground as follows: Beginning at **a monument of stone**

at a point in a **N. 10°-15' E** direction **270** feet from the discovery shaft (at which this notice is posted), being in the center of the **North** end line of said claim; thence **N 58°-01' W, 320** feet to a **monument**, being the **N W** corner of said claim; thence **S 10°-15' W, 1500** feet to a **monument**, being at the **S W** corner of said claim; thence **S 58°-01' E, 320** feet to a **monument** at the center of the **South** end of said claim; thence **S 58°-01' E, 320** feet to a **monument** being at the **S E** corner of said claim; thence **N 10°-15' E, 1500** feet to a **monument** at the **N E** corner of said claim; thence **N 58°-01' W, 320** feet to the place of beginning.

All done under the provisions of Chapter Six, of Title XXXII, of the Revised Statutes of the United States, and of an Act of the General Assembly of Arizona, entitled "An Act to Revise and Codify the Laws of the Territory of Arizona," approved March 16, 1901.

This is **a second** Amended Location Notice of the **DAILY NO. 5** Mining Claim, located by **WM. H. DAILY, grantor of the undersigned owner** on the **fourth** day of **January**, 1907, and recorded in Book **M M** of Records of Mines, at page **7**, in the office of the County Recorder of the aforesaid County of **Pima**, to which reference is hereby made, and this amended Location Notice is made and posted to correct errors in the description in the said original Location Notice.

Dated and posted on the ground this **26th** day of **Nov**, 19**17**

**DAILY-ARIZONA CONSOLIDATED COPPER COMPANY,**  
(Present owner)

By **J. Hancock**  
Its Attorney in Fact.

STATE OF ARIZONA,

County of \_\_\_\_\_

ss.

I \_\_\_\_\_, County Recorder in and for the County and State aforesaid, do hereby certify that the within instrument was filed for record at \_\_\_\_\_ o'clock M., on this \_\_\_\_\_ day of \_\_\_\_\_, 19\_\_\_\_, and duly recorded in book No. \_\_\_\_\_ of \_\_\_\_\_ Records of \_\_\_\_\_ County, Arizona, at pages \_\_\_\_\_.

WITNESS my hand and official seal the year first above written.

Country Recorder.

**AMENDED**  
**Notice of Location**  
**LODE CLAIM**

Dated \_\_\_\_\_, 19\_\_\_\_

Filed and Recorded at request of

*P. W. Langworthy*

*Dw. 14* A. D. 19*17*  
at *11-30* a. M.,

Book *P. B. B. Book of Mines*

Pages *369*

By *P. B. B. B. B.*  
County Recorder.

*J. M. Thibault*  
Deputy Recorder.

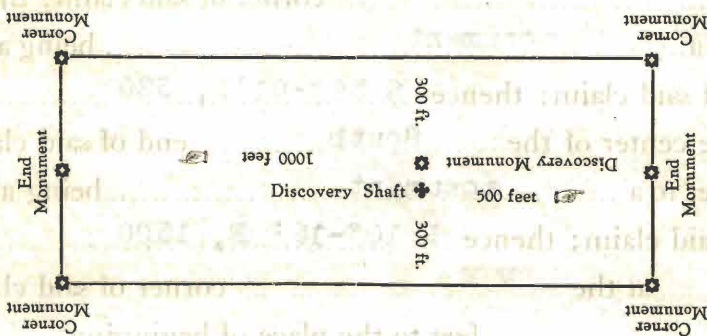

This Diagram is to give locator a general idea of plan of location under the new law. The Discovery Shaft can be in the center of the claim or any distance from either end desired. In the diagram it is placed 500 feet from one end and 1000 ft. from the other.

Commence description of claim at a center end monument, giving its distance and direction from center of Discovery Shaft; thence bound the claim in either direction. In description be careful to state locality of claim with reference to some natural object, or permanent monument, as will identify the claim.

STATE OF ARIZONA, }  
COUNTY OF PIMA. } ss.

I, R. B. Vinson \_\_\_\_\_, County Recorder in and for the  
County of Pima, State of Arizona, do hereby certify that the above and foregoing is a full, true and correct copy  
of Amended Location Notice of Sphinx Mining Claim situated in the  
Old Hat Mining District, and now owned by Daily-Arizona Consolidated  
Copper Company, dated Nov. 26th, 1917  
as appears of record now in my office in Book B.B.B. Record of Mines Pages 370

IN WITNESS WHEREOF, I have hereunto set my hand  
and affixed my official seal, at my office in Tucson,  
this Eighth \_\_\_\_\_ day of  
January \_\_\_\_\_, A. D. 1917



R. B. Vinson  
County Recorder of Pima County, Arizona.



AMENDED

# Notice of Mining Location

## LODE CLAIM

TO ALL WHOM IT MAY CONCERN:

This Mining Claim, the name of which is the SPHINX Mining Claim, situate on lands belonging to the United States of America, and in which there are valuable mineral deposits, was entered upon and located for the purpose of exploration and purchase by J. W. DAILY, a citizen of United States, grantor of

(Locator must insert either "a citizen of the United States." or "who has declared his intention to become a citizen of the United States.")

the undersigned, on the 5th day of October, 1911

The length of the claim is 1500 feet, and we claim 600 feet, in a N 10°-15' E direction and 900 feet in a S 10°-15' W direction from the center of the discovery shaft, at which this notice was posted, lengthwise of the claim, together with 300 feet in width of surface grounds, on each side of the center of said claim. The general course of the lode deposit and premises is from the N 10°-15' E to the S 10°-15' W

The Claim is situated and located in the Old Hat Mining District, in Pima County in the State of Arizona, ~~about~~ ~~xxxx~~ ~~direction~~ from S E Cor Claim the N W Cor Sec 21, T 11 S, R 16 E, bears N 85°-39' E, 1896.82 Ft.

The surface boundaries of the claim are marked upon the ground as follows: Beginning at a monument of stone

at a point in a N 10°-15' E direction 600 feet from the discovery shaft (at which this notice is posted), being in the center of the North end line of said claim; thence N 58°-01' W, 320 feet to a monument of stone, being the N W corner of said claim; thence S 10°-15' W, 1500 feet to a monument, being at the S W corner of said claim; thence S 58°-01' E, 320 feet to a monument at the center of the South end of said claim; thence S 58°-01', 320 feet to a monument being at the S E corner of said claim; thence N 10°-15' E, 1500 feet to a monument at the N E corner of said claim; thence N 58°-01 W, 320 feet to the place of beginning.

All done under the provisions of Chapter Six, of Title XXXII, of the Revised Statutes of the United States, and of an Act of the General Assembly of Arizona, entitled "An Act to Revise and Codify the Laws of the Territory of Arizona," approved March 16, 1901.

This is an Amended Location Notice of the SPHINX Mining Claim, located by J. W. Daily, grantor of the undersigned owner on the 5th day of October, 1911, and recorded in Book S S of Records of Mines, at page 2, in the office of the County Recorder of the aforesaid County of Pima to which reference is hereby made, and this amended Location Notice is made and posted to correct errors in the description in the said original Location Notice

Dated and posted on the ground this 6th day of Nov, 1911

**DAILY-ARIZONA CONSOLIDATED COPPER COMPANY**  
(Present owner)

By

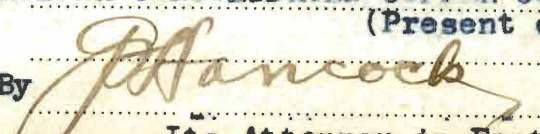

Its Attorney in Fact.

STATE OF ARIZONA,

County of .....

ss.

I ....., County Recorder in and for the County and State aforesaid, do hereby certify that the within instrument was filed for record at ..... o'clock ..... M., on this ..... day of ..... 19....., and duly recorded in book No. .... of ..... Records of ..... County, Arizona, at pages .....

WITNESS my hand and official seal the year first above written.

Country Recorder.

AMENDED

Notice of Location

LODE CLAIM

Dated ..... , 19.....

Filed and Recorded at request of

*R. W. Langworthy*

*Dec. 14 A. D. 1917*

at ..... P. M.,

Book *P. B. B. Record of Mines*

Pages *390*

*P. B. Pinnow*

County Recorder.

By *L. M. Shabel*

Deputy Recorder.

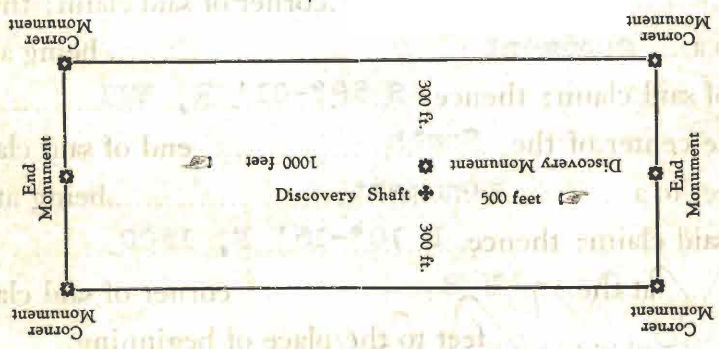

This Diagram is to give locator a general idea of plan of location under the new law. The Discovery Shaft can be in the center of the claim or any distance from either end desired. In the diagram it is placed 500 feet from one end and 1000 ft. from the other. Commence description of claim at a center end monument, giving its distance and direction from center of Discovery Shaft; thence bound the claim in either direction. In description be careful to state locality of claim with reference to some natural object, or permanent monument, as will identify the claim.

STATE OF ARIZONA, }  
COUNTY OF PIMA. } ss.

I, R. B. Vinson, County Recorder in and for the  
County of Pima, State of Arizona, do hereby certify that the above and foregoing is a full, true and correct copy  
of Amended Location Notice of the Roskrige Mining Claim situated  
in the Old Hat Mining District, and now owned by Daily-Consolidated  
Copper Company, dated Nov. 26th, 1917  
as appears of record now in my office in Book B.B.B. Record of Mines Pages 371

IN WITNESS WHEREOF, I have hereunto set my hand

and affixed my official seal, at my office in Tucson,

this Eight day of

January, A. D. 1917

R. B. Vinson  
County Recorder of Pima County, Arizona.

AMENDED

# Notice of Mining Location

## LODE CLAIM

36

TO ALL WHOM IT MAY CONCERN:

This Mining Claim, the name of which is the **ROSKRUGE** Mining Claim, situate on lands belonging to the United States of America, and in which there are valuable mineral deposits, was entered upon and located for the purpose of exploration and purchase by **GEO. F. KITT, a citizen of the United States,** grantor of

(Locator must insert either "a citizen of the United States." or "who has declared his intention to become a citizen of the United States.")

the undersigned, on the **eighth** day of **October**, 19 **10**

The length of the claim is **1500** feet,

and **we** claim **750** feet,

in a **N 10°-15' E** direction and **750**

feet in a **S 10°-15' W** direction from

the center of the discovery shaft, at which this notice was posted, lengthwise of the claim,

together with **300** feet in width of surface grounds, on each side

of the center of said claim. The general course of the lode deposit and premises is from the

**N 10°-15' E** to the **S 10°-15' W**

The Claim is situated and located in the **Old Hat** Mining District, in

**Pima** County in the State of Arizona, about

~~xxx~~ ~~distance~~ from **S E Cor Claim the N W Cor**

**of Sec 21, T 11 S, R 16 E, bears N 70°-18' E, 1432.41 Ft.**

The surface boundaries of the claim are marked upon the ground as follows: Beginning at **a monument of stone**

at a point in a **N 10°-15' E** direction **750** feet from

the discovery shaft (at which this notice is posted), being in the center of the **North**

end line of said claim; thence **N 58°-01' W, 320m** feet to a **monument**

**of stone**, being the **N W** corner of said claim; thence

**S 10°-15' W, 1500** feet to a **monument of stone**, being at the

**S W** corner of said claim; thence **S 58°-01' W, 320** feet

to a **monument** at the center of the **South** end of said claim;

thence **S 58°-01' W, 320** feet to a **monument of stone** being at the

**S E** corner of said claim; thence **N 10°-15' E, 1500** feet

to a **monument of stone** at the **N E** corner of said claim;

thence **N 58°-01' W, 320** feet to the place of beginning.

All done under the provisions of Chapter Six, of Title XXXII, of the Revised Statutes of the United States, and of an Act of the General Assembly of Arizona, entitled "An Act to Revise and Codify the Laws of the Territory of Arizona," approved March 16, 1901.

This is an Amended Location Notice of the **ROSKRUGE** Mining Claim, located by **GEO. F. KITT, grantor of the undersigned owner**

on the **8th** day of

**October**, 19 **10** and recorded in Book **99** of Records of Mines, at

page **361**, in the office of the County Recorder of the aforesaid County of **Pima**

to which reference is hereby made, and this amended Location Notice is made and posted to

correct errors in the description in the said original Location Notice.

Dated and posted on the ground this **26th** day of **Nov**, 19 **10**

**DAILY-ARIZONA CONSOLIDATED COPPER COMPANY**  
(Present Owner)

By *J Hancock*  
Its Attorney in Fact.

STATE OF ARIZONA,

County of .....

ss.

I ....., County Recorder in and for the County and State aforesaid, do hereby certify that the within instrument was filed for record at ..... o'clock ..... M., on this ..... day of ..... 19 ....., and duly recorded in book No. .... of ..... Records of ..... County, Arizona, at pages .....

WITNESS my hand and official seal the year first above written.

Country Recorder.

AMENDED

Notice of Location

LODE CLAIM

Dated ....., 19 .....

Filed and Recorded at request of

*R. W. Bergworthy*

at Dec. 14 A. D. 1917

at 11-30 A. M.,

Book B. B. B. Record of Mines

Pages 341

*R. B. Yarnall*

County Recorder.

*Wm. Hubbell*

Deputy Recorder.

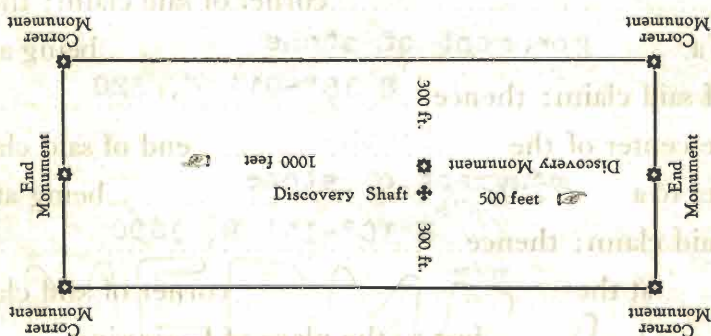

This Diagram is to give locator a general idea of plan of location under the new law. The Discovery Shaft can be in the center of the claim or any distance from either end desired. In the diagram it is placed 500 feet from one end and 1000 ft. from the other. Commence description of claim at a center end monument, giving its distance and direction from center of Discovery Shaft; thence bound the claim in either direction. In description be careful to state locality of claim with reference to some natural object, or permanent monument, as will identify the claim.

STATE OF ARIZONA, }  
COUNTY OF PIMA. } ss.

I, R.B.Vinson, *County Recorder in and for the*  
*County of Pima, State of Arizona, do hereby certify that the above and foregoing is a full, true and correct copy*  
*of Amended Location Notice of the Calumet Mining Claim, situated*  
*in the Old Hat Mining District, and now owned by Daily-Arizona*  
*Consolidated Copper Company, dated Nov. 26th, 1917.*

*as appears of record now in my office in Book* B.B.B. Record of Mines *Pages* 372

*IN WITNESS WHEREOF, I have hereunto set my hand*  
*and affixed my official seal, at my office in Tucson,*  
*this* Eighth *day of*  
January *, A. D. 191*7

*R.B. Vinson*  
*County Recorder of Pima County, Arizona.*

AMENDED

39

# Notice of Mining Location LODE CLAIM

TO ALL WHOM IT MAY CONCERN:

This Mining Claim, the name of which is the CALUMET Mining Claim, situate on lands belonging to the United States of America, and in which there are valuable mineral deposits, was entered upon and located for the purpose of exploration and purchase by J. W. DAILY, a Citizen of the United States, grantor of

(Locator must insert either "a citizen of the United States." or "who has declared his intention to become a citizen of the United States.")

the undersigned, on the 7th day of October, 19 11.

The length of the claim is 1500 feet, and 800 claim 800 feet,

in a N 1°-18' E direction and 700 feet in a S 1°-18' W direction from

the center of the discovery shaft, at which this notice was posted, lengthwise of the claim, together with 300 feet in width of surface grounds, on each side

of the center of said claim. The general course of the lode deposit and premises is from the N 1°-18' E to the S 1°-18' W

The Claim is situated and located in the Old Hat Mining District, in Pima County in the State of Arizona, about

xxx direction from N E Cor of Claim, the N W Cor of Sec 21, T 11 S, R 16 E, bears S 81°-14' E, 2850.09 Ft.

The surface boundaries of the claim are marked upon the ground as follows: Beginning at a monument of stone

at a point in a N 1°-18' E direction 800 feet from the discovery shaft (at which this notice is posted), being in the center of the North

end line of said claim; thence N 58°-10' W, 348.84 feet to a monument of stone, being the NE

corner of said claim; thence S 1°-18' W, 1500 feet to a monument of stone, being at the SW

corner of said claim; thence S 85°-10' E, 348.84 feet to a monument at the center of the South

end of said claim; thence S 85°-10' E, 348.84 feet to a monument of stone being at the SE

corner of said claim; thence N 1°-18' E, 1500 feet to a monument of stone at the NE

corner of said claim; thence N 58°10' E, 348.84 feet to the place of beginning.

All done under the provisions of Chapter Six, of Title XXXII, of the Revised Statutes of the United States, and of an Act of the General Assembly of Arizona, entitled "An Act to Revise and Codify the Laws of the Territory of Arizona," approved March 16, 1901.

This is an Amended Location Notice of the CALUMET Mining Claim, located by J. W. DAILY, grantor of the undersigned owner on the 7th day of

October, 19 11, and recorded in Book SS of Records of Mines, at page 1, in the office of the County Recorder of the aforesaid County of Pima,

to which reference is hereby made, and this amended Location Notice is made and posted to correct errors in the description in the said original Location Notice.

Dated and posted on the ground this 26th day of Nov, 19 17

DAILY-ARIZONA CONSOLIDATED COPPER COMPANY,  
(Present Owner)

By Blancock  
Its Attorney in Fact.

STATE OF ARIZONA,

County of \_\_\_\_\_

ss.

I \_\_\_\_\_, County Recorder in and for the County and State aforesaid, do hereby certify that the within instrument was filed for record at \_\_\_\_\_ o'clock \_\_\_\_\_ M., on this \_\_\_\_\_ day of \_\_\_\_\_ 19\_\_\_\_, and duly recorded in book No. \_\_\_\_\_ of \_\_\_\_\_ Records of \_\_\_\_\_ County, Arizona, at pages \_\_\_\_\_.

WITNESS my hand and official seal the year first above written.

Country Recorder.

AMENDED

Notice of Location

LODE CLAIM

Dated \_\_\_\_\_, 19\_\_\_\_

Filed and Recorded at request of

*R. W. Langworthy*

*Dec. 17* A. D. 19*17*

at *11-20* a. M.,

Book *P. P. B. Record of Mines*

Pages *392*

*P. P. B. Record of Mines*  
County Recorder.

By *R. M. Shihel*  
Deputy Recorder.

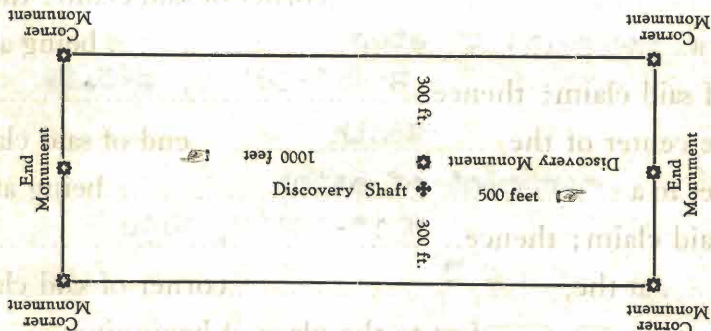

This Diagram is to give locator a general idea of plan of location under the new law. The Discovery Shaft can be in the center of the claim or any distance from either end desired. In the diagram it is placed 500 feet from one end and 1000 ft. from the other.

Commence description of claim at a center end monument, giving its distance and direction from center of Discovery Shaft; thence bound the claim in either direction. In description be careful to state locality of claim with reference to some natural object, or permanent monument, as will identify the claim.



STATE OF ARIZONA, }  
COUNTY OF PIMA. } ss.

I, R. B. Vinson, County Recorder in and for the  
County of Pima, State of Arizona, do hereby certify that the above and foregoing is a full, true and correct copy  
of Amended Location Notice of the Edith Mining Claim, situated in  
the Old Hat Mining District, and now owned by the Daily-Arizona  
Consolidated Copper Company, dated Nov. 26th, 1917,  
as appears of record now in my office in Book B.B.B. Record of Mines Pages 373

IN WITNESS WHEREOF, I have hereunto set my hand

and affixed my official seal, at my office in Tucson,

this Eighth day of

January, A. D. 1917

R. B. Vinson  
County Recorder of Pima County, Arizona.

AMENDED

# Notice of Mining Location

## LODE CLAIM

42

TO ALL WHOM IT MAY CONCERN:

This Mining Claim, the name of which is the EDITH Mining Claim, situate on lands belonging to the United States of America, and in which there are valuable mineral deposits, was entered upon and located for the purpose of exploration and purchase by GEO. F. KITT, a citizen of the United States, grantor of

(Locator must insert either "a citizen of the United States." or "who has declared his intention to become a citizen of the United States.")

the undersigned, on the 27th day of July, 1910.

The length of the claim is 1500 feet, and we claim 225 feet, in a N 58°-01' W direction and 1275 feet in a S 58°-01' E direction from

the center of the discovery shaft, at which this notice was posted, lengthwise of the claim, together with 300 feet in width of surface grounds, on each side of the center of said claim. The general course of the lode deposit and premises is from the N 58°-01' W to the S 58°-01' E.

The Claim is situated and located in the Old Hat Mining District, in Pima County in the State of Arizona, ~~about~~ direction from N E Cor of Claim the N W Cor of Sec 21, T 11 S, R 16 E, bears N 79°-03' E, 1650 Ft.

The surface boundaries of the claim are marked upon the ground as follows: Beginning at a monument of stone

at a point in a N 58°-01' W direction 225 feet from the discovery shaft (at which this notice is posted), being in the center of the West end line of said claim; thence S 1°-18' W, 348.84 feet to a monument of stone, being the S W corner of said claim; thence S 58°-01' E, 1500 feet to a monument, being at the S E corner of said claim; thence N 1°-18' E, 348.84 feet to a monument at the center of the East end of said claim; thence N 1°-18' E, 348.84 feet to a monument of stone being at the N E corner of said claim; thence N 58°-01' W, 1500 feet to a monument of stone at the N E corner of said claim; thence S 1°-18' W, 348.84 feet to the place of beginning.

All done under the provisions of Chapter Six, of Title XXXII, of the Revised Statutes of the United States, and of an Act of the General Assembly of Arizona, entitled "An Act to Revise and Codify the Laws of the Territory of Arizona," approved March 16, 1901.

This is an Amended Location Notice of the EDITH Mining Claim, located by GEO. F. KITT, grantor of the undersigned owner on the 27th day of July, 1910, and recorded in Book 99 of Records of Mines, at page 305, in the office of the County Recorder of the aforesaid County of Pima to which reference is hereby made, and this amended Location Notice is made and posted to correct errors in the description in the said original Location Notice.

Dated and posted on the ground this 26th day of Nov, 1917

DAILY-ARIZONA CONSOLIDATED COPPER COMPANY,  
(Present owner)

By J. Hancock  
Its Attorney in Fact.

STATE OF ARIZONA,

County of \_\_\_\_\_ ss.

I \_\_\_\_\_, County Recorder in and for the County and State aforesaid, do hereby certify that the within instrument was filed for record at \_\_\_\_\_ o'clock \_\_\_\_\_ M., on this \_\_\_\_\_ day of \_\_\_\_\_ 19\_\_\_\_, and duly recorded in book No. \_\_\_\_\_ of \_\_\_\_\_ Records of \_\_\_\_\_ County, Arizona, at pages \_\_\_\_\_.

WITNESS my hand and official seal the year first above written.

\_\_\_\_\_  
Country Recorder.

AMENDED

Notice of Location  
LODE CLAIM

Dated \_\_\_\_\_, 19\_\_\_\_

Filed and Recorded at request of

*R. W. Langworthy*

*Dec. 17* A. D. 19\_\_\_\_

at *11-30* a. M.

Book *213* Page *392*

Pages

*R. P. Howard*

County Recorder.

*A. M. Mitchell*

Deputy Recorder.

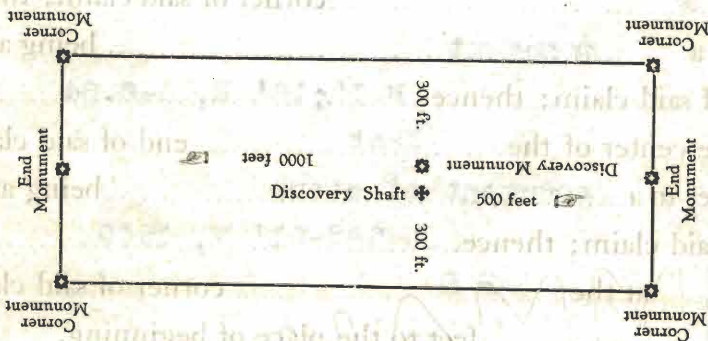

This Diagram is to give locator a general idea of plan of location under the new law. The Discovery Shaft can be in the center of the claim or any distance from either end desired. In the diagram it is placed 500 feet from one end and 1000 ft. from the other. Commence description of claim at a center end monument, giving its distance and direction from center of Discovery Shaft; thence bound the claim in either direction. In description be careful to state locality of claim with reference to some natural object, or permanent monument, as will identify the claim.

STATE OF ARIZONA, }  
COUNTY OF PIMA. } ss.

I, ..... R. B. Vinson ..... County Recorder in and for the  
County of Pima, State of Arizona, do hereby certify that the above and foregoing is a full, true and correct copy  
of Amended Location Notice of the Daily Extension Mining Claim, ...  
situated in the Old Hat Mining District, and now owned by Daily-  
Arizona Consolidated Copper Company, dated Nov. 26th, 1917  
as appears of record now in my office in Book B.B.B. Record of Mines pages 374

IN WITNESS WHEREOF, I have hereunto set my hand  
and affixed my official seal, at my office in Tucson,  
this Eighth ..... day of  
January ..... A. D. 1917  
R. B. Vinson  
County Recorder of Pima County, Arizona.

45

AMENDED  
**Notice of Mining Location**  
**LODE CLAIM**

TO ALL WHOM IT MAY CONCERN:

This Mining Claim, the name of which is the DAILY EXTENSION Mining Claim, situate on lands belonging to the United States of America, and in which there are valuable mineral deposits, was entered upon and located for the purpose of exploration and purchase by J. W. DAILY, grantor of

(Locator must insert either "a citizen of the United States." or "who has declared his intention to become a citizen of the United States.")

the undersigned, on the 1st day of January, 1911

The length of the claim is 1438.9 feet, and we claim 170 feet,

in a S 82°-16' E direction and 1268.9 feet in a N 82°-16' W direction from

the center of the discovery shaft, at which this notice was posted, lengthwise of the claim, together with 300 feet in width of surface grounds, on each side

of the center of said claim. The general course of the lode deposit and premises is from the N 82°-16' W to the S 82° 16' E

The Claim is situated and located in the Old Hat Mining District, in Pima County in the State of Arizona, ~~about~~

in a direction from S. E. Cor. of Claim the N. W. Cor. of Sec 31, T. 11 S., R. 16 E., bears S 67°14' E, 3614.9 ft.

The surface boundaries of the claim are marked upon the ground as follows: Beginning at monument of stone

at a point in a S 82° 16' E direction 170 feet from the discovery shaft (at which this notice is posted), being in the center of the East

end line of said claim; thence N 7° 13' E, 226.04 feet to a monument of stone, being the N. E. corner of said claim; thence

N 78° W 750 ft to N Side Corner; thence S 79° W, 728 feet to a monument of stone, being at the N. W. corner of said claim; thence S 73° 13' W, 47.87 feet

to a Monument at the center of the West end of said claim; thence S 7°13'W, 300 feet to a monument being at the

S. W. corner of said claim; thence S 82°16'E, 1438.9 feet to a monument of stone at the S. E. corner of said claim;

thence N 7°13' E, 300 feet to the place of beginning.

All done under the provisions of Chapter Six, of Title XXXII, of the Revised Statutes of the United States, and of an Act of the General Assembly of Arizona, entitled "An Act to Revise and Codify the Laws of the Territory of Arizona," approved March 16, 1901.

This is an Amended Location Notice of the DAILY EXTENSION Mining Claim, located by J. W. Daily, grantor of the undersigned owner

on the 1st day of January, 1910, and recorded in Book 0.0 of Records of Mines, at

page 491, in the office of the County Recorder of the aforesaid County of Pima to which reference is hereby made, and this amended Location Notice is made and posted to

correct errors in the description in the said original Location Notice and also to correct the date of entry & location and posting on ground to January 1, 1911.

Dated and posted on the ground this 20th day of Jan, 1917.

DAILY-ARIZONA CONSOLIDATED COPPER COMPANY,  
(Present owner)

By Stancock  
Its Attorney in Fact.

STATE OF ARIZONA,

County of .....

AMENDED  
Notice of Mining Location  
LODE CLAIM  
ss.

I ....., County Recorder in and for the County and State aforesaid, do hereby certify that the within instrument was filed for record at ..... o'clock M., on this ..... day of ..... 19 ....., and duly recorded in book No. .... of ..... Records of ..... County, Arizona, at pages .....

WITNESS my hand and official seal the year first above written.

Country Recorder.

AMENDED  
Notice of Location  
LODE CLAIM

Dated ....., 19 .....

Filed and Recorded at request of

*R. N. Casperworthy*

*Quartz Hill* A. D. 19 *19*

at *11-30* A. M.,

Book *7 A. B. B. Ready of mine*

Pages *3 of 4*

*R. B. Yarnall*  
County Recorder.

By *A. M. Shubert*  
Deputy Recorder.

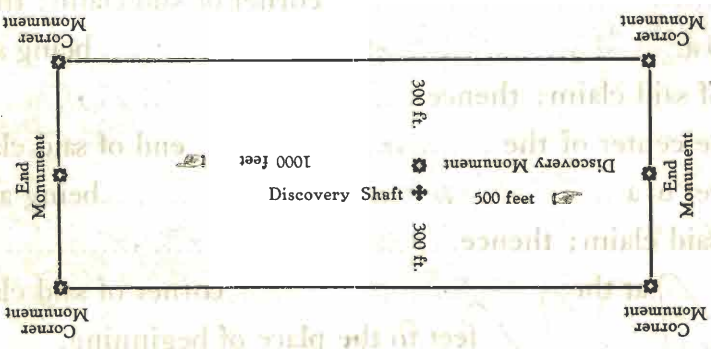

This Diagram is to give locator a general idea of plan of location under the new law. The Discovery Shaft can be in the center of the claim or any distance from either end desired. In the diagram it is placed 500 feet from one end and 1000 ft. from the other. Commence description of claim at a center end monument, giving its distance and direction from center of Discovery Shaft; thence bound the claim in either direction. In description be careful to state locality of claim with reference to some natural object, or permanent monument, as will identify the claim.

STATE OF ARIZONA, }  
COUNTY OF PIMA. } ss.

I, R. B. Vinson, County Recorder in and for the

County of Pima, State of Arizona, do hereby certify that the above and foregoing is a full, true and correct copy of Amended Location Notice of Cave Mining Claim situated in the Old Hat Mining District, and now owned by the Daily-Arizona Consolidated Copper Company, dated Nov. 26th, 1917,

as appears of record now in my office in Book B.B.B. Record of Mines Pages 375

IN WITNESS WHEREOF, I have hereunto set my hand

and affixed my official seal, at my office in Tucson,

this Eighth day of

January, A. D. 1917

*R. B. Vinson*  
County Recorder of Pima County, Arizona.

AMENDED

# Notice of Mining Location

## LODE CLAIM

TO ALL WHOM IT MAY CONCERN:

This Mining Claim, the name of which is the CAVE Mining Claim, situate on lands belonging to the United States of America, and in which there are valuable mineral deposits, was entered upon and located for the purpose of exploration and purchase by J. W. DAILY, a citizen of United States, grantor of

(Locator must insert either "a citizen of the United States," or "who has declared his intention to become a citizen of the United States.")

the undersigned, on the 9th day of October, 1911.

The length of the claim is 1438.9 feet, and we claim 350 feet, in a S 82° 16' E direction and 1088.9

feet in a N 82° 16' W direction from the center of the discovery shaft, at which this notice was posted, lengthwise of the claim, together with 300 feet in width of surface grounds, on each side of the center of said claim. The general course of the lode deposit and premises is from the

S 82° 16' E to the N 82° 16' W. The Claim is situated and located in the Old Hat Mining District, in Pima County in the State of Arizona, about

in a direction from S E Cor of Claim the N W Cor Sec 21, T 11 S, R 16 E, bears S 76° 44' E, 3502.14 Ft.

The surface boundaries of the claim are marked upon the ground as follows: Beginning at A monument of stone

at a point in a S 82° 16' E direction 350 feet from the discovery shaft (at which this notice is posted), being in the center of the East end line of said claim; thence N 7° 13' E, 300 feet to a Monument, being the N E corner of said claim; thence N 82° 16' W, 1438.9 feet to a Monument of stone, being at the N W corner of said claim; thence S 7° 13' W, 300 feet to a Monument at the center of the West end of said claim; thence S 7° 13' W, 300 feet to a Monument being at the S W corner of said claim; thence S 82° 16' E, 1438.9 feet to a Monument at the S E corner of said claim; thence N 7° 13' E, 300 feet to the place of beginning.

All done under the provisions of Chapter Six, of Title XXXII, of the Revised Statutes of the United States, and of an Act of the General Assembly of Arizona, entitled "An Act to Revise and Codify the Laws of the Territory of Arizona," approved March 16, 1901.

This is an Amended Location Notice of the CAVE Mining Claim, located by J W Daily, grantor of the undersigned owner on the 9th day of October, 1911, and recorded in Book S S of Records of Mines, at page 5, in the office of the County Recorder of the aforesaid County of Pima to which reference is hereby made, and this amended Location Notice is made and posted to correct errors in the description in the said original Location Notice.

Dated and posted on the ground this 26th day of Nov, 1917

DAILY-ARIZONA CONSOLIDATED COPPER COMPANY,  
(Present owner)

By J Hancock  
Its Attorney in Fact.



STATE OF ARIZONA,

County of \_\_\_\_\_

ss.

I \_\_\_\_\_, County Recorder in and for the County and State aforesaid, do hereby certify that the within instrument was filed for record at \_\_\_\_\_ o'clock \_\_\_\_\_ M., on this \_\_\_\_\_ day of \_\_\_\_\_ 19\_\_\_\_, and duly recorded in book No. \_\_\_\_\_ of \_\_\_\_\_ Records of \_\_\_\_\_ County, Arizona, at pages \_\_\_\_\_.

WITNESS my hand and official seal the year first above written.

Country Recorder.

AMENDED

Notice of Location  
LODE CLAIM

Dated \_\_\_\_\_, 19\_\_\_\_

Filed and Recorded at request of

*R. W. Fargnworthy*

*Dec. 14 A. D. 1919*

at \_\_\_\_\_ A. M.,

Book *P. B. Record of mines*

Pages *395*

*R. B. Winson*  
County Recorder.

*L. M. Shihel*  
Deputy Recorder.

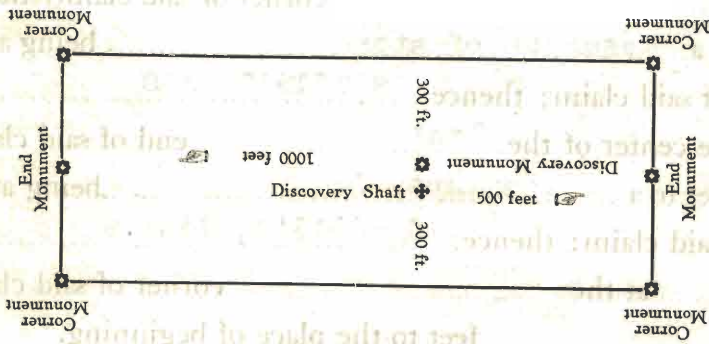

This Diagram is to give locator a general idea of plan of location under the new law. The Discovery Shaft can be in the center of the claim or any distance from either end desired. In the diagram it is placed 500 feet from one end and 1000 ft. from the other. Commence description of claim at a center end monument, giving its distance and direction from center of Discovery Shaft; thence bound the claim in either direction. In description be careful to state locality of claim with reference to some natural object, or permanent monument, as will identify the claim.

STATE OF ARIZONA, }  
COUNTY OF PIMA. } ss.

I, ----- R.B.Vinson -----, County Recorder in and for the

County of Pima, State of Arizona, do hereby certify that the above and foregoing is a full, true and correct copy  
of Amended Location Notice of the Wedge No. 3 Mining Claim situated  
in the Old Hat Mining District and now owned by Daily-Arizona Con-  
solidated Copper Company, dated Nov. 26th, 1917

as appears of record now in my office in Book B.B.B. Record of Mines Pages ----- 376 -----

IN WITNESS WHEREOF, I have hereunto set my hand

and affixed my official seal, at my office in Tucson,

this ----- Eighth ----- day of

----- January -----, A. D. 1917

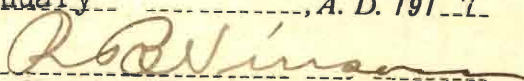
  
-----  
County Recorder of Pima County, Arizona.

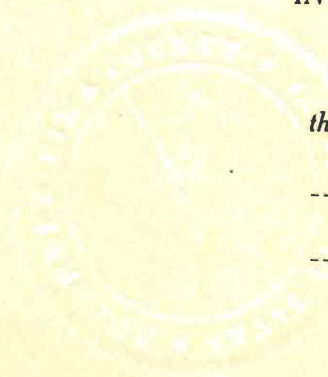

AMENDED

51

# Notice of Mining Location LODE CLAIM

TO ALL WHOM IT MAY CONCERN:

This Mining Claim, the name of which is the **WEDGE NO. 3** Mining Claim, situate on lands belonging to the United States of America, and in which there are valuable mineral deposits, was entered upon and located for the purpose of exploration and purchase by **J. W. DAILY, a citizen of United States, grantor of**

(Locator must insert either "a citizen of the United States," or "who has declared his intention to become a citizen of the United States.")

the undersigned, on the **12th** day of **October**, 19**11**.

The length of the claim is **1438.9** feet, and **we** claim **590** feet,

in a **N 82° 16' W** direction and **848.9**

feet in a **S 82° 16' E** direction from the center of the discovery shaft, at which this notice was posted, lengthwise of the claim, together with **300** feet in width of surface grounds, on each side of the center of said claim. The general course of the lode deposit and premises is from the

**N 82° 16' W** to the **S 82° 16' E**

The Claim is situated and located in the **Old Hat** Mining District, in

**Pima** County in the State of Arizona, about

**xxx** direction from **S. E. Cor claim, the N. W. Cor Sec 21, T. 11 S., R. 16 E., bears S 86° 36' E, 3428.24 ft.**

The surface boundaries of the claim are marked upon the ground as follows: Beginning at **a monument of stone**

at a point in a **S 82° 16' E** direction **848** feet from

the discovery shaft (at which this notice is posted), being in the center of the **East**

end line of said claim; thence **N 1° 18' E, 300** feet to a **monument**

, being the **N. E.** corner of said claim; thence

**N 82° 16' W, 1438.9** feet to a **monument of stone**, being at the

**N. W.** corner of said claim; thence **S 1° 18' W, 300** feet

to a **Monument** at the center of the **West** end of said claim;

thence **S 1° 18' W, 300** feet to a **monument of stone** being at the

**S. W.** corner of said claim; thence **S 82° 16' E, 1438.9** feet

to a **monument** at the **S. E.** corner of said claim;

thence **N 1° 18' E, 300** feet to the place of beginning.

All done under the provisions of Chapter Six, of Title XXXII, of the Revised Statutes of the United States, and of an Act of the General Assembly of Arizona, entitled "An Act to Revise and Codify the Laws of the Territory of Arizona," approved March 16, 1901.

This is an Amended Location Notice of the **WEDGE NO. 3** Mining Claim, located by **J. W. Daily, Grantor of the undersigned owner**

on the **12th** day of

**October**, 19**11**, and recorded in Book **S. S.** of Records of Mines, at

page **3**, in the office of the County Recorder of the aforesaid County of **Pima**

to which reference is hereby made, and this amended Location Notice is made and posted to

correct errors in the description in the said original Location Notice.

Dated and posted on the ground this **16th** day of **Nov**, 19**11**

**DAILY-ARIZONA CONSOLIDATED COPPER COMPANY**  
(Present owner)

By **J. Hancock**  
Its Attorney in Fact

STATE OF ARIZONA,

County of \_\_\_\_\_

ss.

I \_\_\_\_\_, County Recorder in and for the County and State aforesaid, do hereby certify that the within instrument was filed for record at \_\_\_\_\_ o'clock \_\_\_\_\_ M., on this \_\_\_\_\_ day of \_\_\_\_\_ 19\_\_\_\_, and duly recorded in book No. \_\_\_\_\_ of \_\_\_\_\_ Records of \_\_\_\_\_ County, Arizona, at pages \_\_\_\_\_

WITNESS my hand and official seal the year first above written.

Country Recorder.

AMENDED

Notice of Location  
LODE CLAIM

Dated \_\_\_\_\_, 19\_\_\_\_

Filed and Recorded at request of

*R. W. Langworthy*

*Dec. 14* A. D. 19*14*

at \_\_\_\_\_ a. M.,

Book *B. B. Record of Mines*

Pages *376*

*R. B. Jenson*  
County Recorder.

By *L. M. Hubbell*  
Deputy Recorder.

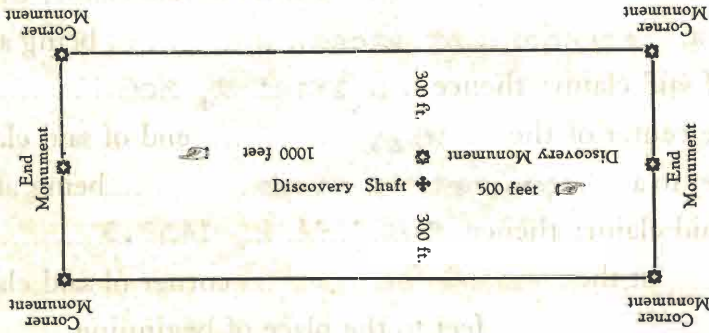

This Diagram is to give locator a general idea of plan of location under the new law. The Discovery Shaft can be in the center of the claim or any distance from either end desired. In the diagram it is placed 500 feet from one end and 1000 ft. from the other.

Commence description of claim at a center end monument, giving its distance and direction from center of Discovery Shaft; thence bound the claim in either direction. In description be careful to state locality of claim with reference to some natural object, or permanent monument, as will identify the claim.

STATE OF ARIZONA, }  
 COUNTY OF PIMA. } ss.

I, R. B. Vinson \_\_\_\_\_, County Recorder in and for the  
 County of Pima, State of Arizona, do hereby certify that the above and foregoing is a full, true and correct copy  
 of Amended Location Notice of the Wedge No. 2 Mining Claim situat-  
 ed in the Old Hat Mining District, and now owned by the Daily-  
 Arizona Consolidated Copper Company, dated Nov. 26th, 1917  
 as appears of record now in my office in Book B.B.B. Record of Mines 377 \_\_\_\_\_

IN WITNESS WHEREOF, I have hereunto set my hand

and affixed my official seal, at my office in Tucson,  
 this Eighth \_\_\_\_\_ day of

January \_\_\_\_\_, A. D. 1917

R. B. Vinson  
 \_\_\_\_\_  
 County Recorder of Pima County, Arizona.

AMENDED

# Notice of Mining Location

## LODE CLAIM

TO ALL WHOM IT MAY CONCERN:

This Mining Claim, the name of which is the WEDGE NO 2 Mining Claim, situate on lands belonging to the United States of America, and in which there are valuable mineral deposits, was entered upon and located for the purpose of exploration and purchase by GEORGE F KITT, a citizen of the United States, grantor of

(Locator must insert either "a citizen of the United States," or "who has declared his intention to become a citizen of the United States.")

the undersigned, on the.....day of....., 19.....

The length of the claim is 1438.9 feet, and we claim 1138.9 feet, in a N 82° 16' W direction and 300.0

feet in a S 82° 16' E direction from the center of the discovery shaft, at which this notice was posted, lengthwise of the claim, together with 300 feet in width of surface grounds, on each side of the center of said claim. The general course of the lode deposit and premises is from the N 82° 16' W to the S 82° 16' E

The Claim is situated and located in the OLD HAT Mining District, in.....County in the State of Arizona, about in a.....direction from N E Cor of Claim The N W Cor Sec 21 - T 11 S - R 16 E bears S 86° 36' E 3428.24 feet

The surface boundaries of the claim are marked upon the ground as follows: Beginning at a monument of stone

at a point in a S 82° 13' E direction 300 feet from the discovery shaft (at which this notice is posted), being in the center of the East end line of said claim; thence N 1° 18' E 300 feet to a monument of stone, being the N E corner of said claim; thence N 82° 13' W 1458.0 feet to a monument of stone, being at the N W corner of said claim; thence S 1° 18' W 300 feet to a monument of stone at the center of the W end of said claim; thence S 1° 18' W 300 feet to a monument of stone being at the S W corner of said claim; thence S 82° 13' E 1458.0 feet to a monument of stone at the S E corner of said claim; thence N 1° 18' E 300 feet to the place of beginning.

All done under the provisions of Chapter Six, of Title XXXII, of the Revised Statutes of the United States, and of an Act of the General Assembly of Arizona, entitled "An Act to Revise and Codify the Laws of the Territory of Arizona," approved March 16, 1901.

This is an Amended Location Notice of the WEDGE NO 2 Mining Claim, located by GEORGE F KITT, grantor of the undersigned owner on the 27th day of July, 1910, and recorded in Book 00 of Records of Mines, at page 307, in the office of the County Recorder of the aforesaid County of Pima to which reference is hereby made, and this amended Location Notice is made and posted to correct errors in the description in the said original Location Notice.

Dated and posted on the ground this 26<sup>th</sup> day of July, 1917

DAILY CONSOLIDATED COPPER COMPANY,  
(present owner)

By J Hancock  
Its Attorney in Fact

STATE OF ARIZONA,

County of \_\_\_\_\_

ss.

I \_\_\_\_\_, County Recorder in and for the County and State aforesaid, do hereby certify that the within instrument was filed for record at \_\_\_\_\_ o'clock \_\_\_\_\_ M., on this \_\_\_\_\_ day of \_\_\_\_\_ 19\_\_\_\_, and duly recorded in book No. \_\_\_\_\_ of \_\_\_\_\_ Records of \_\_\_\_\_ County, Arizona, at pages \_\_\_\_\_.

WITNESS my hand and official seal the year first above written.

Country Recorder.

AMENDED

Notice of Location

LODE CLAIM

Dated \_\_\_\_\_, 19\_\_\_\_

Filed and Recorded at request of

*P. W. Langworthy*

*Dec. 14* A. D. 19*17*

at *11-30* a. M.,

Book *P. P. B. Record of mines*

Pages *3 of*

*P. B. Yarrow*  
County Recorder.

By *P. M. Shubell*  
Deputy Recorder.

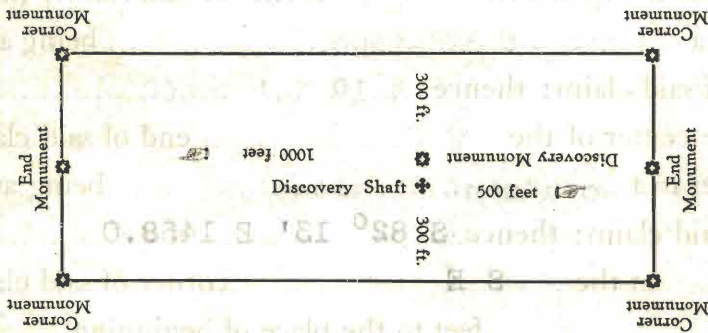

This Diagram is to give locator a general idea of plan of location under the new law. The Discovery Shaft can be in the center of the claim or any distance from either end desired. In the diagram it is placed 500 feet from one end and 1000 ft. from the other. Commence description of claim at a center end monument, giving its distance and direction from center of Discovery Shaft; thence bound the claim in either direction. In description be careful to state locality of claim with reference to some natural object, or permanent monument, as will identify the claim.

STATE OF ARIZONA, }  
COUNTY OF PIMA. } ss.

I, R. B. Vinson, County Recorder in and for the  
County of Pima, State of Arizona, do hereby certify that the above and foregoing is a full, true and correct copy  
of Amended Location Notice of the Katherine Mining Claim, situated  
in the Old Hat Mining District, and now owned by Daily-Arizona  
Consolidated Copper Company, dated Nov. 26th, 1917  
as appears of record now in my office in Book B. B. B. Record of Mines Pages 378

IN WITNESS WHEREOF, I have hereunto set my hand

and affixed my official seal, at my office in Tucson,

this Eighth day of

January, A. D. 1917

R. B. Vinson  
County Recorder of Pima County, Arizona.

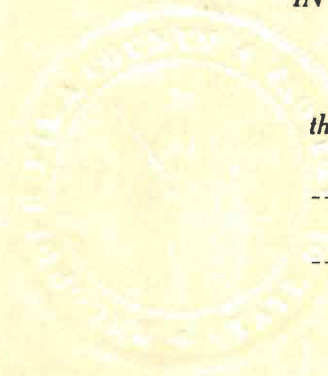



AMENDED

57

# Notice of Mining Location

## LODE CLAIM

TO ALL WHOM IT MAY CONCERN:

This Mining Claim, the name of which is the **KATHERINE** Mining Claim, situate on lands belonging to the United States of America, and in which there are valuable mineral deposits, was entered upon and located for the purpose of exploration and purchase by **GEORGE F. KITT, a citizen of the United States** grantor of

(Locator must insert either "a citizen of the United States." or "who has declared his intention to become a citizen of the United States.")

the undersigned, on the **27th** day of **July**, 19**10**.

The length of the claim is **1500** feet, and **we** claim **600** feet,

in a **N. 82° 16' W** direction and **900** feet in a **S. 82° 16' E** direction from the center of the discovery shaft, at which this notice was posted, lengthwise of the claim, together with **300** feet in width of surface grounds, on each side of the center of said claim. The general course of the lode deposit and premises is from the

**N. 82° 16' W** to the **S. 82° 16' E**

The Claim is situated and located in the **OLD HAT** Mining District, in **Pima** County in the State of Arizona, about **4000** in a **N. W.** direction from **U. S. M. M. No. 1**

The surface boundaries of the claim are marked upon the ground as follows: Beginning at **A. Monument**

at a point in a **S. 82° 16' E** direction **600** feet from the discovery shaft (at which this notice is posted), being in the center of the **East** end line of said claim; thence **N. 1° 18' E 300** feet to a **Monument**, being the **N. E** corner of said claim; thence **N. 82° 16' W 1438.4** feet to a **Monument**, being at the **N. W** corner of said claim; thence **S. 1° 18' W 300** feet to a **Monument** at the center of the **West** end of said claim; thence **S. 1° 18' W 300** feet to a **Monument** being at the **S. W** corner of said claim; thence **S. 82° 16' E 1438.9** feet to a **Monument** at the **S. E** corner of said claim; thence **N. 1° 18' E 300** feet to the place of beginning.

All done under the provisions of Chapter Six, of Title XXXII, of the Revised Statutes of the United States, and of an Act of the General Assembly of Arizona, entitled "An Act to Revise and Codify the Laws of the Territory of Arizona," approved March 16, 1901.

This is an Amended Location Notice of the **KATHERINE** Mining Claim, located by **GEORGE F. KITT, grantor of the Undersigned owner** on the **27th** day of **July**, 19**10**, and recorded in Book **Q. Q.** of Records of Mines, at page **3**, in the office of the County Recorder of the aforesaid County of **\_\_\_\_\_** to which reference is hereby made, and this amended Location Notice is made and posted to correct errors in the description in the said original Location Notice.

Dated and posted on the ground this **26th** day of **July**, 19**17**

**DAILY-ARIZONA CONSOLIDATED COPPER COMPANY,**  
(Present Owner)

By **J. Hancock**  
Its Attorney in Fact

STATE OF ARIZONA,

ss.

County of \_\_\_\_\_

I \_\_\_\_\_, County Recorder in and for the County and State aforesaid, do hereby certify that the within instrument was filed for record at \_\_\_\_\_ o'clock \_\_\_\_\_ M., on this \_\_\_\_\_ day of \_\_\_\_\_ 19\_\_\_\_, and duly recorded in book No. \_\_\_\_\_ of \_\_\_\_\_ Records of \_\_\_\_\_ County, Arizona, at pages \_\_\_\_\_.

WITNESS my hand and official seal the year first above written.

Country Recorder.

**AMENDED  
Notice of Location  
LODE CLAIM**

Dated \_\_\_\_\_, 19\_\_\_\_

Filed and Recorded at request of

*R. N. Baugworth*

*Dec 14* A. D. 19*17*

at \_\_\_\_\_ A. M.,

Book *F. B. Board of Mines*

Pages *378*

By *R. P. Johnson*

County Recorder.

*A. M. Shihell*

Deputy Recorder.

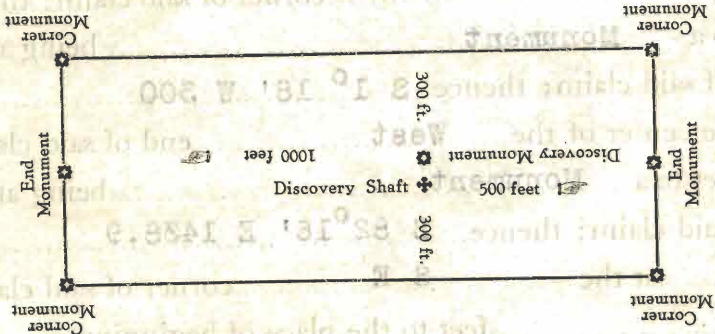

This Diagram is to give locator a general idea of plan of location under the new law. The Discovery Shaft can be in the center of the claim or any distance from either end desired. In the diagram it is placed 500 feet from one end and 1000 ft. from the other.

Commence description of claim at a center end monument, giving its distance and direction from center of Discovery Shaft; thence bound the claim in either direction. In description be careful to state locality of claim with reference to some natural object, or permanent monument, as will identify the claim.

KATHERINE  
 GEORGE Y KITZ, Grantor of the Understated owner  
 on the \_\_\_\_\_ day of \_\_\_\_\_ 19\_\_\_\_  
 recorded in book \_\_\_\_\_ of Records of \_\_\_\_\_ County of \_\_\_\_\_  
 Arizona, at pages \_\_\_\_\_.  
 I, \_\_\_\_\_ County Recorder in and for the County and State aforesaid, do hereby certify that the within instrument was filed for record at \_\_\_\_\_ o'clock \_\_\_\_\_ M., on this \_\_\_\_\_ day of \_\_\_\_\_ 19\_\_\_\_, and duly recorded in book No. \_\_\_\_\_ of \_\_\_\_\_ Records of \_\_\_\_\_ County, Arizona, at pages \_\_\_\_\_.  
 WITNESS my hand and official seal the year first above written.  
 \_\_\_\_\_ Country Recorder.  
 \_\_\_\_\_ Deputy Recorder.

## U. S. SURVEYOR-GENERAL'S FINAL CERTIFICATE ON FIELD NOTES.

## Department of the Interior,

OFFICE OF U. S. SURVEYOR-GENERAL,

Phoenix, Arizona,

July 10, 1919

I, U. S. Surveyor-General for District of Arizona

do hereby certify that the foregoing transcript of the Field Notes, return and approval of the survey of the mining claim of

Daily-Arizona Consolidated Copper Company

known as the Daily No. 3, Daily No. 5, Sphinx, Roskruge, Calumet, Edith, Daily Extension, Cave, Wedge No. 3, Wedge No. 2, and Katherine lodes. situate in Old Hat.

Mining District, Pima County, Arizona.

in Section 17-20 uns Township No. 11 S., Range No. 16 E., and

designated as Survey No. 3499, has been correctly copied from the originals on file in this office; that said Field Notes furnish such an accurate description of said mining claim as will, if incorporated into a patent, serve fully to identify the premises, and that such reference is made therein to natural objects or permanent monuments as will perpetuate and fix the locus thereof.

And I further certify that five hundred dollars' worth of labor has been expended or improvements made upon said mining claims by claimant or its grantors, and that said improvements consist of 17 cuts, 1 shaft, 3 tunnels and 11/12 of the value of improvement No. 7 on the Copper Princess lode, Sur. No. 3500, total value \$7634. As said improvement on the Copper Princess lode is a common improvement for the Copper Princess lode, of Sur. No. 3500, and the eleven claims of this survey, an undivided 1/12 interest therein, value \$500, is properly credited to each of the said twelve claims.

and that no portion of said labor or improvements has been included in the estimate of expenditures upon any other claim.

I further certify that the plat thereof, filed in the U. S. Land Office at Phoenix,

Arizona, is correct and in conformity with the foregoing Field Notes.

Frank P. Trott,

United States Surveyor-General for Arizona.

4-687

SURVEYOR GENERAL'S CERTIFICATE OF APPROVAL OF FIELD NOTES  
AND SURVEY OF MINING CLAIM

DEPARTMENT OF THE INTERIOR  
OFFICE OF U. S. SURVEYOR GENERAL

Phoenix, Arizona,

July 10, 1919

I, U. S. Surveyor General for District of Arizona,

do hereby certify that the foregoing and hereto attached Field Notes and Return of the Survey of the Mining Claim of

Daily-Arizona Consolidated Copper Company

known as the

Daily No. 3, Daily No. 5, Sphinx, Roskruge, Calumet, Edith Daily Extension, Cave, Wedge No. 3, Wedge No. 2, and Katherine lodes.

situate in Old Hat mining district,

Pima County, Arizona.

in Sections 17-20 uns., Township No. 11 S., Range No. 16 E.

designated as Survey No. 3499

executed by T. N. Stevens, U. S. Mineral

Surveyor, April 28-May 12, 1918, under my instructions dated

April 12, 1918, have been critically examined and the necessary cor-

rections and explanations made, and the said Field Notes and Return, and the Survey they describe,

are hereby approved. The certified copy of the location certificate filed by the applicant for survey is

on file in this office and a true copy of said certified copy of said location certificate is included and made

a part of the transcript of the field notes.



U. S. Surveyor General for Arizona.